

EXIST. 2-STORY
FRAME DWELLING

EXIST. WOOD SHED

N. 09° 31' 00" W.

45.00'

80.00'

S. 80° 39' 00" W.

3' HIGH CONC.
BLOCK WALL

54.55'

SCAPING
10' BLDG. SETBACK
CONC. CURB

19
INSTALL NEW
YARD LIGHT

5'-0" BLDG. SETBACK

LANDSCAPING

PHONE
PHONE

ASPHALT PA

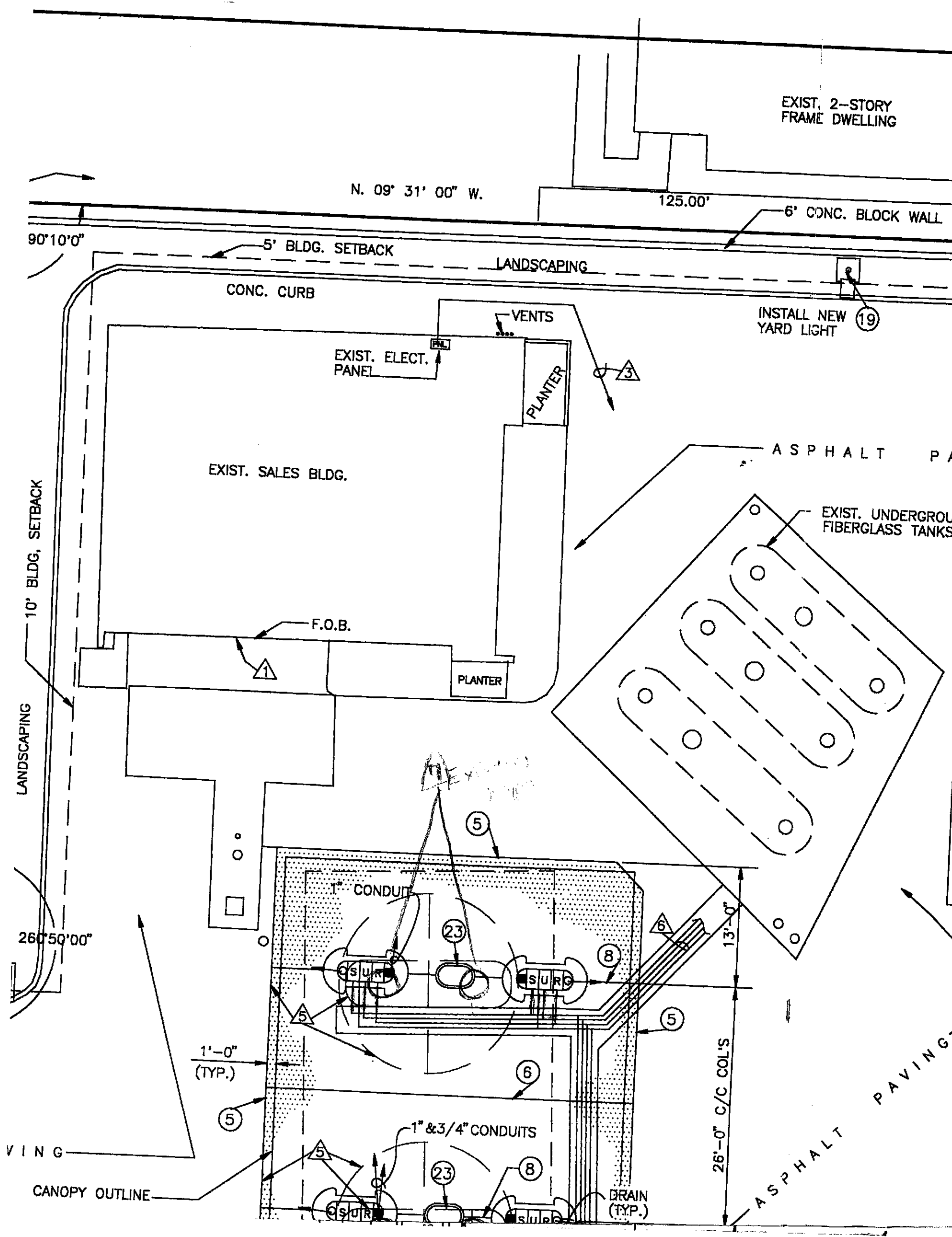

EXIST. 2-STORY
FRAME DWELLING

N. 09° 31' 00" W.

125.00'

6' CONG. BLOCK WALL

90'10"0"

5' BLDG. SETBACK

LANDSCAPING

CONC. CURB

INSTALL NEW
YARD LIGHT (19)

EXIST. ELECT.
PANEL

PLANTER

EXIST. SALES BLDG.

ASPHALT PA

EXIST. UNDERGROU
FIBERGLASS TANKS

F.O.B.

PLANTER

10' BLDG. SETBACK

LANDSCAPING

260'50"00"

1'-0"
(TYP.)

1" CONDUIT

1" & 3/4" CONDUITS

SURG

SURG

SURG

SURG

DRAIN
(TYP.)

13'-0"
26'-0" C/C COL'S

ASPHALT PAVING

V I N G

CANOPY OUTLINE

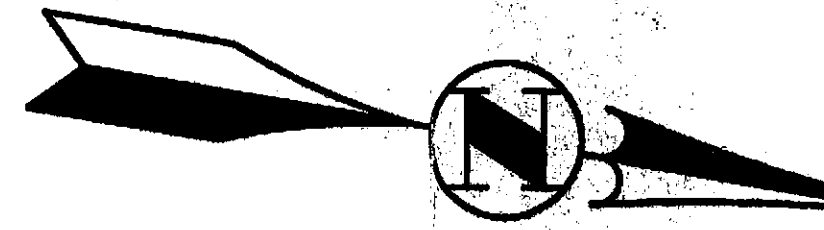
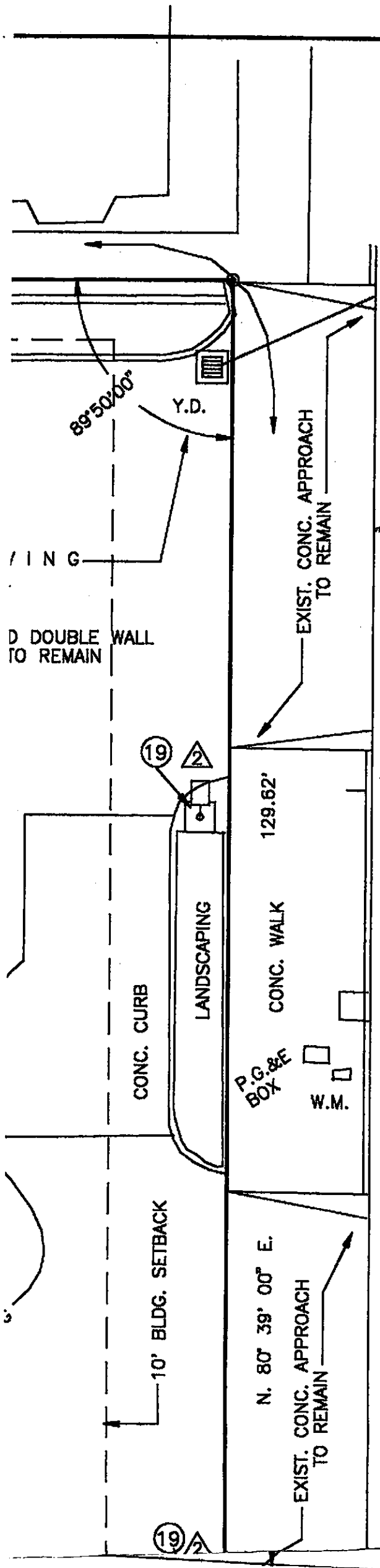

5/2

ACCEPTED

DEPARTMENT OF ENVIRONMENTAL
470 - 27th Street, Third Floor
Oakland, CA 94612
Telephone: (415) 874-7237

These plans have been reviewed and found acceptable and essentially meet the requirements of local health laws. Changes to your plans or Department are to assure compliance with local laws. The project proposed herein is now ready for any required building permits for construction.

One copy of these approved plans must be available to all contractors and craftsmen doing the construction and installation. Any change or alterations of these plans or must be submitted to this Department and Building Inspection Department to determine if changes meet the requirements of State or local laws. Notify this Department at least 48 hours before any required inspections:

- Pressure Test
- Pre-Covering of Tank
- Final Inspection

Issuance of a permit to operate is dependent upon compliance with accepted plans and all applicable regulations.

THERE IS A FINANCIAL PENALTY FOR OBTAINING THESE INSPECTIONS WITHOUT THESE APPROVED PLANS.

A system precision should be done.

S. Hugo 6/1

55 TH STREET

(80.00' R/W)

NO PARKING SIGN

PLANTER

Shing diagrams

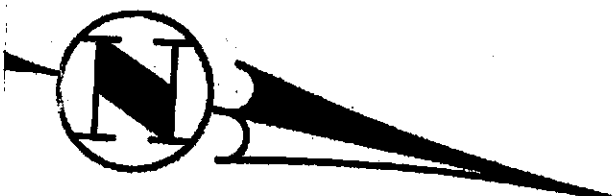

5/2/10
AH

ACCEPTED

DEPARTMENT OF ENVIRONMENTAL HEALTH
470 - 27th Street, Third Floor
Oakland, CA 94612
Telephone: (415) 874-7237

These plans have been reviewed and found to be acceptable and essentially meet the requirements of State and local health laws. Changes to your plans indicated by this Department are to assure compliance with State and local laws. The permit and associated fee is now released for issuance of the permit for construction.

Persons doing the work must be on the job and responsible for the work and craftsmen involved with the work must be licensed.

Any change in the plans and specifications must be submitted to the Department and to the Fire and Building Inspection Department to determine if such changes meet the requirements of State and local laws. Notify this Department at least 48 hours prior to the following required inspections:

- Pressure Test
- Pre-Covering of Tank and Piping
- Final Inspection

Issuance of a permit to operate is dependent on compliance with accepted plans and all applicable laws and regulations.

THERE IS A FINANCIAL PENALTY FOR NOT OBTAINING THESE INSPECTIONS.

As system precision test must be done.

A Hugo 6/25/90

(8 0 . 0 0 ' R / W)

DATA:

BUILDINGS:

BUILDING TREATMENT PER REIMAGE DRAWING:
5-RFF-G-IV .

CANOPY

NEW M-38'X50' C4-14 CANOPY.

TOP OF FOUNDATION:

CL OF DRAINS TO BE 0.17' ABOVE CONC. PAD AT EACH CANOPY COLUMN AND EXIT THRU ISLAND FORM.

BOTTOM OF FASCIA/CAPITAL:

TANKS, DISPENSERS & ISLAND TREATMENT:

EXIST. PRODUCT TANKS, SUBMERGED PUMPS AND PIPING TO REMAIN.

INSTALL (4) MULTIPLE PRODUCT DISPENSERS WITH ISLANDS.

CONNECT NEW 2" GLASS FIBER PRODUCT PIPING FROM NEW DISPENSER LOCATIONS TO EXIST. PIPING.

ISLAND TREATMENT PER REIMAGE DRAWING: II-IL-IV .

SEE DRAWINGS: 13-RG & 13R-S2VR.

YARD & DRIVE:

SEE DRAWING 16 FOR INSTALLATION DETAILS OF ITEMS SHOWN: O.

ISLAND PAD TO BE 6" THICK CONC. W/6X6X6 GA. WELDED WIRE FABRIC.

BENCH MARK:

THE EXISTING CIRCUITS AND WIRING TO BE CHECKED FOR ADEQUACY. REFER TO DRAWING 10-RI.

PAINTING TREATMENT PER REIMAGE DRAWING:
5-RFF-G-IV .

PAINT PREVIOUSLY PAINTED EXPOSED TRIM ON SALES BLDG.

NOTES: Δ

ALL CONSTRUCTION IS EXISTING AND TO REMAIN UNLESS NOTED OTHERWISE.

- 1) SEPARATE CONTRACTOR WILL ADD ALUMINUM COMPOSITE MATERIAL PANELS TO EXTERIOR OF ALL BUILDINGS.
- 2) REMOVE EXISTING YARD LIGHTS AND INSTALL NEW YARD LIGHTS ON EXISTING BASES.
- 3) INSTALL NEW CONDUIT FROM EXIST. ELECTRICAL PANEL TO NEW CANOPY AND DISPENSERS.
- 4) INSTALL NEW 2" FIBERGLASS PRODUCT AND VAPOR RECOVERY PIPING FROM NEW M.P.D.'S AND CONNECT TO THE APPROPRIATE EXISTING 2" PIPING
- 5) REMOVE EXISTING ISLANDS, DISPENSERS, CANOPIES AND CONC. ISLAND PAD.

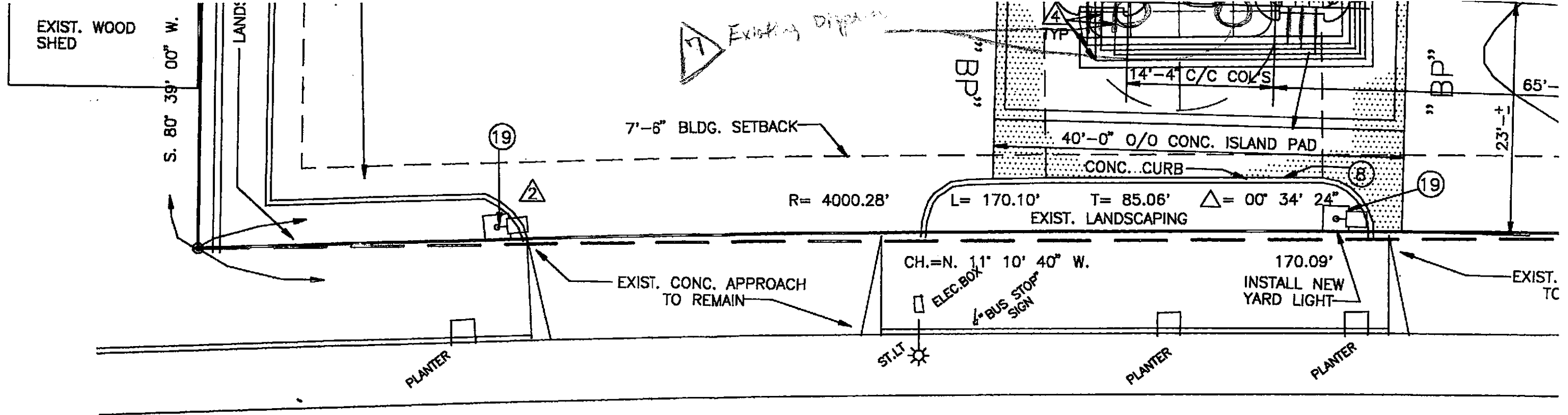

M A R T I N L U T H E R K I

(1 4 4 . 5 0 ' R / W)

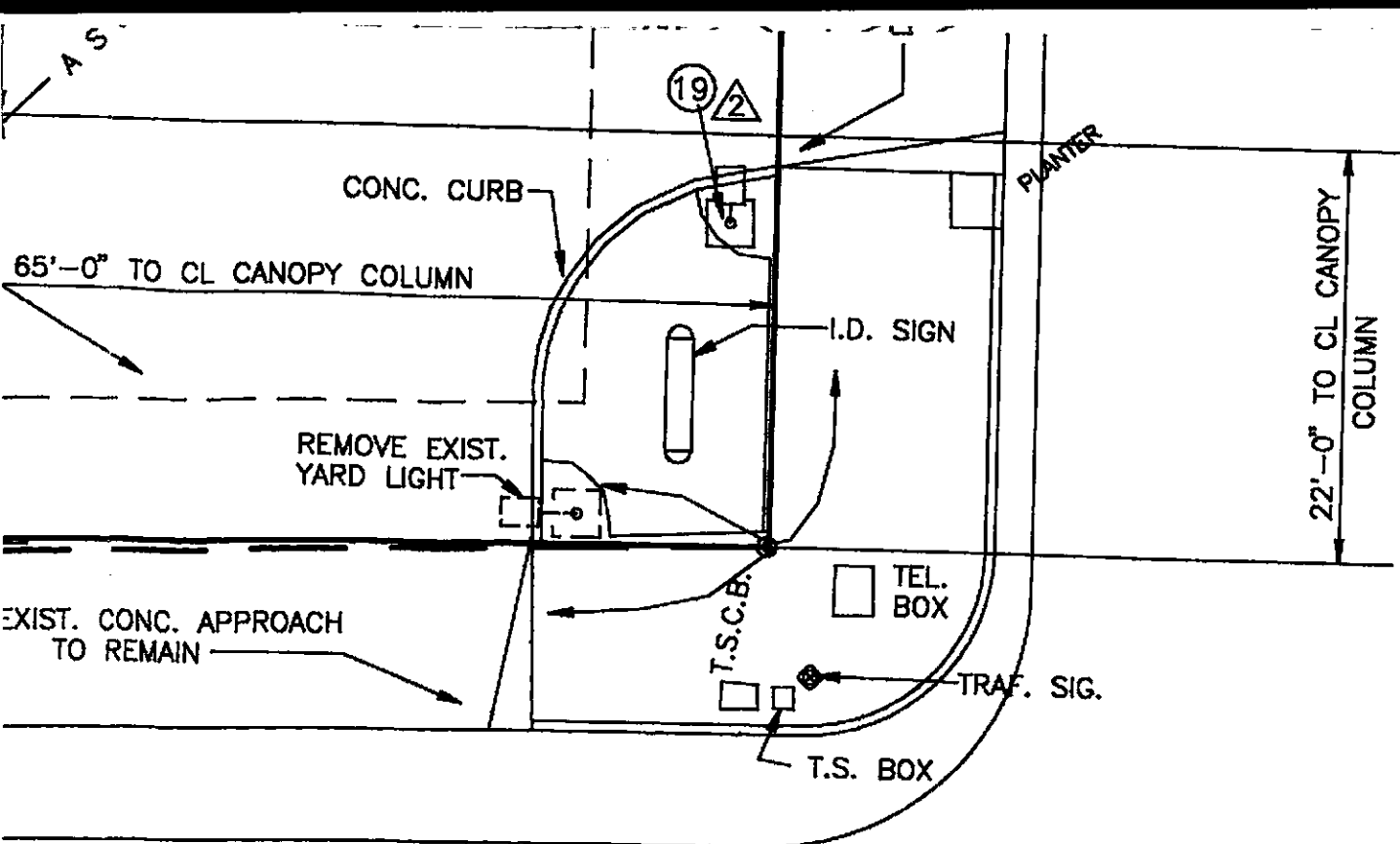

ING BLVD.

CONC. ISLAND PAD. 1 IN 1111

- 6) EXISTING PIPING AND SINGLE WALL WITH FIBER TRENCH TO REMAIN
- 7) Existing dispensers to be removed

Existing piping & trench that will be removed will be reused with the new dispensers.

20 Double wall tanks & associated piping installed in 1987.

23 Trash Receptacle

BP OIL CO.
RETAIL MARKETING
DESIGN AND ENGINEERING
 200 PUBLIC SQUARE
 CLEVELAND, OHIO 44114

PLOT PLAN
M.L. KING & 55TH
5425 M.L. KING BLVD.
OAKLAND, CALIFORNIA

DWG. NO.: 04-001-11127		REV.: _	
SCALE: 1"=10'-0"		MADE BY: GSJ	
DATE: 2/9.90		CHECKED BY: E.H.	
REVISIONS			
1) ADD UNDERGROUND TANKS, PRODUCT PIPING	DATE 5/17/80	DWN CF	CKD SI

F-001-11127 M.L.KING & 55 TH