



GETTLER-RYAN INC.

TRANSMITTAL

December 18, 2002

G-R #386473

10233 ✓

TO: Mr. James Brownell
Delta Environmental Consultants, Inc.
3164 Gold Camp Drive, Suite 200
Rancho Cordova, California 95670

CC: Ms. Karen Streich
Chevron Products Company
P.O. Box 6004
San Ramon, California 94583

FROM: Deanna L. Harding
Project Coordinator
Gettler-Ryan Inc.
6747 Sierra Court, Suite J
Dublin, California 94568

RE: Former Chevron Service Station
#9-4612
3616 San Leandro Street
Oakland, California

WE HAVE ENCLOSED THE FOLLOWING:

COPIES	DATED	DESCRIPTION
1	December 13, 2002	Groundwater Monitoring and Sampling Report Fourth Quarter - Event of November 7, 2002

COMMENTS:

This report is being sent for your review. Please provide any comments/changes and propose any groundwater monitoring modifications for the next event prior to **January 3, 2003**, at which time the final report will be distributed to the following:

- AG
- cc: Mr. Barney Chan, Alameda County Health Care Services, Dept. of Environmental Health, 1131 Harbor Bay Parkway, Suite 250, Alameda, CA 94502-6577
 - Mr. Greg Gurss, Gettler-Ryan Inc., 3140 Gold Camp Drive, Suite 170, Rancho Cordova, CA 95670
 - Mr. Leonard B. Ratto, Ratto Land Company, P.O. Box 6104, Oakland, CA 94603-0104
 - Mr. Terry McIlraith, 407 Castello Road, Lafayette, CA 94549

Enclosures

trans/9-4612-ks



GETTLER-RYAN INC.

December 13, 2002
G-R Job #386473

Ms. Karen Streich
Chevron Products Company
P.O. Box 6004
San Ramon, CA 94583

RE: Fourth Quarter Event of November 7, 2002
Groundwater Monitoring & Sampling Report
Former Chevron Service Station #9-4612
3616 San Leandro Street
Oakland, California

Dear Ms. Streich:

This report documents the most recent groundwater monitoring and sampling event performed by Gettler-Ryan Inc. (G-R) at the referenced site. All field work was conducted in accordance with G-R Standard Operating Procedure - Groundwater Sampling (attached).

Static groundwater levels were measured and the wells were checked for the presence of separate-phase hydrocarbons. Static water level data, groundwater elevations, and separate-phase hydrocarbon thickness (if any) are presented in the attached Table 1. Dissolved Oxygen Concentrations are presented in Table 2. A Potentiometric Map is included as Figure 1.

Groundwater samples were collected from the monitoring wells and submitted to a state certified laboratory for analyses. The field data sheets for this event are attached. Analytical results are presented in the table(s) listed below. The chain of custody document and laboratory analytical report are also attached.

Please call if you have any questions or comments regarding this report. Thank you.

Sincerely,

Deanna L. Harding
Project Coordinator

Robert C. Mallory
Registered Geologist, No. 7285

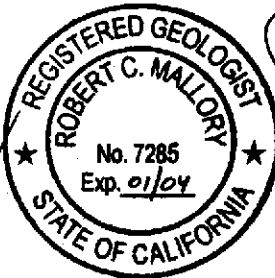

- Figure 1: Potentiometric Map
- Table 1: Groundwater Monitoring Data and Analytical Results
- Table 2: Dissolved Oxygen Concentrations
- Table 3: Groundwater Analytical Results - Oxygenate Compounds
- Attachments: Standard Operating Procedure - Groundwater Sampling
Field Data Sheets
Chain of Custody Document and Laboratory Analytical Reports

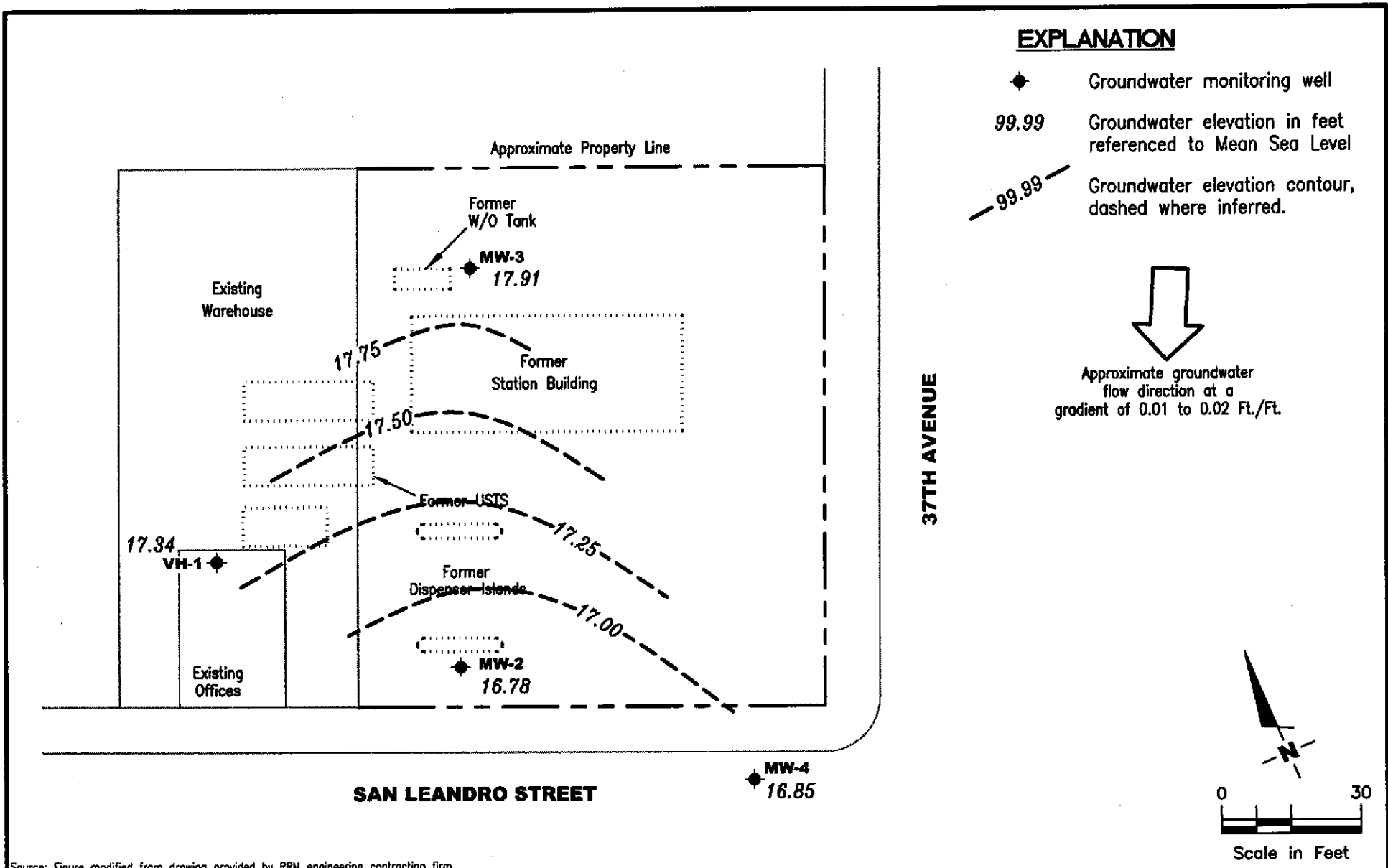

Source: Figure modified from drawing provided by RRM engineering contracting firm.

GETTLER - RYAN INC.
 6747 Sierra Ct., Suite J
 Dublin, CA 94568 (925) 551-7555

POTENTIOMETRIC MAP
 Former Chevron Service Station #9-4612
 3616 San Leandro Street
 Oakland, California

FIGURE
1

PROJECT NUMBER 386473	REVIEWED BY	DATE November 7, 2002	REVISED DATE
---------------------------------	-------------	--------------------------	--------------

Table 1
Groundwater Monitoring Data and Analytical Results
Former Chevron Service Station #9-4612
3616 San Leandro Street
Oakland, California

WELL ID/ DATE	TOC* (ft.)	GWE (msl)	DTW (ft.)	TPH-D (ppb)	TPH-G (ppb)	B (ppb)	T (ppb)	E (ppb)	X (ppb)	MTBE (ppb)	TOG (ppb)
VH-1											
08/10/88	--	--	13.00	--	11,000	3,300	200	520	540	--	--
06/01/89	--	--	10.32	--	15,000	2,200	120	540	310	--	--
09/15/89	--	--	15.69	--	5,600	1,900	90	350	160	--	--
12/08/89	--	--	14.77	--	11,000	1,900	69	270	99	--	--
03/07/91	--	--	11.26	--	4,500	820	39	120	77	--	--
09/24/91	--	--	12.98	--	3,300	520	19	39	27	--	--
01/08/92	--	--	13.77	--	5,000	600	34	81	76	--	--
04/20/92	--	--	8.18	--	7,400	670	60	110	140	--	--
03/26/93	27.85	21.14	6.71	--	4,900	600	40	72	94	--	--
05/27/93	27.85	19.27	8.58	--	13,000	1,600	120	230	220	--	--
08/18/93	27.85	17.39	10.46	--	2,700	210	10	8.1	18	--	--
11/03/93	27.85	15.28	12.57	--	4,600	680	42	35	68	--	--
02/10/94	27.85	18.77	9.08	--	1,900	260	19	22	29	--	--
05/12/94	27.85	19.76	8.09	--	2,000	390	28	3.9	29	--	--
08/26/94	27.85	17.10	10.75	--	4,900	500	<5.0	23	31	--	--
11/14/94	27.85	18.40	9.45	300	760	69	<2.0	<2.0	2.2	--	--
02/01/95	27.85	21.88	5.97	--	1,300	120	5.9	<0.5	13	--	--
05/12/95	27.85	20.14	7.71	--	4,400	460	31	45	49	--	--
08/22/95	27.85	18.59	9.26	--	2,900	310	15	28	32	--	--
12/19/95	27.85	19.05	8.80	--	930	53	<2.5	<2.5	<2.5	39	--
01/31/96	27.85	22.35	5.50	--	3,700	320	<10	41	40	180	--
04/30/96	27.85	19.81	8.04	--	3,900	270	<20	<20	<20	120	--
08/01/96	27.85	18.67	9.18	--	2,700	140	11	18	28	200	--
10/30/96	27.85	18.67	10.76	--	2,700	140	<12	<12	<12	280	--
02/07/97	27.85	19.75	8.10	--	220	13	0.6	<0.5	1.6	15	--
05/07/97	27.85	18.33	9.52	--	5,200	33	12	21	26	330	--
07/22/97	27.85	17.43	10.42	--	4,200	80	<10	16	24	400	--
11/03/97	27.85	16.85	11.00	--	2,400	150	6.8	6.5	9.5	510	--
01/28/98	27.85	20.75	7.10	--	850	69	4.8	5.0	11	38/48 ¹²	--
05/08/98	27.85	20.14	7.71	--	4,200	200	30	40	42	310/200 ¹²	--
07/29/98	27.85	18.40	9.45	--	3,800	54	10	27	30	35/290 ¹²	--

Table 1
Groundwater Monitoring Data and Analytical Results
Former Chevron Service Station #9-4612
3616 San Leandro Street
Oakland, California

WELL ID/ DATE	TOC* (ft.)	GWE (msl)	DTW (ft.)	TPH-D (ppb)	TPH-G (ppb)	B (ppb)	T (ppb)	E (ppb)	X (ppb)	MTBE (ppb)	TOG (ppb)
VH-1 (cont)											
11/06/98	27.85	17.15	10.70	--	4,800	100	20	12	23	360/210 ¹²	--
02/09/99 ⁵	27.85	21.87	5.98	--	2,950	79.5	<10	<10	<10	435/312 ¹²	--
05/13/99	27.85	19.71	8.14	--	4,180	147	12.8	16.5	20.3	433245 ¹²	--
09/07/99	27.85	17.94	9.91	--	2,750	57.6	<5.0	6.53	<5.0	297/233 ¹²	--
11/24/99	27.85	17.36	10.49	--	2,550	38	3.18	2.54	5.21	--/216 ^{1,12}	--
02/25/00	27.85	21.20	6.65	--	120	2.7	<0.5	<0.5	<0.5	20.5/11.9 ¹²	--
05/10/00	27.85	19.76	8.09	--	1,400 ⁸	63	3.3	3.1	4.9	230/110 ¹²	--
7/31/00 ¹¹	27.85	18.30	9.55	--	360 ⁸	22	2.7	1.6	3.1	100/88 ¹²	--
10/30/00 ¹¹	27.85	17.91	9.94	--	987 ¹⁰	47.0	1.00	<0.500	1.80	153/130 ¹²	--
02/05/01	27.91	19.23	8.68	--	2,670	42.7	<5.00	<5.00	<5.00	225/160 ¹²	--
05/07/01 ¹¹	27.91	19.61	8.30	--	1,800 ⁶	100	8.2	10	7.9	440/110 ¹²	--
08/06/01 ¹¹	27.91	18.09	9.82	--	1,000 ⁶	67	6.1	2.1	7.1	270/140 ¹²	--
11/12/01 ¹¹	27.91	17.29	10.62	--	220	1.2	<0.50	<0.50	<1.5	63/61 ¹²	--
02/11/02 ¹¹	27.91	19.83	8.08	--	1,700	33	<5.0	6.3	3.8	64/52 ¹²	--
05/13/02 ¹¹	27.91	19.21	8.70	--	2,700	54	4.1	5.6	6.2	100/80 ¹²	--
08/09/02 ¹¹	27.91	18.50	9.41	--	2,400	37	2.4	1.2	3.4	86/89 ¹²	--
11/07/02 ¹¹	27.91	17.34	10.57	--	150	1.3	<0.50	<0.50	<1.5	56/50 ¹²	--
MW-2											
02/16/93	27.51	--	--	--	9,200	720	110	250	170	--	--
03/26/93	27.51	19.89	7.62	--	--	--	--	--	--	--	--
05/27/93	27.51	18.04	9.47	--	360	5.3	2.1	1.8	2.5	--	--
08/18/93	27.51	16.46	11.05	--	9,400	1,100	76	110	100	--	--
11/03/93	27.51	14.56	12.95	--	8,600	390	20	2.7	120	--	--
02/10/94	27.51	17.72	9.79	--	2,700	370	38	44	41	--	--
05/12/94	27.51	18.59	8.92	--	3,800	650	76	15	62	--	--
08/26/94	27.51	16.14	11.37	--	16,000	1,300	270	28	120	--	--
11/14/94	27.51	17.48	10.03	--	5,100	390	10	43	27	--	--
02/01/95	27.51	20.47	7.04	--	6,900	520	82	170	110	--	--
05/12/95	27.51	18.76	8.75	--	7,700	510	83	110	100	--	--
08/22/95	27.51	17.35	10.16	--	4,500	220	16	61	47	--	--

Table 1
Groundwater Monitoring Data and Analytical Results
Former Chevron Service Station #9-4612
3616 San Leandro Street
Oakland, California

WELL ID/ DATE	TOC* (ft.)	GWE (msl)	DTW (ft.)	TPH-D (ppb)	TPH-G (ppb)	B (ppb)	T (ppb)	E (ppb)	X (ppb)	MTBE (ppb)	TOG (ppb)
MW-2 (cont)											
12/19/95	27.51	18.05	9.46	--	2,900	240	<10	19	18	220	--
01/31/96	27.51	21.91	5.60	--	3,900	320	18	72	39	<25	--
04/30/96	27.51	18.68	8.83	--	5,600	200	36	55	47	170	--
08/01/96	27.51	17.25	10.26	--	6,200	190	15	62	59	220	--
10/30/96	27.51	17.25	11.48	--	5,700	190	<25	67	36	260	--
02/07/97	27.51	18.11	9.40	--	8,300	210	34	70	59	330	--
05/07/97	27.51	17.57	9.94	--	6,900	190	12	38	37	530	--
07/22/97	27.51	16.36	11.15	--	10,000	18	25	62	41	630	--
11/03/97	27.51	15.93	11.58	--	6,500	260	8.5	26	14	590/9.6 ^{4,12}	--
01/28/98	27.51	19.38	8.13	--	6,700	65	13	67	54	280/94 ¹²	--
05/08/98	27.51	18.89	8.62	--	5,500	91	38	43	61	220/62 ¹²	--
07/29/98	27.51	17.06	10.45	--	3,600	41	8.9	3.6	14	16/94 ¹²	--
11/06/98	27.51	15.89	11.62	--	6,900	77	<5.0	14	17	290/110 ¹²	--
02/09/99 ⁵	27.51	20.61	6.90	--	8,070	75.6	<10	<10	<10	397/144 ¹²	--
05/13/99	27.51	18.21	9.30	--	5,890	120	<5.0	12.5	26.6	401/69.4 ¹²	--
09/07/99	27.51	16.57	10.94	--	5,820	41.2	<5.0	14.6	<5.0	260/145 ¹²	--
11/24/99	27.51	15.98	11.53	--	5,940	40.9	<10	10.8	<10	--/120 ^{1,12}	--
02/25/00	27.51	21.00	6.51	--	6,370	101	9.37	39.8	33.2	321/121 ¹²	--
05/10/00	27.51	18.49	9.02	--	6,100 ⁸	110	13	27	31	'560/120 ¹²	--
07/31/00 ¹¹	27.51	17.18	10.33	--	3,000 ⁸	75	14	28	28	200/130 ¹²	--
10/30/00 ¹¹	27.51	16.95	10.56	--	6,810 ¹⁰	162	<5.00	8.05	<15.0	372/140 ¹²	--
02/05/01 ¹¹	28.05	18.47	9.58	--	5,860	28.4	6.86	16.2	11.8	285/140 ¹²	--
05/07/01 ¹¹	28.05	18.85	9.20	--	4,700 ⁶	120	15	30	42	540/88 ¹²	--
08/06/01 ¹¹	28.05	17.31	10.74	--	3,700 ⁶	120	<20	28	33	490/110 ¹²	--
11/12/01 ¹¹	28.05	16.60	11.45	--	7,000	29	<10	27	22	93/98 ¹²	--
02/11/02 ¹¹	28.05	18.99	9.06	--	5,900	43	15	24	27	90/86 ¹²	--
05/13/02 ¹¹	28.05	18.41	9.64	--	5,500	26	5.2	23	26	120/47 ¹²	--
08/09/02 ¹¹	28.05	17.76	10.29	--	5,700	26	3.7	26	50	100/69 ¹²	--
11/07/02 ¹¹	28.05	16.78	11.27	--	5,900	33	4.4	23	21	<100/69 ¹²	--

Table 1
Groundwater Monitoring Data and Analytical Results
Former Chevron Service Station #9-4612
3616 San Leandro Street
Oakland, California

WELL ID/ DATE	TOC* (ft.)	GWE (msl)	DTW (ft.)	TPH-D (ppb)	TPH-G (ppb)	B (ppb)	T (ppb)	E (ppb)	X (ppb)	MTBE (ppb)	TOG (ppb)
MW-3											
02/16/93	28.50	--	--	--	3,500	<0.5	8.1	4.6	7.7	--	--
03/26/93	28.50	21.32	7.18	--	--	--	--	--	--	--	--
05/27/93	28.50	19.17	9.33	--	4,200	580	84	150	100	--	--
08/18/93	28.50	16.50	12.00	1,400	910	12	3.7	6.2	3.8	--	<5,000
11/03/93	28.50	15.21	13.29	--	5,300	29	1.9	0.6	27	--	--
02/10/94	28.50	18.87	9.63	<50	63	<0.5	0.7	<0.5	<0.5	--	--
05/12/94	28.50	19.73	8.77	84	<50	<0.5	0.5	<0.5	<0.5	--	--
08/26/94	28.50	17.08	11.42	--	2,100	12	<0.5	5.0	0.5	--	--
11/14/94	28.50	18.43	10.07	--	140	0.78	<0.5	<0.5	<0.5	--	--
02/01/95	28.50	22.21	6.29	<50	<50	<0.5	<0.5	<0.5	<0.5	--	--
05/12/95	28.50	20.43	8.07	540 ²	330	13	1.1	1.9	0.69	--	--
08/22/95	28.50	18.55	9.95	550 ²	980	32	<1.0	<1.0	<1.0	--	--
12/19/95	28.50	19.10	9.40	<50	<50	<0.5	<0.5	<0.5	<0.5	<2.5	--
01/31/96	28.50	23.45	5.05	<50	<50	<0.5	<0.5	<0.5	<0.5	<2.5	--
04/30/96	28.50	20.10	8.40	240 ²	320	2.4	<0.5	0.75	<0.5	7.8	--
08/01/96	28.50	18.70	9.80	470 ²	980	9.6	<0.5	0.98	2.2	54	--
10/30/96	28.50	18.70	11.48	760 ²	2,000	14	<10	<10	<10	140	--
02/07/97	28.50	19.90	8.60	61 ²	200 ²	<0.5	<0.5	<0.5	<0.5	8.9	--
05/07/97	28.50	19.49	9.01	550 ²	3,500	14	3.9	3.6	8.0	160	--
07/22/97	28.50	17.38	11.12	800 ²	3,500	55	<10	<10	<10	150	--
11/03/97	28.50	16.99	11.51	910 ²	4,100	140	<5.0	<5.0	<5.0	380	--
01/28/98	28.50	21.16	7.34	--	1,100	24	<1.2	<1.2	2.8	33/6.1 ¹²	--
05/08/98	28.50	20.44	8.06	250 ²	990	3.6	7.7	0.7	2.2	37/7.5 ¹²	--
07/29/98	28.50	18.25	10.25	290 ²	-1,200	13	<0.5	<0.5	1.4	11/28 ¹²	--
11/06/98	28.50	17.11	11.39	390 ²	2,600	5.3	<2.5	<2.5	3.0	91/41 ¹²	--
02/09/99 ⁵	28.50	22.40	6.10	184 ²	406	<1.0	4.03	<1.0	<1.0	17.7/1.97 ¹²	--
05/13/99	28.50	19.38	9.12	--	615	13.8	1.05	<0.5	<0.5	43.5/21.2 ¹²	--
09/07/99	28.50	17.77	10.73	528 ²	2,710	<5.0	<5.0	<5.0	<5.0	96.3/57.9 ¹²	--
11/24/99	28.50	17.37	11.13	1,070 ²	5,530	<5.0	<5.0	5.59	<5.0	--/66 ^{1,12}	--
02/25/00	28.50	22.22	6.28	--	189	4.68	<0.5	<0.5	<0.5	11.9/<2.0 ¹²	--
03/01/00	28.50	21.80	6.70	380 ²	--	--	--	--	--	--	--

Table 1
Groundwater Monitoring Data and Analytical Results
Former Chevron Service Station #9-4612
3616 San Leandro Street
Oakland, California

WELL ID/ DATE	TOC* (ft.)	GWE (msl)	DTW (ft.)	TPH-D (ppb)	TPH-G (ppb)	B (ppb)	T (ppb)	E (ppb)	X (ppb)	MTBE (ppb)	TOG (ppb)
MW-3 (cont)											
05/10/00	28.50	19.90	8.60	830 ⁷	1,600 ⁶	22	<10	<10	<10	100/51 ¹²	--
07/31/00 ¹¹	28.50	18.43	10.07	490 ⁷	2,200 ⁶	76	10	<5.0	13	230/52 ¹²	--
10/30/00 ¹¹	28.50	17.97	10.53	580 ⁹	3,320 ¹⁰	<5.00	<5.00	<5.00	<15.0	147/64 ¹²	--
02/05/01 ¹¹	29.04	19.78	9.26	--	3,960	<5.00	6.02	<5.00	<5.00	159/70 ¹²	--
05/07/01 ¹¹	29.04	20.29	8.75	--	2,800 ⁶	61	12	<10	20	230/49 ¹²	--
05/10/01 ¹¹	29.04	20.21	8.83	390 ¹³	--	--	--	--	--	--	--
08/06/01 ¹¹	29.04	18.59	10.45	870 ⁷	1,600 ⁶	39	14	1.3	5.6	130/43 ¹²	--
11/12/01 ¹¹	29.04	17.82	11.22	1,400	3,100	3.6	23	2.3	5.6	40/46 ¹²	--
02/11/02 ¹¹	29.04	20.66	8.38	700	4,000	10	<5.0	4.2	5.5	44/42 ¹²	--
05/13/02 ¹¹	29.04	19.84	9.20	730	2,500	18	<5.0	<5.0	5.2	44/32 ¹²	--
08/09/02 ¹¹	29.04	18.87	10.17	560	2,700	17	<5.0	<5.0	<10	45/33 ¹²	--
11/07/02 ¹¹	29.04	17.91	11.13	660	2,600	24	<5.0	2.0	4.8	51/37 ¹²	--
MW-4											
08/22/95	27.27	18.16	9.11	--	9,600	100	<10	<10	<10	--	--
12/19/95	27.27	18.97	8.30	--	<50	<0.5	<0.5	<0.5	<0.5	<2.5	--
01/31/96	27.27	21.67	5.60	--	<50	<0.5	<0.5	<0.5	<0.5	<2.5	--
04/30/96	27.27	20.27	7.00	--	<50	<0.5	<0.5	<0.5	<0.5	<2.5	--
08/01/96	27.27	18.12	9.15	--	<50	<0.5	<0.5	<0.5	<0.5	--	--
10/30/96	27.27	18.12	10.74	--	110	<0.5	<0.5	<0.5	<0.5	<2.5	--
02/07/97	27.27	19.47	7.80	--	80	<0.5	<0.5	<0.5	<0.5	4.1	--
05/07/97	27.27	21.42	5.85	--	<50	<0.5	<0.5	<0.5	<0.5	<2.5	--
07/22/97	27.27	17.22	10.05	--	150	<0.5	<0.5	<0.5	<0.5	<2.5	--
11/03/97	27.27	16.55	10.72	--	52	0.9	<0.5	<0.5	<0.5	-- ³	--
01/28/98	27.27	20.76	6.51	--	<50	<0.5	<0.5	<0.5	<0.5	<2.5/<2.0 ¹²	--
05/08/98	27.27	20.25	7.02	--	56	<0.5	<0.5	<0.5	<0.5	<2.5/<2.0 ¹²	--
07/29/98	27.27	18.32	8.95	--	<50	0.9	<0.5	<0.5	<0.5	<2.5/<2.0 ¹²	--
11/06/98	27.27	16.68	10.59	--	72	<0.5	<0.5	<0.5	<0.5	<2.5/<2.0 ¹²	--
02/09/99	27.27	21.41	5.86	--	<50	<0.5	<0.5	<0.5	<0.5	<2.0/<1.1 ¹²	--
05/13/99	27.27	19.32	7.95	--	<50	<0.5	<0.5	<0.5	<0.5	<5.0/<2.0 ¹²	--
09/07/99	27.27	17.79	9.48	--	70.2	<0.5	<0.5	<0.5	<0.5	<2.0/<1.0 ¹²	--

Table 1
Groundwater Monitoring Data and Analytical Results
Former Chevron Service Station #9-4612
3616 San Leandro Street
Oakland, California

WELL ID/ DATE	TOC* (ft.)	GWE (msl)	DTW (ft.)	TPH-D (ppb)	TPH-G (ppb)	B (ppb)	T (ppb)	E (ppb)	X (ppb)	MTBE (ppb)	TOG (ppb)
MW-4 (cont)											
11/24/99	27.27	17.22	10.05	--	227	<0.5	<0.5	<0.5	<0.5	--/0.5 ¹²	--
02/25/00	27.27	INACCESSIBLE		--	--	--	--	--	--	--	--
03/01/00	27.27	21.10	6.17	--	<50	<0.5	<0.5	<0.5	<0.5	<2.5/<2.0 ¹²	--
05/10/00	27.27	INACCESSIBLE - CAR PARKED OVER WELL				--	--	--	--	--	--
07/31/00	27.27	17.90	9.37	--	<50	<0.50	<0.50	<0.50	<0.50	<2.5/<2.0 ¹²	--
10/30/00	27.27	17.80	9.47	--	54.0 ¹⁰	<0.500	<0.500	<0.500	<1.50	<2.50/<2.0 ¹²	--
02/05/01	27.27	INACCESSIBLE - CAR PARKED OVER WELL				--	--	--	--	--	--
05/07/01	27.27	19.46	7.81	--	<50	<0.50	<0.50	<0.50	<0.50	<2.5/<2.0 ¹²	--
08/06/01	27.27	17.49	9.78	--	<50	1.1	0.52	<0.50	1.1	6.0/<2.0 ¹²	--
11/12/01	27.27	16.86	10.41	--	93	<0.50	<0.50	<0.50	<1.5	<2.5/<2 ¹²	--
02/11/02	27.27	19.63	7.64	--	<50	<0.50	<0.50	<0.50	<1.5	<2.5/<2 ¹²	--
05/13/02	27.27	18.95	8.32	--	54	<0.50	0.84	<0.50	<1.5	<2.5/<2 ¹²	--
08/09/02	27.27	18.02	9.25	--	54	<0.50	<0.50	<0.50	<1.5	<2.5/<2 ¹²	--
11/07/02	27.27	16.85	10.42	--	<50	<0.50	<0.50	<0.50	<1.5	<2.5/<2 ¹²	--
TRIP BLANK											
05/27/93	--	--	--	--	<50	<0.5	<0.5	<0.5	<1.5	--	--
08/18/93	--	--	--	1,400	<50	<0.5	<0.5	<0.5	<1.5	--	<5,000
11/03/93	--	--	--	--	<50	<0.5	<0.5	<0.5	<0.5	--	--
02/10/94	--	--	--	<50	<50	<0.5	<0.5	<0.5	<0.5	--	--
05/12/94	--	--	--	84	<50	<0.5	<0.5	<0.5	<0.5	--	--
08/26/94	--	--	--	--	<50	<0.5	<0.5	<0.5	<0.5	--	--
11/14/94	--	--	--	--	<50	<0.5	<0.5	<0.5	<0.5	--	--
02/01/95	--	--	--	--	<50	<0.5	<0.5	<0.5	<0.5	--	--
05/12/95	--	--	--	--	<50	<0.5	<0.5	<0.5	<0.5	--	--
08/22/95	--	--	--	--	<50	<0.5	<0.5	<0.5	<0.5	--	--
12/19/95	--	--	--	--	<50	<0.5	<0.5	<0.5	<0.5	<2.5	--
01/31/96	--	--	--	--	<50	<0.5	<0.5	<0.5	<0.5	<2.5	--
04/30/96	--	--	--	--	<50	<0.5	<0.5	<0.5	<0.5	<2.5	--
08/01/96	--	--	--	--	<50	<0.5	<0.5	<0.5	<0.5	<2.5	--
10/30/96	--	--	--	--	<50	<0.5	<0.5	<0.5	<0.5	<2.5	--

Table 1
Groundwater Monitoring Data and Analytical Results
Former Chevron Service Station #9-4612
3616 San Leandro Street
Oakland, California

WELL ID/ DATE	TOC* (ft.)	GWE (msl)	DTW (ft.)	TPH-D (ppb)	TPH-G (ppb)	B (ppb)	T (ppb)	E (ppb)	X (ppb)	MTBE (ppb)	TOG (ppb)
TRIP BLANK (cont)											
02/07/97	--	--	--	--	<50	<0.5	<0.5	<0.5	<0.5	<2.5	--
05/07/97	--	--	--	--	<50	<0.5	<0.5	<0.5	<0.5	<2.5	--
07/22/97	--	--	--	--	<50	<0.5	<0.5	<0.5	<0.5	<2.5	--
01/28/98	--	--	--	--	<50	<0.5	<0.5	<0.5	<0.5	-/<2.0 ¹²	--
05/08/98	--	--	--	--	--	--	--	--	--	-/<2.0 ¹²	--
07/29/98	--	--	--	--	<50	<0.5	<0.5	<0.5	<0.5	-/<2.0 ¹²	--
11/06/98	--	--	--	--	<50	<0.5	<0.5	<0.5	<0.5	<2.5	--
02/09/99	--	--	--	--	<50	<0.5	<0.5	<0.5	<0.5	<2.0	--
05/13/99	--	--	--	--	<50	<0.5	<0.5	<0.5	<0.5	<5.0/<2.0 ¹²	--
09/07/99	--	--	--	--	<50	<0.5	<0.5	<0.5	<0.5	<2.0	--
11/24/99	--	--	--	--	<50	<0.5	<0.5	<0.5	<0.5	<2.5	--
02/25/00	--	--	--	--	<50	<0.5	<0.5	<0.5	<0.5	<5.0	--
03/01/00	--	--	--	--	<50	<0.5	<0.5	<0.5	<0.5	<2.5	--
05/10/00	--	--	--	--	<50	<0.50	<0.50	<0.50	<0.50	<2.5	--
07/31/00	--	--	--	--	<50	<0.50	<0.50	<0.50	<0.50	<2.5	--
10/30/00	--	--	--	--	<50.0	<0.500	<0.500	<0.500	<1.50	<2.50	--
02/05/01	--	--	--	--	<50.0	<0.500	<0.500	<0.500	<0.500	<2.50	--
05/07/01	--	--	--	--	<50	<0.50	<0.50	<0.50	<0.50	<2.5	--
05/10/01	--	--	--	--	<50	<0.50	<0.50	<0.50	<0.50	<2.5	--
08/06/01	--	--	--	--	<50	<0.50	<0.50	<0.50	<0.50	<2.5	--
QA											
11/12/01	--	--	--	--	<50	<0.50	<0.50	<0.50	<1.5	<2.5	--
02/11/02	--	--	--	--	<50	<0.50	<0.50	<0.50	<1.5	<2.5	--
05/13/02	--	--	--	--	<50	<0.50	<0.50	<0.50	<1.5	<2.5	--
08/09/02	--	--	--	--	<50	<0.50	<0.50	<0.50	<1.5	<2.5	--
11/07/02	--	--	--	--	<50	<0.50	<0.50	<0.50	<1.5	<2.5	--

Table 1
Groundwater Monitoring Data and Analytical Results
Former Chevron Service Station #9-4612
3616 San Leandro Street
Oakland, California

EXPLANATIONS:

Groundwater monitoring data and laboratory analytical results prior to May 10, 2000, were compiled from reports prepared by Blaine Tech Services, Inc.

TOC = Top of Casing
(ft.) = Feet

GWE = Groundwater Elevation
(msl) = Mean sea level

DTW = Depth to Water

TPH-D = Total Petroleum Hydrocarbons as Diesel

TPH-G = Total Petroleum Hydrocarbons as Gasoline

B = Benzene

T = Toluene

E = Ethylbenzene

X = Xylenes

MTBE = Methyl tertiary butyl ether

TOG = Total Oil and Grease

(ppb) = Parts per billion

-- = Not Measured/Not Analyzed

QA = Quality Assurance/Trip Blank

* TOC elevations were re-surveyed on March 8, 2001, by Virgil Chavez Land Surveying. The benchmark for the survey was a City of Oakland benchmark, being a cut square top of curb at the centerline return at the northwest corner of East 14th and 37th Avenue, (Benchmark Elevation = 38.21 feet, NGVD 29).

¹ Lab could not get a good ion chromatogram match for MTBE. See laboratory report.

² Chromatogram pattern indicates an unidentified hydrocarbon.

³ No value for MTBE could be determined; see lab report for analyses.

⁴ Confirmation run.

⁵ ORC was installed.

⁶ Laboratory report indicates gasoline C6-C12.

⁷ Laboratory report indicates unidentified hydrocarbons <C16.

⁸ Laboratory report indicates gasoline C6-C12 + unidentified hydrocarbons <C6.

⁹ Laboratory report indicates unidentified hydrocarbons >C16.

¹⁰ Laboratory report indicates hydrocarbon pattern present in the requested fuel quantitation range but does not resemble the pattern of the requested fuel.

¹¹ ORC in well.

¹² MTBE by EPA Method 8260.

¹³ Laboratory report indicates unidentified hydrocarbons C9-C17.

Table 2
Dissolved Oxygen Concentrations
Former Chevron Service Station #9-4612
3616 San Leandro Street
Oakland, California

WELL ID	DATE	Before Purging (mg/L)	After Purging (mg/L)
VH-1	05/10/00	0.90	--
	07/31/00	1.25	--
	10/30/00	1.97	--
	05/07/01	1.10	--
	08/06/01	1.40	--
	11/12/01	0.90	--
	02/11/02	1.10	--
	05/13/02	0.70	--
MW-2	05/10/00	0.57	--
	07/31/00	1.26	--
	10/30/00	1.25	--
	05/07/01	0.90	--
	08/06/01	1.10	--
	11/12/01	0.80	--
	02/11/02	0.60	--
	05/13/02	0.80	--
MW-3	05/10/00	1.56	--
	07/31/00	1.46	--
	10/30/00	1.18	--
	05/07/01	0.70	--
	08/06/01	0.90	--
	11/12/01	0.50	--
	02/11/02	0.80	--
	05/13/02	1.80	--
MW-4	05/10/00	INACCESSIBLE - CAR PARKED OVER WELL	
	07/31/00	0.64	--
	10/30/00	0.97	--
	02/05/01	INACCESSIBLE - CAR PARKED OVER WELL	
	05/07/01	0.50	--
	08/06/01	0.70	--
	11/12/01	1.00	--
	02/11/02	1.00	--
	05/13/02	2.90	--

Table 2
Dissolved Oxygen Concentrations
Former Chevron Service Station #9-4612
3616 San Leandro Street
Oakland, California

EXPLANATIONS:

(mg/L) = Milligrams per liter

-- = Not Measured

Table 3
Groundwater Analytical Results - Oxygenate Compounds
Former Chevron Service Station #9-4612
3616 San Leandro Street
Oakland, California

WELL ID	DATE	ETHANOL (ppb)	TBA (ppb)	MTBE (ppb)	DIPE (ppb)	ETBE (ppb)	TAME (ppb)
VH-1	02/05/01	<500	<50	160	<2.0	<2.0	<2.0
	05/07/01	--	--	110	--	--	--
	08/06/01	--	--	140	--	--	--
	11/12/01	--	--	61	--	--	--
	02/11/02	--	--	52	--	--	--
	05/13/02	--	--	80	--	--	--
	08/09/02	--	--	89	--	--	--
	11/07/02	--	--	50	--	--	--
MW-2	02/05/01	<500	<50	140	<2.0	<2.0	<2.0
	05/07/01	--	--	88	--	--	--
	08/06/01	--	--	110	--	--	--
	11/12/01	--	--	98	--	--	--
	02/11/02	--	--	86	--	--	--
	05/13/02	--	--	47	--	--	--
	08/09/02	--	--	69	--	--	--
	11/07/02	--	--	69	--	--	--
MW-3	02/05/01	<500	<50	70	<2.0	<2.0	<2.0
	05/07/01	--	--	49	--	--	--
	08/06/01	--	--	43	--	--	--
	11/12/01	--	--	46	--	--	--
	02/11/02	--	--	42	--	--	--
	05/13/02	--	--	32	--	--	--
	08/09/02	--	--	33	--	--	--
	11/07/02	--	--	37	--	--	--
MW-4	05/07/01	--	--	<2.0	--	--	--
	08/06/01	--	--	<2.0	--	--	--
	11/12/01	--	--	<2	--	--	--

Table 3
Groundwater Analytical Results - Oxygenate Compounds
Former Chevron Service Station #9-4612
3616 San Leandro Street
Oakland, California

WELL ID	DATE	ETHANOL (ppb)	TBA (ppb)	MTBE (ppb)	DIPE (ppb)	ETBE (ppb)	TAME (ppb)
MW-4	02/11/02	--	--	<2	--	--	--
(cont)	05/13/02	--	--	<2	--	--	--
	08/09/02	--	--	<2	--	--	--
	11/07/02	--	--	<2	--	--	--

Table 3
Groundwater Analytical Results - Oxygenate Compounds
Former Chevron Service Station #9-4612
3616 San Leandro Street
Oakland, California

EXPLANATIONS:

TBA = Tertiary butyl alcohol
MTBE = Methyl tertiary butyl ether
DIPE = Di-isopropyl ether
ETBE = Ethyl tertiary butyl ether
TAME = Tertiary amyl methyl ether
(ppb) = Parts per billion
-- = Not Analyzed

ANALYTICAL METHOD:

EPA Method 8260 for Oxygenate Compounds



GETTLER-RYAN INC.

WELL MONITORING/SAMPLING FIELD DATA SHEET

Client/Facility #: ChevronTexaco #9-4612 Job Number: 386473
 Site Address: 3616 San Leandro Street Event Date: 11/07/02 (inclusive)
 City: Oakland, CA Sampler: Tony C.

Well ID: MW-2 Well Condition: O.K.
 Well Diameter: 214 in.
 Total Depth: 19.00 ft.
 Depth to Water: 11.07 ft.
 $8.33 \times VF .17 = 1.41 \times 3 \text{ (case volume)} = \text{Estimated Purge Volume: } 4\frac{1}{2} \text{ gal.}$

Volume	3/4" = 0.02	1" = 0.04	2" = 0.17	3" = 0.38
Factor (VF)	4" = 0.66	5" = 1.02	6" = 1.50	12" = 5.80

Purge Equipment:
 Disposable Bailer
 Stainless Steel Bailer _____
 Stack Pump _____
 Suction Pump _____
 Grundfos _____
 Other: _____

Sampling Equipment:
 Disposable Bailer
 Pressure Bailer _____
 Discrete Bailer _____
 Other: _____

Time Started: _____ (2400 hrs)
 Time Bailed: _____ (2400 hrs)
 Depth to Product: _____ ft
 Depth to Water: _____ ft
 Hydrocarbon Thickness: 0 ft
 Visual Confirmation/Description: _____
 Skimmer / Absorbent Sock (circle one)
 Amt Removed from Skimmer: _____ gal
 Amt Removed from Well: _____ gal
 Product Transferred to: _____

Start Time (purge): 1039 Weather Conditions: Cloudy
 Sample Time/Date: 1057 11/07/02 Water Color: Cloudy Odor: YES
 Purging Flow Rate: _____ gpm. Sediment Description: _____
 Did well de-water? NO If yes, Time: _____ Volume: _____ gal.

Time (2400 hr.)	Volume (gal.)	pH	Conductivity (u mhos/cm)	Temperature (C/F)	D.O. (mg/L)	ORP (mV)
<u>1041</u>	<u>1.5</u>	<u>7.18</u>	<u>1321</u>	<u>68.9</u>		
<u>1043</u>	<u>3.0</u>	<u>7.02</u>	<u>1315</u>	<u>68.1</u>		
<u>1045</u>	<u>4.5</u>	<u>6.98</u>	<u>1314</u>	<u>67.8</u>		
_____	_____	_____	_____	_____	_____	_____

LABORATORY INFORMATION

SAMPLE ID	(#) CONTAINER	REFRIG.	PRESERV. TYPE	LABORATORY	ANALYSES
<u>MW-2</u>	<u>6</u> x vov vial	<u>YES</u>	<u>HCL</u>	<u>LANCASTER</u>	<u>TPH-G(8015)/BTEX+MTBE(8021)/MTBE(8260)</u>
	x amber	<u>YES</u>	<u>NP</u>	<u>LANCASTER</u>	<u>TPH-D</u>

COMMENTS: ORC FN WELL

Add/Replaced Lock: _____ Add/Replaced Plug: _____ Size: _____



GETTLER-RYAN INC.

WELL MONITORING/SAMPLING FIELD DATA SHEET

Client/Facility #: ChevronTexaco #9-4612 Job Number: 386473
 Site Address: 3616 San Leandro Street Event Date: 11/07/02 (inclusive)
 City: Oakland, CA Sampler: Tony C

Well ID: MW-3
 Well Diameter: 2 1/4 in.
 Total Depth: 18.10 ft.
 Depth to Water: 11.13 ft.

Well Condition: O.K.

Volume	3/4" = 0.02	1" = 0.04	2" = 0.17	3" = 0.38
Factor (VF)	4" = 0.66	5" = 1.02	6" = 1.50	12" = 5.80

$6.97 \times VF .17 = 1.18 \times 3 \text{ (case volume)} = \text{Estimated Purge Volume: } 3\frac{1}{2} \text{ gal.}$

Purge Equipment:
 Disposable Bailer
 Stainless Steel Bailer _____
 Stack Pump _____
 Suction Pump _____
 Grundfos _____
 Other: _____

Sampling Equipment:
 Disposable Bailer
 Pressure Bailer _____
 Discrete Bailer _____
 Other: _____

Time Started: _____ (2400 hrs)
 Time Bailed: _____ (2400 hrs)
 Depth to Product: _____ ft
 Depth to Water: _____ ft
 Hydrocarbon Thickness: 0 ft
 Visual Confirmation/Description: _____
 Skimmer / Absorbant Sock (circle one)
 Amt Removed from Skimmer: _____ gal
 Amt Removed from Well: _____ gal
 Product Transferred to: _____

Start Time (purge): 1112 Weather Conditions: partly cloudy
 Sample Time/Date: 1125 11/07/02 Water Color: cloudy Odor: yes
 Purging Flow Rate: _____ gpm. Sediment Description: _____
 Did well de-water? no If yes, Time: _____ Volume: _____ gal.

Time (2400 hr.)	Volume (gal.)	pH	Conductivity (umhos/cm)	Temperature (C/F)	D.O. (mg/L)	ORP (mV)
<u>1114</u>	<u>1</u>	<u>7.16</u>	<u>1296</u>	<u>68.4</u>	_____	_____
<u>1110</u>	<u>2</u>	<u>7.02</u>	<u>1284</u>	<u>67.6</u>	_____	_____
<u>1118</u>	<u>3 1/2</u>	<u>7.00</u>	<u>1282</u>	<u>67.4</u>	_____	_____
_____	_____	_____	_____	_____	_____	_____

LABORATORY INFORMATION

SAMPLE ID	(#) CONTAINER	REFRIG.	PRESERV. TYPE	LABORATORY	ANALYSES
<u>MW-3</u>	<u>6</u> x voa vial	YES	HCL	LANCASTER	TPH-G(8015)/BTEX+MTBE(8021)/MTBE(8260)
<u>MW-3</u>	<u>2</u> x amber	YES	NP	LANCASTER	TPH-D
_____	_____	_____	_____	_____	_____

COMMENTS: ORL IN WELL.

Add/Replaced Lock: _____ Add/Replaced Plug: _____ Size: _____



GETTLER-RYAN INC.

WELL MONITORING/SAMPLING FIELD DATA SHEET

Client/Facility #: ChevronTexaco #9-4612 Job Number: 386473
 Site Address: 3616 San Leandro Street Event Date: 11/07/02 (inclusive)
 City: Oakland, CA Sampler: TONY C.

Well ID: MW-4 Well Condition: O.K.
 Well Diameter: (2) 1.4 in.
 Total Depth: 19.00 ft.
 Depth to Water: 10.42 ft.
 Volume Factor (VF) table:

Volume	3/4"= 0.02	1"= 0.04	2"= 0.17	3"= 0.38
Factor (VF)	4"= 0.66	5"= 1.02	6"= 1.50	12"= 5.80

 Estimated Purge Volume: $8.58 \times VF = 17 = 1.45 \times 3$ (case volume) = 4 1/2 gal.

Purge Equipment:
 Disposable Bailer
 Stainless Steel Bailer _____
 Stack Pump _____
 Suction Pump _____
 Grundfos _____
 Other: _____

Sampling Equipment:
 Disposable Bailer
 Pressure Bailer _____
 Discrete Bailer _____
 Other: _____

Time Started: _____ (2400 hrs)
 Time Bailed: _____ (2400 hrs)
 Depth to Product: _____ ft
 Depth to Water: _____ ft
 Hydrocarbon Thickness: 0 ft
 Visual Confirmation/Description: _____
 Skimmer / Absorbent Sock (circle one)
 Amt Removed from Skimmer: _____ gal
 Amt Removed from Well: _____ gal
 Product Transferred to: _____

Start Time (purge): 1140 Weather Conditions: CLOUDY / WINDY
 Sample Time/Date: 1154 11/07/02 Water Color: LT. BROWN Odor: NO
 Purging Flow Rate: _____ gpm. Sediment Description: _____
 Did well de-water? NO If yes, Time: _____ Volume: _____ gal.

Time (2400 hr.)	Volume (gal.)	pH	Conductivity (u mhos/cm)	Temperature (C/F)	D.O. (mg/L)	ORP (mV)
<u>1142</u>	<u>1.5</u>	<u>7.31</u>	<u>1189</u>	<u>109.1</u>		
<u>1145</u>	<u>3.0</u>	<u>7.20</u>	<u>1164</u>	<u>108.2</u>		
<u>1148</u>	<u>4.5</u>	<u>7.19</u>	<u>1161</u>	<u>108.4</u>		

LABORATORY INFORMATION

SAMPLE ID	(#) CONTAINER	REFRIG.	PRESERV. TYPE	LABORATORY	ANALYSES
<u>MW-4</u>	<u>6</u> x vov vial	YES	HCL	LANCASTER	TPH-G(8015)/BTEX+MTBE(8021)/MTBE(8260)
	x amber	YES	NP	LANCASTER	TPH-D

COMMENTS: _____

Add/Replaced Lock: _____ Add/Replaced Plug: _____ Size: _____

Chevron California Region Analysis Request/Chain of Custody



For Lancaster Laboratories use only
 Acct. #: 10905 Sample #: 3938087-91 SCR#: _____

110802-010

Group # 830341

Facility #: 9-4612 Job# 386473 Global ID# T0600100333
 Site Address: 3616 SAN LEANDRO STREET, OAKLAND, CA
 Chevron PM: Karen Streich Lead Consultant: Delta/G-R
 Consultant/Office: G-R Inc 6747 Sierra Ct #J Dublin CA 94568
 Consultant Prj. Mgr.: Deanna L Harding (deanna@grinc.com)
 Consultant Phone #: 925-551-7555 Fax #: 925-551-7899
 Sampler: Tony Camarida
 Service Order #: _____ Non SAR: _____

Matrix		Analyses Requested																
		Preservation Codes																
Soil	Water	Oil	Air	Total Number of Containers														
<input type="checkbox"/>	<input type="checkbox"/>	<input type="checkbox"/>	<input type="checkbox"/>	8021	8260	8021	8260	8015 MOD	GRO	8015 MOD DRO	Silica Gel Cleanup	8260 full scan	Oxygenates	Lead 7420	7421	MTBE 8260		

Preservative Codes
 H = HCl T = Thiosulfate
 N = HNO₃ B = NaOH
 S = H₂SO₄ O = Other

J value reporting needed
 Must meet lowest detection limits possible for 8260 compounds

8021 MTBE Confirmation
 Confirm highest hit by 8260
 Confirm all hits by 8260
 Run ___ oxy s on highest hit
 Run ___ oxy s on all hits

Sample Identification	Date Collected	Time Collected	Grab	Composite	Matrix			Total Number of Containers	Analyses Requested										Comments / Remarks						
					Soil	Water	Oil		Air	8021	8260	8015 MOD	GRO	8015 MOD DRO	Silica Gel Cleanup	8260 full scan	Oxygenates	Lead 7420		7421	MTBE 8260				
GA	11/07/02	—						2	X	X															
VII-1		1022	X					6	X	X															
MW-2		1052	X					6	X	X															
MW-3		1125	X					8	X	X	X														
MW-4		1154	X					6	X	X															

Turnaround Time Requested (TAT) (please circle)

STD. TAT 72 hour 48 hour
 24 hour 4 day 5 day

Data Package Options (please circle if required)

QC Summary Type I — Full
 Type VI (Raw Data) Coelt Deliverable not needed
 WIP (RWQCB)
 Disk

Relinquished by: <u>Tony Camarida</u>	Date: <u>11/07/02</u>	Time: <u>1070</u>	Received by: <u>James</u>	Date: <u>11/08/02</u>	Time: <u>1230</u>
Relinquished by: <u>James</u>	Date: <u>11/08/02</u>	Time: <u>1230</u>	Received by: <u>Anche Amays</u>	Date: <u>11/08/02</u>	Time: <u>1230</u>
Relinquished by: <u>Anche Amays</u>	Date: <u>11/08/02</u>	Time: <u>1430</u>	Received by: <u>Airborne</u>	Date: <u>11/10/02</u>	Time: _____
Relinquished by Commercial Carrier: <u>Airborne</u>	UPS FedEx Other: <u>Airborne</u>	Temperature Upon Receipt: <u>2.5</u> °C	Received by: <u>James</u>	Date: <u>11/10/02</u>	Time: <u>0940</u>
Custody Seals Intact? <u>Yes</u> No					



RECEIVED

NOV 28 2002

LANCASTER LABS INC.
2425 NEW HOLLAND PIKE
LANCASTER, PA 17605-2425

ANALYTICAL RESULTS

Prepared for:

ChevronTexaco
6001 Bollinger Canyon Rd L4310
San Ramon CA 94583

925-842-8582

Prepared by:

Lancaster Laboratories
2425 New Holland Pike
Lancaster, PA 17605-2425

SAMPLE GROUP

The sample group for this submittal is 830341. Samples arrived at the laboratory on Tuesday, November 12, 2002. The PO# for this group is 99011184 and the release number is STREICH.

<u>Client Description</u>		<u>Lancaster Labs Number</u>
QA-T-021107	NA Water	3938087
VH-1-W-021107	Grab Water	3938088
MW-2-W-021107	Grab Water	3938089
MW-3-W-021107	Grab Water	3938090
MW-4-W-021107	Grab Water	3938091

1 COPY TO

Delta C/O Gettler-Ryan

Attn: Deanna L. Harding

Questions? Contact your Client Services Representative
Teresa M Lis at (717) 656-2300.

Respectfully Submitted,

Christine M. Dulaney
Sr. Chemist



Lancaster Laboratories, Inc.
2425 New Holland Pike
PO Box 12425
Lancaster, PA 17605-2425
717-656-2300 Fax: 717-656-2681



Lancaster Laboratories Sample No. WW 3938087

Collected: 11/07/2002 00:00

Account Number: 10905

Submitted: 11/12/2002 09:40
 Reported: 11/19/2002 at 20:25
 Discard: 12/20/2002

ChevronTexaco
 6001 Bollinger Canyon Rd L4310
 San Ramon CA 94583

QA-T-021107 NA Water GRD
 Facility# 94612 Job# 386473
 3616 San Leandro-Oakland T0600100333 QA

CAT No.	Analysis Name	CAS Number	As Received Result	As Received Method Detection Limit	Units	Dilution Factor
01729	TPH-GRO - Waters					
01730	TPH-GRO - Waters	n.a.	N.D.	50.	ug/l	1
The reported concentration of TPH-GRO does not include MTBE or other gasoline constituents eluting prior to the C6 (n-hexane) TPH-GRO range start time. A site-specific MSD sample was not submitted for the project. A LCS/LCSD was performed to demonstrate precision and accuracy at a batch level.						
08214	BTEX, MTBE (8021)					
00776	Benzene	71-43-2	N.D.	0.50	ug/l	1
00777	Toluene	108-88-3	N.D.	0.50	ug/l	1
00778	Ethylbenzene	100-41-4	N.D.	0.50	ug/l	1
00779	Total Xylenes	1330-20-7	N.D.	1.5	ug/l	1
00780	Methyl tert-Butyl Ether	1634-04-4	N.D.	2.5	ug/l	1
A site-specific MSD sample was not submitted for the project. A LCS/LCSD was performed to demonstrate precision and accuracy at a batch level.						

State of California Lab Certification No. 2116

Laboratory Chronicle

CAT No.	Analysis Name	Method	Trial#	Analysis Date and Time	Analyst	Dilution Factor
01729	TPH-GRO - Waters	N. CA LUFT Gasoline Method	1	11/14/2002 03:23	Melissa D Mann	1
08214	BTEX, MTBE (8021)	SW-846 8021B	1	11/14/2002 03:23	Melissa D Mann	1
01146	GC VOA Water Prep	SW-846 5030B	1	11/14/2002 03:23	Melissa D Mann	n.a.

#=Laboratory Method Detection Limit exceeded target detection limit
 N.D.=Not detected or above the Reporting Limit



Lancaster Laboratories, Inc.
 1225 New Holland Pike
 Lancaster, PA 17605-2425
 717-656-2300 Fax: 717-656-2681



Lancaster Laboratories Sample No. WW 3938088

Collected: 11/07/2002 10:22 by TC

Account Number: 10905

Submitted: 11/12/2002 09:40

Reported: 11/19/2002 at 20:25

Discard: 12/20/2002

VH-1-W-021107

Grab

Water

Facility# 94612 Job# 386473

GRD

3616 San Leandro-Oakland T0600100333 VH-1

ChevronTexaco

6001 Bollinger Canyon Rd L4310

San Ramon CA 94583

SLSO1

CAT No.	Analysis Name	CAS Number	As Received Result	As Received Method Detection Limit	Units	Dilution Factor
01729	TPH-GRO - Waters					
01730	TPH-GRO - Waters	n.a.	150.	50.	ug/l	1
The reported concentration of TPH-GRO does not include MTBE or other gasoline constituents eluting prior to the C6 (n-hexane) TPH-GRO range start time. A site-specific MSD sample was not submitted for the project. A LCS/LCSD was performed to demonstrate precision and accuracy at a batch level.						
08214	BTEX, MTBE (8021)					
00776	Benzene	71-43-2	1.3	0.50	ug/l	1
00777	Toluene	108-88-3	N.D.	0.50	ug/l	1
00778	Ethylbenzene	100-41-4	N.D.	0.50	ug/l	1
00779	Total Xylenes	1330-20-7	N.D.	1.5	ug/l	1
00780	Methyl tert-Butyl Ether	1634-04-4	56.	2.5	ug/l	1
A site-specific MSD sample was not submitted for the project. A LCS/LCSD was performed to demonstrate precision and accuracy at a batch level.						
01595	Oxygenates by 8260B					
02010	Methyl t-butyl ether	1634-04-4	50.	2.	ug/l	1

State of California Lab Certification No. 2116

Laboratory Chronicle

CAT No.	Analysis Name	Method	Trial#	Analysis		Analyst	Dilution Factor
				Date and Time			
01729	TPH-GRO - Waters	N. CA LUFT Gasoline Method	1	11/14/2002 05:45		Melissa D Mann	1
08214	BTEX, MTBE (8021)	SW-846 8021B	1	11/14/2002 05:45		Melissa D Mann	1
01595	Oxygenates by 8260B	SW-846 8260B	1	11/14/2002 15:48		John B Kiser	1
01146	GC VOA Water Prep	SW-846 5030B	1	11/14/2002 05:45		Melissa D Mann	n.a.
01163	GC/MS VOA Water Prep	SW-846 5030B	1	11/14/2002 15:48		John B Kiser	n.a.

#=Laboratory Method Detection Limit exceeded target detection limit
N.D.=Not detected or above the Reporting Limit

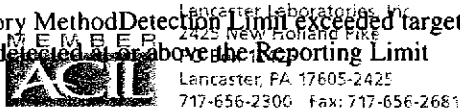



Lancaster Laboratories Sample No. WW 3938089

Collected: 11/07/2002 10:52 by TC

Account Number: 10905

Submitted: 11/12/2002 09:40
 Reported: 11/19/2002 at 20:25
 Discard: 12/20/2002

ChevronTexaco
 6001 Bollinger Canyon Rd L4310
 San Ramon CA 94583

MW-2-W-021107 Grab Water
 Facility# 94612 Job# 386473 GRD
 3616 San Leandro-Oakland T0600100333 MW-2

SLSO2

CAT No.	Analysis Name	CAS Number	As Received Result	As Received Method Detection Limit	Units	Dilution Factor
01729	TPH-GRO - Waters					
01730	TPH-GRO - Waters	n.a.	5,900.	250.	ug/l	5
	The reported concentration of TPH-GRO does not include MTBE or other gasoline constituents eluting prior to the C6 (n-hexane) TPH-GRO range start time. A site-specific MSD sample was not submitted for the project. A LCS/LCSD was performed to demonstrate precision and accuracy at a batch level.					
08214	BTEX, MTBE (8021)					
00776	Benzene	71-43-2	33.	1.0	ug/l	5
00777	Toluene	108-88-3	4.4	1.0	ug/l	5
00778	Ethylbenzene	100-41-4	23.	1.0	ug/l	5
00779	Total Xylenes	1330-20-7	21.	3.0	ug/l	5
00780	Methyl tert-Butyl Ether	1634-04-4	N.D. #	100.	ug/l	5
	A site-specific MSD sample was not submitted for the project. A LCS/LCSD was performed to demonstrate precision and accuracy at a batch level. Due to the presence of an interferent near its retention time, the normal reporting limit was not attained for MTBE. The presence or concentration of this compound cannot be determined due to the presence of this interferent.					
01595	Oxygenates by 8260B					
02010	Methyl t-butyl ether	1634-04-4	69.	2.	ug/l	1

State of California Lab Certification No. 2116

Laboratory Chronicle

CAT No.	Analysis Name	Method	Trial#	Analysis Date and Time	Analyst	Dilution Factor
01729	TPH-GRO - Waters	N. CA LUFT Gasoline Method	1	11/14/2002 06:20	Melissa D Mann	5
08214	BTEX, MTBE (8021)	SW-846 8021B	1	11/14/2002 06:20	Melissa D Mann	5
01595	Oxygenates by 8260B	SW-846 8260B	1	11/15/2002 12:25	John B Kiser	1
01146	GC VOA Water Prep	SW-846 5030B	1	11/14/2002 06:20	Melissa D Mann	n.a.

#=Laboratory Method Detection Limit exceeded target detection limit
 N.D.=Not detected above the Reporting Limit



Lancaster Laboratories, Inc.
 Lancaster, PA 17605-2421
 717-656-2300 Fax: 717-656-2681



Lancaster Laboratories Sample No. WW 3938089

Collected: 11/07/2002 10:52 by TC

Account Number: 10905

Submitted: 11/12/2002 09:40

Reported: 11/19/2002 at 20:25

Discard: 12/20/2002

ChevronTexaco

6001 Bollinger Canyon Rd L4310

San Ramon CA 94583

MW-2-W-021107 Grab Water

Facility# 94612 Job# 386473 GRD

3616 San Leandro-Oakland T0600100333 MW-2

SLSO2

01163 GC/MS VOA Water Prep

SW-846 5030B

1

11/15/2002 12:25

John B Kiser

n.a.

#=Laboratory Method Detection Limit exceeded target detection limit
N.D.=Not detected at or above the Reporting Limit



Lancaster Laboratories, Inc.
2929 New Holland Pkwy
Lancaster, PA 17605-2425
717-656-2300 Fax: 717-656-2681



Lancaster Laboratories Sample No. WW 3938090

Collected: 11/07/2002 11:25 by TC

Account Number: 10905

Submitted: 11/12/2002 09:40
 Reported: 11/19/2002 at 20:25
 Discard: 12/20/2002

ChevronTexaco
 6001 Bollinger Canyon Rd L4310
 San Ramon CA 94583

MW-3-W-021107 Grab Water
 Facility# 94612 Job# 386473 GRD
 3616 San Leandro-Oakland T0600100333 MW-3

SLSO3

CAT No.	Analysis Name	CAS Number	As Received Result	As Received Method Detection Limit	Units	Dilution Factor
05553	TPH - DRO CA LUFT (Waters)	n.a.	660.	50.	ug/l	1
According to the California LUFT Protocol, the quantitation for Diesel Range Organics was performed by peak area comparison of the sample pattern to that of our #2 fuel oil reference standard (between C10 and C28 normal hydrocarbons). Site-specific MS/MSD samples were not submitted for the project. A LCS/LCSD was performed to demonstrate precision and accuracy at a batch level.						
01729	TPH-GRO - Waters					
01730	TPH-GRO - Waters	n.a.	2,600.	50.	ug/l	1
The reported concentration of TPH-GRO does not include MTBE or other gasoline constituents eluting prior to the C6 (n-hexane) TPH-GRO range start time. A site-specific MSD sample was not submitted for the project. A LCS/LCSD was performed to demonstrate precision and accuracy at a batch level.						
08214	BTEX, MTBE (8021)					
00776	Benzene	71-43-2	24.	1.0	ug/l	5
00777	Toluene	108-88-3	N.D. #	5.0	ug/l	5
00778	Ethylbenzene	100-41-4	2.0	1.0	ug/l	5
00779	Total Xylenes	1330-20-7	4.8	3.0	ug/l	5
00780	Methyl tert-Butyl Ether	1634-04-4	51.	2.5	ug/l	5
A site-specific MSD sample was not submitted for the project. A LCS/LCSD was performed to demonstrate precision and accuracy at a batch level.						
Due to the presence of an interferent near its retention time, the normal reporting limit was not attained for toluene. The presence or concentration of this compound cannot be determined due to the presence of this interferent.						
01595	Oxygenates by 8260B					
02010	Methyl t-butyl ether	1634-04-4	37.	2.	ug/l	1

State of California Lab Certification No. 2116

Laboratory Chronicle

#=Laboratory Method Detection Limit exceeded target detection limit
 N.D.=Not detected above the Reporting Limit



Lancaster Laboratories, Inc.
 Lancaster, PA 17605-2425
 717-656-2300 Fax: 717-656-2681



Lancaster Laboratories Sample No. WW 3938090

Collected: 11/07/2002 11:25 by TC

Account Number: 10905

Submitted: 11/12/2002 09:40
Reported: 11/19/2002 at 20:25
Discard: 12/20/2002

ChevronTexaco
6001 Bollinger Canyon Rd L4310
San Ramon CA 94583

MW-3-W-021107 Grab Water
Facility# 94612 Job# 386473 GRD
3616 San Leandro-Oakland T0600100333 MW-3

SLSO3
CAT

No.	Analysis Name	Method	Trial#	Analysis Date and Time	Analyst	Dilution Factor
05553	TPH - DRO CA LUFT (Waters)	CA LUFT Diesel Range Organics	1	11/15/2002 08:40	Tracy A Cole	1
01729	TPH-GRO - Waters	N. CA LUFT Gasoline Method	1	11/14/2002 05:09	Melissa D Mann	1
08214	BTEX, MTBE (8021)	SW-846 8021B	1	11/14/2002 14:57	Melissa D Mann	5
01595	Oxygenates by 8260B	SW-846 8260B	1	11/15/2002 12:51	John B Kiser	1
01146	GC VOA Water Prep	SW-846 5030B	1	11/14/2002 05:09	Melissa D Mann	n.a.
01163	GC/MS VOA Water Prep	SW-846 5030B	1	11/15/2002 12:51	John B Kiser	n.a.
07003	Extraction - DRO (Waters)	TPH by CA LUFT	1	11/14/2002 09:30	William P Stafford	1

#=Laboratory Method Detection Limit exceeded target detection limit
N.D.=Not detected or above the Reporting Limit

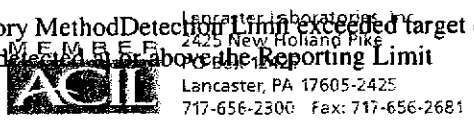



Lancaster Laboratories Sample No. **WW 3938091**

Collected: 11/07/2002 11:54 by TC

Account Number: 10905

Submitted: 11/12/2002 09:40
 Reported: 11/19/2002 at 20:25
 Discard: 12/20/2002

ChevronTexaco
 6001 Bollinger Canyon Rd L4310
 San Ramon CA 94583

MW-4-W-021107 Grab Water
 Facility# 94612 Job# 386473 GRD
 3616 San Leandro-Oakland T0600100333 MW-4

SLSO4

CAT No.	Analysis Name	CAS Number	As Received Result	As Received Method Detection Limit	Units	Dilution Factor
01729	TPH-GRO - Waters					
01730	TPH-GRO - Waters	n.a.	N.D.	50.	ug/l	1
The reported concentration of TPH-GRO does not include MTBE or other gasoline constituents eluting prior to the C6 (n-hexane) TPH-GRO range start time. A site-specific MSD sample was not submitted for the project. A LCS/LCSD was performed to demonstrate precision and accuracy at a batch level.						
08214	BTEX, MTBE (8021)					
00776	Benzene	71-43-2	N.D.	0.50	ug/l	1
00777	Toluene	108-88-3	N.D.	0.50	ug/l	1
00778	Ethylbenzene	100-41-4	N.D.	0.50	ug/l	1
00779	Total Xylenes	1330-20-7	N.D.	1.5	ug/l	1
00780	Methyl tert-Butyl Ether	1634-04-4	N.D.	2.5	ug/l	1
A site-specific MSD sample was not submitted for the project. A LCS/LCSD was performed to demonstrate precision and accuracy at a batch level.						
01595	Oxygenates by 8260B					
02010	Methyl t-butyl ether	1634-04-4	N.D.	2.	ug/l	1

State of California Lab Certification No. 2116

Laboratory Chronicle

CAT No.	Analysis Name	Method	Trial#	Analysis Date and Time	Analyst	Dilution Factor
01729	TPH-GRO - Waters	N. CA LUFT Gasoline Method	1	11/14/2002 03:58	Melissa D Mann	1
08214	BTEX, MTBE (8021)	SW-846 8021B	1	11/14/2002 03:58	Melissa D Mann	1
01595	Oxygenates by 8260B	SW-846 8260B	1	11/15/2002 03:43	Bryan J Polick	1
01146	GC VOA Water Prep	SW-846 5030B	1	11/14/2002 03:58	Melissa D Mann	n.a.
01163	GC/MS VOA Water Prep	SW-846 5030B	1	11/15/2002 03:43	Bryan J Polick	n.a.

#=Laboratory Method Detection Limit exceeded target detection limit
 N.D.=Not detected or above the Reporting Limit



Lancaster Laboratories, Inc.
 1425 New Holland Pike
 Lancaster, PA 17605-2425
 717-656-2300 Fax: 717-656-2681

Quality Control Summary

 Client Name: ChevronTexaco
 Reported: 11/19/02 at 08:25 PM

Group Number: 830341

Laboratory Compliance Quality Control

<u>Analysis Name</u>	<u>Blank Result</u>	<u>Blank MDL</u>	<u>Report Units</u>	<u>LCS %REC</u>	<u>LCSD %REC</u>	<u>LCS/LCSD Limits</u>	<u>RPD</u>	<u>RPD Max</u>
Batch number: 02317A51B	Sample number(s): 3938090							
Benzene	N.D.	.2	ug/l	100	98	80-118	2	30
Toluene	N.D.	.2	ug/l	99	97	82-119	3	30
Ethylbenzene	N.D.	.2	ug/l	99	95	81-119	4	30
Total Xylenes	N.D.	.6	ug/l	101	96	82-120	4	30
Methyl tert-Butyl Ether	N.D.	.3	ug/l	94	97	79-127	3	30
Batch number: 02317A56B	Sample number(s): 3938087-3938091							
Benzene	N.D.	.2	ug/l	91	89	80-118	3	30
Toluene	N.D.	.2	ug/l	98	97	82-119	1	30
Ethylbenzene	N.D.	.2	ug/l	103	102	81-119	1	30
Total Xylenes	N.D.	.6	ug/l	104	102	82-120	1	30
Methyl tert-Butyl Ether	N.D.	.3	ug/l	99	94	79-127	5	30
TPH-GRO - Waters	N.D.	50.	ug/l	93	95	74-116	2	30
Batch number: 023180012A	Sample number(s): 3938090							
TPH - DRO CA LUFT (Waters)	N.D.	50.	ug/l	106	104	54-120	2	20
Batch number: N023181AA	Sample number(s): 3938088							
Methyl t-butyl ether	N.D.	.5	ug/l	102		77-127		
Batch number: N023181AB	Sample number(s): 3938089-3938090							
Methyl t-butyl ether	N.D.	.5	ug/l	102		77-127		
Batch number: N023185AA	Sample number(s): 3938091							
Methyl t-butyl ether	N.D.	.5	ug/l	96		77-127		

Sample Matrix Quality Control

<u>Analysis Name</u>	<u>MS %REC</u>	<u>MSD %REC</u>	<u>MS/MSD Limits</u>	<u>RPD</u>	<u>BKG MAX</u>	<u>CONC</u>	<u>DUP CONC</u>	<u>DUP RPD</u>	<u>Dup RPD Max</u>
Batch number: 02317A51B	Sample number(s): 3938090								
Benzene	86		83-130						
Toluene	88		87-129						
Ethylbenzene	90		86-133						
Total Xylenes	91		86-132						
Methyl tert-Butyl Ether	88		66-140						
Batch number: 02317A56B	Sample number(s): 3938087-3938091								
Benzene	98		83-130						
Toluene	105		87-129						
Ethylbenzene	108		86-133						
Total Xylenes	109		86-132						
Methyl tert-Butyl Ether	101		66-140						
TPH-GRO - Waters	99		74-132						
Batch number: N023181AA	Sample number(s): 3938088								
Methyl t-butyl ether	102	101	69-134	1	30				
Batch number: N023181AB	Sample number(s): 3938089-3938090								
Methyl t-butyl ether	102	101	69-134	1	30				

*- Outside of specification

- (1) The result for one or both determinations was less than five times the LOQ.
- (2) The background result was more than four times the spike added.





Quality Control Summary

Client Name: ChevronTexaco
Reported: 11/19/02 at 08:25 PM

Group Number: 830341

Sample Matrix Quality Control

Analysis Name	MS	MSD	MS/MSD	RPD	BKG	DUP	DUP	Dup RPD	Dup Max
	%REC	%REC	Limits	RPD	MAX	Conc	Conc	RPD	Max
Batch number: N023185AA	Sample number(s): 3938091								
Methyl t-butyl ether	99	95	69-134	4	30				

Surrogate Quality Control

Analysis Name: BTEX, MTBE (8021)
Batch number: 02317A51B

	Trifluorotoluene-F	Trifluorotoluene-P
3938090	88	88
Blank	88	88
LCS	90	88
LCSD	89	90
MS	90	89
Limits:	57-146	71-130

Analysis Name: BTEX, MTBE (8021)
Batch number: 02317A56B

	Trifluorotoluene-F	Trifluorotoluene-P
3938087	87	95
3938088	87	93
3938089	108	102
3938090	119	
3938091	85	94
Blank	85	94
LCS	83	94
LCSD	92	95
MS	90	95
Limits:	57-146	71-130

Analysis Name: TPH - DRO CA LUFT (Waters)
Batch number: 023180012A

	Orthoterphenyl
3938090	98
Blank	119
LCS	113
LCSD	109
Limits:	59-139

Analysis Name: Oxygenates by 8260B
Batch number: N023181AA

	Dibromofluoromethane	1,2-Dichloroethane-d4	Toluene-d8	4-Bromofluorobenzene
3938088	93	95	101	97
Blank	95	95	99	99

*- Outside of specification

- (1) The result for one or both determinations was less than five times the LOQ.
- (2) The background result was more than four times the spike added.



Quality Control Summary Environmental Health

Client Name: ChevronTexaco
Reported: 11/19/02 at 08:25 PM

Group Number: 830341

Surrogate Quality Control

LCS	93	93	102	104
MS	93	93	102	104
MSD	93	93	102	104
Limits:	86-118	80-120	88-110	86-115

Analysis Name: Oxygenates by 8260B
Batch number: N023181AB

	Dibromofluoromethane	1,2-Dichloroethane-d4	Toluene-d8	4-Bromofluorobenzene
3938089	92	93	103	101
3938090	92	92	104	104
Blank	97	93	100	97
LCS	93	93	102	104
MS	93	93	102	104
MSD	93	93	102	104
Limits:	86-118	80-120	88-110	86-115

Analysis Name: Oxygenates by 8260B
Batch number: N023185AA

	Dibromofluoromethane	1,2-Dichloroethane-d4	Toluene-d8	4-Bromofluorobenzene
3938091	95	94	103	97
Blank	96	93	100	97
LCS	93	92	103	105
MS	93	93	103	105
MSD	95	94	104	106
Limits:	86-118	80-120	88-110	86-115

*- Outside of specification

- (1) The result for one or both determinations was less than five times the LOQ.
- (2) The background result was more than four times the spike added.

