

# 4249



# GETTLER-RYAN INC.

ENVIRONMENTAL PROTECTION

## TRANSMITTAL

00 NOV 21 PM 3:56

October 23, 2000

G-R #386473

**TO:** Mr. Jim Brownell  
Delta Environmental Consultants, Inc.  
3164 Gold Camp Drive, Suite 200  
Rancho Cordova, California 95670

**CC:** Mr. Thomas Bauhs  
Chevron Products Company  
P.O. Box 6004  
San Ramon, California 94583

**FROM:** Deanna L. Harding  
Project Coordinator  
Gettler-Ryan Inc.  
6747 Sierra Court, Suite J  
Dublin, California 94568

**RE:** Former Chevron Service Station  
#9-4612  
3616 San Leandro Street  
Oakland, California

**WE HAVE ENCLOSED THE FOLLOWING:**

COPIES	DATED	DESCRIPTION
2	October 9, 2000	Groundwater Monitoring and Sampling Report Third Quarter Event of July 31, 2000

**COMMENTS:**

Enclosed are copies of the above referenced report for your review and distribution to the following:

✓ *BARNEY CHAN*  
Mr. Larry Seto, Alameda County Health Care Services, Dept. of Environmental Health, 1131 Harbor Bay Parkway,  
Suite 250, Alameda, CA 94502-6577

Please provide any comments/changes and propose any groundwater monitoring modifications for the next event prior to **November 3, 2000**, at which time the final report will be distributed to the following:

Mr. Greg Gurs, Gettler-Ryan Inc., 3164 Gold Camp Drive, Suite 240, Rancho Cordova, CA 95670  
Mr. Leonard B. Ratto, Ratto Land Company, P.O. Box 6104, Oakland, CA 94603-0104  
Mr. Terry McIlraith, 407 Castello Road, Lafayette, CA 94549

Enclosures

trans/9-4612.tb



# GETTLER-RYAN INC.

October 9, 2000  
G-R Job #386473

Mr. Thomas Bauhs  
Chevron Products Company  
P.O. Box 6004  
San Ramon, CA 94583

**RE:**

**Third Quarter Event of July 31, 2000**  
Groundwater Monitoring & Sampling Report  
Former Chevron Service Station #9-4612  
3616 San Leandro Street  
Oakland, California

Dear Mr. Bauhs:

This report documents the most recent groundwater monitoring and sampling event performed by Gettler-Ryan Inc. (G-R) at the referenced site. All field work was conducted in accordance with G-R Standard Operating Procedure - Groundwater Sampling (attached).

Static groundwater levels were measured and the wells were checked for the presence of separate-phase hydrocarbons. Static water level data, groundwater elevations, and separate-phase hydrocarbon thickness (if any) are presented in the attached Table 1. Dissolved Oxygen Concentrations are presented in Table 2. A Potentiometric Map is included as Figure 1.

Groundwater samples were collected from the monitoring wells and submitted to a state certified laboratory for analyses. The field data sheets for this event are attached. Analytical results are presented in the table(s) listed below. The chain of custody document and laboratory analytical report are also attached.

Please call if you have any questions or comments regarding this report. Thank you.

Sincerely,

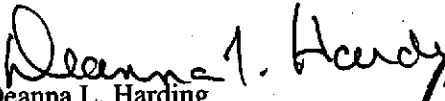
  
Deanna L. Harding  
Project Coordinator

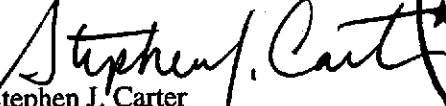
  
Stephen J. Carter  
Senior Geologist, R.G. No. 5577

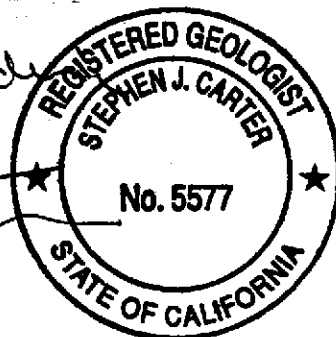

Figure 1: Potentiometric Map  
Table 1: Groundwater Monitoring Data and Analytical Results  
Table 2: Dissolved Oxygen Concentrations  
Attachments: Standard Operating Procedure - Groundwater Sampling  
Field Data Sheets  
Chain of Custody Document and Laboratory Analytical Reports

**EXPLANATION**

- ◆ Groundwater monitoring well
- 99.99 Groundwater elevation in feet referenced to Mean Sea Level (MSL)
- 99.99 - Groundwater elevation contour, dashed where inferred.



Approximate groundwater flow direction at a gradient of 0.02 Ft./Ft.

37th AVENUE

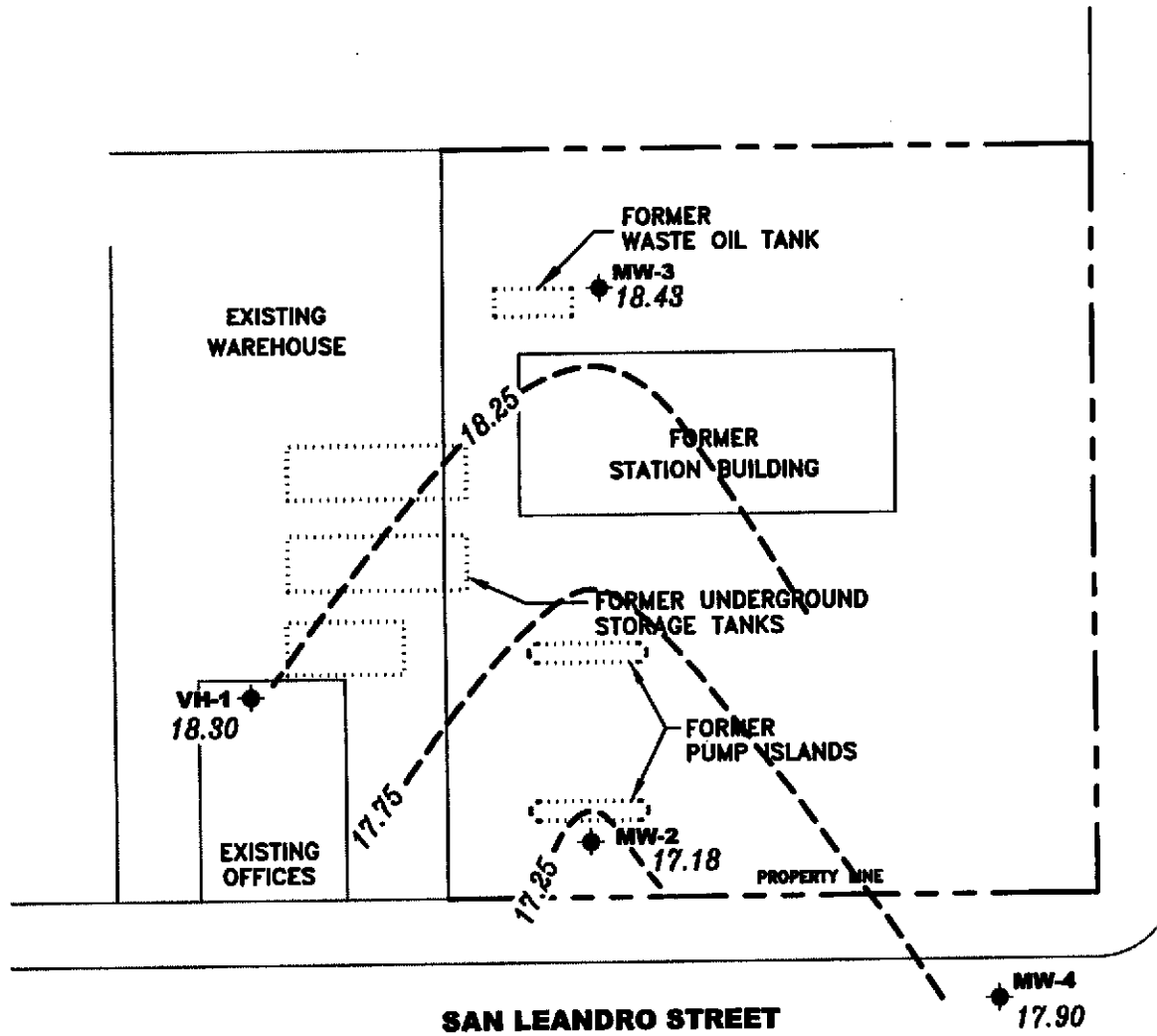

Source: Figure modified from drawing provided by RRM engineering contracting firm.



**Gettler - Ryan Inc.**

8747 Sierra Ct., Suite J  
Dublin, CA 94588 (925) 551-7555

**POTENTIOMETRIC MAP**  
Former Chevron Service Station #9-4612  
3616 San Leandro Street  
Oakland, California

FIGURE

1

PROJECT NUMBER  
386473

REVIEWED BY

DATE  
July 31, 2000

REVISED DATE

**Table 1**  
**Groundwater Monitoring Data and Analytical Results**  
Former Chevron Service Station #9-4612  
3616 San Leandro Street  
Oakland, California

Vertical Measurements are in feet.

Analytical results are in parts per billion (ppb)

DATE	Well Head Elev.	Ground Water Elev.	Depth To Water	Notes	TPH-Diesel	TPH-Gasoline	Benzene	Toluene	Ethyl-Benzene	Xylenes	MTBE	MTBE by 8260	TOG
<b>VH-1</b>													
08/10/88	--	--	13.00	--	--	11,000	3300	200	520	540	--	--	--
06/01/89	--	--	10.32	--	--	15,000	2200	120	540	310	--	--	--
09/15/89	--	--	15.69	--	--	5600	1900	90	350	160	--	--	--
12/08/89	--	--	14.77	--	--	11,000	1900	69	270	99	--	--	--
03/07/91	--	--	11.26	--	--	4500	820	39	120	77	--	--	--
09/24/91	--	--	12.98	--	--	3300	520	19	39	27	--	--	--
01/08/92	--	--	13.77	--	--	5000	600	34	81	76	--	--	--
04/20/92	--	--	8.18	--	--	7400	670	60	110	140	--	--	--
03/26/93	27.85	21.14	6.71	--	--	4900	600	40	72	94	--	--	--
05/27/93	27.85	19.27	8.58	--	--	13,000	1600	120	230	220	--	--	--
08/18/93	27.85	17.39	10.46	--	--	2700	210	10	8.1	18	--	--	--
11/03/93	27.85	15.28	12.57	--	--	4600	680	42	35	68	--	--	--
02/10/94	27.85	18.77	9.08	--	--	1900	260	19	22	29	--	--	--
05/12/94	27.85	19.76	8.09	--	--	2000	390	28	3.9	29	--	--	--
08/26/94	27.85	17.10	10.75	--	--	4900	500	<5.0	23	31	--	--	--
11/14/94	27.85	18.40	9.45	--	300	760	69	<2.0	<2.0	2.2	--	--	--
02/01/95	27.85	21.88	5.97	--	--	1300	120	5.9	<0.5	13	--	--	--
05/12/95	27.85	20.14	7.71	--	--	4400	460	31	45	49	--	--	--
08/22/95	27.85	18.59	9.26	--	--	2900	310	15	28	32	--	--	--
12/19/95	27.85	19.05	8.80	--	--	930	53	<2.5	<2.5	<2.5	39	--	--
01/31/96	27.85	22.35	5.50	--	--	3700	320	<10	41	40	180	--	--
04/30/96	27.85	19.81	8.04	--	--	3900	270	<20	<20	<20	120	--	--
08/01/96	27.85	18.67	9.18	--	--	2700	140	11	18	28	200	--	--
10/30/96	27.85	18.67	10.76	--	--	2700	140	<12	<12	<12	280	--	--
02/07/97	27.85	19.75	8.10	--	--	220	13	0.6	<0.5	1.6	15	--	--
05/07/97	27.85	18.33	9.52	--	--	5200	33	12	21	26	330	--	--
07/22/97	27.85	17.43	10.42	--	--	4200	80	<10	16	24	400	--	--
11/03/97	27.85	16.85	11.00	--	--	2400	150	6.8	6.5	9.5	510	--	--
01/28/98	27.85	20.75	7.10	--	--	850	69	4.8	5.0	11	38	48	--
05/08/98	27.85	20.14	7.71	--	--	4200	200	30	40	42	310	200	--
07/29/98	27.85	18.40	9.45	--	--	3800	54	10	27	30	35	290	--
11/06/98	27.85	17.15	10.70	--	--	4800	100	20	12	23	360	210	--

**Table 1**  
**Groundwater Monitoring Data and Analytical Results**  
Former Chevron Service Station #9-4612  
3616 San Leandro Street  
Oakland, California

Vertical Measurements are in feet.

Analytical results are in parts per billion (ppb)

DATE	Well Head Elev.	Ground Water Elev.	Depth To Water	Notes	TPH-Diesel	TPH-Gasoline	Benzene	Toluene	Ethyl-Benzene	Xylenes	MTBE	MTBE by 8260	TOG
<b>VH-1 (cont)</b>													
02/09/99	27.85	21.87	5.98	ORC socks installed	--	2950	79.5	<10	<10	<10	435	312	--
05/13/99	27.85	19.71	8.14	--	--	4180	147	12.8	16.5	20.3	433	245	--
09/07/99	27.85	17.94	9.91	--	--	2750	57.6	<5.0	6.53	<5.0	297	233	--
11/24/99	27.85	17.36	10.49	--	--	2550	38	3.18	2.54	5.21	--	216+	--
02/25/00	27.85	21.20	6.65	--	--	120	2.7	<0.5	<0.5	<0.5	20.5	11.9	--
05/10/00	27.85	19.76	8.09	--	--	1,400 <sup>3</sup>	63	3.3	3.1	4.9	230	110	--
07/31/00	27.85	18.30	9.55	ORC in well	--	360 <sup>3</sup>	22	2.7	1.6	3.1	100	88	--
<b>MW-2</b>													
02/16/93	27.51	--	--	--	--	9200	720	110	250	170	--	--	--
03/26/93	27.51	19.89	7.62	--	--	--	--	--	--	--	--	--	--
05/27/93	27.51	18.04	9.47	--	--	360	5.3	2.1	1.8	2.5	--	--	--
08/18/93	27.51	16.46	11.05	--	--	9400	1100	76	110	100	--	--	--
11/03/93	27.51	14.56	12.95	--	--	8600	390	20	2.7	120	--	--	--
02/10/94	27.51	17.72	9.79	--	--	2700	370	38	44	41	--	--	--
05/12/94	27.51	18.59	8.92	--	--	3800	650	76	15	62	--	--	--
08/26/94	27.51	16.14	11.37	--	--	16,000	1300	270	28	120	--	--	--
11/14/94	27.51	17.48	10.03	--	--	5100	390	10	43	27	--	--	--
02/01/95	27.51	20.47	7.04	--	--	6900	520	82	170	110	--	--	--
05/12/95	27.51	18.76	8.75	--	--	7700	510	83	110	100	--	--	--
08/22/95	27.51	17.35	10.16	--	--	4500	220	16	61	47	--	--	--
12/19/95	27.51	18.05	9.46	--	--	2900	240	<10	19	18	220	--	--
01/31/96	27.51	21.91	5.60	--	--	3900	320	18	72	39	<25	--	--
04/30/96	27.51	18.68	8.83	--	--	5600	200	36	55	47	170	--	--
08/01/96	27.51	17.25	10.26	--	--	6200	190	15	62	59	220	--	--
10/30/96	27.51	17.25	11.48	--	--	5700	190	<25	67	36	260	--	--
02/07/97	27.51	18.11	9.40	--	--	8300	210	34	70	59	330	--	--
05/07/97	27.51	17.57	9.94	--	--	6900	190	12	38	37	530	--	--
07/22/97	27.51	16.36	11.15	--	--	10,000	18	25	62	41	630	--	--

+ Lab could not get a good ion chromatogram match for MTBE. See laboratory report.

**Table 1**  
**Groundwater Monitoring Data and Analytical Results**  
Former Chevron Service Station #9-4612  
3616 San Leandro Street  
Oakland, California

Vertical Measurements are in feet.

Analytical results are in parts per billion (ppb)

DATE	Well Head Elev.	Ground Water Elev.	Depth To Water	Notes	TPH-Diesel	TPH-Gasoline	Benzene	Toluene	Ethyl-Benzene	Xylenes	MTBE	MTBE by 8260	TOG
<b>MW-2 (cont)</b>													
11/03/97	27.51	15.93	11.58	--	--	6500	260	8.5	26	14	590	--	--
11/03/97	27.51	15.93	11.58	Confirmation run	--	--	--	--	--	--	--	96	--
01/28/98	27.51	19.38	8.13	--	--	6700	65	13	67	54	280	94	--
05/08/98	27.51	18.89	8.62	--	--	5500	91	38	43	61	220	62	--
07/29/98	27.51	17.06	10.45	--	--	3600	41	8.9	3.6	14	16	94	--
11/06/98	27.51	15.89	11.62	--	--	6900	77	<5.0	14	17	290	110	--
02/09/99	27.51	20.61	6.90	ORC socks installed	--	8070	75.6	<10	<10	<10	397	144	--
05/13/99	27.51	18.21	9.30	--	--	5890	120	<5.0	12.5	26.6	401	69.4	--
09/07/99	27.51	16.57	10.94	--	--	5820	41.2	<5.0	14.6	<5.0	260	145	--
11/24/99	27.51	15.98	11.53	--	--	5940	40.9	<10	10.8	<10	--	120+	--
02/25/00	27.51	21.00	6.51	--	--	6370	101	9.37	39.8	33.2	321	121	--
05/10/00	27.51	18.49	9.02	--	--	6,100 <sup>3</sup>	110	13	27	31	560	120	--
07/31/00	27.51	17.18	10.33	ORC in well	--	3,000 <sup>3</sup>	75	14	28	28	200	130	--
<b>MW-3</b>													
02/16/93	28.50	--	--	--	--	3500	<0.5	8.1	4.6	7.7	--	--	--
03/26/93	28.50	21.32	7.18	--	--	--	--	--	--	--	--	--	--
05/27/93	28.50	19.17	9.33	--	--	4200	580	84	150	100	--	--	--
08/18/93	28.50	16.50	12.00	--	--	1400	910	12	3.7	6.2	--	--	<5000
11/03/93	28.50	15.21	13.29	--	--	5300	29	1.9	0.6	27	--	--	--
02/10/94	28.50	18.87	9.63	--	--	<50	63	<0.5	0.7	<0.5	--	--	--
05/12/94	28.50	19.73	8.77	--	--	84	<50	<0.5	0.5	<0.5	--	--	--
08/26/94	28.50	17.08	11.42	--	--	2100	12	<0.5	5.0	0.5	--	--	--
11/14/94	28.50	18.43	10.07	--	--	140	0.78	<0.5	<0.5	<0.5	--	--	--
02/01/95	28.50	22.21	6.29	--	--	<50	<50	<0.5	<0.5	<0.5	--	--	--
05/12/95	28.50	20.43	8.07	--	--	540*	330	13	1.1	1.9	0.69	--	--
08/22/95	28.50	18.55	9.95	--	--	550*	980	32	<1.0	<1.0	--	--	--

+ Lab could not get a good ion chromatogram match for MTBE. See laboratory report.

\* Chromatogram pattern indicates an unidentified hydrocarbon.

**Table 1**  
**Groundwater Monitoring Data and Analytical Results**  
Former Chevron Service Station #9-4612  
3616 San Leandro Street  
Oakland, California

Vertical Measurements are in feet.

Analytical results are in parts per billion (ppb)

DATE	Well Head Elev.	Ground Water Elev.	Depth To Water	Notes	TPH-Diesel	TPH-Gasoline	Benzene	Toluene	Ethyl-Benzene	Xylenes	MTBE	MTBE by 8260	TOG
<b>MW-3 (cont)</b>													
12/19/95	28.50	19.10	9.40	--	<50	<50	<0.5	<0.5	<0.5	<0.5	<2.5	--	--
01/31/96	28.50	23.45	5.05	--	<50	<50	<0.5	<0.5	<0.5	<0.5	<2.5	--	--
04/30/96	28.50	20.10	8.40	--	240*	320	2.4	<0.5	0.75	<0.5	7.8	--	--
08/01/96	28.50	18.70	9.80	--	470*	980	9.6	<0.5	0.98	2.2	54	--	--
10/30/96	28.50	18.70	11.48	--	760*	2000	14	<10	<10	<10	140	--	--
02/07/97	28.50	19.90	8.60	--	61*	200*	<0.5	<0.5	<0.5	<0.5	8.9	--	--
05/07/97	28.50	19.49	9.01	--	550*	3500	14	3.9	3.6	8.0	160	--	--
07/22/97	28.50	17.38	11.12	--	800*	3500	55	<10	<10	<10	150	--	--
11/03/97	28.50	16.99	11.51	--	910*	4100	140	<5.0	<5.0	<5.0	380	--	--
01/28/98	28.50	21.16	7.34	--	--	1100	24	<1.2	<1.2	2.8	33	6.1	--
05/08/98	28.50	20.44	8.06	--	250*	990	3.6	7.7	0.7	2.2	37	7.5	--
07/29/98	28.50	18.25	10.25	--	290*	1200	13	<0.5	<0.5	1.4	11	28	--
11/06/98	28.50	17.11	11.39	--	390*	2600	5.3	<2.5	<2.5	3.0	91	41	--
02/09/99	28.50	22.40	6.10	ORC socks installed	184*	406	<1.0	4.03	<1.0	<1.0	17.7	1.97	--
05/13/99	28.50	19.38	9.12	--	--	615	13.8	1.05	<0.5	<0.5	43.5	21.2	--
09/07/99	28.50	17.77	10.73	--	528*	2710	<5.0	<5.0	<5.0	<5.0	96.3	57.9	--
11/24/99	28.50	17.37	11.13	--	1070*	5530	<5.0	<5.0	5.59	<5.0	--	66+	--
02/25/00	28.50	22.22	6.28	--	--	189	4.68	<0.5	<0.5	<0.5	11.9	<2.0	--
03/01/00	28.50	21.80	6.70	--	380*	--	--	--	--	--	--	--	--
05/10/00	28.50	19.90	8.60	--	830 <sup>2</sup>	1,600 <sup>1</sup>	22	<10	<10	<10	100	51	--
07/31/00	28.50	18.43	10.07	ORC in well	490 <sup>2</sup>	2,200 <sup>1</sup>	76	10	<5.0	13	230	52	--
<b>MW-4</b>													
08/22/95	27.27	18.16	9.11	--	--	9600	100	<10	<10	<10	--	--	--
12/19/95	27.27	18.97	8.30	--	--	<50	<0.5	<0.5	<0.5	<0.5	<2.5	--	--
01/31/96	27.27	21.67	5.60	--	--	<50	<0.5	<0.5	<0.5	<0.5	<2.5	--	--
04/30/96	27.27	20.27	7.00	--	--	<50	<0.5	<0.5	<0.5	<0.5	<2.5	--	--
08/01/96	27.27	18.12	9.15	--	--	<50	<0.5	<0.5	<0.5	<0.5	--	--	--

+ Lab could not get a good ion chromatogram match for MTBE. See laboratory report.

\* Chromatogram pattern indicates an unidentified hydrocarbon.

**Table 1**  
**Groundwater Monitoring Data and Analytical Results**  
Former Chevron Service Station #9-4612  
3616 San Leandro Street  
Oakland, California

Vertical Measurements are in feet.

Analytical results are in parts per billion (ppb)

DATE	Well Head Elev.	Ground Water Elev.	Depth To Water	Notes	TPH-Diesel	TPH-Gasoline	Benzene	Toluene	Ethyl-Benzene	Xylenes	MTBE	MTBE by 8260	TOG
<b>MW-4 (cont)</b>													
10/30/96	27.27	18.12	10.74	--	--	110	<0.5	<0.5	<0.5	<0.5	<2.5	--	--
02/07/97	27.27	19.47	7.80	--	--	80	<0.5	<0.5	<0.5	<0.5	4.1	--	--
05/07/97	27.27	21.42	5.85	--	--	<50	<0.5	<0.5	<0.5	<0.5	<2.5	--	--
07/22/97	27.27	17.22	10.05	--	--	150	<0.5	<0.5	<0.5	<0.5	<2.5	--	--
11/03/97	27.27	16.55	10.72	--	--	52	0.9	<0.5	<0.5	<0.5	*	--	--
01/28/98	27.27	20.76	6.51	--	--	<50	<0.5	<0.5	<0.5	<0.5	<2.5	<2.0	--
05/08/98	27.27	20.25	7.02	--	--	56	<0.5	<0.5	<0.5	<0.5	<2.5	<2.0	--
07/29/98	27.27	18.32	8.95	--	--	<50	0.9	<0.5	<0.5	<0.5	<2.5	<2.0	--
11/06/98	27.27	16.68	10.59	--	--	72	<0.5	<0.5	<0.5	<0.5	<2.5	<2.0	--
02/09/99	27.27	21.41	5.86	--	--	<50	<0.5	<0.5	<0.5	<0.5	<2.0	1.1	--
05/13/99	27.27	19.32	7.95	--	--	<50	<0.5	<0.5	<0.5	<0.5	<5.0	<2.0	--
09/07/99	27.27	17.79	9.48	--	--	70.2	<0.5	<0.5	<0.5	<0.5	<2.0	<1.0	--
11/24/99	27.27	17.22	10.05	--	--	227	<0.5	<0.5	<0.5	<0.5	--	<0.5	--
02/25/00	--	--	--	Inaccessible	--	--	--	--	--	--	--	--	--
03/01/00	27.27	21.10	6.17	--	--	<50	<0.5	<0.5	<0.5	<0.5	<2.5	<2.0	--
05/10/00	--	--	--	Inaccessible	--	--	--	--	--	--	--	--	--
07/31/00	27.27	17.90	9.37	--	--	<50	<0.50	<0.50	<0.50	<0.50	<2.5	<2.0	--

\* No value for MTBE could be determined; see lab report for analyses.



**Table 1**  
**Groundwater Monitoring Data and Analytical Results**  
Former Chevron Service Station #9-4612  
3616 San Leandro Street  
Oakland, California

Vertical Measurements are in feet.

Analytical results are in parts per billion (ppb)

DATE	Well Head Elev.	Ground Water Elev.	Depth To Water	Notes	TPH-Diesel	TPH-Gasoline	Benzene	Toluene	Ethyl-Benzene	Xylenes	MTBE	MTBE by 8260	TOG
<b>TRIP BLANK</b>													
05/27/93	--	--	--	--	--	<50	<0.5	<0.5	<0.5	<1.5	--	--	--
08/18/93	--	--	--	--	1400	<50	<0.5	<0.5	<0.5	<1.5	--	--	<5000
11/03/93	--	--	--	--	--	<50	<0.5	<0.5	<0.5	<0.5	--	--	--
02/10/94	--	--	--	--	<50	<50	<0.5	<0.5	<0.5	<0.5	--	--	--
05/12/94	--	--	--	--	84	<50	<0.5	<0.5	<0.5	<0.5	--	--	--
08/26/94	--	--	--	--	--	<50	<0.5	<0.5	<0.5	<0.5	--	--	--
11/14/94	--	--	--	--	--	<50	<0.5	<0.5	<0.5	<0.5	--	--	--
02/01/95	--	--	--	--	--	<50	<0.5	<0.5	<0.5	<0.5	--	--	--
05/12/95	--	--	--	--	--	<50	<0.5	<0.5	<0.5	<0.5	--	--	--
08/22/95	--	--	--	--	--	<50	<0.5	<0.5	<0.5	<0.5	--	--	--
12/19/95	--	--	--	--	--	<50	<0.5	<0.5	<0.5	<0.5	<2.5	--	--
01/31/96	--	--	--	--	--	<50	<0.5	<0.5	<0.5	<0.5	<2.5	--	--
04/30/96	--	--	--	--	--	<50	<0.5	<0.5	<0.5	<0.5	<2.5	--	--
08/01/96	--	--	--	--	--	<50	<0.5	<0.5	<0.5	<0.5	<2.5	--	--
10/30/96	--	--	--	--	--	<50	<0.5	<0.5	<0.5	<0.5	<2.5	--	--
02/07/97	--	--	--	--	--	<50	<0.5	<0.5	<0.5	<0.5	<2.5	--	--
05/07/97	--	--	--	--	--	<50	<0.5	<0.5	<0.5	<0.5	<2.5	--	--
07/22/97	--	--	--	--	--	<50	<0.5	<0.5	<0.5	<0.5	<2.5	--	--
01/28/98	--	--	--	--	--	<50	<0.5	<0.5	<0.5	<0.5	--	<2.0	--
05/08/98	--	--	--	--	--	--	--	--	--	--	--	<2.0	--
07/29/98	--	--	--	--	--	<50	<0.5	<0.5	<0.5	<0.5	--	<2.0	--
11/06/98	--	--	--	--	--	<50	<0.5	<0.5	<0.5	<0.5	<2.5	--	--
02/09/99	--	--	--	--	--	<50	<0.5	<0.5	<0.5	<0.5	<2.0	--	--
05/13/99	--	--	--	--	--	<50	<0.5	<0.5	<0.5	<0.5	<5.0	<2.0	--
09/07/99	--	--	--	--	--	<50	<0.5	<0.5	<0.5	<0.5	<2.0	--	--
11/24/99	--	--	--	--	--	<50	<0.5	<0.5	<0.5	<0.5	<2.5	--	--
02/25/00	--	--	--	--	--	<50	<0.5	<0.5	<0.5	<0.5	<5.0	--	--
03/01/00	--	--	--	--	--	<50	<0.5	<0.5	<0.5	<0.5	<2.5	--	--
05/10/00	--	--	--	--	--	<50	<0.50	<0.50	<0.50	<0.50	<2.5	--	--
07/31/00	--	--	--	--	--	<50	<0.50	<0.50	<0.50	<0.50	<2.5	--	--

**Table 1**  
**Groundwater Monitoring Data and Analytical Results**  
Former Chevron Service Station #9-4612  
3616 San Leandro Boulevard  
Oakland, California

---

**EXPLANATIONS:**

Groundwater monitoring data and laboratory analytical results prior to May 10, 2000, were compiled from reports prepared by Blaine Tech Services, Inc.

TPH = Total Petroleum Hydrocarbons

MTBE = Methyl tertiary butyl ether

TOG = Total Oil & Grease

-- = Not Measured/Not Analyzed

<sup>1</sup> Laboratory report indicates gasoline C6-C12.

<sup>2</sup> Laboratory report indicates unidentified hydrocarbons <C16.

<sup>3</sup> Laboratory report indicates gasoline C6-C12 + unidentified hydrocarbons <C6.

**Table 2**  
**Dissolved Oxygen Concentrations**  
 Former Chevron Service Station #9-4612  
 3616 San Leandro Street  
 Oakland, California

WELL ID	DATE	Before Purging (mg/L)	After Purging (mg/L)
VH-1	05/10/00	0.90	--
	07/31/00	1.25	--
MW-2	05/10/00	0.57	--
	07/31/00	1.26	--
MW-3	05/10/00	1.56	--
	07/31/00	1.46	--
MW-4	05/10/00	Inaccessible	--
	07/31/00	0.64	--

*Sinks  
 well  
 replacing*

**EXPLANATIONS:**

mg/L = milligrams per liter  
 -- = Not Measured

## STANDARD OPERATING PROCEDURE - GROUNDWATER SAMPLING

Gettler-Ryan Inc. field personnel adhere to the following procedures for the collection and handling of groundwater samples prior to analysis by the analytical laboratory. Prior to sample collection, the type of analysis to be performed is determined. Loss prevention of volatile compounds is controlled and sample preservation for subsequent analysis is maintained.

Prior to sampling, the presence or absence of free-phase hydrocarbons is determined using an interface probe. Product thickness, if present, is measured to the nearest 0.01 foot and is noted in the field notes. In addition, static water level measurements are collected with the interface probe and are also recorded in the field notes.

After water levels are collected and prior to sampling, each well is purged a minimum of three well casing volumes of water using pre-cleaned pumps (stack, suction, Grundfos), or polyvinyl chloride bailers. Temperature, pH and electrical conductivity are measured a minimum of three times during the purging. Purging continues until these parameters stabilize.

Groundwater samples are collected using Chevron-designated disposable bailers. The water samples are transferred from the bailer into appropriate containers. Pre-preserved containers, supplied by analytical laboratories, are used when possible. When pre-preserved containers are not available, the laboratory is instructed to preserve the sample as appropriate. Duplicate samples are collected for the laboratory to use in maintaining quality assurance/quality control standards. The samples are labeled to include the job number, sample identification, collection date and time, analysis, preservation (if any), and the sample collector's initials. The water samples are placed in a cooler, maintained at 4°C for transport to the laboratory. Once collected in the field, all samples are maintained under chain of custody until delivered to the laboratory.

The chain of custody document includes the job number, type of preservation, if any, analysis requested, sample identification, date and time collected, and the sample collector's name. The chain of custody is signed and dated (including time of transfer) by each person who receives or surrenders the samples, beginning with the field personnel and ending with the laboratory personnel.

A laboratory supplied trip blank accompanies each sampling set. For sampling sets greater than 20 samples, 5% trip blanks are included. The trip blank is analyzed for some or all of the same compounds as the groundwater samples.

As requested by Chevron Products Company, the purge water and decontamination water generated during sampling activities is transported by IWM to McKittrick Waste Management located in McKittrick, California.

## WELL MONITORING/SAMPLING FIELD DATA SHEET

Client/ Facility # Chevron 9-4612 Job #: 386473  
 Address: 3616 San Leandro Blvd. Date: 7-31-00  
 City: Oakland, CA Sampler: FRANK T.

Well ID: VH-1 Well Condition: OK  
 Well Diameter: 2 1/4 in. Amount Bailed (Gallons)  
 Total Depth: 27.95 ft. Hydrocarbon Thickness: (feet) (product/water):  
 Depth to Water: 9.55 ft. Volume Factor (VF):  
 2" = 0.17      3" = 0.98      4" = 0.66  
 6" = 1.50      12" = 5.80

18.40 x VF .66 = 12.14 x 3 (case volume) = Estimated Purge Volume: 36.43 (gal.)

Purge Equipment: Disposable Bailer Bailer (Stack) Suction Grundfos Other: \_\_\_\_\_  
 Sampling Equipment: ( Disposable Bailer ) Bailer Pressure Bailer Grab Sample Other: \_\_\_\_\_

Starting Time: 2:28 Weather Conditions: SLUDDY  
 Sampling Time: 3:15 Water Color: CLEAR Odor: YES  
 Purging Flow Rate: 1.0 - 1.5 gpm. Sediment Description: \_\_\_\_\_  
 Did well de-water? NO If yes; Time: \_\_\_\_\_ Volume: \_\_\_\_\_ (gal.)

Time	Volume (gal.)	pH	Conductivity $\mu\text{mhos/cm} \times 100$	Temperature $^{\circ}\text{F}$	D.O. (mg/L)	ORP (mV)	Alkalinity (ppm)
<u>2:36</u>	<u>12.0</u>	<u>7.4</u>	<u>648</u>	<u>76.2</u>	<u>1.25</u>		
<u>2:44</u>	<u>24.0</u>	<u>7.1</u>	<u>648</u>	<u>75.3</u>			
<u>2:52</u>	<u>36.0</u>	<u>6.9</u>	<u>639</u>	<u>75.5</u>			

SAMPLE ID	(M) - CONTAINER	LABORATORY INFORMATION			LABORATORY	ANALYSES
		REFRIG.	PRESERV. TYPE			
<u>VH-1</u>	<u>4-VOAVIAL</u>	<u>Y</u>	<u>HCL</u>		<u>SEQUOIA</u>	<u>TPH(G)/tox/mths by 8260 &amp; 8020</u>

COMMENTS: ORC IN THE WELL. WELL LOCATED IN THE RESTROOM, IN THE BUILDING NEXT TO THE POWER SITE

## WELL MONITORING/SAMPLING FIELD DATA SHEET

Client/Facility # Chevron 9-4612 Job #: 386473  
 Address: 3616 San Leandro Blvd. Date: 7-31-00  
 City: Oakland, CA Sampler: Frank T.

Well ID: MW-2 Well Condition: OK  
 Well Diameter: 2 1/4 in. Amount Bailed (product/water): 0 (Gallons)  
 Total Depth: 19.58 ft. Hydrocarbon Thickness: 0 (feet)  
 Depth to Water: 10.33 ft.  
 Volume Factor (VF) table:  

2" = 0.17	3" = 0.38	4" = 0.66
6" = 1.50	12" = 5.80	

 Purge Volume: 9.25 x VF .17 = 1.57 x 3 (case volume) = Estimated Purge Volume: 4.71 (gal.)

Purge Equipment: (Disposable Bailer) Bailer, Stack, Suction, Grundfos, Other: \_\_\_\_\_  
 Sampling Equipment: (Disposable Bailer) Bailer, Pressure Bailer, Grab Sample, Other: \_\_\_\_\_

Starting Time: 1:31 Weather Conditions: SUNNY  
 Sampling Time: 1:51 Water Color: CLEAR Odor: YES  
 Purging Flow Rate: \_\_\_\_\_ gpm. Sediment Description: \_\_\_\_\_  
 Did well de-water? NO If yes; Time: \_\_\_\_\_ Volume: \_\_\_\_\_ (gal.)

Time	Volume (gal.)	pH	Conductivity $\mu\text{mhos/cm} \times 100$	Temperature $^{\circ}\text{F}$	D.O. (mg/L)	ORP (mV)	Alkalinity (ppm)
<u>1:35</u>	<u>1.5</u>	<u>6.9</u>	<u>686</u>	<u>73.2</u>	<u>1.26</u>	<u>ME</u>	
<u>1:39</u>	<u>3.0</u>	<u>6.7</u>	<u>673</u>	<u>72.2</u>			
<u>1:43</u>	<u>5.0</u>	<u>6.7</u>	<u>665</u>	<u>73.2</u>			

### LABORATORY INFORMATION

SAMPLE ID	(#) - CONTAINER	REFRIG.	PRESERV. TYPE	LABORATORY	ANALYSES
					TPH(GI)/btax/mtbe Du
<u>MW-2</u>	<u>4-VOAVIAL</u>	<u>Y</u>	<u>HCL</u>	<u>SEQUOIA</u>	<u>8020 &amp; 8260</u>

COMMENTS: ORC IN THE WELL.

## WELL MONITORING/SAMPLING FIELD DATA SHEET

Client/ Facility # Chevron 9-4612 Job #: 386473  
 Address: 3616 San Leandro Blvd. Date: 7-31-00  
 City: Oakland, CA Sampler: Frank T.

Well ID: MW-3 Well Condition: OK  
 Well Diameter: 2/4 in. Amount Bailed (Gallons): 0  
 Total Depth: 19:00 ft. Hydrocarbon Thickness: 0 (feet) (product/water):  
 Depth to Water: 10.07 ft. Volume Factor (VF):  
 2" = 0.17      3" = 0.38      4" = 0.66  
 6" = 1.50      12" = 5.80

0.93 x VF .17 = 0.156 x 3 (case volume) = Estimated Purge Volume: 4.55 (gal.)

Purge Equipment: ( Disposable Bailer )  
 Bailer  
 Stack  
 Suction  
 Grundfos  
 Other: \_\_\_\_\_  
 Sampling Equipment: ( Disposable Bailer )  
 Bailer  
 Pressure Bailer  
 Grab Sample  
 Other: \_\_\_\_\_

Starting Time: 12:51 Weather Conditions: SUNNY  
 Sampling Time: 1:10 Water Color: CLEAR Odor: YES  
 Purging Flow Rate: \_\_\_\_\_ gpm. Sediment Description: \_\_\_\_\_  
 Did well de-water? NO If yes; Time: \_\_\_\_\_ Volume: \_\_\_\_\_ (gal.)

Time	Volume (gal.)	pH	Conductivity (µmhos/cm) x 100	Temperature (°F)	D.O. (mg/L)	ORP (mV)	Alkalinity (ppm)
12:54	1.5	7.1	716	76.7	1.46		
12:57	3.0	6.9	673	72.0			
1:02	5.0	6.8	659	71.2			

SAMPLE ID	(#) - CONTAINER	LABORATORY INFORMATION		LABORATORY	ANALYSES
		REFRIG.	PRESERV. TYPE		
MW-3	5 - VOAVIAL	Y	HCL	SEQUOIA	TPH(GI)/BTEX/MTBE by <u>8020 + 8260/TPH</u>

COMMENTS: ORC IN THE WELL

**WELL MONITORING/SAMPLING  
FIELD DATA SHEET**

Client/ Facility# Chevron 9-4612 Job#: 386473  
 Address: 3616 San Leandro Blvd. Date: 7-31-00  
 City: Oakland, CA Sampler: FRANK T.

Well ID MW-4 Well Condition: o'k'  
 Well Diameter 2/4 in. Hydrocarbon Thickness: 0 (feet) Amount Bailed (Gallons) 0  
 Total Depth 18.76 ft. Volume 2" = 0.17 3" = 0.38 4" = 0.66  
 Depth to Water 9.37 ft. Factor (VF) 6" = 1.50 12" = 5.80  
9.39 x VF .17 = 1.59 x 3 (case volume) = Estimated Purge Volume: 4.78 (gal.)

Purge Equipment: (Disposable Bailer) Bailer Stack Suction Grundfos Other: \_\_\_\_\_  
 Sampling Equipment: (Disposable Bailer) Bailer Pressure Bailer Grab Sample Other: \_\_\_\_\_

Starting Time: 12:22 Weather Conditions: SUNNY  
 Sampling Time: 12:33 Water Color: CLOUDY Odor: NO  
 Purging Flow Rate: - gpm. Sediment Description: \_\_\_\_\_  
 Did well de-water? NO If yes; Time: \_\_\_\_\_ Volume: \_\_\_\_\_ (gal.)

Time	Volume (gal)	pH	Conductivity $\mu\text{mhos/cm}$	Temperature $^{\circ}\text{F}$	D.O. (mg/L)	ORP (mV)	Alkalinity (ppm)
12:26	1.5	7.2	484	81.4	0.64 ppe		
12:30	3.0	6.9	400	76.8			
12:35	5.0	7.0	421	75.1			

**LABORATORY INFORMATION**

SAMPLE ID	(#) - CONTAINER	REFRIG.	PRESERV. TYPE	LABORATORY	ANALYSES
					TPH(G)/diox/mtbe $\mu\text{g}$
MW- 4	4 - VOAVIAL	Y	HCL	SEQUOIA	8020 + 8260

COMMENTS: \_\_\_\_\_



Fax copy of Lab Report and COC to Chevron Contact:  Yes  No

# Chain-of-Custody-Record

**Chevron Products Co.**  
 P.O. BOX 6004  
 San Ramon, CA 94583  
 FAX (925)842-8370

Chevron Facility Number #9-4612  
 Facility Address 3616 SAN LEANDRO BLVD., OAKLAND, CA.  
 Consultant Project Number 386473  
 Consultant Name GETTLER-RYAN INC.  
 Address 6747 SIERRA COURT, SUITE J, DUBLIN, CA 94568  
 Project Contact (Name) DEANNA L. HARDING  
 (Phone) 925-551-7555 (Fax Number) 925-551-7899

Chevron Contact (Name) MR. TOM BAUHS  
 (Phone) (925) 842-8898  
 Laboratory Name SEQUOIA W008039  
 Laboratory Service Order \_\_\_\_\_  
 Laboratory Service Code \_\_\_\_\_  
 Samples Collected by (Name) Frank Termini  
 Signature [Signature]

State Method:  CA  OR  WA  NW Series  CO  UT IDAHO

Sample Number	Number of Containers	Matrix S = Soil W = Water C = Charcoal	Sample Preservation	Date/Time	State Method: <input checked="" type="checkbox"/> CA <input type="checkbox"/> OR <input type="checkbox"/> WA <input type="checkbox"/> NW Series <input type="checkbox"/> CO <input type="checkbox"/> UT IDAHO													Lab Sample No.	Remarks							
					ETEX/MTBE/TPH GAS (8020 + 8015)	ETEX + TPH GAS (8020 + 8015)	TPH Diesel (8015)	Oxyaromatics (8280)	Purgeable Hydrocarbons (8010)	Purgeable Organics (8280)	Extractable Organics (8270)	Oil and Grease (5520)	Metals (ICAP or AA) Cd, Cr, Pb, Zn, Ni	ETEX (8020)	ETEX/MTBE/Naph. (8020)	TPH - HCSO	TPH-D Extended			MTBE by 8020 & 8260						
TBLB	1	W	HCL	7-31-00	X					01A																
VH-1	4			15:15		X				02A-D																
MW-2	4			13:51		X				03 ↓																
MW-3	5			13:10		X	X			04A-E																
MW-4	4	↓	↓	12:33		X				05A-D																

Relinquished By (Signature) <u>[Signature]</u>	Organization G-R INC.	Date/Time <u>8-1-00</u>	Received By (Signature) <u>[Signature]</u>	Organization Seq	Date/Time <u>8-1-00</u>	Iced <input checked="" type="checkbox"/>
Relinquished By (Signature) <u>[Signature]</u>	Organization Seq	Date/Time <u>8-1-00</u>	Received By (Signature) <u>[Signature]</u>	Organization	Date/Time	Iced Y/N
Received For Laboratory By (Signature)				Date/Time	Iced Y/N	

Turn Around Time (Circle Choice)

24 Hrs.  
 48 Hrs.  
 5 Days  
 10 Days  
 As Contracted



# Sequoia Analytical

---

404 N. Wiget Lane  
Walnut Creek, CA 94598  
(925) 988-9600  
FAX (925) 988-9673  
[www.sequoialabs.com](http://www.sequoialabs.com)

15 August, 2000

Deanna L. Harding  
Gettler Ryan, Inc. - Dublin  
6747 Sierra Court Suite J  
Dublin, CA 94568

RE: Chevron  
Sequoia Report W008034

Enclosed are the results of analyses for samples received by the laboratory on 01-Aug-00 17:40. If you have any questions concerning this report, please feel free to contact me.

Sincerely,

Charlie Westwater  
Project Manager

CA ELAP Certificate #1271



Gettler Ryan, Inc. - Dublin  
6747 Sierra Court Suite J  
Dublin CA, 94568

Project: Chevron  
Project Number: Chevron # 9-4612  
Project Manager: Deanna L. Harding

Reported:  
15-Aug-00 09:28

## ANALYTICAL REPORT FOR SAMPLES

Sample ID	Laboratory ID	Matrix	Date Sampled	Date Received
TBLB	W008034-01	Water	31-Jul-00 00:00	01-Aug-00 17:40
VH-1	W008034-02	Water	31-Jul-00 15:15	01-Aug-00 17:40
MW-2	W008034-03	Water	31-Jul-00 13:51	01-Aug-00 17:40
MW-3	W008034-04	Water	31-Jul-00 13:10	01-Aug-00 17:40
MW-4	W008034-05	Water	31-Jul-00 12:33	01-Aug-00 17:40



Gettler Ryan, Inc. - Dublin  
6747 Sierra Court Suite J  
Dublin CA, 94568

Project: Chevron  
Project Number: Chevron # 9-4612  
Project Manager: Deanna L. Harding

Reported:  
15-Aug-00 09:28

**Total Purgeable Hydrocarbons (C6-C12), BTEX and MTBE by DHS LUFT**  
**Sequoia Analytical - Walnut Creek**

Analyte	Result	Reporting Limit	Units	Dilution	Batch	Prepared	Analyzed	Method	Notes
<b>TBLB (W008034-01) Water</b> Sampled: 31-Jul-00 00:00 Received: 01-Aug-00 17:40									
Purgeable Hydrocarbons	ND	50	ug/l	1	0H04001	04-Aug-00	04-Aug-00	EPA 8015M/8020	
Benzene	ND	0.50	"	"	"	"	"	"	
Toluene	ND	0.50	"	"	"	"	"	"	
Ethylbenzene	ND	0.50	"	"	"	"	"	"	
Xylenes (total)	ND	0.50	"	"	"	"	"	"	
Methyl tert-butyl ether	ND	2.5	"	"	"	"	"	"	
<i>Surrogate: a,a,a-Trifluorotoluene</i>		96.7 %		70-130	"	"	"	"	
<b>VH-1 (W008034-02) Water</b> Sampled: 31-Jul-00 15:15 Received: 01-Aug-00 17:40 <span style="float:right">P-02</span>									
Purgeable Hydrocarbons	360	50	ug/l	1	0H09001	09-Aug-00	09-Aug-00	EPA 8015M/8020	
Benzene	22	0.50	"	"	"	"	"	"	
Toluene	2.7	0.50	"	"	"	"	"	"	
Ethylbenzene	1.6	0.50	"	"	"	"	"	"	
Xylenes (total)	3.1	0.50	"	"	"	"	"	"	
Methyl tert-butyl ether	100	2.5	"	"	"	"	"	"	
<i>Surrogate: a,a,a-Trifluorotoluene</i>		299 %		70-130	"	"	"	"	S-04
<b>MW-2 (W008034-03) Water</b> Sampled: 31-Jul-00 13:51 Received: 01-Aug-00 17:40 <span style="float:right">P-02</span>									
Purgeable Hydrocarbons	3000	500	ug/l	10	0H04001	04-Aug-00	04-Aug-00	EPA 8015M/8020	
Benzene	75	5.0	"	"	"	"	"	"	
Toluene	14	5.0	"	"	"	"	"	"	
Ethylbenzene	28	5.0	"	"	"	"	"	"	
Xylenes (total)	28	5.0	"	"	"	"	"	"	
Methyl tert-butyl ether	200	25	"	"	"	"	"	"	
<i>Surrogate: a,a,a-Trifluorotoluene</i>		188 %		70-130	"	"	"	"	S-04



Gettler Ryan, Inc. - Dublin  
6747 Sierra Court Suite J  
Dublin CA, 94568

Project: Chevron  
Project Number: Chevron # 9-4612  
Project Manager: Deanna L. Harding

Reported:  
15-Aug-00 09:28

**Total Purgeable Hydrocarbons (C6-C12), BTEX and MTBE by DHS LUFT  
Sequoia Analytical - Walnut Creek**

Analyte	Result	Reporting Limit	Units	Dilution	Batch	Prepared	Analyzed	Method	Notes
MW-3 (W008034-04) Water Sampled: 31-Jul-00 13:10 Received: 01-Aug-00 17:40									P-01
Purgeable Hydrocarbons	2200	500	ug/l	10	0H04002	04-Aug-00	04-Aug-00	EPA 8015M/8020	
Benzene	76	5.0	"	"	"	"	"	"	
Toluene	10	5.0	"	"	"	"	"	"	
Ethylbenzene	ND	5.0	"	"	"	"	"	"	
Xylenes (total)	13	5.0	"	"	"	"	"	"	
Methyl tert-butyl ether	230	25	"	"	"	"	"	"	
Surrogate: a,a,a-Trifluorotoluene		109 %	70-130		"	"	"	"	
MW-4 (W008034-05) Water Sampled: 31-Jul-00 12:33 Received: 01-Aug-00 17:40									
Purgeable Hydrocarbons	ND	50	ug/l	1	0H04002	04-Aug-00	04-Aug-00	EPA 8015M/8020	
Benzene	ND	0.50	"	"	"	"	"	"	
Toluene	ND	0.50	"	"	"	"	"	"	
Ethylbenzene	ND	0.50	"	"	"	"	"	"	
Xylenes (total)	ND	0.50	"	"	"	"	"	"	
Methyl tert-butyl ether	ND	2.5	"	"	"	"	"	"	
Surrogate: a,a,a-Trifluorotoluene		99.3 %	70-130		"	"	"	"	





Gettler Ryan, Inc. - Dublin  
6747 Sierra Court Suite J  
Dublin CA, 94568

Project: Chevron  
Project Number: Chevron # 9-4612  
Project Manager: Deanna L. Harding

Reported:  
15-Aug-00 09:28

**Diesel Hydrocarbons (C9-C24) by DHS LUFT  
Sequoia Analytical - Walnut Creek**

Analyte	Result	Reporting Limit	Units	Dilution	Batch	Prepared	Analyzed	Method	Notes
MW-3 (W008034-04) Water Sampled: 31-Jul-00 13:10 Received: 01-Aug-00 17:40									
Diesel Range Hydrocarbons	490	50	ug/l	1	0H09011	09-Aug-00	13-Aug-00	EPA 8015M	D-11
Surrogate: n-Pentacosane		85.0 %	50-150		"	"	"	"	



Gettler Ryan, Inc. - Dublin  
6747 Sierra Court Suite J  
Dublin CA, 94568

Project: Chevron  
Project Number: Chevron # 9-4612  
Project Manager: Deanna L. Harding

Reported:  
15-Aug-00 09:28

**MTBE by EPA Method 8260A  
Sequoia Analytical - Walnut Creek**

Analyte	Result	Reporting Limit	Units	Dilution	Batch	Prepared	Analyzed	Method	Notes
<b>VH-1 (W008034-02) Water</b> Sampled: 31-Jul-00 15:15 Received: 01-Aug-00 17:40									
Methyl tert-butyl ether	88	2.0	ug/l	1	0H10010	10-Aug-00	10-Aug-00	EPA 8260B	
Surrogate: Dibromofluoromethane		100 %	50-150		"	"	"	"	
<b>MW-2 (W008034-03) Water</b> Sampled: 31-Jul-00 13:51 Received: 01-Aug-00 17:40									
Methyl tert-butyl ether	130	4.0	ug/l	2	0H10010	10-Aug-00	10-Aug-00	EPA 8260B	
Surrogate: Dibromofluoromethane		98.0 %	50-150		"	"	"	"	
<b>MW-3 (W008034-04) Water</b> Sampled: 31-Jul-00 13:10 Received: 01-Aug-00 17:40									
Methyl tert-butyl ether	52	4.0	ug/l	2	0H10010	10-Aug-00	10-Aug-00	EPA 8260B	
Surrogate: Dibromofluoromethane		98.0 %	50-150		"	"	"	"	
<b>MW-4 (W008034-05) Water</b> Sampled: 31-Jul-00 12:33 Received: 01-Aug-00 17:40									
Methyl tert-butyl ether	ND	2.0	ug/l	1	0H10010	10-Aug-00	10-Aug-00	EPA 8260B	
Surrogate: Dibromofluoromethane		102 %	50-150		"	"	"	"	



Gettler Ryan, Inc. - Dublin  
6747 Sierra Court Suite J  
Dublin CA, 94568

Project: Chevron  
Project Number: Chevron # 9-4612  
Project Manager: Deanna L. Harding

Reported:  
15-Aug-00 09:28

**Total Purgeable Hydrocarbons (C6-C12), BTEX and MTBE by DHS LUFT - Quality Control**  
**Sequoia Analytical - Walnut Creek**

Analyte	Result	Reporting Limit	Units	Spike Level	Source Result	%REC	%REC Limits	RPD	RPD Limit	Notes
<b>Batch 0H04001 - EPA 5030B [P/T]</b>										
<b>Blank (0H04001-BLK1)</b>										
Prepared & Analyzed: 04-Aug-00										
Purgeable Hydrocarbons	ND	50	ug/l							
Benzene	ND	0.50	"							
Toluene	ND	0.50	"							
Ethylbenzene	ND	0.50	"							
Xylenes (total)	ND	0.50	"							
Methyl tert-butyl ether	ND	2.5	"							
<i>Surrogate: a,a,a-Trifluorotoluene</i>	27.4		"	30.0		91.3	70-130			
<b>LCS (0H04001-BS1)</b>										
Prepared & Analyzed: 04-Aug-00										
Benzene	17.7	0.50	ug/l	20.0		88.5	70-130			
Toluene	19.4	0.50	"	20.0		97.0	70-130			
Ethylbenzene	19.6	0.50	"	20.0		98.0	70-130			
Xylenes (total)	64.3	0.50	"	60.0		107	70-130			
<i>Surrogate: a,a,a-Trifluorotoluene</i>	24.9		"	30.0		83.0	70-130			
<b>Matrix Spike (0H04001-MS1)</b>										
Source: W008009-03 Prepared & Analyzed: 04-Aug-00										
Benzene	17.2	0.50	ug/l	20.0	ND	86.0	70-130			
Toluene	19.3	0.50	"	20.0	ND	96.5	70-130			
Ethylbenzene	23.4	0.50	"	20.0	ND	117	70-130			
Xylenes (total)	63.9	0.50	"	60.0	ND	107	70-130			
<i>Surrogate: a,a,a-Trifluorotoluene</i>	24.4		"	30.0		81.3	70-130			
<b>Matrix Spike Dup (0H04001-MSD1)</b>										
Source: W008009-03 Prepared & Analyzed: 04-Aug-00										
Benzene	18.7	0.50	ug/l	20.0	ND	93.5	70-130	8.36	20	
Toluene	20.7	0.50	"	20.0	ND	104	70-130	7.00	20	
Ethylbenzene	20.1	0.50	"	20.0	ND	101	70-130	15.2	20	
Xylenes (total)	69.2	0.50	"	60.0	ND	115	70-130	7.96	20	
<i>Surrogate: a,a,a-Trifluorotoluene</i>	25.0		"	30.0		83.3	70-130			





Gettler Ryan, Inc. - Dublin  
6747 Sierra Court Suite J  
Dublin CA, 94568

Project: Chevron  
Project Number: Chevron # 9-4612  
Project Manager: Deanna L. Harding

Reported:  
15-Aug-00 09:28

## Total Purgeable Hydrocarbons (C6-C12), BTEX and MTBE by DHS LUFT - Quality Control Sequoia Analytical - Walnut Creek

Analyte	Result	Reporting Limit	Units	Spike Level	Source Result	%REC	%REC Limits	RPD	RPD Limit	Notes
<b>Batch 0H04002 - EPA 5030B [P/T]</b>										
<b>Blank (0H04002-BLK1)</b> Prepared & Analyzed: 04-Aug-00										
Purgeable Hydrocarbons	ND	50	ug/l							
Benzene	ND	0.50	"							
Toluene	ND	0.50	"							
Ethylbenzene	ND	0.50	"							
Xylenes (total)	ND	0.50	"							
Methyl tert-butyl ether	ND	2.5	"							
<i>Surrogate: a,a,a-Trifluorotoluene</i>	29.2		"	30.0		97.3	70-130			
<b>LCS (0H04002-BS1)</b> Prepared & Analyzed: 04-Aug-00										
Benzene	19.0	0.50	ug/l	20.0		95.0	70-130			
Toluene	19.6	0.50	"	20.0		98.0	70-130			
Ethylbenzene	20.4	0.50	"	20.0		102	70-130			
Xylenes (total)	61.0	0.50	"	60.0		102	70-130			
<i>Surrogate: a,a,a-Trifluorotoluene</i>	28.7		"	30.0		95.7	70-130			
<b>Matrix Spike (0H04002-MS1)</b> Source: W008010-02 Prepared & Analyzed: 04-Aug-00										
Benzene	19.5	0.50	ug/l	20.0	ND	97.5	70-130			
Toluene	19.9	0.50	"	20.0	ND	99.5	70-130			
Ethylbenzene	21.2	0.50	"	20.0	ND	106	70-130			
Xylenes (total)	64.0	0.50	"	60.0	ND	107	70-130			
<i>Surrogate: a,a,a-Trifluorotoluene</i>	27.2		"	30.0		90.7	70-130			
<b>Matrix Spike Dup (0H04002-MSD1)</b> Source: W008010-02 Prepared & Analyzed: 04-Aug-00										
Benzene	19.4	0.50	ug/l	20.0	ND	97.0	70-130	0.514	20	
Toluene	20.1	0.50	"	20.0	ND	101	70-130	1.00	20	
Ethylbenzene	21.5	0.50	"	20.0	ND	108	70-130	1.41	20	
Xylenes (total)	65.7	0.50	"	60.0	ND	109	70-130	2.62	20	
<i>Surrogate: a,a,a-Trifluorotoluene</i>	27.0		"	30.0		90.0	70-130			



Gettler Ryan, Inc. - Dublin  
6747 Sierra Court Suite J  
Dublin CA, 94568

Project: Chevron  
Project Number: Chevron # 9-4612  
Project Manager: Deanna L. Harding

Reported:  
15-Aug-00 09:28

**Total Purgeable Hydrocarbons (C6-C12), BTEX and MTBE by DHS LUFT - Quality Control  
Sequoia Analytical - Walnut Creek**

Analyte	Result	Reporting Limit	Units	Spike Level	Source Result	%REC	%REC Limits	RPD	RPD Limit	Notes
<b>Batch 0H09001 - EPA 5030B [P/T]</b>										
<b>Blank (0H09001-BLK1) Prepared &amp; Analyzed: 09-Aug-00</b>										
Purgeable Hydrocarbons	ND	50	ug/l							
Benzene	ND	0.50	"							
Toluene	ND	0.50	"							
Ethylbenzene	ND	0.50	"							
Xylenes (total)	ND	0.50	"							
Methyl tert-butyl ether	ND	2.5	"							
<i>Surrogate: a,a,a-Trifluorotoluene</i>	29.3		"	30.0		97.7	70-130			
<b>LCS (0H09001-BS1) Prepared &amp; Analyzed: 09-Aug-00</b>										
Benzene	19.0	0.50	ug/l	20.0		95.0	70-130			
Toluene	20.8	0.50	"	20.0		104	70-130			
Ethylbenzene	18.8	0.50	"	20.0		94.0	70-130			
Xylenes (total)	68.9	0.50	"	60.0		115	70-130			
<i>Surrogate: a,a,a-Trifluorotoluene</i>	25.7		"	30.0		85.7	70-130			
<b>Matrix Spike (0H09001-MS1) Source: W008104-15 Prepared &amp; Analyzed: 09-Aug-00</b>										
Benzene	17.0	0.50	ug/l	20.0	ND	85.0	70-130			
Toluene	18.9	0.50	"	20.0	ND	94.5	70-130			
Ethylbenzene	18.2	0.50	"	20.0	ND	91.0	70-130			
Xylenes (total)	62.3	0.50	"	60.0	ND	104	70-130			
<i>Surrogate: a,a,a-Trifluorotoluene</i>	25.6		"	30.0		85.3	70-130			
<b>Matrix Spike Dup (0H09001-MSD1) Source: W008104-15 Prepared &amp; Analyzed: 09-Aug-00</b>										
Benzene	17.2	0.50	ug/l	20.0	ND	86.0	70-130	1.17	20	
Toluene	19.4	0.50	"	20.0	ND	97.0	70-130	2.61	20	
Ethylbenzene	18.2	0.50	"	20.0	ND	91.0	70-130	0	20	
Xylenes (total)	63.4	0.50	"	60.0	ND	106	70-130	1.75	20	
<i>Surrogate: a,a,a-Trifluorotoluene</i>	24.9		"	30.0		83.0	70-130			



Gettler Ryan, Inc. - Dublin  
6747 Sierra Court Suite J  
Dublin CA, 94568

Project: Chevron  
Project Number: Chevron # 9-4612  
Project Manager: Deanna L. Harding

Reported:  
15-Aug-00 09:28

**Diesel Hydrocarbons (C9-C24) by DHS LUFT - Quality Control**  
**Sequoia Analytical - Walnut Creek**

Analyte	Result	Reporting Limit	Units	Spike Level	Source Result	%REC %REC	Limit	RPD	RPD Limit	Notes
<b>Batch 0H09011 - EPA 3510B</b>										
<b>Blank (0H09011-BLK1)</b>										
Prepared: 09-Aug-00 Analyzed: 14-Aug-00										
Diesel Range Hydrocarbons	ND	50	ug/l							
Surrogate: n-Pentacosane	23.0		"	33.3		69.1	50-150			
<b>LCS (0H09011-BS1)</b>										
Prepared: 09-Aug-00 Analyzed: 14-Aug-00										
Diesel Range Hydrocarbons	312	50	ug/l	500		62.4	60-140			
Surrogate: n-Pentacosane	28.3		"	33.3		85.0	50-150			
<b>LCS Dup (0H09011-BSD1)</b>										
Prepared: 09-Aug-00 Analyzed: 14-Aug-00										
Diesel Range Hydrocarbons	293	50	ug/l	500		58.6	60-140	6.28	50	Q-01
Surrogate: n-Pentacosane	26.7		"	33.3		80.2	50-150			



Gettler Ryan, Inc. - Dublin  
6747 Sierra Court Suite J  
Dublin CA, 94568

Project: Chevron  
Project Number: Chevron # 9-4612  
Project Manager: Deanna L. Harding

Reported:  
15-Aug-00 09:28

**MTBE by EPA Method 8260A - Quality Control  
Sequoia Analytical - Walnut Creek**

Analyte	Result	Reporting Limit	Units	Spike Level	Source Result	%REC	%REC Limits	RPD	RPD Limit	Notes
<b>Batch 0H10010 - EPA 5030B [P/T]</b>										
<b>Blank (0H10010-BLK1)</b> Prepared & Analyzed: 10-Aug-00										
Methyl tert-butyl ether	ND	2.0	ug/l							
Surrogate: Dibromofluoromethane	53.0		"	50.0		106	50-150			
<b>Blank (0H10010-BLK2)</b> Prepared & Analyzed: 11-Aug-00										
Methyl tert-butyl ether	ND	2.0	ug/l							
Surrogate: Dibromofluoromethane	52.0		"	50.0		104	50-150			
<b>LCS (0H10010-BS1)</b> Prepared & Analyzed: 10-Aug-00										
Methyl tert-butyl ether	44.2	2.0	ug/l	50.0		88.4	70-130			
Surrogate: Dibromofluoromethane	53.0		"	50.0		106	50-150			
<b>LCS (0H10010-BS2)</b> Prepared & Analyzed: 11-Aug-00										
Methyl tert-butyl ether	42.7	2.0	ug/l	50.0		85.4	70-130			
Surrogate: Dibromofluoromethane	52.0		"	50.0		104	50-150			
<b>Matrix Spike (0H10010-MS1)</b> Source: W008012-03 Prepared & Analyzed: 10-Aug-00										
Methyl tert-butyl ether	44.8	2.0	ug/l	50.0	ND	89.6	60-150			
Surrogate: Dibromofluoromethane	51.0		"	50.0		102	50-150			
<b>Matrix Spike Dup (0H10010-MSD1)</b> Source: W008012-03 Prepared & Analyzed: 10-Aug-00										
Methyl tert-butyl ether	51.5	2.0	ug/l	50.0	ND	103	60-150	13.9	25	
Surrogate: Dibromofluoromethane	52.0		"	50.0		104	50-150			



Gettler Ryan, Inc. - Dublin  
6747 Sierra Court Suite J  
Dublin CA, 94568

Project: Chevron  
Project Number: Chevron # 9-4612  
Project Manager: Deanna L. Harding

Reported:  
15-Aug-00 09:28

### Notes and Definitions

- D-11 Chromatogram Pattern: Unidentified Hydrocarbons < C16
- P-01 Chromatogram Pattern: Gasoline C6-C12
- P-02 Chromatogram Pattern: Gasoline C6-C12 + Unidentified Hydrocarbons <C6
- Q-01 The spike recovery for this QC sample is outside of established control limits. Review of associated batch QC indicates the recovery for this analyte does not represent an out-of-control condition for the batch.
- S-04 The surrogate recovery for this sample is outside of established control limits due to a sample matrix effect.
- DET Analyte DETECTED
- ND Analyte NOT DETECTED at or above the reporting limit
- NR Not Reported
- dry Sample results reported on a dry weight basis
- RPD Relative Percent Difference