

Acc. Ro 229  
JUN 23 2004  
Environmental Services

June 22, 2004

TRC Project No. 42013701

Don Hwang  
Alameda County Health Services  
1131 Harbor Bay Parkway  
Alameda, CA 94502-6577

**RE: Quarterly Status Report - Fourth Quarter 2003  
76 Service Station #5325, 3220 Lakeshore Avenue, Oakland, California  
Alameda County**

Dear Mr. Hwang:

On behalf of ConocoPhillips Company (ConocoPhillips), TRC is submitting the Fourth Quarter 2003 Quarterly Status Report for the subject site, shown on the attached Figure 3.

#### **PREVIOUS ASSESSMENTS**

The subject site is an operating 76 Service Station situated on the southeast corner of the intersection of Lakeshore Avenue and Lake Park Avenue in Oakland, California. Current site facilities consist of the service station building with three service bays, three product dispenser islands, and two 12,000-gallon double-wall fiberglass gasoline underground storage tanks (USTs).

October 1994: The waste oil UST was replaced along with the fuel product piping and dispenser islands. Holes were noted in the waste oil UST upon removal. Hydrocarbon odors and staining were noted in the soil beneath the waste oil UST. Overexcavation to remove the contaminated soil was limited to the area immediately surrounding the waste oil UST due to the proximity of structures. Confirmation soil samples indicated that low to moderate levels of petroleum hydrocarbons remained after the overexcavation. Soil sampling results from the product line/dispenser islands did not contain detectable concentrations of total petroleum hydrocarbons as gasoline (TPH-g), total petroleum hydrocarbons as diesel (TPH-d) or benzene.

October 2003: Site environmental consulting responsibilities were transferred to TRC.

#### **SENSITIVE RECEPTORS**

Lake Merritt is located approximately 0.3 miles down gradient. No domestic wells are located within 1 mile of the site.

#### **MONITORING AND SAMPLING**

Currently, four onsite and two offsite wells are monitored quarterly. All wells were sampled this quarter. The groundwater gradient and flow direction were 0.02 foot/foot to the north.

## **CHARACTERIZATION STATUS**

Total purgeable petroleum hydrocarbons (TPPH) were detected in one of the six wells, at a maximum concentration of 1,300 micrograms per liter ( $\mu\text{g/l}$ ) in offsite monitoring well U-6. However, the lower limit of detection was elevated to 10,000  $\mu\text{g/l}$  in two wells. These levels were consistent with recent historical data.

Benzene was not detected in any of the six wells. However, the lower limit of detection was above the maximum contaminant level (MCL) in three wells. These levels were consistent with recent historical data.

Methyl tertiary butyl ether (MTBE) was detected was detected in four of the six wells, at a maximum concentration of 11,000  $\mu\text{g/l}$  in onsite monitoring well U-1. These levels were consistent with recent historical data.

## **REMEDIATION STATUS**

October 1994: A total of 388.7 tons of impacted soil associated with the waste oil UST has been removed from the site. In addition, approximately 6,500 gallons of hydrocarbon impacted groundwater was pumped from the waste oil UST excavation to remediate hydrocarbon impacted soil and groundwater in the immediate area.

Remediation is not currently being conducted at the site.

## **RECENT CORRESPONDENCE**

No correspondence this quarter.

## **CURRENT QUARTER ACTIVITIES**

December 2, 2003: TRC performed groundwater monitoring and sampling. Wastewater generated from well purging and equipment cleaning was stored at TRC's groundwater monitoring facility in Concord, California, and transported by Onyx to the ConocoPhillips Refinery in Rodeo, California, for treatment and disposal.

## **NEXT QUARTER ACTIVITIES**

Await agency directives for additional assessment work, if any.

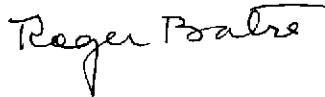
Continue quarterly monitoring and sampling to assess plume stability and concentration trends at key wells.

QSR – Fourth Quarter 2003  
76 Service Station #5325, Oakland, California  
June 22, 2004  
Page 3


If you have any questions regarding this report, please call Roger Batra at (925) 688-2466.

Sincerely,

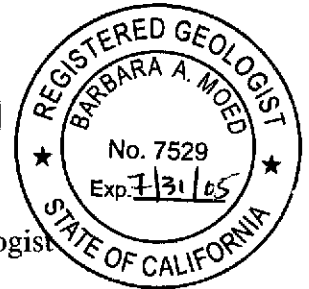
TRC



Roger Batra  
Senior Project Manager



Barbara Moed, R.G.  
Senior Project Geologist

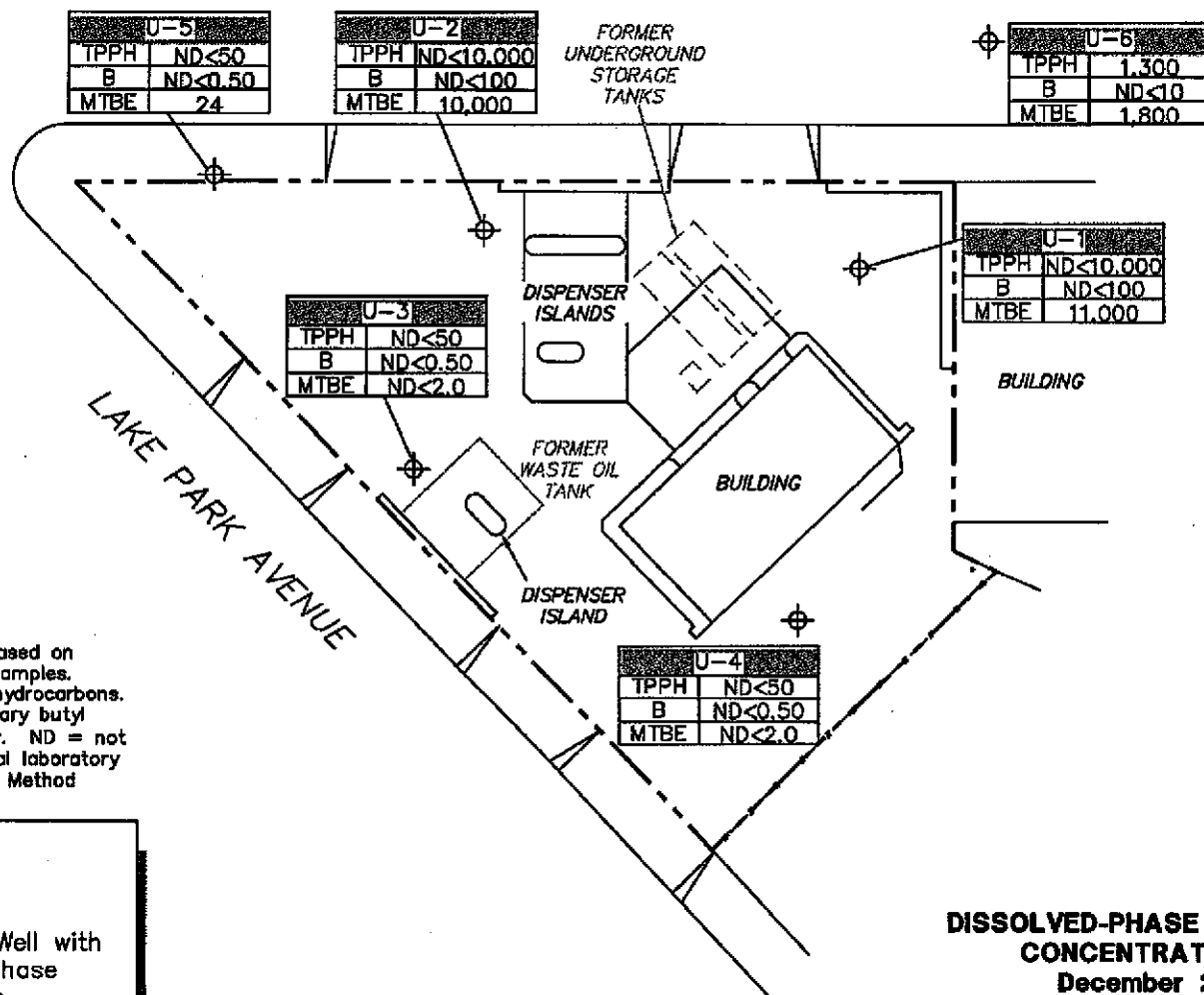


Attachment:

Figure 3 – Dissolved-Phase Hydrocarbon Concentrations Map, December 2, 2003, from Fourth Quarter 2003 Fluid Level Monitoring and Groundwater Sampling Report, dated January 9, 2004 by TRC.

cc: Thomas Kosel, ConocoPhillips (hard copy and electronic upload)

LAKESHORE AVENUE



**NOTES:**

Contour lines are interpretive and based on laboratory analysis of groundwater samples. TPHH = total purgeable petroleum hydrocarbons. B = benzene. MTBE = methyl tertiary butyl ether. µg/l = micrograms per liter. ND = not detected at limit indicated on official laboratory report. Results obtained using EPA Method 8260B.

**LEGEND**

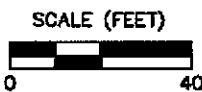
| Well No. |      |
|----------|------|
| TPPH     | µg/l |
| B        | µg/l |
| MTBE     | µg/l |

Monitoring Well with Dissolved-Phase Hydrocarbon Concentrations (µg/l)

**DISSOLVED-PHASE HYDROCARBON CONCENTRATIONS MAP**  
December 2, 2003

76 Station 5325  
3220 Lakeshore Avenue  
Oakland, California

**FIGURE 3**



**TRC**

PS=1:1



Customer-Focused Solutions

R0229

January 9, 2004

ConocoPhillips Company  
76 Broadway  
Sacramento, CA 95818

Alameda County  
JAN 8 0 11  
Environmental Health

ATTN: MR. THOMAS H. KOSEL  
  
SITE: 76 STATION 5325  
3220 LAKESHORE AVENUE  
OAKLAND, CALIFORNIA 94610  
  
RE: QUARTERLY MONITORING REPORT  
OCTOBER THROUGH DECEMBER 2003

Dear Mr. Kosel:

Please find enclosed our Quarterly Monitoring Report for 76 Station 5325, located at 3220 Lakeshore Avenue, Oakland, California. If you have any questions regarding this report, please call us at (949) 753-0101.

Sincerely,

TRC

Anju Farfan  
QMS Operations Manager

CC: Alameda County Health Care Services  
Barbara Moed, TRC

Enclosures  
20-0400/5325R01.QMS



Customer-Focused Solutions

**FOURTH QUARTER 2003  
FLUID LEVEL MONITORING AND  
GROUNDWATER SAMPLING REPORT**

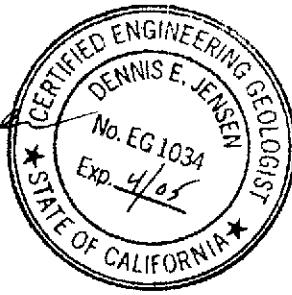

January 9, 2004

76 Station 5325  
3200 Lakeshore Avenue  
Oakland, California

Prepared For:

Mr. Thomas H. Kosel  
CONOCOPHILLIPS COMPANY  
76 Broadway  
Sacramento, California 95818

By:



Senior Project Geologist, Irvine Operations

## GROUNDWATER MONITORING REPORT

| LIST OF ATTACHMENTS                    |   |
|--|---|
| Summary Sheet                          | Summary of Gauging and Sampling Activities  |
| Tables                                 | Table Key<br>Table 1: Summary of Groundwater Levels and Chemical Analysis Results<br>Table 2: Historic Groundwater Levels and Chemical Analysis Results<br>Table 3: Summary of Additional Chemical Analysis Results |
| Gettler-Ryan Inc.<br>Historical Tables | Table 1: Groundwater Monitoring Data and Analytical Results<br>Table 2: Groundwater Analytical Results - Oxygenate Compounds<br>Table 3: Field Measurements and Groundwater Analytical Results                      |
| Figures                                | Figure 1: Vicinity Map<br>Figure 2: Groundwater Elevation Contour Map<br>Figure 3: Dissolved-Phase Hydrocarbon Concentration Map  |
| Graphs                                 | Benzene Concentrations vs. Time<br>Hydrographs  |
| Field Activities                       | General Field Procedures<br>Groundwater Sampling Field Notes  |
| Laboratory<br>Reports                  | Official Laboratory Reports<br>Quality Control Reports<br>Chain of Custody Records  |
| Disposal<br>Documents                  | Statement of Authorized Transportation and Disposal   |
| Statement                              | Limitations   |

**Summary of Gauging and Sampling Activities**  
**October 2003 through December 2003**  
**76 Station 5325**  
**3220 Lakeshore Avenue**  
**Oakland, CA**

**Site Information:**

---

|                                   |  |
|-----------------------------------|--|
| Site:                             | 76 Station<br>3220 Lakeshore Avenue<br>Oakland, CA |
| Project Coordinator/Phone Number: | Thomas H. Kosel/916-558-7666                       |
| Groundwater wells onsite:         | 5  |
| Groundwater wells offsite:        | 1  |

**Field Activity:**

---

|   |                     |
|---|---------------------|
| Sampling consultant:                                    | TRC                 |
| Date(s) sampled:  | 12/2/03             |
| Groundwater wells gauged:                               | 6                   |
| Groundwater wells sampled:                              | 6                   |
| Purging method:   | diaphragm pump      |
| Treatment/disposal method during sampling event:        | Onyx/Rodeo Unit 100 |
| Free product pumpouts other than sampling event:        | No                  |
| Treatment/Disposal method during free product pumpouts: | N/A                 |

**Site Hydrogeology:**

---

|   |                   |
|---|-------------------|
| Minimum depth to groundwater (feet bgs):                              | 7.12              |
| Maximum depth to groundwater (feet bgs):                              | 11                |
| Average groundwater elevation (feet relative to mean sea level):      | 0.07              |
| Average change in groundwater elevations since previous event (feet): | -0.46             |
| Groundwater gradient and flow direction:                              | 0.02 ft/ft, north |

**Groundwater Condition (Benzene Maximum Contaminant Level [MCL] = 1.0 µg/l)**

---

|  |            |
|--|------------|
| Wells with benzene concentrations below MCL:       | 6          |
| Wells with benzene concentrations at or above MCL: | 0          |
| Minimum benzene concentration (µg/l):              | ND         |
| Maximum benzene concentration (µg/l):              | ND         |
| Minimum MTBE concentration (µg/l):                 | ND         |
| Maximum MTBE concentration (µg/l):                 | 11000      |
| Minimum TPPH concentration (µg/l):                 | ND         |
| Maximum TPPH concentration (µg/l):                 | 1300 (U-6) |
| Groundwater wells with free product:               | 0          |
| Minimum free product thickness (feet):             | 0          |
| Maximum free product thickness (feet):             | 0          |

**Additional Information:**

---

This report presents the results of groundwater monitoring and sampling activities performed by TRC. Please contact the primary consultant for other specific information on this site.



## TABLE KEY

### ABBREVIATIONS / SYMBOLS

|         |   |  |
|---------|---|--|
| LPH     | = | liquid-phase hydrocarbons                              |
| µg/l    | = | micrograms per liter                                   |
| mg/l    | = | milligrams per liter                                   |
| ND      | = | not detected at or above laboratory detection limit    |
| DTSC    | = | Department of Toxic Substances Control                 |
| N/A     | = | not applicable   |
| Trace   | = | less than 0.01 foot of LPH in well                     |
| USTs    | = | underground storage tanks                              |
| --      | = | not analyzed, measured, or collected                   |
| TPH-G   | = | total petroleum hydrocarbons with gasoline distinction |
| BTEX    | = | benzene, toluene, ethylbenzene, and total xylenes      |
| TPH-D   | = | total petroleum hydrocarbons with diesel distinction   |
| TRPH    | = | total recoverable petroleum hydrocarbons               |
| MTBE    | = | methyl tertiary butyl ether                            |
| TAME    | = | tertiary amyl methyl ether                             |
| ETBE    | = | ethyl tertiary butyl ether                             |
| DIPE    | = | di-isopropyl ether                                     |
| TBA     | = | tertiary butyl alcohol                                 |
| 1,1-DCA | = | 1,1-Dichloroethane                                     |
| 1,2-DCA | = | 1,2-Dichloroethane                                     |
| 1,1-DCE | = | 1,1-Dichloroethene                                     |
| 1,2-DCE | = | cis- and trans-1,2-Dichloroethene                      |
| PCE     | = | tetrachloroethene                                      |
| TCA     | = | trichloroethane  |
| TCE     | = | trichloroethene  |
| PCB     | = | polychlorinated biphenyls                              |
| TPPH    | = | total purgeable petroleum hydrocarbons                 |

### NOTES

Elevations are in feet above mean sea level.

Groundwater elevation for wells with LPH is calculated as follows:

$$\text{Surface elevation} - \text{depth to water} + (0.75 \times \text{LPH thickness}).$$

Concentration Graphs have been modified to plot non-detect results at the reporting limit stated in the official laboratory report. All non-detect results prior to the Second Quarter 2000 were plotted at 0.1 µg/l for graphical display.

J = estimated concentration, value is between the Method Detection Limit (MDL) and the Practical Quantitation Limit (PQL)

### REFERENCE

TRC began groundwater monitoring and sampling activities in October 2003. Historical data for 76 Station 5325 was provided by Gettler-Ryan Inc., Dublin, California, in an excel table received in September 2003.

**Table 1**  
**SUMMARY OF GROUNDWATER LEVELS AND CHEMICAL ANALYSIS RESULTS**  
**December 2, 2003**  
**76 Station 5325**

| Date Sampled | TOC Elevation<br>(feet) | Depth to Water<br>(feet)                   | LPH Thickness<br>(feet) | Ground-water Elevation<br>(feet) | Change in Elevation<br>(feet) | TPH-G<br>(µg/l) | TPPH 8260B<br>(µg/l) | Benzene<br>(µg/l) | Toluene<br>(µg/l) | Ethyl-benzene<br>(µg/l) | Total Xylenes<br>(µg/l) | MTBE 8021B<br>(µg/l) | MTBE 8260B<br>(µg/l) | Comments |
|--------------|-------------------------|--|-------------------------|----------------------------------|-------------------------------|-----------------|----------------------|-------------------|-------------------|-------------------------|-------------------------|----------------------|----------------------|----------|
| <b>U-1</b>   |                         | <b>(Screen Interval in feet: 5.0-20.0)</b> |                         |                                  |                               |                 |                      |                   |                   |                         |                         |                      |                      |          |
| 12/2/03      | 8.46                    | 8.90                                       | 0.00                    | -0.44                            | --                            | --              | ND<10000             | ND<100            | ND<100            | ND<100                  | ND<200                  | --                   | 11000                |          |
| <b>U-2</b>   |                         | <b>(Screen Interval in feet: 5.0-20.0)</b> |                         |                                  |                               |                 |                      |                   |                   |                         |                         |                      |                      |          |
| 12/2/03      | 7.62                    | 7.95                                       | 0.00                    | -0.33                            | -0.46                         | --              | ND<10000             | ND<100            | ND<100            | ND<100                  | ND<200                  | --                   | 10000                |          |
| <b>U-3</b>   |                         | <b>(Screen Interval in feet: 5.0-20.0)</b> |                         |                                  |                               |                 |                      |                   |                   |                         |                         |                      |                      |          |
| 12/2/03      | 10.98                   | 11.00                                      | 0.00                    | -0.02                            | -0.12                         | --              | ND<50                | ND<0.50           | ND<0.50           | ND<0.50                 | ND<1.0                  | --                   | ND<2.0               |          |
| <b>U-4</b>   |                         | <b>(Screen Interval in feet: 5.0-20.0)</b> |                         |                                  |                               |                 |                      |                   |                   |                         |                         |                      |                      |          |
| 12/2/03      | 11.15                   | 9.16                                       | 0.00                    | 1.99                             | -0.90                         | --              | ND<50                | ND<0.50           | ND<0.50           | ND<0.50                 | ND<1.0                  | --                   | ND<2.0               |          |
| <b>U-5</b>   |                         | <b>(Screen Interval in feet: 5.0-20.0)</b> |                         |                                  |                               |                 |                      |                   |                   |                         |                         |                      |                      |          |
| 12/2/03      | 6.98                    | 7.12                                       | 0.00                    | -0.14                            | -0.26                         | --              | ND<50                | ND<0.50           | ND<0.50           | ND<0.50                 | ND<1.0                  | --                   | 24                   |          |
| <b>U-6</b>   |                         | <b>(Screen Interval in feet: 5.0-24.0)</b> |                         |                                  |                               |                 |                      |                   |                   |                         |                         |                      |                      |          |
| 12/2/03      | 7.14                    | 7.80                                       | 0.00                    | -0.66                            | -0.56                         | --              | 1300                 | ND<10             | ND<10             | ND<10                   | ND<20                   | --                   | 1800                 |          |

**Table 2**  
**HISTORIC GROUNDWATER LEVELS AND CHEMICAL ANALYSIS RESULTS**  
**September 2003 Through December 2003**

| Date Sampled                                   | TOC Elevation<br>(feet) | Depth to Water<br>(feet) | LPH Thickness<br>(feet) | Ground-water Elevation<br>(feet) | Change in Elevation<br>(feet) | TPH-G<br>(µg/l) | 76 Station 5325      |                   |                   |                         |                         |    | MTBE 8021B<br>(µg/l) | MTBE 8260B<br>(µg/l) | Comments |
|--|-------------------------|--------------------------|-------------------------|----------------------------------|-------------------------------|-----------------|----------------------|-------------------|-------------------|-------------------------|-------------------------|----|----------------------|----------------------|----------|
|  |                         |                          |                         |                                  |                               |                 | TPPH 8260B<br>(µg/l) | Benzene<br>(µg/l) | Toluene<br>(µg/l) | Ethyl-benzene<br>(µg/l) | Total Xylenes<br>(µg/l) |    |                      |                      |          |
| <b>U-1 (Screen Interval in feet: 5.0-20.0)</b> |                         |                          |                         |                                  |                               |                 |                      |                   |                   |                         |                         |    |                      |                      |          |
| 9/24/03  | 8.46                    | 8.18                     | 0.00                    | --                               | --                            | --              | ND<10000             | ND<100            | ND<100            | ND<100                  | ND<200                  | -- | 11000                |                      |          |
| 12/2/03  | 8.46                    | 8.90                     | 0.00                    | -0.44                            | --                            | --              | ND<10000             | ND<100            | ND<100            | ND<100                  | ND<200                  | -- | 11000                |                      |          |
| <b>U-2 (Screen Interval in feet: 5.0-20.0)</b> |                         |                          |                         |                                  |                               |                 |                      |                   |                   |                         |                         |    |                      |                      |          |
| 9/24/03  | 7.62                    | 7.49                     | 0.00                    | 0.13                             | --                            | --              | ND<10000             | ND<100            | ND<100            | ND<100                  | ND<200                  | -- | 10000                |                      |          |
| 12/2/03  | 7.62                    | 7.95                     | 0.00                    | -0.33                            | -0.46                         | --              | ND<10000             | ND<100            | ND<100            | ND<100                  | ND<200                  | -- | 10000                |                      |          |
| <b>U-3 (Screen Interval in feet: 5.0-20.0)</b> |                         |                          |                         |                                  |                               |                 |                      |                   |                   |                         |                         |    |                      |                      |          |
| 9/24/03  | 10.98                   | 10.88                    | 0.00                    | 0.10                             | --                            | --              | ND<50                | ND<0.50           | ND<0.50           | ND<0.50                 | ND<1.0                  | -- | ND<2.0               |                      |          |
| 12/2/03  | 10.98                   | 11.00                    | 0.00                    | -0.02                            | -0.12                         | --              | ND<50                | ND<0.50           | ND<0.50           | ND<0.50                 | ND<1.0                  | -- | ND<2.0               |                      |          |
| <b>U-4 (Screen Interval in feet: 5.0-20.0)</b> |                         |                          |                         |                                  |                               |                 |                      |                   |                   |                         |                         |    |                      |                      |          |
| 9/24/03  | 11.15                   | 8.26                     | 0.00                    | 2.89                             | --                            | --              | ND<50                | ND<0.50           | ND<0.50           | ND<0.50                 | ND<1.0                  | -- | ND<2.0               |                      |          |
| 12/2/03  | 11.15                   | 9.16                     | 0.00                    | 1.99                             | -0.90                         | --              | ND<50                | ND<0.50           | ND<0.50           | ND<0.50                 | ND<1.0                  | -- | ND<2.0               |                      |          |
| <b>U-5 (Screen Interval in feet: 5.0-20.0)</b> |                         |                          |                         |                                  |                               |                 |                      |                   |                   |                         |                         |    |                      |                      |          |
| 9/24/03  | 6.98                    | 6.86                     | 0.00                    | 0.12                             | --                            | --              | ND<50                | ND<0.50           | ND<0.50           | ND<0.50                 | ND<1.0                  | -- | ND<2.0               |                      |          |
| 12/2/03  | 6.98                    | 7.12                     | 0.00                    | -0.14                            | -0.26                         | --              | ND<50                | ND<0.50           | ND<0.50           | ND<0.50                 | ND<1.0                  | -- | 24                   |                      |          |
| <b>U-6 (Screen Interval in feet: 5.0-24.0)</b> |                         |                          |                         |                                  |                               |                 |                      |                   |                   |                         |                         |    |                      |                      |          |
| 9/24/03  | 7.14                    | 7.24                     | 0.00                    | -0.10                            | --                            | --              | ND<10000             | ND<100            | ND<100            | ND<100                  | ND<200                  | -- | 1500                 |                      |          |
| 12/2/03  | 7.14                    | 7.80                     | 0.00                    | -0.66                            | -0.56                         | --              | 1300                 | ND<10             | ND<10             | ND<10                   | ND<20                   | -- | 1800                 |                      |          |

**Table 3**  
**SUMMARY OF ADDITIONAL CHEMICAL ANALYSIS RESULTS**  
**76 Station 5325**

| Date Sampled | EDB<br>(µg/l) | NO3<br>(mg/l) | TAME<br>8260B<br>(µg/l) | TBA<br>8260B<br>(µg/l) | DIPE<br>8260B<br>(µg/l) | ETBE<br>8260B<br>(µg/l) | Fe+2<br>(mg/l) | ORP<br>(mV) | Phosphate<br>(mg/l) | Ethanol<br>8260B<br>(µg/l) | 1,2 DCE<br>(µg/l) |
|--------------|---------------|---------------|-------------------------|------------------------|-------------------------|-------------------------|----------------|-------------|---------------------|----------------------------|-------------------|
| <b>U-1</b>   |               |               |                         |                        |                         |                         |                |             |                     |                            |                   |
| 9/24/03      | ND<400        | 18            | ND<400                  | ND<20000               | ND<400                  | ND<400                  | 15             | -36         | ND<1.0              | ND<100000                  | ND<400            |
| 12/2/03      | --            | --            | --                      | --                     | --                      | --                      | 4.0            | --          | --                  | ND<100000                  | --                |
| <b>U-2</b>   |               |               |                         |                        |                         |                         |                |             |                     |                            |                   |
| 9/24/03      | ND<400        | ND<1.0        | ND<400                  | ND<20000               | ND<400                  | ND<400                  | 14             | -10         | ND<1.0              | ND<100000                  | ND<400            |
| 12/2/03      | --            | --            | --                      | --                     | --                      | --                      | 2.7            | --          | --                  | ND<100000                  | --                |
| <b>U-3</b>   |               |               |                         |                        |                         |                         |                |             |                     |                            |                   |
| 9/24/03      | --            | 18            | --                      | --                     | --                      | --                      | ND<0.20        | -50         | 1.4                 | ND<500                     | --                |
| 12/2/03      | --            | --            | --                      | --                     | --                      | --                      | ND<0.20        | --          | --                  | ND<500                     | --                |
| <b>U-4</b>   |               |               |                         |                        |                         |                         |                |             |                     |                            |                   |
| 9/24/03      | --            | 17            | --                      | --                     | --                      | --                      | ND<0.20        | -24         | 1.5                 | --                         | --                |
| 12/2/03      | --            | --            | --                      | --                     | --                      | --                      | ND<0.20        | --          | --                  | ND<500                     | --                |
| <b>U-5</b>   |               |               |                         |                        |                         |                         |                |             |                     |                            |                   |
| 9/24/03      | --            | 18            | --                      | --                     | --                      | --                      | ND<0.20        | -28         | 1.8                 | --                         | --                |
| 12/2/03      | --            | --            | --                      | --                     | --                      | --                      | 9.4            | --          | --                  | ND<500                     | --                |
| <b>U-6</b>   |               |               |                         |                        |                         |                         |                |             |                     |                            |                   |
| 9/24/03      | ND<400        | ND<1.0        | ND<400                  | ND<20000               | ND<400                  | ND<400                  | 1.4            | -12         | 4.6                 | ND<100000                  | ND<400            |
| 12/2/03      | --            | --            | --                      | --                     | --                      | --                      | 1.4            | --          | --                  | ND<10000                   | --                |

**Table 1**  
**Groundwater Monitoring Data and Analytical Results**  
Tosco (Unocal) Service Station #5325  
3220 Lakeshore Avenue  
Oakland, California

| WELL ID/<br>TOC* (ft.) | DATE                   | DTW<br>(ft.) | S.L.<br>(ft. bgs) | GWE<br>(ft.) | Product<br>Thickness<br>(ft.) | TPH-G<br>(ppb)                                  | B<br>(ppb)      | T<br>(ppb) | E<br>(ppb) | X<br>(ppb) | MTBE<br>(ppb)   |
|------------------------|------------------------|--------------|-------------------|--------------|-------------------------------|---|-----------------|------------|------------|------------|-----------------|
| U-1                    | 08/10/90               | --           | 5.0-20.0          | --           | --                            | 690   | 38              | 75         | 8.6        | 130        | --              |
|                        | 01/07/91               | --           |                   | --           | --                            | 250   | 22              | 16         | 4.2        | 17         | --              |
|                        | 04/01/91               | --           |                   | --           | --                            | 160   | 13              | 8.6        | 1.0        | 15         | --              |
|                        | 07/03/91               | --           |                   | --           | --                            | 140   | 21              | 4.3        | 0.36       | 17         | --              |
|                        | 10/09/91               | --           |                   | --           | --                            | ND  | ND              | ND         | ND         | ND         | --              |
|                        | 02/12/92               | --           |                   | --           | --                            | 250   | ND              | ND         | ND         | ND         | --              |
|                        | 05/05/92               | --           |                   | --           | --                            | 230   | 1.2             | ND         | ND         | ND         | --              |
|                        | 06/11/92               | --           |                   | --           | --                            | 1,000   | 80              | 1.4        | 6.7        | 41         | --              |
|                        | 08/20/92               | --           |                   | --           | --                            | 400 <sup>1</sup>                                | 1.0             | ND         | ND         | 0.6        | --              |
|                        | 02/22/93               | --           |                   | --           | --                            | 34,000  | 1,400           | 5,500      | 910        | 7,300      | --              |
|                        | 05/07/93               | --           |                   | --           | --                            | 8,700   | 600             | 240        | 650        | 3,300      | --              |
|                        | 08/08/93               | --           |                   | --           | --                            | 4,900 <sup>2</sup>                              | 79              | ND         | 832        | 270        | --              |
| 5.32                   | 11/16/93               | 8.61         |                   | -3.29        | 0.00                          | 690 <sup>3</sup>                                | ND              | ND         | ND         | ND         | --              |
|                        | 02/16/94               | 8.54         |                   | -3.22        | 0.00                          | 6,800 <sup>4</sup>                              | ND              | ND         | ND         | ND         | --              |
| 8.46                   | 06/22/94               | 8.39         |                   | 0.07         | 0.00                          | 200   | ND              | ND         | 5.9        | 21         | --              |
|                        | 09/22/94               | 8.66         |                   | -0.20        | 0.00                          | 6,100 <sup>3</sup>                              | ND              | ND         | ND         | ND         | --              |
|                        | 12/24/94               | 8.04         |                   | 0.42         | 0.00                          | 50,000  | 2,500           | 9,700      | 2,400      | 17,000     | --              |
|                        | 03/25/95               | 7.72         |                   | 1.02**       | 0.37                          | NOT SAMPLED DUE TO THE PRESENCE OF FREE PRODUCT |                 |            |            |            | --              |
|                        | 06/21/95               | 9.30         |                   | -0.69**      | 0.20                          | NOT SAMPLED DUE TO THE PRESENCE OF FREE PRODUCT |                 |            |            |            | --              |
|                        | 09/19/95               | 9.29         |                   | -0.53**      | 0.40                          | NOT SAMPLED DUE TO THE PRESENCE OF FREE PRODUCT |                 |            |            |            | --              |
|                        | 12/19/95               | 8.98         |                   | -0.50**      | 0.03                          | NOT SAMPLED DUE TO THE PRESENCE OF FREE PRODUCT |                 |            |            |            | --              |
|                        | 03/18/96               | 8.25         |                   | 0.21         | 0.00                          | 27,000  | ND              | 2,300      | 1,400      | 11,000     | 4,900           |
|                        | 06/27/96               | 7.92         |                   | 0.54         | <0.01                         | 120,000   | 540             | 4,300      | 2,600      | 26,000     | ND              |
|                        | 09/26/96               | 9.10         |                   | -0.62**      | 0.02                          | NOT SAMPLED DUE TO THE PRESENCE OF FREE PRODUCT |                 |            |            |            | --              |
|                        | 12/09/96               | 6.88         |                   | 1.60**       | 0.03                          | NOT SAMPLED DUE TO THE PRESENCE OF FREE PRODUCT |                 |            |            |            | --              |
|                        | 03/14/97               | 9.02         |                   | -0.15**      | 0.55                          | NOT SAMPLED DUE TO THE PRESENCE OF FREE PRODUCT |                 |            |            |            | --              |
|                        | 06/30/97               | 8.41         |                   | 0.07**       | 0.02                          | NOT SAMPLED DUE TO THE PRESENCE OF FREE PRODUCT |                 |            |            |            | --              |
|                        | 09/19/97               | 8.56         |                   | -0.08**      | 0.02                          | NOT SAMPLED DUE TO THE PRESENCE OF FREE PRODUCT |                 |            |            |            | --              |
|                        | 12/12/97               | 8.58         |                   | -0.11**      | 0.01                          | NOT SAMPLED DUE TO THE PRESENCE OF FREE PRODUCT |                 |            |            |            | --              |
|                        | 03/03/98 <sup>17</sup> | 8.23         |                   | 0.26**       | 0.04                          | NOT SAMPLED DUE TO THE PRESENCE OF FREE PRODUCT |                 |            |            |            | --              |
|                        | 06/15/98 <sup>17</sup> | 8.37         |                   | 0.09         | Sheen                         | 52,000  | ND <sup>7</sup> | 900        | 1,800      | 13,000     | ND <sup>7</sup> |
|                        | 09/30/98 <sup>17</sup> | 8.94         |                   | -0.48        | Sheen                         | 1,000,000 <sup>8</sup>                          | ND <sup>7</sup> | 2,600      | 13,000     | 83,000     | 4,800           |
|                        | 12/28/98 <sup>17</sup> | 8.57         |                   | -0.11        | <0.01                         | 1,100,000 <sup>9</sup>                          | ND <sup>7</sup> | 1,600      | 8,600      | 71,000     | 5,700           |

**Table 1**  
**Groundwater Monitoring Data and Analytical Results**  
 Tosco (Unocal) Service Station #5325  
 3220 Lakeshore Avenue  
 Oakland, California

| WELL ID/<br>TOC* (ft.) | DATE                         | DTW<br>(ft.) | S.I.<br>(ft. bgs) | GWE<br>(ft.) | Product<br>Thickness<br>(ft.) | TPH-G<br>(ppb)       | B<br>(ppb)      | T<br>(ppb)      | E<br>(ppb)    | X<br>(ppb)    | MTBE<br>(ppb)               |
|------------------------|------------------------------|--------------|-------------------|--------------|-------------------------------|----------------------|-----------------|-----------------|---------------|---------------|-----------------------------|
| U-1                    | 03/22/99 <sup>17</sup>       | 8.18         | 5.0-20.0          | 0.28         | Sheen                         | 130,000              | 470             | 1,100           | 2,000         | 28,000        | 5,700                       |
| (cont)                 | 06/09/99                     | 9.37         |                   | -0.91        | 0.00                          | 40,000               | 230             | 640             | 590           | 13,000        | 3,500/2,100 <sup>10</sup>   |
|                        | 09/08/99 <sup>17</sup>       | 9.53         |                   | -1.07        | 0.00                          | 55,000 <sup>11</sup> | 217             | 202             | 745           | 14,300        | 6,890/6,690 <sup>10</sup>   |
|                        | 12/07/99 <sup>17</sup>       | 9.67         |                   | -1.21        | 0.00                          | 41,200 <sup>13</sup> | 89.3            | ND <sup>7</sup> | 385           | 6,930         | 15,800/14,700 <sup>12</sup> |
|                        | 03/13/00 <sup>17</sup>       | 8.44         |                   | 0.02         | 0.00                          | 48,000 <sup>11</sup> | 490             | 610             | 2,400         | 10,000        | 22,000/23,000 <sup>10</sup> |
|                        | 06/21/00 <sup>17</sup>       | 9.45         |                   | -0.99        | 0.00                          | 37,000 <sup>11</sup> | 200             | ND <sup>7</sup> | 1,200         | 7,200         | 15,000/20,000 <sup>10</sup> |
|                        | 09/27/00 <sup>17</sup>       | 9.29         |                   | -0.83        | 0.00                          | 15,000 <sup>11</sup> | 92              | ND <sup>7</sup> | 540           | 2,800         | 74,000/83,000 <sup>15</sup> |
|                        | 12/12/00 <sup>17</sup>       | 9.37         |                   | -0.91        | 0.00                          | 50,000 <sup>16</sup> | ND <sup>7</sup> | ND <sup>7</sup> | 250           | 1,900         | 12,000/15,000 <sup>12</sup> |
|                        | 03/07/01 <sup>17</sup>       | 8.45         |                   | 0.01         | 0.00                          | 6,220 <sup>13</sup>  | 29.8            | 10.4            | 96.3          | 638           | 11,200/11,800 <sup>10</sup> |
|                        | 06/06/01 <sup>17</sup>       | 9.29         |                   | -0.83        | 0.00                          | 5,200 <sup>13</sup>  | 17              | ND <sup>7</sup> | 69            | 420           | 6,500/8,700 <sup>12</sup>   |
|                        | 09/24/01 <sup>17</sup>       | 9.39         |                   | -0.93        | 0.00                          | 4,300 <sup>18</sup>  | 36              | <25             | 65            | 590           | 4,400/4,400 <sup>10</sup>   |
|                        | 12/10/01 <sup>20</sup>       | 9.17         |                   | -0.71        | 0.00                          | 11,000 <sup>18</sup> | 220             | <100            | 380           | 1,500         | 5,100/5,100 <sup>10</sup>   |
|                        | 03/11/02 <sup>20</sup>       | 9.44         |                   | -0.98        | 0.00                          | 5,500 <sup>13</sup>  | 28              | <20             | 360           | 690           | 6,400/6,300 <sup>10</sup>   |
|                        | 06/04/02 <sup>20</sup>       | 8.32         |                   | 0.14         | 0.00                          | 4,600 <sup>18</sup>  | 31              | <10             | 240           | 180           | 6,500                       |
|                        | 09/03/02 <sup>20</sup>       | 9.36         |                   | -0.90        | 0.00                          | 2,300 <sup>21</sup>  | <12             | <12             | <12           | 68            | 3,500/4,700 <sup>10</sup>   |
|                        | 12/03/02 <sup>20,22</sup>    | 8.18         |                   | 0.28         | 0.00                          | <5,000               | <50             | <50             | <50           | <100          | 4,700                       |
|                        | 03/04/03 <sup>22</sup>       | 8.29         |                   | 0.17         | 0.00                          | 8,900                | 26              | <25             | 400           | 130           | 5,500                       |
|                        | <b>06/18/03<sup>22</sup></b> | <b>7.58</b>  |                   | <b>0.88</b>  | <b>0.00</b>                   | <b>8,300</b>         | <b>&lt;25</b>   | <b>&lt;25</b>   | <b>&lt;25</b> | <b>&lt;50</b> | <b>10,000</b>               |
| U-2                    | 08/10/90                     | --           | 5.0-20.0          | --           | --                            | 780                  | 27              | 46              | 15            | 130           | --                          |
|                        | 01/07/91                     | --           |                   | --           | --                            | 1,900                | 67              | 5.8             | 58            | 69            | --                          |
|                        | 04/01/91                     | --           |                   | --           | --                            | 1,700                | 250             | 89              | 34            | 190           | --                          |
|                        | 07/03/91                     | --           |                   | --           | --                            | 2,100                | 150             | 25              | 3.1           | 290           | --                          |
|                        | 10/09/91                     | --           |                   | --           | --                            | 230                  | 7.1             | ND              | ND            | 11            | --                          |
|                        | 02/12/92                     | --           |                   | --           | --                            | 410                  | 1.9             | ND              | 0.36          | 0.4           | --                          |
|                        | 05/05/92                     | --           |                   | --           | --                            | 1,600                | 120             | 52              | 6.2           | 290           | --                          |
|                        | 06/11/92                     | --           |                   | --           | --                            | 620                  | 17              | 2.1             | ND            | 37            | --                          |
|                        | 08/20/92                     | --           |                   | --           | --                            | 700                  | 28              | 6.5             | 1.3           | 4.6           | --                          |
|                        | 02/22/93                     | --           |                   | --           | --                            | 3,400                | 2,400           | 2,100           | 1,200         | 5,800         | --                          |

**Table 1**  
**Groundwater Monitoring Data and Analytical Results**  
 Tosco (Unocal) Service Station #5325  
 3220 Lakeshore Avenue  
 Oakland, California

| WELL ID/<br>TOC* (ft.) | DATE     | DTW<br>(ft.) | S.I.<br>(ft. bgs) | GWE<br>(ft.) | Product            |   |            |                 |                 |            |                             |
|------------------------|----------|--------------|-------------------|--------------|--------------------|---|------------|-----------------|-----------------|------------|-----------------------------|
|                        |          |              |                   |              | Thickness<br>(ft.) | TPH-G<br>(ppb)                                  | B<br>(ppb) | T<br>(ppb)      | E<br>(ppb)      | X<br>(ppb) | MTBE<br>(ppb)               |
| U-2                    | 05/07/93 | --           | 5.0-20.0          | --           | --                 | 17,000  | 1,800      | 660             | 1,700           | 4,000      | --                          |
| (cont)                 | 08/08/93 | --           |                   | --           | --                 | 5,600 <sup>2</sup>                              | 420        | ND              | 410             | 670        | --                          |
| 4.53                   | 11/16/93 | 8.17         |                   | -3.64        | 0.00               | 510 <sup>3</sup>                                | ND         | ND              | ND              | ND         | --                          |
|                        | 02/16/94 | 7.73         |                   | -3.20        | 0.00               | 980 <sup>4</sup>                                | 49         | 13              | 2.7             | 40         | --                          |
| 7.62                   | 06/22/94 | 7.60         |                   | 0.02         | 0.00               | 31,000  | 2,200      | 62              | 1,500           | 3,500      | --                          |
|                        | 09/22/94 | 7.93         |                   | -0.31        | 0.00               | 8,500 <sup>3</sup>                              | 29         | ND              | ND              | ND         | --                          |
|                        | 12/24/94 | 7.27         |                   | 0.35         | 0.00               | 32,000  | 1,500      | 890             | 1,300           | 5,000      | --                          |
|                        | 03/25/95 | 7.01         |                   | 0.61         | 0.00               | 170,000   | 1,900      | 21,000          | 4,800           | 33,000     | --                          |
|                        | 06/21/95 | 6.98         |                   | 0.64         | 0.00               | 16,000  | 2,100      | ND              | 1,800           | 1,700      | --                          |
|                        | 09/19/95 | 7.70         |                   | -0.08        | 0.00               | 3,000   | 610        | ND              | 78              | 240        | -- <sup>5</sup>             |
|                        | 12/19/95 | 7.30         |                   | 0.32         | 0.00               | 1,600   | 140        | 55              | 52              | 270        | -- <sup>6</sup>             |
|                        | 03/18/96 | 6.45         |                   | 1.17         | 0.00               | 12,000  | 2,200      | ND              | 1,200           | 2,200      | 22,000                      |
|                        | 06/27/96 | 7.41         |                   | 0.21         | 0.00               | 28,000  | 3,400      | ND              | 2,800           | 3,100      | 3,000                       |
|                        | 09/26/96 | 7.90         |                   | -0.28        | 0.00               | 5,900   | 750        | ND              | ND              | ND         | 18,000                      |
|                        | 12/09/96 | 6.76         |                   | 0.86         | 0.00               | 13,000  | 5,100      | 290             | 980             | 370        | 2,700                       |
|                        | 03/14/97 | 7.12         |                   | 0.52**       | 0.03               | NOT SAMPLED DUE TO THE PRESENCE OF FREE PRODUCT |            |                 |                 |            | --                          |
|                        | 06/30/97 | 6.19         |                   | 1.43         | <0.01              | NOT SAMPLED DUE TO THE PRESENCE OF FREE PRODUCT |            |                 |                 |            | --                          |
|                        | 09/19/97 | 7.31         |                   | 0.31         | <0.01              | NOT SAMPLED DUE TO THE PRESENCE OF FREE PRODUCT |            |                 |                 |            | --                          |
|                        | 12/12/97 | 6.75         |                   | 0.88**       | <0.01              | NOT SAMPLED DUE TO THE PRESENCE OF FREE PRODUCT |            |                 |                 |            | --                          |
|                        | 03/03/98 | 6.36         |                   | 1.26         | Sheen              | 80,000  | 3,000      | 1,100           | 820             | 16,000     | 16,000                      |
|                        | 06/15/98 | 6.51         |                   | 1.11         | Sheen              | 48,000  | 1,800      | 330             | 470             | 7,900      | 20,000                      |
|                        | 09/30/98 | 7.17         |                   | 0.45         | Sheen              | 60,000  | 1,300      | ND <sup>7</sup> | 500             | 9,700      | 19,000                      |
|                        | 12/28/98 | 7.06         |                   | 0.56         | 0.00               | 63,000  | 590        | 160             | 320             | 5,600      | 16,000                      |
|                        | 03/22/99 | 6.82         |                   | 0.80         | 0.00               | 28,000  | 1,100      | ND <sup>7</sup> | 360             | 2,900      | 25,000                      |
|                        | 06/09/99 | 7.51         |                   | 0.11         | 0.00               | 21,000  | 110        | 190             | 310             | 2,600      | 7,900/7,800 <sup>10</sup>   |
|                        | 09/08/99 | 8.16         |                   | -0.54        | 0.00               | 23,300 <sup>11</sup>                            | 477        | 138             | 286             | 4,110      | 16,400/15,300 <sup>10</sup> |
|                        | 12/07/99 | 8.31         |                   | -0.69        | 0.00               | 4,840 <sup>13</sup>                             | 17.2       | ND <sup>7</sup> | ND <sup>7</sup> | 157        | 14,900/15,600 <sup>12</sup> |
|                        | 03/13/00 | 6.69         |                   | 0.93         | 0.00               | 11,000 <sup>11</sup>                            | 380        | 160             | ND <sup>7</sup> | 2,100      | 22,000/26,000 <sup>10</sup> |
|                        | 06/21/00 | 7.67         |                   | -0.05        | 0.00               | 9,100 <sup>11</sup>                             | 22         | ND <sup>7</sup> | ND <sup>7</sup> | 800        | 16,000/22,000 <sup>10</sup> |
|                        | 09/27/00 | 7.44         |                   | 0.18         | 0.00               | 2,900 <sup>11</sup>                             | 43         | ND <sup>7</sup> | ND <sup>7</sup> | 39         | 20,000/26,000 <sup>15</sup> |
|                        | 12/12/00 | 7.51         |                   | 0.11         | 0.00               | 3,600 <sup>11</sup>                             | 17         | ND <sup>7</sup> | ND <sup>7</sup> | 87         | 8,000/7,800 <sup>12</sup>   |
|                        | 03/07/01 | 7.15         |                   | 0.47         | 0.00               | 1,670 <sup>13</sup>                             | 51.0       | ND <sup>7</sup> | 7.20            | 19.5       | 5,930/7,900 <sup>10</sup>   |
|                        | 06/06/01 | 7.57         |                   | 0.05         | 0.00               | 1,100 <sup>11</sup>                             | 14         | ND <sup>7</sup> | 9.3             | 35         | 9,200/10,000 <sup>12</sup>  |

**Table 1**  
**Groundwater Monitoring Data and Analytical Results**  
 Tosco (Unocal) Service Station #5325  
 3220 Lakeshore Avenue  
 Oakland, California

| WELL ID/<br>TOC* (ft.) | DATE                   | DTW<br>(ft.) | S.I.<br>(ft. bgs) | GWE<br>(ft.) | Product<br>Thickness<br>(ft.) | TPH-G<br>(ppb)       | B<br>(ppb) | T<br>(ppb) | E<br>(ppb) | X<br>(ppb) | MTBE<br>(ppb)               |
|------------------------|------------------------|--------------|-------------------|--------------|-------------------------------|----------------------|------------|------------|------------|------------|-----------------------------|
| U-2                    | 09/24/01               | 7.63         | 5.0-20.0          | -0.01        | 0.00                          | 1,000 <sup>18</sup>  | 25         | <2.5       | 12         | 100        | 9,800/11,000 <sup>10</sup>  |
| (cont)                 | 12/10/01               | 6.78         |                   | 0.84         | 0.00                          | 83                   | 14         | 0.55       | 3.4        | 6.8        | 2,500/2,500 <sup>10</sup>   |
|                        | 03/11/02               | 7.12         |                   | 0.50         | 0.00                          | <1,000               | 28         | <10        | 40         | 31         | 11,000/11,000 <sup>10</sup> |
|                        | 06/04/02               | 7.18         |                   | 0.44         | 0.00                          | 7,700 <sup>18</sup>  | 32         | <25        | 33         | 48         | 14,000                      |
|                        | 09/03/02               | 7.58         |                   | 0.04         | 0.00                          | 5,200 <sup>21</sup>  | <25        | <25        | <25        | <25        | 11,000/15,000 <sup>10</sup> |
|                        | 12/03/02 <sup>22</sup> | 7.68         |                   | -0.06        | 0.00                          | <5,000               | <50        | <50        | <50        | <100       | 3,200                       |
|                        | 03/04/03 <sup>22</sup> | 7.77         |                   | -0.15        | 0.00                          | 8,100 <sup>21</sup>  | <50        | <50        | <50        | <100       | 7,800                       |
|                        | 06/18/03 <sup>22</sup> | 6.87         |                   | 0.75         | 0.00                          | 11,000 <sup>21</sup> | <50        | <50        | <50        | <100       | 16,000                      |
| U-3                    | 08/10/90               | --           | 5.0-20.0          | --           | --                            | ND                   | ND         | ND         | ND         | ND         | --                          |
|                        | 01/07/91               | --           |                   | --           | --                            | ND                   | ND         | ND         | ND         | 1.8        | --                          |
|                        | 04/01/91               | --           |                   | --           | --                            | ND                   | 1.0        | 2.9        | 0.53       | 5.4        | --                          |
|                        | 07/03/91               | --           |                   | --           | --                            | ND                   | ND         | ND         | ND         | ND         | --                          |
|                        | 10/09/91               | --           |                   | --           | --                            | ND                   | ND         | ND         | ND         | ND         | --                          |
|                        | 02/12/92               | --           |                   | --           | --                            | ND                   | ND         | ND         | ND         | ND         | --                          |
|                        | 05/05/92               | --           |                   | --           | --                            | ND                   | ND         | ND         | ND         | ND         | --                          |
|                        | 06/11/92               | --           |                   | --           | --                            | ND                   | ND         | ND         | ND         | ND         | --                          |
|                        | 08/20/92               | --           |                   | --           | --                            | ND                   | ND         | ND         | ND         | ND         | --                          |
|                        | 02/22/93               | --           |                   | --           | --                            | ND                   | ND         | ND         | ND         | ND         | --                          |
|                        | 05/07/93               | --           |                   | --           | --                            | ND                   | ND         | ND         | ND         | ND         | --                          |
|                        | 08/08/93               | --           |                   | --           | --                            | 210                  | 5.0        | 9.7        | 0.7        | 4.1        | --                          |
| 7.86                   | 11/16/93               | 11.82        |                   | -3.96        | 0.00                          | ND                   | ND         | ND         | ND         | ND         | --                          |
|                        | 02/16/94               | 11.62        |                   | -3.76        | 0.00                          | ND                   | ND         | ND         | ND         | ND         | --                          |
| 10.98                  | 06/22/94               | 11.64        |                   | -0.66        | 0.00                          | ND                   | ND         | ND         | ND         | ND         | --                          |
|                        | 09/22/94               | 11.76        |                   | -0.78        | 0.00                          | ND                   | ND         | ND         | ND         | ND         | --                          |
|                        | 12/24/94               | 11.28        |                   | -0.30        | 0.00                          | ND                   | ND         | ND         | ND         | ND         | --                          |
|                        | 03/25/95               | 10.96        |                   | 0.02         | 0.00                          | ND                   | ND         | ND         | ND         | ND         | --                          |
|                        | 06/21/95               | 11.37        |                   | -0.39        | 0.00                          | ND                   | ND         | ND         | ND         | ND         | --                          |
|                        | 09/19/95               | 11.55        |                   | -0.57        | 0.00                          | ND                   | ND         | ND         | ND         | ND         | -- <sup>5</sup>             |
|                        | 12/19/95               | 11.45        |                   | -0.47        | 0.00                          | ND                   | ND         | ND         | ND         | ND         | --                          |
|                        | 03/18/96               | 11.10        |                   | -0.12        | 0.00                          | ND                   | ND         | ND         | ND         | ND         | --                          |
|                        | 06/27/96               | 11.16        |                   | -0.18        | 0.00                          | 440                  | 49         | 50         | 51         | 140        | 50                          |



**Table 1**  
**Groundwater Monitoring Data and Analytical Results**  
 Tosco (Unocal) Service Station #5325  
 3220 Lakeshore Avenue  
 Oakland, California

| WELL ID/<br>TOC* (ft.) | DATE                   | DTW<br>(ft.) | S.I.<br>(ft. bgs) | GWE<br>(ft.) | Product            |                |            |            |            |            |               |      |
|------------------------|------------------------|--------------|-------------------|--------------|--------------------|----------------|------------|------------|------------|------------|---------------|------|
|                        |                        |              |                   |              | Thickness<br>(ft.) | TPH-G<br>(ppb) | B<br>(ppb) | T<br>(ppb) | E<br>(ppb) | X<br>(ppb) | MTBE<br>(ppb) |      |
| U-3                    | 09/26/96               | 11.55        | 5.0-20.0          | -0.57        | 0.00               | ND             | ND         | ND         | ND         | ND         | ND            | ND   |
| (cont)                 | 12/09/96               | 10.12        |                   | 0.86         | 0.00               | ND             | ND         | ND         | ND         | ND         | ND            | 29   |
|                        | 03/14/97               | 10.87        |                   | 0.11         | 0.00               | ND             | ND         | ND         | ND         | ND         | ND            | ND   |
|                        | 06/30/97               | 11.08        |                   | -0.10        | 0.00               | ND             | ND         | ND         | ND         | ND         | ND            | ND   |
|                        | 09/19/97               | 11.05        |                   | -0.07        | 0.00               | ND             | ND         | ND         | ND         | ND         | ND            | ND   |
|                        | 12/12/97               | 10.58        |                   | 0.40         | 0.00               | ND             | ND         | ND         | ND         | ND         | ND            | ND   |
|                        | 03/03/98               | 9.84         |                   | 1.14         | 0.00               | ND             | ND         | ND         | ND         | ND         | ND            | ND   |
|                        | 06/15/98               | 10.56        |                   | 0.42         | 0.00               | ND             | ND         | ND         | ND         | ND         | ND            | ND   |
|                        | 09/30/98               | 11.12        |                   | -0.14        | 0.00               | ND             | ND         | ND         | ND         | ND         | ND            | ND   |
|                        | 12/28/98               | 10.96        |                   | 0.02         | 0.00               | ND             | ND         | ND         | ND         | ND         | ND            | ND   |
|                        | 03/22/99               | 9.46         |                   | 1.52         | 0.00               | ND             | ND         | ND         | ND         | ND         | ND            | ND   |
|                        | 06/09/99               | 11.01        |                   | -0.03        | 0.00               | ND             | ND         | ND         | ND         | ND         | ND            | ND   |
|                        | 09/08/99               | 11.31        |                   | -0.33        | 0.00               | ND             | ND         | ND         | ND         | ND         | ND            | ND   |
|                        | 12/07/99               | 11.26        |                   | -0.28        | 0.00               | ND             | ND         | ND         | ND         | ND         | ND            | ND   |
|                        | 03/13/00               | 8.28         |                   | 2.70         | 0.00               | ND             | ND         | ND         | ND         | ND         | ND            | ND   |
|                        | 06/21/00               | 11.12        |                   | -0.14        | 0.00               | ND             | ND         | ND         | ND         | ND         | ND            | ND   |
|                        | 09/27/00               | 11.07        |                   | -0.09        | 0.00               | ND             | ND         | ND         | ND         | ND         | ND            | ND   |
|                        | 12/12/00               | 10.94        |                   | 0.04         | 0.00               | ND             | ND         | ND         | ND         | ND         | ND            | ND   |
|                        | 03/07/01               | 8.32         |                   | 2.66         | 0.00               | ND             | ND         | ND         | ND         | ND         | ND            | ND   |
|                        | 06/06/01               | 10.94        |                   | 0.04         | 0.00               | ND             | ND         | ND         | ND         | ND         | ND            | ND   |
|                        | 09/24/01               | 11.03        |                   | -0.05        | 0.00               | <50            | <0.50      | <0.50      | <0.50      | <0.50      | <0.50         | <2.5 |
|                        | 12/10/01               | 8.16         |                   | 2.82         | 0.00               | <50            | <0.50      | <0.50      | <0.50      | <0.50      | <0.50         | <2.5 |
|                        | 03/11/02               | 7.82         |                   | 3.16         | 0.00               | <50            | <0.50      | <0.50      | <0.50      | <0.50      | <0.50         | <5.0 |
|                        | 06/04/02               | 10.58        |                   | 0.40         | 0.00               | <50            | <0.50      | <0.50      | <0.50      | <0.50      | <0.50         | <2.5 |
|                        | 09/03/02               | 10.94        |                   | 0.04         | 0.00               | <50            | <0.50      | <0.50      | <0.50      | <0.50      | <0.50         | <2.5 |
|                        | 12/03/02 <sup>22</sup> | 10.66        |                   | 0.32         | 0.00               | <50            | <0.50      | <0.50      | <0.50      | <0.50      | <1.0          | <2.0 |
|                        | 03/04/03 <sup>22</sup> | 10.76        |                   | 0.22         | 0.00               | <50            | <0.50      | <0.50      | <0.50      | <0.50      | <1.0          | <2.0 |
|                        | 06/18/03 <sup>22</sup> | 10.26        |                   | 0.72         | 0.00               | <50            | <0.50      | <0.50      | <0.50      | <0.50      | <1.0          | <2.0 |

**Table 1**  
**Groundwater Monitoring Data and Analytical Results**  
 Tosco (Unocal) Service Station #5325  
 3220 Lakeshore Avenue  
 Oakland, California

| WELL ID/<br>TOC*(ft.) | DATE     | DTW<br>(ft.) | S.I.<br>(ft. bgs) | GWE<br>(ft.) | Product<br>Thickness<br>(ft.) | TPH-G<br>(ppb) | B<br>(ppb) | T<br>(ppb) | E<br>(ppb) | X<br>(ppb) | MTBE<br>(ppb) |
|-----------------------|----------|--------------|-------------------|--------------|-------------------------------|----------------|------------|------------|------------|------------|---------------|
| U-4                   |          |              |                   |              |                               |                |            |            |            |            |               |
| 11.15                 | 06/22/94 | 10.16        | 5.0-20.0          | 0.99         | 0.00                          | ND             | ND         | ND         | ND         | ND         | --            |
|                       | 09/22/94 | 10.79        |                   | 0.36         | 0.00                          | ND             | 0.78       | 1.3        | ND         | 1.4        | --            |
|                       | 12/24/94 | 9.81         |                   | 1.34         | 0.00                          | ND             | ND         | ND         | ND         | ND         | --            |
|                       | 03/25/95 | 9.51         |                   | 1.64         | 0.00                          | ND             | ND         | ND         | ND         | ND         | --            |
|                       | 06/21/95 | 9.54         |                   | 1.61         | 0.00                          | ND             | ND         | ND         | ND         | ND         | --            |
|                       | 09/19/95 | 10.17        |                   | 0.98         | 0.00                          | ND             | ND         | ND         | ND         | ND         | --            |
|                       | 12/19/95 | 9.98         |                   | 1.17         | 0.00                          | ND             | ND         | ND         | ND         | ND         | --            |
|                       | 03/18/96 | 9.66         |                   | 1.49         | 0.00                          | ND             | ND         | ND         | ND         | ND         | --            |
|                       | 06/27/96 | 9.74         |                   | 1.41         | 0.00                          | ND             | ND         | ND         | ND         | ND         | ND            |
|                       | 09/26/96 | 10.14        |                   | 1.01         | 0.00                          | ND             | ND         | ND         | ND         | ND         | ND            |
|                       | 12/09/96 | 8.67         |                   | 2.48         | 0.00                          | ND             | ND         | ND         | ND         | ND         | 33            |
|                       | 03/14/97 | 9.35         |                   | 1.80         | 0.00                          | ND             | ND         | ND         | ND         | ND         | ND            |
|                       | 06/30/97 | 9.89         |                   | 1.26         | 0.00                          | ND             | ND         | ND         | ND         | ND         | ND            |
|                       | 09/19/97 | 9.96         |                   | 1.19         | 0.00                          | ND             | ND         | ND         | ND         | ND         | ND            |
|                       | 12/12/97 | 8.56         |                   | 2.59         | 0.00                          | ND             | ND         | ND         | ND         | ND         | ND            |
|                       | 03/03/98 | 7.85         |                   | 3.30         | 0.00                          | ND             | ND         | ND         | ND         | ND         | ND            |
|                       | 06/15/98 | 9.08         |                   | 2.07         | 0.00                          | ND             | ND         | ND         | ND         | ND         | ND            |
|                       | 09/30/98 | 9.75         |                   | 1.40         | 0.00                          | ND             | ND         | ND         | ND         | ND         | ND            |
|                       | 12/28/98 | 9.59         |                   | 1.56         | 0.00                          | ND             | ND         | ND         | ND         | ND         | ND            |
|                       | 03/22/99 | 8.34         |                   | 2.81         | 0.00                          | ND             | ND         | ND         | ND         | ND         | ND            |
|                       | 06/09/99 | 9.39         |                   | 1.76         | 0.00                          | ND             | ND         | ND         | ND         | ND         | ND            |
|                       | 09/08/99 | 9.90         |                   | 1.25         | 0.00                          | ND             | ND         | ND         | ND         | ND         | ND            |
|                       | 12/07/99 | 10.05        |                   | 1.10         | 0.00                          | ND             | ND         | ND         | ND         | ND         | ND            |
|                       | 03/13/00 | 7.24         |                   | 3.91         | 0.00                          | ND             | ND         | ND         | ND         | ND         | ND            |
|                       | 06/21/00 | 9.48         |                   | 1.67         | 0.00                          | ND             | ND         | ND         | ND         | ND         | ND            |
|                       | 09/27/00 | 9.42         |                   | 1.73         | 0.00                          | ND             | ND         | ND         | ND         | ND         | ND            |
|                       | 12/12/00 | 9.50         |                   | 1.65         | 0.00                          | ND             | ND         | ND         | ND         | ND         | ND            |
|                       | 03/07/01 | 6.88         |                   | 4.27         | 0.00                          | ND             | ND         | ND         | ND         | ND         | ND            |
|                       | 06/06/01 | 9.18         |                   | 1.97         | 0.00                          | ND             | ND         | ND         | ND         | ND         | ND            |
|                       | 09/24/01 | 9.21         |                   | 1.94         | 0.00                          | <50            | <0.50      | <0.50      | <0.50      | <0.50      | <2.5          |
|                       | 12/10/01 | 7.32         |                   | 3.83         | 0.00                          | <50            | <0.50      | <0.50      | <0.50      | <0.50      | <2.5          |
|                       | 03/11/02 | 6.92         |                   | 4.23         | 0.00                          | <50            | <0.50      | <0.50      | <0.50      | <0.50      | <5.0          |

**Table 1**  
**Groundwater Monitoring Data and Analytical Results**  
 Tosco (Unocal) Service Station #5325  
 3220 Lakeshore Avenue  
 Oakland, California

| WELL ID/<br>TOC* (ft.) | DATE                   | DTW<br>(ft.) | S.I.<br>(ft. bgs) | GWE<br>(ft.) | Product            |                     |                 |                 |            |            |                       |                       |
|------------------------|------------------------|--------------|-------------------|--------------|--------------------|---------------------|-----------------|-----------------|------------|------------|-----------------------|-----------------------|
|                        |                        |              |                   |              | Thickness<br>(ft.) | TPH-G<br>(ppb)      | B<br>(ppb)      | T<br>(ppb)      | E<br>(ppb) | X<br>(ppb) | MTBE<br>(ppb)         |                       |
| U-4                    | 06/04/02               | 7.58         | 5.0-20.0          | 3.57         | 0.00               | <50                 | <0.50           | <0.50           | <0.50      | <0.50      | <0.50                 | <2.5                  |
| (cont)                 | 09/03/02               | 9.17         |                   | 1.98         | 0.00               | <50                 | <0.50           | <0.50           | <0.50      | <0.50      | <0.50                 | <2.5                  |
|                        | 12/03/02 <sup>22</sup> | 9.20         |                   | 1.95         | 0.00               | <50                 | <0.50           | <0.50           | <0.50      | <0.50      | <1.0                  | <2.0                  |
|                        | 03/04/03 <sup>22</sup> | 9.32         |                   | 1.83         | 0.00               | <50                 | <0.50           | <0.50           | <0.50      | <0.50      | <1.0                  | <2.0                  |
|                        | 06/18/03 <sup>22</sup> | 7.65         |                   | 3.50         | 0.00               | <50                 | <0.50           | <0.50           | <0.50      | <0.50      | <1.0                  | <2.0                  |
| U-5                    |                        |              |                   |              |                    |                     |                 |                 |            |            |                       |                       |
| 6.98                   | 06/22/94               | 6.83         | 5.0-20.0          | 0.15         | 0.00               | 210                 | 7.1             | 13              | 4.5        | 26         | --                    | --                    |
|                        | 09/22/94               | 6.90         |                   | 0.08         | 0.00               | 170                 | 8.4             | 10              | 8.5        | 18         | --                    | --                    |
|                        | 12/24/94               | 6.43         |                   | 0.55         | 0.00               | 8,700               | 560             | 70              | 670        | 430        | --                    | --                    |
|                        | 03/25/95               | 6.35         |                   | 0.63         | 0.00               | 44,000              | 390             | 960             | 1,500      | 7,600      | --                    | --                    |
|                        | 06/21/95               | 7.11         |                   | -0.13        | 0.00               | 400                 | 2.3             | ND              | 9.1        | 3.5        | --                    | --                    |
|                        | 09/19/95               | 6.99         |                   | -0.01        | 0.00               | 850                 | 14              | 7.1             | 13         | 66         | -- <sup>5</sup>       | --                    |
|                        | 12/19/95               | 7.17         |                   | -0.19        | 0.00               | ND                  | ND              | ND              | ND         | ND         | --                    | --                    |
|                        | 03/18/96               | 6.65         |                   | 0.33         | 0.00               | 100                 | 0.67            | 0.5             | 0.51       | 5.4        | --                    | --                    |
|                        | 06/27/96               | 6.49         |                   | 0.49         | 0.00               | 16,000              | 280             | 150             | 1,400      | 4,600      | 530                   | 530                   |
|                        | 09/26/96               | 7.13         |                   | -0.15        | 0.00               | ND                  | ND              | 0.57            | ND         | 0.96       | ND                    | ND                    |
|                        | 12/09/96               | 5.90         |                   | 1.08         | 0.00               | 1,300               | 29              | 46              | ND         | 140        | 97                    | 97                    |
|                        | 03/14/97               | 6.99         |                   | -0.01        | 0.00               | ND                  | ND              | ND              | ND         | ND         | 14                    | 14                    |
|                        | 06/30/97               | 7.08         |                   | -0.10        | 0.00               | 4,200               | 74              | 51              | 180        | 980        | 270                   | 270                   |
|                        | 09/19/97               | 6.78         |                   | 0.20         | 0.00               | 6,300               | 160             | 13              | 370        | 1000       | 480                   | 480                   |
|                        | 12/12/97               | 6.94         |                   | 0.04         | 0.00               | 60                  | 1.3             | ND              | 1.6        | 2.1        | 47                    | 47                    |
|                        | 03/03/98               | 6.50         |                   | 0.48         | 0.00               | 1,700               | 29              | ND <sup>7</sup> | 150        | 190        | 330                   | 330                   |
|                        | 06/15/98               | 6.85         |                   | 0.13         | 0.00               | 1,500               | 32              | ND <sup>7</sup> | 91         | 83         | 330                   | 330                   |
|                        | 09/30/98               | 7.31         |                   | -0.33        | 0.00               | 1,700               | 44              | ND <sup>7</sup> | 39         | 150        | 60                    | 60                    |
|                        | 12/28/98               | 7.25         |                   | -0.27        | 0.00               | 1,400               | 59              | ND <sup>7</sup> | 13         | 27         | 150                   | 150                   |
|                        | 03/22/99               | 6.86         |                   | 0.12         | 0.00               | 780                 | 8.9             | ND              | 0.76       | 4.5        | 350                   | 350                   |
|                        | 06/09/99               | 7.28         |                   | -0.30        | 0.00               | 1,000               | ND <sup>7</sup> | ND <sup>7</sup> | 10         | 35         | 280/350 <sup>10</sup> | 280/350 <sup>10</sup> |
|                        | 09/08/99               | 7.52         |                   | -0.54        | 0.00               | 2,620 <sup>11</sup> | 26.2            | ND <sup>7</sup> | 32.2       | 157        | 280/239 <sup>12</sup> | 280/239 <sup>12</sup> |
|                        | 12/07/99               | 7.67         |                   | -0.69        | 0.00               | 949 <sup>11</sup>   | 9.26            | ND <sup>7</sup> | 11.2       | 22.7       | 235/301 <sup>12</sup> | 235/301 <sup>12</sup> |
|                        | 03/13/00               | 6.73         |                   | 0.25         | 0.00               | 880 <sup>14</sup>   | 12              | 1.0             | 5.6        | 8.7        | 46/37 <sup>10</sup>   | 46/37 <sup>10</sup>   |
|                        | 06/21/00               | 7.39         |                   | -0.41        | 0.00               | 700 <sup>11</sup>   | 4.0             | ND              | 0.99       | 4.0        | 120/140 <sup>10</sup> | 120/140 <sup>10</sup> |

**Table 1**  
**Groundwater Monitoring Data and Analytical Results**  
 Tosco (Unocal) Service Station #5325  
 3220 Lakeshore Avenue  
 Oakland, California

| WELL ID/<br>TOC* (ft.) | DATE                   | DTW<br>(ft.) | S.L.<br>(ft. bgs) | GWE<br>(ft.) | Product            |                   |                 |                 |                 |                 |                         |
|------------------------|------------------------|--------------|-------------------|--------------|--------------------|-------------------|-----------------|-----------------|-----------------|-----------------|-------------------------|
|                        |                        |              |                   |              | Thickness<br>(ft.) | TPH-G<br>(ppb)    | B<br>(ppb)      | T<br>(ppb)      | E<br>(ppb)      | X<br>(ppb)      | MTBE<br>(ppb)           |
| U-5                    | 09/27/00               | 7.45         | 5.0-20.0          | -0.47        | 0.00               | 400 <sup>11</sup> | 1.9             | ND              | ND              | 1.5             | 160/250 <sup>15</sup>   |
| (cont)                 | 12/12/00               | 7.68         |                   | -0.70        | 0.00               | 770 <sup>11</sup> | 3.2             | ND <sup>7</sup> | ND <sup>7</sup> | ND <sup>7</sup> | 27/13 <sup>12</sup>     |
|                        | 03/07/01               | 6.83         |                   | 0.15         | 0.00               | 623 <sup>13</sup> | 5.15            | ND              | ND              | 0.669           | 35.7/43.4 <sup>10</sup> |
|                        | 06/06/01               | 7.42         |                   | -0.44        | 0.00               | 110 <sup>13</sup> | ND              | ND              | ND              | ND              | ND                      |
|                        | 09/24/01               | 7.50         |                   | -0.52        | 0.00               | 270 <sup>19</sup> | <0.50           | <0.50           | <0.50           | <0.50           | 40/42 <sup>10</sup>     |
|                        | 12/10/01               | 6.65         |                   | 0.33         | 0.00               | 420 <sup>18</sup> | 13              | 0.60            | 0.66            | <0.50           | <2.5                    |
|                        | 03/11/02               | 7.00         |                   | -0.02        | 0.00               | 260 <sup>13</sup> | <0.50           | <0.50           | <0.50           | <0.50           | 42/47 <sup>10</sup>     |
|                        | 06/04/02               | 6.71         |                   | 0.27         | 0.00               | 170 <sup>19</sup> | <0.50           | 0.77            | 0.87            | 0.69            | 29                      |
|                        | 09/03/02               | 7.47         |                   | -0.49        | 0.00               | <50               | <0.50           | <0.50           | <0.50           | <0.50           | 37/53 <sup>10</sup>     |
|                        | 12/03/02 <sup>22</sup> | 6.64         |                   | 0.34         | 0.00               | 320               | <0.50           | <0.50           | 5.7             | <1.0            | 11                      |
|                        | 03/04/03 <sup>22</sup> | 6.75         |                   | 0.23         | 0.00               | 100 <sup>21</sup> | <0.50           | <0.50           | <0.50           | <1.0            | 44                      |
|                        | 06/18/03 <sup>22</sup> | 6.25         |                   | 0.73         | 0.00               | 51 <sup>21</sup>  | <0.50           | <0.50           | <0.50           | <1.0            | 36                      |
| U-6                    |                        |              |                   |              |                    |                   |                 |                 |                 |                 |                         |
| 7.14                   | 06/22/94               | 7.14         | 5.0-24.0          | 0.00         | 0.00               | ND                | ND              | ND              | ND              | ND              | --                      |
|                        | 09/22/94               | 7.34         |                   | -0.20        | 0.00               | 130               | 1.3             | 0.8             | ND              | 0.73            | --                      |
|                        | 12/24/94               | 6.67         |                   | 0.47         | 0.00               | 6,900             | 500             | 59              | 600             | 380             | --                      |
|                        | 03/25/95               | 6.29         |                   | 0.85         | 0.00               | 47,000            | 450             | 1,300           | 1,700           | 8,200           | --                      |
|                        | 06/21/95               | 7.60         |                   | -0.46        | 0.00               | ND                | ND              | ND              | ND              | ND              | --                      |
|                        | 09/19/95               | 7.70         |                   | -0.56        | 0.00               | ND                | ND              | ND              | ND              | ND              | -- <sup>5</sup>         |
|                        | 12/19/95               | 7.75         |                   | -0.61        | 0.00               | 210               | 2.5             | 1.0             | 2.9             | 17              | --                      |
|                        | 03/18/96               | 6.86         |                   | 0.28         | 0.00               | ND                | ND              | ND              | ND              | ND              | --                      |
|                        | 06/27/96               | 6.52         |                   | 0.62         | 0.00               | ND                | ND              | ND              | ND              | ND              | 510                     |
|                        | 09/26/96               | 7.62         |                   | -0.48        | 0.00               | ND                | ND              | ND              | ND              | ND              | 1,400                   |
|                        | 12/09/96               | 5.88         |                   | 1.26         | 0.00               | 1,200             | 29              | 48              | 6.4             | 140             | 58                      |
|                        | 03/14/97               | 7.30         |                   | -0.16        | 0.00               | ND                | ND              | ND              | ND              | ND              | 1,500                   |
|                        | 06/30/97               | 7.35         |                   | -0.21        | 0.00               | ND                | ND              | ND              | ND              | ND              | 990                     |
|                        | 09/19/97               | 7.25         |                   | -0.11        | 0.00               | ND                | ND              | ND              | ND              | ND              | 1,400                   |
|                        | 12/12/97               | 7.29         |                   | -0.15        | 0.00               | ND                | ND              | ND              | ND              | ND              | 680                     |
|                        | 03/03/98               | 7.00         |                   | 0.14         | 0.00               | ND                | ND              | ND              | ND              | ND              | 1,600                   |
|                        | 06/15/98               | 7.18         |                   | -0.04        | 0.00               | ND <sup>7</sup>   | ND <sup>7</sup> | ND <sup>7</sup> | ND <sup>7</sup> | ND <sup>7</sup> | 1,000                   |
|                        | 09/30/98               | 7.90         |                   | -0.76        | 0.00               | ND                | ND              | ND              | ND              | ND              | 1,200                   |

**Table 1**  
**Groundwater Monitoring Data and Analytical Results**  
 Tosco (Unocal) Service Station #5325  
 3220 Lakeshore Avenue  
 Oakland, California

| WELL ID/<br>TOC* (ft.) | DATE                   | DTW<br>(ft.) | S.I.<br>(ft. bgs) | GWE<br>(ft.) | Product<br>Thickness<br>(ft.) | TPH-G<br>(ppb)      | B<br>(ppb)      | T<br>(ppb)      | E<br>(ppb)      | X<br>(ppb)      | MTBE<br>(ppb)             |
|------------------------|------------------------|--------------|-------------------|--------------|-------------------------------|---------------------|-----------------|-----------------|-----------------|-----------------|---------------------------|
| U-6                    | 12/28/98               | 7.79         | 5.0-24.0          | -0.65        | 0.00                          | ND <sup>7</sup>     | ND <sup>7</sup> | ND <sup>7</sup> | ND <sup>7</sup> | ND <sup>7</sup> | 730                       |
| (cont)                 | 03/22/99               | 7.47         |                   | -0.33        | 0.00                          | ND                  | ND              | ND              | ND              | ND              | 1,800                     |
|                        | 06/09/99               | 7.73         |                   | -0.59        | 0.00                          | ND <sup>7</sup>     | ND <sup>7</sup> | ND <sup>7</sup> | ND <sup>7</sup> | ND <sup>7</sup> | 1,000/850 <sup>10</sup>   |
|                        | 09/08/99               | 7.95         |                   | -0.81        | 0.00                          | ND                  | ND              | ND              | ND              | ND              | 851/1,040 <sup>10</sup>   |
|                        | 12/07/99               | 8.10         |                   | -0.96        | 0.00                          | ND                  | ND              | ND              | ND              | ND              | 1,140/1,150 <sup>12</sup> |
|                        | 03/13/00               | 6.95         |                   | 0.19         | 0.00                          | ND                  | ND              | ND              | ND              | ND              | 560/670 <sup>10</sup>     |
|                        | 06/21/00               | 7.84         |                   | -0.70        | 0.00                          | ND                  | ND              | ND              | ND              | ND              | 400/590 <sup>10</sup>     |
|                        | 09/27/00               | 7.68         |                   | -0.54        | 0.00                          | ND                  | ND              | ND              | ND              | ND              | 2,500/2,800 <sup>15</sup> |
|                        | 12/12/00               | 7.74         |                   | -0.60        | 0.00                          | ND                  | ND              | ND              | ND              | ND              | 590/580 <sup>12</sup>     |
|                        | 03/07/01               | 7.27         |                   | -0.13        | 0.00                          | ND                  | ND              | ND              | ND              | ND              | 310/321 <sup>12</sup>     |
|                        | 06/06/01               | 7.80         |                   | -0.66        | 0.00                          | ND                  | ND              | ND              | ND              | ND              | 250/330 <sup>12</sup>     |
|                        | 09/24/01               | 7.82         |                   | -0.68        | 0.00                          | <50                 | <0.50           | <0.50           | <0.50           | <0.50           | 530/660 <sup>10</sup>     |
|                        | 12/10/01               | 7.15         |                   | -0.01        | 0.00                          | <50                 | <0.50           | <0.50           | <0.50           | <0.50           | 220/220 <sup>10</sup>     |
|                        | 03/11/02               | 7.32         |                   | -0.18        | 0.00                          | <50                 | <0.50           | <0.50           | <0.50           | <0.50           | 720/760 <sup>10</sup>     |
|                        | 06/04/02               | 7.18         |                   | -0.04        | 0.00                          | 250 <sup>19</sup>   | <1.0            | <1.0            | <1.0            | <1.0            | 470                       |
|                        | 09/03/02               | 7.72         |                   | -0.58        | 0.00                          | 420 <sup>21</sup>   | <2.5            | <2.5            | <2.5            | 4.7             | 860/1,200 <sup>10</sup>   |
|                        | 12/03/02 <sup>22</sup> | 6.92         |                   | 0.22         | 0.00                          | <500                | <5.0            | <5.0            | <5.0            | <10             | 870                       |
|                        | 03/04/03 <sup>22</sup> | 7.01         |                   | 0.13         | 0.00                          | 2,300 <sup>21</sup> | <10             | <10             | <10             | <20             | 2,700                     |
|                        | 06/18/03 <sup>22</sup> | 6.60         |                   | 0.54         | 0.00                          | 1,300 <sup>21</sup> | <10             | <10             | <10             | <20             | 1,700                     |

**Table 1**  
**Groundwater Monitoring Data and Analytical Results**  
 Tosco (Unocal) Service Station #5325  
 3220 Lakeshore Avenue  
 Oakland, California

**EXPLANATIONS:**

Groundwater monitoring data and laboratory analytical results prior to March 3, 1998, were compiled from reports prepared by MPDS Services, Inc.

|                                       |  |                                   |
|---------------------------------------|--|-----------------------------------|
| TOC = Top of Casing                   | TPH-G = Total Petroleum Hydrocarbons as Gasoline | (ppb) = Parts per billion         |
| (ft.) = Feet                          | B = Benzene                                      | ND = Not Detected                 |
| DTW = Depth to Water                  | T = Toluene                                      | -- = Not Measured/Not Analyzed    |
| S.I. = Screen Interval                | E = Ethylbenzene                                 | QA = Quality Assurance/Trip Blank |
| (ft. bgs) = Feet Below Ground Surface | X = Xylenes                                      |                                   |
| GWE = Groundwater Elevation           | MTBE = Methyl tertiary butyl ether               |                                   |

- \* TOC elevations are surveyed relative to City of Oakland Benchmark, at the northeasterly corner of Weller and Cheney Avenue (Elevation = 9.055 feet, city datum; add 3.00' to U.S.G.S. datum). Prior to November 16, 1993, the DTW measurements were taken from the well cover.
- \*\* Groundwater elevation corrected due to the presence of free product; correction factor = [(TOC-DTW)+(Product Thickness x 0.75)].
- 1 The positive result for gasoline does not appear to have a typical gasoline pattern.
- 2 The concentration reported as gasoline is primarily due to the presence of a combination of gasoline and a discrete peak not indicative of gasoline.
- 3 Laboratory report indicates the hydrocarbons detected did not appear to be gasoline
- 4 Laboratory report indicates the hydrocarbons detected appeared to be a gasoline and non-gasoline mixture.
- 5 Laboratory has potentially identified the presence of MTBE at reportable levels in the groundwater sample collected from this well.
- 6 Laboratory has identified the presence of MTBE at a level above or equal to the taste and odor threshold of 40 ppb in the sample collected from this well.
- 7 Detection limit raised. Refer to analytical reports.
- 8 Laboratory report indicates unidentified hydrocarbons C6-C12.
- 9 Laboratory report indicates gasoline and unidentified hydrocarbons >C8.
- 10 MTBE by EPA Method 8260.
- 11 Laboratory report indicates gasoline C6-C12.
- 12 MTBE by EPA Method 8260 analyzed past the recommended holding time.
- 13 Laboratory report indicates weathered gasoline C6-C12.
- 14 Laboratory report indicates gasoline C6-C12 + unidentified hydrocarbons <C6.
- 15 Laboratory report indicates sample was originally analyzed within holding time. Re-analysis for confirmation or dilution was performed past the recommended holding time.
- 16 Laboratory report indicates gasoline C6-C12 + unidentified hydrocarbons >C10.
- 17 Skimmer present in well.
- 18 Laboratory report indicates gasoline C6-C10.
- 19 Laboratory report indicates unidentified hydrocarbons C6-C10.
- 20 Skimmer not present in well.
- 21 Laboratory report indicates hydrocarbon pattern is present in the requested fuel quantitation range but does not resemble the pattern of the requested fuel.
- 22 TPH-G, BTEX and MTBE by EPA Method 8260.

**Table 2**  
**Groundwater Analytical Results - Oxygenate Compounds**  
 Tosco (Unocal) Service Station #5325  
 3220 Lakeshore Avenue  
 Oakland, California

| WELL ID               | DATE                  | ETHANOL<br>(ppb) | TBA<br>(ppb)    | MTBE<br>(ppb)       | DIPE<br>(ppb)       | ETBE<br>(ppb)   | TAME<br>(ppb)   | 1,2-DCA<br>(ppb) | EDB<br>(ppb)    |
|-----------------------|-----------------------|------------------|-----------------|---------------------|---------------------|-----------------|-----------------|------------------|-----------------|
| U-1                   | 09/27/00 <sup>1</sup> | --               | ND <sup>2</sup> | 83,000              | ND <sup>2</sup>     | ND <sup>2</sup> | ND <sup>2</sup> | ND <sup>2</sup>  | ND <sup>2</sup> |
|                       | 12/12/00              | --               | --              | 15,000 <sup>3</sup> | --                  | --              | --              | --               | --              |
|                       | 03/07/01              | ND <sup>2</sup>  | ND <sup>2</sup> | 11,800              | ND <sup>2</sup>     | ND <sup>2</sup> | ND <sup>2</sup> | ND <sup>2</sup>  | ND <sup>2</sup> |
|                       | 06/06/01 <sup>3</sup> | ND <sup>2</sup>  | ND <sup>2</sup> | 8,700               | ND <sup>2</sup>     | ND <sup>2</sup> | ND <sup>2</sup> | ND <sup>2</sup>  | ND <sup>2</sup> |
|                       | 09/24/01              | <400,000         | <20,000         | 4,400               | <1,000              | <1,000          | <1,000          | <1,000           | <1,000          |
|                       | 12/10/01              | <8,000           | <4,000          | 5,100               | <100                | <100            | <100            | <100             | <100            |
|                       | 03/11/02              | <25,000          | <5,000          | 6,300               | <100                | <100            | <100            | <100             | <100            |
|                       | 06/04/02 <sup>4</sup> | --               | --              | --                  | --                  | --              | --              | --               | --              |
|                       | 09/03/02              | <50,000          | <10,000         | 4,700               | <200                | <200            | <200            | <200             | <200            |
|                       | 12/03/02              | <50,000          | <10,000         | 4,700               | <200                | <200            | <200            | <200             | <200            |
|                       | 03/04/03              | <25,000          | <5,000          | 5,500               | <100                | <100            | <100            | <100             | <100            |
|                       | 06/18/03              | <25,000          | <5,000          | 10,000              | <100                | <100            | <100            | <100             | <100            |
|                       | U-2                   | 09/27/00         | --              | --                  | 26,000 <sup>1</sup> | --              | --              | --               | --              |
| 12/12/00              |                       | --               | --              | 7,800 <sup>3</sup>  | --                  | --              | --              | --               | --              |
| 03/07/01              |                       | ND <sup>2</sup>  | ND <sup>2</sup> | 7,900               | ND <sup>2</sup>     | ND <sup>2</sup> | ND <sup>2</sup> | ND <sup>2</sup>  | ND <sup>2</sup> |
| 06/06/01 <sup>3</sup> |                       | ND <sup>2</sup>  | ND <sup>2</sup> | 10,000              | ND <sup>2</sup>     | ND <sup>2</sup> | ND <sup>2</sup> | ND <sup>2</sup>  | ND <sup>2</sup> |
| 09/24/01              |                       | <400,000         | <20,000         | 11,000              | <1,000              | <1,000          | <1,000          | <1,000           | <1,000          |
| 12/10/01              |                       | <4,000           | <2,000          | 2,500               | <50                 | <50             | <50             | <50              | <50             |
| 03/11/02              |                       | <50,000          | <10,000         | 11,000              | <200                | <200            | <200            | <200             | <200            |
| 06/04/02 <sup>4</sup> |                       | --               | --              | --                  | --                  | --              | --              | --               | --              |
| 09/03/02              |                       | <250,000         | <50,000         | 15,000              | <1,000              | <1,000          | <1,000          | <1,000           | <1,000          |
| 12/03/02              |                       | <50,000          | <10,000         | 3,200               | <200                | <200            | <200            | <200             | <200            |
| 03/04/03              |                       | <50,000          | <10,000         | 7,800               | <200                | <200            | <200            | <200             | <200            |
| 06/18/03              |                       | <50,000          | <10,000         | 16,000              | <200                | <200            | <200            | <200             | <200            |
| U-3                   |                       | 12/03/02         | --              | --                  | <2.0                | --              | --              | --               | --              |
|                       | 03/04/03              | --               | --              | <2.0                | --                  | --              | --              | --               | --              |
|                       | 06/18/03              | --               | --              | <2.0                | --                  | --              | --              | --               | --              |

**Table 2**  
**Groundwater Analytical Results - Oxygenate Compounds**  
Tosco (Unocal) Service Station #5325  
3220 Lakeshore Avenue  
Oakland, California

| WELL ID  | DATE                  | ETHANOL<br>(ppb) | TBA<br>(ppb)    | MTBE<br>(ppb)      | DIPE<br>(ppb)   | ETBE<br>(ppb)   | TAME<br>(ppb)   | 1,2-DCA<br>(ppb) | EDB<br>(ppb)    |
|----------|-----------------------|------------------|-----------------|--------------------|-----------------|-----------------|-----------------|------------------|-----------------|
| U-4      | 12/03/02              | --               | --              | <2.0               | --              | --              | --              | --               | --              |
|          | 03/04/03              | --               | --              | <2.0               | --              | --              | --              | --               | --              |
|          | 06/18/03              | --               | --              | <2.0               | --              | --              | --              | --               | --              |
| U-5      | 09/27/00              | --               | --              | 250 <sup>1</sup>   | --              | --              | --              | --               | --              |
|          | 12/12/00              | --               | --              | 13 <sup>3</sup>    | --              | --              | --              | --               | --              |
|          | 03/07/01              | ND               | ND              | 43.4               | ND              | ND              | ND              | ND               | ND              |
|          | 09/24/01              | <4,000           | <200            | 42                 | <10             | <10             | <10             | <10              | <10             |
|          | 03/11/02              | <500             | <100            | 47                 | <2.0            | <2.0            | <2.0            | <2.0             | <2.0            |
|          | 06/04/02 <sup>4</sup> | --               | --              | --                 | --              | --              | --              | --               | --              |
|          | 09/03/02              | <500             | <100            | 53                 | <2.0            | <2.0            | <2.0            | <2.0             | <2.0            |
|          | 12/03/02              | <500             | <100            | 11                 | <2.0            | <2.0            | <2.0            | <2.0             | <2.0            |
|          | 03/04/03              | <500             | <100            | 44                 | <2.0            | <2.0            | <2.0            | <2.0             | <2.0            |
|          | 06/18/03              | <500             | <100            | 36                 | <2.0            | <2.0            | <2.0            | <2.0             | <2.0            |
| U-6      | 09/27/00              | --               | --              | 2,800 <sup>1</sup> | --              | --              | --              | --               | --              |
|          | 12/12/00              | --               | --              | 580 <sup>3</sup>   | --              | --              | --              | --               | --              |
|          | 03/07/01 <sup>3</sup> | ND <sup>2</sup>  | ND <sup>2</sup> | 321                | ND <sup>2</sup> | ND <sup>2</sup> | ND <sup>2</sup> | ND <sup>2</sup>  | ND <sup>2</sup> |
|          | 06/06/01 <sup>3</sup> | ND <sup>2</sup>  | ND <sup>2</sup> | 330                | ND <sup>2</sup> | ND <sup>2</sup> | ND <sup>2</sup> | ND <sup>2</sup>  | ND <sup>2</sup> |
|          | 09/24/01              | <40,000          | <2,000          | 660                | <100            | <100            | <100            | <100             | <100            |
|          | 12/10/01              | <400             | <200            | 220                | <5.0            | <5.0            | <5.0            | <5.0             | <5.0            |
|          | 03/11/02              | <2,000           | <400            | 760                | <8.0            | <8.0            | <8.0            | <8.0             | <8.0            |
|          | 06/04/02 <sup>4</sup> | --               | --              | --                 | --              | --              | --              | --               | --              |
|          | 09/03/02              | <10,000          | <2,000          | 1,200              | <40             | <40             | <40             | <40              | <40             |
|          | 12/03/02              | <5,000           | <1,000          | 870                | <20             | <20             | <20             | <20              | <20             |
|          | 03/04/03              | <10,000          | <2,000          | 2,700              | <40             | <40             | <40             | <40              | <40             |
| 06/18/03 | <10,000               | <2,000           | 1,700           | <40                | <40             | <40             | <40             | <40              |                 |



**Table 2**  
**Groundwater Analytical Results - Oxygenate Compounds**  
Tosco (Unocal) Service Station #5325  
3220 Lakeshore Avenue  
Oakland, California

**EXPLANATIONS:**

**ANALYTICAL METHOD:**

EPA Method 8260 for Oxygenate Compounds

TBA = Tertiary butyl alcohol  
MTBE = Methyl tertiary butyl ether  
DIPE = Di-isopropyl ether  
ETBE = Ethyl tertiary butyl ether  
TAME = Tertiary amyl methyl ether  
1,2-DCA = 1,2-Dichloroethane  
EDB = 1,2-Dibromoethane  
(ppb) = Parts per billion  
ND = Not Detected  
-- = Not Analyzed

- <sup>1</sup> Laboratory report indicates sample was originally analyzed within holding time. Re-analysis for confirmation or dilution was performed past the recommended holding time.
- <sup>2</sup> Detection limit raised. Refer to analytical reports.
- <sup>3</sup> Laboratory report indicates sample was analyzed outside the EPA recommended holding time.
- <sup>4</sup> Due to Laboratory error, samples for oxygenate (8260) analyses was not performed.

**Table 3**  
**Field Measurements and Groundwater Analytical Results**  
 Tosco (Unocal) Service Station #5325  
 3220 Lakeshore Avenue  
 Oakland, California

| WELL ID  | DATE     | Ferrous Iron<br>(ppm) | Nitrate<br>as NO3<br>(ppm) | Phosphate<br>as PO4<br>(ppm) | ORP<br>(mV)                        | D.O.<br>Before Purge<br>(mg/L) | D.O.<br>After Purge<br>(mg/L) |
|----------|----------|-----------------------|----------------------------|------------------------------|------------------------------------|--------------------------------|-------------------------------|
| U-1      | 06/15/98 | 39                    | ND                         | ND                           | 382 <sup>2</sup>                   | --                             | --                            |
|          | 09/30/98 | 17                    | ND                         | ND                           | 366 <sup>2</sup>                   | --                             | --                            |
|          | 12/28/98 | 4.3                   | 6.3                        | 28                           | 298 <sup>2</sup>                   | --                             | --                            |
|          | 03/22/99 | 4.9                   | ND                         | 3.5                          | 320 <sup>3</sup>                   | --                             | --                            |
|          | 06/09/99 | 1.2                   | ND                         | ND                           | 260 <sup>3</sup>                   | --                             | --                            |
|          | 09/08/99 | 1.80                  | ND <sup>1</sup>            | ND <sup>1</sup>              | 85 <sup>3</sup>                    | --                             | --                            |
|          | 12/07/99 | 5.70                  | ND <sup>1</sup>            | 17.0                         | 404 <sup>3</sup>                   | 1.36                           | --                            |
|          | 03/13/00 | 8.0                   | 0.18                       | ND                           | <sup>2</sup> 117/ <sup>262</sup> 3 | --                             | --                            |
|          | 06/21/00 | 9.3                   | ND <sup>1</sup>            | ND <sup>1</sup>              | 148 <sup>2</sup>                   | 1.53                           | --                            |
|          | 09/27/00 | 2.8                   | ND <sup>1</sup>            | 18.4                         | 119 <sup>2</sup>                   | 1.63                           | --                            |
|          | 12/12/00 | 0.49                  | ND <sup>1</sup>            | 16.0                         | 131 <sup>2</sup>                   | 1.48                           | --                            |
|          | 03/07/01 | 0.483                 | 2.64                       | 6.89                         | 125 <sup>2</sup>                   | 1.91                           | --                            |
|          | 06/06/01 | 1.0 <sup>4</sup>      | ND                         | 2.7                          | 141 <sup>2</sup>                   | 1.77                           | --                            |
|          | 09/24/01 | <0.10                 | 0.45 <sup>5</sup>          | --                           | 125 <sup>2</sup>                   | 1.64                           | --                            |
|          | 12/10/01 | 14                    | <0.50                      | 2.2                          | 141 <sup>2</sup>                   | 1.82                           | --                            |
|          | 03/11/02 | 15                    | <0.50                      | 0.11                         | 132 <sup>2</sup>                   | 2.21                           | --                            |
|          | 06/04/02 | <0.50                 | <0.50                      | <0.10                        | 117 <sup>2</sup>                   | 1.88                           | --                            |
|          | 09/03/02 | <0.50                 | <0.50                      | <0.10                        | 94 <sup>2</sup>                    | 1.62                           | --                            |
|          | 12/03/02 | 9.6                   | <1.0                       | <1.0                         | 72 <sup>2</sup>                    | 1.71                           | --                            |
|          | 03/04/03 | 36                    | <1.0                       | <1.0                         | -125 <sup>2</sup>                  | 0.30                           | --                            |
| 06/18/03 | 16       | <1.0                  | <1.0                       | -48 <sup>2</sup>             | --                                 | 1.7                            |                               |
| U-2      | 03/03/98 | 25                    | ND                         | ND                           | 369 <sup>2</sup>                   | --                             | --                            |
|          | 06/15/98 | 42                    | ND                         | ND                           | 341 <sup>2</sup>                   | --                             | --                            |
|          | 09/30/98 | 25                    | ND                         | ND                           | 354 <sup>2</sup>                   | --                             | --                            |
|          | 12/28/98 | 28                    | ND                         | ND                           | 276 <sup>2</sup>                   | --                             | --                            |
|          | 03/22/99 | 0.68                  | ND                         | 2.3                          | 320 <sup>3</sup>                   | --                             | --                            |
|          | 06/09/99 | 0.50                  | ND                         | ND                           | 290 <sup>3</sup>                   | --                             | --                            |
|          | 09/08/99 | 1.90                  | ND <sup>1</sup>            | ND <sup>1</sup>              | 235 <sup>3</sup>                   | --                             | --                            |
|          | 12/07/99 | 0.250                 | ND <sup>1</sup>            | ND <sup>1</sup>              | 389 <sup>3</sup>                   | 2.28                           | --                            |
|          | 03/13/00 | 4.3                   | 0.31                       | ND                           | <sup>2</sup> 121/ <sup>184</sup> 3 | --                             | --                            |
|          | 06/21/00 | 0.26                  | ND <sup>1</sup>            | ND <sup>1</sup>              | 136 <sup>2</sup>                   | 1.96                           | --                            |
|          | 09/27/00 | 0.64                  | ND <sup>1</sup>            | 10.5                         | 142 <sup>2</sup>                   | 2.12                           | --                            |
|          | 12/12/00 | 2.7                   | ND <sup>1</sup>            | ND <sup>1</sup>              | 155 <sup>2</sup>                   | 2.35                           | --                            |
|          | 03/07/01 | 0.677                 | 2.24                       | 3.02                         | 148 <sup>2</sup>                   | 2.21                           | --                            |
|          | 06/06/01 | 0.80 <sup>4</sup>     | ND                         | 2.8                          | 163 <sup>2</sup>                   | 2.67                           | --                            |
|          | 09/24/01 | <0.10                 | 0.49 <sup>5</sup>          | --                           | 151 <sup>2</sup>                   | 2.10                           | --                            |
|          | 12/10/01 | <0.10                 | <0.50                      | 0.20                         | 171 <sup>2</sup>                   | 2.81                           | --                            |
|          | 03/11/02 | <0.10                 | <0.50                      | 0.65                         | 156 <sup>2</sup>                   | 2.77                           | --                            |
|          | 06/04/02 | <0.10                 | <0.50                      | <0.10                        | 144 <sup>2</sup>                   | 3.14                           | --                            |
|          | 09/03/02 | <0.25                 | <0.50                      | 0.26                         | 151 <sup>2</sup>                   | 2.85                           | --                            |
|          | 12/03/02 | 9.9                   | <1.0                       | <1.0                         | 94 <sup>2</sup>                    | 1.97                           | --                            |
| 03/04/03 | 8.6      | <1.0                  | <1.0                       | -147 <sup>2</sup>            | 0.40                               | --                             |                               |
| 06/18/03 | 5.5      | <1.0                  | 3.1                        | -8 <sup>2</sup>              | --                                 | 3.2                            |                               |

**Table 3**  
**Field Measurements and Groundwater Analytical Results**  
 Tosco (Unocal) Service Station #5325  
 3220 Lakeshore Avenue  
 Oakland, California

| WELL ID | DATE            | Ferrous Iron<br>(ppm) | Nitrate<br>as NO3<br>(ppm) | Phosphate<br>as PO4<br>(ppm) | ORP<br>(mV)                                     | D.O.<br>Before Purge<br>(mg/L) | D.O.<br>After Purge<br>(mg/L) |
|---------|-----------------|-----------------------|----------------------------|------------------------------|---|--------------------------------|-------------------------------|
| U-3     | 06/30/97        | 1.4                   | 21                         | 0.86                         | 190 <sup>3</sup>                                | 4.10                           | --                            |
|         | 09/19/97        | 0.57                  | 19                         | ND                           | 75 <sup>3</sup>                                 | 4.20                           | --                            |
|         | 12/12/97        | 1.9                   | 23                         | 0.85                         | 390 <sup>3</sup>                                | 2.97                           | --                            |
|         | 03/03/98        | 0.013                 | 36                         | ND                           | 358 <sup>2</sup>                                | 2.63                           | --                            |
|         | 06/15/98        | 0.16                  | 33                         | ND                           | 318 <sup>2</sup>                                | 2.93                           | --                            |
|         | 09/30/98        | 0.040                 | 31                         | ND                           | 295 <sup>2</sup>                                | 3.11                           | --                            |
|         | 12/28/98        | ND                    | 29                         | ND                           | 281 <sup>2</sup>                                | 3.59                           | --                            |
|         | 03/22/99        | 0.015                 | 30                         | 0.14                         | 310 <sup>3</sup>                                | 4.02                           | --                            |
|         | 06/09/99        | ND                    | 26                         | 1.2                          | 350 <sup>3</sup>                                | 3.70                           | --                            |
|         | 09/08/99        | ND                    | 32.9                       | ND <sup>1</sup>              | 417 <sup>3</sup>                                | 3.96                           | --                            |
|         | 12/07/99        | 0.0520                | 27.9                       | ND <sup>1</sup>              | 437 <sup>3</sup>                                | 4.21                           | --                            |
|         | 03/13/00        | 0.15                  | 33                         | ND                           | <sup>2</sup> 226/ <sup>3</sup> 307 <sup>3</sup> | --                             | --                            |
|         | 06/21/00        | 0.20                  | 32                         | ND <sup>1</sup>              | 225 <sup>2</sup>                                | 4.27                           | --                            |
|         | 09/27/00        | ND                    | 34                         | 15.7                         | 211 <sup>2</sup>                                | 4.67                           | --                            |
|         | 12/12/00        | ND                    | 31                         | ND <sup>1</sup>              | 246 <sup>2</sup>                                | 4.79                           | --                            |
|         | 03/07/01        | ND                    | 36.5                       | 0.443                        | 251 <sup>2</sup>                                | 5.16                           | --                            |
|         | 06/06/01        | ND <sup>4</sup>       | 8.0                        | 0.18                         | 214 <sup>2</sup>                                | 4.79                           | --                            |
|         | 09/24/01        | <0.10                 | 23 <sup>5</sup>            | --                           | 198 <sup>2</sup>                                | 4.27                           | --                            |
|         | 12/10/01        | <0.10                 | 21                         | 0.11                         | 188 <sup>2</sup>                                | 4.66                           | --                            |
|         | 03/11/02        | <0.10                 | 30                         | 0.14                         | 166 <sup>2</sup>                                | 5.06                           | --                            |
|         | 06/04/02        | <0.10                 | 18                         | <0.10                        | 151 <sup>2</sup>                                | 5.79                           | --                            |
|         | 09/03/02        | <0.10 <sup>5</sup>    | 28                         | <0.10                        | 143 <sup>2</sup>                                | 6.04                           | --                            |
|         | 12/03/02        | <0.20                 | 20                         | <1.0                         | 154 <sup>2</sup>                                | 5.58                           | --                            |
|         | 03/04/03        | <0.20                 | 18                         | <1.0                         | -136 <sup>2</sup>                               | 0.20                           | --                            |
|         | <b>06/18/03</b> | <b>&lt;0.20</b>       | <b>17</b>                  | <b>&lt;1.0</b>               | <b>333<sup>2</sup></b>                          | --                             | <b>3.5</b>                    |
| U-4     | 06/30/97        | 0.13                  | 35                         | 0.52                         | 200 <sup>3</sup>                                | 5.40                           | --                            |
|         | 09/19/97        | 0.35                  | 30                         | ND                           | 45 <sup>3</sup>                                 | 5.10                           | --                            |
|         | 12/12/97        | 0.68                  | 31                         | 0.73                         | 380 <sup>3</sup>                                | 3.11                           | --                            |
|         | 03/03/98        | 0.018                 | 3.2                        | ND                           | 284 <sup>2</sup>                                | 2.94                           | --                            |
|         | 06/15/98        | 0.14                  | 33                         | ND                           | 256 <sup>2</sup>                                | 3.08                           | --                            |
|         | 09/30/98        | 0.049                 | 31                         | ND                           | 276 <sup>2</sup>                                | 4.05                           | --                            |
|         | 12/28/98        | 0.36                  | 31                         | ND                           | 280 <sup>2</sup>                                | 4.57                           | --                            |
|         | 03/22/99        | ND                    | 30                         | 0.14                         | 320 <sup>3</sup>                                | 4.26                           | --                            |
|         | 06/09/99        | ND                    | 35                         | 0.91                         | 340 <sup>3</sup>                                | 3.61                           | --                            |
|         | 09/08/99        | ND                    | 24                         | ND <sup>1</sup>              | 391 <sup>3</sup>                                | 3.75                           | --                            |
|         | 12/07/99        | ND                    | 27.7                       | ND <sup>1</sup>              | 478 <sup>3</sup>                                | 4.03                           | --                            |
|         | 03/13/00        | ND                    | 33                         | ND                           | <sup>2</sup> 219/ <sup>3</sup> 244 <sup>3</sup> | --                             | --                            |
|         | 06/21/00        | 0.034                 | 32                         | ND <sup>1</sup>              | 248 <sup>2</sup>                                | 4.89                           | --                            |
|         | 09/27/00        | ND                    | 28                         | ND <sup>1</sup>              | 198 <sup>2</sup>                                | 5.09                           | --                            |
|         | 12/12/00        | ND                    | 30                         | ND <sup>1</sup>              | 210 <sup>2</sup>                                | 4.86                           | --                            |
|         | 03/07/01        | ND                    | 33.9                       | 0.226                        | 233 <sup>2</sup>                                | 4.97                           | --                            |
|         | 06/06/01        | ND <sup>4</sup>       | 7.4                        | 0.21                         | 248 <sup>2</sup>                                | 5.12                           | --                            |
|         | 09/24/01        | <0.10                 | 24 <sup>5</sup>            | --                           | 262 <sup>2</sup>                                | 4.86                           | --                            |

**Table 3**  
**Field Measurements and Groundwater Analytical Results**  
 Tosco (Unocal) Service Station #5325  
 3220 Lakeshore Avenue  
 Oakland, California

| WELL ID | DATE     | Ferrous Iron<br>(ppm) | Nitrate<br>as NO3<br>(ppm) | Phosphate<br>as PO4<br>(ppm) | ORP<br>(mV)                       | D.O.<br>Before Purge<br>(mg/L) | D.O.<br>After Purge<br>(mg/L) |
|---------|----------|-----------------------|----------------------------|------------------------------|-----------------------------------|--------------------------------|-------------------------------|
| U-4     | 12/10/01 | <0.10                 | 19                         | 0.10                         | 242 <sup>2</sup>                  | 5.05                           | --                            |
| (cont)  | 03/11/02 | <0.10                 | 31                         | 0.14                         | 195 <sup>2</sup>                  | 4.83                           | --                            |
|         | 06/04/02 | <0.10                 | 27                         | <0.10                        | 169 <sup>2</sup>                  | 5.58                           | --                            |
|         | 09/03/02 | <0.10 <sup>5</sup>    | 28                         | 0.27                         | 126 <sup>2</sup>                  | 5.94                           | --                            |
|         | 12/03/02 | <0.20                 | 20                         | <1.0                         | 133 <sup>2</sup>                  | 5.82                           | --                            |
|         | 03/04/03 | <0.20                 | 26                         | <1.0                         | -148 <sup>2</sup>                 | 0.30                           | --                            |
|         | 06/18/03 | <0.20                 | 31                         | <1.0                         | 250 <sup>2</sup>                  | --                             | 3.6                           |
| U-5     | 06/30/97 | 16                    | ND                         | ND                           | 160 <sup>3</sup>                  | 3.40                           | --                            |
|         | 09/19/97 | 0.22                  | ND                         | ND                           | 63 <sup>3</sup>                   | 0.60                           | --                            |
|         | 12/12/97 | 6.7                   | ND                         | ND                           | 400 <sup>3</sup>                  | 1.75                           | --                            |
|         | 03/03/98 | 18                    | 3.1                        | ND                           | 345 <sup>2</sup>                  | 2.36                           | --                            |
|         | 06/15/98 | 17                    | ND                         | ND                           | 333 <sup>2</sup>                  | 2.55                           | --                            |
|         | 09/30/98 | 17                    | ND                         | ND                           | 318 <sup>2</sup>                  | 1.93                           | --                            |
|         | 12/28/98 | 17                    | 6.6                        | ND                           | 305 <sup>2</sup>                  | 1.64                           | --                            |
|         | 03/22/99 | 0.12                  | ND                         | 2.4                          | 340 <sup>3</sup>                  | 1.99                           | --                            |
|         | 06/09/99 | 0.23                  | ND                         | ND                           | 320 <sup>3</sup>                  | 2.10                           | --                            |
|         | 09/08/99 | 2.10                  | ND <sup>1</sup>            | ND <sup>1</sup>              | 335 <sup>3</sup>                  | 2.21                           | --                            |
|         | 12/07/99 | 0.310                 | ND <sup>1</sup>            | ND <sup>1</sup>              | 408 <sup>3</sup>                  | 2.66                           | --                            |
|         | 03/13/00 | 0.33                  | 0.16                       | ND                           | <sup>2</sup> 111/264 <sup>3</sup> | --                             | --                            |
|         | 06/21/00 | 0.15                  | ND <sup>1</sup>            | ND <sup>1</sup>              | 159 <sup>2</sup>                  | 3.42                           | --                            |
|         | 09/27/00 | 0.33                  | ND <sup>1</sup>            | ND <sup>1</sup>              | 136 <sup>2</sup>                  | 3.85                           | --                            |
|         | 12/12/00 | 0.086                 | ND <sup>1</sup>            | ND <sup>1</sup>              | 122 <sup>2</sup>                  | 3.53                           | --                            |
|         | 03/07/01 | 1.07                  | 3.02                       | 4.00                         | 141 <sup>2</sup>                  | 2.98                           | --                            |
|         | 06/06/01 | ND <sup>4</sup>       | ND                         | 1.2                          | 112 <sup>2</sup>                  | 2.67                           | --                            |
|         | 09/24/01 | <0.10                 | 0.77 <sup>5</sup>          | --                           | 146 <sup>2</sup>                  | 3.15                           | --                            |
|         | 12/10/01 | 3.7                   | <0.50                      | 2.6                          | 96 <sup>2</sup>                   | 2.85                           | --                            |
|         | 03/11/02 | 0.10                  | <0.50                      | 0.52                         | 108 <sup>2</sup>                  | 3.15                           | --                            |
|         | 06/04/02 | <0.25                 | <0.50                      | <0.10                        | 118 <sup>2</sup>                  | 3.46                           | --                            |
|         | 09/03/02 | <0.25                 | <0.50                      | <0.10                        | 87 <sup>2</sup>                   | 2.85                           | --                            |
|         | 12/03/02 | 22                    | <1.0                       | <1.0                         | 104 <sup>2</sup>                  | 2.71                           | --                            |
|         | 03/04/03 | 19                    | <1.0                       | <1.0                         | -166 <sup>2</sup>                 | 0.20                           | --                            |
|         | 06/18/03 | 11                    | <1.0                       | <1.0                         | -10 <sup>2</sup>                  | --                             | 2.4                           |
| U-6     | 06/30/97 | 88                    | 0.80                       | ND                           | 190 <sup>3</sup>                  | 0.30                           | --                            |
|         | 09/19/97 | 2.9                   | 1.80                       | ND                           | ND <sup>3</sup>                   | 0.60                           | --                            |
|         | 12/12/97 | 51                    | ND                         | ND                           | 380 <sup>3</sup>                  | 2.70                           | --                            |
|         | 03/03/98 | 60                    | 3.5                        | ND                           | 327 <sup>2</sup>                  | 2.18                           | --                            |
|         | 06/15/98 | 590                   | 4.8                        | ND                           | 315 <sup>2</sup>                  | 2.48                           | --                            |
|         | 09/30/98 | 33                    | ND                         | ND                           | 345 <sup>2</sup>                  | 3.06                           | --                            |
|         | 12/28/98 | 83                    | 7.2                        | ND                           | 297 <sup>2</sup>                  | 3.42                           | --                            |
|         | 03/22/99 | 2.1                   | ND                         | 0.98                         | 330 <sup>3</sup>                  | 3.88                           | --                            |
|         | 06/09/99 | 0.47                  | 0.20                       | ND                           | 320 <sup>3</sup>                  | 3.29                           | --                            |

**Table 3**  
**Field Measurements and Groundwater Analytical Results**  
 Tosco (Unocal) Service Station #5325  
 3220 Lakeshore Avenue  
 Oakland, California

| WELL ID | DATE     | Ferrous Iron<br>(ppm) | Nitrate<br>as NO <sub>3</sub> <sup>-</sup><br>(ppm) | Phosphate<br>as PO <sub>4</sub> <sup>-3</sup><br>(ppm) | ORP<br>(mV)                       | D.O.<br>Before Purge<br>(mg/L) | D.O.<br>After Purge<br>(mg/L) |
|---------|----------|-----------------------|---|--|-----------------------------------|--------------------------------|-------------------------------|
| U-6     | 09/08/99 | 0.140                 | 5.59  | ND <sup>1</sup>  | 305 <sup>3</sup>                  | 3.12                           | --                            |
| (cont)  | 12/07/99 | 0.260                 | ND <sup>1</sup>                                     | ND <sup>1</sup>  | 443 <sup>3</sup>                  | 3.44                           | --                            |
|         | 03/13/00 | 0.79                  | 0.26  | ND   | <sup>2</sup> 68/ <sup>3</sup> 222 | --                             | --                            |
|         | 06/21/00 | 1.9                   | ND <sup>1</sup>                                     | ND <sup>1</sup>  | 159 <sup>2</sup>                  | 3.27                           | --                            |
|         | 09/27/00 | 2.6                   | ND <sup>1</sup>                                     | ND <sup>1</sup>  | 170 <sup>2</sup>                  | 3.49                           | --                            |
|         | 12/12/00 | ND                    | 2.7   | ND <sup>1</sup>  | 128 <sup>2</sup>                  | 3.06                           | --                            |
|         | 03/07/01 | 2.52                  | 3.11  | 37.0   | 117 <sup>2</sup>                  | 2.85                           | --                            |
|         | 06/06/01 | 0.47 <sup>4</sup>     | 0.15  | 0.70   | 97 <sup>2</sup>                   | 2.46                           | --                            |
|         | 09/24/01 | <0.10                 | 0.58 <sup>5</sup>                                   | --   | 123 <sup>2</sup>                  | 3.10                           | --                            |
|         | 12/10/01 | 0.99                  | 0.50  | 2.0  | 112 <sup>2</sup>                  | 2.57                           | --                            |
|         | 03/11/02 | 1.2                   | <0.50   | 0.089  | 128 <sup>2</sup>                  | 3.03                           | --                            |
|         | 06/04/02 | <0.10                 | <0.50   | <1.0   | 97 <sup>2</sup>                   | 2.84                           | --                            |
|         | 09/03/02 | <0.10                 | 0.58  | 1.1  | 110 <sup>2</sup>                  | 3.12                           | --                            |
|         | 12/03/02 | 1.2                   | <1.0  | 2.6  | 95 <sup>2</sup>                   | 2.96                           | --                            |
|         | 03/04/03 | 20                    | <1.0  | <1.0   | -112 <sup>2</sup>                 | 0.30                           | --                            |
|         | 06/18/03 | 3.2                   | <1.0  | 2.0  | -15 <sup>2</sup>                  | --                             | 3.2                           |

**Table 3**  
**Field Measurements and Groundwater Analytical Results**  
Tosco (Unocal) Service Station #5325  
3220 Lakeshore Avenue  
Oakland, California

---

**EXPLANATIONS:**

Groundwater analytical results prior to March 3, 1998, were compiled from reports prepared by MPDS Services, Inc.

ORP = Oxidation Reduction Potential

(mV) = millivolts

D.O. = Dissolved Oxygen

(mg/L) = milligrams per liter

(ppm) = Parts per million

ND = Not Detected

-- = Not Measured/Not Analyzed

<sup>1</sup> Detection limit raised. Refer to analytical reports.

<sup>2</sup> Field measurement.

<sup>3</sup> Analyzed by laboratory.

<sup>4</sup> Due to the transfer of samples from one laboratory to another laboratory; the sample was received beyond the EPA recommended holding time.

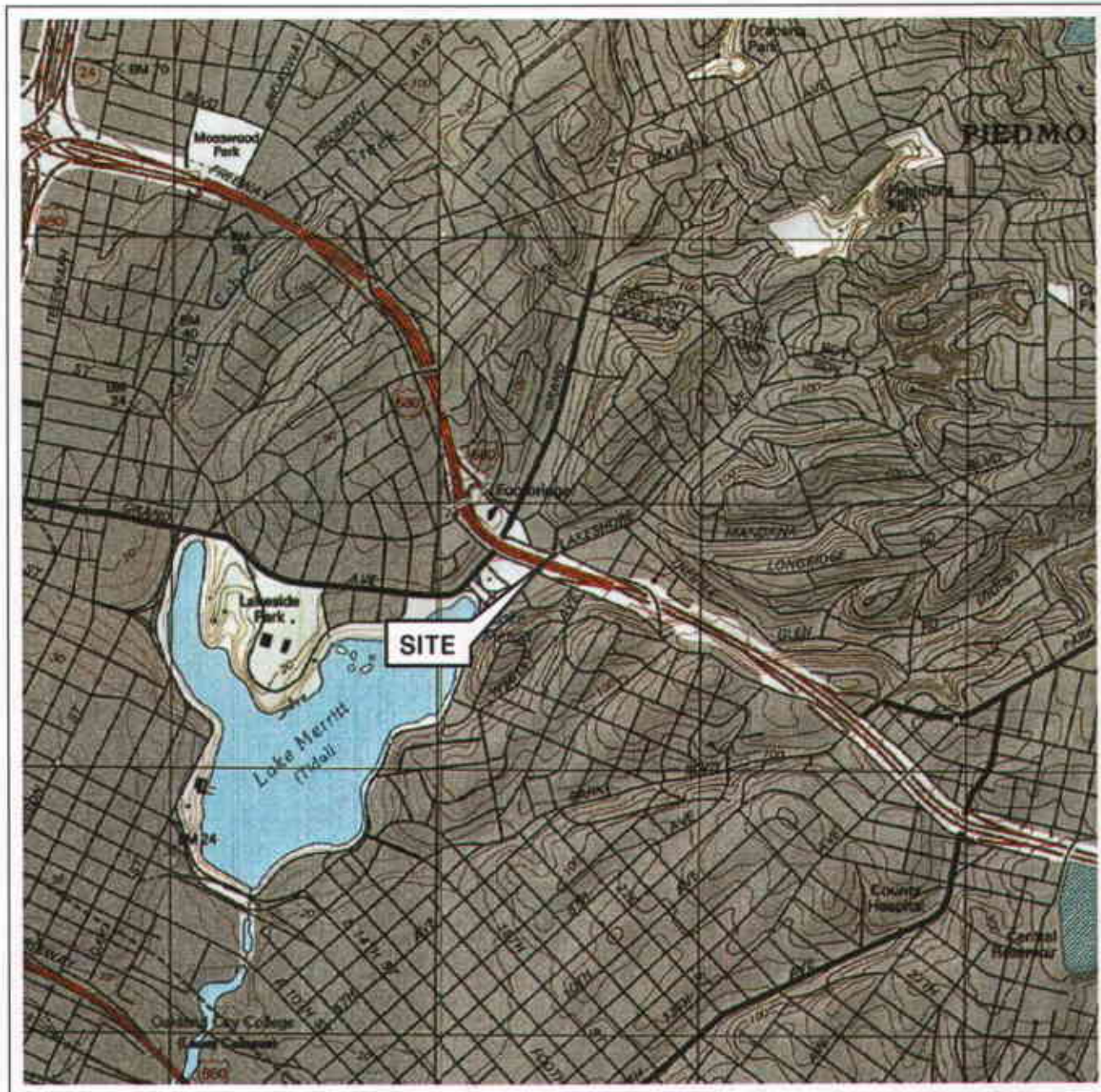
<sup>5</sup> Laboratory report indicates the sample was analyzed beyond the EPA recommended holding time.

**ANALYTICAL METHODS:**

Ferrous Iron by Hach method 8146/1;10 Phenanthroline Method

Nitrate as NO<sub>3</sub> by EPA Method 300.0

Phosphate as PO<sub>4</sub> by EPA Method 300.0



SCALE 1:24,000



**VICINITY MAP**

76 Station 5325  
3220 Lakeshore Avenue  
Oakland, California

**SOURCE:**

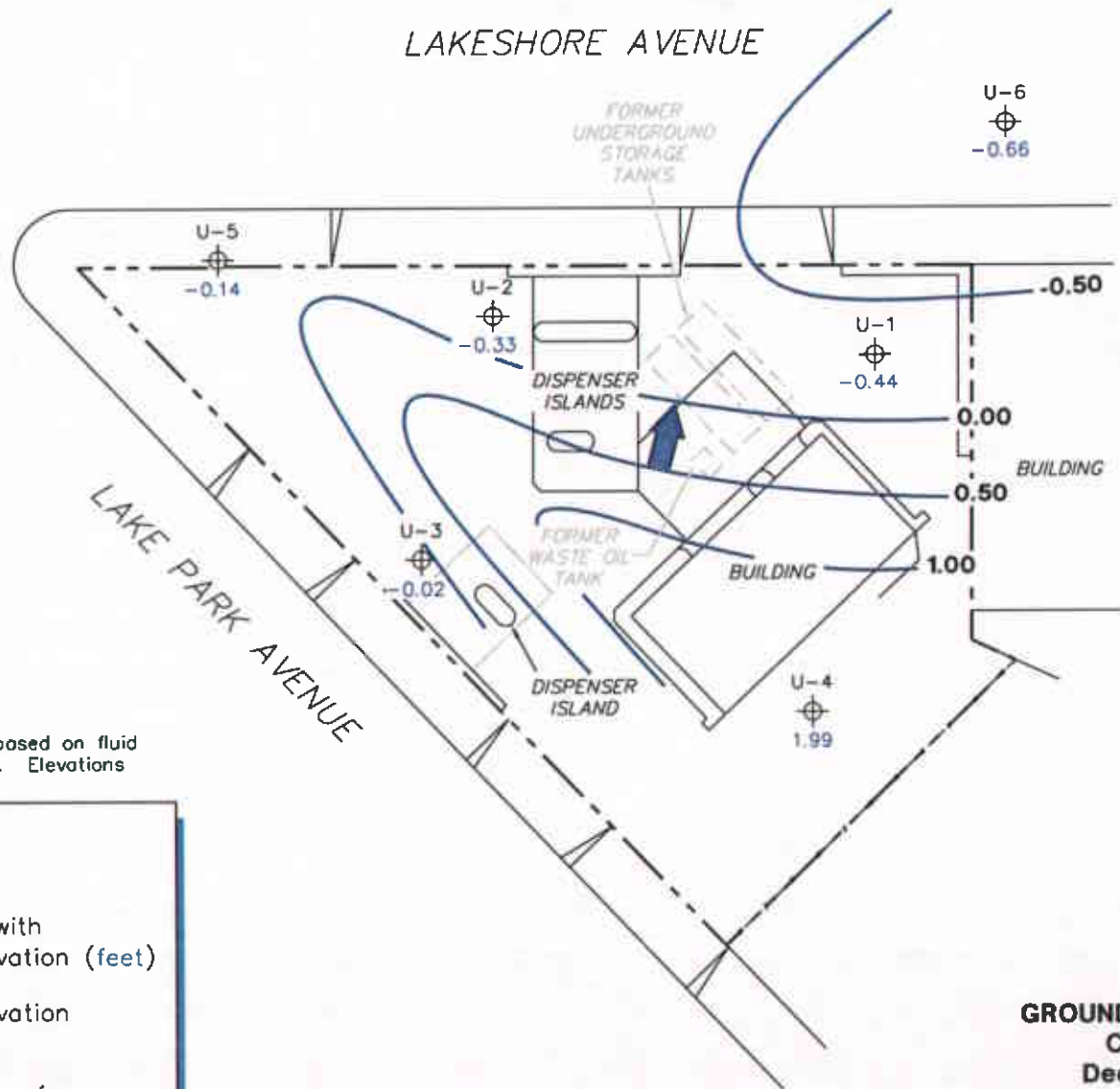
United States Geological Survey  
7.5 Minute Topographic Map:  
Oakland West Quadrangle

**FIGURE 1**

**TRC**

LAKESHORE AVENUE


U-6  
-0.66





**NOTES:**

Contour lines are interpretive and based on fluid levels measured in monitoring wells. Elevations are in feet above mean sea level.

**LEGEND**

U-6  Monitoring Well with Groundwater Elevation (feet)

1.00  Groundwater Elevation Contour

 General Direction of Groundwater Flow

**GROUNDWATER ELEVATION  
CONTOUR MAP  
December 2, 2003**

76 Station 5325  
3220 Lakeshore Avenue  
Oakland, California

SCALE (FEET)



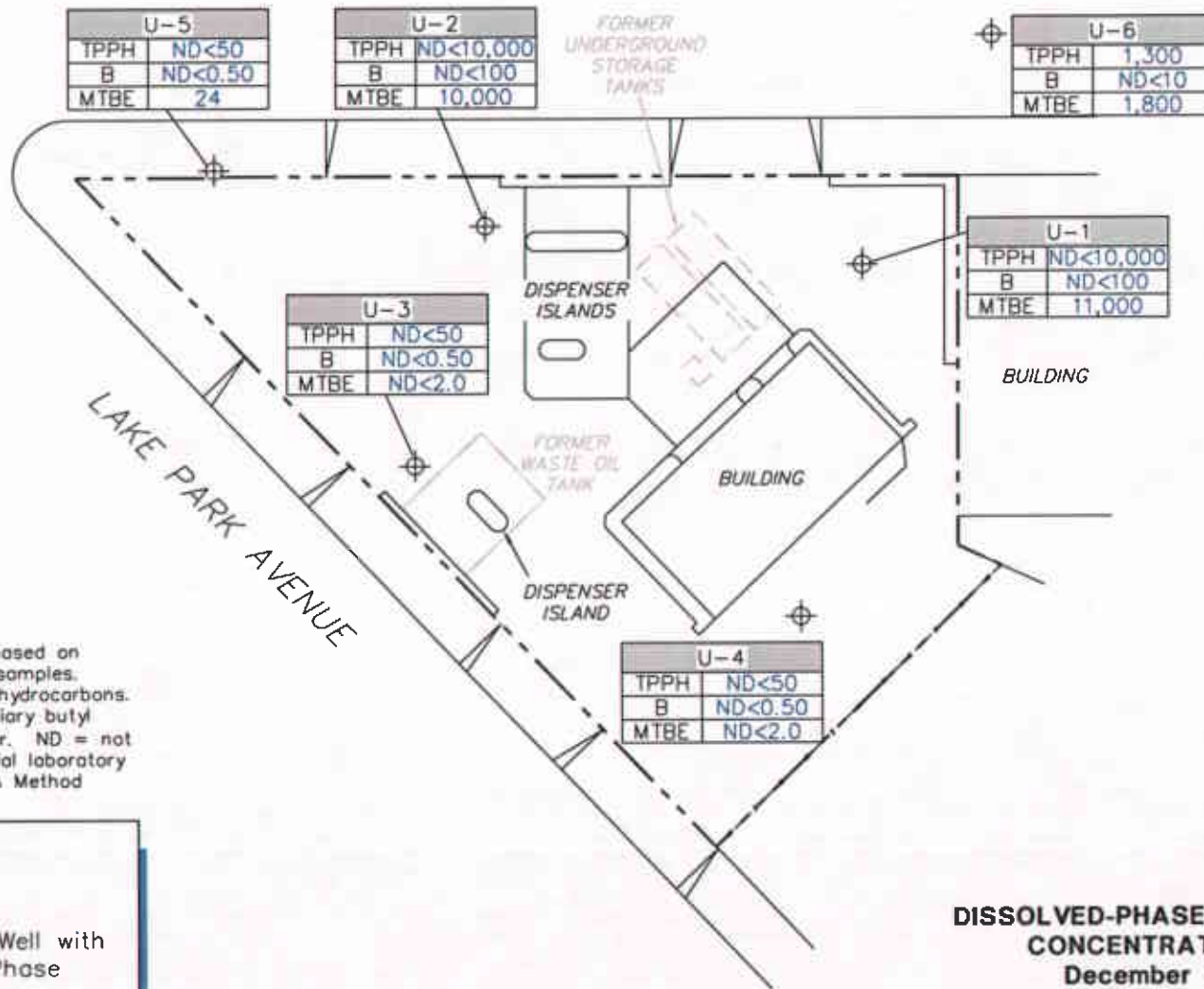
**FIGURE 2**

PS=1:1





LAKESHORE AVENUE



NOTES:

Contour lines are interpretive and based on laboratory analysis of groundwater samples. TPPH = total purgeable petroleum hydrocarbons. B = benzene. MTBE = methyl tertiary butyl ether.  $\mu\text{g}/\text{l}$  = micrograms per liter. ND = not detected at limit indicated on official laboratory report. Results obtained using EPA Method 8260B.

LEGEND

| Well No. |                        |
|----------|------------------------|
| TPPH     | $\mu\text{g}/\text{l}$ |
| B        | $\mu\text{g}/\text{l}$ |
| MTBE     | $\mu\text{g}/\text{l}$ |

Monitoring Well with Dissolved-Phase Hydrocarbon Concentrations ( $\mu\text{g}/\text{l}$ )

DISSOLVED-PHASE HYDROCARBON CONCENTRATIONS MAP  
December 2, 2003

76 Station 5325  
3220 Lakeshore Avenue  
Oakland, California

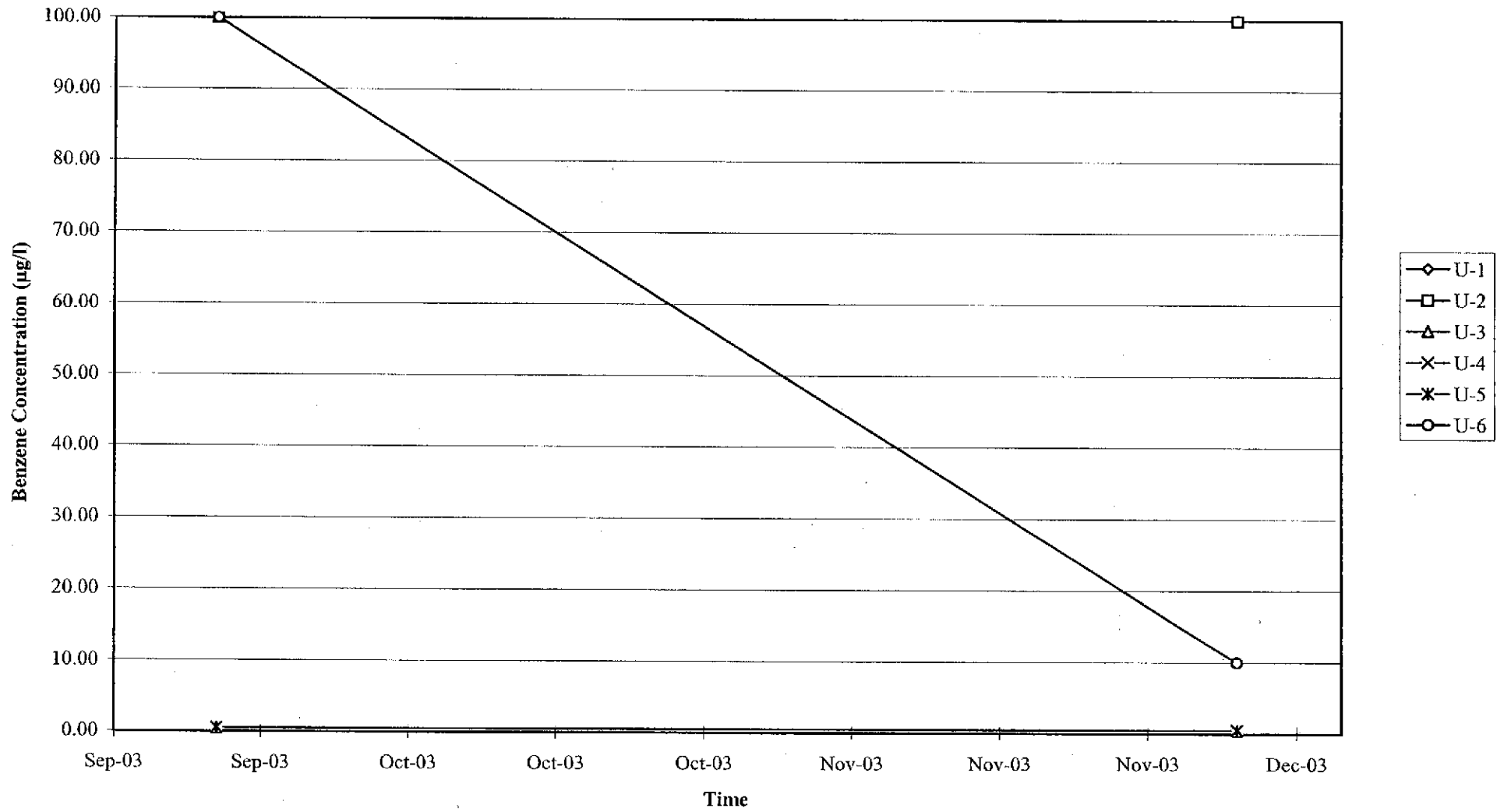
**TRC**

SCALE (FEET)

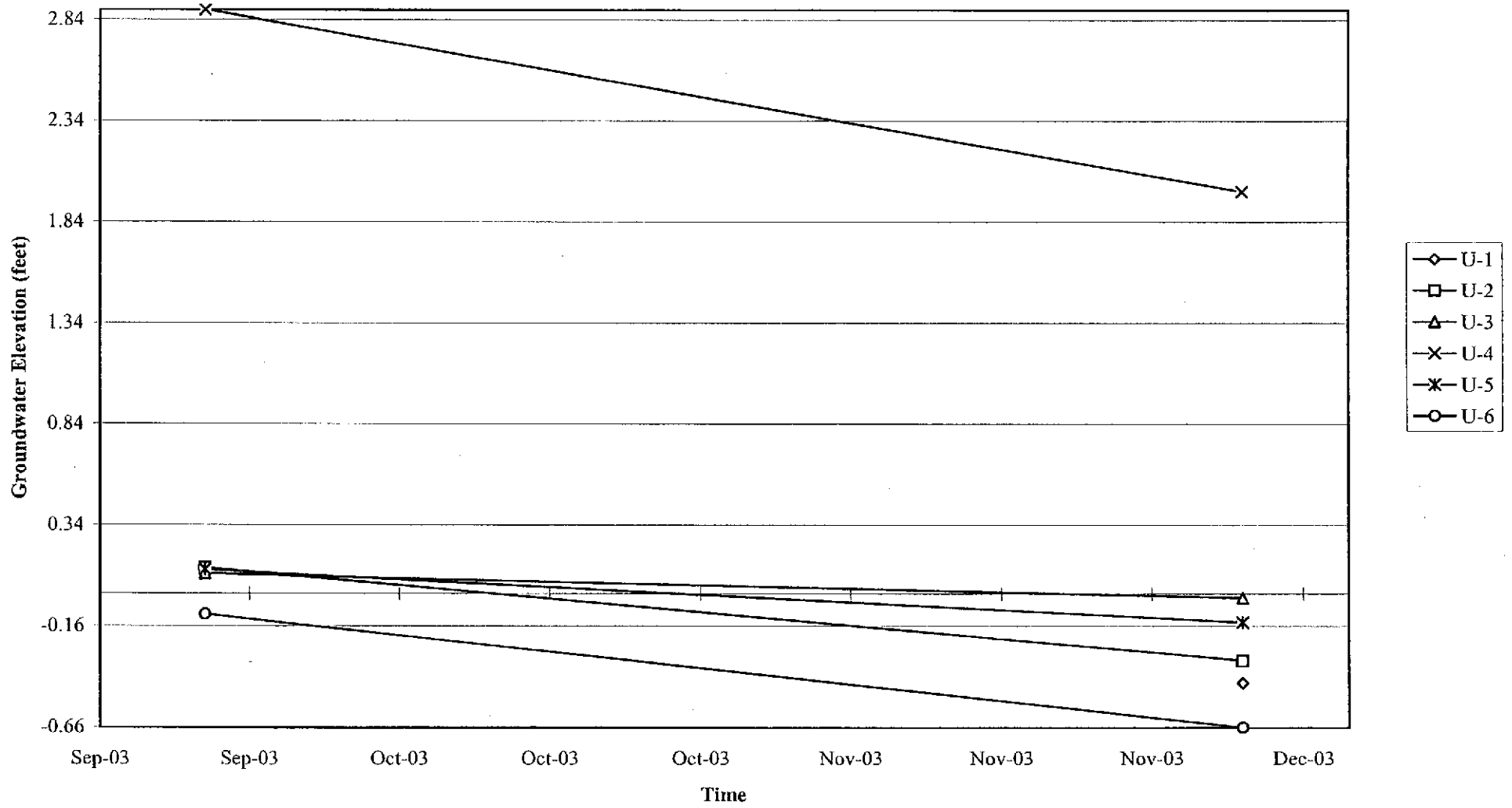


FIGURE 3

Graph 1  
Benzene Concentrations vs. Time  
76 Station 5325



Graph 2  
Hydrograph  
76 Station 5325



## GENERAL FIELD PROCEDURES

### Groundwater Monitoring and Sampling Assignments

For each site, TRC technicians are provided with a Technical Service Request (TSR) that specifies activities required to complete the groundwater monitoring and sampling assignment for the site. TSRs are based on client directives, instructions from the primary environmental consultant for the site, regulatory requirements, and TRC's previous experience with the site.

### Fluid Level Measurements

Initial site activities include determination of well locations based on a site map provided with the TSR. Well boxes are opened and caps are removed. Indications of well or well box damage, or of pressure buildup in the well are noted.

Fluid levels in each well are measured using a coated cloth tape equipped with an electronic interface probe, which distinguishes between liquid phase hydrocarbon (LPH) and water. The depth to LPH (if it is present), to water, and to the bottom of the well are measured from the top of the well casing (surveyors mark or notch if present) to the nearest 0.01 foot. Unless otherwise instructed, a well with less than 0.67 foot between the measured top of water and the measured bottom of the well casing is considered dry, and is not sampled. If the well contains 0.67 foot or more of water, an attempt is made to bail and/or sample as specified on the TSR.

Wells that are found to contain LPH are not purged or sampled. Instead, one casing volume of fluid is bailed from the well and the well is re-sealed. Bailed fluids are placed in a container separate from normal purge water, and properly disposed.

### Purging and Groundwater Parameter Measurement

TSR instructions may specify that a well not be purged (no-purge sampling), be purged using low-flow methods, or be purged using conventional pump and/or bail methods. Conventional purging generally consists of pumping or bailing until a minimum of three casing volumes of water have been removed or until the well has been pumped dry. Pumping is generally accomplished using submersible electric or pneumatic diaphragm pumps.

During conventional purging, three groundwater parameters (temperature, pH, and conductivity) are measured after removal of each casing volume. Stabilization of these parameters, to within 10 percent, confirm that sufficient purging has been completed. In some cases, the TSR indicates that other parameters are also to be measured during purging. TRC commonly measures dissolved oxygen (DO), oxidation-reduction potential (ORP), and/or turbidity. Instruments used for groundwater parameter measurement are calibrated daily according to manufacturer's instructions.

Low-flow purging utilizes a bladder or peristaltic pump to remove water from the well at a low rate. Groundwater parameters specified by the TSR are measured continuously until they become stable in general accordance with EPA guidelines.

Purge water is generally collected in labeled drums for disposal. Drums may be left on site for disposal by others, or transported to a collection location for eventual transfer to a licensed treatment or recycling facility. In some cases, purge water may be collected directly from the site by a licensed vacuum truck company, or may be treated on site by an active remediation system, if so directed.

### **Groundwater Sample Collection**

After wells are purged, or not purged, according to TSR instructions, samples are collected for laboratory analysis. For wells that have been purged using conventional pump or bail methods, sampling is conducted after the well has recovered to 80 percent of its original volume or after two hours if the well does not recover to at least 80 percent. If there is insufficient recharge of water in the well after two hours, the well is not sampled.

Samples are collected by lowering a new, disposable, ½-inch to 4-inch polyethylene bottom-fill bailer to just below the water level in the well. The bailer is retrieved and the water sample is carefully transferred to containers specified for the laboratory analytical methods indicated by the TSR. Particular care is given to containers for volatile organic analysis (VOAs) which require filling to zero headspace and fitting with Teflon-sealed caps.

After filling, all containers are labeled with project number (or site number), well designation, sample date, and the samplers initials, and placed in an insulated chest with ice. Samples remain chilled prior to and during transport to a state-certified laboratory for analysis. Sample container descriptions and requested analyses are entered onto a chain-of-custody form in order to provide instructions to the laboratory. The chain-of-custody form accompanies the samples during transportation to provide a continuous record of possession from the field to the laboratory. If a freight or overnight carrier transports the samples, the carrier is noted on the form.

For wells that have been purged using low-flow methods, sample containers are filled from the effluent stream of the bladder or peristaltic pump. In some cases, if so specified by the TSR, samples are taken from the sample ports of actively pumping remediation wells.

### **Sequence of Gauging, Purging, and Sampling**

The sequence in which monitoring activities are conducted are specified on the TSR. In general, wells are gauged beginning with the least-affected well and ending with the well that has highest concentration based on previous analytic results. After all gauging for the site is completed, wells are purged and/or sampled from the least-affected well to the most-affected well.

### **Decontamination**

In order to reduce the possibility of cross-contamination between wells, strict isolation and decontamination procedures are observed. Portable pumps are not used in wells with LPH. Technicians wear nitrile gloves during all gauging, purging and sampling activities. Gloves are changed between wells and more often if warranted. Any equipment that could come in contact with fluids are either dedicated to a particular well, decontaminated prior to each use, or discarded after a single use. Decontamination consists of washing in a solution of Liqui-nox and water and rinsing twice. The final rinse is in deionized water.

### **Exceptions**

Additional tasks or non-standard procedures, if any, that may be requested or required for a particular site, and noted on the site TSR, are documented in field notes on the following pages.

# FIELD MONITORING DATA SHEET



Technician: MEX

Job #/Task #: 4050001 / FA20

Date: 12-2-03

Site # 5325

Project Manager KATHIE / FOSKUN

Page 1 of 1

| Well # | Grade | TOC | Total Depth | Depth to Water | Depth to Product | Product Thickness (feet) | Time Sampled | Misc. Well Notes |
|--------|-------|-----|-------------|----------------|------------------|--------------------------|--------------|------------------|
| U-1    |       | ✓   | 13.23       | 8.96           | Ø                | Ø                        | 1435         | 3"               |
| U-2    |       | ✓   | 19.80       | 7.95           | Ø                | Ø                        | 1500         | 3"               |
| U-3    |       | ✓   | 19.38       | 11.0           | Ø                | Ø                        | 1320         | 3"               |
| U-4    |       | ✓   | 20.69       | 9.16           | Ø                | Ø                        | 1345         | 4"               |
| U-5    |       | ✓   | 20.04       | 7.12           | Ø                | Ø                        | 1410         | 4"               |
| U-6    |       | ✓   | 22.20       | 7.86           | Ø                | Ø                        | 1300         | 2"               |
|        |       |     |             |                |                  |                          |              |                  |
|        |       |     |             |                |                  |                          |              |                  |
|        |       |     |             |                |                  |                          |              |                  |
|        |       |     |             |                |                  |                          |              |                  |
|        |       |     |             |                |                  |                          |              |                  |
|        |       |     |             |                |                  |                          |              |                  |
|        |       |     |             |                |                  |                          |              |                  |
|        |       |     |             |                |                  |                          |              |                  |
|        |       |     |             |                |                  |                          |              |                  |
|        |       |     |             |                |                  |                          |              |                  |
|        |       |     |             |                |                  |                          |              |                  |
|        |       |     |             |                |                  |                          |              |                  |
|        |       |     |             |                |                  |                          |              |                  |
|        |       |     |             |                |                  |                          |              |                  |
|        |       |     |             |                |                  |                          |              |                  |
|        |       |     |             |                |                  |                          |              |                  |
|        |       |     |             |                |                  |                          |              |                  |
|        |       |     |             |                |                  |                          |              |                  |
|        |       |     |             |                |                  |                          |              |                  |
|        |       |     |             |                |                  |                          |              |                  |
|        |       |     |             |                |                  |                          |              |                  |
|        |       |     |             |                |                  |                          |              |                  |
|        |       |     |             |                |                  |                          |              |                  |
|        |       |     |             |                |                  |                          |              |                  |
|        |       |     |             |                |                  |                          |              |                  |
|        |       |     |             |                |                  |                          |              |                  |
|        |       |     |             |                |                  |                          |              |                  |
|        |       |     |             |                |                  |                          |              |                  |
|        |       |     |             |                |                  |                          |              |                  |
|        |       |     |             |                |                  |                          |              |                  |
|        |       |     |             |                |                  |                          |              |                  |
|        |       |     |             |                |                  |                          |              |                  |
|        |       |     |             |                |                  |                          |              |                  |
|        |       |     |             |                |                  |                          |              |                  |
|        |       |     |             |                |                  |                          |              |                  |
|        |       |     |             |                |                  |                          |              |                  |
|        |       |     |             |                |                  |                          |              |                  |
|        |       |     |             |                |                  |                          |              |                  |
|        |       |     |             |                |                  |                          |              |                  |
|        |       |     |             |                |                  |                          |              |                  |

|                     |          |                |                           |
|---------------------|----------|----------------|---------------------------|
| FIELD DATA COMPLETE | QA/QC    | COC            | WELL BOX CONDITION SHEETS |
| WTT CERTIFICATE     | MANIFEST | DRUM INVENTORY | TRAFFIC CONTROL           |

# GROUNDWATER SAMPLING FIELD NOTES

Technician: AMEX

Site: 5325

Project No.: 4105001

Date: 12-2-83

Well No.: U-4

Purge Method: DIA

Depth to Water (feet): 9.14

Depth to Product (feet): 0

Total Depth (feet): 20.09

LPH & Water Recovered (gallons): 0

Water Column (feet): 10.93

Casing Diameter (Inches): 4"

80% Recharge Depth (feet): 11.54

1 Well Volume (gallons): 7

| Time Start                                | Time Stop | Depth To Water (feet) | Volume Purged (gallons) | Conductivity (uS/cm) | Temperature (F. C) | pH   | Turbidity | D.O. |
|---|-----------|-----------------------|-------------------------|----------------------|--------------------|------|-----------|------|
| 1101                                      |           |                       | 7                       | 802                  | 21.1               | 7.24 |           | 3.57 |
|   |           |                       | 14                      | 790                  | 21.4               | 7.36 |           | 3.54 |
|   | 1110      |                       | 21                      | 801                  | 21.5               | 7.36 |           | 3.45 |
| Static at Time Sampled                    |           | Total Gallons Purged  |                         |                      | Time Sampled       |      |           |      |
| 1310                                      |           | 21                    |                         |                      | 1345               |      |           |      |
| Comments: <u>WELL NOT RECOVER IN 2HRS</u> |           |                       |                         |                      |                    |      |           |      |

ORP  
107  
105  
102

Well No.: U-5

Purge Method: DIA

Depth to Water (feet): 7.12

Depth to Product (feet): 0

Total Depth (feet): 20.04

LPH & Water Recovered (gallons): 0

Water Column (feet): 12.92

Casing Diameter (Inches): 4"

80% Recharge Depth (feet): 9.70

1 Well Volume (gallons): 8

| Time Start             | Time Stop | Depth To Water (feet) | Volume Purged (gallons) | Conductivity (uS/cm) | Temperature (F. C) | pH   | Turbidity | D.O. |
|------------------------|-----------|-----------------------|-------------------------|----------------------|--------------------|------|-----------|------|
| 1120                   |           |                       | 8                       | 4.94 ms              | 20.8               | 6.59 |           | 2.15 |
|                        |           |                       | 16                      | 502 ms               | 20.2               | 6.63 |           | 2.06 |
|                        | 1132      |                       | 24                      | 4.98 ms              | 20.1               | 6.65 |           | 2.22 |
| Static at Time Sampled |           | Total Gallons Purged  |                         |                      | Time Sampled       |      |           |      |
| 8:30                   |           | 24                    |                         |                      | 1410               |      |           |      |
| Comments:              |           |                       |                         |                      |                    |      |           |      |

ORP  
-39  
-45  
-39

# GROUNDWATER SAMPLING FIELD NOTES

Technician: ALEX

Site: 5325

Project No.: 4050001

Date: 12-2

Well No.: U-3

Purge Method: DIA

Depth to Water (feet): 11.0

Depth to Product (feet): 6

Total Depth (feet): 19.38

LPH & Water Recovered (gallons): 6

Water Column (feet): 8.38

Casing Diameter (Inches): 3"

80% Recharge Depth (feet): 12.67

1 Well Volume (gallons): 3

| Time Start             | Time Stop | Depth To Water (feet) | Volume Purged (gallons) | Conductivity (uS/cm) | Temperature (F. C) | pH           | Turbidity | D.O. |
|------------------------|-----------|-----------------------|-------------------------|----------------------|--------------------|--------------|-----------|------|
| 1036                   |           |                       | 3                       | 1102                 | 17.0               | 7.80         |           | 4.30 |
|                        |           |                       | 6                       | 769                  | 18.0               | 7.32         |           | 4.75 |
|                        | 1046      |                       | 9                       | 801                  | 18.7               | 7.30         |           | 4.28 |
| Static at Time Sampled |           |                       | Total Gallons Purged    |                      |                    | Time Sampled |           |      |
| 1110                   |           |                       | 9                       |                      |                    | 1320         |           |      |
| Comments:              |           |                       |                         |                      |                    |              |           |      |

ORP  
97  
96  
105

Well No.: U-6

Purge Method: DIA

Depth to Water (feet): 7.80

Depth to Product (feet): 0

Total Depth (feet): 22.20

LPH & Water Recovered (gallons): 6

Water Column (feet): 4.40

Casing Diameter (Inches): 2"

80% Recharge Depth (feet): 10.68

1 Well Volume (gallons): 2

| Time Start             | Time Stop | Depth To Water (feet) | Volume Purged (gallons) | Conductivity (uS/cm) | Temperature (F. C) | pH           | Turbidity | D.O. |
|------------------------|-----------|-----------------------|-------------------------|----------------------|--------------------|--------------|-----------|------|
| 1008                   |           |                       | 2                       | 2.53 ms              | 16.9               | 7.24         |           | 2.53 |
|                        |           |                       | 4                       | 2.64 ms              | 17.0               | 7.39         |           | 2.40 |
|                        | 1016      |                       | 6                       | 2.64 ms              | 17.6               | 7.47         |           | 3.10 |
| Static at Time Sampled |           |                       | Total Gallons Purged    |                      |                    | Time Sampled |           |      |
| 0900                   |           |                       | 6                       |                      |                    | 1300         |           |      |
| Comments:              |           |                       |                         |                      |                    |              |           |      |

ORP  
-99  
-80  
-74



# GROUNDWATER SAMPLING FIELD NOTES

Technician: Alex

Site: 5325

Project No.: 4105001

Date: 12-2

Well No.: D-1  
 Depth to Water (feet): 8.90  
 Total Depth (feet): 13.23  
 Water Column (feet): 4.33  
 80% Recharge Depth (feet): 9.76

Purge Method: DIA  
 Depth to Product (feet): 0  
 LPH & Water Recovered (gallons): 0  
 Casing Diameter (Inches): 3"  
 1 Well Volume (gallons): 2

| Time Start             | Time Stop | Depth To Water (feet) | Volume Purged (gallons) | Conductivity (uS/cm) | Temperature (F. C) | pH   | Turbidity | D.O. | ORP |
|------------------------|-----------|-----------------------|-------------------------|----------------------|--------------------|------|-----------|------|-----|
| 1148                   |           |                       | 2                       | 1839                 | 19.4               | 6.90 |           | 2.05 | -42 |
|                        |           |                       | 4                       | 1754                 | 20.1               | 7.10 |           | 4.80 | -70 |
|                        | 1157      |                       | 6                       | 1850                 | 20.0               | 7.40 |           | 6.46 | -73 |
| Static at Time Sampled |           | Total Gallons Purged  |                         |                      | Time Sampled       |      |           |      |     |
| 905                    |           | 6                     |                         |                      | 1135               |      |           |      |     |
| Comments:              |           |                       |                         |                      |                    |      |           |      |     |

Well No.: D-2  
 Depth to Water (feet): 7.15  
 Total Depth (feet): 19.80  
 Water Column (feet): 11.85  
 80% Recharge Depth (feet): 10.32

Purge Method: DIA  
 Depth to Product (feet): 0  
 LPH & Water Recovered (gallons): 0  
 Casing Diameter (Inches): 3"  
 1 Well Volume (gallons): 4

| Time Start             | Time Stop | Depth To Water (feet) | Volume Purged (gallons) | Conductivity (uS/cm) | Temperature (F. C) | pH   | Turbidity | D.O. | ORP |
|------------------------|-----------|-----------------------|-------------------------|----------------------|--------------------|------|-----------|------|-----|
| 1207                   |           |                       | 4                       | 3.66 ms              | 20.0               | 6.94 |           | 1.70 | -29 |
|                        |           |                       | 8                       | 3.10 ms              | 20.3               | 6.79 |           | 1.64 | -65 |
|                        | 1217      |                       | 12                      | 3.25 m               | 20.1               | 6.88 |           | 1.81 | -67 |
| Static at Time Sampled |           | Total Gallons Purged  |                         |                      | Time Sampled       |      |           |      |     |
| 1351                   |           | 12                    |                         |                      | 1500               |      |           |      |     |
| Comments:              |           |                       |                         |                      |                    |      |           |      |     |

TRC Alton Geoscience

December 18, 2003

21 Technology Drive  
Irvine, CA 92718

Attn.: Anju Farfan

Project#: 41050001FA20

Project: Conoco Phillips #5325

Site: 3220 Lakeshore Ave., Oakland

Attached is our report for your samples received on 12/03/2003 17:05

This report has been reviewed and approved for release. Reproduction of this report is permitted only in its entirety.

Please note that any unused portion of the samples will be discarded after 01/17/2004 unless you have requested otherwise.

We appreciate the opportunity to be of service to you. If you have any questions,

You can also contact me via email. My email address is: [dsharma@stl-inc.com](mailto:dsharma@stl-inc.com)

Sincerely,



Dimple Sharma  
Project Manager

Severn Trent Laboratories, Inc.

STL San Francisco \* 1220 Quarry Lane, Pleasanton, CA 94566

Tel 925 484 1919 Fax 925 484 1096 \* [www.stl-inc.com](http://www.stl-inc.com) \* CA DHS ELAP# 2496

**Gas/BTEX Fuel Oxygenates by 8260B**

TRC Alton Geoscience

Attn.: Anju Farfan

21 Technology Drive

Irvine, CA 92718

Phone: (949) 341-7440 Fax: (949) 753-0111

Project: 41050001FA20

Conoco Phillips #5325

Received: 12/03/2003 17:05

Site: 3220 Lakeshore Ave., Oakland

**Samples Reported**

| Sample Name | Date Sampled     | Matrix | Lab # |
|-------------|------------------|--------|-------|
| U-1         | 12/02/2003 14:35 | Water  | 1     |
| U-2         | 12/02/2003 15:00 | Water  | 2     |
| U-3         | 12/02/2003 13:20 | Water  | 3     |
| U-4         | 12/02/2003 13:45 | Water  | 4     |
| U-5         | 12/02/2003 14:10 | Water  | 5     |
| U-6         | 12/02/2003 13:00 | Water  | 6     |

Severn Trent Laboratories, Inc.

STL San Francisco \* 1220 Quarry Lane, Pleasanton, CA 94566

Tel 925 484 1919 Fax 925 484 1096 \* www.stl-inc.com \* CA DHS ELAP# 2496

12/15/2003 12:17

**Gas/BTEX Fuel Oxygenates by 8260B**

TRC Alton Geoscience

Attn.: Anju Farfan

21 Technology Drive

Irvine, CA 92718

Phone: (949) 341-7440 Fax: (949) 753-0111

Project: 41050001FA20

Conoco Phillips #5325

Received: 12/03/2003 17:05

Site: 3220 Lakeshore Ave., Oakland

Prep(s): 5030B Test(s): 8260FAB  
Sample ID: U-1 Lab ID: 2003-12-0106 - 1  
Sampled: 12/02/2003 14:35 Extracted: 12/9/2003 10:41  
Matrix: Water QC Batch#: 2003/12/09-01.62  
Analysis Flag: o ( See Legend and Note Section )

| Compound                       | Conc. | RL     | Unit | Dilution | Analyzed         | Flag |
|--------------------------------|-------|--------|------|----------|------------------|------|
| Gasoline                       | ND    | 10000  | ug/L | 200.00   | 12/09/2003 10:41 |      |
| Benzene                        | ND    | 100    | ug/L | 200.00   | 12/09/2003 10:41 |      |
| Toluene                        | ND    | 100    | ug/L | 200.00   | 12/09/2003 10:41 |      |
| Ethylbenzene                   | ND    | 100    | ug/L | 200.00   | 12/09/2003 10:41 |      |
| Total xylenes                  | ND    | 200    | ug/L | 200.00   | 12/09/2003 10:41 |      |
| Methyl tert-butyl ether (MTBE) | 11000 | 400    | ug/L | 200.00   | 12/09/2003 10:41 |      |
| Ethanol                        | ND    | 100000 | ug/L | 200.00   | 12/09/2003 10:41 |      |
| <b>Surrogate(s)</b>            |       |        |      |          |                  |      |
| 1,2-Dichloroethane-d4          | 94.4  | 76-114 | %    | 200.00   | 12/09/2003 10:41 |      |
| Toluene-d8                     | 95.0  | 88-110 | %    | 200.00   | 12/09/2003 10:41 |      |

Severn Trent Laboratories, Inc.

STL San Francisco \* 1220 Quarry Lane, Pleasanton, CA 94566

Tel 925 484 1919 Fax 925 484 1096 \* www.stl-inc.com \* CA DHS ELAP# 2496

12/15/2003 12:17

**Gas/BTEX Fuel Oxygenates by 8260B**

TRC Alton Geoscience

Attn.: Anju Farfan

21 Technology Drive

Irvine, CA 92718

Phone: (949) 341-7440 Fax: (949) 753-0111

Project: 41050001FA20

Conoco Phillips #5325

Received: 12/03/2003 17:05

Site: 3220 Lakeshore Ave., Oakland

Prep(s): 5030B Test(s): 8260FAB  
 Sample ID: U-2 Lab ID: 2003-12-0106 - 2  
 Sampled: 12/02/2003 15:00 Extracted: 12/10/2003 12:00  
 Matrix: Water QC Batch#: 2003/12/10-01.62  
 Analysis Flag: o ( See Legend and Note Section )

| Compound                       | Conc. | RL     | Unit | Dilution | Analyzed         | Flag |
|--------------------------------|-------|--------|------|----------|------------------|------|
| Gasoline                       | ND    | 10000  | ug/L | 200.00   | 12/10/2003 12:00 |      |
| Benzene                        | ND    | 100    | ug/L | 200.00   | 12/10/2003 12:00 |      |
| Toluene                        | ND    | 100    | ug/L | 200.00   | 12/10/2003 12:00 |      |
| Ethylbenzene                   | ND    | 100    | ug/L | 200.00   | 12/10/2003 12:00 |      |
| Total xylenes                  | ND    | 200    | ug/L | 200.00   | 12/10/2003 12:00 |      |
| Methyl tert-butyl ether (MTBE) | 10000 | 400    | ug/L | 200.00   | 12/10/2003 12:00 |      |
| Ethanol                        | ND    | 100000 | ug/L | 200.00   | 12/10/2003 12:00 |      |
| <b>Surrogate(s)</b>            |       |        |      |          |                  |      |
| 1,2-Dichloroethane-d4          | 100.5 | 76-114 | %    | 200.00   | 12/10/2003 12:00 |      |
| Toluene-d8                     | 103.4 | 88-110 | %    | 200.00   | 12/10/2003 12:00 |      |

Severn Trent Laboratories, Inc.

STL San Francisco \* 1220 Quarry Lane, Pleasanton, CA 94566

Tel 925 484 1919 Fax 925 484 1096 \* www.stl-inc.com \* CA DHS ELAP# 2496

12/15/2003 12:17

**Gas/BTEX Fuel Oxygenates by 8260B**

TRC Alton Geoscience

Attn.: Anju Farfan

21 Technology Drive

Irvine, CA 92718

Phone: (949) 341-7440 Fax: (949) 753-0111

Project: 41050001FA20

Conoco Phillips #5325

Received: 12/03/2003 17:05

Site: 3220 Lakeshore Ave., Oakland

|            |                  |            |                  |
|------------|------------------|------------|------------------|
| Prep(s):   | 5030B            | Test(s):   | 8260FAB          |
| Sample ID: | U-3              | Lab ID:    | 2003-12-0106 - 3 |
| Sampled:   | 12/02/2003 13:20 | Extracted: | 12/10/2003 12:22 |
| Matrix:    | Water            | QC Batch#: | 2003/12/10-01.62 |

| Compound                       | Conc. | RL     | Unit | Dilution | Analyzed         | Flag |
|--------------------------------|-------|--------|------|----------|------------------|------|
| Gasoline                       | ND    | 50     | ug/L | 1.00     | 12/10/2003 12:22 |      |
| Benzene                        | ND    | 0.50   | ug/L | 1.00     | 12/10/2003 12:22 |      |
| Toluene                        | ND    | 0.50   | ug/L | 1.00     | 12/10/2003 12:22 |      |
| Ethylbenzene                   | ND    | 0.50   | ug/L | 1.00     | 12/10/2003 12:22 |      |
| Total xylenes                  | ND    | 1.0    | ug/L | 1.00     | 12/10/2003 12:22 |      |
| Methyl tert-butyl ether (MTBE) | ND    | 2.0    | ug/L | 1.00     | 12/10/2003 12:22 |      |
| Ethanol                        | ND    | 500    | ug/L | 1.00     | 12/10/2003 12:22 |      |
| <b>Surrogate(s)</b>            |       |        |      |          |                  |      |
| 1,2-Dichloroethane-d4          | 90.4  | 76-114 | %    | 1.00     | 12/10/2003 12:22 |      |
| Toluene-d8                     | 95.8  | 88-110 | %    | 1.00     | 12/10/2003 12:22 |      |

**Gas/BTEX Fuel Oxygenates by 8260B**

TRC Alton Geoscience

Attn.: Anju Farfan

21 Technology Drive

Irvine, CA 92718

Phone: (949) 341-7440 Fax: (949) 753-0111

Project: 41050001FA20

Conoco Phillips #5325

Received: 12/03/2003 17:05

Site: 3220 Lakeshore Ave., Oakland

|                           |                             |
|---------------------------|-----------------------------|
| Prep(s): 5030B            | Test(s): 8260FAB            |
| Sample ID: U-4            | Lab ID: 2003-12-0106 - 4    |
| Sampled: 12/02/2003 13:45 | Extracted: 12/9/2003 11:47  |
| Matrix: Water             | QC Batch#: 2003/12/09-01.62 |

| Compound                       | Conc. | RL     | Unit | Dilution | Analyzed         | Flag |
|--------------------------------|-------|--------|------|----------|------------------|------|
| Gasoline                       | ND    | 50     | ug/L | 1.00     | 12/09/2003 11:47 |      |
| Benzene                        | ND    | 0.50   | ug/L | 1.00     | 12/09/2003 11:47 |      |
| Toluene                        | ND    | 0.50   | ug/L | 1.00     | 12/09/2003 11:47 |      |
| Ethylbenzene                   | ND    | 0.50   | ug/L | 1.00     | 12/09/2003 11:47 |      |
| Total xylenes                  | ND    | 1.0    | ug/L | 1.00     | 12/09/2003 11:47 |      |
| Methyl tert-butyl ether (MTBE) | ND    | 2.0    | ug/L | 1.00     | 12/09/2003 11:47 |      |
| Ethanol                        | ND    | 500    | ug/L | 1.00     | 12/09/2003 11:47 |      |
| <b>Surrogate(s)</b>            |       |        |      |          |                  |      |
| 1,2-Dichloroethane-d4          | 95.7  | 76-114 | %    | 1.00     | 12/09/2003 11:47 |      |
| Toluene-d8                     | 99.0  | 88-110 | %    | 1.00     | 12/09/2003 11:47 |      |

Severn Trent Laboratories, Inc.

STL San Francisco \* 1220 Quarry Lane, Pleasanton, CA 94566

Tel 925 484 1919 Fax 925 484 1096 \* www.stl-inc.com \* CA DHS ELAP# 2496

12/15/2003 12:17

**Gas/BTEX Fuel Oxygenates by 8260B**

TRC Alton Geoscience

Attn.: Anju Farfan

21 Technology Drive

Irvine, CA 92718

Phone: (949) 341-7440 Fax: (949) 753-0111

Project: 41050001FA20

Conoco Phillips #5325

Received: 12/03/2003 17:05

Site: 3220 Lakeshore Ave., Oakland

|            |                  |            |                  |
|------------|------------------|------------|------------------|
| Prep(s):   | 5030B            | Test(s):   | 8260FAB          |
| Sample ID: | U-5              | Lab ID:    | 2003-12-0106 - 5 |
| Sampled:   | 12/02/2003 14:10 | Extracted: | 12/9/2003 12:09  |
| Matrix:    | Water            | QC Batch#: | 2003/12/09-01.62 |

| Compound                       | Conc. | RL     | Unit | Dilution | Analyzed         | Flag |
|--------------------------------|-------|--------|------|----------|------------------|------|
| Gasoline                       | ND    | 50     | ug/L | 1.00     | 12/09/2003 12:09 |      |
| Benzene                        | ND    | 0.50   | ug/L | 1.00     | 12/09/2003 12:09 |      |
| Toluene                        | ND    | 0.50   | ug/L | 1.00     | 12/09/2003 12:09 |      |
| Ethylbenzene                   | ND    | 0.50   | ug/L | 1.00     | 12/09/2003 12:09 |      |
| Total xylenes                  | ND    | 1.0    | ug/L | 1.00     | 12/09/2003 12:09 |      |
| Methyl tert-butyl ether (MTBE) | 24    | 2.0    | ug/L | 1.00     | 12/09/2003 12:09 |      |
| Ethanol                        | ND    | 500    | ug/L | 1.00     | 12/09/2003 12:09 |      |
| <b>Surrogate(s)</b>            |       |        |      |          |                  |      |
| 1,2-Dichloroethane-d4          | 91.8  | 76-114 | %    | 1.00     | 12/09/2003 12:09 |      |
| Toluene-d8                     | 105.9 | 88-110 | %    | 1.00     | 12/09/2003 12:09 |      |

Severn Trent Laboratories, Inc.

STL San Francisco \* 1220 Quarry Lane, Pleasanton, CA 94566

Tel 925 484 1919 Fax 925 484 1096 \* www.stl-inc.com \* CA DHS ELAP# 2496

12/15/2003 12:17



**Gas/BTEX Fuel Oxygenates by 8260B**

TRC Alton Geoscience

Attn.: Anju Farfan

21 Technology Drive

Irvine, CA 92718

Phone: (949) 341-7440 Fax: (949) 753-0111

Project: 41050001FA20

Conoco Phillips #5325

Received: 12/03/2003 17:05

Site: 3220 Lakeshore Ave., Oakland

|            |                  |            |                  |
|------------|------------------|------------|------------------|
| Prep(s):   | 5030B            | Test(s):   | 8260FAB          |
| Sample ID: | U-6              | Lab ID:    | 2003-12-0106 - 6 |
| Sampled:   | 12/02/2003 13:00 | Extracted: | 12/11/2003 13:35 |
| Matrix:    | Water            | QC Batch#: | 2003/12/11-1B.64 |

| Compound                       | Conc. | RL     | Unit | Dilution | Analyzed         | Flag |
|--------------------------------|-------|--------|------|----------|------------------|------|
| Gasoline                       | 1300  | 1000   | ug/L | 20.00    | 12/11/2003 13:35 | g    |
| Benzene                        | ND    | 10     | ug/L | 20.00    | 12/11/2003 13:35 |      |
| Toluene                        | ND    | 10     | ug/L | 20.00    | 12/11/2003 13:35 |      |
| Ethylbenzene                   | ND    | 10     | ug/L | 20.00    | 12/11/2003 13:35 |      |
| Total xylenes                  | ND    | 20     | ug/L | 20.00    | 12/11/2003 13:35 |      |
| Methyl tert-butyl ether (MTBE) | 1800  | 40     | ug/L | 20.00    | 12/11/2003 13:35 |      |
| Ethanol                        | ND    | 10000  | ug/L | 20.00    | 12/11/2003 13:35 |      |
| <b>Surrogate(s)</b>            |       |        |      |          |                  |      |
| 1,2-Dichloroethane-d4          | 104.4 | 76-114 | %    | 20.00    | 12/11/2003 13:35 |      |
| Toluene-d8                     | 96.0  | 88-110 | %    | 20.00    | 12/11/2003 13:35 |      |

**Gas/BTEX Fuel Oxygenates by 8260B**

TRC Alton Geoscience

Attn.: Anju Farfan

21 Technology Drive

Irvine, CA 92718

Phone: (949) 341-7440 Fax: (949) 753-0111

Project: 41050001FA20

Conoco Phillips #5325

Received: 12/03/2003 17:05

Site: 3220 Lakeshore Ave., Oakland

**Batch QC Report**

Prep(s): 5030B

Method Blank

MB: 2003/12/09-01.62-019

Water

Test(s): 8260FAB

QC Batch # 2003/12/09-01.62

Date Extracted: 12/09/2003 10:19

| Compound                       | Conc. | RL     | Unit | Analyzed         | Flag |
|--------------------------------|-------|--------|------|------------------|------|
| Gasoline                       | ND    | 50     | ug/L | 12/09/2003 10:19 |      |
| Benzene                        | ND    | 0.5    | ug/L | 12/09/2003 10:19 |      |
| Toluene                        | ND    | 0.5    | ug/L | 12/09/2003 10:19 |      |
| Ethylbenzene                   | ND    | 0.5    | ug/L | 12/09/2003 10:19 |      |
| Total xylenes                  | ND    | 1.0    | ug/L | 12/09/2003 10:19 |      |
| Methyl tert-butyl ether (MTBE) | ND    | 2.0    | ug/L | 12/09/2003 10:19 |      |
| Ethanol                        | ND    | 500    | ug/L | 12/09/2003 10:19 |      |
| <b>Surrogates(s)</b>           |       |        |      |                  |      |
| 1,2-Dichloroethane-d4          | 93.3  | 76-114 | %    | 12/09/2003 10:19 |      |
| Toluene-d8                     | 100.6 | 88-110 | %    | 12/09/2003 10:19 |      |

**Gas/BTEX Fuel Oxygenates by 8260B**

TRC Alton Geoscience

Attn.: Anju Farfan

21 Technology Drive

Irvine, CA 92718

Phone: (949) 341-7440 Fax: (949) 753-0111

Project: 41050001FA20

Conoco Phillips #5325

Received: 12/03/2003 17:05

Site: 3220 Lakeshore Ave., Oakland

**Batch QC Report**

Prep(s): 5030B

Method Blank

MB: 2003/12/10-01.62-047

Water

Test(s): 8260FAB

QC Batch # 2003/12/10-01.62

Date Extracted: 12/10/2003 09:47

| Compound                       | Conc. | RL     | Unit | Analyzed         | Flag |
|--------------------------------|-------|--------|------|------------------|------|
| Gasoline                       | ND    | 50     | ug/L | 12/10/2003 09:47 |      |
| Benzene                        | ND    | 0.5    | ug/L | 12/10/2003 09:47 |      |
| Toluene                        | ND    | 0.5    | ug/L | 12/10/2003 09:47 |      |
| Ethylbenzene                   | ND    | 0.5    | ug/L | 12/10/2003 09:47 |      |
| Total xylenes                  | ND    | 1.0    | ug/L | 12/10/2003 09:47 |      |
| Methyl tert-butyl ether (MTBE) | ND    | 2.0    | ug/L | 12/10/2003 09:47 |      |
| Ethanol                        | ND    | 500    | ug/L | 12/10/2003 09:47 |      |
| <b>Surrogates(s)</b>           |       |        |      |                  |      |
| 1,2-Dichloroethane-d4          | 88.5  | 76-114 | %    | 12/10/2003 09:47 |      |
| Toluene-d8                     | 89.2  | 88-110 | %    | 12/10/2003 09:47 |      |

Severn Trent Laboratories, Inc.

STL San Francisco \* 1220 Quarry Lane, Pleasanton, CA 94566

Tel 925 484 1919 Fax 925 484 1096 \* www.stl-inc.com \* CA DHS ELAP# 2496

12/15/2003 12:17

**Gas/BTEX Fuel Oxygenates by 8260B**

TRC Alton Geoscience

Attn.: Anju Farfan

21 Technology Drive

Irvine, CA 92718

Phone: (949) 341-7440 Fax: (949) 753-0111

Project: 41050001FA20

Conoco Phillips #5325

Received: 12/03/2003 17:05

Site: 3220 Lakeshore Ave., Oakland

**Batch QC Report**

Prep(s): 5030B

Method Blank

MB: 2003/12/11-1B.64-031

Water

Test(s): 8260FAB

QC Batch # 2003/12/11-1B.64

Date Extracted: 12/11/2003 10:31

| Compound                       | Conc. | RL     | Unit | Analyzed         | Flag |
|--------------------------------|-------|--------|------|------------------|------|
| Gasoline                       | ND    | 50     | ug/L | 12/11/2003 10:31 |      |
| Methyl tert-butyl ether (MTBE) | ND    | 2.0    | ug/L | 12/11/2003 10:31 |      |
| Benzene                        | ND    | 0.5    | ug/L | 12/11/2003 10:31 |      |
| Toluene                        | ND    | 0.5    | ug/L | 12/11/2003 10:31 |      |
| Ethylbenzene                   | ND    | 0.5    | ug/L | 12/11/2003 10:31 |      |
| Total xylenes                  | ND    | 1.0    | ug/L | 12/11/2003 10:31 |      |
| Ethanol                        | ND    | 500    | ug/L | 12/11/2003 10:31 |      |
| <b>Surrogates(s)</b>           |       |        |      |                  |      |
| 1,2-Dichloroethane-d4          | 89.8  | 76-114 | %    | 12/11/2003 10:31 |      |
| Toluene-d8                     | 93.6  | 88-110 | %    | 12/11/2003 10:31 |      |

**Gas/BTEX Fuel Oxygenates by 8260B**

TRC Alton Geoscience

Attn.: Anju Farfan

21 Technology Drive

Irvine, CA 92718

Phone: (949) 341-7440 Fax: (949) 753-0111

Project: 41050001FA20

Conoco Phillips #5325

Received: 12/03/2003 17:05

Site: 3220 Lakeshore Ave., Oakland

**Batch QC Report**

Prep(s): 5030B

Test(s): 8260FAB

**Laboratory Control Spike**

**Water**

**QC Batch # 2003/12/09-01.62**

LCS 2003/12/09-01.62-035

Extracted: 12/09/2003

Analyzed: 12/09/2003 09:35

LCSD 2003/12/09-01.62-057

Extracted: 12/09/2003

Analyzed: 12/09/2003 09:57

| Compound                       | Conc. ug/L |      | Exp. Conc. | Recovery % |       | RPD  | Ctrl. Limits % |      | Flags |     |
|--------------------------------|------------|------|------------|------------|-------|------|----------------|------|-------|-----|
|                                | LCS        | LCSD |            | LCS        | LCSD  |      | %              | Rec. | RPD   | LCS |
| Benzene                        | 22.8       | 24.2 | 25.0       | 91.2       | 96.8  | 6.0  | 69-129         | 20   |       |     |
| Toluene                        | 23.6       | 26.3 | 25.0       | 94.4       | 105.2 | 10.8 | 70-130         | 20   |       |     |
| Methyl tert-butyl ether (MTBE) | 20.1       | 21.2 | 25.0       | 80.4       | 84.8  | 5.3  | 65-165         | 20   |       |     |
| <b>Surrogates(s)</b>           |            |      |            |            |       |      |                |      |       |     |
| 1,2-Dichloroethane-d4          | 475        | 472  | 500        | 95.0       | 94.4  |      | 76-114         |      |       |     |
| Toluene-d8                     | 523        | 530  | 500        | 104.6      | 106.0 |      | 88-110         |      |       |     |

Severn Trent Laboratories, Inc.

STL San Francisco \* 1220 Quarry Lane, Pleasanton, CA 94566

Tel 925 484 1919 Fax 925 484 1096 \* www.stl-inc.com \* CA DHS ELAP# 2496

12/15/2003 12:17

**Gas/BTEX Fuel Oxygenates by 8260B**

TRC Alton Geoscience

Attn.: Anju Farfan

21 Technology Drive

Irvine, CA 92718

Phone: (949) 341-7440 Fax: (949) 753-0111

Project: 41050001FA20

Conoco Phillips #5325

Received: 12/03/2003 17:05

Site: 3220 Lakeshore Ave., Oakland

**Batch QC Report**

Prep(s): 5030B

Test(s): 8260FAB

**Laboratory Control Spike**

**Water**

**QC Batch # 2003/12/10-01.62**

LCS 2003/12/10-01.62-003

Extracted: 12/10/2003

Analyzed: 12/10/2003 09:03

LCSD 2003/12/10-01.62-025

Extracted: 12/10/2003

Analyzed: 12/10/2003 09:25

| Compound                       | Conc. ug/L |      | Exp. Conc. | Recovery % |      | RPD | Ctri. Limits % |      | Flags |     |
|--------------------------------|------------|------|------------|------------|------|-----|----------------|------|-------|-----|
|                                | LCS        | LCSD |            | LCS        | LCSD |     | %              | Rec. | RPD   | LCS |
| Benzene                        | 21.2       | 22.1 | 25.0       | 84.8       | 88.4 | 4.2 | 69-129         | 20   |       |     |
| Toluene                        | 23.0       | 23.9 | 25.0       | 92.0       | 95.6 | 3.8 | 70-130         | 20   |       |     |
| Methyl tert-butyl ether (MTBE) | 20.3       | 21.8 | 25.0       | 81.2       | 87.2 | 7.1 | 65-165         | 20   |       |     |
| <b>Surrogates(s)</b>           |            |      |            |            |      |     |                |      |       |     |
| 1,2-Dichloroethane-d4          | 453        | 483  | 500        | 90.6       | 96.6 |     | 76-114         |      |       |     |
| Toluene-d8                     | 479        | 499  | 500        | 95.8       | 99.8 |     | 88-110         |      |       |     |

Severn Trent Laboratories, Inc.

STL San Francisco \* 1220 Quarry Lane, Pleasanton, CA 94566

Tel 925 484 1919 Fax 925 484 1096 \* www.stl-inc.com \* CA DHS ELAP# 2496

12/15/2003 12:17

**Gas/BTEX Fuel Oxygenates by 8260B**

TRC Alton Geoscience

Attn.: Anju Farfan

21 Technology Drive

Irvine, CA 92718

Phone: (949) 341-7440 Fax: (949) 753-0111

Project: 41050001FA20

Conoco Phillips #5325

Received: 12/03/2003 17:05

Site: 3220 Lakeshore Ave., Oakland

**Batch QC Report**

Prep(s): 5030B

Test(s): 8260FAB

**Laboratory Control Spike**

**Water**

**QC Batch # 2003/12/11-1B.64**

LCS 2003/12/11-1B.64-047

Extracted: 12/11/2003

Analyzed: 12/11/2003 09:47

LCSD 2003/12/11-1B.64-009

Extracted: 12/11/2003

Analyzed: 12/11/2003 10:09

| Compound                       | Conc. ug/L |      | Exp. Conc. | Recovery % |      | RPD | Ctrl. Limits % |      | Flags |     |
|--------------------------------|------------|------|------------|------------|------|-----|----------------|------|-------|-----|
|                                | LCS        | LCSD |            | LCS        | LCSD |     | %              | Rec. | RPD   | LCS |
| Methyl tert-butyl ether (MTBE) | 23.0       | 23.2 | 25         | 92.0       | 92.8 | 0.9 | 65-165         | 20   |       |     |
| Benzene                        | 21.4       | 22.4 | 25         | 85.6       | 89.6 | 4.6 | 69-129         | 20   |       |     |
| Toluene                        | 21.8       | 23.4 | 25         | 87.2       | 93.6 | 7.1 | 70-130         | 20   |       |     |
| <b>Surrogates(s)</b>           |            |      |            |            |      |     |                |      |       |     |
| 1,2-Dichloroethane-d4          | 494        | 463  | 500        | 98.8       | 92.6 |     | 76-114         |      |       |     |
| Toluene-d8                     | 469        | 470  | 500        | 93.8       | 94.0 |     | 88-110         |      |       |     |

Severn Trent Laboratories, Inc.

STL San Francisco \* 1220 Quarry Lane, Pleasanton, CA 94566

Tel 925 484 1919 Fax 925 484 1096 \* www.stl-inc.com \* CA DHS ELAP# 2496

12/15/2003 12:17

**Gas/BTEX Fuel Oxygenates by 8260B**

TRC Alton Geoscience

Attn.: Anju Farfan

21 Technology Drive

Irvine, CA 92718

Phone: (949) 341-7440 Fax: (949) 753-0111

Project: 41050001FA20

Conoco Phillips #5325

Received: 12/03/2003 17:05

Site: 3220 Lakeshore Ave., Oakland

**Batch QC Report**

Prep(s): 5030B

Test(s): 8260FAB

**Matrix Spike ( MS / MSD )**

**Water**

**QC Batch # 2003/12/09-01.62**

U-5 >> MS

Lab ID: 2003-12-0106 - 005

MS: 2003/12/09-01.62-031

Extracted: 12/09/2003

Analyzed: 12/09/2003 12:31

Dilution: 1.00

MSD: 2003/12/09-01.62-053

Extracted: 12/09/2003

Analyzed: 12/09/2003 12:53

Dilution: 1.00

| Compound                | Conc. ug/L |      |        | Spk.Level | Recovery % |       |     | Limits % |      | Flags |    |
|-------------------------|------------|------|--------|-----------|------------|-------|-----|----------|------|-------|----|
|                         | MS         | MSD  | Sample |           | ug/L       | MS    | MSD | RPD      | Rec. | RPD   | MS |
| Benzene                 | 27.3       | 26.7 | ND     | 25.0      | 109.2      | 106.8 | 2.2 | 69-129   | 20   |       |    |
| Toluene                 | 30.7       | 28.9 | ND     | 25.0      | 122.8      | 115.6 | 6.0 | 70-130   | 20   |       |    |
| Methyl tert-butyl ether | 55.3       | 54.1 | 23.6   | 25.0      | 126.8      | 122.0 | 3.9 | 65-165   | 20   |       |    |
| <b>Surrogate(s)</b>     |            |      |        |           |            |       |     |          |      |       |    |
| 1,2-Dichloroethane-d4   | 539        | 524  |        | 500       | 107.8      | 104.8 |     | 76-114   |      |       |    |
| Toluene-d8              | 504        | 489  |        | 500       | 100.8      | 97.8  |     | 88-110   |      |       |    |

Severn Trent Laboratories, Inc.

STL San Francisco \* 1220 Quarry Lane, Pleasanton, CA 94566

Tel 925 484 1919 Fax 925 484 1096 \* www.stl-inc.com \* CA DHS ELAP# 2496

12/15/2003 12:17



**Gas/BTEX Fuel Oxygenates by 8260B**

TRC Alton Geoscience

Attn.: Anju Farfan

21 Technology Drive

Irvine, CA 92718

Phone: (949) 341-7440 Fax: (949) 753-0111

Project: 41050001FA20

Conoco Phillips #5325

Received: 12/03/2003 17:05

Site: 3220 Lakeshore Ave., Oakland

---

**Legend and Notes**

---

**Analysis Flag**

o

Reporting limits were raised due to high level of analyte present in the sample.

**Result Flag**

g

Hydrocarbon reported in the gasoline range does not match our gasoline standard.

Severn Trent Laboratories, Inc.

STL San Francisco \* 1220 Quarry Lane, Pleasanton, CA 94566

Tel 925 484 1919 Fax 925 484 1096 \* www.stl-inc.com \* CA DHS ELAP# 2496

12/15/2003 12:17

**Dissolved Metals**

TRC Alton Geoscience

Attn.: Anju Farfan

21 Technology Drive

Irvine, CA 92718

Phone: (949) 341-7440 Fax: (949) 753-0111

Project: 41050001FA20

Conoco Phillips #5325

Received: 12/03/2003 17:05

Site: 3220 Lakeshore Ave., Oakland

**Samples Reported**

| Sample Name | Date Sampled     | Matrix | Lab # |
|-------------|------------------|--------|-------|
| U-1         | 12/02/2003 14:35 | Water  | 1     |
| U-2         | 12/02/2003 15:00 | Water  | 2     |
| U-3         | 12/02/2003 13:20 | Water  | 3     |
| U-4         | 12/02/2003 13:45 | Water  | 4     |
| U-5         | 12/02/2003 14:10 | Water  | 5     |
| U-6         | 12/02/2003 13:00 | Water  | 6     |

Severn Trent Laboratories, Inc.

STL San Francisco \* 1220 Quarry Lane, Pleasanton, CA 94566

Tel 925 484 1919 Fax 925 484 1096 \* www.stl-inc.com \* CA DHS ELAP# 2496

12/18/2003 17:53

**Dissolved Metals**

TRC Alton Geoscience

Attn.: Anju Farfan

21 Technology Drive

Irvine, CA 92718

Phone: (949) 341-7440 Fax: (949) 753-0111

Project: 41050001FA20

Conoco Phillips #5325

Received: 12/03/2003 17:05

Site: 3220 Lakeshore Ave., Oakland

|                           |                             |
|---------------------------|-----------------------------|
| Prep(s): 3005A            | Test(s): 6010B              |
| Sample ID: U-1            | Lab ID: 2003-12-0106 - 1    |
| Sampled: 12/02/2003 14:35 | Extracted: 12/4/2003 12:51  |
| Matrix: Water             | QC Batch#: 2003/12/04-03.15 |

| Compound | Conc. | RL   | Unit | Dilution | Analyzed         | Flag |
|----------|-------|------|------|----------|------------------|------|
| Iron     | 4.0   | 0.20 | mg/L | 1.00     | 12/05/2003 17:32 |      |

Severn Trent Laboratories, Inc.

STL San Francisco \* 1220 Quarry Lane, Pleasanton, CA 94566

Tel 925 484 1919 Fax 925 484 1096 \* www.stl-inc.com \* CA DHS ELAP# 2496

12/18/2003 17:53

**Dissolved Metals**

TRC Alton Geoscience

Attn.: Anju Farfan

21 Technology Drive

Irvine, CA 92718

Phone: (949) 341-7440 Fax: (949) 753-0111

Project: 41050001FA20

Conoco Phillips #5325

Received: 12/03/2003 17:05

Site: 3220 Lakeshore Ave., Oakland

|            |                  |            |                  |
|------------|------------------|------------|------------------|
| Prep(s):   | 3005A            | Test(s):   | 6010B            |
| Sample ID: | U-2              | Lab ID:    | 2003-12-0106 - 2 |
| Sampled:   | 12/02/2003 15:00 | Extracted: | 12/4/2003 12:51  |
| Matrix:    | Water            | QC Batch#: | 2003/12/04-03.15 |

| Compound | Conc. | RL   | Unit | Dilution | Analyzed         | Flag |
|----------|-------|------|------|----------|------------------|------|
| Iron     | 2.7   | 0.20 | mg/L | 1.00     | 12/05/2003 18:05 |      |

**Dissolved Metals**

TRC Alton Geoscience

Attn.: Anju Farfan

21 Technology Drive

Irvine, CA 92718

Phone: (949) 341-7440 Fax: (949) 753-0111

Project: 41050001FA20

Conoco Phillips #5325

Received: 12/03/2003 17:05

Site: 3220 Lakeshore Ave., Oakland

|            |                  |            |                  |
|------------|------------------|------------|------------------|
| Prep(s):   | 3005A            | Test(s):   | 6010B            |
| Sample ID: | U-3              | Lab ID:    | 2003-12-0106 - 3 |
| Sampled:   | 12/02/2003 13:20 | Extracted: | 12/4/2003 12:51  |
| Matrix:    | Water            | QC Batch#: | 2003/12/04-03.15 |

| Compound | Conc. | RL   | Unit | Dilution | Analyzed         | Flag |
|----------|-------|------|------|----------|------------------|------|
| Iron     | ND    | 0.20 | mg/L | 1.00     | 12/05/2003 18:10 |      |

Severn Trent Laboratories, Inc.

STL San Francisco \* 1220 Quarry Lane, Pleasanton, CA 94566

Tel 925 484 1919 Fax 925 484 1096 \* www.stl-inc.com \* CA DHS ELAP# 2496

12/18/2003 17:53

**Dissolved Metals**

TRC Alton Geoscience

Attn.: Anju Farfan

21 Technology Drive

Irvine, CA 92718

Phone: (949) 341-7440 Fax: (949) 753-0111

Project: 41050001FA20

Conoco Phillips #5325

Received: 12/03/2003 17:05

Site: 3220 Lakeshore Ave., Oakland

Prep(s): 3005A

Test(s): 6010B

Sample ID: U-4

Lab ID: 2003-12-0106 - 4

Sampled: 12/02/2003 13:45

Extracted: 12/4/2003 12:51

Matrix: Water

QC Batch#: 2003/12/04-03.15

| Compound | Conc. | RL   | Unit | Dilution | Analyzed         | Flag |
|----------|-------|------|------|----------|------------------|------|
| Iron     | ND    | 0.20 | mg/L | 1.00     | 12/05/2003 18:14 |      |

Severn Trent Laboratories, Inc.

STL San Francisco \* 1220 Quarry Lane, Pleasanton, CA 94566

Tel 925 484 1919 Fax 925 484 1096 \* www.stl-inc.com \* CA DHS ELAP# 2496

12/18/2003 17:53

**Dissolved Metals**

TRC Alton Geoscience

Attn.: Anju Farfan

21 Technology Drive

Irvine, CA 92718

Phone: (949) 341-7440 Fax: (949) 753-0111

Project: 41050001FA20

Conoco Phillips #5325

Received: 12/03/2003 17:05

Site: 3220 Lakeshore Ave., Oakland

|            |                  |            |                  |
|------------|------------------|------------|------------------|
| Prep(s):   | 3005A            | Test(s):   | 6010B            |
| Sample ID: | U-5              | Lab ID:    | 2003-12-0106 - 5 |
| Sampled:   | 12/02/2003 14:10 | Extracted: | 12/4/2003 12:51  |
| Matrix:    | Water            | QC Batch#: | 2003/12/04-03.15 |

| Compound | Conc. | RL   | Unit | Dilution | Analyzed         | Flag |
|----------|-------|------|------|----------|------------------|------|
| Iron     | 9.4   | 0.20 | mg/L | 1.00     | 12/05/2003 18:19 |      |

Severn Trent Laboratories, Inc.

STL San Francisco \* 1220 Quarry Lane, Pleasanton, CA 94566

Tel 925 484 1919 Fax 925 484 1096 \* www.stl-inc.com \* CA DHS ELAP# 2496

12/18/2003 17:53

**Dissolved Metals**

TRC Alton Geoscience

Attn.: Anju Farfan

21 Technology Drive

Irvine, CA 92718

Phone: (949) 341-7440 Fax: (949) 753-0111

Project: 41050001FA20

Conoco Phillips #5325

Received: 12/03/2003 17:05

Site: 3220 Lakeshore Ave., Oakland

---

|            |                  |            |                  |
|------------|------------------|------------|------------------|
| Prep(s):   | 3005A            | Test(s):   | 6010E            |
| Sample ID: | U-6              | Lab ID:    | 2003-12-0106 - 6 |
| Sampled:   | 12/02/2003 13:00 | Extracted: | 12/4/2003 12:51  |
| Matrix:    | Water            | QC Batch#: | 2003/12/04-03.15 |

| Compound | Conc. | RL   | Unit | Dilution | Analyzed         | Flag |
|----------|-------|------|------|----------|------------------|------|
| Iron     | 1.4   | 0.20 | mg/L | 1.00     | 12/05/2003 18:24 |      |

Severn Trent Laboratories, Inc.

STL San Francisco \* 1220 Quarry Lane, Pleasanton, CA 94566

Tel 925 484 1919 Fax 925 484 1096 \* www.stl-inc.com \* CA DHS ELAP# 2496

12/18/2003 17:53



**Dissolved Metals**

TRC Alton Geoscience

Attn.: Anju Farfan

21 Technology Drive

Irvine, CA 92718

Phone: (949) 341-7440 Fax: (949) 753-0111

Project: 41050001FA20

Conoco Phillips #5325

Received: 12/03/2003 17:05

Site: 3220 Lakeshore Ave., Oakland

**Batch QC Report**

Prep(s): 3005A

Method Blank

MB: 2003/12/04-03.15-050

Water

Test(s): 6010B

QC Batch # 2003/12/04-03.15

Date Extracted: 12/04/2003 12:51

| Compound | Conc. | RL   | Unit | Analyzed         | Flag |
|----------|-------|------|------|------------------|------|
| Iron     | ND    | 0.20 | mg/L | 12/05/2003 17:03 |      |

Severn Trent Laboratories, Inc.

STL San Francisco \* 1220 Quarry Lane, Pleasanton, CA 94566

Tel 925 484 1919 Fax 925 484 1096 \* www.stl-inc.com \* CA DHS ELAP# 2496

12/18/2003 17:53

Page 8 of 10

**Dissolved Metals**

TRC Alton Geoscience

Attn.: Anju Farfan

21 Technology Drive

Irvine, CA 92718

Phone: (949) 341-7440 Fax: (949) 753-0111

Project: 41050001FA20

Conoco Phillips #5325

Received: 12/03/2003 17:05

Site: 3220 Lakeshore Ave., Oakland

**Batch QC Report**

Prep(s): 3005A

Test(s): 6010B

**Laboratory Control Spike**

**Water**

**QC Batch # 2003/12/04-03.15**

LCS 2003/12/04-03.15-051

Extracted: 12/04/2003

Analyzed: 12/05/2003 17:08

LCSD 2003/12/04-03.15-052

Extracted: 12/04/2003

Analyzed: 12/05/2003 17:13

| Compound | Conc. mg/L |      | Exp.Conc. | Recovery % |      | RPD | Ctrl.Limits % |      | Flags |     |
|----------|------------|------|-----------|------------|------|-----|---------------|------|-------|-----|
|          | LCS        | LCSD |           | LCS        | LCSD |     | %             | Rec. | RPD   | LCS |
| Iron     | 5.22       | 4.99 | 5.00      | 104.4      | 99.8 | 4.5 | 80-120        | 20   |       |     |

Severn Trent Laboratories, Inc.

STL San Francisco \* 1220 Quarry Lane, Pleasanton, CA 94566

Tel 925 484 1919 Fax 925 484 1096 \* www.stl-inc.com \* CA DHS ELAP# 2496

12/18/2003 17:53

**Dissolved Metals**

TRC Alton Geoscience

Attn.: Anju Farfan

21 Technology Drive

Irvine, CA 92718

Phone: (949) 341-7440 Fax: (949) 753-0111

Project: 41050001FA20

Conoco Phillips #5325

Received: 12/03/2003 17:05

Site: 3220 Lakeshore Ave., Oakland

**Batch QC Report**

Prep(s): 3005A

Test(s): 6010B

**Matrix Spike ( MS / MSD )**

**Water**

**QC Batch # 2003/12/04-03.15**

U-1 >> MS

Lab ID: 2003-12-0106 - 001

MS: 2003/12/04-03.15-057

Extracted: 12/04/2003

Analyzed: 12/05/2003 17:37

Dilution: 1.00

MSD: 2003/12/04-03.15-060

Extracted: 12/04/2003

Analyzed: 12/05/2003 18:00

Dilution: 1.00

| Compound | Conc. mg/L |      |        | Spk. Level | Recovery % |      |     | Limits % |     | Flags |     |
|----------|------------|------|--------|------------|------------|------|-----|----------|-----|-------|-----|
|          | MS         | MSD  | Sample | mg/L       | MS         | MSD  | RPD | Rec.     | RPD | MS    | MSD |
| Iron     | 8.75       | 8.90 | 4.03   | 5.00       | 94.4       | 97.4 | 3.1 | 75-125   | 20  |       |     |

Severn Trent Laboratories, Inc.

STL San Francisco \* 1220 Quarry Lane, Pleasanton, CA 94566

Tel 925 484 1919 Fax 925 484 1096 \* www.stl-inc.com \* CA DHS ELAP# 2496

12/18/2003 17:53

Ms. Tina Totorica  
STL San Francisco  
1220 Quarry Lane, #C  
Pleasanton, CA 94566-4756

3943-A Valley Avenue  
Pleasanton, CA 94566-4715  
Tel: 925-462-3771

Sample Source:  
Project No.: 2003-12-0106  
Project Name: Cannon Phillips #5325  
Date Sampled: 12/02/03  
Date Received: 12/04/03  
Matrix: Water

12 December, 2003  
Job No. 0312049  
Sample No. 001-005  
Cust. No. 19176

| Analyte   | Results      | Detection Limit    | Method                 | Date Analyzed        |
|---|--------------|--------------------|------------------------|----------------------|
| Lab No. 001<br>Sample I.D.: U-1<br>Nitrate as NO <sub>3</sub><br>Ortho-Phosphate as P | N.D.<br>7.0  | 1 mg/L<br>0.4 mg/L | EPA 300.0<br>EPA 300.0 | 12/04/03<br>12/04/03 |
| Lab No. 002<br>Sample I.D.: U-2<br>Nitrate as NO <sub>3</sub><br>Ortho-Phosphate as P | N.D.<br>3.5  | 1 mg/L<br>0.4 mg/L | EPA 300.0<br>EPA 300.0 | 12/04/03<br>12/04/03 |
| Lab No. 003<br>Sample I.D.: U-3<br>Nitrate as NO <sub>3</sub><br>Ortho-Phosphate as P | 18<br>0.6    | 1 mg/L<br>0.4 mg/L | EPA 300.0<br>EPA 300.0 | 12/04/03<br>12/04/03 |
| Lab No. 004<br>Sample I.D.: U-4<br>Nitrate as NO <sub>3</sub><br>Ortho-Phosphate as P | 20<br>N.D.   | 1 mg/L<br>0.4 mg/L | EPA 300.0<br>EPA 300.0 | 12/04/03<br>12/04/03 |
| Lab No. 005<br>Sample I.D.: U-5<br>Nitrate as NO <sub>3</sub><br>Ortho-Phosphate as P | N.D.<br>N.D. | 1 mg/L<br>0.4 mg/L | EPA 300.0<br>EPA 300.0 | 12/04/03<br>12/04/03 |
| Lab No. 006<br>Sample I.D.: U-6<br>Nitrate as NO <sub>3</sub><br>Ortho-Phosphate as P | N.D.<br>1.3  | 1 mg/L<br>0.4 mg/L | EPA 300.0<br>EPA 300.0 | 12/04/03<br>12/04/03 |

  
Cheryl McMillen  
Laboratory Director

STL San Francisco  
 12 December, 2003  
 Job No.0312047  
 Page 2 of 2

QUALITY CONTROL DATA - Nitrate as NO<sub>3</sub>  
 EPA Method No.: 300.0  
 Date Analyzed: December 04, 2003

Laboratory Control Sample Summary

|                                    | Blank Result | True Value | LCS Result | Percent Recovery |
|------------------------------------|--------------|------------|------------|------------------|
| Nitrate as NO <sub>3</sub> (mg/L): | N.D.         | 11.08      | 11.55      | 104.1            |
| Reporting Limit (mg/L):            | 0.5          |            |            |                  |
| QC Limits (%):                     |              |            |            | 85-115           |

QUALITY CONTROL DATA - Ortho-Phosphate as P  
 EPA Method No.: 300.0  
 Date Analyzed: December 04, 2003

Laboratory Control Sample Summary

|                              | Blank Result | True Value | LCS Result | Percent Recovery |
|------------------------------|--------------|------------|------------|------------------|
| Ortho-Phosphate as P (mg/L): | N.D.         | 4.89       | 4.95E      | 101.4            |
| Reporting Limit (mg/L):      | 0.2          |            |            |                  |
| QC Limits (%):               |              |            |            | 85-115           |

Chain of Custody 2003-12-0106-1

Date Shipped: 12/04/2003

From: STL San Francisco (CL)  
 1220 Quarry Lane  
 Pleasanton, CA 94566-4756  
 Project Manager: Dimple Sharma  
 Phone: (925) 462-2771  
 Fax: (925) 462-2775  
 Email: dsharma@stl-inc.com

To: Cerco Analytical - SUB CONTRACT ONLY  
 3942 Valley Avenue, Suite A  
 Pleasanton, CA 94566  
 Phone: (925) 462-2771  
 Fax: (925) 462-2775  
 Contact: Darlene Langford  
 Phone: (925) 462-2771

CL Submission #: 2003-12-0106  
 CL PC #:  
 Project #: 41050001FA20  
 Project Name: Conoco Phillips #5325

1  
2  
3  
4  
5

| Client Sample ID              | CL# | Sample           | Matrix    | Method | TAT |
|-------------------------------|-----|------------------|-----------|--------|-----|
| U-1                           | 001 | 12/02/2003 14:35 | Water     |        |     |
| Subcontract - Nitrate         |     |                  | 300/352.1 | 10 Day |     |
| Subcontract - Ortho-Phosphate |     |                  | 365.2     | 10 Day |     |
| U-2                           | 002 | 12/02/2003 15:00 | Water     |        |     |
| Subcontract - Nitrate         |     |                  | 300/352.1 | 10 Day |     |
| Subcontract - Ortho-Phosphate |     |                  | 365.2     | 10 Day |     |
| U-3                           | 003 | 12/02/2003 13:20 | Water     |        |     |
| Subcontract - Nitrate         |     |                  | 300/352.1 | 10 Day |     |
| Subcontract - Ortho-Phosphate |     |                  | 365.2     | 10 Day |     |
| U-4                           | 004 | 12/02/2003 13:45 | Water     |        |     |
| Subcontract - Nitrate         |     |                  | 300/352.1 | 10 Day |     |
| Subcontract - Ortho-Phosphate |     |                  | 365.2     | 10 Day |     |
| U-5                           | 005 | 12/02/2003 14:10 | Water     |        |     |
| Subcontract - Nitrate         |     |                  | 300/352.1 | 10 Day |     |
| Subcontract - Ortho-Phosphate |     |                  | 365.2     | 10 Day |     |

CA 03-2049

|   |  |   |
|---|--|---|
| RELINQUISHED BY:<br>Signature: <i>[Signature]</i><br>Printed Name: D Harrington<br>Company: STL-SF<br>Date: 12/4/03 | 1. RELINQUISHED BY:<br>Signature: <i>[Signature]</i><br>Printed Name: DIMPLE SHARMA<br>Company: STL-SF<br>Date: 12/4                 | 2. RELINQUISHED BY:<br>Signature:<br>Printed Name:<br>Company:<br>Date: |
| RECEIVED BY:<br>Signature: <i>[Signature]</i><br>Printed Name: DIMPLE SHARMA<br>Company: STL-SF<br>Date: 12/4/03    | 1. RECEIVED BY:<br>Signature: <i>[Signature]</i><br>Printed Name: <i>[Signature]</i><br>Company: <i>[Signature]</i><br>Date: 12/4/03 | 2. RECEIVED BY:<br>Signature:<br>Printed Name:<br>Company:<br>Date:     |

Chain of Custody 2003-12-0106-1

Date Shipped: 12/04/2003

From:  
**STL San Francisco (CL)**  
 1220 Quarry Lane  
 Pleasanton, CA 94566-4756  
 Project Manager: Dimple Sharma  
 Phone:  
 Fax: (925) 484-1096  
 Email: dsharma@stl-inc.com

To:  
**Cerco Analytical - SUB CONTRACT ONLY**  
 3842 Valey Avenue, Suite A  
 Pleasanton, CA 94566  
 Phone: (925) 462-2771  
 Fax: (925) 462-2775  
 Contact: Darlene Longford  
 Phone: (925) 462-2771

CL Submission #: **2003-12-0106**  
 CL PO #:

Project #: 41050901FA20  
 Project Name: Cerco Philips #5325

| Client Sample ID              | CL# | Sampled          | Matrix    | TAT    |
|-------------------------------|-----|------------------|-----------|--------|
| U-5                           | 006 | 12/02/2003 13:00 | Water     |        |
| Subcontract - Nitrate         |     |                  | 300/352.1 | 10 Day |
| Subcontract - Ortho-Phosphate |     |                  | 368.2     | 10 Day |

PLEASE INCLUDE QC WITH FAXED AND HARD-COPY RESULTS

CAO 3 12049

|  |   |  |
|--|---|--|
| RELINQUISHED BY:<br>Signature: <i>[Signature]</i><br>Printed Name: <b>STL-SF</b><br>Date: <b>12/4/03</b><br>Company: | RELINQUISHED BY:<br>Signature: <i>[Signature]</i><br>Printed Name: <b>STL-SF</b><br>Date: <b>12/4</b><br>Company: | RELINQUISHED BY:<br>Signature:<br>Printed Name:<br>Date:<br>Company: |
| RECEIVED BY:<br>Signature: <i>[Signature]</i><br>Printed Name: <b>STL-SF</b><br>Date: <b>12/4</b><br>Company:        | RECEIVED BY:<br>Signature: <i>[Signature]</i><br>Printed Name: <b>STL-SF</b><br>Date: <b>12/4</b><br>Company:     | RECEIVED BY:<br>Signature:<br>Printed Name:<br>Date:<br>Company:     |

**C E R C O**  
analytical, inc.


Ms. Tina Totorica  
STL San Francisco  
1220 Quarry Lane, #C  
Pleasanton, CA 94566-4756

3942-A Valley Avenue  
Pleasanton, CA 94566-4715  
Tel: 925.462.2771

Sample Source:  
Project No.: 2003-12-0106  
Project Name: Conoco Phillips #5325  
Date Sampled: 12/02/03  
Date Received: 12/04/03  
Matrix: Water

12 December, 2003  
Job No.0312049  
Sample No.001-005  
Cust. No.10176  
Fax: 925.462.2775

| Analyte                    | Results | Detection Limit | Method    | Date Analyzed |
|----------------------------|---------|-----------------|-----------|---------------|
| Lab No.001                 |         |                 |           |               |
| Sample I.D.: U-1           |         |                 |           |               |
| Nitrate as NO <sub>3</sub> | N.D.    | 1 mg/L          | EPA 300.0 | 12/04/03      |
| Ortho-Phosphate as P       | 7.0     | 0.4 mg/L        | EPA 300.0 | 12/04/03      |
| Lab No.002                 |         |                 |           |               |
| Sample I.D.: U-2           |         |                 |           |               |
| Nitrate as NO <sub>3</sub> | N.D.    | 1 mg/L          | EPA 300.0 | 12/04/03      |
| Ortho-Phosphate as P       | 3.5     | 0.4 mg/L        | EPA 300.0 | 12/04/03      |
| Lab No.003                 |         |                 |           |               |
| Sample I.D.: U-3           |         |                 |           |               |
| Nitrate as NO <sub>3</sub> | 18      | 1 mg/L          | EPA 300.0 | 12/04/03      |
| Ortho-Phosphate as P       | 0.6     | 0.4 mg/L        | EPA 300.0 | 12/04/03      |
| Lab No.004                 |         |                 |           |               |
| Sample I.D.: U-4           |         |                 |           |               |
| Nitrate as NO <sub>3</sub> | 20      | 1 mg/L          | EPA 300.0 | 12/04/03      |
| Ortho-Phosphate as P       | N.D.    | 0.4 mg/L        | EPA 300.0 | 12/04/03      |
| Lab No.005                 |         |                 |           |               |
| Sample I.D.: U-5           |         |                 |           |               |
| Nitrate as NO <sub>3</sub> | N.D.    | 1 mg/L          | EPA 300.0 | 12/04/03      |
| Ortho-Phosphate as P       | N.D.    | 0.4 mg/L        | EPA 300.0 | 12/04/03      |
| Lab No.006                 |         |                 |           |               |
| Sample I.D.: U-6           |         |                 |           |               |
| Nitrate as NO <sub>3</sub> | N.D.    | 1 mg/L          | EPA 300.0 | 12/04/03      |
| Ortho-Phosphate as P       | 1.3     | 0.4 mg/L        | EPA 300.0 | 12/04/03      |

  
Cheryl McMillen  
Laboratory Director



From:  
**STL San Francisco (CL)**  
 1220 Quarry Lane  
 Pleasanton, CA 94566-4756

To:  
 Cerco Analytical - SUB CONTRACT ONLY  
 3942 Valley Avenue, Suite A  
 Pleasanton, CA 94566

Project Manager: Dimple Sharma  
 Phone: Ext:  
 Fax: (925) 484-1096  
 Email: dsharma@stl-inc.com

Phone: (925) 462-2771  
 Fax: (925) 462-2775  
 Contact: Darlene Langford  
 Phone: (925) 462-2771

CL Submission #: **2003-12-0106**  
 CL PO #:

Project #: 41050001FA20  
 Project Name: Conoco Phillips #5325

| Client Sample ID              | CL# | Sampled          | Matrix    | TAT    |
|-------------------------------|-----|------------------|-----------|--------|
| Analysis                      |     |                  | Method    |        |
| U-1                           | 001 | 12/02/2003 14:35 | Water     |        |
| Subcontract - Nitrate         |     |                  | 300/352.1 | 10 Day |
| Subcontract - Ortho-Phosphate |     |                  | 365.2     | 10 Day |
| U-2                           | 002 | 12/02/2003 15:00 | Water     |        |
| Subcontract - Nitrate         |     |                  | 300/352.1 | 10 Day |
| Subcontract - Ortho-Phosphate |     |                  | 365.2     | 10 Day |
| U-3                           | 003 | 12/02/2003 13:20 | Water     |        |
| Subcontract - Nitrate         |     |                  | 300/352.1 | 10 Day |
| Subcontract - Ortho-Phosphate |     |                  | 365.2     | 10 Day |
| U-4                           | 004 | 12/02/2003 13:45 | Water     |        |
| Subcontract - Nitrate         |     |                  | 300/352.1 | 10 Day |
| Subcontract - Ortho-Phosphate |     |                  | 365.2     | 10 Day |
| U-5                           | 005 | 12/02/2003 14:10 | Water     |        |
| Subcontract - Nitrate         |     |                  | 300/352.1 | 10 Day |
| Subcontract - Ortho-Phosphate |     |                  | 365.2     | 10 Day |

OH 03-12049

|  |   |  |
|--|---|--|
| RELINQUISHED BY:<br><i>Dimple Sharma</i><br>Signature Time<br>D Harrington<br>Printed Name Date<br>STL-SF 12/4/03<br>Company | RELINQUISHED BY:<br><i>Dimple Sharma</i> 11:45<br>Signature Time<br>Dimple Sharma<br>Printed Name Date<br>STL-SF<br>Company | RELINQUISHED BY:<br>Signature Time<br>Printed Name Date<br>Company |
| RECEIVED BY:<br><i>Dimple Sharma</i> 11:45<br>Signature Time<br>Dimple Sharma<br>Printed Name Date<br>STL-SF<br>Company      | RECEIVED BY:<br><i>Darlene Langford</i><br>Signature Time<br>Printed Name Date<br>Company                                   | RECEIVED BY:<br>Signature Time<br>Printed Name Date<br>Company     |

From:  
**STL San Francisco (CL)**  
 1220 Quarry Lane  
 Pleasanton, CA 94566-4756  
 Project Manager: Dimple Sharma  
 Phone:  
 Fax: (925) 484-1096  
 Email: dsharma@stl-inc.com

To:  
 Cerco Analytical - SUB CONTRACT ONLY  
 3942 Valley Avenue, Suite A  
 Pleasanton, CA 94566  
 Phone: (925) 462-2771  
 Fax: (925) 462-2775  
 Contact: Darlene Langford  
 Phone: (925) 462-2771

CL Submission #: **2003-12-0106**  
 CL PO #:

Project #: 41050001FA20  
 Project Name: Conoco Phillips #5325

| Client Sample ID              | CL# | Sampled          | Matrix    | TAT    |
|-------------------------------|-----|------------------|-----------|--------|
| Analysis                      |     |                  | Method    |        |
| U-6                           | 006 | 12/02/2003 13:00 | Water     |        |
| Subcontract - Nitrate         |     |                  | 300/352.1 | 10 Day |
| Subcontract - Ortho-Phosphate |     |                  | 365.2     | 10 Day |

PLEASE INCLUDE QC WITH FAXED AND HARD-COPY RESULTS

CAO3 12049

|   |    |   |    |  |    |
|---|----|---|----|--|----|
| RELINQUISHED BY:<br><i>Darlene Langford</i><br>Signature Time<br>D Harrington<br>Printed Name Date<br>STL-SF 12/4/03<br>Company | 1. | RELINQUISHED BY:<br><i>D Sharma 11:45</i><br>Signature Time<br>DIMPLE SHARMA 12/4<br>Printed Name Date<br>STL-SF<br>Company | 2. | RELINQUISHED BY:<br>Signature Time<br>Printed Name Date<br>Company | 3. |
| RECEIVED BY:<br><i>D Sharma 11:45</i><br>Signature Time<br>DIMPLE SHARMA 12/4<br>Printed Name Date<br>STL-SF<br>Company         | 1. | RECEIVED BY:<br><i>D Langford</i><br>Signature Time<br>Printed Name Date<br>STL-SF 11/45<br>Company                         | 2. | RECEIVED BY:<br>Signature Time<br>Printed Name Date<br>Company     | 3. |

STL-San Francisco

2003-12-0106

ConocoPhillips Chain Of Custody Record

80808

1220 Quarry Lane

Pleasanton, CA 94566

(925) 484-1919 (925) 484-1096 fax

ConocoPhillips Site Manager:

INVOICE REMITTANCE ADDRESS:

CONOCOPHILLIPS  
Attn: Dee Hutchinson  
3611 South Harbor, Suite 200  
Santa Ana, CA. 92704

ConocoPhillips Work Order Number

ConocoPhillips Cost Object

DATE: 12-2-03

PAGE: 1 of 1

|   |                      |   |   |                            |                               |
|---|----------------------|---|---|----------------------------|-------------------------------|
| SAMPLING COMPANY:<br>TRC                                    |                      | Valid Value ID:                             | CONOCOPHILLIPS SITE NUMBER<br>5325  |                            | GLOBAL ID NO.:<br>TDC00101463 |
| ADDRESS:<br>21 Technology Drive, Irvine CA 92618            |                      |   | SITE ADDRESS (Street and City):<br>3220 LAKESHORE AVE. OAKLAND                          |                            | CONOCOPHILLIPS SITE MANAGER:  |
| PROJECT CONTACT (Hardcopy or PDF Report to):<br>Anju Farfan |                      |   | EDF DELIVERABLE TO (RP or Designee):<br>Peter Thomson, TRC<br>pthomson@trcsolutions.com | PHONE NO.:<br>949-341-7408 | E-MAIL:<br>LAB USE ONLY       |
| TELEPHONE:<br>949-341-7440                                  | FAX:<br>949-753-0111 | E-MAIL:<br>afarfan@trcsolutions.com         |   |                            |                               |
| SAMPLER NAME(S) (Print):<br>AEX M-                          |                      | CONSULTANT PROJECT NUMBER:<br>41050001/FA20 |   |                            |                               |

REQUESTED ANALYSES

TURNAROUND TIME (CALENDAR DAYS):  
 14 DAYS  7 DAYS  72 HOURS  48 HOURS  24 HOURS  LESS THAN 24 HOURS

SPECIAL INSTRUCTIONS OR NOTES: CHECK BOX IF EDD IS NEEDED

= SAMPLES FOR FERROUS IRON ARE FIELD FILTERED

= RUN 8 OXYS BY SQ60 ON ALL 8260 MTR HITS

\* Field Point name only required if different from Sample ID

FIELD NOTES:  
Container/Preservative or PID Readings or Laboratory Notes

2.0

TEMPERATURE ON RECEIPT C°

| LAB USE ONLY | Sample Identification/Field Point Name* | SAMPLING |      | MATRIX | NO. OF CONT. | 8015m - TPHd Extractable | 8260B - TPHg/BTEX/MBE | 8260B - TPHg / BTEX / 8 Oxygenates | 8260B - TPHg / BTEX / 8 oxygenates + methanol (8015M) | 8260B - Full Scan VOCs (does not include oxygenates) | 8270C - Semi-Volatiles | 8015M / 8021B - TPHg/BTEX/MBE | Lead <input type="checkbox"/> Total DSTLC DTCLP | TPH BY SQ60 | PEX / MTR BY SQ60 | ETHANOL BY SQ60 | NITRATE / PHOSPHATE | FERROUS IRON | 3 VOLS w/ HCL | 1 HNC3 (250 ML) | 1 500 DISINFECTED |   |
|--------------|---|----------|------|--------|--------------|--------------------------|-----------------------|------------------------------------|---|--|------------------------|-------------------------------|---|-------------|-------------------|-----------------|---------------------|--------------|---------------|-----------------|-------------------|---|
|              |   | DATE     | TIME |        |              |                          |                       |                                    |   |  |                        |                               |   |             |                   |                 |                     |              |               |                 |                   |   |
|              | U-1 ✓                                   | 12-2     | 1435 | GW     | 5            |                          |                       |                                    |   |  |                        |                               |   | X           | X                 | X               | X                   | X            | X             | X               | X                 | X |
|              | U-2 ✓                                   |          | 1500 |        |              |                          |                       |                                    |   |  |                        |                               |   |             |                   |                 |                     |              |               |                 |                   |   |
|              | U-3 ✓                                   |          | 1320 |        |              |                          |                       |                                    |   |  |                        |                               |   |             |                   |                 |                     |              |               |                 |                   |   |
|              | U-4 ✓                                   |          | 1345 |        |              |                          |                       |                                    |   |  |                        |                               |   |             |                   |                 |                     |              |               |                 |                   |   |
|              | U-5 ✓                                   |          | 1410 |        |              |                          |                       |                                    |   |  |                        |                               |   |             |                   |                 |                     |              |               |                 |                   |   |
|              | U-6 ✓                                   |          | 1360 |        |              |                          |                       |                                    |   |  |                        |                               |   |             |                   |                 |                     |              |               |                 |                   |   |

|  |  |                   |                |
|--|--|-------------------|----------------|
| Relinquished by: (Signature)<br><i>[Signature]</i> | Received by: (Signature)<br><i>[Signature]</i> | Date:<br>12/2/03  | Time:<br>10:55 |
| Relinquished by: (Signature)<br><i>[Signature]</i> | Received by: (Signature)<br><i>[Signature]</i> | Date:<br>12/3/03  | Time:<br>17:00 |
| Relinquished by: (Signature)<br><i>[Signature]</i> | Received by: (Signature)<br><i>[Signature]</i> | Date:<br>12/03/03 | Time:<br>17:05 |

TRC Customer Focused Solutions  
5052 Commercial Circle  
Concord, CA 94520-1248

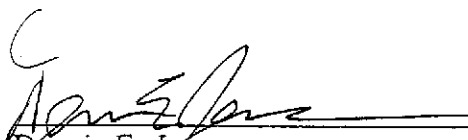
## Statement of Authorized Transportation and Disposal

This is to certify that non-hazardous groundwater produced during purging and sampling of monitoring wells at ConocoPhillips site number 5325 was accumulated at TRC's groundwater monitoring facility at Concord, California, for transportation by Onyx Transportation, Inc. to the ConocoPhillips Refinery at Rodeo California for disposal. TRC records indicate that approximately 63 gallons of purge water from the site were transferred to the purge water holding tank on 12/2/03. The contents of the holding tank were transported to the Unit 100 Water Treatment Facility at the Rodeo Refinery on Pending.

Disposal at the facility was authorized by ConocoPhillips in accordance with "ESD Standard Operating Procedures - Water Quality and Compliance", as revised on February 7, 2003. The procedure requires that TRC dispose only of monitoring well purge water from sites for which TRC services are under contract by ConocoPhillips. The non-hazardous nature of the purge water is confirmed quarterly by analysis by an independent certified laboratory of a random sample from the TRC holding facility. The sample is analyzed for all analytes and parameters that might affect the ConocoPhillips NPDES permit for ultimate disposal of the water. Documentation of compliance with ConocoPhillips requirements is provided by an ESD Form R-149, which is on file with ConocoPhillips.

If any purge water collected at the site is suspected of containing potentially hazardous material such as liquid-phase hydrocarbons, that water was accumulated separately in a drum for transportation and disposal by Filter Recycling, Inc.

In witness of this statement

  
Dennis E. Jensen  
QMS Program Manager

1/8/04  
date

## LIMITATIONS

The fluid level monitoring and groundwater sampling activities summarized in this report have been performed under the responsible charge of a California Registered Geologist or Registered Civil Engineer and have been conducted in accordance with current practice and the standard of care exercised by geologists and engineers performing similar tasks in this area. No warranty, express or implied, is made regarding the conclusions and professional opinions presented in this report. The conclusions are based solely upon an analysis of the observed conditions. If actual conditions differ from those described in this report, our office should be notified.