



2000 Crow Canyon Place
Suite 400
San Ramon, CA 94583

Phone: (925) 277-2384
Fax: (925) 277-2361

Risk Management &
Remediation

November 13, 2003

Alameda County

NOV 18 2003

Environmental Health

Re: **Tosco (Unocal) Service Station #5325**
3220 Lakeshore Avenue
Oakland, California

" I declare under penalty of perjury, that to the best of my knowledge at the present time, that the information and/or recommendations contained in the attached proposal or report is true and correct"

A handwritten signature in cursive script that reads "David B. DeWitt".

David B. DeWitt
Site Manager
ConocoPhillips



GETTLER-RYAN INC.

TRANSMITTAL

October 29, 2003
G-R #180061

TO: Mr. David B. De Witt
ConocoPhillips
76 Broadway Avenue
Sacramento, California 95818

Alameda County

NOV 18 2003

Environmental Health

FROM: Deanna L. Harding
Project Coordinator
Gettler-Ryan Inc.
6747 Sierra Court, Suite J
Dublin, California 94568

RE: **Tosco (Unocal) Service Station
#5325
3220 Lakeshore Avenue
Oakland, California**

WE HAVE ENCLOSED THE FOLLOWING:

COPIES	DATED	DESCRIPTION
1	October 29, 2003	Groundwater Monitoring and Sampling Report Third Quarter - Event of September 24, 2003

COMMENTS:

This report is being sent to you for your review/comment, prior to being distributed on your behalf. If no comments are received by **November 12, 2003**, this report will be distributed to the following:

cc: Alameda County Health Care Services, 1131 Harbor Bay Parkway, Suite 250 Alameda, CA 94502

Enclosure

trans/5325-DBD

6747 Sierra Court, Suite J • Dublin, CA 94568 • (925) 551-7555 • Fax (925) 551-7888
3140 Gold Camp Drive, Suite 170 • Rancho Cordova, CA 95670 • (916) 631-1300 • Fax (916) 631-1317
1364 N. McDowell Blvd., Suite B2 • Petaluma, CA 94954 • (707) 789-3255 • Fax (707) 789-3218



GETTLER - RYAN INC.

October 29, 2003
G-R Job #180061

Mr. David B. De Witt
ConocoPhillips
76 Broadway Avenue
Sacramento, California 95818

RE: Third Quarter Event of September 24, 2003
Groundwater Monitoring & Sampling Report
Tosco (Unocal) Service Station #5325
3220 Lakeshore Avenue
Oakland, California

Dear Mr. De Witt:

This report documents the most recent groundwater monitoring and sampling event performed by Gettler-Ryan Inc. (G-R) at the referenced site. All field work was conducted in accordance with G-R Standard Operating Procedure - Groundwater Sampling (attached).

Static groundwater levels were measured and all wells were checked for the presence of separate-phase hydrocarbons. Separate-phase hydrocarbons were not present in any wells. Static water level data and groundwater elevations are summarized in Table 1. Field Measurements are summarized in Table 3. A Potentiometric Map is included as Figure 1.

Groundwater samples were collected from the monitoring wells and submitted to a state certified laboratory for analyses. The field data sheets for this event are attached. Analytical results are presented in the table(s) listed below. A Concentration Map is included as Figure 2. The chain of custody document and laboratory analytical report are also attached.

Sincerely,

- For -

Deanna L. Harding
Project Coordinator

Robert C. Mallory
Registered Geologist No. 7285



Figure 1: Potentiometric Map
Figure 2: Concentration Map
Table 1: Groundwater Monitoring Data and Analytical Results
Table 2: Groundwater Analytical Results - Oxygenate Compounds
Table 3: Field Measurements and Groundwater Analytical Results
Attachments: Standard Operating Procedure - Groundwater Sampling
Field Data Sheets
Chain of Custody Document and Laboratory Analytical Reports

5325.qml

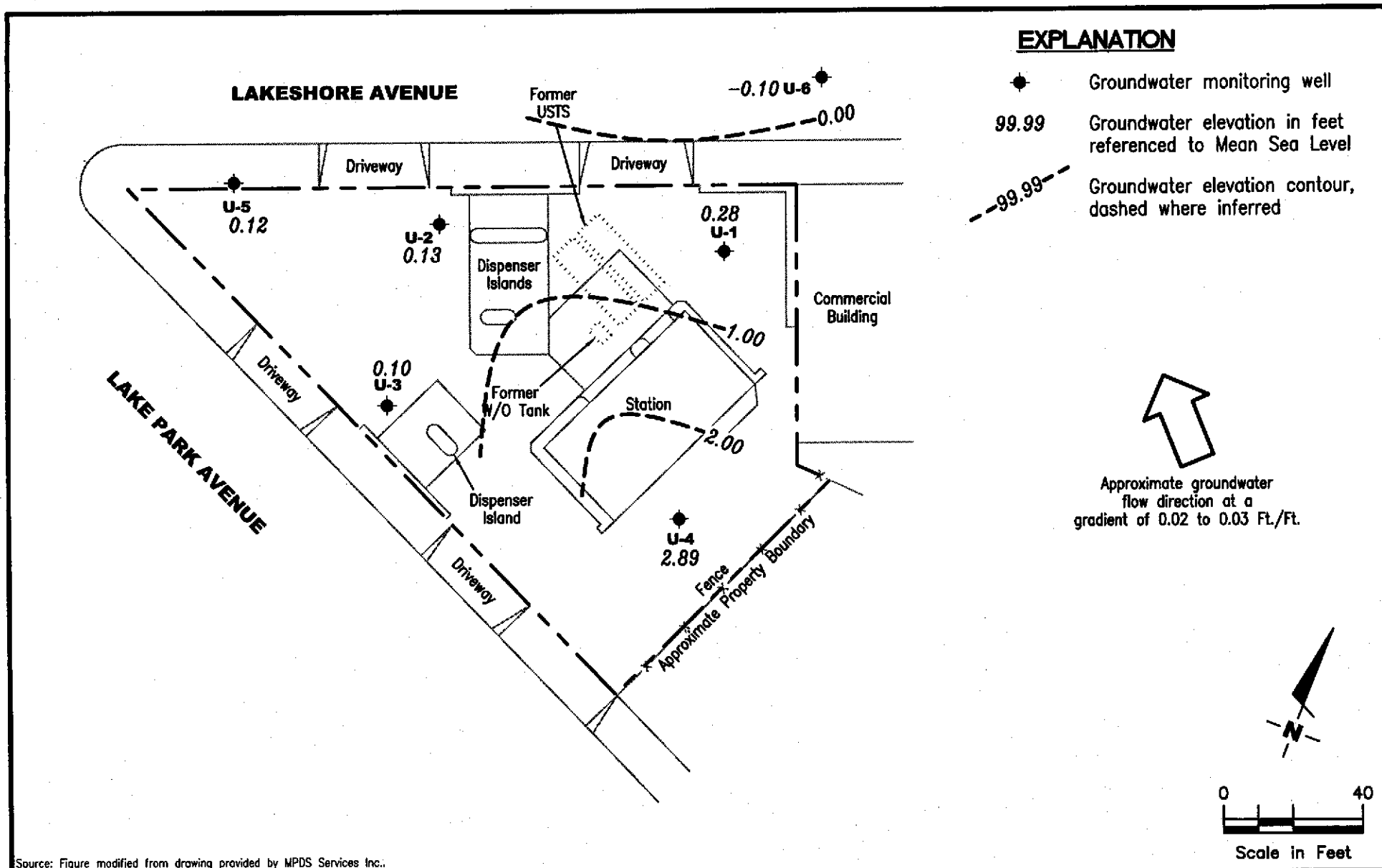

Source: Figure modified from drawing provided by MPDS Services Inc..

GETTLER - RYAN INC.
 6747 Sierra Ct., Suite J
 Dublin, CA 94568 (925) 551-7555

POTENTIOMIC MAP
 Tosco (Unocal) Service Station #5325
 3220 Lakeshore Avenue
 Oakland, California

FIGURE

1

PROJECT NUMBER
 180061

REVIEWED BY

DATE
 September 24, 2003

REVISED DATE

EXPLANATION

- ◆ Groundwater monitoring well
- A/B/C Total Petroleum Hydrocarbons (TPH) as Gasoline/Benzene/MTBE concentrations in ppb

NOTE: Analyses by EPA Method 8260

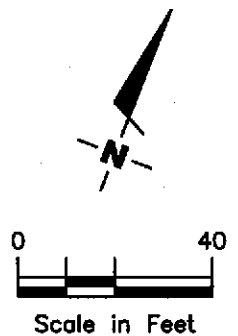
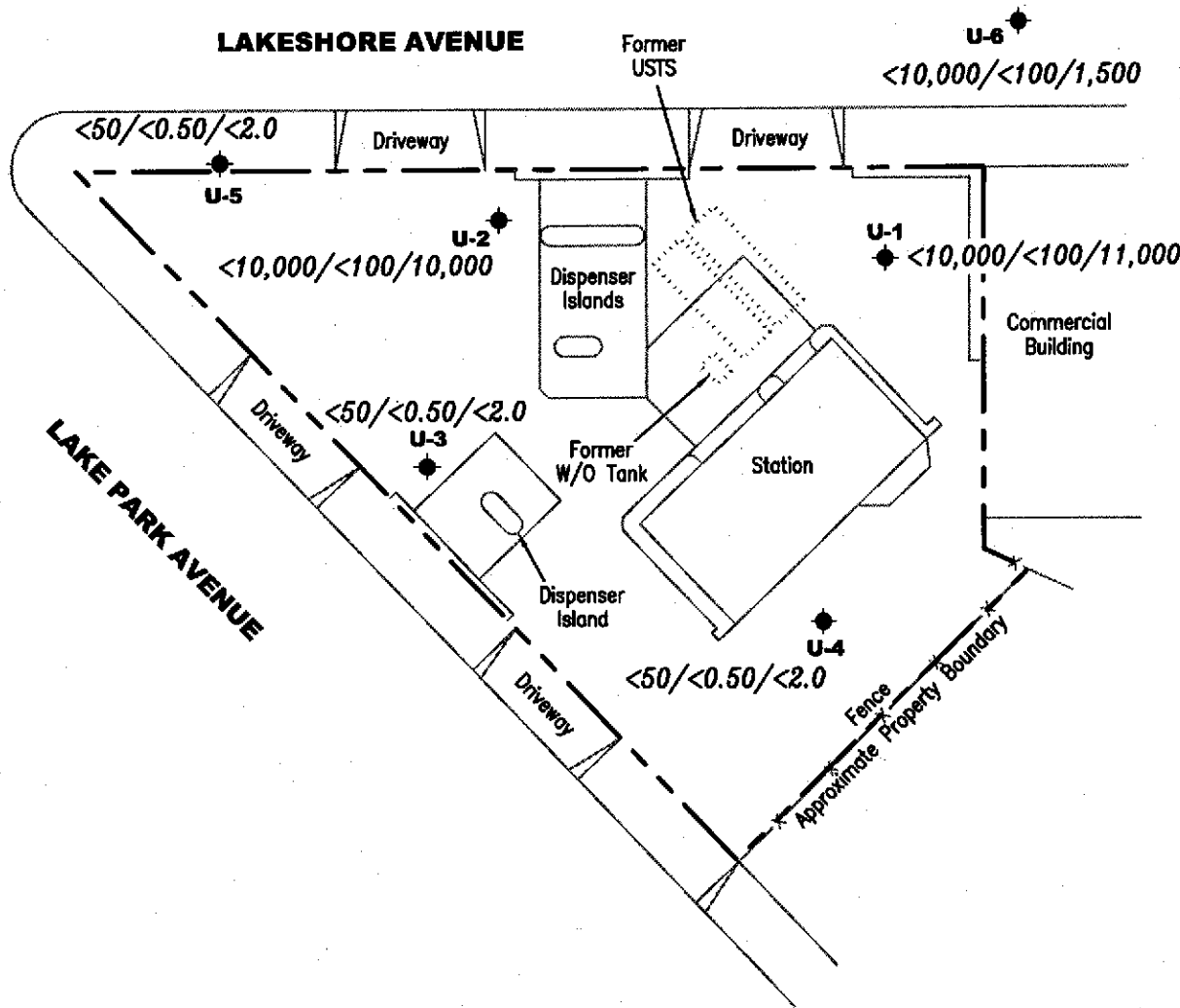

Source: Figure modified from drawing provided by MPDS Services Inc..

GETTLER - RYAN INC.
 6747 Sierra Ct., Suite J
 Dublin, CA 94568 (925) 551-7555

CONCENTRATION MAP
 Tosco (Unocal) Service Station #5325
 3220 Lakeshore Avenue
 Oakland, California

FIGURE
2

PROJECT NUMBER
 180061

REVIEWED BY

DATE
 September 24, 2003

REVISED DATE

FILE NAME: P:\ENVIRO\CONOCOPHILLIPS-TOSCO\5325\003-5325.DWG | Layout Tab: Con3

Table 1
Groundwater Monitoring Data and Analytical Results
 Tosco (Unocal) Service Station #5325
 3220 Lakeshore Avenue
 Oakland, California

WELL ID/ TOC*(ft.)	DATE	DTW (ft.)	S.I. (ft. bgs)	GWE (ft.)	Product Thickness (ft.)	TPH-G (ppb)	B (ppb)	T (ppb)	E (ppb)	X (ppb)	MTBE (ppb)	
U-1	08/10/90	--	5.0-20.0	--	--	690	38	75	8.6	130	--	
	01/07/91	--		--	--	250	22	16	4.2	17	--	
	04/01/91	--		--	--	160	13	8.6	1.0	15	--	
	07/03/91	--		--	--	140	21	4.3	0.36	17	--	
	10/09/91	--		--	--	ND	ND	ND	ND	ND	--	
	02/12/92	--		--	--	250	ND	ND	ND	ND	--	
	05/05/92	--		--	--	230	1.2	ND	ND	ND	--	
	06/11/92	--		--	--	1,000	80	1.4	6.7	41	--	
	08/20/92	--		--	--	400 ¹	1.0	ND	ND	0.6	--	
	02/22/93	--		--	--	34,000	1,400	5,500	910	7,300	--	
	05/07/93	--		--	--	8,700	600	240	650	3,300	--	
	08/08/93	--		--	--	4,900 ²	79	ND	832	270	--	
	5.32	11/16/93	8.61		-3.29	0.00	690 ³	ND	ND	ND	ND	--
		02/16/94	8.54		-3.22	0.00	6,800 ⁴	ND	ND	ND	ND	--
8.46	06/22/94	8.39		0.07	0.00	200	ND	ND	5.9	21	--	
	09/22/94	8.66		-0.20	0.00	6,100 ³	ND	ND	ND	ND	--	
	12/24/94	8.04		0.42	0.00	50,000	2,500	9,700	2,400	17,000	--	
	03/25/95	7.72		1.02**	0.37	NOT SAMPLED DUE TO THE PRESENCE OF FREE PRODUCT					--	
	06/21/95	9.30		-0.69**	0.20	NOT SAMPLED DUE TO THE PRESENCE OF FREE PRODUCT					--	
	09/19/95	9.29		-0.53**	0.40	NOT SAMPLED DUE TO THE PRESENCE OF FREE PRODUCT					--	
	12/19/95	8.98		-0.50**	0.03	NOT SAMPLED DUE TO THE PRESENCE OF FREE PRODUCT					--	
	03/18/96	8.25		0.21	0.00	27,000	ND	2,300	1,400	11,000	4,900	
	06/27/96	7.92		0.54	<0.01	120,000	540	4,300	2,600	26,000	ND	
	09/26/96	9.10		-0.62**	0.02	NOT SAMPLED DUE TO THE PRESENCE OF FREE PRODUCT					--	
	12/09/96	6.88		1.60**	0.03	NOT SAMPLED DUE TO THE PRESENCE OF FREE PRODUCT					--	
	03/14/97	9.02		-0.15**	0.55	NOT SAMPLED DUE TO THE PRESENCE OF FREE PRODUCT					--	
	06/30/97	8.41		0.07**	0.02	NOT SAMPLED DUE TO THE PRESENCE OF FREE PRODUCT					--	
	09/19/97	8.56		-0.08**	0.02	NOT SAMPLED DUE TO THE PRESENCE OF FREE PRODUCT					--	
	12/12/97	8.58		-0.11**	0.01	NOT SAMPLED DUE TO THE PRESENCE OF FREE PRODUCT					--	
	03/03/98 ¹⁷	8.23		0.26**	0.04	NOT SAMPLED DUE TO THE PRESENCE OF FREE PRODUCT					--	
	06/15/98 ¹⁷	8.37		0.09	Sheen	52,000	ND ⁷	900	1,800	13,000	ND ⁷	
09/30/98 ¹⁷	8.94		-0.48	Sheen	1,000,000 ⁸	ND ⁷	2,600	13,000	83,000	4,800		

Table 1
Groundwater Monitoring Data and Analytical Results
 Tosco (Unocal) Service Station #5325
 3220 Lakeshore Avenue
 Oakland, California

WELL ID/ TOC*(ft.)	DATE	DTW (ft.)	S.I. (ft. hgs)	GWE (ft.)	Product Thickness (ft.)	TPH-G (ppb)	B (ppb)	T (ppb)	E (ppb)	X (ppb)	MTBE (ppb)
U-1 (cont)	12/28/98 ¹⁷	8.57	5.0-20.0	-0.11	<0.01	1,100,000 ⁹	ND ⁷	1,600	8,600	71,000	5,700
	03/22/99 ¹⁷	8.18		0.28	Sheen	130,000	470	1,100	2,000	28,000	5,700
	06/09/99	9.37		-0.91	0.00	40,000	230	640	590	13,000	3,500/2,100 ¹⁰
	09/08/99 ¹⁷	9.53		-1.07	0.00	55,000 ¹¹	217	202	745	14,300	6,890/6,690 ¹⁰
	12/07/99 ¹⁷	9.67		-1.21	0.00	41,200 ¹³	89.3	ND ⁷	385	6,930	15,800/14,700 ¹²
	03/13/00 ¹⁷	8.44		0.02	0.00	48,000 ¹¹	490	610	2,400	10,000	22,000/23,000 ¹⁰
	06/21/00 ¹⁷	9.45		-0.99	0.00	37,000 ¹¹	200	ND ⁷	1,200	7,200	15,000/20,000 ¹⁰
	09/27/00 ¹⁷	9.29		-0.83	0.00	15,000 ¹¹	92	ND ⁷	540	2,800	74,000/83,000 ¹⁵
	12/12/00 ¹⁷	9.37		-0.91	0.00	50,000 ¹⁶	ND ⁷	ND ⁷	250	1,900	12,000/15,000 ¹²
	03/07/01 ¹⁷	8.45		0.01	0.00	6,220 ¹³	29.8	10.4	96.3	638	11,200/11,800 ¹⁰
	06/06/01 ¹⁷	9.29		-0.83	0.00	5,200 ¹³	17	ND ⁷	69	420	6,500/8,700 ¹²
	09/24/01 ¹⁷	9.39		-0.93	0.00	4,300 ¹⁸	36	<25	65	590	4,400/4,400 ¹⁰
	12/10/01 ²⁰	9.17		-0.71	0.00	11,000 ¹⁸	220	<100	380	1,500	5,100/5,100 ¹⁰
	03/11/02 ²⁰	9.44		-0.98	0.00	5,500 ¹³	28	<20	360	690	6,400/6,300 ¹⁰
	06/04/02 ²⁰	8.32		0.14	0.00	4,600 ¹⁸	31	<10	240	180	6,500
	09/03/02 ²⁰	9.36		-0.90	0.00	2,300 ²¹	<12	<12	<12	68	3,500/4,700 ¹⁰
	12/03/02 ^{20,22}	8.18		0.28	0.00	<5,000	<50	<50	<50	<100	4,700
	03/04/03 ²²	8.29		0.17	0.00	8,900	26	<25	400	130	5,500
	06/18/03 ²²	7.58		0.88	0.00	8,300	<25	<25	<25	<50	10,000
09/24/03 ²²	8.18		0.28	0.00	<10,000	<100	<100	<100	<200	11,000	
U-2	08/10/90	--	5.0-20.0	--	--	780	27	46	15	130	--
	01/07/91	--		--	--	1,900	67	5.8	58	69	--
	04/01/91	--		--	--	1,700	250	89	34	190	--
	07/03/91	--		--	--	2,100	150	25	3.1	290	--
	10/09/91	--		--	--	230	7.1	ND	ND	11	--
	02/12/92	--		--	--	410	1.9	ND	0.36	0.4	--
	05/05/92	--		--	--	1,600	120	52	6.2	290	--
	06/11/92	--		--	--	620	17	2.1	ND	37	--
	08/20/92	--		--	--	700	28	6.5	1.3	4.6	--
	02/22/93	--		--	--	3,400	2,400	2,100	1,200	5,800	--

Table 1
Groundwater Monitoring Data and Analytical Results
 Tosco (Unocal) Service Station #5325
 3220 Lakeshore Avenue
 Oakland, California

WELL ID/ TOC* (ft.)	DATE	DTW (ft.)	S.I. (ft. bgs)	GWE (ft.)	Product Thickness (ft.)	TPH-G (ppb)	B (ppb)	T (ppb)	E (ppb)	X (ppb)	MTBE (ppb)
U-2	05/07/93	--	5.0-20.0	--	--	17,000	1,800	660	1,700	4,000	--
(cont)	08/08/93	--		--	--	5,600 ²	420	ND	410	670	--
4.53	11/16/93	8.17		-3.64	0.00	510 ³	ND	ND	ND	ND	--
	02/16/94	7.73		-3.20	0.00	980 ⁴	49	13	2.7	40	--
7.62	06/22/94	7.60		0.02	0.00	31,000	2,200	62	1,500	3,500	--
	09/22/94	7.93		-0.31	0.00	8,500 ³	29	ND	ND	ND	--
	12/24/94	7.27		0.35	0.00	32,000	1,500	890	1,300	5,000	--
	03/25/95	7.01		0.61	0.00	170,000	1,900	21,000	4,800	33,000	--
	06/21/95	6.98		0.64	0.00	16,000	2,100	ND	1,800	1,700	-- ⁵
	09/19/95	7.70		-0.08	0.00	3,000	610	ND	78	240	-- ⁶
	12/19/95	7.30		0.32	0.00	1,600	140	55	52	270	--
	03/18/96	6.45		1.17	0.00	12,000	2,200	ND	1,200	2,200	22,000
	06/27/96	7.41		0.21	0.00	28,000	3,400	ND	2,800	3,100	3,000
	09/26/96	7.90		-0.28	0.00	5,900	750	ND	ND	ND	18,000
	12/09/96	6.76		0.86	0.00	13,000	5,100	290	980	370	2,700
	03/14/97	7.12		0.52**	0.03	NOT SAMPLED DUE TO THE PRESENCE OF FREE PRODUCT					--
	06/30/97	6.19		1.43	<0.01	NOT SAMPLED DUE TO THE PRESENCE OF FREE PRODUCT					--
	09/19/97	7.31		0.31	<0.01	NOT SAMPLED DUE TO THE PRESENCE OF FREE PRODUCT					--
	12/12/97	6.75		0.88**	<0.01	NOT SAMPLED DUE TO THE PRESENCE OF FREE PRODUCT					--
	03/03/98	6.36		1.26	Sheen	80,000	3,000	1,100	820	16,000	16,000
	06/15/98	6.51		1.11	Sheen	48,000	1,800	330	470	7,900	20,000
	09/30/98	7.17		0.45	Sheen	60,000	1,300	ND ⁷	500	9,700	19,000
	12/28/98	7.06		0.56	0.00	63,000	590	160	320	5,600	16,000
	03/22/99	6.82		0.80	0.00	28,000	1,100	ND ⁷	360	2,900	25,000
	06/09/99	7.51		0.11	0.00	21,000	110	190	310	2,600	7,900/7,800 ¹⁰
	09/08/99	8.16		-0.54	0.00	23,300 ¹¹	477	138	286	4,110	16,400/15,300 ¹⁰
	12/07/99	8.31		-0.69	0.00	4,840 ¹³	17.2	ND ⁷	ND ⁷	157	14,900/15,600 ¹²
	03/13/00	6.69		0.93	0.00	11,000 ¹¹	380	160	ND ⁷	2,100	22,000/26,000 ¹⁰
	06/21/00	7.67		-0.05	0.00	9,100 ¹¹	22	ND ⁷	ND ⁷	800	16,000/22,000 ¹⁰
	09/27/00	7.44		0.18	0.00	2,900 ¹¹	43	ND ⁷	ND ⁷	39	20,000/26,000 ¹⁵
	12/12/00	7.51		0.11	0.00	3,600 ¹¹	17	ND ⁷	ND ⁷	87	8,000/7,800 ¹²
	03/07/01	7.15		0.47	0.00	1,670 ¹³	51.0	ND ⁷	7.20	19.5	5,930/7,900 ¹⁰

Table 1
Groundwater Monitoring Data and Analytical Results
 Tosco (Unocal) Service Station #5325
 3220 Lakeshore Avenue
 Oakland, California

WELL ID/ TOC*(ft.)	DATE	DTW (ft.)	S.I. (ft. bgs)	GWE (ft.)	Product Thickness (ft.)	TPH-G (ppb)	B (ppb)	T (ppb)	E (ppb)	X (ppb)	MTBE (ppb)
U-2	06/06/01	7.57	5.0-20.0	0.05	0.00	1,100 ¹¹	14	ND ⁷	9.3	35	9,200/10,000 ¹²
(cont)	09/24/01	7.63		-0.01	0.00	1,000 ¹⁸	25	<2.5	12	100	9,800/11,000 ¹⁰
	12/10/01	6.78		0.84	0.00	83	14	0.55	3.4	6.8	2,500/2,500 ¹⁰
	03/11/02	7.12		0.50	0.00	<1,000	28	<10	40	31	11,000/11,000 ¹⁰
	06/04/02	7.18		0.44	0.00	7,700 ¹⁸	32	<25	33	48	14,000
	09/03/02	7.58		0.04	0.00	5,200 ²¹	<25	<25	<25	<25	11,000/15,000 ¹⁰
	12/03/02 ²²	7.68		-0.06	0.00	<5,000	<50	<50	<50	<100	3,200
	03/04/03 ²²	7.77		-0.15	0.00	8,100 ²¹	<50	<50	<50	<100	7,800
	06/18/03 ²²	6.87		0.75	0.00	11,000 ²¹	<50	<50	<50	<100	16,000
	09/24/03 ²²	7.49		0.13	0.00	<10,000	<100	<100	<100	<200	10,000
U-3	08/10/90	--	5.0-20.0	--	--	ND	ND	ND	ND	ND	--
	01/07/91	--		--	--	ND	ND	ND	ND	1.8	--
	04/01/91	--		--	--	ND	1.0	2.9	0.53	5.4	--
	07/03/91	--		--	--	ND	ND	ND	ND	ND	--
	10/09/91	--		--	--	ND	ND	ND	ND	ND	--
	02/12/92	--		--	--	ND	ND	ND	ND	ND	--
	05/05/92	--		--	--	ND	ND	ND	ND	ND	--
	06/11/92	--		--	--	ND	ND	ND	ND	ND	--
	08/20/92	--		--	--	ND	ND	ND	ND	ND	--
	02/22/93	--		--	--	ND	ND	ND	ND	ND	--
	05/07/93	--		--	--	ND	ND	ND	ND	ND	--
	08/08/93	--		--	--	210	5.0	9.7	0.7	4.1	--
7.86	11/16/93	11.82		-3.96	0.00	ND	ND	ND	ND	ND	--
	02/16/94	11.62		-3.76	0.00	ND	ND	ND	ND	ND	--
10.98	06/22/94	11.64		-0.66	0.00	ND	ND	ND	ND	ND	--
	09/22/94	11.76		-0.78	0.00	ND	ND	ND	ND	ND	--
	12/24/94	11.28		-0.30	0.00	ND	ND	ND	ND	ND	--
	03/25/95	10.96		0.02	0.00	ND	ND	ND	ND	ND	--
	06/21/95	11.37		-0.39	0.00	ND	ND	ND	ND	ND	--
	09/19/95	11.55		-0.57	0.00	ND	ND	ND	ND	ND	-- ⁵

Table 1
Groundwater Monitoring Data and Analytical Results
 Tosco (Unocal) Service Station #5325
 3220 Lakeshore Avenue
 Oakland, California

WELL ID/ TOC* (ft.)	DATE	DTW (ft.)	S.I. (ft. bgs)	GWE (ft.)	Product Thickness (ft.)	TPH-G (ppb)	B (ppb)	T (ppb)	E (ppb)	X (ppb)	MTBE (ppb)
U-3	12/19/95	11.45	5.0-20.0	-0.47	0.00	ND	ND	ND	ND	ND	--
(cont)	03/18/96	11.10		-0.12	0.00	ND	ND	ND	ND	ND	--
	06/27/96	11.16		-0.18	0.00	440	49	50	51	140	50
	09/26/96	11.55		-0.57	0.00	ND	ND	ND	ND	ND	ND
	12/09/96	10.12		0.86	0.00	ND	ND	ND	ND	ND	29
	03/14/97	10.87		0.11	0.00	ND	ND	ND	ND	ND	ND
	06/30/97	11.08		-0.10	0.00	ND	ND	ND	ND	ND	ND
	09/19/97	11.05		-0.07	0.00	ND	ND	ND	ND	ND	ND
	12/12/97	10.58		0.40	0.00	ND	ND	ND	ND	ND	ND
	03/03/98	9.84		1.14	0.00	ND	ND	ND	ND	ND	ND
	06/15/98	10.56		0.42	0.00	ND	ND	ND	ND	ND	ND
	09/30/98	11.12		-0.14	0.00	ND	ND	ND	ND	ND	ND
	12/28/98	10.96		0.02	0.00	ND	ND	ND	ND	ND	ND
	03/22/99	9.46		1.52	0.00	ND	ND	ND	ND	ND	ND
	06/09/99	11.01		-0.03	0.00	ND	ND	ND	ND	ND	ND
	09/08/99	11.31		-0.33	0.00	ND	ND	ND	ND	ND	ND
	12/07/99	11.26		-0.28	0.00	ND	ND	ND	ND	ND	ND
	03/13/00	8.28		2.70	0.00	ND	ND	ND	ND	ND	ND
	06/21/00	11.12		-0.14	0.00	ND	ND	ND	ND	ND	ND
	09/27/00	11.07		-0.09	0.00	ND	ND	ND	ND	ND	ND
	12/12/00	10.94		0.04	0.00	ND	ND	ND	ND	ND	ND
	03/07/01	8.32		2.66	0.00	ND	ND	ND	ND	ND	ND
	06/06/01	10.94		0.04	0.00	ND	ND	ND	ND	ND	ND
	09/24/01	11.03		-0.05	0.00	<50	<0.50	<0.50	<0.50	<0.50	<2.5
	12/10/01	8.16		2.82	0.00	<50	<0.50	<0.50	<0.50	<0.50	<2.5
	03/11/02	7.82		3.16	0.00	<50	<0.50	<0.50	<0.50	<0.50	<5.0
	06/04/02	10.58		0.40	0.00	<50	<0.50	<0.50	<0.50	<0.50	<2.5
	09/03/02	10.94		0.04	0.00	<50	<0.50	<0.50	<0.50	<0.50	<2.5
	12/03/02 ²²	10.66		0.32	0.00	<50	<0.50	<0.50	<0.50	<1.0	<2.0
	03/04/03 ²²	10.76		0.22	0.00	<50	<0.50	<0.50	<0.50	<1.0	<2.0
	06/18/03 ²²	10.26		0.72	0.00	<50	<0.50	<0.50	<0.50	<1.0	<2.0
	09/24/03 ²²	10.88		0.10	0.00	<50	<0.50	<0.50	<0.50	<1.0	<2.0

Table 1
Groundwater Monitoring Data and Analytical Results
 Tosco (Unocal) Service Station #5325
 3220 Lakeshore Avenue
 Oakland, California

WELL ID/ TOC* (ft.)	DATE	DTW (ft.)	S.I. (ft. bgs)	GWE (ft.)	Product Thickness (ft.)	TPH-G (ppb)	B (ppb)	T (ppb)	E (ppb)	X (ppb)	MTBE (ppb)
U-4											
11.15	06/22/94	10.16	5.0-20.0	0.99	0.00	ND	ND	ND	ND	ND	--
	09/22/94	10.79		0.36	0.00	ND	0.78	1.3	ND	1.4	--
	12/24/94	9.81		1.34	0.00	ND	ND	ND	ND	ND	--
	03/25/95	9.51		1.64	0.00	ND	ND	ND	ND	ND	--
	06/21/95	9.54		1.61	0.00	ND	ND	ND	ND	ND	--
	09/19/95	10.17		0.98	0.00	ND	ND	ND	ND	ND	--
	12/19/95	9.98		1.17	0.00	ND	ND	ND	ND	ND	--
	03/18/96	9.66		1.49	0.00	ND	ND	ND	ND	ND	--
	06/27/96	9.74		1.41	0.00	ND	ND	ND	ND	ND	ND
	09/26/96	10.14		1.01	0.00	ND	ND	ND	ND	ND	ND
	12/09/96	8.67		2.48	0.00	ND	ND	ND	ND	ND	33
	03/14/97	9.35		1.80	0.00	ND	ND	ND	ND	ND	ND
	06/30/97	9.89		1.26	0.00	ND	ND	ND	ND	ND	ND
	09/19/97	9.96		1.19	0.00	ND	ND	ND	ND	ND	ND
	12/12/97	8.56		2.59	0.00	ND	ND	ND	ND	ND	ND
	03/03/98	7.85		3.30	0.00	ND	ND	ND	ND	ND	ND
	06/15/98	9.08		2.07	0.00	ND	ND	ND	ND	ND	ND
	09/30/98	9.75		1.40	0.00	ND	ND	ND	ND	ND	ND
	12/28/98	9.59		1.56	0.00	ND	ND	ND	ND	ND	ND
	03/22/99	8.34		2.81	0.00	ND	ND	ND	ND	ND	ND
	06/09/99	9.39		1.76	0.00	ND	ND	ND	ND	ND	ND
	09/08/99	9.90		1.25	0.00	ND	ND	ND	ND	ND	ND
	12/07/99	10.05		1.10	0.00	ND	ND	ND	ND	ND	ND
	03/13/00	7.24		3.91	0.00	ND	ND	ND	ND	ND	ND
	06/21/00	9.48		1.67	0.00	ND	ND	ND	ND	ND	ND
	09/27/00	9.42		1.73	0.00	ND	ND	ND	ND	ND	ND
	12/12/00	9.50		1.65	0.00	ND	ND	ND	ND	ND	ND
	03/07/01	6.88		4.27	0.00	ND	ND	ND	ND	ND	ND
	06/06/01	9.18		1.97	0.00	ND	ND	ND	ND	ND	ND
	09/24/01	9.21		1.94	0.00	<50	<0.50	<0.50	<0.50	<0.50	<2.5
	12/10/01	7.32		3.83	0.00	<50	<0.50	<0.50	<0.50	<0.50	<2.5

Table 1
Groundwater Monitoring Data and Analytical Results
 Tosco (Unocal) Service Station #5325
 3220 Lakeshore Avenue
 Oakland, California

WELL ID/ TOC* (ft.)	DATE	DTW (ft.)	S.I. (ft. bgs)	GWE (ft.)	Product Thickness (ft.)	TPH-G (ppb)	B (ppb)	T (ppb)	E (ppb)	X (ppb)	MTBE (ppb)
U-4 (cont)	03/11/02	6.92	5.0-20.0	4.23	0.00	<50	<0.50	<0.50	<0.50	<0.50	<5.0
	06/04/02	7.58		3.57	0.00	<50	<0.50	<0.50	<0.50	<0.50	<2.5
	09/03/02	9.17		1.98	0.00	<50	<0.50	<0.50	<0.50	<0.50	<2.5
	12/03/02 ²²	9.20		1.95	0.00	<50	<0.50	<0.50	<0.50	<1.0	<2.0
	03/04/03 ²²	9.32		1.83	0.00	<50	<0.50	<0.50	<0.50	<1.0	<2.0
	06/18/03 ²²	7.65		3.50	0.00	<50	<0.50	<0.50	<0.50	<1.0	<2.0
	09/24/03 ²²	8.26		2.89	0.00	<50	<0.50	<0.50	<0.50	<1.0	<2.0
U-5 6.98	06/22/94	6.83	5.0-20.0	0.15	0.00	210	7.1	13	4.5	26	--
	09/22/94	6.90		0.08	0.00	170	8.4	10	8.5	18	--
	12/24/94	6.43		0.55	0.00	8,700	560	70	670	430	--
	03/25/95	6.35		0.63	0.00	44,000	390	960	1,500	7,600	--
	06/21/95	7.11		-0.13	0.00	400	2.3	ND	9.1	3.5	--
	09/19/95	6.99		-0.01	0.00	850	14	7.1	13	66	-- ⁵
	12/19/95	7.17		-0.19	0.00	ND	ND	ND	ND	ND	--
	03/18/96	6.65		0.33	0.00	100	0.67	0.5	0.51	5.4	--
	06/27/96	6.49		0.49	0.00	16,000	280	150	1,400	4,600	530
	09/26/96	7.13		-0.15	0.00	ND	ND	0.57	ND	0.96	ND
	12/09/96	5.90		1.08	0.00	1,300	29	46	ND	140	97
	03/14/97	6.99		-0.01	0.00	ND	ND	ND	ND	ND	14
	06/30/97	7.08		-0.10	0.00	4,200	74	51	180	980	270
	09/19/97	6.78		0.20	0.00	6,300	160	13	370	1000	480
	12/12/97	6.94		0.04	0.00	60	1.3	ND	1.6	2.1	47
	03/03/98	6.50		0.48	0.00	1,700	29	ND ⁷	150	190	330
	06/15/98	6.85		0.13	0.00	1,500	32	ND ⁷	91	83	330
	09/30/98	7.31		-0.33	0.00	1,700	44	ND ⁷	39	150	60
	12/28/98	7.25		-0.27	0.00	1,400	59	ND ⁷	13	27	150
	03/22/99	6.86		0.12	0.00	780	8.9	ND	0.76	4.5	350
06/09/99	7.28		-0.30	0.00	1,000	ND ⁷	ND ⁷	10	35	280/350 ¹⁰	
09/08/99	7.52		-0.54	0.00	2,620 ¹¹	26.2	ND ⁷	32.2	157	280/239 ¹²	

Table 1
Groundwater Monitoring Data and Analytical Results
 Tosco (Unocal) Service Station #5325
 3220 Lakeshore Avenue
 Oakland, California

WELL ID/ TOC* (ft.)	DATE	DTW (ft.)	S.I. (ft. bgs)	GWE (ft.)	Product Thickness (ft.)	TPH-G (ppb)	B (ppb)	T (ppb)	E (ppb)	X (ppb)	MTBE (ppb)
U-5	12/07/99	7.67	5.0-20.0	-0.69	0.00	949 ¹¹	9.26	ND ⁷	11.2	22.7	235/301 ¹²
(cont)	03/13/00	6.73		0.25	0.00	880 ¹⁴	12	1.0	5.6	8.7	46/37 ¹⁰
	06/21/00	7.39		-0.41	0.00	700 ¹¹	4.0	ND	0.99	4.0	120/140 ¹⁰
	09/27/00	7.45		-0.47	0.00	400 ¹¹	1.9	ND	ND	1.5	160/250 ¹⁵
	12/12/00	7.68		-0.70	0.00	770 ¹¹	3.2	ND ⁷	ND ⁷	ND ⁷	27/13 ¹²
	03/07/01	6.83		0.15	0.00	623 ¹³	5.15	ND	ND	0.669	35.7/43.4 ¹⁰
	06/06/01	7.42		-0.44	0.00	110 ¹³	ND	ND	ND	ND	ND
	09/24/01	7.50		-0.52	0.00	270 ¹⁹	<0.50	<0.50	<0.50	<0.50	40/42 ¹⁰
	12/10/01	6.65		0.33	0.00	420 ¹⁸	13	0.60	0.66	<0.50	<2.5
	03/11/02	7.00		-0.02	0.00	260 ¹³	<0.50	<0.50	<0.50	<0.50	42/47 ¹⁰
	06/04/02	6.71		0.27	0.00	170 ¹⁹	<0.50	0.77	0.87	0.69	29
	09/03/02	7.47		-0.49	0.00	<50	<0.50	<0.50	<0.50	<0.50	37/53 ¹⁰
	12/03/02 ²²	6.64		0.34	0.00	320	<0.50	<0.50	5.7	<1.0	11
	03/04/03 ²²	6.75		0.23	0.00	100 ²¹	<0.50	<0.50	<0.50	<1.0	44
	06/18/03 ²²	6.25		0.73	0.00	51 ²¹	<0.50	<0.50	<0.50	<1.0	36
	09/24/03 ²²	6.86		0.12	0.00	<50	<0.50	<0.50	<0.50	<1.0	<2.0
U-6											
7.14	06/22/94	7.14	5.0-24.0	0.00	0.00	ND	ND	ND	ND	ND	--
	09/22/94	7.34		-0.20	0.00	130	1.3	0.8	ND	0.73	--
	12/24/94	6.67		0.47	0.00	6,900	500	59	600	380	--
	03/25/95	6.29		0.85	0.00	47,000	450	1,300	1,700	8,200	--
	06/21/95	7.60		-0.46	0.00	ND	ND	ND	ND	ND	--
	09/19/95	7.70		-0.56	0.00	ND	ND	ND	ND	ND	-- ⁵
	12/19/95	7.75		-0.61	0.00	210	2.5	1.0	2.9	17	--
	03/18/96	6.86		0.28	0.00	ND	ND	ND	ND	ND	--
	06/27/96	6.52		0.62	0.00	ND	ND	ND	ND	ND	510
	09/26/96	7.62		-0.48	0.00	ND	ND	ND	ND	ND	1,400
	12/09/96	5.88		1.26	0.00	1,200	29	48	6.4	140	58
	03/14/97	7.30		-0.16	0.00	ND	ND	ND	ND	ND	1,500
	06/30/97	7.35		-0.21	0.00	ND	ND	ND	ND	ND	990

Table 1
Groundwater Monitoring Data and Analytical Results
 Tosco (Unocal) Service Station #5325
 3220 Lakeshore Avenue
 Oakland, California

WELL ID/ TOC*(ft.)	DATE	DTW (ft.)	S.I. (ft. bgs)	GWE (ft.)	Product Thickness (ft.)	TPH-G (ppb)	B (ppb)	T (ppb)	E (ppb)	X (ppb)	MTBE (ppb)
U-6 (cont)	09/19/97	7.25	5.0-24.0	-0.11	0.00	ND	ND	ND	ND	ND	1,400
	12/12/97	7.29		-0.15	0.00	ND	ND	ND	ND	ND	680
	03/03/98	7.00		0.14	0.00	ND	ND	ND	ND	ND	1,600
	06/15/98	7.18		-0.04	0.00	ND ⁷	ND ⁷	ND ⁷	ND ⁷	ND ⁷	1,000
	09/30/98	7.90		-0.76	0.00	ND	ND	ND	ND	ND	1,200
	12/28/98	7.79		-0.65	0.00	ND ⁷	ND ⁷	ND ⁷	ND ⁷	ND ⁷	730
	03/22/99	7.47		-0.33	0.00	ND	ND	ND	ND	ND	1,800
	06/09/99	7.73		-0.59	0.00	ND ⁷	ND ⁷	ND ⁷	ND ⁷	ND ⁷	1,000/850 ¹⁰
	09/08/99	7.95		-0.81	0.00	ND	ND	ND	ND	ND	851/1,040 ¹⁰
	12/07/99	8.10		-0.96	0.00	ND	ND	ND	ND	ND	1,140/1,150 ¹²
	03/13/00	6.95		0.19	0.00	ND	ND	ND	ND	ND	560/670 ¹⁰
	06/21/00	7.84		-0.70	0.00	ND	ND	ND	ND	ND	400/590 ¹⁰
	09/27/00	7.68		-0.54	0.00	ND	ND	ND	ND	ND	2,500/2,800 ¹⁵
	12/12/00	7.74		-0.60	0.00	ND	ND	ND	ND	ND	590/580 ¹²
	03/07/01	7.27		-0.13	0.00	ND	ND	ND	ND	ND	310/321 ¹²
	06/06/01	7.80		-0.66	0.00	ND	ND	ND	ND	ND	250/330 ¹²
	09/24/01	7.82		-0.68	0.00	<50	<0.50	<0.50	<0.50	<0.50	530/660 ¹⁰
	12/10/01	7.15		-0.01	0.00	<50	<0.50	<0.50	<0.50	<0.50	220/220 ¹⁰
	03/11/02	7.32		-0.18	0.00	<50	<0.50	<0.50	<0.50	<0.50	720/760 ¹⁰
	06/04/02	7.18		-0.04	0.00	250 ¹⁹	<1.0	<1.0	<1.0	<1.0	470
	09/03/02	7.72		-0.58	0.00	420 ²¹	<2.5	<2.5	<2.5	4.7	860/1,200 ¹⁰
	12/03/02 ²²	6.92		0.22	0.00	<500	<5.0	<5.0	<5.0	<10	870
03/04/03 ²²	7.01		0.13	0.00	2,300 ²¹	<10	<10	<10	<20	2,700	
06/18/03 ²²	6.60		0.54	0.00	1,300 ²¹	<10	<10	<10	<20	1,700	
09/24/03 ²²	7.24		-0.10	0.00	<10,000	<100	<100	<100	<200	1,500	
Trip Blank											
TB-LB	03/03/98	--	--	--	--	ND	ND	ND	ND	ND	ND
	06/15/98	--	--	--	--	ND	ND	ND	ND	ND	ND
	09/30/98	--	--	--	--	ND	ND	1.7	ND	2.2	ND
	12/28/98	--	--	--	--	ND	ND	0.71	ND	0.72	9.5

Table 1
Groundwater Monitoring Data and Analytical Results
 Tosco (Unocal) Service Station #5325
 3220 Lakeshore Avenue
 Oakland, California

WELL ID/ TOC*(ft.)	DATE	DTW (ft.)	S.I. (ft. bgs)	GWE (ft.)	Product Thickness (ft.)	TPH-G (ppb)	B (ppb)	T (ppb)	E (ppb)	X (ppb)	MTBE (ppb)	
TB-LB (cont)	03/22/99	--	--	--	--	ND	ND	ND	ND	ND	ND	
	06/09/99	--	--	--	--	ND	ND	ND	ND	ND	ND	
	09/08/99	--	--	--	--	ND	ND	ND	ND	ND	ND	
	12/07/99	--	--	--	--	ND	ND	0.762	ND	ND	ND	
	03/13/00	--	--	--	--	ND	ND	ND	ND	ND	ND	
	06/21/00	--	--	--	--	ND	ND	ND	ND	ND	ND	
	09/27/00	--	--	--	--	ND	ND	ND	ND	ND	ND	
	12/12/00	--	--	--	--	ND	ND	ND	ND	ND	ND	
	03/07/01	--	--	--	--	ND	ND	ND	ND	ND	ND	
	06/06/01	--	--	--	--	ND	ND	ND	ND	ND	ND	
	09/24/01	--	--	--	--	<50	<0.50	<0.50	<0.50	<0.50	<2.5	
	12/10/01	--	--	--	--	<50	<0.50	<0.50	<0.50	<0.50	<2.5	
	03/11/02	--	--	--	--	<50	<0.50	<0.50	<0.50	<0.50	<2.5	
	QA	06/04/02	--	--	--	--	<50	<0.50	<0.50	<0.50	<0.50	<2.5
		09/03/02	--	--	--	--	<50	<0.50	0.83	<0.50	0.50	<2.5
12/03/02 ²²		--	--	--	--	<50	<0.50	<0.50	<0.50	<1.0	<2.0	
03/04/03 ²²		--	--	--	--	<50	<0.50	<0.50	<0.50	<1.0	<2.0	
06/18/03 ²²		--	--	--	--	<50	<0.50	<0.50	<0.50	<1.0	<2.0	
09/24/03 ²²	--	--	--	--	<50	<0.50	<0.50	<0.50	<1.0	<2.0		

Table 1
Groundwater Monitoring Data and Analytical Results
 Tosco (Unocal) Service Station #5325
 3220 Lakeshore Avenue
 Oakland, California

EXPLANATIONS:

Groundwater monitoring data and laboratory analytical results prior to March 3, 1998, were compiled from reports prepared by MPDS Services, Inc.

TOC = Top of Casing	TPH-G = Total Petroleum Hydrocarbons as Gasoline	(ppb) = Parts per billion
(ft.) = Feet	B = Benzene	ND = Not Detected
DTW = Depth to Water	T = Toluene	-- = Not Measured/Not Analyzed
S.I. = Screen Interval	E = Ethylbenzene	QA = Quality Assurance/Trip Blank
(ft. bgs) = Feet Below Ground Surface	X = Xylenes	
GWE = Groundwater Elevation	MTBE = Methyl tertiary butyl ether	

- * TOC elevations are surveyed relative to City of Oakland Benchmark, at the northeasterly corner of Weller and Cheney Avenue (Elevation = 9.055 feet, city datum; add 3.00' to U.S.G.S. datum). Prior to November 16, 1993, the DTW measurements were taken from the well cover.
- ** Groundwater elevation corrected due to the presence of free product; correction factor = $[(TOC-DTW)+(Product\ Thickness \times 0.75)]$.
- 1 The positive result for gasoline does not appear to have a typical gasoline pattern.
- 2 The concentration reported as gasoline is primarily due to the presence of a combination of gasoline and a discrete peak not indicative of gasoline.
- 3 Laboratory report indicates the hydrocarbons detected did not appear to be gasoline
- 4 Laboratory report indicates the hydrocarbons detected appeared to be a gasoline and non-gasoline mixture.
- 5 Laboratory has potentially identified the presence of MTBE at reportable levels in the groundwater sample collected from this well.
- 6 Laboratory has identified the presence of MTBE at a level above or equal to the taste and odor threshold of 40 ppb in the sample collected from this well.
- 7 Detection limit raised. Refer to analytical reports.
- 8 Laboratory report indicates unidentified hydrocarbons C6-C12.
- 9 Laboratory report indicates gasoline and unidentified hydrocarbons >C8.
- 10 MTBE by EPA Method 8260.
- 11 Laboratory report indicates gasoline C6-C12.
- 12 MTBE by EPA Method 8260 analyzed past the recommended holding time.
- 13 Laboratory report indicates weathered gasoline C6-C12.
- 14 Laboratory report indicates gasoline C6-C12 + unidentified hydrocarbons <C6.
- 15 Laboratory report indicates sample was originally analyzed within holding time. Re-analysis for confirmation or dilution was performed past the recommended holding time.
- 16 Laboratory report indicates gasoline C6-C12 + unidentified hydrocarbons >C10.
- 17 Skimmer present in well.
- 18 Laboratory report indicates gasoline C6-C10.
- 19 Laboratory report indicates unidentified hydrocarbons C6-C10.
- 20 Skimmer not present in well.
- 21 Laboratory report indicates hydrocarbon pattern is present in the requested fuel quantitation range but does not resemble the pattern of the requested fuel.
- 22 TPH-G, BTEX and MTBE by EPA Method 8260.

Table 2
Groundwater Analytical Results - Oxygenate Compounds
 Tosco (Unocal) Service Station #5325
 3220 Lakeshore Avenue
 Oakland, California

WELL ID	DATE	ETHANOL (ppb)	TBA (ppb)	MTBE (ppb)	DIPE (ppb)	ETBE (ppb)	TAME (ppb)	1,2-DCA (ppb)	EDB (ppb)
U-1	09/27/00 ¹	--	ND ²	83,000	ND ²	ND ²	ND ²	ND ²	ND ²
	12/12/00	--	--	15,000 ³	--	--	--	--	--
	03/07/01	ND ²	ND ²	11,800	ND ²	ND ²	ND ²	ND ²	ND ²
	06/06/01 ³	ND ²	ND ²	8,700	ND ²	ND ²	ND ²	ND ²	ND ²
	09/24/01	<400,000	<20,000	4,400	<1,000	<1,000	<1,000	<1,000	<1,000
	12/10/01	<8,000	<4,000	5,100	<100	<100	<100	<100	<100
	03/11/02	<25,000	<5,000	6,300	<100	<100	<100	<100	<100
	06/04/02 ⁴	--	--	--	--	--	--	--	--
	09/03/02	<50,000	<10,000	4,700	<200	<200	<200	<200	<200
	12/03/02	<50,000	<10,000	4,700	<200	<200	<200	<200	<200
	03/04/03	<25,000	<5,000	5,500	<100	<100	<100	<100	<100
	06/18/03	<25,000	<5,000	10,000	<100	<100	<100	<100	<100
	09/24/03	<100,000	<20,000	11,000	<400	<400	<400	<400	<400
	U-2	09/27/00	--	--	26,000 ¹	--	--	--	--
12/12/00		--	--	7,800 ³	--	--	--	--	--
03/07/01		ND ²	ND ²	7,900	ND ²	ND ²	ND ²	ND ²	ND ²
06/06/01 ³		ND ²	ND ²	10,000	ND ²	ND ²	ND ²	ND ²	ND ²
09/24/01		<400,000	<20,000	11,000	<1,000	<1,000	<1,000	<1,000	<1,000
12/10/01		<4,000	<2,000	2,500	<50	<50	<50	<50	<50
03/11/02		<50,000	<10,000	11,000	<200	<200	<200	<200	<200
06/04/02 ⁴		--	--	--	--	--	--	--	--
09/03/02		<250,000	<50,000	15,000	<1,000	<1,000	<1,000	<1,000	<1,000
12/03/02		<50,000	<10,000	3,200	<200	<200	<200	<200	<200
03/04/03		<50,000	<10,000	7,800	<200	<200	<200	<200	<200
06/18/03		<50,000	<10,000	16,000	<200	<200	<200	<200	<200
09/24/03		<100,000	<20,000	10,000	<400	<400	<400	<400	<400

Table 2
Groundwater Analytical Results - Oxygenate Compounds
 Tosco (Unocal) Service Station #5325
 3220 Lakeshore Avenue
 Oakland, California

WELL ID	DATE	ETHANOL (ppb)	TBA (ppb)	MTBE (ppb)	DIPE (ppb)	ETBE (ppb)	TAME (ppb)	1,2-DCA (ppb)	EDB (ppb)
U-3	12/03/02	--	--	<2.0	--	--	--	--	--
	03/04/03	--	--	<2.0	--	--	--	--	--
	06/18/03	--	--	<2.0	--	--	--	--	--
	09/24/03	<500	--	<2.0	--	--	--	--	--
U-4	12/03/02	--	--	<2.0	--	--	--	--	--
	03/04/03	--	--	<2.0	--	--	--	--	--
	06/18/03	--	--	<2.0	--	--	--	--	--
	09/24/03	<500	--	<2.0	--	--	--	--	--
U-5	09/27/00	--	--	250 ¹	--	--	--	--	--
	12/12/00	--	--	13 ³	--	--	--	--	--
	03/07/01	ND	ND	43.4	ND	ND	ND	ND	ND
	09/24/01	<4,000	<200	42	<10	<10	<10	<10	<10
	03/11/02	<500	<100	47	<2.0	<2.0	<2.0	<2.0	<2.0
	06/04/02 ⁴	--	--	--	--	--	--	--	--
	09/03/02	<500	<100	53	<2.0	<2.0	<2.0	<2.0	<2.0
	12/03/02	<500	<100	11	<2.0	<2.0	<2.0	<2.0	<2.0
	03/04/03	<500	<100	44	<2.0	<2.0	<2.0	<2.0	<2.0
	06/18/03	<500	<100	36	<2.0	<2.0	<2.0	<2.0	<2.0
09/24/03	<500	--	<2.0	--	--	--	--	--	
U-6	09/27/00	--	--	2,800 ¹	--	--	--	--	--
	12/12/00	--	--	580 ³	--	--	--	--	--
	03/07/01 ³	ND ²	ND ²	321	ND ²	ND ²	ND ²	ND ²	ND ²
	06/06/01 ³	ND ²	ND ²	330	ND ²	ND ²	ND ²	ND ²	ND ²
	09/24/01	<40,000	<2,000	660	<100	<100	<100	<100	<100
	12/10/01	<400	<200	220	<5.0	<5.0	<5.0	<5.0	<5.0
	03/11/02	<2,000	<400	760	<8.0	<8.0	<8.0	<8.0	<8.0
	06/04/02 ⁴	--	--	--	--	--	--	--	--

Table 2
Groundwater Analytical Results - Oxygenate Compounds
 Tosco (Unocal) Service Station #5325
 3220 Lakeshore Avenue
 Oakland, California

WELL ID	DATE	ETHANOL (ppb)	TBA (ppb)	MTBE (ppb)	DIPE (ppb)	ETBE (ppb)	TAME (ppb)	1,2-DCA (ppb)	EDB (ppb)
U-6	09/03/02	<10,000	<2,000	1,200	<40	<40	<40	<40	<40
(cont)	12/03/02	<5,000	<1,000	870	<20	<20	<20	<20	<20
	03/04/03	<10,000	<2,000	2,700	<40	<40	<40	<40	<40
	06/18/03	<10,000	<2,000	1,700	<40	<40	<40	<40	<40
	09/24/03	<100,000	<20,000	1,500	<400	<400	<400	<400	<400

Table 2
Groundwater Analytical Results - Oxygenate Compounds
Tosco (Unocal) Service Station #5325
3220 Lakeshore Avenue
Oakland, California

EXPLANATIONS:

TBA = Tertiary butyl alcohol
MTBE = Methyl tertiary butyl ether
DIPE = Di-isopropyl ether
ETBE = Ethyl tertiary butyl ether
TAME = Tertiary amyl methyl ether
1,2-DCA = 1,2-Dichloroethane
EDB = 1,2-Dibromoethane
(ppb) = Parts per billion
ND = Not Detected
-- = Not Analyzed

ANALYTICAL METHOD:

EPA Method 8260 for Oxygenate Compounds

- ¹ Laboratory report indicates sample was originally analyzed within holding time. Re-analysis for confirmation or dilution was performed past the recommended holding time.
- ² Detection limit raised. Refer to analytical reports.
- ³ Laboratory report indicates sample was analyzed outside the EPA recommended holding time.
- ⁴ Due to Laboratory error, samples for oxygenate (8260) analyses was not performed.

Table 3
Field Measurements and Groundwater Analytical Results
 Tosco (Unocal) Service Station #5325
 3220 Lakeshore Avenue
 Oakland, California

WELL ID	DATE	Ferrous Iron (ppm)	Nitrate as NO3 (ppm)	Phosphate as PO4 (ppm)	ORP (mV)	D.O. Before Purge (mg/L)	D.O. After Purge (mg/L)
U-1	06/15/98	39	ND	ND	382 ²	--	--
	09/30/98	17	ND	ND	366 ²	--	--
	12/28/98	4.3	6.3	28	298 ²	--	--
	03/22/99	4.9	ND	3.5	320 ³	--	--
	06/09/99	1.2	ND	ND	260 ³	--	--
	09/08/99	1.80	ND ¹	ND ¹	85 ³	--	--
	12/07/99	5.70	ND ¹	17.0	404 ³	1.36	--
	03/13/00	8.0	0.18	ND	² 117/ ²⁶² ³	--	--
	06/21/00	9.3	ND ¹	ND ¹	148 ²	1.53	--
	09/27/00	2.8	ND ¹	18.4	119 ²	1.63	--
	12/12/00	0.49	ND ¹	16.0	131 ²	1.48	--
	03/07/01	0.483	2.64	6.89	125 ²	1.91	--
	06/06/01	1.0 ⁴	ND	2.7	141 ²	1.77	--
	09/24/01	<0.10	0.45 ⁵	--	125 ²	1.64	--
	12/10/01	14	<0.50	2.2	141 ²	1.82	--
	03/11/02	15	<0.50	0.11	132 ²	2.21	--
	06/04/02	<0.50	<0.50	<0.10	117 ²	1.88	--
	09/03/02	<0.50	<0.50	<0.10	94 ²	1.62	--
	12/03/02	9.6	<1.0	<1.0	72 ²	1.71	--
	03/04/03	36	<1.0	<1.0	-125 ²	0.30	--
06/18/03	16	<1.0	<1.0	-48 ²	--	1.7	
09/24/03	15	<1.0	<1.0	-36 ²	0.40	--	
U-2	03/03/98	25	ND	ND	369 ²	--	--
	06/15/98	42	ND	ND	341 ²	--	--
	09/30/98	25	ND	ND	354 ²	--	--
	12/28/98	28	ND	ND	276 ²	--	--
	03/22/99	0.68	ND	2.3	320 ³	--	--
	06/09/99	0.50	ND	ND	290 ³	--	--
	09/08/99	1.90	ND ¹	ND ¹	235 ³	--	--
	12/07/99	0.250	ND ¹	ND ¹	389 ³	2.28	--
	03/13/00	4.3	0.31	ND	² 121/ ¹⁸⁴ ³	--	--
	06/21/00	0.26	ND ¹	ND ¹	136 ²	1.96	--
	09/27/00	0.64	ND ¹	10.5	142 ²	2.12	--
	12/12/00	2.7	ND ¹	ND ¹	155 ²	2.35	--
	03/07/01	0.677	2.24	3.02	148 ²	2.21	--
	06/06/01	0.80 ⁴	ND	2.8	163 ²	2.67	--
	09/24/01	<0.10	0.49 ⁵	--	151 ²	2.10	--
	12/10/01	<0.10	<0.50	0.20	171 ²	2.81	--
	03/11/02	<0.10	<0.50	0.65	156 ²	2.77	--
	06/04/02	<0.10	<0.50	<0.10	144 ²	3.14	--
	09/03/02	<0.25	<0.50	0.26	151 ²	2.85	--
	12/03/02	9.9	<1.0	<1.0	94 ²	1.97	--

Table 3
Field Measurements and Groundwater Analytical Results
 Tosco (Unocal) Service Station #5325
 3220 Lakeshore Avenue
 Oakland, California

WELL ID	DATE	Ferrous Iron (ppm)	Nitrate as NO3 (ppm)	Phosphate as PO4 (ppm)	ORP (mV)	D.O. Before Purge (mg/L)	D.O. After Purge (mg/L)
U-2 (cont)	03/04/03	8.6	<1.0	<1.0	-147 ²	0.40	--
	06/18/03	5.5	<1.0	3.1	-8 ²	--	3.2
	09/24/03	14	<1.0	<1.0	-10 ²	0.20	--
U-3	06/30/97	1.4	21	0.86	190 ³	4.10	--
	09/19/97	0.57	19	ND	75 ³	4.20	--
	12/12/97	1.9	23	0.85	390 ³	2.97	--
	03/03/98	0.013	36	ND	358 ²	2.63	--
	06/15/98	0.16	33	ND	318 ²	2.93	--
	09/30/98	0.040	31	ND	295 ²	3.11	--
	12/28/98	ND	29	ND	281 ²	3.59	--
	03/22/99	0.015	30	0.14	310 ³	4.02	--
	06/09/99	ND	26	1.2	350 ³	3.70	--
	09/08/99	ND	32.9	ND ¹	417 ³	3.96	--
	12/07/99	0.0520	27.9	ND ¹	437 ³	4.21	--
	03/13/00	0.15	33	ND	² 226/307 ³	--	--
	06/21/00	0.20	32	ND ¹	225 ²	4.27	--
	09/27/00	ND	34	15.7	211 ²	4.67	--
	12/12/00	ND	31	ND ¹	246 ²	4.79	--
	03/07/01	ND	36.5	0.443	251 ²	5.16	--
	06/06/01	ND ⁴	8.0	0.18	214 ²	4.79	--
	09/24/01	<0.10	23 ⁵	--	198 ²	4.27	--
	12/10/01	<0.10	21	0.11	188 ²	4.66	--
	03/11/02	<0.10	30	0.14	166 ²	5.06	--
06/04/02	<0.10	18	<0.10	151 ²	5.79	--	
09/03/02	<0.10 ⁵	28	<0.10	143 ²	6.04	--	
12/03/02	<0.20	20	<1.0	154 ²	5.58	--	
03/04/03	<0.20	18	<1.0	-136 ²	0.20	--	
06/18/03	<0.20	17	<1.0	333 ²	--	3.5	
09/24/03	<0.20	18	1.4	-50 ²	0.60	--	
U-4	06/30/97	0.13	35	0.52	200 ³	5.40	--
	09/19/97	0.35	30	ND	45 ³	5.10	--
	12/12/97	0.68	31	0.73	380 ³	3.11	--
	03/03/98	0.018	3.2	ND	284 ²	2.94	--
	06/15/98	0.14	33	ND	256 ²	3.08	--
	09/30/98	0.049	31	ND	276 ²	4.05	--
	12/28/98	0.36	31	ND	280 ²	4.57	--
	03/22/99	ND	30	0.14	320 ³	4.26	--
	06/09/99	ND	35	0.91	340 ³	3.61	--
	09/08/99	ND	24	ND ¹	391 ³	3.75	--
12/07/99	ND	27.7	ND ¹	478 ³	4.03	--	
03/13/00	ND	33	ND	² 219/244 ³	--	--	

Table 3
Field Measurements and Groundwater Analytical Results
 Tosco (Unocal) Service Station #5325
 3220 Lakeshore Avenue
 Oakland, California

WELL ID	DATE	Ferrous Iron (ppm)	Nitrate as NO3 (ppm)	Phosphate as PO4 (ppm)	ORP (mV)	D.O. Before Purge (mg/L)	D.O. After Purge (mg/L)
U-4	06/21/00	0.034	32	ND ¹	248 ²	4.89	--
(cont)	09/27/00	ND	28	ND ¹	198 ²	5.09	--
	12/12/00	ND	30	ND ¹	210 ²	4.86	--
	03/07/01	ND	33.9	0.226	233 ²	4.97	--
	06/06/01	ND ⁴	7.4	0.21	248 ²	5.12	--
	09/24/01	<0.10	24 ⁵	--	262 ²	4.86	--
	12/10/01	<0.10	19	0.10	242 ²	5.05	--
	03/11/02	<0.10	31	0.14	195 ²	4.83	--
	06/04/02	<0.10	27	<0.10	169 ²	5.58	--
	09/03/02	<0.10 ⁵	28	0.27	126 ²	5.94	--
	12/03/02	<0.20	20	<1.0	133 ²	5.82	--
	03/04/03	<0.20	26	<1.0	-148 ²	0.30	--
	06/18/03	<0.20	31	<1.0	250 ²	--	3.6
	09/24/03	<0.20	17	1.5	-24 ²	0.20	--
U-5	06/30/97	16	ND	ND	160 ³	3.40	--
	09/19/97	0.22	ND	ND	63 ³	0.60	--
	12/12/97	6.7	ND	ND	400 ³	1.75	--
	03/03/98	18	3.1	ND	345 ²	2.36	--
	06/15/98	17	ND	ND	333 ²	2.55	--
	09/30/98	17	ND	ND	318 ²	1.93	--
	12/28/98	17	6.6	ND	305 ²	1.64	--
	03/22/99	0.12	ND	2.4	340 ³	1.99	--
	06/09/99	0.23	ND	ND	320 ³	2.10	--
	09/08/99	2.10	ND ¹	ND ¹	335 ³	2.21	--
	12/07/99	0.310	ND ¹	ND ¹	408 ³	2.66	--
	03/13/00	0.33	0.16	ND	² 111/264 ³	--	--
	06/21/00	0.15	ND ¹	ND ¹	159 ²	3.42	--
	09/27/00	0.33	ND ¹	ND ¹	136 ²	3.85	--
	12/12/00	0.086	ND ¹	ND ¹	122 ²	3.53	--
	03/07/01	1.07	3.02	4.00	141 ²	2.98	--
	06/06/01	ND ⁴	ND	1.2	112 ²	2.67	--
	09/24/01	<0.10	0.77 ⁵	--	146 ²	3.15	--
	12/10/01	3.7	<0.50	2.6	96 ²	2.85	--
	03/11/02	0.10	<0.50	0.52	108 ²	3.15	--
	06/04/02	<0.25	<0.50	<0.10	118 ²	3.46	--
	09/03/02	<0.25	<0.50	<0.10	87 ²	2.85	--
	12/03/02	22	<1.0	<1.0	104 ²	2.71	--
	03/04/03	19	<1.0	<1.0	-166 ²	0.20	--
	06/18/03	11	<1.0	<1.0	-10 ²	--	2.4
	09/24/03	<0.20	18	1.8	-28 ²	0.30	--

Table 3
Field Measurements and Groundwater Analytical Results
 Tosco (Unocal) Service Station #5325
 3220 Lakeshore Avenue
 Oakland, California

WELL ID	DATE	Ferrous Iron (ppm)	Nitrate as NO3 (ppm)	Phosphate as PO4 (ppm)	ORP (mV)	D.O. Before Purge (mg/L)	D.O. After Purge (mg/L)
U-6	06/30/97	88	0.80	ND	190 ³	0.30	--
	09/19/97	2.9	1.80	ND	ND ³	0.60	--
	12/12/97	51	ND	ND	380 ³	2.70	--
	03/03/98	60	3.5	ND	327 ²	2.18	--
	06/15/98	590	4.8	ND	315 ²	2.48	--
	09/30/98	33	ND	ND	345 ²	3.06	--
	12/28/98	83	7.2	ND	297 ²	3.42	--
	03/22/99	2.1	ND	0.98	330 ³	3.88	--
	06/09/99	0.47	0.20	ND	320 ³	3.29	--
	09/08/99	0.140	5.59	ND ¹	305 ³	3.12	--
	12/07/99	0.260	ND ¹	ND ¹	443 ³	3.44	--
	03/13/00	0.79	0.26	ND	² 68/ ²²² 3	--	--
	06/21/00	1.9	ND ¹	ND ¹	159 ²	3.27	--
	09/27/00	2.6	ND ¹	ND ¹	170 ²	3.49	--
	12/12/00	ND	2.7	ND ¹	128 ²	3.06	--
	03/07/01	2.52	3.11	37.0	117 ²	2.85	--
	06/06/01	0.47 ⁴	0.15	0.70	97 ²	2.46	--
	09/24/01	<0.10	0.58 ⁵	--	123 ²	3.10	--
	12/10/01	0.99	0.50	2.0	112 ²	2.57	--
	03/11/02	1.2	<0.50	0.089	128 ²	3.03	--
	06/04/02	<0.10	<0.50	<1.0	97 ²	2.84	--
	09/03/02	<0.10	0.58	1.1	110 ²	3.12	--
	12/03/02	1.2	<1.0	2.6	95 ²	2.96	--
	03/04/03	20	<1.0	<1.0	-112 ²	0.30	--
	06/18/03	3.2	<1.0	2.0	-15 ²	--	3.2
	09/24/03	1.4	<1.0	4.6	-12 ²	0.30	--

Table 3
Field Measurements and Groundwater Analytical Results
Tosco (Unocal) Service Station #5325
3220 Lakeshore Avenue
Oakland, California

EXPLANATIONS:

Groundwater analytical results prior to March 3, 1998, were compiled from reports prepared by MPDS Services, Inc.

ORP = Oxidation Reduction Potential

(mV) = millivolts

D.O. = Dissolved Oxygen

(mg/L) = milligrams per liter

(ppm) = Parts per million

ND = Not Detected

-- = Not Measured/Not Analyzed

¹ Detection limit raised. Refer to analytical reports.

² Field measurement.

³ Analyzed by laboratory.

⁴ Due to the transfer of samples from one laboratory to another laboratory; the sample was received beyond the EPA recommended holding time.

⁵ Laboratory report indicates the sample was analyzed beyond the EPA recommended holding time.

ANALYTICAL METHODS:

Ferrous Iron by Hach method 8146/1;10 Phenanthroline Method

Nitrate as NO₃ by EPA Method 300.0

Phosphate as PO₄ by EPA Method 300.0

STANDARD OPERATING PROCEDURE - GROUNDWATER SAMPLING

Gettler-Ryan Inc. field personnel adhere to the following procedures for the collection and handling of groundwater samples prior to analysis by the analytical laboratory. Prior to sample collection, the type of analysis to be performed is determined. Loss prevention of volatile compounds is controlled and sample preservation for subsequent analysis is maintained.

Prior to sampling, the presence or absence of free-phase hydrocarbons is determined using an interface probe. Product thickness, if present, is measured to the nearest 0.01 foot and is noted in the field notes. In addition, all depth to water level measurements are collected with a static water level indicator and are also recorded in the field notes, prior to purging and sampling any wells.

After water levels are collected and prior to sampling, temperature, pH and electrical conductivity are measured. If purging is to occur, each well is purged a minimum of three well casing volumes of water using pre-cleaned pumps (stack, suction, Grundfos), or disposable bailers. The measurements are taken a minimum of three times during the purging. Purging continues until these parameters stabilize.

Groundwater samples are collected using disposable bailers. The water samples are transferred from the bailer into appropriate containers. Pre-preserved containers, supplied by analytical laboratories, are used when possible. When pre-preserved containers are not available, the laboratory is instructed to preserve the sample as appropriate. Duplicate samples are collected for the laboratory to use in maintaining quality assurance/quality control standards. The samples are labeled to include the job number, sample identification, collection date and time, analysis, preservation (if any), and the sample collector's initials. The water samples are placed in a cooler, maintained at 4°C for transport to the laboratory. Once collected in the field, all samples are maintained under chain of custody until delivered to the laboratory.

The chain of custody document includes the job number, type of preservation, if any, analysis requested, sample identification, date and time collected, and the sample collector's name. The chain of custody is signed and dated (including time of transfer) by each person who receives or surrenders the samples, beginning with the field personnel and ending with the laboratory personnel.

A laboratory supplied trip blank accompanies each sampling set and is labeled as QA. For sampling sets greater than 20 samples, 5% trip blanks are included. The trip blank is analyzed for some or all of the same compounds as the groundwater samples.

As requested by ConocoPhillips Company, the purge water and decontamination water generated during sampling activities is transported to ConocoPhillips - San Francisco Refinery, located in Rodeo, California.



GETTLER - RYAN INC.

WELL MONITORING/SAMPLING FIELD DATA SHEET

Client/Facility #: ConocoPhillips#5325
 Site Address: 3220 Lakeshore Avenue
 City: Oakland, CA

Job Number: 180061
 Event Date: 9-24-03 (inclusive)
 Sampler: D.D.

Well ID: U-1
 Well Diameter: 21 3/4 in.
 Total Depth: 19.65 ft.
 Depth to Water: 8.18 ft.
11.47 xVF .38 = 4.35 x3 (case volume) = Estimated Purge Volume: 13 gal.

Date Monitored: 9-24 Well Condition: OK

Volume	3/4" = 0.02	1" = 0.04	2" = 0.17	3" = 0.38
Factor (VF)	4" = 0.66	5" = 1.02	6" = 1.50	12" = 5.80

Purge Equipment:
 Disposable Bailer _____
 Stainless Steel Bailer _____
 Stack Pump _____
 Suction Pump X
 Grundfos _____
 Other: _____

Sampling Equipment:
 Disposable Bailer X
 Pressure Bailer X
 Discrete Bailer _____
 Other: _____

Time Started: _____ (2400 hrs)
 Time Bailed: _____ (2400 hrs)
 Depth to Product: _____ ft
 Depth to Water: _____ ft
 Hydrocarbon Thickness: _____ ft
 Visual Confirmation/Description: _____
 Skimmer / Absorbant Sock (circle one)
 Amt Removed from Skimmer: _____ gal
 Amt Removed from Well: _____ gal
 Product Transferred to: _____

Start Time (purge): 1133 Weather Conditions: clear
 Sample Time/Date: 1148 / 9-24-03 Water Color: clear Odor: yes
 Purging Flow Rate: 2 gpm. Sediment Description: _____
 Did well de-water? no If yes, Time: _____ Volume: _____ gal.

Time (2400 hr.)	Volume (gal.)	pH	Conductivity (umhos/cm)	Temperature (°F)	D.O. (mg/L) ← PC →	ORP (mV)
<u>1136</u>	<u>4.5</u>	<u>6.81</u>	<u>461</u>	<u>19.3</u>	<u>0.4</u>	<u>-36</u>
<u>1139</u>	<u>9</u>	<u>6.75</u>	<u>470</u>	<u>19.4</u>		
<u>1141</u>	<u>13</u>	<u>6.72</u>	<u>476</u>	<u>19.6</u>		

LABORATORY INFORMATION

SAMPLE ID	(#) CONTAINER	REFRIG.	PRESERV. TYPE	LABORATORY	ANALYSES
<u>U-1</u>	<u>3</u> x voa vial	<u>YES</u>	<u>HCL</u>	<u>STL Pleasanton</u>	<u>TPH-G/BTEX/MTBE(8260)</u>
	<u>1</u> x 500ml Poly	<u>YES</u>	<u>NP</u>	<u>STL Pleasanton</u>	<u>Nitrate/Phosphate</u>
	<u>1</u> x 250ml Poly	<u>YES</u>	<u>HNO3</u>	<u>STL Pleasanton</u>	<u>Ferrous Iron</u>

COMMENTS: _____

Add/Replaced Lock: _____

Add/Replaced Plug: _____ Size: _____



GETTLER - RYAN INC.

WELL MONITORING/SAMPLING FIELD DATA SHEET

Client/Facility #: ConocoPhillips#5325 Job Number: 180061
 Site Address: 3220 Lakeshore Avenue Event Date: 9-27-03 (inclusive)
 City: Oakland, CA Sampler: D.O.

Well ID: U-2 Date Monitored: 9-23 Well Condition: OK
 Well Diameter: 2 1/4 in. Total Depth: 19.62 ft.
 Depth to Water: 7.49 ft.
 Volume Factor (VF) table:

Volume	3/4"= 0.02	1"= 0.04	2"= 0.17	3"= 0.38
Factor (VF)	4"= 0.66	5"= 1.02	6"= 1.50	12"= 5.80

 xVF .38 = 4.60 x3 (case volume) = Estimated Purge Volume: 14 gal.

Purge Equipment:
 Disposable Bailer: ✓
 Stainless Steel Bailer: _____
 Stack Pump: _____
 Suction Pump: ✓
 Grundfos: _____
 Other: _____

Sampling Equipment:
 Disposable Bailer: ✓
 Pressure Bailer: ✓
 Discrete Bailer: _____
 Other: _____

Time Started: _____ (2400 hrs)
 Time Bailed: _____ (2400 hrs)
 Depth to Product: _____ ft.
 Depth to Water: _____ ft.
 Hydrocarbon Thickness: _____ ft.
 Visual Confirmation/Description: _____
 Skimmer / Absorbant Sock (circle one)
 Amt Removed from Skimmer: _____ gal
 Amt Removed from Well: _____ gal
 Product Transferred to: _____

Start Time (purge): 1208 Weather Conditions: clear
 Sample Time/Date: 1224 / 9-24-03 Water Color: clear Odor: no
 Purging Flow Rate: 2 gpm. Sediment Description: _____
 Did well de-water? no If yes, Time: _____ Volume: _____ gal.

Time (2400 hr.)	Volume (gal.)	pH	Conductivity (umhos/cm)	Temperature (°F)	D.O. (mg/L)	ORP (mV)
<u>1211</u>	<u>4.5</u>	<u>7.61</u>	<u>501</u>	<u>19.8</u>	<u>0.2</u>	<u>-10</u>
<u>1214</u>	<u>9</u>	<u>7.38</u>	<u>511</u>	<u>19.8</u>		
<u>1217</u>	<u>14</u>	<u>7.29</u>	<u>516</u>	<u>20.0</u>		

LABORATORY INFORMATION

SAMPLE ID	(#) CONTAINER	REFRIG.	PRESERV. TYPE	LABORATORY	ANALYSES
<u>U-2</u>	<u>3</u> x vov vial	<u>YES</u>	<u>HCL</u>	<u>STL Pleasanton</u>	<u>TPH-G/BTEX/MTBE(8260)</u>
	<u>1</u> x 500ml Poly	<u>YES</u>	<u>NP</u>	<u>STL Pleasanton</u>	<u>Nitrate/Phosphate</u>
	<u>1</u> x 250ml Poly	<u>YES</u>	<u>HNO3</u>	<u>STL Pleasanton</u>	<u>Ferrous Iron</u>

COMMENTS: _____

Add/Replaced Lock: _____ Add/Replaced Plug: _____ Size: _____



GETTLER - RYAN INC.

WELL MONITORING/SAMPLING FIELD DATA SHEET

Client/Facility #: ConocoPhillips#5325 Job Number: 180061
 Site Address: 3220 Lakeshore Avenue Event Date: 9-24-03 (inclusive)
 City: Oakland, CA Sampler: D.O.

Well ID: U-3
 Well Diameter: 2 1/4 in.
 Total Depth: 19.33 ft.
 Depth to Water: 10.88 ft.

Date Monitored: 9-24 Well Condition: OK

Volume	3/4" = 0.02	1" = 0.04	2" = 0.17	3" = 0.38
Factor (VF)	4" = 0.66	5" = 1.02	6" = 1.50	12" = 5.80

2.45 xVF .38 = 3.21 x3 (case volume) = Estimated Purge Volume: 9.5 gal.

Purge Equipment:
 Disposable Bailer _____
 Stainless Steel Bailer _____
 Stack Pump _____
 Suction Pump X
 Grundfos _____
 Other: _____

Sampling Equipment:
 Disposable Bailer X
 Pressure Bailer X
 Discrete Bailer _____
 Other: _____

Time Started: _____ (2400 hrs)
 Time Bailed: _____ (2400 hrs)
 Depth to Product: _____ ft
 Depth to Water: _____ ft
 Hydrocarbon Thickness: _____ ft
 Visual Confirmation/Description: _____
 Skimmer / Absorbant Sock (circle one)
 Amt Removed from Skimmer: _____ gal
 Amt Removed from Well: _____ gal
 Product Transferred to: _____

Start Time (purge): 1245 Weather Conditions: clear
 Sample Time/Date: 1258 / 9-24-03 Water Color: clear Odor: no
 Purging Flow Rate: 2 gpm. Sediment Description: _____
 Did well de-water? no If yes, Time: _____ Volume: _____ gal.

Time (2400 hr.)	Volume (gal.)	pH	Conductivity (umhos/cm)	Temperature (°F)	D.O. (mg/L) ←/→	ORP (mV)
<u>1247</u>	<u>3</u>	<u>7.08</u>	<u>474</u>	<u>19.1</u>	<u>0.6</u>	<u>-50</u>
<u>1249</u>	<u>6</u>	<u>6.95</u>	<u>480</u>	<u>19.3</u>		
<u>1251</u>	<u>9.5</u>	<u>6.87</u>	<u>486</u>	<u>19.5</u>		

LABORATORY INFORMATION

SAMPLE ID	(#) CONTAINER	REFRIG.	PRESERV. TYPE	LABORATORY	ANALYSES
<u>U-3</u>	<u>3</u> x vov vial	<u>YES</u>	<u>HCL</u>	<u>STL Pleasanton</u>	<u>TPH-G/BTEX/MTBE(8260)</u>
	<u>1</u> x 500ml Poly	<u>YES</u>	<u>NP</u>	<u>STL Pleasanton</u>	<u>Nitrate/Phosphate</u>
	<u>1</u> x 250ml Poly	<u>YES</u>	<u>HNO3</u>	<u>STL Pleasanton</u>	<u>Ferrous Iron</u>

COMMENTS: _____
 Add/Replaced Lock: _____ Add/Replaced Plug: _____ Size: _____



GETTLER-RYAN INC.

WELL MONITORING/SAMPLING FIELD DATA SHEET

Client/Facility #: ConocoPhillips#5325 Job Number: 180061
 Site Address: 3220 Lakeshore Avenue Event Date: 9-24-03 (inclusive)
 City: Oakland, CA Sampler: D.O.

Well ID: U-4 Date Monitored: 9-24 Well Condition: OK
 Well Diameter: 2 1/4 in.
 Total Depth: 20.6 ft.
 Depth to Water: 8.26 ft.
11.90 xVF .66 = 7.85 x3 (case volume) = Estimated Purge Volume: 23.5 gal.

Volume	3/4"= 0.02	1"= 0.04	2"= 0.17	3"= 0.38
Factor (VF)	4"= 0.66	5"= 1.02	6"= 1.50	12"= 5.80

Purge Equipment:
 Disposable Bailer _____
 Stainless Steel Bailer _____
 Stack Pump _____
 Suction Pump X
 Grundfos _____
 Other: _____

Sampling Equipment:
 Disposable Bailer X
 Pressure Bailer X
 Discrete Bailer _____
 Other: _____

Time Started: _____ (2400 hrs)
 Time Bailed: _____ (2400 hrs)
 Depth to Product: _____ ft
 Depth to Water: _____ ft
 Hydrocarbon Thickness: _____ ft
 Visual Confirmation/Description: _____
 Skimmer / Absorbant Sock (circle one)
 Amt Removed from Skimmer: _____ gal
 Amt Removed from Well: _____ gal
 Product Transferred to: _____

Start Time (purge): 1320 Weather Conditions: clear
 Sample Time/Date: 1341 / 9-24-03 Water Color: clear Odor: no
 Purging Flow Rate: =2 gpm. Sediment Description: _____
 Did well de-water? no If yes, Time: _____ Volume: _____ gal.

Time (2400 hr.)	Volume (gal.)	pH	Conductivity (umhos/cm)	Temperature (°C/F)	D.O. (mg/L) ← / → ORP (mV)
<u>1324</u>	<u>8</u>	<u>6.51</u>	<u>390</u>	<u>18.9</u>	<u>0.2</u> / <u>-24</u>
<u>1328</u>	<u>16</u>	<u>6.47</u>	<u>397</u>	<u>19.3</u>	
<u>1332</u>	<u>23.5</u>	<u>6.42</u>	<u>404</u>	<u>19.4</u>	

LABORATORY INFORMATION

SAMPLE ID	(#) CONTAINER	REFRIG.	PRESERV. TYPE	LABORATORY	ANALYSES
<u>U-4</u>	<u>3</u> x vov vial	<u>YES</u>	<u>HCL</u>	<u>STL Pleasanton</u>	<u>TPH-G/BTEX/MTBE(8260)</u>
	<u>1</u> x 500ml Poly	<u>YES</u>	<u>NP</u>	<u>STL Pleasanton</u>	<u>Nitrate/Phosphate</u>
	<u>1</u> x 250ml Poly	<u>YES</u>	<u>HNO3</u>	<u>STL Pleasanton</u>	<u>Ferrous Iron</u>

COMMENTS: _____

Add/Replaced Lock: _____ Add/Replaced Plug: _____ Size: _____



GETTLER-RYAN INC.

WELL MONITORING/SAMPLING FIELD DATA SHEET

Client/Facility #: ConocoPhillips#5325 Job Number: 180061
 Site Address: 3220 Lakeshore Avenue Event Date: 9-24-03 (inclusive)
 City: Oakland, CA Sampler: D.O.

Well ID: U-5 Date Monitored: 9-24 Well Condition: OK
 Well Diameter: 2 1/3 1/4 in.
 Total Depth: 20.06 ft.
 Depth to Water: 6.86 ft.
13.20 xVF .66 = 8.71 x3 (case volume) = Estimated Purge Volume: 26 gal.

Volume	3/4"= 0.02	1"= 0.04	2"= 0.17	3"= 0.38
Factor (VF)	4"= 0.66	5"= 1.02	6"= 1.50	12"= 5.80

Purge Equipment:
 Disposable Bailer _____
 Stainless Steel Bailer _____
 Stack Pump _____
 Suction Pump X
 Grundfos _____
 Other: _____

Sampling Equipment:
 Disposable Bailer X
 Pressure Bailer X
 Discrete Bailer _____
 Other: _____

Time Started: _____ (2400 hrs)
 Time Bailed: _____ (2400 hrs)
 Depth to Product: _____ ft
 Depth to Water: _____ ft
 Hydrocarbon Thickness: _____ ft
 Visual Confirmation/Description: _____
 Skimmer / Absorbant Sock (circle one)
 Amt Removed from Skimmer: _____ gal
 Amt Removed from Well: _____ gal
 Product Transferred to: _____

Start Time (purge): 1359 Weather Conditions: clear
 Sample Time/Date: 1419 / 9-24-03 Water Color: clear Odor: slight
 Purging Flow Rate: 2.5 gpm. Sediment Description: _____
 Did well de-water? no If yes, Time: _____ Volume: _____ gal.

Time (2400 hr.)	Volume (gal.)	pH	Conductivity (umhos/cm)	Temperature (°F)	D.O. (mg/L) ← Air →	ORP (mV)
<u>1403</u>	<u>8.5</u>	<u>7.60</u>	<u>499</u>	<u>18.9</u>	<u>0.3</u>	<u>-28</u>
<u>1407</u>	<u>17</u>	<u>7.48</u>	<u>506</u>	<u>19.2</u>		
<u>1411</u>	<u>26</u>	<u>7.35</u>	<u>512</u>	<u>19.4</u>		

LABORATORY INFORMATION

SAMPLE ID	(#) CONTAINER	REFRIG.	PRESERV. TYPE	LABORATORY	ANALYSES
<u>U-5</u>	<u>3 x vov vial</u>	<u>YES</u>	<u>HCL</u>	<u>STL Pleasanton</u>	<u>TPH-G/BTEX/MTBE(8260)</u>
	<u>1 x 500ml Poly</u>	<u>YES</u>	<u>NP</u>	<u>STL Pleasanton</u>	<u>Nitrate/Phosphate</u>
	<u>1 x 250ml Poly</u>	<u>YES</u>	<u>HNO3</u>	<u>STL Pleasanton</u>	<u>Ferrous Iron</u>

COMMENTS: _____

Add/Replaced Lock: _____

Add/Replaced Plug: _____ Size: _____



GETTLER - RYAN INC.

WELL MONITORING/SAMPLING FIELD DATA SHEET

Client/Facility #: ConocoPhillips#5325 Job Number: 180061
 Site Address: 3220 Lakeshore Avenue Event Date: 9-24-03 (inclusive)
 City: Oakland, CA Sampler: D.O.

Well ID: U-6 Date Monitored: 9-24 Well Condition: OK
 Well Diameter: 2 13/16 in.
 Total Depth: 23.74 ft.
 Depth to Water: 7.24 ft.
 Volume Factor (VF) table:

3/4" = 0.02	1" = 0.04	2" = 0.17	3" = 0.38
4" = 0.66	5" = 1.02	6" = 1.50	12" = 5.80

$$xVF \cdot .17 = 2.81 \times 3 \text{ (case volume)} = \text{Estimated Purge Volume: } 8.5 \text{ gal.}$$

Purge Equipment:
 Disposable Bailer: X
 Stainless Steel Bailer: _____
 Stack Pump: _____
 Suction Pump: _____
 Grundfos: _____
 Other: _____

Sampling Equipment:
 Disposable Bailer: X
 Pressure Bailer: X
 Discrete Bailer: _____
 Other: _____

Time Started: _____ (2400 hrs)
 Time Bailed: _____ (2400 hrs)
 Depth to Product: _____ ft.
 Depth to Water: _____ ft.
 Hydrocarbon Thickness: _____ ft.
 Visual Confirmation/Description: _____
 Skimmer / Absorbant Sock (circle one)
 Amt Removed from Skimmer: _____ gal
 Amt Removed from Well: _____ gal
 Product Transferred to: _____

Start Time (purge): 1442 Weather Conditions: clear
 Sample Time/Date: 1506 / 9-24-03 Water Color: cloudy/clear Odor: yes
 Purging Flow Rate: — gpm. Sediment Description: —
 Did well de-water? no If yes, Time: _____ Volume: _____ gal.

Time (2400 hr.)	Volume (gal.)	pH	Conductivity (umhos/cm)	Temperature (°F)	D.O. (mg/L) ← Pre →	ORP (mV)
1442	3	7.22	350	19.1	0.3	-12
1454	6	7.09	358	18.9		
1500	8.5	7.01	363	19.0		

LABORATORY INFORMATION

SAMPLE ID	(#) CONTAINER	REFRIG.	PRESERV. TYPE	LABORATORY	ANALYSES
U-6	3 x vov vial	YES	HCL	STL Pleasanton	TPH-G/BTEX/MTBE(8260)
	1 x 500ml Poly	YES	NP	STL Pleasanton	Nitrate/Phosphate
	1 x 250ml Poly	YES	HNO3	STL Pleasanton	Ferrous Iron

COMMENTS: _____

Add/Replaced Lock: _____ Add/Replaced Plug: _____ Size: _____

2003-09-0949

Gettler-Ryan Inc., Chain-of-Custody

Tosco Corp./
Phillips 66 Co.
2000 Crow Canyon Place
Suite 400
San Ramon, CA 94583

Facility Number #5325
Facility Address 3220 Lakeshore Avenue, Oakland, CA
Global ID T0600101463 Project 180061.80
Client Contact David DeWitt
Phone 916-558-7666

Laboratory Name STL PLEASANTON
Consultant GETTLER-RYAN INC. DEANNA L. HARDING
Address 6747 SIERRA CT., SUITE J, DUBLIN, CA 94568
Phone 925-551-7555 Fax 925-551-7899
Samples Collected by David Okamoto

19097

SAMPLE ID	Number of Containers Matrix	S = Soil A = Air W = Water C = Charcoal	Sample Preservation	Date/Time (2400 Hrs)	TPH-GAS/BTEX/MTBE EPA 8015/8021B	TPH-DIESEL EPA 8015	TPH-DIESEL w/SILOX EPA 8015	TPH-GAS EPA 8015	TPH-GAS/BTEX/MTBE EPA 8260 + E11 + M0	OXYGENATES EPA 8260	METHANOL EPA 8015	TOTAL OIL & GREASE EPA 8260	METALS Cd, Cr, Pb, Zn, Ni	NITRATE/SULFATE/ALKALINITY EPA 300 SERIES	HMOC'S (8010) EPA 8021B	VOCS (8240) EPA 8260	SVOC'S EPA 8270	Nitrate/Phosphate	Ferrous Iron	Remarks
QA	1	W	KL	9:24/09					X											Run 8 Oxy's by 8260 on all 8260 MTBE hits.
U-1	5			1148					X									X	X	Ferrous Iron has been filtered and preserved.
U-2	5			1224					X									X	X	
U-3	5			125P					X									X	X	
U-4	5			1341					X									X	X	
U-5	5			1419					X									X	X	
U-6	5			1506					X									X	X	

SHORT HOLD ANALYSIS SAMPLES

- OXYGENATES 8260
- 1 - MTBE
 - 2 - TBA
 - 3 - TAME
 - 4 - DIPE
 - 5 - ETBE
 - 6 - 1,2-DCA
 - 7 - EDB
 - 8 - ETHANOL

Relinquished By (Signature) <i>David DeWitt</i>	Organization G.R.	Date/Time 9/24/09	Received By (Signature) <i>David DeWitt</i>	Organization G-R	Date/Time 9/25/09	Lead Y/N Y	Turn Around Time (Circle Choice) 24 Hrs. 48 Hrs. 72 Hrs. 5 Days 10 Days <u>As Contracted</u>
Relinquished By (Signature) <i>David DeWitt</i>	Organization G-R	Date/Time 9/25/09	Received By (Signature) <i>David DeWitt</i>	Organization STL	Date/Time 9/25/09	Lead Y/N Y	
Relinquished By (Signature) <i>David DeWitt</i>	Organization STL	Date/Time 9/25/09	Received For Laboratory By (Signature) <i>David DeWitt</i>	Organization STL	Date/Time 09/25/09	Lead Y/N Y	

FILE NAME: P:\Environ\ChainofCustody\04-09-0949\Layout_09_09_09.doc

Gettler Ryan

October 08, 2003

6747 Sierra Court Suite J
Dublin, CA 94568

Attn.: Deanna Harding

Project#: 180061.80

Project: Conoco #5325

Site: 3220 Lakeshore Ave., Oakland, CA

RECEIVED

GETTLER RYAN INC.
GENERAL CONTRACTORS

Dear Ms. Harding,

Attached is our report for your samples received on 09/25/2003 09:35

This report has been reviewed and approved for release. Reproduction of this report
is permitted only in its entirety.

Please note that any unused portion of the samples will be discarded after
11/09/2003 unless you have requested otherwise.

We appreciate the opportunity to be of service to you. If you have any questions,
please call me at (925) 484-1919.

You can also contact me via email. My email address is: tgranicher@stl-inc.com

Sincerely,

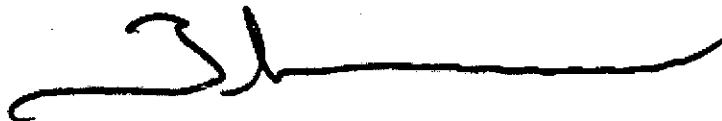

Tod Granicher
Project Manager

SEVERN
TRENT

STL

Gas/BTEX Fuel Oxygenates by 8260B

Gettler Ryan

Attn.: Deanna Harding

6747 Sierra Court Suite J

Dublin, CA 94568

Phone: (925) 551-7444 Fax: (925) 551-7899

Project: 180061.80

Conoco #5325

Received: 09/25/2003 09:35

Site: 3220 Lakeshore Ave., Oakland, CA

Samples Reported

Sample Name	Date Sampled	Matrix	Lab #
QA	09/24/2003	Water	1
U-1	09/24/2003 11:48	Water	2
U-2	09/24/2003 12:24	Water	3
U-3	09/24/2003 12:58	Water	4
U-4	09/24/2003 13:41	Water	5
U-5	09/24/2003 14:19	Water	6
U-6	09/24/2003 15:06	Water	7

Severn Trent Laboratories, Inc.

STL San Francisco * 1220 Quarry Lane, Pleasanton, CA 94566

Tel 925 484 1919 Fax 925 484 1096 * www.stl-inc.com * CA DHS ELAP# 2496

10/08/2003 13:26

Page 1 of 12

Gas/BTEX Fuel Oxygenates by 8260B

Gettler Ryan

Attn.: Deanna Harding

6747 Sierra Court Suite J

Dublin, CA 94568

Phone: (925) 551-7444 Fax: (925) 551-7899

Project: 180061.80

Conoco #5325

Received: 09/25/2003 09:35

Site: 3220 Lakeshore Ave., Oakland, CA

Prep(s): 5030B Test(s): 8260FAB
 Sample ID: QA Lab ID: 2003-09-0949 - 1
 Sampled: 09/24/2003 Extracted: 10/2/2003 22:52
 Matrix: Water QC Batch#: 2003/10/02-2A:65

Compound	Conc.	RL	Unit	Dilution	Analyzed	Flag
Gasoline	ND	50	ug/L	1.00	10/02/2003 22:52	
Benzene	ND	0.50	ug/L	1.00	10/02/2003 22:52	
Toluene	ND	0.50	ug/L	1.00	10/02/2003 22:52	
Ethylbenzene	ND	0.50	ug/L	1.00	10/02/2003 22:52	
Total xylenes	ND	1.0	ug/L	1.00	10/02/2003 22:52	
Methyl tert-butyl ether (MTBE)	ND	2.0	ug/L	1.00	10/02/2003 22:52	
Surrogate(s)						
1,2-Dichloroethane-d4	94.1	76-114	%	1.00	10/02/2003 22:52	
Toluene-d8	102.6	88-110	%	1.00	10/02/2003 22:52	

SEVERN
TRENT

STL

Gas/BTEX Fuel Oxygenates by 8260B

Gettler Ryan

Attn.: Deanna Harding

6747 Sierra Court Suite J

Dublin, CA 94568

Phone: (925) 551-7444 Fax: (925) 551-7899

Project: 180061.80

Conoco #5325

Received: 09/25/2003 09:35

Site: 3220 Lakeshore Ave., Oakland, CA

Prep(s): 5030B

Sample ID: U-1

Sampled: 09/24/2003 11:48

Matrix: Water

Test(s): 8260FAB

Lab ID: 2003-09-0949 - 2

Extracted: 10/2/2003 23:15

QC Batch#: 2003/10/02-2A.65

Analysis Flag: o (See Legend and Note Section)

Compound	Conc.	RL	Unit	Dilution	Analyzed	Flag
Gasoline	ND	10000	ug/L	200.00	10/02/2003 23:15	
Benzene	ND	100	ug/L	200.00	10/02/2003 23:15	
Toluene	ND	100	ug/L	200.00	10/02/2003 23:15	
Ethylbenzene	ND	100	ug/L	200.00	10/02/2003 23:15	
Total xylenes	ND	200	ug/L	200.00	10/02/2003 23:15	
tert-Butyl alcohol (TBA)	ND	20000	ug/L	200.00	10/02/2003 23:15	
Methyl tert-butyl ether (MTBE)	11000	400	ug/L	200.00	10/02/2003 23:15	
Di-isopropyl Ether (DIPE)	ND	400	ug/L	200.00	10/02/2003 23:15	
Ethyl tert-butyl ether (ETBE)	ND	400	ug/L	200.00	10/02/2003 23:15	
tert-Amyl methyl ether (TAME)	ND	400	ug/L	200.00	10/02/2003 23:15	
1,2-DCA	ND	400	ug/L	200.00	10/02/2003 23:15	
EDB	ND	400	ug/L	200.00	10/02/2003 23:15	
Ethanol	ND	100000	ug/L	200.00	10/02/2003 23:15	
Surrogate(s)						
1,2-Dichloroethane-d4	104.2	76-114	%	200.00	10/02/2003 23:15	
Toluene-d8	104.8	88-110	%	200.00	10/02/2003 23:15	

10/08/2003 13:26

Severn Trent Laboratories, Inc.

STL San Francisco * 1220 Quarry Lane, Pleasanton, CA 94566

Tel 925 484 1919 Fax 925 484 1096 * www.stl-inc.com * CA DHS ELAP# 2496

Gas/BTEX Fuel Oxygenates by 8260B

Gettler Ryan

Attn.: Deanna Harding

6747 Sierra Court Suite J

Dublin, CA 94568

Phone: (925) 551-7444 Fax: (925) 551-7899

Project: 180061.80

Conoco #5325

Received: 09/25/2003 09:35

Site: 3220 Lakeshore Ave., Oakland, CA

Prep(s): 5030B Test(s): 8260FAB
 Sample ID: U-2 Lab ID: 2003-09-0949 - 3
 Sampled: 09/24/2003 12:24 Extracted: 10/2/2003 23:38
 Matrix: Water QC Batch#: 2003/10/02-2A.65
 Analysis Flag: o (See Legend and Note Section)

Compound	Conc.	RL	Unit	Dilution	Analyzed	Flag
Gasoline	ND	10000	ug/L	200.00	10/02/2003 23:38	
Benzene	ND	100	ug/L	200.00	10/02/2003 23:38	
Toluene	ND	100	ug/L	200.00	10/02/2003 23:38	
Ethylbenzene	ND	100	ug/L	200.00	10/02/2003 23:38	
Total xylenes	ND	200	ug/L	200.00	10/02/2003 23:38	
tert-Butyl alcohol (TBA)	ND	20000	ug/L	200.00	10/02/2003 23:38	
Methyl tert-butyl ether (MTBE)	10000	400	ug/L	200.00	10/02/2003 23:38	
Di-isopropyl Ether (DIPE)	ND	400	ug/L	200.00	10/02/2003 23:38	
Ethyl tert-butyl ether (ETBE)	ND	400	ug/L	200.00	10/02/2003 23:38	
tert-Amyl methyl ether (TAME)	ND	400	ug/L	200.00	10/02/2003 23:38	
1,2-DCA	ND	400	ug/L	200.00	10/02/2003 23:38	
EDB	ND	400	ug/L	200.00	10/02/2003 23:38	
Ethanol	ND	100000	ug/L	200.00	10/02/2003 23:38	
Surrogate(s)						
1,2-Dichloroethane-d4	100.9	76-114	%	200.00	10/02/2003 23:38	
Toluene-d8	97.5	88-110	%	200.00	10/02/2003 23:38	



Gas/BTEX Fuel Oxygenates by 8260B

Gettler Ryan

Attn.: Deanna Harding

6747 Sierra Court Suite J
 Dublin, CA 94568
 Phone: (925) 551-7444 Fax: (925) 551-7899

Project: 180061.80
 Conoco #5325

Received: 09/25/2003 09:35

Site: 3220 Lakeshore Ave., Oakland, CA

Prep(s):	5030B	Test(s):	8260FAB
Sample ID:	U-3	Lab ID:	2003-09-0949 - 4
Sampled:	09/24/2003 12:58	Extracted:	10/3/2003 00:02
Matrix:	Water	QC Batch#:	2003/10/02-2A.65

Compound	Conc.	RL	Unit	Dilution	Analyzed	Flag
Gasoline	ND	50	ug/L	1.00	10/03/2003 00:02	
Benzene	ND	0.50	ug/L	1.00	10/03/2003 00:02	
Toluene	ND	0.50	ug/L	1.00	10/03/2003 00:02	
Ethylbenzene	ND	0.50	ug/L	1.00	10/03/2003 00:02	
Total xylenes	ND	1.0	ug/L	1.00	10/03/2003 00:02	
Methyl tert-butyl ether (MTBE)	ND	2.0	ug/L	1.00	10/03/2003 00:02	
Ethanol	ND	500	ug/L	1.00	10/03/2003 00:02	
Surrogate(s)						
1,2-Dichloroethane-d4	93.6	76-114	%	1.00	10/03/2003 00:02	
Toluene-d8	102.8	88-110	%	1.00	10/03/2003 00:02	

Gas/BTEX Fuel Oxygenates by 8260B

Gettler Ryan

Attn.: Deanna Harding

6747 Sierra Court Suite J

Dublin, CA 94568

Phone: (925) 551-7444 Fax: (925) 551-7899

Project: 180061.80

Conoco #5325

Received: 09/25/2003 09:35

Site: 3220 Lakeshore Ave., Oakland, CA

Prep(s):	5030B	Test(s):	8260FAB
Sample ID:	U-4	Lab ID:	2003-09-0949 - 5
Sampled:	09/24/2003 13:41	Extracted:	10/3/2003 00:24
Matrix:	Water	QC Batch#:	2003/10/02-2A.65

Compound	Conc.	RL	Unit	Dilution	Analyzed	Flag
Gasoline	ND	50	ug/L	1.00	10/03/2003 00:24	
Benzene	ND	0.50	ug/L	1.00	10/03/2003 00:24	
Toluene	ND	0.50	ug/L	1.00	10/03/2003 00:24	
Ethylbenzene	ND	0.50	ug/L	1.00	10/03/2003 00:24	
Total xylenes	ND	1.0	ug/L	1.00	10/03/2003 00:24	
Methyl tert-butyl ether (MTBE)	ND	2.0	ug/L	1.00	10/03/2003 00:24	
Ethanol	ND	500	ug/L	1.00	10/03/2003 00:24	
Surrogate(s)						
1,2-Dichloroethane-d4	96.3	76-114	%	1.00	10/03/2003 00:24	
Toluene-d8	103.4	88-110	%	1.00	10/03/2003 00:24	

SEVERN
TRENT

STL

Gas/BTEX Fuel Oxygenates by 8260B

Gettler Ryan

Attn.: Deanna Harding

6747 Sierra Court Suite J

Dublin, CA 94568

Phone: (925) 551-7444 Fax: (925) 551-7899

Project: 180061.80

Conoco #5325

Received: 09/25/2003 09:35

Site: 3220 Lakeshore Ave., Oakland, CA

Prep(s): 5030B

Sample ID: U-5

Sampled: 09/24/2003 14:19

Matrix: Water

Test(s): 8260FAB

Lab ID: 2003-09-0949 - 6

Extracted: 10/3/2003 01:32

QC Batch#: 2003/10/02-2A.65

Compound	Conc.	RL	Unit	Dilution	Analyzed	Flag
Gasoline	ND	50	ug/L	1.00	10/03/2003 01:32	
Benzene	ND	0.50	ug/L	1.00	10/03/2003 01:32	
Toluene	ND	0.50	ug/L	1.00	10/03/2003 01:32	
Ethylbenzene	ND	0.50	ug/L	1.00	10/03/2003 01:32	
Total xylenes	ND	1.0	ug/L	1.00	10/03/2003 01:32	
Methyl tert-butyl ether (MTBE)	ND	2.0	ug/L	1.00	10/03/2003 01:32	
Ethanol	ND	500	ug/L	1.00	10/03/2003 01:32	
<i>Surrogate(s)</i>						
1,2-Dichloroethane-d4	92.7	76-114	%	1.00	10/03/2003 01:32	
Toluene-d8	97.2	88-110	%	1.00	10/03/2003 01:32	

Severn Trent Laboratories, Inc.

STL San Francisco * 1220 Quarry Lane, Pleasanton, CA 94566

Tel 925 484 1919 Fax 925 484 1096 * www.stl-inc.com * CA DHS ELAP# 2496

10/08/2003 13:26

Page 7 of 12

Gas/BTEX Fuel Oxygenates by 8260B

Gettler Ryan

Attn.: Deanna Harding

6747 Sierra Court Suite J
Dublin, CA 94568
Phone: (925) 551-7444 Fax: (925) 551-7899

Project: 180061.80
Conoco #5325

Received: 09/25/2003 09:35

Site: 3220 Lakeshore Ave., Oakland, CA

Prep(s):	5030B	Test(s):	8260FAB
Sample ID:	U-6	Lab ID:	2003-09-0949 - 7
Sampled:	09/24/2003 15:06	Extracted:	10/3/2003 01:54
Matrix:	Water	QC Batch#:	2003/10/02-2A.65

Analysis Flag: o (See Legend and Note Section)

Compound	Conc.	RL	Unit	Dilution	Analyzed	Flag
Gasoline	ND	10000	ug/L	200.00	10/03/2003 01:54	
Benzene	ND	100	ug/L	200.00	10/03/2003 01:54	
Toluene	ND	100	ug/L	200.00	10/03/2003 01:54	
Ethylbenzene	ND	100	ug/L	200.00	10/03/2003 01:54	
Total xylenes	ND	200	ug/L	200.00	10/03/2003 01:54	
tert-Butyl alcohol (TBA)	ND	20000	ug/L	200.00	10/03/2003 01:54	
Methyl tert-butyl ether (MTBE)	1500	400	ug/L	200.00	10/03/2003 01:54	
Di-isopropyl Ether (DIPE)	ND	400	ug/L	200.00	10/03/2003 01:54	
Ethyl tert-butyl ether (ETBE)	ND	400	ug/L	200.00	10/03/2003 01:54	
tert-Amyl methyl ether (TAME)	ND	400	ug/L	200.00	10/03/2003 01:54	
1,2-DCA	ND	400	ug/L	200.00	10/03/2003 01:54	
EDB	ND	400	ug/L	200.00	10/03/2003 01:54	
Ethanol	ND	100000	ug/L	200.00	10/03/2003 01:54	
Surrogate(s)						
1,2-Dichloroethane-d4	99.7	76-114	%	200.00	10/03/2003 01:54	
Toluene-d8	96.4	88-110	%	200.00	10/03/2003 01:54	

Gas/BTEX Fuel Oxygenates by 8260B

Gettler Ryan

Attn.: Deanna Harding

6747 Sierra Court Suite J

Dublin, CA 94568

Phone: (925) 551-7444 Fax: (925) 551-7899

Project: 180061.80

Conoco #5325

Received: 09/25/2003 09:35

Site: 3220 Lakeshore Ave., Oakland, CA

Batch QC Report

Prep(s): 5030B

Method Blank

MB: 2003/10/02-2A.65-022

Water

Test(s): 8260FAB

QC Batch # 2003/10/02-2A.65

Date Extracted: 10/02/2003 21:22

Compound	Conc.	RL	Unit	Analyzed	Flag
Gasoline	ND	50	ug/L	10/02/2003 21:22	
Gasoline	ND	50	ug/L	10/02/2003 21:22	
tert-Butyl alcohol (TBA)	ND	100	ug/L	10/02/2003 21:22	
Methyl tert-butyl ether (MTBE)	ND	2.0	ug/L	10/02/2003 21:22	
Di-isopropyl Ether (DIPE)	ND	2.0	ug/L	10/02/2003 21:22	
Ethyl tert-butyl ether (ETBE)	ND	2.0	ug/L	10/02/2003 21:22	
tert-Amyl methyl ether (TAME)	ND	2.0	ug/L	10/02/2003 21:22	
1,2-DCA	ND	2.0	ug/L	10/02/2003 21:22	
EDB	ND	2.0	ug/L	10/02/2003 21:22	
Benzene	ND	0.5	ug/L	10/02/2003 21:22	
Toluene	ND	0.5	ug/L	10/02/2003 21:22	
Ethylbenzene	ND	0.5	ug/L	10/02/2003 21:22	
Total xylenes	ND	1.0	ug/L	10/02/2003 21:22	
Ethanol	ND	500	ug/L	10/02/2003 21:22	
Surrogates(s)					
1,2-Dichloroethane-d4	90.1	76-114	%	10/02/2003 21:22	
Toluene-d8	103.9	88-110	%	10/02/2003 21:22	

Gas/BTEX Fuel Oxygenates by 8260B

Gettler Ryan

Attn.: Deanna Harding

6747 Sierra Court Suite J

Dublin, CA 94568

Phone: (925) 551-7444 Fax: (925) 551-7899

Project: 180061.80

Conoco #5325

Received: 09/25/2003 09:35

Site: 3220 Lakeshore Ave., Oakland, CA

Batch QC Report

Prep(s): 5030B

Test(s): 8260FAB

Laboratory Control Spike

Water

QC Batch # 2003/10/02-2A.65

LCS 2003/10/02-2A.65-036

Extracted: 10/02/2003

Analyzed: 10/02/2003 20:36

LCSD

Compound	Conc. ug/L		Exp.Conc.	Recovery %		RPD	Ctrl.Limits %		Flags	
	LCS	LCSD		LCS	LCSD		%	Rec.	RPD	LCS
Methyl tert-butyl ether (MTBE)	23.8		25	95.2			65-165	20		
Benzene	27.0		25	108.0			69-129	20		
Toluene	27.1		25	108.4			70-130	20		
Surrogates(s)										
1,2-Dichloroethane-d4	481		500	96.2			76-114			
Toluene-d8	519		500	103.8			88-110			

Gas/BTEX Fuel Oxygenates by 8260B

Gettler Ryan

Attn.: Deanna Harding

6747 Sierra Court Suite J

Dublin, CA 94568

Phone: (925) 551-7444 Fax: (925) 551-7899

Project: 180061.80

Conoco #5325

Received: 09/25/2003 09:35

Site: 3220 Lakeshore Ave., Oakland, CA

Batch QC Report

Prep(s): 5030B

Test(s): 8260FAB

Matrix Spike (MS / MSD)

Water

QC Batch # 2003/10/02-2A.65

U-4 >> MS

Lab ID: 2003-09-0949 - 005

MS: 2003/10/02-2A.65-047

Extracted: 10/03/2003

Analyzed: 10/03/2003 00:47

Dilution: 1.00

MSD: 2003/10/02-2A.65-009

Extracted: 10/03/2003

Analyzed: 10/03/2003 01:09

Dilution: 1.00

Compound	Conc. ug/L			Spk.Level ug/L	Recovery %			Limits %		Flags	
	MS	MSD	Sample		MS	MSD	RPD	Rec.	RPD	MS	MSD
Benzene	25.3	22.7	ND	25	101.2	90.8	10.8	69-129	20		
Toluene	26.1	29.6	ND	25	104.4	118.4	12.6	70-130	20		
Methyl tert-butyl ether	23.3	20.6	ND	25	93.2	82.4	12.3	65-165	20		
<i>Surrogate(s)</i>											
1,2-Dichloroethane-d4	491	469		500	98.2	93.8		76-114			
Toluene-d8	510	516		500	102.0	103.2		88-110			

Severn Trent Laboratories, Inc.

STL San Francisco * 1220 Quarry Lane, Pleasanton, CA 94566

Tel 925 484 1919 Fax 925 484 1096 * www.stl-inc.com * CA DHS ELAP# 2496

10/08/2003 13:26

Page 11 of 12

Gas/BTEX Fuel Oxygenates by 8260B

Gettler Ryan

Attn.: Deanna Harding

6747 Sierra Court Suite J

Dublin, CA 94568

Phone: (925) 551-7444 Fax: (925) 551-7899

Project: 180061.80

Conoco #5325

Received: 09/25/2003 09:35

Site: 3220 Lakeshore Ave., Oakland, CA

Legend and Notes

Report Comment

LSCD for batch 2003/10/02-2A.65 was outside of control limits. MS/MSD verifies the accuracy for that batch. Data reported as is.

Analysis Flag

o

Reporting limits were raised due to high level of analyte present in the sample.

Misc Anions by Ion Chromatograph

Gettler Ryan

Attn.: Deanna Harding

6747 Sierra Court Suite J

Dublin, CA 94568

Phone: (925) 551-7444 Fax: (925) 551-7899

Project: 180061.80

Conoco #5325

Received: 09/25/2003 09:35

Site: 3220 Lakeshore Ave., Oakland, CA

Samples Reported

Sample Name	Date Sampled	Matrix	Lab #
U-1	09/24/2003 11:48	Water	2
U-2	09/24/2003 12:24	Water	3
U-3	09/24/2003 12:58	Water	4
U-4	09/24/2003 13:41	Water	5
U-5	09/24/2003 14:19	Water	6
U-6	09/24/2003 15:06	Water	7

Misc Anions by Ion Chromatograph

Gettler Ryan

Attn.: Deanna Harding

6747 Sierra Court Suite J

Dublin, CA 94568

Phone: (925) 551-7444 Fax: (925) 551-7899

Project: 180061.80

Conoco #5325

Received: 09/25/2003 09:35

Site: 3220 Lakeshore Ave., Oakland, CA

Prep(s):	300.0/9056	Test(s):	300.0/9056
Sample ID:	U-1	Lab ID:	2003-09-0949 - 2
Sampled:	09/24/2003 11:48	Extracted:	9/25/2003 00:00
Matrix:	Water	QC Batch#:	2003/09/25-01.41

Compound	Conc.	RL	Unit	Dilution	Analyzed	Flag
Nitrate	ND	1.0	mg/L	1.00	09/25/2003	
Orthophosphate	ND	1.0	mg/L	1.00	09/25/2003	

Misc Anions by Ion Chromatograph

Gettler Ryan

Attn.: Deanna Harding

6747 Sierra Court Suite J

Dublin, CA 94568

Phone: (925) 551-7444 Fax: (925) 551-7899

Project: 180061.80

Conoco #5325

Received: 09/25/2003 09:35

Site: 3220 Lakeshore Ave., Oakland, CA

Prep(s):	300.0/9056	Test(s):	300.0/9056
Sample ID:	U-2	Lab ID:	2003-09-0949 - 3
Sampled:	09/24/2003 12:24	Extracted:	9/25/2003 00:00
Matrix:	Water	QC Batch#:	2003/09/25-01.41

Compound	Conc.	RL	Unit	Dilution	Analyzed	Flag
Nitrate	ND	1.0	mg/L	1.00	09/25/2003	
Orthophosphate	ND	1.0	mg/L	1.00	09/25/2003	

Misc Anions by Ion Chromatograph

Gettler Ryan

Attn.: Deanna Harding

6747 Sierra Court Suite J

Dublin, CA 94568

Phone: (925) 551-7444 Fax: (925) 551-7899

Project: 180061.80

Conoco #5325

Received: 09/25/2003 09:35

Site: 3220 Lakeshore Ave., Oakland, CA

Prep(s): 300.0/9056 Test(s): 300.0/9056
Sample ID: U-3 Lab ID: 2003-09-0949 - 4
Sampled: 09/24/2003 12:58 Extracted: 9/25/2003 00:00
Matrix: Water QC Batch#: 2003/09/25-01.41

Compound	Conc.	RL	Unit	Dilution	Analyzed	Flag
Nitrate	18	1.0	mg/L	1.00	09/25/2003	
Orthophosphate	1.4	1.0	mg/L	1.00	09/25/2003	

Misc Anions by Ion Chromatograph

Gettler Ryan

Attn.: Deanna Harding

6747 Sierra Court Suite J

Dublin, CA 94568

Phone: (925) 551-7444 Fax: (925) 551-7899

Project: 180061.80

Conoco #5325

Received: 09/25/2003 09:35

Site: 3220 Lakeshore Ave., Oakland, CA

Prep(s):	300.0/9056	Test(s):	300.0/9056
Sample ID:	U-4	Lab ID:	2003-09-0949 - 5
Sampled:	09/24/2003 13:41	Extracted:	9/25/2003 00:00
Matrix:	Water	QC Batch#:	2003/09/25-01.41

Compound	Conc.	RL	Unit	Dilution	Analyzed	Flag
Nitrate	17	1.0	mg/L	1.00	09/25/2003	
Orthophosphate	1.5	1.0	mg/L	1.00	09/25/2003	

Misc Anions by Ion Chromatograph

Gettler Ryan

Attn.: Deanna Harding

6747 Sierra Court Suite J

Dublin, CA 94568

Phone: (925) 551-7444 Fax: (925) 551-7899

Project: 180061.80

Conoco #5325

Received: 09/25/2003 09:35

Site: 3220 Lakeshore Ave., Oakland, CA

Prep(s):	300.0/9056	Test(s):	300.0/9056
Sample ID:	U-5	Lab ID:	2003-09-0949 - 6
Sampled:	09/24/2003 14:19	Extracted:	9/25/2003 00:00
Matrix:	Water	QC Batch#:	2003/09/25-01.41

Compound	Conc.	RL	Unit	Dilution	Analyzed	Flag
Nitrate	18	1.0	mg/L	1.00	09/25/2003	
Orthophosphate	1.8	1.0	mg/L	1.00	09/25/2003	

Misc Anions by Ion Chromatograph

Gettler Ryan

Attn.: Deanna Harding

6747 Sierra Court Suite J

Dublin, CA 94568

Phone: (925) 551-7444 Fax: (925) 551-7899

Project: 180061.80

Conoco #5325

Received: 09/25/2003 09:35

Site: 3220 Lakeshore Ave., Oakland, CA

Prep(s): 300.0/9056 Test(s): 300.0/9056
Sample ID: U-6 Lab ID: 2003-09-0949 - 7
Sampled: 09/24/2003 15:06 Extracted: 9/25/2003 00:00
Matrix: Water QC Batch#: 2003/09/25-01.41

Compound	Conc.	RL	Unit	Dilution	Analyzed	Flag
Nitrate	ND	1.0	mg/L	1.00	09/25/2003	
Orthophosphate	4.6	1.0	mg/L	1.00	09/25/2003	

Misc Anions by Ion Chromatograph

Gettler Ryan

Attn.: Deanna Harding

6747 Sierra Court Suite J

Dublin, CA 94568

Phone: (925) 551-7444 Fax: (925) 551-7899

Project: 180061.80

Conoco #5325

Received: 09/25/2003 09:35

Site: 3220 Lakeshore Ave., Oakland, CA

Batch QC Report

Prep(s): 300.0/9056

Method Blank

MB: 2003/09/25-01.41-001

Water

Test(s): 300.0/9056

QC Batch # 2003/09/25-01.41

Date Extracted: 09/25/2003

Compound	Conc.	RL	Unit	Analyzed	Flag
Nitrate	ND	1.0	mg/L	09/25/2003	
Orthophosphate	ND	1.0	mg/L	09/25/2003	

Misc Anions by Ion Chromatograph

Gettler Ryan

Attn.: Deanna Harding

6747 Sierra Court Suite J

Dublin, CA 94568

Phone: (925) 551-7444 Fax: (925) 551-7899

Project: 180061.80

Conoco #5325

Received: 09/25/2003 09:35

Site: 3220 Lakeshore Ave., Oakland, CA

Batch QC Report

Prep(s): 300.0/9056

Test(s): 300.0/9056

Laboratory Control Spike

Water

QC Batch # 2003/09/25-01.41

LCS 2003/09/25-01.41-002

Extracted: 09/25/2003

Analyzed: 09/25/2003

LCSD 2003/09/25-01.41-003

Extracted: 09/25/2003

Analyzed: 09/25/2003

Compound	Conc. mg/L		Exp. Conc.	Recovery %		RPD	Ctrl. Limits %		Flags	
	LCS	LCSD		LCS	LCSD		%	Rec.	RPD	LCS
Nitrate	19.0	18.8	20.0	95.0	94.0	1.1	80-120	20		
Orthophosphate	19.7	19.5	20.0	98.5	97.5	1.0	80-120	20		

Misc Anions by Ion Chromatograph

Gettler Ryan

Attn.: Deanna Harding

6747 Sierra Court Suite J

Dublin, CA 94568

Phone: (925) 551-7444 Fax: (925) 551-7899

Project: 180061.80

Conoco #5325

Received: 09/25/2003 09:35

Site: 3220 Lakeshore Ave., Oakland, CA

Batch QC Report

Prep(s): 300.0/9056

Test(s): 300.0/9056

Matrix Spike (MS / MSD)

Water

QC Batch # 2003/09/25-01.41

U-3 >> MS

Lab ID: 2003-09-0949 - 004

MS: 2003/09/25-01.41-004

Extracted: 09/25/2003

Analyzed: 09/25/2003

Dilution: 1.00

MSD: 2003/09/25-01.41-005

Extracted: 09/25/2003

Analyzed: 09/25/2003

Dilution: 1.00

Compound	Conc. mg/L			Spk. Level mg/L	Recovery %			Limits %		Flags	
	MS	MSD	Sample		MS	MSD	RPD	Rec.	RPD	MS	MSD
Nitrate	57.7	56.4	17.5	40.0	100.5	97.3	3.2	80-120	20		
Orthophosphate	41.4	42.8	1.44	40.0	99.9	103.4	3.4	80-120	20		

Severn Trent Laboratories, Inc.

STL San Francisco * 1220 Quarry Lane, Pleasanton, CA 94566

Tel 925 484 1919 Fax 925 484 1096 * www.stl-inc.com * CA DHS ELAP# 2496

10/06/2003 09:20

Page 10 of 10

Dissolved Metals

Gettler Ryan

Attn.: Deanna Harding

6747 Sierra Court Suite J

Dublin, CA 94568

Phone: (925) 551-7444 Fax: (925) 551-7899

Project: 180061.80

Conoco #5325

Received: 09/25/2003 09:35

Site: 3220 Lakeshore Ave., Oakland, CA

Samples Reported

Sample Name	Date Sampled	Matrix	Lab #
U-1	09/24/2003 11:48	Water	2
U-2	09/24/2003 12:24	Water	3
U-3	09/24/2003 12:58	Water	4
U-4	09/24/2003 13:41	Water	5
U-5	09/24/2003 14:19	Water	6
U-6	09/24/2003 15:06	Water	7

Dissolved Metals

Gettler Ryan

Attn.: Deanna Harding

6747 Sierra Court Suite J

Dublin, CA 94568

Phone: (925) 551-7444 Fax: (925) 551-7899

Project: 180061.80

Conoco #5325

Received: 09/25/2003 09:35

Site: 3220 Lakeshore Ave., Oakland, CA

Prep(s):	3005A	Test(s):	6010B
Sample ID:	U-1	Lab ID:	2003-09-0949 - 2
Sampled:	09/24/2003 11:48	Extracted:	9/26/2003 11:45
Matrix:	Water	QC Batch#:	2003/09/26-03.15

Compound	Conc.	RL	Unit	Dilution	Analyzed	Flag
Iron	15	0.20	mg/L	1.00	09/29/2003 13:57	

Dissolved Metals

Gettler Ryan

Attn.: Deanna Harding

6747 Sierra Court Suite J

Dublin, CA 94568

Phone: (925) 551-7444 Fax: (925) 551-7899

Project: 180061.80

Conoco #5325

Received: 09/25/2003 09:35

Site: 3220 Lakeshore Ave., Oakland, CA

Prep(s):	3005A	Test(s):	6010B
Sample ID:	U-2	Lab ID:	2003-09-0949 - 3
Sampled:	09/24/2003 12:24	Extracted:	9/26/2003 11:45
Matrix:	Water	QC Batch#:	2003/09/26-03.15

Compound	Conc.	RL	Unit	Dilution	Analyzed	Flag
Iron	14	0.20	mg/L	1.00	09/29/2003 14:01	

Dissolved Metals

Gettler Ryan

Attn.: Deanna Harding

6747 Sierra Court Suite J

Dublin, CA 94568

Phone: (925) 551-7444 Fax: (925) 551-7899

Project: 180061.80

Conoco #5325

Received: 09/25/2003 09:35

Site: 3220 Lakeshore Ave., Oakland, CA

Prep(s):	3005A	Test(s):	6010B
Sample ID:	U-3	Lab ID:	2003-09-0949 - 4
Sampled:	09/24/2003 12:58	Extracted:	9/26/2003 11:45
Matrix:	Water	QC Batch#:	2003/09/26-03.15

Compound	Conc.	RL	Unit	Dilution	Analyzed	Flag
Iron	ND	0.20	mg/L	1.00	09/29/2003 14:05	

Dissolved Metals

Gettler Ryan

Attn.: Deanna Harding

6747 Sierra Court Suite J

Dublin, CA 94568

Phone: (925) 551-7444 Fax: (925) 551-7899

Project: 180061.80

Conoco #5325

Received: 09/25/2003 09:35

Site: 3220 Lakeshore Ave., Oakland, CA

Prep(s):	3005A	Test(s):	6010B
Sample ID:	U-4	Lab ID:	2003-09-0949 - 5
Sampled:	09/24/2003 13:41	Extracted:	9/26/2003 11:45
Matrix:	Water	QC Batch#:	2003/09/26-03.15

Compound	Conc.	RL	Unit	Dilution	Analyzed	Flag
Iron	ND	0.20	mg/L	1.00	09/29/2003 14:09	

Dissolved Metals

Gettler Ryan

Attn.: Deanna Harding

6747 Sierra Court Suite J

Dublin, CA 94568

Phone: (925) 551-7444 Fax: (925) 551-7899

Project: 180061.80

Conoco #5325

Received: 09/25/2003 09:35

Site: 3220 Lakeshore Ave., Oakland, CA

Prep(s):	3005A	Test(s):	6010B
Sample ID:	U-5	Lab ID:	2003-09-0949 - 6
Sampled:	09/24/2003 14:19	Extracted:	9/26/2003 11:45
Matrix:	Water	QC Batch#:	2003/09/26-03.15

Compound	Conc.	RL	Unit	Dilution	Analyzed	Flag
Iron	ND	0.20	mg/L	1.00	09/29/2003 14:14	

Dissolved Metals

Gettler Ryan

Attn.: Deanna Harding

6747 Sierra Court Suite J

Dublin, CA 94568

Phone: (925) 551-7444 Fax: (925) 551-7899

Project: 180061.80

Conoco #5325

Received: 09/25/2003 09:35

Site: 3220 Lakeshore Ave., Oakland, CA

Prep(s):	3005A	Test(s):	6010B
Sample ID:	U-6	Lab ID:	2003-09-0949-7
Sampled:	09/24/2003 15:06	Extracted:	9/26/2003 11:45
Matrix:	Water	QC Batch#:	2003/09/26-03.15

Compound	Conc.	RL	Unit	Dilution	Analyzed	Flag
Iron	1.4	0.20	mg/L	1.00	09/29/2003 14:18	

Dissolved Metals

Gettler Ryan

Attn.: Deanna Harding

6747 Sierra Court Suite J

Dublin, CA 94568

Phone: (925) 551-7444 Fax: (925) 551-7899

Project: 180061.80

Conoco #5325

Received: 09/25/2003 09:35

Site: 3220 Lakeshore Ave., Oakland, CA

Batch QC Report

Prep(s): 3005A

Method Blank

MB: 2003/09/26-03.15-072

Water

Test(s): 6010B

QC Batch # 2003/09/26-03.15

Date Extracted: 09/26/2003 11:45

Compound	Conc.	RL	Unit	Analyzed	Flag
Iron	ND	0.20	mg/L	09/29/2003 12:54	

Dissolved Metals

Gettler Ryan

Attn.: Deanna Harding

6747 Sierra Court Suite J

Dublin, CA 94568

Phone: (925) 551-7444 Fax: (925) 551-7899

Project: 180061.80

Conoco #5325

Received: 09/25/2003 09:35

Site: 3220 Lakeshore Ave., Oakland, CA

Batch QC Report

Prep(s): 3005A

Test(s): 6010B

Laboratory Control Spike

Water

QC Batch # 2003/09/26-03.15

LCS 2003/09/26-03.15-073

Extracted: 09/26/2003

Analyzed: 09/29/2003 12:59

LCSD 2003/09/26-03.15-074

Extracted: 09/26/2003

Analyzed: 09/29/2003 13:03

Compound	Conc. mg/L		Exp.Conc.	Recovery %		RPD	Ctrl.Limits %		Flags	
	LCS	LCSD		LCS	LCSD		%	Rec.	RPD	LCS
Iron	5.03	4.97	5.00	100.6	99.4	1.2	80-120	20		