

20229  
Don



# GETTLER-RYAN INC.

## TRANSMITTAL

July 21, 2003  
G-R #180061

TO: Mr. David B. De Witt  
ConocoPhillips  
76 Broadway Avenue  
Sacramento, California 95818

CC: Mr. David Vossler  
Gettler-Ryan Inc.  
Petaluma, California

FROM: Deanna L. Harding  
Project Coordinator  
Gettler-Ryan Inc.  
6747 Sierra Court, Suite J  
Dublin, California 94568

RE: Tosco (Unocal) Service Station  
#5325  
3220 Lakeshore Avenue  
Oakland, California

Alameda County  
AUG 07 2003  
Environmental Health

WE HAVE ENCLOSED THE FOLLOWING:

COPIES	DATED	DESCRIPTION
1	July 15, 2003	Groundwater Monitoring and Sampling Report Second Quarter - Event of June 18, 2003

### COMMENTS:

This report is being sent to you for your review/comment, prior to being distributed on your behalf. If no comments are received by **August 4, 2003**, this report will be distributed to the following:

cc: Alameda County Health Care Services, 1131 Harbor Bay Parkway, Suite 250 Alameda, CA 94502

Enclosure

trans/5325-DBD



2000 Crow Canyon Place  
Suite 400  
San Ramon, CA 94583

Phone: (925) 277-2305  
Fax: (925) 277-2361

Environmental Department

August 5, 2003

Re: Tosco (Unocal) Service Station #5325  
3220 Lakeshore Avenue  
Oakland, California

Alameda County  
AUG 07 2003  
Environmental Health

" I declare under penalty of perjury, that to the best of my knowledge at the present time, the information and/or recommendations contained in the attached proposal or report is true and correct."

David B. DeWitt  
Site Manager  
ConocoPhillips



# GETTLER-RYAN INC.

July 15, 2003  
G-R Job #180061

Mr. David B. De Witt  
ConocoPhillips  
76 Broadway Avenue  
Sacramento, California 95818

**RE: Second Quarter Event of June 18, 2003**  
Groundwater Monitoring & Sampling Report  
Tosco (Unocal) Service Station #5325  
3220 Lakeshore Avenue  
Oakland, California

Dear Mr. De Witt:

This report documents the most recent groundwater monitoring and sampling event performed by Gettler-Ryan Inc. (G-R) at the referenced site. All field work was conducted in accordance with G-R Standard Operating Procedure - Groundwater Sampling (attached).

Static groundwater levels were measured and all wells were checked for the presence of separate-phase hydrocarbons. Separate-phase hydrocarbons were not present in any wells. Static water level data and groundwater elevations are summarized in Table 1. Field Measurements are summarized in Table 3. A Potentiometric Map is included as Figure 1.

Groundwater samples were collected from the monitoring wells and submitted to a state certified laboratory for analyses. The field data sheets for this event are attached. Analytical results are presented in the table(s) listed below. A Concentration Map is included as Figure 2. The chain of custody document and laboratory analytical report are also attached.

Sincerely,

Deanna L. Harding  
Project Coordinator

Robert C. Mallory  
Registered Geologist No. 7285

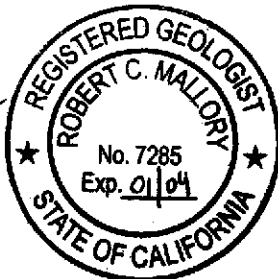
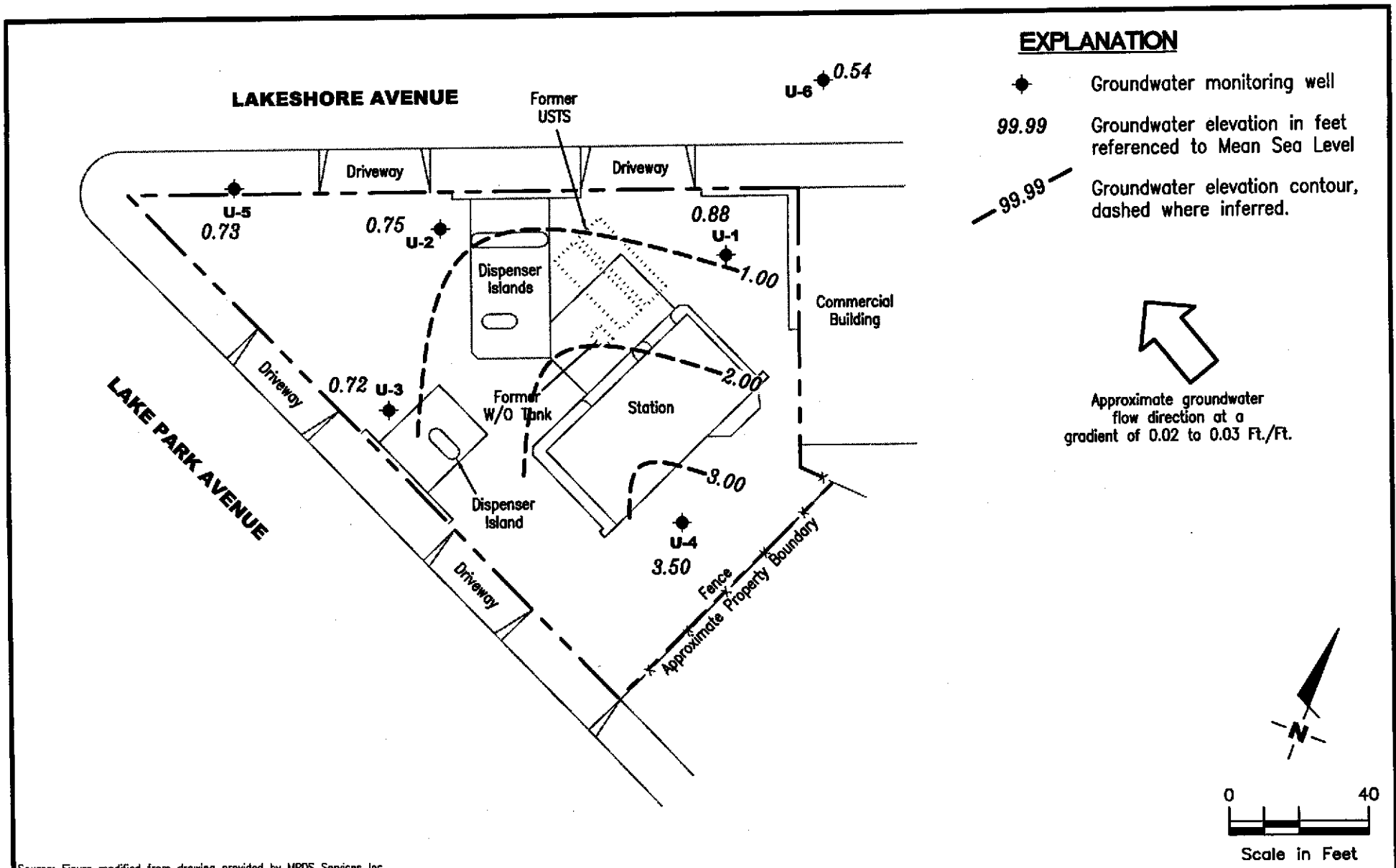

Figure 1: Potentiometric Map  
Figure 2: Concentration Map  
Table 1: Groundwater Monitoring Data and Analytical Results  
Table 2: Groundwater Analytical Results - Oxygenate Compounds  
Table 3: Field Measurements and Groundwater Analytical Results  
Attachments: Standard Operating Procedure - Groundwater Sampling  
Field Data Sheets  
Chain of Custody Document and Laboratory Analytical Reports

5325.qml



Source: Figure modified from drawing provided by MPDS Services Inc..

**GETTLER - RYAN INC.**  
 6747 Sierra Ct., Suite J  
 Dublin, CA 94568 (925) 551-7555

**POTENTIOMETRIC MAP**  
 Tosco (Unocal) Service Station #5325  
 3220 Lakeshore Avenue  
 Oakland, California

FIGURE  
**1**

PROJECT NUMBER  
 180061

REVIEWED BY

DATE  
 June 18, 2003

REVISED DATE

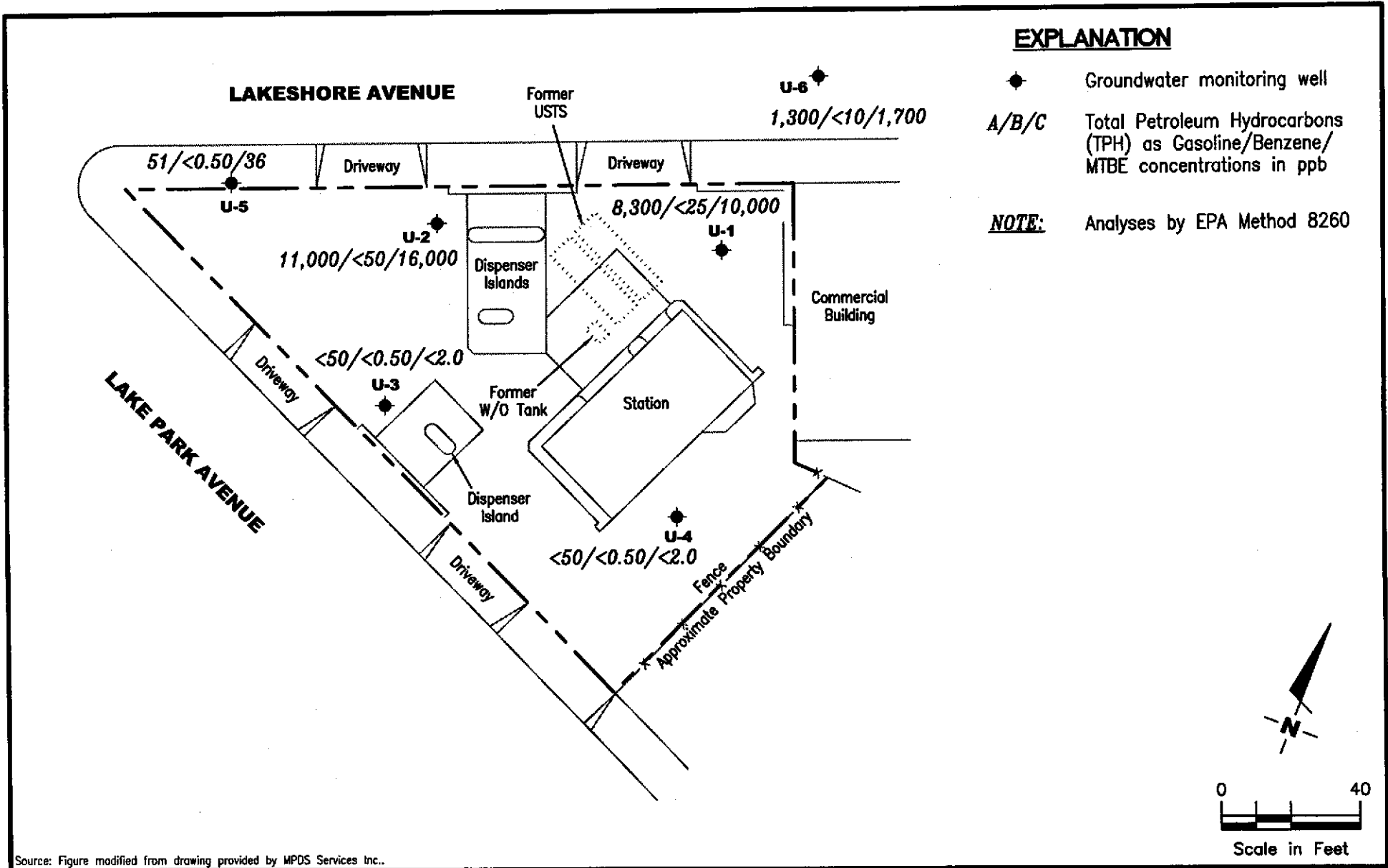

**GETTLER - RYAN INC.**  
 6747 Sierra Ct., Suite J  
 Dublin, CA 94568 (925) 551-7555

**CONCENTRATION MAP**  
 Tosco (Unocal) Service Station #5325  
 3220 Lakeshore Avenue  
 Oakland, California

FIGURE  
**2**

**Table 1**  
**Groundwater Monitoring Data and Analytical Results**  
 Tosco (Unocal) Service Station #5325  
 3220 Lakeshore Avenue  
 Oakland, California

WELL ID/ TOC*(ft.)	DATE	DTW (ft.)	S.I. (ft. bgs)	GWE (ft.)	Product Thickness (ft.)	TPH-G (ppb)	B (ppb)	T (ppb)	E (ppb)	X (ppb)	MTBE (ppb)	
U-1	08/10/90	--	5.0-20.0	--	--	690	38	75	8.6	130	--	
	01/07/91	--		--	--	250	22	16	4.2	17	--	
	04/01/91	--		--	--	160	13	8.6	1.0	15	--	
	07/03/91	--		--	--	140	21	4.3	0.36	17	--	
	10/09/91	--		--	--	ND	ND	ND	ND	ND	--	
	02/12/92	--		--	--	250	ND	ND	ND	ND	--	
	05/05/92	--		--	--	230	1.2	ND	ND	ND	--	
	06/11/92	--		--	--	1,000	80	1.4	6.7	41	--	
	08/20/92	--		--	--	400 <sup>1</sup>	1.0	ND	ND	0.6	--	
	02/22/93	--		--	--	34,000	1,400	5,500	910	7,300	--	
5.32	05/07/93	--		--	--	8,700	600	240	650	3,300	--	
	08/08/93	--		--	--	4,900 <sup>2</sup>	79	ND	832	270	--	
	11/16/93	8.61		-3.29	0.00	690 <sup>3</sup>	ND	ND	ND	ND	--	
	02/16/94	8.54		-3.22	0.00	6,800 <sup>4</sup>	ND	ND	ND	ND	--	
	8.46	06/22/94	8.39		0.07	0.00	200	ND	ND	5.9	21	--
		09/22/94	8.66		-0.20	0.00	6,100 <sup>3</sup>	ND	ND	ND	ND	--
	12/24/94	8.04		0.42	0.00	50,000	2,500	9,700	2,400	17,000	--	
	03/25/95	7.72		1.02**	0.37	NOT SAMPLED DUE TO THE PRESENCE OF FREE PRODUCT					--	
	06/21/95	9.30		-0.69**	0.20	NOT SAMPLED DUE TO THE PRESENCE OF FREE PRODUCT					--	
	09/19/95	9.29		-0.53**	0.40	NOT SAMPLED DUE TO THE PRESENCE OF FREE PRODUCT					--	
	12/19/95	8.98		-0.50**	0.03	NOT SAMPLED DUE TO THE PRESENCE OF FREE PRODUCT					--	
	03/18/96	8.25		0.21	0.00	27,000	ND	2,300	1,400	11,000	4,900	
	06/27/96	7.92		0.54	<0.01	120,000	540	4,300	2,600	26,000	ND	
	09/26/96	9.10		-0.62**	0.02	NOT SAMPLED DUE TO THE PRESENCE OF FREE PRODUCT					--	
	12/09/96	6.88		1.60**	0.03	NOT SAMPLED DUE TO THE PRESENCE OF FREE PRODUCT					--	
	03/14/97	9.02		-0.15**	0.55	NOT SAMPLED DUE TO THE PRESENCE OF FREE PRODUCT					--	
	06/30/97	8.41		0.07**	0.02	NOT SAMPLED DUE TO THE PRESENCE OF FREE PRODUCT					--	
	09/19/97	8.56		-0.08**	0.02	NOT SAMPLED DUE TO THE PRESENCE OF FREE PRODUCT					--	
	12/12/97	8.58		-0.11**	0.01	NOT SAMPLED DUE TO THE PRESENCE OF FREE PRODUCT					--	
	03/03/98 <sup>17</sup>	8.23		0.26**	0.04	NOT SAMPLED DUE TO THE PRESENCE OF FREE PRODUCT					--	
06/15/98 <sup>17</sup>	8.37		0.09	Sheen	52,000	ND <sup>7</sup>	900	1,800	13,000	ND <sup>7</sup>		
09/30/98 <sup>17</sup>	8.94		-0.48	Sheen	1,000,000 <sup>8</sup>	ND <sup>7</sup>	2,600	13,000	83,000	4,800		
12/28/98 <sup>17</sup>	8.57		-0.11	<0.01	1,100,000 <sup>9</sup>	ND <sup>7</sup>	1,600	8,600	71,000	5,700		

**Table 1**  
**Groundwater Monitoring Data and Analytical Results**  
 Tosco (Unocal) Service Station #5325  
 3220 Lakeshore Avenue  
 Oakland, California

WELL ID/ TOC* (ft.)	DATE	DTW (ft.)	S.I. (ft. bgs)	GWE (ft.)	Product Thickness (ft.)	TPH-G (ppb)	B (ppb)	T (ppb)	E (ppb)	X (ppb)	MTBE (ppb)
U-1 (cont)	03/22/99 <sup>17</sup>	8.18	5.0-20.0	0.28	Sheen	130,000	470	1,100	2,000	28,000	5,700
	06/09/99	9.37		-0.91	0.00	40,000	230	640	590	13,000	3,500/2,100 <sup>10</sup>
	09/08/99 <sup>17</sup>	9.53		-1.07	0.00	55,000 <sup>11</sup>	217	202	745	14,300	6,890/6,690 <sup>10</sup>
	12/07/99 <sup>17</sup>	9.67		-1.21	0.00	41,200 <sup>13</sup>	89.3	ND <sup>7</sup>	385	6,930	15,800/14,700 <sup>12</sup>
	03/13/00 <sup>17</sup>	8.44		0.02	0.00	48,000 <sup>11</sup>	490	610	2,400	10,000	22,000/23,000 <sup>10</sup>
	06/21/00 <sup>17</sup>	9.45		-0.99	0.00	37,000 <sup>11</sup>	200	ND <sup>7</sup>	1,200	7,200	15,000/20,000 <sup>10</sup>
	09/27/00 <sup>17</sup>	9.29		-0.83	0.00	15,000 <sup>11</sup>	92	ND <sup>7</sup>	540	2,800	74,000/83,000 <sup>15</sup>
	12/12/00 <sup>17</sup>	9.37		-0.91	0.00	50,000 <sup>16</sup>	ND <sup>7</sup>	ND <sup>7</sup>	250	1,900	12,000/15,000 <sup>12</sup>
	03/07/01 <sup>17</sup>	8.45		0.01	0.00	6,220 <sup>13</sup>	29.8	10.4	96.3	638	11,200/11,800 <sup>10</sup>
	06/06/01 <sup>17</sup>	9.29		-0.83	0.00	5,200 <sup>13</sup>	17	ND <sup>7</sup>	69	420	6,500/8,700 <sup>12</sup>
	09/24/01 <sup>17</sup>	9.39		-0.93	0.00	4,300 <sup>18</sup>	36	<25	65	590	4,400/4,400 <sup>10</sup>
	12/10/01 <sup>20</sup>	9.17		-0.71	0.00	11,000 <sup>18</sup>	220	<100	380	1,500	5,100/5,100 <sup>10</sup>
	03/11/02 <sup>20</sup>	9.44		-0.98	0.00	5,500 <sup>13</sup>	28	<20	360	690	6,400/6,300 <sup>10</sup>
	06/04/02 <sup>20</sup>	8.32		0.14	0.00	4,600 <sup>18</sup>	31	<10	240	180	6,500
	09/03/02 <sup>20</sup>	9.36		-0.90	0.00	2,300 <sup>21</sup>	<12	<12	<12	68	3,500/4,700 <sup>10</sup>
	12/03/02 <sup>20,22</sup>	8.18		0.28	0.00	<5,000	<50	<50	<50	<100	4,700
	03/04/03 <sup>22</sup>	8.29		0.17	0.00	8,900	26	<25	400	130	5,500
06/18/03 <sup>22</sup>	7.58		0.88	0.00	8,300	<25	<25	<25	<50	10,000	
U-2	08/10/90	--	5.0-20.0	--	--	780	27	46	15	130	--
	01/07/91	--		--	--	1,900	67	5.8	58	69	--
	04/01/91	--		--	--	1,700	250	89	34	190	--
	07/03/91	--		--	--	2,100	150	25	3.1	290	--
	10/09/91	--		--	--	230	7.1	ND	ND	11	--
	02/12/92	--		--	--	410	1.9	ND	0.36	0.4	--
	05/05/92	--		--	--	1,600	120	52	6.2	290	--
	06/11/92	--		--	--	620	17	2.1	ND	37	--
	08/20/92	--		--	--	700	28	6.5	1.3	4.6	--
02/22/93	--		--	--	3,400	2,400	2,100	1,200	5,800	--	

**Table 1**  
**Groundwater Monitoring Data and Analytical Results**  
Tosco (Unocal) Service Station #5325  
3220 Lakeshore Avenue  
Oakland, California

WELL ID/ TOC* (ft.)	DATE	DTW (ft.)	S.I. (ft. bgs)	GWE (ft.)	Product Thickness (ft.)	TPH-G (ppb)	B (ppb)	T (ppb)	E (ppb)	X (ppb)	MTBE (ppb)
U-2	05/07/93	--	5.0-20.0	--	--	17,000	1,800	660	1,700	4,000	--
(cont)	08/08/93	--		--	--	5,600 <sup>2</sup>	420	ND	410	670	--
4.53	11/16/93	8.17		-3.64	0.00	510 <sup>3</sup>	ND	ND	ND	ND	--
	02/16/94	7.73		-3.20	0.00	980 <sup>4</sup>	49	13	2.7	40	--
7.62	06/22/94	7.60		0.02	0.00	31,000	2,200	62	1,500	3,500	--
	09/22/94	7.93		-0.31	0.00	8,500 <sup>3</sup>	29	ND	ND	ND	--
	12/24/94	7.27		0.35	0.00	32,000	1,500	890	1,300	5,000	--
	03/25/95	7.01		0.61	0.00	170,000	1,900	21,000	4,800	33,000	--
	06/21/95	6.98		0.64	0.00	16,000	2,100	ND	1,800	1,700	--
	09/19/95	7.70		-0.08	0.00	3,000	610	ND	78	240	-- <sup>5</sup>
	12/19/95	7.30		0.32	0.00	1,600	140	55	52	270	-- <sup>6</sup>
	03/18/96	6.45		1.17	0.00	12,000	2,200	ND	1,200	2,200	22,000
	06/27/96	7.41		0.21	0.00	28,000	3,400	ND	2,800	3,100	3,000
	09/26/96	7.90		-0.28	0.00	5,900	750	ND	ND	ND	18,000
	12/09/96	6.76		0.86	0.00	13,000	5,100	290	980	370	2,700
	03/14/97	7.12		0.52**	0.03	NOT SAMPLED DUE TO THE PRESENCE OF FREE PRODUCT					--
	06/30/97	6.19		1.43	<0.01	NOT SAMPLED DUE TO THE PRESENCE OF FREE PRODUCT					--
	09/19/97	7.31		0.31	<0.01	NOT SAMPLED DUE TO THE PRESENCE OF FREE PRODUCT					--
	12/12/97	6.75		0.88**	<0.01	NOT SAMPLED DUE TO THE PRESENCE OF FREE PRODUCT					--
	03/03/98	6.36		1.26	Sheen	80,000	3,000	1,100	820	16,000	16,000
	06/15/98	6.51		1.11	Sheen	48,000	1,800	330	470	7,900	20,000
	09/30/98	7.17		0.45	Sheen	60,000	1,300	ND <sup>7</sup>	500	9,700	19,000
	12/28/98	7.06		0.56	0.00	63,000	590	160	320	5,600	16,000
	03/22/99	6.82		0.80	0.00	28,000	1,100	ND <sup>7</sup>	360	2,900	25,000
	06/09/99	7.51		0.11	0.00	21,000	110	190	310	2,600	7,900/7,800 <sup>10</sup>
	09/08/99	8.16		-0.54	0.00	23,300 <sup>11</sup>	477	138	286	4,110	16,400/15,300 <sup>10</sup>
	12/07/99	8.31		-0.69	0.00	4,840 <sup>13</sup>	17.2	ND <sup>7</sup>	ND <sup>7</sup>	157	14,900/15,600 <sup>12</sup>
	03/13/00	6.69		0.93	0.00	11,000 <sup>11</sup>	380	160	ND <sup>7</sup>	2,100	22,000/26,000 <sup>10</sup>
	06/21/00	7.67		-0.05	0.00	9,100 <sup>11</sup>	22	ND <sup>7</sup>	ND <sup>7</sup>	800	16,000/22,000 <sup>10</sup>
	09/27/00	7.44		0.18	0.00	2,900 <sup>11</sup>	43	ND <sup>7</sup>	ND <sup>7</sup>	39	20,000/26,000 <sup>15</sup>
	12/12/00	7.51		0.11	0.00	3,600 <sup>11</sup>	17	ND <sup>7</sup>	ND <sup>7</sup>	87	8,000/7,800 <sup>12</sup>
	03/07/01	7.15		0.47	0.00	1,670 <sup>13</sup>	51.0	ND <sup>7</sup>	7.20	19.5	5,930/7,900 <sup>10</sup>
	06/06/01	7.57		0.05	0.00	1,100 <sup>11</sup>	14	ND <sup>7</sup>	9.3	35	9,200/10,000 <sup>12</sup>



**Table 1**  
**Groundwater Monitoring Data and Analytical Results**  
 Tosco (Unocal) Service Station #5325  
 3220 Lakeshore Avenue  
 Oakland, California

WELL ID/ TOC* (ft.)	DATE	DTW (ft.)	S.I. (ft. bgs)	GWE (ft.)	Product Thickness (ft.)	TPH-G (ppb)	B (ppb)	T (ppb)	E (ppb)	X (ppb)	MTBE (ppb)
U-2 (cont)	09/24/01	7.63	5.0-20.0	-0.01	0.00	1,000 <sup>18</sup>	25	<2.5	12	100	9,800/11,000 <sup>10</sup>
	12/10/01	6.78		0.84	0.00	83	14	0.55	3.4	6.8	2,500/2,500 <sup>10</sup>
	03/11/02	7.12		0.50	0.00	<1,000	28	<10	40	31	11,000/11,000 <sup>10</sup>
	06/04/02	7.18		0.44	0.00	7,700 <sup>18</sup>	32	<25	33	48	14,000
	09/03/02	7.58		0.04	0.00	5,200 <sup>21</sup>	<25	<25	<25	<25	11,000/15,000 <sup>10</sup>
	12/03/02 <sup>22</sup>	7.68		-0.06	0.00	<5,000	<50	<50	<50	<100	3,200
	03/04/03 <sup>22</sup>	7.77		-0.15	0.00	8,100 <sup>21</sup>	<50	<50	<50	<100	7,800
	06/18/03 <sup>22</sup>	6.87		0.75	0.00	11,000 <sup>21</sup>	<50	<50	<50	<100	16,000
U-3	08/10/90	--	5.0-20.0	--	--	ND	ND	ND	ND	ND	--
	01/07/91	--		--	--	ND	ND	ND	ND	1.8	--
	04/01/91	--		--	--	ND	1.0	2.9	0.53	5.4	--
	07/03/91	--		--	--	ND	ND	ND	ND	ND	--
	10/09/91	--		--	--	ND	ND	ND	ND	ND	--
	02/12/92	--		--	--	ND	ND	ND	ND	ND	--
	05/05/92	--		--	--	ND	ND	ND	ND	ND	--
	06/11/92	--		--	--	ND	ND	ND	ND	ND	--
	08/20/92	--		--	--	ND	ND	ND	ND	ND	--
	02/22/93	--		--	--	ND	ND	ND	ND	ND	--
05/07/93	--		--	--	ND	ND	ND	ND	ND	--	
08/08/93	--		--	--	210	5.0	9.7	0.7	4.1	--	
7.86	11/16/93	11.82		-3.96	0.00	ND	ND	ND	ND	ND	--
	02/16/94	11.62		-3.76	0.00	ND	ND	ND	ND	ND	--
10.98	06/22/94	11.64		-0.66	0.00	ND	ND	ND	ND	ND	--
	09/22/94	11.76		-0.78	0.00	ND	ND	ND	ND	ND	--
	12/24/94	11.28		-0.30	0.00	ND	ND	ND	ND	ND	--
	03/25/95	10.96		0.02	0.00	ND	ND	ND	ND	ND	--
	06/21/95	11.37		-0.39	0.00	ND	ND	ND	ND	ND	--
	09/19/95	11.55		-0.57	0.00	ND	ND	ND	ND	ND	-- <sup>5</sup>
	12/19/95	11.45		-0.47	0.00	ND	ND	ND	ND	ND	--
	03/18/96	11.10		-0.12	0.00	ND	ND	ND	ND	ND	--
	06/27/96	11.16		-0.18	0.00	440	49	50	51	140	50

**Table 1**  
**Groundwater Monitoring Data and Analytical Results**  
 Tosco (Unocal) Service Station #5325  
 3220 Lakeshore Avenue  
 Oakland, California

WELL ID/ TOC* (ft.)	DATE	DTW (ft.)	S.I. (ft. bgs)	GWE (ft.)	Product Thickness (ft.)	TPH-G (ppb)	B (ppb)	T (ppb)	E (ppb)	X (ppb)	MTBE (ppb)
U-3	09/26/96	11.55	5.0-20.0	-0.57	0.00	ND	ND	ND	ND	ND	ND
(cont)	12/09/96	10.12		0.86	0.00	ND	ND	ND	ND	ND	29
	03/14/97	10.87		0.11	0.00	ND	ND	ND	ND	ND	ND
	06/30/97	11.08		-0.10	0.00	ND	ND	ND	ND	ND	ND
	09/19/97	11.05		-0.07	0.00	ND	ND	ND	ND	ND	ND
	12/12/97	10.58		0.40	0.00	ND	ND	ND	ND	ND	ND
	03/03/98	9.84		1.14	0.00	ND	ND	ND	ND	ND	ND
	06/15/98	10.56		0.42	0.00	ND	ND	ND	ND	ND	ND
	09/30/98	11.12		-0.14	0.00	ND	ND	ND	ND	ND	ND
	12/28/98	10.96		0.02	0.00	ND	ND	ND	ND	ND	ND
	03/22/99	9.46		1.52	0.00	ND	ND	ND	ND	ND	ND
	06/09/99	11.01		-0.03	0.00	ND	ND	ND	ND	ND	ND
	09/08/99	11.31		-0.33	0.00	ND	ND	ND	ND	ND	ND
	12/07/99	11.26		-0.28	0.00	ND	ND	ND	ND	ND	ND
	03/13/00	8.28		2.70	0.00	ND	ND	ND	ND	ND	ND
	06/21/00	11.12		-0.14	0.00	ND	ND	ND	ND	ND	ND
	09/27/00	11.07		-0.09	0.00	ND	ND	ND	ND	ND	ND
	12/12/00	10.94		0.04	0.00	ND	ND	ND	ND	ND	ND
	03/07/01	8.32		2.66	0.00	ND	ND	ND	ND	ND	ND
	06/06/01	10.94		0.04	0.00	ND	ND	ND	ND	ND	ND
	09/24/01	11.03		-0.05	0.00	<50	<0.50	<0.50	<0.50	<0.50	<2.5
	12/10/01	8.16		2.82	0.00	<50	<0.50	<0.50	<0.50	<0.50	<2.5
	03/11/02	7.82		3.16	0.00	<50	<0.50	<0.50	<0.50	<0.50	<5.0
	06/04/02	10.58		0.40	0.00	<50	<0.50	<0.50	<0.50	<0.50	<2.5
	09/03/02	10.94		0.04	0.00	<50	<0.50	<0.50	<0.50	<0.50	<2.5
	12/03/02 <sup>22</sup>	10.66		0.32	0.00	<50	<0.50	<0.50	<0.50	<1.0	<2.0
	03/04/03 <sup>22</sup>	10.76		0.22	0.00	<50	<0.50	<0.50	<0.50	<1.0	<2.0
	06/18/03 <sup>22</sup>	10.26		0.72	0.00	<50	<0.50	<0.50	<0.50	<1.0	<2.0

**Table 1**  
**Groundwater Monitoring Data and Analytical Results**  
 Tosco (Unocal) Service Station #5325  
 3220 Lakeshore Avenue  
 Oakland, California

WELL ID/ TOC* (ft.)	DATE	DTW (ft.)	S.I. (ft. bgs)	GWE (ft.)	Product Thickness (ft.)	TPH-G (ppb)	B (ppb)	T (ppb)	E (ppb)	X (ppb)	MTBE (ppb)
U-4											
11.15	06/22/94	10.16	5.0-20.0	0.99	0.00	ND	ND	ND	ND	ND	--
	09/22/94	10.79		0.36	0.00	ND	0.78	1.3	ND	1.4	--
	12/24/94	9.81		1.34	0.00	ND	ND	ND	ND	ND	--
	03/25/95	9.51		1.64	0.00	ND	ND	ND	ND	ND	--
	06/21/95	9.54		1.61	0.00	ND	ND	ND	ND	ND	--
	09/19/95	10.17		0.98	0.00	ND	ND	ND	ND	ND	--
	12/19/95	9.98		1.17	0.00	ND	ND	ND	ND	ND	--
	03/18/96	9.66		1.49	0.00	ND	ND	ND	ND	ND	--
	06/27/96	9.74		1.41	0.00	ND	ND	ND	ND	ND	ND
	09/26/96	10.14		1.01	0.00	ND	ND	ND	ND	ND	ND
	12/09/96	8.67		2.48	0.00	ND	ND	ND	ND	ND	33
	03/14/97	9.35		1.80	0.00	ND	ND	ND	ND	ND	ND
	06/30/97	9.89		1.26	0.00	ND	ND	ND	ND	ND	ND
	09/19/97	9.96		1.19	0.00	ND	ND	ND	ND	ND	ND
	12/12/97	8.56		2.59	0.00	ND	ND	ND	ND	ND	ND
	03/03/98	7.85		3.30	0.00	ND	ND	ND	ND	ND	ND
	06/15/98	9.08		2.07	0.00	ND	ND	ND	ND	ND	ND
	09/30/98	9.75		1.40	0.00	ND	ND	ND	ND	ND	ND
	12/28/98	9.59		1.56	0.00	ND	ND	ND	ND	ND	ND
	03/22/99	8.34		2.81	0.00	ND	ND	ND	ND	ND	ND
	06/09/99	9.39		1.76	0.00	ND	ND	ND	ND	ND	ND
	09/08/99	9.90		1.25	0.00	ND	ND	ND	ND	ND	ND
	12/07/99	10.05		1.10	0.00	ND	ND	ND	ND	ND	ND
	03/13/00	7.24		3.91	0.00	ND	ND	ND	ND	ND	ND
	06/21/00	9.48		1.67	0.00	ND	ND	ND	ND	ND	ND
	09/27/00	9.42		1.73	0.00	ND	ND	ND	ND	ND	ND
	12/12/00	9.50		1.65	0.00	ND	ND	ND	ND	ND	ND
	03/07/01	6.88		4.27	0.00	ND	ND	ND	ND	ND	ND
	06/06/01	9.18		1.97	0.00	ND	ND	ND	ND	ND	ND
	09/24/01	9.21		1.94	0.00	<50	<0.50	<0.50	<0.50	<0.50	<2.5
	12/10/01	7.32		3.83	0.00	<50	<0.50	<0.50	<0.50	<0.50	<2.5
	03/11/02	6.92		4.23	0.00	<50	<0.50	<0.50	<0.50	<0.50	<5.0

**Table 1**  
**Groundwater Monitoring Data and Analytical Results**  
 Tosco (Unocal) Service Station #5325  
 3220 Lakeshore Avenue  
 Oakland, California

WELL ID/ TOC* (ft.)	DATE	DTW (ft.)	S.I. (ft. bgs)	GWE (ft.)	Product Thickness (ft.)	TPH-G (ppb)	B (ppb)	T (ppb)	E (ppb)	X (ppb)	MTBE (ppb)
U-4 (cont)	06/04/02	7.58	5.0-20.0	3.57	0.00	<50	<0.50	<0.50	<0.50	<0.50	<2.5
	09/03/02	9.17		1.98	0.00	<50	<0.50	<0.50	<0.50	<0.50	<2.5
	12/03/02 <sup>22</sup>	9.20		1.95	0.00	<50	<0.50	<0.50	<0.50	<1.0	<2.0
	03/04/03 <sup>22</sup>	9.32		1.83	0.00	<50	<0.50	<0.50	<0.50	<1.0	<2.0
	06/18/03 <sup>22</sup>	7.65		3.50	0.00	<50	<0.50	<0.50	<0.50	<1.0	<2.0
U-5 6.98	06/22/94	6.83	5.0-20.0	0.15	0.00	210	7.1	13	4.5	26	--
	09/22/94	6.90		0.08	0.00	170	8.4	10	8.5	18	--
	12/24/94	6.43		0.55	0.00	8,700	560	70	670	430	--
	03/25/95	6.35		0.63	0.00	44,000	390	960	1,500	7,600	--
	06/21/95	7.11		-0.13	0.00	400	2.3	ND	9.1	3.5	--
	09/19/95	6.99		-0.01	0.00	850	14	7.1	13	66	-- <sup>5</sup>
	12/19/95	7.17		-0.19	0.00	ND	ND	ND	ND	ND	--
	03/18/96	6.65		0.33	0.00	100	0.67	0.5	0.51	5.4	--
	06/27/96	6.49		0.49	0.00	16,000	280	150	1,400	4,600	530
	09/26/96	7.13		-0.15	0.00	ND	ND	0.57	ND	0.96	ND
	12/09/96	5.90		1.08	0.00	1,300	29	46	ND	140	97
	03/14/97	6.99		-0.01	0.00	ND	ND	ND	ND	ND	14
	06/30/97	7.08		-0.10	0.00	4,200	74	51	180	980	270
	09/19/97	6.78		0.20	0.00	6,300	160	13	370	1000	480
	12/12/97	6.94		0.04	0.00	60	1.3	ND	1.6	2.1	47
	03/03/98	6.50		0.48	0.00	1,700	29	ND <sup>7</sup>	150	190	330
	06/15/98	6.85		0.13	0.00	1,500	32	ND <sup>7</sup>	91	83	330
	09/30/98	7.31		-0.33	0.00	1,700	44	ND <sup>7</sup>	39	150	60
	12/28/98	7.25		-0.27	0.00	1,400	59	ND <sup>7</sup>	13	27	150
	03/22/99	6.86		0.12	0.00	780	8.9	ND	0.76	4.5	350
06/09/99	7.28	-0.30	0.00	1,000	ND <sup>7</sup>	ND <sup>7</sup>	10	35	280/350 <sup>10</sup>		
09/08/99	7.52	-0.54	0.00	2,620 <sup>11</sup>	26.2	ND <sup>7</sup>	32.2	157	280/239 <sup>12</sup>		
12/07/99	7.67	-0.69	0.00	949 <sup>11</sup>	9.26	ND <sup>7</sup>	11.2	22.7	235/301 <sup>12</sup>		
03/13/00	6.73	0.25	0.00	880 <sup>14</sup>	12	1.0	5.6	8.7	46/37 <sup>10</sup>		
06/21/00	7.39	-0.41	0.00	700 <sup>11</sup>	4.0	ND	0.99	4.0	120/140 <sup>10</sup>		

**Table 1**  
**Groundwater Monitoring Data and Analytical Results**  
Tosco (Unocal) Service Station #5325  
3220 Lakeshore Avenue  
Oakland, California

WELL ID/ TOC*(ft.)	DATE	DTW (ft.)	S.I. (ft. bgs)	GWE (ft.)	Product Thickness (ft.)	TPH-G (ppb)	B (ppb)	T (ppb)	E (ppb)	X (ppb)	MTBE (ppb)
U-5 (cont)	09/27/00	7.45	5.0-20.0	-0.47	0.00	400 <sup>11</sup>	1.9	ND	ND	1.5	160/250 <sup>15</sup>
	12/12/00	7.68		-0.70	0.00	770 <sup>11</sup>	3.2	ND <sup>7</sup>	ND <sup>7</sup>	ND <sup>7</sup>	27/13 <sup>12</sup>
	03/07/01	6.83		0.15	0.00	623 <sup>13</sup>	5.15	ND	ND	0.669	35.7/43.4 <sup>10</sup>
	06/06/01	7.42		-0.44	0.00	110 <sup>13</sup>	ND	ND	ND	ND	ND
	09/24/01	7.50		-0.52	0.00	270 <sup>19</sup>	<0.50	<0.50	<0.50	<0.50	40/42 <sup>10</sup>
	12/10/01	6.65		0.33	0.00	420 <sup>18</sup>	13	0.60	0.66	<0.50	<2.5
	03/11/02	7.00		-0.02	0.00	260 <sup>13</sup>	<0.50	<0.50	<0.50	<0.50	42/47 <sup>10</sup>
	06/04/02	6.71		0.27	0.00	170 <sup>19</sup>	<0.50	0.77	0.87	0.69	29
	09/03/02	7.47		-0.49	0.00	<50	<0.50	<0.50	<0.50	<0.50	37/53 <sup>10</sup>
	12/03/02 <sup>22</sup>	6.64		0.34	0.00	320	<0.50	<0.50	5.7	<1.0	11
	03/04/03 <sup>22</sup>	6.75		0.23	0.00	100 <sup>21</sup>	<0.50	<0.50	<0.50	<1.0	44
	06/18/03 <sup>22</sup>	6.25		0.73	0.00	51 <sup>21</sup>	<0.50	<0.50	<0.50	<1.0	36
	U-6 7.14	06/22/94	7.14	5.0-24.0	0.00	0.00	ND	ND	ND	ND	ND
09/22/94		7.34		-0.20	0.00	130	1.3	0.8	ND	0.73	--
12/24/94		6.67		0.47	0.00	6,900	500	59	600	380	--
03/25/95		6.29		0.85	0.00	47,000	450	1,300	1,700	8,200	--
06/21/95		7.60		-0.46	0.00	ND	ND	ND	ND	ND	--
09/19/95		7.70		-0.56	0.00	ND	ND	ND	ND	ND	-- <sup>5</sup>
12/19/95		7.75		-0.61	0.00	210	2.5	1.0	2.9	17	--
03/18/96		6.86		0.28	0.00	ND	ND	ND	ND	ND	--
06/27/96		6.52		0.62	0.00	ND	ND	ND	ND	ND	510
09/26/96		7.62		-0.48	0.00	ND	ND	ND	ND	ND	1,400
12/09/96		5.88		1.26	0.00	1,200	29	48	6.4	140	58
03/14/97		7.30		-0.16	0.00	ND	ND	ND	ND	ND	1,500
06/30/97		7.35		-0.21	0.00	ND	ND	ND	ND	ND	990
09/19/97		7.25		-0.11	0.00	ND	ND	ND	ND	ND	1,400
12/12/97		7.29		-0.15	0.00	ND	ND	ND	ND	ND	680
03/03/98		7.00		0.14	0.00	ND	ND	ND	ND	ND	1,600
06/15/98	7.18		-0.04	0.00	ND <sup>7</sup>	ND <sup>7</sup>	ND <sup>7</sup>	ND <sup>7</sup>	ND <sup>7</sup>	1,000	
09/30/98	7.90		-0.76	0.00	ND	ND	ND	ND	ND	1,200	

**Table 1**  
**Groundwater Monitoring Data and Analytical Results**  
 Tosco (Unocal) Service Station #5325  
 3220 Lakeshore Avenue  
 Oakland, California

WELL ID/ TOC* (ft.)	DATE	DTW (ft.)	S.I. (ft. bgs)	GWE (ft.)	Product		B (ppb)	T (ppb)	E (ppb)	X (ppb)	MTBE (ppb)
					Thickness (ft.)	TPH-G (ppb)					
U-6	12/28/98	7.79	5.0-24.0	-0.65	0.00	ND <sup>7</sup>	ND <sup>7</sup>	ND <sup>7</sup>	ND <sup>7</sup>	ND <sup>7</sup>	730
(cont)	03/22/99	7.47		-0.33	0.00	ND	ND	ND	ND	ND	1,800
	06/09/99	7.73		-0.59	0.00	ND <sup>7</sup>	ND <sup>7</sup>	ND <sup>7</sup>	ND <sup>7</sup>	ND <sup>7</sup>	1,000/850 <sup>10</sup>
	09/08/99	7.95		-0.81	0.00	ND	ND	ND	ND	ND	851/1,040 <sup>10</sup>
	12/07/99	8.10		-0.96	0.00	ND	ND	ND	ND	ND	1,140/1,150 <sup>12</sup>
	03/13/00	6.95		0.19	0.00	ND	ND	ND	ND	ND	560/670 <sup>10</sup>
	06/21/00	7.84		-0.70	0.00	ND	ND	ND	ND	ND	400/590 <sup>10</sup>
	09/27/00	7.68		-0.54	0.00	ND	ND	ND	ND	ND	2,500/2,800 <sup>15</sup>
	12/12/00	7.74		-0.60	0.00	ND	ND	ND	ND	ND	590/580 <sup>12</sup>
	03/07/01	7.27		-0.13	0.00	ND	ND	ND	ND	ND	310/321 <sup>12</sup>
	06/06/01	7.80		-0.66	0.00	ND	ND	ND	ND	ND	250/330 <sup>12</sup>
	09/24/01	7.82		-0.68	0.00	<50	<0.50	<0.50	<0.50	<0.50	530/660 <sup>10</sup>
	12/10/01	7.15		-0.01	0.00	<50	<0.50	<0.50	<0.50	<0.50	220/220 <sup>10</sup>
	03/11/02	7.32		-0.18	0.00	<50	<0.50	<0.50	<0.50	<0.50	720/760 <sup>10</sup>
	06/04/02	7.18		-0.04	0.00	250 <sup>19</sup>	<1.0	<1.0	<1.0	<1.0	470
	09/03/02	7.72		-0.58	0.00	420 <sup>21</sup>	<2.5	<2.5	<2.5	4.7	860/1,200 <sup>10</sup>
	12/03/02 <sup>22</sup>	6.92		0.22	0.00	<500	<5.0	<5.0	<5.0	<10	870
	03/04/03 <sup>22</sup>	7.01		0.13	0.00	2,300 <sup>21</sup>	<10	<10	<10	<20	2,700
	06/18/03 <sup>22</sup>	6.60		0.54	0.00	1,300 <sup>21</sup>	<10	<10	<10	<20	1,700
<b>Trip Blank</b>											
TB-LB	03/03/98	--	--	--	--	ND	ND	ND	ND	ND	ND
	06/15/98	--	--	--	--	ND	ND	ND	ND	ND	ND
	09/30/98	--	--	--	--	ND	ND	1.7	ND	2.2	ND
	12/28/98	--	--	--	--	ND	ND	0.71	ND	0.72	9.5
	03/22/99	--	--	--	--	ND	ND	ND	ND	ND	ND
	06/09/99	--	--	--	--	ND	ND	ND	ND	ND	ND
	09/08/99	--	--	--	--	ND	ND	ND	ND	ND	ND
	12/07/99	--	--	--	--	ND	ND	0.762	ND	ND	ND
	03/13/00	--	--	--	--	ND	ND	ND	ND	ND	ND
	06/21/00	--	--	--	--	ND	ND	ND	ND	ND	ND
	09/27/00	--	--	--	--	ND	ND	ND	ND	ND	ND

**Table 2**  
**Groundwater Analytical Results - Oxygenate Compounds**  
 Tosco (Unocal) Service Station #5325  
 3220 Lakeshore Avenue  
 Oakland, California

WELL ID	DATE	ETHANOL (ppb)	TBA (ppb)	MTBE (ppb)	DIPE (ppb)	ETBE (ppb)	TAME (ppb)	1,2-DCA (ppb)	EDB (ppb)
U-1	09/27/00 <sup>1</sup>	--	ND <sup>2</sup>	83,000	ND <sup>2</sup>	ND <sup>2</sup>	ND <sup>2</sup>	ND <sup>2</sup>	ND <sup>2</sup>
	12/12/00	--	--	15,000 <sup>3</sup>	--	--	--	--	--
	03/07/01	ND <sup>2</sup>	ND <sup>2</sup>	11,800	ND <sup>2</sup>	ND <sup>2</sup>	ND <sup>2</sup>	ND <sup>2</sup>	ND <sup>2</sup>
	06/06/01 <sup>3</sup>	ND <sup>2</sup>	ND <sup>2</sup>	8,700	ND <sup>2</sup>	ND <sup>2</sup>	ND <sup>2</sup>	ND <sup>2</sup>	ND <sup>2</sup>
	09/24/01	<400,000	<20,000	4,400	<1,000	<1,000	<1,000	<1,000	<1,000
	12/10/01	<8,000	<4,000	5,100	<100	<100	<100	<100	<100
	03/11/02	<25,000	<5,000	6,300	<100	<100	<100	<100	<100
	06/04/02 <sup>4</sup>	--	--	--	--	--	--	--	--
	09/03/02	<50,000	<10,000	4,700	<200	<200	<200	<200	<200
	12/03/02	<50,000	<10,000	4,700	<200	<200	<200	<200	<200
	03/04/03	<25,000	<5,000	5,500	<100	<100	<100	<100	<100
	06/18/03	<25,000	<5,000	10,000	<100	<100	<100	<100	<100
	U-2	09/27/00	--	--	26,000 <sup>1</sup>	--	--	--	--
12/12/00		--	--	7,800 <sup>3</sup>	--	--	--	--	--
03/07/01		ND <sup>2</sup>	ND <sup>2</sup>	7,900	ND <sup>2</sup>	ND <sup>2</sup>	ND <sup>2</sup>	ND <sup>2</sup>	ND <sup>2</sup>
06/06/01 <sup>3</sup>		ND <sup>2</sup>	ND <sup>2</sup>	10,000	ND <sup>2</sup>	ND <sup>2</sup>	ND <sup>2</sup>	ND <sup>2</sup>	ND <sup>2</sup>
09/24/01		<400,000	<20,000	11,000	<1,000	<1,000	<1,000	<1,000	<1,000
12/10/01		<4,000	<2,000	2,500	<50	<50	<50	<50	<50
03/11/02		<50,000	<10,000	11,000	<200	<200	<200	<200	<200
06/04/02 <sup>4</sup>		--	--	--	--	--	--	--	--
09/03/02		<250,000	<50,000	15,000	<1,000	<1,000	<1,000	<1,000	<1,000
12/03/02		<50,000	<10,000	3,200	<200	<200	<200	<200	<200
03/04/03		<50,000	<10,000	7,800	<200	<200	<200	<200	<200
06/18/03		<50,000	<10,000	16,000	<200	<200	<200	<200	<200
U-3		12/03/02	--	--	<2.0	--	--	--	--
	03/04/03	--	--	<2.0	--	--	--	--	--
	06/18/03	--	--	<2.0	--	--	--	--	--

**Table 2**  
**Groundwater Analytical Results - Oxygenate Compounds**  
 Tosco (Unocal) Service Station #5325  
 3220 Lakeshore Avenue  
 Oakland, California

WELL ID	DATE	ETHANOL (ppb)	TBA (ppb)	MTBE (ppb)	DIPE (ppb)	ETBE (ppb)	TAME (ppb)	1,2-DCA (ppb)	EDB (ppb)
U-4	12/03/02	--	--	<2.0	--	--	--	--	--
	03/04/03	--	--	<2.0	--	--	--	--	--
	06/18/03	--	--	<2.0	--	--	--	--	--
U-5	09/27/00	--	--	250 <sup>1</sup>	--	--	--	--	--
	12/12/00	--	--	13 <sup>3</sup>	--	--	--	--	--
	03/07/01	ND	ND	43.4	ND	ND	ND	ND	ND
	09/24/01	<4,000	<200	42	<10	<10	<10	<10	<10
	03/11/02	<500	<100	47	<2.0	<2.0	<2.0	<2.0	<2.0
	06/04/02 <sup>4</sup>	--	--	--	--	--	--	--	--
	09/03/02	<500	<100	53	<2.0	<2.0	<2.0	<2.0	<2.0
	12/03/02	<500	<100	11	<2.0	<2.0	<2.0	<2.0	<2.0
	03/04/03	<500	<100	44	<2.0	<2.0	<2.0	<2.0	<2.0
	06/18/03	<500	<100	36	<2.0	<2.0	<2.0	<2.0	<2.0
U-6	09/27/00	--	--	2,800 <sup>1</sup>	--	--	--	--	--
	12/12/00	--	--	580 <sup>3</sup>	--	--	--	--	--
	03/07/01 <sup>3</sup>	ND <sup>2</sup>	ND <sup>2</sup>	321	ND <sup>2</sup>	ND <sup>2</sup>	ND <sup>2</sup>	ND <sup>2</sup>	ND <sup>2</sup>
	06/06/01 <sup>3</sup>	ND <sup>2</sup>	ND <sup>2</sup>	330	ND <sup>2</sup>	ND <sup>2</sup>	ND <sup>2</sup>	ND <sup>2</sup>	ND <sup>2</sup>
	09/24/01	<40,000	<2,000	660	<100	<100	<100	<100	<100
	12/10/01	<400	<200	220	<5.0	<5.0	<5.0	<5.0	<5.0
	03/11/02	<2,000	<400	760	<8.0	<8.0	<8.0	<8.0	<8.0
	06/04/02 <sup>4</sup>	--	--	--	--	--	--	--	--
	09/03/02	<10,000	<2,000	1,200	<40	<40	<40	<40	<40
	12/03/02	<5,000	<1,000	870	<20	<20	<20	<20	<20
03/04/03	<10,000	<2,000	2,700	<40	<40	<40	<40	<40	
06/18/03	<10,000	<2,000	1,700	<40	<40	<40	<40	<40	



**Table 3**  
**Field Measurements and Groundwater Analytical Results**  
 Tosco (Unocal) Service Station #5325  
 3220 Lakeshore Avenue  
 Oakland, California

WELL ID	DATE	Ferrous Iron (ppm)	Nitrate as NO3 (ppm)	Phosphate as PO4 (ppm)	ORP (mV)	D.O. Before Purge (mg/L)	D.O. After Purge (mg/L)
U-3	06/30/97	1.4	21	0.86	190 <sup>3</sup>	4.10	--
	09/19/97	0.57	19	ND	75 <sup>3</sup>	4.20	--
	12/12/97	1.9	23	0.85	390 <sup>3</sup>	2.97	--
	03/03/98	0.013	36	ND	358 <sup>2</sup>	2.63	--
	06/15/98	0.16	33	ND	318 <sup>2</sup>	2.93	--
	09/30/98	0.040	31	ND	295 <sup>2</sup>	3.11	--
	12/28/98	ND	29	ND	281 <sup>2</sup>	3.59	--
	03/22/99	0.015	30	0.14	310 <sup>3</sup>	4.02	--
	06/09/99	ND	26	1.2	350 <sup>3</sup>	3.70	--
	09/08/99	ND	32.9	ND <sup>1</sup>	417 <sup>3</sup>	3.96	--
	12/07/99	0.0520	27.9	ND <sup>1</sup>	437 <sup>3</sup>	4.21	--
	03/13/00	0.15	33	ND	<sup>2</sup> 226/ <sup>3</sup> 307 <sup>3</sup>	--	--
	06/21/00	0.20	32	ND <sup>1</sup>	225 <sup>2</sup>	4.27	--
	09/27/00	ND	34	15.7	211 <sup>2</sup>	4.67	--
	12/12/00	ND	31	ND <sup>1</sup>	246 <sup>2</sup>	4.79	--
	03/07/01	ND	36.5	0.443	251 <sup>2</sup>	5.16	--
	06/06/01	ND <sup>4</sup>	8.0	0.18	214 <sup>2</sup>	4.79	--
	09/24/01	<0.10	23 <sup>3</sup>	--	198 <sup>2</sup>	4.27	--
	12/10/01	<0.10	21	0.11	188 <sup>2</sup>	4.66	--
	03/11/02	<0.10	30	0.14	166 <sup>2</sup>	5.06	--
06/04/02	<0.10	18	<0.10	151 <sup>2</sup>	5.79	--	
09/03/02	<0.10 <sup>5</sup>	28	<0.10	143 <sup>2</sup>	6.04	--	
12/03/02	<0.20	20	<1.0	154 <sup>2</sup>	5.58	--	
03/04/03	<0.20	18	<1.0	-136 <sup>2</sup>	0.20	--	
06/18/03	<0.20	17	<1.0	333 <sup>2</sup>	--	3.5	
U-4	06/30/97	0.13	35	0.52	200 <sup>3</sup>	5.40	--
	09/19/97	0.35	30	ND	45 <sup>3</sup>	5.10	--
	12/12/97	0.68	31	0.73	380 <sup>3</sup>	3.11	--
	03/03/98	0.018	3.2	ND	284 <sup>2</sup>	2.94	--
	06/15/98	0.14	33	ND	256 <sup>2</sup>	3.08	--
	09/30/98	0.049	31	ND	276 <sup>2</sup>	4.05	--
	12/28/98	0.36	31	ND	280 <sup>2</sup>	4.57	--
	03/22/99	ND	30	0.14	320 <sup>3</sup>	4.26	--
	06/09/99	ND	35	0.91	340 <sup>3</sup>	3.61	--
	09/08/99	ND	24	ND <sup>1</sup>	391 <sup>3</sup>	3.75	--
	12/07/99	ND	27.7	ND <sup>1</sup>	478 <sup>3</sup>	4.03	--
	03/13/00	ND	33	ND	<sup>2</sup> 219/ <sup>3</sup> 244 <sup>3</sup>	--	--
	06/21/00	0.034	32	ND <sup>1</sup>	248 <sup>2</sup>	4.89	--
	09/27/00	ND	28	ND <sup>1</sup>	198 <sup>2</sup>	5.09	--
	12/12/00	ND	30	ND <sup>1</sup>	210 <sup>2</sup>	4.86	--
	03/07/01	ND	33.9	0.226	233 <sup>2</sup>	4.97	--
06/06/01	ND <sup>4</sup>	7.4	0.21	248 <sup>2</sup>	5.12	--	
09/24/01	<0.10	24 <sup>5</sup>	--	262 <sup>2</sup>	4.86	--	

**Table 3**  
**Field Measurements and Groundwater Analytical Results**  
 Tosco (Unocal) Service Station #5325  
 3220 Lakeshore Avenue  
 Oakland, California

WELL ID	DATE	Ferrous Iron (ppm)	Nitrate as NO3 (ppm)	Phosphate as PO4 (ppm)	ORP (mV)	D.O. Before Purge (mg/L)	D.O. After Purge (mg/L)
U-4	12/10/01	<0.10	19	0.10	242 <sup>2</sup>	5.05	--
(cont)	03/11/02	<0.10	31	0.14	195 <sup>2</sup>	4.83	--
	06/04/02	<0.10	27	<0.10	169 <sup>2</sup>	5.58	--
	09/03/02	<0.10 <sup>5</sup>	28	0.27	126 <sup>2</sup>	5.94	--
	12/03/02	<0.20	20	<1.0	133 <sup>2</sup>	5.82	--
	03/04/03	<0.20	26	<1.0	-148 <sup>2</sup>	0.30	--
	06/18/03	<0.20	31	<1.0	250 <sup>2</sup>	--	3.6
U-5	06/30/97	16	ND	ND	160 <sup>3</sup>	3.40	--
	09/19/97	0.22	ND	ND	63 <sup>3</sup>	0.60	--
	12/12/97	6.7	ND	ND	400 <sup>3</sup>	1.75	--
	03/03/98	18	3.1	ND	345 <sup>2</sup>	2.36	--
	06/15/98	17	ND	ND	333 <sup>2</sup>	2.55	--
	09/30/98	17	ND	ND	318 <sup>2</sup>	1.93	--
	12/28/98	17	6.6	ND	305 <sup>2</sup>	1.64	--
	03/22/99	0.12	ND	2.4	340 <sup>3</sup>	1.99	--
	06/09/99	0.23	ND	ND	320 <sup>3</sup>	2.10	--
	09/08/99	2.10	ND <sup>1</sup>	ND <sup>1</sup>	335 <sup>3</sup>	2.21	--
	12/07/99	0.310	ND <sup>1</sup>	ND <sup>1</sup>	408 <sup>3</sup>	2.66	--
	03/13/00	0.33	0.16	ND	<sup>2</sup> 111/ <sup>3</sup> 264 <sup>3</sup>	--	--
	06/21/00	0.15	ND <sup>1</sup>	ND <sup>1</sup>	159 <sup>2</sup>	3.42	--
	09/27/00	0.33	ND <sup>1</sup>	ND <sup>1</sup>	136 <sup>2</sup>	3.85	--
	12/12/00	0.086	ND <sup>1</sup>	ND <sup>1</sup>	122 <sup>2</sup>	3.53	--
	03/07/01	1.07	3.02	4.00	141 <sup>2</sup>	2.98	--
	06/06/01	ND <sup>4</sup>	ND	1.2	112 <sup>2</sup>	2.67	--
	09/24/01	<0.10	0.77 <sup>5</sup>	--	146 <sup>2</sup>	3.15	--
	12/10/01	3.7	<0.50	2.6	96 <sup>2</sup>	2.85	--
	03/11/02	0.10	<0.50	0.52	108 <sup>2</sup>	3.15	--
	06/04/02	<0.25	<0.50	<0.10	118 <sup>2</sup>	3.46	--
	09/03/02	<0.25	<0.50	<0.10	87 <sup>2</sup>	2.85	--
	12/03/02	22	<1.0	<1.0	104 <sup>2</sup>	2.71	--
	03/04/03	19	<1.0	<1.0	-166 <sup>2</sup>	0.20	--
	06/18/03	11	<1.0	<1.0	-10 <sup>2</sup>	--	2.4
U-6	06/30/97	88	0.80	ND	190 <sup>3</sup>	0.30	--
	09/19/97	2.9	1.80	ND	ND <sup>3</sup>	0.60	--
	12/12/97	51	ND	ND	380 <sup>3</sup>	2.70	--
	03/03/98	60	3.5	ND	327 <sup>2</sup>	2.18	--
	06/15/98	590	4.8	ND	315 <sup>2</sup>	2.48	--
	09/30/98	33	ND	ND	345 <sup>2</sup>	3.06	--
	12/28/98	83	7.2	ND	297 <sup>2</sup>	3.42	--
	03/22/99	2.1	ND	0.98	330 <sup>3</sup>	3.88	--
	06/09/99	0.47	0.20	ND	320 <sup>3</sup>	3.29	--

## STANDARD OPERATING PROCEDURE - GROUNDWATER SAMPLING

Gettler-Ryan Inc. field personnel adhere to the following procedures for the collection and handling of groundwater samples prior to analysis by the analytical laboratory. Prior to sample collection, the type of analysis to be performed is determined. Loss prevention of volatile compounds is controlled and sample preservation for subsequent analysis is maintained.

Prior to sampling, the presence or absence of free-phase hydrocarbons is determined using an interface probe. Product thickness, if present, is measured to the nearest 0.01 foot and is noted in the field notes. In addition, all depth to water level measurements are collected with a static water level indicator and are also recorded in the field notes, prior to purging and sampling any wells.

After water levels are collected and prior to sampling, temperature, pH and electrical conductivity are measured. If purging is to occur, each well is purged a minimum of three well casing volumes of water using pre-cleaned pumps (stack, suction, Grundfos), or disposable bailers. The measurements are taken a minimum of three times during the purging. Purging continues until these parameters stabilize.

Groundwater samples are collected using disposable bailers. The water samples are transferred from the bailer into appropriate containers. Pre-preserved containers, supplied by analytical laboratories, are used when possible. When pre-preserved containers are not available, the laboratory is instructed to preserve the sample as appropriate. Duplicate samples are collected for the laboratory to use in maintaining quality assurance/quality control standards. The samples are labeled to include the job number, sample identification, collection date and time, analysis, preservation (if any), and the sample collector's initials. The water samples are placed in a cooler, maintained at 4°C for transport to the laboratory. Once collected in the field, all samples are maintained under chain of custody until delivered to the laboratory.

The chain of custody document includes the job number, type of preservation, if any, analysis requested, sample identification, date and time collected, and the sample collector's name. The chain of custody is signed and dated (including time of transfer) by each person who receives or surrenders the samples, beginning with the field personnel and ending with the laboratory personnel.

A laboratory supplied trip blank accompanies each sampling set and is labeled as QA. For sampling sets greater than 20 samples, 5% trip blanks are included. The trip blank is analyzed for some or all of the same compounds as the groundwater samples.

As requested by ConocoPhillips Company, the purge water and decontamination water generated during sampling activities is transported to ConocoPhillips - San Francisco Refinery, located in Rodeo, California.



# GETTLER-RYAN INC.

## WELL MONITORING/SAMPLING FIELD DATA SHEET

Client/Facility #: ConocoPhillips#5325 Job Number: 180061  
 Site Address: 3220 Lakeshore Avenue Event Date: 6/18/03 (inclusive)  
 City: Oakland, CA Sampler: Andrew Smith

Well ID: U-1 Date Monitored: 6/18/03 Well Condition: ok  
 Well Diameter: 210/14 in.  
 Total Depth: 19.65 ft.  
 Depth to Water: 7.58 ft.  
 Volume Factor (VF): 

3/4" = 0.02	1" = 0.04	2" = 0.17	3" = 0.38
4" = 0.66	5" = 1.02	6" = 1.50	12" = 5.80

  
 $12.07 \times VF \ 0.38 = 4.6 \times 3 \text{ (case volume)} = \text{Estimated Purge Volume: } 13.8 \text{ gal.}$

**Purge Equipment:**  
 Disposable Bailer \_\_\_\_\_  
 Stainless Steel Bailer \_\_\_\_\_  
 Stack Pump   
 Suction Pump \_\_\_\_\_  
 Grundfos \_\_\_\_\_  
 Other: \_\_\_\_\_

**Sampling Equipment:**  
 Disposable Bailer   
 Pressure Bailer   
 Discrete Bailer \_\_\_\_\_  
 Other: \_\_\_\_\_

Time Started: \_\_\_\_\_ (2400 hrs)  
 Time Bailed: \_\_\_\_\_ (2400 hrs)  
 Depth to Product: \_\_\_\_\_ ft  
 Depth to Water: \_\_\_\_\_ ft  
 Hydrocarbon Thickness: \_\_\_\_\_ ft  
 Visual Confirmation/Description: \_\_\_\_\_  
 Skimmer / Absorbant Sock (circle one)  
 Amt Removed from Skimmer: \_\_\_\_\_ gal  
 Amt Removed from Well: \_\_\_\_\_ gal  
 Product Transferred to: \_\_\_\_\_

Start Time (purge): 1300 Weather Conditions: Sunny  
 Sample Time/Date: 1315 6/18/03 Water Color: Clear Odor: Yes  
 Purging Flow Rate: 5 gpm. Sediment Description: None  
 Did well de-water? No If yes, Time: 0 Volume: 0 gal.

Time (2400 hr.)	Volume (gal.)	pH	Conductivity (umhos/cm)	Temperature (°F)	D.O. (mg/L)	ORP (mV)
1301	5	7.62	1286	20.3		
1302	10	7.34	1285	19.7		
1303	15	7.21	1317	20.7	1.7	-48

### LABORATORY INFORMATION

SAMPLE ID	(#) CONTAINER	REFRIG.	PRESERV. TYPE	LABORATORY	ANALYSES
U-1	3 x vva vial	YES	HCL	STL Pleasanton	TPH-G/BTEX/MTBE(8260)
U-1	1 x 500ml Poly	YES	NP	STL Pleasanton	Nitrate/Phosphate
U-1	1 x 250ml Poly	YES	HNO3	STL Pleasanton	Ferrous Iron

COMMENTS: \_\_\_\_\_

Add/Replaced Lock: \_\_\_\_\_ Add/Replaced Plug: \_\_\_\_\_ Size: \_\_\_\_\_



# GETTLER-RYAN INC.

## WELL MONITORING/SAMPLING FIELD DATA SHEET

Client/Facility #: ConocoPhillips#5325 Job Number: 180061  
 Site Address: 3220 Lakeshore Avenue Event Date: 6/18/03 (inclusive)  
 City: Oakland, CA Sampler: Andrew Smith

Well ID: U-2 Date Monitored: 6/18/03 Well Condition: GK

Well Diameter: 2 3/4 in.

Total Depth: 19.62 ft.

Depth to Water: 6.87 ft.

Volume	3/4"= 0.02	1"= 0.04	2"= 0.17	3"= 0.38
Factor (VF)	4"= 0.66	5"= 1.02	6"= 1.50	12"= 5.80

12.75 x VF 0.38 = 4.8 x3 (case volume) = Estimated Purge Volume: 14.4 gal.

### Purge Equipment:

Disposable Bailer \_\_\_\_\_  
 Stainless Steel Bailer \_\_\_\_\_  
 Stack Pump  \_\_\_\_\_  
 Suction Pump \_\_\_\_\_  
 Grundfos \_\_\_\_\_  
 Other: \_\_\_\_\_

### Sampling Equipment:

Disposable Bailer  \_\_\_\_\_  
 Pressure Bailer  \_\_\_\_\_  
 Discrete Bailer \_\_\_\_\_  
 Other: \_\_\_\_\_

Time Started: \_\_\_\_\_ (2400 hrs)  
 Time Bailed: \_\_\_\_\_ (2400 hrs)  
 Depth to Product: \_\_\_\_\_ ft  
 Depth to Water: \_\_\_\_\_ ft  
 Hydrocarbon Thickness: \_\_\_\_\_ ft  
 Visual Confirmation/Description: \_\_\_\_\_  
 Skimmer / Absorbant Sock (circle one)  
 Amt Removed from Skimmer: \_\_\_\_\_ gal  
 Amt Removed from Well: \_\_\_\_\_ gal  
 Product Transferred to: \_\_\_\_\_

Start Time (purge): 1345 Weather Conditions: Sunny  
 Sample Time/Date: 1400 6/18/03 Water Color: Clear Odor: Yes  
 Purging Flow Rate: 5 gpm. Sediment Description: none  
 Did well de-water? no If yes, Time: 0 Volume: 0 gal.

Time (2400 hr.)	Volume (gal.)	pH	Conductivity (umhos/cm)	Temperature (C/F)	D.O. (mg/L)	ORP (mV)
<u>1346</u>	<u>5</u>	<u>7.81</u>	<u>1880</u>	<u>20.9</u>		
<u>1347</u>	<u>10</u>	<u>7.70</u>	<u>2029</u>	<u>20.5</u>		
<u>1348</u>	<u>15</u>	<u>7.18</u>	<u>2007</u>	<u>21.7</u>	<u>3.2</u>	<u>-8</u>

### LABORATORY INFORMATION

SAMPLE ID	(#) CONTAINER	REFRIG.	PRESERV. TYPE	LABORATORY	ANALYSES
<u>U-2</u>	<u>3</u> x vov vial	<u>YES</u>	<u>HCL</u>	<u>STL Pleasanton</u>	<u>TPH-G/BTEX/MTBE(8260)</u>
<u>U-2</u>	<u>1</u> x 500ml Poly	<u>YES</u>	<u>NP</u>	<u>STL Pleasanton</u>	<u>Nitrate/Phosphate</u>
<u>U-2</u>	<u>1</u> x 250ml Poly	<u>YES</u>	<u>HNO3</u>	<u>STL Pleasanton</u>	<u>Ferrous Iron</u>

### COMMENTS:

Add/Replaced Lock: \_\_\_\_\_

Add/Replaced Plug: \_\_\_\_\_ Size: \_\_\_\_\_



# GETTLER - RYAN INC.

## WELL MONITORING/SAMPLING FIELD DATA SHEET

Client/Facility #: ConocoPhillips#5325 Job Number: 180061  
 Site Address: 3220 Lakeshore Avenue Event Date: 6/18/03 (inclusive)  
 City: Oakland, CA Sampler: Andrew Smith

Well ID: U-3 Date Monitored: 6/18/03 Well Condition: OK  
 Well Diameter: 2(3)14 in.  
 Total Depth: 19.33 ft.  
 Depth to Water: 10.26 ft.  
 Volume Factor (VF):  $3/4" = 0.02$   $1" = 0.04$   $2" = 0.17$   $3" = 0.38$   
 $4" = 0.66$   $5" = 1.02$   $6" = 1.50$   $12" = 5.80$   
 $9.07 \times VF 0.38 = 3.4 \times 3 \text{ (case volume)} = \text{Estimated Purge Volume: } 10.2 \text{ gal.}$

Purge Equipment:  
 Disposable Bailer \_\_\_\_\_  
 Stainless Steel Bailer \_\_\_\_\_  
 Stack Pump  \_\_\_\_\_  
 Suction Pump \_\_\_\_\_  
 Grundfos \_\_\_\_\_  
 Other: \_\_\_\_\_

Sampling Equipment:  
 Disposable Bailer  \_\_\_\_\_  
 Pressure Bailer  \_\_\_\_\_  
 Discrete Bailer \_\_\_\_\_  
 Other: \_\_\_\_\_

Time Started: \_\_\_\_\_ (2400 hrs)  
 Time Bailed: \_\_\_\_\_ (2400 hrs)  
 Depth to Product: \_\_\_\_\_ ft  
 Depth to Water: \_\_\_\_\_ ft  
 Hydrocarbon Thickness: \_\_\_\_\_ ft  
 Visual Confirmation/Description: \_\_\_\_\_  
 Skimmer / Absorbant Sock (circle one)  
 Amt Removed from Skimmer: \_\_\_\_\_ gal  
 Amt Removed from Well: \_\_\_\_\_ gal  
 Product Transferred to: \_\_\_\_\_

Start Time (purge): 1105 Weather Conditions: Sunny Breeze  
 Sample Time/Date: 1115 16/18/03 Water Color: Clear Odor: None  
 Purging Flow Rate: 2 gpm. Sediment Description: None  
 Did well de-water? NO If yes, Time: 0 Volume: 0 gal.

Time (2400 hr.)	Volume (gal.)	pH	Conductivity (umhos/cm)	Temperature (C/F)	D.O. (mg/L)	ORP (mV)
<u>1107</u>	<u>4</u>	<u>8.04</u>	<u>653</u>	<u>23.4</u>		
<u>1109</u>	<u>8</u>	<u>7.80</u>	<u>597</u>	<u>20.0</u>		
<u>1111</u>	<u>12</u>	<u>7.63</u>	<u>602</u>	<u>19.5</u>	<u>3.5</u>	<u>333</u>

### LABORATORY INFORMATION

SAMPLE ID	(#) CONTAINER	REFRIG.	PRESERV. TYPE	LABORATORY	ANALYSES
<u>U-3</u>	<u>3</u> x voa vial	YES	HCL	STL Pleasanton	TPH-G/BTEX/MTBE(8260)
<u>U-3</u>	<u>1</u> x 500ml Poly	YES	NP	STL Pleasanton	Nitrate/Phosphate
<u>U-3</u>	<u>1</u> x 250ml Poly	YES	HNO3	STL Pleasanton	Ferrous Iron

COMMENTS: \_\_\_\_\_

Add/Replaced Lock: \_\_\_\_\_ Add/Replaced Plug: \_\_\_\_\_ Size: \_\_\_\_\_



# GETTLER - RYAN INC.

## WELL MONITORING/SAMPLING FIELD DATA SHEET

Client/Facility #: ConocoPhillips#5325 Job Number: 180061  
 Site Address: 3220 Lakeshore Avenue Event Date: 6/18/03 (inclusive)  
 City: Oakland, CA Sampler: Andrew Smith

Well ID: U-6 Date Monitored: 6/18/03 Well Condition: \_\_\_\_\_  
 Well Diameter: 2 3/4 in.  
 Total Depth: 23.74 ft.  
 Depth to Water: 6.60 ft.  
 Volume Factor (VF): 17.14 x VF 0.17 = 2.9 x3 (case volume) = Estimated Purge Volume: 8.7 gal.

Volume	3/4"= 0.02	1"= 0.04	2"= 0.17	3"= 0.38
Factor (VF)	4"= 0.66	5"= 1.02	6"= 1.50	12"= 5.80

Purge Equipment:  
 Disposable Bailer \_\_\_\_\_  
 Stainless Steel Bailer \_\_\_\_\_  
 Stack Pump ✓  
 Suction Pump \_\_\_\_\_  
 Grundfos \_\_\_\_\_  
 Other: \_\_\_\_\_

Sampling Equipment:  
 Disposable Bailer \_\_\_\_\_  
 Pressure Bailer ✓  
 Discrete Bailer \_\_\_\_\_  
 Other: \_\_\_\_\_

Time Started: \_\_\_\_\_ (2400 hrs)  
 Time Bailed: \_\_\_\_\_ (2400 hrs)  
 Depth to Product: \_\_\_\_\_ ft  
 Depth to Water: \_\_\_\_\_ ft  
 Hydrocarbon Thickness: \_\_\_\_\_ ft  
 Visual Confirmation/Description: \_\_\_\_\_  
 Skimmer / Absorbant Sock (circle one)  
 Amt Removed from Skimmer: \_\_\_\_\_ gal  
 Amt Removed from Well: \_\_\_\_\_ gal  
 Product Transferred to: \_\_\_\_\_

Start Time (purge): 1230 Weather Conditions: Sunny  
 Sample Time/Date: 1240 6/18/03 Water Color: Clear/Cloudy Odor: Gas  
 Purging Flow Rate: 2 gpm. Sediment Description: Silty Sand  
 Did well de-water? no If yes, Time: 0 Volume: 0 gal.

Time (2400 hr.)	Volume (gal.)	pH	Conductivity (umhos/cm)	Temperature (C/F)	D.O. (mg/L)	ORP (mV)
<u>1231</u>	<u>2</u>	<u>8.01</u>	<u>1775</u>	<u>19.4</u>		
<u>1232</u>	<u>4</u>	<u>7.62</u>	<u>1665</u>	<u>18.4</u>		
<u>1236</u>	<u>8</u>	<u>7.40</u>	<u>1620</u>	<u>19.6</u>	<u>3.2</u>	<u>-15</u>
_____	_____	_____	_____	_____	_____	_____
_____	_____	_____	_____	_____	_____	_____

### LABORATORY INFORMATION

SAMPLE ID	(#) CONTAINER	REFRIG.	PRESERV. TYPE	LABORATORY	ANALYSES
<u>U-6</u>	<u>3</u> x vov vial	<u>YES</u>	<u>HCL</u>	<u>STL Pleasanton</u>	<u>TPH-G/BTEX/MTBE(8260)</u>
<u>U-6</u>	<u>1</u> x 500ml Poly	<u>YES</u>	<u>NP</u>	<u>STL Pleasanton</u>	<u>Nitrate/Phosphate</u>
<u>U-6</u>	<u>1</u> x 250ml Poly	<u>YES</u>	<u>HNO3</u>	<u>STL Pleasanton</u>	<u>Ferrous Iron</u>
_____	_____	_____	_____	_____	_____
_____	_____	_____	_____	_____	_____

COMMENTS: \_\_\_\_\_

Add/Replaced Lock: \_\_\_\_\_ Add/Replaced Plug: \_\_\_\_\_ Size: \_\_\_\_\_

75310

Tosco Corp./  
Phillips 66 Co.  
2000 Crow Canyon Place  
Suite 400  
San Ramon, CA 94583

Facility Number #5325  
Facility Address 3220 Lakeshore Avenue, Oakland, CA  
Global ID T0600101463 Project 180061.80  
Client Contact David DeWitt  
Phone 916-558-7666

Laboratory Name STL PLEASANTON  
Consultant GETTLER-RYAN INC. DEANNA L. BARDING  
Address 6747 SIERRA CT., SUITE J, DUBLIN, CA 94568  
Phone 925-551-7555 Fax 925-551-7899  
Samples Collected by Andrew Smith

SAMPLE ID	Number of Containers Liters	S = Soil A = Air W = Water C = Charcoal	Sample Preservation	Date/Time (2400 Hrs)	TPH-GAS/BTEX/MTBE EPA 8015/8021B	TPH-DIESEL EPA 8015	TPH-DIESEL w/SURCS EPA 8015	TPH-GAS EPA 8015	TPH-GAS/BTEX/MTBE EPA 8260	OXYGENATES EPA 8260	METHANOL EPA 8015	TOTAL OIL & GREASE EPA 8520	METALS Cd, Cr, Pb, Zn, Ni	NITRATE/SULFATE/ALKALINITY EPA 300 SERIES	MOC'S (8010) EPA 8021B	MOC'S (8240) EPA 8260	MOC'S EPA 8270	Nitrate/Phosphate	Phosphate	FERROUS IRON	Remarks
U-1	5	W	RCL HCS	6/18/03/1315					X									X	X	X	Run 8 Oxy's by 8260 on all 8260 MTBE hits.  Ferrous Iron has been filtered and preserved.  SHORT HOLD ANALYSIS SAMPLES
U-2	5			/1410					X									X	X	X	
U-3	5			/1115					X									X	X	X	
U-4	5			/1150					X									X	X	X	
U-5	5			/1220					X									X	X	X	
U-6	5	W	W	/1240					X									X	X	X	
OA	2	W	HCL	6/18/03/					X												

- OXYGENATES 8260**
- 1 - MTBE
  - 2 - TBA
  - 3 - TAME
  - 4 - DIPE
  - 5 - ETBE
  - 6 - 1,2-DCA
  - 7 - EOB
  - 8 - ETHANOL

Relinquished By (Signature) <i>[Signature]</i>	Organization <b>GRI</b>	Date/Time 6/18/03 1530	Received By (Signature) <i>[Signature]</i>	Organization <b>G-R</b>	Date/Time 6/18/03 1530	iced Y/N
Relinquished By (Signature) <i>[Signature]</i>	Organization <b>G-R</b>	Date/Time 6/18/03 0950	Received By (Signature) <i>[Signature]</i>	Organization <b>STL-SF</b>	Date/Time 6/18/03	iced Y/N
Relinquished By (Signature) <i>[Signature]</i>	Organization <b>STL-SF</b>	Date/Time 6/19/03	Received For Laboratory By (Signature) <i>[Signature]</i>	Organization <b>STL-SF</b>	Date/Time 6/19/03 1658	iced Y/N

Turn Around Time (Circle Choice)

- 24 Hrs.
- 48 Hrs.
- 72 Hrs.
- 5 Days
- 10 Days
- As Contracted

2.0



**Gettler Ryan**

July 13, 2003

6747 Sierra Court Suite J  
Dublin, CA 94568

Attn.: Deanna Harding

Project#: 180061.80

Project: Conoco #5325

Site: 3220 Lakeshore Avenue, Oakland

RECEIVED

GETTLER RYAN, INC.  
3220 LAKESHORE AVENUE  
OAKLAND, CA 94612

Dear Ms. Harding,

Attached is our report for your samples received on 06/19/2003 16:58

This report has been reviewed and approved for release. Reproduction of this report is permitted only in its entirety.

Please note that any unused portion of the samples will be discarded after 08/03/2003 unless you have requested otherwise.

We appreciate the opportunity to be of service to you. If you have any questions, please call me at (925) 484-1919.

You can also contact me via email. My email address is: [tgranicher@stl-inc.com](mailto:tgranicher@stl-inc.com)

Sincerely,

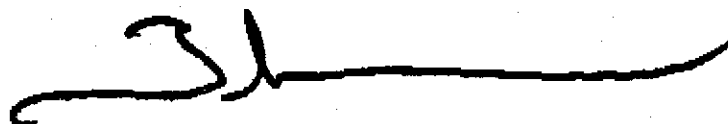

Tod Granicher  
Project Manager

**Gas/BTEX Fuel Oxygenates by 8260B**

Gettler Ryan

Attn.: Deanna Harding

6747 Sierra Court Suite J

Dublin, CA 94568

Phone: (925) 551-7444 Fax: (925) 551-7899

Project: 180061.80

Conoco #5325

Received: 06/19/2003 16:58

Site: 3220 Lakeshore Avenue, Oakland

**Samples Reported**

Sample Name	Date Sampled	Matrix	Lab #
U-1	06/18/2003 13:15	Water	1
U-2	06/18/2003 14:10	Water	2
U-3	06/18/2003 11:15	Water	3
U-4	06/18/2003 11:50	Water	4
U-5	06/18/2003 12:20	Water	5
U-6	06/18/2003 12:40	Water	6
QA	06/18/2003	Water	7

Severn Trent Laboratories, Inc.

STL San Francisco \* 1220 Quarry Lane, Pleasanton, CA 94566

Tel 925 484 1919 Fax 925 484 1096 \* www.stl-inc.com \* CA DHS ELAP# 2496

06/30/2003 16:59

Page 1 of 14

**Gas/BTEX Fuel Oxygenates by 8260B**

Gettler Ryan

Attn.: Deanna Harding

6747 Sierra Court Suite J

Dublin, CA 94568

Phone: (925) 551-7444 Fax: (925) 551-7899

Project: 180061.80

Conoco #5325

Received: 06/19/2003 16:58

Site: 3220 Lakeshore Avenue, Oakland

Prep(s): 5030B	Test(s): 8260FAB
Sample ID: U-3	Lab ID: 2003-06-0630 - 3
Sampled: 06/18/2003 11:15	Extracted: 6/30/2003 15:47
Matrix: Water	QC Batch#: 2003/06/30-01.62

Compound	Conc.	RL	Unit	Dilution	Analyzed	Flag
Gasoline	ND	50	ug/L	1.00	06/30/2003 15:47	
Benzene	ND	0.50	ug/L	1.00	06/30/2003 15:47	
Toluene	ND	0.50	ug/L	1.00	06/30/2003 15:47	
Ethylbenzene	ND	0.50	ug/L	1.00	06/30/2003 15:47	
Total xylenes	ND	1.0	ug/L	1.00	06/30/2003 15:47	
Methyl tert-butyl ether (MTBE)	ND	2.0	ug/L	1.00	06/30/2003 15:47	
<b>Surrogates(s)</b>						
1,2-Dichloroethane-d4	98.1	76-114	%	1.00	06/30/2003 15:47	
Toluene-d8	98.7	88-110	%	1.00	06/30/2003 15:47	

**Gas/BTEX Fuel Oxygenates by 8260B**

Gettler Ryan  
Attn.: Deanna Harding

6747 Sierra Court Suite J  
Dublin, CA 94568  
Phone: (925) 551-7444 Fax: (925) 551-7899

Project: 180061.80  
Conoco #5325

Received: 06/19/2003 16:58

Site: 3220 Lakeshore Avenue, Oakland

Prep(s): 5030B	Test(s): 8260FAB
Sample ID: U-4	Lab ID: 2003-06-0630 - 4
Sampled: 06/18/2003 11:50	Extracted: 6/29/2003 17:48
Matrix: Water	QC Batch#: 2003/06/29-01.62

Compound	Conc.	RL	Unit	Dilution	Analyzed	Flag
Gasoline	ND	50	ug/L	1.00	06/29/2003 17:48	
Benzene	ND	0.50	ug/L	1.00	06/29/2003 17:48	
Toluene	ND	0.50	ug/L	1.00	06/29/2003 17:48	
Ethylbenzene	ND	0.50	ug/L	1.00	06/29/2003 17:48	
Total xylenes	ND	1.0	ug/L	1.00	06/29/2003 17:48	
Methyl tert-butyl ether (MTBE)	ND	2.0	ug/L	1.00	06/29/2003 17:48	
<b>Surrogates(s)</b>						
1,2-Dichloroethane-d4	87.9	76-114	%	1.00	06/29/2003 17:48	
Toluene-d8	94.2	88-110	%	1.00	06/29/2003 17:48	

**Gas/BTEX Fuel Oxygenates by 8260B**

Gettler Ryan

Attn.: Deanna Harding

6747 Sierra Court Suite J

Dublin, CA 94568

Phone: (925) 551-7444 Fax: (925) 551-7899

Project: 180061.80

Conoco #5325

Received: 06/19/2003 16:58

Site: 3220 Lakeshore Avenue, Oakland

Prep(s):	5030B	Test(s):	8260FAB
Sample ID:	U-5	Lab ID:	2003-06-0630 - 5
Sampled:	06/18/2003 12:20	Extracted:	6/29/2003 18:10
Matrix:	Water	QC Batch#:	2003/06/29-01.62

Compound	Conc.	RL	Unit	Dilution	Analyzed	Flag
Gasoline	51	50	ug/L	1.00	06/29/2003 18:10	g
Benzene	ND	0.50	ug/L	1.00	06/29/2003 18:10	
Toluene	ND	0.50	ug/L	1.00	06/29/2003 18:10	
Ethylbenzene	ND	0.50	ug/L	1.00	06/29/2003 18:10	
Total xylenes	ND	1.0	ug/L	1.00	06/29/2003 18:10	
tert-Butyl alcohol (TBA)	ND	100	ug/L	1.00	06/29/2003 18:10	
Methyl tert-butyl ether (MTBE)	36	2.0	ug/L	1.00	06/29/2003 18:10	
Di-isopropyl Ether (DIPE)	ND	2.0	ug/L	1.00	06/29/2003 18:10	
Ethyl tert-butyl ether (ETBE)	ND	2.0	ug/L	1.00	06/29/2003 18:10	
tert-Amyl methyl ether (TAME)	ND	2.0	ug/L	1.00	06/29/2003 18:10	
1,2-DCA	ND	2.0	ug/L	1.00	06/29/2003 18:10	
EDB	ND	2.0	ug/L	1.00	06/29/2003 18:10	
Ethanol	ND	500	ug/L	1.00	06/29/2003 18:10	
<b>Surrogates(s)</b>						
1,2-Dichloroethane-d4	88.3	76-114	%	1.00	06/29/2003 18:10	
Toluene-d8	95.7	88-110	%	1.00	06/29/2003 18:10	

**Gas/BTEX Fuel Oxygenates by 8260B**

Gettler Ryan

Attn.: Deanna Harding

6747 Sierra Court Suite J  
Dublin, CA 94568  
Phone: (925) 551-7444 Fax: (925) 551-7899

Project: 180061.80  
Conoco #5325

Received: 06/19/2003 16:58

Site: 3220 Lakeshore Avenue, Oakland

Prep(s): 5030B	Test(s): 8260FAB
Sample ID: U-6	Lab ID: 2003-06-0630 - 6
Sampled: 06/18/2003 12:40	Extracted: 6/30/2003 16:10
Matrix: Water	QC Batch#: 2003/06/30-01.62

Compound	Conc.	RL	Unit	Dilution	Analyzed	Flag
Gasoline	1300	1000	ug/L	20.00	06/30/2003 16:10	9
Benzene	ND	10	ug/L	20.00	06/30/2003 16:10	
Toluene	ND	10	ug/L	20.00	06/30/2003 16:10	
Ethylbenzene	ND	10	ug/L	20.00	06/30/2003 16:10	
Total xylenes	ND	20	ug/L	20.00	06/30/2003 16:10	
tert-Butyl alcohol (TBA)	ND	2000	ug/L	20.00	06/30/2003 16:10	
Methyl tert-butyl ether (MTBE)	1700	40	ug/L	20.00	06/30/2003 16:10	
Di-isopropyl Ether (DIPE)	ND	40	ug/L	20.00	06/30/2003 16:10	
Ethyl tert-butyl ether (ETBE)	ND	40	ug/L	20.00	06/30/2003 16:10	
tert-Amyl methyl ether (TAME)	ND	40	ug/L	20.00	06/30/2003 16:10	
1,2-DCA	ND	40	ug/L	20.00	06/30/2003 16:10	
EDB	ND	40	ug/L	20.00	06/30/2003 16:10	
Ethanol	ND	10000	ug/L	20.00	06/30/2003 16:10	
<b>Surrogates(s)</b>						
1,2-Dichloroethane-d4	106.3	76-114	%	20.00	06/30/2003 16:10	
Toluene-d8	97.1	88-110	%	20.00	06/30/2003 16:10	

**Gas/BTEX Fuel Oxygenates by 8260B**

Gettler Ryan

Attn.: Deanna Harding

6747 Sierra Court Suite J

Dublin, CA 94568

Phone: (925) 551-7444 Fax: (925) 551-7899

Project: 180061.80

Conoco #5325

Received: 06/19/2003 16:58

Site: 3220 Lakeshore Avenue, Oakland

Prep(s):	5030B	Test(s):	8260FAB
Sample ID:	QA	Lab ID:	2003-06-0630 - 7
Sampled:	06/18/2003	Extracted:	6/30/2003 16:32
Matrix:	Water	QC Batch#:	2003/06/30-01.62

Compound	Conc.	RL	Unit	Dilution	Analyzed	Flag
Gasoline	ND	50	ug/L	1.00	06/30/2003 16:32	
Benzene	ND	0.50	ug/L	1.00	06/30/2003 16:32	
Toluene	ND	0.50	ug/L	1.00	06/30/2003 16:32	
Ethylbenzene	ND	0.50	ug/L	1.00	06/30/2003 16:32	
Total xylenes	ND	1.0	ug/L	1.00	06/30/2003 16:32	
Methyl tert-butyl ether (MTBE)	ND	2.0	ug/L	1.00	06/30/2003 16:32	
<b>Surrogates(s)</b>						
1,2-Dichloroethane-d4	103.6	76-114	%	1.00	06/30/2003 16:32	
Toluene-d8	96.1	88-110	%	1.00	06/30/2003 16:32	

**Gas/BTEX Fuel Oxygenates by 8260B**

Gettler Ryan

Attn.: Deanna Harding

6747 Sierra Court Suite J

Dublin, CA 94568

Phone: (925) 551-7444 Fax: (925) 551-7899

Project: 180061.80

Conoco #5325

Received: 06/19/2003 16:58

Site: 3220 Lakeshore Avenue, Oakland

**Batch QC Report**

Prep(s): 5030B

Method Blank

MB: 2003/06/29-01.62-002

Water

Test(s): 8260FAB

QC Batch # 2003/06/29-01.62

Date Extracted: 06/29/2003 11:02

Compound	Conc.	RL	Unit	Analyzed	Flag
Gasoline	ND	50	ug/L	06/29/2003 11:02	
Gasoline	ND	50	ug/L	06/29/2003 11:02	
Benzene	ND	0.5	ug/L	06/29/2003 11:02	
Toluene	ND	0.5	ug/L	06/29/2003 11:02	
Ethylbenzene	ND	0.5	ug/L	06/29/2003 11:02	
Total xylenes	ND	1.0	ug/L	06/29/2003 11:02	
tert-Butyl alcohol (TBA)	ND	100	ug/L	06/29/2003 11:02	
Methyl tert-butyl ether (MTBE)	ND	2.0	ug/L	06/29/2003 11:02	
Di-isopropyl Ether (DIPE)	ND	2.0	ug/L	06/29/2003 11:02	
Ethyl tert-butyl ether (ETBE)	ND	2.0	ug/L	06/29/2003 11:02	
tert-Amyl methyl ether (TAME)	ND	2.0	ug/L	06/29/2003 11:02	
1,2-DCA	ND	2.0	ug/L	06/29/2003 11:02	
EDB	ND	2.0	ug/L	06/29/2003 11:02	
Ethanol	ND	500	ug/L	06/29/2003 11:02	
<b>Surrogates(s)</b>					
1,2-Dichloroethane-d4	92.5	76-114	%	06/29/2003 11:02	
Toluene-d8	93.5	88-110	%	06/29/2003 11:02	



**Gas/BTEX Fuel Oxygenates by 8260B**

Gettler Ryan

Attn.: Deanna Harding

6747 Sierra Court Suite J

Dublin, CA 94568

Phone: (925) 551-7444 Fax: (925) 551-7899

Project: 180061.80

Conoco #5325

Received: 06/19/2003 16:58

Site: 3220 Lakeshore Avenue, Oakland

**Batch QC Report**

Prep(s): 5030B

Method Blank

MB: 2003/06/30-01.62-018

Water

Test(s): 8260FAB

QC Batch # 2003/06/30-01.62

Date Extracted: 06/30/2003 14:18

Compound	Conc.	RL	Unit	Analyzed	Flag
Gasoline	ND	50	ug/L	06/30/2003 14:18	
Benzene	ND	0.5	ug/L	06/30/2003 14:18	
Toluene	ND	0.5	ug/L	06/30/2003 14:18	
Ethylbenzene	ND	0.5	ug/L	06/30/2003 14:18	
Total xylenes	ND	1.0	ug/L	06/30/2003 14:18	
tert-Butyl alcohol (TBA)	ND	100	ug/L	06/30/2003 14:18	
Methyl tert-butyl ether (MTBE)	ND	2.0	ug/L	06/30/2003 14:18	
Di-isopropyl Ether (DIPE)	ND	2.0	ug/L	06/30/2003 14:18	
Ethyl tert-butyl ether (ETBE)	ND	2.0	ug/L	06/30/2003 14:18	
tert-Amyl methyl ether (TAME)	ND	2.0	ug/L	06/30/2003 14:18	
1,2-DCA	ND	2.0	ug/L	06/30/2003 14:18	
EDB	ND	2.0	ug/L	06/30/2003 14:18	
Ethanol	ND	500	ug/L	06/30/2003 14:18	
<b>Surrogates(s)</b>					
1,2-Dichloroethane-d4	95.7	76-114	%	06/30/2003 14:18	
Toluene-d8	93.6	88-110	%	06/30/2003 14:18	

**Gas/BTEX Fuel Oxygenates by 8260B**

Gettler Ryan

Attn.: Deanna Harding

6747 Sierra Court Suite J

Dublin, CA 94568

Phone: (925) 551-7444 Fax: (925) 551-7899

Project: 180061.80

Conoco #5325

Received: 06/19/2003 16:58

Site: 3220 Lakeshore Avenue, Oakland

**Batch QC Report**

Prep(s): 5030B

Test(s): 8260FAB

**Laboratory Control Spike**

**Water**

**QC Batch # 2003/06/29-01.62**

LCS 2003/06/29-01.62-017

Extracted: 06/29/2003

Analyzed: 06/29/2003 10:17

LCSD 2003/06/29-01.62-040

Extracted: 06/29/2003

Analyzed: 06/29/2003 10:40

Compound	Conc. ug/L		Exp. Conc.	Recovery %		RPD	Ctrl. Limits %		Flags	
	LCS	LCSD		LCS	LCSD		%	Rec.	RPD	LCS
Benzene	27.0	26.8	25.0	108.0	107.2	0.7	69-129	20		
Toluene	25.9	25.7	25.0	103.6	102.8	0.8	70-130	20		
Methyl tert-butyl ether (MTBE)	29.8	27.2	25.0	119.2	108.8	9.1	65-165	20		
<b>Surrogates(s)</b>										
1,2-Dichloroethane-d4	466	445	500	93.2	89.0		76-114			
Toluene-d8	489	490	500	97.8	98.0		88-110			

**Gas/BTEX Fuel Oxygenates by 8260B**

Gettler Ryan

Attn.: Deanna Harding

6747 Sierra Court Suite J

Dublin, CA 94568

Phone: (925) 551-7444 Fax: (925) 551-7899

Project: 180061.80

Conoco #5325

Received: 06/19/2003 16:58

Site: 3220 Lakeshore Avenue, Oakland

**Batch QC Report**

Prep(s): 5030B

Test(s): 8260FAB

**Laboratory Control Spike**

**Water**

**QC Batch # 2003/06/30-01.62**

LCS 2003/06/30-01.62-033

Extracted: 06/30/2003

Analyzed: 06/30/2003 13:33

LCSD 2003/06/30-01.62-056

Extracted: 06/30/2003

Analyzed: 06/30/2003 13:56

Compound	Conc. ug/L		Exp. Conc.	Recovery %		RPD %	Ctrl.Limits %		Flags	
	LCS	LCSD		LCS	LCSD		Rec.	RPD	LCS	LCSD
Benzene	25.2	26.4	25.0	100.8	105.6	4.7	69-129	20		
Toluene	24.4	25.5	25.0	97.6	102.0	4.4	70-130	20		
Methyl tert-butyl ether (MTBE)	28.2	28.5	25.0	112.8	114.0	1.1	65-165	20		
<b>Surrogates(s)</b>										
1,2-Dichloroethane-d4	467	479	500	93.4	95.8		76-114			
Toluene-d8	476	495	500	95.2	99.0		88-110			

**Gas/BTEX Fuel Oxygenates by 8260B**

Gettler Ryan

Attn.: Deanna Harding

6747 Sierra Court Suite J

Dublin, CA 94568

Phone: (925) 551-7444 Fax: (925) 551-7899

Project: 180061.80

Conoco #5325

Received: 06/19/2003 16:58

Site: 3220 Lakeshore Avenue, Oakland

**Batch QC Report**

Prep(s): 5030B

Test(s): 8260FAB

**Matrix Spike ( MS / MSD )**

**Water**

**QC Batch # 2003/06/29-01.62**

U-3 >> MS

Lab ID: 2003-06-0630 - 003

MS: 2003/06/29-01.62-041

Extracted: 06/29/2003

Analyzed: 06/29/2003 19:18

Dilution: 1.00

MSD:

Analyzed:

Dilution:

Compound	Conc. ug/L			Spk.Level ug/L	Recovery %			Limits %		Flags	
	MS	MSD	Sample		MS	MSD	RPD	Rec.	RPD	MS	MSD
Benzene	26.7		ND	25.0	106.8			69-129	20		
Toluene	25.8		ND	25.0	103.2			70-130	20		
Methyl tert-butyl ether	27.2		ND	25.0	108.8			65-165	20		
<b>Surrogate(s)</b>											
1,2-Dichloroethane-d4	425			500	85.0			76-114	0		
Toluene-d8	491			500	98.2			88-110	0		

**Gas/BTEX Fuel Oxygenates by 8260B**

Gettler Ryan

Attn.: Deanna Harding

6747 Sierra Court Suite J

Dublin, CA 94568

Phone: (925) 551-7444 Fax: (925) 551-7899

Project: 180061.80

Conoco #5325

Received: 06/19/2003 16:58

Site: 3220 Lakeshore Avenue, Oakland

---

**Legend and Notes**

---

**Result Flag**

9

Hydrocarbon reported in the gasoline range does not match our gasoline standard.

**Dissolved Metals**

Gettler Ryan

Attn.: Deanna Harding

6747 Sierra Court Suite J

Dublin, CA 94568

Phone: (925) 551-7444 Fax: (925) 551-7899

Project: 180061.80

Conoco #5325

Received: 06/19/2003 16:58

Site: 3220 Lakeshore Avenue, Oakland

**Samples Reported**

Sample Name	Date Sampled	Matrix	Lab #
U-1	06/18/2003 13:15	Water	1
U-2	06/18/2003 14:10	Water	2
U-3	06/18/2003 11:15	Water	3
U-4	06/18/2003 11:50	Water	4
U-5	06/18/2003 12:20	Water	5
U-6	06/18/2003 12:40	Water	6

**Dissolved Metals**

Gettler Ryan

Attn.: Deanna Harding

6747 Sierra Court Suite J  
Dublin, CA 94568

Phone: (925) 551-7444 Fax: (925) 551-7899

Project: 180061.80  
Conoco #5325

Received: 06/19/2003 16:58

Site: 3220 Lakeshore Avenue, Oakland

Prep(s):	3005A	Test(s):	6010B
Sample ID:	U-3	Lab ID:	2003-06-0630 - 3
Sampled:	06/18/2003 11:15	Extracted:	6/30/2003 08:01
Matrix:	Water	QC Batch#:	2003/06/30-03.15

Compound	Conc.	RL	Unit	Dilution	Analyzed	Flag
Iron	ND	0.20	mg/L	1.00	07/01/2003 21:44	

**Dissolved Metals**

Gettler Ryan

Attn.: Deanna Harding

6747 Sierra Court Suite J

Dublin, CA 94568

Phone: (925) 551-7444 Fax: (925) 551-7899

Project: 180061.80

Conoco #5325

Received: 06/19/2003 16:58

Site: 3220 Lakeshore Avenue, Oakland

Prep(s): 3005A	Test(s): 6010B
Sample ID: U-4	Lab ID: 2003-06-0630 - 4
Sampled: 06/18/2003 11:50	Extracted: 6/30/2003 08:01
Matrix: Water	QC Batch#: 2003/06/30-03.15

Compound	Conc.	RL	Unit	Dilution	Analyzed	Flag
Iron	ND	0.20	mg/L	1.00	07/01/2003 21:48	



**Dissolved Metals**

Gettler Ryan

Attn.: Deanna Harding

6747 Sierra Court Suite J

Dublin, CA 94568

Phone: (925) 551-7444 Fax: (925) 551-7899

Project: 180061.80

Conoco #5325

Received: 06/19/2003 16:58

Site: 3220 Lakeshore Avenue, Oakland

Prep(s): 3005A	Test(s): 6010B
Sample ID: U-5	Lab ID: 2003-06-0630 - 5
Sampled: 06/18/2003 12:20	Extracted: 6/30/2003 08:01
Matrix: Water	QC Batch#: 2003/06/30-03.15

Compound	Conc.	RL	Unit	Dilution	Analyzed	Flag
Iron	11	0.20	mg/L	1.00	07/01/2003 21:53	

**Dissolved Metals**

Gettler Ryan  
Attn.: Deanna Harding

6747 Sierra Court Suite J  
Dublin, CA 94568  
Phone: (925) 551-7444 Fax: (925) 551-7899

Project: 180061.80  
Conoco #5325

Received: 06/19/2003 16:58

Site: 3220 Lakeshore Avenue, Oakland

Prep(s): 3005A	Test(s): 6010B
Sample ID: U-6	Lab ID: 2003-06-0630 - 6
Sampled: 06/18/2003 12:40	Extracted: 6/30/2003 08:01
Matrix: Water	QC Batch#: 2003/06/30-03.15

Compound	Conc.	RL	Unit	Dilution	Analyzed	Flag
Iron	3.2	0.20	mg/L	1.00	07/01/2003 21:57	

**Dissolved Metals**

Gettler Ryan

Attn.: Deanna Harding

6747 Sierra Court Suite J

Dublin, CA 94568

Phone: (925) 551-7444 Fax: (925) 551-7899

Project: 180061.80

Conoco #5325

Received: 06/19/2003 16:58

Site: 3220 Lakeshore Avenue, Oakland

**Batch QC Report**

Prep(s): 3005A

Method Blank

MB: 2003/06/30-03.15-210

Water

Test(s): 6010B

QC Batch # 2003/06/30-03.15

Date Extracted: 06/30/2003 08:01

Compound	Conc.	RL	Unit	Analyzed	Flag
Iron	ND	0.20	mg/L	07/01/2003 20:54	

**Dissolved Metals**

Gettler Ryan

Attn.: Deanna Harding

6747 Sierra Court Suite J

Dublin, CA 94568

Phone: (925) 551-7444 Fax: (925) 551-7899

Project: 180061.80

Conoco #5325

Received: 06/19/2003 16:58

Site: 3220 Lakeshore Avenue, Oakland

**Batch QC Report**

Prep(s): 3005A

Test(s): 6010B

**Laboratory Control Spike**

**Water**

**QC Batch # 2003/06/30-03.15**

LCS 2003/06/30-03.15-211

Extracted: 06/30/2003

Analyzed: 07/01/2003 20:58

LCSD 2003/06/30-03.15-212

Extracted: 06/30/2003

Analyzed: 07/01/2003 21:02

Compound	Conc. mg/L		Exp.Conc.	Recovery %		RPD	Ctrl.Limits %		Flags	
	LCS	LCSD		LCS	LCSD		%	Rec.	RPD	LCS
Iron	4.71	4.72	5.00	94.2	94.4	0.2	80-120	20		

**Misc Anions by Ion Chromatograph**

Gettler Ryan

Attn.: Deanna Harding

6747 Sierra Court Suite J

Dublin, CA 94568

Phone: (925) 551-7444 Fax: (925) 551-7899

Project: 180061.80

Conoco #5325

Received: 06/19/2003 16:58

Site: 3220 Lakeshore Avenue, Oakland

**Samples Reported**

Sample Name	Date Sampled	Matrix	Lab #
U-1	06/18/2003 13:15	Water	1
U-2	06/18/2003 14:10	Water	2
U-3	06/18/2003 11:15	Water	3
U-4	06/18/2003 11:50	Water	4
U-5	06/18/2003 12:20	Water	5
U-6	06/18/2003 12:40	Water	6

Misc Anions by Ion Chromatograph

Gettler Ryan

Attn.: Deanna Harding

6747 Sierra Court Suite J

Dublin, CA 94568

Phone: (925) 551-7444 Fax: (925) 551-7899

Project: 180061.80

Conoco #5325

Received: 06/19/2003 16:58

Site: 3220 Lakeshore Avenue, Oakland

Prep(s): 300.0/9056	Test(s): 300.0/9056
Sample ID: U-1	Lab ID: 2003-06-0630 - 1
Sampled: 06/18/2003 13:15	Extracted: 6/20/2003 07:43
Matrix: Water	QC Batch#: 2003/06/20-01.41
Analysis Flag: ( See Legend and Note Section )	

Compound	Conc.	RL	Unit	Dilution	Analyzed	Flag
Nitrate	ND	1.0	mg/L	1.00	06/20/2003 07:43	
Orthophosphate	ND	1.0	mg/L	1.00	06/20/2003 07:43	

Misc Anions by Ion Chromatograph

Gettler Ryan

Attn.: Deanna Harding

6747 Sierra Court Suite J

Dublin, CA 94568

Phone: (925) 551-7444 Fax: (925) 551-7899

Project: 180061.80

Conoco #5325

Received: 06/19/2003 16:58

Site: 3220 Lakeshore Avenue, Oakland

Prep(s):	300.0/9056	Test(s):	300.0/9056
Sample ID:	U-2	Lab ID:	2003-06-0630 - 2
Sampled:	06/18/2003 14:10	Extracted:	6/20/2003 07:51
Matrix:	Water	QC Batch#:	2003/06/20-01.41

Compound	Conc.	RL	Unit	Dilution	Analyzed	Flag
Nitrate	ND	1.0	mg/L	1.00	06/20/2003 07:51	
Orthophosphate	3.1	1.0	mg/L	1.00	06/20/2003 07:51	

Misc Anions by Ion Chromatograph

Gettler Ryan

Attn.: Deanna Harding

6747 Sierra Court Suite J

Dublin, CA 94568

Phone: (925) 551-7444 Fax: (925) 551-7899

Project: 180061.80

Conoco #5325

Received: 06/19/2003 16:58

Site: 3220 Lakeshore Avenue, Oakland

Prep(s): 300.0/9056	Test(s): 300.0/9056
Sample ID: U-3	Lab ID: 2003-06-0630 - 3
Sampled: 06/18/2003 11:15	Extracted: 6/20/2003 07:59
Matrix: Water	QC Batch#: 2003/06/20-01.41

Compound	Conc.	RL	Unit	Dilution	Analyzed	Flag
Nitrate	17	1.0	mg/L	1.00	06/20/2003 07:59	
Orthophosphate	ND	1.0	mg/L	1.00	06/20/2003 07:59	



**Misc Anions by Ion Chromatograph**

Gettler Ryan

Attn.: Deanna Harding

6747 Sierra Court Suite J

Dublin, CA 94568

Phone: (925) 551-7444 Fax: (925) 551-7899

Project: 180061.80

Conoco #5325

Received: 06/19/2003 16:58

Site: 3220 Lakeshore Avenue, Oakland

Prep(s):	300.0/9056	Test(s):	300.0/9056
Sample ID:	U-4	Lab ID:	2003-06-0630 - 4
Sampled:	06/18/2003 11:50	Extracted:	6/20/2003 08:07
Matrix:	Water	QC Batch#:	2003/06/20-01.41

Compound	Conc.	RL	Unit	Dilution	Analyzed	Flag
Nitrate	31	1.0	mg/L	1.00	06/20/2003 08:07	
Orthophosphate	ND	1.0	mg/L	1.00	06/20/2003 08:07	

Misc Anions by Ion Chromatograph

Gettler Ryan  
Attn.: Deanna Harding

6747 Sierra Court Suite J  
Dublin, CA 94568  
Phone: (925) 551-7444 Fax: (925) 551-7899

Project: 180061.80  
Conoco #5325

Received: 06/19/2003 16:58

Site: 3220 Lakeshore Avenue, Oakland

Prep(s): 300.0/9056	Test(s): 300.0/9056
Sample ID: U-5	Lab ID: 2003-06-0630 - 5
Sampled: 06/18/2003 12:20	Extracted: 6/20/2003 08:15
Matrix: Water	QC Batch#: 2003/06/20-01.41

Compound	Conc.	RL	Unit	Dilution	Analyzed	Flag
Nitrate	ND	1.0	mg/L	1.00	06/20/2003 08:15	
Orthophosphate	ND	1.0	mg/L	1.00	06/20/2003 08:15	

**Misc Anions by Ion Chromatograph**

Gettler Ryan

Attn.: Deanna Harding

6747 Sierra Court Suite J

Dublin, CA 94568

Phone: (925) 551-7444 Fax: (925) 551-7899

Project: 180061.80

Conoco #5325

Received: 06/19/2003 16:58

Site: 3220 Lakeshore Avenue, Oakland

Prep(s): 300.0/9056	Test(s): 300.0/9056
Sample ID: U-6	Lab ID: 2003-06-0630 - 6
Sampled: 06/18/2003 12:40	Extracted: 6/20/2003 08:23
Matrix: Water	QC Batch#: 2003/06/20-01.41

Compound	Conc.	RL	Unit	Dilution	Analyzed	Flag
Nitrate	ND	1.0	mg/L	1.00	06/20/2003 08:23	
Orthophosphate	2.0	1.0	mg/L	1.00	06/20/2003 08:23	

**Misc Anions by Ion Chromatograph**

Gettler Ryan

Attn.: Deanna Harding

6747 Sierra Court Suite J

Dublin, CA 94568

Phone: (925) 551-7444 Fax: (925) 551-7899

Project: 180061.80

Conoco #5325

Received: 06/19/2003 16:58

Site: 3220 Lakeshore Avenue, Oakland

**Batch QC Report**

Prep(s): 300.0/9056

Method Blank

MB: 2003/06/20-01.41-001

Water

Test(s): 300.0/9056

QC Batch # 2003/06/20-01.41

Date Extracted: 06/20/2003

Compound	Conc.	RL	Unit	Analyzed	Flag
Nitrate	ND	1.0	mg/L	06/20/2003	
Orthophosphate	ND	1.0	mg/L	06/20/2003	

**Misc Anions by Ion Chromatograph**

Gettler Ryan

Attn.: Deanna Harding

6747 Sierra Court Suite J  
Dublin, CA 94568  
Phone: (925) 551-7444 Fax: (925) 551-7899

Project: 180061.80  
Conoco #5325

Received: 06/19/2003 16:58

Site: 3220 Lakeshore Avenue, Oakland

**Batch QC Report**

Prep(s): 300.0/9056

Test(s): 300.0/9056

**Laboratory Control Spike**

**Water**

**QC Batch # 2003/06/20-01.41**

LCS 2003/06/20-01.41-002

Extracted: 06/20/2003

Analyzed: 06/20/2003

LCSD 2003/06/20-01.41-003

Extracted: 06/20/2003

Analyzed: 06/20/2003

Compound	Conc. mg/L		Exp.Conc.	Recovery %		RPD	Ctrl.Limits %		Flags	
	LCS	LCSD		LCS	LCSD		%	Rec.	RPD	LCS
Nitrate	19.6	19.6	20.0	98.0	98.0	0.0	80-120	20		
Orthophosphate	20.1	20.2	20.0	100.5	101.0	0.5	80-120	20		

**Misc Anions by Ion Chromatograph**

Gettler Ryan

Attn.: Deanna Harding

6747 Sierra Court Suite J

Dublin, CA 94568

Phone: (925) 551-7444 Fax: (925) 551-7899

Project: 180061.80

Conoco #5325

Received: 06/19/2003 16:58

Site: 3220 Lakeshore Avenue, Oakland

**Batch QC Report**

Prep(s): 300.0/9056

Test(s): 300.0/9056

**Matrix Spike ( MS / MSD )**

**Water**

**QC Batch # 2003/06/20-01.41**

U-6 >> MS

Lab ID: 2003-06-0630 - 006

MS: 2003/06/20-01.41-004

Extracted: 06/20/2003

Analyzed: 06/20/2003

Dilution: 1.00

MSD: 2003/06/20-01.41-005

Extracted: 06/20/2003

Analyzed: 06/20/2003

Dilution: 1.00

Compound	Conc. mg/L			Spk.Level mg/L	Recovery %			Limits %		Flags	
	MS	MSD	Sample		MS	MSD	RPD	Rec.	RPD	MS	MSD
Nitrate	32.5	25.5	ND	20.0	162.5	127.5	24.1	80-120	20	mso	rpd
Orthophosphate	32.6	28.8	1.95	20.0	153.3	134.3	13.2	80-120	20	mso	rpd

**Misc Anions by Ion Chromatograph**

Gettler Ryan

Attn.: Deanna Harding

6747 Sierra Court Suite J

Dublin, CA 94568

Phone: (925) 551-7444 Fax: (925) 551-7899

Project: 180061.80

Conoco #5325

Received: 06/19/2003 16:58

Site: 3220 Lakeshore Avenue, Oakland

---

**Legend and Notes**

---

**Analysis Flag**

**Result Flag**

mso

MS/MSD spike recoveries were out of QC limits due to matrix interference.  
Precision and Accuracy were verified by LCS/LCSD.

rpd

Analyte RPD was out of QC limits due to sample heterogeneity.