



2000 Crow Canyon Place
Suite 400
San Ramon, CA 94583

Phone: (925) 277-2305
Fax: (925) 277-2361

Environmental Department

April 24, 2003

DH

Re: **Tosco (Unocal) Service Station #5325**
3220 Lakeshore Avenue
Oakland, California

Alameda County
APR 29 2003
Environmental Health

“ I declare under penalty of perjury, that to the best of my knowledge at the present time, the information and/or recommendations contained in the attached proposal or report is true and correct.”

David B. DeWitt
Site Manager
ConocoPhillips



GETTLER-RYAN Inc.

TRANSMITTAL

April 9, 2003
G-R #180061

TO: Mr. David B. De Witt
ConocoPhillips
76 Broadway Avenue
Sacramento, California 95818

CC: Mr. David Vossler
Gettler-Ryan Inc.
Petaluma, California

FROM: Deanna L. Harding
Project Coordinator
Gettler-Ryan Inc.
6747 Sierra Court, Suite J
Dublin, California 94568

RE: **Tosco (Unocal) Service Station
#5325
3220 Lakeshore Avenue
Oakland, California**

WE HAVE ENCLOSED THE FOLLOWING:

COPIES	DATED	DESCRIPTION
1	April 4, 2003	Groundwater Monitoring and Sampling Report First Quarter - Event of March 4, 2003

COMMENTS:

This report is being sent to you for your review/comment, prior to being distributed on your behalf. If no comments are received by *April 23, 2003*, this report will be distributed to the following:

cc: Alameda County Health Care Services, 1131 Harbor Bay Parkway, Suite 250 Alameda, CA 94502

Enclosure

trans/5325-DBD



GETTLER - RYAN INC.

April 4, 2003
G-R Job #180061

Mr. David B. De Witt
ConocoPhillips
2000 Crow Canyon Place, Suite 400
San Ramon, California 94583

RE: First Quarter Event of March 4, 2003
Groundwater Monitoring & Sampling Report
Tosco (Unocal) Service Station #5325
3220 Lakeshore Avenue
Oakland, California

Alameda County
APR 29 2003
Environmental Health

Dear Mr. De Witt:

This report documents the most recent groundwater monitoring and sampling event performed by Gettler-Ryan Inc. (G-R) at the referenced site. All field work was conducted in accordance with G-R Standard Operating Procedure - Groundwater Sampling (attached).

Static groundwater levels were measured and all wells were checked for the presence of separate-phase hydrocarbons. Separate-phase hydrocarbons were not present in any wells. Static water level data and groundwater elevations are summarized in Table 1. Field Measurements are summarized in Table 3. A Potentiometric Map is included as Figure 1.

Groundwater samples were collected from the monitoring wells and submitted to a state certified laboratory for analyses. The field data sheets for this event are attached. Analytical results are presented in the table(s) listed below. A Concentration Map is included as Figure 2. The chain of custody document and laboratory analytical report are also attached.

Sincerely,

Deanna L. Harding
Deanna L. Harding
Project Coordinator

Hagop Kevork
Hagop Kevork
P.E. No. C55734



- Figure 1: Potentiometric Map
- Figure 2: Concentration Map
- Table 1: Groundwater Monitoring Data and Analytical Results
- Table 2: Groundwater Analytical Results – Oxygenate Compounds
- Table 3: Field Measurements and Groundwater Analytical Results
- Attachments: Standard Operating Procedure - Groundwater Sampling
Field Data Sheets
Chain of Custody Document and Laboratory Analytical Reports

5325.qml

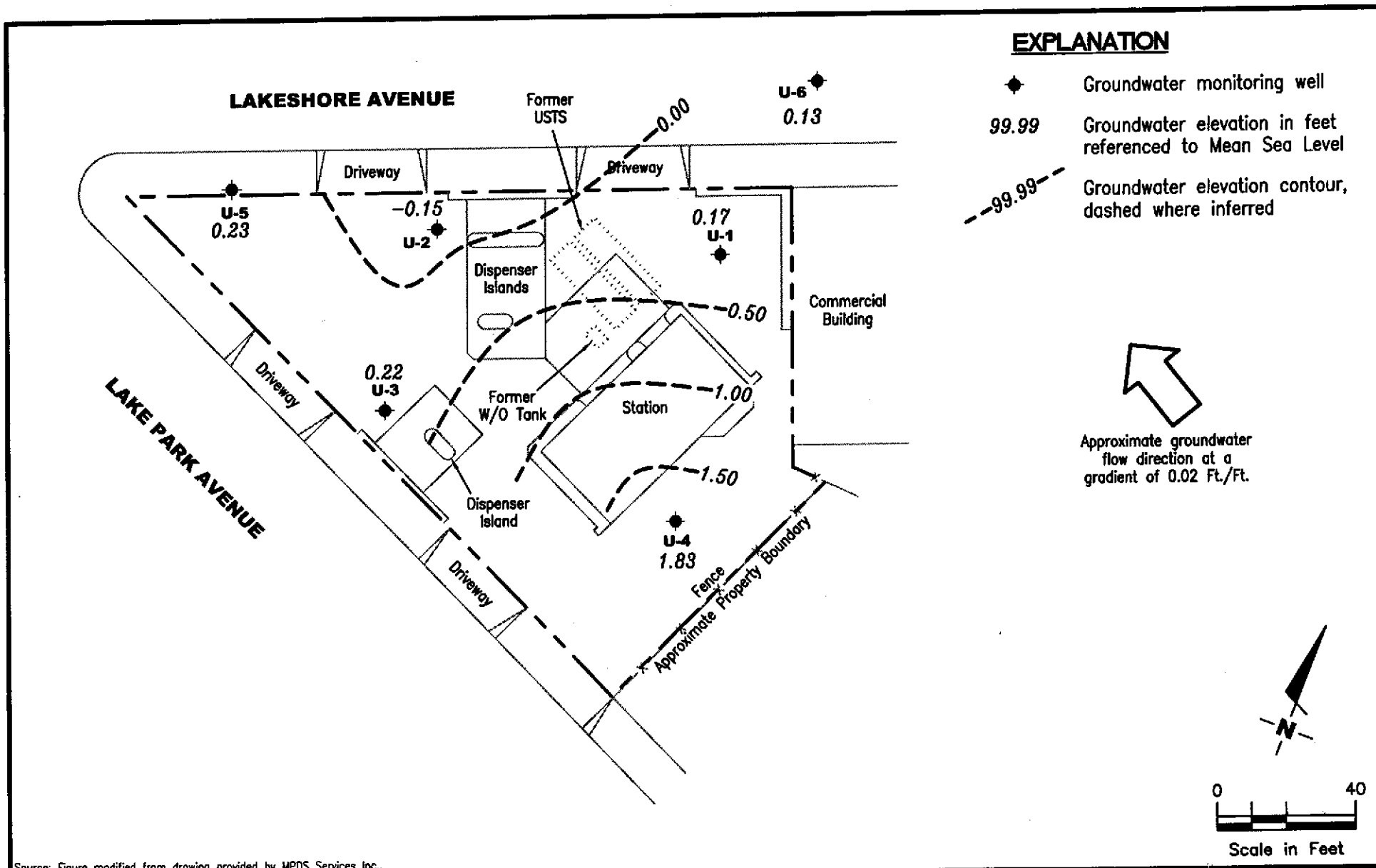

Source: Figure modified from drawing provided by MPDS Services Inc..



GETTLER - RYAN INC.

6747 Sierra Ct., Suite J
Dublin, CA 94568 (925) 551-7555

POTENTIOMETRIC MAP

Tosco (Unocal) Service Station #5325
3220 Lakeshore Avenue
Oakland, California

FIGURE

1

PROJECT NUMBER
180061

REVIEWED BY

DATE
March 4, 2003

REVISED DATE

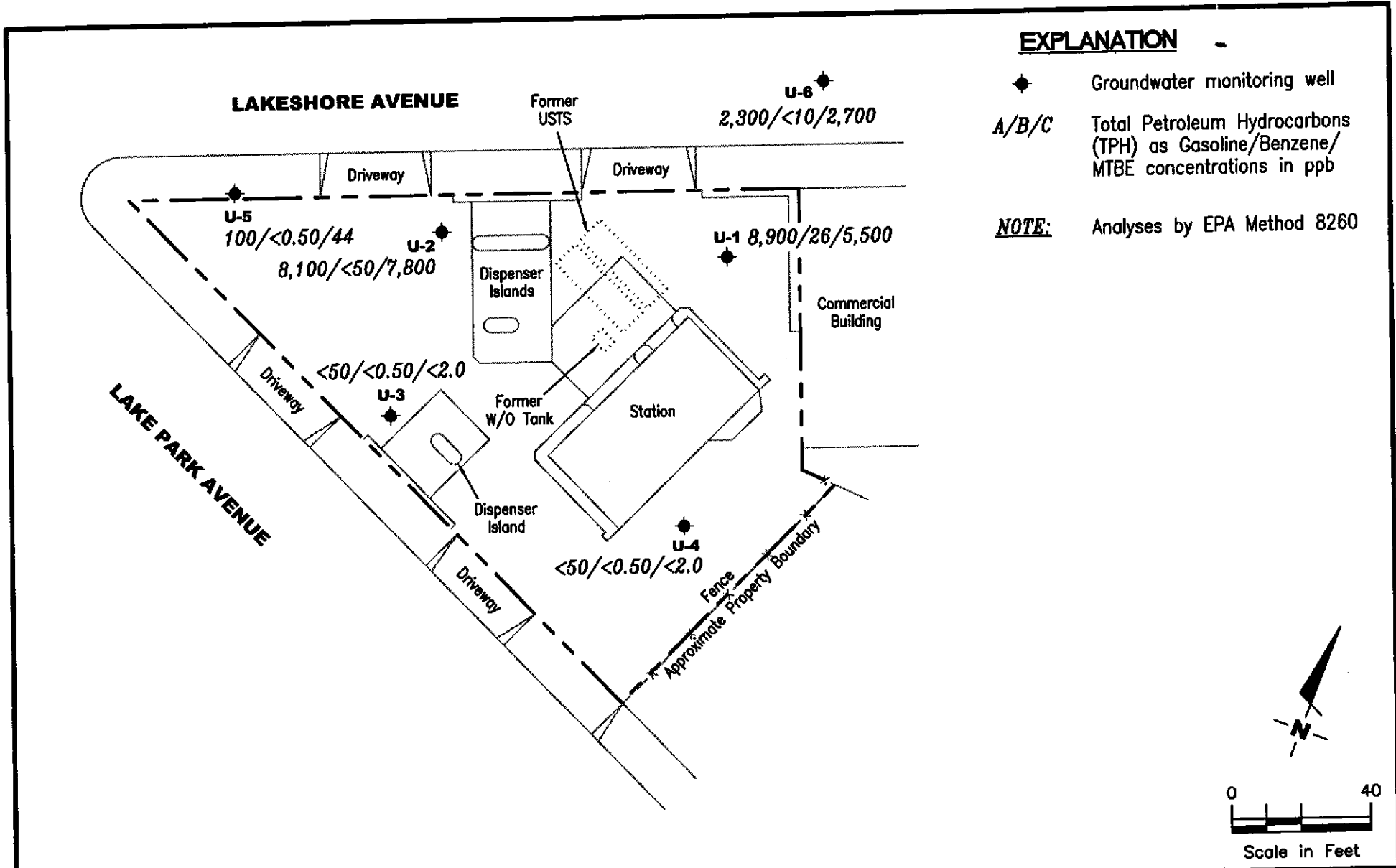

Source: Figure modified from drawing provided by MPDS Services Inc..

GETTLER - RYAN INC.
 6747 Sierra Ct., Suite J
 Dublin, CA 94568 (925) 551-7555

CONCENTRATION MAP
 Tosco (Unocal) Service Station #5325
 3220 Lakeshore Avenue
 Oakland, California

FIGURE

2

PROJECT NUMBER
180061

REVIEWED BY

DATE
March 4, 2003

REVISED DATE

Table 1
Groundwater Monitoring Data and Analytical Results
 Tosco (Unocal) Service Station #5325
 3220 Lakeshore Avenue
 Oakland, California

WELL ID/ TOC*(ft.)	DATE	DTW (ft.)	S.I. (ft. bgs)	GWE (ft.)	Product Thickness (ft.)	TPH-G (ppb)	B (ppb)	T (ppb)	E (ppb)	X (ppb)	MTBE (ppb)
U-1	08/10/90	--	5.0-20.0	--	--	690	38	75	8.6	130	--
	01/07/91	--		--	--	250	22	16	4.2	17	--
	04/01/91	--		--	--	160	13	8.6	1.0	15	--
	07/03/91	--		--	--	140	21	4.3	0.36	17	--
	10/09/91	--		--	--	ND	ND	ND	ND	ND	--
	02/12/92	--		--	--	250	ND	ND	ND	ND	--
	05/05/92	--		--	--	230	1.2	ND	ND	ND	--
	06/11/92	--		--	--	1,000	80	1.4	6.7	41	--
	08/20/92	--		--	--	400 ¹	1.0	ND	ND	0.6	--
	02/22/93	--		--	--	34,000	1,400	5,500	910	7,300	--
5.32	05/07/93	--		--	--	8,700	600	240	650	3,300	--
	08/08/93	--		--	--	4,900 ²	79	ND	832	270	--
8.46	11/16/93	8.61		-3.29	0.00	690 ³	ND	ND	ND	ND	--
	02/16/94	8.54		-3.22	0.00	6,800 ⁴	ND	ND	ND	ND	--
8.46	06/22/94	8.39		0.07	0.00	200	ND	ND	5.9	21	--
	09/22/94	8.66		-0.20	0.00	6,100 ³	ND	ND	ND	ND	--
	12/24/94	8.04		0.42	0.00	50,000	2,500	9,700	2,400	17,000	--
	03/25/95	7.72		1.02**	0.37	NOT SAMPLED DUE TO THE PRESENCE OF FREE PRODUCT					--
	06/21/95	9.30		-0.69**	0.20	NOT SAMPLED DUE TO THE PRESENCE OF FREE PRODUCT					--
	09/19/95	9.29		-0.53**	0.40	NOT SAMPLED DUE TO THE PRESENCE OF FREE PRODUCT					--
	12/19/95	8.98		-0.50**	0.03	NOT SAMPLED DUE TO THE PRESENCE OF FREE PRODUCT					--
	03/18/96	8.25		0.21	0.00	27,000	ND	2,300	1,400	11,000	4,900
	06/27/96	7.92		0.54	<0.01	120,000	540	4,300	2,600	26,000	ND
	09/26/96	9.10		-0.62**	0.02	NOT SAMPLED DUE TO THE PRESENCE OF FREE PRODUCT					--
	12/09/96	6.88		1.60**	0.03	NOT SAMPLED DUE TO THE PRESENCE OF FREE PRODUCT					--
	03/14/97	9.02		-0.15**	0.55	NOT SAMPLED DUE TO THE PRESENCE OF FREE PRODUCT					--
	06/30/97	8.41		0.07**	0.02	NOT SAMPLED DUE TO THE PRESENCE OF FREE PRODUCT					--
	09/19/97	8.56		-0.08**	0.02	NOT SAMPLED DUE TO THE PRESENCE OF FREE PRODUCT					--
	12/12/97	8.58		-0.11**	0.01	NOT SAMPLED DUE TO THE PRESENCE OF FREE PRODUCT					--
	03/03/98 ¹⁷	8.23		0.26**	0.04	NOT SAMPLED DUE TO THE PRESENCE OF FREE PRODUCT					--
	06/15/98 ¹⁷	8.37		0.09	Sheen	52,000	ND ⁷	900	1,800	13,000	13,000
09/30/98 ¹⁷	8.94		-0.48	Sheen	1,000,000 ⁸	ND ⁷	2,600	13,000	83,000	83,000	4,800
12/28/98 ¹⁷	8.57		-0.11	<0.01	1,100,000 ⁹	ND ⁷	1,600	8,600	71,000	71,000	5,700

Table 1
Groundwater Monitoring Data and Analytical Results
 Tosco (Unocal) Service Station #5325
 3220 Lakeshore Avenue
 Oakland, California

WELL ID/ TOC*(ft.)	DATE	DTW (ft.)	S.I. (ft. bgs)	GWE (ft.)	Product Thickness (ft.)	TPH-G (ppb)	B (ppb)	T (ppb)	E (ppb)	X (ppb)	MTBE (ppb)
U-1	03/22/99 ¹⁷	8.18	5.0-20.0	0.28	Sheen	130,000	470	1,100	2,000	28,000	5,700
(cont)	06/09/99	9.37		-0.91	0.00	40,000	230	640	590	13,000	3,500/2,100 ¹⁰
	09/08/99 ¹⁷	9.53		-1.07	0.00	55,000 ¹¹	217	202	745	14,300	6,890/6,690 ¹⁰
	12/07/99 ¹⁷	9.67		-1.21	0.00	41,200 ¹³	89.3	ND ⁷	385	6,930	15,800/14,700 ¹²
	03/13/00 ¹⁷	8.44		0.02	0.00	48,000 ¹¹	490	610	2,400	10,000	22,000/23,000 ¹⁰
	06/21/00 ¹⁷	9.45		-0.99	0.00	37,000 ¹¹	200	ND ⁷	1,200	7,200	15,000/20,000 ¹⁰
	09/27/00 ¹⁷	9.29		-0.83	0.00	15,000 ¹¹	92	ND ⁷	540	2,800	74,000/83,000 ¹⁵
	12/12/00 ¹⁷	9.37		-0.91	0.00	50,000 ¹⁶	ND ⁷	ND ⁷	250	1,900	12,000/15,000 ¹²
	03/07/01 ¹⁷	8.45		0.01	0.00	6,220 ¹³	29.8	10.4	96.3	638	11,200/11,800 ¹⁰
	06/06/01 ¹⁷	9.29		-0.83	0.00	5,200 ¹³	17	ND ⁷	69	420	6,500/8,700 ¹²
	09/24/01 ¹⁷	9.39		-0.93	0.00	4,300 ¹⁸	36	<25	65	590	4,400/4,400 ¹⁰
	12/10/01 ²⁰	9.17		-0.71	0.00	11,000 ¹⁸	220	<100	380	1,500	5,100/5,100 ¹⁰
	03/11/02 ²⁰	9.44		-0.98	0.00	5,500 ¹³	28	<20	360	690	6,400/6,300 ¹⁰
	06/04/02 ²⁰	8.32		0.14	0.00	4,600 ¹⁸	31	<10	240	180	6,500
	09/03/02 ²⁰	9.36		-0.90	0.00	2,300 ²¹	<12	<12	<12	68	3,500/4,700 ¹⁰
	12/03/02 ^{20,22}	8.18		0.28	0.00	<5,000	<50	<50	<50	<100	4,700
	03/04/03 ²²	8.29		0.17	0.00	8,900	26	<25	400	130	5,500
U-2	08/10/90	--	5.0-20.0	--	--	780	27	46	15	130	--
	01/07/91	--		--	--	1,900	67	5.8	58	69	--
	04/01/91	--		--	--	1,700	250	89	34	190	--
	07/03/91	--		--	--	2,100	150	25	3.1	290	--
	10/09/91	--		--	--	230	7.1	ND	ND	11	--
	02/12/92	--		--	--	410	1.9	ND	0.36	0.4	--
	05/05/92	--		--	--	1,600	120	52	6.2	290	--
	06/11/92	--		--	--	620	17	2.1	ND	37	--
	08/20/92	--		--	--	700	28	6.5	1.3	4.6	--
	02/22/93	--		--	--	3,400	2,400	2,100	1,200	5,800	--

Table 1
Groundwater Monitoring Data and Analytical Results
 Tosco (Unocal) Service Station #5325
 3220 Lakeshore Avenue
 Oakland, California

WELL ID/ TOC* (ft.)	DATE	DTW (ft.)	S.I. (ft. bgs)	GWE (ft.)	Product Thickness (ft.)	TPH-G (ppb)	B (ppb)	T (ppb)	E (ppb)	X (ppb)	MTBE (ppb)
U-2	05/07/93	--	5.0-20.0	--	--	17,000	1,800	660	1,700	4,000	--
(cont)	08/08/93	--		--	--	5,600 ²	420	ND	410	670	--
4.53	11/16/93	8.17		-3.64	0.00	510 ³	ND	ND	ND	ND	--
	02/16/94	7.73		-3.20	0.00	980 ⁴	49	13	2.7	40	--
7.62	06/22/94	7.60		0.02	0.00	31,000	2,200	62	1,500	3,500	--
	09/22/94	7.93		-0.31	0.00	8,500 ³	29	ND	ND	ND	--
	12/24/94	7.27		0.35	0.00	32,000	1,500	890	1,300	5,000	--
	03/25/95	7.01		0.61	0.00	170,000	1,900	21,000	4,800	33,000	--
	06/21/95	6.98		0.64	0.00	16,000	2,100	ND	1,800	1,700	--
	09/19/95	7.70		-0.08	0.00	3,000	610	ND	78	240	-- ⁵
	12/19/95	7.30		0.32	0.00	1,600	140	55	52	270	-- ⁶
	03/18/96	6.45		1.17	0.00	12,000	2,200	ND	1,200	2,200	22,000
	06/27/96	7.41		0.21	0.00	28,000	3,400	ND	2,800	3,100	3,000
	09/26/96	7.90		-0.28	0.00	5,900	750	ND	ND	ND	18,000
	12/09/96	6.76		0.86	0.00	13,000	5,100	290	980	370	2,700
	03/14/97	7.12		0.52**	0.03	NOT SAMPLED DUE TO THE PRESENCE OF FREE PRODUCT					--
	06/30/97	6.19		1.43	<0.01	NOT SAMPLED DUE TO THE PRESENCE OF FREE PRODUCT					--
	09/19/97	7.31		0.31	<0.01	NOT SAMPLED DUE TO THE PRESENCE OF FREE PRODUCT					--
	12/12/97	6.75		0.88**	<0.01	NOT SAMPLED DUE TO THE PRESENCE OF FREE PRODUCT					--
	03/03/98	6.36		1.26	Sheen	80,000	3,000	1,100	820	16,000	16,000
	06/15/98	6.51		1.11	Sheen	48,000	1,800	330	470	7,900	20,000
	09/30/98	7.17		0.45	Sheen	60,000	1,300	ND ⁷	500	9,700	19,000
	12/28/98	7.06		0.56	0.00	63,000	590	160	320	5,600	16,000
	03/22/99	6.82		0.80	0.00	28,000	1,100	ND ⁷	360	2,900	25,000
	06/09/99	7.51		0.11	0.00	21,000	110	190	310	2,600	7,900/7,800 ¹⁰
	09/08/99	8.16		-0.54	0.00	23,300 ¹¹	477	138	286	4,110	16,400/15,300 ¹⁰
	12/07/99	8.31		-0.69	0.00	4,840 ¹³	17.2	ND ⁷	ND ⁷	157	14,900/15,600 ¹²
	03/13/00	6.69		0.93	0.00	11,000 ¹¹	380	160	ND ⁷	2,100	22,000/26,000 ¹⁰
	06/21/00	7.67		-0.05	0.00	9,100 ¹¹	22	ND ⁷	ND ⁷	800	16,000/22,000 ¹⁰
	09/27/00	7.44		0.18	0.00	2,900 ¹¹	43	ND ⁷	ND ⁷	39	20,000/26,000 ¹⁵
	12/12/00	7.51		0.11	0.00	3,600 ¹¹	17	ND ⁷	ND ⁷	87	8,000/7,800 ¹²
	03/07/01	7.15		0.47	0.00	1,670 ¹³	51.0	ND ⁷	7.20	19.5	5,930/7,900 ¹⁰
	06/06/01	7.57		0.05	0.00	1,100 ¹¹	14	ND ⁷	9.3	35	9,200/10,000 ¹²

Table 1
Groundwater Monitoring Data and Analytical Results
 Tosco (Unocal) Service Station #5325
 3220 Lakeshore Avenue
 Oakland, California

WELL ID/ TOC* (ft.)	DATE	DTW (ft.)	S.I. (ft. bgs)	GWE (ft.)	Product Thickness (ft.)	TPH-G (ppb)	B (ppb)	T (ppb)	E (ppb)	X (ppb)	MTBE (ppb)
U-2	09/24/01	7.63	5.0-20.0	-0.01	0.00	1,000 ¹⁸	25	<2.5	12	100	9,800/11,000 ¹⁰
(cont)	12/10/01	6.78		0.84	0.00	83	14	0.55	3.4	6.8	2,500/2,500 ¹⁰
	03/11/02	7.12		0.50	0.00	<1,000	28	<10	40	31	11,000/11,000 ¹⁰
	06/04/02	7.18		0.44	0.00	7,700 ¹⁸	32	<25	33	48	14,000
	09/03/02	7.58		0.04	0.00	5,200 ²¹	<25	<25	<25	<25	11,000/15,000 ¹⁰
	12/03/02 ²²	7.68		-0.06	0.00	<5,000	<50	<50	<50	<100	3,200
	03/04/03 ²²	7.77		-0.15	0.00	8,100 ²¹	<50	<50	<50	<100	7,800
U-3	08/10/90	--	5.0-20.0	--	--	ND	ND	ND	ND	ND	--
	01/07/91	--		--	--	ND	ND	ND	ND	1.8	--
	04/01/91	--		--	--	ND	1.0	2.9	0.53	5.4	--
	07/03/91	--		--	--	ND	ND	ND	ND	ND	--
	10/09/91	--		--	--	ND	ND	ND	ND	ND	--
	02/12/92	--		--	--	ND	ND	ND	ND	ND	--
	05/05/92	--		--	--	ND	ND	ND	ND	ND	--
	06/11/92	--		--	--	ND	ND	ND	ND	ND	--
	08/20/92	--		--	--	ND	ND	ND	ND	ND	--
	02/22/93	--		--	--	ND	ND	ND	ND	ND	--
	05/07/93	--		--	--	ND	ND	ND	ND	ND	--
	08/08/93	--		--	--	210	5.0	9.7	0.7	4.1	--
7.86	11/16/93	11.82		-3.96	0.00	ND	ND	ND	ND	ND	--
	02/16/94	11.62		-3.76	0.00	ND	ND	ND	ND	ND	--
10.98	06/22/94	11.64		-0.66	0.00	ND	ND	ND	ND	ND	--
	09/22/94	11.76		-0.78	0.00	ND	ND	ND	ND	ND	--
	12/24/94	11.28		-0.30	0.00	ND	ND	ND	ND	ND	--
	03/25/95	10.96		0.02	0.00	ND	ND	ND	ND	ND	--
	06/21/95	11.37		-0.39	0.00	ND	ND	ND	ND	ND	--
	09/19/95	11.55		-0.57	0.00	ND	ND	ND	ND	ND	-- ⁵
	12/19/95	11.45		-0.47	0.00	ND	ND	ND	ND	ND	--
	03/18/96	11.10		-0.12	0.00	ND	ND	ND	ND	ND	--
	06/27/96	11.16		-0.18	0.00	440	49	50	51	140	50
	09/26/96	11.55		-0.57	0.00	ND	ND	ND	ND	ND	ND

Table 1
Groundwater Monitoring Data and Analytical Results
 Tosco (Unocal) Service Station #5325
 3220 Lakeshore Avenue
 Oakland, California

WELL ID/ TOC*(ft.)	DATE	DTW (ft.)	S.I. (ft. bgs)	GWE (ft.)	Product Thickness (ft.)	TPH-G (ppb)	B (ppb)	T (ppb)	E (ppb)	X (ppb)	MTBE (ppb)
U-3 (cont)	12/09/96	10.12	5.0-20.0	0.86	0.00	ND	ND	ND	ND	ND	29
	03/14/97	10.87		0.11	0.00	ND	ND	ND	ND	ND	ND
	06/30/97	11.08		-0.10	0.00	ND	ND	ND	ND	ND	ND
	09/19/97	11.05		-0.07	0.00	ND	ND	ND	ND	ND	ND
	12/12/97	10.58		0.40	0.00	ND	ND	ND	ND	ND	ND
	03/03/98	9.84		1.14	0.00	ND	ND	ND	ND	ND	ND
	06/15/98	10.56		0.42	0.00	ND	ND	ND	ND	ND	ND
	09/30/98	11.12		-0.14	0.00	ND	ND	ND	ND	ND	ND
	12/28/98	10.96		0.02	0.00	ND	ND	ND	ND	ND	ND
	03/22/99	9.46		1.52	0.00	ND	ND	ND	ND	ND	ND
	06/09/99	11.01		-0.03	0.00	ND	ND	ND	ND	ND	ND
	09/08/99	11.31		-0.33	0.00	ND	ND	ND	ND	ND	ND
	12/07/99	11.26		-0.28	0.00	ND	ND	ND	ND	ND	ND
	03/13/00	8.28		2.70	0.00	ND	ND	ND	ND	ND	ND
	06/21/00	11.12		-0.14	0.00	ND	ND	ND	ND	ND	ND
	09/27/00	11.07		-0.09	0.00	ND	ND	ND	ND	ND	ND
	12/12/00	10.94		0.04	0.00	ND	ND	ND	ND	ND	ND
	03/07/01	8.32		2.66	0.00	ND	ND	ND	ND	ND	ND
	06/06/01	10.94		0.04	0.00	ND	ND	ND	ND	ND	ND
	09/24/01	11.03		-0.05	0.00	<50	<0.50	<0.50	<0.50	<0.50	<2.5
	12/10/01	8.16		2.82	0.00	<50	<0.50	<0.50	<0.50	<0.50	<2.5
	03/11/02	7.82		3.16	0.00	<50	<0.50	<0.50	<0.50	<0.50	<2.5
	06/04/02	10.58		0.40	0.00	<50	<0.50	<0.50	<0.50	<0.50	<2.5
09/03/02	10.94		0.04	0.00	<50	<0.50	<0.50	<0.50	<0.50	<2.5	
12/03/02 ²²	10.66		0.32	0.00	<50	<0.50	<0.50	<0.50	<1.0	<2.0	
03/04/03 ²²	10.76		0.22	0.00	<50	<0.50	<0.50	<0.50	<1.0	<2.0	
U-4 11.15	06/22/94	10.16	5.0-20.0	0.99	0.00	ND	ND	ND	ND	ND	--
	09/22/94	10.79		0.36	0.00	ND	0.78	1.3	ND	1.4	--
	12/24/94	9.81		1.34	0.00	ND	ND	ND	ND	ND	--
	03/25/95	9.51		1.64	0.00	ND	ND	ND	ND	ND	--

Table 1
Groundwater Monitoring Data and Analytical Results
 Tosco (Unocal) Service Station #5325
 3220 Lakeshore Avenue
 Oakland, California

WELL ID/ TOC*(ft.)	DATE	DTW (ft.)	S.L. (ft. bgs)	GWE (ft.)	Product Thickness (ft.)	TPH-G (ppb)	B (ppb)	T (ppb)	E (ppb)	X (ppb)	MTBE (ppb)
U-4	06/21/95	9.54	5.0-20.0	1.61	0.00	ND	ND	ND	ND	ND	--
(cont)	09/19/95	10.17		0.98	0.00	ND	ND	ND	ND	ND	--
	12/19/95	9.98		1.17	0.00	ND	ND	ND	ND	ND	--
	03/18/96	9.66		1.49	0.00	ND	ND	ND	ND	ND	ND
	06/27/96	9.74		1.41	0.00	ND	ND	ND	ND	ND	ND
	09/26/96	10.14		1.01	0.00	ND	ND	ND	ND	ND	33
	12/09/96	8.67		2.48	0.00	ND	ND	ND	ND	ND	ND
	03/14/97	9.35		1.80	0.00	ND	ND	ND	ND	ND	ND
	06/30/97	9.89		1.26	0.00	ND	ND	ND	ND	ND	ND
	09/19/97	9.96		1.19	0.00	ND	ND	ND	ND	ND	ND
	12/12/97	8.56		2.59	0.00	ND	ND	ND	ND	ND	ND
	03/03/98	7.85		3.30	0.00	ND	ND	ND	ND	ND	ND
	06/15/98	9.08		2.07	0.00	ND	ND	ND	ND	ND	ND
	09/30/98	9.75		1.40	0.00	ND	ND	ND	ND	ND	ND
	12/28/98	9.59		1.56	0.00	ND	ND	ND	ND	ND	ND
	03/22/99	8.34		2.81	0.00	ND	ND	ND	ND	ND	ND
	06/09/99	9.39		1.76	0.00	ND	ND	ND	ND	ND	ND
	09/08/99	9.90		1.25	0.00	ND	ND	ND	ND	ND	ND
	12/07/99	10.05		1.10	0.00	ND	ND	ND	ND	ND	ND
	03/13/00	7.24		3.91	0.00	ND	ND	ND	ND	ND	ND
	06/21/00	9.48		1.67	0.00	ND	ND	ND	ND	ND	ND
	09/27/00	9.42		1.73	0.00	ND	ND	ND	ND	ND	ND
	12/12/00	9.50		1.65	0.00	ND	ND	ND	ND	ND	ND
	03/07/01	6.88		4.27	0.00	ND	ND	ND	ND	ND	ND
	06/06/01	9.18		1.97	0.00	ND	ND	ND	ND	ND	ND
	09/24/01	9.21		1.94	0.00	<50	<0.50	<0.50	<0.50	<0.50	<2.5
	12/10/01	7.32		3.83	0.00	<50	<0.50	<0.50	<0.50	<0.50	<2.5
	03/11/02	6.92		4.23	0.00	<50	<0.50	<0.50	<0.50	<0.50	<5.0
	06/04/02	7.58		3.57	0.00	<50	<0.50	<0.50	<0.50	<0.50	<2.5
	09/03/02	9.17		1.98	0.00	<50	<0.50	<0.50	<0.50	<0.50	<2.5
	12/03/02 ²²	9.20		1.95	0.00	<50	<0.50	<0.50	<0.50	<1.0	<2.0
	03/04/03 ²²	9.32		1.83	0.00	<50	<0.50	<0.50	<0.50	<1.0	<2.0

Table 1
Groundwater Monitoring Data and Analytical Results
 Tosco (Unocal) Service Station #5325
 3220 Lakeshore Avenue
 Oakland, California

WELL ID/ TOC* (ft.)	DATE	DTW (ft.)	S.I. (ft. bgs)	GWE (ft.)	Product Thickness (ft.)	TPH-G (ppb)	B (ppb)	T (ppb)	E (ppb)	X (ppb)	MTBE (ppb)
U-5											
6.98	06/22/94	6.83	5.0-20.0	0.15	0.00	210	7.1	13	4.5	26	--
	09/22/94	6.90		0.08	0.00	170	8.4	10	8.5	18	--
	12/24/94	6.43		0.55	0.00	8,700	560	70	670	430	--
	03/25/95	6.35		0.63	0.00	44,000	390	960	1,500	7,600	--
	06/21/95	7.11		-0.13	0.00	400	2.3	ND	9.1	3.5	--
	09/19/95	6.99		-0.01	0.00	850	14	7.1	13	66	-- ⁵
	12/19/95	7.17		-0.19	0.00	ND	ND	ND	ND	ND	--
	03/18/96	6.65		0.33	0.00	100	0.67	0.5	0.51	5.4	--
	06/27/96	6.49		0.49	0.00	16,000	280	150	1,400	4,600	530
	09/26/96	7.13		-0.15	0.00	ND	ND	0.57	ND	0.96	ND
	12/09/96	5.90		1.08	0.00	1,300	29	46	ND	140	97
	03/14/97	6.99		-0.01	0.00	ND	ND	ND	ND	ND	14
	06/30/97	7.08		-0.10	0.00	4,200	74	51	180	980	270
	09/19/97	6.78		0.20	0.00	6,300	160	13	370	1000	480
	12/12/97	6.94		0.04	0.00	60	1.3	ND	1.6	2.1	47
	03/03/98	6.50		0.48	0.00	1,700	29	ND ⁷	150	190	330
	06/15/98	6.85		0.13	0.00	1,500	32	ND ⁷	91	83	330
	09/30/98	7.31		-0.33	0.00	1,700	44	ND ⁷	39	150	60
	12/28/98	7.25		-0.27	0.00	1,400	59	ND ⁷	13	27	150
	03/22/99	6.86		0.12	0.00	780	8.9	ND	0.76	4.5	350
	06/09/99	7.28		-0.30	0.00	1,000	ND ⁷	ND ⁷	10	35	280/350 ¹⁰
	09/08/99	7.52		-0.54	0.00	2,620 ¹¹	26.2	ND ⁷	32.2	157	280/239 ¹²
	12/07/99	7.67		-0.69	0.00	949 ¹¹	9.26	ND ⁷	11.2	22.7	235/301 ¹²
	03/13/00	6.73		0.25	0.00	880 ¹⁴	12	1.0	5.6	8.7	46/37 ¹⁰
	06/21/00	7.39		-0.41	0.00	700 ¹¹	4.0	ND	0.99	4.0	120/140 ¹⁰
	09/27/00	7.45		-0.47	0.00	400 ¹¹	1.9	ND	ND	1.5	160/250 ¹⁵
	12/12/00	7.68		-0.70	0.00	770 ¹¹	3.2	ND ⁷	ND ⁷	ND ⁷	27/13 ¹²
	03/07/01	6.83		0.15	0.00	623 ¹³	5.15	ND	ND	0.669	35.7/43.4 ¹⁰
	06/06/01	7.42		-0.44	0.00	110 ¹³	ND	ND	ND	ND	ND
	09/24/01	7.50		-0.52	0.00	270 ¹⁹	<0.50	<0.50	<0.50	<0.50	40/42 ¹⁰
	12/10/01	6.65		0.33	0.00	420 ¹⁸	13	0.60	0.66	<0.50	<2.5
	03/11/02	7.00		-0.02	0.00	260 ¹³	<0.50	<0.50	<0.50	<0.50	42/47 ¹⁰

Table 1
Groundwater Monitoring Data and Analytical Results
 Tosco (Unocal) Service Station #5325
 3220 Lakeshore Avenue
 Oakland, California

WELL ID/ TOC* (ft.)	DATE	DTW (ft.)	S.I. (ft. bgs)	GWE (ft.)	Product Thickness (ft.)	TPH-G (ppb)	B (ppb)	T (ppb)	E (ppb)	X (ppb)	MTBE (ppb)	
U-5 (cont)	06/04/02	6.71	5.0-20.0	0.27	0.00	170 ¹⁹	<0.50	0.77	0.87	0.69	29	
	09/03/02	7.47		-0.49	0.00	<50	<0.50	<0.50	<0.50	<0.50	37/53 ¹⁰	
	12/03/02 ²²	6.64		0.34	0.00	320	<0.50	<0.50	5.7	<1.0	11	
	03/04/03 ²²	6.75		0.23	0.00	100 ²¹	<0.50	<0.50	<0.50	<1.0	44	
U-6 7.14	06/22/94	7.14	5.0-24.0	0.00	0.00	ND	ND	ND	ND	ND	--	
	09/22/94	7.34		-0.20	0.00	130	1.3	0.8	ND	0.73	--	
	12/24/94	6.67		0.47	0.00	6,900	500	59	600	380	--	
	03/25/95	6.29		0.85	0.00	47,000	450	1,300	1,700	8,200	--	
	06/21/95	7.60		-0.46	0.00	ND	ND	ND	ND	ND	--	
	09/19/95	7.70		-0.56	0.00	ND	ND	ND	ND	ND	-- ⁵	
	12/19/95	7.75		-0.61	0.00	210	2.5	1.0	2.9	17	--	
	03/18/96	6.86		0.28	0.00	ND	ND	ND	ND	ND	--	
	06/27/96	6.52		0.62	0.00	ND	ND	ND	ND	ND	510	
	09/26/96	7.62		-0.48	0.00	ND	ND	ND	ND	ND	1,400	
	12/09/96	5.88		1.26	0.00	1,200	29	48	6.4	140	58	
	03/14/97	7.30		-0.16	0.00	ND	ND	ND	ND	ND	1,500	
	06/30/97	7.35		-0.21	0.00	ND	ND	ND	ND	ND	990	
	09/19/97	7.25		-0.11	0.00	ND	ND	ND	ND	ND	1,400	
	12/12/97	7.29		-0.15	0.00	ND	ND	ND	ND	ND	680	
	03/03/98	7.00		0.14	0.00	ND	ND	ND	ND	ND	1,600	
	06/15/98	7.18		-0.04	0.00	ND ⁷	ND ⁷	ND ⁷	ND ⁷	ND ⁷	ND ⁷	1,000
	09/30/98	7.90		-0.76	0.00	ND	ND	ND	ND	ND	ND	1,200
	12/28/98	7.79		-0.65	0.00	ND ⁷	ND ⁷	ND ⁷	ND ⁷	ND ⁷	ND ⁷	730
	03/22/99	7.47		-0.33	0.00	ND	ND	ND	ND	ND	ND	1,800
06/09/99	7.73	-0.59	0.00	ND ⁷	ND ⁷	ND ⁷	ND ⁷	ND ⁷	ND ⁷	1,000/850 ¹⁰		
09/08/99	7.95	-0.81	0.00	ND	ND	ND	ND	ND	ND	851/1,040 ¹⁰		
12/07/99	8.10	-0.96	0.00	ND	ND	ND	ND	ND	ND	1,140/1,150 ¹²		
03/13/00	6.95	0.19	0.00	ND	ND	ND	ND	ND	ND	560/670 ¹⁰		
06/21/00	7.84	-0.70	0.00	ND	ND	ND	ND	ND	ND	400/590 ¹⁰		
09/27/00	7.68	-0.54	0.00	ND	ND	ND	ND	ND	ND	2,500/2,800 ¹⁵		

Table 1
Groundwater Monitoring Data and Analytical Results
 Tosco (Unocal) Service Station #5325
 3220 Lakeshore Avenue
 Oakland, California

WELL ID/ TOC*(ft.)	DATE	DTW (ft.)	S.I. (ft. bgs)	GWE (ft.)	Product Thickness (ft.)	TPH-G (ppb)	B (ppb)	T (ppb)	E (ppb)	X (ppb)	MTBE (ppb)
U-6 (cont)	12/12/00	7.74	5.0-24.0	-0.60	0.00	ND	ND	ND	ND	ND	590/580 ¹²
	03/07/01	7.27		-0.13	0.00	ND	ND	ND	ND	ND	310/321 ¹²
	06/06/01	7.80		-0.66	0.00	ND	ND	ND	ND	ND	250/330 ¹²
	09/24/01	7.82		-0.68	0.00	<50	<0.50	<0.50	<0.50	<0.50	530/660 ¹⁰
	12/10/01	7.15		-0.01	0.00	<50	<0.50	<0.50	<0.50	<0.50	220/220 ¹⁰
	03/11/02	7.32		-0.18	0.00	<50	<0.50	<0.50	<0.50	<0.50	720/760 ¹⁰
	06/04/02	7.18		-0.04	0.00	250 ¹⁹	<1.0	<1.0	<1.0	<1.0	470
	09/03/02	7.72		-0.58	0.00	420 ²¹	<2.5	<2.5	<2.5	4.7	860/1,200 ¹⁰
	12/03/02 ²²	6.92		0.22	0.00	<500	<5.0	<5.0	<5.0	<10	870
	03/04/03 ²²	7.01		0.13	0.00	2,300 ²¹	<10	<10	<10	<20	2,700
Trip Blank											
TB-LB	03/03/98	--	--	--	--	ND	ND	ND	ND	ND	ND
	06/15/98	--	--	--	--	ND	ND	ND	ND	ND	ND
	09/30/98	--	--	--	--	ND	ND	1.7	ND	2.2	ND
	12/28/98	--	--	--	--	ND	ND	0.71	ND	0.72	9.5
	03/22/99	--	--	--	--	ND	ND	ND	ND	ND	ND
	06/09/99	--	--	--	--	ND	ND	ND	ND	ND	ND
	09/08/99	--	--	--	--	ND	ND	ND	ND	ND	ND
	12/07/99	--	--	--	--	ND	ND	0.762	ND	ND	ND
	03/13/00	--	--	--	--	ND	ND	ND	ND	ND	ND
	06/21/00	--	--	--	--	ND	ND	ND	ND	ND	ND
	09/27/00	--	--	--	--	ND	ND	ND	ND	ND	ND
	12/12/00	--	--	--	--	ND	ND	ND	ND	ND	ND
	03/07/01	--	--	--	--	ND	ND	ND	ND	ND	ND
	06/06/01	--	--	--	--	ND	ND	ND	ND	ND	ND
	09/24/01	--	--	--	--	<50	<0.50	<0.50	<0.50	<0.50	<2.5
	12/10/01	--	--	--	--	<50	<0.50	<0.50	<0.50	<0.50	<2.5
	03/11/02	--	--	--	--	<50	<0.50	<0.50	<0.50	<0.50	<5.0

Table 1
Groundwater Monitoring Data and Analytical Results
 Tosco (Unocal) Service Station #5325
 3220 Lakeshore Avenue
 Oakland, California

WELL ID/ TOC* (ft.)	DATE	DTW (ft.)	S.I. (ft. bgs)	GWE (ft.)	Product Thickness (ft.)	TPH-G (ppb)	B (ppb)	T (ppb)	E (ppb)	X (ppb)	MTBE (ppb)
QA	06/04/02	--	--	--	--	<50	<0.50	<0.50	<0.50	<0.50	<2.5
	09/03/02	--	--	--	--	<50	<0.50	0.83	<0.50	0.50	<2.5
	12/03/02 ²²	--	--	--	--	<50	<0.50	<0.50	<0.50	<1.0	<2.0
	03/04/03 ²²	--	--	--	--	<50	<0.50	<0.50	<0.50	<1.0	<2.0

Table 1
Groundwater Monitoring Data and Analytical Results
 Tosco (Unocal) Service Station #5325
 3220 Lakeshore Avenue
 Oakland, California

EXPLANATIONS:

Groundwater monitoring data and laboratory analytical results prior to March 3, 1998, were compiled from reports prepared by MPDS Services, Inc.

TOC = Top of Casing	TPH-G = Total Petroleum Hydrocarbons as Gasoline	(ppb) = Parts per billion
(ft.) = Feet	B = Benzene	ND = Not Detected
DTW = Depth to Water	T = Toluene	-- = Not Measured/Not Analyzed
S.I. = Screen Interval	E = Ethylbenzene	QA = Quality Assurance/Trip Blank
(ft. bgs) = Feet Below Ground Surface	X = Xylenes	
GWE = Groundwater Elevation	MTBE = Methyl tertiary butyl ether	

- * TOC elevations are surveyed relative to City of Oakland Benchmark, at the northeasterly corner of Weller and Cheney Avenue (Elevation = 9.055 feet, city datum; add 3.00' to U.S.G.S. datum). Prior to November 16, 1993, the DTW measurements were taken from the well cover.
- ** Groundwater elevation corrected due to the presence of free product; correction factor = [(TOC-DTW)+(Product Thickness x 0.75)].
- ¹ The positive result for gasoline does not appear to have a typical gasoline pattern.
- ² The concentration reported as gasoline is primarily due to the presence of a combination of gasoline and a discrete peak not indicative of gasoline.
- ³ Laboratory report indicates the hydrocarbons detected did not appear to be gasoline
- ⁴ Laboratory report indicates the hydrocarbons detected appeared to be a gasoline and non-gasoline mixture.
- ⁵ Laboratory has potentially identified the presence of MTBE at reportable levels in the groundwater sample collected from this well.
- ⁶ Laboratory has identified the presence of MTBE at a level above or equal to the taste and odor threshold of 40 ppb in the sample collected from this well.
- ⁷ Detection limit raised. Refer to analytical reports.
- ⁸ Laboratory report indicates unidentified hydrocarbons C6-C12.
- ⁹ Laboratory report indicates gasoline and unidentified hydrocarbons >C8.
- ¹⁰ MTBE by EPA Method 8260.
- ¹¹ Laboratory report indicates gasoline C6-C12.
- ¹² MTBE by EPA Method 8260 analyzed past the recommended holding time.
- ¹³ Laboratory report indicates weathered gasoline C6-C12.
- ¹⁴ Laboratory report indicates gasoline C6-C12 + unidentified hydrocarbons <C6.
- ¹⁵ Laboratory report indicates sample was originally analyzed within holding time. Re-analysis for confirmation or dilution was performed past the recommended holding time.
- ¹⁶ Laboratory report indicates gasoline C6-C12 + unidentified hydrocarbons >C10.
- ¹⁷ Skimmer present in well.
- ¹⁸ Laboratory report indicates gasoline C6-C10.
- ¹⁹ Laboratory report indicates unidentified hydrocarbons C6-C10.
- ²⁰ Skimmer not present in well.
- ²¹ Laboratory report indicates hydrocarbon pattern is present in the requested fuel quantitation range but does not resemble the pattern of the requested fuel.
- ²² TPH-G, BTEX and MTBE by EPA Method 8260.

Table 2
Groundwater Analytical Results - Oxygenate Compounds
 Tosco (Unocal) Service Station #5325
 3220 Lakeshore Avenue
 Oakland, California

WELL ID	DATE	ETHANOL (ppb)	TBA (ppb)	MTBE (ppb)	DIPE (ppb)	ETBE (ppb)	TAME (ppb)	1,2-DCA (ppb)	EDB (ppb)
U-1	09/27/00 ¹	--	ND ²	83,000	ND ²	ND ²	ND ²	ND ²	ND ²
	12/12/00	--	--	15,000 ³	--	--	--	--	--
	03/07/01	ND ²	ND ²	11,800	ND ²	ND ²	ND ²	ND ²	ND ²
	06/06/01 ³	ND ²	ND ²	8,700	ND ²	ND ²	ND ²	ND ²	ND ²
	09/24/01	<400,000	<20,000	4,400	<1,000	<1,000	<1,000	<1,000	<1,000
	12/10/01	<8,000	<4,000	5,100	<100	<100	<100	<100	<100
	03/11/02	<25,000	<5,000	6,300	<100	<100	<100	<100	<100
	06/04/02 ⁴	--	--	--	--	--	--	--	--
	09/03/02	<50,000	<10,000	4,700	<200	<200	<200	<200	<200
	12/03/02	<50,000	<10,000	4,700	<200	<200	<200	<200	<200
	03/04/03	<25,000	<5,000	5,500	<100	<100	<100	<100	<100
	U-2	09/27/00	--	--	26,000 ¹	--	--	--	--
12/12/00		--	--	7,800 ³	--	--	--	--	--
03/07/01		ND ²	ND ²	7,900	ND ²	ND ²	ND ²	ND ²	ND ²
06/06/01 ³		ND ²	ND ²	10,000	ND ²	ND ²	ND ²	ND ²	ND ²
09/24/01		<400,000	<20,000	11,000	<1,000	<1,000	<1,000	<1,000	<1,000
12/10/01		<4,000	<2,000	2,500	<50	<50	<50	<50	<50
03/11/02		<50,000	<10,000	11,000	<200	<200	<200	<200	<200
06/04/02 ⁴		--	--	--	--	--	--	--	--
09/03/02		<250,000	<50,000	15,000	<1,000	<1,000	<1,000	<1,000	<1,000
12/03/02		<50,000	<10,000	3,200	<200	<200	<200	<200	<200
03/04/03		<50,000	<10,000	7,800	<200	<200	<200	<200	<200
U-3		12/03/02	--	--	<2.0	--	--	--	--
	03/04/03	--	--	<2.0	--	--	--	--	--
U-4	12/03/02	--	--	<2.0	--	--	--	--	--
	03/04/03	--	--	<2.0	--	--	--	--	--

Table 2
Groundwater Analytical Results - Oxygenate Compounds
 Tosco (Unocal) Service Station #5325
 3220 Lakeshore Avenue
 Oakland, California

WELL ID	DATE	ETHANOL (ppb)	TBA (ppb)	MTBE (ppb)	DIPE (ppb)	ETBE (ppb)	TAME (ppb)	1,2-DCA (ppb)	EDB (ppb)
U-5	09/27/00	--	--	250 ¹	--	--	--	--	--
	12/12/00	--	--	13 ³	--	--	--	--	--
	03/07/01	ND	ND	43.4	ND	ND	ND	ND	ND
	09/24/01	<4,000	<200	42	<10	<10	<10	<10	<10
	03/11/02	<500	<100	47	<2.0	<2.0	<2.0	<2.0	<2.0
	06/04/02 ⁴	--	--	--	--	--	--	--	--
	09/03/02	<500	<100	53	<2.0	<2.0	<2.0	<2.0	<2.0
	12/03/02	<500	<100	11	<2.0	<2.0	<2.0	<2.0	<2.0
	03/04/03	<500	<100	44	<2.0	<2.0	<2.0	<2.0	<2.0
U-6	09/27/00	--	--	2,800 ¹	--	--	--	--	--
	12/12/00	--	--	580 ³	--	--	--	--	--
	03/07/01 ³	ND ²	ND ²	321	ND ²	ND ²	ND ²	ND ²	ND ²
	06/06/01 ³	ND ²	ND ²	330	ND ²	ND ²	ND ²	ND ²	ND ²
	09/24/01	<40,000	<2,000	660	<100	<100	<100	<100	<100
	12/10/01	<400	<200	220	<5.0	<5.0	<5.0	<5.0	<5.0
	03/11/02	<2,000	<400	760	<8.0	<8.0	<8.0	<8.0	<8.0
	06/04/02 ⁴	--	--	--	--	--	--	--	--
	09/03/02	<10,000	<2,000	1,200	<40	<40	<40	<40	<40
	12/03/02	<5,000	<1,000	870	<20	<20	<20	<20	<20
03/04/03	<10,000	<2,000	2,700	<40	<40	<40	<40	<40	

Table 2
Groundwater Analytical Results - Oxygenate Compounds
Tosco (Unocal) Service Station #5325
3220 Lakeshore Avenue
Oakland, California

EXPLANATIONS:

TBA = Tertiary butyl alcohol
MTBE = Methyl tertiary butyl ether
DIPE = Di-isopropyl ether
ETBE = Ethyl tertiary butyl ether
TAME = Tertiary amyl methyl ether
1,2-DCA = 1,2-Dichloroethane
EDB = 1,2-Dibromoethane
(ppb) = Parts per billion
ND = Not Detected
-- = Not Analyzed

ANALYTICAL METHOD:

EPA Method 8260 for Oxygenate Compounds

- ¹ Laboratory report indicates sample was originally analyzed within holding time. Re-analysis for confirmation or dilution was performed past the recommended holding time.
- ² Detection limit raised. Refer to analytical reports.
- ³ Laboratory report indicates sample was analyzed outside the EPA recommended holding time.
- ⁴ Due to Laboratory error, samples for oxygenate (8260) analyses was not performed.

Table 3
Field Measurements and Groundwater Analytical Results
 Tosco (Unocal) Service Station #5325
 3220 Lakeshore Avenue
 Oakland, California

WELL ID	DATE	Ferrous Iron (ppm)	Nitrate as NO ₃ (ppm)	Phosphate as PO ₄ (ppm)	ORP (mV)	D.O. Before Purge (mg/L)
U-1	06/15/98	39	ND	ND	382 ²	--
	09/30/98	17	ND	ND	366 ²	--
	12/28/98	4.3	6.3	28	298 ²	--
	03/22/99	4.9	ND	3.5	320 ³	--
	06/09/99	1.2	ND	ND	260 ³	--
	09/08/99	1.80	ND ¹	ND ¹	85 ³	--
	12/07/99	5.70	ND ¹	17.0	404 ³	1.36
	03/13/00	8.0	0.18	ND	² 117/ ²⁶² 3	--
	06/21/00	9.3	ND ¹	ND ¹	148 ²	1.53
	09/27/00	2.8	ND ¹	18.4	119 ²	1.63
	12/12/00	0.49	ND ¹	16.0	131 ²	1.48
	03/07/01	0.483	2.64	6.89	125 ²	1.91
	06/06/01	1.0 ⁴	ND	2.7	141 ²	1.77
	09/24/01	<0.10	0.45 ⁵	--	125 ²	1.64
	12/10/01	14	<0.50	2.2	141 ²	1.82
	03/11/02	15	<0.50	0.11	132 ²	2.21
	06/04/02	<0.50	<0.50	<0.10	117 ²	1.88
	09/03/02	<0.50	<0.50	<0.10	94 ²	1.62
	12/03/02	9.6	<1.0	<1.0	72 ²	1.71
	03/04/03	36	<1.0	<1.0	-125 ²	0.30
U-2	03/03/98	25	ND	ND	369 ²	--
	06/15/98	42	ND	ND	341 ²	--
	09/30/98	25	ND	ND	354 ²	--
	12/28/98	28	ND	ND	276 ²	--
	03/22/99	0.68	ND	2.3	320 ³	--
	06/09/99	0.50	ND	ND	290 ³	--
	09/08/99	1.90	ND ¹	ND ¹	235 ³	--
	12/07/99	0.250	ND ¹	ND ¹	389 ³	2.28
	03/13/00	4.3	0.31	ND	² 121/ ¹⁸⁴ 3	--
	06/21/00	0.26	ND ¹	ND ¹	136 ²	1.96
	09/27/00	0.64	ND ¹	10.5	142 ²	2.12
	12/12/00	2.7	ND ¹	ND ¹	155 ²	2.35
	03/07/01	0.677	2.24	3.02	148 ²	2.21
	06/06/01	0.80 ⁴	ND	2.8	163 ²	2.67
	09/24/01	<0.10	0.49 ⁵	--	151 ²	2.10
	12/10/01	<0.10	<0.50	0.20	171 ²	2.81
	03/11/02	<0.10	<0.50	0.65	156 ²	2.77
	06/04/02	<0.10	<0.50	<0.10	144 ²	3.14
	09/03/02	<0.25	<0.50	0.26	151 ²	2.85
	12/03/02	9.9	<1.0	<1.0	94 ²	1.97
03/04/03	8.6	<1.0	<1.0	-147 ²	0.40	

Table 3
Field Measurements and Groundwater Analytical Results
 Tosco (Unocal) Service Station #5325
 3220 Lakeshore Avenue
 Oakland, California

WELL ID	DATE	Ferrous Iron (ppm)	Nitrate as NO3 (ppm)	Phosphate as PO4 (ppm)	ORP (mV)	D.O. Before Purge (mg/L)
U-6	03/13/00	0.79	0.26	ND	² 68/222 ³	--
(cont)	06/21/00	1.9	ND ¹	ND ¹	159 ²	3.27
	09/27/00	2.6	ND ¹	ND ¹	170 ²	3.49
	12/12/00	ND	2.7	ND ¹	128 ²	3.06
	03/07/01	2.52	3.11	37.0	117 ²	2.85
	06/06/01	0.47 ⁴	0.15	0.70	97 ²	2.46
	09/24/01	<0.10	0.58 ⁵	--	123 ²	3.10
	12/10/01	0.99	0.50	2.0	112 ²	2.57
	03/11/02	1.2	<0.50	0.089	128 ²	3.03
	06/04/02	<0.10	<0.50	<1.0	97 ²	2.84
	09/03/02	<0.10	0.58	1.1	110 ²	3.12
	12/03/02	1.2	<1.0	2.6	95 ²	2.96
	03/04/03	20	<1.0	<1.0	-112 ²	0.30

Table 3
Field Measurements and Groundwater Analytical Results
Tosco (Unocal) Service Station #5325
3220 Lakeshore Avenue
Oakland, California

EXPLANATIONS:

Groundwater analytical results prior to March 3, 1998, were compiled from reports prepared by MPDS Services, Inc.

ORP = Oxidation Reduction Potential

(mV) = millivolts

D.O. = Dissolved Oxygen

(mg/L) = milligrams per liter

(ppm) = Parts per million

ND = Not Detected

-- = Not Measured/Not Analyzed

- ¹ Detection limit raised. Refer to analytical reports.
- ² Field measurement.
- ³ Analyzed by laboratory.
- ⁴ Due to the transfer of samples from one laboratory to another laboratory; the sample was received beyond the EPA recommended holding time.
- ⁵ Laboratory report indicates the sample was analyzed beyond the EPA recommended holding time.

ANALYTICAL METHODS:

Ferrous Iron by Hach method 8146/1;10 Phenanthroline Method

Nitrate as NO₃ by EPA Method 300.0

Phosphate as PO₄ by EPA Method 300.0

STANDARD OPERATING PROCEDURE - GROUNDWATER SAMPLING

Gettler-Ryan Inc. field personnel adhere to the following procedures for the collection and handling of groundwater samples prior to analysis by the analytical laboratory. Prior to sample collection, the type of analysis to be performed is determined. Loss prevention of volatile compounds is controlled and sample preservation for subsequent analysis is maintained.

Prior to sampling, the presence or absence of free-phase hydrocarbons is determined using an interface probe. Product thickness, if present, is measured to the nearest 0.01 foot and is noted in the field notes. In addition, all depth to water level measurements are collected with a static water level indicator and are also recorded in the field notes, prior to purging and sampling any wells.

After water levels are collected and prior to sampling, temperature, pH and electrical conductivity are measured. If purging is to occur, each well is purged a minimum of three well casing volumes of water using pre-cleaned pumps (stack, suction, Grundfos), or disposable bailers. The measurements are taken a minimum of three times during the purging. Purging continues until these parameters stabilize.

Groundwater samples are collected using disposable bailers. The water samples are transferred from the bailer into appropriate containers. Pre-preserved containers, supplied by analytical laboratories, are used when possible. When pre-preserved containers are not available, the laboratory is instructed to preserve the sample as appropriate. Duplicate samples are collected for the laboratory to use in maintaining quality assurance/quality control standards. The samples are labeled to include the job number, sample identification, collection date and time, analysis, preservation (if any), and the sample collector's initials. The water samples are placed in a cooler, maintained at 4°C for transport to the laboratory. Once collected in the field, all samples are maintained under chain of custody until delivered to the laboratory.

The chain of custody document includes the job number, type of preservation, if any, analysis requested, sample identification, date and time collected, and the sample collector's name. The chain of custody is signed and dated (including time of transfer) by each person who receives or surrenders the samples, beginning with the field personnel and ending with the laboratory personnel.

A laboratory supplied trip blank accompanies each sampling set and is labeled as QA. For sampling sets greater than 20 samples, 5% trip blanks are included. The trip blank is analyzed for some or all of the same compounds as the groundwater samples.

As requested by Phillips 66 Company, the purge water and decontamination water generated during sampling activities is transported to Phillips 66 - San Francisco Refinery, located in Rodeo, California.



GETTLER-RYAN INC.

WELL MONITORING/SAMPLING FIELD DATA SHEET

Client/Facility #: ConocoPhillips#5325
 Site Address: 3220 Lakeshore Avenue
 City: Oakland, CA

Job Number: 180061
 Event Date: 3-4-03 (inclusive)
 Sampler: D.O.

Well ID: U-1 Date Monitored: 3-4 Well Condition: OK

Well Diameter: 2 1/4 in.

Total Depth: 19.65 ft.

Depth to Water: 8.29 ft.

Volume	3/4" = 0.02	1" = 0.04	2" = 0.17	3" = 0.38
Factor (VF)	4" = 0.66	5" = 1.02	6" = 1.50	12" = 5.80

11.36 xVF 38 = 4.31 x3 (case volume) = Estimated Purge Volume: 13 gal.

Purge Equipment:
 Disposable Bailer _____
 Stainless Steel Bailer _____
 Stack Pump _____
 Suction Pump x
 Grundfos _____
 Other: _____

Sampling Equipment:
 Disposable Bailer _____
 Pressure Bailer x
 Discrete Bailer _____
 Other: _____

Time Started: _____ (2400 hrs)
 Time Bailed: _____ (2400 hrs)
 Depth to Product: _____ ft
 Depth to Water: _____ ft
 Hydrocarbon Thickness: _____ ft
 Visual Confirmation/Description: _____
 Skimmer / Absorbant Sock (circle one)
 Amt Removed from Skimmer: _____ gal
 Amt Removed from Well: _____ gal
 Product Transferred to: _____

Start Time (purge): 1215 Weather Conditions: clear
 Sample Time/Date: 1231 13-4-03 Water Color: clear Odor: yes
 Purging Flow Rate: 2 gpm. Sediment Description: _____
 Did well de-water? no If yes, Time: _____ Volume: _____ gal.

Time (2400 hr.)	Volume (gal.)	pH	Conductivity (umhos/cm)	Temperature (°F)	D.O. (mg/L)	ORP (mV)
<u>1218</u>	<u>4.5</u>	<u>7.17</u>	<u>446</u>	<u>18.4</u>	<u>0.3</u>	<u>-125</u>
<u>1221</u>	<u>9</u>	<u>7.12</u>	<u>452</u>	<u>18.2</u>		
<u>1223</u>	<u>13</u>	<u>7.08</u>	<u>456</u>	<u>18.1</u>		

LABORATORY INFORMATION

SAMPLE ID	(#) CONTAINER	REFRIG.	PRESERV. TYPE	LABORATORY	ANALYSES
<u>U-1</u>	<u>3 x vovial</u>	<u>YES</u>	<u>HCL</u>	<u>STL Pleasanton</u>	<u>TPH-G/BTEX/MTBE(8260)</u>
	<u>1 x 500ml Poly</u>	<u>YES</u>	<u>NP</u>	<u>STL Pleasanton</u>	<u>Nitrate/Phosphate</u>
	<u>1 x 250ml Poly</u>	<u>YES</u>	<u>HNO3</u>	<u>STL Pleasanton</u>	<u>Ferrous Iron</u>

COMMENTS: _____
 Add/Replaced Lock: _____ Add/Replaced Plug: _____ Size: _____



GETTLER-RYAN INC.

WELL MONITORING/SAMPLING FIELD DATA SHEET

Client/Facility #: ConocoPhillips#5325 Job Number: 180061
 Site Address: 3220 Lakeshore Avenue Event Date: 3-4-03 (inclusive)
 City: Oakland, CA Sampler: D.O.

Well ID: U-2 Date Monitored: 3-4-03 Well Condition: OK
 Well Diameter: 21 3/4 in.
 Total Depth: 19.62 ft.
 Depth to Water: 7.77 ft.
11.85 xVF .38 = 4.50 x3 (case volume) = Estimated Purge Volume: 13.5 gal.

Volume Factor (VF)	3/4" = 0.02	1" = 0.04	2" = 0.17	3" = 0.38
	4" = 0.66	5" = 1.02	6" = 1.50	12" = 5.80

Purge Equipment:
 Disposable Bailer _____
 Stainless Steel Bailer _____
 Stack Pump _____
 Suction Pump 8
 Grundfos _____
 Other: _____

Sampling Equipment:
 Disposable Bailer _____
 Pressure Bailer X
 Discrete Bailer _____
 Other: _____

Time Started: _____ (2400 hrs)
 Time Bailed: _____ (2400 hrs)
 Depth to Product: _____ ft
 Depth to Water: _____ ft
 Hydrocarbon Thickness: _____ ft
 Visual Confirmation/Description: _____
 Skimmer / Absorbant Sock (circle one)
 Amt Removed from Skimmer: _____ gal
 Amt Removed from Well: _____ gal
 Product Transferred to: _____

Start Time (purge): 1142 Weather Conditions: clear
 Sample Time/Date: 1158 / 3-4-03 Water Color: clear Odor: no
 Purging Flow Rate: ~2 gpm. Sediment Description: _____
 Did well de-water? no If yes, Time: _____ Volume: _____ gal.

Time (2400 hr.)	Volume (gal.)	pH	Conductivity (umhos/cm)	Temperature (°F)	D.O. (mg/L)	ORP (mV)
<u>1145</u>	<u>4.5</u>	<u>7.33</u>	<u>598</u>	<u>17.1</u>	<u>0.4</u>	<u>-147</u>
<u>1147</u>	<u>9</u>	<u>7.27</u>	<u>589</u>	<u>17.2</u>		
<u>1150</u>	<u>13.5</u>	<u>7.23</u>	<u>582</u>	<u>17.3</u>		

LABORATORY INFORMATION

SAMPLE ID	(#) CONTAINER	REFRIG.	PRESERV. TYPE	LABORATORY	ANALYSES
<u>U-2</u>	<u>2 x vov vial</u>	<u>YES</u>	<u>HCL</u>	<u>STL Pleasanton</u>	<u>TPH-G/BTEX/MTBE(8260)</u>
	<u>1 x 500ml Poly</u>	<u>YES</u>	<u>NP</u>	<u>STL Pleasanton</u>	<u>Nitrate/Phosphate</u>
	<u>1 x 250ml Poly</u>	<u>YES</u>	<u>HNO3</u>	<u>STL Pleasanton</u>	<u>Ferrous Iron</u>

COMMENTS: _____
 Add/Replaced Lock: _____ Add/Replaced Plug: _____ Size: _____



GETTLER-RYAN INC.

WELL MONITORING/SAMPLING FIELD DATA SHEET

Client/Facility #: ConocoPhillips#5325 Job Number: 180061
 Site Address: 3220 Lakeshore Avenue Event Date: 3-4-03 (inclusive)
 City: Oakland, CA Sampler: D.O.

Well ID: U-3 Date Monitored: 3-4-03 Well Condition: OK
 Well Diameter: 210/4 in.
 Total Depth: 19.33 ft.
 Depth to Water: 10.76 ft.
 $8.57 \times VF = 3.8 = 3.25 \times 3$ (case volume) = Estimated Purge Volume: 10 gal.

Volume	3/4"= 0.02	1"= 0.04	2"= 0.17	3"= 0.38
Factor (VF)	4"= 0.66	5"= 1.02	6"= 1.50	12"= 5.80

Purge Equipment:
 Disposable Bailer _____
 Stainless Steel Bailer _____
 Stack Pump _____
 Suction Pump X
 Grundfos _____
 Other: _____

Sampling Equipment:
 Disposable Bailer _____
 Pressure Bailer X
 Discrete Bailer _____
 Other: _____

Time Started: _____ (2400 hrs)
 Time Bailed: _____ (2400 hrs)
 Depth to Product: _____ ft
 Depth to Water: _____ ft
 Hydrocarbon Thickness: _____ ft
 Visual Confirmation/Description: _____
 Skimmer / Absorbent Sock (circle one)
 Amt Removed from Skimmer: _____ gal
 Amt Removed from Well: _____ gal
 Product Transferred to: _____

Start Time (purge): 1003 Weather Conditions: clear
 Sample Time/Date: 1018 13-4-03 Water Color: clear Odor: No
 Purging Flow Rate: ≈ 2 gpm. Sediment Description: _____
 Did well de-water? no If yes, Time: _____ Volume: _____ gal.

Time (2400 hr.)	Volume (gal.)	pH	Conductivity (umhos/cm)	Temperature (°F)	D.O. (mg/L)	ORP (mV)
<u>1005</u>	<u>3.5</u>	<u>7.26</u>	<u>481</u>	<u>19.2</u>	<u>0.2</u>	<u>-136</u>
<u>1007</u>	<u>7</u>	<u>7.21</u>	<u>475</u>	<u>19.1</u>		
<u>1009</u>	<u>10</u>	<u>7.18</u>	<u>472</u>	<u>19.1</u>		

LABORATORY INFORMATION

SAMPLE ID	(#) CONTAINER	REFRIG.	PRESERV. TYPE	LABORATORY	ANALYSES
<u>U-3</u>	<u>3 x vov vial</u>	<u>YES</u>	<u>HCL</u>	<u>STL Pleasanton</u>	<u>TPH-G/BTEX/MTBE(8260)</u>
	<u>1 x 500ml Poly</u>	<u>YES</u>	<u>NP</u>	<u>STL Pleasanton</u>	<u>Nitrate/Phosphate</u>
	<u>1 x 250ml Poly</u>	<u>YES</u>	<u>HNO3</u>	<u>STL Pleasanton</u>	<u>Ferrous Iron</u>

COMMENTS: _____

Add/Replaced Lock: _____ Add/Replaced Plug: _____ Size: _____



GETTLER - RYAN INC.

WELL MONITORING/SAMPLING FIELD DATA SHEET

Client/Facility #: ConocoPhillips#5325 Job Number: 180061
 Site Address: 3220 Lakeshore Avenue Event Date: 3-7-03 (inclusive)
 City: Oakland, CA Sampler: J.O.

Well ID: U-4 Date Monitored: 3-4-03 Well Condition: OK
 Well Diameter: 2 1/3 1/4 in.
 Total Depth: 20.16 ft.
 Depth to Water: 9.32 ft.
10.84 xVF .66 = 7.15 x3 (case volume) = Estimated Purge Volume: 21.5 gal.

Volume	3/4"= 0.02	1"= 0.04	2"= 0.17	3"= 0.38
Factor (VF)	4"= 0.66	5"= 1.02	6"= 1.50	12"= 5.80

Purge Equipment:
 Disposable Bailor _____
 Stainless Steel Bailor _____
 Stack Pump _____
 Suction Pump x
 Grundfos _____
 Other: _____

Sampling Equipment:
 Disposable Bailor x
 Pressure Bailor x
 Discrete Bailor _____
 Other: _____

Time Started: _____ (2400 hrs)
 Time Bailed: _____ (2400 hrs)
 Depth to Product: _____ ft
 Depth to Water: _____ ft
 Hydrocarbon Thickness: _____ ft
 Visual Confirmation/Description: _____
 Skimmer / Absorbant Sock (circle one)
 Amt Removed from Skimmer: _____ gal
 Amt Removed from Well: _____ gal
 Product Transferred to: _____

Start Time (purge): 1034 Weather Conditions: clear
 Sample Time/Date: 1054 3-4-03 Water Color: clear Odor: no
 Purging Flow Rate: ≈ 2 gpm. Sediment Description: _____
 Did well de-water? no If yes, Time: _____ Volume: _____ gal.

Time (2400 hr.)	Volume (gal.)	pH	Conductivity (u mhos/cm)	Temperature (°C)	D.O. (mg/L)	ORP (mV)
<u>1038</u>	<u>7</u>	<u>7.88</u>	<u>182</u>	<u>18.0</u>	<u>0.3</u>	<u>-148</u>
<u>1041</u>	<u>14</u>	<u>7.91</u>	<u>176</u>	<u>17.9</u>		
<u>1045</u>	<u>21.5</u>	<u>7.76</u>	<u>174</u>	<u>17.9</u>		

LABORATORY INFORMATION

SAMPLE ID	(#) CONTAINER	REFRIG.	PRESERV. TYPE	LABORATORY	ANALYSES
<u>U-4</u>	<u>3 x vov vial</u>	<u>YES</u>	<u>HCL</u>	<u>STL Pleasanton</u>	<u>TPH-G/BTEX/MTBE(8260)</u>
	<u>1 x 500ml Poly</u>	<u>YES</u>	<u>NP</u>	<u>STL Pleasanton</u>	<u>Nitrate/Phosphate</u>
	<u>1 x 250ml Poly</u>	<u>YES</u>	<u>HNO3</u>	<u>STL Pleasanton</u>	<u>Ferrous Iron</u>

COMMENTS: _____

Add/Replaced Lock: _____ Add/Replaced Plug: _____ Size: _____



GETTLER - RYAN INC.

WELL MONITORING/SAMPLING FIELD DATA SHEET

Client/Facility #: ConocoPhillips#5325 Job Number: 180061
 Site Address: 3220 Lakeshore Avenue Event Date: 3-4-03 (inclusive)
 City: Oakland, CA Sampler: D.O.

Well ID: U-6 Date Monitored: 3-4-03 Well Condition: OK
 Well Diameter: 23 1/4 in.
 Total Depth: 23.74 ft.
 Depth to Water: 7.01 ft.
16.73 x VF .17 = 2.84 x3 (case volume) = Estimated Purge Volume: 8.5 gal.

Volume	3/4"= 0.02	1"= 0.04	2"= 0.17	3"= 0.38
Factor (VF)	4"= 0.66	5"= 1.02	6"= 1.50	12"= 5.80

Purge Equipment:
 Disposable Bailer X
 Stainless Steel Bailer _____
 Stack Pump _____
 Suction Pump _____
 Grundfos _____
 Other: _____

Sampling Equipment:
 Disposable Bailer _____
 Pressure Bailer X
 Discrete Bailer _____
 Other: _____

Time Started: _____ (2400 hrs)
 Time Bailed: _____ (2400 hrs)
 Depth to Product: _____ ft
 Depth to Water: _____ ft
 Hydrocarbon Thickness: _____ ft
 Visual Confirmation/Description: _____
 Skimmer / Absorbant Sock (circle one)
 Amt Removed from Skimmer: _____ gal
 Amt Removed from Well: _____ gal
 Product Transferred to: _____

Start Time (purge): 1250 Weather Conditions: clear
 Sample Time/Date: 1314 13-4-03 Water Color: brown Odor: yes
 Purging Flow Rate: - gpm. Sediment Description: -
 Did well de-water? no If yes, Time: _____ Volume: _____ gal.

Time (2400 hr.)	Volume (gal.)	pH	Conductivity (umhos/cm)	Temperature (CF)	D.O. (mg/L)	ORP (mV)
<u>1255</u>	<u>3</u>	<u>7.01</u>	<u>598</u>	<u>16.4</u>	<u>0.3</u>	<u>-112</u>
<u>1301</u>	<u>6</u>	<u>6.98</u>	<u>602</u>	<u>16.5</u>		
<u>1306</u>	<u>8.5</u>	<u>6.96</u>	<u>600</u>	<u>16.7</u>		

LABORATORY INFORMATION

SAMPLE ID	(#) CONTAINER	REFRIG.	PRESERV. TYPE	LABORATORY	ANALYSES
<u>U-6</u>	<u>3</u> x vva vial	<u>YES</u>	<u>HCL</u>	<u>STL Pleasanton</u>	<u>TPH-G/BTEX/MTBE(8260)</u>
	<u>1</u> x 500ml Poly	<u>YES</u>	<u>NP</u>	<u>STL Pleasanton</u>	<u>Nitrate/Phosphate</u>
	<u>1</u> x 250ml Poly	<u>YES</u>	<u>HNO3</u>	<u>STL Pleasanton</u>	<u>Ferrous Iron</u>

COMMENTS: _____
 Add/Replaced Lock: _____ Add/Replaced Plug: _____ Size: _____



GETTLER - RYAN INC.

WELL MONITORING/SAMPLING FIELD DATA SHEET

Client/Facility #: ConocoPhillips#5325 Job Number: 180061
 Site Address: 3220 Lakeshore Avenue Event Date: 3-4-03 (inclusive)
 City: Oakland, CA Sampler: D.O.

Well ID: U-5 Date Monitored: 3-4-03 Well Condition: OK
 Well Diameter: 213/4 in.
 Total Depth: 20.06 ft.
 Depth to Water: 6.75 ft.
 13.31 xVF .66 = 8.78 x3 (case volume) = Estimated Purge Volume: 26.5 gal.

Volume Factor (VF)	3/4"= 0.02	1"= 0.04	2"= 0.17	3"= 0.38
	4"= 0.66	5"= 1.02	6"= 1.50	12"= 5.80

Purge Equipment:
 Disposable Bailer _____
 Stainless Steel Bailer _____
 Stack Pump _____
 Suction Pump X
 Grundfos _____
 Other: _____

Sampling Equipment:
 Disposable Bailer _____
 Pressure Bailer X
 Discrete Bailer _____
 Other: _____

Time Started: _____ (2400 hrs)
 Time Bailed: _____ (2400 hrs)
 Depth to Product: _____ ft
 Depth to Water: _____ ft
 Hydrocarbon Thickness: _____ ft
 Visual Confirmation/Description: _____
 Skimmer / Absorbant Sock (circle one)
 Amt Removed from Skimmer: _____ gal
 Amt Removed from Well: _____ gal
 Product Transferred to: _____

Start Time (purge): 1108 Weather Conditions: clear
 Sample Time/Date: 1125 3-4-03 Water Color: clear Odor: nr
 Purging Flow Rate: ≈3 gpm. Sediment Description: _____
 Did well de-water? no If yes, Time: _____ Volume: _____ gal.

Time (2400 hr.)	Volume (gal.)	pH	Conductivity (umhos/cm)	Temperature (°F)	D.O. (mg/L)	ORP (mV)
<u>1111</u>	<u>9</u>	<u>7.14</u>	<u>754</u>	<u>16.8</u>	<u>0.2</u>	<u>-166</u>
<u>1114</u>	<u>18</u>	<u>7.07</u>	<u>789</u>	<u>16.9</u>		
<u>1117</u>	<u>26.5</u>	<u>7.02</u>	<u>761</u>	<u>16.8</u>		

LABORATORY INFORMATION

SAMPLE ID	(#) CONTAINER	REFRIG.	PRESERV. TYPE	LABORATORY	ANALYSES
<u>U-5</u>	<u>3 x voa vial</u>	<u>YES</u>	<u>HCL</u>	<u>STL Pleasanton</u>	<u>TPH-G/BTEX/MTBE(8260)</u>
	<u>1 x 500ml Poly</u>	<u>YES</u>	<u>NP</u>	<u>STL Pleasanton</u>	<u>Nitrate/Phosphate</u>
	<u>1 x 250ml Poly</u>	<u>YES</u>	<u>HNO3</u>	<u>STL Pleasanton</u>	<u>Ferrous Iron</u>

COMMENTS: _____

Add/Replaced Lock: _____ Add/Replaced Plug: _____ Size: _____

2003-03-0069

72410
Gettler-Ryan Inc., Chain-of-Custody

Mar 24 03 04:49P

st1Onsite

9256003002

P.1

Tosco Corp./ Phillips 66 Co. 100 Crow Canyon Place Suite 400 San Ramon, CA 94583	Facility Number <u>#5325</u>	Laboratory Name <u>STL PLEASANTON</u>
	Facility Address <u>3220 Lakeshore Avenue, Oakland, CA</u>	Consultant <u>GETTLER-RYAN INC.</u> <u>DEANNA L. BARDING</u>
	Global ID <u>T0600101463</u> Project <u>180061.80</u>	Address <u>6747 SIERRA CT., SUITE J, DUBLIN, CA 94568</u>
	Client Contact <u>David DeWitt</u>	Phone <u>925-551-7555</u> Fax <u>925-551-7899</u>
	Phone <u>925-277-2384</u>	Samples Collected by <u>David Okimoto</u>

SAMPLE ID	Number of Containers Matrix	S = Soil W = Water A = Air C = Charcoal	Sample Preservation	Date/Time (2400 Hrs)	TPH-GAS/BTEX/MTBE EPA 8015/8021B	TPH-DIESEL EPA 8015	TPH-DIESEL: n/SIBCAI gal EPA 8015	TPH-GAS EPA 8015	TPH-GAS/BTEX/MTBE EPA 8260	OXYGENATES EPA 8260	METHANOL EPA 8015	TOTAL OIL & GREASE EPA 8260	METALS Cd, Cr, Pb, Zn, Ni	NITRATE/SULFATE/ALKALINITY EPA 300 SERIES	HMOCS (8010) EPA 8021B	VOC'S (8240) EPA 8260	SMOCS EPA 8270	Nitrate/Phosphate	Ferrous Iron	Remarks
QA	1	W	HCL	3-4-03 / —				X												Run 8 Oxy's by 8260 on all 8260 MTBE hits.
V-1	5		HCL	/1231				X										X	X	Ferrous Iron has been filtered and preserved.
V-2	5			/1108				X										X	X	
V-3	5			/1018				X										X	X	
V-4	5			/1054				X										X	X	
V-5	5			/1125				X										X	X	
V-6	5	W	W	/1314				X												

Inquired By (Signature) <i>David Okimoto</i>	Organization <u>G.R.</u>	Date/Time <u>3-4-03/1415</u>	Received By (Signature)	Organization	Date/Time	iced Y/N	Turn Around Time (Circle Choice) 24 Hrs. 48 Hrs. 72 Hrs. 5 Days 10 Days <u>As Contracted</u>
Inquired By (Signature)	Organization	Date/Time	Received By (Signature)	Organization	Date/Time	iced Y/N	
Inquired By (Signature)	Organization	Date/Time	Received For Laboratory By (Signature) <i>[Signature]</i>		Date/Time <u>3-5-3</u>	iced Y/N <u>1305</u>	

Gettler Ryan

March 24, 2003

6747 Sierra Court Suite J
Dublin, CA 94568

Attn.: Deanna Harding

Project#: 180061.80

Project: Tosco #5325

Site: 3220 Lakeshore Avenue
Oakland, CA

STL
SEVERN TRENT LABORATORIES

Dear Ms. Harding,

Attached is our report for your samples received on 03/05/2003 13:05

This report has been reviewed and approved for release. Reproduction of this report is permitted only in its entirety.

Please note that any unused portion of the samples will be discarded after 04/19/2003 unless you have requested otherwise.

We appreciate the opportunity to be of service to you. If you have any questions, please call me at (925) 484-1919.

You can also contact me via email. My email address is: tgranicher@stl-inc.com

Sincerely,



Tod Granicher
Project Manager

Gas/BTEX Fuel Oxygenates by 8260B

Gettler Ryan

Attn.: Deanna Harding

6747 Sierra Court Suite J

Dublin, CA 94568

Phone: (925) 551-7444 Fax: (925) 551-7899

Project: 180061.80

Tosco #5325

Received: 03/05/2003 13:05

Site: 3220 Lakeshore Avenue
Oakland, CA

Samples Reported

Sample Name	Date Sampled	Matrix	Lab #
QA	03/04/2003	Water	1
U-1	03/04/2003 12:31	Water	2
U-2	03/04/2003 11:58	Water	3
U-3	03/04/2003 10:18	Water	4
U-4	03/04/2003 10:54	Water	5
U-5	03/04/2003 11:25	Water	6
U-6	03/04/2003 13:14	Water	7

Gas/BTEX Fuel Oxygenates by 8260B

Gettler Ryan

Attn.: Deanna Harding

6747 Sierra Court Suite J

Dublin, CA 94568

Phone: (925) 551-7444 Fax: (925) 551-7899

Project: 180061.80

Tosco #5325

Received: 03/05/2003 13:05

Site: 3220 Lakeshore Avenue

Oakland, CA

Prep(s): 5030B	Test(s): 8260FAB
Sample ID: QA	Lab ID: 2003-03-0069 - 1
Sampled: 03/04/2003	Extracted: 3/5/2003 16:04
Matrix: Water	QC Batch#: 2003/03/05-01.27

Compound	Conc.	RL	Unit	Dilution	Analyzed	Flag
Gasoline	ND	50	ug/L	1.00	03/05/2003 16:04	
Benzene	ND	0.50	ug/L	1.00	03/05/2003 16:04	
Toluene	ND	0.50	ug/L	1.00	03/05/2003 16:04	
Ethylbenzene	ND	0.50	ug/L	1.00	03/05/2003 16:04	
Total xylenes	ND	1.0	ug/L	1.00	03/05/2003 16:04	
Methyl tert-butyl ether (MTBE)	ND	2.0	ug/L	1.00	03/05/2003 16:04	
Surrogates(s)						
1,2-Dichloroethane-d4	97.7	76-114	%	1.00	03/05/2003 16:04	
Toluene-d8	97.6	88-110	%	1.00	03/05/2003 16:04	

Gas/BTEX Fuel Oxygenates by 8260B

Gettler Ryan

Attn.: Deanna Harding

6747 Sierra Court Suite J

Dublin, CA 94568

Phone: (925) 551-7444 Fax: (925) 551-7899

Project: 180061.80

Tosco #5325

Received: 03/05/2003 13:05

 Site: 3220 Lakeshore Avenue
Oakland, CA

Prep(s): 5030B	Test(s): 8260FAB
Sample ID: U-1	Lab ID: 2003-03-0069 - 2
Sampled: 03/04/2003 12:31	Extracted: 3/6/2003 17:33
Matrix: Water	QC Batch#: 2003/03/06-01.62
Analysis Flag: o (See Legend and Note Section)	

Compound	Conc.	RL	Unit	Dilution	Analyzed	Flag
Gasoline	8900	2500	ug/L	50.00	03/06/2003 17:33	
Benzene	26	25	ug/L	50.00	03/06/2003 17:33	
Toluene	ND	25	ug/L	50.00	03/06/2003 17:33	
Ethylbenzene	400	25	ug/L	50.00	03/06/2003 17:33	
Total xylenes	130	50	ug/L	50.00	03/06/2003 17:33	
tert-Butyl alcohol (TBA)	ND	5000	ug/L	50.00	03/06/2003 17:33	
Methyl tert-butyl ether (MTBE)	5500	100	ug/L	50.00	03/06/2003 17:33	
Di-isopropyl Ether (DIPE)	ND	100	ug/L	50.00	03/06/2003 17:33	
Ethyl tert-butyl ether (ETBE)	ND	100	ug/L	50.00	03/06/2003 17:33	
tert-Amyl methyl ether (TAME)	ND	100	ug/L	50.00	03/06/2003 17:33	
1,2-DCA	ND	100	ug/L	50.00	03/06/2003 17:33	
EDB	ND	100	ug/L	50.00	03/06/2003 17:33	
Ethanol	ND	25000	ug/L	50.00	03/06/2003 17:33	
Surrogates(s)						
1,2-Dichloroethane-d4	109.2	76-114	%	50.00	03/06/2003 17:33	
Toluene-d8	92.6	88-110	%	50.00	03/06/2003 17:33	

Severn Trent Laboratories, Inc.

STL San Francisco * 1220 Quarry Lane, Pleasanton, CA 94566

Tel 925 484 1919 Fax 925 484 1096 * www.stl-inc.com * CA DHS ELAP# 2496

03/24/2003 11:41

Gas/BTEX Fuel Oxygenates by 8260B

Gettler Ryan
Attn.: Deanna Harding

6747 Sierra Court Suite J
Dublin, CA 94568
Phone: (925) 551-7444 Fax: (925) 551-7899

Project: 180061.80
Tosco #5325

Received: 03/05/2003 13:05

Site: 3220 Lakeshore Avenue
Oakland, CA

Prep(s): 5030B Test(s): 8260FAB
Sample ID: U-2 Lab ID: 2003-03-0069 - 3
Sampled: 03/04/2003 11:58 Extracted: 3/6/2003 17:55
Matrix: Water QC Batch#: 2003/03/06-01.62
Analysis Flag: o (See Legend and Note Section)

Compound	Conc.	RL	Unit	Dilution	Analyzed	Flag
Gasoline	8100	5000	ug/L	100.00	03/06/2003 17:55	g
Benzene	ND	50	ug/L	100.00	03/06/2003 17:55	
Toluene	ND	50	ug/L	100.00	03/06/2003 17:55	
Ethylbenzene	ND	50	ug/L	100.00	03/06/2003 17:55	
Total xylenes	ND	100	ug/L	100.00	03/06/2003 17:55	
tert-Butyl alcohol (TBA)	ND	10000	ug/L	100.00	03/06/2003 17:55	
Methyl tert-butyl ether (MTBE)	7800	200	ug/L	100.00	03/06/2003 17:55	
Di-isopropyl Ether (DIPE)	ND	200	ug/L	100.00	03/06/2003 17:55	
Ethyl tert-butyl ether (ETBE)	ND	200	ug/L	100.00	03/06/2003 17:55	
tert-Amyl methyl ether (TAME)	ND	200	ug/L	100.00	03/06/2003 17:55	
1,2-DCA	ND	200	ug/L	100.00	03/06/2003 17:55	
EDB	ND	200	ug/L	100.00	03/06/2003 17:55	
Ethanol	ND	50000	ug/L	100.00	03/06/2003 17:55	
Surrogates(s)						
1,2-Dichloroethane-d4	108.0	76-114	%	100.00	03/06/2003 17:55	
Toluene-d8	94.8	88-110	%	100.00	03/06/2003 17:55	

Gas/BTEX Fuel Oxygenates by 8260B

Gettler Ryan

Attn.: Deanna Harding

6747 Sierra Court Suite J

Dublin, CA 94568

Phone: (925) 551-7444 Fax: (925) 551-7899

Project: 180061.80

Tosco #5325

Received: 03/05/2003 13:05

Site: 3220 Lakeshore Avenue
Oakland, CA

Prep(s): 5030B	Test(s): 8260FAB
Sample ID: U-3	Lab ID: 2003-03-0069 - 4
Sampled: 03/04/2003 10:18	Extracted: 3/5/2003 17:30
Matrix: Water	QC Batch#: 2003/03/05-01.27

Compound	Conc.	RL	Unit	Dilution	Analyzed	Flag
Gasoline	ND	50	ug/L	1.00	03/05/2003 17:30	
Benzene	ND	0.50	ug/L	1.00	03/05/2003 17:30	
Toluene	ND	0.50	ug/L	1.00	03/05/2003 17:30	
Ethylbenzene	ND	0.50	ug/L	1.00	03/05/2003 17:30	
Total xylenes	ND	1.0	ug/L	1.00	03/05/2003 17:30	
Methyl tert-butyl ether (MTBE)	ND	2.0	ug/L	1.00	03/05/2003 17:30	
Surrogates(s)						
1,2-Dichloroethane-d4	96.4	76-114	%	1.00	03/05/2003 17:30	
Toluene-d8	95.0	88-110	%	1.00	03/05/2003 17:30	

Gas/BTEX Fuel Oxygenates by 8260B

Gettler Ryan
Attn.: Deanna Harding

6747 Sierra Court Suite J
Dublin, CA 94568
Phone: (925) 551-7444 Fax: (925) 551-7899

Project: 180061.80
Tosco #5325

Received: 03/05/2003 13:05

Site: 3220 Lakeshore Avenue
Oakland, CA

Prep(s):	5030B	Test(s):	8260FAB
Sample ID:	U-4	Lab ID:	2003-03-0069 - 5
Sampled:	03/04/2003 10:54	Extracted:	3/5/2003 17:52
Matrix:	Water	QC Batch#:	2003/03/05-01.27

Compound	Conc.	RL	Unit	Dilution	Analyzed	Flag
Gasoline	ND	50	ug/L	1.00	03/05/2003 17:52	
Benzene	ND	0.50	ug/L	1.00	03/05/2003 17:52	
Toluene	ND	0.50	ug/L	1.00	03/05/2003 17:52	
Ethylbenzene	ND	0.50	ug/L	1.00	03/05/2003 17:52	
Total xylenes	ND	1.0	ug/L	1.00	03/05/2003 17:52	
Methyl tert-butyl ether (MTBE)	ND	2.0	ug/L	1.00	03/05/2003 17:52	
Surrogates(s)						
1,2-Dichloroethane-d4	96.3	76-114	%	1.00	03/05/2003 17:52	
Toluene-d8	99.8	88-110	%	1.00	03/05/2003 17:52	

Gas/BTEX Fuel Oxygenates by 8260B

Gettler Ryan

Attn.: Deanna Harding

6747 Sierra Court Suite J

Dublin, CA 94568

Phone: (925) 551-7444 Fax: (925) 551-7899

Project: 180061.80

Tosco #5325

Received: 03/05/2003 13:05

Site: 3220 Lakeshore Avenue

Oakland, CA

Prep(s): 5030B	Test(s): 8260FAB
Sample ID: U-5	Lab ID: 2003-03-0069 - 6
Sampled: 03/04/2003 11:25	Extracted: 3/5/2003 18:14
Matrix: Water	QC Batch#: 2003/03/05-01.27

Compound	Conc.	RL	Unit	Dilution	Analyzed	Flag
Gasoline	100	50	ug/L	1.00	03/05/2003 18:14	g
Benzene	ND	0.50	ug/L	1.00	03/05/2003 18:14	
Toluene	ND	0.50	ug/L	1.00	03/05/2003 18:14	
Ethylbenzene	ND	0.50	ug/L	1.00	03/05/2003 18:14	
Total xylenes	ND	1.0	ug/L	1.00	03/05/2003 18:14	
tert-Butyl alcohol (TBA)	ND	100	ug/L	1.00	03/05/2003 18:14	
Methyl tert-butyl ether (MTBE)	44	2.0	ug/L	1.00	03/05/2003 18:14	
Di-isopropyl Ether (DIPE)	ND	2.0	ug/L	1.00	03/05/2003 18:14	
Ethyl tert-butyl ether (ETBE)	ND	2.0	ug/L	1.00	03/05/2003 18:14	
tert-Amyl methyl ether (TAME)	ND	2.0	ug/L	1.00	03/05/2003 18:14	
1,2-DCA	ND	2.0	ug/L	1.00	03/05/2003 18:14	
EDB	ND	2.0	ug/L	1.00	03/05/2003 18:14	
Ethanol	ND	500	ug/L	1.00	03/05/2003 18:14	
Surrogates(s)						
1,2-Dichloroethane-d4	94.7	76-114	%	1.00	03/05/2003 18:14	
Toluene-d8	97.7	88-110	%	1.00	03/05/2003 18:14	

Gas/BTEX Fuel Oxygenates by 8260B

Gettler Ryan

Attn.: Deanna Harding

6747 Sierra Court Suite J
Dublin, CA 94568
Phone: (925) 551-7444 Fax: (925) 551-7899Project: 180061.80
Tosco #5325

Received: 03/05/2003 13:05

Site: 3220 Lakeshore Avenue
Oakland, CA

Prep(s): 5030B Test(s): 8260FAB
Sample ID: U-6 Lab ID: 2003-03-0069 - 7
Sampled: 03/04/2003 13:14 Extracted: 3/6/2003 18:18
Matrix: Water QC Batch#: 2003/03/06-01.62
Analysis Flag: o (See Legend and Note Section)

Compound	Conc.	RL	Unit	Dilution	Analyzed	Flag
Gasoline	2300	1000	ug/L	20.00	03/06/2003 18:18	g
Benzene	ND	10	ug/L	20.00	03/06/2003 18:18	
Toluene	ND	10	ug/L	20.00	03/06/2003 18:18	
Ethylbenzene	ND	10	ug/L	20.00	03/06/2003 18:18	
Total xylenes	ND	20	ug/L	20.00	03/06/2003 18:18	
tert-Butyl alcohol (TBA)	ND	2000	ug/L	20.00	03/06/2003 18:18	
Methyl tert-butyl ether (MTBE)	2700	40	ug/L	20.00	03/06/2003 18:18	
Di-isopropyl Ether (DIPE)	ND	40	ug/L	20.00	03/06/2003 18:18	
Ethyl tert-butyl ether (ETBE)	ND	40	ug/L	20.00	03/06/2003 18:18	
tert-Amyl methyl ether (TAME)	ND	40	ug/L	20.00	03/06/2003 18:18	
1,2-DCA	ND	40	ug/L	20.00	03/06/2003 18:18	
EDB	ND	40	ug/L	20.00	03/06/2003 18:18	
Ethanol	ND	10000	ug/L	20.00	03/06/2003 18:18	
Surrogates(s)						
1,2-Dichloroethane-d4	108.7	76-114	%	20.00	03/06/2003 18:18	
Toluene-d8	95.8	88-110	%	20.00	03/06/2003 18:18	

Gas/BTEX Fuel Oxygenates by 8260B

Gettler Ryan
Attn.: Deanna Harding

6747 Sierra Court Suite J
Dublin, CA 94568
Phone: (925) 551-7444 Fax: (925) 551-7899

Project: 180061.80
Tosco #5325

Received: 03/05/2003 13:05

Site: 3220 Lakeshore Avenue
Oakland, CA

Batch QC Report

Prep(s): 5030B
Method Blank

Water

Test(s): 8260FAB

QC Batch # 2003/03/05-01.27

MB: 2003/03/05-01.27-009

Date Extracted: 03/05/2003 12:45

Compound	Conc.	RL	Unit	Analyzed	Flag
Gasoline	ND	50	ug/L	03/05/2003 12:45	
Benzene	ND	0.5	ug/L	03/05/2003 12:45	
Toluene	ND	0.5	ug/L	03/05/2003 12:45	
Ethylbenzene	ND	0.5	ug/L	03/05/2003 12:45	
Total xylenes	ND	1.0	ug/L	03/05/2003 12:45	
tert-Butyl alcohol (TBA)	ND	100	ug/L	03/05/2003 12:45	
Methyl tert-butyl ether (MTBE)	ND	2.0	ug/L	03/05/2003 12:45	
Di-isopropyl Ether (DIPE)	ND	2.0	ug/L	03/05/2003 12:45	
Ethyl tert-butyl ether (ETBE)	ND	2.0	ug/L	03/05/2003 12:45	
tert-Amyl methyl ether (TAME)	ND	2.0	ug/L	03/05/2003 12:45	
1,2-DCA	ND	2.0	ug/L	03/05/2003 12:45	
EDB	ND	2.0	ug/L	03/05/2003 12:45	
Ethanol	ND	500	ug/L	03/05/2003 12:45	
Surrogates(s)					
1,2-Dichloroethane-d4	99.8	76-114	%	03/05/2003 12:45	
Toluene-d8	96.6	88-110	%	03/05/2003 12:45	

Gas/BTEX Fuel Oxygenates by 8260B

Gettler Ryan
Attn.: Deanna Harding

6747 Sierra Court Suite J
Dublin, CA 94568
Phone: (925) 551-7444 Fax: (925) 551-7899

Project: 180061.80
Tosco #5325

Received: 03/05/2003 13:05

Site: 3220 Lakeshore Avenue
Oakland, CA

Batch QC Report

Prep(s): 5030B

Method Blank

MB: 2003/03/06-01.62-061

Water

Test(s): 8260FAB

QC Batch # 2003/03/06-01.62

Date Extracted: 03/06/2003 11:21

Compound	Conc.	RL	Unit	Analyzed	Flag
Gasoline	ND	50	ug/L	03/06/2003 11:21	
Benzene	ND	0.5	ug/L	03/06/2003 11:21	
Toluene	ND	0.5	ug/L	03/06/2003 11:21	
Ethylbenzene	ND	0.5	ug/L	03/06/2003 11:21	
Total xylenes	ND	1.0	ug/L	03/06/2003 11:21	
tert-Butyl alcohol (TBA)	ND	100	ug/L	03/06/2003 11:21	
Methyl tert-butyl ether (MTBE)	ND	2.0	ug/L	03/06/2003 11:21	
Di-isopropyl Ether (DIPE)	ND	2.0	ug/L	03/06/2003 11:21	
Ethyl tert-butyl ether (ETBE)	ND	2.0	ug/L	03/06/2003 11:21	
tert-Amyl methyl ether (TAME)	ND	2.0	ug/L	03/06/2003 11:21	
1,2-DCA	ND	2.0	ug/L	03/06/2003 11:21	
EDB	ND	2.0	ug/L	03/06/2003 11:21	
Ethanol	ND	500	ug/L	03/06/2003 11:21	
Surrogates(s)					
1,2-Dichloroethane-d4	106.6	76-114	%	03/06/2003 11:21	
Toluene-d8	96.0	88-110	%	03/06/2003 11:21	

Gas/BTEX Fuel Oxygenates by 8260B

Gettler Ryan
Attn.: Deanna Harding

6747 Sierra Court Suite J
Dublin, CA 94568
Phone: (925) 551-7444 Fax: (925) 551-7899

Project: 180061.80
Tosco #5325

Received: 03/05/2003 13:05

Site: 3220 Lakeshore Avenue
Oakland, CA

Batch QC Report

Prep(s): 5030B

Test(s): 8260B

Laboratory Control Spike

Water

QC Batch # 2003/03/05-01.27

LCS 2003/03/05-01.27-005

Extracted: 03/05/2003

Analyzed: 03/05/2003 11:56

LCSD 2003/03/05-01.27-006

Extracted: 03/05/2003

Analyzed: 03/05/2003 12:24

Compound	Conc. ug/L		Exp.Conc.	Recovery		RPD %	Ctrl.Limits %		Flags	
	LCS	LCSD		LCS	LCSD		Rec.	RPD	LCS	LCSD
Methyl tert-butyl ether (MTBE)	29.5	29.3	25.0	118.0	117.2	0.7	65-165	20		
Benzene	21.9	22.4	25.0	87.6	89.6	2.3	69-129	20		
Toluene	23.3	23.7	25.0	93.2	94.8	1.7	70-130	20		
Surrogates(s)										
1,2-Dichloroethane-d4	535	527	500	107.0	105.4		76-114			
Toluene-d8	502	490	500	100.4	98.0		88-110			

Gas/BTEX Fuel Oxygenates by 8260B

Gettler Ryan

Attn.: Deanna Harding

6747 Sierra Court Suite J

Dublin, CA 94568

Phone: (925) 551-7444 Fax: (925) 551-7899

Project: 180061.80

Tosco #5325

Received: 03/05/2003 13:05

Site: 3220 Lakeshore Avenue

Oakland, CA

Batch QC Report

Prep(s): 5030B

Test(s): 8260B

Laboratory Control Spike

Water

QC Batch # 2003/03/06-01.62

LCS 2003/03/06-01.62-037

Extracted: 03/06/2003

Analyzed: 03/06/2003 10:37

LCSD 2003/03/06-01.62-059

Extracted: 03/06/2003

Analyzed: 03/06/2003 10:59

Compound	Conc. ug/L		Exp.Conc.	Recovery		RPD %	Ctrl.Limits %		Flags	
	LCS	LCSD		LCS	LCSD		Rec.	RPD	LCS	LCSD
Methyl tert-butyl ether (MTBE)	23.6	22.3	25.0	94.4	89.2	5.7	65-165	20		
Benzene	24.5	24.7	25.0	98.0	98.8	0.8	69-129	20		
Toluene	25.1	24.6	25.0	100.4	98.4	2.0	70-130	20		
Surrogates(s)										
1,2-Dichloroethane-d4	535	523	500	107.0	104.6		76-114			
Toluene-d8	477	476	500	95.4	95.2		88-110			

Gas/BTEX Fuel Oxygenates by 8260B

Gettler Ryan

Attn.: Deanna Harding

6747 Sierra Court Suite J

Dublin, CA 94568

Phone: (925) 551-7444 Fax: (925) 551-7899

Project: 180061.80

Tosco #5325

Received: 03/05/2003 13:05

Site: 3220 Lakeshore Avenue
Oakland, CA

Legend and Notes

Analysis Flag

o

Reporting limits were raised due to high level of analyte present in the sample.

Result Flag

g

Hydrocarbon reported in the gasoline range does not match our gasoline standard.

Dissolved Metals

Gettler Ryan

Attn.: Deanna Harding

6747 Sierra Court Suite J

Dublin, CA 94568

Phone: (925) 551-7444 Fax: (925) 551-7899

Project: 180061.80

Tosco #5325

Received: 03/05/2003 13:05

Site: 3220 Lakeshore Avenue
Oakland, CA**Samples Reported**

Sample Name	Date Sampled	Matrix	Lab #
U-1	03/04/2003 12:31	Water	2
U-2	03/04/2003 11:58	Water	3
U-3	03/04/2003 10:18	Water	4
U-4	03/04/2003 10:54	Water	5
U-5	03/04/2003 11:25	Water	6
U-6	03/04/2003 13:14	Water	7

Severn Trent Laboratories, Inc.

STL San Francisco * 1220 Quarry Lane, Pleasanton, CA 94566

Tel 925 484 1919 Fax 925 484 1096 * www.stl-inc.com * CA DHS ELAP# 2496

03/18/2003 15:08

Dissolved Metals

Gettler Ryan

Attn.: Deanna Harding

6747 Sierra Court Suite J

Dublin, CA 94568

Phone: (925) 551-7444 Fax: (925) 551-7899

Project: 180061.80

Tosco #5325

Received: 03/05/2003 13:05

Site: 3220 Lakeshore Avenue
Oakland, CA

Prep(s): 3005A	Test(s): 6010B
Sample ID: U-1	Lab ID: 2003-03-0069 - 2
Sampled: 03/04/2003 12:31	Extracted: 3/11/2003 10:46
Matrix: Water	QC Batch#: 2003/03/11-03.15

Compound	Conc.	RL	Unit	Dilution	Analyzed	Flag
Iron	36	0.20	mg/L	1.00	03/12/2003 23:21	

Dissolved Metals

Gettler Ryan

Attn.: Deanna Harding

6747 Sierra Court Suite J

Dublin, CA 94568

Phone: (925) 551-7444 Fax: (925) 551-7899

Project: 180061.80

Tosco #5325

Received: 03/05/2003 13:05

Site: 3220 Lakeshore Avenue
Oakland, CA

Prep(s):	3005A	Test(s):	6010B
Sample ID:	U-2	Lab ID:	2003-03-0069 - 3
Sampled:	03/04/2003 11:58	Extracted:	3/11/2003 10:46
Matrix:	Water	QC Batch#:	2003/03/11-03.15

Compound	Conc.	RL	Unit	Dilution	Analyzed	Flag
Iron	8.6	0.20	mg/L	1.00	03/12/2003 23:25	

Dissolved Metals

Gettler Ryan

Attn.: Deanna Harding

6747 Sierra Court Suite J
Dublin, CA 94568
Phone: (925) 551-7444 Fax: (925) 551-7899

Project: 180061.80
Tosco #5325

Received: 03/05/2003 13:05

Site: 3220 Lakeshore Avenue
Oakland, CA

Prep(s): 3005A	Test(s): 6010B
Sample ID: U-3	Lab ID: 2003-03-0069 - 4
Sampled: 03/04/2003 10:18	Extracted: 3/12/2003 08:55
Matrix: Water	QC Batch#: 2003/03/12-02.15

Compound	Conc.	RL	Unit	Dilution	Analyzed	Flag
Iron	ND	0.20	mg/L	1.00	03/12/2003 20:51	

Dissolved Metals

Gettler Ryan

Attn.: Deanna Harding

6747 Sierra Court Suite J

Dublin, CA 94568

Phone: (925) 551-7444 Fax: (925) 551-7899

Project: 180061.80

Tosco #5325

Received: 03/05/2003 13:05

Site: 3220 Lakeshore Avenue
Oakland, CA

Prep(s):	3005A	Test(s):	6010B
Sample ID:	U-4	Lab ID:	2003-03-0069 - 5
Sampled:	03/04/2003 10:54	Extracted:	3/12/2003 08:55
Matrix:	Water	QC Batch#:	2003/03/12-02.15

Compound	Conc.	RL	Unit	Dilution	Analyzed	Flag
Iron	ND	0.20	mg/L	1.00	03/12/2003 21:04	

Dissolved Metals

Gettler Ryan

Attn.: Deanna Harding

6747 Sierra Court Suite J

Dublin, CA 94568

Phone: (925) 551-7444 Fax: (925) 551-7899

Project: 180061.80

Tosco #5325

Received: 03/05/2003 13:05

Site: 3220 Lakeshore Avenue
Oakland, CA

Prep(s): 3005A

Sample ID: U-5

Sampled: 03/04/2003 11:25

Matrix: Water

Test(s): 6010B

Lab ID: 2003-03-0069 - 6

Extracted: 3/12/2003 08:55

QC Batch#: 2003/03/12-02.15

Compound	Conc.	RL	Unit	Dilution	Analyzed	Flag
Iron	19	0.20	mg/L	1.00	03/12/2003 21:08	

Dissolved Metals

Gettler Ryan

Attn.: Deanna Harding

6747 Sierra Court Suite J
Dublin, CA 94568
Phone: (925) 551-7444 Fax: (925) 551-7899

Project: 180061.80
Tosco #5325

Received: 03/05/2003 13:05

Site: 3220 Lakeshore Avenue
Oakland, CA

Prep(s): 3005A	Test(s): 6010B
Sample ID: U-6	Lab ID: 2003-03-0069 - 7
Sampled: 03/04/2003 13:14	Extracted: 3/12/2003 08:55
Matrix: Water	QC Batch#: 2003/03/12-02.15

Compound	Conc.	RL	Unit	Dilution	Analyzed	Flag
Iron	20	0.20	mg/L	1.00	03/12/2003 21:12	

Dissolved Metals

Gettler Ryan

Attn.: Deanna Harding

6747 Sierra Court Suite J

Dublin, CA 94568

Phone: (925) 551-7444 Fax: (925) 551-7899

Project: 180061.80

Tosco #5325

Received: 03/05/2003 13:05

Site: 3220 Lakeshore Avenue
Oakland, CA

Batch QC Report

Prep(s): 3005A

Method Blank

MB: 2003/03/11-03.15-046

Water

Test(s): 6010B

QC Batch # 2003/03/11-03.15

Date Extracted: 03/11/2003 10:46

Compound	Conc.	RL	Unit	Analyzed	Flag
Iron	ND	0.20	mg/L	03/12/2003 23:09	

Dissolved Metals

Gettler Ryan

Attn.: Deanna Harding

6747 Sierra Court Suite J

Dublin, CA 94568

Phone: (925) 551-7444 Fax: (925) 551-7899

Project: 180061.80

Tosco #5325

Received: 03/05/2003 13:05 ..

Site: 3220 Lakeshore Avenue
Oakland, CA**Batch QC Report**

Prep(s): 3005A

Method Blank

MB: 2003/03/12-02.15-017

Water

Test(s): 6010B

QC Batch # 2003/03/12-02.15

Date Extracted: 03/12/2003 08:55

Compound	Conc.	RL	Unit	Analyzed	Flag
Iron	ND	0.20	mg/L	03/12/2003 20:40	

Dissolved Metals

Gettler Ryan
Attn.: Deanna Harding

6747 Sierra Court Suite J
Dublin, CA 94568
Phone: (925) 551-7444 Fax: (925) 551-7899
Project: 180061.80
Tosco #5325

Received: 03/05/2003 13:05

Site: 3220 Lakeshore Avenue
Oakland, CA

Batch QC Report

Prep(s): 3005A

Test(s): 6010B

Laboratory Control Spike

Water

QC Batch # 2003/03/11-03.15

LCS 2003/03/11-03.15-047

Extracted: 03/11/2003

Analyzed: 03/12/2003 23:13

LCSD 2003/03/11-03.15-048

Extracted: 03/11/2003

Analyzed: 03/12/2003 23:17

Compound	Conc. mg/L		Exp.Conc.	Recovery		RPD	Ctrl.Limits %		Flags	
	LCS	LCSD		LCS	LCSD		%	Rec.	RPD	LCS
Iron	4.82	4.89	5.00	96.4	97.8	1.4	80-120	20		

Dissolved Metals

Gettler Ryan

Attn.: Deanna Harding

6747 Sierra Court Suite J

Dublin, CA 94568

Phone: (925) 551-7444 Fax: (925) 551-7899

Project: 180061.80

Tosco #5325

Received: 03/05/2003 13:05

Site: 3220 Lakeshore Avenue
Oakland, CA

Batch QC Report

Prep(s): 3005A

Test(s): 6010B

Laboratory Control Spike

Water

QC Batch # 2003/03/12-02.15

LCS 2003/03/12-02.15-018

Extracted: 03/12/2003

Analyzed: 03/12/2003 20:44

LCSD 2003/03/12-02.15-019

Extracted: 03/12/2003

Analyzed: 03/12/2003 20:48

Compound	Conc. mg/L		Exp.Conc.	Recovery		RPD	Ctrl.Limits %		Flags	
	LCS	LCSD		LCS	LCSD		%	Rec.	RPD	LCS
Iron	4.85	4.87	5.00	97.0	97.4	0.4	80-120	20		

Misc Anions by Ion Chromatograph

Gettler Ryan

Attn.: Deanna Harding

6747 Sierra Court Suite J

Dublin, CA 94568

Phone: (925) 551-7444 Fax: (925) 551-7899

Project: 180061.80

Tosco #5325

Received: 03/05/2003 13:05

Site: 3220 Lakeshore Avenue
Oakland, CA**Samples Reported**

Sample Name	Date Sampled	Matrix	Lab #
U-1	03/04/2003 12:31	Water	2
U-2	03/04/2003 11:58	Water	3
U-3	03/04/2003 10:18	Water	4
U-4	03/04/2003 10:54	Water	5
U-5	03/04/2003 11:25	Water	6
U-6	03/04/2003 13:14	Water	7

Misc Anions by Ion Chromatograph

Gettler Ryan

Attn.: Deanna Harding

6747 Sierra Court Suite J

Dublin, CA 94568

Phone: (925) 551-7444 Fax: (925) 551-7899

Project: 180061.80

Tosco #5325

Received: 03/05/2003 13:05

Site: 3220 Lakeshore Avenue

Oakland, CA

Prep(s): 300.0/9056	Test(s): 300.0/9056
Sample ID: U-1	Lab ID: 2003-03-0069 - 2
Sampled: 03/04/2003 12:31	Extracted: 3/6/2003 00:00
Matrix: Water	QC Batch#: 2003/03/06-01.41

Compound	Conc.	RL	Unit	Dilution	Analyzed	Flag
Nitrate	ND	1.0	mg/L	1.00	03/06/2003	
Orthophosphate	ND	1.0	mg/L	1.00	03/06/2003	

Misc Anions by Ion Chromatograph

Gettler Ryan
Attn.: Deanna Harding

6747 Sierra Court Suite J
Dublin, CA 94568
Phone: (925) 551-7444 Fax: (925) 551-7899

Project: 180061.80
Tosco #5325

Received: 03/05/2003 13:05

Site: 3220 Lakeshore Avenue
Oakland, CA

Prep(s): 300.0/9056	Test(s): 300.0/9056
Sample ID: U-2	Lab ID: 2003-03-0069 - 3
Sampled: 03/04/2003 11:58	Extracted: 3/6/2003 00:00
Matrix: Water	QC Batch#: 2003/03/06-01.41

Compound	Conc.	RL	Unit	Dilution	Analyzed	Flag
Nitrate	ND	1.0	mg/L	1.00	03/06/2003	
Orthophosphate	ND	1.0	mg/L	1.00	03/06/2003	

Misc Anions by Ion Chromatograph

Gettler Ryan

Attn.: Deanna Harding

6747 Sierra Court Suite J

Dublin, CA 94568

Phone: (925) 551-7444 Fax: (925) 551-7899

Project: 180061.80

Tosco #5325

Received: 03/05/2003 13:05

Site: 3220 Lakeshore Avenue
Oakland, CA

Prep(s): 300.0/9056	Test(s): 300.0/9056
Sample ID: U-3	Lab ID: 2003-03-0069 - 4
Sampled: 03/04/2003 10:18	Extracted: 3/6/2003 00:00
Matrix: Water	QC Batch#: 2003/03/06-01.41

Compound	Conc.	RL	Unit	Dilution	Analyzed	Flag
Nitrate	18	1.0	mg/L	1.00	03/06/2003	
Orthophosphate	ND	1.0	mg/L	1.00	03/06/2003	

Misc Anions by Ion Chromatograph

Gettler Ryan

Attn.: Deanna Harding

6747 Sierra Court Suite J

Dublin, CA 94568

Phone: (925) 551-7444 Fax: (925) 551-7899

Project: 180061.80

Tosco #5325

Received: 03/05/2003 13:05

Site: 3220 Lakeshore Avenue
Oakland, CA

Prep(s):	300.0/9056	Test(s):	300.0/9056
Sample ID:	U-4	Lab ID:	2003-03-0069 - 5
Sampled:	03/04/2003 10:54	Extracted:	3/6/2003 00:00
Matrix:	Water	QC Batch#:	2003/03/06-01.41

Compound	Conc.	RL	Unit	Dilution	Analyzed	Flag
Nitrate	26	1.0	mg/L	1.00	03/06/2003	
Orthophosphate	ND	1.0	mg/L	1.00	03/06/2003	

Misc Anions by Ion Chromatograph

Gettler Ryan

Attn.: Deanna Harding

6747 Sierra Court Suite J

Dublin, CA 94568

Phone: (925) 551-7444 Fax: (925) 551-7899

Project: 180061.80

Tosco #5325

Received: 03/05/2003 13:05

Site: 3220 Lakeshore Avenue

Oakland, CA

Prep(s):	300.0/9056	Test(s):	300.0/9056
Sample ID:	U-5	Lab ID:	2003-03-0069 - 6
Sampled:	03/04/2003 11:25	Extracted:	3/6/2003 00:00
Matrix:	Water	QC Batch#:	2003/03/06-01.41

Compound	Conc.	RL	Unit	Dilution	Analyzed	Flag
Nitrate	ND	1.0	mg/L	1.00	03/06/2003	
Orthophosphate	ND	1.0	mg/L	1.00	03/06/2003	

Misc Anions by Ion Chromatograph

Gettler Ryan

Attn.: Deanna Harding

6747 Sierra Court Suite J
Dublin, CA 94568
Phone: (925) 551-7444 Fax: (925) 551-7899

Project: 180061.80
Tosco #5325

Received: 03/05/2003 13:05

Site: 3220 Lakeshore Avenue
Oakland, CA

Prep(s): 300.0/9056	Test(s): 300.0/9056
Sample ID: U-6	Lab ID: 2003-03-0069 - 7
Sampled: 03/04/2003 13:14	Extracted: 3/6/2003 00:00
Matrix: Water	QC Batch#: 2003/03/06-01.41

Compound	Conc.	RL	Unit	Dilution	Analyzed	Flag
Nitrate	ND	1.0	mg/L	1.00	03/06/2003	
Orthophosphate	ND	1.0	mg/L	1.00	03/06/2003	

Misc Anions by Ion Chromatograph

Gettler Ryan
Attn.: Deanna Harding

6747 Sierra Court Suite J
Dublin, CA 94568
Phone: (925) 551-7444 Fax: (925) 551-7899

Project: 180061.80
Tosco #5325

Received: 03/05/2003 13:05

Site: 3220 Lakeshore Avenue
Oakland, CA

Batch QC Report

Prep(s): 300.0/9056

Method Blank

MB: 2003/03/06-01.41-001

Water

Test(s): 300.0/9056

QC Batch # 2003/03/06-01.41

Date Extracted: 03/06/2003

Compound	Conc.	RL	Unit	Analyzed	Flag
Nitrate	ND	1.0	mg/L	03/06/2003	
Orthophosphate	ND	1.0	mg/L	03/06/2003	

Misc Anions by Ion Chromatograph

Gettler Ryan
Attn.: Deanna Harding

6747 Sierra Court Suite J
Dublin, CA 94568
Phone: (925) 551-7444 Fax: (925) 551-7899

Project: 180061.80
Tosco #5325

Received: 03/05/2003 13:05

Site: 3220 Lakeshore Avenue
Oakland, CA

Batch QC Report

Prep(s): 300.0/9056

Test(s): 300.0/9056

Laboratory Control Spike

Water

QC Batch # 2003/03/06-01.41

LCS 2003/03/06-01.41-002

Extracted: 03/06/2003

Analyzed: 03/06/2003

LCSD 2003/03/06-01.41-003

Extracted: 03/06/2003

Analyzed: 03/06/2003

Compound	Conc. mg/L		Exp.Conc.	Recovery		RPD %	Ctrl.Limits %		Flags	
	LCS	LCSD		LCS	LCSD		Rec.	RPD	LCS	LCSD
Nitrate	18.6	18.5	20.0	93.0	92.5	0.5	80-120	20		
Orthophosphate	19.2	19.1	20.0	96.0	95.5	0.5	80-120	20		