

CAMBRIA

January 15, 2001

Barney Chan
Alameda County Health Care Services Agency
1131 Harbor Bay Parkway, Suite 250
Alameda, California 94502-6577

Re: **Fourth Quarter 2000 Monitoring Report**
Shell-branded Service Station
630 High Street
Oakland, California
Incident #98995751
Cambria Project #243-0318-002

3737

o continuing semi-annual mon
o continue to watch apparent release
of AMSS near MW 3, maybe reporting
post MW 6.



Dear Mr. Chan:

On behalf of Equiva Services LLC, Cambria Environmental Technology, Inc. (Cambria) is submitting this groundwater monitoring report in accordance with the reporting requirements of 23 CCR 2652d.

FOURTH QUARTER 2000 ACTIVITIES

Groundwater Monitoring: Blaine Tech Services, Inc. (Blaine) of San Jose, California gauged and sampled all site wells, calculated groundwater elevations, and compiled the analytical data. Cambria prepared a groundwater elevation contour map (Figure 1). Blaine's report, presenting the laboratory report and supporting field documents, is included as Attachment A.

ANTICIPATED FUTURE 2001 ACTIVITIES

Groundwater Monitoring: The next sampling event is scheduled for the second quarter 2001. Blaine will gauge and sample selected site wells and tabulate the data. Cambria will prepare a monitoring report.

Oakland, CA
San Ramon, CA
Sonoma, CA

**Cambria
Environmental
Technology, Inc.**

1144 65th Street
Suite B
Oakland, CA 94608
Tel (510) 420-0700
Fax (510) 420-9170

00 JAN 17 PM 4:20
ENVIRONMENTAL
PROTECTION

CLOSING

We appreciate the opportunity to work with you on this project. Please call Stephan Bork at (510) 420-3344 if you have any questions or comments.

Sincerely,
Cambria Environmental Technology, Inc

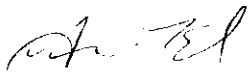

Anni Kreml
Senior Staff Scientist

Stephan A. Bork, C.E.G., C.HG.
Associate Hydrogeologist

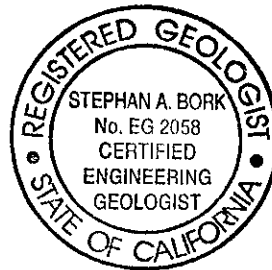

Figure: 1 - Groundwater Elevation Contour Map

Attachment: A - Blaine Groundwater Monitoring Report and Field Notes

cc: Karen Petryna, Equiva Services LLC, P.O. Box 7869, Burbank, California 91510-7869

g:\oakland630high\qm\2q00qm.doc

ATTACHMENT A
Blaine Groundwater Monitoring Report
and Field Notes

BLAINE
TECH SERVICES, INC.



1680 ROGERS AVENUE
SAN JOSE, CA 95112-1105
(408) 573-7771 FAX
(408) 573-0555 PHONE
CONTRACTOR'S LICENSE #746684
www.blainetech.com

January 10, 2001

Karen Petryna
Equiva Services LLC
P.O. Box 7869
Burbank, CA 91510-7869

Fourth Quarter 2000 Groundwater Monitoring at
Shell-branded Service Station
630 High Street
Oakland, CA

Monitoring performed on November 2, 2000

Groundwater Monitoring Report 001102-S-2

This report covers the routine monitoring of groundwater wells at this Shell-branded facility. In accordance with standard procedures that conform to Regional Water Quality Control Board requirements, routine field data collection includes depth to water, total well depth, thickness of any separate immiscible layer, water column volume, calculated purge volume (if applicable), elapsed evacuation time (if applicable), total volume of water removed (if applicable), and standard water parameter instrument readings. Sample material is collected, contained, stored, and transported to the laboratory in conformance with EPA standards. Purge water (if applicable) is, likewise, collected and transported to the Martinez Refining Company.

Basic field information is presented alongside analytical values excerpted from the laboratory report in the cumulative table of **WELL CONCENTRATIONS**. The full analytical report for the most recent samples and the field data sheets are attached to this report.

At a minimum, Blaine Tech Services, Inc. field personnel are certified on completion of a forty hour Hazardous Materials and Emergency Response training course per 29 CFR 1910.120. Field personnel are also enrolled in annual eight hour refresher courses.

Blaine Tech Services, Inc. conducts sampling and documentation assignments of this type as an independent third party. In order to avoid compromising the objectivity necessary for the proper and disinterested performance of this work, Blaine Tech Services, Inc. concentrates on objective data collection and does not participate in the interpretation of analytical results, the definition of geological or hydrological conditions, the formulation of recommendations, or the marketing of remedial systems.

Please call if you have any questions.

Yours truly,

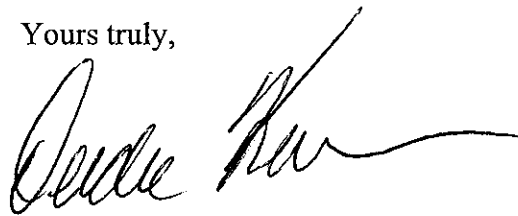
A handwritten signature in black ink, appearing to read "Deidre Kerwin", with a long horizontal flourish extending to the right.

Deidre Kerwin
Operations Manager

DK/jt

attachments: Cumulative Table of WELL CONCENTRATIONS
Certified Analytical Report
Field Data Sheets

cc: Anni Kreml
Cambria Environmental Technology, Inc.
1144 65th Street, Suite C
Oakland, CA 94608-2411

RAMP TO HIGHWAY 880

9:\OAKLAND\930\HIGH\FIGURES\4\GM00-MP.DWG

EXPLANATION

- MW-1 ◆ Monitoring well location
- ↑ Groundwater flow direction
- XX.XX Groundwater elevation contour, in feet above mean sea level (msl), approximately located; dashed where inferred

Well	ELEV	Benz - date	MTBE - date
MW-1	90.45	8/13	4/40
MW-2	91.12	<0.500	8/27/99
MW-3	89.44	1,210	8,750
MW-4	89.52	32.8	8/27/99
MW-5	89.33	0.659	20.0
MW-6	89.43	<0.500	4/97
MW-7	89.73	<0.500	7/38
MW-8	89.18	<0.500	8/27/99
MW-9	91.31	<0.500	8/27/99
MW-10	90.73	<0.500	8/27/99

Well designation
Groundwater elevation, in feet above msl
Benzene and MTBE concentrations are in parts per billion and are analyzed by EPA Method 8020; MTBE results in parentheses are analyzed by EPA Method 8260.

HIGH STREET

JENSEN STREET

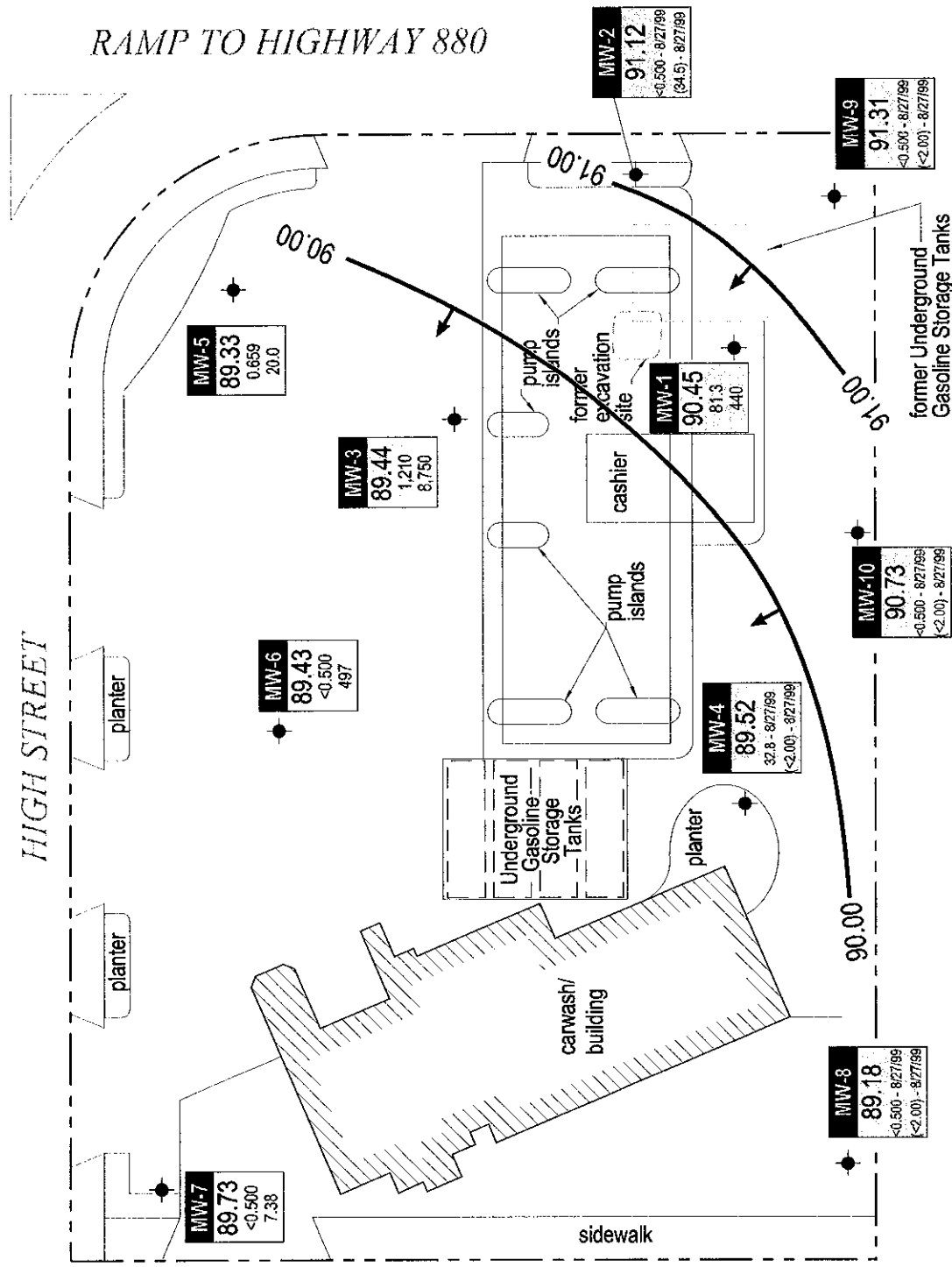

Shell-branded Service Station

630 High Street
Oakland, California
Incident #98995751



C A M B R I A

Groundwater Elevation Contour Map

November 2, 2000

FIGURE

1

WELL CONCENTRATIONS
Shell-Branded Service Station
630 High Street
Oakland, CA
WIC #204-5508-5801

Well ID	Date	TPPH (ug/L)	TEPH (ug/L)	B (ug/L)	T (ug/L)	E (ug/L)	X (ug/L)	MTBE 8020 (ug/L)	MTBE 8260 (ug/L)	TOC (MSL)	Depth to Water (ft.)	GW Elevation (MSL)	DO Reading (ppm)
---------	------	----------------	----------------	-------------	-------------	-------------	-------------	------------------------	------------------------	--------------	----------------------------	--------------------------	------------------------

MW-1	01/29/1991	11,000	21,000a	310	41	500	400	NA	NA	99.35	10.79	88.56	NA
MW-1	04/30/1991	8,300	2,100	250	32	310	300	NA	NA	99.35	9.48	89.87	NA
MW-1	07/22/1991	11,000	3,800	310	36	290	280	NA	NA	99.35	10.53	88.82	NA
MW-1	02/21/1992	7,300	8,900b	200	36	340	270	NA	NA	99.35	8.31	91.04	NA
MW-1	05/22/1992	7,600	18,000b, c	140	<50	300	140	NA	NA	99.35	10.02	89.33	NA
MW-1	07/07/1992	NA	NA	NA	NA	NA	NA	NA	NA	99.35	10.06	89.29	NA
MW-1	08/20/1992	9,100	5,200b	530	340	860	540	NA	NA	99.35	10.32	89.03	NA
MW-1	11/18/1992	15,000	4,100b	220	50	790	340	NA	NA	99.35	10.64	88.71	NA
MW-1	02/09/1993	7,000	1,200	130	23	220	160	NA	NA	99.35	8.71	90.64	NA
MW-1	06/16/1993	4,800	NA	150	31	320	130	NA	NA	99.35	9.71	89.64	1.73/1.58k
MW-1	08/24/1993	10,000	NA	170	27	610	170	NA	NA	99.35	10.23	89.12	1.49/1.70k
MW-1	11/23/1993	7,600	NA	190	<12	430	140	NA	NA	99.35	10.48	88.87	1.77/2.80k
MW-1	02/14/1994	8,000	NA	150	47	210	68	NA	NA	99.35	9.17	90.18	6.2/2.5k
MW-1	05/25/1994	8,800	NA	95	<10	210	63	NA	NA	99.35	9.52	89.83	NA
MW-1	08/04/1994	6,200	NA	150	14	350	180	NA	NA	99.35	10.51	88.84	NA
MW-1	11/08/1994	7,600	NA	190	<10	480	200	NA	NA	99.35	10.20	89.15	NA
MW-1	02/01/1995	8,200	NA	130	21	170	130	NA	NA	99.35	6.94	92.41	NA
MW-1	05/04/1995	7,000	NA	130	47	190	180	NA	NA	99.35	8.40	90.95	NA
MW-1	05/16/1997	5,600	NA	57	<10	26	29	84	NA	99.35	9.93	89.42	1.5
MW-1	11/03/1997	6,900	NA	81	<10	32	30	170	NA	99.35	10.27	89.08	0.8/0.6k
MW-1	06/05/1998	4,200	NA	68	7.6	39	69	84	NA	99.35	8.95	90.40	1.0/0.5k
MW-1	11/06/1998	6,200	NA	87	<2.5	48	55	200	NA	99.35	10.69	88.66	1.2/1.8
MW-1	06/07/1999	5,210	NA	33.6	21.9	7.42	<5.00	153	205	99.35	9.81	89.54	NA
MW-1	06/22/1999	NA	NA	NA	NA	NA	NA	NA	NA	99.35	9.55	89.80	0.8
MW-1	08/27/1999	6,080	NA	46.0	<20.0	<20.0	26.1	303	429	99.35	10.00	89.35	0.7/1.5

WELL CONCENTRATIONS
Shell-Branded Service Station
630 High Street
Oakland, CA
WIC #204-5508-5801

Well ID	Date	TPPH (ug/L)	TEPH (ug/L)	B (ug/L)	T (ug/L)	E (ug/L)	X (ug/L)	MTBE 8020 (ug/L)	MTBE 8260 (ug/L)	TOC (MSL)	Depth to Water (ft.)	GW Elevation (MSL)	DO Reading (ppm)
---------	------	----------------	----------------	-------------	-------------	-------------	-------------	------------------------	------------------------	--------------	----------------------------	--------------------------	------------------------

MW-1	11/11/1999	7,660	NA	92.0	20.4	28.2	46.1	520	542	99.35	10.27	89.08	1.3/1.8
MW-1	04/26/2000	3,730	NA	69.4	<5.00	9.42	28.6	206	NA	99.35	9.54	89.81	2.30/2.71
MW-1	11/02/2000	4,930	NA	81.3	5.32	18.3	29.8	440	NA	99.35	8.90	90.45	3.0/3.2

MW-2	01/29/1991	<50	<50	<0.5	<0.5	<0.5	<0.5	NA	NA	101.15	13.25	87.90	NA
MW-2	04/30/1991	<50	<50	<0.5	<0.5	<0.5	<0.5	NA	NA	101.15	10.94	90.21	NA
MW-2	07/22/1991	<50	<50	<0.5	<0.5	<0.5	<0.5	NA	NA	101.15	12.14	89.01	NA
MW-2	02/21/1992	<50	NA	<0.5	<0.5	<0.5	<0.5	NA	NA	101.15	10.08	91.07	NA
MW-2	05/22/1992	<50	NA	<0.5	<0.5	<0.5	<0.5	NA	NA	101.15	11.52	89.63	NA
MW-2	07/07/1992	NA	NA	NA	NA	NA	NA	NA	NA	101.15	11.50	89.65	NA
MW-2	08/20/1992	<50	NA	<0.5	<0.5	<0.5	<0.5	NA	NA	101.15	11.72	89.43	NA
MW-2	11/18/1992	<50	NA	<0.5	<0.5	<0.5	<0.5	NA	NA	101.15	13.06	88.09	NA
MW-2	02/09/1993	95	NA	<0.5	<0.5	<0.5	<0.5	NA	NA	101.15	10.06	91.09	NA
MW-2	06/16/1993	<50	NA	<0.5	<0.5	<0.5	<0.5	NA	NA	101.15	11.60	89.55	NA
MW-2	08/24/1993	<50	NA	<0.5	<0.5	<0.5	<0.5	NA	NA	101.15	12.16	88.99	NA
MW-2	11/23/1993	<50	NA	<0.5	<0.5	<0.5	<0.5	NA	NA	101.15	12.74	88.41	NA
MW-2	02/14/1994	<50	NA	<0.5	<0.5	<0.5	<0.5	NA	NA	101.15	10.91	90.24	NA
MW-2	05/25/1994	100	NA	1.2	4.9	2.3	13	NA	NA	101.15	11.06	90.09	NA
MW-2	08/04/1994	NA	NA	NA	NA	NA	NA	NA	NA	101.15	12.04	89.11	NA
MW-2	11/08/1994	<50	NA	<0.5	<0.5	<0.5	<0.5	NA	NA	101.15	12.38	88.77	NA
MW-2	02/01/1995	NA	NA	NA	NA	NA	NA	NA	NA	101.15	8.76	92.39	NA
MW-2	05/04/1995	<50	NA	<0.5	<0.5	<0.5	<0.5	NA	NA	101.15	10.20	90.95	NA
MW-2	05/16/1997	NA	NA	NA	NA	NA	NA	NA	NA	101.15	11.28	89.87	NA
MW-2	11/03/1997	NA	NA	NA	NA	NA	NA	NA	NA	101.15	11.71	89.44	NA
MW-2	06/05/1998	NA	NA	NA	NA	NA	NA	NA	NA	101.15	9.85	91.30	NA
MW-2	11/06/1998	NA	NA	NA	NA	NA	NA	NA	NA	101.15	12.60	88.55	NA

WELL CONCENTRATIONS
Shell-Branded Service Station
630 High Street
Oakland, CA
WIC #204-5508-5801

Well ID	Date	TPPH (ug/L)	TEPH (ug/L)	B (ug/L)	T (ug/L)	E (ug/L)	X (ug/L)	MTBE 8020 (ug/L)	MTBE 8260 (ug/L)	TOC (MSL)	Depth to Water (ft.)	GW Elevation (MSL)	DO Reading (ppm)
---------	------	----------------	----------------	-------------	-------------	-------------	-------------	------------------------	------------------------	--------------	----------------------------	--------------------------	------------------------

MW-2	06/07/1999	NA	NA	NA	NA	NA	NA	NA	NA	101.15	11.03	90.12	NA
MW-2	08/27/1999	<50.0	NA	<0.500	<0.500	<0.500	<0.500	19.2	34.5	101.15	10.98	90.17	0.71/4.0
MW-2	11/11/1999	NA	NA	NA	NA	NA	NA	NA	NA	101.15	10.33	90.82	NA
MW-2	04/26/2000	NA	NA	NA	NA	NA	NA	NA	NA	101.15	9.58	91.57	NA
MW-2	11/02/2000	NA	NA	NA	NA	NA	NA	NA	NA	101.15	10.03	91.12	NA

MW-3	01/29/1991	2,300	410a	17	14.1	10	230	NA	NA	99.49	11.09	88.40	NA
MW-3	04/30/1991	<50	260	22	4	7	17	NA	NA	99.49	9.57	89.92	NA
MW-3	07/22/1991	2,000	310	51	<0.5	<0.5	<0.5	NA	NA	99.49	10.66	88.83	NA
MW-3	02/21/1992	2,800	640d	15	2.8	<2.5	12	NA	NA	99.49	8.97	90.52	NA
MW-3	05/22/1992	3,700	220b, c	27	11	20	110	NA	NA	99.49	9.32	90.17	NA
MW-3	07/07/1992	NA	NA	NA	NA	NA	NA	NA	NA	99.49	10.22	89.27	NA
MW-3	08/20/1992	13,000	340b	72	85	71	140	NA	NA	99.49	10.44	89.05	NA
MW-3	11/18/1992	2,100	430b	21	3.6	11	13	NA	NA	99.49	10.79	88.70	NA
MW-3	02/09/1993	3,300	83	21	5.6	6.1	<0.5	NA	NA	99.49	9.35	90.14	NA
MW-3	06/16/1993	3,500e	NA	66	6	<0.5	<0.5	NA	NA	99.49	9.56	89.93	NA
MW-3	08/24/1993	3,400e	NA	110	<5	<5	<5	NA	NA	99.49	10.51	88.98	NA
MW-3	11/23/1993	3,000	NA	36	44	6.9	23	NA	NA	99.49	10.77	88.72	NA
MW-3	02/14/1994	4,700g	NA	9.9	5.2	8.8	<5.0	NA	NA	99.49	9.61	89.88	NA
MW-3	05/25/1994	1,200	NA	<10	<10	<10	<10	NA	NA	99.49	10.00	89.49	NA
MW-3	08/04/1994	2,600	NA	29	<5	14	11	NA	NA	99.49	10.63	88.86	NA
MW-3	11/08/1994	2,600	NA	5.5	1.5	1.9	0.9	NA	NA	99.49	11.02	88.47	NA
MW-3	02/01/1995	4,600	NA	27	1.2	3.2	2.5	NA	NA	99.49	8.31	91.18	NA
MW-3	05/04/1995	1,800	NA	140	11	11	16	NA	NA	99.49	8.70	90.79	NA
MW-3	05/16/1997	NA	NA	NA	NA	NA	NA	NA	NA	99.49	10.30	89.19	NA
MW-3	11/03/1997	NA	NA	NA	NA	NA	NA	NA	NA	99.49	10.52	88.97	NA

WELL CONCENTRATIONS
Shell-Branded Service Station
630 High Street
Oakland, CA
WIC #204-5508-5801

Well ID	Date	TPPH (ug/L)	TEPH (ug/L)	B (ug/L)	T (ug/L)	E (ug/L)	X (ug/L)	MTBE 8020 (ug/L)	MTBE 8260 (ug/L)	TOC (MSL)	Depth to Water (ft.)	GW Elevation (MSL)	DO Reading (ppm)
MW-3	06/05/1998	NA	NA	NA	NA	NA	NA	NA	NA	99.49	9.18	90.31	NA
MW-3	11/06/1998	NA	NA	NA	NA	NA	NA	NA	NA	99.49	11.00	88.49	NA
MW-3	06/07/1999	NA	NA	NA	NA	NA	NA	NA	NA	99.49	10.93	88.56	NA
MW-3	08/27/1999	8,600	NA	2,410	135	279	1,390	26,400	29,500	99.49	10.23	89.26	0.8/0.7
MW-3	11/11/1999	NA	NA	NA	NA	NA	NA	NA	NA	99.49	10.46	89.03	NA
MW-3	04/26/2000	7,100	NA	1,310	573	89.2	376	35,000	38,000	99.49	9.45	90.04	2.42/2.63
MW-3	11/02/2000	4,750	NA	1,210	29.3	50.5	125	8,750	8,960	99.49	10.05	89.44	2.0/2.5
<i>outside hold time</i>													
MW-4	01/29/1991	2,600	1,300	83	<0.5	<0.5	110	NA	NA	99.24	10.76	88.48	NA
MW-4	04/30/1991	2,600	750	22	4	7	17	NA	NA	99.24	9.45	89.79	NA
MW-4	07/22/1991	4,300	1,200	120	<0.5	<0.5	10	NA	NA	99.24	10.34	88.90	NA
MW-4	02/21/1992	2,000	8,300b	31	6.3	3.5	6.6	NA	NA	99.24	7.60	91.64	NA
MW-4	05/22/1992	3,600	3,400b, c	55	5	3	10	NA	NA	99.24	9.90	89.34	NA
MW-4	07/07/1992	NA	NA	NA	NA	NA	NA	NA	NA	99.24	10.02	89.22	NA
MW-4	08/20/1992	3,100	3,400	100	45	14	45	NA	NA	99.24	10.32	88.92	NA
MW-4	11/18/1992	2,200	1,400	32	12	4.2	24	NA	NA	99.24	10.51	88.73	NA
MW-4	02/09/1993	1,500	180	1.1	<0.5	<0.5	<0.5	NA	NA	99.24	8.13	91.11	NA
MW-4	06/16/1993	1,100	NA	120	47	5.1	19	NA	NA	99.24	9.60	89.64	1.86/4.82k
MW-4	08/24/1993	2,700	NA	46	11	25	0.97	NA	NA	99.24	10.05	89.19	1.46/1.27k
MW-4	11/23/1993	2,500	NA	23	5.7	3.7	16	NA	NA	99.24	10.25	89.99	5.29/6.59k
MW-4	02/14/1994	1,500	NA	12	7.8	<2.5	<2.5	NA	NA	99.24	8.83	90.41	2.1/1.9k
MW-4	05/25/1994	810	NA	20	<2	<2	4	NA	NA	99.24	9.64	89.60	NA
MW-4	08/04/1994	2,300	NA	99	15	6.3	24	NA	NA	99.24	10.62	88.62	NA
MW-4	11/08/1994	<50	NA	<0.5	<0.5	<0.5	<0.5	NA	NA	99.24	9.28	89.96	NA
MW-4	02/01/1995	960	NA	5.6	2.2	2.6	2.8	NA	NA	99.24	6.52	92.72	NA
MW-4	05/04/1995	960	NA	20	4.7	3.7	5.6	NA	NA	99.24	8.40	90.84	NA

WELL CONCENTRATIONS
Shell-Branded Service Station
630 High Street
Oakland, CA
WIC #204-5508-5801

Well ID	Date	TPPH (ug/L)	TEPH (ug/L)	B (ug/L)	T (ug/L)	E (ug/L)	X (ug/L)	MTBE 8020 (ug/L)	MTBE 8260 (ug/L)	TOC (MSL)	Depth to Water (ft.)	GW Elevation (MSL)	DO Reading (ppm)
MW-4	05/16/1997	NA	NA	NA	NA	NA	NA	NA	NA	99.24	9.35	89.89	NA
MW-4	11/03/1997	NA	NA	NA	NA	NA	NA	NA	NA	99.24	10.17	89.07	NA
MW-4	06/05/1998	NA	NA	NA	NA	NA	NA	NA	NA	99.24	8.85	90.39	NA
MW-4	11/06/1998	NA	NA	NA	NA	NA	NA	NA	NA	99.24	10.17	89.07	NA
MW-4	06/07/1999	NA	NA	NA	NA	NA	NA	NA	NA	99.24	11.06	88.18	NA
MW-4	08/27/1999	1,520	NA	32.8	6.25	<2.50	5.65	61.5	<2.00	99.24	10.25	88.99	1.0/1.4
MW-4	11/11/1999	NA	NA	NA	NA	NA	NA	NA	NA	99.24	10.11	89.13	NA
MW-4	04/26/2000	NA	NA	NA	NA	NA	NA	NA	NA	99.24	9.18	90.06	NA
MW-4	11/02/2000	NA	NA	NA	NA	NA	NA	NA	NA	99.24	9.72	89.52	NA
MW-5	01/29/1991	3,100	720	86	<0.5	24	28	NA	NA	100.08	11.72	88.36	NA
MW-5	04/30/1991	<50	90	46	<0.5	9	9	NA	NA	100.08	10.45	89.63	NA
MW-5	07/22/1991	1,700	300	23	<0.5	6,700	10,000	NA	NA	100.08	11.43	88.65	NA
MW-5	02/21/1992	240	180h	1	<0.5	<0.5	1	NA	NA	100.08	9.24	90.84	NA
MW-5	05/22/1992	6,200	7,100b, c	6	95	56	99	NA	NA	100.08	10.97	89.11	NA
MW-5	07/07/1992	NA	NA	NA	NA	NA	NA	NA	NA	100.08	10.98	89.10	NA
MW-5	08/20/1992	7,400	120b	56	95	91	150	NA	NA	100.08	11.14	88.94	NA
MW-5	11/18/1992	3,300	320b	27	<12.5	20	470	NA	NA	100.08	11.21	88.87	NA
MW-5	02/09/1993	160	<50	<0.5	<0.5	<0.5	<0.5	NA	NA	100.08	10.01	90.07	NA
MW-5	06/16/1993	140	NA	0.8	<0.5	<0.5	<0.5	NA	NA	100.08	11.05	89.03	1.53/2.72k
MW-5	08/24/1993	1,000	NA	7.9	<1	2.2	<1.5	NA	NA	100.08	11.32	88.76	2.69/1.41k
MW-5	11/23/1993	2,000	NA	67	15	11	33	NA	NA	100.08	11.35	88.73	8.20/3.09k
MW-5	02/14/1994	660	NA	1.3	<0.5	0.5	0.7	NA	NA	100.08	10.34	89.74	2.0/1.9k
MW-5	05/25/1994	670	NA	0.65	<0.5	2.6	<0.5	NA	NA	100.08	10.54	89.54	NA
MW-5	08/04/1994	700	NA	5	<0.5	1.2	<0.5	NA	NA	100.08	11.50	88.58	NA
MW-5	11/08/1994	810	NA	4.2	<0.5	1.5	0.8	NA	NA	100.08	11.24	88.84	NA

WELL CONCENTRATIONS
Shell-Branded Service Station
630 High Street
Oakland, CA
WIC #204-5508-5801

Well ID	Date	TPPH (ug/L)	TEPH (ug/L)	B (ug/L)	T (ug/L)	E (ug/L)	X (ug/L)	MTBE 8020 (ug/L)	MTBE 8260 (ug/L)	TOC (MSL)	Depth to Water (ft.)	GW Elevation (MSL)	DO Reading (ppm)
---------	------	----------------	----------------	-------------	-------------	-------------	-------------	------------------------	------------------------	--------------	----------------------------	--------------------------	------------------------

MW-5	02/01/1995	110	NA	7	<0.5	<0.5	<0.5	NA	NA	100.08	9.05	91.03	NA
MW-5	05/04/1995	260	NA	3.1	1.3	2	1.5	NA	NA	100.08	10.35	89.73	NA
MW-5	05/16/1997	440	NA	2.4	3.1	1.6	3.3	7.1	NA	100.08	11.21	88.87	2.9
MW-5	11/03/1997	1,400	NA	34	<2.5	2.8	4.4	33	NA	100.08	11.43	88.65	3.0/1.2k
MW-5	06/05/1998	230	NA	3.6	0.5	<0.50	1.3	34	NA	100.08	10.35	89.73	3.2/1.4k
MW-5	11/06/1998	1,800	NA	29	<0.50	3.8	7.1	26	NA	100.08	11.89	88.19	2.6/3.0
MW-5	06/07/1999	<50.0	NA	<0.500	<0.500	<0.500	<0.500	19.5	NA	100.08	10.28	89.80	NA
MW-5	06/22/1999	NA	NA	NA	NA	NA	NA	NA	NA	100.08	10.74	89.34	0.6
MW-5	08/27/1999	254	NA	5.09	1.08	<0.500	<0.500	9.97	12.0	100.08	11.01	89.07	NA
MW-5	11/11/1999	549	NA	16.4	3.29	2.18	3.16	18.2	NA	100.08	11.33	88.75	2.3/2.7
MW-5	04/26/2000	338	NA	0.787	2.30	<0.500	3.01	21.7	NA	100.08	10.32	89.76	1.99/3.01
MW-5	11/02/2000	507	NA	0.659	2.39	2.70	3.88	20.0	NA	100.08	10.75	89.33	4.0/2.0

MW-6	01/29/1991	<50	860	<0.5	<0.5	<0.5	<0.5	NA	NA	98.56	10.23	88.33	NA
MW-6	04/30/1991	<50	1,100	<0.5	<0.5	<0.5	<0.5	NA	NA	98.56	9.15	89.41	NA
MW-6	07/22/1991	<50	1,200	<0.5	<0.5	<0.5	<0.5	NA	NA	98.56	10.10	88.46	NA
MW-6	02/21/1992	<50	60d	<0.5	<0.5	<0.5	<0.5	NA	NA	98.56	7.15	91.41	NA
MW-6	05/22/1992	<50	650c	<0.5	<0.5	<0.5	<0.5	NA	NA	98.56	9.55	89.01	NA
MW-6	07/07/1992	NA	NA	NA	NA	NA	NA	NA	NA	98.56	9.53	89.03	NA
MW-6	08/20/1992	140e	510c	<0.5	<0.5	<0.5	<0.5	NA	NA	98.56	9.84	88.72	NA
MW-6	11/18/1992	200e	350	<0.5	<0.5	<0.5	<0.5	NA	NA	98.56	10.03	88.53	NA
MW-6	02/09/1993	14,000e	NA	<0.5	<0.5	<0.5	<0.5	NA	NA	98.56	7.91	90.65	NA
MW-6	06/16/1993	5,700e	NA	<0.5	22	<0.5	34	NA	NA	98.56	8.74	89.82	8.46/9.73k
MW-6	08/24/1993	4,300e	NA	<12.5	<12.5	<12.5	<12.5	NA	NA	98.56	9.66	88.90	2.15/1.52k
MW-6	11/23/1993	3,300e	NA	<12	<12	<12	<12	NA	NA	98.56	9.86	88.70	3.86/6.75k
MW-6	02/14/1994	14,000e	NA	<12.5	<12.5	<12.5	<12.5	NA	NA	98.56	8.27	90.29	2.3/5.2k

WELL CONCENTRATIONS
Shell-Branded Service Station
630 High Street
Oakland, CA
WIC #204-5508-5801

Well ID	Date	TPPH (ug/L)	TEPH (ug/L)	B (ug/L)	T (ug/L)	E (ug/L)	X (ug/L)	MTBE 8020 (ug/L)	MTBE 8260 (ug/L)	TOC (MSL)	Depth to Water (ft.)	GW Elevation (MSL)	DO Reading (ppm)
---------	------	----------------	----------------	-------------	-------------	-------------	-------------	------------------------	------------------------	--------------	----------------------------	--------------------------	------------------------

MW-6	05/25/1994	<1,000i	NA	<10	<10	<10	<10	NA	NA	98.56	8.89	89.67	NA
MW-6	08/04/1994	250j	NA	<0.5	<0.5	<0.5	<0.5	NA	NA	98.56	10.10	88.46	NA
MW-6	11/08/1994	4,600e	NA	<0.5	<0.5	<0.5	<0.5	NA	NA	98.56	8.98	89.58	NA
MW-6	02/01/1995	710	NA	<0.5	<0.5	<0.5	<0.5	NA	NA	98.56	7.07	91.49	NA
MW-6	05/04/1995	<50	NA	<0.5	<0.5	<0.5	<0.5	NA	NA	98.56	8.56	90.00	NA
MW-6	05/16/1997	<500	NA	<5.0	<5.0	<5.0	<5.0	1,700	NA	98.56	9.57	88.99	6.2
MW-6	11/03/1997	<500	NA	<5.0	<5.0	<5.0	<5.0	990	NA	98.56	9.76	88.80	1.4/1.0k
MW-6	06/05/1998	<50	NA	<0.50	<0.50	<0.50	<0.50	590	NA	98.56	8.50	90.06	1.5/1.1k
MW-6	11/06/1998	<250	NA	<2.5	<2.5	<2.5	<2.5	810	NA	98.56	10.00	88.56	2.0/1.4
MW-6	06/07/1999	<50.0	NA	<0.500	<0.500	<0.500	<0.500	71.5	NA	98.56	9.35	89.21	NA
MW-6	06/22/1999	NA	NA	NA	NA	NA	NA	NA	NA	98.56	9.20	89.36	1.9
MW-6	08/27/1999	<50.0	NA	<0.500	<0.500	<0.500	<0.500	197	276	98.56	9.52	89.04	1.5/7.8
MW-6	11/11/1999	<50.0	NA	<0.500	<0.500	<0.500	<0.500	212	NA	98.56	9.87	88.69	1.4/1.7
MW-6	04/26/2000	<50.0	NA	<0.500	<0.500	<0.500	<0.500	236	NA	98.56	9.13	89.43	1.93/2.90
MW-6	11/02/2000	<50.0	NA	<0.500	<0.500	<0.500	<0.500	497	NA	98.56	9.13	89.43	2.5/3.5

MW-7	01/29/1991	<50	<50	<0.5	<0.5	<0.5	<0.5	NA	NA	97.53	8.91	88.62	NA
MW-7	04/30/1991	<50	<50	<0.5	<0.5	<0.5	<0.5	NA	NA	97.53	8.38	89.15	NA
MW-7	07/22/1991	<50	<50	<0.5	<0.5	<0.5	<0.5	NA	NA	97.53	9.13	88.40	NA
MW-7	02/21/1992	<50	NA	<0.5	<0.5	<0.5	<0.5	NA	NA	97.53	6.87	90.66	NA
MW-7	05/22/1992	<50	NA	<0.5	<0.5	<0.5	<0.5	NA	NA	97.53	8.08	89.45	NA
MW-7	07/07/1992	NA	NA	NA	NA	NA	NA	NA	NA	97.53	8.82	88.71	NA
MW-7	08/20/1992	<50	NA	<0.5	<0.5	<0.5	<0.5	NA	NA	97.53	8.89	88.64	NA
MW-7	11/18/1992	<50	NA	<0.5	<0.5	<0.5	<0.5	NA	NA	97.53	9.54	87.99	NA
MW-7	02/09/1993	72	NA	<0.5	<0.5	<0.5	<0.5	NA	NA	97.53	7.84	89.69	NA
MW-7	06/16/1993	<50	NA	<0.5	<0.5	<0.5	<0.5	NA	NA	97.53	7.80	89.73	NA

WELL CONCENTRATIONS
Shell-Branded Service Station
630 High Street
Oakland, CA
WIC #204-5508-5801

Well ID	Date	TPPH (ug/L)	TEPH (ug/L)	B (ug/L)	T (ug/L)	E (ug/L)	X (ug/L)	MTBE 8020 (ug/L)	MTBE 8260 (ug/L)	TOC (MSL)	Depth to Water (ft.)	GW Elevation (MSL)	DO Reading (ppm)
---------	------	----------------	----------------	-------------	-------------	-------------	-------------	------------------------	------------------------	--------------	----------------------------	--------------------------	------------------------

MW-7	08/24/1993	<50	NA	<0.5	<0.5	<0.5	<0.5	NA	NA	97.53	8.51	89.02	NA
MW-7	11/23/1993	<50	NA	<0.5	<0.5	<0.5	<0.5	NA	NA	97.53	8.70	88.83	NA
MW-7	02/14/1994	<50	NA	<0.5	<0.5	<0.5	<0.5	NA	NA	97.53	7.52	90.01	NA
MW-7	05/25/1994	<50	NA	<0.5	0.63	<0.5	0.93	NA	NA	97.53	9.04	88.49	NA
MW-7	08/04/1994	NA	NA	NA	NA	NA	NA	NA	NA	97.53	9.80	87.83	NA
MW-7	11/08/1994	<50	NA	<0.5	<0.5	<0.5	<0.5	NA	NA	97.53	8.45	89.08	NA
MW-7	02/01/1995	NA	NA	NA	NA	NA	NA	NA	NA	97.53	5.51	92.02	NA
MW-7	05/04/1995	<50	NA	<0.5	<0.5	<0.5	<0.5	NA	NA	97.53	8.34	89.19	NA
MW-7	05/16/1997	<50	NA	<0.50	<0.50	<0.50	<0.50	2.7	NA	97.53	8.80	88.73	2.8
MW-7	11/03/1997	<50	NA	<0.50	<0.50	<0.50	<0.50	<2.5	NA	97.53	8.95	88.58	1.6/1.2k
MW-7	06/05/1998	<50	NA	<0.50	<0.50	<0.50	<0.50	4.3	NA	97.53	7.75	89.78	1.5/1.1k
MW-7	11/06/1998	<50	NA	<0.50	<0.50	<0.50	<0.50	4.5	NA	97.53	9.20	88.33	4.1/2.2
MW-7	06/07/1999	<50.0	NA	<0.500	<0.500	<0.500	<0.500	<2.50	NA	97.53	8.39	89.14	NA
MW-7	06/22/1999	NA	NA	NA	NA	NA	NA	NA	NA	97.53	8.43	89.10	0.4
MW-7	06/22/1999	NA	NA	NA	NA	NA	NA	NA	NA	97.53	8.43	89.10	0.4
MW-7	08/27/1999	<50.0	NA	<0.500	<0.500	<0.500	<0.500	<5.00	4.33	97.53	8.82	88.71	1.3/1.9
MW-7	11/11/1999	<50.0	NA	<0.500	<0.500	<0.500	<0.500	4.30	NA	97.53	8.64	88.89	1.1/1.0
MW-7	04/26/2000	<50.0	NA	<0.500	<0.500	<0.500	<0.500	6.59	NA	97.53	8.31	89.22	1.09/2.41
MW-7	11/02/2000	<50.0	NA	<0.500	<0.500	<0.500	<0.500	7.38	NA	97.53	7.80	89.73	4.0/4.0

MW-8	01/29/1991	<50	<50	<0.5	<0.5	<0.5	<0.5	NA	NA	97.13	8.47	88.66	NA
MW-8	04/30/1991	<50	<50	<0.5	<0.5	<0.5	<0.5	NA	NA	97.13	7.64	89.49	NA
MW-8	07/22/1991	<50	<50	<0.5	<0.5	<0.5	<0.5	NA	NA	97.13	8.36	88.77	NA
MW-8	02/21/1992	<50	NA	<0.5	<0.5	<0.5	<0.5	NA	NA	97.13	6.54	90.59	NA
MW-8	05/22/1992	<50	NA	<0.5	<0.5	<0.5	<0.5	NA	NA	97.13	7.68	89.45	NA
MW-8	07/07/1992	NA	NA	NA	NA	NA	NA	NA	NA	97.13	8.16	88.97	NA

WELL CONCENTRATIONS
Shell-Branded Service Station
630 High Street
Oakland, CA
WIC #204-5508-5801

Well ID	Date	TPPH (ug/L)	TEPH (ug/L)	B (ug/L)	T (ug/L)	E (ug/L)	X (ug/L)	MTBE 8020 (ug/L)	MTBE 8260 (ug/L)	TOC (MSL)	Depth to Water (ft.)	GW Elevation (MSL)	DO Reading (ppm)
---------	------	----------------	----------------	-------------	-------------	-------------	-------------	------------------------	------------------------	--------------	----------------------------	--------------------------	------------------------

MW-8	08/20/1992	<50	NA	<0.5	<0.5	<0.5	<0.5	NA	NA	97.13	8.25	88.88	NA
MW-8	11/18/1992	<50	NA	<0.5	<0.5	<0.5	<0.5	NA	NA	97.13	8.32	88.81	NA
MW-8	02/09/1993	63	NA	<0.5	<0.5	<0.5	<0.5	NA	NA	97.13	5.58	91.55	NA
MW-8	06/16/1993	<50	NA	<0.5	<0.5	<0.5	<0.5	NA	NA	97.13	7.19	89.94	NA
MW-8	08/24/1993	<50	NA	<0.5	<0.5	<0.5	<0.5	NA	NA	97.13	7.98	89.15	NA
MW-8	11/23/1993	<50	NA	<0.5	<0.5	<0.5	<0.5	NA	NA	97.13	8.09	89.04	NA
MW-8	02/14/1994	<50	NA	<0.5	<0.5	<0.5	<0.5	NA	NA	97.13	9.42	87.71	NA
MW-8	05/25/1994	<50	NA	<0.5	1.1	<0.5	2.5	NA	NA	97.13	7.18	89.95	NA
MW-8	08/04/1994	NA	NA	NA	NA	NA	NA	NA	NA	97.13	8.51	88.62	NA
MW-8	11/08/1994	<50	NA	<0.5	<0.5	<0.5	<0.5	NA	NA	97.13	6.24	90.89	NA
MW-8	02/01/1995	NA	NA	NA	NA	NA	NA	NA	NA	97.13	3.94	93.19	NA
MW-8	05/04/1995	<50	NA	<0.5	<0.5	<0.5	<0.5	NA	NA	97.13	5.04	92.09	NA
MW-8	05/16/1997	NA	NA	NA	NA	NA	NA	NA	NA	97.13	7.65	89.48	NA
MW-8	11/03/1997	NA	NA	NA	NA	NA	NA	NA	NA	97.13	7.03	90.10	NA
MW-8	06/05/1998	NA	NA	NA	NA	NA	NA	NA	NA	97.13	6.47	90.66	NA
MW-8	11/06/1998	NA	NA	NA	NA	NA	NA	NA	NA	97.13	8.27	88.86	NA
MW-8	06/07/1999	NA	NA	NA	NA	NA	NA	NA	NA	97.13	8.69	88.44	NA
MW-8	08/27/1999	<50.0	NA	<0.500	<0.500	<0.500	<0.500	<5.00	<2.00	97.13	7.82	89.31	1.5/2.0
MW-8	11/11/1999	NA	NA	NA	NA	NA	NA	NA	NA	97.13	7.91	89.22	NA
MW-8	04/26/2000	NA	NA	NA	NA	NA	NA	NA	NA	97.13	7.10	90.03	NA
MW-8	11/02/2000	NA	NA	NA	NA	NA	NA	NA	NA	97.13	7.95	89.18	NA

MW-9	01/29/1991	<50	<50	<0.5	<0.5	<0.5	<0.5	NA	NA	99.72	8.27	91.45	NA
MW-9	04/30/1991	<50	<50	0.6	<0.5	<0.5	1.1	NA	NA	99.72	7.62	92.10	NA
MW-9	07/22/1991	<50	<50	<0.5	<0.5	<0.5	<0.5	NA	NA	99.72	8.48	91.24	NA
MW-9	02/21/1992	<50	NA	<0.5	<0.5	<0.5	<0.5	NA	NA	99.72	6.91	92.81	NA

WELL CONCENTRATIONS
Shell-Branded Service Station
630 High Street
Oakland, CA
WIC #204-5508-5801

Well ID	Date	TPPH (ug/L)	TEPH (ug/L)	B (ug/L)	T (ug/L)	E (ug/L)	X (ug/L)	MTBE 8020 (ug/L)	MTBE 8260 (ug/L)	TOC (MSL)	Depth to Water (ft.)	GW Elevation (MSL)	DO Reading (ppm)
MW-9	05/22/1992	<50	NA	<0.5	<0.5	<0.5	<0.5	NA	NA	99.72	8.64	91.08	NA
MW-9	07/07/1992	NA	NA	NA	NA	NA	NA	NA	NA	99.72	7.55	92.17	NA
MW-9	08/20/1992	<50	NA	<0.5	<0.5	<0.5	<0.5	NA	NA	99.72	7.38	92.34	NA
MW-9	11/18/1992	<50	NA	<0.5	<0.5	<0.5	<0.5	NA	NA	99.72	10.17	89.55	NA
MW-9	02/09/1993	290	110	6	<0.5	<0.5	<0.5	NA	NA	99.72	6.89	92.83	NA
MW-9	06/16/1993	90e	NA	<0.5	<0.5	<0.5	<0.5	NA	NA	99.72	8.74	90.98	1.51/2.17k
MW-9	08/24/1993	50e	NA	<0.5	<0.5	<0.5	<0.5	NA	NA	99.72	8.32	91.40	2.86/2.74k
MW-9	11/23/1993	<50	NA	<0.5	<0.5	<0.5	<0.5	NA	NA	99.72	8.17	91.55	3.41/3.78k
MW-9	02/14/1994	<50	NA	<0.5	<0.5	<0.5	<0.5	NA	NA	99.72	7.67	92.05	4.6/5.2k
MW-9	05/25/1994	56	NA	1.3	4	1.4	8.3	NA	NA	99.72	7.89	91.83	NA
MW-9	08/04/1994	NA	NA	NA	NA	NA	NA	NA	NA	99.72	9.76	89.96	NA
MW-9	11/08/1994	<50	NA	<0.5	<0.5	<0.5	<0.5	NA	NA	99.72	7.75	91.97	NA
MW-9	02/01/1995	NA	NA	NA	NA	NA	NA	NA	NA	99.72	5.66	94.06	NA
MW-9	05/04/1995	<50	NA	<0.5	<0.5	<0.5	<0.5	NA	NA	99.72	7.40	92.32	NA
MW-9	05/16/1997	NA	NA	NA	NA	NA	NA	NA	NA	99.72	7.72	92.00	NA
MW-9	11/03/1997	NA	NA	NA	NA	NA	NA	NA	NA	99.72	6.93	92.79	NA
MW-9	06/05/1998	NA	NA	NA	NA	NA	NA	NA	NA	99.72	7.23	92.49	NA
MW-9	11/06/1998	NA	NA	NA	NA	NA	NA	NA	NA	99.72	9.91	89.81	NA
MW-9	06/07/1999	NA	NA	NA	NA	NA	NA	NA	NA	99.72	9.03	90.69	NA
MW-9	08/27/1999	<50.0	NA	<0.500	<0.500	<0.500	<0.500	<5.00	<2.00	99.72	7.45	92.27	3.5/4.3
MW-9	11/11/1999	NA	NA	NA	NA	NA	NA	NA	NA	99.72	7.40	92.32	NA
MW-9	04/26/2000	NA	NA	NA	NA	NA	NA	NA	NA	99.72	7.66	92.06	NA
MW-9	11/02/2000	NA	NA	NA	NA	NA	NA	NA	NA	99.72	8.41	91.31	NA
MW-10	01/29/1991	<50	NA	<0.5	<0.5	<0.5	<0.5	NA	NA	98.99	10.81	88.18	NA
MW-10	04/30/1991	<50	460	<0.5	<0.5	<0.5	<0.5	NA	NA	98.99	8.79	90.20	NA

WELL CONCENTRATIONS
Shell-Branded Service Station
630 High Street
Oakland, CA
WIC #204-5508-5801

Well ID	Date	TPPH (ug/L)	TEPH (ug/L)	B (ug/L)	T (ug/L)	E (ug/L)	X (ug/L)	MTBE 8020 (ug/L)	MTBE 8260 (ug/L)	TOC (MSL)	Depth to Water (ft.)	GW Elevation (MSL)	DO Reading (ppm)
MW-10	07/22/1991	<50	<50	<0.5	<0.5	<0.5	<0.5	NA	NA	98.99	9.94	89.05	NA
MW-10	02/21/1992	<50	120	<0.5	<0.5	<0.5	<0.5	NA	NA	98.99	9.11	89.88	NA
MW-10	05/22/1992	<50	310	<0.5	<0.5	<0.5	<0.5	NA	NA	98.99	9.14	89.85	NA
MW-10	07/07/1992	NA	NA	NA	NA	NA	NA	NA	NA	98.99	9.87	89.12	NA
MW-10	08/20/1992	<50	460	<0.5	<0.5	<0.5	<0.5	NA	NA	98.99	9.30	89.69	NA
MW-10	11/18/1992	<50	470	<0.5	<0.5	<0.5	<0.5	NA	NA	98.99	10.21	88.78	NA
MW-10	02/09/1993	<50	NA	<0.5	<0.5	<0.5	<0.5	NA	NA	98.99	7.63	91.36	NA
MW-10	06/16/1993	<50	NA	<0.5	<0.5	<0.5	<0.5	NA	NA	98.99	8.57	90.42	NA
MW-10	08/24/1993	<50	NA	<0.5	<0.5	<0.5	<0.5	NA	NA	98.99	9.61	89.38	NA
MW-10	11/23/1993	<50	NA	<0.5	<0.5	<0.5	<0.5	NA	NA	98.99	10.10	88.89	NA
MW-10	02/14/1994	<50	NA	<0.5	<0.5	<0.5	<0.5	NA	NA	98.99	9.01	89.98	NA
MW-10	05/25/1994	<50	NA	<0.5	1.1	<0.5	1.4	NA	NA	98.99	8.84	90.15	NA
MW-10	08/04/1994	NA	NA	NA	NA	NA	NA	NA	NA	98.99	9.82	89.17	NA
MW-10	11/08/1994	<50	NA	<0.5	<0.5	<0.5	<0.5	NA	NA	98.99	9.40	89.59	NA
MW-10	02/01/1995	NA	NA	NA	NA	NA	NA	NA	NA	98.99	6.78	92.21	NA
MW-10	05/04/1995	NA	NA	NA	NA	NA	NA	NA	NA	98.99	7.00	91.99	NA
MW-10	05/16/1997	<50	NA	<0.5	<0.5	<0.5	<0.5	NA	NA	98.99	8.66	90.33	NA
MW-10	11/03/1997	NA	NA	NA	NA	NA	NA	NA	NA	98.99	9.37	89.62	NA
MW-10	06/05/1998	NA	NA	NA	NA	NA	NA	NA	NA	98.99	7.27	91.72	NA
MW-10	11/06/1998	NA	NA	NA	NA	NA	NA	NA	NA	98.99	9.48	89.51	NA
MW-10	06/07/1999	NA	NA	NA	NA	NA	NA	NA	NA	98.99	8.72	90.27	NA
MW-10	08/27/1999	<50.0	NA	<0.500	<0.500	<0.500	<0.500	<5.00	<2.00	98.99	8.62	90.37	1.6/1.6
MW-10	11/11/1999	NA	NA	NA	NA	NA	NA	NA	NA	98.99	8.55	90.44	NA
MW-10	04/26/2000	NA	NA	NA	NA	NA	NA	NA	NA	98.99	7.39	91.60	NA
MW-10	11/02/2000	NA	NA	NA	NA	NA	NA	NA	NA	98.99	8.26	90.73	NA

WELL CONCENTRATIONS
Shell-Branded Service Station
630 High Street
Oakland, CA
WIC #204-5508-5801

Well ID	Date	TPPH (ug/L)	TEPH (ug/L)	B (ug/L)	T (ug/L)	E (ug/L)	X (ug/L)	MTBE 8020 (ug/L)	MTBE 8260 (ug/L)	TOC (MSL)	Depth to Water (ft.)	GW Elevation (MSL)	DO Reading (ppm)
---------	------	----------------	----------------	-------------	-------------	-------------	-------------	------------------------	------------------------	--------------	----------------------------	--------------------------	------------------------

Abbreviations:

TPPH= Total petroleum hydrocarbons as gasoline by modified EPA Method 8015

TEPH = Total petroleum hydrocarbons as diesel by modified EPA Method 8015

BTEX = benzene, toluene, ethylbenzene, xylenes by EPA Method 8020

MTBE = methyl-tertiary-butyl ether

TOC = Top of Casing Elevation

GW = Groundwater

DO = Dissolved Oxygen

ug/L = parts per billion

msl = Mean sea level

ft = Feet

<n = Below detection limit

D = Duplicate sample

NA = Not Applicable

n/n = 1st case volume/3rd case volume D.O.'s

ppm = parts per million

Notes:

a =Compounds detected and calculated as TEPH do not match the diesel standard; pattern is characteristic of weathered diesel.

b =Concentration reported as TEPH is primarily due to the presence of a lighter petroleum product, possibly gasoline or kerosene.

c =Concentration reported as TEPH is primarily due to a heavier petroleum product, possibly motor oil or aged diesel fuel.

d =Compounds detected within the TEPH range are not characteristic of the standard diesel chromatographic pattern.

e =Concentration reported as TPPH is primarily due to the presence of a discrete hydrocarbon peak not indicative of gasoline.

f =26 ug/L benzene detected using EPA Method 8240.

g =The concentration reported as TPPH is due to the presence of a combination of gasoline and a discrete peak not indicative of gasoline.

h =Compounds detected and calculated as TPPH appear to be the less volatile constituents of gasoline.

WELL CONCENTRATIONS
Shell-Branded Service Station
630 High Street
Oakland, CA
WIC #204-5508-5801

Well ID	Date	TPPH (ug/L)	TEPH (ug/L)	B (ug/L)	T (ug/L)	E (ug/L)	X (ug/L)	MTBE 8020 (ug/L)	MTBE 8260 (ug/L)	TOC (MSL)	Depth to Water (ft.)	GW Elevation (MSL)	DO Reading (ppm)
---------	------	----------------	----------------	-------------	-------------	-------------	-------------	------------------------	------------------------	--------------	----------------------------	--------------------------	------------------------

i =Sample diluted due to high-non hydrocarbon peak.

j =The positive result has an atypical pattern for gasoline analysis.

k =Field measurement of DO concentrations before and after well purging.

l = This sample was analyzed outside of EPA recommended holding time.



Sequoia Analytical

885 Jarvis Drive
Morgan Hill, CA 95037
(408) 776-9600
FAX (408) 782-6308
www.sequiolabs.com

5 December, 2000

Nick Sudano
Blaine Tech Services (Shell)
1680 Rogers Avenue
San Jose, CA 95112

RE: 630 High St.
Sequoia Report: MJK0241

Enclosed are the results of analyses for samples received by the laboratory on 11/03/00 12:52. If you have any questions concerning this report, please feel free to contact me.

Sincerely,

for Wayne Stevenson
Client Services Manager

CA ELAP Certificate #1210





Blaine Tech Services (Shell)
1680 Rogers Avenue
San Jose CA, 95112

Project: 630 High St.
Project Number: 630 High St.
Project Manager: Nick Sudano

Reported:
12/05/00 12:17

ANALYTICAL REPORT FOR SAMPLES

Sample ID	Laboratory ID	Matrix	Date Sampled	Date Received
MW-1	MJK0241-01	Water	11/02/00 15:45	11/03/00 12:52
MW-3	MJK0241-02	Water	11/02/00 16:00	11/03/00 12:52
MW-5	MJK0241-03	Water	11/02/00 15:32	11/03/00 12:52
MW-6	MJK0241-04	Water	11/02/00 14:47	11/03/00 12:52
MW-7	MJK0241-05	Water	11/02/00 13:42	11/03/00 12:52

Sequoia Analytical - Morgan Hill

The results in this report apply to the samples analyzed in accordance with the chain of custody document. This analytical report must be reproduced in its entirety.

Wayne Stevenson, Client Services Manager





Blaine Tech Services (Shell)
1680 Rogers Avenue
San Jose CA, 95112

Project: 630 High St.
Project Number: 630 High St.
Project Manager: Nick Sudano

Reported:
12/05/00 12:17

Total Purgeable Hydrocarbons (C6-C12), BTEX and MTBE by DHS LUFT Sequoia Analytical - Morgan Hill

Analyte	Result	Reporting Limit	Units	Dilution	Batch	Prepared	Analyzed	Method	Notes
MW-1 (MJK0241-01) Water Sampled: 11/02/00 15:45 Received: 11/03/00 12:52									
Purgeable Hydrocarbons	4930	500	ug/l	10	OK10002	11/10/00	11/10/00	DHS LUFT	P-01
Benzene	81.3	5.00	"	"	"	"	"	"	
Toluene	5.32	5.00	"	"	"	"	"	"	
Ethylbenzene	18.3	5.00	"	"	"	"	"	"	
Xylenes (total)	29.8	5.00	"	"	"	"	"	"	
Methyl tert-butyl ether	440	25.0	"	"	"	"	"	"	
Surrogate: a,a,a-Trifluorotoluene		112 %	70-130		"	"	"	"	
MW-3 (MJK0241-02) Water Sampled: 11/02/00 16:00 Received: 11/03/00 12:52									
Purgeable Hydrocarbons	4750	1000	ug/l	20	OK10002	11/10/00	11/10/00	DHS LUFT	P-01
Benzene	1210	10.0	"	"	"	"	"	"	
Toluene	29.3	10.0	"	"	"	"	"	"	
Ethylbenzene	50.5	10.0	"	"	"	"	"	"	
Xylenes (total)	125	10.0	"	"	"	"	"	"	
Methyl tert-butyl ether	8750	250	"	100	"	"	11/13/00	"	M-03
Surrogate: a,a,a-Trifluorotoluene		116 %	70-130		"	"	11/10/00	"	
MW-5 (MJK0241-03) Water Sampled: 11/02/00 15:32 Received: 11/03/00 12:52									
Purgeable Hydrocarbons	507	50.0	ug/l	1	OK10002	11/10/00	11/10/00	DHS LUFT	P-03
Benzene	0.659	0.500	"	"	"	"	"	"	
Toluene	2.39	0.500	"	"	"	"	"	"	
Ethylbenzene	2.70	0.500	"	"	"	"	"	"	
Xylenes (total)	3.88	0.500	"	"	"	"	"	"	
Methyl tert-butyl ether	20.0	2.50	"	"	"	"	"	"	
Surrogate: a,a,a-Trifluorotoluene		106 %	70-130		"	"	"	"	





Blaine Tech Services (Shell)
1680 Rogers Avenue
San Jose CA, 95112

Project: 630 High St.
Project Number: 630 High St.
Project Manager: Nick Sudano

Reported:
12/05/00 12:17

Total Purgeable Hydrocarbons (C6-C12), BTEX and MTBE by DHS LUFT Sequoia Analytical - Morgan Hill

Analyte	Result	Reporting Limit	Units	Dilution	Batch	Prepared	Analyzed	Method	Notes
MW-6 (MJK0241-04) Water Sampled: 11/02/00 14:47 Received: 11/03/00 12:52									
Purgeable Hydrocarbons	ND	50.0	ug/l	1	OK10002	11/10/00	11/10/00	DHS LUFT	
Benzene	ND	0.500	"	"	"	"	"	"	
Toluene	ND	0.500	"	"	"	"	"	"	
Ethylbenzene	ND	0.500	"	"	"	"	"	"	
Xylenes (total)	ND	0.500	"	"	"	"	"	"	
Methyl tert-butyl ether	497	25.0	"	10	"	"	11/10/00	"	M-03
<i>Surrogate: a,a,a-Trifluorotoluene</i>		94.4 %	70-130	"	"	"	11/10/00	"	
MW-7 (MJK0241-05) Water Sampled: 11/02/00 13:42 Received: 11/03/00 12:52									
Purgeable Hydrocarbons	ND	50.0	ug/l	1	OK10002	11/10/00	11/10/00	DHS LUFT	
Benzene	ND	0.500	"	"	"	"	"	"	
Toluene	ND	0.500	"	"	"	"	"	"	
Ethylbenzene	ND	0.500	"	"	"	"	"	"	
Xylenes (total)	ND	0.500	"	"	"	"	"	"	
Methyl tert-butyl ether	7.38	2.50	"	"	"	"	"	"	
<i>Surrogate: a,a,a-Trifluorotoluene</i>		94.6 %	70-130	"	"	"	"	"	





Blaine Tech Services (Shell)
1680 Rogers Avenue
San Jose CA, 95112

Project: 630 High St.
Project Number: 630 High St.
Project Manager: Nick Sudano

Reported:
12/05/00 12:17

**MTBE Confirmation by EPA Method 8260A
Sequoia Analytical - Morgan Hill**

Analyte	Result	Reporting Limit	Units	Dilution	Batch	Prepared	Analyzed	Method	Notes
MW-3 (MJK0241-02) Water Sampled: 11/02/00 16:00 Received: 11/03/00 12:52									
Methyl tert-butyl ether	8960	200	ug/l	200	0L05007	12/01/00	12/04/00	EPA 8260A	H-02
Surrogate: 1,2-Dichloroethane-d4		104 %	70-130		"	"	"	"	H-02





Blaine Tech Services (Shell)
1680 Rogers Avenue
San Jose CA, 95112

Project: 630 High St.
Project Number: 630 High St.
Project Manager: Nick Sudano

Reported:
12/05/00 12:17

Total Purgeable Hydrocarbons (C6-C12), BTEX and MTBE by DHS LUFT - Quality Control Sequoia Analytical - Morgan Hill

Analyte	Result	Reporting Limit	Units	Spike Level	Source Result	%REC	%REC Limits	RPD	RPD Limit	Notes
---------	--------	-----------------	-------	-------------	---------------	------	-------------	-----	-----------	-------

Batch 0K10002 - EPA 5030B [P/T]

Blank (0K10002-BLK1)

Prepared & Analyzed: 11/10/00

Purgeable Hydrocarbons	ND	50.0	ug/l							
Benzene	ND	0.500	"							
Toluene	ND	0.500	"							
Ethylbenzene	ND	0.500	"							
Xylenes (total)	ND	0.500	"							
Methyl tert-butyl ether	ND	2.50	"							
<i>Surrogate: a,a,a-Trifluorotoluene</i>	9.79		"	10.0		97.9	70-130			

LCS (0K10002-BS1)

Prepared & Analyzed: 11/10/00

Purgeable Hydrocarbons	236	50.0	ug/l	250		94.4	70-130			
<i>Surrogate: a,a,a-Trifluorotoluene</i>	10.4		"	10.0		104	70-130			

Matrix Spike (0K10002-MS1)

Source: MJK0241-05

Prepared & Analyzed: 11/10/00

Purgeable Hydrocarbons	209	50.0	ug/l	250	ND	83.6	60-140			
<i>Surrogate: a,a,a-Trifluorotoluene</i>	10.5		"	10.0		105	70-130			

Matrix Spike Dup (0K10002-MSD1)

Source: MJK0241-05

Prepared & Analyzed: 11/10/00

Purgeable Hydrocarbons	200	50.0	ug/l	250	ND	80.0	60-140	4.40	25	
<i>Surrogate: a,a,a-Trifluorotoluene</i>	10.1		"	10.0		101	70-130			





Blaine Tech Services (Shell)
1680 Rogers Avenue
San Jose CA, 95112

Project: 630 High St.
Project Number: 630 High St.
Project Manager: Nick Sudano

Reported:
12/05/00 12:17

**MTBE Confirmation by EPA Method 8260A - Quality Control
Sequoia Analytical - Morgan Hill**

Analyte	Result	Reporting Limit	Units	Spike Level	Source Result	%REC	%REC Limits	RPD	RPD Limit	Notes
---------	--------	-----------------	-------	-------------	---------------	------	-------------	-----	-----------	-------

Batch 0L05007 - EPA 5030B [P/T]

Blank (0L05007-BLK1)

Prepared & Analyzed: 12/01/00

Methyl tert-butyl ether	ND	1.00	ug/l							
Surrogate: 1,2-Dichloroethane-d4	9.12		"	10.0		91.2	70-130			

LCS (0L05007-BS1)

Prepared & Analyzed: 12/01/00

Methyl tert-butyl ether	7.50	1.00	ug/l	10.0		75.0	70-130			
Surrogate: 1,2-Dichloroethane-d4	9.75		"	10.0		97.5	70-130			

Matrix Spike (0L05007-MS1)

Source: MJK0241-02

Prepared & Analyzed: 12/01/00

Methyl tert-butyl ether	9910	200	ug/l	2000	8960	47.5	70-130			Q-02
Surrogate: 1,2-Dichloroethane-d4	10.3		"	10.0		103	70-130			

Matrix Spike Dup (0L05007-MSD1)

Source: MJK0241-02

Prepared & Analyzed: 12/01/00

Methyl tert-butyl ether	9810	200	ug/l	2000	8960	42.5	70-130	1.01	25	Q-02
Surrogate: 1,2-Dichloroethane-d4	10.9		"	10.0		109	70-130			





Blaine Tech Services (Shell)
1680 Rogers Avenue
San Jose CA, 95112

Project: 630 High St.
Project Number: 630 High St.
Project Manager: Nick Sudano

Reported:
12/05/00 12:17

Notes and Definitions

- H-02 This sample was analyzed outside of EPA recommended hold time.
- M-03 Sample was analyzed at a second dilution per clients request.
- P-01 Chromatogram Pattern: Gasoline C6-C12
- P-03 Chromatogram Pattern: Unidentified Hydrocarbons C6-C12
- Q-02 The spike recovery for this QC sample is outside of established control limits due to sample matrix interference.
- DET Analyte DETECTED
- ND Analyte NOT DETECTED at or above the reporting limit
- NR Not Reported
- dry Sample results reported on a dry weight basis
- RPD Relative Percent Difference



BLAINE

TECH SERVICES INC.

1680 ROGERS AVENUE
 SAN JOSE, CALIFORNIA 95112-1105
 FAX (408) 573-7771
 PHONE (408) 573-0555

CONDUCT ANALYSIS TO DETECT

LAB SEQUOIA

DHS #

ALL ANALYSES MUST MEET SPECIFICATIONS AND DETECTION LIMITS SET BY CALIFORNIA DHS AND

EPA

RWQCB REGION

LIA

OTHER

MJK0241

SPECIAL INSTRUCTIONS

Send invoice to Equiva

Incident # 98995751

Send report to Blaine Tech Services

Attn: ~~Ann Pember~~ Nick Sudano

ADD'L INFORMATION STATUS CONDITION LAB SAMPLE #

CHAIN OF CUSTODY

CLIENT 001102-52
 Equiva - Karen Petryna

SITE
 630 High Street
 Oakland, CA

C = COMPOSITE ALL CONTAINERS

SAMPLE I.D.	DATE	TIME	MATRIX S = SOIL W = H2O	CONTAINERS	
				TOTAL	
MW-1	11/2/00	1545	✓	3	
MW-3		1600	✓	3	
MW-5		1530	✓	3	
MW-6		1447	✓	3	
MW-7		1542	✓	3	

TPH - gas, BTEX	MTBE by 8020	MTBE by 8260	TPH-diesel	Oxygenates by 8260	1,2-DCA & EDB by 8010
X	X				
X	X				
X	X				
X	X				

Confirm Highest Detect
 MTBE Concentrations By
 EPA 8260."

SAMPLING COMPLETED	DATE	TIME	SAMPLING PERFORMED BY	RESULTS NEEDED NO LATER THAN	
	11/2/00	1600	St/ White		
RELEASED BY	DATE	TIME	RECEIVED BY	DATE	TIME
St/ White	11/2/00	8:30	[Signature]	11/3/00	9:30
RELEASED BY	DATE	TIME	RECEIVED BY	DATE	TIME
[Signature]	11/3/00		Thomas M [Signature]	11/3/00	12:52
RELEASED BY	DATE	TIME	RECEIVED BY	DATE	TIME
TRIPPED VIA	DATE SENT	TIME SENT	COOLER #		

WELL GAUGING DATA

Project # 001107-52 Date 11/2/00 Client Equinox # 204-5502-5201

Site 630 Nigt St. Ophelia, CA

Well ID	Well Size (in.)	Sheen / Odor	Depth to Immiscible Liquid (ft.)	Thickness of Immiscible Liquid (ft.)	Volume of Immiscibles Removed (ml)	Depth to water (ft.)	Depth to well bottom (ft.)	Survey Point: TOB or TOC	
MW-1	4					8.90	13.00	TOC	
MW-2	4					10.03	19.21	↓	
MW-3	4					10.05	17.26		
MW-4	4					9.72	11.81		
MW-5	4					10.75	17.75		
MW-6	4					9.12	19.30		
MW-7	4					7.80	19.41		
MW-8	4					7.95	20.53		
MW-9	4					8.41	11.45		
MW-10	4					8.26	12.48		

EQUIVA WELL MONITORING DATA SHEET

BTS #: <u>041602-52</u>	Site: <u>II-04-5508-5800</u>
Sampler: <u>Siga</u>	Date: <u>11/2/00</u>
Well I.D.: <u>2-1/2</u>	Well Diameter: 2 3 <u>4</u> 6 8
Total Well Depth: <u>13.90</u>	Depth to Water: <u>8.90</u>
Depth to Free Product:	Thickness of Free Product (feet):
Referenced to: <u>PVC</u> Grade	D.O. Meter (if req'd): <u>733</u> HACH

Purge Method:

- Bailer
- Disposable Bailer
- Middleburg
- Electric Submersible
- Waterra
- Peristaltic
- Extraction Pump
- Other _____

Sampling Method:

- Bailer
- Disposable Bailer
- Extraction Port
- Dedicated Tubing
- Other: _____

<u>3.17</u> (Gals.) X	<u>3</u>	<u>= 9.51</u> Gals.
1 Case Volume	Specified Volumes	Calculated Volume

Well Diameter	Multiplier	Well Diameter	Multiplier
1"	0.04	4"	0.65
2"	0.16	6"	1.47
3"	0.37	Other	radius ² * 0.163

Time	Temp (°F)	pH	Cond.	Turbidity	Gals. Removed	Observations
<u>1538</u>	<u>72.4</u>	<u>7.0</u>	<u>1983</u>	<u>1200</u>	<u>3.17</u>	<u>clear odor</u>
<u>1539</u>	<u>72.5</u>	<u>6.9</u>	<u>2021</u>	<u>7200</u>	<u>4.38</u>	<u>Turbid</u>
<u>1540</u>	<u>73.1</u>	<u>7.0</u>	<u>2029</u>	<u>7100</u>	<u>10.00</u>	<u>"</u>

Did well dewater? Yes No Gallons actually evacuated: 10

Sampling Time: 1545 Sampling Date: 11/2/00

Sample I.D.: 2-1/2 Laboratory: Sequent Columbia Other _____

Analyzed for: TPH-G BTEX MTBE TPH-D Other: _____

EB I.D. (if applicable): _____ @ _____ Time Duplicate I.D. (if applicable): _____

Analyzed for: TPH-G BTEX MTBE TPH-D Other: _____

D.O. (if req'd): Pre-purge: 134. 3.0 mg/l Post-purge: 329. 3.2 mg/l

O.R.P. (if req'd): Pre-purge: _____ mV Post-purge: _____ mV

EQUIVA WELL MONITORING DATA SHEET

BTS #: <u>001104.33</u>	Site: # <u>204.5508.5701</u>
Sampler: <u>Sdyh</u>	Date: <u>11/2/00</u>
Well I.D.: <u>M-3</u>	Well Diameter: 2 3 <u>4</u> 6 8 _____
Total Well Depth: <u>17.26</u>	Depth to Water: <u>10.05</u>
Depth to Free Product:	Thickness of Free Product (feet):
Referenced to: <u>PVE</u> Grade	D.O. Meter (if req'd): <u>YSI</u> HACH

Purge Method:

- Bailer
- Disposable Bailer
- Middleburg
- Electric Submersible
- Waterra
- Peristaltic
- Extraction Pump
- Other _____

Sampling Method:

- Bailer
- Disposable Bailer
- Extraction Port
- Dedicated Tubing

Other: _____

4.69 (Gals.) X	3	= 14.06 Gals.
1 Case Volume	Specified Volumes	Calculated Volume

Well Diameter	Multiplier	Well Diameter	Multiplier
1"	0.04	4"	0.65
2"	0.16	6"	1.47
3"	0.37	Other	radius ² * 0.163

Time	Temp (°F)	pH	Cond.	Turbidity	Gals. Removed	Observations
<u>1553</u>	<u>70.9</u>	<u>6.9</u>	<u>1329</u>	<u>2200</u>	<u>4.69</u>	<u>odor</u>
<u>1554</u>	<u>71.4</u>	<u>6.9</u>	<u>1277</u>	<u>2200</u>	<u>9.38</u>	<u>"</u>
<u>1555</u>	<u>70.2</u>	<u>7.0</u>	<u>1304</u>	<u>2200</u>	<u>14.06</u>	<u>"</u>

Did well dewater? Yes No Gallons actually evacuated: 5

Sampling Time: 1600 Sampling Date: 11/2/00

Sample I.D.: M-3 Laboratory: Sequa Columbia Other _____

Analyzed for: ~~TPH-G BTEX MTBE~~ TPH-D Other: _____

EB I.D. (if applicable): _____ Time Duplicate I.D. (if applicable): _____

Analyzed for: TPH-G BTEX MTBE TPH-D Other: _____

D.O. (if req'd): Pre-purge: 2.0 mg/L Post-purge: 3.4 mg/L

O.R.P. (if req'd): Pre-purge: _____ mV Post-purge: _____ mV

EQUIVA WELL MONITORING DATA SHEET

BTS #: <u>00102-32</u>	Site: <u># 104-5508-5901</u>
Sampler: <u>Soga</u>	Date: <u>11/4/00</u>
Well I.D.: <u>MW-5</u>	Well Diameter: 2 3 <u>4</u> 6 8
Total Well Depth: <u>17.75</u>	Depth to Water: <u>10.75</u>
Depth to Free Product:	Thickness of Free Product (feet):
Referenced to: <u>P9C</u> Grade	D.O. Meter (if req'd): <u>Y81</u> HACH

Purge Method:

Bailer
 Disposable Bailer
 Middleburg
 Electric Submersible
 Waterra
 Peristaltic
 Extraction Pump
 Other _____

Sampling Method:

Bailer
 Disposable Bailer
 Extraction Port
 Dedicated Tubing

Other: _____

4.55 (Gals.) X	3	= 13.65 Gals.
1 Case Volume	Specified Volumes	Calculated Volume

Well Diameter	Multiplier	Well Diameter	Multiplier
1"	0.04	4"	0.65
2"	0.16	6"	1.47
3"	0.37	Other	radius ² * 0.163

Time	Temp (°F)	pH	Cond.	Turbidity	Gals. Removed	Observations
1:25	72.5	6.9	1195	2200	4.55	clear
1:50	72.4	6.9	1198	2200	9.10	"
2:15	72.0	6.9	1233	2200	13.65	"

Did well dewater? Yes NO Gallons actually evacuated: 14

Sampling Time: 1532 Sampling Date: 11/2/00

Sample I.D.: MW-5 Laboratory: Sequoia Columbia Other _____

Analyzed for: TPH-G BTEX MTBE TPH-D Other: _____

EB I.D. (if applicable): _____ @ _____ Time Duplicate I.D. (if applicable): _____

Analyzed for: TPH-G BTEX MTBE TPH-D Other: _____

D.O. (if req'd): Pre-purge: 154 4.0 mg/L Post-purge: 3.0 mg/L

O.R.P. (if req'd): Pre-purge: _____ mV Post-purge: _____ mV

EQUIVA WELL MONITORING DATA SHEET

BTS #: <u>00102-77</u>	Site: <u># 204-3509-5901</u>
Sampler: <u>Sequa</u>	Date: <u>11/1/00</u>
Well I.D.: <u>4</u>	Well Diameter: 2 3 <u>4</u> 6 8
Total Well Depth: <u>19.30</u>	Depth to Water: <u>9.13</u>
Depth to Free Product:	Thickness of Free Product (feet):
Referenced to: <u>PVC</u> Grade	D.O. Meter (if req'd): <u>YSI</u> HACH

Purge Method:

- | | |
|--|--|
| Bailer
Disposable Bailer
Middleburg
<u>Electric Submersible</u> | Waterra
Peristaltic
Extraction Pump
Other _____ |
|--|--|

Sampling Method:

- Bailer
 Disposable Bailer
 Extraction Port
 Dedicated Tubing

Other: _____

6.61 (Gals.) X	<u>3</u>	= <u>19.83</u> Gals.
1 Case Volume	Specified Volumes	Calculated Volume

Well Diameter	Multiplier	Well Diameter	Multiplier
1"	0.04	4"	0.65
2"	0.16	6"	1.47
3"	0.37	Other	radius ² * 0.163

Time	Temp (°F)	pH	Cond.	Turbidity	Gals. Removed	Observations
1440	74.3	6.7	1172	<200	5.61	clean
1441	25.2	7.0	1166	<200	13.22	"
1442	74.7	7.1	1153	<200	19.83	"

Did well dewater? Yes No Gallons actually evacuated: 20

Sampling Time: 1447 Sampling Date: 11/1/00

Sample I.D.: 4 Laboratory: Sequoia Columbia Other _____

Analyzed for: ~~TPH-G~~ BTEX MTBE TPH-D Other: _____

EB I.D. (if applicable): _____ @ _____ Time Duplicate I.D. (if applicable): _____

Analyzed for: TPH-G BTEX MTBE TPH-D Other: _____

D.O. (if req'd): Pre-purge: 154 2.5 mg/L Post-purge: 3.5 mg/L

O.R.P. (if req'd): Pre-purge: _____ mV Post-purge: _____ mV

EQUIVA WELL MONITORING DATA SHEET

BTS #: <u>001101-S2</u>	Site: <u>204-5508-5901</u>
Sampler: <u>SP</u>	Date: <u>11/2/00</u>
Well I.D.: <u>2 3 4 6 8</u>	Well Diameter: 2 3 <u>4</u> 6 8
Total Well Depth: <u>19.41</u>	Depth to Water: <u>7.80</u>
Depth to Free Product:	Thickness of Free Product (feet):
Referenced to: <u>PVC</u> Grade	D.O. Meter (if req'd): <u>YSI</u> HACH

Purge Method:

- Bailer
 Disposable Bailer
 Middleburg
 Electric Submersible
 Waterra
 Peristaltic
 Extraction Pump
 Other _____

Sampling Method:

- Bailer
 Disposable Bailer
 Extraction Port
 Dedicated Tubing
 Other: _____

7.55 (Gals.) X 3 = 22.64 Gals.
 I Case Volume Specified Volumes Calculated Volume

Well Diameter	Multiplier	Well Diameter	Multiplier
1"	0.04	4"	0.65
2"	0.16	6"	1.47
3"	0.37	Other	radius ² * 0.163

Time	Temp (°F)	pH	Cond.	Turbidity	Gals. Removed	Observations
<u>14:05</u>	<u>71.1</u>	<u>7.1</u>	<u>964.0</u>	<u>L200</u>	<u>7.55</u>	<u>clear</u>
<u>15:06</u>	<u>70.4</u>	<u>7.2</u>	<u>1096</u>	<u>L200</u>	<u>15.10</u>	<u>"</u>
<u>15:07</u>	<u>70.2</u>	<u>7.4</u>	<u>1112</u>	<u>L200</u>	<u>23.00</u>	<u>"</u>

Did well dewater? Yes No Gallons actually evacuated: 23

Sampling Time: 15:12 Sampling Date: 11/2/00

Sample I.D.: 204-5508-5901 Laboratory: Sequetra Columbia Other _____

Analyzed for: ~~TPH-G BTEX MTBE~~ TPH-D Other: _____

EB I.D. (if applicable): _____ @ _____ Time Duplicate I.D. (if applicable): _____

Analyzed for: TPH-G BTEX MTBE TPH-D Other: _____

D.O. (if req'd): Pre-purge: 4.0 mg/L Post-purge: 3.0 mg/L

O.R.P. (if req'd): Pre-purge: _____ mV Post-purge: _____ mV