



**Shell Oil Products US**

**RECEIVED**

8:50 am, Apr 16, 2010

Alameda County  
Environmental Health

April 15, 2010

**Re: First Quarter 2010 Semiannual  
Groundwater Monitoring Report**  
Shell-Branded Service Station  
11989 Dublin Boulevard  
Dublin, California

Dear Mr. Jerry Wickham:

I declare, under penalty of perjury, that the information and/or recommendations contained in the attached document or report is true and correct to the best of my knowledge.

Sincerely,  
Shell Oil Products US

A handwritten signature in black ink, appearing to read "Denis L. Brown", with a long horizontal flourish extending to the right.

Denis L. Brown  
Project Manager

April 15, 2010  
DELTA Project No. SCA119891D  
SAP No. 135243

Mr. Jerry Wickham  
Alameda County Health Care Services Agency  
1131 Harbor Bay Parkway, Suite 250  
Alameda, California 94502-6577

**Re: FIRST QUARTER 2010 SEMIANNUAL  
GROUNDWATER MONITORING REPORT  
Shell-Branded Service Station  
11989 Dublin Boulevard  
Dublin, California**



Dear Mr. Wickham:

On behalf of Equilon Enterprises LLC *dba* Shell Oil Products US (Shell), Delta Consultants (Delta) has prepared this *First Quarter 2010 Semiannual Groundwater Monitoring Report* for the above referenced site. The sampling activities at the site were performed by Blaine Tech Services, Inc. (Blaine Tech) under contract to Shell and included the collection of groundwater samples and static water level measurements. Delta did not provide any oversight of Blaine Tech's work or protocol. A Delta staff member, under the supervision of a California Registered Civil Engineer or a California Professional Geologist, performed evaluation of the data provided to us.

This quarterly report represents Delta's professional opinions based upon the currently available information and is arrived at in accordance with currently acceptable professional standards. This report is based upon a specific scope of work requested by the client. The Contract between Delta and its client outlines the scope of work, and only those tasks specifically authorized by that contract or outlined in this report were performed. This report is intended only for the use of Delta's Client and anyone else specifically listed on this report. Delta will not and cannot be liable for unauthorized reliance by any other third party. Other than as contained in this paragraph, Delta makes no express or implied warranty as to the contents of this report.

a member of:



---

312 PIERCY ROAD SAN JOSE, CALIFORNIA 95138 USA  
PHONE +1 408.224.4724 / USA TOLL FREE 800.477.7411  
FAX +1 408.225.8506 WWW.DELTAENV.COM

If you have any questions regarding this site, please contact Ms. Regina Bussard (Delta Site Manager) at (408) 826-1880 or Mr. Denis Brown (Shell Project Manager) at (707) 865-0251.

Sincerely,  
**Delta Consultants**



Abhik Dutta  
Senior Staff Geologist



Regina Bussard, P.G.  
Project Manager

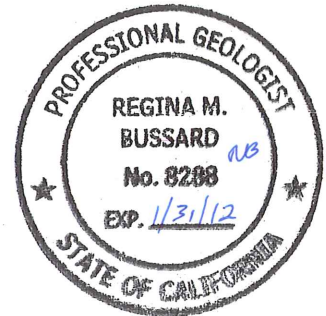

Attachment: First Quarter 2010 Semiannual Groundwater Monitoring Report

cc: Denis Brown, Shell Oil Products US, Carson  
Matt Katen, Zone 7 Water District, Livermore  
Richard Hudson, Hudson Investment Properties L.L.C.

## SHELL SEMIANNUAL STATUS REPORT

Station Address: 11989 Dublin Boulevard, Dublin, California  
DELTA Project No.: SCA119891D  
SHELL Project Manager / Phone No.: Denis Brown / (707) 865-0251  
DELTA Site Manager / Phone No.: Regina Bussard / (408) 826-1876  
Primary Agency / Regulatory ID No.: Alameda County Health Care Services Agency /  
Mr. Jerry Wickham, P.G., CHG  
Other Agencies to Receive Copies: Zone 7 Water District / Matt Katen

### WORK PERFORMED THIS PERIOD (FOURTH QUARTER 2009 AND FIRST QUARTER 2010):

1. Semiannual groundwater monitoring and sampling on **January 6, 2010**. Submitted semiannual report.

### WORK PROPOSED FOR NEXT PERIOD (SECOND AND THIRD QUARTER 2010):

1. Semiannual groundwater monitoring and sampling. Submit semiannual report.

Current Phase of Project: Groundwater monitoring.  
Site Use: Shell-branded Service Station  
Frequency of Sampling: Semiannual (Wells MW-2 through MW-7)  
Frequency of Monitoring: Semiannual (Wells MW-2 through MW-7)  
Is Separate Phase Hydrocarbon Present On-site (Well #'s):  Yes  No  
Cumulative SPH Recovered to Date: NA  
SPH Recovered This Quarter : None  
Groundwater Removed This Quarter: 67.2 gallons were removed on January 6, 2010  
Sensitive Receptor(s) and Respective Direction(s): Dublin Creek is located approximately 538 feet south of the site.  
Site Lithology: Site is generally underlain by approximately 60 feet of clay and silt with some discontinuous beds of clayey sand, silty sand and silty gravel between approximately 20 to 40 feet below the surface. Beneath this is approximately 15 feet of sand and gravel which over lies clay and silt to 80 feet, the depth explored.  
Current Remediation Techniques: None  
Permits for Discharge: None  
Approximate Depth to Groundwater: 22.22 to 25.41 feet below top of casing (TOC) in the shallow wells and 31.52 feet below TOC in the deeper well  
Groundwater Gradient: East-northeast at a gradient of 0.02 ft/ft, consistent with previous data  
Current Agency Correspondence: ACEH letter dated July 14, 2009.  
Date of Most Recent Work Plan Approval: August 30, 2006

## SHELL SEMIANNUAL STATUS REPORT (CONT.)

### Site History:

Case Opening	1999
Onsite Assessment	8/98 – 6/99
Offsite Assessment	2001 - 2005
Passive Remediation	Natural attenuation
Active Remediation	None
Closure	None
Summary of Unusual Activity:	Concentrations of Total petroleum hydrocarbons as gasoline (TPH-g - reported as TPPH by the lab) were detected in wells MW-6 and MW-7

Description: TPH-g was detected in wells MW-2 through MW-4, MW-6 and MW-7 at concentrations ranging from 3,200 µg/L (MW-2) to 75 µg/L (MW-4). TBA was detected in wells MW-2 and MW-3 at concentrations of 48 µg/L and 13 µg/L, respectively. The TPH-g concentrations detected in wells MW-2 through MW-4 are consistent with historical data; however, the concentrations detected in offsite wells MW-6 and MW-7 are inconsistent with previous data. Additional monitoring will be required to fully evaluate the observed changes.

## **ATTACHMENTS:**

### Figures:

Figure 1 – Site Location Map

Figure 2 – Groundwater Elevation Contour Map

Figure 3 – Groundwater Hydrocarbon Distribution Map

### Table:

Table 1 – Well Concentrations

### Appendices:

Appendix A – Blaine Tech Services, Inc. Field Data Sheets

Appendix B – Blaine Tech Services, Inc. Field Procedures

Appendix C – Laboratory Report and Chain-of-Custody Documentation

## FIGURES



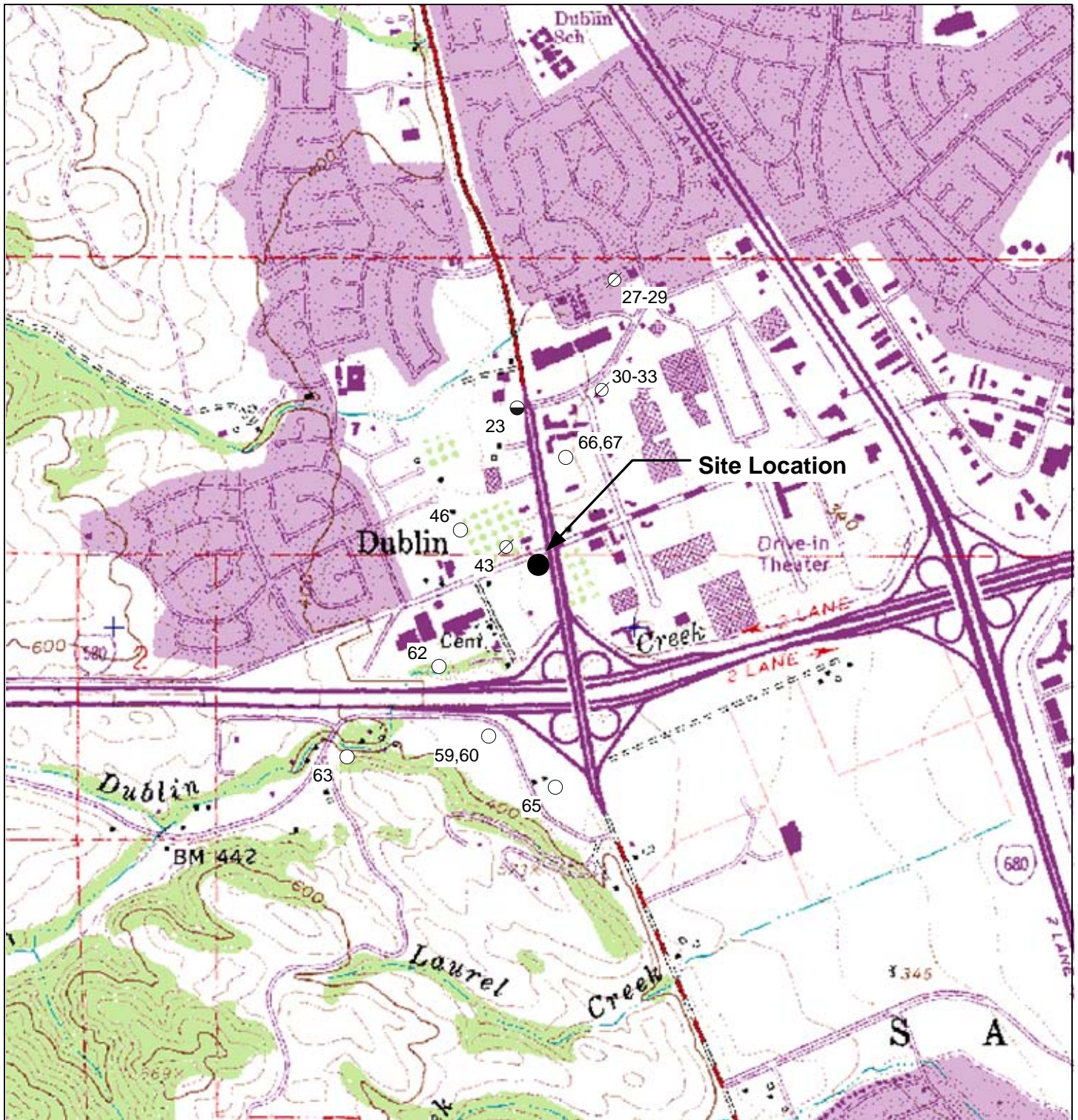

GENERAL NOTES:  
 Base Map from: DeLorme Yarmouth, ME 04096  
 Source Data: USGS

Legend

- Domestic Well
- Irrigation Well
- ⊗ Destroyed/Abandoned Well



0 1,800 3,600

Scale, Feet

QUADRANGLE LOCATION

FIGURE 1  
 SITE LOCATION MAP

SHELL-BRANDED SERVICE STATION  
 11989 Dublin Boulevard  
 Dublin, California

PROJECT NO. SCA119891D	DRAWN BY VF 10/22/03
FILE NO.	PREPARED BY VF
REVISION NO.	REVIEWED BY





PROJECT NUMBER  
SCA119891D

APPROVED BY

CHECKED BY

DRAWN BY  
J.F.F.  
1/29/2010

SCALE IN FEET  
0 40 80

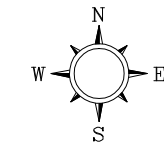
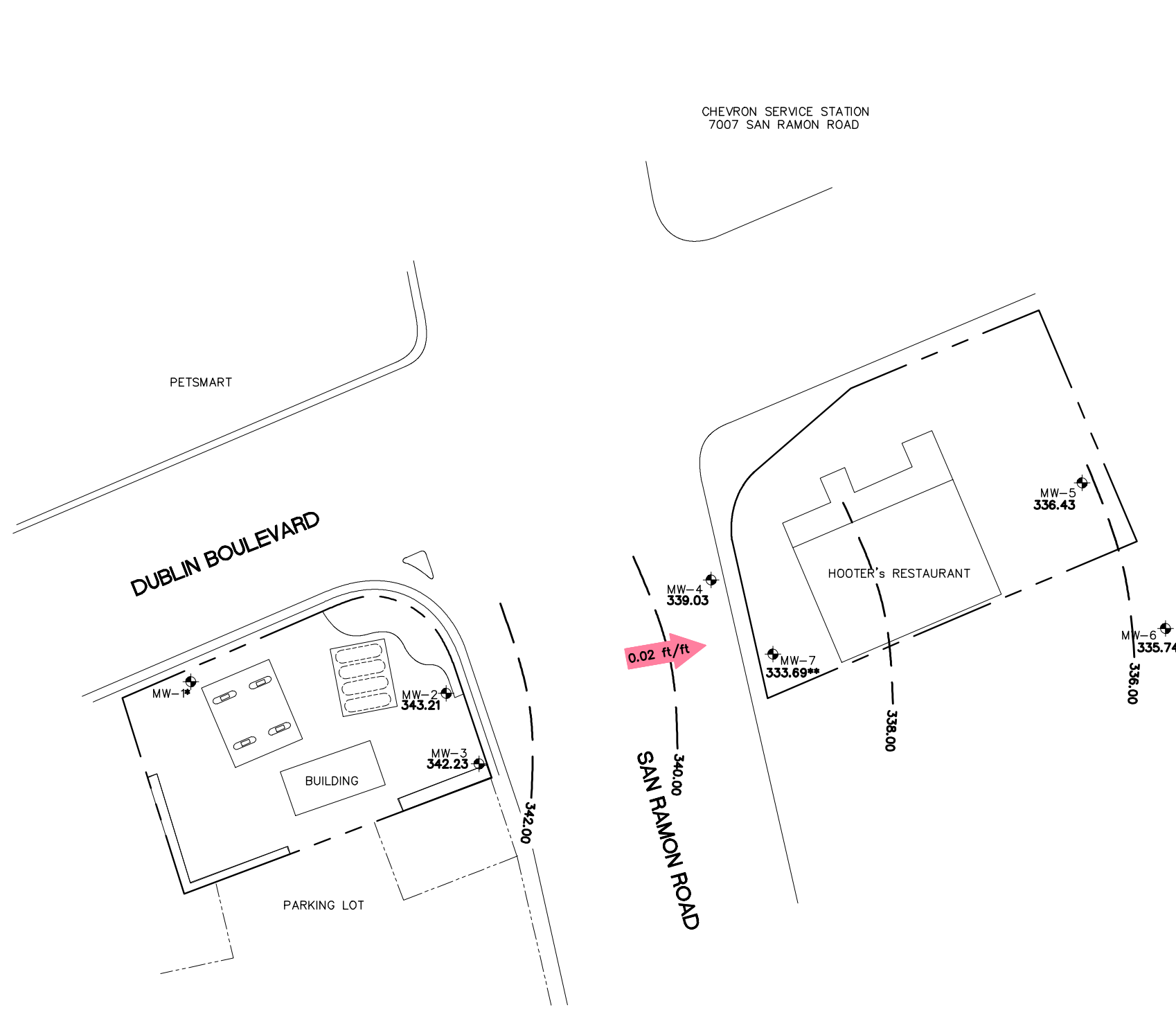

LEGEND

- MW-1 GROUNDWATER MONITORING WELL LOCATION AND DESIGNATION
- 344.71 GROUNDWATER ELEVATION IN FEET ABOVE MEAN SEA LEVEL (Ft/MSL)
- 340.00 GROUNDWATER CONTOUR IN FEET ABOVE MEAN SEA LEVEL (Ft/MSL)  
CONTOUR INTERVAL=2.00 FEET
- 0.02 ft/ft APPROXIMATE GROUNDWATER GRADIENT DIRECTION (ft/ft)
- \* REMOVED FROM SAMPLING PROGRAM
- \*\* DEEP WELL - NOT USED FOR CONTOURING

HISTORIC GROUNDWATER FLOW DIRECTIONS

DATE	FLOW
10/27/2006	E
1/19/2007	E, ENE
4/3/2007	E, ENE
7/6/2007	E, ENE
10/30/2007	E, ENE
1/10/2008	E
4/24/2008	E
7/31/2008	ENE
10/13/2008	ENE
1/5/2009	ENE
7/7/2009	ENE
1/6/2010	ENE

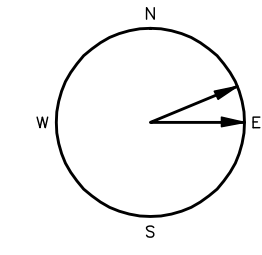

SHELL OIL PRODUCTS US  
SHELL-BRANDED SERVICE STATION  
DUBLIN, CALIFORNIA

**FIGURE 2**  
**GROUNDWATER ELEVATION CONTOUR MAP**  
**1/6/2010**  
11989 DUBLIN BOULEVARD  
DUBLIN, CALIFORNIA

PROJECT NUMBER SCA119891D  
 APPROVED BY  
 CHECKED BY  
 DRAWN BY J.F.F. 1/29/2010

0 40 80  
 SCALE IN FEET

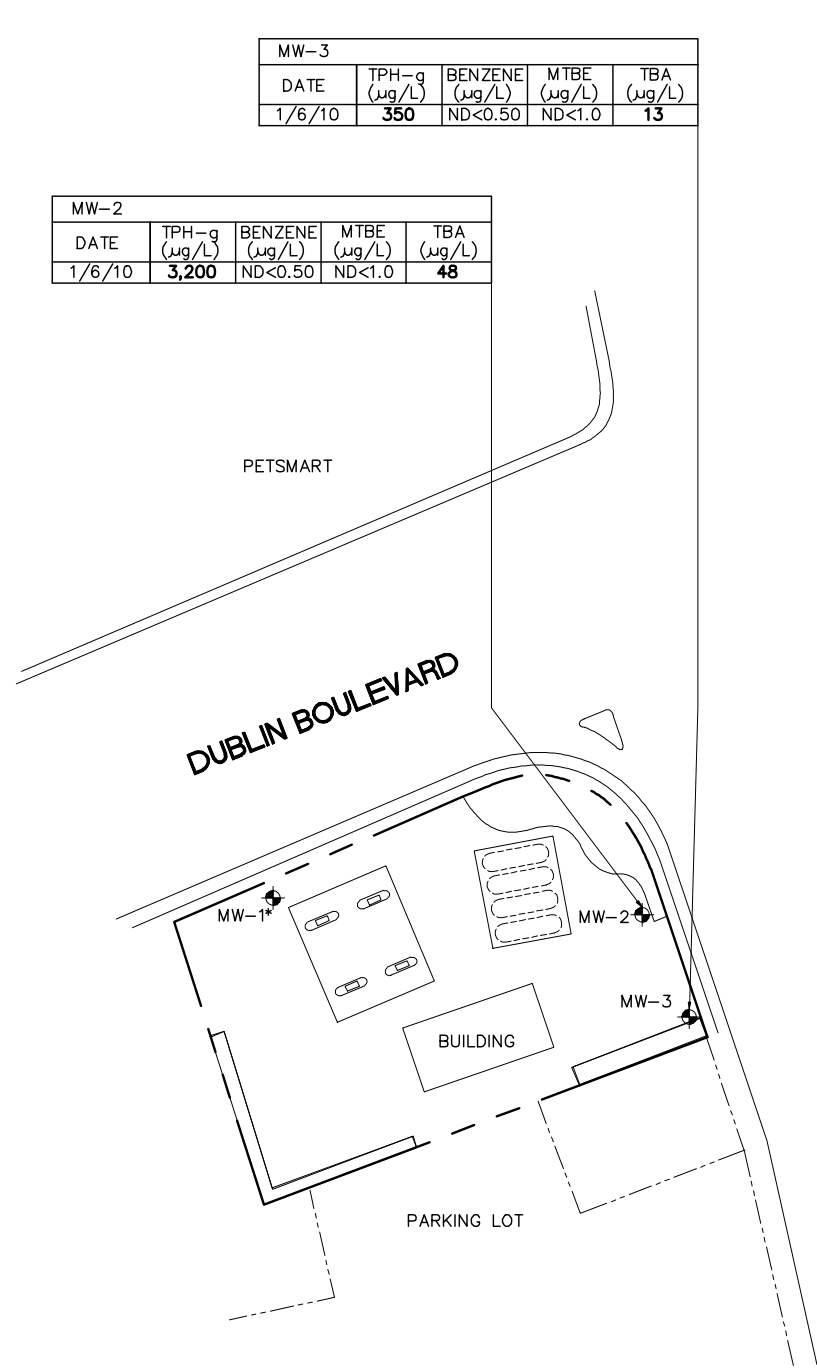

MW-2				
DATE	TPH-g (µg/L)	BENZENE (µg/L)	MTBE (µg/L)	TBA (µg/L)
1/6/10	3,200	ND<0.50	ND<1.0	48

MW-3				
DATE	TPH-g (µg/L)	BENZENE (µg/L)	MTBE (µg/L)	TBA (µg/L)
1/6/10	350	ND<0.50	ND<1.0	13

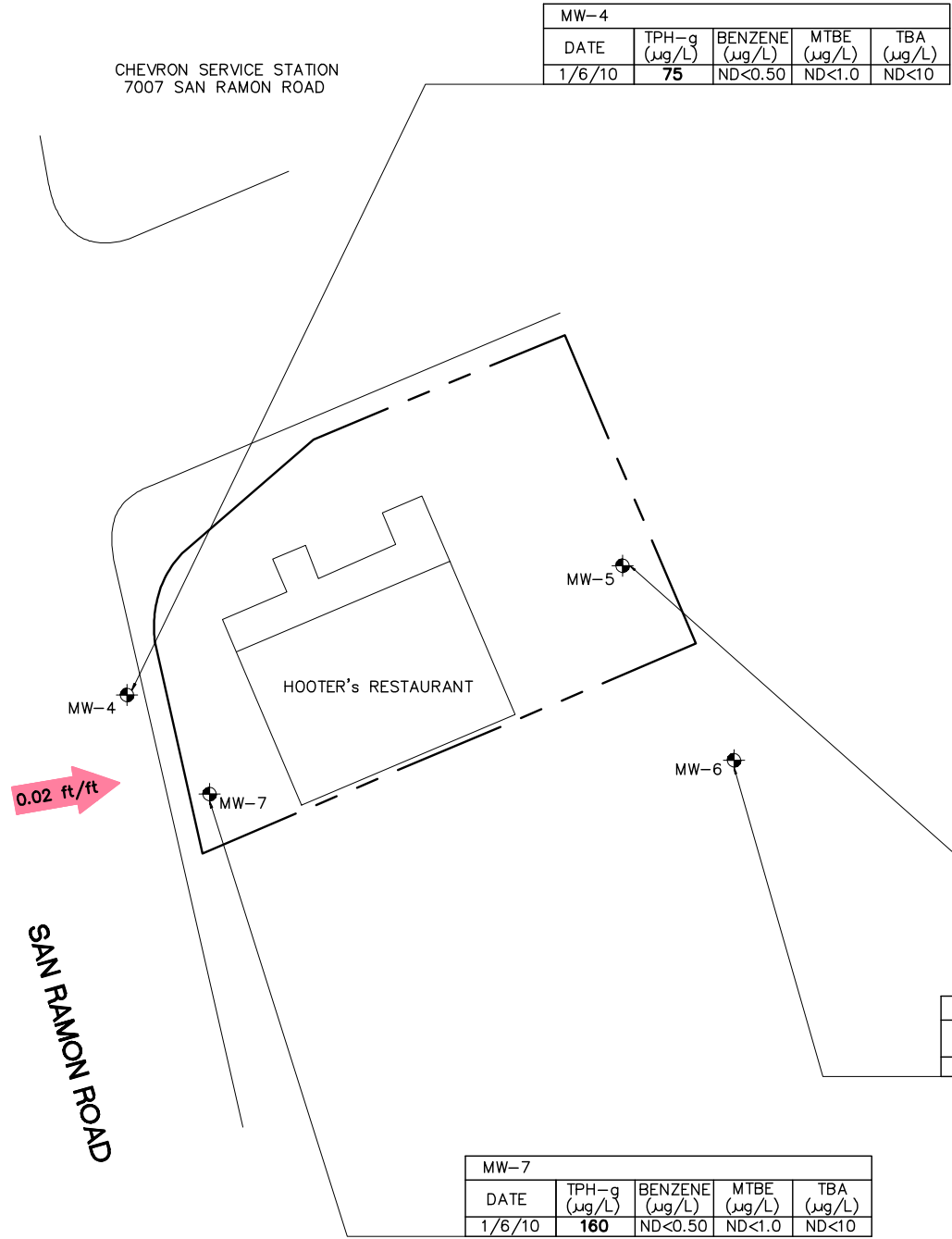

MW-4				
DATE	TPH-g (µg/L)	BENZENE (µg/L)	MTBE (µg/L)	TBA (µg/L)
1/6/10	75	ND<0.50	ND<1.0	ND<10

MW-7				
DATE	TPH-g (µg/L)	BENZENE (µg/L)	MTBE (µg/L)	TBA (µg/L)
1/6/10	160	ND<0.50	ND<1.0	ND<10

MW-6				
DATE	TPH-g (µg/L)	BENZENE (µg/L)	MTBE (µg/L)	TBA (µg/L)
1/6/10	89	ND<0.50	ND<1.0	ND<10

MW-5				
DATE	TPH-g (µg/L)	BENZENE (µg/L)	MTBE (µg/L)	TBA (µg/L)
1/6/10	ND<50	ND<0.50	ND<1.0	ND<10

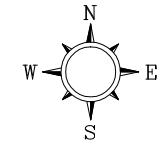

LEGEND

- MW-1 GROUNDWATER MONITORING WELL LOCATION AND DESIGNATION
- MTBE METHYL TERT-BUTYL ETHER
- TBA TERT-BUTYL ALCOHOL
- TPH-g TOTAL PETROLEUM HYDROCARBONS AS GASOLINE
- µg/L MICROGRAMS PER LITER
- 0.02 ft/ft APPROXIMATE GROUNDWATER GRADIENT DIRECTION (ft/ft)
- ND< NOT DETECTED ABOVE LIMIT NOTED
- \* REMOVED FROM SAMPLING PROGRAM



SHELL OIL PRODUCTS US  
 SHELL-BRANDED SERVICE STATION  
 DUBLIN, CALIFORNIA

**FIGURE 3**  
**GROUNDWATER HYDROCARBON**  
**DISTRIBUTION MAP**  
**1/6/2010**

11989 DUBLIN BOULEVARD  
 DUBLIN, CALIFORNIA

## TABLE

**TABLE 1**  
**WELL CONCENTRATIONS**  
**Shell-branded Service Station**  
**11989 Dublin Boulevard**  
**Dublin, CA**

Well ID	Date	TPPH (ug/L)	TEPH (ug/L)	B (ug/L)	T (ug/L)	E (ug/L)	X (ug/L)	MTBE 8020 (ug/L)	MTBE 8260 (ug/L)	DIPE (ug/L)	ETBE (ug/L)	TAME (ug/L)	TBA (ug/L)	Ethanol (ug/L)	TOC (MSL)	Depth to Water (ft.)	GW Elevation (MSL)	DO Reading (ppm)
MW-1	7/20/1999	<50.0	<50.0	<0.500	<0.500	<0.500	<0.500	<5.00	NA	NA	NA	NA	NA	NA	367.99	6.24	361.75	NA
MW-1	10/25/1999	<50.0	<50.0	<0.500	<0.500	<0.500	<0.500	<5.00	NA	NA	NA	NA	NA	NA	367.99	6.36	361.63	NA
MW-1	1/27/2000	<50.0	<50.0	<0.500	<0.500	<0.500	<0.500	<2.50	NA	NA	NA	NA	NA	NA	367.99	5.65	362.34	NA
MW-1	4/3/2000	<50.0	<50.0	<0.500	<0.500	<0.500	<0.500	<2.50	NA	NA	NA	NA	NA	NA	367.99	5.68	362.31	1.2/1.6
MW-1	7/27/2000	<50.0	NA	<0.500	<0.500	<0.500	<0.500	<2.50	NA	NA	NA	NA	NA	NA	367.99	5.69	362.30	1.0/1.1
MW-1	10/16/2000	<50.0	NA	<0.500	<0.500	<0.500	<0.500	<2.50	NA	NA	NA	NA	NA	NA	367.99	5.74	362.25	1.2/0.8
MW-1	1/16/2001	<50.0	NA	<0.500	<0.500	<0.500	<0.500	<2.50	NA	NA	NA	NA	NA	NA	367.99	5.71	362.28	0.59/2.8
MW-1	4/19/2001	<50.0	NA	<0.500	<0.500	<0.500	<0.500	<2.50	NA	NA	NA	NA	NA	NA	367.99	5.63	362.36	1.4/1.5
MW-1	7/13/2001	<50	NA	<0.50	<0.50	<0.50	<0.50	NA	<5.0	NA	NA	NA	NA	NA	367.99	5.70	362.29	2.3/3.1
MW-1	8/13/2001	NA	NA	NA	NA	NA	NA	NA	NA	NA	NA	NA	NA	NA	367.99	5.72	362.27	NA
MW-1	10/26/2001	<50	NA	<0.50	<0.50	<0.50	<0.50	NA	<5.0	NA	NA	NA	NA	NA	367.99	5.73	362.26	0.4/0.0
MW-1	1/11/2002	<50	NA	<0.50	<0.50	<0.50	<0.50	NA	<5.0	NA	NA	NA	NA	NA	367.99	5.55	362.44	5.4/2.0
MW-1	5/22/2002	<50	NA	<0.50	<0.50	<0.50	<0.50	NA	<5.0	NA	NA	NA	NA	NA	367.99	5.55	362.44	NA
MW-1	7/15/2002	<50	NA	<0.50	<0.50	<0.50	<0.50	NA	<5.0	NA	NA	NA	NA	NA	367.99	5.70	362.29	NA
MW-1	10/11/2002	<50	NA	<0.50	<0.50	<0.50	<0.50	NA	<5.0	NA	NA	NA	NA	NA	367.99	5.87	362.12	NA
MW-1	1/17/2003	<50	NA	<0.50	<0.50	<0.50	<0.50	NA	<5.0	NA	NA	NA	NA	NA	367.99	5.79	362.20	NA
MW-1	5/1/2003	52	NA	<0.50	<0.50	<0.50	<1.0	NA	<5.0	NA	NA	NA	NA	NA	367.99	5.61	362.38	NA
MW-1	8/27/2003	<50	NA	<0.50	<0.50	<0.50	<1.0	NA	<0.50	NA	NA	NA	NA	NA	367.99	5.84	362.15	NA
MW-1	10/3/2003	<50	NA	<0.50	<0.50	<0.50	<1.0	NA	<0.50	NA	NA	NA	NA	NA	367.99	5.95	362.04	NA
MW-1	1/5/2004	<50	NA	<0.50	<0.50	<0.50	<1.0	NA	<0.50	NA	NA	NA	NA	NA	367.99	5.66	362.33	NA
MW-1	4/9/2004	<50	NA	<0.50	<0.50	<0.50	<1.0	NA	<0.50	NA	NA	NA	NA	NA	367.99	5.55	362.44	NA
MW-1	7/22/2004	<50	NA	<0.50	<0.50	<0.50	<1.0	NA	<0.50	NA	NA	NA	NA	NA	367.99	5.73	362.26	NA
MW-1	11/1/2004	<50	NA	<0.50	<0.50	<0.50	<1.0	NA	<0.50	NA	NA	NA	NA	NA	367.99	5.73	362.26	NA
MW-1	1/26/2005	<50	NA	<0.50	<0.50	<0.50	<1.0	NA	<0.50	NA	NA	NA	NA	NA	367.99	5.50	362.49	NA
MW-1	4/14/2005	<50	NA	<0.50	<0.50	<0.50	<1.0	NA	<0.50	NA	NA	NA	NA	NA	367.99	5.60	362.39	NA
MW-1	7/21/2005	<50	NA	<0.50	<0.50	<0.50	<1.0	NA	<0.50	NA	NA	NA	NA	NA	367.99	6.14	361.85	NA
MW-1	11/8/2005	<50.0	NA	<0.500	<0.500	<0.500	<0.500	NA	<0.500	<0.500	<0.500	<0.500	<10.0	NA	367.99	6.33	361.66	NA
MW-2	7/20/1999	2,600	699	55.0	<2.50	59.5	<2.50	9,370	NA	NA	NA	NA	NA	NA	365.43	20.31	345.12	NA



**TABLE 1**  
**WELL CONCENTRATIONS**  
**Shell-branded Service Station**  
**11989 Dublin Boulevard**  
**Dublin, CA**

Well ID	Date	TPPH (ug/L)	TEPH (ug/L)	B (ug/L)	T (ug/L)	E (ug/L)	X (ug/L)	MTBE 8020 (ug/L)	MTBE 8260 (ug/L)	DIPE (ug/L)	ETBE (ug/L)	TAME (ug/L)	TBA (ug/L)	Ethanol (ug/L)	TOC (MSL)	Depth to Water (ft.)	GW Elevation (MSL)	DO Reading (ppm)
MW-2	10/25/1999	4,710	761	61.1	<10.0	74.6	<10.0	22,800	NA	NA	NA	NA	NA	NA	365.43	22.80	342.63	NA
MW-2	1/27/2000	3,820	1490	60.8	<10.0	156	<10.0	13,400	15,000 a	NA	NA	NA	NA	NA	365.43	19.17	346.26	NA
MW-2	4/3/2000	7,130	NA	184	14.9	238	18.8	34,200	28,000	NA	NA	NA	NA	NA	365.43	19.03	346.40	1.6/1.7
MW-2	7/27/2000	311	NA	10.0	<0.500	<0.500	<0.500	280	NA	NA	NA	NA	NA	NA	365.43	19.09	346.34	1.9/1.7
MW-2	10/16/2000	3,970	NA	123	<5.00	68.5	<5.00	14,000	15,600	NA	NA	NA	NA	NA	365.43	23.98	341.45	0.5/0.5
MW-2	1/16/2001	5,780	NA	125	9.71	139	6.93	7,660	7,810	NA	NA	NA	NA	NA	365.43	22.12	343.31	0.90/2.61
MW-2	4/19/2001	4,460	NA	114	7.61	115	4.87	15,200	18,400	NA	NA	NA	NA	NA	365.43	20.95	344.48	1.6/1.5
MW-2	7/13/2001	<5,000	NA	<25	<25	110	<25	NA	15,000	NA	NA	NA	NA	NA	365.43	22.62	342.81	2.7/1.8
MW-2	8/13/2001	NA	NA	NA	NA	NA	NA	NA	NA	NA	NA	NA	NA	NA	365.43	22.33	343.10	NA
MW-2	10/26/2001	3,700	NA	<20	<20	66	<20	NA	9,200	<20	<20	<20	1,800	<500	365.43	22.32	343.11	0.7/0.8
MW-2	1/11/2002	<5,000	NA	<50	<50	54	<50	NA	15,000	NA	NA	NA	NA	NA	365.43	18.72	346.71	5.1/c
MW-2	5/22/2002	<5,000	NA	53	<50	57	<50	NA	20,000	<50	<50	<50	6,300	NA	365.43	20.59	344.84	NA
MW-2	7/15/2002	<5,000	NA	<50	<50	<50	<50	NA	16,000	<50	<50	<50	3,100	NA	365.43	21.90	343.53	NA
MW-2	10/11/2002	3,600	NA	<20	<20	48	<20	NA	8,200	<20	<20	<20	1,600	NA	365.43	22.45	342.98	NA
MW-2	1/17/2003	4,700	NA	<25	<25	87	<25	NA	13,000	<25	<25	<25	7,700	NA	365.43	19.27	346.16	NA
MW-2	5/1/2003	6,000	NA	<50	<50	110	<100	NA	12,000	<200	<200	<200	6,700	NA	365.43	19.09	346.34	NA
MW-2	8/27/2003	2,500	NA	32	<25	100	<50	NA	4,800	<100	<100	<100	9,100	NA	365.43	22.53	342.90	NA
MW-2	10/3/2003	5,500 d	NA	32	<13	86	<25	NA	2,200	<50	<50	<50	9,900	NA	365.43	23.02	342.41	NA
MW-2	1/5/2004	6,500	NA	22	<13	58	<25	NA	1,200	<50	<50	<50	7,400	NA	365.43	19.08	346.35	NA
MW-2	4/9/2004	6,500	NA	72	<13	30	<25	NA	1,600	<50	<50	<50	11,000	NA	365.43	20.22	345.21	NA
MW-2	7/22/2004	4,900	NA	32	<13	19	<25	NA	180	<50	<50	<50	7,100	NA	365.43	22.14	343.29	NA
MW-2	11/1/2004	5,700	NA	42	<13	13	<25	NA	190	<50	<50	<50	6,100	NA	365.43	20.72	344.71	NA
MW-2	1/26/2005	6,600	NA	94	<13	13	<25	NA	1,700	<50	<50	<50	16,000	NA	365.43	17.95	347.48	NA
MW-2	4/14/2005	8,200	NA	170	<10	92	<20	NA	1,300	<40	<40	<40	15,000	NA	365.43	18.10	347.33	NA
MW-2	7/21/2005	4,100	NA	23	<10	13	<20	NA	96	<40	<40	<40	4,600	NA	365.43	22.72	342.71	NA
MW-2	11/8/2005	1,290	NA	1.66	0.990	2.56	1.25	NA	11.9	<0.500	<0.500	<0.500	428	NA	365.43	21.77	343.66	NA
MW-2	1/6/2006	6,650	NA	<0.500	<0.500	2.69	<0.500	NA	9.23 g	<0.500	<0.500	<0.500	1,300 g	NA	365.43	18.94	346.49	NA
MW-2	4/19/2006	5,490	NA	3.58	0.890	4.32	<0.500	NA	19.0	<0.500	<0.500	<0.500	1,040	NA	365.43	18.34	347.09	NA
MW-2	7/26/2006	4,990	NA	<0.500	<0.500	<0.500	<0.500	NA	4.66	NA	NA	NA	353	NA	365.43	22.53	342.90	NA
MW-2	10/27/2006	2,900	NA	<0.50	<0.50	<0.50	1.2	NA	<0.50	<2.0	<2.0	<2.0	270	NA	365.43	23.08	342.35	NA

**TABLE 1**  
**WELL CONCENTRATIONS**  
**Shell-branded Service Station**  
**11989 Dublin Boulevard**  
**Dublin, CA**

Well ID	Date	TPPH (ug/L)	TEPH (ug/L)	B (ug/L)	T (ug/L)	E (ug/L)	X (ug/L)	MTBE 8020 (ug/L)	MTBE 8260 (ug/L)	DIPE (ug/L)	ETBE (ug/L)	TAME (ug/L)	TBA (ug/L)	Ethanol (ug/L)	TOC (MSL)	Depth to Water (ft.)	GW Elevation (MSL)	DO Reading (ppm)
---------	------	----------------	----------------	-------------	-------------	-------------	-------------	------------------------	------------------------	----------------	----------------	----------------	---------------	-------------------	--------------	----------------------------	--------------------------	------------------------

MW-2	1/19/2007	1,700	NA	<0.50	0.72	<0.50	<0.50	NA	<0.50	NA	NA	NA	280	NA	365.43	18.91	346.52	NA
MW-2	4/3/2007	2,100 h,i	NA	<0.50	<1.0	<1.0	<1.0	NA	<1.0	NA	NA	NA	120	NA	365.43	19.37	346.06	NA
MW-2	7/6/2007	2,000 h,i	NA	<0.50	<1.0	0.90 j	7.72 j	NA	<1.0	NA	NA	NA	29	NA	365.43	21.24	344.19	NA
MW-2	10/30/2007	2,100 h	NA	<0.50	<1.0	<1.0	<1.0	NA	<1.0	<2.0	<2.0	<2.0	30	NA	365.43	21.38	344.05	NA
MW-2	1/10/2008	2,200 h,i	NA	<0.50	<1.0	<1.0	<1.0	NA	<1.0	NA	NA	NA	72	NA	365.43	17.95	347.48	NA
MW-2	4/24/2008	2,700	NA	<0.50	<1.0	<1.0	<1.0	NA	<1.0	NA	NA	NA	22	NA	365.43	20.72	344.71	NA
MW-2	7/31/2008	2,700	NA	<0.50	<1.0	<1.0	<1.0	NA	<1.0	NA	NA	NA	28	NA	365.43	21.25	344.18	NA
MW-2	10/13/2008	1,700	NA	<0.50	<1.0	<1.0	<1.0	NA	<1.0	<2.0	<2.0	<2.0	16	NA	365.43	20.42	345.01	NA
MW-2	1/5/2009	2,300	NA	<0.50	<1.0	<1.0	<1.0	NA	1.0	NA	NA	NA	170	NA	365.43	17.71	347.72	NA
MW-2	7/7/2009	2,200	NA	<0.50	<1.0	<1.0	<1.0	NA	<1.0	<2.0	<2.0	<2.0	25	NA	365.43	22.43	343.00	NA
<b>MW-2</b>	<b>1/6/2010</b>	<b>3,200</b>	<b>NA</b>	<b>&lt;0.50</b>	<b>&lt;1.0</b>	<b>&lt;1.0</b>	<b>&lt;1.0</b>	<b>NA</b>	<b>&lt;1.0</b>	<b>NA</b>	<b>NA</b>	<b>NA</b>	<b>48</b>	<b>NA</b>	<b>365.43</b>	<b>22.22</b>	<b>343.21</b>	<b>NA</b>

MW-3	7/20/1999	208	177	4.69	<0.500	<0.500	<0.500	664	NA	NA	NA	NA	NA	NA	364.97	24.23	340.74	NA
MW-3	10/25/1999	378	182	9.49	<0.500	<0.500	<0.500	1,410	NA	NA	NA	NA	NA	NA	364.97	23.26	341.71	NA
MW-3	1/27/2000	428	100	29.4	<0.500	<0.500	<0.500	941	NA	NA	NA	NA	NA	NA	364.97	19.53	345.44	NA
MW-3	4/3/2000	<125	NA	11.4	<1.25	<1.25	<1.25	639	NA	NA	NA	NA	NA	NA	364.97	19.13	345.84	1.4/1.9
MW-3	7/27/2000	4,360	NA	78.4	6.95	85.8	2.61	26,600	25,200 b	NA	NA	NA	NA	NA	364.97	19.10	345.87	1.9/2.0
MW-3	10/16/2000	586	NA	21.3	<0.500	<0.500	<0.500	3,310	NA	NA	NA	NA	NA	NA	364.97	24.11	340.86	1.1/0.8
MW-3	1/16/2001	558	NA	14.7	<0.500	<0.500	<0.500	2,210	NA	NA	NA	NA	NA	NA	364.97	22.19	342.78	0.87/3.5
MW-3	4/19/2001	376	NA	9.08	<0.500	<0.500	<0.500	667	NA	NA	NA	NA	NA	NA	364.97	20.96	344.01	1.7/1.4
MW-3	7/13/2001	370	NA	<2.0	<2.0	<2.0	<2.0	NA	670	NA	NA	NA	NA	NA	364.97	22.77	342.20	3.1/4.8
MW-3	8/13/2001	NA	NA	NA	NA	NA	NA	NA	NA	NA	NA	NA	NA	NA	364.97	22.59	342.38	NA
MW-3	10/26/2001	<200	NA	<2.0	<2.0	<2.0	<2.0	NA	680	<2.0	<2.0	<2.0	79	<500	364.97	22.81	342.16	1.0/3.2
MW-3	1/11/2002	480	NA	<2.0	<2.0	<2.0	<2.0	NA	830	NA	NA	NA	NA	NA	364.97	18.88	346.09	1.1/3.2
MW-3	5/22/2002	570	NA	<1.0	<1.0	<1.0	<1.0	NA	680	<2.0	<2.0	<2.0	58	NA	364.97	20.75	344.22	NA
MW-3	7/15/2002	420	NA	1.1	<1.0	<1.0	1.1	NA	520	<2.0	<2.0	<2.0	53	NA	364.97	22.09	342.88	NA
MW-3	10/11/2002	730	NA	<0.50	<0.50	<0.50	<0.50	NA	320	<2.0	<2.0	<2.0	330	NA	364.97	22.68	342.29	NA
MW-3	1/17/2003	740	NA	<0.50	<0.50	<0.50	<0.50	NA	150	<2.0	<2.0	<2.0	440	NA	364.97	19.34	345.63	NA
MW-3	5/1/2003	890	NA	<0.50	<0.50	<0.50	<1.0	NA	78	<2.0	<2.0	<2.0	300	NA	364.97	19.27	345.70	NA
MW-3	8/27/2003	920 d	NA	<0.50	<0.50	<0.50	<1.0	NA	52	<2.0	<2.0	<2.0	330	NA	364.97	22.73	342.24	NA

**TABLE 1**  
**WELL CONCENTRATIONS**  
**Shell-branded Service Station**  
**11989 Dublin Boulevard**  
**Dublin, CA**

Well ID	Date	TPPH (ug/L)	TEPH (ug/L)	B (ug/L)	T (ug/L)	E (ug/L)	X (ug/L)	MTBE 8020 (ug/L)	MTBE 8260 (ug/L)	DIPE (ug/L)	ETBE (ug/L)	TAME (ug/L)	TBA (ug/L)	Ethanol (ug/L)	TOC (MSL)	Depth to Water (ft.)	GW Elevation (MSL)	DO Reading (ppm)
MW-3	10/3/2003	870 d	NA	<0.50	<0.50	<0.50	<1.0	NA	65	<2.0	<2.0	<2.0	520	NA	364.97	23.15	341.82	NA
MW-3	1/5/2004	860 d	NA	<0.50	<0.50	<0.50	<1.0	NA	40	<2.0	<2.0	<2.0	750	NA	364.97	19.60	345.37	NA
MW-3	4/9/2004	420 d	NA	<0.50	<0.50	<0.50	<1.0	NA	58	<2.0	<2.0	<2.0	280	NA	364.97	20.30	344.67	NA
MW-3	7/22/2004	570 e	NA	<0.50	<0.50	<0.50	<1.0	NA	20	<2.0	<2.0	<2.0	360	NA	364.97	22.42	342.55	NA
MW-3	11/1/2004	430	NA	<0.50	<0.50	<0.50	<1.0	NA	28	<2.0	<2.0	<2.0	680	NA	364.97	21.00	343.97	NA
MW-3	1/26/2005	1000	NA	0.53	<0.50	<0.50	<1.0	NA	20	<2.0	<2.0	<2.0	820	NA	364.97	17.92	347.05	NA
MW-3	4/14/2005	1,100	NA	1.3	<0.50	<0.50	<1.0	NA	16	<2.0	<2.0	<2.0	580	NA	364.97	18.11	346.86	NA
MW-3	7/21/2005	490	NA	<0.50	<0.50	<0.50	<1.0	NA	4.2	<2.0	<2.0	<2.0	400	NA	364.97	22.95	342.02	NA
MW-3	11/8/2005	349	NA	<0.500	<0.500	<0.500	<0.500	NA	10.1	<0.500	<0.500	<0.500	418	NA	364.97	22.18	342.79	NA
MW-3	1/6/2006	<50.0	NA	<0.500	<0.500	<0.500	<0.500	NA	13.7	<0.500	<0.500	<0.500	1,060	NA	364.97	19.40	345.57	NA
MW-3	4/19/2006	376	NA	0.580	<0.500	<0.500	<0.500	NA	4.44	<0.500	<0.500	<0.500	452	NA	364.97	18.62	346.35	NA
MW-3	7/26/2006	<50.0	NA	<0.500	<0.500	<0.500	<0.500	NA	5.98	NA	NA	NA	72.1	NA	364.97	22.79	342.18	NA
MW-3	10/27/2006	550	NA	<0.50	<0.50	<0.50	<1.0	NA	3.8	<2.0	<2.0	<2.0	270	NA	364.97	23.41	341.56	NA
MW-3	1/19/2007	390	NA	<0.50	<0.50	<0.50	<0.50	NA	6.0	NA	NA	NA	770	NA	364.97	19.88	345.09	NA
MW-3	4/3/2007	310 h,i	NA	<0.50	<1.0	<1.0	<1.0	NA	4.1	NA	NA	NA	480	NA	364.97	20.23	344.74	NA
MW-3	7/6/2007	330 h,i	NA	<0.50	<1.0	0.24 j	2.09 j	NA	1.3	NA	NA	NA	210	NA	364.97	21.85	343.12	NA
MW-3	10/30/2007	310 h	NA	<0.50	<1.0	<1.0	<1.0	NA	2.2	<2.0	<2.0	<2.0	90	NA	364.97	22.00	342.97	NA
MW-3	1/10/2008	320 h,i	NA	<0.50	<1.0	<1.0	<1.0	NA	2.3	NA	NA	NA	160	NA	364.97	18.81	346.16	NA
MW-3	4/24/2008	610	NA	<0.50	<1.0	<1.0	<1.0	NA	<1.0	NA	NA	NA	160	NA	364.97	21.15	343.82	NA
MW-3	7/31/2008	560	NA	<0.50	<1.0	<1.0	<1.0	NA	1.9	NA	NA	NA	72	NA	364.97	21.90	343.07	NA
MW-3	10/13/2008	550	NA	<0.50	<1.0	<1.0	<1.0	NA	<1.0	<2.0	<2.0	<2.0	40	NA	364.97	21.04	343.93	NA
MW-3	1/5/2009	280	NA	<0.50	<1.0	<1.0	<1.0	NA	<1.0	NA	NA	NA	13	NA	364.97	18.12	346.85	NA
MW-3	7/7/2009	700	NA	<0.50	<1.0	<1.0	<1.0	NA	<1.0	<2.0	<2.0	<2.0	34	NA	364.97	22.95	342.02	NA
<b>MW-3</b>	<b>1/6/2010</b>	<b>350</b>	<b>NA</b>	<b>&lt;0.50</b>	<b>&lt;1.0</b>	<b>&lt;1.0</b>	<b>&lt;1.0</b>	<b>NA</b>	<b>&lt;1.0</b>	<b>NA</b>	<b>NA</b>	<b>NA</b>	<b>13</b>	<b>NA</b>	<b>364.97</b>	<b>22.74</b>	<b>342.23</b>	<b>NA</b>
MW-4	8/10/2001	NA	NA	NA	NA	NA	NA	NA	NA	NA	NA	NA	NA	NA	364.01	25.63	338.38	NA
MW-4	8/13/2001	2,400	NA	<10	<10	<10	<10	NA	8,300	NA	NA	NA	NA	NA	364.01	26.32	337.69	4.2/2.7
MW-4	10/26/2001	<2,000	NA	<20	<20	<20	<20	NA	8,600	NA	NA	NA	NA	NA	364.01	26.02	337.99	3.1/2.8
MW-4	1/11/2002	<2,000	NA	<20	<20	<20	<20	NA	5,100	NA	NA	NA	NA	NA	364.01	22.25	341.76	7.9/3.0
MW-4	5/22/2002	<500	NA	<5.0	<5.0	<5.0	<5.0	NA	3,200	<5.0	<5.0	<5.0	2,500	NA	364.01	23.96	340.05	NA

**TABLE 1**  
**WELL CONCENTRATIONS**  
**Shell-branded Service Station**  
**11989 Dublin Boulevard**  
**Dublin, CA**

Well ID	Date	TPPH (ug/L)	TEPH (ug/L)	B (ug/L)	T (ug/L)	E (ug/L)	X (ug/L)	MTBE 8020 (ug/L)	MTBE 8260 (ug/L)	DIPE (ug/L)	ETBE (ug/L)	TAME (ug/L)	TBA (ug/L)	Ethanol (ug/L)	TOC (MSL)	Depth to Water (ft.)	GW Elevation (MSL)	DO Reading (ppm)
MW-4	7/15/2002	<2,500	NA	<20	<20	<20	<20	NA	7,000	<20	<20	<20	2,000	NA	363.97	25.18	338.79	NA
MW-4	10/11/2002	1,900	NA	<5.0	<5.0	<5.0	<5.0	NA	2,900	<5.0	<5.0	<5.0	5,100	NA	363.97	25.91	338.06	NA
MW-4	1/17/2003	580	NA	<2.5	<2.5	<2.5	<2.5	NA	59	<2.5	<2.5	<2.5	7,000	NA	363.97	22.38	341.59	NA
MW-4	5/1/2003	770	NA	<5.0	<5.0	<5.0	<10	NA	73	<20	<20	<20	4,300	NA	363.97	21.92	342.05	NA
MW-4	8/27/2003	<1,000	NA	<10	<10	<10	<20	NA	370	<40	<40	<40	11,000	NA	363.97	25.31	338.66	NA
MW-4	10/3/2003	<1,000	NA	<10	<10	<10	<20	NA	190	<40	<40	<40	11,000	NA	363.97	26.00	337.97	NA
MW-4	1/5/2004	<1,000	NA	<10	<10	<10	<20	NA	<10	<40	<40	<40	7,400	NA	363.97	23.48	340.49	NA
MW-4	4/9/2004	<1,000	NA	<10	<10	<10	<20	NA	<10	<40	<40	<40	5,700	NA	363.97	23.45	340.52	NA
MW-4	7/22/2004	Well inaccessible		NA	NA	NA	NA	NA	NA	NA	NA	NA	NA	NA	363.97	NA	NA	NA
MW-4	11/1/2004	Well inaccessible		NA	NA	NA	NA	NA	NA	NA	NA	NA	NA	NA	363.97	NA	NA	NA
MW-4	1/26/2005	1200 f	NA	<10	<10	<10	<20	NA	<10	<40	<40	<40	3700	NA	363.97	21.44	342.53	NA
MW-4	4/14/2005	1,000 f	NA	<0.50	<0.50	<0.50	<1.0	NA	6.2	<2.0	<2.0	<2.0	5,800	NA	363.97	20.69	343.28	NA
MW-4	7/21/2005	390	NA	<2.5	<2.5	<2.5	<5.0	NA	<2.5	<10	<10	<10	2,400	NA	363.97	25.55	338.42	NA
MW-4	11/8/2005	489	NA	<0.500	<0.500	<0.500	<0.500	NA	3.23	<0.500	<0.500	<0.500	1,710	NA	363.97	25.46	338.51	NA
MW-4	1/6/2006	<50.0	NA	<0.500	<0.500	<0.500	<0.500	NA	2.75 g	<0.500	<0.500	<0.500	302	NA	363.97	22.55	341.42	NA
MW-4	4/19/2006	<50.0	NA	<0.500	<0.500	<0.500	<0.500	NA	0.630	<0.500	<0.500	<0.500	301	NA	363.97	21.59	342.38	NA
MW-4	7/26/2006	785	NA	<0.500	<0.500	<0.500	<0.500	NA	1.47	NA	NA	NA	1,810	NA	363.97	25.67	338.30	NA
MW-4	10/27/2006	270	NA	<0.50	<0.50	<0.50	<1.0	NA	0.98	<2.0	<2.0	<2.0	3,000	NA	363.97	26.41	337.56	NA
MW-4	1/19/2007	79	NA	<0.50	<0.50	<0.50	<0.50	NA	<0.50	NA	NA	NA	550	NA	363.97	23.79	340.18	NA
MW-4	4/3/2007	63 h,i	NA	<0.50	<1.0	<1.0	<1.0	NA	<1.0	NA	NA	NA	13	NA	363.97	23.36	340.61	NA
MW-4	7/6/2007	130 h,i	NA	<0.50	<1.0	<1.0	1.0	NA	<1.0	NA	NA	NA	750	NA	363.97	24.47	339.50	NA
MW-4	10/30/2007	150 h,i	NA	<0.50	<1.0	<1.0	<1.0	NA	<1.0	<2.0	<2.0	<2.0	530	NA	363.97	24.66	339.31	NA
MW-4	1/10/2008	Well inaccessible		NA	NA	NA	NA	NA	NA	NA	NA	NA	NA	NA	363.97	NA	NA	NA
MW-4	4/24/2008	230	NA	<0.50	<1.0	<1.0	<1.0	NA	<1.0	NA	NA	NA	170	NA	363.97	23.49	340.48	NA
MW-4	7/31/2008	67	NA	<0.50	<1.0	<1.0	<1.0	NA	<1.0	NA	NA	NA	29	NA	363.97	24.63	339.34	NA
MW-4	10/13/2008	170	NA	<0.50	<1.0	<1.0	<1.0	NA	<1.0	<2.0	<2.0	<2.0	120	NA	363.97	24.52	339.45	NA
MW-4	1/5/2009	<50	NA	<0.50	<1.0	<1.0	<1.0	NA	<1.0	NA	NA	NA	<10	NA	363.97	23.18	340.79	NA
MW-4	7/7/2009	<50	NA	<0.50	<1.0	<1.0	<1.0	NA	<1.0	<2.0	<2.0	<2.0	<10	NA	363.97	24.98	338.99	NA
<b>MW-4</b>	<b>1/6/2010</b>	<b>75</b>	<b>NA</b>	<b>&lt;0.50</b>	<b>&lt;1.0</b>	<b>&lt;1.0</b>	<b>&lt;1.0</b>	<b>NA</b>	<b>&lt;1.0</b>	<b>NA</b>	<b>NA</b>	<b>NA</b>	<b>&lt;10</b>	<b>NA</b>	<b>363.97</b>	<b>24.94</b>	<b>339.03</b>	<b>NA</b>



**TABLE 1**  
**WELL CONCENTRATIONS**  
**Shell-branded Service Station**  
**11989 Dublin Boulevard**  
**Dublin, CA**

Well ID	Date	TPPH (ug/L)	TEPH (ug/L)	B (ug/L)	T (ug/L)	E (ug/L)	X (ug/L)	MTBE 8020 (ug/L)	MTBE 8260 (ug/L)	DIPE (ug/L)	ETBE (ug/L)	TAME (ug/L)	TBA (ug/L)	Ethanol (ug/L)	TOC (MSL)	Depth to Water (ft.)	GW Elevation (MSL)	DO Reading (ppm)
---------	------	----------------	----------------	-------------	-------------	-------------	-------------	------------------------	------------------------	----------------	----------------	----------------	---------------	-------------------	--------------	----------------------------	--------------------------	------------------------

MW-5	1/3/2006	NA	NA	NA	NA	NA	NA	NA	NA	NA	NA	NA	NA	NA	361.00	22.95	338.05	NA
MW-5	1/6/2006	<50.0	280	<0.500	<0.500	<0.500	<0.500	NA	<0.500	<0.500	<0.500	<0.500	<10.0	NA	361.00	22.77	338.23	NA
MW-5	4/19/2006	<50.0	NA	<0.500	<0.500	<0.500	<0.500	NA	<0.500	<0.500	<0.500	<0.500	32.1	NA	361.00	21.06	339.94	NA
MW-5	7/26/2006	<50.0	NA	<0.500	<0.500	<0.500	<0.500	NA	<0.500	NA	NA	NA	<10.0	NA	361.00	24.68	336.32	NA
MW-5	10/27/2006	170	NA	<0.50	<0.50	<0.50	<1.0	NA	<0.50	<2.0	<2.0	<2.0	<5.0	NA	361.00	25.57	335.43	NA
MW-5	1/19/2007	230	NA	<0.50	<0.50	<0.50	<0.50	NA	<0.50	NA	NA	NA	<20	NA	361.00	24.24	336.76	NA
MW-5	4/3/2007	76 h	NA	<0.50	<1.0	<1.0	<1.0	NA	<1.0	NA	NA	NA	<10	NA	361.00	23.64	337.36	NA
MW-5	7/6/2007	<50 h	NA	<0.50	<1.0	<1.0	0.84 j	NA	<1.0	NA	NA	NA	<10	NA	361.00	24.74	336.26	NA
MW-5	10/30/2007	<50 h	NA	<0.50	<1.0	<1.0	<1.0	NA	<1.0	<2.0	<2.0	<2.0	<10	NA	361.00	24.84	336.16	NA
MW-5	1/10/2008	<50 h	NA	<0.50	<1.0	<1.0	<1.0	NA	<1.0	NA	NA	NA	<10	NA	361.00	22.95	338.05	NA
MW-5	4/24/2008	<50	NA	<0.50	<1.0	<1.0	<1.0	NA	<1.0	NA	NA	NA	<10	NA	361.00	23.58	337.42	NA
MW-5	7/31/2008	<50	NA	<0.50	<1.0	<1.0	<1.0	NA	<1.0	NA	NA	NA	<10	NA	361.00	24.88	336.12	NA
MW-5	10/13/2008	<50	NA	<0.50	<1.0	<1.0	<1.0	NA	<1.0	<2.0	<2.0	<2.0	<10	NA	361.00	25.02	335.98	NA
MW-5	1/5/2009	<50	NA	<0.50	<1.0	<1.0	<1.0	NA	<1.0	NA	NA	NA	<10	NA	361.00	24.06	336.94	NA
MW-5	7/7/2009	<50	NA	<0.50	<1.0	<1.0	<1.0	NA	<1.0	<2.0	<2.0	<2.0	<10	NA	361.00	24.75	336.25	NA
<b>MW-5</b>	<b>1/6/2010</b>	<b>&lt;50</b>	<b>NA</b>	<b>&lt;0.50</b>	<b>&lt;1.0</b>	<b>&lt;1.0</b>	<b>&lt;1.0</b>	<b>NA</b>	<b>&lt;1.0</b>	<b>NA</b>	<b>NA</b>	<b>NA</b>	<b>&lt;10</b>	<b>NA</b>	<b>361.00</b>	<b>24.57</b>	<b>336.43</b>	<b>NA</b>

MW-6	7/21/2006	NA	NA	NA	NA	NA	NA	NA	NA	NA	NA	NA	NA	NA	361.15	25.33	335.82	NA
MW-6	7/26/2006	<50.0	NA	<0.500	<0.500	<0.500	<0.500	NA	<0.500	<0.500	<0.500	<0.500	<10.0	NA	361.15	25.45	335.70	NA
MW-6	10/27/2006	<50	NA	<0.50	<0.50	<0.50	<1.0	NA	0.63	<2.0	<2.0	<2.0	<5.0	NA	361.15	26.41	334.74	NA
MW-6	1/19/2007	<50	NA	<0.50	<0.50	<0.50	<0.50	NA	1.1	NA	NA	NA	<20	NA	361.15	25.50	335.65	NA
MW-6	4/3/2007	<50 h	NA	<0.50	<1.0	<1.0	<1.0	NA	0.70 j	NA	NA	NA	<10	NA	361.15	25.00	336.15	NA
MW-6	7/6/2007	<50 h	NA	<0.50	<1.0	<1.0	<1.0	NA	0.34 j	NA	NA	NA	<10	NA	361.15	25.93	335.22	NA
MW-6	10/30/2007	<50 h	NA	<0.50	<1.0	<1.0	<1.0	NA	0.30 j	<2.0	<2.0	<2.0	<10	NA	361.15	26.10	335.05	NA
MW-6	1/10/2008	<50 h	NA	<0.50	<1.0	<1.0	<1.0	NA	<1.0	NA	NA	NA	<10	NA	361.15	24.43	336.72	NA
MW-6	4/24/2008	<50	NA	<0.50	<1.0	<1.0	<1.0	NA	<1.0	NA	NA	NA	<10	NA	361.15	24.76	336.39	NA
MW-6	7/31/2008	<50	NA	<0.50	<1.0	<1.0	<1.0	NA	<1.0	NA	NA	NA	<10	NA	361.15	26.00	335.15	NA
MW-6	10/13/2008	<50	NA	<0.50	<1.0	<1.0	<1.0	NA	<1.0	<2.0	<2.0	<2.0	<10	NA	361.15	26.28	334.87	NA
MW-6	1/5/2009	<50	NA	<0.50	<1.0	<1.0	<1.0	NA	<1.0	NA	NA	NA	<10	NA	361.15	25.18	335.97	NA
MW-6	7/7/2009	<50	NA	<0.50	<1.0	<1.0	<1.0	NA	<1.0	<2.0	<2.0	<2.0	<10	NA	361.15	25.70	335.45	NA

**TABLE 1**  
**WELL CONCENTRATIONS**  
**Shell-branded Service Station**  
**11989 Dublin Boulevard**  
**Dublin, CA**

Well ID	Date	TPPH (ug/L)	TEPH (ug/L)	B (ug/L)	T (ug/L)	E (ug/L)	X (ug/L)	MTBE 8020 (ug/L)	MTBE 8260 (ug/L)	DIPE (ug/L)	ETBE (ug/L)	TAME (ug/L)	TBA (ug/L)	Ethanol (ug/L)	TOC (MSL)	Depth to Water (ft.)	GW Elevation (MSL)	DO Reading (ppm)
<b>MW-6</b>	<b>1/6/2010</b>	<b>89</b>	<b>NA</b>	<b>&lt;0.50</b>	<b>&lt;1.0</b>	<b>&lt;1.0</b>	<b>&lt;1.0</b>	<b>NA</b>	<b>&lt;1.0</b>	<b>NA</b>	<b>NA</b>	<b>NA</b>	<b>&lt;10</b>	<b>NA</b>	<b>361.15</b>	<b>25.41</b>	<b>335.74</b>	<b>NA</b>
MW-7	7/21/2006	NA	NA	NA	NA	NA	NA	NA	NA	NA	NA	NA	NA	NA	365.21	25.93	339.28	NA
MW-7	7/26/2006	<50.0	NA	<0.500	<0.500	<0.500	<0.500	NA	<0.500	<0.500	<0.500	<0.500	<10.0	NA	365.21	30.53	334.68	NA
MW-7	10/27/2006	<50	NA	<0.50	<0.50	<0.50	<1.0	NA	<0.50	<2.0	<2.0	<2.0	<5.0	NA	365.21	31.97	333.24	NA
MW-7	1/19/2007	<50	NA	<0.50	<0.50	<0.50	<0.50	NA	<0.50	NA	NA	NA	<20	NA	365.21	31.61	333.60	NA
MW-7	4/3/2007	<50 h	NA	<0.50	<1.0	<1.0	<1.0	NA	<1.0	NA	NA	NA	<10	NA	365.21	30.80	334.41	NA
MW-7	7/6/2007	<50 h	NA	<0.50	<1.0	<1.0	<1.0	NA	<1.0	NA	NA	NA	<10	NA	365.21	31.86	333.35	NA
MW-7	10/30/2007	<50 h	NA	<0.50	<1.0	<1.0	<1.0	NA	<1.0	<2.0	<2.0	<2.0	<10	NA	365.21	32.32	332.89	NA
MW-7	1/10/2008	<50 h	NA	<0.50	<1.0	<1.0	<1.0	NA	<1.0	NA	NA	NA	<10	NA	365.21	31.40	333.81	NA
MW-7	4/24/2008	<50	NA	<0.50	<1.0	<1.0	<1.0	NA	<1.0	NA	NA	NA	<10	NA	365.21	30.60	334.61	NA
MW-7	7/31/2008	<50	NA	<0.50	<1.0	<1.0	<1.0	NA	<1.0	NA	NA	NA	<10	NA	365.21	32.14	333.07	NA
MW-7	10/13/2008	<50	NA	<0.50	<1.0	<1.0	<1.0	NA	<1.0	<2.0	<2.0	<2.0	<10	NA	365.21	32.80	332.41	NA
MW-7	1/5/2009	<50	NA	<0.50	<1.0	<1.0	<1.0	NA	<1.0	NA	NA	NA	<10	NA	365.21	31.86	333.35	NA
MW-7	7/7/2009	<50	NA	<0.50	<1.0	<1.0	<1.0	NA	<1.0	<2.0	<2.0	<2.0	<10	NA	365.21	31.49	333.72	NA
<b>MW-7</b>	<b>1/6/2010</b>	<b>160</b>	<b>NA</b>	<b>&lt;0.50</b>	<b>&lt;1.0</b>	<b>&lt;1.0</b>	<b>&lt;1.0</b>	<b>NA</b>	<b>&lt;1.0</b>	<b>NA</b>	<b>NA</b>	<b>NA</b>	<b>&lt;10</b>	<b>NA</b>	<b>365.21</b>	<b>31.52</b>	<b>333.69</b>	<b>NA</b>

**TABLE 1**  
**WELL CONCENTRATIONS**  
**Shell-branded Service Station**  
**11989 Dublin Boulevard**  
**Dublin, CA**

Well ID	Date	TPPH (ug/L)	TEPH (ug/L)	B (ug/L)	T (ug/L)	E (ug/L)	X (ug/L)	MTBE 8020 (ug/L)	MTBE 8260 (ug/L)	DIPE (ug/L)	ETBE (ug/L)	TAME (ug/L)	TBA (ug/L)	Ethanol (ug/L)	TOC (MSL)	Depth to Water (ft.)	GW Elevation (MSL)	DO Reading (ppm)
---------	------	----------------	----------------	-------------	-------------	-------------	-------------	------------------------	------------------------	----------------	----------------	----------------	---------------	-------------------	--------------	----------------------------	--------------------------	------------------------

Abbreviations:

TPPH = Total petroleum hydrocarbons as gasoline by EPA Method 8260B; prior to July 13, 2001, analyzed by EPA Method 8015.

TEPH = Total petroleum hydrocarbons as diesel by modified EPA Method 8015.

BTEX = Benzene, toluene, ethylbenzene, xylenes by EPA Method 8260B; prior to July 13, 2001, analyzed by EPA Method 8020.

MTBE = Methyl tertiary butyl ether

DIPE = Di-isopropyl ether, analyzed by EPA Method 8260

ETBE = Ethyl tertiary butyl ether, analyzed by EPA Method 8260

TAME = Tertiary amyl methyl ether, analyzed by EPA Method 8260

TBA = Tertiary butyl alcohol, analyzed by EPA Method 8260

TOC = Top of Casing Elevation

GW = Groundwater

DO = Dissolved Oxygen

n/n = Pre-purge/Post-purge DO Readings

ug/L = Parts per billion

ppm = Parts per million

MSL = Mean sea level

ft. = Feet

<n = Below detection limit

NA = Not applicable

**TABLE 1  
WELL CONCENTRATIONS  
Shell-branded Service Station  
11989 Dublin Boulevard  
Dublin, CA**

Well ID	Date	TPPH (ug/L)	TEPH (ug/L)	B (ug/L)	T (ug/L)	E (ug/L)	X (ug/L)	MTBE 8020 (ug/L)	MTBE 8260 (ug/L)	DIPE (ug/L)	ETBE (ug/L)	TAME (ug/L)	TBA (ug/L)	Ethanol (ug/L)	TOC (MSL)	Depth to Water (ft.)	GW Elevation (MSL)	DO Reading (ppm)
---------	------	----------------	----------------	-------------	-------------	-------------	-------------	------------------------	------------------------	----------------	----------------	----------------	---------------	-------------------	--------------	----------------------------	--------------------------	------------------------

Notes:

a = Sample was analyzed outside the EPA recommended holding time.

b = Concentration is an estimate.

c = DO meter malfunctioning.

d = Hydrocarbon does not match pattern of laboratory's standard.

e = Sample contains discrete peak in addition to gasoline.

f = Quantity of unknown hydrocarbon(s) in sample based on gasoline.

g = Secondary ion abundances were outside method requirements. Identification based on analytical judgement.

h = Analyzed by EPA Method 8015B (M).

i = The sample chromatographic pattern for TPH does not match the chromatographic pattern of the specified standard. Quantitation of the unknown hydrocarbon(s) in the sample was based upon the specified standard.

j = Analyte was detected at a concentration below the reporting limit and above the laboratory method detection limit. Reported value is estimated.

Ethanol analyzed by EPA Method 8260B.

Wells surveyed June 21, 1999 by Virgil Chavez Land Surveying of Vallejo, CA.

Wells surveyed August 23, 2001 and February 18, 2002 by Virgil Chavez Land Surveying of Vallejo, CA.

Well MW-5 surveyed on March 3, 2006 by Mid Coast Engineers.

Well MW-6 and MW-7 surveyed data provided by Delta Environmental Consultants, Inc, CA. on August 15, 2006.



**APPENDIX A**

**BLAINE TECH SERVICES, INC.**

**FIELD DATA SHEETS**

# SHELL WELLHEAD INSPECTION FORM

## (FOR SAMPLE TECHNICIAN)

Site Address 11989 DUBLIN BVD, DUBLIN, CA

Date 1/6/10

Job Number 100106-NW1

Technician WW

Page 1 of 1

Well ID	Well Inspected - No Corrective Action Required	Well Box Meets Compliance Requirements *See Below	Water Bailed From Wellbox	Cap Replaced	Lock Replaced	Well Not Inspected (explain in notes)	New Deficiency Identified	Previously Identified Deficiency Persists	Notes
MW-2	X	X							
MW-3	X	X							
MW-4		X							<del>NO TAG</del> 1/2 BOLTS MISSING
MW-5	X	X							
MW-6							X		NO TAG
MW-7							P		NO TAG

\*Well box must meet all three criteria to be compliant: 1) WELL IS SECURABLE BY DESIGN (12" or less) 2) WELL IS MARKED WITH THE WORDS "MONITORING WELL" (12" or less) 3) WELL TAG IS PRESENT, SECURE, AND CORRECT

Notes: \_\_\_\_\_

## WELL GAUGING DATA

Project # 100106-WWI Date 1/6/10 Client SHELL

Site 11989 DUBLIN BLVD, DUBLIN, CA

Well ID	Time	Well Size (in.)	Sheen / Odor	Depth to Immiscible Liquid (ft.)	Thickness of Immiscible Liquid (ft.)	Volume of Immiscibles Removed (ml)	Depth to water (ft.)	Depth to well bottom (ft.)	Survey Point: TOB or <del>FOC</del>	Notes
MW-2	1243	4					22.22	32.43	↓	
MW-3	1245	4				22.74	32.64			
MW-4	1337	2				24.94	34.90			
MW-5	1254	2				24.57	31.75			
MW-6	1256	2				25.41	29.55			
MW-7	1302	2				31.52	69.18			

**SHELL OIL WELL MONITORING DATA SHEET**

BTS #: <b>100106-WW2</b>	Site: <b>11989 DUBLIN BLVD, DUBLIN, CA</b>
Sampler: <b>WW</b>	Date: <b>1/6/10</b>
Well I.D.: <b>MW-2</b>	Well Diameter: 2 3 <b>(4)</b> 6 8
Total Well Depth (TD): <b>32.43</b>	Depth to Water (DTW): <b>22.22</b>
Depth to Free Product:	Thickness of Free Product (feet):
Referenced to: <b>(PVC)</b> Grade	D.O. Meter (if req'd): YSI HACH
DTW with 80% Recharge [(Height of Water Column x 0.20) + DTW]: <b>24.26</b>	

Purge Method:  Bailer  Disposable Bailer  Positive Air Displacement  Electric Submersible

Water:  Waterra  Peristaltic  Extraction Pump  Other \_\_\_\_\_

Sampling Method:  Bailer  Disposable Bailer  Extraction Port  Dedicated Tubing

Other: \_\_\_\_\_

$6.6 \text{ (Gals.)} \times 3 = 19.8 \text{ Gals.}$ <p>I Case Volume      Specified Volumes      Calculated Volume</p>	<table border="1" style="width:100%; border-collapse: collapse;"> <thead> <tr> <th>Well Diameter</th> <th>Multiplier</th> <th>Well Diameter</th> <th>Multiplier</th> </tr> </thead> <tbody> <tr> <td>1"</td> <td>0.04</td> <td>4"</td> <td>0.65</td> </tr> <tr> <td>2"</td> <td>0.16</td> <td>6"</td> <td>1.47</td> </tr> <tr> <td>3"</td> <td>0.37</td> <td>Other</td> <td>radius<sup>2</sup> * 0.163</td> </tr> </tbody> </table>	Well Diameter	Multiplier	Well Diameter	Multiplier	1"	0.04	4"	0.65	2"	0.16	6"	1.47	3"	0.37	Other	radius <sup>2</sup> * 0.163
Well Diameter	Multiplier	Well Diameter	Multiplier														
1"	0.04	4"	0.65														
2"	0.16	6"	1.47														
3"	0.37	Other	radius <sup>2</sup> * 0.163														

Time	Temp (°F)	pH	Cond. (mS or µS)	Turbidity (NTUs)	Gals. Removed	Observations
1528	17.7	7.79	941	103	6.6	odor
1529	18.4	7.39	948	135	13.2	"
1530	18.8	7.20	944	171	19.8	"

Did well dewater? Yes  No  Gallons actually evacuated: **19.8**

Sampling Date: **1/6/10** Sampling Time: **1540** Depth to Water: **24.26**

Sample I.D.: **MW-2** Laboratory: **(CalScience)** Columbia Other \_\_\_\_\_

Analyzed for: **(TPH-G BTEX MTBE)** TPH-D Oxygenates (5) Other: **TBA**

EB I.D. (if applicable): @ \_\_\_\_\_ Time Duplicate I.D. (if applicable): \_\_\_\_\_

Analyzed for: TPH-G BTEX MTBE TPH-D Oxygenates (5) Other: \_\_\_\_\_

D.O. (if req'd):	Pre-purge:	mg/L	Post-purge:	mg/L
------------------	------------	------	-------------	------

O.R.P. (if req'd):	Pre-purge:	mV	Post-purge:	mV
--------------------	------------	----	-------------	----

**SHELL WELL MONITORING DATA SHEET**

BTS #: <b>100106-WW2</b>	Site: <b>11989 DUBLIN BLVD, DUBLIN, CA</b>
Sampler: <b>WW</b>	Date: <b>1/6/10</b>
Well I.D.: <b>MW-3</b>	Well Diameter: 2 3 <b>(4)</b> 6 8
Total Well Depth (TD): <b>32.64</b>	Depth to Water (DTW): <b>22.74</b>
Depth to Free Product:	Thickness of Free Product (feet):
Referenced to: <b>(PVC)</b> Grade	D.O. Meter (if req'd): YSI HACH
DTW with 80% Recharge [(Height of Water Column x 0.20) + DTW]: <b>24.72</b>	

Purge Method: Bailer	Waterra	Sampling Method: <input checked="" type="checkbox"/> Bailer
Disposable Bailer	Peristaltic	Disposable Bailer
Positive Air Displacement	Extraction Pump	Extraction Port
<input checked="" type="checkbox"/> Electric Submersible	Other _____	Dedicated Tubing

Other: \_\_\_\_\_

<b>6.4</b> (Gals.) X	<b>3</b>	= <b>19.2</b> Gals.
Case Volume	Specified Volumes	Calculated Volume

Well Diameter	Multiplier	Well Diameter	Multiplier
1"	0.04	4"	0.65
2"	0.16	6"	1.47
3"	0.37	Other	radius <sup>2</sup> * 0.163

Time	Temp (°F)	pH	Cond. (mS or <u>µS</u> )	Turbidity (NTUs)	Gals. Removed	Observations
1516	16.7	7.20	930	240	6.4	
1517	17.5	7.41	945	262	12.8	
1518	18.2	7.26	950	246	19.2	

Did well dewater? Yes  No  Gallons actually evacuated: **19.2**

Sampling Date: **1/6/10** Sampling Time: **1525** Depth to Water: **24.50**

Sample I.D.: **MW-3** Laboratory: **(CalScience)** Columbia Other \_\_\_\_\_

Analyzed for: **(TPH-G BTEX MTBE)** TPH-D Oxygenates (5) Other: **TBA**

EB I.D. (if applicable): @ \_\_\_\_\_ Duplicate I.D. (if applicable): \_\_\_\_\_

Analyzed for: TPH-G BTEX MTBE TPH-D Oxygenates (5) Other: \_\_\_\_\_

D.O. (if req'd):	Pre-purge:	mg/L	Post-purge:	mg/L
O.R.P. (if req'd):	Pre-purge:	mV	Post-purge:	mV

**SHELL WELL MONITORING DATA SHEET**

BTS #: 100106-WW2	Site: 11989 DUBLIN BLVD, DUBLIN, CA
Sampler: WW	Date: 1/6/10
Well I.D.: MW-4	Well Diameter: (2) 3 4 6 8
Total Well Depth (TD): 34.90	Depth to Water (DTW): 24.94
Depth to Free Product:	Thickness of Free Product (feet):
Referenced to: PVC Grade	D.O. Meter (if req'd): YSI HACH
DTW with 80% Recharge [(Height of Water Column x 0.20) + DTW]: 26.93	

Purge Method: Bailer      Waterra      Sampling Method: ~~Bailer~~ W

Disposable Bailer      Peristaltic       Disposable Bailer

Positive Air Displacement      Extraction Pump      Extraction Port

Electric Submersible      Other \_\_\_\_\_      Dedicated Tubing

Other: \_\_\_\_\_

1.6 (Gals.) X	3	= 4.8 Gals.
1 Case Volume	Specified Volumes	Calculated Volume

Well Diameter	Multiplier	Well Diameter	Multiplier
1"	0.04	4"	0.65
2"	0.16	6"	1.47
3"	0.37	Other	radius <sup>2</sup> * 0.163

Time	Temp (°F)	pH	Cond. (mS or <u>µS</u> )	Turbidity (NTUs)	Gals. Removed	Observations
1338	18.6	7.34	1156	339	1.6	Odor
1341	19.3	7.16	1132	979	3.2	"
1344	29.7	7.08	1132	>1000	4.8	"

Did well dewater? Yes  No

Gallons actually evacuated: 4.8

Sampling Date: 1/6/10      Sampling Time: 1350      Depth to Water: 27.69 (TR)

Sample I.D.: MW-4      Laboratory: CalScience Columbia Other \_\_\_\_\_

Analyzed for: TPH-G BTEX MTBE TPH-D Oxygenates (5) Other: TBA

EB I.D. (if applicable): @ Time      Duplicate I.D. (if applicable):

Analyzed for: TPH-G BTEX MTBE TPH-D Oxygenates (5) Other:

D.O. (if req'd):	Pre-purge:	mg/L	Post-purge:	mg/L
O.R.P. (if req'd):	Pre-purge:	mV	Post-purge:	mV

# SHELL WELL MONITORING DATA SHEET

BTS #: 100106-WW2	Site: 11989 DUBLIN BLVD, DUBLIN, CA
Sampler: WW	Date: 1/6/10
Well I.D.: MW-5	Well Diameter: (2) 3 4 6 8
Total Well Depth (TD): 31.75	Depth to Water (DTW): 24.57
Depth to Free Product:	Thickness of Free Product (feet):
Referenced to: (PVC) Grade	D.O. Meter (if req'd): YSI HACH
DTW with 80% Recharge [(Height of Water Column x 0.20) + DTW]: 26.0	

Purge Method:  Bailer      Waterra      Sampling Method:  Bailer  
 Disposable Bailer       Peristaltic       Disposable Bailer  
 Positive Air Displacement       Extraction Pump       Extraction Port  
 Electric Submersible      Other \_\_\_\_\_       Dedicated Tubing  
 Other: \_\_\_\_\_

1.1 (Gals.) X	3	= 3.3 Gals.
I Case Volume	Specified Volumes	Calculated Volume

Well Diameter	Multiplier	Well Diameter	Multiplier
1"	0.04	4"	0.65
2"	0.16	6"	1.47
3"	0.37	Other	radius <sup>2</sup> * 0.163

Time	Temp (°F)	pH	Cond. (mS or $\mu$ S)	Turbidity (NTUs)	Gals. Removed	Observations
1406	17.2	7.44	1313	>1000	1.1	
1409	18.0	7.28	1298	>1000	2.2	
1412	18.6	7.19	1287	>1000	3.3	

Did well dewater? Yes  No  Gallons actually evacuated: 3.3

Sampling Date: 1/6/10      Sampling Time: 1420      Depth to Water: 24.62

Sample I.D.: MW-5      Laboratory: (CalScience) Columbia Other \_\_\_\_\_

Analyzed for: (TPH-G BTEX MTBE) TPH-D Oxygenates (5) Other: TBA

EB I.D. (if applicable): @ \_\_\_\_\_ Duplicate I.D. (if applicable): \_\_\_\_\_

Analyzed for: TPH-G BTEX MTBE TPH-D Oxygenates (5) Other: \_\_\_\_\_

D.O. (if req'd):	Pre-purge:	mg/L	Post-purge:	mg/L
O.R.P. (if req'd):	Pre-purge:	mV	Post-purge:	mV



# SHELL OIL WELL MONITORING DATA SHEET

BTS #: 100106-WW2	Site: 11989 DUBLIN BLVD, DUBLIN, CA
Sampler: WW	Date: 1/6/10
Well I.D.: MW-6	Well Diameter: (2) 3 4 6 8
Total Well Depth (TD): 29.55	Depth to Water (DTW): 25.41
Depth to Free Product:	Thickness of Free Product (feet):
Referenced to: PVC Grade	D.O. Meter (if req'd): YSI HACH
DTW with 80% Recharge [(Height of Water Column x 0.20) + DTW]: 26.24	

Purge Method:  Bailer  Disposable Bailer  Positive Air Displacement  Electric Submersible

Water:  Peristaltic  Extraction Pump  Other \_\_\_\_\_

Sampling Method:  Bailer  Disposable Bailer  Extraction Port  Dedicated Tubing

Other: \_\_\_\_\_

0.7 (Gals.) X 3 = 2.1 Gals.		
I Case Volume	Specified Volumes	Calculated Volume

Well Diameter	Multiplier	Well Diameter	Multiplier
1"	0.04	4"	0.65
2"	0.16	6"	1.47
3"	0.37	Other	radius <sup>2</sup> * 0.163

Time	Temp (°F)	pH	Cond. (mS or µS)	Turbidity (NTUs)	Gals. Removed	Observations
1421	17.3	8.03	1076	>1000	0.7	
1423	17.8	7.37	1077	>1000	1.4	
1425	18.6	7.30	1071	>1000	2.1	

Did well dewater? Yes  No  Gallons actually evacuated: 2.1

Sampling Date: 1/6/10 Sampling Time: 1430 Depth to Water: 25.70

Sample I.D.: MW-6 Laboratory: CalScience Columbia Other \_\_\_\_\_

Analyzed for:  TPH-G  BTEX  MTBE  TPH-D  Oxygenates (5) Other: TBA

LB I.D. (if applicable): @ \_\_\_\_\_ Duplicate I.D. (if applicable): \_\_\_\_\_

Analyzed for: TPH-G BTEX MTBE TPH-D Oxygenates (5) Other: \_\_\_\_\_

D.O. (if req'd):	Pre-purge:	mg/L	Post-purge:	mg/L
O.R.P. (if req'd):	Pre-purge:	mV	Post-purge:	mV

# SHELL WELL MONITORING DATA SHEET

BTS #: 100106-WW2	Site: 11989 DUBLIN BLVD, DUBLIN, CA
Sampler: WW	Date: 1/6/10
Well I.D.: MW-7	Well Diameter: 2 3 4 6 8
Total Well Depth (TD): 69.18	Depth to Water (DTW): 31.52
Depth to Free Product:	Thickness of Free Product (feet):
Referenced to: PVC Grade	D.O. Meter (if req'd): YSI HACH
DTW with 80% Recharge [(Height of Water Column x 0.20) + DTW]: 39.05	

Purge Method: Bailer      Watera      Sampling Method: Bailer  
 Disposable Bailer      Peristaltic      Disposable Bailer  
 Positive Air Displacement      Extraction Pump      Extraction Port  
 Electric Submersible      Other \_\_\_\_\_      Dedicated Tubing

6.0 (Gals.) X	3	= 18.0 Gals.
I Case Volume	Specified Volumes	Calculated Volume

Well Diameter	Multiplier	Well Diameter	Multiplier
1"	0.04	4"	0.65
2"	0.16	6"	1.47
3"	0.37	Other	radius <sup>2</sup> * 0.163

Time	Temp (°F)	pH	Cond. (mS or µS)	Turbidity (NTUs)	Gals. Removed	Observations
1450	16.9	8.40	987	>1000	6	
1453	16.6	8.01	920	>1000	12	
1457	17.3	8.78	920	858	18	

Did well dewater? Yes  No  Gallons actually evacuated: 18

Sampling Date: 1/6/10      Sampling Time: 1505      Depth to Water: 31.75

Sample I.D.: MW-7      Laboratory: CalScience Columbia Other \_\_\_\_\_

Analyzed for: TPH-G BTEX MTBE TPH-D Oxygenates (5) Other: TBA

EB I.D. (if applicable): @ \_\_\_\_\_ Duplicate I.D. (if applicable): \_\_\_\_\_

Analyzed for: TPH-G BTEX MTBE TPH-D Oxygenates (5) Other: \_\_\_\_\_

D.O. (if req'd):	Pre-purge:	mg/L	Post-purge:	mg/L
O.R.P. (if req'd):	Pre-purge:	mV	Post-purge:	mV

# SHELL SITE INSPECTION CHECKLIST

Client Shell Date 11/17/09

Site Address 11898 Dublin Blvd. Dublin

Job Number 091117-BW1 Technician BW

Site Status Shell Branded Station Vacant Lot Other \_\_\_\_\_

- |   |                                     |       |
|---|-------------------------------------|-------|
| Inspected / Labeled / Cleaned - all wells on Scope Of Work  | <input checked="" type="checkbox"/> |       |
| Inspected / Cleaned Components - all other identifiable wells   | <input checked="" type="checkbox"/> | N/A   |
| Inspected site for site investigation & site remediation related trip hazards                                   | <input checked="" type="checkbox"/> |       |
| Completed all outstanding <i>BLAINE Wellhead Repair Order(s)</i>  | <input checked="" type="checkbox"/> | N/A   |
| Completed <i>Shell Wellhead Repair Form(s)</i>  | <input checked="" type="checkbox"/> | N/A   |
| Inspected treatment / remediation system compound for security, cleanliness and appearance                      | <input type="checkbox"/>            | (N/A) |
| Inspected vacant lot for signs of habitation, hazardous materials or terrain, overgrown vegetation and security | <input type="checkbox"/>            | (N/A) |
| Visually inspected site drums for condition and proper labeling   | <input checked="" type="checkbox"/> | N/A   |
| Unresolved deficiencies identified - " <i>Notice of Deficient Condition</i> " form(s) completed                 | <input type="checkbox"/>            | (N/A) |

Notes \_\_\_\_\_

\_\_\_\_\_

\_\_\_\_\_

\_\_\_\_\_

PROJECT MANAGER ONLY

Checklist Reviewed	<u>msj 11/19</u> <small>Initial/Date</small>	Notes
--------------------	---	-------

# SHELL WELLHEAD REPAIR FORM

## (FOR REPAIR TECHNICIAN)

Site Address 11898 Dublin Blvd. Dublin

Date 11/17/09

Job Number 091117-BW1 Technician BW

Page 1 of 1

Inspection Point (Well ID or description of location)	Well Inspected, Cleaned, Labeled - No Further Corrective Action Required	Replaced Cap	Replaced Lock	Replaced Lid Seal	Check Indicates deficiency										All Repairs Completed	Remaining Deficiencies Logged onto BLAINE Repair Order	Remaining Deficiencies Logged onto Notice of Deficient Condition - BLAINE Unable to Repair		
					Casing	Annular Seal	Tabs / Bolts	Box Structure	Apron	Trip Hazard	Below Grade	Not Secure by Design (12" diameter or less)	Lid not marked with words "MONITORING WELL"	Other Deficiency				Not Secure by Design (greater than 12" diameter)	Well Not Inspected (explain in notes)
MW-2							X										X		
	Notes: Retapped 3/2 Tabs																		
	Well box type / size: 12" Emco Materials used: 2 bolts																		
MW-3							X										X		
	Notes: Heli-Coil 3/2 Tabs																		
	Well box type / size: 12" Morrison Materials used: 2 bolts																		
MW-4				X		X											X		
	Notes: Heli-Coil 3/2 Tabs																		
	Well box type / size: 12" Emco Materials used: 2 bolts																		
MW-5		X				X											X		
	Notes: Retapped 3/2 Tabs																		
	Well box type / size: 12" Emco Materials used: 2 bolts																		
MW-6				X		X											X		
	Notes: Retapped 3/2 Tabs																		
	Well box type / size: 12" Emco Materials used: 2 bolts																		
MW-7				X		X											X		
	Notes: Retapped 3/2 Tabs																		
	Well box type / size: 12" Emco Materials used: 2 bolts																		
	Notes:																		
	Well box type / size: Materials used:																		

**APPENDIX B**

**BLAINE TECH SERVICES, INC.**

**FIELD PROCEDURES**

---

# BLAINE

TECH SERVICES INC.

---

GROUNDWATER SAMPLING SPECIALISTS  
SINCE 1985

January 25, 2010

Denis Brown  
Shell Oil Products US  
20945 South Wilmington Avenue  
Carson, CA 90810

First Quarter 2010 Groundwater Monitoring at  
Shell-branded Service Station  
11989 Dublin Boulevard  
Dublin, CA

Monitoring performed on January 6, 2010

---

## Groundwater Monitoring Report **100106-WW-1**

This report covers the routine monitoring of groundwater wells at this Shell-branded facility. In accordance with standard procedures that conform to Regional Water Quality Control Board requirements, routine field data collection includes depth to water, total well depth, thickness of any separate immiscible layer, water column volume, calculated purge volume (if applicable), elapsed evacuation time (if applicable), total volume of water removed (if applicable), and standard water parameter instrument readings. Sample material is collected, contained, stored, and transported to the laboratory in conformance with EPA standards. Purge water (if applicable) is, likewise, collected and transported to the Martinez Refining Company.

Basic field information is presented alongside analytical values excerpted from the laboratory report in the cumulative table of **WELL CONCENTRATIONS**. The full analytical report for the most recent samples and the field data sheets are attached to this report.

At a minimum, Blaine Tech Services, Inc. field personnel are certified on completion of a forty-hour Hazardous Materials and Emergency Response training course per 29 CFR 1910.120. Field personnel are also enrolled in annual eight-hour refresher courses.

Blaine Tech Services, Inc. conducts sampling and documentation assignments of this type as an independent third party. Our activities at this site consisted of objective data and sample collection only. No interpretation of analytical results, defining of hydrological conditions or formulation of recommendations was performed.

Please call if you have any questions.

Yours truly,

A handwritten signature in black ink, appearing to read 'Mike Ninokata', with a long horizontal flourish extending to the right.

Mike Ninokata  
Project Manager

MN/np

attachments: Cumulative Table of WELL CONCENTRATIONS  
Certified Analytical Report  
Field Data Sheets

cc: Regina Bussard  
Delta Environmental  
175 Bernal Road, Suite 200  
San Jose, CA 95119



# BLAINE TECH SERVICES, INC. METHODS AND PROCEDURES FOR THE ROUTINE MONITORING OF GROUNDWATER WELLS AT SHELL SITES

Blaine Tech Services, Inc. performs environmental sampling and documentation as an independent third party. We specialize in groundwater monitoring assignments and intentionally limit the scope of our services to those centered on the generation of objective information.

To avoid conflicts of interest, Blaine Tech Services, Inc. personnel do not evaluate or interpret the information we collect. As a state licensed contractor (C-57 well drilling –water – 746684 ) performing strictly technical services, we do not make any professional recommendations and perform no consulting of any kind.

---

## SAMPLING PROCEDURES OVERVIEW

### SAFETY

All groundwater monitoring assignments performed for Shell comply with Shell's safety guidelines, 29 CFR 1910.120 and SB-198 Injury and Illness Prevention Program (IIPP). All Field Technicians receive the full 40-hour 29CFR 1910.120 OSHA SARA HAZWOPER course, medical clearance and on-the-job training prior to commencing any work on any Shell site.

### INSPECTION AND GAUGING

Wells are inspected prior to evacuation and sampling. The condition of the wellhead is checked and noted according to a wellhead inspection checklist.

Standard measurements include the depth to water (DTW) and the total well depth (TD) obtained with industry standard electronic water level indicators that are graduated in increments of hundredths of a foot.

The water in each well is inspected for the presence of immiscibles. When free product is suspected, its presence is confirmed using an electronic interface probe (e.g. MMC). No samples are collected from a well containing over two-hundredths of a foot (0.02') of product.

### EVACUATION

Depth to water measurements are collected by our personnel prior to purging and minimum purge volumes are calculated anew for each well based on the height of the water column and the diameter of the well. Expected purge volumes are never less than three case volumes and are set at no less than four case volumes in some jurisdictions.

Well purging devices are selected on the basis of the well diameter and the total volume to be evacuated. In most cases the well will be purged using an electric submersible pump (i.e. Grundfos) suspended near (but not touching) the bottom of the well.

#### PARAMETER STABILIZATION

Well purging completion standards include minimum purge volumes, but additionally require stabilization of specific groundwater parameters prior to sample collection. Typical groundwater parameters used to measure stability are electrical conductivity, pH, and temperature. Instrument readings are obtained at regular intervals during the evacuation process (no less than once per case volume).

Stabilization standards for routine quarterly monitoring of fuel sites include the following: Temperature is considered to have stabilized when successive readings do not fluctuate more than +/- 1 degree Celsius. Electrical conductivity is considered stable when successive readings are within 10%. pH is considered to be stable when successive readings remain constant or vary no more than 0.2 of a pH unit.

#### DEWATERED WELLS

Normal evacuation removes no less than three case volumes of water from the well. However, less water may be removed in cases where the well dewateres and does not immediately recharge.

#### MEASURING RECHARGE

Upon completion of well purging, a depth to water measurement is collected and notated to ensure that the well has recharged to within 80% of its static, pre-purge level prior to sampling.

Wells that do not immediately show 80% recharge or dewatered wells will be allowed a minimum of 2 hours to recharge prior to sampling. The water level at time of sampling will be noted.

#### PURGEWATER CONTAINMENT

All non-hazardous purgewater evacuated from each groundwater monitoring well is captured and contained in on-board storage tanks on the Sampling Vehicle and/or special water hauling trailers. Effluent from the decontamination of reusable apparatus (sounders, electric pumps and hoses etc.), consisting of groundwater combined with deionized water and non-phosphate soap, is also captured and pumped into effluent tanks.

Non-hazardous purgewater is transported under standard Bill of Lading documentation to a Blaine Tech Services, Inc. facility before being transported to a Shell approved disposal facility.

## SAMPLE COLLECTION DEVICES

All samples are collected using a stainless steel, Teflon or disposable bailers.

## SAMPLE CONTAINERS

Sample material is decanted directly from the sampling bailer into sample containers provided by the laboratory that will analyze the samples. The transfer of sample material from the bailer to the sample container conforms to specifications contained in the USEPA T.E.G.D. The type of sample container, material of construction, method of closure and filling requirements are specific to the intended analysis. Chemicals needed to preserve the sample material are commonly placed inside the sample containers by the laboratory or glassware vendor prior to delivery of the bottle to our personnel. The laboratory sets the number of replicate containers.

## TRIP BLANKS

Trip Blanks, if requested, are taken to the site and kept inside the sample cooler for the duration of the event. They are turned over to the laboratory for analysis with the samples from that site.

## DUPLICATES

Duplicates, if requested, may be collected at a site. The Field Technician uses their discretion in choosing the well at which the Duplicate is collected, typically one suspected of containing measurable contaminants. The Duplicate sample is labeled "DUP" and the time of collection is omitted from the COC, thus rendering the sample blind.

## SAMPLE STORAGE

All sample containers are promptly placed in food grade ice chests for storage in the field and transport (direct or via our facility) to the designated analytical laboratory. These ice chests contain quantities of restaurant grade ice as a refrigerant material. The samples are maintained in either an ice chest or a refrigerator until relinquished into the custody of the laboratory or laboratory courier.

## DOCUMENTATION CONVENTIONS

A label must be affixed to all sample containers. In most cases these labels are generated by our office personnel and are partially preprinted. Labels can also be hand written by our field personnel. The site is identified with the store number and site address, as is the particular groundwater well from which the sample is drawn (e.g. MW-1, MW-2, S-1 etc.). The time and date of sample collection along with the initials of the person who collects the sample are handwritten onto the label.

Chain of Custody records are created using client specific preprinted forms following USEPA specifications.

Bill of Lading records are contemporaneous records created in the field at the site where the non-hazardous purgewater is generated. Field Technicians use preprinted Bill of Lading forms.

## DECONTAMINATION

All equipment is brought to the site in clean and serviceable condition and is cleaned after use in each well and before subsequent use in any other well. Equipment is decontaminated before leaving the site.

The primary decontamination device is a commercial steam cleaner. The steam cleaner is de-tuned to function as a hot pressure washer that is then operated with high quality deionized water that is produced at our facility and stored onboard our sampling vehicle. Cleaning is facilitated by the use of proprietary fixtures and devices included in the patented workstation (U.S. Patent 5,535,775) that is incorporated in each sampling vehicle. The steam cleaner is used to decon reels, pumps and bailers.

Any sensitive equipment or parts (i.e. Dissolved Oxygen sensor membrane, water level indicator, etc.) that cannot be washed using the high pressure water, will be sprayed with a non-phosphate soap and deionized water solution and rinsed with deionized water.

## DISSOLVED OXYGEN READINGS

Dissolved Oxygen readings are taken pre- and/or post-purge using YSI meters (e.g. YSI Model 54, 58 or 95) or HACH field test kits.

The YSI meters are equipped with a stirring device that enables them to collect accurate in-situ readings. The probe/stirring devices are modified to allow downhole measurements to be taken from wells with diameters as small as two inches. The probe and reel is decontaminated between wells as described above. The meter is calibrated between wells as per the instructions in the operating manual. The probe and stirrer is lowered into the water column. The reading is allowed to stabilize prior to collection.

## OXYIDATON REDUCTION POTENTIAL READINGS

All readings are obtained with either Corning or Myron-L meters (e.g. Corning ORP-65 or a Myron-L Ultrameter GP). The meter is cleaned between wells as described above. The meter is calibrated at the start of each day according to the instruction manual.

## FERROUS IRON MEASUREMENTS

All field measurements are collected at time of sampling with a HACH test kit.

## **APPENDIX C**

### **LABORATORY REPORT AND CHAIN-OF-CUSTODY DOCUMENTATION**

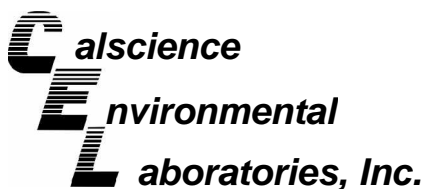

January 19, 2010

Michael Ninokata  
Blaine Tech Services, Inc.  
1680 Rogers Avenue  
San Jose, CA 95112-1105

Subject: **Calscience Work Order No.: 10-01-0451**  
**Client Reference: 11989 Dublin Blvd., Dublin, CA**

Dear Client:

Enclosed is an analytical report for the above-referenced project. The samples included in this report were received 1/8/2010 and analyzed in accordance with the attached chain-of-custody.

Unless otherwise noted, all analytical testing was accomplished in accordance with the guidelines established in our Quality Systems Manual, applicable standard operating procedures, and other related documentation. The original report of subcontracted analysis, if any, is provided herein, and follows the standard Calscience data package. The results in this analytical report are limited to the samples tested and any reproduction thereof must be made in its entirety.

If you have any questions regarding this report, please do not hesitate to contact the undersigned.

Sincerely,

A handwritten signature in black ink that reads 'Philip Samelle for'.

Calscience Environmental  
Laboratories, Inc.  
Xuan H. Dang  
Project Manager

**Analytical Report**



Blaine Tech Services, Inc.  
 1680 Rogers Avenue  
 San Jose, CA 95112-1105

Date Received: 01/08/10  
 Work Order No: 10-01-0451  
 Preparation: EPA 5030B  
 Method: LUFT GC/MS / EPA 8260B  
 Units: ug/L

Project: 11989 Dublin Blvd., Dublin, CA

Page 1 of 3

Client Sample Number	Lab Sample Number	Date/Time Collected	Matrix	Instrument	Date Prepared	Date/Time Analyzed	QC Batch ID
<b>MW-2</b>	<b>10-01-0451-1-A</b>	<b>01/06/10 15:40</b>	<b>Aqueous</b>	<b>GC/MS LL</b>	<b>01/08/10</b>	<b>01/09/10 04:27</b>	<b>100108L02</b>

Parameter	Result	RL	DF	Qual	Parameter	Result	RL	DF	Qual
Benzene	ND	0.50	1		Methyl-t-Butyl Ether (MTBE)	ND	1.0	1	
Ethylbenzene	ND	1.0	1		Tert-Butyl Alcohol (TBA)	48	10	1	
Toluene	ND	1.0	1		TPPH	3200	50	1	
Xylenes (total)	ND	1.0	1						
<u>Surrogates:</u>	<u>REC (%)</u>	<u>Control Limits</u>	<u>Qual</u>		<u>Surrogates:</u>	<u>REC (%)</u>	<u>Control Limits</u>	<u>Qual</u>	
Dibromofluoromethane	98	80-132			1,2-Dichloroethane-d4	102	80-141		
Toluene-d8	104	80-120			Toluene-d8-TPPH	110	88-112		
1,4-Bromofluorobenzene	96	76-120							

Client Sample Number	Lab Sample Number	Date/Time Collected	Matrix	Instrument	Date Prepared	Date/Time Analyzed	QC Batch ID
<b>MW-3</b>	<b>10-01-0451-2-A</b>	<b>01/06/10 15:25</b>	<b>Aqueous</b>	<b>GC/MS LL</b>	<b>01/08/10</b>	<b>01/09/10 06:25</b>	<b>100108L02</b>

Parameter	Result	RL	DF	Qual	Parameter	Result	RL	DF	Qual
Benzene	ND	0.50	1		Methyl-t-Butyl Ether (MTBE)	ND	1.0	1	
Ethylbenzene	ND	1.0	1		Tert-Butyl Alcohol (TBA)	13	10	1	
Toluene	ND	1.0	1		TPPH	350	50	1	
Xylenes (total)	ND	1.0	1						
<u>Surrogates:</u>	<u>REC (%)</u>	<u>Control Limits</u>	<u>Qual</u>		<u>Surrogates:</u>	<u>REC (%)</u>	<u>Control Limits</u>	<u>Qual</u>	
Dibromofluoromethane	109	80-132			1,2-Dichloroethane-d4	105	80-141		
Toluene-d8	97	80-120			Toluene-d8-TPPH	103	88-112		
1,4-Bromofluorobenzene	97	76-120							

Client Sample Number	Lab Sample Number	Date/Time Collected	Matrix	Instrument	Date Prepared	Date/Time Analyzed	QC Batch ID
<b>MW-4</b>	<b>10-01-0451-3-A</b>	<b>01/06/10 13:50</b>	<b>Aqueous</b>	<b>GC/MS LL</b>	<b>01/08/10</b>	<b>01/09/10 06:55</b>	<b>100108L02</b>

Parameter	Result	RL	DF	Qual	Parameter	Result	RL	DF	Qual
Benzene	ND	0.50	1		Methyl-t-Butyl Ether (MTBE)	ND	1.0	1	
Ethylbenzene	ND	1.0	1		Tert-Butyl Alcohol (TBA)	ND	10	1	
Toluene	ND	1.0	1		TPPH	75	50	1	
Xylenes (total)	ND	1.0	1						
<u>Surrogates:</u>	<u>REC (%)</u>	<u>Control Limits</u>	<u>Qual</u>		<u>Surrogates:</u>	<u>REC (%)</u>	<u>Control Limits</u>	<u>Qual</u>	
Dibromofluoromethane	107	80-132			1,2-Dichloroethane-d4	103	80-141		
Toluene-d8	97	80-120			Toluene-d8-TPPH	103	88-112		
1,4-Bromofluorobenzene	94	76-120							

RL - Reporting Limit , DF - Dilution Factor , Qual - Qualifiers

## Analytical Report



Blaine Tech Services, Inc.  
1680 Rogers Avenue  
San Jose, CA 95112-1105

Date Received: 01/08/10  
Work Order No: 10-01-0451  
Preparation: EPA 5030B  
Method: LUFT GC/MS / EPA 8260B  
Units: ug/L

Project: 11989 Dublin Blvd., Dublin, CA

Page 2 of 3

Client Sample Number	Lab Sample Number	Date/Time Collected	Matrix	Instrument	Date Prepared	Date/Time Analyzed	QC Batch ID
<b>MW-6</b>	<b>10-01-0451-4-A</b>	<b>01/06/10 14:30</b>	<b>Aqueous</b>	<b>GC/MS LL</b>	<b>01/08/10</b>	<b>01/09/10 07:24</b>	<b>100108L02</b>

Parameter	Result	RL	DF	Qual	Parameter	Result	RL	DF	Qual
Benzene	ND	0.50	1		Methyl-t-Butyl Ether (MTBE)	ND	1.0	1	
Ethylbenzene	ND	1.0	1		Tert-Butyl Alcohol (TBA)	ND	10	1	
Toluene	ND	1.0	1		TPPH	89	50	1	
Xylenes (total)	ND	1.0	1						
<u>Surrogates:</u>	<u>REC (%)</u>	<u>Control Limits</u>	<u>Qual</u>		<u>Surrogates:</u>	<u>REC (%)</u>	<u>Control Limits</u>	<u>Qual</u>	
Dibromofluoromethane	107	80-132			1,2-Dichloroethane-d4	106	80-141		
Toluene-d8	100	80-120			Toluene-d8-TPPH	106	88-112		
1,4-Bromofluorobenzene	95	76-120							

Client Sample Number	Lab Sample Number	Date/Time Collected	Matrix	Instrument	Date Prepared	Date/Time Analyzed	QC Batch ID
<b>MW-7</b>	<b>10-01-0451-5-A</b>	<b>01/06/10 15:05</b>	<b>Aqueous</b>	<b>GC/MS LL</b>	<b>01/08/10</b>	<b>01/09/10 07:53</b>	<b>100108L02</b>

Parameter	Result	RL	DF	Qual	Parameter	Result	RL	DF	Qual
Benzene	ND	0.50	1		Methyl-t-Butyl Ether (MTBE)	ND	1.0	1	
Ethylbenzene	ND	1.0	1		Tert-Butyl Alcohol (TBA)	ND	10	1	
Toluene	ND	1.0	1		TPPH	160	50	1	
Xylenes (total)	ND	1.0	1						
<u>Surrogates:</u>	<u>REC (%)</u>	<u>Control Limits</u>	<u>Qual</u>		<u>Surrogates:</u>	<u>REC (%)</u>	<u>Control Limits</u>	<u>Qual</u>	
Dibromofluoromethane	108	80-132			1,2-Dichloroethane-d4	109	80-141		
Toluene-d8	97	80-120			Toluene-d8-TPPH	104	88-112		
1,4-Bromofluorobenzene	94	76-120							

Client Sample Number	Lab Sample Number	Date/Time Collected	Matrix	Instrument	Date Prepared	Date/Time Analyzed	QC Batch ID
<b>MW-5</b>	<b>10-01-0451-6-A</b>	<b>01/06/10 14:20</b>	<b>Aqueous</b>	<b>GC/MS LL</b>	<b>01/08/10</b>	<b>01/09/10 08:23</b>	<b>100108L02</b>

Parameter	Result	RL	DF	Qual	Parameter	Result	RL	DF	Qual
Benzene	ND	0.50	1		Methyl-t-Butyl Ether (MTBE)	ND	1.0	1	
Ethylbenzene	ND	1.0	1		Tert-Butyl Alcohol (TBA)	ND	10	1	
Toluene	ND	1.0	1		TPPH	ND	50	1	
Xylenes (total)	ND	1.0	1						
<u>Surrogates:</u>	<u>REC (%)</u>	<u>Control Limits</u>	<u>Qual</u>		<u>Surrogates:</u>	<u>REC (%)</u>	<u>Control Limits</u>	<u>Qual</u>	
Dibromofluoromethane	107	80-132			1,2-Dichloroethane-d4	107	80-141		
Toluene-d8	96	80-120			Toluene-d8-TPPH	102	88-112		
1,4-Bromofluorobenzene	96	76-120							

RL - Reporting Limit , DF - Dilution Factor , Qual - Qualifiers

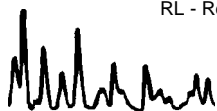



**Analytical Report**



Blaine Tech Services, Inc.  
 1680 Rogers Avenue  
 San Jose, CA 95112-1105

Date Received: 01/08/10  
 Work Order No: 10-01-0451  
 Preparation: EPA 5030B  
 Method: LUFT GC/MS / EPA 8260B  
 Units: ug/L

Project: 11989 Dublin Blvd., Dublin, CA

Page 3 of 3

Client Sample Number	Lab Sample Number	Date/Time Collected	Matrix	Instrument	Date Prepared	Date/Time Analyzed	QC Batch ID
Method Blank	099-12-767-3,151	N/A	Aqueous	GC/MS LL	01/08/10	01/09/10 03:58	100108L02

Parameter	Result	RL	DF	Qual	Parameter	Result	RL	DF	Qual
Benzene	ND	0.50	1		Methyl-t-Butyl Ether (MTBE)	ND	1.0	1	
Ethylbenzene	ND	1.0	1		Tert-Butyl Alcohol (TBA)	ND	10	1	
Toluene	ND	1.0	1		TPPH	ND	50	1	
Xylenes (total)	ND	1.0	1						
<u>Surrogates:</u>	<u>REC (%)</u>	<u>Control Limits</u>	<u>Qual</u>		<u>Surrogates:</u>	<u>REC (%)</u>	<u>Control Limits</u>	<u>Qual</u>	
Dibromofluoromethane	97	80-132			1,2-Dichloroethane-d4	104	80-141		
Toluene-d8	99	80-120			Toluene-d8-TPPH	105	88-112		
1,4-Bromofluorobenzene	93	76-120							

RL - Reporting Limit , DF - Dilution Factor , Qual - Qualifiers



## Quality Control - Spike/Spike Duplicate



Blaine Tech Services, Inc.  
1680 Rogers Avenue  
San Jose, CA 95112-1105

Date Received: 01/08/10  
Work Order No: 10-01-0451  
Preparation: EPA 5030B  
Method: LUFT GC/MS / EPA  
8260B

Project 11989 Dublin Blvd., Dublin, CA

Quality Control Sample ID	Matrix	Instrument	Date Prepared	Date Analyzed	MS/MSD Batch Number
MW-2	Aqueous	GC/MS LL	01/08/10	01/09/10	100108S02

Parameter	MS %REC	MSD %REC	%REC CL	RPD	RPD CL	Qualifiers
Benzene	92	89	72-120	3	0-20	
Carbon Tetrachloride	111	106	63-135	4	0-20	
Chlorobenzene	92	90	80-120	3	0-20	
1,2-Dibromoethane	96	92	80-120	4	0-20	
1,2-Dichlorobenzene	94	91	80-120	4	0-20	
1,1-Dichloroethene	91	91	60-132	0	0-24	
Ethylbenzene	94	91	78-120	3	0-20	
Toluene	93	89	74-122	4	0-20	
Trichloroethene	95	95	69-120	0	0-20	
Vinyl Chloride	72	70	58-130	2	0-20	
Methyl-t-Butyl Ether (MTBE)	93	92	72-126	1	0-21	
Tert-Butyl Alcohol (TBA)	90	92	72-126	2	0-20	
Diisopropyl Ether (DIPE)	93	91	71-137	3	0-23	
Ethyl-t-Butyl Ether (ETBE)	96	92	74-128	3	0-20	
Tert-Amyl-Methyl Ether (TAME)	94	91	76-124	3	0-20	
Ethanol	89	91	35-167	3	0-48	

RPD - Relative Percent Difference , CL - Control Limit



## Quality Control - LCS/LCS Duplicate



Blaine Tech Services, Inc.  
1680 Rogers Avenue  
San Jose, CA 95112-1105

Date Received: N/A  
Work Order No: 10-01-0451  
Preparation: EPA 5030B  
Method: LUFT GC/MS / EPA 8260B

Project: 11989 Dublin Blvd., Dublin, CA

Quality Control Sample ID	Matrix	Instrument	Date Prepared	Date Analyzed	LCS/LCSD Batch Number		
099-12-767-3,151	Aqueous	GC/MS LL	01/08/10	01/09/10	100108L02		
Parameter	LCS %REC	LCSD %REC	%REC CL	ME CL	RPD	RPD CL	Qualifiers
Benzene	99	97	80-122	73-129	2	0-20	
Carbon Tetrachloride	121	116	68-140	56-152	4	0-20	
Chlorobenzene	102	98	80-120	73-127	3	0-20	
1,2-Dibromoethane	106	98	80-121	73-128	7	0-20	
1,2-Dichlorobenzene	99	97	80-120	73-127	2	0-20	
1,1-Dichloroethene	101	98	72-132	62-142	3	0-25	
Ethylbenzene	102	98	80-126	72-134	4	0-20	
Toluene	100	99	80-121	73-128	2	0-20	
Trichloroethene	104	102	80-123	73-130	2	0-20	
Vinyl Chloride	80	79	67-133	56-144	2	0-20	
Methyl-t-Butyl Ether (MTBE)	100	99	75-123	67-131	2	0-20	
Tert-Butyl Alcohol (TBA)	94	91	75-123	67-131	2	0-20	
Diisopropyl Ether (DIPE)	101	99	71-131	61-141	3	0-20	
Ethyl-t-Butyl Ether (ETBE)	102	99	76-124	68-132	4	0-20	
Tert-Amyl-Methyl Ether (TAME)	103	103	80-123	73-130	0	0-20	
Ethanol	89	88	61-139	48-152	1	0-27	
TPPH	99	108	65-135	53-147	9	0-30	

Total number of LCS compounds : 17

Total number of ME compounds : 0

Total number of ME compounds allowed : 1

LCS ME CL validation result : Pass

RPD - Relative Percent Difference , CL - Control Limit

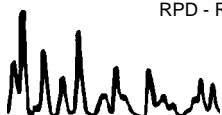

Work Order Number: 10-01-0451

<u>Qualifier</u>	<u>Definition</u>
*	See applicable analysis comment.
1	Surrogate compound recovery was out of control due to a required sample dilution, therefore, the sample data was reported without further clarification.
2	Surrogate compound recovery was out of control due to matrix interference. The associated method blank surrogate spike compound was in control and, therefore, the sample data was reported without further clarification.
3	Recovery of the Matrix Spike (MS) or Matrix Spike Duplicate (MSD) compound was out of control due to matrix interference. The associated LCS and/or LCSD was in control and, therefore, the sample data was reported without further clarification.
4	The MS/MSD RPD was out of control due to matrix interference. The LCS/LCSD RPD was in control and, therefore, the sample data was reported without further clarification.
5	The PDS/PDSD associated with this batch of samples was out of control due to a matrix interference effect. The associated batch LCS/LCSD was in control and, hence, the associated sample data was reported with no further corrective action required.
A	Result is the average of all dilutions, as defined by the method.
B	Analyte was present in the associated method blank.
C	Analyte presence was not confirmed on primary column.
E	Concentration exceeds the calibration range.
J	Analyte was detected at a concentration below the reporting limit and above the laboratory method detection limit. Reported value is estimated.
ME	LCS Recovery Percentage is within LCS ME Control Limit range.
N	Nontarget Analyte.
ND	Parameter not detected at the indicated reporting limit.
Q	Spike recovery and RPD control limits do not apply resulting from the parameter concentration in the sample exceeding the spike concentration by a factor of four or greater.
U	Undetected at the laboratory method detection limit.
X	% Recovery and/or RPD out-of-range.
Z	Analyte presence was not confirmed by second column or GC/MS analysis. Solid - Unless otherwise indicated, solid sample data is reported on a wet weight basis, not corrected for % moisture.

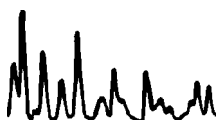

LAB (LOCATION)

- CALSCIENCE ( )
- SPL ( )
- XENCO ( )
- TEST AMERICA ( )
- OTHER ( )



# Shell Oil Products Chain Of Custody Record

Please Check Appropriate Box:

<input checked="" type="checkbox"/> ENVIRONMENTAL	<input type="checkbox"/> MOTIVA RETAIL	<input type="checkbox"/> SHELL RETAIL
<input type="checkbox"/> MOTIVA SD&CM	<input checked="" type="checkbox"/> CONSULTANT	<input type="checkbox"/> LUBES
<input type="checkbox"/> SHELL PIPELINE	<input type="checkbox"/> OTHER _____	

Print Bill To Contact Name: **Denis Brown**

INCIDENT # (ENV SERVICES): 9 8 9 9 5 3 2 8

PO #: \_\_\_\_\_ SAP #: \_\_\_\_\_

CHECK IF NO INCIDENT # APPLIES:

DATE: 1/6/10

PAGE: 1 of 1

SAMPLING COMPANY <b>Blaine Tech Services</b>		LOG CODE <b>BTSS</b>	SITE ADDRESS: Street and City <b>11989 Dublin Blvd., Dublin</b>		State <b>CA</b>	GLOBAL ID NO <b>T0600102083</b>
ADDRESS <b>1680 Rogers Ave, San Jose, CA 95112</b>			EDF DELIVERABLE TO (Name, Company, Office Location) <b>Angela Pico, Delta, San Jose Office</b>	PHONE NO <b>408.826.1862</b>	E-MAIL <b>apico@deltaenv.com</b>	CONSULTANT PROJECT NO <b>100106-ww2</b>
PROJECT CONTACT (Hardcopy or PDF Report to) <b>Michael Ninokata</b>			SAMPLER NAME(S) (Print) <b>WILLIAM WONG</b>		BTS # <b>01-0451</b>	
TELEPHONE <b>(408)573-0555</b>	FAX <b>(408)573-7771</b>	E-MAIL <b>mninokata@blainetech.com</b>				

TURNAROUND TIME (CALENDAR DAYS):

STANDARD (14 DAY)     5 DAYS     3 DAYS     2 DAYS     24 HOURS

RESULTS NEEDED ON WEEKEND

REQUESTED ANALYSIS

LA - RWQCB REPORT FORMAT     UST AGENCY:

SPECIAL INSTRUCTIONS OR NOTES :

**CC Regina Bussard w/final report rbussard@deltaenv.com**

**Run TPH-d w/Silica Gel Clean Up**

SHELL CONTRACT RATE APPLIES

STATE REIMBURSEMENT RATE APPLIES

EDD NOT NEEDED

RECEIPT VERIFICATION REQUESTED

LAB USE ONLY	Field Sample Identification			SAMPLING		MATRIX	PRESERVATIVE					NO. OF CONT.	REQUESTED ANALYSIS												TEMPERATURE ON RECEIPT °C	Container PID Readings or Laboratory Notes							
				DATE	TIME		HCL	HNO3	H2SO4	NONE	OTHER		TPH - Purgeable (8260B)	TPH - Extractable (8015M)	BTEX (8260B)	5 Oxygenates (8260B)	MTBE (8260B)	TBA (8260B)	DIPE (8260B)	TAME (8260B)	ETBE (8260B)	1,2 DCA (8260B)	EDB (8260B)	Ethanol (8260B)			Methanol (8015M)						
	1	MW-2			1/6/10		w	3						3	X		X	X	X														
2	MW-3				1525									X		X	X	X															
3	MW-4				1350									X		X	X	X															
4	MW-6				1430									X		X	X	X															
5	MW-7				1505									X		X	X	X															
6	MW-5				1420									X		X	X	X															

Relinquished by: (Signature) <i>[Signature]</i>	Received by: (Signature) <i>[Signature]</i> <b>SAMPLE CUSTODIAN</b>	Date: 1/6/10	Time: 1643
Relinquished by: (Signature) <i>[Signature]</i> <b>Sample Custodian</b>	Received by: (Signature) <i>[Signature]</i> <b>Tom Smalley CEC</b>	Date: 1/7/10	Time: 1000
Relinquished by: (Signature) <i>[Signature]</i> <b>1-7-10 1730</b>	Received by: (Signature) <i>[Signature]</i>	Date: 1/7/10	Time: 1030

05/2/06 Revision

0451



< WebShip > > > > >  
800-322-5555 www.gso.com

Ship From:  
ALAN KEMP  
CAL SCIENCE- CONCORD  
5063 COMMERCIAL CIRCLE #H  
CONCORD, CA 94520

Ship To:  
SAMPLE RECEIVING  
CEL  
7440 LINCOLN WAY  
GARDEN GROVE, CA 92841

COD:  
\$0.00

Reference:  
ERI, BTS

Delivery Instructions:

Signature Type:  
SIGNATURE REQUIRED

Tracking #: 513338248



NPS

ORC

D

GARDEN GROVE

D92843A

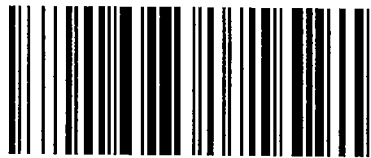

78401493

Print Date : 01/07/10 14:15 PM

Package 1 of 1

Send Label To Printer  Print All Edit Shipment Finish

LABEL INSTRUCTIONS:

Do not copy or reprint this label for additional shipments - each package must have a unique barcode.

STEP 1 - Use the "Send Label to Printer" button on this page to print the shipping label on a laser or inkjet printer.

STEP 2 - Fold this page in half.

STEP 3 - Securely attach this label to your package, do not cover the barcode.

STEP 4 - Request an on-call pickup for your package, if you do not have scheduled daily pickup service or Drop-off your package at the nearest GSO drop box. Locate nearest GSO dropbox locations using this link.

ADDITIONAL OPTIONS:

Send Label Via Email Create Return Label

TERMS AND CONDITIONS:

By giving us your shipment to deliver, you agree to all the service terms and conditions described in this section. Our liability for loss or damage to any package is limited to your actual damages or \$100 whichever is less, unless you pay for and declare a higher authorized value. If you declare a higher value and pay the additional charge, our liability will be the lesser of your declared value or the actual value of your loss or damage. In any event, we will not be liable for any damage, whether direct, incidental, special or consequential, in excess of the declared value of a shipment whether or not we had knowledge that such damage might be incurred including but not limited to loss of income or profit. We will not be liable for your acts or omissions, including but not limited to improper or insufficient packaging, securing, marking or addressing. Also, we will not be liable if you or the recipient violates any of the terms of our agreement. We will not be liable for loss, damage or delay caused by events we cannot control, including but not limited to acts of God, perils of the air, weather conditions, act of public enemies, war, strikes, or civil commotion. The highest declared value for our GSO Priority Letter or GSO Priority Package is \$500. For other shipments the highest declared value is \$10,000 unless your package contains items of "extraordinary value", in which case the highest declared value we allow is \$500. Items of "extraordinary value" include, but are not limited to, artwork, jewelry, furs, precious metals, tickets, negotiable instruments and other items with intrinsic value.

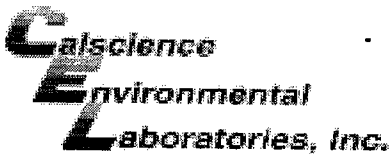

WORK ORDER #: 10-01-0451

**SAMPLE RECEIPT FORM**

Cooler 1 of 1

CLIENT: Blaine Tech

DATE: 01/08/10

**TEMPERATURE:** Thermometer ID: SC1 (Criteria: 0.0°C – 6.0°C, not frozen)

Temperature 3.1 °C + 0.5°C (CF) = 3.6 °C  Blank  Sample

- Sample(s) outside temperature criteria (PM/APM contacted by: \_\_\_\_\_).
- Sample(s) outside temperature criteria but received on ice/chilled on same day of sampling.

Received at ambient temperature, placed on ice for transport by Courier.

Ambient Temperature:  Air  Filter  Metals Only  PCBs Only

Initial: [Signature]

**CUSTODY SEALS INTACT:**

- Cooler  \_\_\_\_\_  No (Not Intact)  Not Present  N/A
- Sample  \_\_\_\_\_  No (Not Intact)  Not Present

Initial: [Signature]

Initial: [Signature]

**SAMPLE CONDITION:**

	Yes	No	N/A
Chain-Of-Custody (COC) document(s) received with samples.....	<input checked="" type="checkbox"/>	<input type="checkbox"/>	<input type="checkbox"/>
COC document(s) received complete.....	<input type="checkbox"/>	<input checked="" type="checkbox"/>	<input type="checkbox"/>
<input checked="" type="checkbox"/> Collection date/time, matrix, and/or # of containers logged in based on sample labels.			
<input type="checkbox"/> No analysis requested. <input type="checkbox"/> Not relinquished. <input type="checkbox"/> No date/time relinquished.			
Sampler's name indicated on COC.....	<input checked="" type="checkbox"/>	<input type="checkbox"/>	<input type="checkbox"/>
Sample container label(s) consistent with COC.....	<input checked="" type="checkbox"/>	<input type="checkbox"/>	<input type="checkbox"/>
Sample container(s) intact and good condition.....	<input checked="" type="checkbox"/>	<input type="checkbox"/>	<input type="checkbox"/>
Correct containers and volume for analyses requested.....	<input checked="" type="checkbox"/>	<input type="checkbox"/>	<input type="checkbox"/>
Analyses received within holding time.....	<input checked="" type="checkbox"/>	<input type="checkbox"/>	<input type="checkbox"/>
Proper preservation noted on COC or sample container.....	<input checked="" type="checkbox"/>	<input type="checkbox"/>	<input type="checkbox"/>
<input type="checkbox"/> Unpreserved vials received for Volatiles analysis			
Volatile analysis container(s) free of headspace.....	<input checked="" type="checkbox"/>	<input type="checkbox"/>	<input type="checkbox"/>
Tedlar bag(s) free of condensation.....	<input type="checkbox"/>	<input type="checkbox"/>	<input checked="" type="checkbox"/>

**CONTAINER TYPE:**

- Solid:**  4ozCGJ  8ozCGJ  16ozCGJ  Sleeve  EnCores®  TerraCores®  \_\_\_\_\_
- Water:**  VOA  VOAh  VOAna<sub>2</sub>  125AGB  125AGBh  125AGBp  1AGB  1AGBna<sub>2</sub>  1AGBs
- 500AGB  500AGJ  500AGJs  250AGB  250CGB  250CGBs  1PB  500PB  500PBna
- 250PB  250PBn  125PB  125PBz<sub>nna</sub>  100PJ  100PJna<sub>2</sub>  \_\_\_\_\_  \_\_\_\_\_  \_\_\_\_\_

**Air:**  Tedlar®  Summa® **Other:**  \_\_\_\_\_ **Trip Blank Lot#:** \_\_\_\_\_ **Checked by:** [Signature]

**Container:** C: Clear A: Amber P: Plastic G: Glass J: Jar B: Bottle Z: Ziploc/Resealable Bag E: Envelope **Reviewed by:** WJL

**Preservative:** h: HCL n: HNO<sub>3</sub> na<sub>2</sub>:Na<sub>2</sub>S<sub>2</sub>O<sub>3</sub> Na: NaOH p: H<sub>3</sub>PO<sub>4</sub> s: H<sub>2</sub>SO<sub>4</sub> z<sub>nna</sub>: ZnAc<sub>2</sub>+NaOH f: Field-filtered **Scanned by:** [Signature]