

C A M B R I A

November 29, 2000

eva chu
Alameda County Health Care Services Agency
1131 Harbor Bay Parkway, Suite 250
Alameda, California 94502-6577

ENVIRONMENTAL PROTECTION
00 NOV 30 AM 9:27

Re: **Fourth Quarter 2000 Monitoring Report**
Shell-branded Service Station
11989 Dublin Boulevard
Dublin, California
Incident #98995328
Cambria Project #242-0548-002



Dear Ms. chu:

On behalf of Equiva Services LLC, Cambria Environmental Technology, Inc. (Cambria) is submitting this groundwater monitoring report in accordance with the reporting requirements of 23 CCR 2652d.

ENVIRONMENTAL PROTECTION
00 DEC 04 PM 3:20

FOURTH QUARTER 2000 ACTIVITIES

Groundwater Monitoring: Blaine Tech Services, Inc. (Blaine) of San Jose, California gauged and sampled the site wells, calculated groundwater elevations, and compiled the analytical data. Cambria prepared a groundwater elevation contour map (Figure 1). Blaine's report, presenting the laboratory report and supporting field documents, is included as Attachment A.

Oxygenate Sampling: On October 4, 2000, Alameda County Health Care Services Agency requested that Equiva confirm oxygenates in water in well MW-2. The requested sampling was performed during the second quarter. **No TBA, DIPE, TAME, or ETBE was detected** in well MW-2. *was BBL's interpretation of chromatogram available?*

Potential Receptor Survey and Conduit Study: Cambria submitted a *Potential Receptor Survey and Conduit Study* on November 8, 2000 which presents the preliminary results of well and conduit research that was performed for the site. Additional conduit information will be submitted in the first quarter 2001 monitoring report.

Oakland, CA
San Ramon, CA
Sonoma, CA

**Cambria
Environmental
Technology, Inc.**

1144 65th Street
Suite B
Oakland, CA 94608
Tel (510) 420-0700
Fax (510) 420-9170

ANTICIPATED FIRST QUARTER 2001 ACTIVITIES

Groundwater Monitoring: Blaine will gauge and sample all wells and tabulate the data. Cambria will prepare a monitoring report.

CLOSING



We appreciate the opportunity to work with you on this project. Please call Barbara Jakub at (510) 420-3309 if you have any questions or comments.

Sincerely,
Cambria Environmental Technology, Inc

Barbara J. Jakub
Project Geologist

Stephan A. Bork, C.E.G., C.HG.
Associate Hydrogeologist

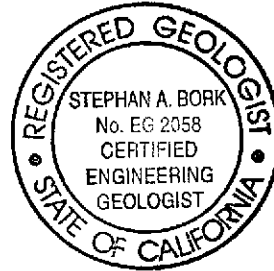

Figure: 1 - Groundwater Elevation Contour Map

Attachment: A - Blaine Groundwater Monitoring Report and Field Notes

cc: Karen Petryna, Equiva Services LLC, P.O. Box 7869, Burbank, California 91510-7869

g:\dublin 11989\dublin\qgm\4q00qm.doc

DUBLIN BOULEVARD

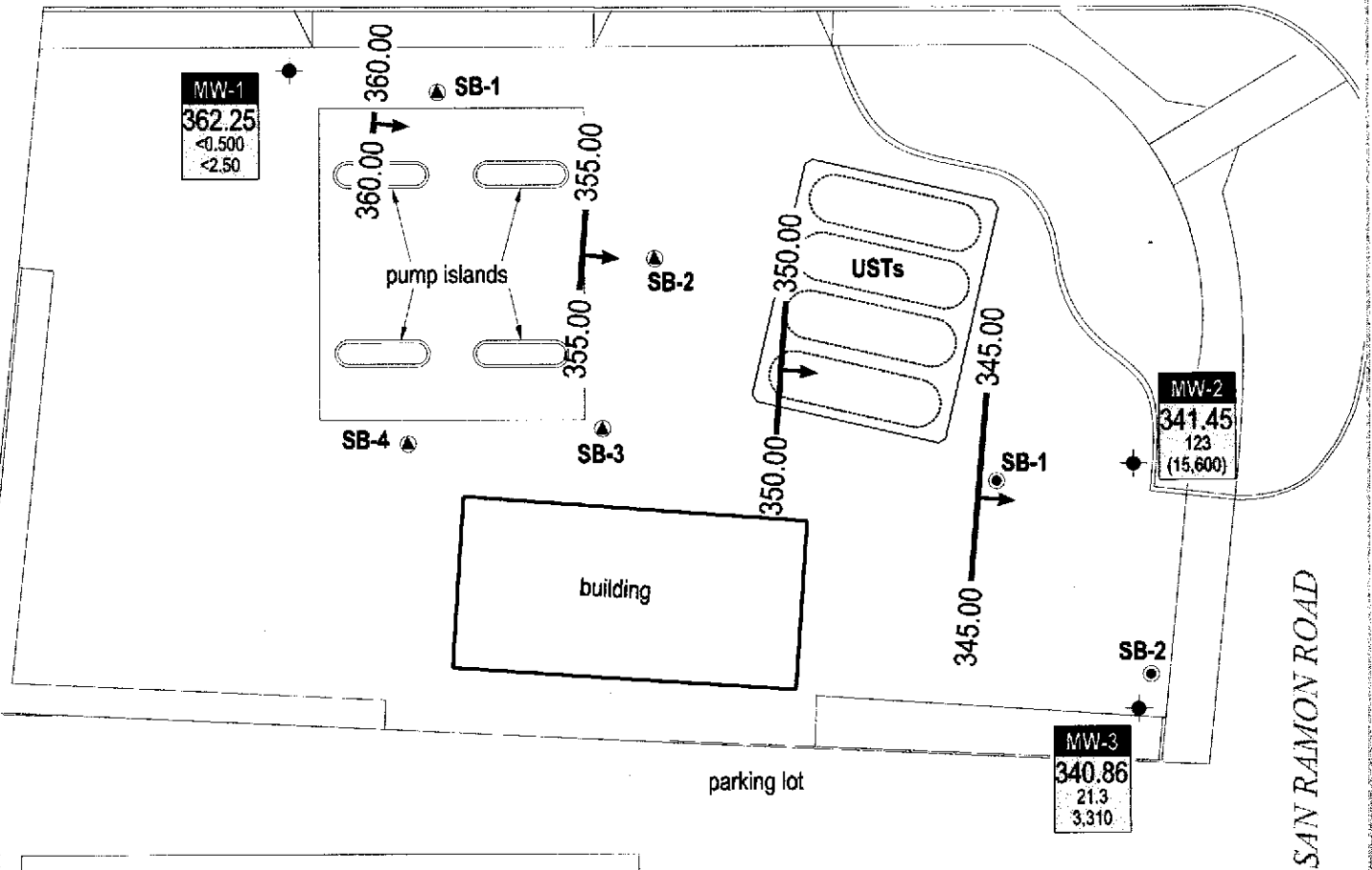

EXPLANATION

- MW-1 ● Monitoring well location
- SB-1 ▲ Soil boring locations for November 16, 1997 investigation
- SB-1 ● Soil boring locations for August 5, 1998 investigation
- Groundwater flow direction
- XX.XX Groundwater elevation contour, in feet above mean sea level (msl), approximately located

Well	Well designation
ELEV	Groundwater elevation, in feet above msl
Benzene	Benzene and MTBE concentrations are in parts per billion and are analyzed by EPA Method 8020; MTBE results in parentheses are analyzed by EPA Method 8260.
MTBE	

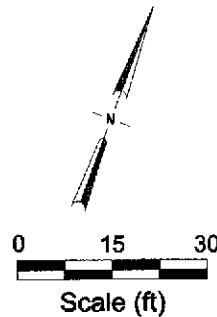

FIGURE 1

G:\DUBLIN11989\SUB\IN\FIGURES\G1000.MP.DWG

Shell-branded Service Station

11989 Dublin Boulevard
 Dublin, California
 Incident #98995328



C A M B R I A

Groundwater Elevation Contour Map

October 16, 2000

ATTACHMENT A
Blaine Groundwater Monitoring Report
and Field Notes

BLAINE
TECH SERVICES, INC.



1680 ROGERS AVENUE
SAN JOSE, CA 95112-1105
(408) 573-7771 FAX
(408) 573-0555 PHONE
CONTRACTOR'S LICENSE #746684
www.blainetech.com

November 13, 2000

Karen Petryna
Equiva Services LLC
P.O. Box 7869
Burbank, CA 91510-7869

Fourth Quarter 2000 Groundwater Monitoring at
Shell-branded Service Station
11989 Dublin Boulevard
Dublin, CA

Monitoring performed on October 16, 2000

Groundwater Monitoring Report **001016-R-1**

This report covers the routine monitoring of groundwater wells at this Shell-branded facility. In accordance with standard procedures that conform to Regional Water Quality Control Board requirements, routine field data collection includes depth to water, total well depth, thickness of any separate immiscible layer, water column volume, calculated purge volume (if applicable), elapsed evacuation time (if applicable), total volume of water removed (if applicable), and standard water parameter instrument readings. Sample material is collected, contained, stored, and transported to the laboratory in conformance with EPA standards. Purgewater (if applicable) is, likewise, collected and transported to the Martinez Refining Company.

Basic field information is presented alongside analytical values excerpted from the laboratory report in the cumulative table of **WELL CONCENTRATIONS**. The full analytical report for the most recent samples and the field data sheets are attached to this report.

At a minimum, Blaine Tech Services, Inc. field personnel are certified on completion of a forty hour Hazardous Materials and Emergency Response training course per 29 CFR 1910.120. Field personnel are also enrolled in annual eight hour refresher courses.

Blaine Tech Services, Inc. conducts sampling and documentation assignments of this type as an independent Fourth party. In order to avoid compromising the objectivity necessary for the proper and disinterested performance of this work, Blaine Tech Services, Inc. concentrates on objective data collection and does not participate in the interpretation of analytical results, the definition of geological or hydrological conditions, the formulation of recommendations, or the marketing of remedial systems.

Please call if you have any questions.

Yours truly,

A handwritten signature in black ink, appearing to read "Deidre Kerwin", with a long horizontal flourish extending to the right.

Deidre Kerwin
Operations Manager

DK/jt

attachments: Cumulative Table of WELL CONCENTRATIONS
Certified Analytical Report
Field Data Sheets

cc: Anni Kreml
Cambria Environmental Technology, Inc.
1144 65th Street
Oakland, CA 94608-2411

WELL CONCENTRATIONS
Shell-branded Service Station
11989 Dublin Boulevard
Dublin, CA

Well ID	Date	TPPH (ug/L)	TEPH (ug/L)	B (ug/L)	T (ug/L)	E (ug/L)	X (ug/L)	MTBE 8020 (ug/L)	MTBE 8260 (ug/L)	TOC (MSL)	Depth to Water (ft.)	GW Elevation (MSL)	D.O. Reading (ppm)
---------	------	----------------	----------------	-------------	-------------	-------------	-------------	------------------------	------------------------	--------------	----------------------------	--------------------------	--------------------------

MW-1	07/20/1999	<50.0	<50.0	<0.500	<0.500	<0.500	<0.500	<5.00	NA	367.99	6.24	361.75	NA
MW-1	10/25/1999	<50.0	<50.0	<0.500	<0.500	<0.500	<0.500	<5.00	NA	367.99	6.36	361.63	NA
MW-1	01/27/2000	<50.0	<50.0	<0.500	<0.500	<0.500	<0.500	<2.50	NA	367.99	5.65	362.34	NA
MW-1	04/03/2000	<50.0	<50.0	<0.500	<0.500	<0.500	<0.500	<2.50	NA	367.99	5.68	362.31	1.2/1.6
MW-1	07/27/2000	<50.0	NA	<0.500	<0.500	<0.500	<0.500	<2.50	NA	367.99	5.69	362.30	1.0/1.1
MW-1	10/16/2000	<50.0	NA	<0.500	<0.500	<0.500	<0.500	<2.50	NA	367.99	5.74	362.25	1.2/0.8

MW-2	07/20/1999	2,600	699	55.0	<2.50	59.5	<2.50	9,370	NA	365.43	20.31	345.12	NA
MW-2	10/25/1999	4,710	761	61.1	<10.0	74.6	<10.0	22,800	NA	365.43	22.80	342.63	NA
MW-2	01/27/2000	3,820	1490	60.8	<10.0	156	<10.0	13,400	15,000a	365.43	19.17	346.26	NA
MW-2	04/03/2000	7,130	NA	184	14.9	238	18.8	34,200	28,000	365.43	19.03	346.40	1.6/1.7
MW-2	07/27/2000	311	NA	10.0	<0.500	<0.500	<0.500	280	NA	365.43	19.09	346.34	1.9/1.7
MW-2	10/16/2000	3,970	NA	123	<5.00	68.5	<5.00	14,000	15,600	365.43	23.98	341.45	0.5/0.5

MW-3	07/20/1999	208	177	4.69	<0.500	<0.500	<0.500	664	NA	364.97	24.23	340.74	NA
MW-3	10/25/1999	378	182	9.49	<0.500	<0.500	<0.500	1,410	NA	364.97	23.26	341.71	NA
MW-3	01/27/2000	428	100	29.4	<0.500	<0.500	<0.500	941	NA	364.97	19.53	345.44	NA
MW-3	04/03/2000	<125	NA	11.4	<1.25	<1.25	<1.25	639	NA	364.97	19.13	345.84	1.4/1.9
MW-3	07/27/2000	4,360	NA	78.4	6.95	85.8	2.61	26,600	25,200b	364.97	19.10	345.87	1.9/2.0
MW-3	10/16/2000	586	NA	21.3	<0.500	<0.500	<0.500	3,310	NA	364.97	24.11	340.86	1.1/0.8

probably switched

WELL CONCENTRATIONS
Shell-branded Service Station
11989 Dublin Boulevard
Dublin, CA

Well ID	Date	TPPH (ug/L)	TEPH (ug/L)	B (ug/L)	T (ug/L)	E (ug/L)	X (ug/L)	MTBE 8020 (ug/L)	MTBE 8260 (ug/L)	TOC (MSL)	Depth to Water (ft.)	GW Elevation (MSL)	D.O. Reading (ppm)
---------	------	----------------	----------------	-------------	-------------	-------------	-------------	------------------------	------------------------	--------------	----------------------------	--------------------------	--------------------------

Abbreviations:

TPPH = Total petroleum hydrocarbons as gasoline by modified EPA Method 8015

TEPH = Total petroleum hydrocarbons as diesel by modified EPA Method 8015

BTEX = benzene, toluene, ethylbenzene, xylenes by EPA Method 8020

MTBE = methyl-tertiary-butyl ether by EPA Method 8020

TOC = Top of Casing Elevation

GW = Groundwater

DO = Dissolved Oxygen

ug/L = parts per billion

ppm = parts per million

msl = Mean sea level

ft = Feet

<n = Below detection limit

n/n = Pre-purge/Post-purge DO Readings

NA = Not applicable

Notes:

Wells surveyed June 21, 1999 by Virgil Chavez Land Surveying of Vallejo, California.

a = Sample was analyzed outside the EPA recommended holding time.

b = Concentration is an estimate.



Sequoia Analytical

885 Jarvis Drive
Morgan Hill, CA 95037
(408) 776-9600
FAX (408) 782-6308
www.sequoialabs.com

2 November, 2000

Nick Sudano
Blaine Tech Services (Shell)
1680 Rogers Avenue
San Jose, CA 95112

RE: 11989 Dublin Blvd.
Sequoia Report: MJJ0495

Enclosed are the results of analyses for samples received by the laboratory on 10/17/00 13:20. If you have any questions concerning this report, please feel free to contact me.

Sincerely,

Wayne Stevenson
Client Services Manager

CA ELAP Certificate #1210





Blaine Tech Services (Shell)
1680 Rogers Avenue
San Jose CA, 95112

Project: 11989 Dublin Blvd.
Project Number: 11989 Dublin Blvd./ Dublin
Project Manager: Nick Sudano

Reported:
11/02/00 12:40

ANALYTICAL REPORT FOR SAMPLES

Sample ID	Laboratory ID	Matrix	Date Sampled	Date Received
MW-1	MJJ0495-01	Water	10/16/00 09:01	10/17/00 13:20
MW-2	MJJ0495-02	Water	10/16/00 09:21	10/17/00 13:20
MW-3	MJJ0495-03	Water	10/16/00 09:41	10/17/00 13:20

Sequoia Analytical - Morgan Hill

The results in this report apply to the samples analyzed in accordance with the chain of custody document. This analytical report must be reproduced in its entirety.

Wayne Stevenson, Client Services Manager





Blaine Tech Services (Shell)
1680 Rogers Avenue
San Jose CA, 95112

Project: 11989 Dublin Blvd.
Project Number: 11989 Dublin Blvd./ Dublin
Project Manager: Nick Sudano

Reported:
11/02/00 12:40

Total Purgeable Hydrocarbons (C6-C12), BTEX and MTBE by DHS LUFT Sequoia Analytical - Morgan Hill

Analyte	Result	Reporting Limit	Units	Dilution	Batch	Prepared	Analyzed	Method	Notes
MW-1 (MJJ0495-01) Water Sampled: 10/16/00 09:01 Received: 10/17/00 13:20									
Purgeable Hydrocarbons	ND	50.0	ug/l	1	0J25004	10/25/00	10/25/00	DHS LUFT	
Benzene	ND	0.500	"	"	"	"	"	"	
Toluene	ND	0.500	"	"	"	"	"	"	
Ethylbenzene	ND	0.500	"	"	"	"	"	"	
Xylenes (total)	ND	0.500	"	"	"	"	"	"	
Methyl tert-butyl ether	ND	2.50	"	"	"	"	"	"	
<i>Surrogate: a,a,a-Trifluorotoluene</i>		95.9 %	70-130	"	"	"	"	"	
MW-2 (MJJ0495-02) Water Sampled: 10/16/00 09:21 Received: 10/17/00 13:20									
Purgeable Hydrocarbons	3970	500	ug/l	10	0J25004	10/25/00	10/25/00	DHS LUFT	P-01
Benzene	123	5.00	"	"	"	"	"	"	
Toluene	ND	5.00	"	"	"	"	"	"	
Ethylbenzene	68.5	5.00	"	"	"	"	"	"	
Xylenes (total)	ND	5.00	"	"	"	"	"	"	
Methyl tert-butyl ether	14000	500	"	200	"	"	10/30/00	"	M-03
<i>Surrogate: a,a,a-Trifluorotoluene</i>		90.3 %	70-130	"	"	"	10/25/00	"	
MW-3 (MJJ0495-03) Water Sampled: 10/16/00 09:41 Received: 10/17/00 13:20									
Purgeable Hydrocarbons	586	50.0	ug/l	1	0J25004	10/25/00	10/25/00	DHS LUFT	P-03
Benzene	21.3	0.500	"	"	"	"	"	"	
Toluene	ND	0.500	"	"	"	"	"	"	
Ethylbenzene	ND	0.500	"	"	"	"	"	"	
Xylenes (total)	ND	0.500	"	"	"	"	"	"	
Methyl tert-butyl ether	3310	250	"	100	"	"	10/30/00	"	M-03
<i>Surrogate: a,a,a-Trifluorotoluene</i>		98.5 %	70-130	"	"	"	10/25/00	"	





Blaine Tech Services (Shell) 1680 Rogers Avenue San Jose CA, 95112	Project: 11989 Dublin Blvd. Project Number: 11989 Dublin Blvd./ Dublin Project Manager: Nick Sudano	Reported: 11/02/00 12:40
--	---	------------------------------------

**MTBE Confirmation by EPA Method 8260A
Sequoia Analytical - Morgan Hill**

Analyte	Result	Reporting Limit	Units	Dilution	Batch	Prepared	Analyzed	Method	Notes
MW-2 (MJJ0495-02) Water Sampled: 10/16/00 09:21 Received: 10/17/00 13:20									
Methyl tert-butyl ether	15600	1000	ug/l	1000	0J26012	10/26/00	10/26/00	EPA 8260A	
Surrogate: 1,2-Dichloroethane-d4		102 %	70-130		"	"	"	"	





Blaine Tech Services (Shell)
1680 Rogers Avenue
San Jose CA, 95112

Project: 11989 Dublin Blvd.
Project Number: 11989 Dublin Blvd./ Dublin
Project Manager: Nick Sudano

Reported:
11/02/00 12:40

Total Purgeable Hydrocarbons (C6-C12), BTEX and MTBE by DHS LUFT - Quality Control Sequoia Analytical - Morgan Hill

Analyte	Result	Reporting Limit	Units	Spike Level	Source Result	%REC	%REC Limits	RPD	RPD Limit	Notes
---------	--------	-----------------	-------	-------------	---------------	------	-------------	-----	-----------	-------

Batch 0J25004 - EPA 5030B [P/T]

Blank (0J25004-BLK1)

Prepared & Analyzed: 10/25/00

Purgeable Hydrocarbons	ND	50.0	ug/l							
Benzene	ND	0.500	"							
Toluene	ND	0.500	"							
Ethylbenzene	ND	0.500	"							
Xylenes (total)	ND	0.500	"							
Methyl tert-butyl ether	ND	2.50	"							
<i>Surrogate: a,a,a-Trifluorotoluene</i>	9.38		"	10.0		93.8	70-130			

LCS (0J25004-BS1)

Prepared & Analyzed: 10/25/00

Purgeable Hydrocarbons	241	50.0	ug/l	250		96.4	70-130			
<i>Surrogate: a,a,a-Trifluorotoluene</i>	8.62		"	10.0		86.2	70-130			

Matrix Spike (0J25004-MS1)

Source: MJJ0494-02

Prepared & Analyzed: 10/25/00

Purgeable Hydrocarbons	233	50.0	ug/l	250	ND	93.2	60-140			
<i>Surrogate: a,a,a-Trifluorotoluene</i>	8.08		"	10.0		80.8	70-130			

Matrix Spike Dup (0J25004-MSD1)

Source: MJJ0494-02

Prepared & Analyzed: 10/25/00

Purgeable Hydrocarbons	233	50.0	ug/l	250	ND	93.2	60-140	0	25	
<i>Surrogate: a,a,a-Trifluorotoluene</i>	8.14		"	10.0		81.4	70-130			





Blaine Tech Services (Shell)
1680 Rogers Avenue
San Jose CA, 95112

Project: 11989 Dublin Blvd.
Project Number: 11989 Dublin Blvd./ Dublin
Project Manager: Nick Sudano

Reported:
11/02/00 12:40

**MTBE Confirmation by EPA Method 8260A - Quality Control
Sequoia Analytical - Morgan Hill**

Analyte	Result	Reporting Limit	Units	Spike Level	Source Result	%REC	%REC Limits	RPD	RPD Limit	Notes
Batch 0J26012 - EPA 5030B [P/T]										
Blank (0J26012-BLK1) Prepared & Analyzed: 10/26/00										
Methyl tert-butyl ether	ND	1.00	ug/l							
<i>Surrogate: 1,2-Dichloroethane-d4</i>	9.02		"	10.0		90.2	70-130			
LCS (0J26012-BS1) Prepared & Analyzed: 10/26/00										
Methyl tert-butyl ether	9.29	1.00	ug/l	10.0		92.9	70-130			
<i>Surrogate: 1,2-Dichloroethane-d4</i>	8.80		"	10.0		88.0	70-130			
Matrix Spike (0J26012-MS1) Source: MJJ0451-02 Prepared & Analyzed: 10/26/00										
Methyl tert-butyl ether	1160	50.0	ug/l	500	701	91.8	70-130			
<i>Surrogate: 1,2-Dichloroethane-d4</i>	9.45		"	10.0		94.5	70-130			
Matrix Spike Dup (0J26012-MSD1) Source: MJJ0451-02 Prepared & Analyzed: 10/26/00										
Methyl tert-butyl ether	1080	50.0	ug/l	500	701	75.8	70-130	7.14	25	
<i>Surrogate: 1,2-Dichloroethane-d4</i>	9.40		"	10.0		94.0	70-130			





Blaine Tech Services (Shell)
1680 Rogers Avenue
San Jose CA, 95112

Project: 11989 Dublin Blvd.
Project Number: 11989 Dublin Blvd./ Dublin
Project Manager: Nick Sudano

Reported:
11/02/00 12:40

Notes and Definitions

M-03 Sample was analyzed at a second dilution per clients request.
P-01 Chromatogram Pattern: Gasoline C6-C12
P-03 Chromatogram Pattern: Unidentified Hydrocarbons C6-C12
DET Analyte DETECTED
ND Analyte NOT DETECTED at or above the reporting limit
NR Not Reported
dry Sample results reported on a dry weight basis
RPD Relative Percent Difference



BLAINE

TECH SERVICES, INC.

1680 ROGERS AVENUE
SAN JOSE, CALIFORNIA 95112-1105
FAX (408) 573-7771
PHONE (408) 573-0555

10/1

LAB Sequoia DHS # _____

ALL ANALYSIS MUST MEET SPECIFICATIONS AND DETECTION LIMITS SET BY CALIFORNIA DHS AND

- EPA RWQCB REGION _____
 LIA
 OTHER 98995328

CHAIN OF 001016 R1
 CLIENT Equiva - Karen Petryna
 SITE 11989 Dublin Blvd.
Dublin, CA

C = COMPOSITE ALL CONTAINERS

CONDUCT ANALYSIS TO DETECT									
TPH - gas, BTEX	MTBE by 8020	MTBE by 8260	TPH - diesel	Oxygenates by 8260					
X	X								
X	X								
X	X								

SPECIAL INSTRUCTIONS
 Send invoice to Equiva MJJ0495
 Incident # 98995328
 Sent report to Blaine Tech Services, Inc.
 ATTN: Ann Pember

SAMPLE I.D.	DATE	TIME	MATRIX		CONTAINERS	C = COMPOSITE ALL CONTAINERS	TPH - gas, BTEX	MTBE by 8020	MTBE by 8260	TPH - diesel	Oxygenates by 8260					ADD'L INFORMATION	STATUS	CONDITION	LAB SAMPLE #	
			% SOIL	W=H ₂ O																
MW 1	10/16/00	901	W	Z	HCLVH		X	X												01
MW 2	J	921	J	J			X	X								Confirm the lighter				02
MW 3	J	941	J	J			X	X								detected MTBE by 8260				03

SAMPLING COMPLETED 10/16/00 DATE 10/16/00 TIME 1000 SAMPLING PERFORMED BY Jared RESULTS NEEDED NO LATER THAN Standard

RELEASED BY <u>Jared</u>	DATE <u>10/17/00</u>	TIME <u>12:25</u>	RECEIVED BY <u>[Signature]</u>	DATE <u>10/17/00</u>	TIME <u>1225</u>
RELEASED BY <u>[Signature]</u>	DATE <u>10/17/00</u>	TIME	RECEIVED BY <u>[Signature]</u>	DATE <u>10/17/00</u>	TIME <u>1320</u>
RELEASED BY	DATE	TIME	RECEIVED BY	DATE	TIME

SHIPPED VIA _____ DATE SENT _____ TIME SENT _____ COOLER # _____

WELL GAUGING DATA

Project # 001016 R1 Date 10/16/00 Client Egiva

Site 11989 Dublin Blvd. Dublin

Well ID	Well Size (in.)	Sheen / Odor	Depth to Immiscible Liquid (ft.)	Thickness of Immiscible Liquid (ft.)	Volume of Immiscibles Removed (ml)	Depth to water (ft.)	Depth to well bottom (ft.)	Survey Point: TOB or TOO
1 MW1	4					5.74	19.65	↓
2 MW2	4					23.98	32.28	↓
3 MW3	4					24.11	32.38	↓

eva chu
Alameda County Health Care Services Agency
1131 Harbor Bay Parkway, Suite 250
Alameda, California 94502-6577

TBA at 1640 ug/l

Re: **First Quarter 2001 Monitoring Report**
Shell-branded Service Station
11989 Dublin Boulevard
Dublin, California
Incident #98995328
Cambria Project #243-0548-002



Dear Ms. chu:

On behalf of Equiva Services LLC, Cambria Environmental Technology, Inc. (Cambria) is submitting this groundwater monitoring report in accordance with the reporting requirements of 23 CCR 2652d.

FIRST QUARTER 2001 ACTIVITIES

Groundwater Monitoring: Blaine Tech Services, Inc. (Blaine) of San Jose, California gauged and sampled the site wells, calculated groundwater elevations, and compiled the analytical data. Cambria prepared a groundwater elevation contour map (Figure 1). Blaine's report, presenting the laboratory report and supporting field documents, is included as Attachment A.

Oxygenate Sampling: On October 4, 2000, Alameda County Health Care Services Agency requested that Equiva confirm oxygenates in water in well MW-2. The requested sampling was performed in the first quarter 2001. Methyl tert-butyl ether and tert-butyl alcohol were detected at concentrations of 7,810 parts per billion (ppb) and 1,640 ppb. No other oxygenates were detected in well MW-2.

Oakland, CA
San Ramon, CA
Sonoma, CA
Portland, OR

ANTICIPATED SECOND QUARTER 2001 ACTIVITIES

**Cambria
Environmental
Technology, Inc.**

Groundwater Monitoring: Blaine will gauge and sample all wells and tabulate the data. Cambria will prepare a monitoring report.

1144 65th Street
Suite B
Oakland, CA 94608
Tel (510) 420-0700
Fax (510) 420-9170

C A M B R I A

eva chu
March 13, 2001

CLOSING

We appreciate the opportunity to work with you on this project. Please call Barbara Jakub at (510) 420-3309 if you have any questions or comments.

Sincerely,
Cambria Environmental Technology, Inc



Barbara J. Jakub
Project Geologist

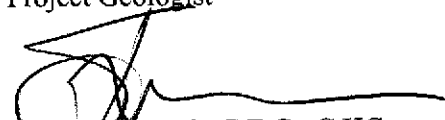

Stephan A. Bork, C.E.G., C.H.G.
Associate Hydrogeologist

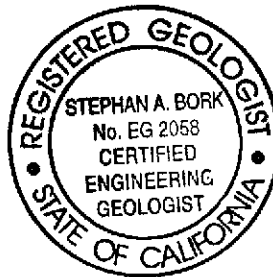

Figure: 1 - Groundwater Elevation Contour Map

Attachment: A - Blaine Groundwater Monitoring Report and Field Notes

cc: Karen Petryna, Equiva Services LLC, P.O. Box 7869, Burbank, California 91510-7869

g:\dublin 11989\dublin\qm\lq01qm.doc

DUBLIN BOULEVARD

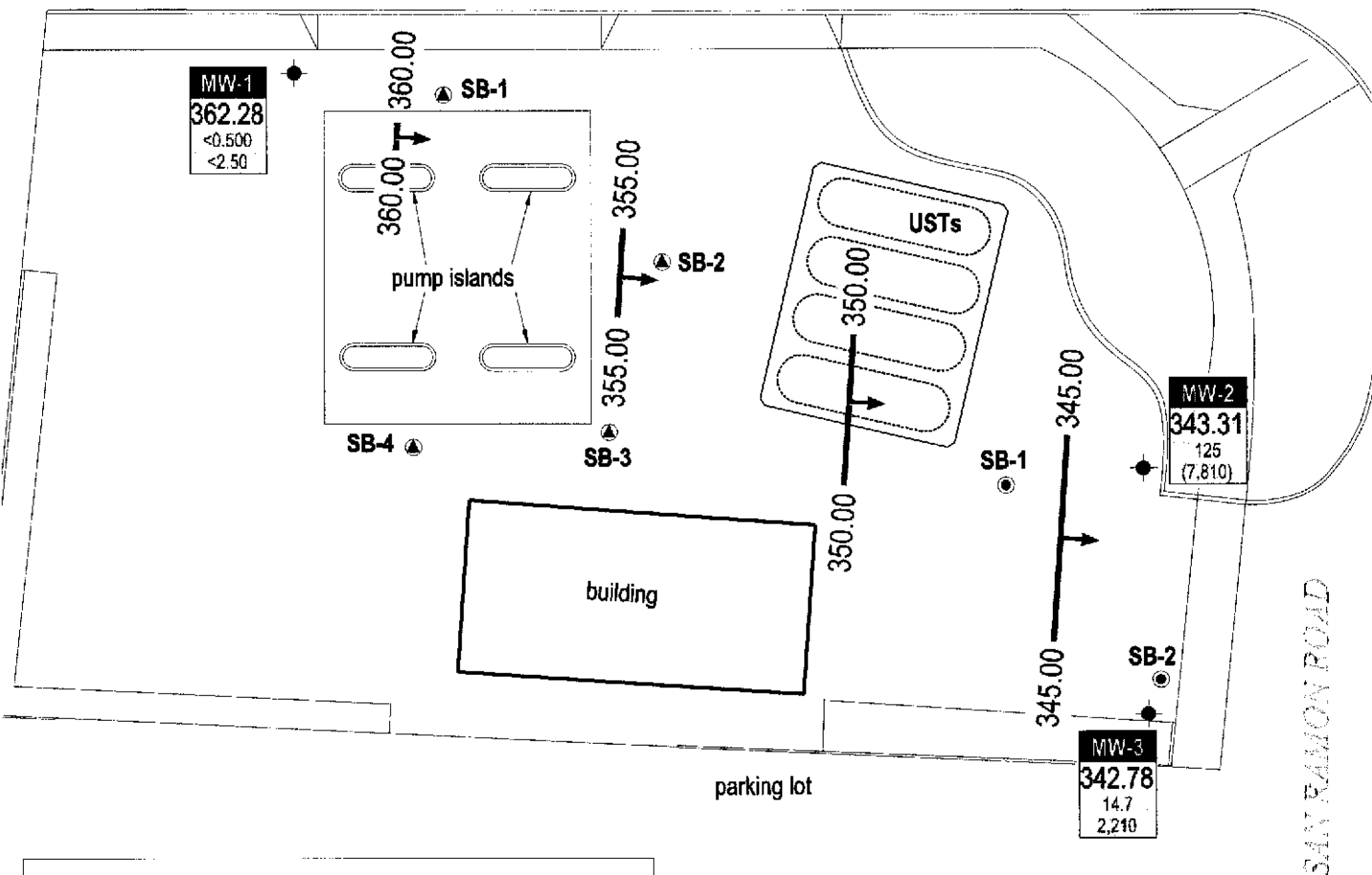

SAN RAMON ROAD

EXPLANATION

- MW-1 ● Monitoring well location
- SB-1 ▲ Soil boring locations for November 16, 1997 investigation
- SB-1 ● Soil boring locations for August 5, 1998 investigation
- Groundwater flow direction
- XX.XX Groundwater elevation contour, in feet above mean sea level (msl), approximately located
- Well Well designation
- ELEV Groundwater elevation, in feet above msl
- Benzene Benzene and MTBE concentrations are in parts per billion and are analyzed by EPA Method 8020; MTBE results in parentheses are analyzed by EPA Method 8260.
- MTBE

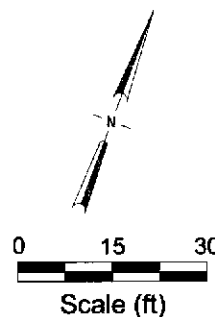

FIGURE 1

G:\DUBLIN\11989DUBLIN\FIGURES\1\QM01-MP.DWG

Shell-branded Service Station

11989 Dublin Boulevard
 Dublin, California
 Incident #98995328



C A M B R I A

Groundwater Elevation Contour Map

January 16, 2001

ATTACHMENT A
Blaine Groundwater Monitoring Report
and Field Notes