



Customer-Focused Solutions

**FOURTH QUARTER 2003
FLUID LEVEL MONITORING AND
GROUNDWATER SAMPLING REPORT**

March 10, 2004

76 STATION 0746
3943 Broadway
Oakland, California

Prepared For:

Mr. Thomas H. Kosel
CONOCOPHILLIPS COMPANY
76 Broadway
Sacramento, California 95818

By:

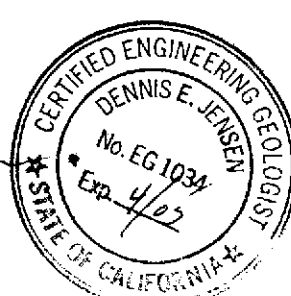
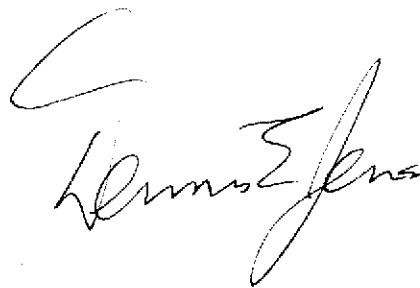

Senior Project Geologist, Irvine Operations

GROUNDWATER MONITORING REPORT

LIST OF ATTACHMENTS	
Summary Sheet	Summary of Gauging and Sampling Activities
Tables	Table Key Table 1: Summary of Groundwater Levels and Chemical Analysis Results Table 2: Historic Groundwater Levels and Chemical Analysis Results Table 3: Summary of Additional Chemical Analysis Results
Figures	Figure 1: Vicinity Map Figure 2: Groundwater Elevation Contour Map Figure 3: Dissolved-Phase Hydrocarbon Concentration Map
Graphs	Benzene Concentrations vs. Time Hydrographs
Field Activities	General Field Procedures Groundwater Sampling Field Notes
Laboratory Reports	Official Laboratory Reports Quality Control Reports Chain of Custody Records
Disposal Documents	Statement of Authorized Transportation and Disposal
Statement	Limitations

**Summary of Gauging and Sampling Activities
 October 2003 through December 2003
 76 Station 0746
 3943 Broadway
 Oakland, CA**

Site Information:

Site:	76 Station 3943 Broadway Oakland, CA
Project Coordinator/Phone Number:	Thomas H. Kosel/916-558-7666
Groundwater wells onsite:	8
Groundwater wells offsite:	5

Field Activity:

Sampling consultant:	TRC
Date(s) sampled:	11/4/03
Groundwater wells gauged:	11
Groundwater wells sampled:	10
Purging method:	diaphragm pump
Treatment/disposal method during sampling event:	Onyx/Rodeo Unit 100
Free product pumpouts other than sampling event:	No
Treatment/Disposal method during free product pumpouts:	N/A

Site Hydrogeology:

Minimum depth to groundwater (feet bgs):	7.8
Maximum depth to groundwater (feet bgs):	12.82
Average groundwater elevation (feet relative to mean sea level):	70.79
Average change in groundwater elevations since previous event (feet):	-1.49
Groundwater gradient and flow direction:	0.025 ft/ft, Southwest

Groundwater Condition (Benzene Maximum Contaminant Level [MCL] = 1.0 µg/l)

Wells with benzene concentrations below MCL:	9
Wells with benzene concentrations at or above MCL:	1
Minimum benzene concentration (µg/l):	ND
Maximum benzene concentration (µg/l):	11 (RW-1)
Minimum MTBE concentration (µg/l):	ND
Maximum MTBE concentration (µg/l):	530
Minimum TPPH concentration (µg/l):	ND
Maximum TPPH concentration (µg/l):	13000 (MW-3)
Groundwater wells with free product:	1
Minimum free product thickness (feet):	0
Maximum free product thickness (feet):	0.25

Additional Information:

MW-2=Inaccessible, MW-9=Inaccessible,

This report presents the results of groundwater monitoring and sampling activities performed by TRC. Please contact the primary consultant for other specific information on this site.

TABLES

TABLE KEY

ABBREVIATIONS / SYMBOLS

LPH	=	liquid-phase hydrocarbons
µg/l	=	micrograms per liter
mg/l	=	milligrams per liter
ND	=	not detected at or above laboratory detection limit
DTSC	=	Department of Toxic Substances Control
N/A	=	not applicable
Trace	=	less than 0.01 foot of LPH in well
USTs	=	underground storage tanks
--	=	not analyzed, measured, or collected
TPH-G	=	total petroleum hydrocarbons with gasoline distinction
BTEX	=	benzene, toluene, ethylbenzene, and total xylenes
TPH-D	=	total petroleum hydrocarbons with diesel distinction
TRPH	=	total recoverable petroleum hydrocarbons
MTBE	=	methyl tertiary butyl ether
TAME	=	tertiary amyl methyl ether
ETBE	=	ethyl tertiary butyl ether
DIPE	=	di-isopropyl ether
TBA	=	tertiary butyl alcohol
1,1-DCA	=	1,1-Dichloroethane
1,2-DCA	=	1,2-Dichloroethane
1,1-DCE	=	1,1-Dichloroethene
1,2-DCE	=	cis- and trans-1,2-Dichloroethene
PCE	=	tetrachloroethene
TCA	=	trichloroethane
TCE	=	trichloroethene
PCB	=	polychlorinated biphenyls
TPPH	=	total purgeable petroleum hydrocarbons

NOTES

Elevations are in feet above mean sea level.

Groundwater elevation for wells with LPH is calculated as follows:

$$\text{Surface elevation} - \text{depth to water} + (0.75 \times \text{LPH thickness}).$$

Concentration Graphs have been modified to plot non-detect results at the reporting limit stated in the official laboratory report. All non-detect results prior to the Second Quarter 2000 were plotted at 0.1 µg/l for graphical display.

J = estimated concentration, value is between the Method Detection Limit (MDL) and the Practical Quantitation Limit (PQL)

REFERENCE

TRC began groundwater monitoring and sampling activities in October 2003. Historical data for 76 Station 0746 was provided by Gettler-Ryan Inc., Dublin, California, in an excel table received in September 2003.

Table 1
SUMMARY OF GROUNDWATER LEVELS AND CHEMICAL ANALYSIS RESULTS
November 4, 2003
76 Station 0746

Date Sampled	TOC Elevation (feet)	Depth to Water (feet)	LPH Thickness (feet)	Ground-water Elevation (feet)	Change in Elevation (feet)	TPH-G (µg/l)	TPPH 8260B (µg/l)	Benzene (µg/l)	Toluene (µg/l)	Ethyl-benzene (µg/l)	Total Xylenes (µg/l)	MTBE 8021B (µg/l)	MTBE 8260B (µg/l)	Comments
MW-1														
11/4/03	80.54	7.94	0.00	72.60	--	--	120	ND<1.0	ND<1.0	ND<1.0	ND<2.0	--	140	
MW-2														
11/4/03	81.32	--	--	--	--	--	--	--	--	--	--	--	--	Inaccessible
MW-3														
11/4/03	81.41	9.90	0.00	71.51	--	--	13000	ND<20	ND<20	72	56	--	530	
MW-4														
11/4/03	81.48	9.45	0.00	72.03	--	--	61	ND<0.50	ND<0.50	ND<0.50	ND<1.0	--	ND<2.0	
MW-5														
11/4/03	81.38	9.90	0.25	71.67	-1.14	--	--	--	--	--	--	--	--	
MW-6														
11/4/03	79.94	7.80	0.00	72.14	--	--	ND<50	ND<0.50	ND<0.50	ND<0.50	ND<1.0	--	2.4	
MW-7														
11/4/03	81.64	8.76	0.00	72.88	--	--	70	ND<0.50	ND<0.50	ND<0.50	ND<1.0	--	ND<2.0	
MW-8														
11/4/03	81.41	10.20	0.00	71.21	--	--	690	ND<1.0	ND<1.0	3.3	ND<2.0	--	190	
MW-9														
11/4/03	80.53	--	--	--	--	--	--	--	--	--	--	--	--	Inaccessible
MW-10														
11/4/03	81.61	12.82	0.00	68.79	--	--	ND<50	ND<0.50	ND<0.50	ND<0.50	ND<1.0	--	ND<2.0	
MW-11														
11/4/03	78.18	11.23	0.00	66.95	--	--	ND<50	ND<0.50	ND<0.50	ND<0.50	ND<1.0	--	ND<2.0	
MW-12														
11/4/03	79.61	11.34	0.00	68.27	--	--	ND<50	ND<0.50	ND<0.50	ND<0.50	ND<1.0	--	4.4	
RW-1														

Date Sampled	TOC Elevation (feet)	Depth to Water (feet)	LPH Thickness (feet)	Ground- water Elevation (feet)	Change in Elevation (feet)	TPH-G (µg/l)	TPPH 8260B (µg/l)	Benzene (µg/l)	Toluene (µg/l)	Ethyl- benzene (µg/l)	Total Xylenes (µg/l)	MTBE 8021B (µg/l)	MTBE 8260B (µg/l)	Comments
RW-1 continued														
11/4/03	80.63	9.97	0.00	70.66	-1.84	--	2600	11	ND<10	ND<10	ND<20	--	210	

Table 2
HISTORIC GROUNDWATER LEVELS AND CHEMICAL ANALYSIS RESULTS
November 1989 Through November 2003

76 Station 0746

Date Sampled	TOC Elevation (feet)	Depth to Water (feet)	LPH Thickness (feet)	Ground-water Elevation (feet)	Change in Elevation (feet)	TPH-G (µg/l)	TPPH 8260B (µg/l)	Benzene (µg/l)	Toluene (µg/l)	Ethyl-benzene (µg/l)	Total Xylenes (µg/l)	MTBE 8021B (µg/l)	MTBE 8260B (µg/l)	Comments
MW-1														
2/15/1990	81.07	--	0.00	--	--	170	--	7.9	ND	2.2	2.8	--	--	
8/16/1990	81.07	--	0.00	--	--	ND	--	ND	ND	ND	ND	--	--	
11/7/1990	81.07	--	0.00	--	--	45	--	ND	ND	ND	ND	--	--	
2/25/1991	81.07	--	0.00	--	--	ND	--	ND	ND	ND	ND	--	--	
5/28/1991	81.07	--	0.00	--	--	ND	--	ND	ND	ND	ND	--	--	
8/28/1991	81.07	--	0.00	--	--	ND	--	ND	ND	ND	ND	--	--	
11/19/1991	81.07	--	0.00	--	--	ND	--	ND	ND	ND	ND	--	--	
2/6/1992	81.07	--	0.00	--	--	ND	--	ND	ND	ND	ND	--	--	
5/23/1992	81.07	--	0.00	--	--	ND	--	ND	ND	ND	ND	--	--	
8/26/1992	81.07	--	0.00	--	--	ND	--	ND	ND	ND	ND	--	--	
11/20/1992	81.07	--	0.00	--	--	ND	--	0.75	ND	ND	ND	--	--	
12/21/1992	81.07	8.12	0.00	72.95	--	--	--	--	--	--	--	--	--	
1/30/1993	81.07	7.63	0.00	73.44	--	--	--	--	--	--	--	--	--	
2/24/1993	81.07	7.16	0.00	73.91	--	1100	--	280	4.9	120	140	--	--	
3/22/1993	81.07	6.26	0.00	74.81	--	--	--	--	--	--	--	--	--	
4/28/1993	81.07	7.91	0.00	73.16	--	--	--	--	--	--	--	--	--	
5/25/1993	81.07	7.87	0.00	73.20	--	260	--	27	4.9	2.6	54	--	--	
6/23/1993	80.54	7.66	0.00	72.88	--	--	--	--	--	--	--	--	--	
7/22/1993	80.54	7.87	0.00	72.67	--	--	--	--	--	--	--	--	--	
8/25/1993	80.54	8.00	0.00	72.54	--	ND	--	ND	ND	ND	ND	--	--	
9/22/1993	80.54	8.10	0.00	72.44	--	--	--	--	--	--	--	--	--	
10/28/1993	80.54	8.15	0.00	72.39	--	--	--	--	--	--	--	--	--	
11/30/1993	80.54	7.65	0.00	72.89	--	--	--	--	--	--	--	--	--	
2/16/1994	80.54	7.46	0.00	73.08	--	ND	--	0.84	ND	ND	0.59	--	--	
5/31/1994	80.54	7.80	0.00	72.74	-0.34	--	--	--	--	--	--	--	--	

Date Sampled	TOC Elevation (feet)	Depth to Water (feet)	LPH Thickness (feet)	Ground-water Elevation (feet)	Change in Elevation (feet)	TPH-G (µg/l)	TPPH 8260B (µg/l)	Benzene (µg/l)	Toluene (µg/l)	Ethylbenzene (µg/l)	Total Xylenes (µg/l)	MTBE 8021B (µg/l)	MTBE 8260B (µg/l)	Comments
MW-1 continued														
8/31/1994	80.54	8.27	0.00	72.27	-0.47	ND	--	ND	0.98	ND	0.84	--	--	
9/27/1994	80.54	8.37	0.00	72.17	--	--	--	--	--	--	--	--	--	
10/11/1994	80.54	8.36	0.00	72.18	0.01	--	--	--	--	--	--	--	--	
11/10/1994	80.54	6.43	0.00	74.11	1.93	--	--	--	--	--	--	--	--	
2/7/1995	80.54	7.06	0.00	73.48	-0.63	6100	--	670	ND	120	60	--	--	
5/3/1995	80.54	6.85	0.00	73.69	--	260	--	21	39	17	24	--	--	
8/3/1995	80.54	7.69	0.00	72.85	-0.84	--	--	--	--	--	--	--	--	
11/7/1995	80.54	8.15	0.00	72.39	--	ND	--	ND	ND	ND	ND	--	--	
5/6/1996	80.54	7.40	0.00	73.14	0.75	170	--	1	20	2.3	17	--	55	
11/5/1996	80.54	7.90	0.00	72.64	-0.50	ND	--	ND	ND	ND	ND	--	5.2	
5/15/1997	80.54	7.77	0.00	72.77	0.13	ND	--	ND	ND	ND	ND	--	16	
11/12/1997	80.54	7.48	0.00	73.06	0.29	ND	--	ND	ND	ND	ND	--	11	
5/4/1998	80.54	7.39	0.00	73.15	0.09	ND	--	ND	ND	ND	ND	--	320	
11/11/1998	80.54	7.37	0.00	73.17	0.02	ND	--	ND	ND	ND	ND	--	200	
5/20/1999	80.54	7.41	0.00	73.13	--	ND	--	ND	ND	ND	ND	--	47	
11/15/1999	80.54	7.84	0.00	72.70	--	ND	--	ND	ND	ND	ND	--	7.19	
5/22/2000	80.54	7.53	0.00	73.01	--	ND	--	0.89	ND	ND	ND	--	290	
11/22/2000	80.54	7.35	0.00	73.19	0.18	ND	--	ND	ND	ND	ND	--	142	
5/15/2001	80.54	7.48	0.00	73.06	--	345	--	ND	3.41	2.77	25.2	--	374	
11/23/2001	80.54	7.57	0.00	72.97	--	ND<50	--	ND<0.50	ND<0.50	ND<0.50	ND<0.50	--	350	
5/24/2002	80.54	7.10	0.00	73.44	--	70	--	ND<0.50	ND<0.50	ND<0.50	ND<0.50	--	240	
11/29/2002	80.54	7.96	0.00	72.58	--	ND<250	--	ND<2.5	ND<2.5	ND<2.5	ND<5.0	--	330	
5/15/2003	80.54	7.22	0.00	73.32	--	ND<250	--	ND<2.5	ND<2.5	ND<2.5	ND<5.0	--	210	
11/4/2003	80.54	7.94	0.00	72.60	--	--	120	ND<1.0	ND<1.0	ND<1.0	ND<2.0	--	140	
MW-2														
11/1/1989	81.62	--	0.00	--	--	200	--	ND	ND	3	1.2	--	--	
2/15/1990	81.62	--	0.00	--	--	ND	--	ND	ND	ND	ND	--	--	
8/16/1990	81.62	--	0.00	--	--	ND	--	ND	6.7	ND	ND	--	--	
11/7/1990	81.62	--	0.00	--	--	ND	--	ND	ND	ND	ND	--	--	

Date Sampled	TOC Elevation (feet)	Depth to Water (feet)	LPH Thickness (feet)	Ground-water Elevation (feet)	Change in Elevation (feet)	TPH-G (µg/l)	TPPH 8260B (µg/l)	Benzene (µg/l)	Toluene (µg/l)	Ethyl-benzene (µg/l)	Total Xylenes (µg/l)	MTBE 8021B (µg/l)	MTBE 8260B (µg/l)	Comments
MW-2 continued														
2/25/1991	81.62	--	0.00	--	--	ND	--	0.68	0.42	ND	0.86	--	--	
5/28/1991	81.62	--	0.00	--	--	ND	--	ND	ND	ND	ND	--	--	
8/28/1991	81.62	--	0.00	--	--	ND	--	ND	ND	ND	ND	--	--	
11/19/1991	81.62	--	0.00	--	--	ND	--	ND	ND	ND	ND	--	--	
2/6/1992	81.62	--	0.00	--	--	ND	--	0.36	0.66	ND	0.62	--	--	
5/23/1992	81.62	--	0.00	--	--	ND	--	ND	ND	ND	ND	--	--	
8/26/1992	81.62	--	0.00	--	--	ND	--	ND	ND	ND	ND	--	--	
11/20/1992	81.62	--	0.00	--	--	510	--	ND	ND	ND	ND	--	--	
12/21/1992	81.62	9.14	0.00	72.48	--	--	--	--	--	--	--	--	--	
1/30/1993	81.62	8.99	0.00	72.63	--	--	--	--	--	--	--	--	--	
2/24/1993	81.62	8.03	0.00	73.59	--	11,000J	--	ND	ND	ND	ND	--	--	
3/22/1993	81.62	9.50	0.00	72.12	--	--	--	--	--	--	--	--	--	
4/28/1993	81.62	8.87	0.00	72.75	--	--	--	--	--	--	--	--	--	
5/25/1993	81.62	9.04	0.00	72.58	--	1,300J	--	ND	ND	ND	ND	--	2700	
6/23/1993	81.32	9.17	0.00	72.15	--	--	--	--	--	--	--	--	--	
7/22/1993	81.32	9.42	0.00	71.90	--	--	--	--	--	--	--	--	--	
8/25/1993	81.32	9.53	0.00	71.79	--	190J	--	ND	ND	ND	ND	--	--	
9/22/1993	81.32	9.67	0.00	71.65	--	--	--	--	--	--	--	--	--	
10/28/1993	81.32	9.65	0.00	71.67	--	--	--	--	--	--	--	--	--	
11/30/1993	81.32	9.18	0.00	72.14	--	480J	--	ND	ND	ND	ND	--	--	
2/16/1994	81.32	8.91	0.00	72.41	--	3,200J	--	ND	ND	ND	ND	--	--	
5/31/1994	81.32	9.36	0.00	71.96	-0.45	1,100J	--	ND	ND	ND	ND	--	--	
8/31/1994	81.32	9.85	0.00	71.47	-0.49	310J	--	ND	ND	ND	ND	--	--	
9/27/1994	81.32	9.95	0.00	71.37	--	--	--	--	--	--	--	--	--	
11/10/1994	81.32	7.47	0.00	73.85	--	95J	--	ND	ND	ND	ND	--	--	
2/7/1995	81.32	8.29	0.00	73.03	-0.82	1,600J	--	ND	ND	ND	ND	--	--	
5/3/1995	81.32	8.12	0.00	73.20	--	ND	--	ND	ND	ND	ND	--	--	
8/3/1995	81.32	9.35	0.00	71.97	-1.23	ND	--	ND	ND	ND	ND	--	--	
8/19/1995	81.32	--	0.00	--	--	--	--	--	--	--	--	--	--	

Date Sampled	TOC Elevation (feet)	Depth to Water (feet)	LPH Thickness (feet)	Ground-water Elevation (feet)	Change in Elevation (feet)	TPH-G (µg/l)	TPPH 8260B (µg/l)	Benzene (µg/l)	Toluene (µg/l)	Ethyl-benzene (µg/l)	Total Xylenes (µg/l)	MTBE 8021B (µg/l)	MTBE 8260B (µg/l)	Comments
MW-2 continued														
10/11/1995	81.32	9.95	0.00	71.37	--	--	--	--	--	--	--	--	--	
11/7/1995	81.32	9.65	0.00	71.67	0.30	ND	--	ND	ND	ND	ND	--	160	
5/6/1996	81.32	8.90	0.00	72.42	0.75	--	--	--	--	--	--	--	--	
11/5/1996	81.32	10.98	0.00	70.34	-2.08	--	--	--	--	--	--	--	--	
5/15/1997	81.32	9.13	0.00	72.19	1.85	--	--	--	--	--	--	--	--	
11/12/1997	81.32	9.84	0.00	71.48	-0.71	--	--	--	--	--	--	--	--	
5/4/1998	81.32	9.26	0.00	72.06	0.58	--	--	--	--	--	--	--	--	
11/11/1998	81.32	8.88	0.00	72.44	0.38	--	--	--	--	--	--	--	--	
5/20/1999	81.32	8.68	0.00	72.64	--	--	--	--	--	--	--	--	--	
11/15/1999	81.32	8.91	0.00	72.41	--	--	--	--	--	--	--	--	--	
5/22/2000	81.32	8.61	0.00	72.71	--	--	--	--	--	--	--	--	--	
11/22/2000	81.32	8.64	0.00	72.68	-0.03	--	--	--	--	--	--	--	--	
5/15/2001	81.32	8.73	0.00	72.59	--	--	--	--	--	--	--	--	--	
11/23/2001	81.32	8.61	0.00	72.71	--	--	--	--	--	--	--	--	--	
5/24/2002	81.32	8.03	0.00	73.29	--	--	--	--	--	--	--	--	--	
11/29/2002	81.32	8.79	0.00	72.53	--	--	--	--	--	--	--	--	--	
5/15/2003	81.32	8.21	0.00	73.11	--	--	--	--	--	--	--	--	--	
11/4/2003	81.32	--	--	--	--	--	--	--	--	--	--	--	--	Inaccessible
MW-3														
11/1/1989	82.01	--	0.00	--	--	13000	--	57	48	1.7	120	--	--	
2/15/1990	82.01	--	0.00	--	--	20000	--	1700	2100	750	3100	--	--	
8/16/1990	82.01	--	0.00	--	--	6800	--	600	660	760	160	--	--	
11/7/1990	82.01	--	0.00	--	--	42000	--	1400	5000	1800	7500	--	--	
2/25/1991	82.01	--	0.00	--	--	37000	--	730	2900	1300	7300	--	--	
5/28/1991	82.01	--	0.00	--	--	24000	--	570	1100	810	4200	--	--	
8/28/1991	82.01	--	0.00	--	--	16000	--	650	2200	1100	5400	--	--	
11/19/1991	82.01	--	0.00	--	--	22000	--	250	440	660	3000	--	--	
2/6/1992	82.01	--	0.00	--	--	24000	--	600	1800	1200	5800	--	--	
5/23/1992	82.01	--	0.00	--	--	25000	--	300	130	880	4900	--	--	

Date Sampled	TOC Elevation (feet)	Depth to Water (feet)	LPH Thickness (feet)	Ground-water Elevation (feet)	Change in Elevation (feet)	TPH-G (µg/l)	TPPH 8260B (µg/l)	Benzene (µg/l)	Toluene (µg/l)	Ethyl-benzene (µg/l)	Total Xylenes (µg/l)	MTBE 8021B (µg/l)	MTBE 8260B (µg/l)	Comments
MW-3 continued														
9/24/1994	81.41	10.22	0.00	71.19	-0.14	--	--	--	--	--	--	--	--	
10/11/1994	81.41	10.41	0.01	71.01	--	--	--	--	--	--	--	--	--	
11/10/1994	81.41	7.47	0.00	73.94	2.93	86000	--	3300	3800	1800	8300	--	--	
2/7/1995	81.41	8.05	0.00	73.36	-0.58	45000	--	1400	1300	1500	5600	--	--	
3/14/1995	81.41	7.05	0.00	74.36	1.00	--	--	--	--	--	--	--	--	
5/3/1995	81.41	7.91	0.00	73.50	-0.86	26000	--	740	990	1100	4400	--	--	
8/3/1995	81.41	9.28	0.00	72.13	-1.37	18000	--	59	ND	530	1900	--	--	
8/19/1995	81.41	--	0.00	--	--	--	--	--	--	--	--	--	--	
11/7/1995	81.41	10.79	0.00	70.62	--	17000	--	110	26	400	1500	--	880	
5/6/1996	81.41	9.44	0.00	71.97	1.35	5100	--	48	ND	87	210	--	370	
11/5/1996	81.41	10.64	0.00	70.77	-1.20	35000	--	2200	ND	1200	2800	--	460	
5/15/1997	81.41	9.61	0.00	71.80	1.03	2400	--	110	ND	ND	140	--	100	
11/12/1997	81.41	9.18	0.00	72.23	0.43	29000	--	2000	ND	1800	3000	--	ND	
5/4/1998	81.41	9.50	0.00	71.91	-0.32	8200	--	430	ND	310	320	--	ND	
11/11/1998	81.41	9.25	0.00	72.16	0.25	8700	--	500	ND	330	310	--	ND	
5/20/1999	81.41	8.95	0.00	72.46	--	4300	--	250	ND	ND	86	--	ND	
11/15/1999	81.41	10.35	0.00	71.06	--	6,720	--	326	ND	398	226	--	45.1	
5/22/2000	81.41	9.14	0.00	72.27	--	4,000	--	99	4.5	190	75	--	94	
11/22/2000	81.41	9.33	0.00	72.08	-0.19	6,130	--	93.7	6.71	174	47.8	--	131	
5/15/2001	81.41	9.25	0.00	72.16	--	4,490	--	229	7.09	160	31.6	--	75.5	
11/23/2001	81.41	9.12	0.00	72.29	--	3,500	--	41	ND<5.0	120	8	--	390	
5/24/2002	81.41	8.58	0.00	72.83	--	4,000	--	86	6.0	120	5.8	--	73	
11/29/2002	81.41	9.81	0.00	71.60	--	5,300	--	ND<25	ND<25	65	ND<50	--	340	
5/15/2003	81.41	8.76	0.00	72.65	--	5,600	--	ND<5.0	ND<5.0	81	ND<10	--	440	
11/4/2003	81.41	9.90	0.00	71.51	--	--	13000	ND<20	ND<20	72	56	--	530	
MW-4														
2/15/1990	81.48	--	0.00	--	--	150	--	8	8	10	45	--	--	
8/16/1990	81.48	--	0.00	--	--	3600	--	480	17	230	260	--	--	
11/7/1990	81.48	--	0.00	--	--	180	--	1.5	0.37	6.3	26	--	--	

Date Sampled	TOC Elevation (feet)	Depth to Water (feet)	LPH Thickness (feet)	Ground-water Elevation (feet)	Change in Elevation (feet)	TPH-G (µg/l)	TPPH 8260B (µg/l)	Benzene (µg/l)	Toluene (µg/l)	Ethyl-benzene (µg/l)	Total Xylenes (µg/l)	MTBE 8021B (µg/l)	MTBE 8260B (µg/l)	Comments
MW-4 continued														
2/25/1991	81.48	--	0.00	--	--	22000	--	600	1300	780	2800	--	--	
5/28/1991	81.48	--	0.00	--	--	38	--	ND	ND	ND	1.9	--	--	
8/28/1991	81.48	--	0.00	--	--	2000	--	1500	20	120	300	--	--	
11/19/1991	81.48	--	0.00	--	--	55	--	9.2	4.5	1.4	6.7	--	--	
2/6/1992	81.48	--	0.00	--	--	5700	--	2200	140	57	980	--	--	
5/23/1992	81.48	--	0.00	--	--	ND	--	ND	ND	ND	ND	--	--	
8/26/1992	81.48	--	0.00	--	--	120	--	86	0.52	0.57	1.6	--	--	
11/20/1992	81.48	--	0.00	--	--	ND	--	6.2	ND	1.2	0.52	--	--	
1/30/1993	81.48	8.35	0.00	73.13	--	--	--	--	--	--	--	--	--	
2/24/1993	81.48	8.17	0.00	73.31	--	140	--	12	0.64	9.4	3.7	--	--	
3/22/1993	81.48	8.12	0.00	73.36	--	--	--	--	--	--	--	--	--	
4/28/1993	81.48	9.36	0.00	72.12	--	--	--	--	--	--	--	--	--	
5/25/1993	81.48	8.75	0.00	72.73	--	74	--	10	ND	4.6	1.8	--	--	
6/23/1993	81.29	8.90	0.00	72.39	--	--	--	--	--	--	--	--	--	
7/22/1993	81.29	9.26	0.00	72.03	--	--	--	--	--	--	--	--	--	
8/25/1993	81.29	9.45	0.00	71.84	--	640	--	100	1.1	100	22	--	--	
9/22/1993	81.29	9.63	0.00	71.66	--	--	--	--	--	--	--	--	--	
10/28/1993	81.29	9.62	0.00	71.67	--	--	--	--	--	--	--	--	--	
11/30/1993	81.29	9.40	0.00	71.89	--	200	--	28	ND	17	8.1	--	--	
12/21/1993	81.48	9.10	0.00	72.38	0.49	--	--	--	--	--	--	--	--	
2/16/1994	81.29	9.21	0.00	72.08	-0.30	190	--	11	0.98	21	6.6	--	--	
5/31/1994	81.29	9.11	0.00	72.18	0.10	1100	--	190	ND	100	58	--	--	
8/31/1994	81.29	10.01	0.00	71.28	-0.90	400	--	17	0.94	14	5.2	--	--	
9/27/1994	81.29	10.09	0.00	71.20	--	--	--	--	--	--	--	--	--	
10/11/1994	81.29	11.50	0.00	69.79	-1.41	--	--	--	--	--	--	--	--	
11/10/1994	81.29	9.21	0.00	72.08	2.29	7700	--	1800	280	460	1300	--	--	
2/7/1995	81.29	7.66	0.00	73.63	1.55	540	--	47	ND	17	2.5	--	--	
5/3/1995	81.29	8.29	0.00	73.00	--	160	--	8.3	0.52	1.5	3.7	--	--	
8/3/1995	81.29	8.60	0.00	72.69	-0.31	57	--	2	ND	ND	ND	--	--	

Date Sampled	TOC Elevation (feet)	Depth to Water (feet)	LPH Thickness (feet)	Ground-water Elevation (feet)	Change in Elevation (feet)	TPH-G (µg/l)	TPPH 8260B (µg/l)	Benzene (µg/l)	Toluene (µg/l)	Ethyl-benzene (µg/l)	Total Xylenes (µg/l)	MTBE 8021B (µg/l)	MTBE 8260B (µg/l)	Comments
MW-5 continued														
11/20/1992	81.59	--	0.00	--	--	--	--	--	--	--	--	--	--	--
12/4/1992	81.59	10.03	0.08	71.62	--	--	--	--	--	--	--	--	--	--
12/21/1992	81.59	9.50	0.01	72.10	0.48	--	--	--	--	--	--	--	--	--
1/9/1993	81.59	8.22	0.00	73.37	1.27	--	--	--	--	--	--	--	--	--
1/30/1993	81.59	8.58	0.00	73.01	-0.36	--	--	--	--	--	--	--	--	--
2/10/1993	81.59	8.68	0.00	72.91	-0.10	--	--	--	--	--	--	--	--	--
2/24/1993	81.59	7.91	0.01	73.69	0.78	--	--	--	--	--	--	--	--	--
3/9/1993	81.59	8.87	0.01	72.73	-0.96	--	--	--	--	--	--	--	--	--
3/22/1993	81.59	8.46	0.01	73.14	0.41	--	--	--	--	--	--	--	--	--
4/8/1993	81.59	8.84	0.01	72.76	-0.38	--	--	--	--	--	--	--	--	--
4/28/1993	81.59	9.14	0.02	72.46	-0.29	--	--	--	--	--	--	--	--	--
5/12/1993	81.59	9.28	0.02	72.32	-0.14	--	--	--	--	--	--	--	--	--
5/25/1993	81.59	9.63	0.13	72.06	-0.27	--	--	--	--	--	--	--	--	--
6/7/1993	81.38	9.75	0.01	71.64	-0.42	--	--	--	--	--	--	--	--	--
6/23/1993	81.38	9.32	0.03	72.08	0.44	--	--	--	--	--	--	--	--	--
7/8/1993	81.38	9.48	0.04	71.93	-0.15	--	--	--	--	--	--	--	--	--
7/22/1993	81.38	9.73	0.16	71.77	-0.16	--	--	--	--	--	--	--	--	--
8/11/1993	81.38	9.84	0.04	71.57	-0.20	--	--	--	--	--	--	--	--	--
8/25/1993	81.38	9.81	0.02	71.58	0.02	--	--	--	--	--	--	--	--	--
9/8/1993	81.38	10.09	0.03	71.31	-0.27	--	--	--	--	--	--	--	--	--
9/22/1993	81.38	10.01	0.05	71.41	0.10	--	--	--	--	--	--	--	--	--
10/7/1993	81.38	9.94	0.03	71.46	0.06	--	--	--	--	--	--	--	--	--
10/28/1993	81.38	10.04	0.02	71.35	-0.11	--	--	--	--	--	--	--	--	--
11/12/1993	81.38	9.79	0.00	71.59	0.24	--	--	--	--	--	--	--	--	--
11/30/1993	81.38	9.62	0.00	71.76	0.17	--	--	--	--	--	--	--	--	--
2/16/1994	81.38	8.95	0.02	72.44	--	--	--	--	--	--	--	--	--	--
5/31/1994	81.38	9.63	0.00	71.75	-0.69	43000	--	1500	1200	1600	6700	--	--	--
8/31/1994	81.38	10.25	0.02	71.14	-0.61	--	--	--	--	--	--	--	--	--
9/27/1994	81.38	10.38	0.00	71.00	--	--	--	--	--	--	--	--	--	--

Date Sampled	TOC Elevation (feet)	Depth to Water (feet)	LPH Thickness (feet)	Ground-water Elevation (feet)	Change in Elevation (feet)	TPH-G (µg/l)	TPPH 8260B (µg/l)	Benzene (µg/l)	Toluene (µg/l)	Ethyl-benzene (µg/l)	Total Xylenes (µg/l)	MTBE 8021B (µg/l)	MTBE 8260B (µg/l)	Comments
MW-5 continued														
10/11/1994	81.38	10.45	0.02	70.94	-0.06	--	--	--	--	--	--	--	--	
11/10/1994	81.38	7.54	0.08	73.90	2.95	--	--	--	--	--	--	--	--	
2/7/1995	81.38	8.10	0.00	73.28	-0.62	25000	--	1400	740	990	3000	--	--	
3/14/1995	81.38	7.04	0.00	74.34	1.06	--	--	--	--	--	--	--	--	
5/3/1995	81.38	7.98	0.00	73.40	-0.94	12000	--	680	160	600	1800	--	--	
8/3/1995	81.38	9.25	0.00	72.13	-1.27	23000	--	940	280	810	2700	--	--	
8/19/1995	81.38	--	0.00	--	--	--	--	--	--	--	--	--	--	
11/7/1995	81.38	10.00	0.00	71.38	--	40000	--	510	280	1000	5700	--	630	
5/6/1996	81.38	9.03	0.00	72.35	0.97	13000	--	200	ND	180	610	--	170	
11/5/1996	81.38	10.41	0.00	70.97	-1.38	35000	--	1800	ND	1300	4900	--	580	
5/15/1997	81.38	9.41	0.00	71.97	1.00	10000	--	490	ND	ND	1300	--	ND	
11/12/1997	81.38	9.27	0.00	72.11	0.14	100	--	5.1	ND	ND	ND	--	74	
5/4/1998	81.38	9.18	0.00	72.20	0.09	39000	--	1600	230	1000	3200	--	ND	
11/11/1998	81.38	9.23	0.37	72.43	0.23	--	--	--	--	--	--	--	--	
2/22/1999	81.38	7.69	0.25	73.88	1.45	--	--	--	--	--	--	--	--	
4/2/1999	81.38	8.19	0.28	73.40	-0.48	--	--	--	--	--	--	--	--	
5/4/1999	81.38	8.44	0.01	72.95	-0.45	--	--	--	--	--	--	--	--	
5/20/1999	81.38	8.73	0.04	72.68	-0.27	--	--	--	--	--	--	--	--	
6/29/1999	81.38	8.91	0.05	72.51	-0.17	--	--	--	--	--	--	--	--	
7/29/1999	81.38	9.12	0.07	72.31	-0.20	--	--	--	--	--	--	--	--	
8/24/1999	81.38	9.37	0.09	72.08	-0.24	--	--	--	--	--	--	--	--	
9/27/1999	81.38	9.51	0.06	71.91	-0.16	--	--	--	--	--	--	--	--	
10/28/1999	81.38	--	0.05	--	--	--	--	--	--	--	--	--	--	
11/15/1999	81.38	9.29	0.00	72.09	--	--	--	--	--	--	--	--	--	
12/20/1999	81.38	9.14	0.00	72.24	0.15	--	--	--	--	--	--	--	--	
1/20/2000	81.38	9.08	0.00	72.30	0.06	--	--	--	--	--	--	--	--	
2/26/2000	81.38	8.69	0.00	72.69	0.39	--	--	--	--	--	--	--	--	
3/31/2000	81.38	8.48	0.00	72.90	0.21	--	--	--	--	--	--	--	--	
4/13/2000	81.38	8.66	0.00	72.72	-0.18	--	--	--	--	--	--	--	--	

Date Sampled	TOC Elevation (feet)	Depth to Water (feet)	LPH Thickness (feet)	Ground-water Elevation (feet)	Change in Elevation (feet)	TPH-G (µg/l)	TPPH 8260B (µg/l)	Benzene (µg/l)	Toluene (µg/l)	Ethyl-benzene (µg/l)	Total Xylenes (µg/l)	MTBE 8021B (µg/l)	MTBE 8260B (µg/l)	Comments
MW-5 continued														
5/22/2000	81.38	9.06	0.00	72.32	-0.40	240000	--	33000	5000	18000	59000	--	21	
11/22/2000	81.38	9.24	0.67	72.64	0.32	--	--	--	--	--	--	--	--	
2/14/2001	81.38	7.63	0.33	74.00	1.35	--	--	--	--	--	--	--	--	
3/28/2001	81.38	8.82	0.00	72.56	-1.44	--	--	--	--	--	--	--	--	
4/28/2001	81.38	8.66	0.00	72.72	0.16	--	--	--	--	--	--	--	--	
5/15/2001	81.38	8.97	0.00	72.41	-0.31	--	--	--	--	--	--	--	--	
6/29/2001	81.38	8.73	0.00	72.65	0.24	--	--	--	--	--	--	--	--	
7/17/2001	81.38	8.92	0.02	72.47	-0.17	--	--	--	--	--	--	--	--	
8/30/2001	81.38	8.85	0.00	72.53	0.06	--	--	--	--	--	--	--	--	
9/24/2001	81.38	8.89	0.00	72.49	-0.04	--	--	--	--	--	--	--	--	
10/15/2001	81.38	9.11	0.03	72.29	-0.20	--	--	--	--	--	--	--	--	
11/23/2001	81.38	8.77	0.00	72.61	0.32	29000	--	3900	450	1400	3500	--	ND<500	
12/10/2001	81.38	8.75	0.00	72.63	0.02	--	--	--	--	--	--	--	--	
1/14/2002	81.38	8.26	0.00	73.12	0.49	--	--	--	--	--	--	--	--	
2/22/2002	81.38	6.30	0.00	75.08	1.96	--	--	--	--	--	--	--	--	
3/11/2002	81.38	6.47	0.00	74.91	-0.17	--	--	--	--	--	--	--	--	
4/15/2002	81.38	6.56	0.00	74.82	-0.09	--	--	--	--	--	--	--	--	
5/24/2002	81.38	8.32	0.15	73.17	-1.65	--	--	--	--	--	--	--	--	
6/17/2002	81.38	8.41	0.20	73.12	-0.05	--	--	--	--	--	--	--	--	
7/15/2002	81.38	8.63	0.20	72.90	-0.22	--	--	--	--	--	--	--	--	
8/19/2002	81.38	8.76	0.31	72.85	-0.05	--	--	--	--	--	--	--	--	
9/5/2002	81.38	8.73	0.16	72.77	-0.08	--	--	--	--	--	--	--	--	
10/7/2002	81.38	8.79	0.09	72.66	-0.11	--	--	--	--	--	--	--	--	
11/29/2002	81.38	9.18	0.05	72.24	-0.42	--	--	--	--	--	--	--	--	
12/12/2002	81.38	9.12	0.04	72.29	0.05	--	--	--	--	--	--	--	--	
1/6/2003	81.38	9.05	0.03	72.35	0.06	--	--	--	--	--	--	--	--	
2/12/2003	81.38	8.87	0.04	72.54	0.19	--	--	--	--	--	--	--	--	
3/13/2003	81.38	8.25	0.03	73.15	0.61	--	--	--	--	--	--	--	--	
4/7/2003	81.38	8.31	0.02	73.08	-0.07	--	--	--	--	--	--	--	--	

Date Sampled	TOC Elevation (feet)	Depth to Water (feet)	LPH Thickness (feet)	Ground-water Elevation (feet)	Change in Elevation (feet)	TPH-G (µg/l)	TPPH 8260B (µg/l)	Benzene (µg/l)	Toluene (µg/l)	Ethyl-benzene (µg/l)	Total Xylenes (µg/l)	MTBE 8021B (µg/l)	MTBE 8260B (µg/l)	Comments
MW-5 continued														
5/15/2003	81.38	8.58	0.03	72.82	-0.26	--	--	--	--	--	--	--	--	
6/12/2003	81.38	8.63	0.02	72.76	-0.06	--	--	--	--	--	--	--	--	
7/7/2003	81.38	8.59	0.02	72.80	0.04	--	--	--	--	--	--	--	--	
11/4/2003	81.38	9.90	0.25	71.67	-1.14	--	--	--	--	--	--	--	--	
MW-6														
11/7/1990	80.47	--	--	--	--	ND	--	ND	ND	ND	ND	--	--	
2/25/1991	80.47	--	--	--	--	ND	--	0.37	0.4	0.35	1.5	--	--	
5/28/1991	80.47	--	--	--	--	ND	--	ND	ND	ND	0.42	--	--	
8/28/1991	80.47	--	--	--	--	ND	--	ND	ND	ND	ND	--	--	
11/19/1991	80.47	--	--	--	--	ND	--	ND	ND	ND	ND	--	--	
2/6/1992	80.47	--	--	--	--	ND	--	ND	ND	ND	ND	--	--	
5/23/1992	80.47	--	--	--	--	ND	--	ND	ND	ND	ND	--	--	
8/26/1992	80.47	--	--	--	--	ND	--	ND	ND	ND	ND	--	--	
11/20/1992	80.47	--	--	--	--	ND	--	ND	ND	ND	ND	--	--	
12/21/1992	80.47	7.71	0.00	72.76	--	--	--	--	--	--	--	--	--	
1/30/1993	80.47	7.25	0.00	73.22	--	--	--	--	--	--	--	--	--	
2/24/1993	80.47	6.74	0.00	73.73	--	ND	--	ND	ND	ND	ND	--	--	
3/22/1993	80.47	5.85	0.00	74.62	--	--	--	--	--	--	--	--	--	
4/28/1993	80.47	7.58	0.00	72.89	--	--	--	--	--	--	--	--	--	
5/25/1993	80.47	7.48	0.00	72.99	--	ND	--	ND	ND	ND	ND	--	--	
6/23/1993	79.94	7.34	0.00	72.60	--	--	--	--	--	--	--	--	--	
7/22/1993	79.94	7.53	0.00	72.41	--	--	--	--	--	--	--	--	--	
8/25/1993	79.94	7.66	0.00	72.28	--	ND	--	ND	ND	ND	ND	--	--	
9/22/1993	79.94	7.76	0.00	72.18	--	--	--	--	--	--	--	--	--	
10/28/1993	79.94	8.30	0.00	71.64	--	--	--	--	--	--	--	--	--	
11/30/1993	79.94	7.40	0.00	72.54	--	--	--	--	--	--	--	--	--	
2/16/1994	79.94	7.13	0.00	72.81	--	ND	--	ND	ND	ND	ND	--	--	
5/31/1994	79.94	7.49	0.00	72.45	-0.36	--	--	--	--	--	--	--	--	
8/31/1994	79.94	7.93	0.00	72.01	-0.44	ND	--	ND	1.5	ND	1.6	--	--	

Date Sampled	TOC Elevation (feet)	Depth to Water (feet)	LPH Thickness (feet)	Ground-water Elevation (feet)	Change in Elevation (feet)	TPH-G (µg/l)	TPPH 8260B (µg/l)	Benzene (µg/l)	Toluene (µg/l)	Ethyl-benzene (µg/l)	Total Xylenes (µg/l)	MTBE 8021B (µg/l)	MTBE 8260B (µg/l)	Comments
MW-6 continued														
9/27/1994	79.94	8.03	0.00	71.91	--	--	--	--	--	--	--	--	--	
10/11/1994	79.94	8.05	0.00	71.89	-0.02	--	--	--	--	--	--	--	--	
11/10/1994	79.94	6.12	0.00	73.82	1.93	--	--	--	--	--	--	--	--	
2/7/1995	79.94	6.65	0.00	73.29	-0.53	ND	--	ND	ND	ND	ND	--	--	
5/3/1995	79.94	6.47	0.00	73.47	--	ND	--	ND	ND	ND	1	--	--	
8/3/1995	79.94	7.28	0.00	72.66	-0.81	--	--	--	--	--	--	--	--	
11/7/1995	79.94	7.98	0.00	71.96	--	ND	--	ND	ND	ND	ND	--	--	
5/6/1996	79.94	7.80	0.00	72.14	0.18	--	--	--	--	--	--	--	--	
11/5/1996	79.94	7.63	0.00	72.31	0.17	--	--	--	--	--	--	--	--	
5/15/1997	79.94	7.41	0.00	72.53	0.22	--	--	--	--	--	--	--	--	
11/12/1997	79.94	7.51	0.00	72.43	-0.10	--	--	--	--	--	--	--	--	
5/4/1998	79.94	7.15	0.00	72.79	0.36	--	--	--	--	--	--	--	--	
11/11/1998	79.94	7.04	0.00	72.90	0.11	--	--	--	--	--	--	--	--	
5/20/1999	79.94	7.00	0.00	72.94	--	--	--	--	--	--	--	--	--	
11/15/1999	79.94	7.42	0.00	72.52	--	--	--	--	--	--	--	--	--	
5/22/2000	79.94	7.24	0.00	72.70	--	--	--	--	--	--	--	--	--	
11/22/2000	79.94	7.40	0.00	72.54	-0.16	--	--	--	--	--	--	--	--	
5/15/2001	79.94	7.12	0.00	72.82	--	--	--	--	--	--	--	--	--	
11/23/2001	79.94	7.19	0.00	72.75	--	--	--	--	--	--	--	--	--	
5/24/2002	79.94	6.54	0.00	73.40	--	--	--	--	--	--	--	--	--	
11/29/2002	79.94	7.26	0.00	72.68	--	--	--	--	--	--	--	--	--	
5/15/2003	79.94	6.26	0.00	73.68	--	--	--	--	--	--	--	--	--	
11/4/2003	79.94	7.80	0.00	72.14	--	--	ND<50	ND<0.50	ND<0.50	ND<0.50	ND<1.0	--	2.4	
MW-7														
11/7/1990	81.83	--	--	--	--	ND	--	ND	ND	ND	ND	--	--	
2/25/1991	81.83	--	--	--	--	70	--	ND	ND	ND	0.52	--	--	
5/28/1991	81.83	--	--	--	--	39	--	ND	ND	ND	0.73	--	--	
8/28/1991	81.83	--	--	--	--	ND	--	ND	ND	ND	ND	--	--	
11/19/1991	81.83	--	--	--	--	32	--	ND	ND	ND	ND	--	--	

Date Sampled	TOC Elevation (feet)	Depth to Water (feet)	LPH Thickness (feet)	Ground-water Elevation (feet)	Change in Elevation (feet)	TPH-G (µg/l)	TPPH 8260B (µg/l)	Benzene (µg/l)	Toluene (µg/l)	Ethyl-benzene (µg/l)	Total Xylenes (µg/l)	MTBE 8021B (µg/l)	MTBE 8260B (µg/l)	Comments
MW-7 continued														
2/6/1992	81.83	--	--	--	--	ND	--	ND	ND	ND	ND	--	--	
5/23/1992	81.83	--	--	--	--	ND	--	ND	ND	ND	ND	--	--	
8/26/1992	81.83	--	--	--	--	ND	--	ND	ND	0.73	ND	--	--	
11/20/1992	81.83	--	--	--	--	ND	--	ND	ND	ND	ND	--	--	
12/21/1992	81.83	8.42	0.00	73.41	--	--	--	--	--	--	--	--	--	
1/30/1993	81.83	8.21	0.00	73.62	--	--	--	--	--	--	--	--	--	
2/24/1993	81.83	7.85	0.00	73.98	--	ND	--	ND	ND	ND	ND	--	--	
3/22/1993	81.83	6.97	0.00	74.86	--	--	--	--	--	--	--	--	--	
4/28/1993	81.83	8.39	0.00	73.44	--	--	--	--	--	--	--	--	--	
5/25/1993	81.83	8.43	0.00	73.40	--	ND	--	ND	ND	ND	ND	--	--	
6/23/1993	81.64	8.47	0.00	73.17	--	--	--	--	--	--	--	--	--	
7/22/1993	81.64	8.83	0.00	72.81	--	--	--	--	--	--	--	--	--	
8/25/1993	81.64	8.81	0.00	72.83	--	ND	--	ND	ND	ND	ND	--	--	
9/22/1993	81.64	8.96	0.00	72.68	--	--	--	--	--	--	--	--	--	
10/28/1993	81.64	8.98	0.00	72.66	--	--	--	--	--	--	--	--	--	
11/30/1993	81.64	8.65	0.00	72.99	--	--	--	--	--	--	--	--	--	
2/16/1994	81.64	8.36	0.00	73.28	--	ND	--	ND	ND	ND	0.7	--	--	
5/31/1994	81.64	8.67	0.00	72.97	-0.31	--	--	--	--	--	--	--	--	
8/31/1994	81.64	9.12	0.00	72.52	-0.45	ND	--	ND	0.8	ND	0.75	--	--	
9/27/1994	81.64	9.22	0.00	72.42	--	--	--	--	--	--	--	--	--	
10/11/1994	81.64	9.23	0.00	72.41	-0.01	--	--	--	--	--	--	--	--	
11/10/1994	81.64	7.66	0.00	73.98	1.57	--	--	--	--	--	--	--	--	
2/7/1995	81.64	7.88	0.00	73.76	-0.22	ND	--	ND	ND	ND	ND	--	--	
5/3/1995	81.64	7.71	0.00	73.93	--	ND	--	ND	ND	ND	1	--	--	
8/3/1995	81.64	8.40	0.00	73.24	-0.69	--	--	--	--	--	--	--	--	
11/7/1995	81.64	8.95	0.00	72.69	--	ND	--	ND	ND	ND	ND	--	--	
5/6/1996	81.64	8.15	0.00	73.49	0.80	--	--	--	--	--	--	--	--	
11/5/1996	81.64	8.67	0.00	72.97	-0.52	--	--	--	--	--	--	--	--	
5/15/1997	81.64	8.47	0.00	73.17	0.20	--	--	--	--	--	--	--	--	

Date Sampled	TOC Elevation (feet)	Depth to Water (feet)	LPH Thickness (feet)	Ground-water Elevation (feet)	Change in Elevation (feet)	TPH-G (µg/l)	TPPH 8260B (µg/l)	Benzene (µg/l)	Toluene (µg/l)	Ethyl-benzene (µg/l)	Total Xylenes (µg/l)	MTBE 8021B (µg/l)	MTBE 8260B (µg/l)	Comments
MW-7 continued														
11/12/1997	81.64	7.88	0.00	73.76	0.59	--	--	--	--	--	--	--	--	--
5/4/1998	81.64	7.93	0.00	73.71	-0.05	--	--	--	--	--	--	--	--	--
11/11/1998	81.64	8.20	0.00	73.44	-0.27	--	--	--	--	--	--	--	--	--
5/20/1999	81.64	8.04	0.00	73.60	--	--	--	--	--	--	--	--	--	--
11/15/1999	81.64	8.17	0.00	73.47	--	--	--	--	--	--	--	--	--	--
5/22/2000	81.64	8.10	0.00	73.54	--	--	--	--	--	--	--	--	--	--
11/22/2000	81.64	8.30	0.00	73.34	-0.20	--	--	--	--	--	--	--	--	--
5/15/2001	81.64	8.09	0.00	73.55	--	--	--	--	--	--	--	--	--	--
11/23/2001	81.64	8.14	0.00	73.50	--	--	--	--	--	--	--	--	--	--
5/24/2002	81.64	7.56	0.00	74.08	--	--	--	--	--	--	--	--	--	--
11/29/2002	81.64	8.23	0.00	73.41	--	--	--	--	--	--	--	--	--	--
5/15/2003	81.64	7.25	0.00	74.39	--	--	--	--	--	--	--	--	--	--
11/4/2003	81.64	8.76	0.00	72.88	--	--	70	ND<0.50	ND<0.50	ND<0.50	ND<1.0	--	ND<2.0	--
MW-8														
11/7/1990	81.71	--	--	--	--	4700	--	28	38	86	7200	--	--	--
2/25/1991	81.71	--	--	--	--	5300	--	17	6.1	53	300	--	--	--
5/28/1991	81.71	--	--	--	--	4800	--	4.2	1.3	5.1	170	--	--	--
8/28/1991	81.71	--	--	--	--	1800	--	3.2	1.9	19	74	--	--	--
11/19/1991	81.71	--	--	--	--	1600	--	8.1	1.8	19	52	--	--	--
2/6/1992	81.71	--	--	--	--	2600	--	4.1	7	31	93	--	--	--
5/23/1992	81.71	--	--	--	--	2100	--	8.6	1.6	1.7	28	--	--	--
8/26/1992	81.71	--	--	--	--	1800	--	12	8	4	13	--	--	--
11/20/1992	81.71	--	--	--	--	--	--	--	--	--	--	--	--	--
12/21/1992	81.71	--	--	--	--	--	--	--	--	--	--	--	--	--
1/9/1993	81.71	--	--	--	--	--	--	--	--	--	--	--	--	--
1/30/1993	81.71	--	--	--	--	--	--	--	--	--	--	--	--	--
2/10/1993	81.71	--	--	--	--	--	--	--	--	--	--	--	--	--
2/24/1993	81.71	--	--	--	--	--	--	--	--	--	--	--	--	--
3/9/1993	81.71	--	--	--	--	--	--	--	--	--	--	--	--	--

Date Sampled	TOC Elevation (feet)	Depth to Water (feet)	LPH Thickness (feet)	Ground-water Elevation (feet)	Change in Elevation (feet)	TPH-G (µg/l)	TPPH 8260B (µg/l)	Benzene (µg/l)	Toluene (µg/l)	Ethyl-benzene (µg/l)	Total Xylenes (µg/l)	MTBE 8021B (µg/l)	MTBE 8260B (µg/l)	Comments
MW-8 continued														
3/22/1993	81.71	--	--	--	--	--	--	--	--	--	--	--	--	
4/8/1993	81.71	--	--	--	--	--	--	--	--	--	--	--	--	
4/28/1993	81.71	--	--	--	--	--	--	--	--	--	--	--	--	
5/12/1993	81.71	--	--	--	--	--	--	--	--	--	--	--	--	
5/25/1993	81.71	10.12	0.00	71.59	--	1200	--	5.4	ND	9	21	--	--	
6/7/1993	81.41	9.98	0.00	71.43	-0.16	--	--	--	--	--	--	--	--	
6/23/1993	81.41	10.36	0.00	71.05	-0.38	--	--	--	--	--	--	--	--	
7/8/1993	81.41	10.52	0.00	70.89	-0.16	--	--	--	--	--	--	--	--	
7/22/1993	81.41	--	--	--	--	--	--	--	--	--	--	--	--	
8/11/1993	81.41	--	--	--	--	--	--	--	--	--	--	--	--	
8/25/1993	81.41	10.95	0.00	70.46	--	1800	--	11	17	8.9	29	--	--	
9/8/1993	81.41	11.34	0.00	70.07	-0.39	--	--	--	--	--	--	--	--	
9/22/1993	81.41	11.13	0.00	70.28	0.21	--	--	--	--	--	--	--	--	
10/7/1993	81.41	10.96	0.00	70.45	0.17	--	--	--	--	--	--	--	--	
10/28/1993	81.41	11.19	0.00	70.22	-0.23	--	--	--	--	--	--	--	--	
11/12/1993	81.41	--	--	--	--	--	--	--	--	--	--	--	--	
11/30/1993	81.41	10.42	0.00	70.99	--	3,500	--	18	ND	ND	ND	--	--	
2/16/1994	81.41	9.86	0.00	71.55	--	990	--	4.9	1.8	2.4	4.5	--	--	
5/31/1994	81.41	10.61	0.00	70.80	-0.75	350	--	3.0	1.0	0.73	1.7	--	--	
8/31/1994	81.41	11.37	0.00	70.04	-0.76	1,800	--	ND	ND	ND	ND	--	--	
9/27/1994	81.41	--	--	--	--	--	--	--	--	--	--	--	--	
10/11/1994	81.41	11.50	0.00	69.91	--	--	--	--	--	--	--	--	--	
11/10/1994	81.41	7.81	0.00	73.60	3.69	940	--	6.7	6.3	ND	16	--	--	
2/7/1995	81.41	8.69	0.00	72.72	-0.88	230	--	1.4	0.95	0.9	1.1	--	--	
5/3/1995	81.41	8.60	0.00	72.81	--	75	--	ND	ND	ND	1.0	--	--	
8/3/1995	81.41	--	--	--	--	--	--	--	--	--	--	--	--	
11/7/1995	81.41	11.05	0.00	70.36	--	210	--	1.3	1.2	ND	ND	--	--	
5/6/1996	81.41	--	--	--	--	--	--	--	--	--	--	--	--	
11/5/1996	81.41	--	--	--	--	--	--	--	--	--	--	--	--	

Date Sampled	TOC Elevation (feet)	Depth to Water (feet)	LPH Thickness (feet)	Ground-water Elevation (feet)	Change in Elevation (feet)	TPH-G (µg/l)	TPPH 8260B (µg/l)	Benzene (µg/l)	Toluene (µg/l)	Ethyl-benzene (µg/l)	Total Xylenes (µg/l)	MTBE 8021B (µg/l)	MTBE 8260B (µg/l)	Comments
MW-8 continued														
5/15/1997	81.41	10.46	0.00	70.95	--	ND	--	ND	ND	ND	ND	--	43	
11/12/1997	81.41	--	--	--	--	--	--	--	--	--	--	--	--	
5/4/1998	81.41	--	--	--	--	--	--	--	--	--	--	--	--	
11/11/1998	81.41	--	--	--	--	--	--	--	--	--	--	--	--	
5/20/1999	81.41	9.75	0.00	71.66	--	ND	--	ND	ND	ND	ND	--	10	
11/15/1999	81.41	--	--	--	--	--	--	--	--	--	--	--	45.1	
5/22/2000	81.41	9.80	0.00	71.61	--	ND	--	ND	1.9	ND	3.3	--	ND	
11/22/2000	81.41	9.76	0.00	71.65	0.04	ND	--	ND	1.16	ND	1.22	--	ND	
5/15/2001	81.41	9.87	0.00	71.54	--	ND	--	ND	ND	ND	ND	--	ND	
11/23/2001	81.41	9.92	0.00	71.49	--	ND<50	--	ND<0.50	ND<0.50	ND<0.50	ND<0.50	--	ND<5.0	
5/24/2002	81.41	9.26	0.00	72.15	--	ND<50	--	ND<0.50	ND<0.50	ND<0.50	ND<0.50	--	ND<5.0	
11/29/2002	81.41	9.71	0.00	71.70	--	ND<50	--	ND<0.50	ND<0.50	ND<0.50	ND<1.0	--	ND<2.0	
5/15/2003	81.41	9.04	0.00	72.37	--	ND<50	--	ND<0.50	ND<0.50	ND<0.50	ND<1.0	--	ND<2.0	
11/4/2003	81.41	10.20	0.00	71.21	--	--	690	ND<1.0	ND<1.0	3.3	ND<2.0	--	190	
MW-9														
11/7/1990	81.13	--	--	--	--	480	--	7.8	1.2	13	47	--	--	
2/25/1991	81.13	--	--	--	--	390	--	13	1.1	2.8	14	--	--	
5/28/1991	81.13	--	--	--	--	590	--	6.0	0.43	6.8	1.4	--	--	
8/28/1991	81.13	--	--	--	--	450	--	17	0.9	13	14	--	--	
11/19/1991	81.13	--	--	--	--	360	--	17	0.45	15	11	--	--	
2/6/1992	81.13	--	--	--	--	660	--	41	1.0	33	15	--	--	
5/23/1992	81.13	--	--	--	--	460	--	18	0.66	1.4	3.2	--	--	
8/26/1992	81.13	--	--	--	--	250	--	13	ND	8.6	3.8	--	--	
11/20/1992	81.13	--	--	--	--	--	--	--	--	--	--	--	--	
12/21/1992	81.13	--	--	--	--	--	--	--	--	--	--	--	--	
1/30/1993	81.13	--	--	--	--	--	--	--	--	--	--	--	--	
2/24/1993	81.13	--	--	--	--	--	--	--	--	--	--	--	--	
3/22/1993	81.13	--	--	--	--	--	--	--	--	--	--	--	--	
4/28/1993	81.13	--	--	--	--	--	--	--	--	--	--	--	--	

Date Sampled	TOC Elevation (feet)	Depth to Water (feet)	LPH Thickness (feet)	Ground-water Elevation (feet)	Change in Elevation (feet)	TPH-G (µg/l)	TPPH 8260B (µg/l)	Benzene (µg/l)	Toluene (µg/l)	Ethyl-benzene (µg/l)	Total Xylenes (µg/l)	MTBE 8021B (µg/l)	MTBE 8260B (µg/l)	Comments
MW-9 continued														
5/25/1993	81.13	11.50	0.00	69.63	--	160	--	6.1	ND	7.4	1.1	--	--	
6/23/1993	80.53	9.78	0.00	70.75	--	--	--	--	--	--	--	--	--	
7/22/1993	80.53	10.10	0.00	70.43	--	--	--	--	--	--	--	--	--	
8/25/1993	80.53	10.44	0.00	70.09	--	220	--	10	ND	6.8	1.4	--	--	
9/22/1993	80.53	10.64	0.00	69.89	--	--	--	--	--	--	--	--	--	
10/28/1993	80.53	10.68	0.00	69.85	--	--	--	--	--	--	--	--	--	
11/30/1993	80.53	9.87	0.00	70.66	--	200	--	5.6	ND	2.9	2.7	--	--	
2/16/1994	80.53	9.21	0.00	71.32	--	250	--	5.1	1.3	4.4	1.5	--	--	
5/31/1994	80.53	10.15	0.00	70.38	-0.94	360	--	7.8	0.97	4.6	2.2	--	--	
8/31/1994	80.53	10.97	0.00	69.56	-0.82	650	--	7.7	2.8	4.4	5.0	--	59	
9/27/1994	80.53	11.10	0.00	69.43	--	--	--	--	--	--	--	--	--	
10/11/1994	80.53	11.20	0.00	69.33	-0.10	--	--	--	--	--	--	--	--	
11/10/1994	80.53	7.25	0.00	73.28	3.95	ND	--	ND	ND	ND	ND	--	--	
2/7/1995	80.53	7.76	0.00	72.77	-0.51	57	--	0.7	ND	0.86	ND	--	--	
5/3/1995	80.53	7.82	0.00	72.71	--	ND	--	0.85	0.67	1.3	1.0	--	--	
8/3/1995	80.53	9.70	0.00	70.83	-1.88	91	--	1.1	ND	ND	ND	--	--	
11/7/1995	80.53	10.64	0.00	69.89	--	130	--	1.5	0.62	0.71	ND	--	60	
5/6/1996	80.53	9.01	0.00	71.52	1.63	860	--	6.1	13	6.0	25	--	ND	
11/5/1996	80.53	11.42	0.00	69.11	-2.41	84	--	0.74	ND	1.2	4.5	--	ND	
5/15/1997	80.53	9.89	0.00	70.64	1.53	ND	--	ND	ND	ND	ND	--	ND	
11/12/1997	80.53	10.22	0.00	70.31	-0.33	ND	--	0.55	ND	ND	ND	--	74	
5/4/1998	80.53	10.05	0.00	70.48	0.17	ND	--	ND	ND	ND	ND	--	45	
11/11/1998	80.53	9.23	0.00	71.30	0.82	ND	--	ND	ND	ND	ND	--	ND	
5/20/1999	80.53	8.78	0.00	71.75	--	ND	--	ND	ND	ND	ND	--	ND	
11/15/1999	80.53	9.12	0.00	71.41	--	ND	--	ND	ND	ND	ND	--	ND	
5/22/2000	80.53	9.17	0.00	71.36	--	ND	--	ND	1.9	ND	3.5	--	ND	
11/22/2000	80.53	9.08	0.00	71.45	0.09	ND	--	ND	1.18	ND	1.16	--	ND	
5/15/2001	80.53	8.85	0.00	71.68	--	ND	--	ND	ND	ND	ND	--	ND	
11/23/2001	80.53	9.10	0.00	71.43	--	ND<50	--	ND<0.50	ND<0.50	ND<0.50	ND<0.50	--	ND<5.0	

Date Sampled	TOC Elevation (feet)	Depth to Water (feet)	LPH Thickness (feet)	Ground-water Elevation (feet)	Change in Elevation (feet)	TPH-G (µg/l)	TPPH 8260B (µg/l)	Benzene (µg/l)	Toluene (µg/l)	Ethyl- benzene (µg/l)	Total Xylenes (µg/l)	MTBE 8021B (µg/l)	MTBE 8260B (µg/l)	Comments
MW-9 continued														
5/24/2002	80.53	8.79	0.00	71.74	--	ND<50	--	ND<0.50	ND<0.50	ND<0.50	ND<0.50	--	ND<5.0	
11/29/2002	80.53	9.24	0.00	71.29	--	ND<50	--	ND<0.50	ND<0.50	ND<0.50	ND<1.0	--	ND<2.0	
5/15/2003	80.53	8.56	0.00	71.97	--	ND<50	--	ND<0.50	ND<0.50	ND<0.50	ND<1.0	--	ND<2.0	
11/4/2003	80.53	--	--	--	--	--	--	--	--	--	--	--	--	Inaccessible
MW-10														
2/6/1992	81.90	--	--	--	--	ND	--	ND	ND	ND	ND	--	--	
5/23/1992	81.90	--	--	--	--	ND	--	ND	ND	ND	ND	--	--	
8/26/1992	81.90	--	--	--	--	ND	--	ND	ND	ND	ND	--	--	
11/20/1992	81.90	--	--	--	--	ND	--	ND	ND	ND	ND	--	--	
12/21/1992	81.90	13.41	0.00	68.49	--	--	--	--	--	--	--	--	--	
1/30/1993	81.90	11.60	0.00	70.30	--	--	--	--	--	--	--	--	--	
2/24/1993	81.90	11.23	0.00	70.67	--	ND	--	ND	ND	ND	ND	--	--	
3/22/1993	81.90	10.89	0.00	71.01	--	--	--	--	--	--	--	--	--	
4/28/1993	81.90	12.11	0.00	69.79	--	--	--	--	--	--	--	--	--	
5/25/1993	81.90	12.02	0.00	69.88	--	ND	--	ND	ND	ND	ND	--	--	
6/23/1993	81.61	12.11	0.00	69.50	--	--	--	--	--	--	--	--	--	
7/22/1993	81.61	12.49	0.00	69.12	--	--	--	--	--	--	--	--	--	
8/25/1993	81.61	12.78	0.00	68.83	--	ND	--	ND	ND	ND	ND	--	--	
9/22/1993	81.61	13.06	0.00	68.55	--	--	--	--	--	--	--	--	--	
10/28/1993	81.61	13.23	0.00	68.38	--	--	--	--	--	--	--	--	--	
11/30/1993	81.61	--	--	--	--	--	--	--	--	--	--	--	--	
2/16/1994	81.61	12.43	0.00	69.18	--	ND	--	ND	ND	ND	ND	--	--	
5/31/1994	81.61	12.69	0.00	68.92	-0.26	ND	--	ND	0.9	ND	0.91	--	--	
8/31/1994	81.61	13.47	0.00	68.14	-0.78	ND	--	ND	0.64	ND	0.54	--	--	
9/27/1994	81.61	13.72	0.00	67.89	--	--	--	--	--	--	--	--	--	
10/11/1994	81.61	14.80	0.00	66.81	-1.08	--	--	--	--	--	--	--	--	
11/10/1994	81.61	12.64	0.00	68.97	2.16	ND	--	ND	ND	ND	ND	--	--	
2/7/1995	81.61	10.29	0.00	71.32	2.35	--	--	--	--	--	--	--	--	
5/3/1995	81.61	10.22	0.00	71.39	--	ND	--	ND	ND	ND	0.65	--	--	

Date Sampled	TOC Elevation (feet)	Depth to Water (feet)	LPH Thickness (feet)	Ground-water Elevation (feet)	Change in Elevation (feet)	TPH-G (µg/l)	TPPH 8260B (µg/l)	Benzene (µg/l)	Toluene (µg/l)	Ethyl-benzene (µg/l)	Total Xylenes (µg/l)	MTBE 8021B (µg/l)	MTBE 8260B (µg/l)	Comments
MW-10 continued														
8/3/1995	81.61	11.73	0.00	69.88	-1.51	--	--	--	--	--	--	--	--	
11/7/1995	81.61	12.98	0.00	68.63	--	ND	--	ND	ND	ND	ND	--	--	
5/6/1996	81.61	10.90	0.00	70.71	2.08	--	--	--	--	--	--	--	--	
11/5/1996	81.61	11.96	0.00	69.65	-1.06	--	--	--	--	--	--	--	--	
5/15/1997	81.61	10.79	0.00	70.82	1.17	--	--	--	--	--	--	--	--	
11/12/1997	81.61	10.07	0.00	71.54	0.72	--	--	--	--	--	--	--	--	
5/4/1998	81.61	10.01	0.00	71.60	0.06	--	--	--	--	--	--	--	--	
11/11/1998	81.61	12.03	0.00	69.58	-2.02	--	--	--	--	--	--	--	--	
5/20/1999	81.61	10.05	0.00	71.56	--	--	--	--	--	--	--	--	--	
11/15/1999	81.61	10.16	0.00	71.45	--	--	--	--	--	--	--	--	--	
5/22/2000	81.61	10.06	0.00	71.55	--	--	--	--	--	--	--	--	--	
11/22/2000	81.61	10.12	0.00	71.49	-0.06	--	--	--	--	--	--	--	--	
5/15/2001	81.61	10.08	0.00	71.53	--	--	--	--	--	--	--	--	--	
11/23/2001	81.61	10.14	0.00	71.47	--	--	--	--	--	--	--	--	--	
5/24/2002	81.61	9.48	0.00	72.13	--	--	--	--	--	--	--	--	--	
11/29/2002	81.61	10.11	0.00	71.50	--	--	--	--	--	--	--	--	--	
5/15/2003	81.61	9.22	0.00	72.39	--	--	--	--	--	--	--	--	--	
11/4/2003	81.61	12.82	0.00	68.79	--	--	ND<50	ND<0.50	ND<0.50	ND<0.50	ND<1.0	--	ND<2.0	
MW-11														
2/6/1992	78.43	--	--	--	--	ND	--	ND	ND	ND	ND	--	--	
5/23/1992	78.43	--	--	--	--	ND	--	ND	ND	ND	ND	--	--	
8/26/1992	78.43	--	--	--	--	ND	--	ND	ND	ND	ND	--	--	
11/20/1992	78.43	--	--	--	--	ND	--	ND	ND	ND	ND	--	--	
12/21/1992	78.43	12.34	0.00	66.09	--	--	--	--	--	--	--	--	--	
1/30/1993	78.43	14.17	0.00	64.26	--	--	--	--	--	--	--	--	--	
2/24/1993	78.43	12.70	0.00	65.73	--	ND	--	ND	ND	ND	ND	--	--	
3/22/1993	78.43	8.95	0.00	69.48	--	--	--	--	--	--	--	--	--	
4/28/1993	78.43	13.87	0.00	64.56	--	--	--	--	--	--	--	--	--	
5/25/1993	78.43	15.14	0.00	63.29	--	ND	--	ND	0.75	ND	1.0	--	--	

Date Sampled	TOC Elevation (feet)	Depth to Water (feet)	LPH Thickness (feet)	Ground-water Elevation (feet)	Change in Elevation (feet)	TPH-G (µg/l)	TPPH 8260B (µg/l)	Benzene (µg/l)	Toluene (µg/l)	Ethyl-benzene (µg/l)	Total Xylenes (µg/l)	MTBE 8021B (µg/l)	MTBE 8260B (µg/l)	Comments
MW-11 continued														
6/23/1993	78.18	15.08	0.00	63.10	--	--	--	--	--	--	--	--	--	
7/22/1993	78.18	15.46	0.00	62.72	--	--	--	--	--	--	--	--	--	
8/25/1993	78.18	14.10	0.00	64.08	--	ND	--	ND	ND	ND	ND	--	--	
9/22/1993	78.18	15.03	0.00	63.15	--	--	--	--	--	--	--	--	--	
10/28/1993	78.18	13.84	0.00	64.34	--	--	--	--	--	--	--	--	--	
11/30/1993	78.18	13.04	0.00	65.14	--	ND	--	ND	ND	ND	ND	--	--	
2/16/1994	78.18	12.76	0.00	65.42	--	ND	--	ND	ND	ND	ND	--	--	
5/31/1994	78.18	12.79	0.00	65.39	-0.03	ND	--	ND	ND	ND	ND	--	--	
8/31/1994	78.18	12.97	0.00	65.21	-0.18	ND	--	ND	1.5	ND	1.8	--	--	
9/27/1994	78.18	14.88	0.00	63.30	--	--	--	--	--	--	--	--	--	
10/11/1994	78.18	13.40	0.00	64.78	1.48	--	--	--	--	--	--	--	--	
11/10/1994	78.18	13.57	0.00	64.61	-0.17	ND	--	ND	ND	ND	ND	--	--	
2/7/1995	78.18	12.28	0.00	65.90	1.29	--	--	--	--	--	--	--	--	
5/3/1995	78.18	9.28	0.00	68.90	--	ND	--	ND	ND	ND	ND	--	--	
8/3/1995	78.18	12.67	0.00	65.51	-3.39	--	--	--	--	--	--	--	--	
11/7/1995	78.18	12.28	0.00	65.90	--	ND	--	ND	ND	ND	ND	--	--	
5/6/1996	78.18	13.30	0.00	64.88	-1.02	--	--	--	--	--	--	--	--	
11/5/1996	78.18	10.90	0.00	67.28	2.40	--	--	--	--	--	--	--	--	
5/15/1997	78.18	11.65	0.00	66.53	-0.75	--	--	--	--	--	--	--	--	
11/12/1997	78.18	9.66	0.00	68.52	1.99	--	--	--	--	--	--	--	--	
5/4/1998	78.18	10.87	0.00	67.31	-1.21	--	--	--	--	--	--	--	--	
11/11/1998	78.18	11.40	0.00	66.78	-0.53	--	--	--	--	--	--	--	--	
5/20/1999	78.18	10.71	0.00	67.47	--	ND	--	ND	ND	ND	ND	--	ND	
11/15/1999	78.18	11.32	0.00	66.86	--	ND	--	ND	1.04	ND	ND	--	ND	
5/22/2000	78.18	10.98	0.00	67.20	--	ND	--	ND	ND	ND	ND	--	ND	
11/22/2000	78.18	11.17	0.00	67.01	-0.19	ND	--	ND	ND	ND	ND	--	ND	
5/15/2001	78.18	10.93	0.00	67.25	--	ND	--	ND	ND	ND	ND	--	ND	
11/23/2001	78.18	11.08	0.00	67.10	--	ND<50	--	ND<0.50	ND<0.50	ND<0.50	ND<0.50	--	ND<5.0	
5/24/2002	78.18	10.58	0.00	67.60	--	ND<50	--	ND<0.50	ND<0.50	ND<0.50	ND<0.50	--	ND<5.0	

Date Sampled	TOC Elevation (feet)	Depth to Water (feet)	LPH Thickness (feet)	Ground-water Elevation (feet)	Change in Elevation (feet)	TPH-G (µg/l)	TPPH 8260B (µg/l)	Benzene (µg/l)	Toluene (µg/l)	Ethyl-benzene (µg/l)	Total Xylenes (µg/l)	MTBE 8021B (µg/l)	MTBE 8260B (µg/l)	Comments
MW-11 continued														
11/29/2002	78.18	11.27	0.00	66.91	--	ND<50	--	ND<0.50	ND<0.50	ND<0.50	ND<1.0	--	ND<2.0	
5/15/2003	78.18	10.25	0.00	67.93	--	ND<50	--	ND<0.50	ND<0.50	ND<0.50	ND<1.0	--	ND<2.0	
11/4/2003	78.18	11.23	0.00	66.95	--	--	ND<50	ND<0.50	ND<0.50	ND<0.50	ND<1.0	--	ND<2.0	
MW-12														
8/26/1992	79.89	--	--	--	--	ND	--	ND	ND	ND	ND	--	--	
11/20/1992	79.89	--	--	--	--	ND	--	ND	ND	ND	ND	--	--	
12/21/1992	79.89	12.11	0.00	67.78	--	--	--	--	--	--	--	--	--	
1/30/1993	79.89	13.18	0.00	66.71	--	--	--	--	--	--	--	--	--	
2/24/1993	79.89	12.13	0.00	67.76	--	ND	--	ND	ND	ND	ND	--	--	
3/22/1993	79.89	11.22	0.00	68.67	--	--	--	--	--	--	--	--	--	
4/28/1993	79.89	13.42	0.00	66.47	--	--	--	--	--	--	--	--	--	
5/25/1993	79.89	13.68	0.00	66.21	--	ND	--	ND	ND	ND	ND	--	--	
6/23/1993	79.61	14.56	0.00	65.05	--	--	--	--	--	--	--	--	--	
7/22/1993	79.61	14.96	0.00	64.65	--	--	--	--	--	--	--	--	--	
8/25/1993	79.61	13.61	0.00	66.00	--	ND	--	ND	ND	ND	ND	--	--	
9/22/1993	79.61	15.02	0.00	64.59	--	--	--	--	--	--	--	--	--	
10/28/1993	79.61	14.04	0.00	65.57	--	--	--	--	--	--	--	--	--	
11/30/1993	79.61	13.28	0.00	66.33	--	ND	--	ND	ND	ND	ND	--	--	
2/16/1994	79.61	12.76	0.00	66.85	--	ND	--	ND	ND	ND	ND	--	--	
5/31/1994	79.61	12.64	0.00	66.97	0.12	ND	--	ND	0.81	ND	0.82	--	--	
8/31/1994	79.61	12.82	0.00	66.79	-0.18	ND	--	ND	1.0	ND	1.0	--	ND	
9/27/1994	79.61	14.66	0.00	64.95	--	--	--	--	--	--	--	--	--	
10/11/1994	79.61	14.25	0.00	65.36	0.41	--	--	--	--	--	--	--	--	
11/10/1994	79.61	13.40	0.00	66.21	0.85	ND	--	ND	ND	ND	ND	--	--	
2/7/1995	79.61	11.72	0.00	67.89	1.68	--	--	--	--	--	--	--	--	
5/3/1995	79.61	13.38	0.00	66.23	--	ND	--	ND	ND	ND	ND	--	--	
8/3/1995	79.61	13.47	0.00	66.14	-0.09	--	--	--	--	--	--	--	--	
11/7/1995	79.61	12.78	0.00	66.83	--	ND	--	ND	ND	ND	ND	--	--	
5/6/1996	79.61	13.25	0.00	66.36	-0.47	--	--	--	--	--	--	--	--	

Date Sampled	TOC Elevation (feet)	Depth to Water (feet)	LPH Thickness (feet)	Ground-water Elevation (feet)	Change in Elevation (feet)	TPH-G (µg/l)	TPPH 8260B (µg/l)	Benzene (µg/l)	Toluene (µg/l)	Ethyl-benzene (µg/l)	Total Xylenes (µg/l)	MTBE 8021B (µg/l)	MTBE 8260B (µg/l)	Comments
RW-1 continued														
11/12/1993	80.63	9.00	--	71.63	--	--	--	--	--	--	--	--	--	
2/16/1994	80.63	7.82	0.00	72.81	--	--	--	--	--	--	--	--	--	
5/31/1994	80.63	8.81	0.00	71.82	-0.99	--	--	--	--	--	--	--	--	
8/31/1994	80.63	9.61	0.00	71.02	-0.80	--	--	--	--	--	--	--	--	
11/10/1994	80.63	6.34	0.00	74.29	--	--	--	--	--	--	--	--	--	
2/7/1995	80.63	7.18	0.00	73.45	-0.84	--	--	--	--	--	--	--	--	
3/14/1995	80.63	6.01	0.00	74.62	1.17	--	--	--	--	--	--	--	--	
11/7/1995	--	--	--	--	--	--	--	--	--	--	--	--	--	
10/15/2001	80.63	8.43	0.00	72.20	--	--	--	--	--	--	--	--	--	
11/23/2001	80.63	8.57	0.00	72.06	-0.14	--	--	--	--	--	--	--	--	
12/10/2001	80.63	8.51	0.00	72.12	0.06	--	--	--	--	--	--	--	--	
1/14/2002	80.63	8.13	0.00	72.50	0.38	--	--	--	--	--	--	--	--	
2/22/2002	80.63	6.18	0.00	74.45	1.95	--	--	--	--	--	--	--	--	
3/11/2002	80.63	6.31	0.00	74.32	-0.13	--	--	--	--	--	--	--	--	
4/15/2002	80.63	6.39	0.00	74.24	-0.08	--	--	--	--	--	--	--	--	
5/24/2002	80.63	8.14	0.00	72.49	-1.75	--	--	--	--	--	--	--	--	
6/17/2002	80.63	8.18	0.00	72.45	-0.04	--	--	--	--	--	--	--	--	
7/15/2002	80.63	8.29	0.00	72.34	-0.11	--	--	--	--	--	--	--	--	
8/19/2002	80.63	8.44	0.00	72.19	-0.15	--	--	--	--	--	--	--	--	
9/5/2002	80.63	8.47	0.00	72.16	-0.03	--	--	--	--	--	--	--	--	
10/7/2002	80.63	8.43	0.00	72.20	0.04	--	--	--	--	--	--	--	--	
11/29/2002	80.63	8.92	0.00	71.71	-0.49	--	--	--	--	--	--	--	--	
12/12/2002	80.63	8.87	0.00	71.76	0.05	--	--	--	--	--	--	--	--	
1/6/2003	80.63	8.66	0.00	71.97	0.21	--	--	--	--	--	--	--	--	
2/12/2003	80.63	8.39	0.00	72.24	0.27	--	--	--	--	--	--	--	--	
3/13/2003	80.63	8.06	0.00	72.57	0.33	--	--	--	--	--	--	--	--	
4/7/2003	80.63	8.09	0.00	72.54	-0.03	--	--	--	--	--	--	--	--	
5/15/2003	80.63	8.07	0.00	72.56	0.02	--	--	--	--	--	--	--	--	
6/12/2003	80.63	8.11	0.00	72.52	-0.04	--	--	--	--	--	--	--	--	

Date Sampled	TOC Elevation (feet)	Depth to Water (feet)	LPH Thickness (feet)	Ground-water Elevation (feet)	Change in Elevation (feet)	TPH-G (µg/l)	TPPH 8260B (µg/l)	Benzene (µg/l)	Toluene (µg/l)	Ethyl-benzene (µg/l)	Total Xylenes (µg/l)	MTBE 8021B (µg/l)	MTBE 8260B (µg/l)	Comments
RW-1 continued														
7/7/2003	80.63	8.13	0.00	72.50	-0.02	--	--	--	--	--	--	--	--	--
11/4/2003	80.63	9.97	0.00	70.66	-1.84	--	2600	11	ND<10	ND<10	ND<20	--	210	
Trip Blank														
5/4/1998	--	--	--	--	--	ND	--	ND	ND	ND	ND	--	ND	
11/11/1998	--	--	--	--	--	ND	--	ND	ND	ND	ND	--	ND	
5/20/1999	--	--	--	--	--	ND	--	ND	ND	ND	ND	--	ND	
11/15/1999	--	--	--	--	--	ND	--	ND	1.12	ND	ND	--	ND	
5/22/2000	--	--	--	--	--	ND	--	ND	ND	ND	ND	--	ND	
11/22/2000	--	--	--	--	--	ND	--	ND	ND	ND	ND	--	ND	
5/15/2001	--	--	--	--	--	ND	--	ND	ND	ND	ND	--	ND	
11/23/2001	--	--	--	--	--	ND<50	--	ND<0.50	ND<0.50	ND<0.50	ND<0.50	--	ND<5.0	
5/24/2002	--	--	--	--	--	ND<50	--	ND<0.50	ND<0.50	ND<0.50	ND<0.50	--	ND<5.0	

Table 3
SUMMARY OF ADDITIONAL CHEMICAL ANALYSIS RESULTS
76 Station 0746

Date Sampled	EDB (µg/l)	Pre-Purge DO (mg/l)	Post Purge DO (mg/l)	TAME 8260B (µg/l)	TBA 8260B (µg/l)	DIPE 8260B (µg/l)	ETBE 8260B (µg/l)	Ethanol 8015B (mg/l)	Ethanol 8260B (µg/l)	1,2 DCE (µg/l)
MW-1										
5/6/1996	--	5.21	4.13	--	--	--	--	--	--	--
11/5/1996	--	3.12	--	--	--	--	--	--	--	--
5/15/1997	--	3.92	--	--	--	--	--	--	--	--
11/12/1997	--	4.16	--	--	--	--	--	--	--	--
5/4/1998	--	3.84	--	--	--	--	--	--	--	--
11/11/1998	--	2.85	--	--	--	--	--	--	--	--
5/20/1999	--	3.3	--	ND	ND	ND	ND	ND	ND	--
11/15/1999	--	--	--	ND	ND	ND	ND	ND	ND	--
5/22/2000	--	--	--	ND	130	ND	ND	ND	ND	--
11/22/2000	--	--	--	ND	--	ND	ND	--	--	--
5/15/2001	--	--	--	ND	ND	ND	ND	ND	ND	--
11/23/2001	ND<2.9	--	--	ND<2.9	ND<57	ND<2.9	ND<2.9	ND<1,400	ND<1,400	ND<2.9
5/24/2002	ND<4.0	--	--	ND<4.0	ND<200	ND<4.0	ND<4.0	ND<1,000	ND<1,000	ND<4.0
11/29/2002	ND<10	--	--	ND<10	ND<500	ND<10	ND<10	ND<2,500	ND<2,500	ND<10
5/15/2003	ND<10	--	--	ND<10	ND<500	ND<10	ND<10	ND<2,500	ND<2,500	ND<10
11/4/2003	--	--	--	ND<4.0	ND<200	ND<4.0	ND<4.0	--	ND<1000	--
MW-2										
8/19/1995	--	--	2.77	--	--	--	--	--	--	--
5/15/1997	--	3.01	--	--	--	--	--	--	--	--
11/12/1997	--	3.27	--	--	--	--	--	--	--	--
5/4/1998	--	3.63	--	--	--	--	--	--	--	--
MW-3										
8/19/1995	--	--	2.06	--	--	--	--	--	--	--
11/7/1995	--	--	1.68	--	--	--	--	--	--	--
5/6/1996	--	3.18	3.4	--	--	--	--	--	--	--
11/5/1996	--	2.03	--	--	--	--	--	--	--	--

Date Sampled	EDB (µg/l)	Pre-Purge DO (mg/l)	Post Purge DO (mg/l)	TAME 8260B (µg/l)	TBA 8260B (µg/l)	DIPE 8260B (µg/l)	ETBE 8260B (µg/l)	Ethanol 8015B (mg/l)	Ethanol 8260B (µg/l)	1,2 DCE (µg/l)
MW-3 continued										
5/15/1997	--	3.08	--	--	--	--	--	--	--	--
5/4/1998	--	2.98	--	--	--	--	--	--	--	--
11/11/1998	--	2.22	--	--	--	--	--	--	--	--
5/20/1999	--	2.6	--	--	--	--	--	--	--	--
5/22/2000	--	--	--	ND	ND	ND	ND	--	ND	--
11/22/2000	--	--	--	ND	--	ND	ND	--	--	--
5/15/2001	--	--	--	ND	ND	ND	ND	--	ND	--
11/23/2001	ND<2.5	--	--	ND<2.5	79	ND<2.5	ND<2.5	--	ND<1,200	ND<2.5
5/24/2002	ND<2.0	--	--	ND<2.0	ND<100	ND<2.0	ND<2.0	--	ND<500	ND<2.0
11/29/2002	ND<100	--	--	ND<100	ND<5,000	ND<100	ND<100	--	ND<25,000	ND<100
5/15/2003	ND<20	--	--	ND<20	ND<1,000	ND<20	ND<20	--	ND<5,000	ND<20
11/4/2003	--	--	--	ND<80	ND<4000	ND<80	ND<80	--	ND<20000	--
MW-4										
8/19/1995	--	--	2.19	--	--	--	--	--	--	--
11/7/1995	--	--	8.43	--	--	--	--	--	--	--
5/6/1996	--	3.75	5.97	--	--	--	--	--	--	--
11/5/1996	--	2.11	--	--	--	--	--	--	--	--
5/15/1997	--	3.24	--	--	--	--	--	--	--	--
11/12/1997	--	3.11	--	--	--	--	--	--	--	--
5/4/1998	--	3.73	--	--	--	--	--	--	--	--
11/11/1998	--	4.33	--	--	--	--	--	--	--	--
5/20/1999	--	3.9	--	--	--	--	--	--	--	--
5/24/2002	ND<2.0	--	--	--	ND<100	--	--	--	ND<500	ND<2.0
11/29/2002	ND<2.0	--	--	--	ND<100	--	--	--	ND<500	ND<2.0
11/4/2003	--	--	--	--	--	--	--	--	ND<500	--
MW-5										
8/19/1995	--	--	2.09	--	--	--	--	--	--	--
11/7/1995	--	--	1.79	--	--	--	--	--	--	--
5/6/1996	--	2.91	1.8	--	--	--	--	--	--	--

Date Sampled	EDB (µg/l)	Pre-Purge DO (mg/l)	Post Purge DO (mg/l)	TAME 8260B (µg/l)	TBA 8260B (µg/l)	DIPE 8260B (µg/l)	ETBE 8260B (µg/l)	Ethanol 8015B (mg/l)	Ethanol 8260B (µg/l)	1,2 DCE (µg/l)
MW-5 continued										
11/5/1996	--	1.85	--	--	--	--	--	--	--	--
5/15/1997	--	2.1	--	--	--	--	--	--	--	--
11/12/1997	--	1.98	--	--	--	--	--	--	--	--
5/4/1998	--	1.69	--	--	--	--	--	--	--	--
5/22/2000	--	--	--	ND	ND	ND	ND	ND	ND	--
MW-6										
5/15/1997	--	2.9	--	--	--	--	--	--	--	--
5/4/1998	--	3.57	--	--	--	--	--	--	--	--
11/4/2003	--	--	--	ND<2.0	ND<100	ND<2.0	ND<2.0	--	ND<500	--
MW-7										
5/15/1997	--	2.21	--	--	--	--	--	--	--	--
5/4/1998	--	3.09	--	--	--	--	--	--	--	--
11/4/2003	--	--	--	--	--	--	--	--	ND<500	--
MW-8										
5/15/1997	--	2.88	--	--	--	--	--	--	--	--
5/20/1999	--	3.55	--	ND	--	ND	ND	--	ND	--
11/15/1999	--	--	--	ND	--	ND	ND	--	ND	--
11/4/2003	--	--	--	ND<4.0	ND<200	ND<4.0	ND<4.0	--	ND<1000	--
MW-9										
5/6/1996	--	4.23	3.25	--	--	--	--	--	--	--
11/5/1996	--	2.98	--	--	--	--	--	--	--	--
5/15/1997	--	3.04	--	--	--	--	--	--	--	--
11/12/1997	--	4.02	--	--	--	--	--	--	--	--
5/4/1998	--	3.41	--	--	--	--	--	--	--	--
11/11/1998	--	5.19	--	--	--	--	--	--	--	--
5/20/1999	--	4.46	--	--	--	--	--	--	--	--
MW-10										
5/15/1997	--	1.61	--	--	--	--	--	--	--	--
5/4/1998	--	2.85	--	--	--	--	--	--	--	--

Date Sampled	EDB (µg/l)	Pre-Purge DO (mg/l)	Post Purge DO (mg/l)	TAME 8260B (µg/l)	TBA 8260B (µg/l)	DIPE 8260B (µg/l)	ETBE 8260B (µg/l)	Ethanol 801 5B (mg/l)	Ethanol 8260B (µg/l)	1,2 DCE (µg/l)
MW-10 continued										
11/4/2003	--	--	--	--	--	--	--	--	ND<500	--
MW-11										
5/15/1997	--	1.68	--	--	--	--	--	--	--	--
5/4/1998	--	2.94	--	--	--	--	--	--	--	--
5/20/1999	--	3.22	--	--	--	--	--	--	--	--
11/4/2003	--	--	--	--	--	--	--	--	ND<500	--
MW-12										
5/15/1997	--	2.10	--	--	--	--	--	--	*	--
5/4/1998	--	3.41	--	--	--	--	--	--	--	--
11/4/2003	--	--	--	ND<2.0	ND<100	ND<2.0	ND<2.0	--	ND<500	--
RW-1										
11/7/1995	--	--	2.13	--	--	--	--	--	--	--
11/4/2003	--	--	--	ND<40	ND<2000	ND<40	ND<40	--	ND<10000	--

FIGURES

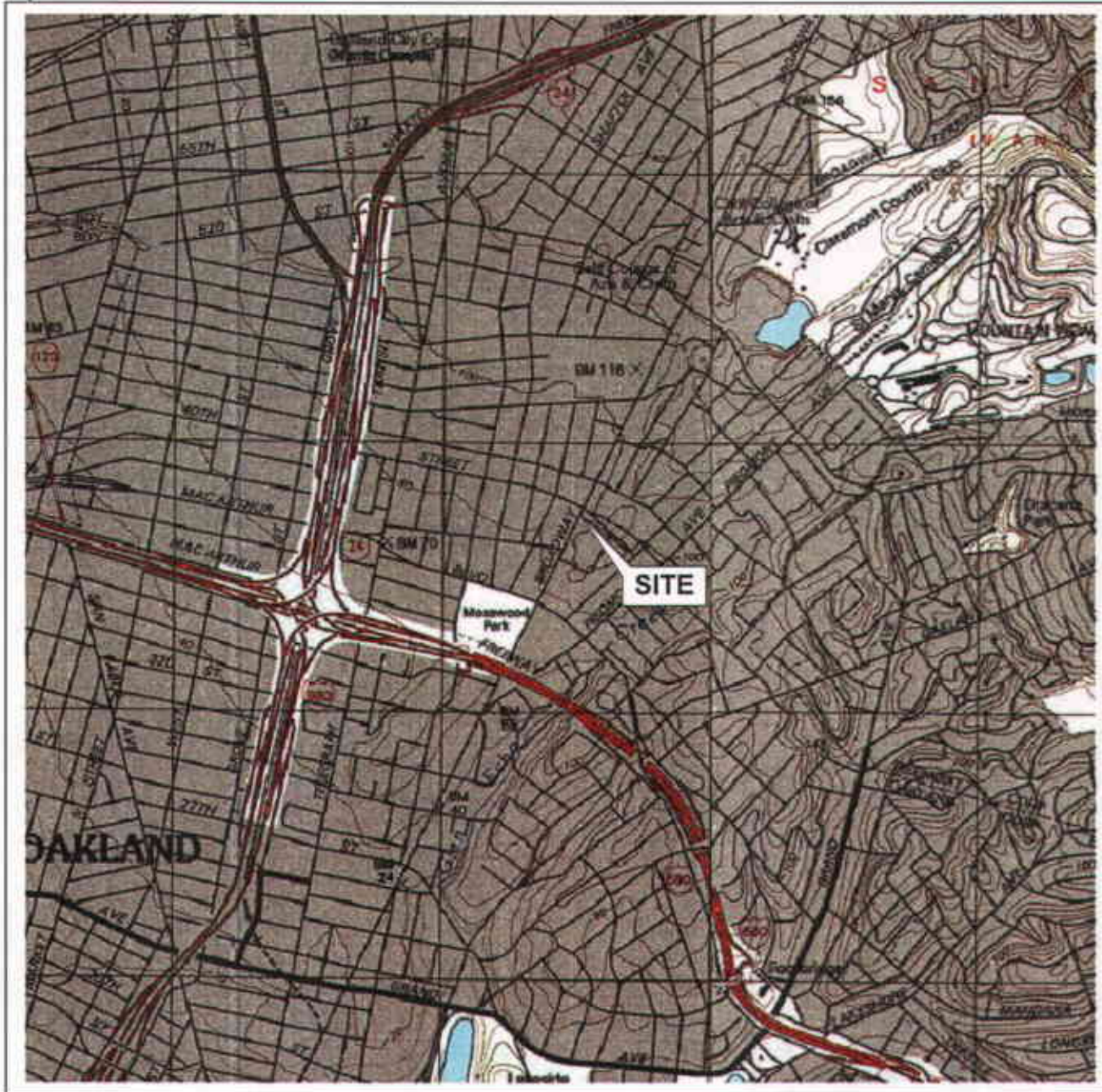

0 1/4 1/2 3/4 1 MILE



SCALE 1: 24,000



SOURCE:

United States Geological Survey
7.5 Minute Topographic Maps:
Placerville Quadrangle



VICINITY MAP

76 Station 0746
3943 Broadway
Oakland, California

FIGURE 1

PS = 1:1

TRC



BUILDING | BUILDING | BUILDING

40TH STREET

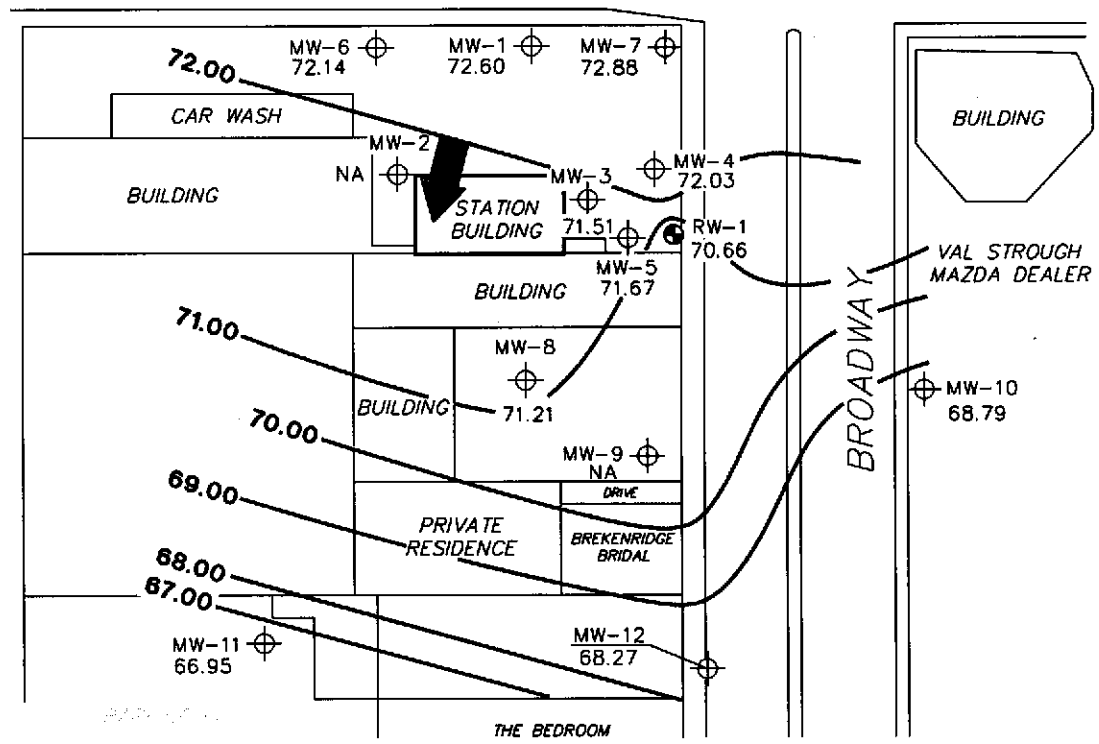

LEGEND

- MW-12 Monitoring Well with Groundwater Elevation (feet)
- RW-1 Recovery Well with Groundwater Elevation (feet)
- 72.00 Groundwater Elevation Contour
- General Direction of Groundwater Flow

NOTES:
 Contour lines are interpretive and based on fluid levels measured in monitoring wells. Elevations are in feet above mean sea level.

**GROUNDWATER ELEVATION
 CONTOUR MAP
 November 4, 2003**

76 Station 0746
 3943 Broadway
 Oakland, California

FIGURE 2

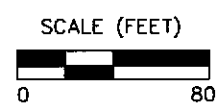

PS=1:1

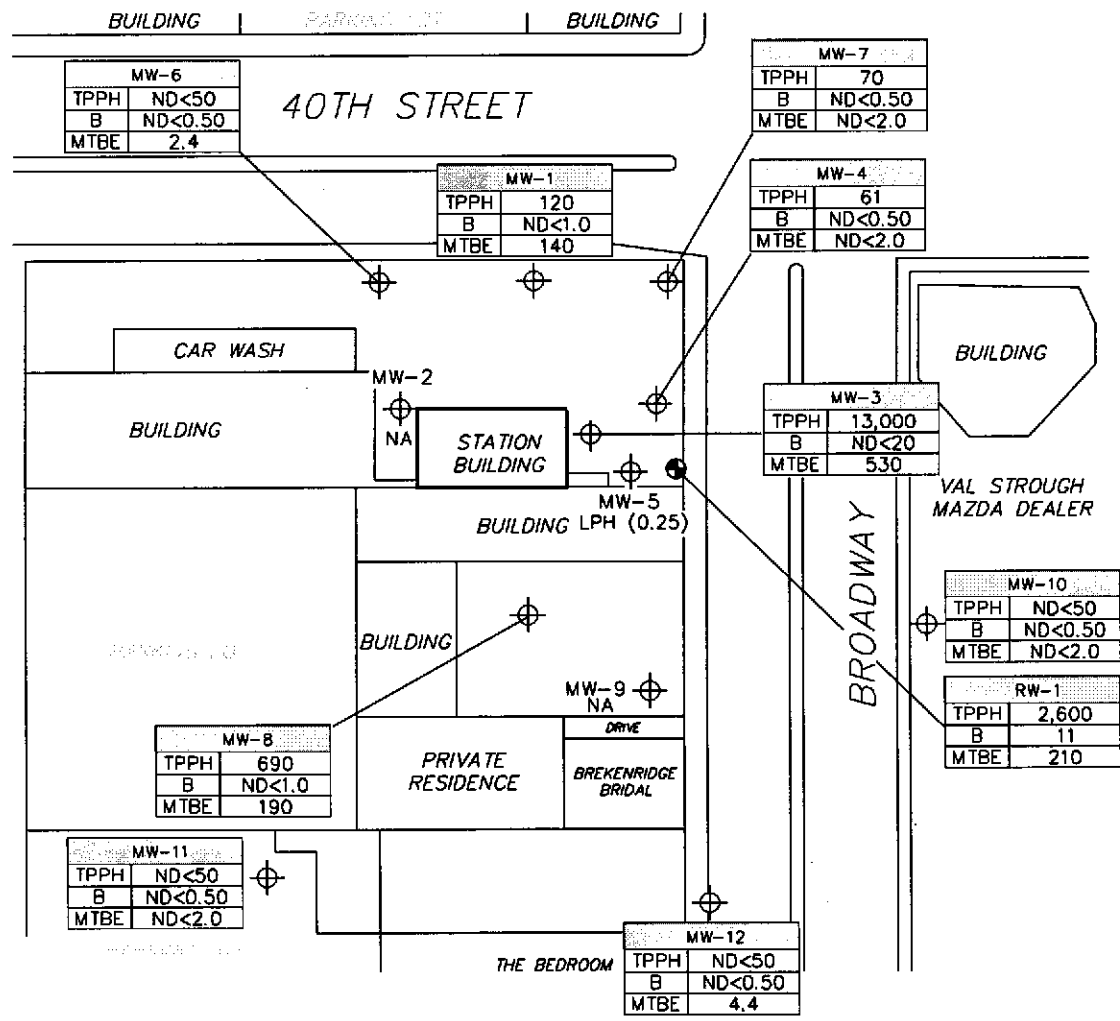

LEGEND

Well No.	TPPH	B	MTBE
	μg/l	μg/l	μg/l

Monitoring Well or Recovery Well with Dissolved-Phase Hydrocarbon Concentrations (μg/l) or LPH Thickness (feet)

NOTES:

TPPH = total purgeable petroleum hydrocarbons. B = benzene. MTBE = methyl tertiary butyl ether. LPH = liquid-phase hydrocarbons. μg/l = micrograms per liter. ND = not detected at limit indicated on official laboratory report. NA = not analyzed, measured, or collected. MTBE results obtained using EPA Method 8260B.

DISSOLVED-PHASE HYDROCARBON CONCENTRATIONS MAP
November 4, 2003

76 Station 0746
3943 Broadway
Oakland, California

TRC

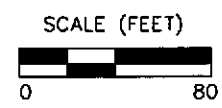
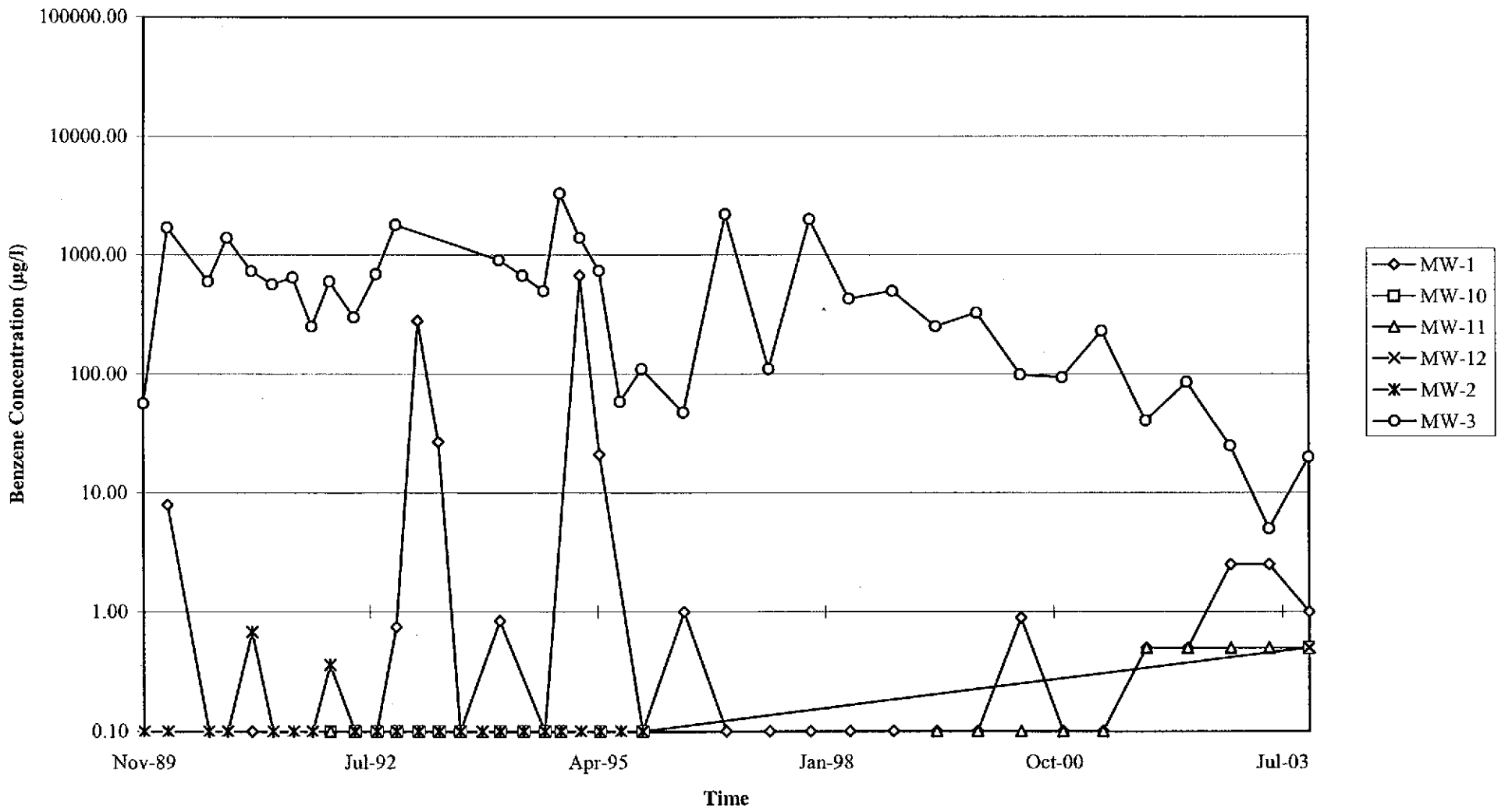

FIGURE 3

P.S=1:1

GRAPHS

Graph 1
Benzene Concentrations vs. Time
76 Station 0746



Graph 2
Benzene Concentrations vs. Time
76 Station 0746

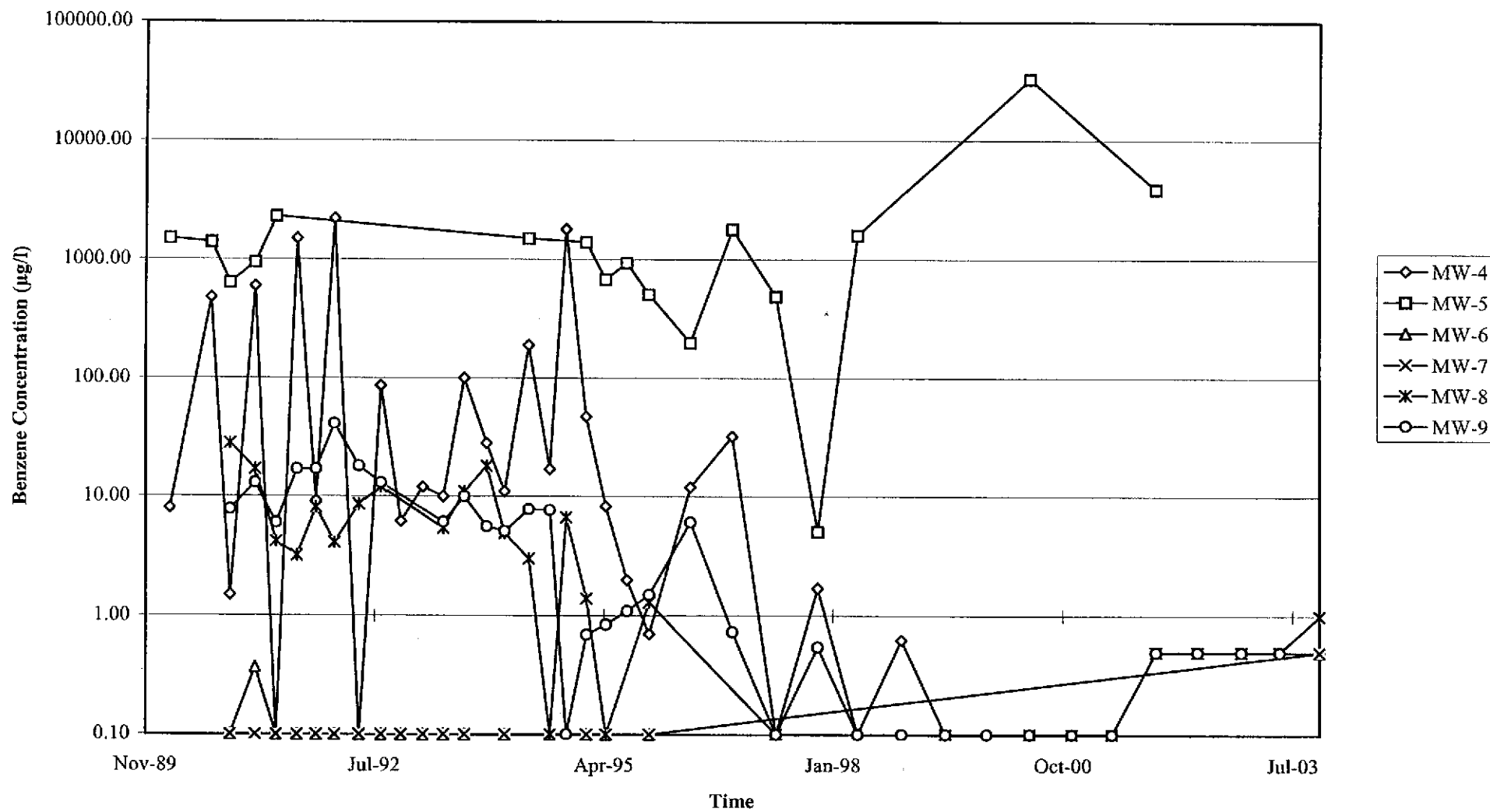

Graph 3
Benzene Concentrations vs. Time
76 Station 0746

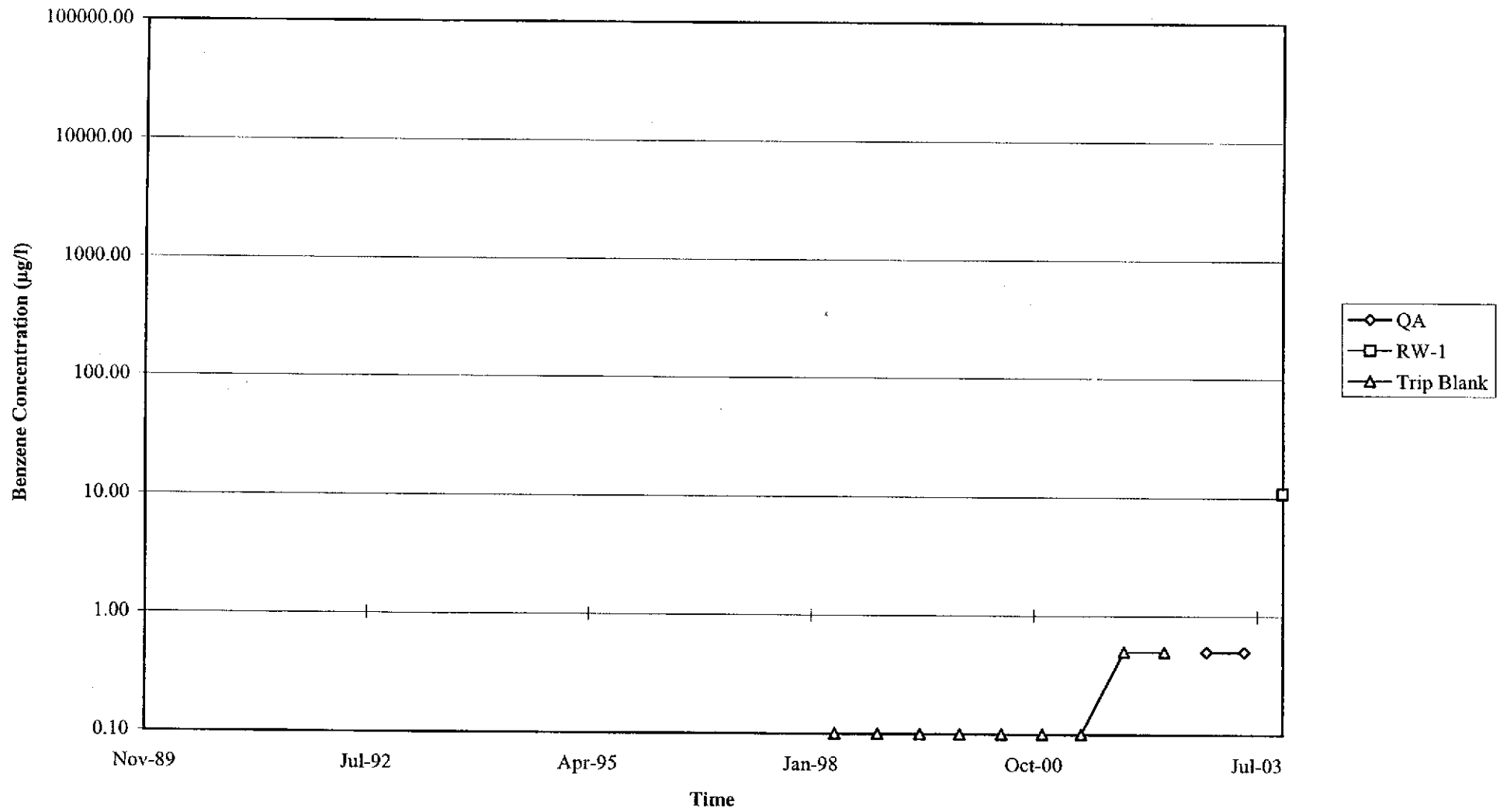

Graph 4
Hydrograph
76 Station 0746

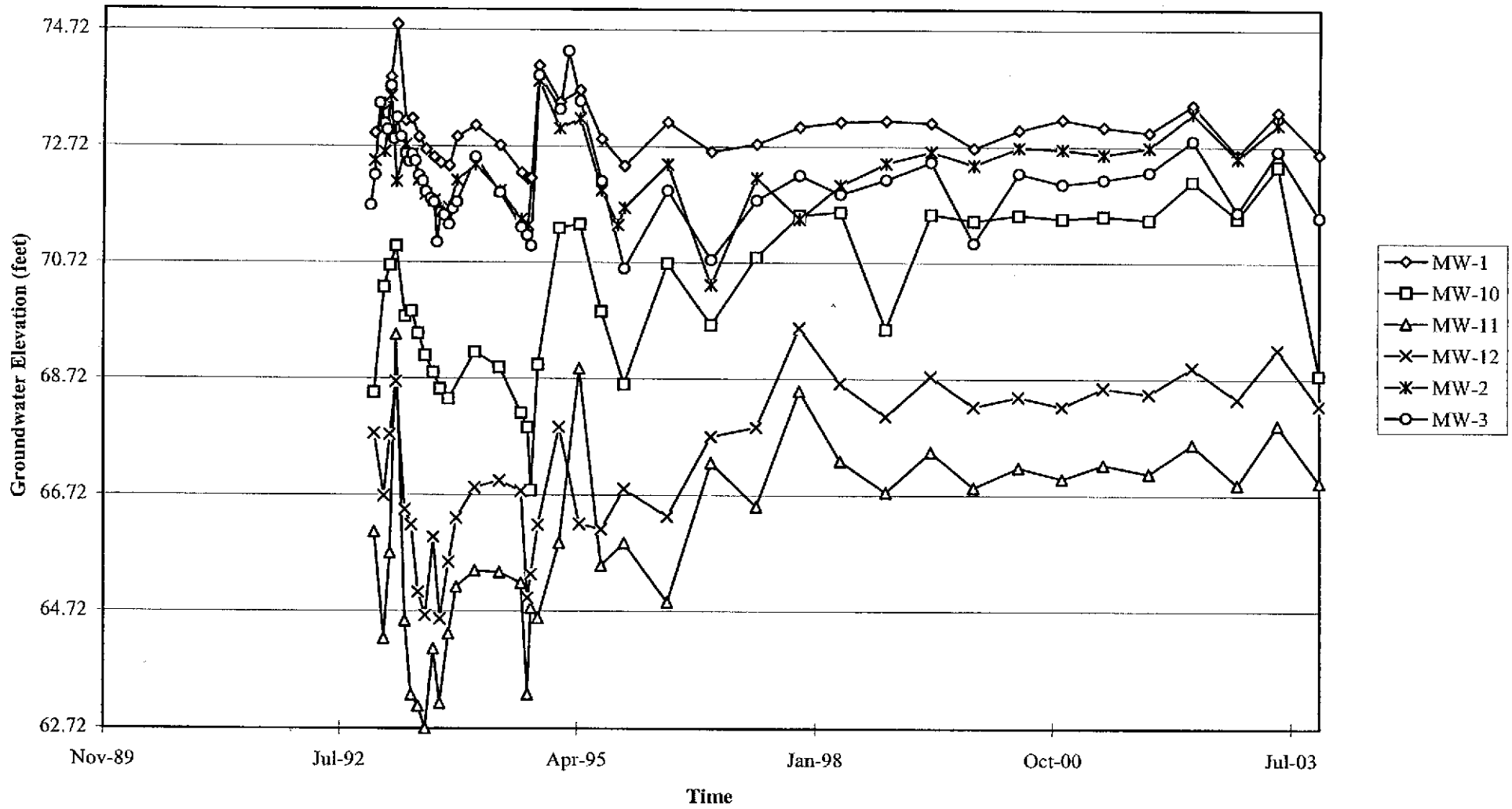

Graph 5
Hydrograph
76 Station 0746

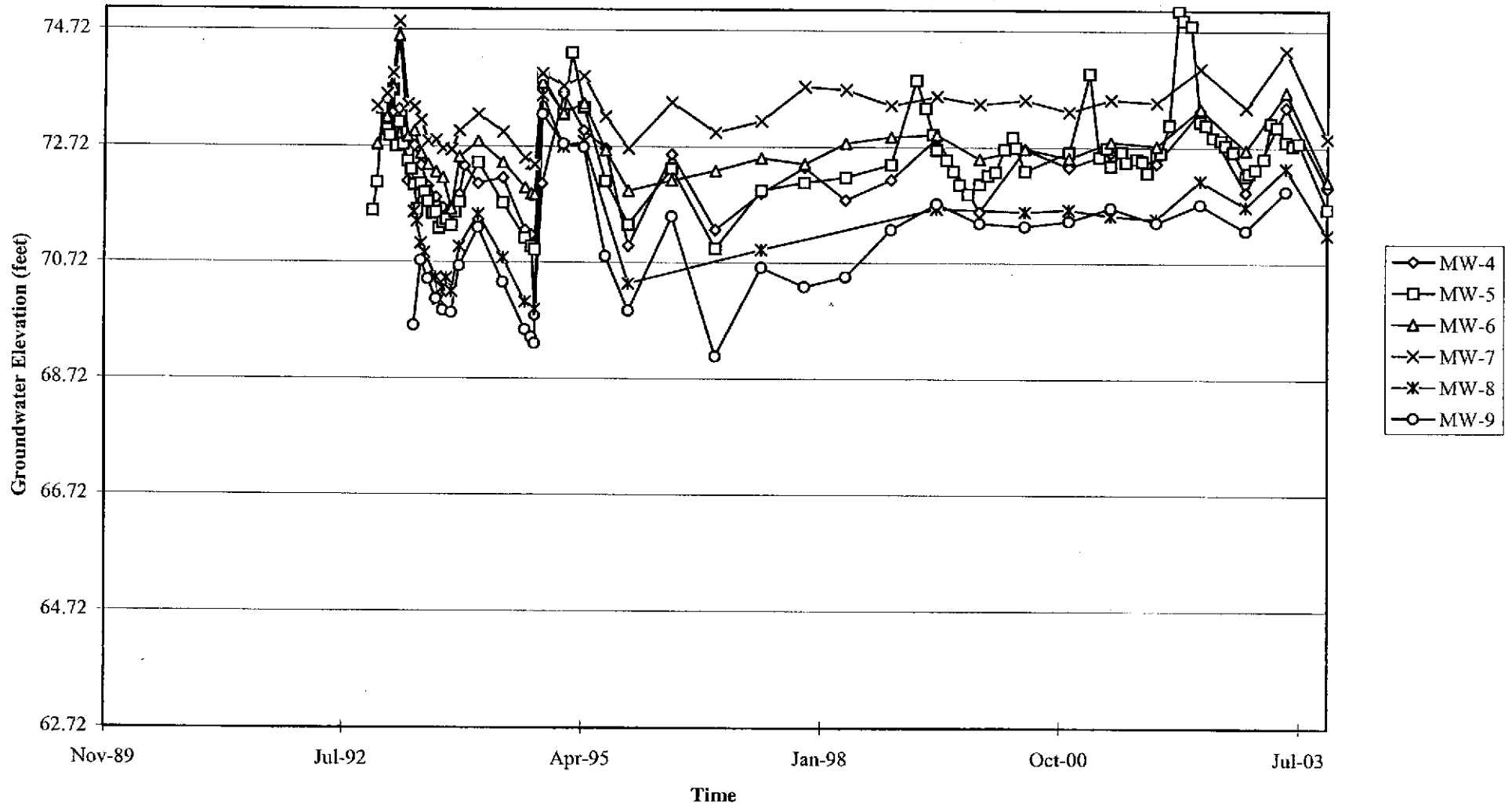

Graph 6
 Hydrograph
 76 Station 0746

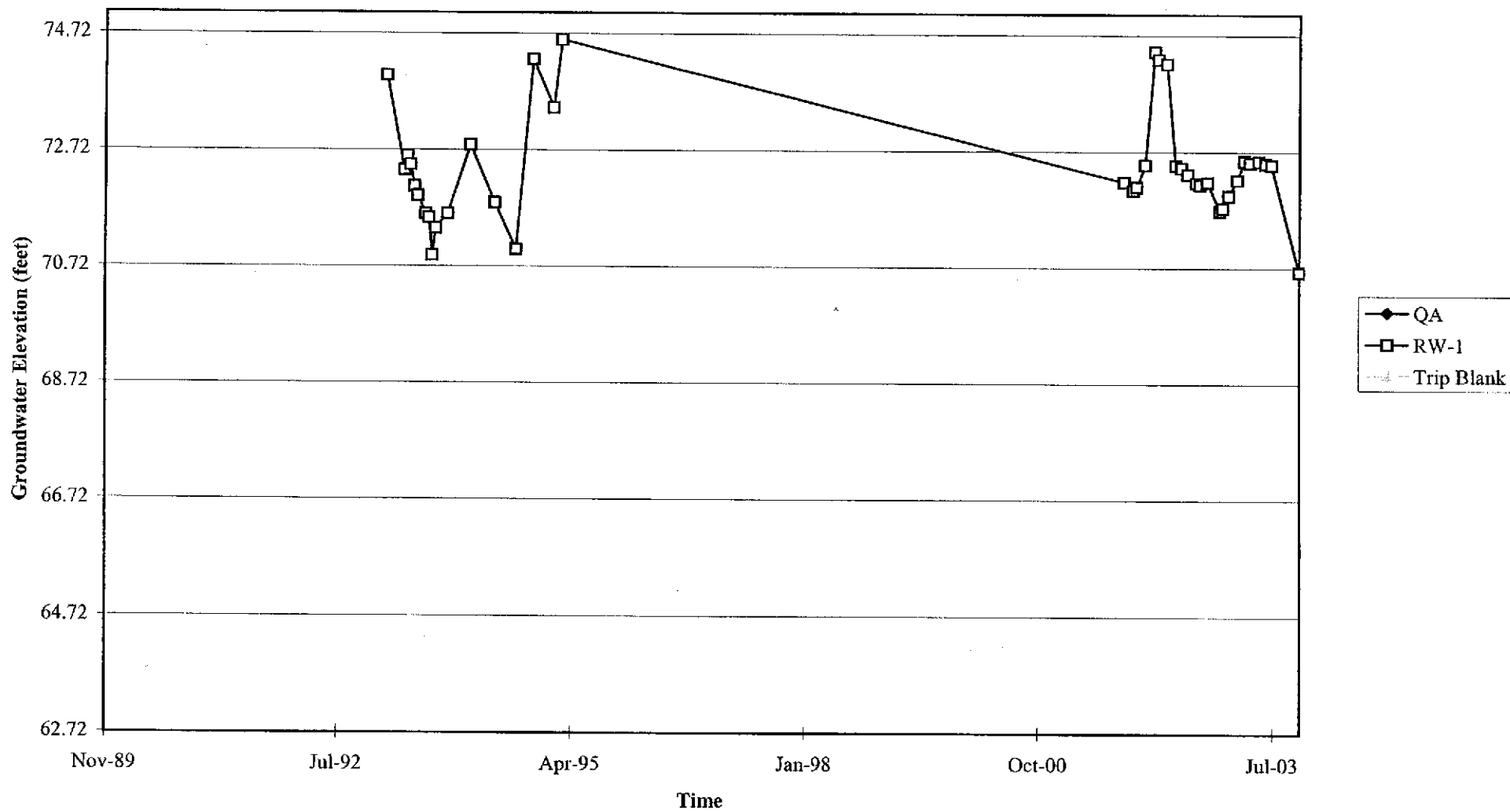

GENERAL FIELD PROCEDURES

Groundwater Monitoring and Sampling Assignments

For each site, TRC technicians are provided with a Technical Service Request (TSR) that specifies activities required to complete the groundwater monitoring and sampling assignment for the site. TSRs are based on client directives, instructions from the primary environmental consultant for the site, regulatory requirements, and TRC's previous experience with the site.

Fluid Level Measurements

Initial site activities include determination of well locations based on a site map provided with the TSR. Well boxes are opened and caps are removed. Indications of well or well box damage, or of pressure buildup in the well are noted.

Fluid levels in each well are measured using a coated cloth tape equipped with an electronic interface probe, which distinguishes between liquid phase hydrocarbon (LPH) and water. The depth to LPH (if it is present), to water, and to the bottom of the well are measured from the top of the well casing (surveyors mark or notch if present) to the nearest 0.01 foot. If the difference between the measured top of water and the measured bottom of the well casing is less than 0.67 foot, the well is considered to be dry, and is not sampled. If the well contains 0.67 foot or more of water, an attempt is made to bail and/or sample as specified on the TSR.

Wells that are found to contain LPH are not purged or sampled. Instead, one casing volume of fluid is bailed from the well and the well is re-sealed. Bailed fluids are placed in a container separate from normal purge water, and properly disposed.

Purging and Groundwater Parameter Measurement

TSR instructions may specify that a well not be purged (no-purge sampling), be purged using low-flow methods, or be purged using conventional pump and/or bail methods. Conventional purging generally consists of pumping or bailing until a minimum of three casing volumes of water have been removed or until the well has been pumped dry. Pumping is generally accomplished using submersible electric or pneumatic diaphragm pumps.

During conventional purging, three groundwater parameters (temperature, pH, and conductivity) are measured after removal of each casing volume. Stabilization of these parameters, to within 10 percent, confirm that sufficient purging has been completed. In some cases, the TSR indicates that other parameters are also to be measured during purging. TRC commonly measures dissolved oxygen (DO), oxidation-reduction potential (ORP), and/or turbidity. Instruments used for groundwater parameter measurement are calibrated daily according to manufacturer's instructions.

Low-flow purging utilizes a bladder or peristaltic pump to remove water from the well at a low rate. Groundwater parameters specified by the TSR are measured continuously until they become stable in general accordance with EPA guidelines.

Purge water is generally collected in labeled drums for disposal. Drums may be left on site for disposal by others, or transported to a collection location for eventual transfer to a licensed treatment or recycling facility. In some cases, purge water may be collected directly from the site by a licensed vacuum truck company, or may be treated on site by an active remediation system, if so directed.

Groundwater Sample Collection

After wells are purged, or not purged, according to TSR instructions, samples are collected for laboratory analysis. For wells that have been purged using conventional pump or bail methods, sampling is conducted after the well has recovered to 80 percent of its original volume or after two hours if the well does not recover to at least 80 percent. If there is insufficient recharge of water in the well after two hours, the well is not sampled.

Samples are collected by lowering a new, disposable, ½-inch to 4-inch polyethylene bottom-fill bailer to just below the water level in the well. The bailer is retrieved and the water sample is carefully transferred to containers specified for the laboratory analytical methods indicated by the TSR. Particular care is given to containers for volatile organic analysis (VOAs) which require filling to zero headspace and fitting with Teflon-sealed caps.

After filling, all containers are labeled with project number (or site number), well designation, sample date, and the samplers initials, and placed in an insulated chest with ice. Samples remain chilled prior to and during transport to a state-certified laboratory for analysis. Sample container descriptions and requested analyses are entered onto a chain-of-custody form in order to provide instructions to the laboratory. The chain-of-custody form accompanies the samples during transportation to provide a continuous record of possession from the field to the laboratory. If a freight or overnight carrier transports the samples, the carrier is noted on the form.

For wells that have been purged using low-flow methods, sample containers are filled from the effluent stream of the bladder or peristaltic pump. In some cases, if so specified by the TSR, samples are taken from the sample ports of actively pumping remediation wells.

Sequence of Gauging, Purging, and Sampling

The sequence in which monitoring activities are conducted are specified on the TSR. In general, wells are gauged beginning with the least-affected well and ending with the well that has highest concentration based on previous analytic results. After all gauging for the site is completed, wells are purged and/or sampled from the least-affected well to the most-affected well.

Decontamination

In order to reduce the possibility of cross-contamination between wells, strict isolation and decontamination procedures are observed. Portable pumps are not used in wells with LPH. Technicians wear nitrile gloves during all gauging, purging and sampling activities. Gloves are changed between wells and more often if warranted. Any equipment that could come in contact with fluids are either dedicated to a particular well, decontaminated prior to each use, or discarded after a single use. Decontamination consists of washing in a solution of Liqui-nox and water and rinsing twice. The final rinse is in deionized water.

Exceptions

Additional tasks or non-standard procedures, if any, that may be requested or required for a particular site, and noted on the site TSR, are documented in field notes on the following pages.

FIELD MONITORING DATA SHEET



Technician: R. Cormier Job #/Task #: 410500-01FA20

Date: 11-04-03

Site # 0746 Project Manager Kathie DesKit

Page 1 of 1

Well #	Grade	TOC	Total Depth	Depth to Water	Depth to Product	Product Thickness (feet)	Time Sampled	Misc. Well Notes
MW-12		X	17.53	11.34	Ø	Ø	0816	2"
MW-4		X	19.91	9.45	Ø	Ø	0949	2"
RW-1		X	16.11	9.97	Ø	Ø	0916	6"
MW-5		X	19.73	9.90	9.65	.25	N/A	2"
MW-7		X	19.90	8.76	Ø	Ø	0935	2"
MW-3		X	22.33	9.90	Ø	Ø	0909	2"
MW-1		X	19.53	7.94	Ø	Ø	10 11	2"
MW-6		X	19.50	7.80	Ø	Ø	1228	2"
MW-10		X	21.63	12.82	Ø	Ø	1240	2"
MW-11		X	19.04	11.83	Ø	Ø	1121	2"
MW-8		X	21.70	10.20	Ø	Ø	1607	2"
mw-2		-	-	-	-	-	N/A	unable to open screws stripped
mw-9		-	-	-	-	-	N/A	car on well

FIELD DATA COMPLETE	QA/QC	COC	WELL BOX CONDITION SHEETS
WTT CERTIFICATE	MANIFEST	DRUM INVENTORY	TRAFFIC CONTROL

GROUNDWATER SAMPLING FIELD NOTES

Site: 0746 Technician: R. Cormier
 Project No.: 410500-01 Date: 11-4-03
 Well No.: RW-1 Purge Method: Dia
 Depth to Water (feet): 9.97 Depth to Product (feet): 0
 Total Depth (feet): 16.11 LPH & Water Recovered (gallons): 0
 Water Column (feet): 6.14 Casing Diameter (Inches): 6"
 80% Recharge Depth (feet): 11.19 1 Well Volume (gallons): 9

Time Start	Time Stop	Depth To Water (feet)	Volume Purged (gallons)	Conductivity (uS/cm)	Temperature (F, C)	pH	Turbidity	D.O.
0757			9	952	19.2	6.98		
			18	970	16.9	6.98		
	0807		27	978	19.6	6.98		
Static at Time Sampled		Total Gallons Purged			Time Sampled			
1050		27			0916			
Comments:								

Well No.: _____ Purge Method: _____
 Depth to Water (feet): _____ Depth to Product (feet): _____
 Total Depth (feet): _____ LPH & Water Recovered (gallons): _____
 Water Column (feet): _____ Casing Diameter (Inches): _____
 80% Recharge Depth (feet): _____ 1 Well Volume (gallons): _____

Time Start	Time Stop	Depth To Water (feet)	Volume Purged (gallons)	Conductivity (uS/cm)	Temperature (F, C)	pH	Turbidity	D.O.
Static at Time Sampled		Total Gallons Purged			Time Sampled			
Comments:								

GROUNDWATER SAMPLING FIELD NOTES

Site: 0746 Technician: R. Cormier
 Project No.: 410500-01 Date: 11-04-03
 Well No.: MW-3 Purge Method: Hand Bail
 Depth to Water (feet): 9.90 Depth to Product (feet): Ø
 Total Depth (feet): 22.33 LPH & Water Recovered (gallons): Ø
 Water Column (feet): 12.43 Casing Diameter (Inches): 2"
 80% Recharge Depth (feet): 12.38 1 Well Volume (gallons): 2

Time Start	Time Stop	Depth To Water (feet)	Volume Purged (gallons)	Conductivity (uS/cm)	Temperature (F, C)	pH	Turbidity	D.O.
0851			2	998	21.3	6.97		
			4	1011	20.9	6.97		
	0902		6	1019	21.1	6.97		
Static at Time Sampled			Total Gallons Purged			Time Sampled		
10.75			6			0909		
Comments:								

Well No.: MW-7 Purge Method: Dia
 Depth to Water (feet): 8.76 Depth to Product (feet): Ø
 Total Depth (feet): 19.90 LPH & Water Recovered (gallons): Ø
 Water Column (feet): 11.14 Casing Diameter (Inches): 2"
 80% Recharge Depth (feet): 10.98 1 Well Volume (gallons): 2

Time Start	Time Stop	Depth To Water (feet)	Volume Purged (gallons)	Conductivity (uS/cm)	Temperature (F, C)	pH	Turbidity	D.O.
0925			2	815	32.7	6.96		
			4	813	21.8	6.95		
	0931		6	572	21.6	6.96		
Static at Time Sampled			Total Gallons Purged			Time Sampled		
10.28			6			0935		
Comments:								

GROUNDWATER SAMPLING FIELD NOTES

Site: 0746 Technician: R. Cornter
 Project No.: 410500-01 Date: 11-04-03

Well No.: MW-10 Purge Method: Dia
 Depth to Water (feet): 12.82 Depth to Product (feet): 6
 Total Depth (feet): 21.63 LPH & Water Recovered (gallons): 0
 Water Column (feet): 8.81 Casing Diameter (Inches): 2.11
 80% Recharge Depth (feet): 14.58 1 Well Volume (gallons): 1

Time Start	Time Stop	Depth To Water (feet)	Volume Purged (gallons)	Conductivity (uS/cm)	Temperature (F, C)	pH	Turbidity	D.O.
1034			1	580	20.2	6.98		
			2	589	18.4	6.98		
	1040	1040	3	609	19.0	6.98		
Static at Time Sampled		Total Gallons Purged			Time Sampled			
14.30		3			1240			
Comments: <u>Well didnt recover within a 2 hr period,</u>								

Well No.: MW-11 Purge Method: Dia
 Depth to Water (feet): 11.23 Depth to Product (feet): 0
 Total Depth (feet): 19.04 LPH & Water Recovered (gallons): 0
 Water Column (feet): 7.81 Casing Diameter (Inches): 2
 80% Recharge Depth (feet): 12.79 1 Well Volume (gallons): 1

Time Start	Time Stop	Depth To Water (feet)	Volume Purged (gallons)	Conductivity (uS/cm)	Temperature (F, C)	pH	Turbidity	D.O.
11.09			1	900	17.8	7.00		
			2	919	17.4	6.99		
	1114		3	913	17.2	6.99		
Static at Time Sampled		Total Gallons Purged			Time Sampled			
12.00		3			1121			
Comments:								

GROUNDWATER SAMPLING FIELD NOTES

Technician: _____

Site: 0746

Project No.: 410500-01

Date: 11-04-03

Well No.: MW-1

Purge Method: Dia

Depth to Water (feet): 7.94

Depth to Product (feet): 0

Total Depth (feet): 19.53

LPH & Water Recovered (gallons): 0

Water Column (feet): 11.59

Casing Diameter (Inches): 2

80% Recharge Depth (feet): 10.25

1 Well Volume (gallons): 2

Time Start	Time Stop	Depth To Water (feet)	Volume Purged (gallons)	Conductivity (uS/cm)	Temperature (F, C)	pH	Turbidity	D.O.
0958			2	764	17.2	6.98		
			4	745	20.3	6.97		
	10.05		6	734	16.8	6.97		
Static at Time Sampled			Total Gallons Purged			Time Sampled		
0 8.75			6			10.11		
Comments:								

Well No.: MW-6

Purge Method: Dia

Depth to Water (feet): 7.80

Depth to Product (feet): 0

Total Depth (feet): 19.50

LPH & Water Recovered (gallons): 0

Water Column (feet): 11.70

Casing Diameter (Inches): 2"

80% Recharge Depth (feet): 10.14

1 Well Volume (gallons): 2

Time Start	Time Stop	Depth To Water (feet)	Volume Purged (gallons)	Conductivity (uS/cm)	Temperature (F, C)	pH	Turbidity	D.O.
1018			2	1164	20.6	6.99		
			4	1166	20.3	6.98		
	10.25		6	1135	16.6	6.97		
Static at Time Sampled			Total Gallons Purged			Time Sampled		
8:00			6			12.28		
Comments: <u>didn't recover in 2 hrs Well</u>								

GROUNDWATER SAMPLING FIELD NOTES

Site: 0746 Technician: R. Cormier
 Project No.: 410500-01 Date: 11-04-03

Well No.: MW-12 Purge Method: Dia
 Depth to Water (feet): 11.34 Depth to Product (feet): 0
 Total Depth (feet): 17.53 LPH & Water Recovered (gallons): 0
 Water Column (feet): 6.19 Casing Diameter (Inches): 2"
 80% Recharge Depth (feet): 12.57 1 Well Volume (gallons): 1

Time Start	Time Stop	Depth To Water (feet)	Volume Purged (gallons)	Conductivity (uS/cm)	Temperature (F, C)	pH	Turbidity	D.O.
<u>0550</u>			<u>1</u>	<u>721</u>	<u>12.0</u>	<u>7.03</u>		
			<u>2</u>	<u>714</u>	<u>17.9</u>	<u>7.01</u>		
	<u>0556</u>		<u>3</u>	<u>717</u>	<u>17.3</u>	<u>7.00</u>		
Static at Time Sampled		Total Gallons Purged		Time Sampled				
<u>15.51</u>		<u>3</u>		<u>0816</u>				
Comments: <u>Well didnt recover within 2hr period.</u>								

Well No.: MW-4 Purge Method: Dia
 Depth to Water (feet): 9.45 Depth to Product (feet): 0
 Total Depth (feet): 19.91 LPH & Water Recovered (gallons): 0
 Water Column (feet): 9.45 Casing Diameter (Inches): 2"
 80% Recharge Depth (feet): 12.35 1 Well Volume (gallons): 2

Time Start	Time Stop	Depth To Water (feet)	Volume Purged (gallons)	Conductivity (uS/cm)	Temperature (F, C)	pH	Turbidity	D.O.
<u>0743</u>			<u>2</u>	<u>1321</u>	<u>19.2</u>	<u>7.00</u>		
			<u>4</u>	<u>1353</u>	<u>18.2</u>	<u>7.00</u>		
	<u>0748</u>		<u>6</u>	<u>1357</u>	<u>16.9</u>	<u>7.00</u>		
Static at Time Sampled		Total Gallons Purged		Time Sampled				
<u>13.44</u>		<u>6</u>		<u>0949</u>				
Comments: <u>Well didnt recover within 2hr period</u>								

GROUNDWATER SAMPLING FIELD NOTES

Site: 0746

Technician: R Cormier

Project No.: 410500-01

Date: 11-04-03

Well No.: MW-8

Purge Method: Hand Bail

Depth to Water (feet): 10.20

Depth to Product (feet): Ø

Total Depth (feet): 21.70

LPH & Water Recovered (gallons): Ø

Water Column (feet): 11.50

Casing Diameter (Inches): 2"

80% Recharge Depth (feet): 12.50

1 Well Volume (gallons): 2

Time Start	Time Stop	Depth To Water (feet)	Volume Purged (gallons)	Conductivity (uS/cm)	Temperature (F, C)	pH	Turbidity	D.O.
1505			2	910	16.8	7.00		
			4	1028	17.4	6.99		
	1550		6	1003	12.0	7.01		

Static at Time Sampled	Total Gallons Purged	Time Sampled
1140	6	1607

Comments: _____

Well No.: _____
 Depth to Water (feet): _____
 Total Depth (feet): _____
 Water Column (feet): _____
 80% Recharge Depth (feet): _____

Purge Method: _____
 Depth to Product (feet): _____
 LPH & Water Recovered (gallons): _____
 Casing Diameter (Inches): _____
 1 Well Volume (gallons): _____

Time Start	Time Stop	Depth To Water (feet)	Volume Purged (gallons)	Conductivity (uS/cm)	Temperature (F, C)	pH	Turbidity	D.O.

Static at Time Sampled	Total Gallons Purged	Time Sampled

Comments: _____

MANUAL PUMP/BAIL OUT SHEET

Site #: 0746 Project #: 40500-01 Date: 11-21-03
 Technician: Jeremy K Page #: 1 of 1

Monitoring Data Before Pump/Bail Out

Well Number MW-5
 Depth to Product 9.37
 Depth to Water 9.56
 Total Depth of Well 19.74
 Feet of Total Fluid in Well 10.37
 Thickness of Product (ft.) 0.19
 Well Diameter (in.) 2"
 One Well Volume (gal.) 2

Pump/Bail One Well Volume

Water Recovered (gal.) 1.97
 Product Recovered (gal.) .03
THICKNESS OF PRODUCT x (0.67 FOR 4" CASING) OR (0.17 FOR 2" CASING) OR (1.5 FOR 6" CASING)
 Time Required for Purge 10 min
 Comments: 1/2 gallon removed from skimmer mostly water

Monitoring Data Before Pump/Bail Out

Well Number _____
 Depth to Product _____
 Depth to Water _____
 Total Depth of Well _____
 Feet of Total Fluid in Well _____
 Thickness of Product (ft.) _____
 Well Diameter (in.) _____
 One Well Volume (gal.) _____

Pump/Bail One Well Volume

Water Recovered (gal.) _____
 Product Recovered (gal.) _____
THICKNESS OF PRODUCT x (0.67 FOR 4" CASING) OR (0.17 FOR 2" CASING) OR (1.5 FOR 6" CASING)
 Time Required for Purge _____
 Comments: _____

Monitoring Data Before Pump/Bail Out

Well Number _____
 Depth to Product _____
 Depth to Water _____
 Total Depth of Well _____
 Feet of Total Fluid in Well _____
 Thickness of Product (ft.) _____
 Well Diameter (in.) _____
 One Well Volume (gal.) _____

Pump/Bail One Well Volume

Water Recovered (gal.) _____
 Product Recovered (gal.) _____
THICKNESS OF PRODUCT x (0.67 FOR 4" CASING) OR (0.17 FOR 2" CASING) OR (1.5 FOR 6" CASING)
 Time Required for Purge _____
 Comments: _____

Monitoring Data Before Pump/Bail Out

Well Number _____
 Depth to Product _____
 Depth to Water _____
 Total Depth of Well _____
 Feet of Total Fluid in Well _____
 Thickness of Product (ft.) _____
 Well Diameter (in.) _____
 One Well Volume (gal.) _____

Pump/Bail One Well Volume

Water Recovered (gal.) _____
 Product Recovered (gal.) _____
THICKNESS OF PRODUCT x (0.67 FOR 4" CASING) OR (0.17 FOR 2" CASING) OR (1.5 FOR 6" CASING)
 Time Required for Purge _____
 Comments: _____

Fluids from all of today's Manual Pump/Bail Outs were pumped into:

1) The ARS 2) Properly Labeled Drums 3) Other _____

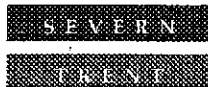

STL

Submission#: 2003-11-0258

TRC Alton Geoscience

November 19, 2003

21 Technology Drive
Irvine, CA 92718

Attn.: Anju Farfan

Project#: 41050001FA20

Project: Conoco Phillips #0746

Site: 3943 Broadway, Oakland

Attached is our report for your samples received on 11/06/2003 15:25

This report has been reviewed and approved for release. Reproduction of this report is permitted only in its entirety.

Please note that any unused portion of the samples will be discarded after 12/21/2003 unless you have requested otherwise.

We appreciate the opportunity to be of service to you. If you have any questions,

You can also contact me via email. My email address is: dsharma@stl-inc.com

Sincerely,

Dimple Sharma
Project Manager

Severn Trent Laboratories, Inc.

STL San Francisco * 1220 Quarry Lane, Pleasanton, CA 94566

Tel 925 484 1919 Fax 925 484 1096 * www.stl-inc.com * CA DHS ELAP# 2496

Gas/BTEX Fuel Oxygenates by 8260B

TRC Alton Geoscience

Attn.: Anju Farfan

21 Technology Drive

Irvine, CA 92718

Phone: (949) 341-7440 Fax: (949) 753-0111

Project: 41050001FA20

Conoco Phillips #0746

Received: 11/06/2003 15:25

Site: 3943 Broadway, Oakland

Samples Reported

Sample Name	Date Sampled	Matrix	Lab #
MW-12	11/04/2003 08:16	Water	1
MW-4	11/04/2003 09:49	Water	2
RW-1	11/04/2003 09:16	Water	3
MW-3	11/04/2003 09:09	Water	4
MW-7	11/04/2003 09:35	Water	5
MW-1	11/04/2003 10:11	Water	6
MW-6	11/04/2003 12:28	Water	7
MW-10	11/04/2003 12:40	Water	8
MW-11	11/04/2003 11:21	Water	9
MW-8	11/04/2003 16:07	Water	10

Gas/BTEX Fuel Oxygenates by 8260B

TRC Alton Geoscience

Attn.: Anju Farfan

21 Technology Drive

Irvine, CA 92718

Phone: (949) 341-7440 Fax: (949) 753-0111

Project: 41050001FA20

Conoco Phillips #0746

Received: 11/06/2003 15:25

Site: 3943 Broadway, Oakland

Prep(s):	5030B	Test(s):	8260FAB
Sample ID:	MW-12	Lab ID:	2003-11-0258 - 1
Sampled:	11/04/2003 08:16	Extracted:	11/13/2003 13:50
Matrix:	Water	QC Batch#:	2003/11/13-1B.66

Compound	Conc.	RL	Unit	Dilution	Analyzed	Flag
Gasoline	ND	50	ug/L	1.00	11/13/2003 13:50	
Benzene	ND	0.50	ug/L	1.00	11/13/2003 13:50	
Toluene	ND	0.50	ug/L	1.00	11/13/2003 13:50	
Ethylbenzene	ND	0.50	ug/L	1.00	11/13/2003 13:50	
Total xylenes	ND	1.0	ug/L	1.00	11/13/2003 13:50	
Methyl tert-butyl ether (MTBE)	4.4	2.0	ug/L	1.00	11/13/2003 13:50	
Ethanol	ND	500	ug/L	1.00	11/13/2003 13:50	
Surrogate(s)						
1,2-Dichloroethane-d4	103.7	76-114	%	1.00	11/13/2003 13:50	
Toluene-d8	94.5	88-110	%	1.00	11/13/2003 13:50	

Gas/BTEX Fuel Oxygenates by 8260B

TRC Alton Geoscience

Attn.: Anju Farfan

21 Technology Drive

Irvine, CA 92718

Phone: (949) 341-7440 Fax: (949) 753-0111

Project: 41050001FA20

Conoco Phillips #0746

Received: 11/06/2003 15:25

Site: 3943 Broadway, Oakland

Prep(s):	5030B	Test(s):	8260FAB
Sample ID:	MW-4	Lab ID:	2003-11-0258 - 2
Sampled:	11/04/2003 09:49	Extracted:	11/17/2003 13:28
Matrix:	Water	QC Batch#:	2003/11/17-1C.66

Compound	Conc.	RL	Unit	Dilution	Analyzed	Flag
Gasoline	61	50	ug/L	1.00	11/17/2003 13:28	g
Benzene	ND	0.50	ug/L	1.00	11/17/2003 13:28	
Toluene	ND	0.50	ug/L	1.00	11/17/2003 13:28	
Ethylbenzene	ND	0.50	ug/L	1.00	11/17/2003 13:28	
Total xylenes	ND	1.0	ug/L	1.00	11/17/2003 13:28	
Methyl tert-butyl ether (MTBE)	ND	2.0	ug/L	1.00	11/17/2003 13:28	
Ethanol	ND	500	ug/L	1.00	11/17/2003 13:28	
Surrogate(s)						
1,2-Dichloroethane-d4	95.4	76-114	%	1.00	11/17/2003 13:28	
Toluene-d8	95.1	88-110	%	1.00	11/17/2003 13:28	

Gas/BTEX Fuel Oxygenates by 8260B

TRC Alton Geoscience

Attn.: Anju Farfan

21 Technology Drive

Irvine, CA 92718

Phone: (949) 341-7440 Fax: (949) 753-0111

Project: 41050001FA20

Conoco Phillips #0746

Received: 11/06/2003 15:25

Site: 3943 Broadway, Oakland

Prep(s): 5030B	Test(s): 8260FAB
Sample ID: RW-1	Lab ID: 2003-11-0258 - 3
Sampled: 11/04/2003 09:16	Extracted: 11/13/2003 14:38
Matrix: Water	QC Batch#: 2003/11/13-1B.66
Analysis Flag: o (See Legend and Note Section)	

Compound	Conc.	RL	Unit	Dilution	Analyzed	Flag
Gasoline	2600	1000	ug/L	20.00	11/13/2003 14:38	
Benzene	11	10	ug/L	20.00	11/13/2003 14:38	
Toluene	ND	10	ug/L	20.00	11/13/2003 14:38	
Ethylbenzene	ND	10	ug/L	20.00	11/13/2003 14:38	
Total xylenes	ND	20	ug/L	20.00	11/13/2003 14:38	
Methyl tert-butyl ether (MTBE)	210	40	ug/L	20.00	11/13/2003 14:38	
Ethanol	ND	10000	ug/L	20.00	11/13/2003 14:38	
Surrogate(s)						
1,2-Dichloroethane-d4	102.4	76-114	%	20.00	11/13/2003 14:38	
Toluene-d8	92.0	88-110	%	20.00	11/13/2003 14:38	

Gas/BTEX Fuel Oxygenates by 8260B

TRC Alton Geoscience

Attn.: Anju Farfan

21 Technology Drive

Irvine, CA 92718

Phone: (949) 341-7440 Fax: (949) 753-0111

Project: 41050001FA20

Conoco Phillips #0746

Received: 11/06/2003 15:25

Site: 3943 Broadway, Oakland

Prep(s): 5030B	Test(s): 8260FAB
Sample ID: MW-3	Lab ID: 2003-11-0258 - 4
Sampled: 11/04/2003 09:09	Extracted: 11/13/2003 15:02
Matrix: Water	QC Batch#: 2003/11/13-1B.66
Analysis Flag: o (See Legend and Note Section)	

Compound	Conc.	RL	Unit	Dilution	Analyzed	Flag
Gasoline	13000	2000	ug/L	40.00	11/13/2003 15:02	
Benzene	ND	20	ug/L	40.00	11/13/2003 15:02	
Toluene	ND	20	ug/L	40.00	11/13/2003 15:02	
Ethylbenzene	72	20	ug/L	40.00	11/13/2003 15:02	
Total xylenes	56	40	ug/L	40.00	11/13/2003 15:02	
Methyl tert-butyl ether (MTBE)	530	80	ug/L	40.00	11/13/2003 15:02	
Ethanol	ND	20000	ug/L	40.00	11/13/2003 15:02	
Surrogate(s)						
1,2-Dichloroethane-d4	106.8	76-114	%	40.00	11/13/2003 15:02	
Toluene-d8	96.1	88-110	%	40.00	11/13/2003 15:02	

Gas/BTEX Fuel Oxygenates by 8260B

TRC Alton Geoscience

Attn.: Anju Farfan

21 Technology Drive

Irvine, CA 92718

Phone: (949) 341-7440 Fax: (949) 753-0111

Project: 41050001FA20

Conoco Phillips #0746

Received: 11/06/2003 15:25

Site: 3943 Broadway, Oakland

Prep(s): 5030B	Test(s): 8260FAB
Sample ID: MW-7	Lab ID: 2003-11-0258 - 5
Sampled: 11/04/2003 09:35	Extracted: 11/13/2003 15:26
Matrix: Water	QC Batch#: 2003/11/13-1B.66

Compound	Conc.	RL	Unit	Dilution	Analyzed	Flag
Gasoline	70	50	ug/L	1.00	11/13/2003 15:26	
Benzene	ND	0.50	ug/L	1.00	11/13/2003 15:26	
Toluene	ND	0.50	ug/L	1.00	11/13/2003 15:26	
Ethylbenzene	ND	0.50	ug/L	1.00	11/13/2003 15:26	
Total xylenes	ND	1.0	ug/L	1.00	11/13/2003 15:26	
Methyl tert-butyl ether (MTBE)	ND	2.0	ug/L	1.00	11/13/2003 15:26	
Ethanol	ND	500	ug/L	1.00	11/13/2003 15:26	
Surrogate(s)						
1,2-Dichloroethane-d4	100.2	76-114	%	1.00	11/13/2003 15:26	
Toluene-d8	93.5	88-110	%	1.00	11/13/2003 15:26	

Gas/BTEX Fuel Oxygenates by 8260B

TRC Alton Geoscience

Attn.: Anju Farfan

21 Technology Drive

Irvine, CA 92718

Phone: (949) 341-7440 Fax: (949) 753-0111

Project: 41050001FA20

Conoco Phillips #0746

Received: 11/06/2003 15:25

Site: 3943 Broadway, Oakland

Prep(s):	5030B	Test(s):	8260FAB
Sample ID:	MW-1	Lab ID:	2003-11-0258 - 6
Sampled:	11/04/2003 10:11	Extracted:	11/13/2003 15:50
Matrix:	Water	QC Batch#:	2003/11/13-1B.66

Compound	Conc.	RL	Unit	Dilution	Analyzed	Flag
Gasoline	120	100	ug/L	2.00	11/13/2003 15:50	
Benzene	ND	1.0	ug/L	2.00	11/13/2003 15:50	
Toluene	ND	1.0	ug/L	2.00	11/13/2003 15:50	
Ethylbenzene	ND	1.0	ug/L	2.00	11/13/2003 15:50	
Total xylenes	ND	2.0	ug/L	2.00	11/13/2003 15:50	
Methyl tert-butyl ether (MTBE)	140	4.0	ug/L	2.00	11/13/2003 15:50	
Ethanol	ND	1000	ug/L	2.00	11/13/2003 15:50	
Surrogate(s)						
1,2-Dichloroethane-d4	111.0	76-114	%	2.00	11/13/2003 15:50	
Toluene-d8	94.0	88-110	%	2.00	11/13/2003 15:50	

Gas/BTEX Fuel Oxygenates by 8260B

TRC Alton Geoscience

Attn.: Anju Farfan

21 Technology Drive

Irvine, CA 92718

Phone: (949) 341-7440 Fax: (949) 753-0111

Project: 41050001FA20

Conoco Phillips #0746

Received: 11/06/2003 15:25

Site: 3943 Broadway, Oakland

Prep(s):	5030B	Test(s):	8260FAB
Sample ID:	MW-6	Lab ID:	2003-11-0258 - 7
Sampled:	11/04/2003 12:28	Extracted:	11/13/2003 16:14
Matrix:	Water	QC Batch#:	2003/11/13-1B.66

Compound	Conc.	RL	Unit	Dilution	Analyzed	Flag
Gasoline	ND	50	ug/L	1.00	11/13/2003 16:14	
Benzene	ND	0.50	ug/L	1.00	11/13/2003 16:14	
Toluene	ND	0.50	ug/L	1.00	11/13/2003 16:14	
Ethylbenzene	ND	0.50	ug/L	1.00	11/13/2003 16:14	
Total xylenes	ND	1.0	ug/L	1.00	11/13/2003 16:14	
Methyl tert-butyl ether (MTBE)	2.4	2.0	ug/L	1.00	11/13/2003 16:14	
Ethanol	ND	500	ug/L	1.00	11/13/2003 16:14	
Surrogate(s)						
1,2-Dichloroethane-d4	99.9	76-114	%	1.00	11/13/2003 16:14	
Toluene-d8	92.3	88-110	%	1.00	11/13/2003 16:14	

Gas/BTEX Fuel Oxygenates by 8260B

TRC Alton Geoscience

Attn.: Anju Farfan

21 Technology Drive

Irvine, CA 92718

Phone: (949) 341-7440 Fax: (949) 753-0111

Project: 41050001FA20

Conoco Phillips #0746

Received: 11/06/2003 15:25

Site: 3943 Broadway, Oakland

Prep(s):	5030B	Test(s):	8260FAB
Sample ID:	MW-10	Lab ID:	2003-11-0258 - 8
Sampled:	11/04/2003 12:40	Extracted:	11/13/2003 16:38
Matrix:	Water	QC Batch#:	2003/11/13-1B.66

Compound	Conc.	RL	Unit	Dilution	Analyzed	Flag
Gasoline	ND	50	ug/L	1.00	11/13/2003 16:38	
Benzene	ND	0.50	ug/L	1.00	11/13/2003 16:38	
Toluene	ND	0.50	ug/L	1.00	11/13/2003 16:38	
Ethylbenzene	ND	0.50	ug/L	1.00	11/13/2003 16:38	
Total xylenes	ND	1.0	ug/L	1.00	11/13/2003 16:38	
Methyl tert-butyl ether (MTBE)	ND	2.0	ug/L	1.00	11/13/2003 16:38	
Ethanol	ND	500	ug/L	1.00	11/13/2003 16:38	
Surrogate(s)						
1,2-Dichloroethane-d4	100.0	76-114	%	1.00	11/13/2003 16:38	
Toluene-d8	93.2	88-110	%	1.00	11/13/2003 16:38	

Gas/BTEX Fuel Oxygenates by 8260B

TRC Alton Geoscience

Attn.: Anju Farfan

21 Technology Drive

Irvine, CA 92718

Phone: (949) 341-7440 Fax: (949) 753-0111

Project: 41050001FA20

Conoco Phillips #0746

Received: 11/06/2003 15:25

Site: 3943 Broadway, Oakland

Prep(s):	5030B	Test(s):	8260FAB
Sample ID:	MW-11	Lab ID:	2003-11-0258 - 9
Sampled:	11/04/2003 11:21	Extracted:	11/13/2003 18:42
Matrix:	Water	QC Batch#:	2003/11/13-1B.66

Compound	Conc.	RL	Unit	Dilution	Analyzed	Flag
Gasoline	ND	50	ug/L	1.00	11/13/2003 18:42	
Benzene	ND	0.50	ug/L	1.00	11/13/2003 18:42	
Toluene	ND	0.50	ug/L	1.00	11/13/2003 18:42	
Ethylbenzene	ND	0.50	ug/L	1.00	11/13/2003 18:42	
Total xylenes	ND	1.0	ug/L	1.00	11/13/2003 18:42	
Methyl tert-butyl ether (MTBE)	ND	2.0	ug/L	1.00	11/13/2003 18:42	
Ethanol	ND	500	ug/L	1.00	11/13/2003 18:42	
Surrogate(s)						
1,2-Dichloroethane-d4	111.9	76-114	%	1.00	11/13/2003 18:42	
Toluene-d8	100.8	88-110	%	1.00	11/13/2003 18:42	

Gas/BTEX Fuel Oxygenates by 8260B

TRC Alton Geoscience

Attn.: Anju Farfan

21 Technology Drive

Irvine, CA 92718

Phone: (949) 341-7440 Fax: (949) 753-0111

Project: 41050001FA20

Conoco Phillips #0746

Received: 11/06/2003 15:25

Site: 3943 Broadway, Oakland

Prep(s):	5030B	Test(s):	8260FAB
Sample ID:	MW-8	Lab ID:	2003-11-0258 - 10
Sampled:	11/04/2003 16:07	Extracted:	11/17/2003 14:29
Matrix:	Water	QC Batch#:	2003/11/17-1C.66

Compound	Conc.	RL	Unit	Dilution	Analyzed	Flag
Gasoline	690	100	ug/L	2.00	11/17/2003 14:29	
Benzene	ND	1.0	ug/L	2.00	11/17/2003 14:29	
Toluene	ND	1.0	ug/L	2.00	11/17/2003 14:29	
Ethylbenzene	3.3	1.0	ug/L	2.00	11/17/2003 14:29	
Total xylenes	ND	2.0	ug/L	2.00	11/17/2003 14:29	
Methyl tert-butyl ether (MTBE)	190	4.0	ug/L	2.00	11/17/2003 14:29	
Ethanol	ND	1000	ug/L	2.00	11/17/2003 14:29	
Surrogate(s)						
1,2-Dichloroethane-d4	102.9	76-114	%	2.00	11/17/2003 14:29	
Toluene-d8	91.1	88-110	%	2.00	11/17/2003 14:29	

Gas/BTEX Fuel Oxygenates by 8260B

TRC Alton Geoscience
Attn.: Anju Farfan

21 Technology Drive
Irvine, CA 92718
Phone: (949) 341-7440 Fax: (949) 753-0111

Project: 41050001FA20
Conoco Phillips #0746

Received: 11/06/2003 15:25

Site: 3943 Broadway, Oakland

Batch QC Report					
Prep(s): 5030B				Test(s): 8260FAB	
Method Blank		Water		QC Batch # 2003/11/13-1B.66	
MB: 2003/11/13-1B.66-058				Date Extracted: 11/13/2003 10:58	

Compound	Conc.	RL	Unit	Analyzed	Flag
Gasoline	ND	50	ug/L	11/13/2003 10:58	
Methyl tert-butyl ether (MTBE)	ND	2.0	ug/L	11/13/2003 10:58	
Benzene	ND	0.5	ug/L	11/13/2003 10:58	
Toluene	ND	0.5	ug/L	11/13/2003 10:58	
Ethylbenzene	ND	0.5	ug/L	11/13/2003 10:58	
Total xylenes	ND	1.0	ug/L	11/13/2003 10:58	
Ethanol	ND	500	ug/L	11/13/2003 10:58	
Surrogates(s)					
1,2-Dichloroethane-d4	93.8	76-114	%	11/13/2003 10:58	
Toluene-d8	92.8	88-110	%	11/13/2003 10:58	

Gas/BTEX Fuel Oxygenates by 8260B

TRC Alton Geoscience
Attn.: Anju Farfan

21 Technology Drive
Irvine, CA 92718
Phone: (949) 341-7440 Fax: (949) 753-0111

Project: 41050001FA20
Conoco Phillips #0746

Received: 11/06/2003 15:25

Site: 3943 Broadway, Oakland

Batch QC Report					
Prep(s): 5030B				Test(s): 8260FAB	
Method Blank		Water		QC Batch # 2003/11/17-1C.66	
MB: 2003/11/17-1C.66-042				Date Extracted: 11/17/2003 11:42	

Compound	Conc.	RL	Unit	Analyzed	Flag
Gasoline	ND	50	ug/L	11/17/2003 11:42	
Methyl tert-butyl ether (MTBE)	ND	2.0	ug/L	11/17/2003 11:42	
Benzene	ND	0.5	ug/L	11/17/2003 11:42	
Toluene	ND	0.5	ug/L	11/17/2003 11:42	
Ethylbenzene	ND	0.5	ug/L	11/17/2003 11:42	
Total xylenes	ND	1.0	ug/L	11/17/2003 11:42	
Ethanol	ND	500	ug/L	11/17/2003 11:42	
Surrogates(s)					
1,2-Dichloroethane-d4	99.0	76-114	%	11/17/2003 11:42	
Toluene-d8	93.6	88-110	%	11/17/2003 11:42	

Gas/BTEX Fuel Oxygenates by 8260B

TRC Alton Geoscience

Attn.: Anju Farfan

21 Technology Drive

Irvine, CA 92718

Phone: (949) 341-7440 Fax: (949) 753-0111

Project: 41050001FA20

Conoco Phillips #0746

Received: 11/06/2003 15:25

Site: 3943 Broadway, Oakland

Batch QC Report

Prep(s): 5030B

Test(s): 8260FAB

Laboratory Control Spike

Water

QC Batch # 2003/11/13-1B.66

LCS 2003/11/13-1B.66-010

Extracted: 11/13/2003

Analyzed: 11/13/2003 10:10

LCSD 2003/11/13-1B.66-034

Extracted: 11/13/2003

Analyzed: 11/13/2003 10:34

Compound	Conc. ug/L		Exp.Conc.	Recovery %		RPD	Ctrl.Limits %		Flags	
	LCS	LCSD		LCS	LCSD		%	Rec.	RPD	LCS
Methyl tert-butyl ether (MTBE)	18.2	18.7	25	72.8	74.8	2.7	65-165	20		
Benzene	19.2	19.0	25	76.8	76.0	1.0	69-129	20		
Toluene	19.3	21.3	25	77.2	85.2	9.9	70-130	20		
Surrogates(s)										
1,2-Dichloroethane-d4	487	470	500	97.4	94.0		76-114			
Toluene-d8	455	496	500	91.0	99.2		88-110			

Gas/BTEX Fuel Oxygenates by 8260B

TRC Alton Geoscience

Attn.: Anju Farfan

21 Technology Drive

Irvine, CA 92718

Phone: (949) 341-7440 Fax: (949) 753-0111

Project: 41050001FA20

Conoco Phillips #0746

Received: 11/06/2003 15:25

Site: 3943 Broadway, Oakland

Batch QC Report

Prep(s): 5030B

Test(s): 8260FAB

Laboratory Control Spike

Water

QC Batch # 2003/11/17-1C.66

LCS 2003/11/17-1C.66-054

Extracted: 11/17/2003

Analyzed: 11/17/2003 10:54

LCSD 2003/11/17-1C.66-018

Extracted: 11/17/2003

Analyzed: 11/17/2003 11:18

Compound	Conc. - ug/L		Exp.Conc.	Recovery %		RPD	Ctrl.Limits %		Flags	
	LCS	LCSD		LCS	LCSD		%	Rec.	RPD	LCS
Methyl tert-butyl ether (MTBE)	22.6	22.6	25	90.4	90.4	0.0	65-165	20		
Benzene	23.4	23.2	25	93.6	92.8	0.9	69-129	20		
Toluene	23.5	23.2	25	94.0	92.8	1.3	70-130	20		
Surrogates(s)										
1,2-Dichloroethane-d4	492	489	500	98.4	97.8		76-114			
Toluene-d8	467	481	500	93.4	96.2		88-110			

Gas/BTEX Fuel Oxygenates by 8260B

TRC Alton Geoscience

Attn.: Anju Farfan

21 Technology Drive

Irvine, CA 92718

Phone: (949) 341-7440 Fax: (949) 753-0111

Project: 41050001FA20

Conoco Phillips #0746

Received: 11/06/2003 15:25

Site: 3943 Broadway, Oakland

Legend and Notes

Analysis Flag

o

Reporting limits were raised due to high level of analyte present in the sample.

Result Flag

g

Hydrocarbon reported in the gasoline range does not match our gasoline standard.

1239 Quarry Lane

Pleasanton, CA 94566

(925) 484-1949 (925) 484-1000 fax

ConocoPhillips Site Manager:

INVOICE REMITTANCE ADDRESS:

CONOCOPHILLIPS
 Attn: Dee Hutchinson
 3511 South Harbor, Suite 250
 Santa Ana, CA 92704

ConocoPhillips Work Order Number

ConocoPhillips Cost Object

DATE: 11-04-08
 PAGE: 1 of 1

TAC
 21 Technology Drive, Irvine CA 92618
 Ansu Farfan
 949-341-7440 FAX 949-793-0111
 afarfana@rcsolutions.com

CONOCOPHILLIPS SITE NUMBER: 0746
 ADDRESS (Street and City): 2943 Broadway Oakland
 Peter Thomson, TAC
 949-341-7408

LABORATORY ID NO.: T0600101471
 CONOCOPHILLIPS SITE ADDRESS:

CONOCOPHILLIPS PROJECT NUMBER: 41050017A20
 Hazarulla Corridor

REQUESTED ANALYSES

SPECIAL INSTRUCTIONS OR NOTES:
 Run 80%YS by 8:00 on all
 8260 MTBE hits

80108 - TPHnd Extractable	82008 - TPHBTXEXMSE	82108 - TPHBTXEXK76	82208 - TPHBTXEXK76	82308 - TPHBTXEXK76	82408 - Full Screen VOCs (does not include oxygenated)	82708 - Semi-Volatiles	82858 - TPHBTXEXMSE	82908 - TPHBTXEXMSE

FIELD NOTES:
 Customer/Preservative
 or PID Readings
 or Laboratory Notes
 10.0°C
 TEMPERATURE ON RECEIPT

Sample ID	Sample Name	Field Point	SAMPLING DATE	SAMPLING TIME	MATRIX	NO. OF CONT.
MW-12			10/20/08	16:00	BW	3
MW-4			10/20/08	16:00		
RW-1			10/20/08	16:00		
MW-3			10/20/08	16:00		
MW-7			10/20/08	16:00		
MW-1			10/20/08	16:00		
MW-6			10/20/08	16:00		
MW-10			10/20/08	16:00		
MW-11			10/20/08	16:00		
MW-8			10/20/08	16:00		

Signature: Hazarulla Corridor
 Date: 11-06-08
 Date: 11-06-08

LIMITATIONS

The fluid level monitoring and groundwater sampling activities summarized in this report have been performed under the responsible charge of a California Registered Geologist or Registered Civil Engineer and have been conducted in accordance with current practice and the standard of care exercised by geologists and engineers performing similar tasks in this area. No warranty, express or implied, is made regarding the conclusions and professional opinions presented in this report. The conclusions are based solely upon an analysis of the observed conditions. If actual conditions differ from those described in this report, our office should be notified.