

TRC Well Box Repair Site Summary Report

<u>Descriptive Work Title</u>	Well Box Repair and Replacement	RECEIVED 10:13 am, Apr 22, 2009 Alameda County Environmental Health
<u>Site No./AOC No.</u>	0746/1085	
<u>Purchase Order No.</u>	4506609299	
<u>Additional Purchase Order No.</u>		
<u>Site Address</u>	3943 Broadway, Oakland	
<u>COP Site Manager</u>	Shelby Lathrop	
<u>TRC Project Manager</u>	Mike Glenn	
<u>Repairs Completed</u>	RW-1, MW-1, MW-2, MW-11	
<u>Replacements Completed</u>	MW-4, MW-5, MW-6, MW-7, MW-6	
<u>Start Date</u>	Tuesday, June 20, 2006	
<u>Date of Completion</u>	Wednesday, June 21, 2006	
<u>Notes</u>		

DAILY REPORT

Gettler - Ryan Inc.

TAGS

FORMS

COMPANY Unocal II 0746

JOB NO. 140064.02

LOCATION 3943 Broadway/40th Oakland

DATE 2/19/98 Thurs

ARRIVAL TIME 8:55

DEPARTURE TIME: _____

JOB INSTRUCTIONS: Leave office @ 8:00 & arrive @ site @ 8:55.

Paradiso has area under canopy exposed & piping removed.

Collect US-1 (Comp) @ 9:25 - ~ 12-18 yds³ (no odors)

WORK PERFORMED (CONT. ON REVERSE SIDE): Paradiso will be finished 2/26 Friday.

ACHSCA ^{Robert Weston} arrives @ 9:45. Collect UT-1-4 @ 4' bgs &

1.5' into "native" @ 9:55 - very hot black clay/silt ~ 8' from south dispenser.

Collect UT-2-4 @ 4' bgs @ 10:05 ~ 8' NW of ^{south} canopy footing

Collect UT-3-4 @ 4' bgs @ 10:15 ~ 8' from N canopy footing (OK)

Collect UT-4-4 @ 4' bgs @ 10:35 → H₂O in dispenser hole so had

auger down ~ 6' from canopy footing & collect sample (OK)

ACHSCA leaves @ ~ 10:40. Call DV - he says not to

MATERIALS: go deeper - he will call Tena. Raining very

hard. Clean up. Leave @ 11:15

SUBCONTRACTORS: _____

Store # <u>25074</u>	Date: <u>2-19-98</u>
Unit # <u>0746</u>	Code: _____ Color <input type="checkbox"/>
Description: _____	

EQUIPMENT:

AIR COMPRESSOR	_____	CONCRETE SAWING	_____	HELIUM TESTER	_____
DUMP TRUCK	_____	STEAM CLEANER	_____	HYDROCARBON SURVEYOR	_____
SPECIALTY TRUCK	_____	WATER/TRANSFER PUMP	_____	HORIBA	_____
BACKHOE/LOADER	_____	PETRO-TITE LINE TESTER	_____	VR-3	_____
KOMATSU	_____	PETRO-TITE TANK TESTER	_____	OVA	_____
PAVING EQUIPMENT	_____	VAPOR TESTER	_____	ELECTRONIC INTERFACE PROBE	_____

FOREMAN _____

KEI
KAPREALIAN ENGINEERING
INCORPORATED

March 24, 1995

Unocal Corporation
1201 W. 5th Street
Los Angeles, California 90051

Attention: Mr. E.H. (Ted) Everett

RE: Remediation Cost
Unocal Service Station #0746
3943 Broadway
Oakland, California

Dear Mr. Everett:

Based upon the information provided to and obtained by Kaprealian Engineering, Inc. (KEI) to date, the estimated remediation cost is \$150,000.00, and the estimated completion date is 2005. These estimates are based upon the current and planned course of action for the subject site. Please note that the cost estimate and completion date are subject to change associated with any change in scope and/or change in regulatory direction, and also due to the inherent uncertainties associated with subsurface conditions.

If you have any questions, please do not hesitate to call me at (510) 602-5100.

Sincerely,

Kaprealian Engineering, Inc.



Timothy R. Ross
General Manager

jad\0746

cc: Mr. Edward C. Ralston, Unocal Corporation, San Ramon ✓
Mr. Adadu Yemane, Unocal Corporation, San Ramon

FILE #	0746	SS	<input checked="" type="checkbox"/>	BP	<input type="checkbox"/>
RPT	QM	TRANSMITTAL	<input type="checkbox"/>	<input type="checkbox"/>	<input type="checkbox"/>
1	2	3	4	5	6 <input checked="" type="checkbox"/>

ALAMEDA COUNTY
HEALTH CARE SERVICES
AGENCY

DAVID J. KEARS, Agency Director



RAFAT A. SHAHID, ASST. AGENCY DIRECTOR

StID 1119

July 5, 1994

Mr. Ed Ralston
UNOCAL
P.O.Box 5155
San Ramon, CA 94583

RECEIVED

JUL 06 1994

DEPARTMENT OF ENVIRONMENTAL HEALTH
State Water Resources Control Board
Division of Clean Water Programs
UST Local Oversight Program
80 Swan Way, Rm 200
Oakland, CA 94621
(510) 271-4530

Re: Additional Investigations at Unocal #0746, 3943 Broadway,
Oakland 94611

Dear Mr. Ralston:

The recent water recovery tests and vapor extraction pilot test performed suggest that standard groundwater exatraction or vapor extraction techniques are not suitable for the remediation of petroleum hydrocarbon contamination at the above referenced site. Your consultant, Kaprealian Engineering Inc, has recommended that long term monitoring continue, to verify that the contaminant plume does not continue to migrate. And that in time, the levels of contamination will naturally attenuate.

This may be a suitable management alternative for this site after a risk assessment has been performed and cleanup levels are determined. I would need verification that residual hydrocarbons in soil will not continue to be a source of contamination to ground water. The former underground storage tank pit appears to have been adequately overexcavated. Still, there are elevated levels of (free product, that is) TPH-G and benzene in groundwater from wells MW-3 and MW-5. A soil investigation may be required between the former pump islands and monitoring well MW-3.

Also, the next quarterly sampling event should include the analysis for MTBE of groundwater from wells MW-9 and MW-12.

Our office has moved to: 1131 Harbor Bay Parkway, 2nd Floor, Alameda, CA 94502. Our phone lines are not yet connected, but I may be reached at (510) 271-4330. Please do not hesitate to call if you have any questions or comments regarding this letter.

eva chu
Hazardous Materials Specialist

cc: Tim Ross, KEI, 2401 Stanwell, Dr, Suite 400, Concord 94520
files (unocal01.5)

FILE #	0746	SS	<input checked="" type="checkbox"/>	BP	<input type="checkbox"/>
RPT	QM	TRANSMITTAL	<input type="checkbox"/>	<input type="checkbox"/>	<input type="checkbox"/>
1	2	3	<input checked="" type="checkbox"/>	4	5
				6	



0746
 TO: Service Station Dealer
 Territory Manager
~~Environmental Compliance Dept~~
 Maintenance & Construction
 Maintenance Dispatch

FROM: Marion Milley *MM*

RE: Environmental Exception Report

The attached Environmental Health & Safety Exception Report details the status of compliance at the listed service station. These exception items were noted during a survey conducted at the facility on the date indicated.

The Exception report describes the issues examined and the particular situation at the facility. "Corrective Action" is a brief statement of an appropriate response to the situation. "Responsibility" indicates the parties responsible for taking corrective action. "Priority" ranks the situation in order of urgency (see footnote). The "closure" column is a space for your notes, including the actual date the situation is closed. Please note those items which are the responsibility of you or your department to close.

When your issues are resolved, please return a copy of the attached report, with your closure comments, to my attention at:

1148 Canal Boulevard
 Richmond, CA 94804

In about 8 weeks I will re-survey the facility to ensure that each exception item has been adequately addressed. Thank you for your attention to these important issues. If you have any questions, please contact me at 510/232-5447.

MARION MILLER

FEB 28 1994

Store #:	250746
Report Type Code:	COR
Description:	EER
Date:	2/28/94

Box 9494

**ENVIRONMENTAL, HEALTH AND SAFETY
EXCEPTION REPORT**

Facility Number : 746

Survey Date : 1/25/93

Item	Issue	Situation	Corrective Action	Dispatch	TerrMgr	Compliance	Env Guidance	Operator	CERT Group	Construction Engr	MSDS Coordinator	Maintenance Engr	Priority	Closure Notes	Closure Date
BI01	Clarifier.		Closed per Unocal program			✓							C		
BI07	"Equipment starts automatically" sign present	Compressor starts automatically sticker is absent or illegible.	Environmental Guidance Specialist to provide copy of sign. Dealer to post sign on compressor and obtain new signs as needed. Directions for ordering signs are located in Section 2 of the Greenbook.				✓	✓					A		
BI11	Grinder has safety guard	Grinder safety guard missing.	Dealer to replace or install safety guard on grinder.					✓					A		
BI16	Used batteries stored not directly on concrete	Batteries stored on concrete.	Dealer to move batteries so that they are not stored on concrete. Palets, plastic tubs, shelves are recommended.					✓					B		
BI21	Waste oil remote fill properly used	Waste oil remote fill closed by screw on cap at pipe 2.5 feet tall.	Maintenance engineer to consider more permanent closure of remote fill.									✓	B		
DS01	Shear valve: properly sealed, bolted to island	Not evaluated. Dealer was unable to located key.	Environmental guidance to review at revisit.				✓						B		
DS02	Dispenser area free of leaks	Not evaluated	Evaluate at revisit.				✓						B		
DS03	Blend valve hooked up correctly	Not evaluated at initial visit.	Evaluate at revisit.				✓						B		

Item	Issue	Situation	Corrective Action	Dispatch	TerrMgr	Compliance	EnvGuidance	Operator	CERT Group	Construction Engr	MSDS Coordinator	Maintenance Engr	Priority	Closure Notes	Closure Date
DS04	Dispenser has secondary containment	Not evaluated at initial visit.	Evaluate at revisit.				✓						C		
JS07	Emergency shut-off within 75 feet of each dispenser	Emergency pump shut off switch is not within 75 feet of the furthest dispenser	Maintenance engineer to arrange for installation of emergency pump shut off switch as required.									✓	C		
JR02	Yard in safe condition	Pavement sinking at old waste oil tank site which is west of building.	Maintenance engineer to review conditions									✓	B		
JR19	Drums properly covered and labeled	Waste oil filter drum needs label	Label drums with the name of the contents, hazardous waste, and date you started filling the drum. Recycler should provide drum label.					✓					B		
HS01	SB 198 program available	SB 198 program not available	Dealer to obtain an SB 198 program. Environmental guidance specialist can provide a list of contractors to provide plans if requested. Dealer to maintain plan in Section 2 of Greenbook.					✓					A		
HS02	SB 198 Program designates responsible persons	Responsible parties need to be desingated in SB 198 plan.	Specify responsible parties					✓					B		

Item	Issue	Situation	Corrective Action	Dispatch	TerrMgr	Compliance	EnvGuidance	Operator	CERT Group	Construction Engr	MSDS Coordinator	Maintenance Engr	Priority	Closure Notes	Closure Date
HS03	SB 198 Inspection documentation available	SB 198 program needs to include documentation of inspections.	Complete inspection documents and maintain in Section 2 of the Greenbook. Unocal recommends brief inspections monthly and comprehensive inspections quarterly. Unocal recommends that all dealers record their inspections in a log because without documentation you have no evidence that inspections take place.					✓					B		
HS04	SB 198 Training log complete for last six trainings	SB 198 requires employers to conduct safety training for their employees. This training must be documented for facilities with more than 10 employees and should be documented for other facilities.	Dealer to provide safety training to your employees as required and document that the training has taken place. Maintain training records for three years in Section 2 of the Greenbook. Unocal recommends monthly safety meetings and training for new employees is required at hire and if the employee is reassigned.					✓					B		

Item	Issue	Situation	Corrective Action	Dispatch	TerrMgr	Compliance	EnvGuidance	Operator	CERT Group	Construction Engr	MSDS Coordinator	Maintenance Engr	Priority	Closure Notes	Closure Date
HS05	Written hazard communication program exists	Hazard communication program is either not available to employees or not completed with station specific information.	Unocal will provide service station dealers with a program model. The operator must complete the station specific information, sign and date the plan, maintain the plan in the Greenbook Section 2, Health & Safety.					✓					A		
HS06	Hazard Communication annual training log current	Dealer has not maintained an updated training log for employees as part of the hazard communication program.	Dealer to review training requirements outlined in the hazard communication program, conduct employee training as outlined, and document training on form provided in HMMP, Section 4 of the Greenbook.					✓					B		
HS08	All MSDS's Available	Material Safety Data Sheets (MSDS) are not available for all hazardous materials stored at the site. The following MSDS are required: batteries, solvent.	Dealer to contact suppliers for copies of MSDS for non Unocal products. For Unocal products, dealer to contact the Unocal MSDS office: 1-800-435-7761.					✓					A		
M09	Manual available	Manual for the electronic monitoring equipment not available at station.	Unocal tank test coordinator to provide manual to station.			✓							B	Given to Bob 4-11-94 mk	
NZ01	No topping off, no smoking, turn off engine sign posted, current, legible	Signs missing or damaged No topping off	Environmental guidance specialist to provide copies of signs to dealer. Dealer to post signs in appropriate places.				✓	✓					A		

Item	Issue	Situation	Corrective Action	Dispatch	Terr:Mgr	Compliance	Env:Guidance	Operator	CERT Group	Construction Engr	MSDS Coordinator	Maintenance Engr	Priority	Closure Notes	Closure Date
NZ06	Face shield free of damage	Face shield damaged at nozzle # 10	Replace face shield					✓					A		
TA04	Current UST permit to operate posted:	Underground storage tank permit to operate not posted or available at the station. Most recent permit available expired 11/1/89.	Compliance to provide copy of current permit and dealer to post and maintain at the station.			✓		✓					A		
TA07	Current tank registration forms A & B & C available:	Tank registration forms not current or available	Compliance to provide copies of current forms A, B, and C. Dealer to maintain at site in Section 3 of the Greenbook.			✓		✓					B		
TA08	Current UST monitoring plan available:	Underground storage tank monitoring plan not current or not available Plan should be attached to 1992 HMMP.	Compliance to provide copy of current UST monitoring plan to station. Dealer to maintain copy on site in Section 3 of the Greenbook.			✓		✓					B	sent 4-11-94 mk	
TA09	Certificate of financial responsibility available:	Certificate of Financial responsibility absent and should be attached to 1992 HMMP.	Compliance to provide copy of certificate and dealer to maintain copy in Section 3 of the Greenbook.			✓		✓					C	sent 4-11-94 mk	
TA10	Certification of UST Owner/Operator Agreement available:	UST owner/operator agreement not available	Compliance to provide copy of agreement and dealer to maintain copy in Section 3 of the Greenbook.			✓		✓					C		
TA11	Daily inventory readings for product tanks available:	Inventory readings not available because dealer stores his records at home.	Environmental guidance to review daily books at revisit.				✓	✓					B	Given to Lynda 4/11 mk	

Item	Issue	Situation	Corrective Action	Dispatch	TerrMgr	Compliance	EnvGuidance	Operator	CERT Group	Construction Engr	MSDS Coordinator	Maintenance Engr	Priority	Closure Notes	Closure Date
TA12	Daily water readings recorded:	Dealer not measuring or not recording water levels in product tanks on a daily basis. Dealer needs to order	Dealer to measure and record water levels on a daily basis. If water level is found to exceed lease tolerances of 1" for gasoline and 1/2" for any diesel tank, dealer will immediately notify maintenance dispatch. Territory manager to verify that dealer is measuring water level.		✓			✓					A		
TA14	Inventory records for three years available:	Inventory reconciliation records not available for last three years. Dealer stores records at home.	Dealer to maintain inventory reconciliation records for at least three years. Dealer to provide records to Unocal or regulatory agency upon request.					✓					C		
TA16	Records: Date Throughput Variance	Y, (within tolerance), N (exceeds tolerance or cannot determine if within tolerance) Inventory reconciliation not reviewed at initial visit.	Environmental guidance to review records at revisit.				✓	✓					B		
TA17	1)	No review at visit. Records not available.	Dealer to make records available. Environmental guidance to review at revisit.				✓	✓					B		
TA18	2)	Variances not recorded on survey because records not available.	Environmental guidance to review inventory reconciliation procedures with the dealer. Dealer to implement changes outlined by territory manager.					✓					B		

Item	Issue	Situation	Corrective Action	Dispatch	TerrMgr	Compliance	EnvGuidance	Operator	CERT Group	Construction Engr	MSDS Coordinator	Maintenance Engr	Priority	Closure Notes	Closure Date
TA20	Correct tank chart (at 1/8") exists:	Tank chart is either not in 1/8" increments or not the correct chart for the tanks installed.	Compliance to provide correct tank chart based on the following measurements: Modern Welding 12,000 gallon tank 96 X 387 10 @ 671.9, 96 @ 12245.2			✓							B		
TK06	Tank brand name	Field verification	Correct database with Modern Welding			✓							C		
TK17	UST brass gallon capacity tag present	Brass gallon capacity tag missing or damaged @ 87 & 92	Dispatch to send contractor to install brass gallon capacity tag.	✓									B		
TK21	Spill box gaskets operational	Spill box gaskets need repair at 87 tank gasket which attached spill box to cover	Dispatch to send contractor to fix spill box gasket at	✓									B		
WD0	Hazardous waste generator permit available	Hazardous waste generator permit not current or not available	Compliance to provide permit and dealer to post and maintain permit.			✓		✓					B	not available	
WD0	Complete manifests for waste oil:	Waste oil manifests are not complete or not available.	Environmental guidance specialist to provide list of recyclers which will provide complete waste receipts.				✓	✓					B		
WD0	Waste hauler EPA ID included	Waste hauler EPA ID number not provided on waste receipt	Environmental guidance specialist to provide list of recyclers which will provide complete waste receipts.				✓	✓					C		
WD0	Complete manifests for recycled batteries:	Receipts for used batteries are not complete or not available.	Maintain receipts for battery cores picked up by battery supplier in Section 5 of the Greenbook.				✓	✓					B		
WD1	Waste hauler EPA ID included	Waste hauler EPA ID number not included with waste receipt.	Maintain receipts for battery cores picked up by battery supplier.				✓	✓					C		

Item	Issue	Situation	Corrective Action	Dispatch	TerrMgr	Compliance	EnvGuidance	Operator	CERT Group	Construction Engr	MSDS Coordinator	Maintenance Engr	Priority	Closure Notes	Closure Date
WD1	Complete manifests for waste oil filters:	Waste oil receipts not complete or not available	Environmental guidance to provide list of recyclers who will provide complete receipts for waste.				✓	✓					B		
WD1	Hauler EPA ID included	Waste oil receipts not complete or not available	Environmental guidance to provide list of recyclers who will provide complete receipts for waste.				✓	✓					C		
WD1	Complete manifests for waste antifreeze	Waste oil receipts not complete or not available	Environmental guidance to provide list of recyclers who will provide complete receipts for waste.				✓	✓					B		
WD1	Hauler EPA ID included for waste antifreeze	Waste antifreeze receipts not complete or not available	Environmental guidance to provide list of recyclers who will provide complete receipts for waste.				✓	✓					C		
WD1	Tire recycling receipts available	Tire receipts not available	Maintain tire receipts in Section 5 of the Greenbook				✓	✓					B		
WD2	Waste removed in less than 90 days	Waste receipts not available so unable to determine compliance with storage requirements.	Remove waste oil and antifreeze every 90 days and waste oil filters every 180 days.					✓					B		
WT02	Tank size in gallons	Field Verification	Record information on database tank capacity 500 gallons.			✓							C		
WT06	Tank brand name	Field Verification	Record information on database Modern Welding.			✓							C		
WT08	Tag present	Waste oil (drain oil) product tag missing or damaged	Dispatch to Install tank tag	✓									B		

KAPREALIAN ENGINEERING
INCORPORATED

RECEIVED

FEB 18 1994

February 16, 1994

Unocal Service Station #0746
3943 Broadway
Oakland, CA 94611

Attention: Station Dealer

Dear Sir:

Kaprealian Engineering, Inc. (KEI) will be performing water recovery tests at your station on behalf of Unocal Corporation on Thursday, February 24, 1994. The water recovery tests will only require access to on-site wells MW3, MW4, MW5, MW7, and RW1. A single barricade will be placed on top of each well during the tests and should not disrupt business in a significant manner. KEI will work with you to minimize any inconvenience. The location of all the wells is shown on the attached Figure 1. The test will begin at 9:00 a.m. on February 24, 1994, and conclude at the end of the day.

If you have any questions regarding the upcoming tests, please do not hesitate to call me at (510) 602-5100.

Sincerely,

Kaprealian Engineering, Inc.



Sarkis A. Soghomonian
Staff Engineer

SAS:jad\0746

Attachment

cc: Edward C. Ralston, Unocal Corporation ✓

FILE #	0746	SS	✓	BP	
RPT	QM		TRANSMITTAL		
1	2	3	4	5	6

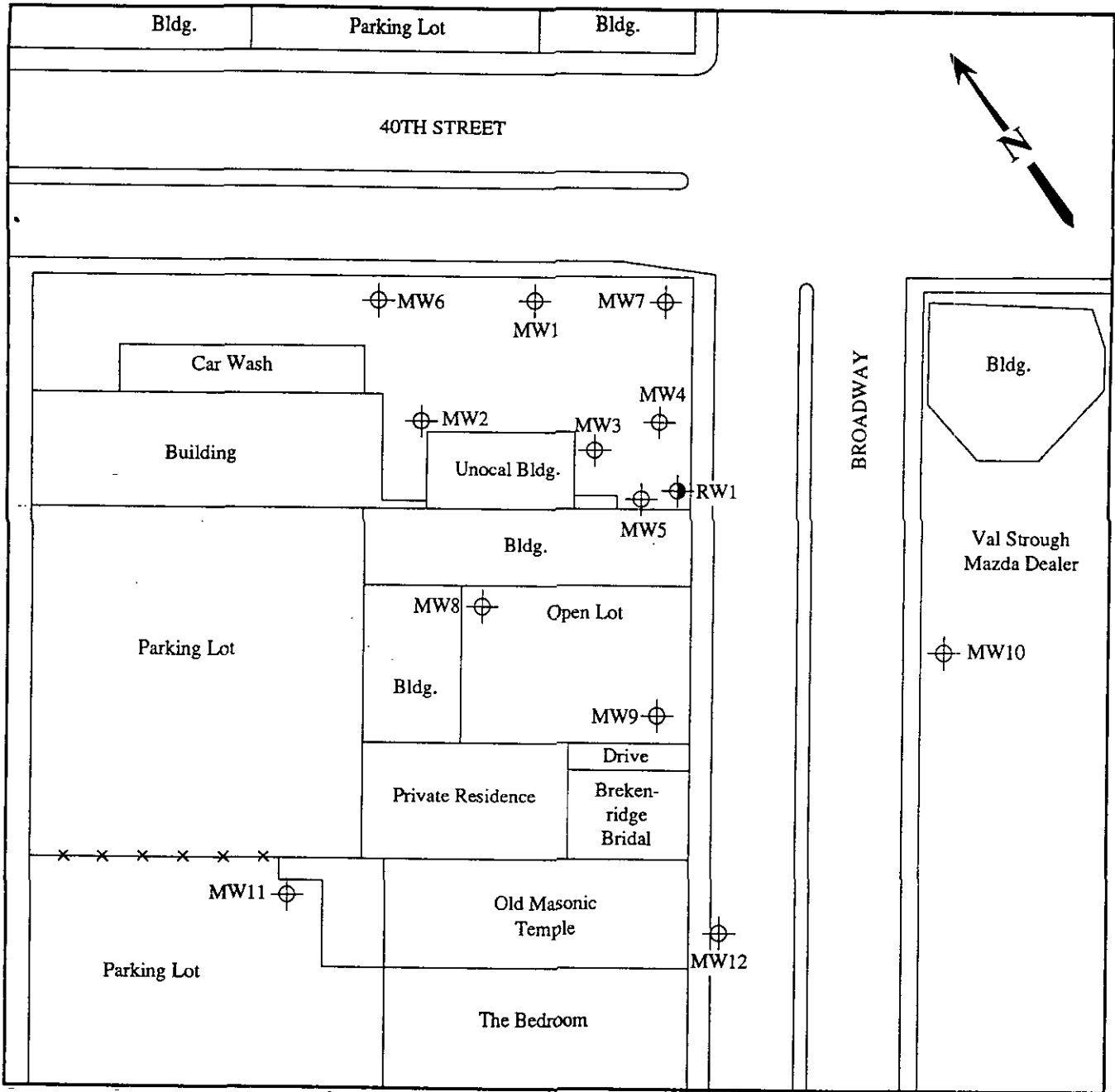

LEGEND

- ⊕ Monitoring well
- ⊙ 6-inch diameter well

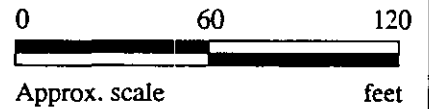

WELL LOCATION MAP



**UNOCAL SERVICE STATION #0746
 3943 BROADWAY
 OAKLAND, CA**

**FIGURE
 1**

KAPREALIAN ENGINEERING
I N C O R P O R A T E D

July 7, 1993

Unocal Corporation
1201 West 5th Street
Los Angeles, California 90051

Attention: Mr. E.H. (Ted) Everett

RE: Remediation Cost
Unocal Service Station #0746
3943 Broadway
Oakland, California

FILE #	<u>0746</u>	SS	<u>X</u>	BP	_____
RPT	_____	QM	_____	TRANSMITTAL	_____
1	<u>2</u>	3	4	5	<u>6 X</u>

Dear Mr. Everett:

Based upon the information provided to and obtained by Kaprealian Engineering, Inc. (KEI) to date, the estimated remediation cost is \$300,000.00, and the estimated completion date is 2005. These estimates are based upon the information known to KEI on this date and also based upon the current and planned course of action for the subject site. Please note that the cost estimate and completion date are subject to change associated with any change in scope and/or change in regulatory direction and also due to the inherent uncertainties associated with subsurface conditions.

If you have any questions, please do not hesitate to call me at (510) 602-5100.

Sincerely,

Kaprealian Engineering, Inc.



Aram Kaloustian
Project Engineer

\bp

cc: Mr. Al Dew, Unocal Corporation, Los Angeles
Mr. Adadu Yemane, Unocal Corporation, San Ramon

250746

BIOASSAY SAMPLING

FACILITY NAME & ADDRESS:

Unocal / Oakland
3943 Broadway

DATE 6/11/92 NAME Vatkes

CONTAINER 1 LITER 5 GALLONS

WELLS SAMPLED

- | | |
|--|--|
| <input checked="" type="checkbox"/> MW1 | <input checked="" type="checkbox"/> MW11 |
| <input checked="" type="checkbox"/> MW2 | <input type="checkbox"/> MW12 |
| <input type="checkbox"/> MW3 | <input type="checkbox"/> MW13 |
| <input checked="" type="checkbox"/> MW4 | <input type="checkbox"/> MW14 |
| <input type="checkbox"/> MW5 | <input type="checkbox"/> MW15 |
| <input checked="" type="checkbox"/> MW6 | <input type="checkbox"/> MW16 |
| <input checked="" type="checkbox"/> MW7 | <input type="checkbox"/> MW17 |
| <input checked="" type="checkbox"/> MW8 | <input type="checkbox"/> MW18 |
| <input checked="" type="checkbox"/> MW9 | <input type="checkbox"/> MW19 |
| <input checked="" type="checkbox"/> MW10 | <input type="checkbox"/> MW20 |

WESTERN REGION BOX:

#9513

Store # <u>250746</u>	Date: <u>6-11-92</u>
Unit # <u>0746</u>	Code: <u>LAP</u> Color <input type="checkbox"/>
Description: <u>FISH BIOASSAY-GW</u>	

pH
Reading 7.16



SEQUOIA ANALYTICAL

1900 Bates Avenue • Suite LM • Concord, California 94520
(510) 686-9600 • FAX (510) 686-9689

Kaprealian Engineering, Inc.
2401 Stanwell Drive, Suite 400
Concord, CA 94520
Attention: Mardo Kaprealian, P.E.

Client Project ID: Unocal, 3943 Broadway,
Sample Descript: Water, Comp Oakland
Analysis Method: See below
Lab Number: 2060544

Sampled: Jun 11, 1992
Received: Jun 11, 1992
Reported: Jun 25, 1992

HAZARDOUS ABBREVIATED SCREEN BIOASSAY

Static
Cont. Flow

Species: Pimephales Promelas
Common Name: Fat-Head Minnow
Mean length: 31 mm
Mean weight: 0.49 g
Supplier: Sticklebacks Unlimited
Acclimation Temp.: 18 degrees C

Organisms/Tank: 10
Replicates: 1
Organisms/Conc.: 10
Tank Depth: 13 cm
Tank Volume: 10 L

Screening
Definitive

Dilution Water: Synthetic Softwater

	Alkalinity, mg/L	Hardness, mg/L
Control	34	49
250 ppm	-	-
750 ppm	32	49

	Initial	24 Hr	48 Hr	72 Hr	96 Hr
DATE	6/19/92	6/20/92	6/21/92	6/22/92	6/23/92

	DO mg/L	C Temp	pH Units	DO mg/L	C Temp	pH Units	# M Dead	DO mg/L	C Temp	pH Units	# M Dead	DO mg/L	C Temp	pH Units	# M Dead	DO mg/L	C Temp	pH Units	# M Dead	Total Dead
Control	7.7	20	7.5	7.0	17	7.2	0	7.2	18	7.1	0	6.8	17	7.2	0	7.9	17	7.2	0	0
250 ppm	8.0	18	7.8	7.1	17	7.2	0	7.3	18	7.2	0	6.6	17	7.2	0	7.1	16	7.1	0	0
750 ppm	8.0	18	7.8	7.5	16	7.3	0	7.8	17	7.2	0	7.0	16	7.3	0	8.3	16	7.1	0	0
Duplicate																				
250 ppm	7.7	18	7.8	7.0	16	7.2	0	7.2	17	7.2	0	6.5	16	7.2	0	7.8	16	7.1	0	0
750 ppm	8.0	17	7.8	7.6	16	7.2	0	7.7	18	7.2	0	7.0	16	7.2	0	8.3	16	7.2	0	0

Remarks:

Method Reference: Static Acute Bioassay Procedures for Hazardous Waste Samples, September 1987, California Department of Fish and Game WPCL.

SEQUOIA ANALYTICAL

Scott A. Chieffo
Scott A. Chieffo
Project Manager

Unocal Refining & Marketing Division
Unocal Corporation
2000 Crow Canyon Place, Suite 440
P.O. Box 5155
San Ramon, California 94583
Telephone (510) 277-2401

UNOCAL 76

FILE #	0746	SS	<input checked="" type="checkbox"/>	BP	<input type="checkbox"/>
RPT	QM	TRANSMITTAL			
1	2	3	4	5	6

December 31, 1991

Western Marketing Retail

Mr. Clem Leung
Unocal LS-0746
3943 Broadway
Oakland, CA 94611

MONITORING WELLS

Dear Mr. Leung

On January 7, 1992 Unocal contractor Kaprealian Engineering, Inc. needs to enter the station property to install two monitoring wells off-site.

Your station need not be closed down. Additionally, the contractor will work with you to minimize inconvenience to your business.

I appreciate your cooperation in allowing this very necessary work to be completed. Please address any questions you may have to me at (510) 277-2416.

Thank you.

Respectively,



RON SENNER
FIELD SUPPORT COORDINATOR

RES/ved

cc: D. J. Hoover
K. D. Dixon
Ron Bock
Rick Sisk

a:784RES

ALAMEDA COUNTY
HEALTH CARE SERVICES

AGENCY
DAVID J. KEARS, Agency Director



February 1, 1991

DEPARTMENT OF ENVIRONMENTAL HEALTH
Hazardous Materials Program
80 Swan Way, Rm. 200
Oakland, CA 94621
(415)

RECEIVED

FEB 06 1991

SAN RAMON
MAINT. & CONST.

Mr. Ron Bock
Unocal Refining & Marketing
P.O. Box 5155
San Ramon, CA 94583

MARDO

Re: **Groundwater investigation at Unocal #0746, 3943 Broadway,
Oakland**

Dear Mr. Bock:

Thank you for submitting Kaprealian Engineering's December 17 report on the above site. This document describes the installation of four additional monitoring wells at this location, including two off-site, downgradient wells. Groundwater contamination is widespread, apparently extending beyond the furthest downgradient well, MW-9. Based on upgradient wells' analytical data, the hydrocarbons in groundwater have resulted from previous releases from the facility's underground tanks.

Analytical data from the Kaprealian report shows that the groundwater contaminant plume may extend further downgradient and cross-gradient along the Broadway right-of-way. Thus, the plume must be defined towards the south, southeast, and southwest; this means that additional monitoring wells need to be placed along Broadway, within the street and/or on its sidewalks. We are requiring that Unocal develop hard data to define the "zero edge" of the plume. In this respect, the upgradient direction has been defined adequately, and no further wells are necessary to the north or northeast.

Because of the high levels of dissolved gasoline and benzene in the plume, as well as its extent, we are requiring that Unocal begin to develop a remedial action plan for this site. The purpose of the groundwater remediation will be treatment to drinking water standards, i.e., reducing benzene to below state action levels. Such a plan will require the following general elements:

- a monitoring network within and surrounding the plume, to provide an adequate number of data points;
- pump-test data and information on site-specific hydrologic characteristics, including a capture-zone analysis;
- specific information such as location of extraction well(s), groundwater treatment/disposal methods, system maintenance plans, and system evaluation/monitoring protocol; and

Mr. Ron Bock
February 1, 1991
Page 2 of 2

- an implementation schedule for all phases of remedial action.

Please submit a work plan for the installation of additional monitoring wells, together with a report on 1st quarter 1991 sampling, to this office by **March 15, 1991**. Your proposal must include a schedule for installation of the wells and for the implementation of the various elements of groundwater remediation. Copies of this and all technical reports must be sent to the Regional Water Quality Control Board in Oakland, and signed by an appropriate professional.

Because we are overseeing this site under the designated authority of the Water Board, this letter constitutes a formal request for technical reports, per Sec. 13267(b) of the California Water Code. Failure to respond in a timely manner could result in civil liabilities under the Water Code of up to \$1,000 per day. Other violations of California law, such as Sec. 25299.37 of the Health and Safety Code, may also be cited.

If you have any questions about this letter or about remediation requirements established by the RWQCB, please contact me at 271-4320.

Sincerely,

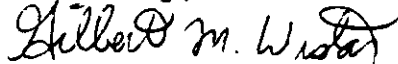

Gil Wistar
Hazardous Materials Specialist

cc: Lester Feldman, San Francisco Bay RWQCB
Rafat Shahid, Asst. Agency Director, Environmental Health
files



Section 6.2.4.3 - Waste Determination Form

Issue Date: 11-1-2003

Revision Date: N/A

Owner: Steve Heidorn

- If a Waste Determination Form (WDF) was completed on this material within the last 3 years and there have been no changes in material components or the process generating the material, you do not need to complete a new form. Complete Section A and file the top copy of this document in the project files for the active period of the project plus 5 years. Authorized (Approval) signature required in Section A.
- X If a Waste Determination Form (WDF) has not been completed in the last 3 years for the material or if the material components or the material generation process has changed since this material was last generated, complete all of the Waste Determination Form. Maintain a copy in the project files for the active period of the project plus 5 years.

A. MATERIAL GENERATOR INFORMATION

- 1. Site Name: 250746
- 2. SIC Code: 562910
- 3. Street Address: 3943 BROADWAY
- 4. Phone #: _____
- 5. City: OAKLAND
- 6. State: CA
- 7. Zip Code: 94611
- 8. EPA ID #: _____
- 9. County: ALAMEDA
- 10. State ID #: _____ Other State ID #: _____
- 11. RM&R Project I.D. #: 1085
- 12. Project Contact Name & Phone Number: Shelby Lathrop 916-558-7609
- 13. Date Form Completed: 2/28/2005
- 14. Material Generation Start Date (Date Waste Container(s) are to be Filled): 1/1/05

B. MATERIAL INFORMATION

- 1. Material Name: Groundwater
- 2. Material Generation Process: Groundwater Monitoring Purge Water

Petroleum contaminated media and debris that fail the test for TCLP but are managed under a Federal/State UST Corrective Action program are excluded from the definition of a solid waste and therefore are not hazardous. (40 CFR 261.4(b) (10)) Project file has the necessary analytical data.

Section A and B approval signature required below.

Approval (Site Mgr): Shelby Lathrop Title: Site Manager Date: 2/28/2005

Note that the remainder of form does not need to be completed if this is a UST project.

C. MATERIAL PROFILE

- 1. Material Type, Specify: _____
- 2. Material Generation Frequency: One Time Only Periodic/Routine
- 3. Material Safety Data Sheets (MSDSs are good sources of information. If an MSDS is not available electronically, contact the material vendor/manufacture and request an MSDS).
(Mark One Only)
 Electronic MSDS/MSDS Number: _____
 Hard Copy (A copy of the MSDS should be submitted along with this completed form).
 No MSDS available
- 4. Physical State: (Mark One Only)
 Solid Sludge (20% Solids) Slurry (> 5% < 20% Solids)
 Mixture Liquid (5% Solids) Compressed Gas
- 5. Characteristics: % Solids _____ Specific Gravity _____ Flashpoint _____ °F / °C pH _____
Circle
- 6. Material description and major components (percent):

WESTERN REGION BOX:

#9470

Store # 250746 Date: 2/28/05
Unit # 0746 Code: WST Color
Description: GWM Waste Determination Form

RM&R Site Mgr
Reviewed By:
Reviewed Date:

WATER QUALITY & COMPLIANCE		Remediation Wastewater from Petroleum Product Facilities	
Responsible Dept: ESD	Orig. Issue: 12/1/94	Latest Revision: 12/17/03	Page: 1

Form R-149: Authorization for Receipt of Remediation Wastewater @ ConocoPhillips's San Francisco Refinery at Rodeo

WASTEWATER TREATMENT PLANT (UNIT 100) OPERATORS:

This form below, if approved, serves as an acceptance document to process the wastewater at the San Francisco Refinery Wastewater Treatment Plant, Unit 100. The Requester is required to supply all of the necessary analytical and completely fill out the following table:

Requester's Name/Signature:	Name: Ed Ralston	Signature:
Company:	ConocoPhillips	Date of Request: 5/12/2005
Address:	76 Broadway, Sacramento, CA. 95818	
Telephone/Fax:	Phone: 916-558-7633	FAX: 916-558-7639
Station No. and Location:	COP #250746, 3943 Broadway, Oakland, CA	
Description of Water Source:	Purge Water - DPE test	
Total Volume of Water/Solids Expected:	Water: 8,000 gallons	Solids: <u>minimal</u>
Expected per-Delivery Volume/Frequency:	Volume: 8,000 gallons	Frequency: one time discharge
Pesticides/Fish Toxicity Expected:	Pesticides: Yes <input type="checkbox"/> No <input checked="" type="checkbox"/>	Fish Tox: Yes <input type="checkbox"/> No <input checked="" type="checkbox"/>
Maximum Rate of Disposal (ESD)	8000 Gallons per Week	

The remediation wastewater described above has been reviewed for Federal and California Hazardous Waste characteristics.

This water is (circle one): recommended / not recommended for processing at the WWTP.

This form is valid until:

ESD Signature:

Operations Signature:

8/14/05

Date Recommended:

Date Approved:

5/16/05
5/17/05

TRUCK DRIVERS: Please provide a copy of this R-149 form upon delivery of wastewater to Unit 100.

Driver's info:

Truck No. _____	pH at site _____
-----------------	------------------

UNIT 100 OPERATORS: Please fill out the portion below and forward this completed form to ESD in Room 111 of the Administration Building.

Date and time of delivery:

Delivered on: ____ / ____ / ____	@ ____ AM / PM
----------------------------------	----------------

Volume delivered:

_____ gallons or _____ bbl.	pH _____
-----------------------------	----------

NO FREE PRODUCT ACCEPTED

GRAVITY OFF-LOAD ONLY

Any questions? Call: (510) 245-4403, (510); (510) 245-4465 or FAX (510) 245-4476.
ONYX/Mark Laliberte: FAX: (707) 745-0510; DIRECT: (707) 748-3722; CELL: (510) 715-6532
TRC: Dennis Jensen; 21 Technology Drive, Irvine, CA 92618; (949) 753-0101 (office); (949) 753-0111 (fax); djensen@trcsolutions.com

WESTERN REGION BOX:

Revision Date: 9/4/03

9 4 8 9

Store # <u>250746</u>	Date: <u>5/16/05</u>
Unit # <u>0746</u>	Code: <u>WST</u> Color: <u>LJ</u>
Description: <u>R-149 FORM</u>	