

RD199
SS

C A M B R I A

January 25, 2001

Ms. Susan Hugo
Alameda County Health Care Services Agency
1131 Harbor Bay Parkway, Suite 250
Alameda, California 94502

Re: **Fourth Quarter 2000 Monitoring Report**
Connell Automobile Dealership
3093 Broadway
Oakland, California
StID #469

ENVIRONMENTAL
PROTECTION
CO 01/25/01 PM 2:51



Dear Ms. Hugo:

On behalf of Messrs. George Hill and Gordon Linden, and as required by the Alameda County Health Care Services Agency (ACHCSA), Cambria Environmental Technology, Inc. (Cambria) has prepared this quarterly monitoring report for the above-referenced site. This report satisfies the quarterly reporting requirements prescribed by 23 CCR 2652d. The site background, fourth quarter 2000 activities and results, and the anticipated first quarter 2001 activities are presented below.

SITE BACKGROUND

Three underground storage tanks (USTs) which previously contained gasoline, diesel, and waste oil were removed from the subject site in December 1989. Soil and groundwater investigation has been ongoing since 1990. Between October 1996 and March 1998, operation of a soil vapor extraction (SVE) remediation system removed approximately 1,421 lbs of hydrocarbons. Manual removal of separate phase hydrocarbons (SPH) from site monitoring wells has been ongoing since 1991.

FOURTH QUARTER 2000 ACTIVITIES AND RESULTS

Groundwater Monitoring: Cambria monitored site groundwater following the sampling protocol described in Cambria's May 8, 2000 *Workplan Addendum*. On November 14, 2000, Cambria gauged monitoring wells MW-1, MW-4, MW-6, MW-7, MW-8, MW-9, MW-13, MW-14, and MW-15, and inspected the wells for SPH. Groundwater samples were collected from wells MW-4, MW-7, MW-8, MW-9, and MW-13. The samples were analyzed by a California Department of Health Services (DHS) certified analytical laboratory for total petroleum hydrocarbons as gasoline (TPHg), benzene, toluene, ethylbenzene, xylenes (BTEX), methyl tertiary butyl ether (MTBE), TPH as diesel (TPHd), TPH as motor oil (TPHmo), and EPA List 8010 halogenated volatile organic compounds (HVOCs). The groundwater elevations, groundwater flow direction, and gradient are shown on

Oakland, CA
San Ramon, CA
Sonoma, CA

**Cambria
Environmental
Technology, Inc.**

1144 65th Street
Suite B
Oakland, CA 94608
Tel (510) 420-0700
Fax (510) 420-9170

Figure 1. The groundwater elevation, petroleum hydrocarbon, and HVOC data are presented in Tables 1 and 2. Dissolved metals data is presented in Table 3, and SPH thicknesses and quantities removed are presented in Table 4. The analytical laboratory report is included as Attachment A. Field data sheets are included as Attachment B.

Groundwater Flow Direction: Based on the November 14, 2000 depth-to-water measurements, groundwater flowed northeastward with a gradient of approximately 0.08 ft/ft during the fourth quarter of 2000 (Figure 1). This result is consistent with the historical local groundwater flow direction.



Contaminant Distribution in Groundwater: In general, monitoring results were consistent with past results for this site. SPH were detected in wells MW-1, MW-6, and MW-14 (Figure 1). The primary contaminants of concern (COCs) in site groundwater are benzene, 1,2 dichloroethane (1,2-DCA), naphthalene, lead and nickel; these COCs are typically associated with releases from USTs containing gasoline, diesel, and/or motor oil. The maximum benzene concentration detected in groundwater was 19,000 micrograms per liter (ug/l) in MW-4, the maximum 1,2-DCA concentration was 610 ug/l in MW-9, the maximum TPHd concentration was 8,000 ug/l in MW-4, and the maximum TPHmo concentration was 290 ug/l, also in MW-4 (Table 1). The contaminant plumes are adequately defined cross-gradient (south) and downgradient (east) of the former UST complex location by wells MW-7 and MW-13, respectively.

Separate-Phase Hydrocarbon Removal: During site visits on October 6, November 3 and December 1, 2000, Cambria inspected the passive SPH recovery devices in wells MW-1, MW-6, and MW-14. On October 6, 2000, product sheen was detected in MW-1 and MW-6; Cambria removed and replaced the absorbent sock in MW-1, and emptied and reset the skimmer in MW-6. On November 3, 2000, product sheen was detected in well MW-1. Product was removed from the sock in well MW-1. On December 1, 2000, product sheen was detected in MW-1, MW-6, and MW-14; the absorbent socks in MW-1 and MW-14 were removed and replaced, and the skimmer in MW-6 was reset. Cambria recovered a total of approximately 10.99 lbs of SPH from the site monitoring wells during the fourth quarter, 2000; and, as of December 31, 2000, a total of approximately 920.49 lbs of SPH had been recovered since liquid-phase hydrocarbon removal began in December 1991. Table 4 presents the SPH thickness measurements, the amount of SPH removed from the wells during each site visit, and the cumulative mass of SPH removed from each well.

ANTICIPATED FIRST QUARTER 2001 ACTIVITIES

Groundwater Monitoring and Reporting: As required by the ACHCSA, Cambria will gauge site wells MW-1, MW-4, MW-6, MW-7, MW-8, MW-9, MW-13, MW-14, and MW-15 on a quarterly basis, collecting groundwater samples from MW-4, MW-7, MW-8, MW-9, and MW-13. During first quarter 2001, Cambria will analyze groundwater samples for TPHd, TPHmo, TPHg, BTEX, MTBE, EPA List 8010 HVOCs, semi-volatile organic compounds (SVOCs), lead, cadmium, chromium, zinc, and nickel (LUFT metals). Cambria will prepare a quarterly monitoring report that will include tabulated groundwater elevation and analytical data and a potentiometric surface map.



Separate-Phase Hydrocarbon Removal: Cambria will conduct monthly SPH recovery events. Proper functioning of the recovery devices in MW-1 and MW-14 will be verified, and the skimmer in MW-6 will be either replaced, possibly with a skimmer containing a hydrophobic filter. Collected SPH will be transferred to labeled, DOT-approved steel drums pending disposal or recycling.

Implementation of the May 8, 2000 Workplan Addendum: Cambria anticipates ongoing implementation of the May 8, 2000 *Workplan Addendum* to continue during the first quarter 2001. As requested by the ACHCSA in its October 30, 2000 letter, Cambria is in the process of preparing a *Feasibility Testing Evaluation and Secondary Feasibility Testing Workplan*. Additional feasibility testing of DVE from site wells MW-1 and MW-6 will be discussed in the workplan. Prior to implementation, cost pre-approval will be obtained from the state UST Cleanup Fund.

CLOSING

We trust that this report meets your requirements. If you have any questions or comments concerning this report, please call Bob Schultz at (510) 420-3341.

Sincerely,
Cambria Environmental Technology, Inc.

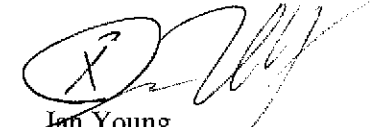

Ian Young
Staff Geologist

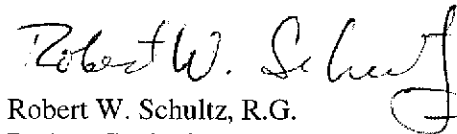

Robert W. Schultz, R.G.
Project Geologist

- Figures: 1 - Groundwater Elevation Contour Map
- Tables: 1 - Groundwater Elevation and Analytical Data: Volatile Hydrocarbons and HVOCs
2 - Groundwater Elevation and Analytical Data: Extractable Hydrocarbons and SVOCs
3 - LUFT Metals in Groundwater
4 - Liquid Phase Hydrocarbon Removal
- Attachments: A - Analytical Laboratory Report
B - Field Data Sheets

cc: Mr. George Hill, 305 Sheridan Avenue, Piedmont, CA 94611
Mr. Gordon Linden, 150 La Salle Avenue, Piedmont, CA 94611
Mr. Paul Kibel, Fitzgerald, Abbott & Beardsley, LLP, 1221 Broadway, 21st Floor, Oakland, CA 94612
Mr. Leroy Griffin, Hazardous Materials Manager, Fire Department - OES, 1605 MLK Jr. Way, Oakland, CA 94612

H:\SB-2000\CONNELLS\FIGURES\40-OLD\DWG

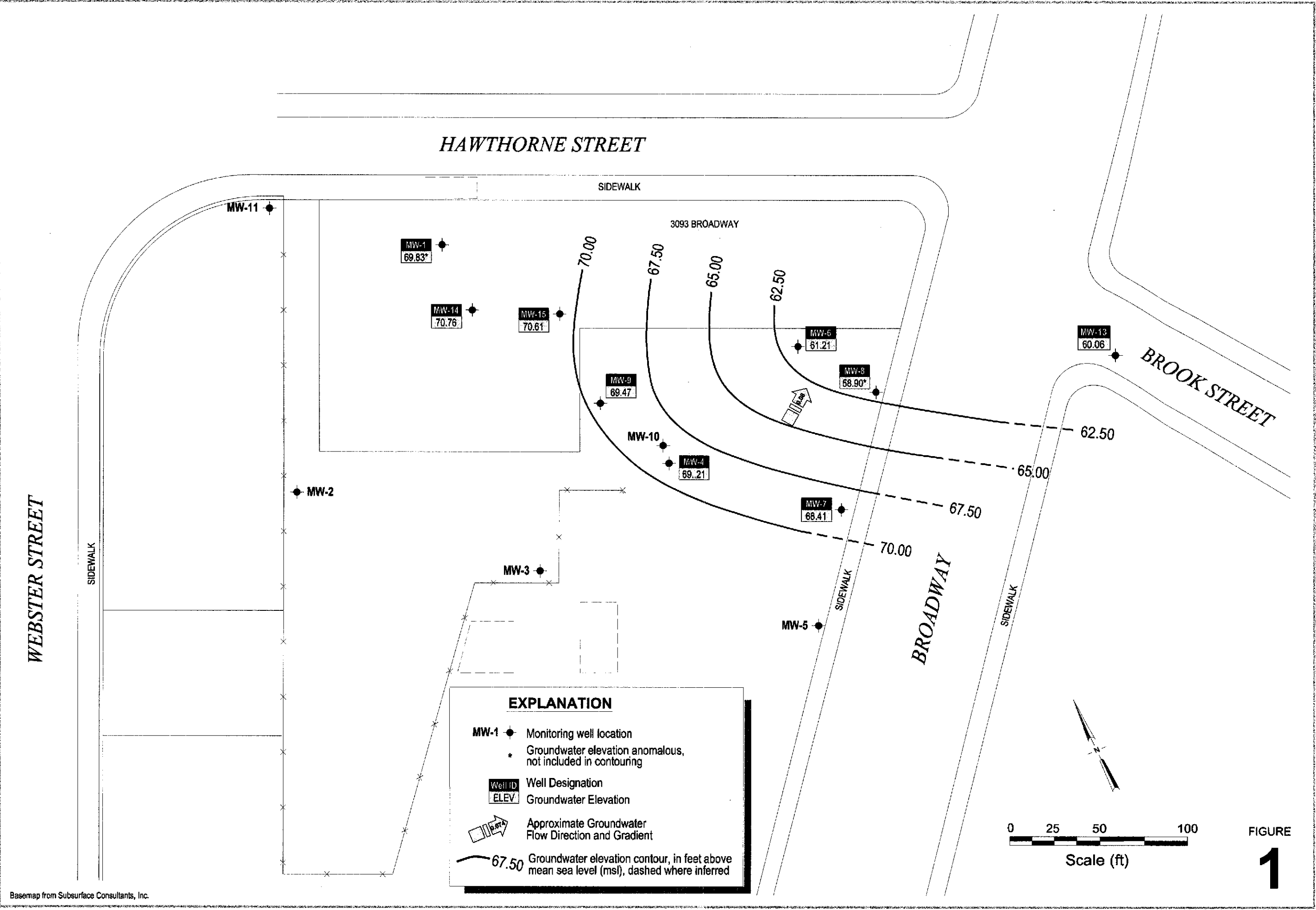

Basemap from Subsurface Consultants, Inc.



CAMBRIA

Table 1. Groundwater Elevation and Analytical Data: Volatile Hydrocarbons and HVOCs

Connell Automobile Dealership, 3093 Broadway, Oakland, California

Well ID TOC Elev. (ft)	Sampling Date	Depth to Groundwater (ft)	Groundwater Elevation (ft)	TVH ←	TPHg	Benzene	Toluene	Ethyl- benzene μg/l	Xylenes	MTBE	1,2-DCA	Other HVOCs →
MW-1	10/5/1990	26.40	68.08	620,000	--	33,000	50,000	7,900	41,000	--	2,900	ND
94.48	3/1/1991	27.46	67.02	SPH	--	--	--	--	--	**	--	--
	10/12/1992	26.44	68.04	490,000	--	51,000	59,000	5,000	27,000	--	1,300	--
	11/24/1992	26.63	67.85	320,000	--	35,000	43,000	4,200	22,000	--	1,600	ND
	4/5/1993	23.77	70.71	270,000	--	50,000	58,000	4,600	25,000	--	1,800	ND
	7/21/1993	24.51	69.97	SPH	--	--	--	--	--	--	--	--
	11/9/1993	26.06	68.42	SPH	--	--	--	--	--	--	--	--
	8/30/1995	21.73	72.75	SPH	--	--	--	--	--	--	--	--
	12/4/1995	21.94	72.54	SPH	--	--	--	--	--	<200	--	--
	5/2/1996	20.65	73.83	340,000	--	57,000	73,000	7,200	38,000	--	1,200	--
	11/5/1996	24.29	70.19	270,000	--	43,000	56,000	4,500	34,000	--	--	--
	5/9/1997	22.79	71.69	240,000	--	36,000	45,000	3,300	17,900	--	930	--
	11/5/1997	25.06	69.42	240,000	--	42,000	48,000	3,600	18,800	<1,000	1,200	--
	2/9/1998	22.64	71.84	220,000	--	47,000	60,000	5,200	29,800	<1,000	1,500	ND
	5/1/1998	19.95	74.53	160,000	--	35,000	42,000	2,800	16,000	<1,000	1,100	ND
	11/3/1998	23.29	71.19	200,000	--	39,000	49,000	4,400	26,000	<500	1,200	ND
	3/24/1999	22.30	72.18	SPH	--	--	--	--	--	--	--	--
	7/1/1999	22.70	71.78	SPH	--	--	--	--	--	--	--	--
	9/21/1999	23.81	70.67	SPH	--	--	--	--	--	--	--	--
	2/9/2000	23.95	70.59	SPH	--	--	--	--	--	--	--	--
	5/31/2000	22.05	72.43	--	SPH	--	--	--	--	--	--	--
	8/8/2000	22.49	71.99	--	SPH	--	--	--	--	--	--	--
	11/14/2000	24.65	69.83	--	SPH	--	--	--	--	--	--	--
MW-2	3/1/1991	27.86	66.95	<50	--	<0.5	<0.5	<0.5	<0.5	--	<1.0	ND
94.81	11/24/1992	27.91	66.90	<50	--	<0.5	1.1	<0.5	1.5	--	<1.0	ND
	4/5/1993	25.95	68.86	<50	--	<0.5	<0.5	<0.5	<0.5	--	<1.0	ND
	7/21/1993	25.59	69.22	<50	--	<0.5	<0.5	<0.5	<0.5	--	<1.0	ND
	11/10/1993	26.72	68.09	<50	--	<0.5	<0.5	<0.5	<0.5	--	<1.0	ND
	8/30/1995	25.75	69.06	<50	--	<0.5	<0.5	<0.5	<0.5	--	<1.0	--
	5/3/1996	23.28	71.53	<50	--	<0.5	<0.5	<0.5	<0.5	--	<1.0	ND
	5/8/1997	24.58	70.23	<50	--	<0.5	0.7	<0.5	<0.5	--	<1.0	--
	4/29/1998	22.18	72.63	<50	--	<0.5	<0.5	<0.5	<0.5	<2	<1.0	ND

CAMBRIA

Table 1. Groundwater Elevation and Analytical Data: Volatile Hydrocarbons and HVOCs

Connell Automobile Dealership, 3093 Broadway, Oakland, California

Well ID TOC Elev. (ft)	Sampling Date	Depth to Groundwater (ft)	Groundwater Elevation (ft)	TVH ←	TPHg	Benzene	Toluene	Ethyl- benzene μg/l	Xylenes	MTBE	1,2-DCA	Other HVOCs →
MW-3 90.08	3/1/1991	23.17	66.91	<50	--	<50	0.6	<0.5	<0.5	--	<1.0	ND
	11/25/1992	23.01	67.07	50	--	<0.5	0.9	<0.5	2	--	<1.0	ND
	4/5/1993	22.11	67.97	<50	--	<0.5	<0.5	<0.5	<0.5	--	<1.0	ND
	7/21/1993	23.93	66.15	<50	--	<0.5	<0.5	<0.5	<0.5	--	<1.0	ND
	11/10/1993	23.14	66.94	<50	--	<0.5	<0.5	<0.5	<0.5	--	<1.0	ND
	8/30/1995	20.61	69.47	<50	--	<0.5	<0.5	<0.5	<0.5	--	<1.0	--
	5/3/1996	18.43	71.65	<50	--	<0.5	<0.5	<0.5	<0.5	--	<1.0	ND
	5/8/1997	19.77	70.31	<50	--	<0.5	0.7	<0.5	<0.5	--	<1.0	--
	4/29/1998	17.92	72.16	<50	--	<0.5	<0.5	<0.5	<0.5	<2	<1.0	ND
MW-4 88.84	3/1/1991	23.79	65.05	150,000	--	20,000	38,000	2,800	14,000	**	610	ND
	10/12/1992	22.48	66.36	230,000	--	15,000	32,000	2,500	14,000	--	430	--
	11/24/1992	22.60	66.24	210,000	--	14,000	31,000	2,500	14,000	--	500	ND
	4/2/1993	20.11	68.73	SPH	--	--	--	--	--	--	--	--
	7/21/1993	20.48	68.36	SPH	--	--	--	--	--	--	--	--
	11/9/1993	21.71	67.13	SPH	--	--	--	--	--	--	--	--
	8/30/1995	19.90	68.94	SPH	--	--	--	--	--	--	--	--
	12/1/1995	19.40	69.44	SPH	--	--	--	--	--	--	--	--
	5/2/1996	17.50	71.34	140,000	--	24,000	50,000	3,000	15,100	--	420	ND
	11/4/1996	20.13	68.71	160,000	--	16,000	38,000	2,700	14,000	--	380	ND
	5/8/1997	18.63	70.21	170,000	--	16,000	37,000	2,400	15,900	--	290	--
	11/5/1997	20.19	68.65	190,000	--	15,000	31,000	2,200	14,600	<400	290	--
	2/9/1998	18.28	70.56	110,000	--	19,000	42,000	2,500	18,300	<500	300	--
	5/1/1998	16.11	72.73	130,000	--	15,000	31,000	2,000	13,400	<1,000	260	ND
	8/4/1998	17.54	71.30	130,000	--	16,000	34,000	2,400	15,700	<400	240	ND
	11/2/1998	19.21	69.63	140,000	--	16,000	32,000	2,300	15,500	<400	230	ND
	3/26/1999	17.51	71.33	110,000	--	15,000	30,000	1,600	15,000	450 ⁴	210	⁵
	7/1/1999	18.80	70.04	110,000	--	13,000	23,000	1,600	12,000	<83	170	⁵
	9/21/1999	19.85	68.99	140,000	--	16,000	31,000	2,400	14,800	ND	<1000	⁵
	2/9/2000	19.76	69.08	--	140,000	16,000	28,000	2,100	14,000	<400	100	DCB: 5.9, MCB: 5.9
5/31/2000	17.90	70.94	--	15,000	17,000	28,000	2,400	14,000	<0.5 ⁶	<0.5	ND	
8/8/2000	18.62	70.22	--	140,000	15,000	25,000	2,100	13,000	<300	110	ND	
11/14/2000	19.63	69.21	--	150,000	19,000	36,000	2,900	17,000	< 200	120	ND	

CAMBRIA

Table 1. Groundwater Elevation and Analytical Data: Volatile Hydrocarbons and HVOCs

Connell Automobile Dealership, 3093 Broadway, Oakland, California

Well ID TOC Elev. (ft)	Sampling Date	Depth to Groundwater (ft)	Groundwater Elevation (ft)	TVH ←	TPHg	Benzene	Toluene	Ethyl- benzene μg/l	Xylenes	MTBE	1,2-DCA	Other HVOCs →
MW-5 84.84	3/15/1991	26.31	58.53	<50	--	<0.5	<0.5	<0.5	<0.5	--	<1.0	ND
	11/10/1992	26.83	58.01	<50	--	<0.5	<0.5	<0.5	<0.5	--	<1.0	ND
	4/2/1993	26.62	58.22	<50	--	<0.5	<0.5	<0.5	<0.5	--	<1.0	ND
	7/21/1993	26.60	58.24	<50	--	<0.5	<0.5	<0.5	<0.5	--	<1.0	ND
	11/9/1993	27.24	57.60	<50	--	<0.5	<0.5	<0.5	<0.5	--	<1.0	ND
	8/30/1995	27.46	57.38	<50	--	<0.5	<0.5	<0.5	<0.5	--	<1.0	--
	5/3/1996	26.02	58.82	<50	--	<0.5	<0.5	<0.5	<0.5	--	<1.0	ND
	5/8/1997	26.76	58.08	<50	--	<0.5	0.5	<0.5	<0.5	--	<1.0	--
	4/29/1998	26.55	58.29	<50	--	<0.5	0.5	<0.5	<0.5	<2	<1.0	ND
MW-6 85.62	3/15/1991	25.82	59.80	80,000	--	12,000	13,000	1,100	5,400	--	1,400	DBCM: 160
	10/12/1992	25.02	60.60	19,000	--	3,200	1,400	200	560	--	840	--
	12/1/1992	28.87	56.75	SPH	--	--	--	--	--	--	--	--
	4/2/1993	26.96	58.66	SPH	--	--	--	--	--	--	--	--
	7/21/1993	26.17	59.45	SPH	--	--	--	--	--	--	--	--
	11/9/1993	27.51	58.11	SPH	--	--	--	--	--	--	--	--
	8/30/1995	28.00	57.62	SPH	--	--	--	--	--	--	--	--
	12/1/1995	27.58	58.04	SPH	--	--	--	--	--	<8,000,000	71	--
86.94	5/3/1996	28.15	58.79	130,000	--	37,000	50,000	3,200	14,200	--	2,400	ND
	5/9/1997	26.54	60.40	1,700,000	--	14,000	27,000	4,000	28,200	--	1,200	--
	11/5/1997	26.16	60.78	160,000	--	13,000	19,000	1,900	14,300	<200	790	--
85.82	5/1/1998	22.96	62.86	130,000	--	15,000	23,000	1,700	13,200	<500	1,100	ND
	11/3/1998	24.35	61.47	110,000	--	17,000	21,000	1,800	10,700	<200	990	ND
	3/26/1999	23.82	62.00	SPH	--	--	--	--	--	--	--	--
	7/1/1999	24.45	61.37	SPH	--	--	--	--	--	--	--	--
	9/21/1999	24.58	61.24	SPH	--	--	--	--	--	--	--	--
	2/9/2000	24.93	61.24	SPH	--	--	--	--	--	--	--	--
	5/31/2000	23.47	62.41	--	SPH	--	--	--	--	--	--	--
	8/8/2000	23.85	61.97	--	SPH	--	--	--	--	--	--	--
	11/14/2000	24.61	61.21	--	SPH	--	--	--	--	--	--	--

CAMBRIA

Table 1. Groundwater Elevation and Analytical Data: Volatile Hydrocarbons and HVOCs

Connell Automobile Dealership, 3093 Broadway, Oakland, California

Well ID	Sampling Date	Depth to Groundwater (ft)	Groundwater Elevation (ft)	TVH	TPHg	Benzene	Toluene	Ethyl-benzene	Xylenes	MTBE	1,2-DCA	Other HVOCs	
TOC Elev. (ft)				←----- μg/l -----→									
MW-8	10/12/1992	27.70	57.80	70	--	20	1	1	3	--	210	--	
85.50	11/25/1992	27.62	57.88	<50	--	<0.5	<0.5	<0.5	<0.5	--	200	ND	
	4/8/1993	26.64	58.86	490	--	15	45	5.1	73	--	210	ND	
	7/21/1993	26.60	58.90	180	--	2.5	3	<0.5	1.9	--	350	ND	
	11/11/1993	27.18	58.32	310	--	23	<0.5	<0.5	<0.5	--	240	ND	
	8/30/1995	26.35	59.15	660	--	360	6.8	13	2.8	--	130	--	
	12/4/1995	26.72	58.78	250	--	46	0.9	4.9	<0.5	--	94	ND	
	5/3/1996	25.47	60.03	69	--	110	<0.5	<0.5	1.5	--	100	ND	
	8/8/1996	26.41	59.09	120	--	11	<0.5	<0.5	<0.5	<2	93	ND	
	11/5/1996	26.77	58.73	110	--	20	<1	1	<1	--	98	ND	
	2/6/1997	25.84	59.66	67 ^{1,2}	--	51	<0.5	0.56	<0.5	<2	81	ND	
	5/9/1997	26.39	59.11	110 ^{1,2}	--	59	<0.5	<0.5	<0.5	--	76	--	
	8/7/1997	26.72	58.78	<50	--	12 ⁵	<0.5	<0.5	<0.5	<2	79	ND	
	11/5/1997	26.82	58.68	<50	--	9.4	<0.5	<0.5	<0.5	<2	84	--	
	2/9/1998	25.57	59.93	<50	--	6	<0.5	<0.5	<0.5	<2	85	--	
	5/1/1998	25.64	59.86	430	--	490	7.1	27	26	<10	85	ND	
	8/5/1998	25.96	59.54	140	--	19	<0.5	5.2	5.3	<2	69	ND	
	11/3/1998	26.27	59.23	150	--	110	1.1	4.3	4.5	<2	67	ND	
	3/31/1999	20.93	64.57	54	--	170	1.5	4.1	1.9	4.4 ⁴	5.9	1,1 DCA: 0.7 ⁵	
	7/1/1999	26.59	58.91	140	--	58	0.9	3	2.3	<0.5	55	--	
	9/21/1999	26.89	58.61	670	--	170	2.6	11	7.9	<5	41	ND	
	2/9/2000	26.60	58.90	--	300	60	1.2	4.8	1.2	<5.0	40	<0.5	
	8/8/2000	26.43	59.07	--	270	56	1.2	4.1	1.0	<5.0	39	ND	
	11/14/2000	26.60	58.90	--	330	64	1.3	3.5	0.60	<5.0	47	ND	
MW-9	11/24/1992	23.51	66.86	19,000	--	180	590	23	2000	--	340	TCM: 15	
90.37	4/5/1993	21.14	69.23	2,300	--	48	4	0.6	13	--	600	TCM: 2	
	7/21/1993	21.54	68.83	2,300	--	170	8.1	15	<0.5	--	1100	ND	
	11/10/1993	27.53	62.84	4,400	--	69	7.3	21	9.7	--	900	ND	
	8/30/1995	19.59	70.78	3,200	--	3,900	49	80	22.8	--	960	--	
	12/4/1995	20.65	69.72	--	--	--	--	--	--	<2	--	--	
	5/2/1996	18.63	71.74	<1300	--	2,600	<13	200	<13	--	550	ND	
	11/5/1996	20.69	69.68	1,800	--	280	<5	65	<5	--	770	ND	

CAMBRIA

Table 1. Groundwater Elevation and Analytical Data: Volatile Hydrocarbons and HVOCs

Connell Automobile Dealership, 3093 Broadway, Oakland, California

Well ID TOC Elev. (ft)	Sampling Date	Depth to Groundwater (ft)	Groundwater Elevation (ft)	TVH ←	TPHg	Benzene	Toluene	Ethyl- benzene μg/l	Xylenes	MTBE	1,2-DCA	Other HVOCs →
MW-9	5/9/1997	19.96	70.41	1,100	--	160	<0.5	42	<0.5	--	690	--
(cont'd)	8/8/1997	20.84	69.53	570 ^{1,2}	--	<0.5	<0.5	<0.5	0.78 ³	<2	680	ND
	11/5/1997	21.55	68.82	490 ¹	--	<0.5	<0.5	6	<0.5	<2	500	--
	2/9/1998	20.21	70.16	270 ¹	--	48	17	5.8	<0.5	<2	520	--
	5/1/1998	19.27	71.10	550	--	70	<0.5	22	2.2	<2	390	ND
	8/5/1998	19.35	71.02	550 ¹	--	88	<0.5	13	1.9 ³	<2	420	ND
	11/2/1998	20.43	69.94	580	--	<0.5	<0.5	7.5 ³	1.6 ³	<2	430	ND
	3/25/1999	18.46	71.91	1,100	--	160	<0.5	21	2.1 ³	5.7 ⁴	550	ND
	7/1/1999	19.95	70.42	540	--	100	7.4	26	16.9	<1.3	400	⁵
	9/21/1999	21.15	69.22	2,700	--	320	98	88	47	<20	540	ND
	2/9/2000	21.08	69.29	--	1,600	81	3.6	19	18	<5.0	360	<0.5
	5/31/2000	19.11	71.26	--	1,500	170	13	25	<1.0	<0.5	300	ND
	8/8/2000	19.86	70.51	--	1,300	140	2.1	19	<0.5	<5.0	330	ND
	11/14/2000	20.90	69.47	--	1,700	250	2.6	44	2.1	<5.0	610	ND
MW-10	10/12/1992	21.55	67.05	28,000	--	2,700	3,800	210	1,300	--	150	--
88.60	11/24/1992	21.86	66.74	130,000	--	9,700	19,000	1,400	8,400	--	370	ND
	4/5/1993	19.14	69.46	63,000	--	6,300	14,000	1,100	7,500	--	70	ND
	7/21/1993	19.79	68.81	140,000	--	16,000	31,000	2,200	13,000	--	700	ND
	8/30/1995	17.99	70.61	92,000	--	13,000	24,000	1,800	9,100	--	300	--
	5/3/1996	17.04	71.56	81,000	--	17,000	29,000	2,100	8,500	--	320	ND
	5/9/1997	18.36	70.24	63,000	--	7,400	13,000	940	4,100	--	150	--
	5/1/1998	15.84	72.76	60,000	--	7,100	14,000	1100	5,300	<250	120	ND
MW-11	11/24/1992	33.65	68.41	<50	--	<0.5	<0.5	<0.5	<0.5	--	<1.0	ND
102.06	12/8/92***	33.37	68.69	<50	--	<0.1	<0.1	<0.1	<0.1	--	--	--
	12/8/1992	33.37	68.69	<50	--	<0.5	<0.5	<0.5	<0.5	--	--	--
	4/5/1993	31.03	71.03	<50	--	<0.5	<0.5	<0.5	<0.5	--	<1.0	ND
	7/21/1993	31.90	70.16	160	--	<0.5	1.8	<0.5	<0.5	--	<1.0	ND
	11/9/1993	32.60	69.46	80	--	<0.5	<0.5	<0.5	<0.5	--	<1.0	ND
	8/30/1995	28.92	73.14	<50	--	<0.5	<0.5	<0.5	<0.5	--	<1.0	--
	5/3/1996	28.00	74.06	<50	--	<0.5	<0.5	<0.5	<0.5	--	<1.0	ND
	5/8/1997	29.93	72.13	<50	--	<0.5	<0.5	<0.5	<0.5	--	<1.0	--
	4/29/1998	27.22	74.84	<50	--	<0.5	<0.5	<0.5	<0.5	<2	<1.0	ND

CAMBRIA

Table 1. Groundwater Elevation and Analytical Data: Volatile Hydrocarbons and HVOCs

Connell Automobile Dealership, 3093 Broadway, Oakland, California

Well ID TOC Elev. (ft)	Sampling Date	Depth to Groundwater (ft)	Groundwater Elevation (ft)	←-----→								
				TVH	TPHg	Benzene	Toluenc	Ethyl- benzene μg/l	Xylenes	MTBE	1,2-DCA	Other HVOCs
MW-13	11/24/1992	26.05	58.01	<50	--	<0.5	<0.5	<0.5	<0.5	--	<1.0	ND
84.06	12/8/92***	25.08	58.98	<50	--	<0.1	<0.1	<0.1	<0.1	--	--	--
	12/8/1992	25.08	58.98	<50	--	<0.5	<0.5	<0.5	<0.5	--	--	--
	4/5/1993	24.64	59.42	<50	--	<0.5	0.9	<0.5	<0.5	--	<1.0	ND
	7/21/1993	24.29	59.77	<50	--	<0.5	<0.5	<0.5	<0.5	--	<1.0	ND
	11/9/1993	24.23	59.83	<50	--	<0.5	<0.5	<0.5	<0.5	--	<1.0	ND
	8/30/1995	23.30	60.76	<50	--	49	<0.5	<0.5	<0.5	--	3.6	--
	12/1/1995	23.80	60.26	<50	--	<0.5	<0.5	<0.5	<0.5	--	4.1	ND
	5/3/1996	23.19	60.87	<50	--	<0.5	<0.5	<0.5	<0.5	--	4	ND
	8/8/1996	23.44	60.62	<50	--	32	<0.5	<0.5	<0.5	<2	6.4	ND
	11/5/1996	24.04	60.02	<50	--	<1	<1	<1	<1	--	5.7	ND
	2/6/1997	23.24	60.82	<50	--	<0.5	<0.5	<0.5	<0.5	<2	3.5	ND
	5/8/1997	23.46	60.60	<50	--	81	<0.5	<0.5	<0.5	--	5.5	--
	8/8/1997	23.92	60.14	<50	--	<0.5	<0.5	<0.5	<0.5	<2	6.8	ND
	11/5/1997	24.27	59.79	<50	--	<0.5	<0.5	<0.5	<0.5	<2	5.5	--
	2/9/1998	22.89	61.17	<50	--	<0.5	<0.5	<0.5	<0.5	<2	2.9	--
	4/29/1998	22.27	61.79	<50	--	24	<0.5	<0.5	<0.5	<2	5.7	ND
	8/4/1998	22.75	61.31	120	--	200	<1	<1	<1	<4	6.2	ND
	11/3/1998	23.90	60.16	59 ¹	--	33	<0.5	<0.5	<0.5	<2	6.1	ND
	3/31/1999	23.11	60.95	130	--	0.56	<0.5	<0.5	<0.5	<2	1.4	ND
	7/1/1999	23.40	60.66	160	--	370	19	1.2	3.5	<1	4.2	⁵
	9/21/1999	21.91	62.15	370	--	150	1.0	0.8	0.8	<5.0	<5.0	ND
	2/9/2000	23.84	60.22	--	<50	<0.5	<0.5	<0.5	<0.5	<5.0	2.1	<0.5
	8/8/2000	23.31	60.75	--	<50	<0.5	<0.5	<0.5	<0.5	<5.0	3.6	ND
	11/14/2000	24.00	60.06	--	<50	<0.5	0.52	<0.5	<0.5	<5.0	3.3	ND

CAMBRIA

Table 1. Groundwater Elevation and Analytical Data: Volatile Hydrocarbons and HVOCs

Connell Automobile Dealership, 3093 Broadway, Oakland, California

Well ID TOC Elev. (ft)	Sampling Date	Depth to Groundwater (ft)	Groundwater Elevation (ft)	TVH ←	TPHg	Benzene	Toluene	Ethyl- benzene μg/l	Xylenes	MTBE	1,2-DCA	Other HVOCs →
MW-14 94.66	5/26/1998	21.67	72.99	41,000	--	7,100	11,000	720	3,900	<1000	440	ND
	7/1/1999	22.95	71.71	SPH	--	--	--	--	--	--	--	--
	9/21/1999	24.26	70.40	SPH	--	--	--	--	--	--	--	--
	2/9/2000	24.13	70.53	--	92,000	12,000	17,000	1,300	8,700	<140	450	<0.5
	5/31/2000	22.09	72.57	--	SPH	--	--	--	--	--	--	--
	8/8/2000	22.88	71.78	--	SPH	--	--	--	--	--	--	--
	11/14/2000	23.90	70.76	--	SPH	--	--	--	--	--	--	--
MW-15 94.76	5/26/1998	21.87	72.89	130,000	--	30,000	38,000	2,500	12,600	<1000	1,200	ND
	7/1/1999	22.25	72.51	SPH	--	--	--	--	--	--	--	--
	9/21/1999	24.12	70.64	SPH	--	--	--	--	--	--	--	--
	2/9/2000	24.42	70.34	--	180,000	32,000	37,000	2,800	14,000	<200	1,100	<0.5
	5/31/2000	22.40	72.36	--	SPH	--	--	--	--	--	--	--
	8/8/2000	23.17	71.59	--	SPH	--	--	--	--	--	--	--
	11/14/2000	24.15	70.61	--	SPH	--	--	--	--	--	--	--

Abbreviations and Notes:

TOC Elev. (ft) = Top of casing elevation in feet above mean sea level

μg/l = micrograms per liter = parts per billion = ppb

TVH = Total Volatile Hydrocarbons

TPHg = Total petroleum hydrocarbons as gasoline

MTBE = Methyl tert-butyl ether

1,2-DCA = 1,2 Dichloroethane

HVOCs = Halogenated volatile organic compounds by EPA Method 8010

DCB = 1, 3 Dichlorobenzene

MCB = Chlorobenzene

DBCM = Dibromochloromethane

TCM = Chloroform = trichloromethane

ND = None detected above laboratory reporting limit, see laboratory report for individual reporting limits.

-- = Sample not analyzed

SPH = Free product encountered in well

<n = Chemical not present at a concentration in excess of detection limit shown

MW-1 was initially referred to as Sample 5.

* = Suspect laboratory contamination contributing to test result.

** = Fuel fingerprint analysis indicates MTBE is not present in the free product sample collected from this well.

*** = Duplicate sample sent to a different chemical laboratory.

1 = Sample exhibits fuel pattern which does not resemble standard

2 = Lighter hydrocarbons than indicated standard

3 = Presence of this compound confirmed by second column, however, the confirmation concentration differed from the reported result by more than a factor of two

4 = Detection may potentially be a false positive, to be checked during the next event.

5 = One or more of the following substances found: Acetone, 1,2-Dibromoethane, 1,3,5-Trimethylbenzene, 2-Chlorotoluene, 1,2,4-Trimethylbenzene, n-Butylbenzene, and Naphthalene. See laboratory results for details.

6 = Confirmed by GC/MS.

CAMBRIA

Table 2. Groundwater Elevation and Analytical Data: Extractable Hydrocarbons and SVOCs

Connell Automobile Dealership, 3093 Broadway, Oakland, California

Well ID TOC Elev. (ft)	Sampling Date	Depth to water (ft)	Groundwater Elevation (ft)	←-----→					
				TEH	TPHd	TPHmo	2-Methyl naphthalene µg/l	Naphthalene	Other SVOCs
MW-1	10/5/1990	26.40	68.08	<500	--	--	--	--	--
94.48	3/1/1991	27.46	67.02	SPH	--	--	--	--	--
	10/12/1992	26.44	68.04	--	--	--	--	--	--
	11/24/1992	26.63	67.85	4,600	--	--	--	--	--
	4/5/1993	23.77	70.71	25,000	--	--	--	--	--
	7/21/1993	24.51	69.97	SPH	--	--	--	--	--
	11/9/1993	26.06	68.42	SPH	--	--	--	--	--
	8/30/1995	21.73	72.75	SPH	--	--	630	1,200	ND
	12/4/1995	21.94	72.54	SPH	--	--	--	--	--
	5/2/1996	20.65	73.83	32,000	--	--	250	640	ND
	11/5/1996	24.29	70.19	--	--	--	--	--	--
	5/9/1997	22.79	71.69	28,000	--	--	280	650	ND
	11/5/1997	25.06	69.42	28,000	--	--	720	1,500	ND
	2/9/1998	22.64	71.84	27,000	--	--	160	570	ND
	5/1/1998	19.95	74.53	29,000	--	--	--	--	--
	5/27/1998	--	--	--	--	--	120	630	ND
	11/3/1998	23.29	71.19	37,000	--	--	500	1,100	ND
	3/24/1999	22.30	72.18	SPH	--	--	--	--	--
	7/1/1999	22.70	71.78	SPH	--	--	--	--	--
	9/21/1999	23.81	70.67	SPH	--	--	--	--	--
	2/9/2000	23.95	70.59	--	SPH	--	--	--	--
5/31/2000	22.05	72.43	--	SPH	--	--	--	--	
11/14/2000	24.65	69.83	--	SPH	--	--	--	--	
MW-2	3/1/1991	27.86	66.95	<50	--	--	--	--	--
94.81	11/24/1992	27.91	66.90	<50	--	--	--	--	--
	4/5/1993	25.95	68.86	870	--	--	--	--	--
	7/21/1993	25.59	69.22	<50	--	--	--	--	--
	11/10/1993	26.72	68.09	240	--	--	--	--	--
	8/30/1995	25.75	69.06	150	--	--	--	--	--
	5/3/1996	23.28	71.53	<50	--	--	--	--	--
	5/8/1997	24.58	70.23	<50	--	--	--	--	--
	4/29/1998	22.18	72.63	<47	--	--	--	--	--

CAMBRIA

Table 2. Groundwater Elevation and Analytical Data: Extractable Hydrocarbons and SVOCs

Connell Automobile Dealership, 3093 Broadway, Oakland, California

Well ID	Sampling Date	Depth to water (ft)	Groundwater Elevation (ft)	TEH	TPHd	TPHmo	2-Methyl naphthalene µg/l	Naphthalene	Other SVOCs
MW-3	3/1/1991	23.17	66.91	<50	--	--	--	--	--
90.08	11/25/1992	23.01	67.07	160	--	--	--	--	--
	4/5/1993	22.11	67.97	<50	--	--	--	--	--
	7/21/1993	23.93	66.15	<50	--	--	--	--	--
	11/10/1993	23.14	66.94	<50	--	--	--	--	--
	8/30/1995	20.61	69.47	<50	--	--	--	--	--
	5/3/1996	18.43	71.65	<50	--	--	--	--	--
	5/8/1997	19.77	70.31	<50	--	--	--	--	--
	4/29/1998	17.92	72.16	<47	--	--	--	--	--
MW-4	3/1/1991	23.79	65.05	<500	--	--	--	--	--
88.84	10/12/1992	22.48	66.36	--	--	--	--	--	--
	11/24/1992	22.60	66.24	1,600	--	--	--	--	--
	4/2/1993	20.11	68.73	SPH	--	--	--	--	--
	7/21/1993	20.48	68.36	SPH	--	--	--	--	--
	11/9/1993	21.71	67.13	SPH	--	--	--	--	--
	8/30/1995	19.90	68.94	SPH	--	--	--	--	--
	12/1/1995	19.40	69.44	SPH	--	--	--	--	--
	5/2/1996	17.50	71.34	9,200	--	--	--	--	--
	11/4/1996	20.13	68.71	4,700	--	--	--	--	--
	5/8/1997	18.63	70.21	5,100	--	--	--	--	--
	11/5/1997	20.19	68.65	3,700	--	--	--	--	--
	2/9/1998	18.28	70.56	4,800	--	--	--	--	--
	5/1/1998	16.11	72.73	5,000	--	--	--	--	--
	8/4/1998	17.54	71.30	3,500	--	--	--	--	--
	11/2/1998	19.21	69.63	7,200	--	--	--	--	--
	3/26/1999	17.51	71.33	14,000	--	--	--	--	--
	7/1/1999	18.80	70.04	17,000	--	--	370	860	ND
	9/21/1999	19.85	68.99	14,000	--	--	360	820	ND
	2/9/2000	19.76	69.08	--	12,000	1,000	290	700	ND
	5/31/2000	17.90	70.94	--	14,000 **	<500	--	--	--
	11/14/2000	19.63	69.21	--	8,000	290	--	--	--

CAMBRIA

Table 2. Groundwater Elevation and Analytical Data: Extractable Hydrocarbons and SVOCs

Connell Automobile Dealership, 3093 Broadway, Oakland, California

Well ID TOC Elev. (ft)	Sampling Date	Depth to water (ft)	Groundwater Elevation (ft)	TEH ←	TPHd	TPHmo	2-Methyl naphthalene µg/l	Naphthalene	Other SVOCs →
MW-5 84.84	3/15/1991	26.31	58.53	<50	--	--	--	--	--
	11/10/1992	26.83	58.01	50	--	--	--	--	--
	4/2/1993	26.62	58.22	<50	--	--	--	--	--
	7/21/1993	26.60	58.24	190	--	--	--	--	--
	11/9/1993	27.24	57.60	170	--	--	--	--	--
	8/30/1995	27.46	57.38	180	--	--	--	--	--
	5/3/1996	26.02	58.82	<50	--	--	--	--	--
	5/8/1997	26.76	58.08	<50	--	--	--	--	--
	4/29/1998	26.55	58.29	<47	--	--	--	--	--
MW-6 85.62	3/15/1991	25.82	59.80	<50	--	--	--	--	--
	10/12/1992	25.02	60.60	--	--	--	--	--	--
	12/1/1992	28.87	56.75	SPH	--	--	--	--	--
	4/2/1993	26.96	58.66	SPH	--	--	--	--	--
	7/21/1993	26.17	59.45	SPH	--	--	--	--	--
	11/9/1993	27.51	58.11	SPH	--	--	--	--	--
	8/30/1995	28.00	57.62	SPH	--	--	--	--	--
	12/1/1995	27.58	58.04	SPH	--	--	--	--	--
	5/3/1996	26.83	58.79	9,000	--	--	--	--	--
86.94	5/9/1997	26.54	60.40	53,000	--	--	--	--	--
	11/5/1997	26.16	60.78	65,000	--	--	--	--	--
85.82	5/1/1998	22.96	62.86	25,000	--	--	--	--	--
	11/3/1998	24.35	61.47	30,000	--	--	--	--	--
	3/26/1999	23.82	62.00	SPH	--	--	--	--	--
	7/1/1999	24.45	61.37	SPH	--	--	--	--	--
	9/21/1999	24.58	61.24	SPH	--	--	--	--	--
	2/9/2000	24.93	61.24	--	SPH	--	--	--	--
	5/31/2000	23.47	62.41	--	SPH	--	--	--	--
	11/14/2000	24.61	61.21	--	SPH	--	--	--	--
MW-7 85.41	3/15/1991	21.63	63.78	<50	--	--	--	--	--
	11/24/1992	21.52	63.89	<50	--	--	--	--	--
	4/2/1993	20.08	65.33	<50	--	--	--	--	--
	7/21/1993	19.59	65.82	150	--	--	--	--	--
	11/9/1993	20.65	64.76	200	--	--	--	--	--
	8/30/1995	18.78	66.63	170	--	--	--	--	--
	12/1/1995	19.47	65.94	<50	--	--	--	--	--

CAMBRIA

Table 2. Groundwater Elevation and Analytical Data: Extractable Hydrocarbons and SVOCs

Connell Automobile Dealership, 3093 Broadway, Oakland, California

Well ID	Sampling Date	Depth to water (ft)	Groundwater Elevation (ft)	TEH	TPHd	TPHmo	2-Methyl naphthalene $\mu\text{g/l}$	Naphthalene	Other SVOCs
MW-7	5/2/1996	17.15	68.26	<50	--	--	--	--	--
(cont'd)	8/8/1996	18.48	66.93	<50	--	--	--	--	--
	11/4/1996	18.69	66.72	<50	--	--	--	--	--
	2/6/1997	17.44	67.97	<50	--	--	--	--	--
	5/8/1997	17.72	67.69	<50	--	--	--	--	--
	8/7/1997	18.49	66.92	<50	--	--	--	--	--
	11/5/1997	18.86	66.55	<50	--	--	--	--	--
	2/9/1998	17.56	67.85	<50	--	--	--	--	--
	4/29/1998	16.23	69.18	<47	--	--	--	--	--
	8/4/1998	17.24	68.17	<50	--	--	--	--	--
	11/2/1998	17.91	67.50	<50	--	--	--	--	--
	3/26/1999	16.42	68.99	<50	--	--	--	--	--
	7/1/1999	17.90	67.51	<50	--	--	<10	<10	ND
	9/21/1999	18.91	66.50	<48	--	--	<9.5	<9.5	ND
	2/9/2000	16.74	68.67	--	<50	<250	<10	<10	ND
	5/31/2000	16.21	69.20	--	<50	<500	--	--	--
	11/14/2000	17.00	68.41	--	< 50	< 250	--	--	--
MW-8	10/12/1992	27.70	57.80	--	--	--	--	--	--
85.50	11/25/1992	27.62	57.88	170	--	--	--	--	--
	4/8/1993	26.64	58.86	100	--	--	--	--	--
	7/21/1993	26.60	58.90	90	--	--	--	--	--
	11/11/1993	27.18	58.32	170	--	--	--	--	--
	8/30/1995	26.35	59.15	240	--	--	--	--	--
	12/4/1995	26.72	58.78	<50	--	--	--	--	--
	5/3/1996	25.47	60.03	94	--	--	--	--	--
	8/8/1996	26.41	59.09	250	--	--	--	--	--
	11/5/1996	26.77	58.73	<50	--	--	--	--	--
	2/6/1997	25.84	59.66	130	--	--	--	--	--
	5/9/1997	26.39	59.11	120	--	--	--	--	--
	8/7/1997	26.72	58.78	150	--	--	--	--	--
	11/5/1997	26.82	58.68	110	--	--	--	--	--
	2/9/1998	25.57	59.93	75	--	--	--	--	--
	5/1/1998	25.64	59.86	210	--	--	--	--	--
	8/5/1998	25.96	59.54	260	--	--	--	--	--
	11/3/1998	26.27	59.23	190	--	--	--	--	--
	3/31/1999	20.93	64.57	200	--	--	--	--	--

CAMBRIA

Table 2. Groundwater Elevation and Analytical Data: Extractable Hydrocarbons and SVOCs

Connell Automobile Dealership, 3093 Broadway, Oakland, California

Well ID TOC Elev. (ft)	Sampling Date	Depth to water (ft)	Groundwater Elevation (ft)	TEH ←	TPHd	TPHmo	2-Methyl naphthalene µg/l	Naphthalene	Other SVOCs →
MW-8	7/1/1999	26.59	58.91	170	--	--	<9.6	<9.6	ND
(cont'd)	9/21/1999	26.89	58.61	420	--	--	<9.4	<9.4	ND
	2/9/2000	26.60	58.90	--	120	280	<10	<10	ND
	5/31/2000	26.16	59.34	--	160 **	<500	--	--	--
	11/14/2000	26.60	58.90	--	150	< 250	--	--	--
MW-9 90.37	11/24/1992	23.51	66.86	320	--	--	--	--	--
	4/5/1993	21.14	69.23	920	--	--	--	--	--
	7/21/1993	21.54	68.83	450	--	--	--	--	--
	11/10/1993	27.53	62.84	450	--	--	--	--	--
	8/30/1995	19.59	70.78	680	--	--	--	--	--
	12/4/1995	20.65	69.72	--	--	--	--	--	--
	5/2/1996	18.63	71.74	710	--	--	--	--	--
	11/5/1996	20.69	69.68	420	--	--	--	--	--
	5/9/1997	19.96	70.41	490	--	--	--	--	--
	8/8/1997	20.84	69.53	480	--	--	--	--	--
	11/5/1997	21.55	68.82	370	--	--	--	--	--
	2/9/1998	20.21	70.16	410	--	--	--	--	--
	5/1/1998	19.27	71.10	450	--	--	--	--	--
	8/5/1998	19.35	71.02	630	--	--	--	--	--
	11/2/1998	20.43	69.94	500	--	--	--	--	--
	3/25/1999	18.46	71.91	630	--	--	--	--	--
	7/1/1999	19.95	70.42	570	--	--	<9.5	<9.5	ND
	9/21/1999	21.15	69.22	770	--	--	<9.4	<9.4	ND
	2/9/2000	21.08	69.29	--	320	<250	<10	<10	ND
	5/31/2000	19.11	71.26	--	390 **	<500	--	--	--
	11/14/2000	20.90	69.47	--	160	< 250	--	--	--
MW-10 88.60	10/12/1992	21.55	67.05	--	--	--	--	--	--
	11/24/1992	21.86	66.74	1,300	--	--	--	--	--
	4/5/1993	19.14	69.46	5,000	--	--	--	--	--
	7/21/1993	19.79	68.81	20,000	--	--	--	--	--
	8/30/1995	17.99	70.61	5,900	--	--	--	--	--
	5/3/1996	17.04	71.56	5,600	--	--	--	--	--
	5/9/1997	18.36	70.24	2,500	--	--	--	--	--
	5/1/1998	15.84	72.76	2,000	--	--	--	--	--

CAMBRIA

Table 2. Groundwater Elevation and Analytical Data: Extractable Hydrocarbons and SVOCs

Connell Automobile Dealership, 3093 Broadway, Oakland, California

Well ID TOC Elev. (ft)	Sampling Date	Depth to water (ft)	Groundwater Elevation (ft)	TEH ←	TPHd	TPHmo	2-Methyl naphthalene µg/l	Naphthalene	Other SVOCs →
MW-11 102.06	11/24/1992	33.65	68.41	220	--	--	--	--	--
	12/8/92*	33.37	68.69	140	--	--	--	--	--
	12/8/1992	33.37	68.69	120	--	--	--	--	--
	4/5/1993	31.03	71.03	<50	--	--	--	--	--
	7/21/1993	31.90	70.16	150	--	--	--	--	--
	11/9/1993	32.60	69.46	60	--	--	--	--	--
	8/30/1995	28.92	73.14	240	--	--	--	--	--
	5/3/1996	28.00	74.06	<50	--	--	--	--	--
	5/8/1997	29.93	72.13	<50	--	--	--	--	--
	4/29/1998	27.22	74.84	<47	--	--	--	--	--
MW-13 84.06	11/24/1992	26.05	58.01	3,600	--	--	--	--	--
	12/8/92*	25.08	58.98	210	--	--	--	--	--
	12/8/1992	25.08	58.98	100	--	--	--	--	--
	4/5/1993	24.64	59.42	<50	--	--	--	--	--
	7/21/1993	24.29	59.77	<50	--	--	--	--	--
	11/9/1993	24.23	59.83	160	--	--	--	--	--
	8/30/1995	23.30	60.76	<50	--	--	--	--	--
	12/1/1995	23.80	60.26	<50	--	--	--	--	--
	5/3/1996	23.19	60.87	<50	--	--	--	--	--
	8/8/1996	23.44	60.62	<50	--	--	--	--	--
	11/5/1996	24.04	60.02	<50	--	--	--	--	--
	2/6/1997	23.24	60.82	<50	--	--	--	--	--
	5/8/1997	23.46	60.60	<50	--	--	--	--	--
	8/8/1997	23.92	60.14	<50	--	--	--	--	--
	11/5/1997	24.27	59.79	<50	--	--	--	--	--
	2/9/1998	22.89	61.17	<50	--	--	--	--	--
	4/29/1998	22.27	61.79	<47	--	--	--	--	--
	8/4/1998	22.75	61.31	78	--	--	--	--	--
	11/3/1998	23.90	60.16	<50	--	--	--	--	--
	3/31/1999	23.11	60.95	<48	--	--	--	--	--
	7/1/1999	23.40	60.66	100	--	--	<9.6	<9.6	ND
	9/21/1999	21.91	62.15	<48	--	--	<9.4	<9.4	ND
	2/9/2000	23.84	60.22	--	<50	<250	<10	<10	ND
	5/31/2000	22.97	61.09	--	<50	<500	--	--	--
	11/14/2000	24.00	60.06	--	65	< 250	--	--	--

CAMBRIA

Table 2. Groundwater Elevation and Analytical Data: Extractable Hydrocarbons and SVOCs

Connell Automobile Dealership, 3093 Broadway, Oakland, California

Well ID	Sampling Date	Depth to water (ft)	Groundwater Elevation (ft)	TEH	TPHd	TPHmo	2-Methyl naphthalene $\mu\text{g/l}$	Naphthalene	Other SVOCs
MW-14	5/26/1998	21.67	72.99	7,700	--	--	--	--	--
94.66	7/1/1999	22.95	71.71	SPH	--	--	--	--	--
	9/21/1999	24.26	70.40	SPH	--	--	--	--	--
	2/9/2000	24.13	70.53	--	14,000	1,500	290	600	ND
	5/31/2000	22.09	72.57	--	SPH	--	--	--	--
	11/14/2000	23.90	70.76	--	SPH	--	--	--	--
MW-15	5/26/1998	21.87	72.89	1,700	--	--	--	--	--
94.76	7/1/1999	22.25	72.51	SPH	--	--	--	--	--
	9/21/1999	24.12	70.64	SPH	--	--	--	--	--
	2/9/2000	24.42	70.34	--	4,000	1,200	50	270	ND
	5/31/2000	22.40	72.36	--	SPH	--	--	--	--
	11/14/2000	24.15	70.61	--	SPH	--	--	--	--

Abbreviations and Notes:

TOC Elev. (ft) = Top of casing elevation, surveyed to an arbitrary datum

TEH = Total extractable hydrocarbons

TPHd = Total petroleum hydrocarbons as diesel

TPHmo = Total petroleum hydrocarbons as motor oil

SVOCs = Semi-volatile organic compounds

Other SVOC's = All other compounds analyzed by EPA Method 8270

$\mu\text{g/l}$ = micrograms per liter = parts per billion = ppb

ND = None detected above laboratory reporting limit, see laboratory report for individual reporting limits

< n = Not detected above n ug/l

-- = Not analyzed/not available

* = Duplicate sample sent to a different chemical laboratory

** = Does not match diesel pattern

CAMBRIA

Table 3. LUFT Metals in Groundwater

Connell Automobile Dealership, 3093 Broadway, Oakland, California

Well ID	Sampling Date	Cadmium	Chromium	Lead	Nickel	Zinc
		←-----ug/l-----→				
MW-4	7/1/1999	<5	<10	59	<20	<20
	9/21/1999	<5	<10	66	<20	33
	2/9/2000	<5	17	68	<50	<50
MW-7	7/1/1999	<5	<10	<3	<20	<20
	9/21/1999	<5	<10	<3	<20	<20
	2/9/2000	<5	14	8.6	59	<50
MW-8	7/1/1999	<5	<10	<3	<20	<20
	9/21/1999	<5	<10	<3	<20	<20
	2/9/2000	<5	<5	<5	<50	<50
MW-9	7/1/1999	<5	<10	<3	34	<20
	9/21/1999	<5	<10	<3	25	37
	2/9/2000	<5	82	29	160	130
MW-13	7/1/1999	<5	<10	<3	<20	<20
	9/21/1999	<5	<10	<3	<20	<20
	2/9/2000	<5	12	15	<50	<50
MW-14	2/9/2000	<5	210	24	2,500	280
MW-15	2/9/2000	<5	140	1,800	220	150

Abbreviations and Notes:

LUFT metals analyzed by EPA Method 6010

ug/l = micrograms per liter

CAMBRIA

Table 4. Liquid-Phase Hydrocarbon Removal

Connell Automobile Dealership, 3093 Broadway, Oakland, California

Well ID	Sampling	Depth to	LPH	Hydrocarbons	Hydrocarbons	Cumulative	Notes
<i>TOC Elev.</i>	Date	Water	Thickness	Removed	Removed	Hydrocarbons	
(ft)		(ft)	(ft)	(gallons)	(lbs)	Removed (lbs)	
MW-1	12/23/1991	26.86	1.15	2.00	12.20	12.20	1
94.48	12/26/1991	26.08	0.22	0.50	3.05	15.25	1
	1/13/1992	26.53	0.66	1.00	6.10	21.35	1
	2/28/1992	27.75	0.42	2.00	12.20	33.55	1
	11/9/1993	26.06	1.17	0.50	3.05	36.60	1
	11/3/1995	23.10	0.76	0.75	4.58	41.18	1
	11/30/1995	23.38	0.70	0.25	1.53	42.70	1
	1/3/1996	23.30	0.78	0.53	3.23	45.93	1
	2/2/1996	22.96	0.84	0.75	4.58	50.51	1
	3/1/1996	21.69	0.14	0.10	0.61	51.12	1
	4/4/1996	21.11	0.00	0.00	0.00	51.12	1
	5/2/1996	20.96	0.00	0.00	0.00	51.12	1
	6/5/1996	20.98	0.04	0.10	0.61	51.73	1
	7/9/1996	21.64	0.20	0.10	0.61	52.34	1
	8/8/1996	22.43	0.33	0.05	0.31	52.64	1
	9/10/1996	23.25	0.60	0.10	0.61	53.25	1
	10/1/1996	23.58	0.60	0.25	1.53	54.78	1
	11/4/1996	24.29	0.78	0.13	0.79	55.57	1
	12/2/1996	24.63	0.88	0.26	1.59	57.16	1
	1/3/1997	24.08	0.81	0.39	2.38	59.54	1
	2/6/1997	22.46	0.30	0.01	0.06	59.60	1
	3/5/1997	23.00	0.00	0.00	0.00	59.60	1
	4/1/1997	22.29	0.20	0.01	0.06	59.66	1
	5/8/1997	22.79	0.33	0.02	0.12	59.78	1
	6/6/1997	24.33	1.69	0.26	1.59	61.37	1
	7/8/1997	24.00	0.96	0.20	1.22	62.59	1
	8/7/1997	24.58	1.29	1.00	6.10	68.69	1
	9/10/1997	24.93	1.21	1.50	9.15	77.84	1
	10/1/1997	24.89	0.86	0.26	1.59	79.42	1
	11/4/1997	25.06	0.77	0.26	1.59	81.01	1
	12/4/1997	24.76	0.54	0.19	1.16	82.17	1
	1/8/1998	23.66	0.00	0.00	0.00	82.17	1
	2/5/1998	22.64	0.00	0.00	0.00	82.17	1
	3/6/1998	20.80	0.00	0.00	0.00	82.17	1
	4/2/1998	20.31	0.00	0.00	0.00	82.17	1
	4/29/1998	19.95	0.00	0.00	0.00	82.17	1
	6/3/1998	20.41	0.00	0.00	0.00	82.17	1
	7/9/1998	20.97	0.07	0.00	0.00	82.17	1
	8/4/1998	21.40	trace	trace	0.00	82.17	1
	8/26/1998	21.85	0.10	trace	0.00	82.17	1
	11/2/1998	22.92	0.39	trace	0.00	82.17	1

CAMBRIA

Table 4. Liquid-Phase Hydrocarbon Removal

Connell Automobile Dealership, 3093 Broadway, Oakland, California

Well ID TOC Elev. (ft)	Sampling Date	Depth to Water (ft)	LPH Thickness (ft)	Hydrocarbons Removed (gallons)	Hydrocarbons Removed (lbs)	Cumulative Hydrocarbons Removed (lbs)	Notes
MW-4	4/20/1992	20.74	0.19	0.13	0.79	246.38	1
(cont'd)	5/4/1992	20.83	0.33	0.13	0.79	247.17	1
	5/18/1992	21.33	0.23	0.13	0.79	247.97	1
	5/26/1992	20.83	0.17	0.13	0.79	248.76	1
	6/1/1992	20.85	0.19	0.06	0.37	249.12	1
	6/29/1992	21.38	0.53	0.25	1.53	250.65	1
	7/29/1992	21.69	0.56	1.11	6.77	257.42	1
	8/28/1992	21.35	0.63	1.68	10.25	267.67	1
	4/3/1993	20.11	0.51	0.13	0.79	268.46	1
	11/9/1993	20.48	0.52	0.03	0.18	268.64	1
	8/30/1995	21.71	0.63	1.75	10.68	279.32	1
	10/2/1995	19.90	2.20	0.50	3.05	282.37	1
	11/3/1995	18.76	0.57	0.25	1.53	283.89	1
	11/30/1995	19.17	0.65	0.25	1.53	285.42	1
	1/3/1996	19.45	0.44	0.05	0.31	285.72	1
	2/2/1996	19.50	0.32	0.10	0.61	286.33	1
	3/1/1996	19.31	0.20	0.20	1.22	287.55	1
	4/4/1996	17.53	0.18	0.20	1.22	288.77	1
	5/2/1996	17.50	0.25	0.20	1.22	289.99	1
	6/5/1996	17.67	0.39	0.15	0.92	290.91	1
	7/9/1996	18.29	0.50	0.16	0.98	291.89	1
	8/8/1996	18.84	0.00	0.00	0.00	291.89	1
	9/10/1996	19.31	0.34	0.05	0.31	292.19	1
	10/1/1996	19.51	0.29	0.05	0.31	292.50	1
	11/4/1996	20.13	0.35	0.02	0.12	292.62	1
	12/2/1996	20.23	0.33	0.02	0.12	292.74	1
	1/3/1997	19.33	0.10	0.02	0.12	292.86	1
	2/6/1997	18.13	0.01	0.01	0.06	292.92	1
	4/30/1999	17.28	trace	0.00	0.00	292.92	1
	2/9/2000	19.76	0.00	0.00	0.00	292.92	1
	2/15/2000	--	0.00	0.00	0.00	292.92	2
	2/25/2000	19.30	0.00	0.00	0.00	292.92	2
MW-6	12/23/1991	28.40	3.21	7.50	45.75	45.75	1
85.62	12/26/1991	27.25	1.67	2.00	12.20	57.95	1
	1/10/1992	27.23	0.90	1.00	6.10	64.05	1
	2/4/1992	27.71	2.04	2.00	12.20	76.25	1
	2/28/1992	27.92	3.00	3.00	18.30	94.55	1
	3/10/1992	27.16	2.06	2.75	16.78	111.33	1
	3/12/1992	25.96	0.52	2.00	12.20	123.53	1
	3/23/1992	26.34	1.09	1.00	6.10	129.63	1
	3/30/1992	25.73	0.35	0.50	3.05	132.68	1

CAMBRIA

Table 4. Liquid-Phase Hydrocarbon Removal

Connell Automobile Dealership, 3093 Broadway, Oakland, California

Well ID TOC Elev. (ft)	Sampling Date	Depth to Water (ft)	LPH Thickness (ft)	Hydrocarbons Removed (gallons)	Hydrocarbons Removed (lbs)	Cumulative Hydrocarbons Removed (lbs)	Notes
	4/10/1992	25.29	0.05	0.25	1.53	134.20	1
	4/13/1992	25.52	0.21	0.13	0.79	134.99	1
	4/20/1992	25.38	0.10	0.13	0.79	135.79	1
	5/4/1992	25.40	--	0.13	0.79	136.58	1
	5/8/1992	25.50	0.17	0.06	0.37	136.95	1
	5/26/1992	25.46	0.13	0.13	0.79	137.74	1
	6/1/1992	25.46	0.09	0.06	0.37	138.10	1
	6/29/1992	25.59	0.14	0.19	1.16	139.26	1
	7/29/1992	26.90	1.71	0.60	3.66	142.92	1
	8/28/1992	25.09	2.62	2.40	14.64	157.56	1
	12/2/1992	--	--	0.00	0.00	157.56	1
	4/3/1993	26.96	2.86	1.75	10.68	168.24	1
	11/9/1993	27.51	3.06	0.83	5.06	173.30	1
	8/30/1995	28.00	7.96	4.50	27.45	200.75	1
	10/2/1995	28.24	6.14	4.00	24.40	225.15	1
	11/3/1995	28.39	6.13	3.00	18.30	243.45	1
	11/30/1995	26.91	3.44	2.50	15.25	258.70	1
	1/3/1996	27.58	4.41	2.50	15.25	273.95	1
	2/2/1996	27.58	4.37	5.00	30.50	304.45	1
	3/1/1996	27.96	5.15	4.00	24.40	328.85	1
	4/4/1996	27.96	5.41	5.00	30.50	359.35	1
	5/2/1996	26.83	4.66	4.50	27.45	386.80	1
	6/5/1996	27.15	5.17	4.00	24.40	411.20	1
	7/9/1996	27.08	4.86	4.50	27.45	438.65	1
	8/8/1996	26.71	4.05	4.00	24.40	463.05	1
	9/10/1996	26.83	3.82	3.50	21.35	484.40	1
	10/1/1996	26.96	3.77	4.00	24.40	508.80	1
	11/4/1996	--	--	NM	NM	NM	4
86.94	12/2/1996	--	--	NM	NM	NM	4
	1/3/1997	--	--	NM	NM	NM	4
	2/6/1997	25.08	0.20	NM	NM	NM	4
	3/5/1997	24.20	0.00	NM	NM	NM	4
	4/1/1997	24.04	0.00	NM	NM	NM	4
	5/8/1997	26.54	1.88	0.40	2.44	511.24	1
	6/6/1997	25.33	0.21	0.03	0.18	511.42	1
	7/8/1997	25.30	0.07	0.00	0.00	511.42	1
	8/7/1997	25.52	0.00	0.00	0.00	511.42	1
	9/10/1997	25.76	0.00	0.00	0.00	511.42	1
	10/1/1997	25.12	0.00	0.00	0.00	511.42	1
	11/4/1997	26.16	0.18	0.02	0.12	511.55	1
	12/4/1997	26.08	0.16	0.05	0.31	511.85	1
	1/8/1998	25.79	0.10	0.66	4.03	515.88	1

CAMBRIA

Table 4. Liquid-Phase Hydrocarbon Removal

Connell Automobile Dealership, 3093 Broadway, Oakland, California

Well ID	Sampling	Depth to	LPH	Hydrocarbons	Hydrocarbons	Cumulative	Notes
TOC Elev.	Date	Water	Thickness	Removed	Removed	Hydrocarbons	
(ft)		(ft)	(ft)	(gallons)	(lbs)	Removed (lbs)	
MW-6	2/5/1998	25.31	0.89	NM	NM	NM	4
(cont'd)	3/6/1998	24.63	0.46	0.04	0.24	516.12	1
85.82	4/2/1998	24.45	0.59	0.10	0.61	516.73	1
	4/29/1998	22.96	0.55	0.09	0.55	517.28	1
	6/3/1998	22.81	0.41	0.03	0.18	517.46	1
	7/9/1998	23.04	0.35	0.05	0.31	517.77	1
	8/4/1998	23.29	0.35	0.04	0.24	518.01	1
	8/26/1998	23.50	0.31	0.01	0.06	518.07	1
	11/2/1998	24.24	0.43	0.02	0.12	518.20	1
	12/4/1998	24.35	0.32	0.01	0.06	518.26	1
	1/5/1999	24.51	0.40	0.03	0.18	518.44	1
	2/8/1999	24.00	0.03	0.13	0.76	519.20	1
	3/24/1999	23.82	0.19	0.03	0.18	519.38	1
	4/30/1999	23.60	1.13	0.10	0.61	519.99	1
	7/1/1999	24.45	0.42	0.06	0.38	520.38	1
	7/27/1999	25.35	0.24	0.06	0.38	520.76	1
	8/19/1999	24.87	0.24	0.06	0.37	521.12	1
	9/21/1999	24.58	0.10	0.20	1.22	522.34	1
	10/20/1999	25.05	0.17	0.20	1.22	523.56	1
	12/13/1999	25.08	0.10	0.06	0.37	523.93	1
	2/9/2000	24.93	0.44	0.25	1.53	525.45	1
	2/15/2000	--	0.00	0.07	0.43	525.88	3
	2/25/2000	24.23	0.00	0.01	0.06	525.94	3
	3/3/2000	24.00	0.00	0.00	0.01	525.95	3
	3/28/2000	23.54	0.00	0.05	0.31	526.26	3
	5/2/2000	23.52	0.06	0.03	0.15	526.41	3
	5/31/2000	23.39	0.08	0.00	0.00	526.41	3
	7/3/2000	23.61	trace	0.02	0.12	526.53	3
	8/4/2000	23.80	0.10	0.01	0.06	526.59	3
	10/6/2000	24.22	0.04	0.01	0.06	526.65	
	11/3/2000	24.30	0.09	0.00	0.00	526.65	
	12/1/2000	24.38	0.07	0.03	0.18	526.83	2, 3
MW-9	8/8/1996	19.89	0.35	0.10	0.61	0.61	1
90.37							
MW-14	12/4/1998	23.42	0.23	0.01	0.06	0.06	1
94.66	1/5/1999	23.36	0.12	0.01	0.06	0.12	1
	2/8/1999	23.17	trace	0.01	0.06	0.18	1
	3/24/1999	22.08	trace	trace	0.00	0.18	1
	4/30/1999	21.17	0.01	trace	0.00	0.18	1
	7/1/1999	22.95	0.04	trace	0.00	0.18	1

CAMBRIA

Table 4. Liquid-Phase Hydrocarbon Removal

Connell Automobile Dealership, 3093 Broadway, Oakland, California

Well ID TOC Elev. (ft)	Sampling Date	Depth to Water (ft)	LPH Thickness (ft)	Hydrocarbons Removed (gallons)	Hydrocarbons Removed (lbs)	Cumulative Hydrocarbons Removed (lbs)	Notes
MW-14	9/21/1999	24.26	trace	trace	0.00	0.18	1
(cont'd)	10/20/1999	24.10	0.00	0.00	0.00	0.18	1
	2/9/2000	24.13	0.00	0.00	0.00	0.18	1
	2/15/2000	--	0.00	0.00	0.00	0.18	1
	2/25/2000	--	0.00	0.00	0.00	0.18	2
	3/3/2000	23.27	0.00	0.05	0.31	0.49	2
	3/28/2000	22.40	0.00	0.13	0.76	1.25	2
	5/2/2000	22.22	0.00	0.04	0.24	1.49	2
	5/31/2000	22.09	0.00	0.00	0.00	1.49	2
	7/3/2000	22.35	trace	0.01	0.06	1.55	2
	8/4/2000	22.78	0.00	0.03	0.18	1.73	2
	10/6/2000	23.48	0.00	0.00	0.00	1.73	
	11/3/2000	23.60	0.00	0.00	0.00	1.73	
	12/1/2000	23.90	0.04	0.04	0.24	1.97	1, 2
MW-15	9/20/1999	24.12	trace	trace	0.00	0.00	1
94.76	10/20/1999	24.40	0.00	0.00	0.00	0.00	1
	12/13/1999	24.61	0.00	0.00	0.00	0.00	1

Abbreviations and Notes:

TOC Elev. (ft) = Top of casing elevation, surveyed to an arbitrary datum

-- = Not measured or not applicable

NM = product was being removed by vapor extraction at time of measurement.

1 = LPH removed by manual bailing

2 = LPH removed from well by absorbent sock

3 = LPH removed from well by passive skimmer

4 = vapor extraction system operating in well

Liquid-phase hydrocarbons (LPH) converted from volume to weight using the relation 1 gallon LPH= 6.1 pounds.

ATTACHMENT A

Analytical Laboratory Report

2.3136 2059

McCAMPBELL ANALYTICAL INC.

110 2nd AVENUE SOUTH, #D7
PACHECO, CA 94553

Telephone: (925) 798-1620

Fax: (925) 798-1622

task 021
task 021

CHAIN OF CUSTODY RECORD

TURN AROUND TIME

RUSH 24 HOUR 48 HOUR 5 DAY

Report To: Ron Scheele Bill To: Cambria Env. Tech

Company: Cambria Environmental Technology

6262 Hollis Street

Emeryville, CA 94608

Tele: (510) 450-1983

Fax: (510) 450-8295

Project #: 425-1580

Project Name: Connell

Project Location: 3093 Broadway Oakland Ca

Sampler Signature: [Signature]

Analysis Request

Other

Comments

BTEX & TPH as Gas (602/8020 + 8015) / MTBE	TPH as Diesel (8015)	Total Petroleum Oil & Grease (5520 E&F/B&F)	Total Petroleum Hydrocarbons (418.1)	EPA 601 / 8010	BTEX ONLY (EPA 602 / 8020)	EPA 608 / 8080	EPA 608 / 8080 PCB's ONLY	EPA 624 / 8240 / 8260	EPA 625 / 8270	PAH's / PNA's by EPA 625 / 8270 / 8310	CAM-17 Metals	LUFT 5 Metals	Lead (7240/7421/239.2/6010)	RCI	MVOC'S	TPH, TPHmo 2015
--	----------------------	---	--------------------------------------	----------------	----------------------------	----------------	---------------------------	-----------------------	----------------	--	---------------	---------------	-----------------------------	-----	--------	-----------------

SAMPLE ID	LOCATION	SAMPLING		# Containers	Type Containers	MATRIX					METHOD PRESERVED						
		Date	Time			Water	Soil	Air	Sludge	Other	Ice	HCl	HNO ₃	Other			
MW-4		11-14-00	14:14	7	VOC												
MW-7		11-14-00	13:52	7	VOC												
MW-8		11-14-00	14:00	7	VOC												
MW-9		11-14-00	15:00	7	VOC												
MW-13		11-14-00	17:20	7	VOC												
TB		11-14-00		2	VOC												

53513
53514
53515
53516
53517
53518

Relinquished By: [Signature]	Date: 11/16/00	Time: 955	Received By: [Signature]
Relinquished By: [Signature]	Date: 11/16/00	Time: 1540	Received By: [Signature]
Relinquished By: [Signature]	Date: 11/16	Time: 1730	Received By: [Signature]

Remarks: Confirm MTBE bi 8260

ICE/GOOD CONDITION HEAD SPACE ABSENT

PRESERVATION APPROPRIATE CONTAINERS

VOC'S [Signature]



McCAMPBELL ANALYTICAL INC.

110 2nd Avenue South, #D7, Pacheco, CA 94553-5560
 Telephone : 925-798-1620 Fax : 925-798-1622
<http://www.mccampbell.com> E-mail: main@mccampbell.com

Cambria Environmental Technology 1144 65 th Street, Suite C Oakland, CA 94608	Client Project ID: #425-1580; Connell	Date Sampled: 11/14/00
	Client Contact: Ron Scheele	Date Received: 11/16/00
	Client P.O:	Date Extracted: 11/17-11/21/00
		Date Analyzed: 11/17-11/21/00

Volatile Halocarbons

EPA method 601 or 8010

Lab ID	53513	53514	53515	53516
Client ID	MW-4	MW-7	MW-8	MW-9
Matrix	W	W	W	W
Compound	Concentration			
Bromodichloromethane	ND<10	ND	ND	ND
Bromoform ^(b)	ND<10	ND	ND	ND
Bromomethane	ND<10	ND	ND	ND
Carbon Tetrachloride ^(c)	ND<10	ND	ND	ND
Chlorobenzene	ND<10	ND	ND	ND
Chloroethane	ND<10	ND	ND	ND
2-Chloroethyl Vinyl Ether ^(d)	ND<10	ND	ND	ND
Chloroform ^(c)	ND<10	ND	ND	ND
Chloromethane	ND<10	ND	ND	ND
Dibromochloromethane	ND<10	ND	ND	ND
1,2-Dichlorobenzene	ND<10	ND	ND	ND
1,3-Dichlorobenzene	ND<10	ND	ND	ND
1,4-Dichlorobenzene	ND<10	ND	ND	ND
Dichlorodifluoromethane	ND<10	ND	ND	ND
1,1-Dichloroethane	ND<10	ND	ND	ND
1,2-Dichloroethane	120	ND	47	610
1,1-Dichloroethene	ND<10	ND	ND	ND
cis 1,2-Dichloroethene	ND<10	ND	ND	ND
trans 1,2-Dichloroethene	ND<10	ND	ND	ND
1,2-Dichloropropane	ND<10	ND	ND	ND
cis 1,3-Dichloropropene	ND<10	ND	ND	ND
trans 1,3-Dichloropropene	ND<10	ND	ND	ND
Methylene Chloride ^(f)	ND<15	ND	ND	ND
1,1,2,2-Tetrachloroethane	ND<10	ND	ND	ND
Tetrachloroethene	ND<10	ND	ND	ND
1,1,1-Trichloroethane	ND<10	ND	ND	ND
1,1,2-Trichloroethane	ND<10	ND	ND	ND
Trichloroethene	ND<10	ND	ND	ND
Trichlorofluoromethane	ND<10	ND	ND	ND
Vinyl Chloride ^(g)	ND<10	ND	ND	ND
% Recovery Surrogate	105	104	91	
Comments				

* water and vapor samples and all TCLP & SPLP extracts are reported in ug/L, soil and sludge samples in ug/kg, wipe samples in ug/wipe
 Reporting limit unless otherwise stated: water/TCLP/SPLP extracts, ND<0.5ug/L; soils and sludges, ND<5ug/kg; wipes, ND<0.2ug/wipe
 ND means not detected above the reporting limit; N/A means analyte not applicable to this analysis

(b) tribromomethane; (c) tetrachloromethane; (d) (2-chloroethoxy) ethene; (e) trichloromethane; (f) dichloromethane; (g) chloroethene; (h) a lighter than water immiscible sheen is present; (i) liquid sample that contains greater than ~5 vol. % sediment; (j) sample diluted due to high organic content.

DHS Certification No. 1644

Edward Hamilton, Lab Director



McCAMPBELL ANALYTICAL INC.

110 2nd Avenue South, #D7, Pacheco, CA 94553-5560
 Telephone : 925-798-1620 Fax : 925-798-1622
<http://www.mccampbell.com> E-mail: main@mccampbell.com

Cambria Environmental Technology 1144 65 th Street, Suite C Oakland, CA 94608	Client Project ID: #425-1580; Connell	Date Sampled: 11/14/00
	Client Contact: Ron Scheele	Date Received: 11/16/00
	Client P.O:	Date Extracted: 11/17-11/21/00
		Date Analyzed: 11/17-11/21/00

Volatile Halocarbons

EPA method 601 or 8010

Lab ID	53517		
Client ID	MW-13		
Matrix	W		
Compound	Concentration		
Bromodichloromethane	ND		
Bromoform ^(b)	ND		
Bromomethane	ND		
Carbon Tetrachloride ^(c)	ND		
Chlorobenzene	ND		
Chloroethane	ND		
2-Chloroethyl Vinyl Ether ^(d)	ND		
Chloroform ^(e)	ND		
Chloromethane	ND		
Dibromochloromethane	ND		
1,2-Dichlorobenzene	ND		
1,3-Dichlorobenzene	ND		
1,4-Dichlorobenzene	ND		
Dichlorodifluoromethane	ND		
1,1-Dichloroethane	ND		
1,2-Dichloroethane	3.3		
1,1-Dichloroethene	ND		
cis 1,2-Dichloroethene	ND		
trans 1,2-Dichloroethene	ND		
1,2-Dichloropropane	ND		
cis 1,3-Dichloropropene	ND		
trans 1,3-Dichloropropene	ND		
Methylene Chloride ^(f)	ND		
1,1,2,2-Tetrachloroethane	ND		
Tetrachloroethene	ND		
1,1,1-Trichloroethane	ND		
1,1,2-Trichloroethane	ND		
Trichloroethene	ND		
Trichlorofluoromethane	ND		
Vinyl Chloride ^(g)	ND		
% Recovery Surrogate	106		
Comments			

* water and vapor samples and all TCLP & SPLP extracts are reported in ug/L, soil and sludge samples in ug/kg, wipe samples in ug/wipe
 Reporting limit unless otherwise stated: water/TCLP/SPLP extracts, ND<0.5ug/L; soils and sludges, ND<5ug/kg; wipes, ND<0.2ug/wipe
 ND means not detected above the reporting limit; N/A means analyte not applicable to this analysis

(b) tribromomethane; (c) tetrachloromethane; (d) (2-chloroethoxy) ethene; (e) trichloromethane; (f) dichloromethane; (g) chloroethene; (h) a lighter than water immiscible sheen is present; (i) liquid sample that contains greater than ~5 vol. % sediment; (j) sample diluted due to high organic content.

DHS Certification No. 1644

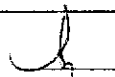
 Edward Hamilton, Lab Director

WELL DEPTH MEASUREMENTS

Well ID	Time	Product Depth	Water Depth	Product Thickness	Well Depth	Comments
MW-2	11:25	24.67	24.65		24.67	SPH ^{strong} _{visual check} ^{odec}
MW-4	11:15		19.63		24.00	
MW-6	11:40		24.61		—	visual check no SPH ^{strong} _{odec}
MW-7	11:05		17.00		30.00	
MW-8	11:10		26.60		39.40	
MW-9	11:20		19.65 20.90		24.00 38.30	
MW-13	11:00		24.00		39.45	
MW-14	11:30		23.90		—	visual ^{strong} _{odec} no SPH detected
MW-15	11:35		24.15		—	visual ^{strong} _{odec} no SPH detected

Project Name: Connell
 Measured By: [Signature]

Project Number: 452-1580-021 425-1580
 Date: 11-14-00

WELL SAMPLING FORM

Project Name: Connell	Cambria Mgr: RWS	Well ID: MV-13
Project Number: 425-1580	Date: 11/14/00	Well Yield: -----
Site Address: 3093 Broadway Oakland, California	Sampling Method: Disposable bailer	Well Diameter: "pvc 2
		Technician(s): SG
Initial Depth to Water: 24.00	Total Well Depth: 39.45	Water Column Height: 15.45
Volume/ft: 0.16	1 Casing Volume: 2.47	3 Casing Volumes: 7.41
Purging Device: dis bailer	Did Well Dewater?: NO	Total Gallons Purged: 7.5
Start Purge Time: 12:08	Stop Purge Time: 12:14	Total Time: 6mins

1 Casing Volume = Water column height x Volume/ ft.

Well Diam.	Volume/ft (gallons)
2"	0.16
4"	0.65
6"	1.47

Time	Casing Volume	Temp. °C	pH	Cond. µS	Comments
12:10	2.5	17.2	7.75	1055	
12:12	3	17.9	7.68	1062	
12:15	7.5	17.7	7.83	1059	
					DO = 0.49 mg/l

Sample ID	Date	Time	Container Type	Preservative	Analytes	Analytic Method
MV-13	11-14-00	12:20	6 voa's	HCL	TPHg, BTEX, MTBE, SVOCs, HVOCs	8015M/8020, confirm MTBE 8260, SVOCs by 8270, 8010 list
			2- 1L ambers	none	TPHd/TPHmo	8015 multi-range
			1- 0.5L plastic	none	Luft 5 Metals - Pb, Cr, Cd, Zn, Ni	

WELL SAMPLING FORM

Project Name: Connell	Cambria Mgr: RWS	Well ID: MW-8
Project Number: 425-1580	Date: 11/14/00	Well Yield: -----
Site Address: 3093 Broadway Oakland, California	Sampling Method: Disposable bailer	Well Diameter: " pvc 6
		Technician(s): SG
Initial Depth to Water: 26.60	Total Well Depth: 39.40	Water Column Height: 12.80
Volume/ft: 1.47	1 Casing Volume: 18.81	3 Casing Volumes: 56.44
Purging Device: 4" PVC bailer	Did Well Dewater?: NO	Total Gallons Purged: 50
Start Purge Time: 12:50	Stop Purge Time: 13:05	Total Time: 15 mins

1 Casing Volume = Water column height x Volume/ft.

Well Diam.	Volume/ft (gallons)
2"	0.16
4"	0.65
6"	1.47

Time	Casing Volume	Temp. °C	pH	Cond. µS	Comments
12:55	18	18.0	6.75	972	very slow
13:00	36	17.9	6.39	900	recharge
13:06	50	17.3	6.40	947	at the 3rd purge
					DO = 5.1 mg/L

Sample ID	Date	Time	Container Type	Preservative	Analytes	Analytic Method
MW-8	11-14-00	12:50 13:01	6 voa's	HCL	TPHg, BTEX, MTBE SVOCs HVOCs	8015M/8020, confirm MTBE 8260, SVOCs by 8270, 8010 list
			2- 1L ambers	none	TPHd/TPHmo	8015 multi- range
			1- 0.5L plastic	none	Luft 5 Metals - Pb, Cr, Cd, Zn, Ni	

WELL SAMPLING FORM

Project Name: Connell	Cambria Mgr: RWS	Well ID: MW-7
Project Number: 425-1580	Date: 11-14-00	Well Yield: -----
Site Address: 3093 Broadway Oakland, California	Sampling Method: Disposable bailer	Well Diameter: "pvc 2
		Technician(s): SG
Initial Depth to Water: 17.00	Total Well Depth: 30.00	Water Column Height: 13.00
Volume/ft: 0.16	1 Casing Volume: 2.08	3 Casing Volumes: 6.24
Purging Device: dis bailer	Did Well Dewater?: no	Total Gallons Purged: 6
Start Purge Time: 13:40	Stop Purge Time: 13:46	Total Time: 6mins

1 Casing Volume = Water column height x Volume/ft.

Well Diam.	Volume/ft (gallons)
2"	0.16
4"	0.65
6"	1.47

Time	Casing Volume	Temp. °C	pH	Cond. µS	Comments
13:42	2	17.0	7.29	459	
13:44	4	17.4	7.93	794	
13:47	6	17.1	7.54	796	
					DD = 0.44 mg/L

Sample ID	Date	Time	Container Type	Preservative	Analytes	Analytic Method
MW-7	11-14-00	13:52	6 voa's	HCL	TPHg, BTEX, MTBE SVOCs HVOCs	8015M/8020, confirm MTBE 8260, SVOCs by 8270, 8010 list
			2- 1L ambers	none	TPHd/TPHmo	8015 multi-range
			1- 0.5L plastic	none	Luft 5 Metals - Pb, Cr, Cd, Zn, Ni	

WELL SAMPLING FORM

Project Name: Connell	Cambria Mgr: RWS	Well ID: MW-4
Project Number: 425-1580	Date: 11-14-00	Well Yield: -----
Site Address: 3093 Broadway Oakland, California	Sampling Method: Disposable bailer	Well Diameter: "pvc 2
		Technician(s): SG
Initial Depth to Water: 19.63	Total Well Depth: 24.00	Water Column Height: 4.37
Volume/ft: 0.16	1 Casing Volume: 0.69	3 Casing Volumes: 2.07
Purging Device: dis bailer	Did Well Dewater?: no	Total Gallons Purged: 2
Start Purge Time: 14:05	Stop Purge Time: 14:08	Total Time: 3 mins

1 Casing Volume = Water column height x Volume/ ft.

Well Diam.	Volume/ft (gallons)
2"	0.16
4"	0.65
6"	1.47

Time	Casing Volume	Temp. °C	pH	Cond. µS	Comments
14:06	1	17.6	6.39	791	
14:07	1.5	17.1	6.52	752	
14:09	2	17.4	6.17	759	
					DO = 0.32 mg/L

Sample ID	Date	Time	Container Type	Preservative	Analytes	Analytic Method
MW-4	11-14-00	14:14	6 voa's	HCL	TPHg, BTEX, MTBE SVOCs HVOCs	8015M/8020, confirm MTBE 8260, SVOCs by 8270, 8010 list
			2- 1L ambers	none	TPHd/TPHmo	8015 multi- range
			1- 0.5L plastic	none	Luft 5 Metals - Pb, Cr, Cd, Zn, Ni	

WELL SAMPLING FORM

Project Name: Connell	Cambria Mgr: RWS	Well ID: MW-9
Project Number: 425-1580	Date: 11-14-00	Well Yield: -----
Site Address: 3093 Broadway Oakland, California	Sampling Method: Disposable bailer	Well Diameter: "pvc"
		Technician(s): SS
Initial Depth to Water: 20.90	Total Well Depth: 30.50	Water Column Height: 9.60
Volume/ft: 0.16	1 Casing Volume: 1.53	3 Casing Volumes: 4.60
Purging Device: dis bailer	Did Well Dewater?: YES	Total Gallons Purged: 3
Start Purge Time: 14:27	Stop Purge Time: 14:29	Total Time:

1 Casing Volume = Water column height x Volume/ ft.

Well Diam.	Volume/ft (gallons)
2"	0.16
4"	0.65
6"	1.47

Time	Casing Volume	Temp. °C	pH	Cond. µS	Comments
14:28	2	17.1	7.90	975	
14:30	3	17.7	7.35	962	
	4.5				DO = 0.29mg/L

Sample ID	Date	Time	Container Type	Preservative	Analytes	Analytic Method
MW-9	11-14-00	15:00	6 voa's	HCL	TPHg, BTEX, MTBE SVOCs HVOCs	8015M/8020, confirm MTBE 8260, SVOCs by 8270, 8010 list
			2- 1L ambers	none	TPHd/TPHmo	8015 multi-range
			1- 0.5L plastic	none	Luft 5 Metals - Pb, Cr, Cd, Zn, Ni	