



Technology, Engineering & Construction, Inc.

262 Michelle Court • So. San Francisco, CA 94080-6201 • Contractor's Lic. #762034
Tel: (650) 616-1200 • Fax: (650) 616-1244 • www.tecaccutite.com

RECEIVED

2:03 pm, Aug 09, 2007

Alameda County
Environmental Health

August 6, 2007

Mr. Steven Plunkett
Hazardous Materials Specialist
Alameda County Health Agency
Division of Environmental Protection
1131 Harbor Bay Parkway, 2nd Floor
Alameda, CA 94502

SUBJECT: SECOND QUARTER 2007 GROUNDWATER MONITORING REPORT

SITE: FORMER OLYMPIAN SERVICE STATION
1435 WEBSTER STREET
ALAMEDA, CALIFORNIA 94501
FLC # RO0000193

Dear Mr. Plunkett:

On behalf of Olympian, TEC Accutite is pleased to submit this second quarter 2007 groundwater monitoring report for the above referenced site.

Thank you for your cooperation and assistance on this project. If you have any questions or concerns, please call Marc Mullaney at (650) 616-1209.

Sincerely,
TEC Accutite

Nathan W. Smith
Project Geologist

cc: Mr. Fred Bertetta c/o Ms. Janet Heikel, Olympian, 1300 Industrial Road, Suite 2, San Carlos, California 94070
Mr. Jeff Farrar, P.O. Box 1701, Chico, California 95927
Mr. and Mrs. Charles A. & Ose M. Begley, 2592 Pine View Dr., Fortuna, California 95540

**SECOND QUARTER 2007
GROUNDWATER MONITORING REPORT**

**FORMER OLYMPIAN SERVICE STATION
1435 WEBSTER STREET
ALAMEDA, CALIFORNIA 94501**

PREPARED FOR:

OLYMPIAN

AND

ALAMEDA COUNTY HEALTH AGENCY

SAMPLING DATE:

JUNE 27, 2007

REPORT DATE:

AUGUST 6, 2007



TABLE OF CONTENTS

	<u>PAGE</u>
1.0 INTRODUCTION.....	1
2.0 SITE DESCRIPTION.....	1
3.0 ENVIRONMENTAL BACKGROUND	1
3.1 Site Timeline.....	1
3.2 Site Condition	2
4.0 GROUNDWATER MONITORING.....	2
4.1 Sampling Methods.....	2
4.2 Electronic Laboratory Data Submittal	3
5.0 RESULTS.....	3
5.1 Groundwater Elevation and Flow Direction	3
5.2 Petroleum Hydrocarbons in Groundwater.....	3
6.0 CONCLUSIONS AND RECOMMENDATIONS	3
7.0 LIMITATIONS.....	4

TABLES

- 1 SUMMARY OF GROUNDWATER ELEVATION DATA
- 2 SUMMARY OF GROUNDWATER MONITORING ANALYTICAL RESULTS

FIGURES

- 1 VICINITY MAP
- 2 SITE MAP
- 3 GROUNDWATER GRADIENT MAP
- 4 PETROLEUM HYDROCARBONS IN GROUNDWATER

ATTACHMENTS

- A WELL SAMPLING LOGS
- B LABORATORY REPORT AND CHAIN-OF-CUSTODY DOCUMENTATION
- C GEOTRACKER SUBMISSION CONFIRMATIONS



1.0 INTRODUCTION

On behalf of Olympian, TEC Accutite conducted the second quarter 2007 groundwater monitoring event at the former Olympian Service Station, located at 1435 Webster Street, Alameda, California. This event represents the second sampling event that included the newly installed monitoring wells MW-7 and MW-8, and the second sampling event following the completion of soil excavation activities during February 2007. Presented herein are the site environmental background and results of the groundwater monitoring event.

2.0 SITE DESCRIPTION

The site is located on the corner of Webster Street and Taylor Avenue in Alameda, California. Prior to 1989, the site was occupied by an Olympian Service Station. The former station facilities consisted of two 10,000-gallon gasoline and one 7,500-gallon diesel underground storage tanks (USTs), two dispenser islands and a 500-gallon waste oil UST. A Vicinity Map and a Site Map are presented as Figures 1 and 2, respectively.

The surrounding topography is flat and the site is approximately 20 feet above mean sea level. The site is situated in a mixed commercial and residential area and is currently leased by the City of Alameda and used as a metered parking lot.

3.0 ENVIRONMENTAL BACKGROUND

3.1 Site Timeline

- | | |
|-----------------------|--|
| October 1988 | Soil gas analysis performed on site reveals high soil gas readings. |
| September 1989 | Two 10,000-gallon gasoline USTs, one 7,500-gallon diesel UST and one 500-gallon waste oil UST removed by TEC Accutite; Petroleum hydrocarbons detected in soil beneath former tanks. |
| January 1991 | Approximately 950 cubic yards of soil were removed from the former location of the USTs; This soil was bioremediated onsite and returned to the former excavation. |
| January 1993 | Three monitoring wells installed onsite (MW-1 through MW-3); No petroleum hydrocarbons detected in soil. |
| February 1999 | Four soil borings advanced on- and offsite (B-1 through B-4); Petroleum hydrocarbon concentrations detected in soil and groundwater. |
| December 1999 | Three monitoring wells, installed onsite (MW-4 through MW-6); Petroleum hydrocarbons detected in soil. |
| November 2000 | Site conceptual model (SCM) completed; Potential for benzene vapor-phase migration from hydrocarbon affected groundwater to indoor and ambient air identified as an exposure pathway requiring further evaluation. |
| June 2001 | Four soil borings advanced (B-1 through B-4 (second set of B-1 through B-4)); No petroleum hydrocarbons detected in soil; Petroleum hydrocarbons detected in groundwater. |



- February 2002** Site-specific risk assessment performed; Compounds of concern identified as TPHg and benzene.
- May 2003** Eight soil vapor probes advanced onsite (SV-1 through SV-7); Petroleum hydrocarbons detected below their respective Environmental Screening Levels (ESLs).
- September 2005** Site conceptual model updated; Uncertainties determined with onsite benzene vapor concentrations and offsite groundwater conditions.
- June 2006** Eight soil borings advanced (SP-1 through SP-8); Petroleum hydrocarbons detected in soil above constituent ESLs.
- November 2006** Seventeen soil borings advanced (CB-1 through CB-17) to determine excavation limits; Petroleum hydrocarbons detected at concentrations below ESLs and/or laboratory detection limits at depths shallower than 8 feet bsg; Onsite soils classified as SP to SP-SM, as determined by Geophysical analysis.
- December 2006** Five soil borings advanced (DB-1 through DB-5); Onsite soils classified as Class II waste; Monitoring wells MW-1 and MW-5 abandoned by pressure grouting.
- February 2007** Interim remedial action conducted; 992.54 tons of soil excavated from site and properly disposed; 15,000 gallons of groundwater pumped from open excavation pit, sediment and carbon-filtered, and discharged to sewer under permit.
- March 2007** Two monitoring wells installed onsite (MW-7 and MW-8);

3.2 Site Condition

The site currently has six monitoring wells in its network (MW-2 through MW-4 and MW-6 through MW-8), and activities are progressing towards site closure. Locations of site monitoring wells are presented in Figure 2.

4.0 GROUNDWATER MONITORING

4.1 Sampling Methods

On June 27, 2007, a technician from TEC Accutite uncapped all site wells and allowed the water level in each well to fully equilibrate prior to gauging. Following well gauging, approximately three casing volumes of groundwater were purged from wells MW-2 through MW-4 and MW-6 through MW-8 (all active wells). Water levels in each well were allowed to recover to 80% of the pre-purge level prior to collection of groundwater samples. Following purging and recovery, groundwater samples were collected from the wells with a disposable bailer and transferred into HCL preserved VOAs. The samples were labeled, placed on ice in an ice chest, and delivered to *Torrent Laboratory, Inc.*, a California Certified Laboratory, under chain of custody documentation for analysis.

All groundwater samples were analyzed for TPHg, BTEX, fuel oxygenates, ethanol, and lead scavengers by EPA Method 8260. Well sampling logs are presented in Attachment A. The laboratory analytical report and chain-of-custody documentation are presented in Attachment B.



4.2 Electronic Laboratory Data Submittal

The laboratory report was converted into EDF format and uploaded to GeoTracker, the California web-based geospatial database of California. Depths to groundwater were uploaded to GeoTracker as a GEO_WELL file. Attachment C contains hard copies of the GeoTracker submission confirmations.

5.0 RESULTS

5.1 Groundwater Elevation and Flow Direction

The calculated groundwater flow direction based on groundwater elevation is toward the south-southwest at a gradient of approximately 0.004 feet/foot (ft/ft) (Figure 3). Groundwater elevations are presented in Table 1 and Figure 3.

5.2 Petroleum Hydrocarbons in Groundwater

For this monitoring event, the highest concentrations of dissolved-phase petroleum hydrocarbons and MTBE were detected in monitoring well MW-8 (20,000 µg/L TPHg, 2,460 µg/L benzene, 382 µg/L toluene, 611 µg/L ethylbenzene, 1,040 µg/L xylenes, 7,310 µg/L MTBE). Elevated concentrations were also present in monitoring wells MW-2 (10.5 µg/L MTBE) and MW-7 (270 µg/L TPHg, 126 µg/L benzene, 7.11 ethylbenzene, 94.4 µg/L MTBE). No dissolved-phase petroleum hydrocarbons or MTBE were detected at or above respective laboratory reporting limits in remaining monitoring wells MW-3, MW-4 and MW-6. Groundwater analytical results are summarized in Table 2 and Figure 4.

6.0 CONCLUSIONS AND RECOMMENDATIONS

- The groundwater potentiometric surface beneath the site appears to be stabilizing from the recent excavation activity. For this monitoring event, groundwater flow appears to be to the south-southwest at a gradient of approximately 0.004 ft/ft. This is consistent with the fourth quarter of 2006, which was to the south-southwest at approximately 0.005 ft/ft.
- Concentrations of dissolved-phase petroleum hydrocarbons and MTBE were detected above respective ESLs in the two monitoring wells installed on March 9, 2007 (MW-7 and MW-8); Well MW-7 is located approximately 10 feet southwest of former monitoring well MW-5 and concentrations of petroleum hydrocarbons and MTBE are within the historic range of former well MW-5. Similarly, MW-8 is located approximately 5 feet south-southwest of former monitoring well MW-1 and concentrations of petroleum hydrocarbons and MTBE are within the historical range of former well MW-1. MTBE was detected at a concentration above the respective ESL in monitoring well MW-2, but within historical range.
- No dissolved-phase petroleum hydrocarbons nor MTBE were detected at or above respective laboratory reporting limits in monitoring wells MW-3, MW-4 and MW-6.
- On July 10 and 11, 2007, TEC Accutite advanced 13 off-site soil borings, in order to define the off-site plume, and the activities and findings of this investigation are in preparation. TEC Accutite will continue to monitor all active wells associated with the site on a quarterly basis in preparation for applying for site closure.



7.0 LIMITATIONS

Our services consist of professional opinions, conclusions, and recommendations made today in accordance with generally accepted engineering principles and practices. This warranty is in lieu of all other warranties either expressed or implied. TEC Accutite's liability is limited to the dollar amount of the work performed.

Thank you for your cooperation and assistance with this project. If you have any questions or concerns, please contact the undersigned at (650) 616-1200.

Sincerely,
TEC Accutite

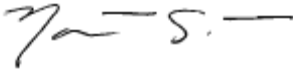

Nathan W. Smith
Project Geologist

Reviewed by:



Marc Mullaney, PG # 7438
Project Manager

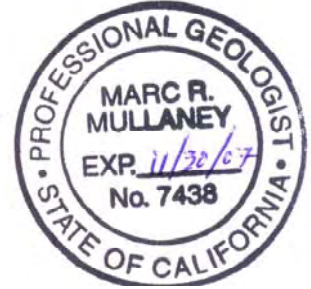

TABLES

Table 1
Summary of Historical Groundwater Elevation Data
Former Olympian Service Station
1435 Webster Street
Alameda, California

Well ID	TOC Elevation (ft msl)	Sample Date	Depth to Water (ft)	Groundwater Elevation (ft msl)
MW-1	19.53	6/3/1993	---(1)	
		9/14/1994	11.46	8.07
		12/30/1994	9.22	10.31
		3/26/1995	6.76	12.77
		7/9/1995	8.92	10.61
		7/31/1998	8.30	11.23
		2/11/1999	7.91	11.62
		6/23/1999	9.03	10.50
		12/6/1999	10.86	8.67
		3/16/2000	6.93	12.60
		6/13/2000	8.73	10.80
		9/29/2000	10.18	9.35
		3/22/2001	8.24	11.29
		6/25/2001	9.73	9.80
		9/28/2001	11.06	8.47
		12/26/2001	8.11	11.42
		07/0705	8.69	10.84
		10/19/2005	10.25	9.28
		1/13/2006	7.09	12.44
		5/5/2006	6.40	13.13
7/19/2006	8.28	11.25		
10/5/2006	9.67	9.86		
***** Abandoned 12/27/2006*****				
MW-2	19.8	6/3/1993	9.54	10.26
		9/14/1994	11.82	7.98
		12/30/1994	9.46	10.34
		3/26/1995	6.82	12.98
		7/9/1995	9.22	10.58
		7/31/1998	8.56	11.24
		2/11/1999	8.12	11.68
		6/23/1999	9.33	10.47
		12/6/1999	11.20	8.60
		3/16/2000	6.88	12.92
		6/13/2000	8.99	10.81
		9/29/2000	10.40	9.40
		3/22/2001	8.46	11.34
		6/25/2001	10.11	9.69
		9/28/2001	11.40	8.40
		12/26/2001	8.28	11.52
		7/7/2005	8.99	10.81
		10/19/2005	10.63	9.17
		1/13/2006	7.15	12.65
		5/5/2006	6.43	13.37
7/19/2006	8.57	11.23		
10/5/2006	10.05	9.75		
3/29/2007	8.83	10.97		
6/27/2007	9.86	9.94		

Table 1
Summary of Historical Groundwater Elevation Data
Former Olympian Service Station
1435 Webster Street
Alameda, California

Well ID	TOC Elevation (ft msl)	Sample Date	Depth to Water (ft)	Groundwater Elevation (ft msl)
MW-3	19.79	6/3/1993	9.80	9.99
		9/14/1994	12.19	7.60
		12/30/1994	9.72	10.07
		3/26/1995	6.88	12.91
		7/9/1995	9.52	10.27
		7/31/1998	8.40	11.39
		2/11/1999	7.77	12.02
		6/23/1999	9.21	10.58
		12/6/1999	11.12	8.67
		3/16/2000	6.48	13.31
		6/13/2000	8.76	11.03
		9/29/2000	10.20	9.59
		3/22/2001	8.24	11.55
		6/25/2001	10.04	9.75
		9/28/2001	11.34	8.45
		12/26/2001	8.01	11.78
		7/7/2005	8.84	10.95
		10/19/2005	10.58	9.21
		1/13/2006	6.85	12.94
		5/5/2006	6.11	13.68
7/19/2006	8.41	11.38		
10/5/2006	10.02	9.77		
3/29/2007	9.71	10.08		
		6/27/2007	9.82	9.97
MW-4	19.3	12/6/1999	10.79	8.51
		3/16/2000	6.86	12.44
		6/13/2000	8.18	11.12
		9/29/2000	10.11	9.19
		4/5/2001	8.26	11.04
		6/25/2001	9.68	9.62
		9/28/2001	10.98	8.32
		12/26/2001	8.18	11.12
		7/7/2005	8.77	10.53
		10/19/2005	10.24	9.06
		1/13/2006	(1)	(1)
		5/5/2006	(1)	(1)
		7/19/2006	8.38	10.92
		10/5/2006	9.65	9.65
		3/29/2007	8.55	10.75
		6/27/2007	9.40	9.90

Table 1
Summary of Historical Groundwater Elevation Data
Former Olympian Service Station
1435 Webster Street
Alameda, California

Well ID	TOC Elevation (ft msl)	Sample Date	Depth to Water (ft)	Groundwater Elevation (ft msl)
MW-5	18.99	12/6/1999	10.17	8.82
		3/16/2000	6.28	12.71
		6/13/2000	7.95	11.04
		9/29/2000	9.54	9.45
		3/22/2001	7.48	11.51
		6/25/2001	9.05	9.94
		9/28/2001	10.39	8.60
		12/26/2001	7.28	11.71
		8/24/2005	7.87	11.12
		10/19/2005	9.51	9.48
		1/13/2006	6.35	12.64
		5/5/2006	5.64	13.35
		7/19/2006	7.41	11.58
		10/5/2006	8.89	10.10
		*****Abandoned 12/27/2006*****		
MW-6	20.27	12/6/1999	11.46	8.81
		3/16/2000	8.32	11.95
		6/13/2000	9.14	11.13
		9/29/2000	10.81	9.46
		3/22/2001	8.64	11.63
		6/25/2001	10.39	9.88
		9/28/2001	11.70	8.57
		12/26/2001	8.40	11.87
		7/7/2005	9.10	11.17
		10/19/2005	10.88	9.39
		1/13/2006	7.33	12.94
		5/5/2006	6.53	13.74
		7/19/2006	8.64	11.63
		10/5/2006	10.29	9.98
		3/29/2007	9.01	11.26
	6/27/2007	10.14	10.13	
MW-7	18.93	3/29/2007	7.90	11.03
		6/27/2007	8.87	10.06
MW-8	19.33	3/29/2007	8.40	10.93
		6/27/2007	9.33	10.00
Notes:				
TOC = Top of Casing				
ft msl = Feet referenced to mean sea level				
--- = Not Available				
(1) = Well not accessible due to obstruction by a parked car				

Table 2
Summary of Groundwater Monitoring Analytical Results
Former Olympian Service Station
1435 Webster Street
Alameda, California

Well ID	Sample Date	TPHd	TPHg	Concentrations in micrograms per liter (µg/L)					
				B	T	E	X	MTBE	TRPH
<i>ESL</i>		<i>100</i>	<i>100</i>	<i>1.0</i>	<i>40</i>	<i>30</i>	<i>20</i>	<i>5.0</i>	<i>---</i>
MW-1	6/3/1993	---	---	---	---	---	---	---	---
	9/14/1994	<50	14,000	44	28	25	50	---	800
	12/30/1994	<50	4,000	12	9	6.8	30	---	<500
	3/26/1995	<50	1,000	21	10	7.1	25	---	2,100
	7/9/1995	<50	16,000	57	28	25	53	---	---
	7/31/1998	1,700	4,700	1,300	48	140	150	6,600	<5000
	2/11/1999	2000	25,000	18,000	1,600	1,400	500	28,000	---
	6/23/1999	4,900	42,000	11,000	1,100	1,500	2,300	15,000	---
	12/6/1999	4,000	44,000	8,900	3,400	1,900	5,100	11,000	---
	3/16/2000	700	5,100	2,400	100	280	460	2,700(2)	---
	6/13/2000	2,800	17,000	5,300	260	720	790	7,000(2)	---
	9/29/2000	5,200 (1)	50,000	11,000	2,900	1,900	4,600	7,200(2)	---
	3/22/2001	1,500 (1)	8,600	2,600	750	250	950	3,200(2)	---
	6/25/2001	---	18,000	1,200	1,800	970	3,200	1500(2)	---
	9/28/2001	---	48,000	5,200	6100	2200	8100	4000	---
	12/26/2001	---	524	216	1.2	8.6	7.4	721	---
	7/7/2005	---	1,500	190	15	36	29	1,100	---
	10/19/2005	---	11,000	2,100	45	370	82	4,600	---
	1/13/2006	---	5,400	680	37	83	41	3,900	---
	5/5/2006	---	<25	2	<0.5	<0.5	<0.5	2.2	---
7/19/2006	---	5,000	836	22.3	107	81.8	1,130	---	
10/5/2006	---	23,000	3,740	112	395	161	6,020	---	
*****Well Abandoned 12/27/2006*****									
MW-2	6/3/1993	<50	<50	5.8	<0.5	<0.5	<0.5	---	<500
	9/14/1994	<50	<50	<0.5	<0.5	<0.5	<0.5	---	<500
	12/30/1994	<50	160	1.4	1.4	0.8	5	---	<500
	3/26/1995	<50	<50	<0.5	<0.5	<0.5	<0.5	---	<500
	7/9/1995	---	---	---	---	---	---	---	---
	7/31/1998	220	<50	<0.5	<0.5	<0.5	<0.5	73	<500
	2/11/1999	<50	<50	<0.5	<0.5	<0.5	<0.5	75	---
	6/23/1999	420	<50	<0.5	<0.5	<0.5	<0.5	96	---
	12/6/1999	<110	300	28	45	6	37	210	---
	3/16/2000	<50	<50	1	<0.5	0.5	1	3	---
	6/13/2000	<50	68	0.8	<0.5	<0.5	<0.5	38	---
	9/29/2000	<50	67	0.8	0.5	<0.5	1	86 (2)	---
	3/22/2001	<50	<50	1	0.5	<0.5	1	14	---
	6/25/2001	---	<50	<0.5	<0.5	<0.5	<1.0	13	---
	9/28/2001	---	300	4	6	3	10	130	---
	12/26/2001	---	<50	<0.5	<0.5	<0.5	<1.0	<0.5	---
	7/7/2005	---	<50	<0.5	<0.5	<0.5	<1.0	20	---
	10/19/2005	---	29	1.4	<0.5 (3)	<0.5	<0.5	19	---
	1/13/2006	---	<25	<0.5	<0.5	<0.5	<0.5	<1.0	---
	5/5/2006	---	<25	<0.5	<0.5	<0.5	<0.5	<1.0	---
7/19/2006	---	<50	<0.5	<0.5	<0.5	<1.5	16.6	---	
10/5/2006	---	<50	<0.5	<0.5	<0.5	<1.5	11.9	---	
3/29/2007	---	<50	<0.5	<0.5	<0.5	<1.5	3.36	---	
6/27/2007	---	<50	<0.5	<0.5	<0.5	<1.5	10.5	---	

Table 2
Summary of Groundwater Monitoring Analytical Results
Former Olympian Service Station
1435 Webster Street
Alameda, California

Well ID	Sample Date	TPHd	TPHg	Concentrations in micrograms per liter (µg/L)				MTBE	TRPH	
				B	T	E	X			
<i>ESL</i>		<i>100</i>	<i>100</i>	<i>1.0</i>	<i>40</i>	<i>30</i>	<i>20</i>	<i>5.0</i>	<i>---</i>	
MW-3	6/3/1993	<50	<50	<0.5	<0.5	<0.5	<0.5	---	<500	
	9/14/1994	<50	<50	<0.5	<0.5	<0.5	<0.5	---	<500	
	12/30/1994	<50	<50	<0.5	<0.5	<0.5	<0.5	---	<500	
	3/26/1995	<50	<50	<0.5	<0.5	<0.5	<0.5	---	<500	
	7/9/1995	---	---	---	---	---	---	---	---	
	7/31/1998	<50	<50	<0.5	<0.5	<0.5	<0.5	<0.5	<5000	
	2/11/1999	<50	<50	<0.5	<0.5	<0.5	<0.5	<0.5	---	
	6/23/1999	<50	<50	<0.5	<0.5	<0.5	<0.5	3	---	
	12/6/1999	<110	<50	3	1	<0.5	1	0.6	---	
	3/16/2000	<50	<50	<0.5	<0.5	<0.5	<1.0	1	---	
	6/13/2000	<50	490	0.8	<0.5	<0.5	9	2	---	
	9/29/2000	<50	57	<0.5	<0.5	<0.5	<1.0	<1.0 (2)	---	
	3/22/2001	<50	<50	<0.5	<0.5	<0.5	<1.0	2	---	
	6/25/2001	---	<50	<0.5	<0.5	<0.5	<1.0	0.8	---	
	9/28/2001	---	91	<0.5	<0.5	<0.5	2	2	---	
	12/26/2001	---	<50	<0.5	<0.5	<0.5	<1.0	<0.5	---	
	7/7/2005	---	<50	<0.5	<0.5	<0.5	<1.0	<0.5	---	
	10/19/2005	---	<25	<0.5	<0.5 (3)	<0.5	<0.5	<1.0	---	
	1/13/2006	---	<25	<0.5	<0.5	<0.5	<0.5	<1.0	---	
	5/5/2006	---	<25	<0.5	<0.5	<0.5	<0.5	<1.0	---	
7/19/2006	---	<50	<0.5	<0.5	<0.5	<1.5	<0.5	---		
10/5/2006	---	<50	<0.5	<0.5	<0.5	<1.5	<0.5	---		
3/29/2007	---	<50	<0.5	<0.5	<0.5	<1.5	<0.5	---		
6/27/2007	---	<50	<0.5	<0.5	<0.5	<1.5	<0.5	---		
MW-4	12/6/1999	160	<50	3	2	0.6	4	140	---	
	3/16/2000	90	<50	0.5	0.5	<0.5	2	34	---	
	6/13/2000	<50	56	<0.5	<0.5	<0.5	<1.0	1	---	
	9/29/2000	<50	92	0.7	<0.5	<0.5	3	<1.0 (2)	---	
	4/5/2001	<50	51	<0.5	0.5	<0.5	1	6.0 (2)	---	
	6/25/2001	---	<50	<0.5	<0.5	<0.5	<1.0	<0.5	---	
	9/28/2001	---	<50	<0.5	<0.5	<0.5	2	2	---	
	12/26/2001	---	<50	1.6	1.7	1.6	4.4	2.7	---	
	7/7/2005	---	<50	<0.5	<0.5	<0.5	<1.0	<0.5	---	
	10/19/2005	---	<25	<0.5	<0.5 (3)	<0.5	<0.5	<1.0	---	
	1/13/2006	*****Not sampled*****								
	5/5/2006	*****Not sampled*****								
	7/19/2006	---	<50	<0.5	<0.5	<0.5	<1.5	<0.5	---	
	10/5/2006	---	<50	<0.5	<0.5	<0.5	<1.5	<0.5	---	
3/29/2007	---	<50	<0.5	<0.5	<0.5	<1.5	0.69	---		
6/27/2007	---	<50	<0.5	<0.5	<0.5	<1.5	<0.5	---		

Table 2
Summary of Groundwater Monitoring Analytical Results
Former Olympian Service Station
1435 Webster Street
Alameda, California

Well ID	Sample Date	TPHd	TPHg	Concentrations in micrograms per liter (µg/L)				MTBE	TRPH
				B	T	E	X		
<i>ESL</i>		<i>100</i>	<i>100</i>	<i>1.0</i>	<i>40</i>	<i>30</i>	<i>20</i>	<i>5.0</i>	<i>---</i>
MW-5	12/6/1999	2,800	30,000	2,200	3,300	910	7000	670	---
	3/16/2000	1,100	3,500	1,100	260	210	6300	260	---
	6/13/2000	1,100	6,500	2200	360	360	730	480	---
	9/29/2000	700 (1)	3,900	990	120	300	340	390 (2)	---
	3/22/2001	380 (1)	4,300	780	240	250	530	190	---
	6/25/2001	---	3,100	1000	110	200	320	140	---
	9/28/2001	---	3,000	1200	77	120	170	770	---
	12/26/2001	---	3,240	738	262	218	626	66.4	---
	8/24/2005	---	150	57	3	8	3.9	67	---
	10/19/2005	---	560	130	3.8	23	9.3	230	---
	1/13/2006	---	2,300	570	18	120	140	220	---
	5/5/2006	---	130	35	1.7	7.8	7.4	8	---
	7/19/2006	---	210	102	1.54	15.8	3.85	27.6	---
10/5/2006	---	410	105	1.06	9.05	2.24	101	---	
*****Well Abandoned 12/27/2006*****									
MW-6	12/6/1999	110	<50	2	2	0.8	8	1	---
	3/16/2000	<50	<50	8	8	5	18	<0.5	---
	6/13/2000	<50	75	0.7	1	0.9	2	0.6	---
	9/29/2000	<50	<50	<0.5	<0.5	<0.5	<1.0	<0.5	---
	3/22/2001	<50	66	0.5	<0.5	<0.5	<1.0	3	---
	6/25/2001	---	<50	<0.5	<0.5	<0.5	<1.0	4	---
	9/28/2001	---	63	2	ND	ND	1	3	---
	12/26/2001	---	<50	<0.5	<0.5	<0.5	1.4	<0.5	---
	7/7/2005	---	<50	<0.5	<0.5	<0.5	<1.0	<0.5	---
	10/19/2005	---	<25	<0.5	<0.5 (3)	<0.5	<0.5	<1.0	---
	1/13/2006	---	<25	<0.5	<0.5	<0.5	<0.5	<1.0	---
	5/5/2006	---	<25	<0.5	<0.5	<0.5	<0.5	<1.0	---
	7/19/2006	---	<50	<0.5	<0.5	<0.5	<1.5	<0.5	---
	10/5/2006	---	<50	<0.5	<0.5	<0.5	<1.5	<0.5	---
3/29/2007	---	<50	<0.5	<0.5	<0.5	<1.5	<0.5	---	
6/27/2007	---	<50	<0.5	<0.5	<0.5	<1.5	<0.5	---	
MW-7	3/29/2007	---	840	50.8	9.33	2.54	162	39.9	---
	6/27/2007	---	270	126	<0.5	7.11	<1.5	94.4	---
MW-8	4/6/2007	---	27,000	2,460	1,520	210	1,810	16,000	---
	6/27/2007	---	20,000	2,460	382	611	1,040	7,310	---

Notes:

TPHd = Total Petroleum Hydrocarbons as Diesel (EPA Method 8015)
TPHg = Total Petroleum Hydrocarbons as Gasoline by EPA Method 8015; July 2005 by EPA 8260
BTEX = Benzene, Toluene, Ethylbenzene, Xylenes by EPA Method 8020; July 2005 by EPA 8260
MTBE = Methyl tert-butyl Ether by EPA Method 8020; July 2005 by EPA 8260
TRPH = Total Recoverable Petroleum Hydrocarbons
<X = Concentration less than laboratory reporting limit
--- = Not Analyzed
(1) Does not match diesel chromatogram pattern
(2) Confirmed by EPA Method 8260
(3) Toluene was detected at concentrations of 1 ppb in sample from well MW-2, 0.74 ppb in sample from well MW-3, 0.9 ppb in sample from well MW-4, and 0.66 ppb in sample from well MW-6. Data were adjusted to non-detect because of the presence of toluene (0.81 ppb) in method blank and the sample results were less than 5 times in the blank (EPA, Laboratory Data Validation Functional Guidelines for Evaluating Organics Analyses, December 1994).
ESLs = Environmental Screening Levels (**Table F-1a**), groundwater is a current or potential drinking water resource (CARWQCB, Interim Final, February 2005).

FIGURES

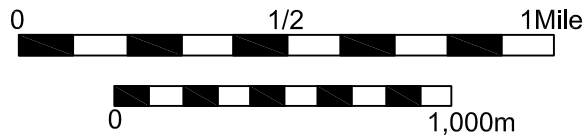
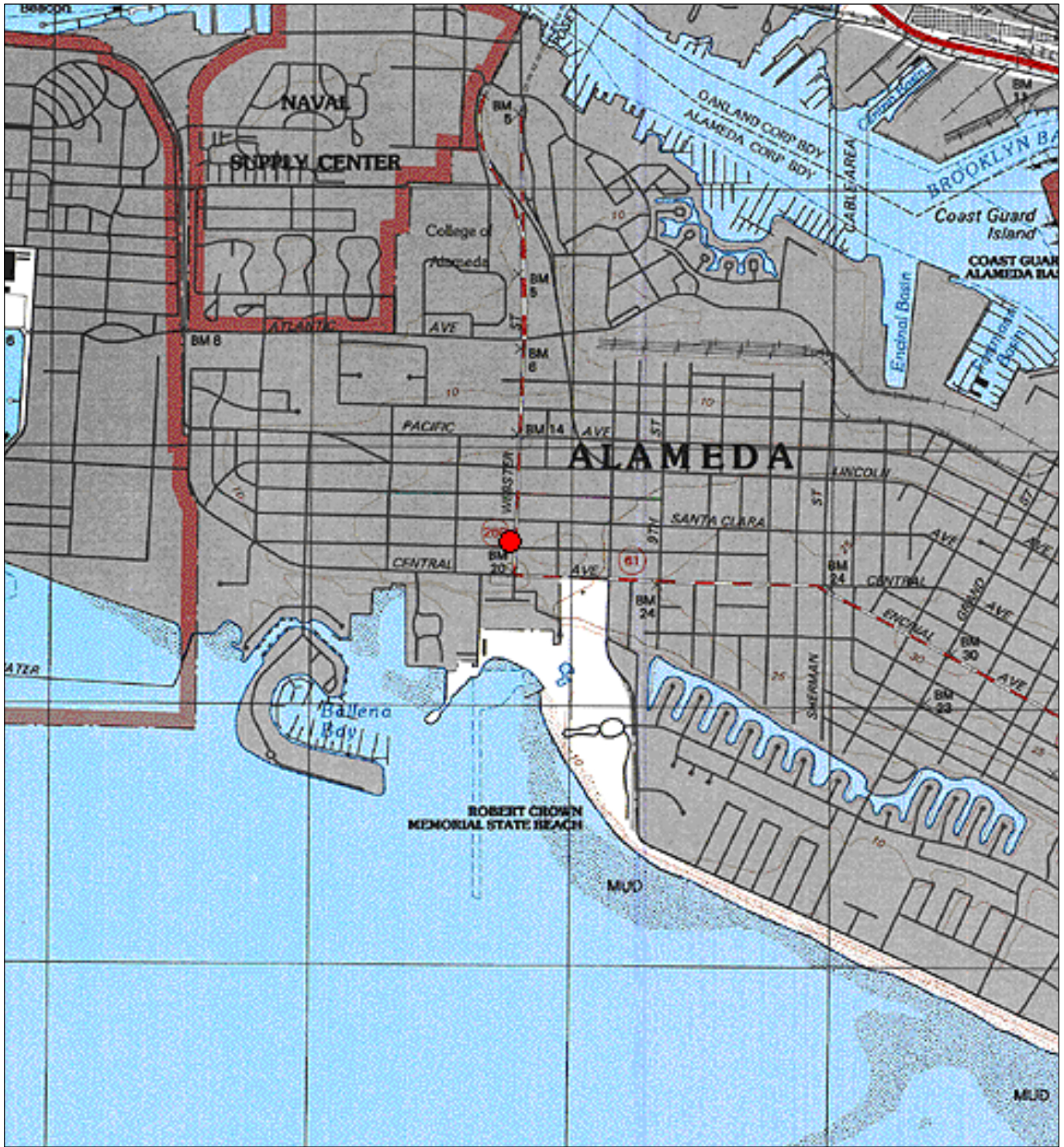

● Site Location

Map By: TOPO!

Date: 07/18/2007

Drafted By: LC

SITE
1435 Webster Street
Alameda, California



262 Michelle Court
So. San Francisco, CA 94080
Main: (650) 616-1200
Fax: (650) 616-1244

FIGURE

TITLE

1

Vicinity Map

S:\1 Environmental Dept\Active Sites\Olympian\1435 Webster, Alameda\FIGURES\QMS\2007 07 QMR 1435 Webster E74.dwg, 7/18/2007 12:57:54 PM

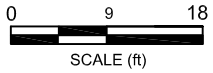
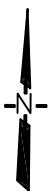
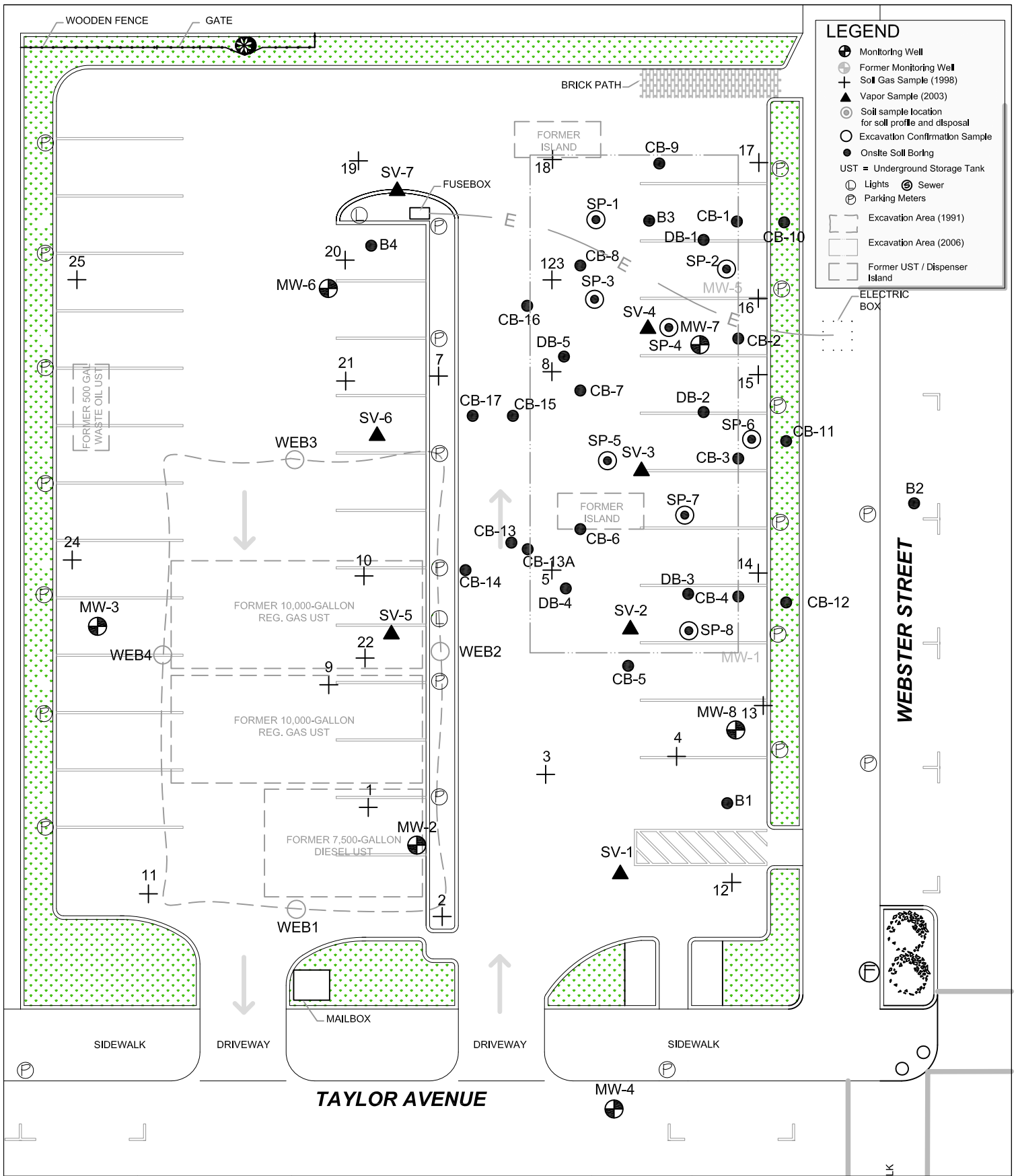

Revision: 1
Date: 07/18/2007
Drafted By: LC



262 Michelle Court
So. San Francisco, CA 94080
Main: (650) 616-1200
Fax: (650) 616-1244

SITE
1435 Webster Street
Alameda, California

FIGURE
2

Site Map

S:\1 Environmental Dept\Active Sites\Olympian\1435 Webster, Alameda\FIGURES\QMS\2007 07 QMR 1435 Webster E74.dwg, 7/19/2007 9:02:54 AM

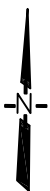
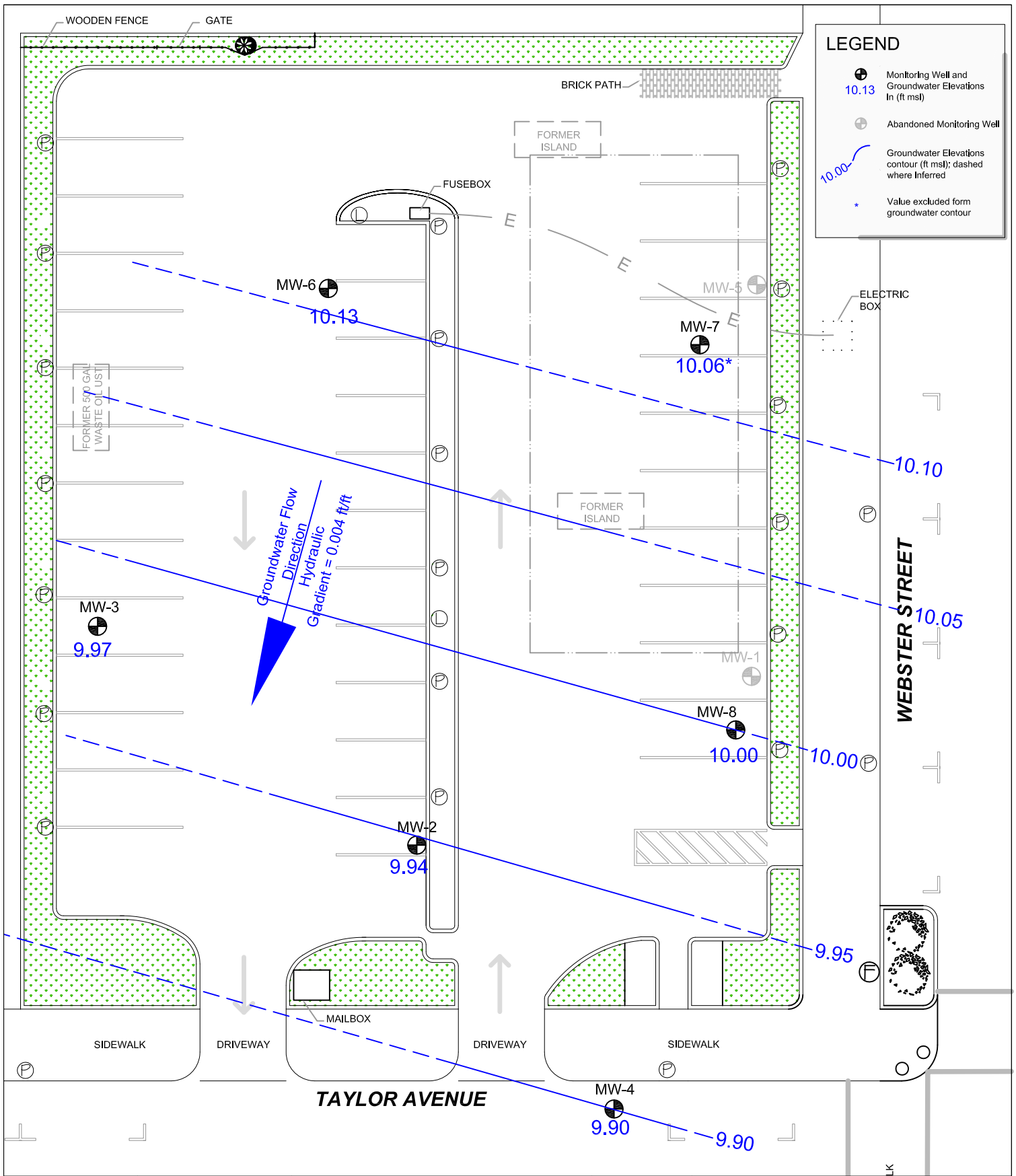

Revision: 1
 Date: 07/18/2007
 Drafted By: LC



262 Michelle Court
 So. San Francisco, CA 94080
 Main: (650) 616-1200
 Fax: (650) 616-1244

SITE
 1435 Webster Street
 Alameda, California

FIGURE 3

Groundwater Gradient Map
June 27, 2007

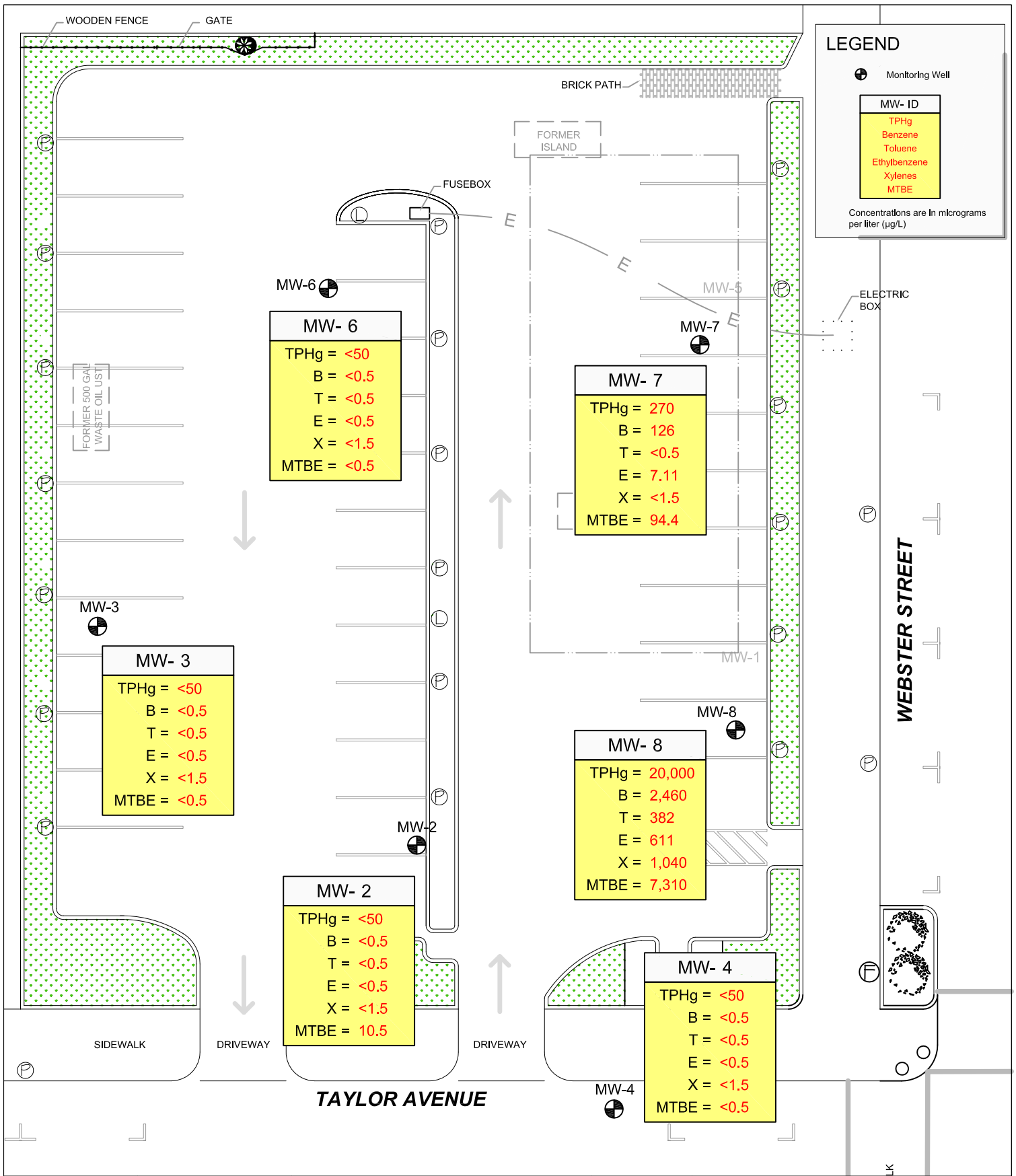

Revision: 1
 Date: 07/18/2007
 Drafted By: LC



262 Michelle Court
 So. San Francisco, CA 94080
 Main: (650) 616-1200
 Fax: (650) 616-1244

SITE
 1435 Webster Street
 Alameda, California

FIGURE
4

**Petroleum Hydrocarbons
 in Groundwater**

June 2007

ATTACHMENT A

WELL SAMPLING LOGS



TEC Accutite
Water Sample Field Data Sheet

Project #: 1435 Webster Ave Purged By: A.M. Well I.D.: MW-2
 Client Name: Olympian Sampled By: ↓ Sample I.D.: MW-2
 Location: Alameda QA Samples:

Date Purged 6/27/07 Start (2400hr) 1218 End (2400hr) 1224
 Date Sampled ↓ Sample Time (2400hr) 1627
 Sample Type: Groundwater Other:

Casing Diameter 2" 3" 4" 5" 6" 8" Other

Depth to Bottom (feet) = 19.30 Depth to Water (feet) = 9.86
 DTB-DTW = 9.44 Purge (gal) = 1.60 x 3 (volumes) = 4.81 gal

Field Measurements

Date (mm/dd/yy)	Time (2400hr)	Volume (gal)	Temp. (degrees C)	Conductivity (umhos/cm)	pH (units)	Color (visual)	Turbidity (NTU)	D.O. (mg/l)	Depth (ft)
<u>6/27/07</u>	<u>1220</u>	<u>1.60</u>	<u>19.5</u>	<u>47.6</u>	<u>6.08</u>	<u>Clear</u>	<u>low</u>	<u>—</u>	<u>13.65</u>
<u>↓</u>	<u>1222</u>	<u>3.20</u>	<u>19.3</u>	<u>48.1</u>	<u>6.21</u>	<u> </u>	<u> </u>	<u>—</u>	<u>15.0</u>
<u>↓</u>	<u>1224</u>	<u>4.81</u>	<u>19.3</u>	<u>48.0</u>	<u>6.40</u>	<u> </u>	<u> </u>	<u>—</u>	<u>15.35</u>

Sample Depth to Water: 9.86 Sample Information Sample Turbidity: low

Odor: None Analysis: 8260
 Sample Vessel/Preservative: 3 VOAS w/ HCL

Purging Equipment

Bladder Pump Bailer (Teflon)
 Centrifugal Pump Bailer (PVC or Disposable)
 Submersible Pump Bailer (Stainless Steel)
 Peristaltic Pump Dedicated

Other:

Pump Depth:

Sampling Equipment

Bladder Pump Bailer (Teflon)
 Centrifugal Pump Bailer (PVC or disposable)
 Submersible Pump Bailer (Stainless Steel)
 Peristaltic Pump Dedicated

Other:

Well Integrity: Good Lock #:

NOTE: To Convert water column height to total amount of gallons in one well volume, multiply the water column height by A

Well Diameter	A
2"	0.17
4"	0.65
6"	1.47
8"	2.62

Signature: Anthony Melby

**TEC Accutite
Water Sample Field Data Sheet**

Project #: 1435 Webster Ave Purged By: A.M. Well I.D.: MW-3
 Client Name: Olympian Sampled By: ↓ Sample I.D.: MW-3
 Location: Alameda QA Samples: _____

Date Purged 6/27/07 Start (2400hr) 1147 End (2400hr) 1153
 Date Sampled ↓ Sample Time (2400hr) 1604
 Sample Type: Groundwater Other: _____

Casing Diameter 2" 3" _____ 4" _____ 5" _____ 6" _____ 8" _____ Other _____

Depth to Bottom (feet) = 21.95 Depth to Water (feet) = 9.82
 DTB-DTW = 12.13 Purge (gal) = 2.06 x 3 (volumes) = 6.18 gal

Field Measurements

Date (mm/dd/yy)	Time (2400hr)	Volume (gal)	Temp. (degrees C)	Conductivity (umhos/cm)	pH (units)	Color (visual)	Turbidity (NTU)	D.O. (mg/l)	Depth (ft)
<u>6/27/07</u>	<u>1149</u>	<u>2.06</u>	<u>19.5</u>	<u>43.2</u>	<u>6.18</u>	<u>Orange</u>	<u>MOD</u>	<u>—</u>	<u>11.5</u>
	<u>1151</u>	<u>4.12</u>	<u>19.5</u>	<u>42.1</u>	<u>6.19</u>	<u>11</u>	<u>11</u>	<u>—</u>	<u>12.0</u>
	<u>1153</u>	<u>6.18</u>	<u>19.4</u>	<u>41.0</u>	<u>6.22</u>	<u>11</u>	<u>11</u>	<u>—</u>	<u>12.45</u>

Sample Depth to Water: 9.82 Sample Information Sample Turbidity: low

Odor: None Analysis: 8260
 Sample Vessel/Preservative: 3 VOAS w/ HCL

Purging Equipment

___ Bladder Pump ___ Bailer (Teflon)
 ___ Centrifugal Pump ___ Bailer (PVC or Disposable)
 Submersible Pump ___ Bailer (Stainless Steel)
 ___ Peristaltic Pump ___ Dedicated _____

Other: _____
 Pump Depth: _____

Sampling Equipment

___ Bladder Pump ___ Bailer (Teflon)
 ___ Centrifugal Pump Bailer (PVC or disposable)
 ___ Submersible Pump ___ Bailer (Stainless Steel)
 ___ Peristaltic Pump ___ Dedicated _____

Other: _____

Well Integrity: Good Lock #: _____

NOTE: To Convert water column height to total amount of gallons in one well volume, multiply the water column height by A

Well Diameter	A
2"	0.17
4"	0.65
6"	1.47
8"	2.62

Signature: Anthony M. [Signature]

**TEC Accutite
Water Sample Field Data Sheet**

Project #: 1435 Webster Ave Purged By: A.M. Well I.D.: MW-4
 Client Name: Olympian Sampled By: ↓ Sample I.D.: MW-4
 Location: Alameda QA Samples: _____

Date Purged 6/27/07 Start (2400hr) 1204 End (2400hr) 1206
 Date Sampled _____ Sample Time (2400hr) 1614
 Sample Type: Groundwater Other: _____

Casing Diameter 2" 3" _____ 4" _____ 5" _____ 6" _____ 8" _____ Other _____
 Depth to Bottom (feet) = 19.60 Depth to Water (feet) = 9.40
 DTB-DTW = 10.2 Purge (gal) = 1.73 x 3 (volumes) = 5.20 gal

Field Measurements

Date (mm/dd/yy)	Time (2400hr)	Volume (gal)	Temp. (degrees C)	Conductivity (umhos/cm)	pH (units)	Color (visual)	Turbidity (NTU)	D.O. (mg/l)	Depth (ft)
<u>6/27/07</u>	<u>1206</u>	<u>1.73</u>	<u>19.1</u>	<u>39.5</u>	<u>6.12</u>	<u>Clear</u>	<u>low</u>	<u>—</u>	<u>18.60</u>
	<u>1206</u>		<u>well</u>	<u>went</u>		<u>DRY</u>			

Sample Depth to Water: 9.40 Sample Information Sample Turbidity: low

Odor: None Analysis: 8260
 Sample Vessel/Preservative: 3 VOAS w/ HCL

Purging Equipment

___ Bladder Pump ___ Bailer (Teflon)
 ___ Centrifugal Pump ___ Bailer (PVC or Disposable)
 Submersible Pump ___ Bailer (Stainless Steel)
 ___ Peristaltic Pump ___ Dedicated _____
 Other: _____
 Pump Depth: _____

Sampling Equipment

___ Bladder Pump ___ Bailer (Teflon)
 ___ Centrifugal Pump Bailer (PVC or disposable)
 ___ Submersible Pump ___ Bailer (Stainless Steel)
 ___ Peristaltic Pump ___ Dedicated _____
 Other: _____

Well Integrity: Good Lock #: _____

NOTE: To Convert water column height to total amount of gallons in one well volume, multiply the water column height by A

Well Diameter	A
2"	0.17
4"	0.65
6"	1.47
8"	2.62

Signature: Anthony M. [Signature] Page 1 of 1

**TEC Accutite
Water Sample Field Data Sheet**

Project #: 1435 Webster Ave Purged By: A.M. Well I.D.: MW-6
 Client Name: Olympian Sampled By: ↓ Sample I.D.: MW-6
 Location: Alameda QA Samples: _____

Date Purged 6/27/07 Start (2400hr) 1123 End (2400hr) 1134
 Date Sampled ↓ Sample Time (2400hr) 1551
 Sample Type: Groundwater Other: _____

Casing Diameter 2" 3" _____ 4" _____ 5" _____ 6" _____ 8" _____ Other _____

Depth to Bottom (feet) = 19.40 Depth to Water (feet) = 10.14
 DTB-DTW = 9.26 Purge (gal) = 1.57 x 3 (volumes) = 4.72 gal

Field Measurements

Date (mm/dd/yy)	Time (2400hr)	Volume (gal)	Temp. (degrees C)	Conductivity (µmhos/cm)	pH (units)	Color (visual)	Turbidity (NTU)	D.O. (mg/l)	Depth (ft)
<u>6/27/07</u>	<u>1126</u>	<u>1.57</u>	<u>19.6</u>	<u>49.0</u>	<u>6.15</u>	<u>Orange</u>	<u>High</u>	<u>—</u>	<u>11.55</u>
<u>↓</u>	<u>1131</u>	<u>3.14</u>	<u>19.7</u>	<u>47.4</u>	<u>6.25</u>	<u>11</u>	<u>11</u>	<u>—</u>	<u>11.70</u>
<u>↓</u>	<u>1134</u>	<u>4.72</u>	<u>19.7</u>	<u>45.6</u>	<u>6.17</u>	<u>11</u>	<u>11</u>	<u>—</u>	<u>12.00</u>

Sample Information

Sample Depth to Water: 10.14 Sample Turbidity: 100

Odor: None Analysis: 8260
 Sample Vessel/Preservative: 3 VOAS w/ HCL

Purging Equipment

___ Bladder Pump ___ Bailer (Teflon)
 ___ Centrifugal Pump Bailer (PVC or Disposable)
 ___ Submersible Pump ___ Bailer (Stainless Steel)
 ___ Peristaltic Pump ___ Dedicated _____
 Other: _____

Sampling Equipment

___ Bladder Pump ___ Bailer (Teflon)
 ___ Centrifugal Pump Bailer (PVC or disposable)
 ___ Submersible Pump ___ Bailer (Stainless Steel)
 ___ Peristaltic Pump ___ Dedicated _____
 Other: _____

Pump Depth: _____

Well Integrity: Good Lock #: _____

NOTE: To Convert water column height to total amount of gallons in one well volume, multiply the water column height by A

Well Diameter	A
2"	0.17
4"	0.65
6"	1.47
8"	2.62

Signature: Anthony M. [Signature] Page 1 of 1

**TEC Accutite
Water Sample Field Data Sheet**

Project #: 1435 Webster Ave Purged By: A.M. Well I.D.: MW-7
 Client Name: Olympian Sampled By: ↓ Sample I.D.: MW-7
 Location: Alameda QA Samples: _____

Date Purged 6/27/07 Start (2400hr) 1354 End (2400hr) 1408
 Date Sampled ↓ Sample Time (2400hr) 1636
 Sample Type: Groundwater Other: _____

Casing Diameter 2" _____ 3" _____ 4" 5" _____ 6" _____ 8" _____ Other _____

Depth to Bottom (feet) = 19.83 Depth to Water (feet) = 8.87
 DTB-DTW = 10.96 Purge (gal) = 7.12 x 3 (volumes) = 21.37 gal

Field Measurements

Date (mm/dd/yy)	Time (2400hr)	Volume (gal)	Temp. (degrees C)	Conductivity (µmhos/cm)	pH (units)	Color (visual)	Turbidity (NTU)	D.O. (mg/l)	Depth (ft)
<u>6/27/07</u>	<u>1358</u>	<u>7.12</u>	<u>21.0</u>	<u>169.8</u>	<u>5.86</u>	<u>0/edf</u>	<u>low</u>	<u>—</u>	<u>13.69</u>
<u>↓</u>	<u>1403</u>	<u>14.24</u>	<u>20.7</u>	<u>301</u>	<u>6.26</u>	<u> </u>	<u> </u>	<u>—</u>	<u>15.67</u>
<u>↓</u>	<u>1408</u>	<u>21.37</u>	<u>20.2</u>	<u>318</u>	<u>6.46</u>	<u> </u>	<u> </u>	<u>—</u>	<u>16.80</u>

Sample Information

Sample Depth to Water: 8.87 Sample Turbidity: low

Odor: Slight Analysis: 8260
 Sample Vessel/Preservative: 3 VOAS w/ HCL

Purging Equipment

Bladder Pump Bailer (Teflon)
 Centrifugal Pump Bailer (PVC or Disposable)
 Submersible Pump Bailer (Stainless Steel)
 Peristaltic Pump Dedicated _____

Other: _____
 Pump Depth: _____

Sampling Equipment

Bladder Pump Bailer (Teflon)
 Centrifugal Pump Bailer (PVC or disposable)
 Submersible Pump Bailer (Stainless Steel)
 Peristaltic Pump Dedicated _____

Other: _____

Well Integrity: Good Lock #: _____

NOTE: To Convert water column height to total amount of gallons in one well volume, multiply the water column height by A

Well Diameter	A
2"	0.17
4"	0.65
6"	1.47
8"	2.62

Signature: Anthony M. [Signature]

**TEC Accutite
Water Sample Field Data Sheet**

Project #: 1435 Webster Ave Purged By: A.M. Well I.D.: MW-8
 Client Name: Olympian Sampled By: ↓ Sample I.D.: MW-8
 Location: Alameda QA Samples: _____
 Date Purged: 6/27/07 Start (2400hr) 1238 End (2400hr) 1247
 Date Sampled: ↓ Sample Time (2400hr) 1629
 Sample Type: Groundwater Other: _____

Casing Diameter 2" _____ 3" _____ 4" 5" _____ 6" _____ 8" _____ Other _____
 Depth to Bottom (feet) = 19.85 Depth to Water (feet) = 9.33
 DTB-DTW = 10.52 Purge (gal) = 6.83 x 3 (volumes) = 20.49 gal

Field Measurements

Date (mm/dd/yy)	Time (2400hr)	Volume (gal)	Temp. (degrees C)	Conductivity (µmhos/cm)	pH (units)	Color (visual)	Turbidity (NTU)	D.O. (mg/l)	Depth (ft)
<u>6/27/07</u>	<u>1241</u>	<u>6.83</u>	<u>20.5</u>	<u>55.6</u>	<u>6.19</u>	<u>Clear</u>	<u>low</u>	<u>—</u>	<u>14.20</u>
	<u>1245</u>	<u>13.76</u>	<u>19.9</u>	<u>58.2</u>	<u>6.57</u>	<u>11</u>	<u>11</u>	<u>—</u>	<u>18.59</u>
	<u>1247</u>		<u>well</u>		<u>went</u>	<u>Day</u>			<u>18.85</u>

Sample Information

Sample Depth to Water: 9.33 Sample Turbidity: low
 Odor: Strong odor Analysis: 8260
 Sample Vessel/Preservative: 3 VOA's w/ HCL

Purging Equipment

___ Bladder Pump ___ Bailer (Teflon)
 ___ Centrifugal Pump ___ Bailer (PVC or Disposable)
 Submersible Pump ___ Bailer (Stainless Steel)
 ___ Peristaltic Pump ___ Dedicated _____
 Other: _____
 Pump Depth: _____

Sampling Equipment

___ Bladder Pump ___ Bailer (Teflon)
 ___ Centrifugal Pump Bailer (PVC or disposable)
 ___ Submersible Pump ___ Bailer (Stainless Steel)
 ___ Peristaltic Pump ___ Dedicated _____
 Other: _____

Well Integrity: Good Lock #: _____

NOTE: To Convert water column height to total amount of gallons in one well volume, multiply the water column height by A

Well Diameter	A
2"	0.17
4"	0.65
6"	1.47
8"	2.62

Signature: Anthony M... Page 1 of 1

ATTACHMENT B

LABORATORY REPORT AND
CHAIN-OF-CUSTODY DOCUMENTATION





TORRENT LABORATORY, INC.

483 Sinclair Frontage Rd. • Milpitas, CA 95035 • Ph: (408) 263-5258 • Fax: (408) 263-8293

www.torrentlab.com

July 12, 2007

NATE SMITH
TEC Accutite
262 Michelle Ct
South San Francisco, CA 94080

TEL: (650) 616-1200
FAX 650-616-1244

RE: 1435 Webster Ave/13318

Order No.: 0707018

Dear NATE SMITH:

Torrent Laboratory, Inc. received 6 samples on 7/5/2007 for the analyses presented in the following report.

All data for associated QC met EPA or laboratory specification(s) except where noted in the case narrative.

Torrent Laboratory, Inc. is certified by the State of California, ELAP #1991. If you have any questions regarding these tests results, please feel free to contact the Project Management Team at (408)263-5258;ext: 204.

Sincerely,

Laboratory Director

Date

Patti Sandrock
QA Officer



TORRENT LABORATORY, INC.

483 Sinclair Frontage Road • Milpitas, CA • Phone: (408) 263-5258 • Fax: (408) 263-8293

Visit us at www.torrentlab.com email: analysis@torrentlab.com

Report prepared for: NATE SMITH
TEC Accutite

Date Received: 7/5/2007

Date Reported: 7/12/2007

Client Sample ID: MW-2

Lab Sample ID: 0707018-001

Sample Location: 1435 Webster Ave/2nd QMR Sa

Date Prepared: 7/6/2007

Sample Matrix: GROUNDWATER

Date/Time Sampled 6/27/2007 4:22:00 PM

Parameters	Analysis Method	Date Analyzed	RL	Dilution Factor	MRL	Result	Units	Analytical Batch
1,2-Dibromoethane (EDB)	SW8260B	7/6/2007	0.5	1	0.500	ND	µg/L	R13259
1,2-Dichloroethane (EDC)	SW8260B	7/6/2007	0.5	1	0.500	0.820	µg/L	R13259
Benzene	SW8260B	7/6/2007	0.5	1	0.500	ND	µg/L	R13259
Ethyl tert-butyl ether (ETBE)	SW8260B	7/6/2007	0.5	1	0.500	ND	µg/L	R13259
Ethylbenzene	SW8260B	7/6/2007	0.5	1	0.500	ND	µg/L	R13259
Isopropyl ether (DIPE)	SW8260B	7/6/2007	0.5	1	0.500	ND	µg/L	R13259
Methyl tert-butyl ether (MTBE)	SW8260B	7/6/2007	0.5	1	0.500	10.5	µg/L	R13259
t-Butyl alcohol (t-Butanol)	SW8260B	7/6/2007	10	1	10.0	ND	µg/L	R13259
tert-Amyl methyl ether (TAME)	SW8260B	7/6/2007	0.5	1	0.500	ND	µg/L	R13259
Toluene	SW8260B	7/6/2007	0.5	1	0.500	ND	µg/L	R13259
Xylenes, Total	SW8260B	7/6/2007	1.5	1	1.50	ND	µg/L	R13259
Surr: Dibromofluoromethane	SW8260B	7/6/2007	0	1	61.2-131	118	%REC	R13259
Surr: 4-Bromofluorobenzene	SW8260B	7/6/2007	0	1	64.1-120	108	%REC	R13259
Surr: Toluene-d8	SW8260B	7/6/2007	0	1	75.1-127	118	%REC	R13259
TPH (Gasoline)	SW8260B(TPH)	7/6/2007	50	1	50	ND	µg/L	G13259
Surr: 4-Bromofluorobenzene	SW8260B(TPH)	7/6/2007	0	1	58.4-133	98.3	%REC	G13259

Report prepared for: NATE SMITH
TEC Accutite

Date Received: 7/5/2007
Date Reported: 7/12/2007

Client Sample ID: MW-3
Sample Location: 1435 Webster Ave/2nd QMR Sa
Sample Matrix: GROUNDWATER
Date/Time Sampled 6/27/2007 4:04:00 PM

Lab Sample ID: 0707018-002
Date Prepared: 7/6/2007

Parameters	Analysis Method	Date Analyzed	RL	Dilution Factor	MRL	Result	Units	Analytical Batch
1,2-Dibromoethane (EDB)	SW8260B	7/6/2007	0.5	1	0.500	ND	µg/L	R13259
1,2-Dichloroethane (EDC)	SW8260B	7/6/2007	0.5	1	0.500	ND	µg/L	R13259
Benzene	SW8260B	7/6/2007	0.5	1	0.500	ND	µg/L	R13259
Ethyl tert-butyl ether (ETBE)	SW8260B	7/6/2007	0.5	1	0.500	ND	µg/L	R13259
Ethylbenzene	SW8260B	7/6/2007	0.5	1	0.500	ND	µg/L	R13259
Isopropyl ether (DIPE)	SW8260B	7/6/2007	0.5	1	0.500	ND	µg/L	R13259
Methyl tert-butyl ether (MTBE)	SW8260B	7/6/2007	0.5	1	0.500	ND	µg/L	R13259
t-Butyl alcohol (t-Butanol)	SW8260B	7/6/2007	10	1	10.0	ND	µg/L	R13259
tert-Amyl methyl ether (TAME)	SW8260B	7/6/2007	0.5	1	0.500	ND	µg/L	R13259
Toluene	SW8260B	7/6/2007	0.5	1	0.500	ND	µg/L	R13259
Xylenes, Total	SW8260B	7/6/2007	1.5	1	1.50	ND	µg/L	R13259
Surr: Dibromofluoromethane	SW8260B	7/6/2007	0	1	61.2-131	121	%REC	R13259
Surr: 4-Bromofluorobenzene	SW8260B	7/6/2007	0	1	64.1-120	118	%REC	R13259
Surr: Toluene-d8	SW8260B	7/6/2007	0	1	75.1-127	116	%REC	R13259
TPH (Gasoline)	SW8260B(TPH)	7/6/2007	50	1	50	ND	µg/L	G13259
Surr: 4-Bromofluorobenzene	SW8260B(TPH)	7/6/2007	0	1	58.4-133	96.6	%REC	G13259

Report prepared for: NATE SMITH
TEC Accutite

Date Received: 7/5/2007
Date Reported: 7/12/2007

Client Sample ID: MW-4
Sample Location: 1435 Webster Ave/2nd QMR Sa
Sample Matrix: GROUNDWATER
Date/Time Sampled 6/27/2007 4:14:00 PM

Lab Sample ID: 0707018-003
Date Prepared: 7/6/2007

Parameters	Analysis Method	Date Analyzed	RL	Dilution Factor	MRL	Result	Units	Analytical Batch
1,2-Dibromoethane (EDB)	SW8260B	7/6/2007	0.5	1	0.500	ND	µg/L	R13259
1,2-Dichloroethane (EDC)	SW8260B	7/6/2007	0.5	1	0.500	ND	µg/L	R13259
Benzene	SW8260B	7/6/2007	0.5	1	0.500	ND	µg/L	R13259
Ethyl tert-butyl ether (ETBE)	SW8260B	7/6/2007	0.5	1	0.500	ND	µg/L	R13259
Ethylbenzene	SW8260B	7/6/2007	0.5	1	0.500	ND	µg/L	R13259
Isopropyl ether (DIPE)	SW8260B	7/6/2007	0.5	1	0.500	ND	µg/L	R13259
Methyl tert-butyl ether (MTBE)	SW8260B	7/6/2007	0.5	1	0.500	ND	µg/L	R13259
t-Butyl alcohol (t-Butanol)	SW8260B	7/6/2007	10	1	10.0	ND	µg/L	R13259
tert-Amyl methyl ether (TAME)	SW8260B	7/6/2007	0.5	1	0.500	ND	µg/L	R13259
Toluene	SW8260B	7/6/2007	0.5	1	0.500	ND	µg/L	R13259
Xylenes, Total	SW8260B	7/6/2007	1.5	1	1.50	ND	µg/L	R13259
Surr: Dibromofluoromethane	SW8260B	7/6/2007	0	1	61.2-131	122	%REC	R13259
Surr: 4-Bromofluorobenzene	SW8260B	7/6/2007	0	1	64.1-120	119	%REC	R13259
Surr: Toluene-d8	SW8260B	7/6/2007	0	1	75.1-127	116	%REC	R13259
TPH (Gasoline)	SW8260B(TPH)	7/6/2007	50	1	50	ND	µg/L	G13259
Surr: 4-Bromofluorobenzene	SW8260B(TPH)	7/6/2007	0	1	58.4-133	93.1	%REC	G13259

Report prepared for: NATE SMITH
TEC Accutite

Date Received: 7/5/2007
Date Reported: 7/12/2007

Client Sample ID: MW-6
Sample Location: 1435 Webster Ave/2nd QMR Sa
Sample Matrix: GROUNDWATER
Date/Time Sampled 6/27/2007 3:51:00 PM

Lab Sample ID: 0707018-004
Date Prepared: 7/6/2007

Parameters	Analysis Method	Date Analyzed	RL	Dilution Factor	MRL	Result	Units	Analytical Batch
1,2-Dibromoethane (EDB)	SW8260B	7/6/2007	0.5	1	0.500	ND	µg/L	R13259
1,2-Dichloroethane (EDC)	SW8260B	7/6/2007	0.5	1	0.500	ND	µg/L	R13259
Benzene	SW8260B	7/6/2007	0.5	1	0.500	ND	µg/L	R13259
Ethyl tert-butyl ether (ETBE)	SW8260B	7/6/2007	0.5	1	0.500	ND	µg/L	R13259
Ethylbenzene	SW8260B	7/6/2007	0.5	1	0.500	ND	µg/L	R13259
Isopropyl ether (DIPE)	SW8260B	7/6/2007	0.5	1	0.500	ND	µg/L	R13259
Methyl tert-butyl ether (MTBE)	SW8260B	7/6/2007	0.5	1	0.500	ND	µg/L	R13259
t-Butyl alcohol (t-Butanol)	SW8260B	7/6/2007	10	1	10.0	ND	µg/L	R13259
tert-Amyl methyl ether (TAME)	SW8260B	7/6/2007	0.5	1	0.500	ND	µg/L	R13259
Toluene	SW8260B	7/6/2007	0.5	1	0.500	ND	µg/L	R13259
Xylenes, Total	SW8260B	7/6/2007	1.5	1	1.50	ND	µg/L	R13259
Surr: Dibromofluoromethane	SW8260B	7/6/2007	0	1	61.2-131	107	%REC	R13259
Surr: 4-Bromofluorobenzene	SW8260B	7/6/2007	0	1	64.1-120	107	%REC	R13259
Surr: Toluene-d8	SW8260B	7/6/2007	0	1	75.1-127	117	%REC	R13259
TPH (Gasoline)	SW8260B(TPH)	7/6/2007	50	1	50	ND	µg/L	G13259
Surr: 4-Bromofluorobenzene	SW8260B(TPH)	7/6/2007	0	1	58.4-133	94.8	%REC	G13259

Report prepared for: NATE SMITH
TEC Accutite

Date Received: 7/5/2007
Date Reported: 7/12/2007

Client Sample ID: MW-7
Sample Location: 1435 Webster Ave/2nd QMR Sa
Sample Matrix: GROUNDWATER
Date/Time Sampled 6/27/2007 4:36:00 PM

Lab Sample ID: 0707018-005
Date Prepared: 7/6/2007

Parameters	Analysis Method	Date Analyzed	RL	Dilution Factor	MRL	Result	Units	Analytical Batch
1,2-Dibromoethane (EDB)	SW8260B	7/6/2007	0.5	1	0.500	ND	µg/L	R13259
1,2-Dichloroethane (EDC)	SW8260B	7/6/2007	0.5	1	0.500	6.21	µg/L	R13259
Benzene	SW8260B	7/6/2007	0.5	1	0.500	126	µg/L	R13259
Ethyl tert-butyl ether (ETBE)	SW8260B	7/6/2007	0.5	1	0.500	ND	µg/L	R13259
Ethylbenzene	SW8260B	7/6/2007	0.5	1	0.500	7.11	µg/L	R13259
Isopropyl ether (DIPE)	SW8260B	7/6/2007	0.5	1	0.500	0.550	µg/L	R13259
Methyl tert-butyl ether (MTBE)	SW8260B	7/6/2007	0.5	1	0.500	94.4	µg/L	R13259
t-Butyl alcohol (t-Butanol)	SW8260B	7/6/2007	10	1	10.0	58.4	µg/L	R13259
tert-Amyl methyl ether (TAME)	SW8260B	7/6/2007	0.5	1	0.500	ND	µg/L	R13259
Toluene	SW8260B	7/6/2007	0.5	1	0.500	ND	µg/L	R13259
Xylenes, Total	SW8260B	7/6/2007	1.5	1	1.50	ND	µg/L	R13259
Surr: Dibromofluoromethane	SW8260B	7/6/2007	0	1	61.2-131	112	%REC	R13259
Surr: 4-Bromofluorobenzene	SW8260B	7/6/2007	0	1	64.1-120	118	%REC	R13259
Surr: Toluene-d8	SW8260B	7/6/2007	0	1	75.1-127	117	%REC	R13259
TPH (Gasoline)	SW8260B(TPH)	7/6/2007	50	1	50	270	µg/L	G13259
Surr: 4-Bromofluorobenzene	SW8260B(TPH)	7/6/2007	0	1	58.4-133	87.1	%REC	G13259

Report prepared for: NATE SMITH
TEC Accutite

Date Received: 7/5/2007
Date Reported: 7/12/2007

Client Sample ID: MW-8
Sample Location: 1435 Webster Ave/2nd QMR Sa
Sample Matrix: GROUNDWATER
Date/Time Sampled 6/27/2007 4:29:00 PM

Lab Sample ID: 0707018-006
Date Prepared: 7/7/2007

Parameters	Analysis Method	Date Analyzed	RL	Dilution Factor	MRL	Result	Units	Analytical Batch
1,2-Dibromoethane (EDB)	SW8260B	7/7/2007	0.5	8.8	4.40	9.59	µg/L	R13259
1,2-Dichloroethane (EDC)	SW8260B	7/7/2007	0.5	8.8	4.40	319	µg/L	R13259
Benzene	SW8260B	7/7/2007	0.5	88	44.0	2460	µg/L	R13259
Ethyl tert-butyl ether (ETBE)	SW8260B	7/7/2007	0.5	8.8	4.40	ND	µg/L	R13259
Ethylbenzene	SW8260B	7/7/2007	0.5	8.8	4.40	611	µg/L	R13259
Isopropyl ether (DIPE)	SW8260B	7/7/2007	0.5	8.8	4.40	11.1	µg/L	R13259
Methyl tert-butyl ether (MTBE)	SW8260B	7/7/2007	0.5	88	44.0	7310	µg/L	R13259
t-Butyl alcohol (t-Butanol)	SW8260B	7/7/2007	10	8.8	88.0	3400	µg/L	R13259
Toluene	SW8260B	7/7/2007	0.5	8.8	4.40	382	µg/L	R13259
Xylenes, Total	SW8260B	7/7/2007	1.5	8.8	13.2	1040	µg/L	R13259
Surr: Dibromofluoromethane	SW8260B	7/7/2007	0	8.8	61.2-131	114	%REC	R13259
Surr: Dibromofluoromethane	SW8260B	7/7/2007	0	88	61.2-131	108	%REC	R13259
Surr: 4-Bromofluorobenzene	SW8260B	7/7/2007	0	88	64.1-120	113	%REC	R13259
Surr: 4-Bromofluorobenzene	SW8260B	7/7/2007	0	8.8	64.1-120	112	%REC	R13259
Surr: Toluene-d8	SW8260B	7/7/2007	0	88	75.1-127	113	%REC	R13259
Surr: Toluene-d8	SW8260B	7/7/2007	0	8.8	75.1-127	119	%REC	R13259
TPH (Gasoline)	SW8260B(TPH)	7/7/2007	50	88	4400	20000	µg/L	G13259
Surr: 4-Bromofluorobenzene	SW8260B(TPH)	7/7/2007	0	88	58.4-133	95.7	%REC	G13259

Definitions, legends and Notes

Note	Description
ug/kg	Microgram per kilogram (ppb, part per billion).
ug/L	Microgram per liter (ppb, part per billion).
mg/kg	Milligram per kilogram (ppm, part per million).
mg/L	Milligram per liter (ppm, part per million).
LCS/LCSD	Laboratory control sample/laboratory control sample duplicate.
MDL	Method detection limit.
MRL	Modified reporting limit. When sample is subject to dilution, reporting limit times dilution factor yields MRL.
MS/MSD	Matrix spike/matrix spike duplicate.
N/A	Not applicable.
ND	Not detected at or above detection limit.
NR	Not reported.
QC	Quality Control.
RL	Reporting limit.
% RPD	Percent relative difference.
a	pH was measured immediately upon the receipt of the sample, but it was still done outside the holding time.
sub	Analyzed by subcontracting laboratory, Lab Certificate #

CLIENT: TEC Accutite
Work Order: 0707018
Project: 1435 Webster Ave/13318

ANALYTICAL QC SUMMARY REPORT

BatchID: G13259

Sample ID: MB-G	SampType: MBLK	TestCode: TPH_GAS_W	Units: µg/L	Prep Date: 7/7/2007	RunNo: 13259						
Client ID: ZZZZZ	Batch ID: G13259	TestNo: SW8260B(TP)	Analysis Date: 7/7/2007	SeqNo: 193298							
Analyte	Result	PQL	SPK value	SPK Ref Val	%REC	LowLimit	HighLimit	RPD Ref Val	%RPD	RPDLimit	Qual
TPH (Gasoline)	ND	50									
Surr: 4-Bromofllurobenzene	8.300	0	11.36	0	73.1	58.4	133				

Sample ID: LCS-G	SampType: LCS	TestCode: TPH_GAS_W	Units: µg/L	Prep Date: 7/7/2007	RunNo: 13259						
Client ID: ZZZZZ	Batch ID: G13259	TestNo: SW8260B(TP)	Analysis Date: 7/7/2007	SeqNo: 193299							
Analyte	Result	PQL	SPK value	SPK Ref Val	%REC	LowLimit	HighLimit	RPD Ref Val	%RPD	RPDLimit	Qual
TPH (Gasoline)	187.0	50	227	0	82.4	52.4	127				
Surr: 4-Bromofllurobenzene	10.70	0	11.36	0	94.2	58.4	133				

Sample ID: LCSD-G	SampType: LCSD	TestCode: TPH_GAS_W	Units: µg/L	Prep Date: 7/7/2007	RunNo: 13259						
Client ID: ZZZZZ	Batch ID: G13259	TestNo: SW8260B(TP)	Analysis Date: 7/7/2007	SeqNo: 193300							
Analyte	Result	PQL	SPK value	SPK Ref Val	%REC	LowLimit	HighLimit	RPD Ref Val	%RPD	RPDLimit	Qual
TPH (Gasoline)	209.0	50	227	0	92.1	52.4	127	187	11.1	20	
Surr: 4-Bromofllurobenzene	11.90	0	11.36	0	105	58.4	133	0	0	0	

Qualifiers: E Value above quantitation range H Holding times for preparation or analysis exceeded J Analyte detected below quantitation limits
 ND Not Detected at the Reporting Limit R RPD outside accepted recovery limits S Spike Recovery outside accepted recovery limits

CLIENT: TEC Accutite
Work Order: 0707018
Project: 1435 Webster Ave/13318

ANALYTICAL QC SUMMARY REPORT

BatchID: R13259

Sample ID: MB	SampType: MBLK	TestCode: 8260B_W	Units: µg/L	Prep Date: 7/6/2007	RunNo: 13259						
Client ID: ZZZZZ	Batch ID: R13259	TestNo: SW8260B		Analysis Date: 7/6/2007	SeqNo: 193294						
Analyte	Result	PQL	SPK value	SPK Ref Val	%REC	LowLimit	HighLimit	RPD Ref Val	%RPD	RPDLimit	Qual
1,2-Dibromoethane (EDB)	ND	0.500									
1,2-Dichloroethane (EDC)	ND	0.500									
Benzene	ND	0.500									
Ethyl tert-butyl ether (ETBE)	ND	0.500									
Ethylbenzene	ND	0.500									
Isopropyl ether (DIPE)	ND	0.500									
Methyl tert-butyl ether (MTBE)	ND	0.500									
t-Butyl alcohol (t-Butanol)	ND	5.00									
tert-Amyl methyl ether (TAME)	ND	0.500									
Toluene	ND	0.500									
Xylenes, Total	ND	1.50									
Surr: Dibromofluoromethane	11.86	0	11.36	0	104	61.2	131				
Surr: 4-Bromofluorobenzene	12.35	0	11.36	0	109	64.1	120				
Surr: Toluene-d8	12.95	0	11.36	0	114	75.1	127				

Sample ID: LCS	SampType: LCS	TestCode: 8260B_W	Units: µg/L	Prep Date: 7/7/2007	RunNo: 13259						
Client ID: ZZZZZ	Batch ID: R13259	TestNo: SW8260B		Analysis Date: 7/7/2007	SeqNo: 193295						
Analyte	Result	PQL	SPK value	SPK Ref Val	%REC	LowLimit	HighLimit	RPD Ref Val	%RPD	RPDLimit	Qual
Benzene	16.96	0.500	17.04	0	99.5	66.9	140				
Toluene	15.62	0.500	17.04	0	91.7	76.6	123				
Surr: Dibromofluoromethane	13.68	0	11.36	0	120	61.2	131				
Surr: 4-Bromofluorobenzene	11.68	0	11.36	0	103	64.1	120				
Surr: Toluene-d8	13.50	0	11.36	0	119	75.1	127				

Sample ID: LCSD	SampType: LCSD	TestCode: 8260B_W	Units: µg/L	Prep Date: 7/7/2007	RunNo: 13259						
Client ID: ZZZZZ	Batch ID: R13259	TestNo: SW8260B		Analysis Date: 7/7/2007	SeqNo: 193296						
Analyte	Result	PQL	SPK value	SPK Ref Val	%REC	LowLimit	HighLimit	RPD Ref Val	%RPD	RPDLimit	Qual
Benzene	15.78	0.500	17.04	0	92.6	66.9	140	16.96	7.21	20	
Toluene	15.72	0.500	17.04	0	92.3	76.6	123	15.62	0.638	20	

Qualifiers: E Value above quantitation range H Holding times for preparation or analysis exceeded J Analyte detected below quantitation limits
 ND Not Detected at the Reporting Limit R RPD outside accepted recovery limits S Spike Recovery outside accepted recovery limits

CLIENT: TEC Accutite
Work Order: 0707018
Project: 1435 Webster Ave/13318

ANALYTICAL QC SUMMARY REPORT

BatchID: R13259

Sample ID: LCSD	SampType: LCSD	TestCode: 8260B_W	Units: µg/L	Prep Date: 7/7/2007	RunNo: 13259						
Client ID: ZZZZZ	Batch ID: R13259	TestNo: SW8260B		Analysis Date: 7/7/2007	SeqNo: 193296						
Analyte	Result	PQL	SPK value	SPK Ref Val	%REC	LowLimit	HighLimit	RPD Ref Val	%RPD	RPDLimit	Qual
Surr: Dibromofluoromethane	12.49	0	11.36	0	110	61.2	131	0	0	0	
Surr: 4-Bromofluorobenzene	12.83	0	11.36	0	113	64.1	120	0	0	0	
Surr: Toluene-d8	12.68	0	11.36	0	112	75.1	127	0	0	0	

Qualifiers:	E Value above quantitation range	H Holding times for preparation or analysis exceeded	J Analyte detected below quantitation limits
	ND Not Detected at the Reporting Limit	R RPD outside accepted recovery limits	S Spike Recovery outside accepted recovery limits

Torrent Laboratory, Inc.

WORK ORDER Summary

06-Jul-07

Work Order 0707018

Client ID: TEC ACCUTITE

Project: 1435 Webster Ave/13318

QC Level:

Comments: 5 Day TAT! Run to ESLs; EDF and Excel EDD

Sample ID	Client Sample ID	Collection Date	Date Received	Date Due	Matrix	Test Code	Hld	MS	SEL	Sub	Storage
0707018-001A	MW-2	6/27/2007 4:22:00 PM	7/5/2007	7/11/2007	Groundwater	8260B_W_PETR	<input type="checkbox"/>	<input type="checkbox"/>	<input checked="" type="checkbox"/>	<input type="checkbox"/>	SR
						OLEUM EDF	<input type="checkbox"/>	<input type="checkbox"/>	<input type="checkbox"/>	<input type="checkbox"/>	SR
0707018-002A	MW-3	6/27/2007 4:04:00 PM		7/11/2007		TPH_GAS_W_GC	<input type="checkbox"/>	<input type="checkbox"/>	<input type="checkbox"/>	<input type="checkbox"/>	SR
						MS 8260B_W_PETR	<input type="checkbox"/>	<input type="checkbox"/>	<input checked="" type="checkbox"/>	<input type="checkbox"/>	SR
0707018-003A	MW-4	6/27/2007 4:14:00 PM		7/11/2007		TPH_GAS_W_GC	<input type="checkbox"/>	<input type="checkbox"/>	<input type="checkbox"/>	<input type="checkbox"/>	SR
						MS 8260B_W_PETR	<input type="checkbox"/>	<input type="checkbox"/>	<input checked="" type="checkbox"/>	<input type="checkbox"/>	SR
0707018-004A	MW-6	6/27/2007 3:51:00 PM		7/11/2007		TPH_GAS_W_GC	<input type="checkbox"/>	<input type="checkbox"/>	<input type="checkbox"/>	<input type="checkbox"/>	SR
						MS 8260B_W_PETR	<input type="checkbox"/>	<input type="checkbox"/>	<input checked="" type="checkbox"/>	<input type="checkbox"/>	SR
0707018-005A	MW-7	6/27/2007 4:36:00 PM		7/11/2007		TPH_GAS_W_GC	<input type="checkbox"/>	<input type="checkbox"/>	<input type="checkbox"/>	<input type="checkbox"/>	SR
						MS 8260B_W_PETR	<input type="checkbox"/>	<input type="checkbox"/>	<input checked="" type="checkbox"/>	<input type="checkbox"/>	SR
0707018-006A	MW-8	6/27/2007 4:29:00 PM		7/11/2007		TPH_GAS_W_GC	<input type="checkbox"/>	<input type="checkbox"/>	<input type="checkbox"/>	<input type="checkbox"/>	SR
						MS 8260B_W_PETR	<input type="checkbox"/>	<input type="checkbox"/>	<input checked="" type="checkbox"/>	<input type="checkbox"/>	SR



403 Sinclair Frontage Road
 Milpitas, CA 95035
 Phone: 408.263.5258
 FAX: 408.263.8293
 www.torrentlab.com

CHAIN OF CUSTODY

LAB WORK ORDER NO.
 0707018

NOTE: SHADED AREAS ARE FOR TORRENT LAB USE ONLY.

Company Name: TEC Accutite Location of Sampling: 1435 Webster Ave
 Address: 262 Michelle Ct Purpose: 2nd QMR Sampling
 City: S.S.F State: CA Zip Code: 94080 Special Instructions / Comments: Run to ESL'S
 Telephone: (650) 616-1200 FAX: (650) 616-1244 Global I.D. = T060010076
 REPORT TO: Nathan Smith SAMPLER: A.M. P.O. #: 13318 EMAIL: NSmith@tecaccutite.com

TURNAROUND TIME:
 10 Working Days 3 Working Days Noon - Nxt Day
 7 Working Days 2 Working Days 2 - 8 Hours
 5 Working Days 1 Working Day Othe.

SAMPLE TYPE:
 Storm Water Air
 Waste Water Other
 Ground Water Soil

REPORT FORMAT:
 QC Level IV
 EDF
 Excel / EDD

ANALYSIS REQUESTED									
<i>3000 TPLS BTEX Ever/Oxys lead scavengers</i>									

CLIENT'S SAMPLE I.D.	DATE/TIME SAMPLED	SAMPLE TYPE	# OF CONT	CONT TYPE									TORRENT'S SAMPLE I.D.
1. MW-2	6/27/07 1622	W	3	VOA W/HCL	X	X							001A
2. MW-3	1604				X	X							002A
3. MW-4	1614				X	X							003A
4. MW-6	1551				X	X							004A
5. MW-7	1636				X	X							005A
6. MW-8	1629				X	X							006A
7.													
8.													
9.													
10.													

1 Relinquished By: <u>Anthony M...</u> Print: <u>Anthony M.</u> Date: <u>7/5/07</u> Time: <u>12:06</u>	Received By: <u>Paul Diaz</u> Print: <u>PAUL DIAZ</u> Date: <u>7/5/07</u> Time: <u>12:06</u>
2 Relinquished By: <u>Paul Diaz</u> Print: <u>PAUL DIAZ</u> Date: <u>7/5/07</u> Time: <u>3:10</u>	Received By: <u>H.S. Leary</u> Print: <u>H.S. Leary</u> Date: <u>7/5/07</u> Time: <u>3:10 pm</u>

Were Samples Received in Good Condition? Yes NO Samples on Ice? Yes NO Method of Shipment Hi speed Sample seals intact? Yes NO N/A
 NOTE: Samples are discarded by the laboratory 30 days from date of receipt unless other arrangements are made.
 Log In By: _____ Date: _____ Log In Reviewed By: _____ Date: _____ Page 1 of 1

ATTACHMENT C

GEOTRACKER SUBMISSION CONFIRMATIONS



Electronic Submittal Information

[Main Menu](#) |
 [View/Add Facilities](#) |
 [Upload EDD](#) |
 [Check EDD](#)

Your EDF file has been successfully uploaded!

Confirmation Number: 8131771147

Date/Time of Submittal: 7/31/2007 11:57:50 AM

Facility Global ID: T0600100766

Facility Name: OLYMPIAN #112

Submittal Title: Second Quarter 2007 Groundwater Monitoring Lab Results

Submittal Type: GW Monitoring Report

Click [here](#) to view the detections report for this upload.

OLYMPIAN #112
 1435 WEBSTER
 ALAMEDA, CA 94501

Regional Board - Case #: 01-0832
 SAN FRANCISCO BAY RWQCB (REGION 2)
Local Agency (lead agency) - Case #: RO0000193
 ALAMEDA COUNTY LOP - (SP)

CONF #	TITLE	QUARTER
8131771147	Second Quarter 2007 Groundwater Monitoring Lab Results	Q2 2007
SUBMITTED BY	SUBMIT DATE	STATUS
Nicholas Haddad	7/31/2007	PENDING REVIEW

SAMPLE DETECTIONS REPORT

# FIELD POINTS SAMPLED	6
# FIELD POINTS WITH DETECTIONS	3
# FIELD POINTS WITH WATER SAMPLE DETECTIONS ABOVE MCL	2
SAMPLE MATRIX TYPES	GROUNDWATER

METHOD QA/QC REPORT

METHODS USED	8260TPH,SW8260B
TESTED FOR REQUIRED ANALYTES?	Y
LAB NOTE DATA QUALIFIERS	N

QA/QC FOR 8021/8260 SERIES SAMPLES

TECHNICAL HOLDING TIME VIOLATIONS	0
METHOD HOLDING TIME VIOLATIONS	0
LAB BLANK DETECTIONS ABOVE REPORTING DETECTION LIMIT	0
LAB BLANK DETECTIONS	0
DO ALL BATCHES WITH THE 8021/8260 SERIES INCLUDE THE FOLLOWING?	
- LAB METHOD BLANK	Y
- MATRIX SPIKE	N
- MATRIX SPIKE DUPLICATE	N
- BLANK SPIKE	Y
- SURROGATE SPIKE - NON-STANDARD SURROGATE USED	N

WATER SAMPLES FOR 8021/8260 SERIES

MATRIX SPIKE / MATRIX SPIKE DUPLICATE(S) % RECOVERY BETWEEN 65-135%	n/a
MATRIX SPIKE / MATRIX SPIKE DUPLICATE(S) RPD LESS THAN 30%	n/a
SURROGATE SPIKES % RECOVERY BETWEEN 85-115%	n/a
BLANK SPIKE / BLANK SPIKE DUPLICATES % RECOVERY BETWEEN 70-130%	Y

SOIL SAMPLES FOR 8021/8260 SERIES

MATRIX SPIKE / MATRIX SPIKE DUPLICATE(S) % RECOVERY BETWEEN 65-135%	n/a
MATRIX SPIKE / MATRIX SPIKE DUPLICATE(S) RPD LESS THAN 30%	n/a
SURROGATE SPIKES % RECOVERY BETWEEN 70-125%	n/a
BLANK SPIKE / BLANK SPIKE DUPLICATES % RECOVERY BETWEEN 70-130%	n/a

FIELD QC SAMPLES

<u>SAMPLE</u>	<u>COLLECTED</u>	<u>DETECTIONS > REPD</u>
QCTB SAMPLES	N	0
QCEB SAMPLES	N	0
QCAB SAMPLES	N	0

Logged in as TEC-OLYMPIAN (AUTH_RP)

CONTACT SITE [ADMINISTRATOR](#).

Electronic Submittal Information

[Main Menu](#) | [View/Add Facilities](#) | [Upload EDD](#) | [Check EDD](#)

UPLOADING A GEO_WELL FILE

Processing is complete. No errors were found!
Your file has been successfully submitted!

Submittal Title: Second Quarter 2007 Groundwater Elevation
Data
Facility Global ID: T0600100766
Facility Name: OLYMPIAN #112
Submittal Date/Time: 7/31/2007 12:02:10 PM
Confirmation
Number: **6398452579**

[Back to Main Menu](#)

Logged in as TEC-OLYMPIAN (AUTH_RP)

CONTACT SITE [ADMINISTRATOR](#).

Electronic Submittal Information

[Main Menu](#) | [View/Add Facilities](#) | [Upload EDD](#) | [Check EDD](#)

UPLOADING A GEO_REPORT FILE

YOUR DOCUMENT UPLOAD WAS SUCCESSFUL!

Facility Name: OLYMPIAN #112
Global ID: T0600100766
Title: SECOND QUARTER 2007 GROUNDWATER MONITORING REPORT
Document Type: Monitoring Report - Quarterly
Submittal Type: GEO_REPORT
Submittal Date/Time: 8/8/2007 12:15:49 PM
Confirmation Number: **9887041985**

Click [here](#) to view the document.

[Back to Main Menu](#)

Logged in as TEC-OLYMPIAN (AUTH_RP)

CONTACT SITE [ADMINISTRATOR](#).