

RECEIVED

By Alameda County Environmental Health at 2:25 pm, Oct 16, 2013

Atlantic Richfield Company

Chuck Carmel

Remediation Management Project Manager

PO Box 1257
San Ramon, CA 94583
Phone: (925) 275-3804
Fax: (925) 275-3815
E-Mail: chuck.carmel@bp.com

October 15, 2013

Re: Third Quarter 2013 Status Report
Atlantic Richfield Company Station #2162
15135 Hesperian Boulevard, San Leandro, California
ACEH Case #RO0000190

I declare that to the best of my knowledge at the present time, that the information and/or recommendations contained in the attached document are true and correct.

Submitted by,



Chuck Carmel
Remediation Management Project Manager

Attachment



BROADBENT

875 Cotting Ln., Suite G, Vacaville, CA 95688

[T] 707-455-7290 [F] 707-455-7295

broadbentinc.com

CREATING SOLUTIONS. BUILDING TRUST.

October 15, 2013

Project No. 06-88-620

Atlantic Richfield Company
P.O. Box 1257
San Ramon, CA 94583
Submitted via ENFOS

Attn.: Mr. Chuck Carmel

Re: Third Quarter 2013 Status Report, Atlantic Richfield Company Station No. 2162,
15135 Hesperian Boulevard, San Leandro, California; ACEH Case #RO0000190

Dear Mr. Carmel:

Attached is the Third Quarter 2013 Status Report for Atlantic Richfield Company Station No. 2162 located at 15135 Hesperian Boulevard in San Leandro, California. This report presents a summary of current developments at the Site through the Third Quarter 2013.

Should you have questions regarding this submittal, please do not hesitate to contact us at (707)455-7290.

Sincerely,
BROADBENT & ASSOCIATES, INC.

Alejandra Hernandez
Project Geologist

Kristene Tidwell, P.G., CHG
Senior Geologist



Enclosures

cc: Ms. Dilan Roe, P.E., Alameda County Environmental Health (submitted via ACEH ftp site)
Electronic copy uploaded to GeoTracker

**THIRD QUARTER 2013
STATUS REPORT
ARCO STATION No. 2162, SAN LEANDRO, CALIFORNIA**

Broadbent & Associates, Inc. (Broadbent) is pleased to present this *Third Quarter 2013 Status Report* on behalf of Atlantic Richfield Company (a BP affiliated company) for ARCO Station No. 2162 located at 15135 Hesperian Boulevard in San Leandro, Alameda County, California. Quarterly reporting is being submitted to the Alameda County Environmental Health Services Agency (ACEH) consistent with their requirements under the legal authority of the California Regional Water Quality Control Board as codified by California Code of Regulations Title 23, Section 2652(d). A summary description of current developments regarding the site is provided below.

Facility Name / Address:	ARCO Station No. 2162 / 15135 Hesperian Boulevard, San Leandro
Client Project Manager / Title:	Mr. Chuck Carmel / Remediation Management Project Manager
Broadbent Contact:	Ms. Kristene Tidwell, PG, CHG / 707-455-7290
Broadbent Project No.:	06-88-620
Primary Regulatory Agency / ID No.:	ACEH, Case #RO0000190
Current phase of project:	Monitoring/Offsite Assessment
List of Acronyms / Abbreviations:	ACEH: Alameda County Environmental Health ARCO: Atlantic Richfield Company KFC: Kentucky Fried Chicken

WORK PERFORMED THIS QUARTER (Third Quarter 2013):

1. Submitted *Second Quarter 2013 Monitoring Report* on July 23, 2013.
2. Submitted *Conceptual Site Model and Addendum to the Revised Work Plan* on September 9, 2013
3. No environmental field work was conducted at ARCO Station No. 2162 during the Third Quarter 2012.

WORK SCHEDULED FOR NEXT QUARTER (Fourth Quarter 2013):

1. Submit *Third Quarter 2013 Status Report* (contained herein).
2. Conduct groundwater monitoring for Fourth Quarter 2013.
3. Implement *Addendum to the Revised Work Plan* upon ACEH approval.

DISCUSSION:

No groundwater monitoring and sampling work activities took place at ARCO Station No. 2162 during Third Quarter 2013. Groundwater monitoring and sampling activities will be conducted during the Fourth Quarter 2013. In accordance with the Broadbent *Revised Work Plan for Offsite Groundwater Investigation*, an offsite property access agreement has been secured for the adjacent parking lot of the neighboring KFC restaurant located at 15179 Hesperian Boulevard. A *Conceptual Site Model and Addendum to the Revised Work Plan* was submitted on September 9, 2013 and will be implemented upon concurrence from the ACEH. A Site Location Map is provided as Drawing 1. A Site Map with groundwater elevation contours for the Second Quarter 2013 is provided as Drawing 2. For reference, a sketch showing proposed soil boring locations is provided as Drawing 3.

ATTACHMENTS:

- Drawing 1: Site Location Map
- Drawing 2: Groundwater Elevation Contours and Analytical Summary Map June 13, 2013
- Drawing 3: Site Map with Proposed Soil Boring Locations

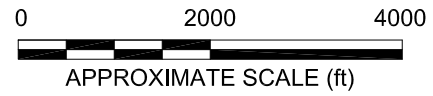
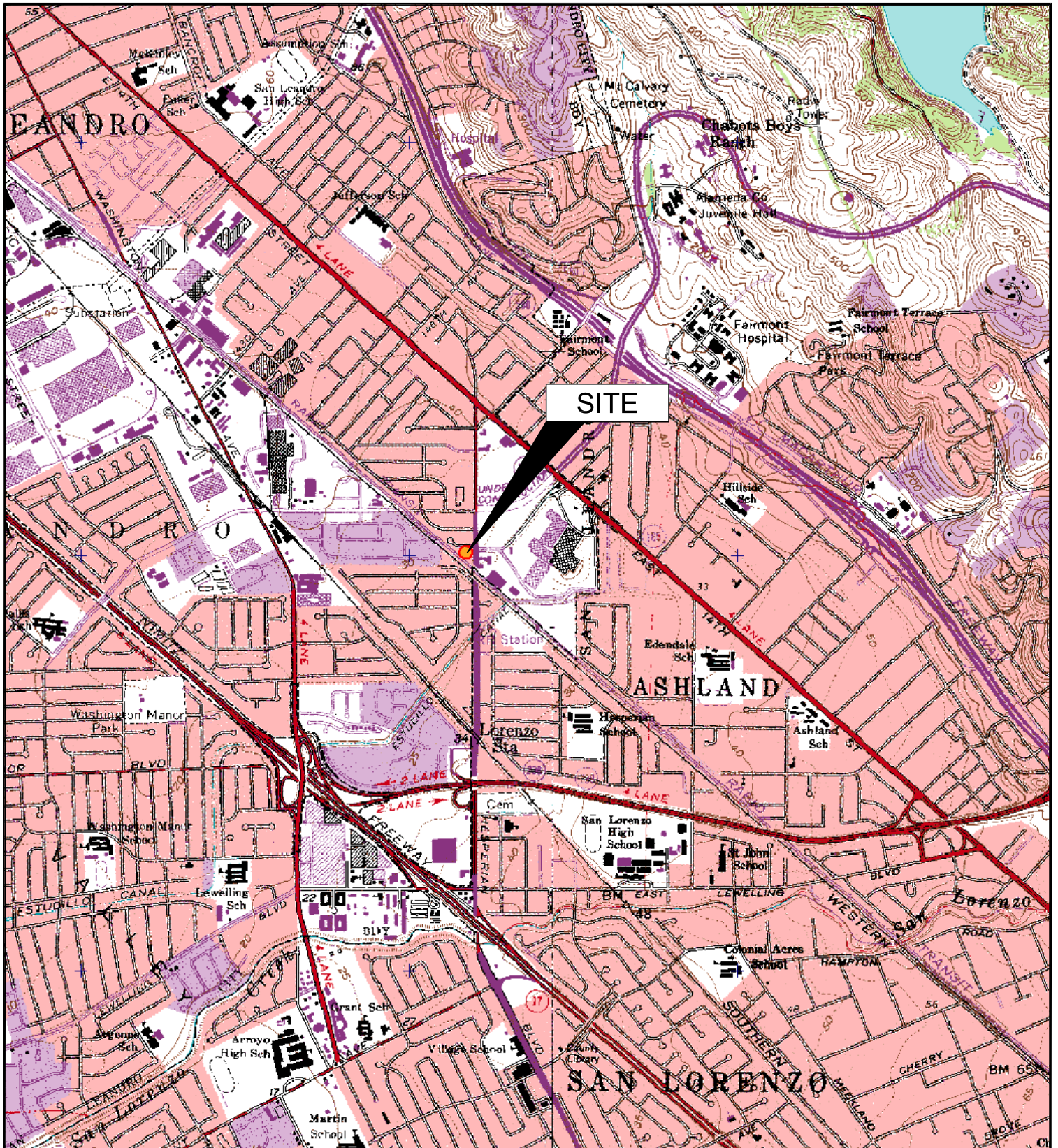

IMAGE SOURCE: USGS

BROADBENT & ASSOCIATES, INC
ENGINEERING, WATER RESOURCES & ENVIRONMENTAL
1324 Mangrove Ave, Suite 212, Chico, CA 95926
Project No.: 06-88-620 Date: 07/27/09

Station #2162
15135 Hesperian Boulevard
San Leandro, California

Site Location Map

Drawing
1

RUTH COURT

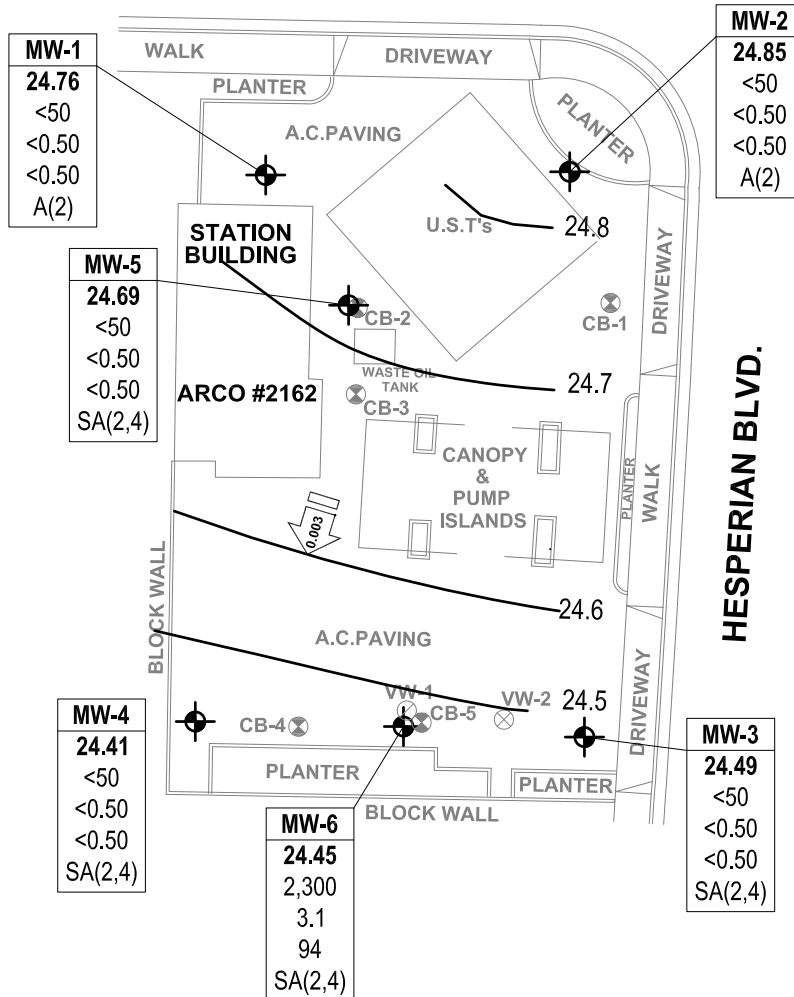

LEGEND

- GROUNDWATER MONITORING WELL
- VAPOR EXTRACTION WELL
- SOIL BORING
- 25.1 GROUNDWATER ELEVATION CONTOUR (FEET ABOVE DATUM)
- APPROXIMATE GROUNDWATER FLOW DIRECTION AND GRADIENT (FT/FT)

- | Well | WELL DESIGNATION |
|---------|---|
| ELEV | GROUNDWATER ELEVATION (FEET) |
| GRO | GRO. BENZENE & MTBE CONCENTRATIONS (µg/L) |
| Benzene | |
| MTBE | |
| A/Q/SA | SAMPLING FREQUENCY |
- < NOT DETECTED AT OR ABOVE LABORATORY REPORTING LIMITS
 - * DATA NOT USED FOR CONTOURING
 - SA SAMPLED SEMI-ANNUALLY

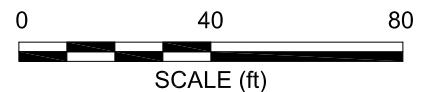
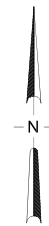

NOTE: SITE MAP ADAPTED FROM WOOD RODGERS SURVYING.

RUTH COURT

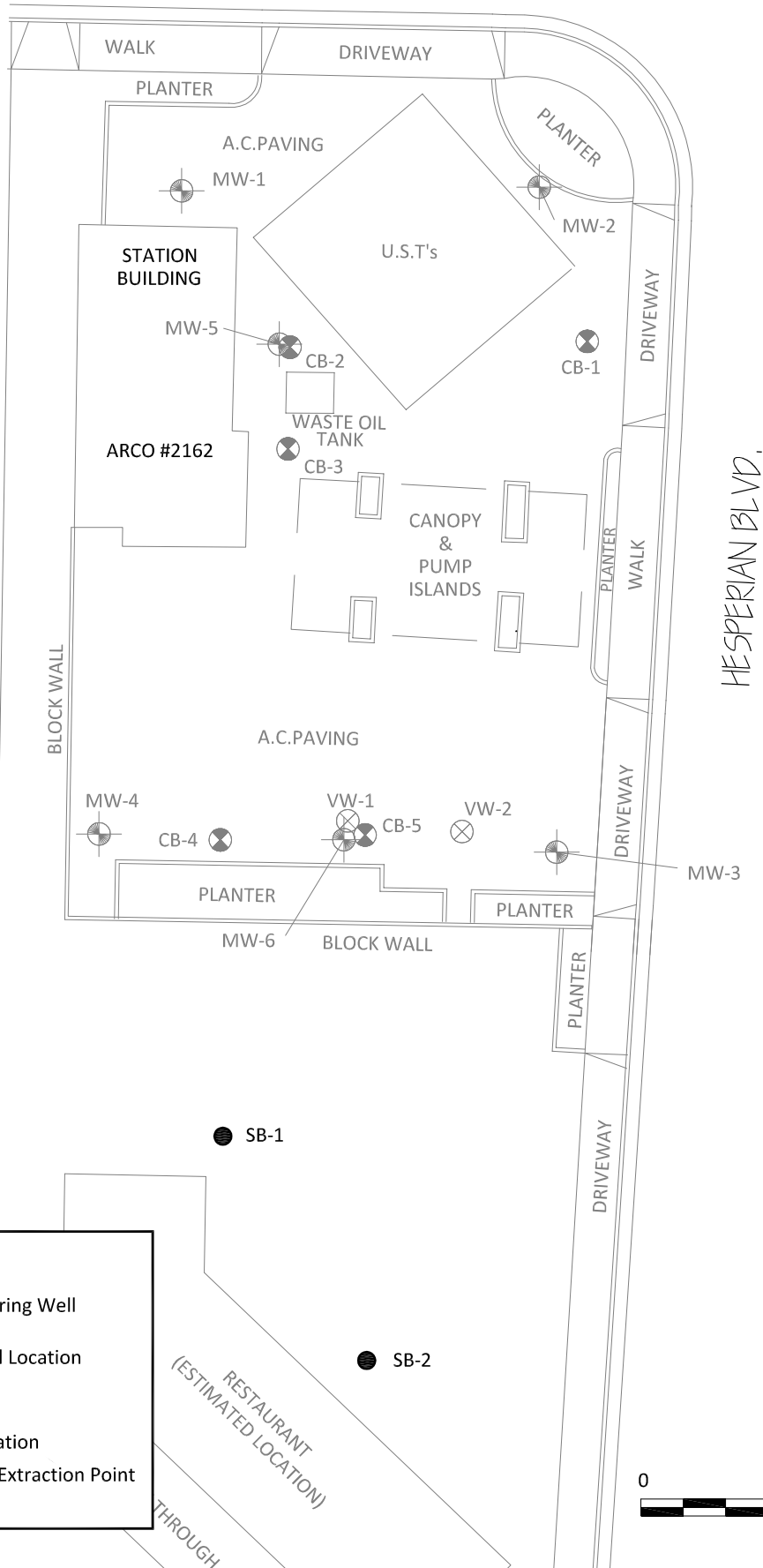

LEGEND

- Groundwater Monitoring Well Location
- Vapor Extraction Well Location
- Soil Boring Location
- Proposed Boring Location
- Proposed Soil Vapor Extraction Point Location

