

**RECEIVED**

By Alameda County Environmental Health at 9:57 am, Oct 21, 2014

## Atlantic Richfield Company

**Chuck Carmel**

Remediation Management Project Manager

PO Box 1257  
San Ramon, CA 94583  
Phone: (925) 275-3804  
Fax: (925) 275-3815  
E-Mail: chuck.carmel@bp.com

October 15, 2014

Re: Third Quarter 2014 Status Report  
Atlantic Richfield Company Station #2162  
15135 Hesperian Boulevard, San Leandro, California  
ACEH Case #RO0000190

I declare that to the best of my knowledge at the present time, that the information and/or recommendations contained in the attached document are true and correct.

Submitted by,



Chuck Carmel  
Remediation Management Project Manager

Attachment



4820 Business Center Drive, Suite 110  
Fairfield, CA 94534  
[T] 707-455-7290 [F] 707-863-9046  
broadbentinc.com

***Creating Solutions. Building Trust.***

October 15, 2014

Project No. 06-88-620

Atlantic Richfield Company  
P.O. Box 1257  
San Ramon, CA 94583  
Submitted via ENFOS

Attn.: Mr. Chuck Carmel

Re: Third Quarter 2014 Status Report, Atlantic Richfield Company Station No. 2162,  
15135 Hesperian Boulevard, San Leandro, California; ACEH Case #RO0000190

Dear Mr. Carmel:

Attached is the Third Quarter 2014 Status Report for Atlantic Richfield Company Station No. 2162 located at 15135 Hesperian Boulevard in San Leandro, California. This report presents a summary of current developments at the Site through the Third Quarter 2014.

Should you have questions regarding this submittal, please do not hesitate to contact us at (707) 455-7290.

Sincerely,  
BROADBENT & ASSOCIATES, INC.

Kristene Tidwell, P.G., CHG  
Associate Hydrogeologist

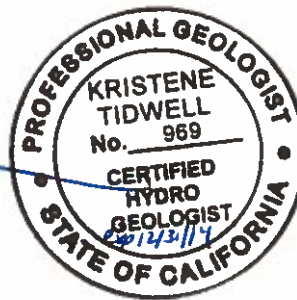

Enclosures

cc: Ms. Dilan Roe, P.E., Alameda County Environmental Health (submitted via ACEH ftp site)  
Electronic copy uploaded to GeoTracker

**THIRD QUARTER 2014  
STATUS REPORT  
ARCO STATION No. 2162, SAN LEANDRO, CALIFORNIA**

Broadbent & Associates, Inc. (Broadbent) is pleased to present this *Third Quarter 2014 Status Report* on behalf of Atlantic Richfield Company (a BP affiliated company) for ARCO Station No. 2162 located at 15135 Hesperian Boulevard in San Leandro, Alameda County, California. Quarterly reporting is being submitted to the Alameda County Environmental Health Services Agency (ACEH) consistent with their requirements under the legal authority of the California Regional Water Quality Control Board as codified by California Code of Regulations Title 23, Section 2652(d). A summary description of current developments regarding the site is provided below.

Facility Name / Address:	ARCO Station No. 2162 / 15135 Hesperian Boulevard, San Leandro
Client Project Manager / Title:	Mr. Chuck Carmel / Remediation Management Project Manager
Broadbent Contact:	Ms. Kristene Tidwell, PG, CHG / 707-455-7290
Broadbent Project No.:	06-88-620
Primary Regulatory Agency / ID No.:	ACEH, Case #RO0000190
Current phase of project:	Pending Closure – Public Comment Period
List of Acronyms / Abbreviations:	ACEH: Alameda County Environmental Health ARCO: Atlantic Richfield Company KFC: Kentucky Fried Chicken

**WORK PERFORMED THIS QUARTER (Third Quarter 2014):**

1. Submitted *Second Quarter 2014 Monitoring Report* on July 28, 2014.
2. Participated in two meetings with Alameda County Environmental Health to discuss site closure activities on June 6, 2014 and July 31, 2014.
3. No environmental field work was conducted at ARCO Station No. 2162 during the Third Quarter 2014.

**WORK SCHEDULED FOR NEXT QUARTER (Fourth Quarter 2014):**

1. Submit *Third Quarter 2014 Status Report* (contained herein).
2. One of the following:
  - a) Submit a *Well Destruction Plan* after the Public Comment Period ends on October 27, 2014, or
  - b) Conduct Groundwater Monitoring and Sampling Activities for Fourth Quarter 2014.

**DISCUSSION:**

No groundwater monitoring and sampling work activities took place at ARCO Station No. 2162 during Third Quarter 2014. The most recent groundwater monitoring/sampling occurred during the First Quarter 2014, the results of which are contained within the Q2 GWM Report. Upon concurrence from the ACEH, Groundwater Monitoring and Sampling Activities will cease for Fourth Quarter 2014 and a *Well Destruction Plan* will be submitted for review. A Site Location Map is provided as Drawing 1. A Site Map with groundwater elevation contours is provided as Drawing 2. A Site Map with MTBE isoconcentration contours is provided as Drawing 3.

**ATTACHMENTS:**

- Drawing 1: Site Location Map  
Drawing 2: Groundwater Elevation Contours and Analytical Summary Map  
Drawing 3: MTBE Isoconcentration Contours and Analytical Summary Map



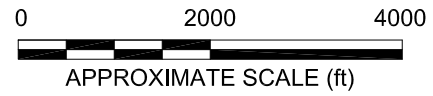
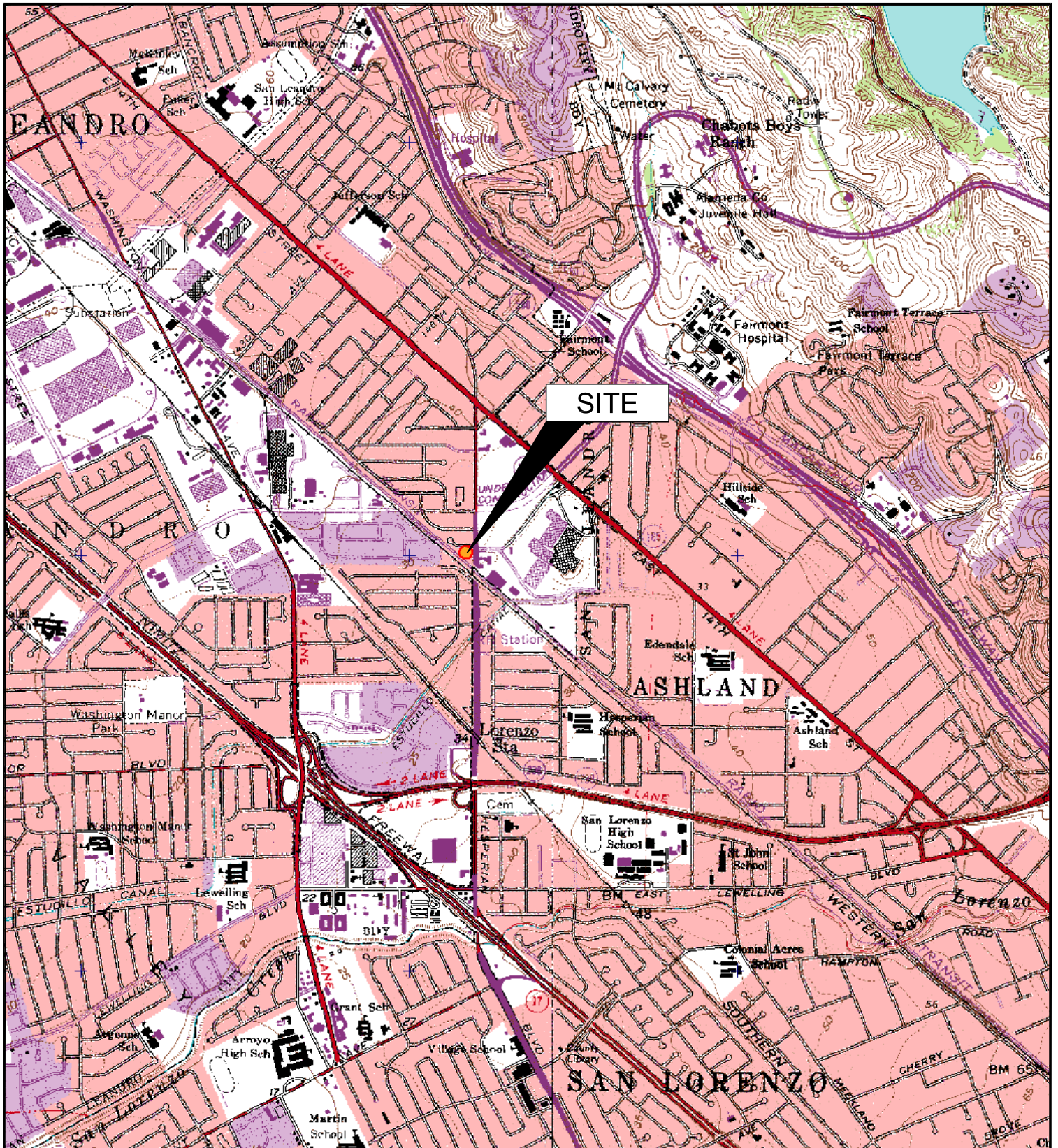

IMAGE SOURCE: USGS

**BROADBENT & ASSOCIATES, INC**  
ENGINEERING, WATER RESOURCES & ENVIRONMENTAL  
1324 Mangrove Ave. Suite 212, Chico, CA 95926  
Project No.: 06-88-620 Date: 07/27/09

Station #2162  
15135 Hesperian Boulevard  
San Leandro, California

Site Location Map

Drawing  
**1**

# RUTH COURT

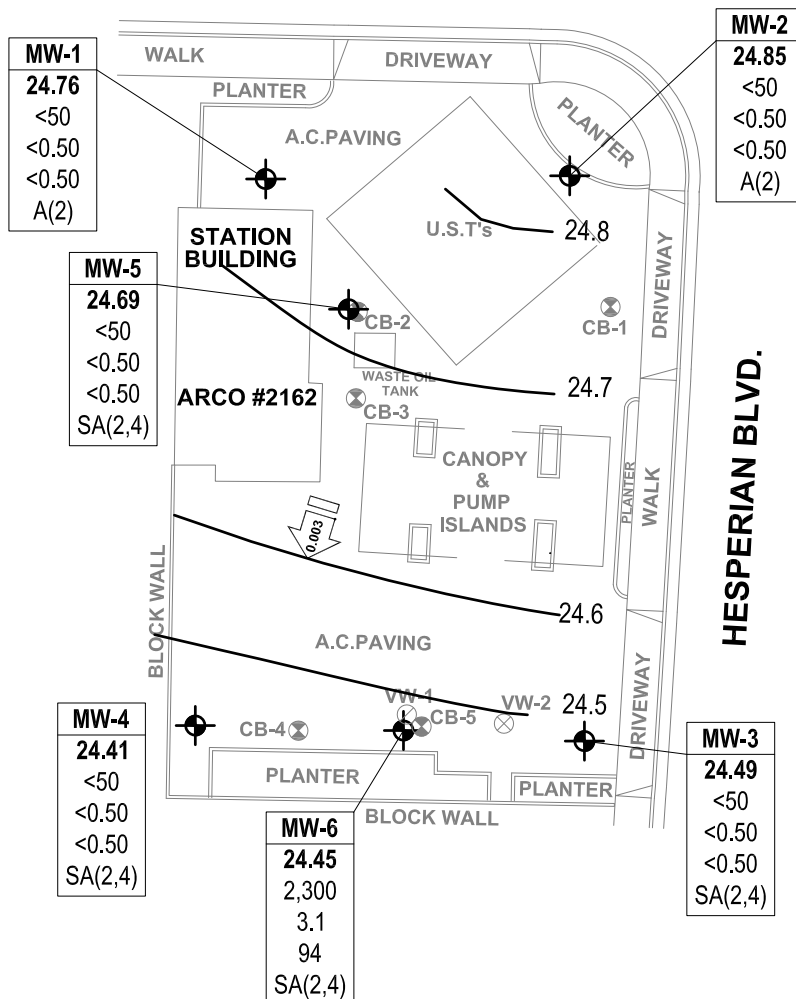

## LEGEND

- GROUNDWATER MONITORING WELL
- VAPOR EXTRACTION WELL
- SOIL BORING
- 25.1 GROUNDWATER ELEVATION CONTOUR (FEET ABOVE DATUM)
- APPROXIMATE GROUNDWATER FLOW DIRECTION AND GRADIENT (FT/FT)

- | Well    | WELL DESIGNATION                          |
|---------|---|
| ELEV    | GROUNDWATER ELEVATION (FEET)              |
| GRO     | GRO. BENZENE & MTBE CONCENTRATIONS (µg/L) |
| Benzene |   |
| MTBE    |   |
| A/Q/SA  | SAMPLING FREQUENCY                        |
- < NOT DETECTED AT OR ABOVE LABORATORY REPORTING LIMITS
  - \* DATA NOT USED FOR CONTOURING
  - SA SAMPLED SEMI-ANNUALLY

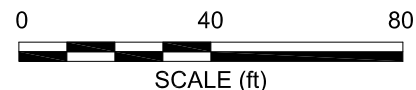

NOTE: SITE MAP ADAPTED FROM WOOD RODGERS SURVYING.