

IESPERIAN BOULEVARD

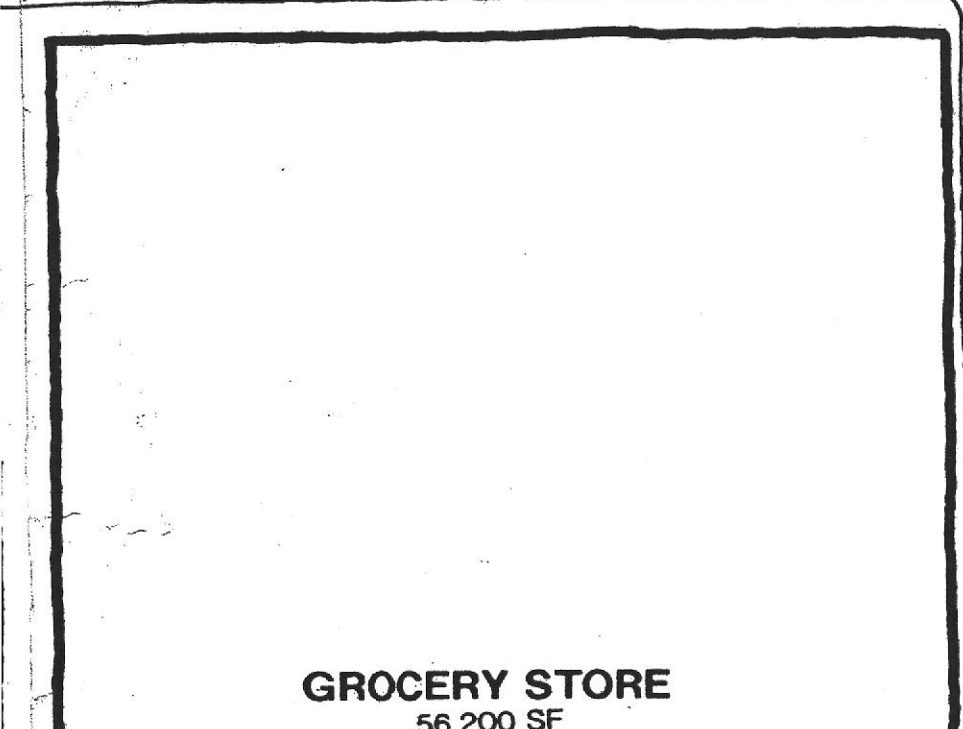

GROCERY STORE
56,200 SF

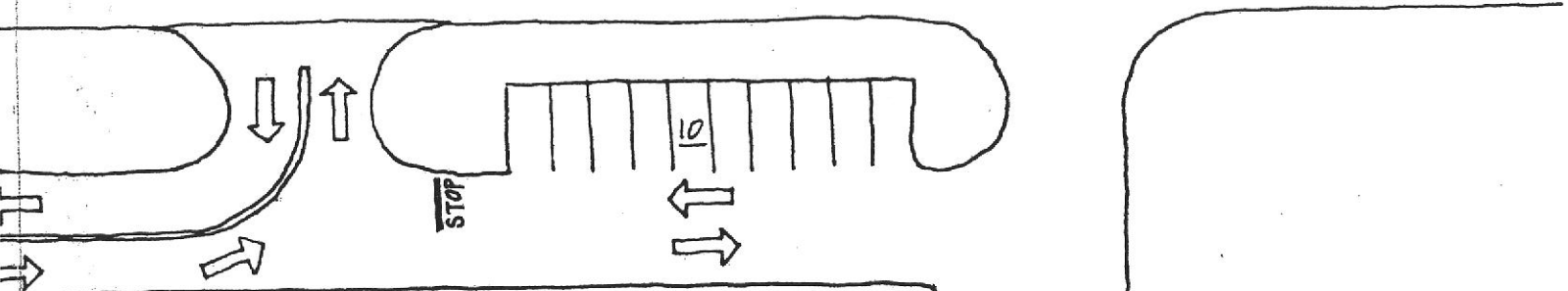

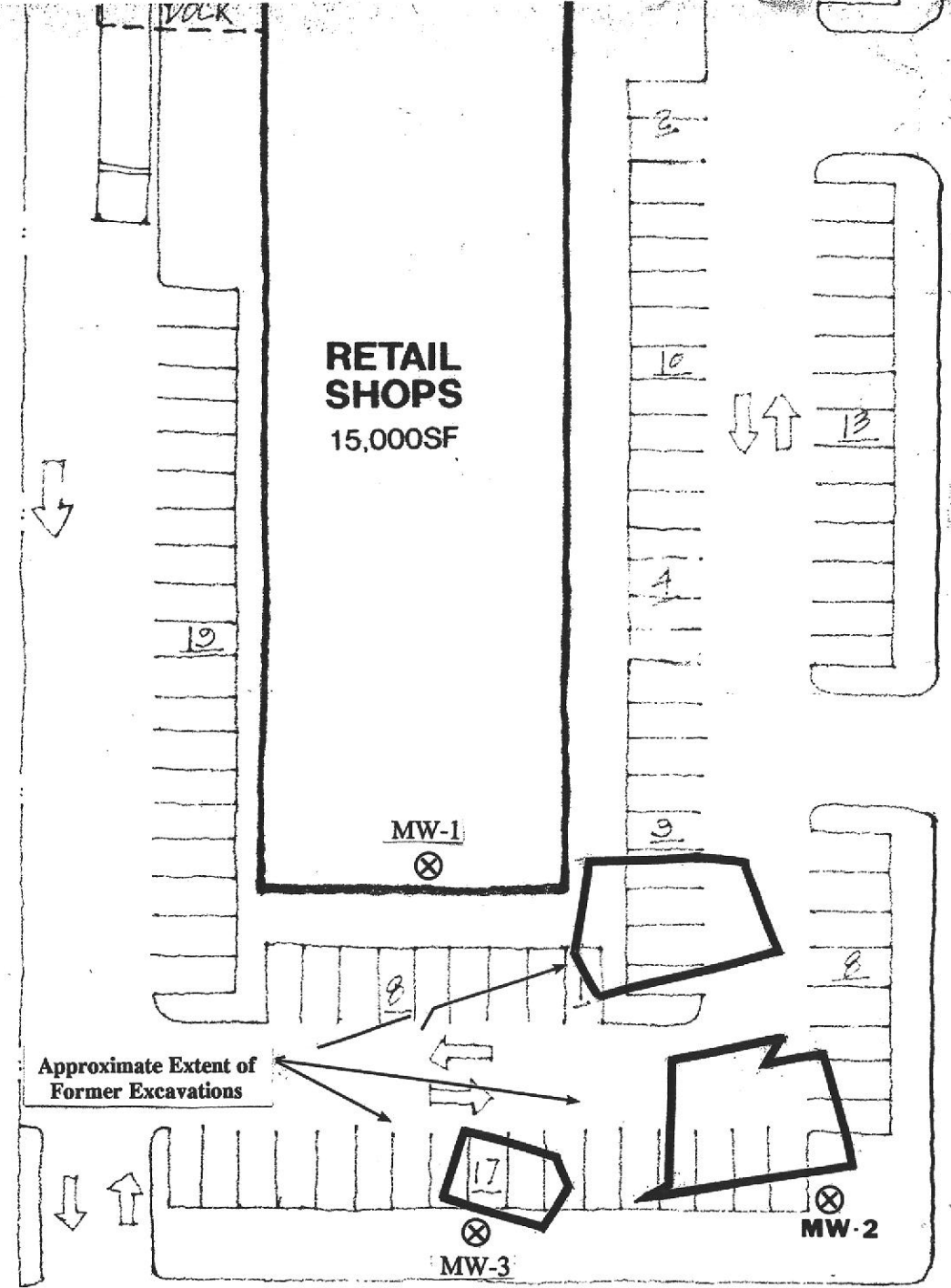

PASEO GRA

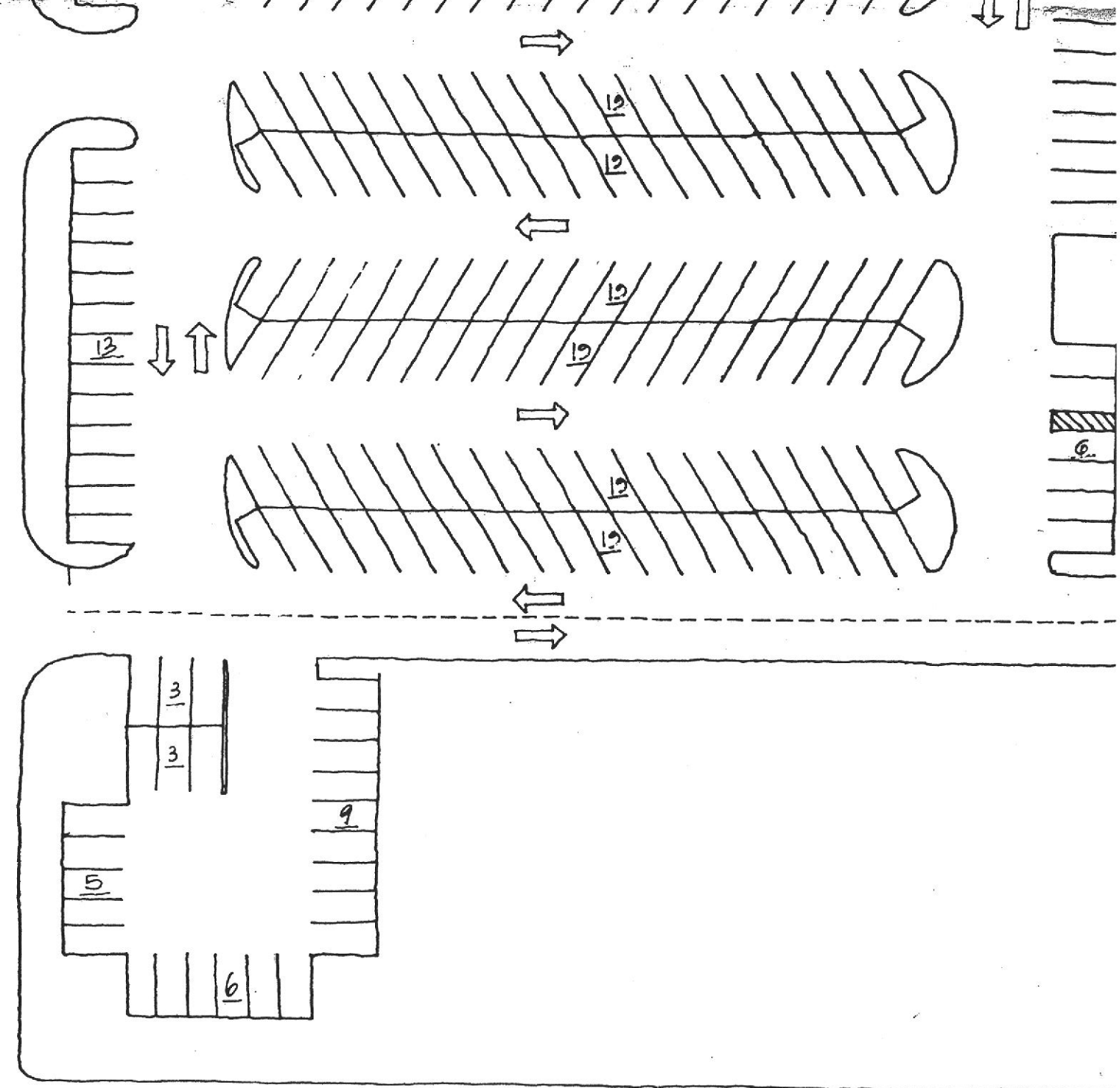

SECOR
International Incorporated

Attachment 1

SAN LOREI

97 JUN 25 AM 11:00

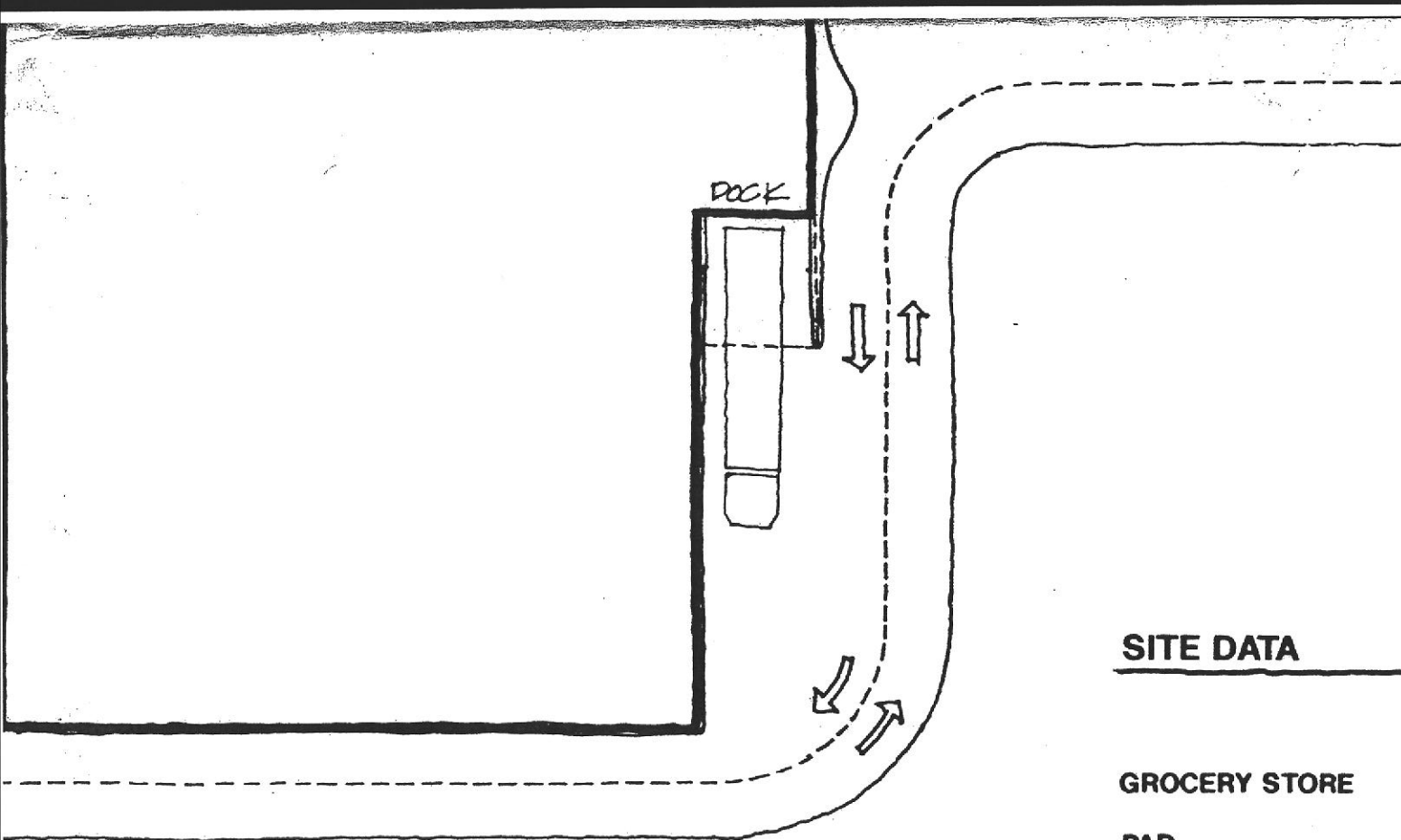

SITE DATA

	FLOOR AREA	PARKING	PARKING RATIO
GROCERY STORE	56,200 SF		
PAD	3,000 SF		
TOTAL	59,200 SF	342 SPACES	5.77 SPACES/1000SF
PHARMACY	16,200 SF		
RETAIL SHOPS	15,000 SF		
TOTAL	31,200 SF	144 SPACES (INCLUDES 19 SPACES AT REAR)	4.61 SPACES/1000SF
		125 SPACES (EXCLUDES 19 SPACES AT REAR)	4.00 SPACES/1000SF

SITE PLAN 

SCALE: 1"=40'-0"

ZO VILLAGE