



Atlantic Richfield Company
(a BP affiliated company)

P.O. Box 6549
Moraga, California 94570
Phone: (925) 299-8891
Fax: (925) 299-8872



RECEIVED
By loprojectop at 11:19 am, Apr 17, 2006

March 31, 2006

Re: ARCO Service Station # 6002
6235 Seminary Avenue
Oakland, California
First Quarter 2006 Groundwater Monitoring Report
ACEH Case # 3942

"I declare, that to the best of my knowledge at the present time, that the information and/or recommendations contained in the attached document are true and correct.

Submitted by:

Paul Supple
Environmental Business Manager



March 31, 2006

Mr. Don Hwang
Alameda County Environmental Health (ACEH)
1131 Harbor Bay Parkway, Suite 250
Alameda, California 94502-6577

**Re: First Quarter 2006 Groundwater Monitoring Report
Former ARCO Service Station #6002
6235 Seminary Avenue
Oakland, California
ACEH Case #3942**

Dear Mr. Hwang:

On behalf of Atlantic Richfield Company, a BP affiliated company, URS Corporation (URS) is submitting the *First Quarter 2006 Groundwater Monitoring Report* for the Former ARCO Service Station #6002, located at 6235 Seminary Avenue, Oakland, California.

If you have any questions regarding this submission, please call (510) 874-3296.

Sincerely,

URS CORPORATION

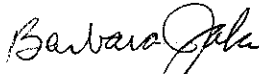
Barbara Jakub, P.G.
Project Manager

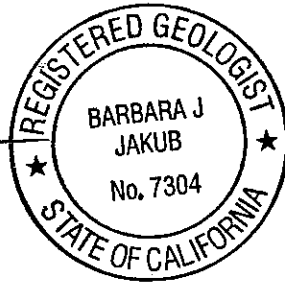

Enclosure: First Quarter 2006 Groundwater Monitoring Report

cc: Mr. Paul Supple, Atlantic Richfield Company (RM), electronic copy uploaded to ENFOS
Mr. Rob Miller, Broadbent & Associates, Inc., electronic copy uploaded to ENFOS

REPORT

RECEIVED

By loprojectop at 11:19 am, Apr 17, 2006

FIRST QUARTER 2006 GROUNDWATER MONITORING REPORT

FORMER ARCO SERVICE STATION #6002
6235 SEMINARY AVENUE
OAKLAND, CALIFORNIA

Prepared for
RM

March 31, 2006

URS

URS Corporation
1333 Broadway, Suite 800
Oakland, California 94612

Date: March 31, 2006
 Quarter: 1Q 06

FIRST QUARTER 2006 GROUNDWATER MONITORING REPORT

Former Facility No.: 6002 Address: 6235 Seminary Avenue, Oakland, California
 RM Environmental Business Manager: Paul Supple
 Consulting Co./Contact Person: URS Corporation / Barbara Jakub
 Primary Agency Alameda County Environmental Health (ACEH)
 ACEH Case #: 3942

WORK PERFORMED THIS QUARTER (First – 2006):

1. Prepared and submitted the Fourth Quarter 2005 Groundwater Monitoring Report.
2. Performed the first quarter 2006 groundwater monitoring event on February 15, 2006.
3. Prepared and submitted this First Quarter 2006 Groundwater Monitoring Report.

WORK PROPOSED FOR NEXT QUARTER (Second – 2006):

1. Perform the second quarter 2006 groundwater monitoring event.
2. Prepare and submit the Second Quarter 2006 Groundwater Monitoring Report.

SITE SUMMARY:

Current Phase of Project:	<u>GW monitoring/sampling</u>
Frequency of Groundwater Sampling:	<u>Quarterly: MW-5, VW-1 and VW-4</u> <u>Annually (3rd quarter): MW-3, MW-4, MW-6, MW-7 and MW-8</u>
Frequency of Groundwater Monitoring:	<u>Quarterly</u>
Is Free Product Present On-Site:	<u>None</u>
Bulk Soil Removed to Date:	<u>Approximately 370 cubic yards of TPH impacted soil</u>
Current Remediation Techniques:	<u>None</u>
Approximate Depth to Groundwater:	<u>7.16 (VW-1) to 10.77 (MW-5) feet</u>
Groundwater Gradient (direction):	<u>Southwest</u>
Groundwater Gradient (magnitude):	<u>0.07 feet per foot</u>

DISCUSSION:

Gasoline range organics were detected at or above the laboratory reporting limit in two of the three wells sampled this quarter at concentrations of 64 micrograms per liter (µg/L) (VW-4) and 790 µg/L (MW-5). Ethylbenzene was detected at or above the laboratory reporting limits in one well (MW-5) at a concentration of 1.2 µg/L. Methyl tert-butyl ether was detected at or above the laboratory reporting limit in two wells at concentrations of 2.8 µg/L (VW-1) and 11 µg/L (VW-4). Tert-butyl alcohol was detected at or above the laboratory reporting limit in one well (VW-4) at a concentration of 230 µg/L. No other fuel components were detected at or above their respective laboratory reporting limits in any wells sampled this quarter.

ATTACHMENTS:

- Figure 1 – Groundwater Elevation Contour and Analytical Summary Map – February 15, 2006
- Table 1 – Groundwater Elevation and Analytical Data
- Table 2 – Fuel Additives Analytical Data
- Table 3 – Groundwater Gradient Data
- Attachment A – Field Procedures and Field Data Sheets
- Attachment B – Laboratory Procedures, Certified Analytical Reports, and Chain-of-Custody Records
- Attachment C – Error Check Reports and EDF/Geowell Submittal Confirmations

Mar 09, 2006 - 2:06pm
 X:\x_emv\wase\BP_CEM\Sites\Scott_Robinson\Paul_Supple\0002\Monitoring\2006 Q1\Drawings\6002-1006-GW.dwg

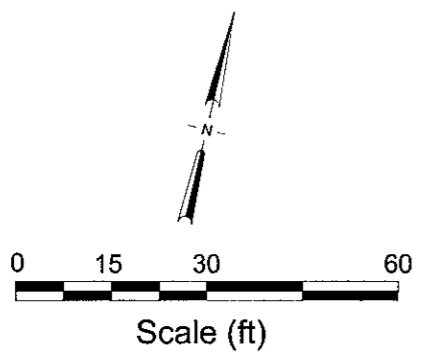
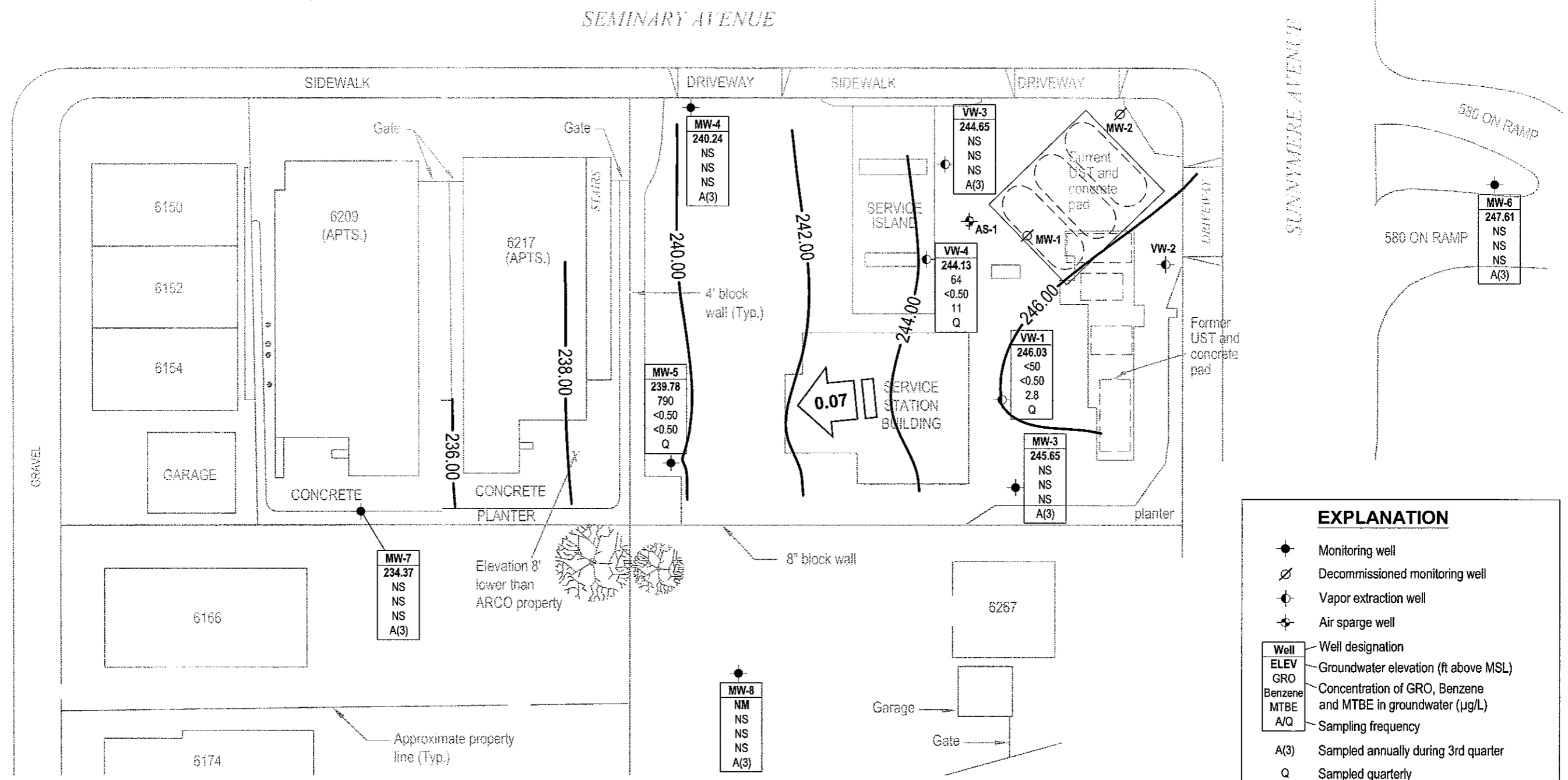

EXPLANATION	
	Monitoring well
	Decommissioned monitoring well
	Vapor extraction well
	Air sparge well
Well	Well designation
ELEV	Groundwater elevation (ft above MSL)
GRO	Concentration of GRO, Benzene and MTBE in groundwater (µg/L)
MTBE	
A/Q	Sampling frequency
A(3)	Sampled annually during 3rd quarter
Q	Sampled quarterly
NM	Not measured
NS	Not sampled
<	Not detected at or above laboratory reporting limits
— 244.00	Groundwater elevation contour (ft above MSL)
	Approximate groundwater flow direction and gradient (ft/ft)

NOTE: SITE MAP ADAPTED FROM CAMBRIA ENVIRONMENTAL FIGURES. SITE DIMESIONS AND FACILITY LOCATIONS NOT VERIFIED.

URS	Project No. 38487564	GROUNDWATER ELEVATION CONTOUR AND ANALYTICAL SUMMARY MAP	FIGURE 1
	Former ARCO Service Station #6002 6235 Seminary Avenue Oakland, California		

Table 1

Groundwater Elevation and Analytical Data

Former ARCO Service Station #6002

6235 Seminary Ave., Oakland, CA

Well No.	Date	P/ NP	Notes	TOC (ft MSL)	Top of Screen (ft bgs)	Bottom of Screen (ft bgs)	DTW (ft bgs)	Product Thickness (feet)	GWE (ft MSL)	GRO/ TPH-g (µg/L)	Benzene (µg/L)	Toluene (µg/L)	Ethylbenzene (µg/L)	Total Xylenes (µg/L)	MTBE (µg/L)	DO (mg/L)	pH
AS-1	6/29/1995	--		--	20.00	22.00	9.20	--	--	<50	1.6	<0.5	0.9	0.9	--	--	--
MW-1	3/15/1995	--		247.06	4.50	24.50	7.37	--	239.69	13,000	1,200	44	770	1,100	--	--	--
	5/30/1995	--		247.06	4.50	24.50	8.48	--	238.58	19,000	1,600	30	890	1,400	--	--	--
	9/1/1995	--		247.06	4.50	24.50	9.47	--	237.59	14,000	1,300	28	480	780	24,000	--	--
	11/13/1995	--	a, b	247.06	4.50	24.50	8.78	0.01	238.29	11,000	570	17	260	410	25,000	--	--
	2/23/1996	--	d	247.06	4.50	24.50	--	--	--	--	--	--	--	--	--	--	--
MW-2	3/15/1995	--		249.3	5.00	17.50	8.25	--	241.05	<50	<0.5	<0.5	<0.5	<0.5	--	--	--
	5/30/1995	--		249.3	5.00	17.50	9.93	--	239.37	<50	<0.5	<0.5	<0.5	<0.5	--	--	--
	9/1/1995	--		249.3	5.00	17.50	10.69	--	238.61	<50	<0.5	<0.5	<0.5	<0.5	<3	--	--
	11/13/1995	--		249.3	5.00	17.50	10.32	--	238.98	<50	<0.5	<0.5	<0.5	<0.5	--	--	--
	2/23/1996	--	d	249.3	5.00	17.50	--	--	--	--	--	--	--	--	--	--	--
MW-3	3/15/1995	--		248.35	5.00	24.50	6.76	--	241.59	<50	<0.5	<0.5	<0.5	<0.5	--	--	--
	5/30/1995	--		248.35	5.00	24.50	7.81	--	240.54	<50	<0.5	<0.5	<0.5	<0.5	--	--	--
	9/1/1995	--		248.35	5.00	24.50	8.65	--	239.70	<50	<0.5	<0.5	<0.5	<0.5	<3	--	--
	11/13/1995	--		248.35	5.00	24.50	8.25	--	240.10	120	45	0.7	<0.5	6.2	--	--	--
	2/23/1996	--		248.35	5.00	24.50	6.64	--	241.71	<50	<0.5	<0.5	0.6	1.9	<3	--	--
	5/10/1996	--		248.35	5.00	24.50	7.95	--	240.40	--	--	--	--	--	--	--	--
	8/9/1996	--		248.35	5.00	24.50	8.06	--	240.29	--	--	--	--	--	--	--	--
	11/8/1996	--	e	248.35	5.00	24.50	--	--	--	--	--	--	--	--	--	--	--
	3/21/1997	--		248.35	5.00	24.50	8.21	--	240.14	<50	<0.5	<0.5	<0.5	<0.5	<3	--	--
	5/27/1997	--		248.35	5.00	24.50	8.25	--	240.10	--	--	--	--	--	--	--	--
	8/5/1997	--		248.35	5.00	24.50	8.29	--	240.06	--	--	--	--	--	--	--	--
	10/29/1997	--		248.35	5.00	24.50	8.58	--	239.77	<50	<0.5	<0.5	<0.5	<0.5	<3	--	--
	2/25/1998	--		248.35	5.00	24.50	7.69	--	240.66	<50	<0.5	<0.5	<0.5	<0.5	<3	--	--
	5/12/1998	--		248.35	5.00	24.50	8.20	--	240.15	--	--	--	--	--	--	--	--
	7/28/1998	--		248.35	5.00	24.50	8.55	--	239.80	--	--	--	--	--	--	--	--
	10/27/1998	--		248.35	5.00	24.50	8.30	--	240.05	--	--	--	--	--	--	--	--
	2/8/1999	--		248.35	5.00	24.50	7.90	--	240.45	<50	<0.5	<0.5	<0.5	<0.5	<3	--	--
	6/1/1999	--		248.35	5.00	24.50	8.40	--	239.95	--	--	--	--	--	--	--	--
	8/25/1999	--		248.35	5.00	24.50	8.49	--	239.86	--	--	--	--	--	--	1.67	--
	10/29/1999	--		248.35	5.00	24.50	8.52	--	239.83	--	--	--	--	--	--	6.9	--
	2/16/2000	NP		248.35	5.00	24.50	8.03	--	240.32	<50	<0.5	0.8	<0.5	<1	<3	8.51	--

Table 1
Groundwater Elevation and Analytical Data
Former ARCO Service Station #6002
6235 Seminary Ave., Oakland, CA

Well No.	Date	P/ NP	Notes	TOC (ft MSL)	Top of Screen (ft bgs)	Bottom of Screen (ft bgs)	DTW (ft bgs)	Product Thickness (feet)	GWE (ft MSL)	GRO/TPH-g (µg/L)	Benzene (µg/L)	Toluene (µg/L)	Ethylbenzene (µg/L)	Total Xylenes (µg/L)	MTBE (µg/L)	DO (mg/L)	pH
MW-3	6/23/2000	--		248.35	5.00	24.50	7.55	--	240.80	--	--	--	--	--	--	2.1	--
	8/17/2000	--		248.35	5.00	24.50	8.65	--	239.70	--	--	--	--	--	--	1.1	--
	11/10/2000	--		248.35	5.00	24.50	7.19	--	241.16	--	--	--	--	--	--	--	--
	2/12/2001	NP		248.35	5.00	24.50	8.60	--	239.75	<50	<0.50	<0.50	<0.50	<0.50	<2.5	0.81	--
	4/13/2001	--		248.35	5.00	24.50	6.13	--	242.22	--	--	--	--	--	--	--	--
	7/18/2001	--		248.35	5.00	24.50	6.47	--	241.88	--	--	--	--	--	--	--	--
	10/1/2001	--		248.35	5.00	24.50	6.99	--	241.36	--	--	--	--	--	--	--	--
	1/14/2002	NP		248.35	5.00	24.50	5.47	--	242.88	<50	<0.50	<0.50	<0.50	<0.50	<5.0	--	--
	4/3/2002	--		248.35	5.00	24.50	6.95	--	241.40	--	--	--	--	--	--	--	--
	8/8/2002	--		248.35	5.00	24.50	8.78	--	239.57	--	--	--	--	--	--	--	--
	11/27/2002	--		248.35	5.00	24.50	8.52	--	239.83	--	--	--	--	--	--	--	--
	2/10/2003	NP		248.35	5.00	24.50	8.40	--	239.95	<50	<0.50	<0.50	<0.50	<0.50	<0.50	0.7	6.4
	6/3/2003	--		248.35	5.00	24.50	8.40	--	239.95	--	--	--	--	--	--	--	--
	8/14/2003	--		248.35	5.00	24.50	8.60	--	239.75	--	--	--	--	--	--	--	--
	11/13/2003	--		248.35	5.00	24.50	8.41	--	239.94	--	--	--	--	--	--	--	--
	02/13/2004	--		253.88	5.00	24.50	8.40	--	245.48	--	--	--	--	--	--	--	--
	05/05/2004	--		253.88	5.00	24.50	8.28	--	245.60	--	--	--	--	--	--	--	--
	08/30/2004	NP		253.88	5.00	24.50	10.32	--	243.56	<50	<0.50	<0.50	<0.50	<0.50	0.72	1.4	6.4
	11/08/2004	--		253.88	5.00	24.50	8.12	--	245.76	--	--	--	--	--	--	--	--
	02/07/2005	--		253.88	5.00	24.50	8.20	--	245.68	--	--	--	--	--	--	--	--
	05/09/2005	--		253.88	5.00	24.50	8.23	--	245.65	--	--	--	--	--	--	--	--
	08/11/2005	NP		253.88	5.00	24.50	8.72	--	245.16	<50	<0.50	<0.50	<0.50	<0.50	0.73	1.6	6.1
	12/02/2005	--		253.88	5.00	24.50	8.15	--	245.73	--	--	--	--	--	--	--	--
	02/15/2006	--		253.88	5.00	24.50	8.23	--	245.65	--	--	--	--	--	--	--	--
MW-4	3/15/1995	--		242.91	4.50	24.50	9.37	--	233.54	<50	<0.5	<0.5	<0.5	<0.5	--	--	--
	5/30/1995	--		242.91	4.50	24.50	11.47	--	231.44	<50	<0.5	<0.5	<0.5	<0.5	--	--	--
	9/1/1995	--		242.91	4.50	24.50	12.28	--	230.63	78	<0.5	0.7	<0.5	<0.5	<3	--	--
	11/13/1995	--		242.91	4.50	24.50	11.75	--	231.16	<50	<0.5	<0.5	<0.5	<0.5	--	--	--
	2/23/1996	--		242.91	4.50	24.50	8.51	--	234.40	59	1.2	7.4	1.6	9.3	3	--	--
	5/10/1996	--		242.91	4.50	24.50	11.35	--	231.56	<50	<0.5	<0.5	<0.5	<0.5	<3	--	--
	8/9/1996	--		242.91	4.50	24.50	9.70	--	233.21	<50	<0.5	<0.5	<0.5	<0.5	<3	--	--
	11/8/1996	--		242.91	4.50	24.50	11.79	--	231.12	<50	<0.5	<0.5	<0.5	<0.5	<3	--	--
	3/21/1997	--		242.91	4.50	24.50	10.94	--	231.97	<50	<0.5	<0.5	<0.5	<0.5	81	--	--

Table 1
Groundwater Elevation and Analytical Data
Former ARCO Service Station #6002
6235 Seminary Ave., Oakland, CA

Well No.	Date	P/ NP	Notes	TOC (ft MSL)	Top of Screen (ft bgs)	Bottom of Screen (ft bgs)	DTW (ft bgs)	Product Thickness (feet)	GWE (ft MSL)	GRO/ TPH-g (µg/L)	Benzene (µg/L)	Toluene (µg/L)	Ethylbenzene (µg/L)	Total Xylenes (µg/L)	MTBE (µg/L)	DO (mg/L)	pH
MW-4	5/27/1997	--		242.91	4.50	24.50	11.51	--	231.40	<50	<0.5	<0.5	<0.5	<0.5	<3	--	--
	8/5/1997	--		242.91	4.50	24.50	11.90	--	231.01	<50	<0.5	<0.5	<0.5	<0.5	<3	--	--
	10/29/1997	--		242.91	4.50	24.50	12.00	--	230.91	<50	<0.5	<0.5	<0.5	<0.5	<3	--	--
	2/25/1998	--		242.91	4.50	24.50	8.34	--	234.57	<50	<0.5	0.9	<0.5	0.9	4	--	--
	5/12/1998	--		242.91	4.50	24.50	10.93	--	231.98	<50	<0.5	<0.5	<0.5	<0.5	<3	--	--
	7/28/1998	--		242.91	4.50	24.50	12.08	--	230.83	<50	<0.5	<0.5	<0.5	<0.5	<3	--	--
	10/27/1998	--		242.91	4.50	24.50	11.40	--	231.51	<5,000	<50	<50	160	64	6,400	--	--
	2/8/1999	--		242.91	4.50	24.50	8.40	--	234.51	<50	<0.5	<0.5	<0.5	<0.5	<3	--	--
	6/1/1999	NP		242.91	4.50	24.50	11.93	--	230.98	<50	<0.5	<0.5	<0.5	<0.5	<3	4	6.26
	8/25/1999	NP		242.91	4.50	24.50	12.21	--	230.70	<50	<0.5	<0.5	<0.5	<0.5	<3	1.29	6.34
	10/29/1999	NP		242.91	4.50	24.50	12.37	--	230.54	<50	<0.5	<0.5	<0.5	<1	<3	1.5	5.60
	2/16/2000	NP		242.91	4.50	24.50	7.45	--	235.46	<50	<0.5	<0.5	<0.5	<1	<3	2.38	--
	6/23/2000	NP		242.91	4.50	24.50	12.31	--	230.60	<50	<0.50	<0.50	<0.50	<0.50	<2.50	2.8	--
	8/17/2000	--	f	242.91	4.50	24.50	--	--	--	<50	<0.50	<0.50	<0.50	<0.50	<2.50	--	--
	8/17/2000	NP		242.91	4.50	24.50	11.92	--	230.99	<50	<0.50	<0.50	<0.50	<0.50	<2.50	2.38	--
	11/10/2000	NP		242.91	4.50	24.50	10.80	--	232.11	<50	<0.50	<0.50	<0.50	<0.50	<2.50	1.55	--
	2/12/2001	NP		242.91	4.50	24.50	11.65	--	231.26	<50	<0.50	<0.50	<0.50	<0.50	<2.50	1.12	--
	4/13/2001	--	f	242.91	4.50	24.50	--	--	--	<50	<0.50	<0.50	<0.50	<0.50	<2.50	--	--
	4/13/2001	NP		242.91	4.50	24.50	8.17	--	234.74	<50	<0.50	<0.50	<0.50	<0.50	<2.50	--	--
	7/18/2001	NP		242.91	4.50	24.50	8.51	--	234.40	<50	<0.50	<0.50	<0.50	<0.50	<2.5	--	--
	10/1/2001	NP		242.91	4.50	24.50	8.71	--	234.20	<50	<0.50	<0.50	<0.50	<0.50	<2.5	--	--
	1/14/2002	--	f	242.91	4.50	24.50	--	--	--	<50	<0.50	<0.50	<0.50	<0.50	<5.0	--	--
	1/14/2002	NP		242.91	4.50	24.50	7.13	--	235.78	<50	<0.50	<0.50	<0.50	<0.50	<5.0	--	--
	4/3/2002	NP		242.91	4.50	24.50	10.10	--	232.81	<50	<0.50	<0.50	<0.50	<0.50	<2.5	--	--
	8/8/2002	NP		242.91	4.50	24.50	12.64	--	230.27	<50	<0.50	<0.50	<0.50	<0.50	<2.5	2.4	8.1
	11/27/2002	NP		242.91	4.50	24.50	12.01	--	230.90	<50	<0.50	<0.50	<0.50	<0.50	4.7	2.5	6.5
	2/10/2003	NP		242.91	4.50	24.50	11.22	--	231.69	<50	<0.50	<0.50	<0.50	<0.50	<0.50	0.8	6.6
	6/3/2003	--		242.91	4.50	24.50	11.54	--	231.37	<50	<0.50	<0.50	<0.50	<0.50	<0.50	3.9	6
	8/14/2003	--		242.91	4.50	24.50	12.41	--	230.50	<50	<0.50	<0.50	<0.50	<0.50	<0.50	1.8	6.3
	11/13/2003	--		242.91	4.50	24.50	11.64	--	231.27	--	--	--	--	--	--	--	--
	02/13/2004	--		248.62	4.50	24.50	10.28	--	238.34	--	--	--	--	--	--	--	--
	05/05/2004	--		248.62	4.50	24.50	12.04	--	236.58	--	--	--	--	--	--	--	--
	08/30/2004	NP		248.62	4.50	24.50	12.98	--	235.64	<50	<0.50	<0.50	<0.50	<0.50	<0.50	1.6	5.8
	11/08/2004	--		248.62	4.50	24.50	11.29	--	237.33	--	--	--	--	--	--	--	--

Table 1

Groundwater Elevation and Analytical Data

Former ARCO Service Station #6002
6235 Seminary Ave., Oakland, CA

Well No.	Date	P/ NP	Notes	TOC (ft MSL)	Top of Screen (ft bgs)	Bottom of Screen (ft bgs)	DTW (ft bgs)	Product Thickness (feet)	GWE (ft MSL)	GRO/ TPH-g (µg/L)	Benzene (µg/L)	Toluene (µg/L)	Ethyl-benzene (µg/L)	Total Xylenes (µg/L)	MTBE (µg/L)	DO (mg/L)	pH
MW-4	02/07/2005	--		248.62	4.50	24.50	10.03	--	238.59	--	--	--	--	--	--	--	--
	05/09/2005	--		248.62	4.50	24.50	10.65	--	237.97	--	--	--	--	--	--	--	--
	08/11/2005	NP		248.62	4.50	24.50	12.68	--	235.94	<50	<0.50	<0.50	<0.50	<0.50	<0.50	1.9	6.5
	12/02/2005	--		248.62	4.50	24.50	10.35	--	238.27	--	--	--	--	--	--	--	--
	02/15/2006	--		248.62	4.50	24.50	8.38	--	240.24	--	--	--	--	--	--	--	--
MW-5	3/15/1995	--		244.82	5.00	24.50	11.99	--	232.83	21,000	870	22	1,600	1,900	--	--	--
	5/30/1995	--		244.82	5.00	24.50	12.97	--	231.85	17,000	2,100	250	1,000	520	--	--	--
	9/1/1995	--		244.82	5.00	24.50	14.03	--	230.79	19,000	1,500	25	1,600	880	8,300	--	--
	11/13/1995	--		244.82	5.00	24.50	13.65	--	231.17	21,000	1,300	22	1,400	630	--	--	--
	2/23/1996	--		244.82	5.00	24.50	11.93	--	232.89	27,000	1,300	<50	1,600	1,500	730	--	--
	5/10/1996	--		244.82	5.00	24.50	13.05	--	231.77	17,000	460	21	760	480	1,000	--	--
	8/9/1996	--		244.82	5.00	24.50	13.22	--	231.60	16,000	420	14	870	390	1,500	--	--
	11/8/1996	--	e	244.82	5.00	24.50	--	--	--	--	--	--	--	--	--	--	--
	3/21/1997	--		244.82	5.00	24.50	13.24	--	231.58	18,000	110	<50	730	1,500	1,800	--	--
	5/27/1997	--		244.82	5.00	24.50	13.10	--	231.72	21,000	86	<20	810	610	1,700	--	--
	8/5/1997	--		244.82	5.00	24.50	13.14	--	231.68	340	2.2	<0.5	15	8.8	39	--	--
	10/29/1997	--		244.82	5.00	24.50	13.03	--	231.79	19,000	130	<20	1,400	620	1,700	--	--
	2/25/1998	--		244.82	5.00	24.50	11.33	--	233.49	8,500	19	13	190	100	170	--	--
	5/12/1998	--		244.82	5.00	24.50	12.81	--	232.01	10,000	34	<10	390	220	610	--	--
	7/28/1998	--		244.82	5.00	24.50	13.12	--	231.70	15,000	68	<10	690	620	1,000	--	--
	10/27/1998	--		244.82	5.00	24.50	12.90	--	231.92	15,000	60	<10	770	400	890	--	--
	2/8/1999	--		244.82	5.00	24.50	11.08	--	233.74	8,200	23	<10	290	120	<60	--	--
	6/1/1999	NP		244.82	5.00	24.50	12.95	--	231.87	11,000	33	3.3	340	180	580	1	6.49
	8/25/1999	NP		244.82	5.00	24.50	12.99	--	231.83	9,200	26	14	420	270	1,100	0.37	7.78
	10/29/1999	NP		244.82	5.00	24.50	13.10	--	231.72	11,000	19	9.8	260	150	590	1.27	6.2
	2/16/2000	NP		244.82	5.00	24.50	8.21	--	236.61	12,000	8.1	10	340	160	130	1.42	--
	6/23/2000	NP		244.82	5.00	24.50	12.90	--	231.92	9,680	38	<20.0	212	114	930	1.4	--
	8/17/2000	NP		244.82	5.00	24.50	13.00	--	231.82	10,500	15	7.98	223	118	430	0.68	--
	11/10/2000	NP		244.82	5.00	24.50	12.50	--	232.32	7,030	19.7	<10.0	190	43.6	445	1.27	--
	2/12/2001	NP		244.82	5.00	24.50	12.81	--	232.01	8,840	33.9	<10.0	186	56.4	352	0.4	--
	4/13/2001	NP		244.82	5.00	24.50	11.31	--	233.51	9,020	54.2	43.3	137	96	297	--	--
	7/18/2001	NP		244.82	5.00	24.50	11.59	--	233.23	13,000	19	10	110	49	230	--	--
	10/1/2001	NP		244.82	5.00	24.50	11.84	--	232.98	8,500	6.9	<1.0	87	27	220	--	--

Table 1
Groundwater Elevation and Analytical Data
Former ARCO Service Station #6002
6235 Seminary Ave., Oakland, CA

Well No.	Date	P/ NP	Notes	TOC (ft MSL)	Top of Screen (ft bgs)	Bottom of Screen (ft bgs)	DTW (ft bgs)	Product Thickness (feet)	GWE (ft MSL)	GRO/TPH-g (µg/L)	Benzene (µg/L)	Toluene (µg/L)	Ethylbenzene (µg/L)	Total Xylenes (µg/L)	MTBE (µg/L)	DO (mg/L)	pH
MW-5	1/14/2002	NP		244.82	5.00	24.50	10.75	--	234.07	9,500	<20	<20	140	22	<200	--	--
	4/3/2002	NP	f	244.82	5.00	24.50	--	--	--	2,700	24	5.1	92	8.5	130	--	--
	4/3/2002	NP		244.82	5.00	24.50	12.50	--	232.32	2,400	21	<5.0	91	8.5	130	--	--
	8/8/2002	NP		244.82	5.00	24.50	12.83	--	231.99	2,000	<20	<20	48	<20	520	0.8	6.9
	11/27/2002	NP		244.82	5.00	24.50	12.79	--	232.03	2,200	<10	<10	33	<10	150	0.8	6.4
	2/10/2003	NP		244.82	5.00	24.50	12.62	--	232.20	2,600	<2.5	<2.5	47	4.2	100	0.7	6.6
	6/3/2003	--		244.82	5.00	24.50	12.41	--	232.41	2,400	<5.0	<5.0	26	<5.0	160	1.8	6.3
	8/14/2003	--	e	244.82	5.00	24.50	--	--	--	--	--	--	--	--	--	--	--
	11/13/2003	NP		244.82	5.00	24.50	12.49	--	232.33	1,900	<5.0	<5.0	13	<5.0	90	0.9	6.4
	02/13/2004	NP		250.55	5.00	24.50	12.38	--	238.17	1,400	1.4	1.9	23	3.6	90	1.1	62.8
	05/05/2004	NP		250.55	5.00	24.50	12.68	--	237.87	5,800	<2.5	<2.5	13	<2.5	130	1.1	6.3
	08/30/2004	P		250.55	5.00	24.50	12.96	--	237.59	4,100	<2.5	<2.5	<2.5	<2.5	85	--	6.4
	11/08/2004	NP		250.55	5.00	24.50	12.10	--	238.45	3,300	14	1.9	17	6.1	69	1.05	6.0
	02/07/2005	NP		250.55	5.00	24.50	12.02	--	238.53	3,500	<1.0	1.1	16	2.6	15	0.95	6.5
	05/09/2005	NP	j	250.55	5.00	24.50	11.94	--	238.61	3,400	<1.0	1.7	12	2.2	19	2.2	6.7
	08/11/2005	NP		250.55	5.00	24.50	12.77	--	237.78	5,700	<2.5	<2.5	13	<2.5	51	0.7	6.0
	12/02/2005	NP		250.55	5.00	24.50	11.83	--	238.72	3,900	<2.5	<2.5	15	8.3	13	1.41	6.9
	02/15/2006	NP		250.55	5.00	24.50	10.77	--	239.78	790	<0.50	<0.50	1.2	<0.50	<0.50	1.2	6.9
MW-6	6/29/1995	--		--	17.00	31.50	6.63	--	--	<50	<0.5	<0.5	<0.5	<0.5	--	--	--
	9/1/1995	--		--	17.00	31.50	--	--	--	--	--	--	--	--	--	--	--
	11/13/1995	--		--	17.00	31.50	7.70	--	--	<50	<0.5	<0.5	<0.5	<0.5	<3	--	--
	2/23/1996	--		--	17.00	31.50	9.82	--	--	<50	<0.5	0.8	<0.5	0.6	<3	--	--
	5/10/1996	--		--	17.00	31.50	15.25	--	--	--	--	--	--	--	--	--	--
	8/9/1996	--		252.2	17.00	31.50	11.11	--	241.09	--	--	--	--	--	--	--	--
	11/8/1996	--		252.2	17.00	31.50	9.31	--	242.89	--	--	--	--	--	--	--	--
	3/21/1997	--		252.2	17.00	31.50	9.40	--	242.80	<50	<0.5	<0.5	<0.5	<0.5	<3	--	--
	5/27/1997	--		252.2	17.00	31.50	7.08	--	245.12	--	--	--	--	--	--	--	--
	8/5/1997	--		252.2	17.00	31.50	7.12	--	245.08	--	--	--	--	--	--	--	--
	10/29/1997	--		252.2	17.00	31.50	7.42	--	244.78	<50	<0.5	<0.5	<0.5	<0.5	<3	--	--
	2/25/1998	--		252.2	17.00	31.50	10.35	--	241.85	<50	<0.5	<0.5	<0.5	<0.5	<3	--	--
	5/12/1998	--		252.2	17.00	31.50	15.83	--	236.37	--	--	--	--	--	--	--	--
	7/28/1998	--		252.2	17.00	31.50	11.84	--	240.36	--	--	--	--	--	--	--	--
	10/27/1998	--		252.2	17.00	31.50	9.73	--	242.47	--	--	--	--	--	--	--	--

Table 1
Groundwater Elevation and Analytical Data
Former ARCO Service Station #6002
6235 Seminary Ave., Oakland, CA

Well No.	Date	P/ NP	Notes	TOC (ft MSL)	Top of Screen (ft bgs)	Bottom of Screen (ft bgs)	DTW (ft bgs)	Product Thickness (feet)	GWE (ft MSL)	GRO/ TPH-g (µg/L)	Benzene (µg/L)	Toluene (µg/L)	Ethyl-benzene (µg/L)	Total Xylenes (µg/L)	MTBE (µg/L)	DO (mg/L)	pH
MW-6	2/8/1999	--		252.2	17.00	31.50	8.10	--	244.10	<50	<0.5	<0.5	<0.5	<0.5	<3	--	--
	6/1/1999	--		252.2	17.00	31.50	17.84	--	234.36	--	--	--	--	--	--	--	--
	8/25/1999	--		252.2	17.00	31.50	11.00	--	241.20	--	--	--	--	--	--	0.77	--
	10/29/1999	--		252.2	17.00	31.50	9.03	--	243.17	--	--	--	--	--	--	3.42	--
	2/16/2000	P		252.2	17.00	31.50	7.71	--	244.49	<50	<0.5	<0.5	<0.5	<1	<3	2.42	--
	6/23/2000	--		252.2	17.00	31.50	6.69	--	245.51	--	--	--	--	--	--	2.3	--
	8/17/2000	--		252.2	17.00	31.50	6.95	--	245.25	--	--	--	--	--	--	2.51	--
	11/10/2000	--		252.2	17.00	31.50	11.79	--	240.41	--	--	--	--	--	--	--	--
		--	f	--	--	--	--	--	--	--	--	--	--	--	--	--	--
	2/12/2001	P		252.2	17.00	31.50	7.35	--	244.85	<50	<0.50	<0.50	<0.50	<0.50	<2.5	1.66	7.77
	4/13/2001	--		252.2	17.00	31.50	10.52	--	241.68	--	--	--	--	--	--	--	--
	7/18/2001	--		252.2	17.00	31.50	11.03	--	241.17	--	--	--	--	--	--	--	--
	10/1/2001	--		252.2	17.00	31.50	11.31	--	240.89	--	--	--	--	--	--	--	--
	1/14/2002	P		252.2	17.00	31.50	9.87	--	242.33	<50	<0.50	<0.50	<0.50	<0.50	<5.0	--	--
	4/3/2002	--		252.2	17.00	31.50	12.19	--	240.01	--	--	--	--	--	--	--	--
	8/8/2002	--		252.2	17.00	31.50	7.04	--	245.16	--	--	--	--	--	--	--	--
	11/27/2002	--		252.2	17.00	31.50	6.85	--	245.35	--	--	--	--	--	--	--	--
	2/10/2003	NP		252.2	17.00	31.50	6.74	--	245.46	<50	<0.50	<0.50	<0.50	<0.50	<0.50	1.1	7.4
	6/3/2003	--		252.2	17.00	31.50	14.35	--	237.85	--	--	--	--	--	--	--	--
	8/14/2003	--		252.2	17.00	31.50	10.74	--	241.46	--	--	--	--	--	--	--	--
	11/13/2003	--		252.20	17.00	31.50	10.68	--	241.52	--	--	--	--	--	--	--	--
	02/13/2004	--		257.94	17.00	31.50	7.38	--	250.56	--	--	--	--	--	--	--	--
	05/05/2004	--		257.94	17.00	31.50	7.43	--	250.51	--	--	--	--	--	--	--	--
	08/30/2004	P		257.94	17.00	31.50	7.39	--	250.55	<50	<0.50	<0.50	<0.50	<0.50	<0.50	2.5	7.0
	11/08/2004	--		257.94	17.00	31.50	15.57	--	242.37	--	--	--	--	--	--	--	--
	02/07/2005	--		257.94	17.00	31.50	15.26	--	242.68	--	--	--	--	--	--	--	--
	05/09/2005	--		257.94	17.00	31.50	11.31	--	246.63	--	--	--	--	--	--	--	--
	08/11/2005	P		257.94	17.00	31.50	9.80	--	248.14	<50	<0.50	<0.50	<0.50	<0.50	<0.50	2.4	7.1
	12/02/2005	--		257.94	17.00	31.50	14.55	--	243.39	--	--	--	--	--	--	--	--
	02/15/2006	--		257.94	17.00	31.50	10.33	--	247.61	--	--	--	--	--	--	--	--
MW-7	8/9/1996	--	g	235.95	8.50	13.50	--	--	--	--	--	--	--	--	--	--	--
	11/8/1996	--	g	235.95	8.50	13.50	--	--	--	--	--	--	--	--	--	--	--
	1/27/1997	--		235.95	8.50	13.50	--	--	--	2,900	29	<5	<5	580	220	--	--

Table 1
Groundwater Elevation and Analytical Data
Former ARCO Service Station #6002
6235 Seminary Ave., Oakland, CA

Well No.	Date	P/ NP	Notes	TOC (ft MSL)	Top of Screen (ft bgs)	Bottom of Screen (ft bgs)	DTW (ft bgs)	Product Thickness (feet)	GWE (ft MSL)	GRO/ TPH-g (µg/L)	Benzene (µg/L)	Toluene (µg/L)	Ethyl-benzene (µg/L)	Total Xylenes (µg/L)	MTBE (µg/L)	DO (mg/L)	pH
MW-7	3/21/1997	--		235.95	8.50	13.50	7.13	--	228.82	590	3.5	<0.5	<0.5	1.3	90	--	--
	5/27/1997	--		235.95	8.50	13.50	9.02	--	226.93	<50	<0.5	<0.5	<0.5	<0.5	<3	--	--
	8/5/1997	--		235.95	8.50	13.50	12.33	--	223.62	110	0.5	<0.5	<0.5	0.8	81	--	--
	10/29/1997	--	g	235.95	8.50	13.50	--	--	--	--	--	--	--	--	--	--	--
	2/25/1998	--		235.95	8.50	13.50	8.04	--	227.91	<50	<0.5	0.6	<0.5	0.7	<3	--	--
	5/12/1998	--		235.95	8.50	13.50	8.88	--	227.07	<50	<0.5	<0.5	<0.5	<0.5	<3	--	--
	7/28/1998	--		235.95	8.50	13.50	10.50	--	225.45	<50	<0.5	<0.5	<0.5	<0.5	<3	--	--
	10/27/1998	--		235.95	8.50	13.50	8.75	--	227.20	<50	<0.5	<0.5	<0.5	<0.5	<3	--	--
	2/8/1999	--		235.95	8.50	13.50	9.35	--	226.60	<50	<0.5	<0.5	<0.5	<0.5	<3	--	--
	6/1/1999	NP		235.95	8.50	13.50	9.85	--	226.10	250	<0.5	0.6	<0.5	1.6	18	1	6.43
	8/25/1999	NP		235.95	8.50	13.50	11.31	--	224.64	119	<0.5	5.7	<0.5	<0.5	11	0.41	8.28
	10/29/1999	NP		235.95	8.50	13.50	9.08	--	226.87	<50	<0.5	<0.5	<0.5	<1	<3	1.29	5.82
	2/25/2000	NP		235.95	8.50	13.50	8.02	--	227.93	<50	<0.5	<0.5	<0.5	<1	38	2.1	--
	6/23/2000	NP		235.95	8.50	13.50	10.68	--	225.27	<50	<0.50	<0.50	<0.50	<0.50	14.4	1.6	--
	8/17/2000	NP		235.95	8.50	13.50	11.85	--	224.10	70	<0.500	0.678	<0.500	1.07	14.2	1.59	--
	11/10/2000	NP		235.95	8.50	13.50	9.62	--	226.33	<50	<0.50	<0.50	<0.50	<0.50	<2.5	1.09	--
	2/12/2001	NP		235.95	8.50	13.50	12.10	--	223.85	<50	<0.50	<0.50	<0.50	<0.50	<2.5	0.84	--
	4/13/2001	P		235.95	8.50	13.50	7.95	--	228.00	<50	<0.50	<0.50	<0.50	<0.50	<2.5	--	--
	7/18/2001	P		235.95	8.50	13.50	8.20	--	227.75	<50	<0.50	<0.50	<0.50	<0.50	<2.5	--	--
	10/1/2001	NP		235.95	8.50	13.50	8.59	--	227.36	<50	<0.50	<0.50	<0.50	<0.50	<2.5	--	--
	1/14/2002	P		235.95	8.50	13.50	6.93	--	229.02	<50	<0.50	<0.50	<0.50	<0.50	<5.0	--	--
	4/3/2002	P		235.95	8.50	13.50	8.31	--	227.64	<50	<0.50	<0.50	<0.50	<0.50	<2.5	--	--
	8/8/2002	P	h	235.95	8.50	13.50	12.11	--	223.84	--	--	--	--	--	--	--	--
	11/27/2002	NP	h	235.95	8.50	13.50	13.01	--	222.94	--	--	--	--	--	--	--	--
	2/10/2003	NP		235.95	8.50	13.50	10.02	--	225.93	<50	<0.50	<0.50	<0.50	<0.50	<0.50	1.5	6.7
	6/3/2003	NP		235.95	8.50	13.50	6.82	--	229.13	<50	<0.50	<0.50	<0.50	<0.50	<0.50	8.1	6.8
	8/14/2003	P		235.95	8.50	13.50	8.16	--	227.79	<50	<0.50	<0.50	<0.50	<0.50	<0.50	2.8	6.7
	11/13/2003	--		235.95	8.50	13.50	8.07	--	227.88	--	--	--	--	--	--	--	--
	02/13/2004	--		241.64	8.50	13.50	7.62	--	234.02	--	--	--	--	--	--	--	--
	05/05/2004	--		241.64	8.50	13.50	11.01	--	230.63	--	--	--	--	--	--	--	--
	08/30/2004	--	h	241.64	8.50	13.50	13.27	--	228.37	--	--	--	--	--	--	--	--
	11/08/2004	--		241.64	8.50	13.50	13.22	--	228.42	--	--	--	--	--	--	--	--
	02/07/2005	--		241.64	8.50	13.50	13.07	--	228.57	--	--	--	--	--	--	--	--
	05/09/2005	--		241.64	8.50	13.50	7.57	--	234.07	--	--	--	--	--	--	--	--

Table 1

Groundwater Elevation and Analytical Data

Former ARCO Service Station #6002

6235 Seminary Ave., Oakland, CA

Well No.	Date	P/ NP	Notes	TOC (ft MSL)	Top of Screen (ft bgs)	Bottom of Screen (ft bgs)	DTW (ft bgs)	Product Thickness (feet)	GWE (ft MSL)	GRO/ TPH-g (µg/L)	Benzene (µg/L)	Toluene (µg/L)	Ethyl-benzene (µg/L)	Total Xylenes (µg/L)	MTBE (µg/L)	DO (mg/L)	pH
MW-7	08/11/2005	NP		241.64	8.50	13.50	11.55	--	230.09	<50	<0.50	<0.50	<0.50	<0.50	<0.50	1.1	6.7
	12/02/2005	--		241.64	8.50	13.50	13.12	--	228.52	--	--	--	--	--	--	--	--
	02/15/2006	--		241.64	8.50	13.50	7.27	--	234.37	--	--	--	--	--	--	--	--
MW-8	8/9/1996	--		240.37	5.50	14.00	9.41	--	230.96	<50	<0.5	<0.5	<0.5	<0.5	<3	--	--
	11/8/1996	--		240.37	5.50	14.00	9.19	--	231.18	<50	<0.5	<0.5	<0.5	<0.5	<3	--	--
	3/21/1997	--		240.37	5.50	14.00	8.55	--	231.82	<50	<0.5	<0.5	<0.5	<0.5	<3	--	--
	5/27/1997	--		240.37	5.50	14.00	11.06	--	229.31	91	0.6	<0.5	<0.5	0.6	66	--	--
	8/5/1997	--		240.37	5.50	14.00	9.32	--	231.05	<50	<0.5	<0.5	<0.5	<0.5	<3	--	--
	10/29/1997	--		240.37	5.50	14.00	9.35	--	231.02	<50	<0.5	<0.5	<0.5	<0.5	<3	--	--
	2/25/1998	--		240.37	5.50	14.00	7.08	--	233.29	<50	<0.5	<0.5	<0.5	<0.5	<3	--	--
	5/12/1998	--		240.37	5.50	14.00	8.61	--	231.76	<50	<0.5	<0.5	<0.5	<0.5	<3	--	--
	7/28/1998	--		240.37	5.50	14.00	9.63	--	230.74	<50	<0.5	<0.5	<0.5	<0.5	4	--	--
	10/27/1998	--		240.37	5.50	14.00	9.30	--	231.07	<50	<0.5	<0.5	<0.5	<0.5	<3	--	--
	2/8/1999	--		240.37	5.50	14.00	5.56	--	234.81	<50	<0.5	<0.5	<0.5	<0.5	<3	--	--
	6/1/1999	--	e	240.37	5.50	14.00	--	--	--	--	--	--	--	--	--	--	--
	8/25/1999	--	e	240.37	5.50	14.00	--	--	--	--	--	--	--	--	--	--	--
	10/29/1999	--	e	240.37	5.50	14.00	--	--	--	--	--	--	--	--	--	--	--
	2/16/2000	--	e	240.37	5.50	14.00	--	--	--	--	--	--	--	--	--	--	--
	6/23/2000	NP		240.37	5.50	14.00	9.45	--	230.92	<50	<0.50	<0.50	<0.500	<0.50	<2.5	1.9	--
	8/17/2000	NP		240.37	5.50	14.00	6.40	--	233.97	<50	<0.50	<0.50	<0.50	<0.50	<2.5	2.56	--
	11/10/2000	--	f	240.37	5.50	14.00	--	--	--	<50	<0.50	<0.50	<0.50	<0.50	<2.5	--	--
	11/10/2000	NP		240.37	5.50	14.00	6.25	--	234.12	<50	<0.50	<0.50	<0.50	<0.50	<2.5	1.93	--
	2/12/2001	NP		240.37	5.50	14.00	8.11	--	232.26	<50	<0.50	<0.50	<0.50	<0.50	<2.5	1.65	--
	4/13/2001	P		240.37	5.50	14.00	5.19	--	235.18	<50	<0.50	<0.50	<0.50	<0.50	<2.5	--	--
	7/18/2001	NP		240.37	5.50	14.00	5.55	--	234.82	<50	<0.50	<0.50	<0.50	<0.50	<2.5	--	--
	10/1/2001	NP		240.37	5.50	14.00	6.41	--	233.96	<50	<0.50	<0.50	<0.50	<0.50	<2.5	--	--
	1/14/2002	P		240.37	5.50	14.00	5.07	--	235.30	<50	<0.50	<0.50	<0.50	<0.50	<5.0	--	--
	4/3/2002	P		240.37	5.50	14.00	8.60	--	231.77	<50	<0.50	<0.50	<0.50	<0.50	<2.5	--	--
	8/8/2002	P		240.37	5.50	14.00	9.58	--	230.79	<50	<0.50	<0.50	<0.50	<0.50	<2.5	1.7	7
	11/27/2002	P		240.37	5.50	14.00	9.15	--	231.22	<50	<0.50	<0.50	<0.50	<0.50	<0.50	3.1	6.7
	2/10/2003	P		240.37	5.50	14.00	8.55	--	231.82	<50	<0.50	<0.50	<0.50	<0.50	<0.50	1.3	6.6
	6/3/2003	--		240.37	5.50	14.00	8.72	--	231.65	<50	<0.50	<0.50	<0.50	<0.50	<0.50	9.1	6.3
	8/14/2003	--		240.37	5.50	14.00	9.52	--	230.85	<50	<0.50	<0.50	<0.50	<0.50	<0.50	5.5	6.4

Table 1
Groundwater Elevation and Analytical Data
Former ARCO Service Station #6002
6235 Seminary Ave., Oakland, CA

Well No.	Date	P/ NP	Notes	TOC (ft MSL)	Top of Screen (ft bgs)	Bottom of Screen (ft bgs)	DTW (ft bgs)	Product Thickness (feet)	GWE (ft MSL)	GRO/ TPH-g (µg/L)	Benzene (µg/L)	Toluene (µg/L)	Ethyl-benzene (µg/L)	Total Xylenes (µg/L)	MTBE (µg/L)	DO (mg/L)	pH
MW-8	11/13/2003	--		240.37	5.50	14.00	9.45	--	230.92	--	--	--	--	--	--	--	--
	02/13/2004	--		246.09	5.50	14.00	8.38	--	237.71	--	--	--	--	--	--	--	--
	05/05/2004	--		246.09	5.50	14.00	9.30	--	236.79	--	--	--	--	--	--	--	--
	08/30/2004	P		246.09	5.50	14.00	9.69	--	236.40	<50	<0.50	<0.50	<0.50	0.75	<0.50	5.1	6.5
	11/08/2004	--		246.09	5.50	14.00	8.34	--	237.75	--	--	--	--	--	--	--	--
	02/07/2005	--		246.09	5.50	14.00	8.23	--	237.86	--	--	--	--	--	--	--	--
	05/09/2005	--		246.09	5.50	14.00	7.07	--	239.02	--	--	--	--	--	--	--	--
	08/11/2005	--	e	246.09	5.50	14.00	--	--	--	--	--	--	--	--	--	--	--
	12/02/2005	--		246.09	5.50	14.00	8.15	--	237.94	--	--	--	--	--	--	--	--
	02/15/2006	--	e	246.09	5.50	14.00	--	--	--	--	--	--	--	--	--	--	--
VW-1	2/23/1996	--		--	6.00	14.00	5.29	--	--	21,000	490	57	520	1,500	240	--	--
	5/10/1996	--		--	6.00	14.00	6.80	--	--	3,700	61	<5	100	50	200	--	--
	8/9/1996	--		--	6.00	14.00	7.03	--	--	970	2.7	<2.5	2.7	3.7	180	--	--
	11/8/1996	--	e	--	6.00	14.00	--	--	--	--	--	--	--	--	--	--	--
	3/21/1997	--		--	6.00	14.00	7.51	--	--	640	<4	<1	1	3	194	--	--
	5/27/1997	--		--	6.00	14.00	7.51	--	--	--	--	--	--	--	--	--	--
	8/5/1997	--		--	6.00	14.00	7.51	--	--	630	<1	<1	3	2	120	--	--
	10/29/1997	--		--	6.00	14.00	7.53	--	--	600	<0.5	<0.5	<0.5	1.6	84	--	--
	2/25/1998	--		--	6.00	14.00	6.77	--	--	230	<4	<0.7	1.2	0.5	27	--	--
	5/12/1998	--		--	6.00	14.00	7.43	--	--	340	<0.5	0.5	2.3	0.8	29	--	--
	7/28/1998	--		--	6.00	14.00	7.00	--	--	240	<0.5	<0.5	<0.5	1.1	54	--	--
	10/27/1998	--		--	6.00	14.00	7.52	--	--	230	<0.5	<0.5	<0.5	<0.5	65	--	--
	2/8/1999	--	c	--	6.00	14.00	7.05	--	--	<50	<0.5	<0.5	<0.5	<0.5	<3/36	--	--
	6/1/1999	NP		--	6.00	14.00	7.55	--	--	180	<0.5	<0.5	<0.5	<0.5	23	1	6.36
	8/25/1999	NP		--	6.00	14.00	7.66	--	--	130	<0.5	5.6	<0.5	<0.5	40	0.39	7.5
	10/29/1999	NP		--	6.00	14.00	7.59	--	--	200	1	<0.5	0.6	1.6	36	0.89	5.65
	2/16/2000	NP		--	6.00	14.00	7.03	--	--	210	<0.5	0.9	2.2	1.9	11	1.41	--
	6/23/2000	NP		--	6.00	14.00	7.71	--	--	175	1.04	<0.500	<0.500	<0.500	14.4	1.9	--
	8/17/2000	NP		--	6.00	14.00	7.75	--	--	180	<0.500	<0.500	0.622	0.76	23.7	0.63	--
	11/10/2000	NP		--	6.00	14.00	6.83	--	--	157	0.955	<0.500	0.973	<0.500	32.5	1.03	--
	2/12/2001	NP		--	6.00	14.00	7.85	--	--	273	0.627	<0.500	<0.500	0.507	9.19	0.47	--
	4/13/2001	P		--	6.00	14.00	5.11	--	--	213	<0.500	<0.500	<0.500	<0.500	6.38	--	--
	7/18/2001	P		--	6.00	14.00	5.39	--	--	270	<0.50	<0.50	<0.50	<0.50	20	--	--

Table 1
Groundwater Elevation and Analytical Data
Former ARCO Service Station #6002
6235 Seminary Ave., Oakland, CA

Well No.	Date	P/ NP	Notes	TOC (ft MSL)	Top of Screen (ft bgs)	Bottom of Screen (ft bgs)	DTW (ft bgs)	Product Thickness (feet)	GWE (ft MSL)	GRO/ TPH-g (µg/L)	Benzene (µg/L)	Toluene (µg/L)	Ethyl-benzene (µg/L)	Total Xylenes (µg/L)	MTBE (µg/L)	DO (mg/L)	pH
VW-1	10/1/2001	NP		--	6.00	14.00	6.50	--	--	200	<0.50	<0.50	<0.50	0.81	14	--	--
	1/14/2002	P		--	6.00	14.00	5.04	--	--	110	<0.50	<0.50	<0.50	<0.50	6.4	--	--
	4/3/2002	P		--	6.00	14.00	7.51	--	--	91	0.72	<0.50	<0.50	<0.50	12	--	--
	8/8/2002	P		--	6.00	14.00	9.58	--	--	<50	<0.50	<0.50	<0.50	<0.50	33	0.6	6.3
	11/27/2002	P		--	6.00	14.00	7.42	--	--	52	0.72	0.78	<0.50	<0.50	21	1	6.1
	2/10/2003	NP		--	6.00	14.00	7.38	--	--	52	<0.50	<0.50	<0.50	<0.50	11	1.7	6.5
	6/3/2003	--		--	6.00	14.00	7.30	--	--	71	<0.50	<0.50	<0.50	<0.50	13	3.3	6.3
	8/14/2003	--		--	6.00	14.00	7.59	--	--	<50	<0.50	<0.50	<0.50	<0.50	18	0.3	6.1
	11/13/2003	P		--	6.00	14.00	7.43	--	--	<50	<0.50	<0.50	<0.50	<0.50	13	0.6	6.1
	02/13/2004	P		253.19	6.00	14.00	7.35	--	245.84	59	<0.50	<0.50	<0.50	0.56	8.0	1.0	6.0
	05/05/2004	P		253.19	6.00	14.00	7.30	--	245.89	<50	0.71	<0.50	<0.50	0.60	11	0.1	6.4
	08/30/2004	P		253.19	6.00	14.00	8.50	--	244.69	<50	<0.50	<0.50	<0.50	<0.50	24	0.2	6.2
	11/08/2004	P		253.19	6.00	14.00	7.22	--	245.97	230	<0.50	<0.50	<0.50	0.75	27	0.65	5.1
	02/07/2005	P		253.19	6.00	14.00	7.25	--	245.94	<50	<0.50	<0.50	<0.50	<0.50	5.1	1.57	5.9
	05/09/2005	P		253.19	6.00	14.00	7.10	--	246.09	64	<0.50	<0.50	<0.50	<0.50	6.9	3.5	--
	08/11/2005	P		253.19	6.00	14.00	7.89	--	245.30	<50	<0.50	<0.50	<0.50	<0.50	10	0.04	6.3
	12/02/2005	P		253.19	6.00	14.00	7.32	--	245.87	130	<0.50	<0.50	<0.50	0.57	9.0	1.85	6.6
	02/15/2006	P		253.19	6.00	14.00	7.16	--	246.03	<50	<0.50	<0.50	<0.50	<0.50	2.8	0.9	6.2
VW-2	2/23/1996	--	i	--	--	--	6.92	--	--	--	--	--	--	--	--	--	--
	8/8/2002	--	i	--	--	--	10.51	--	--	--	--	--	--	--	--	--	--
VW-3	8/8/2002	--		--	5.50	14.50	8.85	--	--	<50	<0.50	<0.50	<0.50	<0.50	2.5	0.7	6.1
	11/27/2002	--	i	--	5.50	14.50	8.80	--	--	--	--	--	--	--	--	--	--
	2/10/2003	--	i	--	5.50	14.50	8.41	--	--	--	--	--	--	--	--	--	--
	6/3/2003	--	i	--	5.50	14.50	8.71	--	--	--	--	--	--	--	--	--	--
	8/14/2003	--	i	--	5.50	14.50	8.81	--	--	--	--	--	--	--	--	--	--
	11/13/2003	--		--	5.50	14.50	8.75	--	--	--	--	--	--	--	--	--	--
	02/13/2004	--		252.26	5.50	14.50	8.48	--	243.78	--	--	--	--	--	--	--	--
	05/05/2004	--		252.26	5.50	14.50	8.85	--	243.41	--	--	--	--	--	--	--	--
	08/30/2004	--		252.26	5.50	14.50	9.07	--	243.19	--	--	--	--	--	--	--	--
	11/08/2004	--		252.26	5.50	14.50	8.32	--	243.94	--	--	--	--	--	--	--	--
	02/07/2005	--		252.26	5.50	14.50	8.28	--	243.98	--	--	--	--	--	--	--	--
	05/09/2005	--		252.26	5.50	14.50	8.44	--	243.82	--	--	--	--	--	--	--	--
	08/11/2005	--		252.26	5.50	14.50	8.96	--	243.30	--	--	--	--	--	--	--	--

Table 1
Groundwater Elevation and Analytical Data
Former ARCO Service Station #6002
6235 Seminary Ave., Oakland, CA

Well No.	Date	P/ NP	Notes	TOC (ft MSL)	Top of Screen (ft bgs)	Bottom of Screen (ft bgs)	DTW (ft bgs)	Product Thickness (feet)	GWE (ft MSL)	GRO/TPH-g (µg/L)	Benzene (µg/L)	Toluene (µg/L)	Ethylbenzene (µg/L)	Total Xylenes (µg/L)	MTBE (µg/L)	DO (mg/L)	pH
VW-3	12/02/2005	--		252.26	5.50	14.50	8.26	--	244.00	--	--	--	--	--	--	--	--
	02/15/2006	--		252.26	5.50	14.50	7.61	--	244.65	--	--	--	--	--	--	--	--
VW-4	5/10/1996	--		--	5.50	14.50	8.58	--	--	13,000	2,500	41	420	660	43,000	--	--
	8/9/1996	--		--	5.50	14.50	11.70	--	--	<50	<0.5	<0.5	<0.5	<0.5	6,200	--	--
	11/8/1996	--		--	5.50	14.50	9.38	--	--	7,800	510	7	180	370	21,000	--	--
	3/21/1997	--		--	5.50	14.50	9.11	--	--	10,000	290	10	270	230	8,900	--	--
	5/27/1997	--		--	5.50	14.50	9.34	--	--	--	--	--	--	--	--	--	--
	8/5/1997	--		--	5.50	14.50	9.47	--	--	<10,000	180	<100	<100	110	12,000	--	--
	10/29/1997	--		--	5.50	14.50	9.35	--	--	9,800	200	69	260	360	4,900	--	--
	2/25/1998	--		--	5.50	14.50	7.08	--	--	<50	2.5	<0.5	<0.5	0.7	<3	--	--
	5/12/1998	--		--	5.50	14.50	9.17	--	--	3,200	<20	22	29	52	2,100	--	--
	7/28/1998	--		--	5.50	14.50	9.55	--	--	<10,000	<100	<100	<100	<100	5,100	--	--
	10/27/1998	--		--	5.50	14.50	9.92	--	--	<50	<0.5	<0.5	<0.5	<0.5	<3	--	--
	2/8/1999	--	c	--	5.50	14.50	7.50	--	--	<2,500	<25	<25	28	<25	2,400/3,100	--	--
	6/1/1999	NP		--	5.50	14.50	9.87	--	--	2,100	2.5	1.1	2.5	15	3,300	2	6.69
	8/25/1999	NP		--	5.50	14.50	9.78	--	--	1,300	4.4	4.9	1.7	2.9	4,600	0.36	7.94
	10/29/1999	NP		--	5.50	14.50	9.93	--	--	1,400	<0.5	1.8	1.6	3	4,200	1.18	6.64
	2/16/2000	NP		--	5.50	14.50	7.45	--	--	1,800	<0.5	2.9	15	10	3,400	1.01	--
	6/23/2000	--	f	--	5.50	14.50	--	--	--	1,260	<2.00	<2.00	<2.00	2.73	2,720	--	--
	6/23/2000	NP		--	5.50	14.50	9.74	--	--	1,360	<2.00	2.26	<2.00	2.25	4,900	1.5	--
	8/17/2000	NP		--	5.50	14.50	9.95	--	--	2,230	<10.0	<10.0	<10.0	<10.0	5,310	1.13	--
	11/10/2000	NP		--	5.50	14.50	9.22	--	--	1,390	18.5	<5.00	<5.00	<5.00	8,840	1.25	--
	2/12/2001	NP		--	5.50	14.50	8.99	--	--	1,400	9.42	<2.00	17.8	16.1	3,570	0.91	--
	4/13/2001	NP		--	5.50	14.50	7.80	--	--	556	3.82	<1.25	<1.25	<1.25	2,450	--	--
	7/18/2001	--	f	--	5.50	14.50	--	--	--	2,000	8.7	2.2	<2.0	<2.0	3,400	--	--
	7/18/2001	NP		--	5.50	14.50	7.73	--	--	2,100	9.2	<2.0	<2.0	<2.0	3,700	--	--
	10/1/2001	--	f	--	5.50	14.50	--	--	--	1,800	<10	<10	<10	<10	5,800	--	--
	10/1/2001	NP		--	5.50	14.50	6.69	--	--	2,000	<10	<10	<10	13	5,900	--	--
	1/14/2002	P		--	5.50	14.50	5.93	--	--	580	<2.0	<2.0	<2.0	<2.0	2,700	--	--
	4/3/2002	NP		--	5.50	14.50	9.60	--	--	1,400	5.2	16	<5.0	9.6	2,200	--	--
	8/8/2002	--	i	--	5.50	14.50	10.01	--	--	--	--	--	--	--	--	--	--
	11/27/2002	P		--	5.50	14.50	10.30	--	--	<10,000	<100	<100	<100	<100	3,800	1.7	6.7
	2/10/2003	NP		--	5.50	14.50	10.06	--	--	<5,000	<50	<50	<50	<50	2,500	1	6.8

Table 1

Groundwater Elevation and Analytical Data

Former ARCO Service Station #6002

6235 Seminary Ave., Oakland, CA

Well No.	Date	P/ NP	Notes	TOC (ft MSL)	Top of Screen (ft bgs)	Bottom of Screen (ft bgs)	DTW (ft bgs)	Product Thickness (feet)	GWE (ft MSL)	GRO/ TPH-g (µg/L)	Benzene (µg/L)	Toluene (µg/L)	Ethyl-benzene (µg/L)	Total Xylenes (µg/L)	MTBE (µg/L)	DO (mg/L)	pH
VW-4	6/3/2003	--		--	5.50	14.50	10.04	--	--	<1,000	<10	<10	<10	<10	440	1.9	6.6
	8/14/2003	--		--	5.50	14.50	9.66	--	--	<500	<5.0	<5.0	<5.0	<5.0	170	0.8	6.7
	11/13/2003	P		--	5.50	14.50	10.01	--	--	<500	<5.0	<5.0	<5.0	<5.0	130	1.7	6.4
	02/13/2004	P		252.69	5.50	14.50	9.34	--	243.35	330	<2.5	<2.5	<2.5	3.0	210	2.0	6.6
	05/05/2004	P		252.69	5.50	14.50	10.07	--	242.62	130	<1.0	<1.0	<1.0	<1.0	66	1.2	6.8
	08/30/2004	P		252.69	5.50	14.50	10.32	--	242.37	<500	<5.0	<5.0	<5.0	<5.0	220	1.1	6.6
	11/08/2004	P		252.69	5.50	14.50	9.35	--	243.34	480	<2.5	<2.5	<2.5	<2.5	140	1.1	6.0
	02/07/2005	P		252.69	5.50	14.50	9.22	--	243.47	180	<0.50	<0.50	<0.50	<0.50	47	1.83	6.5
	05/09/2005	P		252.69	5.50	14.50	9.78	--	242.91	120	0.63	<0.50	<0.50	<0.50	37	--	--
	08/11/2005	P		252.69	5.50	14.50	10.11	--	242.58	74	<0.50	<0.50	<0.50	<0.50	15	0.7	6.7
	12/02/2005	P		252.69	5.50	14.50	9.59	--	243.10	160	<1.0	<1.0	<1.0	<1.0	28	0.75	6.9
	02/15/2006	P		252.69	5.50	14.50	8.56	--	244.13	64	<0.50	<0.50	<0.50	<0.50	11	0.9	6.9

Table 1

Groundwater Elevation and Analytical Data

Former ARCO Service Station #6002
6235 Seminary Ave., Oakland, CA

SYMBOLS AND ABBREVIATIONS:

-- = Not analyzed/applicable/measured/available
< = Not detected at or above laboratory reporting limit
BTEX = Benzene, toluene, ethylbenzene and xylenes
DO = Dissolved oxygen
DTW = Depth to water in ft bgs
ft bgs = feet below ground surface
ft MSL = feet above mean sea level
GRO = Gasoline range organics
GWE = Groundwater elevation measured in ft MSL
mg/L = Milligrams per liter
MTBE = Methyl tert butyl ether
NP = Well not purged prior to sampling
P = Well purged prior to sampling
TOC = Top of casing measured in ft MSL
TPH-g = Total petroleum hydrocarbons as gasoline
µg/L = Micrograms per liter

FOOTNOTES:

a = SPH detected and GWE corrected: Corrected elevation (Z') = Z + (h * 0.73) where: Z: measured elevation, h: floating product thickness, 0.73: density ratio of oil to water.
b = MTBE analyzed by EPA method 8240.
c = MTBE, sample also analyzed for fuel oxygenates.
d = Well was decommissioned on 2/12/1996.
e = Well inaccessible.
f = Duplicate
g = Well was dry.
h = Insufficient water to sample.
i = Well is not part of the sampling program and therefore was not sampled.
j = Sheen in well.

NOTES:

Wells surveyed to NAVD'88 datum on 1/27/2004.

Beginning on the first quarter 2003 sampling event (2/10/2003), TPH-g, BTEX and MTBE analyzed by EPA method 8260. Prior to 2/10/2003, BTEX by EPA method 8021B from 10/29/99 to 2/10/03, and 8020 prior to 10/29/99.

Beginning in the fourth quarter 2003, the laboratory modified the reported analyte list. TPH-g was changed to GRO. The resulting data may be impacted by the potential of non-TPH-g analytes within the requested fuel range resulting in a higher concentration being reported.

Beginning in the second quarter 2004, the carbon range for GRO was changed from C6-C10 to C4-C12.

Values for DO and pH were obtained through field measurements.

The data within this table collected prior to August 2002 was provided to URS by RM and their previous consultants. URS has not verified the accuracy of this information.

Table 2

Fuel Additives Analytical Data
Former ARCO Service Station #6002
6235 Seminary Ave., Oakland, CA

Well Number	Date Sampled	Ethanol (µg/L)	TBA (µg/L)	MTBE (µg/L)	DIPE (µg/L)	ETBE (µg/L)	TAME (µg/L)	1,2-DCA (µg/L)	EDB (µg/L)	Footnotes/ Comments
MW-3	2/10/2003	<40	<20	<0.50	<0.50	<0.50	<0.50	--	--	
	08/30/2004	<100	<20	0.72	<0.50	<0.50	<0.50	<0.50	<0.50	
	08/11/2005	<100	<20	0.73	<0.50	<0.50	<0.50	<0.50	<0.50	
MW-4	2/10/2003	<40	<20	<0.50	<0.50	<0.50	<0.50	--	--	
	6/3/2003	<100	<20	<0.50	<0.50	<0.50	<0.50	--	--	
	8/14/2003	<100	<20	<0.50	<0.50	<0.50	<0.50	<0.50	<0.50	
	08/30/2004	<100	<20	<0.50	<0.50	<0.50	<0.50	<0.50	<0.50	
	08/11/2005	<100	<20	<0.50	<0.50	<0.50	<0.50	<0.50	<0.50	
MW-5	2/10/2003	<200	<100	100	<0.50	<0.50	<0.50	--	--	
	6/3/2003	<1,000	<200	160	<5.0	<5.0	<5.0	--	--	
	11/13/2003	<1,000	<200	90	<5.0	<5.0	<5.0	--	--	
	02/13/2004	<200	41	90	<1.0	<1.0	<1.0	<1.0	<1.0	
	05/05/2004	<500	<100	130	<2.5	<2.5	<2.5	<2.5	<2.5	
	08/30/2004	<500	100	85	<2.5	<2.5	<2.5	<2.5	<2.5	
	11/08/2004	<200	43	69	<1.0	<1.0	<1.0	<1.0	<1.0	
	02/07/2005	<200	<40	15	<1.0	<1.0	<1.0	<1.0	<1.0	
	05/09/2005	<200	<40	19	<1.0	<1.0	<1.0	<1.0	<1.0	a
	08/11/2005	<500	<100	51	<2.5	<2.5	<2.5	<2.5	<2.5	
	12/02/2005	<500	<100	13	<2.5	<2.5	<2.5	<2.5	<2.5	
	02/15/2006	<300	<20	<0.50	<0.50	<0.50	<0.50	<0.50	<0.50	
MW-6	2/10/2003	<40	<20	<0.50	<0.50	<0.50	<0.50	--	--	
	08/30/2004	<100	<20	<0.50	<0.50	<0.50	<0.50	<0.50	<0.50	
	08/11/2005	<100	<20	<0.50	<0.50	<0.50	<0.50	<0.50	<0.50	
MW-7	2/10/2003	<40	<20	<0.50	<0.50	<0.50	<0.50	--	--	
	6/3/2003	<100	<20	<0.50	<0.50	<0.50	<0.50	--	--	
	8/14/2003	<100	<20	<0.50	<0.50	<0.50	<0.50	<0.50	<0.50	
	08/11/2005	<100	<20	<0.50	<0.50	<0.50	<0.50	<0.50	<0.50	
MW-8	2/10/2003	<40	<20	<0.50	<0.50	<0.50	<0.50	--	--	
	6/3/2003	<100	<20	<0.50	<0.50	<0.50	<0.50	--	--	
	8/14/2003	<100	<20	<0.50	<0.50	<0.50	<0.50	<0.50	<0.50	
	08/30/2004	<100	<20	<0.50	<0.50	<0.50	<0.50	<0.50	<0.50	

Table 2

Fuel Additives Analytical Data
Former ARCO Service Station #6002
6235 Seminary Ave., Oakland, CA

Well Number	Date Sampled	Ethanol (µg/L)	TBA (µg/L)	MTBE (µg/L)	DIPE (µg/L)	ETBE (µg/L)	TAME (µg/L)	1,2-DCA (µg/L)	EDB (µg/L)	Footnotes/ Comments
VW-1	2/10/2003	<40	<20	11	<0.50	<0.50	<0.50	--	--	
	6/3/2003	<100	<20	13	<0.50	<0.50	<0.50	--	--	
	8/14/2003	<100	<20	18	<0.50	<0.50	<0.50	<0.50	<0.50	
	11/13/2003	<100	<20	13	<0.50	<0.50	<0.50	--	--	
	02/13/2004	<100	<20	8.0	<0.50	<0.50	<0.50	<0.50	<0.50	
	05/05/2004	<100	<20	11	<0.50	<0.50	<0.50	<0.50	<0.50	
	08/30/2004	<100	<20	24	<0.50	<0.50	<0.50	<0.50	<0.50	
	11/08/2004	<100	<20	27	<0.50	<0.50	<0.50	<0.50	<0.50	
	02/07/2005	<100	<20	5.1	<0.50	<0.50	<0.50	<0.50	<0.50	
	05/09/2005	<100	<20	6.9	<0.50	<0.50	<0.50	<0.50	<0.50	
	08/11/2005	<100	<20	10	<0.50	<0.50	<0.50	<0.50	<0.50	
	12/02/2005	<100	<20	9.0	<0.50	<0.50	<0.50	<0.50	<0.50	a
	02/15/2006	<300	<20	2.8	<0.50	<0.50	<0.50	<0.50	<0.50	
VW-4	2/10/2003	<4,000	<2,000	2500	<0.50	<0.50	<0.50	--	--	
	6/3/2003	<2,000	4,100	440	<10	<10	<10	--	--	
	8/14/2003	<1,000	3,200	170	<5.0	<5.0	<5.0	<5.0	<5.0	
	11/13/2003	<1,000	3,300	130	<5.0	<5.0	<5.0	--	--	
	02/13/2004	<500	1,300	210	<2.5	<2.5	<2.5	<2.5	<2.5	
	05/05/2004	<200	1,500	66	<1.0	1.3	<1.0	<1.0	<1.0	
	08/30/2004	<1,000	5,400	220	<5.0	5.4	<5.0	<5.0	<5.0	
	11/08/2004	<500	2,700	140	<2.5	<2.5	<2.5	<2.5	<2.5	
	02/07/2005	<100	1,000	47	<0.50	0.89	<0.50	<0.50	<0.50	
	05/09/2005	<100	1,200	37	<0.50	0.92	<0.50	<0.50	<0.50	
	08/11/2005	<100	2,000	15	<0.50	1.8	<0.50	<0.50	<0.50	b
	12/02/2005	<200	2,400	28	<1.0	2.2	<1.0	<1.0	<1.0	
	02/15/2006	<300	230	11	<0.50	<0.50	<0.50	<0.50	<0.50	

Table 2

Fuel Additives Analytical Data Former ARCO Service Station #6002 6235 Seminary Ave., Oakland, CA

SYMBOLS AND ABBREVIATIONS:

-- = Not analyzed/applicable/measured/available
< = Not detected at or above the laboratory reporting limit
1,2-DCA = 1,2-Dichloroethane
DIPE = Di-isopropyl ether
EDB = 1,2-Dibromoethane
ETBE = Ethyl tert-butyl ether
MTBE = Methyl tert-butyl ether
TAME = tert-Amyl methyl ether
TBA = tert-Butyl alcohol
µg/L = Micrograms per Liter

FOOTNOTES:

a = Calibration verification for ethanol was within the method limits but outside the contract limits.
b = The initial analysis for TBA was within holding time but required dilution.

NOTES:

All volatile organic compounds analyzed using EPA Method 8260B.

The data within this table collected prior to August 2002 was provided to URS by RM and their previous consultants. URS has not verified the accuracy of this information.

Table 3

Groundwater Gradient Data
Former ARCO Service Station #6002
6235 Seminary Ave., Oakland, CA

Date Sampled	Approximate Flow Direction	Approximate Hydraulic Gradient
3/15/1995	West-Southwest	0.08
5/30/1995	West-Southwest	0.08
9/1/1995	West-Southwest	0.09
11/13/1995	West-Southwest	0.08
2/23/1996	West-Southwest	0.08
5/10/1996	West-Southwest	0.08
8/9/1996	Southwest	0.08
11/8/1996	Southwest	0.06
3/21/1997	West-Southwest	0.05
5/27/1997	West-Southwest	0.07
8/5/1997	West	0.08
10/29/1997	West-Southwest	0.04
2/25/1998	West-Southwest	0.05
5/12/1998	West	0.07
7/28/1998	West	0.07
10/27/1998	West-Southwest	0.06
2/8/1999	West-Southwest	0.07
6/1/1999	West-Northwest	0.07
8/25/1999	West-Southwest	0.07
10/29/1999	West	0.07
2/16/2000	Southwest	0.05
6/23/2000	West	0.04
8/17/2000	West	0.09
11/10/2000	West-Southwest	0.08
2/12/2001	West-Southwest	0.07
4/13/2001	West	0.09
7/18/2001	West	0.08
10/1/2001	West-Southwest	0.08
1/14/2002	West-Southwest	0.07
4/3/2002	West-Southwest	0.08
8/8/2002	West-Southwest	0.09
11/27/2002	West-Southwest	0.08
2/10/2003	Southwest	0.06
6/3/2003	West	0.07
8/14/2003	West-Southwest	0.07
11/13/2003	West-Southwest	0.07
2/13/2004	Southwest	0.05

Table 3

Groundwater Gradient Data
Former ARCO Service Station #6002
6235 Seminary Ave., Oakland, CA

Date Sampled	Approximate Flow Direction	Approximate Hydraulic Gradient
5/4/2004	Southwest	0.06
8/30/2004	Southwest	0.07
11/8/2004	Southwest	0.10
2/7/2005	Southwest	0.1
5/9/2005	Southwest	0.07
8/11/2005	West	0.07
12/2/2005	Southwest	0.10
2/15/2006	Southwest	0.07

Source: The data within this table collected prior to August 2002 was provided to URS by RM and their previous consultants. URS has not verified the accuracy of this information.

ATTACHMENT A
FIELD PROCEDURES AND FIELD DATA SHEETS

FIELD PROCEDURES

Sampling Procedures

The sampling procedure for each well consists first of measuring the water level and depth to bottom, and checking for the presence of free phase petroleum product (free product), using either an electronic indicator and a clear Teflon™ bailer or an oil-water interface probe. Wells not containing free product are purged approximately three casing volumes of water (or until dewatered) using a centrifugal pump, gas displacement pump, or bailer. Equipment and purging method used for the current sampling event is noted on the attached field data sheets. During purging, temperature, pH, and electrical conductivity are monitored to document that these parameters are stable prior to collecting samples. After purging, water levels are allowed to partially (approximately 80%) recover. Groundwater samples (both purge and no purge) are collected using a Teflon bailer, placed into appropriate Environmental Protection Agency- (EPA) approved containers, labeled, logged onto chain-of-custody records, and transported on ice to a California State-certified laboratory. Wells with free product are not sampled and free product is removed according to California Code of Regulation, Title 23, Div. 3, Chap. 16, Section 2655, UST Regulations.

WELL GAUGING DATA

Project # 060215-DW2 Date 02/15/06 Client 6002

Site 6235 Seminary Ave Oakland

Well ID	Well Size (in.)	Sheen / Odor	Depth to Immiscible Liquid (ft.)	Thickness of Immiscible Liquid (ft.)	Volume of Immiscibles Removed (ml)	Depth to water (ft.)	Depth to well bottom (ft.)	Survey Point: TOB TOB
MW-3	4					8.23	24.42	
MW-4	4					8.38	24.20	
- MW-5	4					10.77	24.48	NPE5
MW-6	2					10.33	31.90	
MW-7	2					7.27	13.30	
MW-8	2	unable to gauge, impermeable vehicle parked over well						
- VW-1	4					7.16	13.96	
VW-3	4					7.61	14.20	
- VW-4	4					8.56	14.94	✓

ARCO / BP WELL MONITORING DATA SHEET

BTS #: <u>060215-DW-2</u>	Station # <u>6002</u>
Sampler: <u>DW, J D</u>	Date: <u>02/15/06</u>
Well I.D.: <u>MW-5</u>	Well Diameter: 2 3 <u>4</u> 6 8
Total Well Depth: <u>24.48</u>	Depth to Water: 6.7 <u>10.77</u> ^(6.7)
Depth to Free Product:	Thickness of Free Product (feet):
Referenced to: <u>PVC</u> Grade.	D.O. Meter (if req'd): <u>YSI</u> HACH

Well Diameter	Multiplier	Well Diameter	Multiplier
1"	0.04	4"	0.65
2"	0.16	6"	1.47
3"	0.37	Other	radius ² * 0.163

Purge Method: Bailer
 Disposable Bailer
 Positive Air Displacement
 Electric Submersible Extraction Pump
 Other: _____

Sampling Method: Bailer
 Disposable Bailer
 Extraction Port
 Other: _____

Top of Screen: 5' If well is listed as a no-purge, confirm that water level is below the top of screen. Otherwise, the well must be purged.

_____	X	_____	=	_____ Gals.
1 Case Volume (Gals.)		Specified Volumes		Calculated Volume

Time	Temp (°F)	pH	Conductivity (mS or μ S)	Gals. Removed	Observations
<u>1215</u>	<u>62.1</u>	<u>6.9</u>	<u>519</u>	-	<u>OK</u>

Did well dewater? Yes No Gallons actually evacuated:

Sampling Time: 1215 Sampling Date: 02/15/06

Sample I.D.: MW-5 Laboratory: Pace Sequoia Other _____

Analyzed for: GRD BTEX MTBE DRO Oxy's 1,2-DCA BDB Ethanol Other: _____

D.O. (if req'd):	Pre-purge:	mg/L	Post-purge:	1.2 mg/L
O.R.P. (if req'd):	Pre-purge:	mV	Post-purge:	mV

ARCO / BP WELL MONITORING DATA SHEET

BTS #: 060215-DW1	Station # 6002
Sampler: DW, J	Date: 02/15/06
Well I.D.: VW-1	Well Diameter: 2 3 <u>4</u> 6 8
Total Well Depth: 13.96	Depth to Water: 7.16
Depth to Free Product:	Thickness of Free Product (feet):
Referenced to: <u>PVC</u> Grade	D.O. Meter (if req'd): YSI HACH

Well Diameter	Multiplier	Well Diameter	Multiplier
1"	0.04	4"	0.65
2"	0.16	6"	1.47
3"	0.37	Other	radius ² * 0.163

Purge Method: Bailer Sampling Method: Bailer

Disposable Bailer Disposable Bailer

Positive Air Displacement Extraction Port

Electric Submersible Other: _____

Extraction Pump

Other: _____

Top of Screen: _____ If well is listed as a no-purge, confirm that water level is below the top of screen. Otherwise, the well must be purged.

<u>4.4</u>	x	<u>3</u>	=	<u>13.2</u>	Gals.
1 Case Volume (Gals.)		Specified Volumes		Calculated Volume	

Time	Temp (°F)	pH	Conductivity (mS or µS)	Gals. Removed	Observations
1309	61.0	6.4	790	4.4	cloudy
1310	61.9	6.2	772	8.8	"
1311	62.0	6.2	772	13.2	clear

Did well dewater? Yes No Gallons actually evacuated: 13.2

Sampling Time: 1320 Sampling Date: 02/15/06

Sample I.D.: VW-1 Laboratory: Pace Sequoia Other _____

Analyzed for: GRO BTEX MTBE DRO Oxy's 1,2-DCA EDH Ethanol Other: _____

D.O. (if req'd):	Pre-purge:	mg/L	Post-purge:	mg/L
			<u>0.9</u>	
O.R.P. (if req'd):	Pre-purge:	mV	Post-purge:	mV

ARCO / BP WELL MONITORING DATA SHEET

BTS #: 060215-DW1	Station # 6002
Sampler: DW, JD	Date: 02/15/06
Well I.D.: VW-4	Well Diameter: 2 3 <u>4</u> 6 8
Total Well Depth: 14.94	Depth to Water: 8.56
Depth to Free Product:	Thickness of Free Product (feet):
Referenced to: <u>PVE</u> Grade.	D.O. Meter (if req'd): <u>YSI</u> HACH

Well Diameter	Multiplier	Well Diameter	Multiplier
1"	0.04	4"	0.65
2"	0.16	6"	1.47
3"	0.37	Other	radius ² * 0.163

Purge Method: Bailer
 Disposable Bailer
 Positive Air Displacement
 Electric Submersible
 Extraction Pump
 Other: _____

Sampling Method: Bailer
 Disposable Bailer
 Extraction Port
 Other: _____

Top of Screen: _____ If well is listed as a no-purge, confirm that water level is below the top of screen. Otherwise, the well must be purged.

4.1	x	3	=	12.3	Gals.
1 Case Volume (Gals.)		Specified Volumes		Calculated Volume	

Time	Temp (°F)	pH	Conductivity (mS or μ S)	Gals. Removed	Observations
1244	63.7	7.1	633	4.1	clear
1245	63.4	6.9	640	8.2	"
1246	61.8	6.9	670	12.3	"

Did well dewater? Yes No

Gallons actually evacuated: 12.3

Sampling Time: 1253 Sampling Date: 02/15/06

Sample I.D.: VW-4 Laboratory: Pace Sequoia Other _____

Analyzed for: GRO BTEX MTBE DRO Oxy's 2-DCA EDB Elitrol Other: _____

D.O. (if req'd):	Pre-purge:	mg/L	Post-purge:	mg/L
			0.9	
O.R.P. (if req'd):	Pre-purge:	mV	Post-purge:	mV

BP GEM OIL COMPANY TYPE A BILL OF LADING

SOURCE RECORD BILL OF LADING FOR NON-HAZARDOUS PURGEWATER RECOVERED FROM GROUNDWATER WELLS AT BP GEM OIL COMPANY FACILITIES IN THE STATE OF CALIFORNIA. THE NON-HAZARDOUS PURGE- WATER WHICH HAS BEEN RECOVERED FROM GROUND- WATER WELLS IS COLLECTED BY THE CONTRACTOR, MADE UP INTO LOADS OF APPROPRIATE SIZE AND HAULED BY DILLARD ENVIRONMENTAL TO THE ALTAMONT LANDFILL AND RESOURCE RECOVERY FACILITY IN LIVERMORE, CALIFORNIA.

The contractor performing this work is BLAINE TECH SERVICES, INC. (BTS), 1680 Rogers Avenue, San Jose, CA 95112 (phone [408] 573-0555). Blaine Tech Services, Inc. is authorized by BP GEM OIL COMPANY to recover, collect, apportion into loads the Non-Hazardous Well Purgewater that is drawn from wells at the BP GEM Oil Company facility indicated below and deliver that purgewater to BTS. Transport routing of the Non-Hazardous Well Purgewater may be direct from one BP GEM facility to the designated destination point; from one BP GEM facility to the designated destination point via another BP GEM facility; from a BP GEM facility to the designated destination point via the contractor's facility, or any combination thereof. The Non-Hazardous Well Purgewater is and remains the property of BP GEM Oil Company.

This **Source Record BILL OF LADING** was initiated to cover the recovery of Non-Hazardous Well Purgewater from wells at the BP GEM Oil Company facility described below:

6002

Station #

6235 Seminary Oakland

Station Address

Total Gallons Collected From Groundwater Monitoring Wells:

27

added equip. _____
rinse water 1

any other adjustments 0

TOTAL GALS. RECOVERED 28

loaded onto BTS vehicle # 63

BTS event # 060215-DW2 time 1330 date 02/15/06

signature [Signature]

REC'D AT _____ time _____ date 1/1

unloaded by _____
signature _____

ATTACHMENT B

**LABORATORY PROCEDURES,
CERTIFIED ANALYTICAL REPORTS,
AND CHAIN-OF-CUSTODY RECORDS**

LABORATORY PROCEDURES

Laboratory Procedures

The groundwater samples were analyzed for the presence of the chemicals mentioned in the chain of custody using standard EPA methods. The methods of analysis for the groundwater samples are documented in the certified analytical report. The certified analytical reports and chain-of-custody record are presented in this attachment. The analytical data provided by the laboratory approved by RM have been reviewed and verified by that laboratory.



6 March, 2006

Barbara Jakub
URS Corporation [Arco]
1333 Broadway, Suite 800
Oakland, CA 94612

RE: ARCO #6002, Oakland, CA
Work Order: MPB0832

Enclosed are the results of analyses for samples received by the laboratory on 02/15/06 17:40. If you have any questions concerning this report, please feel free to contact me.

Sincerely,

Lisa Race
Senior Project Manager

CA ELAP Certificate #1210

The results in this laboratory report pertain only to the samples tested in the laboratory. The analyses contained in this report were performed in accordance with the BPGCLN Technical Specifications, applicable Federal, State, local regulations and certification requirements as well as the methodologies as described in laboratory SOPs reviewed by the BPGCLN. This entire report was reviewed and approved for release.



URS Corporation [Arco] 1333 Broadway, Suite 800 Oakland CA, 94612	Project: ARCO #6002, Oakland, CA Project Number: G0C8K-0011 Project Manager: Barbara Jakub	MPB0832 Reported: 03/06/06 13:42
---	--	--

ANALYTICAL REPORT FOR SAMPLES

Sample ID	Laboratory ID	Matrix	Date Sampled	Date Received
MW-5	MPB0832-01	Water	02/15/06 12:15	02/15/06 17:40
VW-1	MPB0832-02	Water	02/15/06 13:20	02/15/06 17:40
VW-4	MPB0832-03	Water	02/15/06 12:53	02/15/06 17:40
TB-6002-02152006	MPB0832-04	Water	02/15/06 12:15	02/15/06 17:40

The carbon range for the TPH-GRO has been changed from C6-C10 to C4-C12. The carbon range for TPH-DRO has been changed from C10-C28 to C10-C36. EPA 8015B has been modified to better meet the requirements of California regulatory agencies. These samples were received with no custody seals.

URS Corporation [Arco]
 1333 Broadway, Suite 800
 Oakland CA, 94612

 Project: ARCO #6002, Oakland, CA
 Project Number: G0C8K-0011
 Project Manager: Barbara Jakub

 MPB0832
 Reported:
 03/06/06 13:42

Volatile Organic Compounds by EPA Method 8260B
Sequoia Analytical - Morgan Hill

Analyte	Result	Reporting Limit	Units	Dilution	Batch	Prepared	Analyzed	Method	Notes
MW-5 (MPB0832-01) Water Sampled: 02/15/06 12:15 Received: 02/15/06 17:40									
tert-Amyl methyl ether	ND	0.50	ug/l	1	6C01004	03/01/06	03/01/06	EPA 8260B	
Benzene	ND	0.50	"	"	"	"	"	"	
tert-Butyl alcohol	ND	20	"	"	"	"	"	"	
Di-isopropyl ether	ND	0.50	"	"	"	"	"	"	
1,2-Dibromoethane (EDB)	ND	0.50	"	"	"	"	"	"	
1,2-Dichloroethane	ND	0.50	"	"	"	"	"	"	
Ethanol	ND	300	"	"	"	"	"	"	
Ethyl tert-butyl ether	ND	0.50	"	"	"	"	"	"	
Ethylbenzene	1.2	0.50	"	"	"	"	"	"	
Methyl tert-butyl ether	ND	0.50	"	"	"	"	"	"	
Toluene	ND	0.50	"	"	"	"	"	"	
Xylenes (total)	ND	0.50	"	"	"	"	"	"	
Gasoline Range Organics (C4-C12)	790	50	"	"	"	"	"	"	
<i>Surrogate: 1,2-Dichloroethane-d4</i>		105 %		60-135	"	"	"	"	
<i>Surrogate: Toluene-d8</i>		104 %		70-120	"	"	"	"	
<i>Surrogate: Dibromofluoromethane</i>		102 %		65-130	"	"	"	"	
<i>Surrogate: 4-Bromofluorobenzene</i>		95 %		70-120	"	"	"	"	
VW-1 (MPB0832-02) Water Sampled: 02/15/06 13:20 Received: 02/15/06 17:40									
tert-Amyl methyl ether	ND	0.50	ug/l	1	6C01004	03/01/06	03/01/06	EPA 8260B	
Benzene	ND	0.50	"	"	"	"	"	"	
tert-Butyl alcohol	ND	20	"	"	"	"	"	"	
Di-isopropyl ether	ND	0.50	"	"	"	"	"	"	
1,2-Dibromoethane (EDB)	ND	0.50	"	"	"	"	"	"	
1,2-Dichloroethane	ND	0.50	"	"	"	"	"	"	
Ethanol	ND	300	"	"	"	"	"	"	
Ethyl tert-butyl ether	ND	0.50	"	"	"	"	"	"	
Ethylbenzene	ND	0.50	"	"	"	"	"	"	
Methyl tert-butyl ether	2.8	0.50	"	"	"	"	"	"	
Toluene	ND	0.50	"	"	"	"	"	"	
Xylenes (total)	ND	0.50	"	"	"	"	"	"	
Gasoline Range Organics (C4-C12)	ND	50	"	"	"	"	"	"	
<i>Surrogate: 1,2-Dichloroethane-d4</i>		85 %		60-135	"	"	"	"	
<i>Surrogate: Toluene-d8</i>		94 %		70-120	"	"	"	"	
<i>Surrogate: Dibromofluoromethane</i>		101 %		65-130	"	"	"	"	
<i>Surrogate: 4-Bromofluorobenzene</i>		89 %		70-120	"	"	"	"	

URS Corporation [Arco]
 1333 Broadway, Suite 800
 Oakland CA, 94612

 Project: ARCO #6002, Oakland, CA
 Project Number: G0C8K-0011
 Project Manager: Barbara Jakub

 MPB0832
 Reported:
 03/06/06 13:42

Volatile Organic Compounds by EPA Method 8260B
Sequoia Analytical - Morgan Hill

Analyte	Result	Reporting Limit	Units	Dilution	Batch	Prepared	Analyzed	Method	Notes
VW-4 (MPB0832-03) Water Sampled: 02/15/06 12:53 Received: 02/15/06 17:40									
tert-Amyl methyl ether	ND	0.50	ug/l	1	6C01004	03/01/06	03/01/06	EPA 8260B	
Benzene	ND	0.50	"	"	"	"	"	"	
tert-Butyl alcohol	230	20	"	"	"	"	"	"	
Di-isopropyl ether	ND	0.50	"	"	"	"	"	"	
1,2-Dibromoethane (EDB)	ND	0.50	"	"	"	"	"	"	
1,2-Dichloroethane	ND	0.50	"	"	"	"	"	"	
Ethanol	ND	300	"	"	"	"	"	"	
Ethyl tert-butyl ether	ND	0.50	"	"	"	"	"	"	
Ethylbenzene	ND	0.50	"	"	"	"	"	"	
Methyl tert-butyl ether	11	0.50	"	"	"	"	"	"	
Toluene	ND	0.50	"	"	"	"	"	"	
Xylenes (total)	ND	0.50	"	"	"	"	"	"	
Gasoline Range Organics (C4-C12)	64	50	"	"	"	"	"	"	
<i>Surrogate: 1,2-Dichloroethane-d4</i>		85 %		60-135	"	"	"	"	
<i>Surrogate: Toluene-d8</i>		94 %		70-120	"	"	"	"	
<i>Surrogate: Dibromofluoromethane</i>		97 %		65-130	"	"	"	"	
<i>Surrogate: 4-Bromofluorobenzene</i>		87 %		70-120	"	"	"	"	

URS Corporation [Arco]
 1333 Broadway, Suite 800
 Oakland CA, 94612

 Project: ARCO #6002, Oakland, CA
 Project Number: G0C8K-0011
 Project Manager: Barbara Jakub

 MPB0832
 Reported:
 03/06/06 13:42

Volatile Organic Compounds by EPA Method 8260B - Quality Control

Sequoia Analytical - Morgan Hill

Analyte	Result	Reporting Limit	Units	Spike Level	Source Result	%REC	%REC Limits	RPD	RPD Limit	Notes
---------	--------	-----------------	-------	-------------	---------------	------	-------------	-----	-----------	-------

Batch 6C01004 - EPA 5030B P/T / EPA 8260B
Blank (6C01004-BLK1)

Prepared & Analyzed: 03/01/06

tert-Amyl methyl ether	ND	0.50	ug/l							
Benzene	ND	0.50	"							
tert-Butyl alcohol	ND	20	"							
Di-isopropyl ether	ND	0.50	"							
1,2-Dibromoethane (EDB)	ND	0.50	"							
1,2-Dichloroethane	ND	0.50	"							
Ethanol	ND	300	"							
Ethyl tert-butyl ether	ND	0.50	"							
Ethylbenzene	ND	0.50	"							
Methyl tert-butyl ether	ND	0.50	"							
Toluene	ND	0.50	"							
Xylenes (total)	ND	0.50	"							
Gasoline Range Organics (C4-C12)	ND	50	"							
<i>Surrogate: 1,2-Dichloroethane-d4</i>	4.35		"	5.00		87	60-135			
<i>Surrogate: Toluene-d8</i>	4.50		"	5.00		90	70-120			
<i>Surrogate: Dibromofluoromethane</i>	4.98		"	5.00		100	65-130			
<i>Surrogate: 4-Bromofluorobenzene</i>	4.08		"	5.00		82	70-120			

Laboratory Control Sample (6C01004-BS1)

Prepared & Analyzed: 03/01/06

tert-Amyl methyl ether	14.4	0.50	ug/l	16.3		88	80-115			
Benzene	4.80	0.50	"	5.04		95	65-115			
tert-Butyl alcohol	154	20	"	169		91	75-150			
Di-isopropyl ether	15.3	0.50	"	16.2		94	75-125			
1,2-Dibromoethane (EDB)	16.4	0.50	"	16.6		99	85-120			
1,2-Dichloroethane	13.9	0.50	"	15.5		90	85-130			
Ethanol	176	300	"	165		107	70-135			
Ethyl tert-butyl ether	13.6	0.50	"	16.4		83	75-130			
Ethylbenzene	7.10	0.50	"	7.28		98	75-135			
Methyl tert-butyl ether	6.72	0.50	"	7.84		86	65-125			
Toluene	35.2	0.50	"	38.0		93	85-120			
Xylenes (total)	36.9	0.50	"	40.8		90	85-125			
Gasoline Range Organics (C4-C12)	436	50	"	440		99	60-140			
<i>Surrogate: 1,2-Dichloroethane-d4</i>	4.27		"	5.00		85	60-135			
<i>Surrogate: Toluene-d8</i>	4.86		"	5.00		97	70-120			
<i>Surrogate: Dibromofluoromethane</i>	4.73		"	5.00		95	65-130			
<i>Surrogate: 4-Bromofluorobenzene</i>	4.44		"	5.00		89	70-120			

Sequoia Analytical - Morgan Hill

The results in this report apply to the samples analyzed in accordance with the chain of custody document. Unless otherwise stated, results are reported on a wet weight basis. This analytical report must be reproduced in its entirety.

URS Corporation [Arco]
 1333 Broadway, Suite 800
 Oakland CA, 94612

 Project: ARCO #6002, Oakland, CA
 Project Number: G0C8K-0011
 Project Manager: Barbara Jakub

 MPB0832
 Reported:
 03/06/06 13:42

Volatile Organic Compounds by EPA Method 8260B - Quality Control
Sequoia Analytical - Morgan Hill

Analyte	Result	Reporting Limit	Units	Spike Level	Source Result	%REC	%REC Limits	RPD	RPD Limit	Notes
---------	--------	-----------------	-------	-------------	---------------	------	-------------	-----	-----------	-------

Batch 6C01004 - EPA 5030B P/T / EPA 8260B

Matrix Spike (6C01004-MS1)	Source: MPB0999-01			Prepared & Analyzed: 03/01/06						
tert-Amyl methyl ether	151	5.0	ug/l	163	9.0	87	80-115			
Benzene	184	5.0	"	50.4	140	87	65-115			
tert-Butyl alcohol	1950	200	"	1690	360	94	75-120			
Di-isopropyl ether	143	5.0	"	162	ND	88	75-125			
1,2-Dibromoethane (EDB)	169	5.0	"	166	ND	102	85-120			
1,2-Dichloroethane	145	5.0	"	155	2.3	92	85-130			
Ethanol	1440	3000	"	1650	ND	87	70-135			
Ethyl tert-butyl ether	130	5.0	"	164	2.1	78	75-130			
Ethylbenzene	110	5.0	"	72.8	36	102	75-135			
Methyl tert-butyl ether	548	5.0	"	78.4	540	10	65-125			BB, LN
Toluene	373	5.0	"	380	18	93	85-120			
Xylenes (total)	627	5.0	"	408	240	95	85-125			
Gasoline Range Organics (C4-C12)	6680	500	"	4400	2100	104	60-140			
<i>Surrogate: 1,2-Dichloroethane-d4</i>	<i>4.52</i>		<i>"</i>	<i>5.00</i>		<i>90</i>	<i>60-135</i>			
<i>Surrogate: Toluene-d8</i>	<i>4.73</i>		<i>"</i>	<i>5.00</i>		<i>95</i>	<i>70-120</i>			
<i>Surrogate: Dibromofluoromethane</i>	<i>4.59</i>		<i>"</i>	<i>5.00</i>		<i>92</i>	<i>65-130</i>			
<i>Surrogate: 4-Bromofluorobenzene</i>	<i>4.52</i>		<i>"</i>	<i>5.00</i>		<i>90</i>	<i>70-120</i>			

Matrix Spike Dup (6C01004-MSD1)	Source: MPB0999-01			Prepared & Analyzed: 03/01/06						
tert-Amyl methyl ether	145	5.0	ug/l	163	9.0	83	80-115	4	15	
Benzene	171	5.0	"	50.4	140	62	65-115	7	20	LN
tert-Butyl alcohol	2000	200	"	1690	360	97	75-120	3	25	
Di-isopropyl ether	144	5.0	"	162	ND	89	75-125	0.7	15	
1,2-Dibromoethane (EDB)	154	5.0	"	166	ND	93	85-120	9	15	
1,2-Dichloroethane	124	5.0	"	155	2.3	79	85-130	16	20	LN
Ethanol	1630	3000	"	1650	ND	99	70-135	12	35	
Ethyl tert-butyl ether	128	5.0	"	164	2.1	77	75-130	2	25	
Ethylbenzene	109	5.0	"	72.8	36	100	75-135	0.9	15	
Methyl tert-butyl ether	540	5.0	"	78.4	540	0	65-125	1	20	BB, LN
Toluene	340	5.0	"	380	18	85	85-120	9	20	
Xylenes (total)	608	5.0	"	408	240	90	85-125	3	20	
Gasoline Range Organics (C4-C12)	5960	500	"	4400	2100	88	60-140	11	25	
<i>Surrogate: 1,2-Dichloroethane-d4</i>	<i>4.09</i>		<i>"</i>	<i>5.00</i>		<i>82</i>	<i>60-135</i>			
<i>Surrogate: Toluene-d8</i>	<i>4.49</i>		<i>"</i>	<i>5.00</i>		<i>90</i>	<i>70-120</i>			
<i>Surrogate: Dibromofluoromethane</i>	<i>4.26</i>		<i>"</i>	<i>5.00</i>		<i>85</i>	<i>65-130</i>			
<i>Surrogate: 4-Bromofluorobenzene</i>	<i>4.53</i>		<i>"</i>	<i>5.00</i>		<i>91</i>	<i>70-120</i>			

Sequoia Analytical - Morgan Hill

The results in this report apply to the samples analyzed in accordance with the chain of custody document. Unless otherwise stated, results are reported on a wet weight basis. This analytical report must be reproduced in its entirety.



URS Corporation [Arco]
1333 Broadway, Suite 800
Oakland CA, 94612

Project: ARCO #6002, Oakland, CA
Project Number: G0C8K-0011
Project Manager: Barbara Jakub

MPB0832
Reported:
03/06/06 13:42

Notes and Definitions

LN MS and/or MSD below acceptance limits. See Blank Spike(LCS).
BB, LN Sample > 4x spike concentration.
DET Analyte DETECTED
ND Analyte NOT DETECTED at or above the reporting limit or MDL, if MDL is specified
NR Not Reported
dry Sample results reported on a dry weight basis
RPD Relative Percent Difference



Chain of Custody Record

Project Name: Analytical for QMR sampling
 BP BU/AR Region/Enfos Segment: BP > Americas > West Coast > Retail > WCBU > CA > Central > 6002 > Historical/BL
 State or Lead Regulatory Agency: California Regional Water Quality Control Board - San Francisco
 Requested Due Date (mm/dd/yy): 10 Day TAT

On-site Time: 1030	Temp: 65
Off-site Time: 1345	Temp: 70
Sky Conditions: Sunny	
Meteorological Events: ---	
Wind Speed: ---	Direction: ---

Lab Name: Sequoia	BP/AR Facility No.: 6002	Consultant/Contractor: URS
Address: 885 Jarvis Drive Morgan Hill, CA 95037	BP/AR Facility Address: 6235 Seminary Ave., Oakland, CA 94605	Address: 1333 Broadway, Suite 800 Oakland, CA 94612
Lab PM: Lisa Race / Katt Min	Site Lat/Long: 37.780021 / -122.173	Consultant/Contractor Project No.: 38487539
Tele/Fax: 408.782.8156 / 408.782.6308	California Global ID No.: T0600100105	Consultant/Contractor PM: Barb Jakub
BP/AR PM Contact: Paul Supple	Enfos Project No.: G0C8K-0011	Tele/Fax: 510.874.3296 / 510.874.3268
Address: P.O. Box 6549 Moraga, CA 94570	Provision or RCOP: Provision	Report Type & QC Level: Level 1 with EDF
Tele/Fax: 925.299.8891 / 925.299.8872	Phase/WBS: 04 - Mon/Remed by Natural Attenuation	E-mail EDD To: Donna.Cosper@urscorp.com
	Sub Phase/Task: 03 - Analytical	Invoice to: Atlantic Richfield Company
	Cost Element: 05 - Subcontracted Costs	

Item No.	Sample Description	Time	Date	Matrix			Laboratory No.	No. of Containers	Preservative					Requested Analysis					Sample Point Lat/Long and Comments			
				Soil/Solid	Water/Liquid	Air			Unpreserved	H ₂ SO ₄	HNO ₃	HCl	Methanol	GRO / ETX (8260)	MIBE, TAME, FTBE DPE, TBA (8260)	EDB, 1,2-DCA (8260)	Ethanol (8260)					
1	MW-5	1215	03/15/06	X			01	3						X	X	X	X					
2	VW-1	1320	↓	X			02	3						X	X	X	X					
3	VW-4	1253		X			03	3						X	X	X	X					
4	TS-6002-02152006	1215		X			04	2						X								ON HOLD
5																						
6																						
7																						
8																						
9																						
10																						

Sampler's Name: Justin Dennis	Relinquished By / Affiliation: Justin Dennis / DTS	Date: 2/15/06	Time: 1615	Accepted By / Affiliation: SAMPLE CUSTODIAN	Date: 2/15/06	Time: 1615
Sampler's Company: Plaine Truck Services	Signature: [Signature]	Date: 2/15/06	Time: 1200	Signature: [Signature]	Date: 2/15/06	Time: 1200
Shipment Date:	Signature: [Signature]	Date: 2-15-06	Time: 1740	Signature: [Signature]	Date: 2-15-06	Time: 1740
Shipment Method:						
Shipment Tracking No:						

Special Instructions:

Seals In Place Yes No Temp Blank Yes No Cooler Temperature on Receipt 5.1 F/C Trip Blank Yes No

SEQUOIA ANALYTICAL SAMPLE RECEIPT LOG

CLIENT NAME: URS
 REC. BY (PRINT) L.P.
 WORKORDER: MPB0832

DATE REC'D AT LAB: 2-15-06
 TIME REC'D AT LAB: 17:40
 DATE LOGGED IN: 2-19-06

For Regulatory Purposes?
 DRINKING WATER YES/NO NO
 WASTE WATER YES/NO NO

CIRCLE THE APPROPRIATE RESPONSE	LAB SAMPLE #	DASH #	CLIENT ID	CONTAINER DESCRIPTION	PRESERVATIVE	pH	SAMPLE MATRIX	DATE SAMPLED	REMARKS: CONDITION (ETC.)
1. Custody Seal(s) Present / Absent Intact / Broken*									2-15-06 7:40
2. Chain-of-Custody Present / Absent*									
3. Traffic Reports or Packing List: Present / Absent									
4. Airbill: Airbill / Sticker Present / Absent									
5. Airbill #:									
6. Sample Labels: Present / Absent									
7. Sample IDs: Listed / Not Listed on Chain-of-Custody									
8. Sample Condition: Intact / Broken* / Leaking*									
9. Does information on chain-of-custody, traffic reports and sample labels agree? Yes / No*									
10. Sample received within hold time? Yes / No*									
11. Adequate sample volume received? Yes / No*									
12. Proper preservatives used? Yes / No*									
13. Trip Blank / Temp Blank Received? (circle which, if yes) Yes / No*									
14. Read Temp: <u>5.1</u> Corrected Temp: <u>5.1C</u> Is corrected temp 4 +/-2°C? Yes / No**									

*IF CIRCLED, CONTACT PROJECT MANAGER AND ATTACH RECORD OF RESOLUTION.

ATTACHMENT C

**ERROR CHECK REPORTS AND EDF/GEOWELL SUBMITTAL
CONFIRMATIONS**

Electronic Submittal Information

[Main Menu](#) | [View/Add Facilities](#) | [Upload EDD](#) | [Check EDD](#)

SUCCESSFUL GEO_WELL CHECK - NO ERRORS

<u>ORGANIZATION NAME:</u>	URS Corporation-Oakland Office
<u>USER NAME:</u>	URSCORP-OAKLAND
<u>DATE CHECKED:</u>	3/9/2006 2:05:22 PM

**Processing is complete. No errors were found!
You may now proceed to the [upload](#) page.**

[Back to Main Menu](#)

Logged in as URSCORP-OAKLAND (CONTRACTOR)

CONTACT SITE [ADMINISTRATOR](#).

Electronic Submittal Information

[Main Menu](#) | [View/Add Facilities](#) | [Upload EDD](#) | [Check EDD](#)

UPLOADING A GEO_WELL FILE

**Processing is complete. No errors were found!
Your file has been successfully submitted!**

Submittal Title: 1Q 2006 BP/ARCO 6002
GOWELL

Submittal Date/Time: 3/9/2006 2:06:35 PM

**Confirmation
Number:** 5948031365

[Back to Main Menu](#)

Logged in as URSCORP-OAKLAND
(CONTRACTOR)

[CONTACT SITE ADMINISTRATOR.](#)

Electronic Submittal Information

[Main Menu](#) |
 [View/Add Facilities](#) |
 [Upload EDF](#) |
 [Check EDF](#)

SUCCESSFUL EDF CHECK - NO ERRORS

<u>ORGANIZATION NAME:</u>	URS Corporation-Oakland Office
<u>USER NAME:</u>	URSCORP-OAKLAND
<u>DATE CHECKED:</u>	3/9/2006 2:07:55 PM
<u>GLOBAL ID:</u>	T0600100105
<u>FILE UPLOADED:</u>	ARCO#6002-EDF- MPB0832.zip

No errors were found in your EDF upload file.

If you want to submit this file to the SWRCB, choose the "Upload EDF" option in the above menu and follow the instructions.

When you complete the submittal process, you will be given a confirmation number for your submittal.

Click [here](#) to view the detections report for this upload.

ARCO # 06002	<u>Regional Board - Case #: 01-0113</u>
6235 SEMINARY AVE	SAN FRANCISCO BAY RWQCB (REGION 2)
OAKLAND, CA 94605	<u>Local Agency (lead agency) - Case #: 3942</u>
	ALAMEDA COUNTY LOP - (AG)

SAMPLE DETECTIONS REPORT

# FIELD POINTS SAMPLED	0
# FIELD POINTS WITH DETECTIONS	0
# FIELD POINTS WITH WATER SAMPLE DETECTIONS ABOVE MCL	0
SAMPLE MATRIX TYPES	

METHOD QA/QC REPORT

METHODS USED	8260FA
TESTED FOR REQUIRED ANALYTES?	Y
LAB NOTE DATA QUALIFIERS	Y

QA/QC FOR 8021/8260 SERIES SAMPLES

TECHNICAL HOLDING TIME VIOLATIONS	0
METHOD HOLDING TIME VIOLATIONS	0
LAB BLANK DETECTIONS ABOVE REPORTING DETECTION LIMIT	0
LAB BLANK DETECTIONS	0
DO ALL BATCHES WITH THE 8021/8260 SERIES INCLUDE THE FOLLOWING?	
- LAB METHOD BLANK	N
- MATRIX SPIKE	N
- MATRIX SPIKE DUPLICATE	Y
- BLANK SPIKE	N
- SURROGATE SPIKE	Y

WATER SAMPLES FOR 8021/8260 SERIES

MATRIX SPIKE / MATRIX SPIKE DUPLICATE(S) % RECOVERY BETWEEN 65-135%	Y
MATRIX SPIKE / MATRIX SPIKE DUPLICATE(S) RPD LESS THAN 30%	n/a
SURROGATE SPIKES % RECOVERY BETWEEN 85-115%	Y
BLANK SPIKE / BLANK SPIKE DUPLICATES % RECOVERY BETWEEN 70-	n/a

130%

SOIL SAMPLES FOR 8021/8260 SERIES

MATRIX SPIKE / MATRIX SPIKE DUPLICATE(S) % RECOVERY BETWEEN 65-135%	n/a
MATRIX SPIKE / MATRIX SPIKE DUPLICATE(S) RPD LESS THAN 30%	n/a
SURROGATE SPIKES % RECOVERY BETWEEN 70-125%	n/a
BLANK SPIKE / BLANK SPIKE DUPLICATES % RECOVERY BETWEEN 70-130%	n/a

FIELD QC SAMPLES

<u>SAMPLE</u>	<u>COLLECTED</u>	<u>DETECTIONS > REPD</u>
QCTB SAMPLES	N	0
QCEB SAMPLES	N	0
QCAB SAMPLES	N	0

Logged in as URSCORP-OAKLAND (CONTRACTOR)

CONTACT SITE ADMINISTRATOR.

Electronic Submittal Information

[Main Menu](#) | [View/Add Facilities](#) | [Upload EDF](#) | [Check EDF](#)

Your EDF file has been successfully uploaded!

Confirmation Number: 7491916239

Date/Time of Submittal: 3/9/2006 2:08:31 PM

Facility Global ID: T0600100105

Facility Name: ARCO # 06002

Submittal Title: 1Q 2006 BP/ARCO 6002 EDF

Submittal Type: GW Monitoring Report

Click [here](#) to view the detections report for this upload.

ARCO # 06002 6235 SEMINARY AVE OAKLAND, CA 94605	Regional Board - Case #: 01-0113 SAN FRANCISCO BAY RWQCB (REGION 2) Local Agency (lead agency) - Case #: 3942 ALAMEDA COUNTY LOP - (AG)
---	--

CONF #	TITLE	QUARTER
7491916239	1Q 2006 BP/ARCO 6002 EDF	Q1 2006
SUBMITTED BY	SUBMIT DATE	STATUS
Srijesh Thapa	3/9/2006	PENDING REVIEW

SAMPLE DETECTIONS REPORT

# FIELD POINTS SAMPLED	3
# FIELD POINTS WITH DETECTIONS	3
# FIELD POINTS WITH WATER SAMPLE DETECTIONS ABOVE MCL	2
SAMPLE MATRIX TYPES	WATER

METHOD QA/QC REPORT

METHODS USED	8260FA
TESTED FOR REQUIRED ANALYTES?	Y
LAB NOTE DATA QUALIFIERS	Y

QA/QC FOR 8021/8260 SERIES SAMPLES

TECHNICAL HOLDING TIME VIOLATIONS	0
METHOD HOLDING TIME VIOLATIONS	0
LAB BLANK DETECTIONS ABOVE REPORTING DETECTION LIMIT	0
LAB BLANK DETECTIONS	0
DO ALL BATCHES WITH THE 8021/8260 SERIES INCLUDE THE FOLLOWING?	
- LAB METHOD BLANK	Y
- MATRIX SPIKE	Y
- MATRIX SPIKE DUPLICATE	Y
- BLANK SPIKE	Y
- SURROGATE SPIKE	Y

WATER SAMPLES FOR 8021/8260 SERIES

MATRIX SPIKE / MATRIX SPIKE DUPLICATE(S) % RECOVERY BETWEEN 65-135%	Y
MATRIX SPIKE / MATRIX SPIKE DUPLICATE(S) RPD LESS THAN 30%	Y
SURROGATE SPIKES % RECOVERY BETWEEN 85-115%	Y
BLANK SPIKE / BLANK SPIKE DUPLICATES % RECOVERY BETWEEN 70-130%	Y

SOIL SAMPLES FOR 8021/8260 SERIES

MATRIX SPIKE / MATRIX SPIKE DUPLICATE(S) % RECOVERY BETWEEN 65-135%	n/a
MATRIX SPIKE / MATRIX SPIKE DUPLICATE(S) RPD LESS THAN 30%	n/a
SURROGATE SPIKES % RECOVERY BETWEEN 70-125%	n/a

BLANK SPIKE / BLANK SPIKE DUPLICATES % RECOVERY BETWEEN 70-130% n/a

FIELD QC SAMPLES

<u>SAMPLE</u>	<u>COLLECTED</u>	<u>DETECTIONS > REPD</u>
QCTB SAMPLES	N	0
QCEB SAMPLES	N	0
QCAB SAMPLES	N	0

Logged in as URSCORP-OAKLAND (CONTRACTOR)

CONTACT SITE ADMINISTRATOR.