

**Shell Oil Products US**

June 2, 2003

Alameda County

JUN 04 2003

Environmental Health

eva chu

Alameda County Health Care Services Agency
1131 Harbor Bay Parkway, Suite 250
Alameda, California 94502-6577

Subject: Shell-branded Service Station
1285 Bancroft Avenue
San Leandro, California

Dear Ms. chu:

Attached for your review and comment is a copy of the *Subsurface Investigation Work Plan Amendment 2* for the above referenced site. Upon information and belief, I declare, under penalty of perjury, that the information contained in the attached document is true and correct.

As always, please feel free to contact me directly at (559) 645-9306 with any questions or concerns.

Sincerely,

Shell Oil Products US

A handwritten signature in cursive script that reads "Karen Petryna".

Karen Petryna
Sr. Environmental Engineer

June 2, 2003

eva chu
Alameda County Health Care Services Agency
1131 Harbor Bay Parkway, Suite 250
Alameda, California 94502-6577

Re: **Subsurface Investigation Work Plan Amendment 2**
Shell-branded Service Station
1285 Bancroft Avenue
San Leandro, California
Incident #98996067
Cambria Project #245-0504



Dear Ms. chu:

On behalf of Equilon Enterprises LLC dba Shell Oil Products US, Cambria Environmental Technology, Inc. (Cambria) is submitting this second amendment to our October 15, 2002 *Subsurface Investigation Work Plan* and our April 4, 2003 *Subsurface Investigation Work Plan Amendment* as requested in a letter from Alameda County Health Care Services Agency (ACHCSA) dated May 14, 2003.

The objective of this investigation is to define the lateral and vertical extent of methyl tertiary butyl ether (MTBE) in groundwater and to provide for ongoing groundwater monitoring downgradient of the site (Figure 1). In the original work plan, Cambria proposed to install two downgradient monitoring wells to achieve this objective. As requested in ACHCSA's May 14, 2003 letter and discussed in a telephone conversation between eva chu of ACHCSA and Melody Munz of Cambria on May 15, 2003, Cambria will instead advance a total of three on-site and five off-site soil borings. Cambria will use the soil and groundwater results of this investigation to determine locations, and depths and screen intervals for the new monitoring wells, if necessary.

PROPOSED SCOPE OF WORK

Cambria will install three on-site and five off-site borings (SB-1 through SB-8) at the locations shown in Figure 2. One grab groundwater sample will be collected from each boring. Cambria will also collect soil samples at approximate 5-foot intervals and at changes in stratigraphy, from approximately 10 feet above to 15 feet below the static groundwater level. Historical soil results indicate very low to non-detect concentrations of total petroleum hydrocarbons as gasoline

**Cambria
Environmental
Technology, Inc.**

5900 Hollis Street
Suite A
Emeryville, CA 94608
Tel (510) 420-0700
Fax (510) 420-9170

(TPHg), benzene, toluene, ethylbenzene, xylenes (BTEX) and MTBE above 30 feet below grade (fbg) off site; therefore, Cambria does not believe that samples above 30 fbg are warranted off site. On site, to characterize the suspected source area, Cambria will collect soil samples for chemical analysis at a minimum of 5-foot intervals and at changes in stratigraphy. Saturated soil sample results will be used as qualitative indicator of the upper and lower limits of the chemical plume. Cambria will follow our standard field procedures for soil borings and monitoring wells, provided with the original work plan, to complete the work.

Upon ACHCSA approval of this work plan, Cambria will complete the following tasks:



Utility Location: Cambria will notify Underground Service Alert (USA) of our proposed drilling activities. USA will have the utilities in the vicinity identified.

Site Health and Safety Plan: Pursuant to OSHA requirements, Cambria will prepare a comprehensive site safety plan to protect site workers. The plan will be kept onsite during field activities and will be reviewed and signed by each site worker.

Permits: Cambria will obtain from the Alameda County Public Works Agency, CWP property owner, and the City of San Leandro all permits, access agreements and encroachment permits required for advancing the soil borings.

Soil Boring and Sampling Activities: Using a hollow-stem auger drill rig, Cambria will install three on-site and five off-site borings to approximately 15 feet below the depth of groundwater (approximately 50 fbg). One grab-groundwater sample will be collected from each boring. During drilling activities, Cambria will collect soil samples for lithologic description at 5-foot intervals and/or at changes in stratigraphy. Cambria will submit undisturbed soil samples for chemical analysis from on-site borings collected at 5-foot intervals between the surface and the total boring depth and from off-site borings collected between approximately 30 fbg and the total boring depth.

Laboratory Analyses: All samples will be analyzed by a State-certified laboratory.

Soil samples will be analyzed for TPHg, BTEX and MTBE by EPA Method 8260

Grab-groundwater samples will be analyzed for TPHg, BTEX, MTBE, tert-amyl methyl ether, ethyl tert-butyl ether, di-isopropyl ether, tert-butyl alcohol, ethanol, ethylene dibromide and ethylene dichloride by EPA Method 8260

Subsurface Investigation Report: After the analytical results are received, Cambria will prepare a report that, at a minimum, will contain:

- A summary of the site background and history;
- Descriptions of drilling and sampling activities;
- Soil boring and monitoring well logs;
- Tabulated analytical results for soil;
- Analytical reports and chain-of-custody forms;
- A discussion of the hydrocarbon distribution in the subsurface; and
- Conclusions and recommendations



SCHEDULE

Upon receiving written ACHCSA approval of this work plan, Cambria will proceed with permitting, re-apply for encroachment permission, confirm access agreements and finalize the drilling schedule. Cambria will provide ACHCSA with a 72-hour notice prior to field activities. We anticipate submitting our investigation report within 60 days of completing the fieldwork.

CLOSING

We appreciate the opportunity to work with you on this project. Please call Melody Munz at (510) 420-3324 if you have any questions or comments.

Sincerely,
Cambria Environmental Technology, Inc



Melody Munz
Project Engineer

Matthew W. Derby, P.E.
Senior Project Engineer



Figures: 1 - Vicinity/Area Well Survey Map
2 - Proposed Soil Boring Location Map

cc: Karen Petryna, Shell Oil Products US, P.O. Box 7869, Burbank, CA 91510-7869
Victor Lemon, City of San Leandro, 835 East 14th Street, San Leandro, CA 94577
Mike Bakaldin, City of San Leandro, 835 East 14th Street, San Leandro, CA 94577

G:\San Leandro 1285 Bancroft\2003 MW Installation\1285 Bancroft WP03_Amendment2.doc

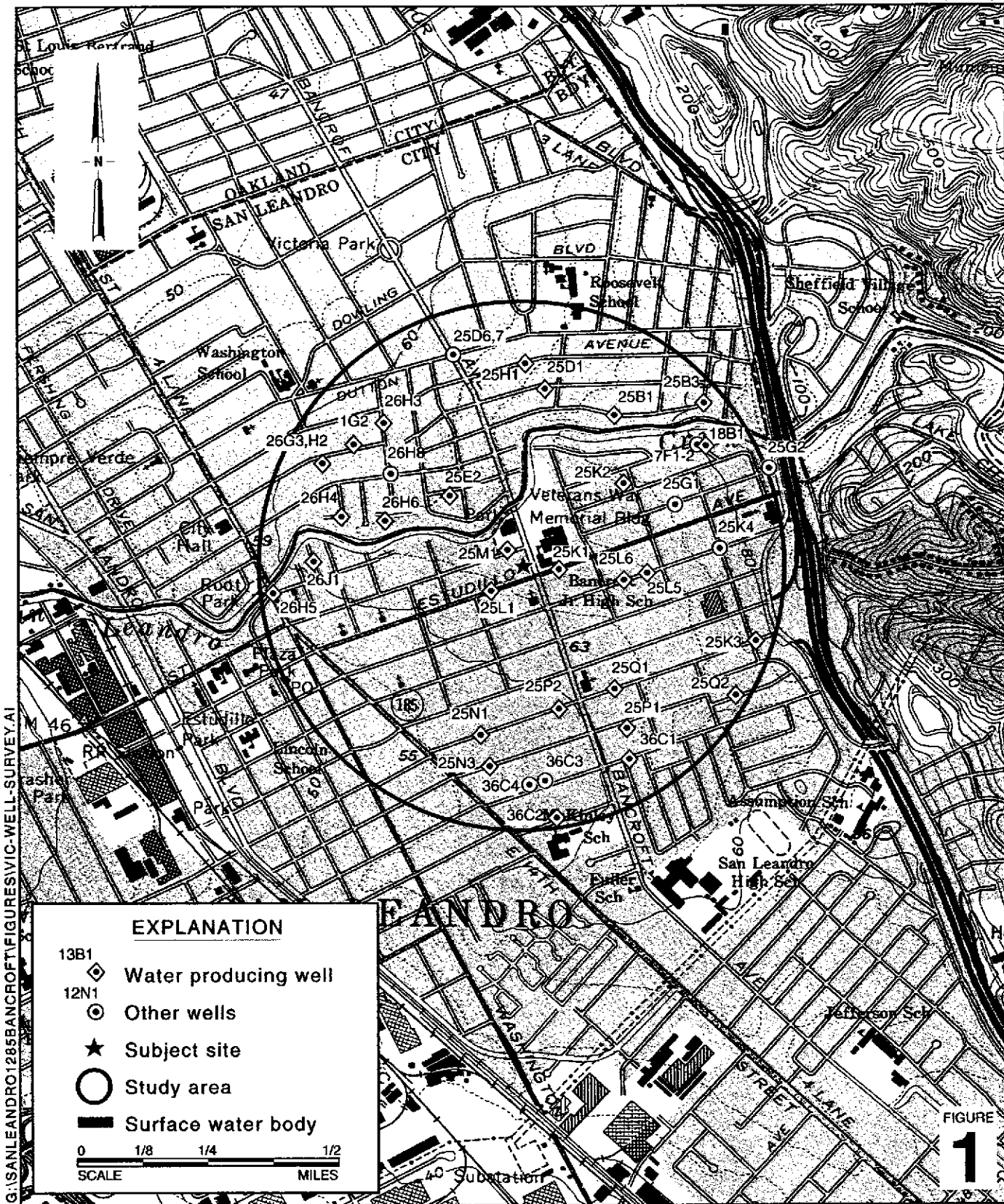

G:\SANLEANDRO\1285BANCROFT\FIGURES\VIC-WELL-SURVEY.A1

FIGURE 1

Shell-branded Service Station
 1285 Bancroft Avenue
 San Leandro, California
 Incident #98996067



Vicinity / Area Well Survey Map
 (1/2-Mile Radius)

EXPLANATION	
SB-1	Proposed soil boring location
MW-1	Monitoring well location
	Irrigation well location
B-1	Soil vapor survey location (6/00)

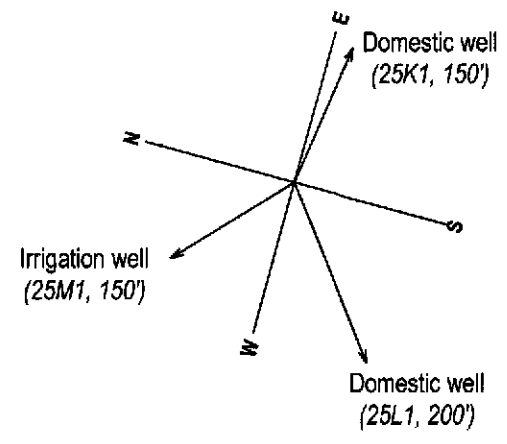

Nearest Sensitive Receptors Relative to Site

City of San Leandro Memorial Park

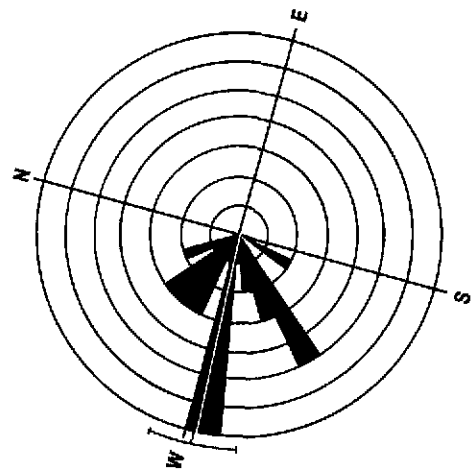

Groundwater Flow Direction (4Q93 through 1Q03)

BANCROFT AVENUE

CALLAN AVENUE

ESTUDILLO AVENUE

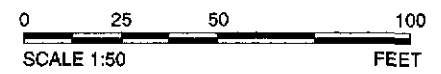
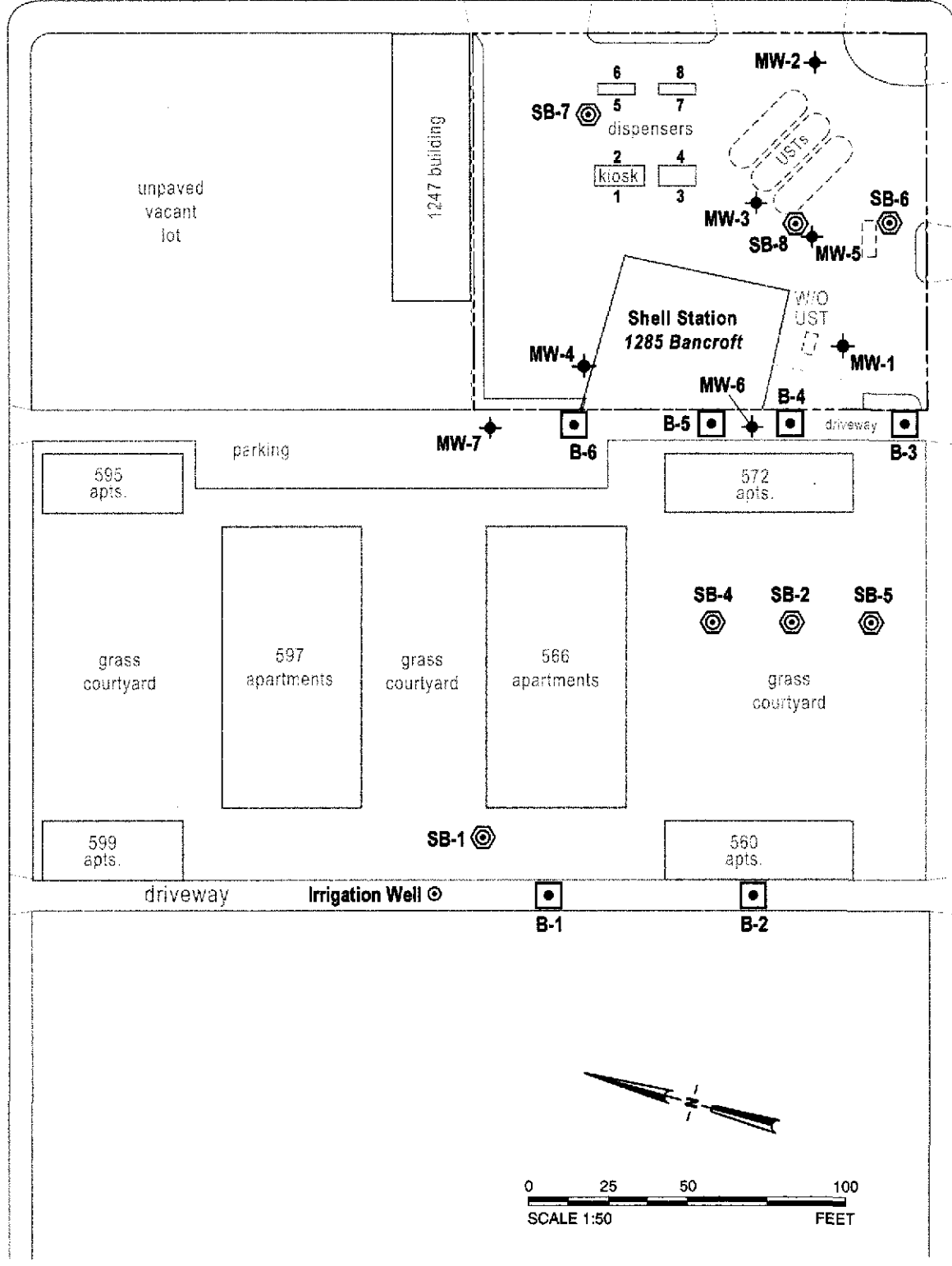

Proposed Soil Boring Location Map



Shell-branded Service Station
 1285 Bancroft Avenue
 San Leandro, California
 Incident #98996067

FIGURE 2

G:\SANLEANDRO\1285BANCROFT\FIGURES\PROP-WELL-9-02.A1