

98 JUN 24 PM 4: 04

June 23, 1998

Ms. Madhulla Logan  
Alameda County Health Care Services Agency  
Department of Environmental Health  
1131 Harbor Bay Parkway, 2nd Floor  
Alameda, CA 94502

Re: May 1998 Semiannual Ground Water Sampling Report  
Mills College Corporation Yard, Oakland, California  
*Project No.: K275-H (982)*

Dear Ms. Logan:

We are pleased to submit our report for the above referenced project. In summary, no significant changes were observed at the site during the May 1998 monitoring event. Should you have any questions or require additional information, please do not hesitate to contact me.

Sincerely,

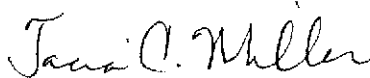
**Harza Engineering Company of California**

*for* Derek Armentrout  
Project Chemist

DA:mac\encl.

Copies: Addressee (1)

Mr. David Johnson (Mills College -1)

Case Officer (Regional Water Quality Control Board -1)

**Harza Engineering Company, Western Division**  
425 Roland Way Oakland, California 94621  
Tel: (510) 568-4001 Fax: (510) 568-2205

K275HRPT.001  
06/23/98

**May 1998 Semiannual  
Ground Water Sampling Report  
Mills College Corporation Yard  
Oakland, California**

June 23, 1998

*Prepared For:*

Mills College  
5000 MacArthur Boulevard  
Oakland, CA 94613

*Prepared By:*

Harza Engineering Company of California  
425 Roland Way  
Oakland, CA 94621

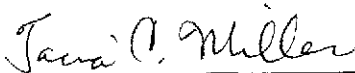

*for* Derek Armentrout  
Project Chemist

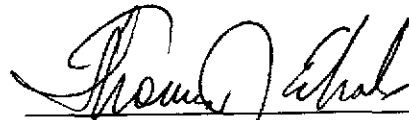

*for* Mark C. Litzau  
Manager, Environmental Services

K275HRPT.001  
06/23/98

**HARZA**

## TABLE OF CONTENTS

1.0	INTRODUCTION.....	1
2.0	BACKGROUND .....	1
3.0	SCOPE OF SERVICES.....	2
4.0	FIELD INVESTIGATION.....	2
4.1	<u>Monitoring Well Sampling</u> .....	2
4.2	<u>Ground Water Gradient</u> .....	2
5.0	ANALYTICAL RESULTS .....	3
5.1	<u>Laboratory Procedures</u> .....	3
5.2	<u>Analytical Results</u> .....	3
6.0	CONCLUSIONS AND RECOMMENDATIONS.....	3
7.0	LIMITATIONS.....	4

### TABLES

1	Ground Water Elevation Data
2	Ground Water Sample Analytical Results

### FIGURES

1	Site Vicinity Map
2	Site Plan

### APPENDIX

A	Laboratory Analytical Reports
---	-------------------------------

# May 1998 Semiannual Ground Water Sampling Report

Mills College Corporation Yard, Oakland, California

## 1.0 INTRODUCTION

This report presents the results of the May 1998 semiannual ground water sampling performed at the Mills College Corporation Yard in Oakland, California. The project location is shown on the Site Vicinity Map (Figure 1).

The purpose of the investigation has been to evaluate the extent of petroleum hydrocarbons in ground water related to a previously removed gasoline underground storage tank (UST) at the site. The investigation included collecting and analyzing ground water samples from five existing monitoring wells. This investigation was performed to comply with the continuing monitoring program under the jurisdiction of Alameda County Health Care Services Agency (ACHCSA).

## 2.0 BACKGROUND

In October 1988, a 1,000-gallon gasoline UST was removed from the Corporation Yard facility. A report prepared by Blaine Tech Services, Inc. of San Jose, California, indicated that soil samples collected from a depth of 21 feet below ground surface (bgs) following tank removal contained moderately high levels of total petroleum hydrocarbons as gasoline (TPHg). It is understood that 100 cubic yards of contaminated soils were excavated from the tank pit area at the time of tank removal and aerated on-site.

Beginning in June 1989, Harza (formerly Kaldveer Associates) performed soil and ground water quality investigations at the site, consisting of the installation and sampling of three ground water monitoring wells (MW-1 through MW-3) and two additional shallow soil borings. The results of these investigations, presented in a report titled *Soil and Ground Water Testing Report for Mills College Corporation Yard*, dated May 7, 1991, indicated that the majority of gasoline contamination in the unsaturated zone in the vicinity of the tanks appeared to have been removed during the soil excavation program conducted when the tanks were removed. Additional wells were installed in May 1994 (MW-4) and April 1995 (MW-5).

Analysis of ground water samples collected from the monitoring wells since June 1989 have indicated the presence of TPHg at concentrations up to 11 parts per million (ppm). The measured ground water flow direction at the site has been toward the south to west-southwest.

### 3.0 SCOPE OF SERVICES

The investigation consisted of the following tasks:

- Measuring ground water levels for use in developing a ground water elevation contour map.
- Collecting ground water samples from the five existing wells at the Corporation Yard.
- Analyzing the ground water samples for TPHg and for purgeable aromatic compounds (benzene, toluene, ethylbenzene, and xylenes [BTEX]).

### 4.0 FIELD INVESTIGATION

#### 4.1 Monitoring Well Sampling

Monitoring wells MW-1 through MW-5 were sampled on May 7, 1998. Following an initial ground water level measurement, a minimum of three well-casing volumes of water were purged from each well using a Teflon bailer. Purging consisted of the gradual removal of water from the well until physical parameters such as pH, temperature, and electrical conductivity (EC) stabilized.

Following purging, samples were collected using a Teflon bailer, placed in appropriate sample containers, labeled, and placed in refrigerated storage for transport to the laboratory under chain-of-custody control. The bailer was washed with trisodium phosphate (TSP) and rinsed with deionized water between wells to reduce the potential for cross contamination. Purge water was contained on-site in 55-gallon drums.

#### 4.2 Ground Water Gradient

Well-top elevations, depth to water, and calculated water-surface elevations are presented in Table 1. These data are used to generate the ground water elevation contours presented on Figure 2. No significant changes were observed from the previous monitoring event.

The water levels are similar in wells MW-1, MW-2, and MW-3, suggesting a flat gradient in this area. However, a relatively steep, west-southwestward gradient is depicted using wells MW-1, MW-4, and MW-5. In our opinion, ground water levels measured in wells MW-1 through MW-3 appear to be influenced by the highly transmissive backfill used in the former tank excavation. Only data from wells MW-1, MW-4, and MW-5 were used to calculate the ground water gradient and flow

direction shown on Figure 2. It is our professional opinion that ground water most likely follows the natural surface topography and flows toward the west or southwest. Wells MW-4 and MW-5 appear sufficient for monitoring downgradient water quality in any of the historically observed or potential ground water flow directions.

## **5.0 ANALYTICAL RESULTS**

### **5.1 Laboratory Procedures**

Ground water samples were analyzed by American Environmental Network (AEN) of Pleasant Hill, California. AEN is certified by the California Environmental Protection Agency for the analyses performed. Samples from each well were analyzed for TPHg using EPA Method 5030/GC-FID, and for BTEX using EPA Method 8020.

### **5.2 Analytical Results**

The results of the chemical analyses are presented in Table 2 and laboratory analytical reports are attached as Appendix A. A historical summary of ground water sample analytical results is also included in Table 2. No significant changes were observed from the previous monitoring event.

TPHg was detected in the sample from well MW-1 at a concentration of 0.51 ppm. BTEX compounds were detected in the sample from MW-1 at concentrations of 0.16, 0.041, 0.045, and 0.022 ppm, respectively. A petroleum odor was recognized during the purging of the well.

Benzene was detected in the sample from well MW-2 at 0.012 ppm, and in the sample from well MW-3 at 0.0049 ppm. TPHg concentrations were below the laboratory method reporting limit (MRL) of 0.05 ppm in these wells. No TPHg or BTEX compounds were detected at or above the MRLs in the samples from wells MW-4 and MW-5.

## **6.0 CONCLUSIONS AND RECOMMENDATIONS**

The May 1998 analytical results are consistent with recent monitoring events, and no significant changes have been observed in ground water quality. The plume does not appear to be migrating significantly, as evidenced by nondetectable levels of contaminants in downgradient wells MW-4 and MW-5. Measured hydrocarbon concentrations appear relatively stable in wells MW-2 and MW-3. Ground water elevations in wells MW-1, MW-4, and MW-5 indicate a general ground water flow direction toward the west-southwest.

Preparation and submittal of reports will continue on a semiannual basis, contingent on ground water quality continuing to exhibit little variation, and on contaminants remaining on-site. The next monitoring event is scheduled for October 1998.

## 7.0 LIMITATIONS

The purpose of a geologic/hydrogeologic study is to reasonably characterize existing site conditions based on the geology/hydrogeology of the area. In performing such a study, a balance must be struck between a reasonable investigation into the site conditions and an exhaustive analysis of each conceivable condition. The following paragraphs discuss the assumptions and parameters under which such a study is conducted.

No investigation is thorough enough to detect every geologic/hydrogeologic condition of interest at a given site. If conditions have not been identified during the study, such a finding should not therefore be construed as a guarantee of the absence of such conditions at the site, but rather as the result of the services performed within the scope, limitations, and cost of the work performed.

We are unable to report on or accurately predict events that may change the site conditions after the described services are performed, whether occurring naturally or caused by external forces. We cannot assume responsibility for conditions we were not authorized to evaluate, or conditions not generally recognized as predictable when services were performed.

Geologic/hydrogeologic conditions may exist at the site that cannot be identified solely by visual observation. Where subsurface exploratory work was performed, our professional opinions are based in part on interpretation of data from discrete sampling locations that may not represent actual conditions at unsampled locations.

**TABLES**

---

**HARZA**



**TABLE 1**  
**Ground Water Elevation Data**  
 May 1998 Semiannual Ground Water Sampling Report  
 Mills College Corporation Yard, Oakland, California  
 (Reported in Feet)

Date	Monitoring Well	Relative Well-Top Elevation <sup>(1)</sup>	Depth to Water	Ground Water Elevation
June 1989	MW-1	100.00	19.44	80.56
	MW-2	99.98	19.36	80.62
	MW-3	100.01	19.40	80.61
December 1990	MW-1	100.00	22.05	77.95
	MW-2	99.98	21.96	78.02
	MW-3	100.01	22.00	78.01
June 1991	MW-1	100.00	20.85	79.15
	MW-2	99.98	20.76	79.22
	MW-3	100.01	20.81	79.20
March 1992	MW-1	100.00	19.87	80.13
	MW-2	99.98	19.92	80.06
	MW-3	100.01	19.82	80.19
October 1992	MW-1	100.00	21.69	78.31
	MW-2	99.98	21.60	78.38
	MW-3	100.01	21.65	78.36
May 1994	MW-1	100.00	19.66	80.34
	MW-2	99.98	19.62	80.36
	MW-3	100.01	19.60	80.41
	MW-4	88.88	13.60	75.28
June 1994	MW-1	100.00	19.72	80.28
	MW-2	99.98	19.65	80.33
	MW-3	100.01	19.65	80.36
	MW-4	88.88	14.01	74.87
October 1994	MW-1	100.00	20.17	79.83
	MW-2	99.98	20.10	79.88
	MW-3	100.01	20.08	79.93
	MW-4	88.88	17.95	70.93
January 1995	MW-1	100.00	17.46	82.54
	MW-2	99.98	17.48	82.50
	MW-3	100.01	17.30	82.71
	MW-4	88.88	10.76	78.12
May 1995	MW-1	100.00	15.56	84.44
	MW-2	99.98	15.75	84.23
	MW-3	100.01	15.50	84.51
	MW-4	88.88	9.25	79.63
	MW-5	99.98	27.66	72.32

**TABLE 1**  
**Ground Water Elevation Data**  
 May 1998 Semiannual Ground Water Sampling Report  
 Mills College Corporation Yard, Oakland, California  
 (Reported in Feet)

Date	Monitoring Well	Relative Well-Top Elevation <sup>(1)</sup>	Depth to Water	Ground Water Elevation
October 1995	MW-1	100.00	18.68	81.32
	MW-2	99.98	18.21	81.77
	MW-3	100.01	18.62	81.39
	MW-4	88.88	14.65	74.23
	MW-5	99.98	28.36	71.62
May 1996	MW-1	100.00	15.92	84.08
	MW-2	99.98	15.70	84.28
	MW-3	100.01	15.83	84.18
	MW-4	88.88	9.55	79.33
	MW-5	99.98	25.51	74.47
September 1996	MW-1	100.00	17.74	82.26
	MW-2	99.98	17.67	82.31
	MW-3	100.01	17.64	82.37
	MW-4	88.88	14.59	74.29
	MW-5	99.98	27.83	72.15
April 1997	MW-1	100.00	16.91	83.09
	MW-2	99.98	16.82	83.16
	MW-3	100.01	16.83	83.18
	MW-4	88.88	11.77	77.11
	MW-5	99.98	26.93	73.05
October 1997	MW-1	100.00	19.00	81.00
	MW-2	99.98	18.96	81.02
	MW-3	100.01	18.98	81.03
	MW-4	88.88	16.10	72.78
	MW-5	99.98	31.25	68.73
May 1998	MW-1	100.00	14.36	85.64
	MW-2	99.98	14.37	85.61
	MW-3	100.01	14.11	85.90
	MW-4	88.88	8.84	80.04
	MW-5	99.98	23.38	76.60

NOTE

<sup>(1)</sup> Well-top elevations are based on an arbitrary datum of 100.00 feet at MW-1.

**TABLE 2**  
**Ground Water Sample Analytical Results**  
 May 1998 Semiannual Ground Water Sampling Report  
 Mills College Corporation Yard, Oakland, California

Sample ID	Sample Date	TPHg ppm	Benzene ppm	Toluene ppm	Ethylbenzene ppm	Xylenes ppm
MW-1	June 1989	11.	2.1	1.9	0.031	1.4
	December 1990	2.5	0.4	0.21	0.056	0.31
	June 1991	16.	2.0	1.1	0.41	2.8
	March 1992	1.6	0.26	0.1	0.47	0.12
	October 1992	2.8	0.33	0.13	0.06	0.2
	October 1992 (D)	4.2	0.54	0.23	0.08	0.36
	May 1994	3.4	0.6	0.11	0.11	0.15
	October 1994	8.7	1.0	0.29	0.14	0.36
	January 1995	5.9	1.5	0.088	0.13	0.14
	April 1995	3.4	0.78	0.34	0.1	0.21
	October 1995	0.87	0.092	0.026	0.041	0.025
	May 1996	1.0	0.2	0.068	0.035	0.05
	September 1996	1.5	0.27	0.073	0.064	0.0095
	April 1997	0.6	0.12	0.027	0.024	0.028
	October 1997	1.0	0.16	0.036	0.035	0.07
	May 1998	0.51	0.16	0.041	0.045	0.022
MW-2	June 1989	ND	ND	ND	ND	ND
	December 1990	ND	ND	ND	ND	ND
	June 1991	ND	0.005	0.0005	ND	ND
	March 1992	0.09	0.047	ND	ND	ND
	October 1992	ND	0.003	0.0006	ND	ND
	May 1994	0.2	0.084	ND	ND	ND
	October 1994	0.2	0.13	ND	ND	ND
	January 1995	0.7	0.21	ND	ND	ND
	May 1995	ND	0.004	ND	ND	ND
	October 1995	0.2	0.11	ND	ND	ND
	May 1996	0.2	0.086	ND	0.001	ND
	September 1996	0.09	0.059	ND	ND	ND
	April 1997	ND	0.022	ND	ND	ND
	October 1997	ND	0.022	ND	ND	ND
May 1998	ND	0.012	ND	ND	ND	
MW-3	June 1989	ND	ND	ND	ND	ND
	December 1990	0.05	0.011	ND	ND	ND
	June 1991	0.1	0.007	ND	ND	ND
	March 1992	0.09	0.27	0.0009	ND	ND
	October 1992	ND	0.005	ND	ND	ND

**TABLE 2**  
**Ground Water Sample Analytical Results**  
 May 1998 Semiannual Ground Water Sampling Report  
 Mills College Corporation Yard, Oakland, California

Sample ID	Sample Date	TPHg ppm	Benzene ppm	Toluene ppm	Ethylbenzene ppm	Xylenes ppm
<b>MW-3</b> (continued)	May 1994	ND	0.005	ND	ND	ND
	October 1994	ND	0.004	ND	ND	ND
	January 1995	ND	0.012	ND	ND	ND
	May 1995	0.07	0.006	ND	ND	ND
	October 1995	ND	0.002	ND	ND	0.002
	May 1996	ND	0.007	ND	ND	ND
	September 1996	ND	0.012	ND	ND	ND
	April 1997	ND	0.043	ND	ND	ND
	October 1997	ND	0.0057	ND	ND	ND
	May 1998	ND	0.0049	ND	ND	ND
<b>MW-4</b>	May 1994	ND	ND	ND	ND	ND
	June 1994	ND	ND	ND	ND	ND
	October 1994	ND	ND	ND	ND	ND
	January 1995	ND	ND	ND	ND	ND
	May 1995	ND	ND	ND	ND	ND
	October 1995	ND	ND	ND	ND	ND
	May 1996	ND	ND	ND	ND	ND
	September 1996	ND	ND	ND	ND	ND
	April 1997	ND	ND	ND	ND	ND
	October 1997	ND	ND	ND	ND	ND
	May 1998	ND	ND	ND	ND	ND
<b>MW-5</b>	April 1995	ND	ND	ND	ND	ND
	October 1995	ND	ND	ND	ND	ND
	May 1996	ND	ND	ND	ND	ND
	September 1996	ND	ND	ND	ND	ND
	April 1997	ND	ND	ND	ND	ND
	October 1997	ND	ND	ND	ND	ND
	May 1998	ND	ND	ND	ND	ND

NOTES

- TPHg: Total petroleum hydrocarbons as gasoline
- ppm: Parts per million or milligrams per liter
- ND: Not detected at or above the laboratory method reporting limits
- (D): Duplicate sample analytical results

**FIGURES**

---

**HARZA**



Approximate Scale In Miles

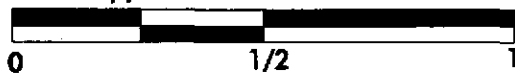

BASE: By U.S.G.S. Oakland East, California, 7.5 Min. Quadrangle Topography.

E275G1

Date	<b>HARZA</b>	SITE VICINITY MAP	Figure
12/97		MILLS COLLEGE CORPORATION YARD FACILITY Oakland, California	1
Project No. K275-H			

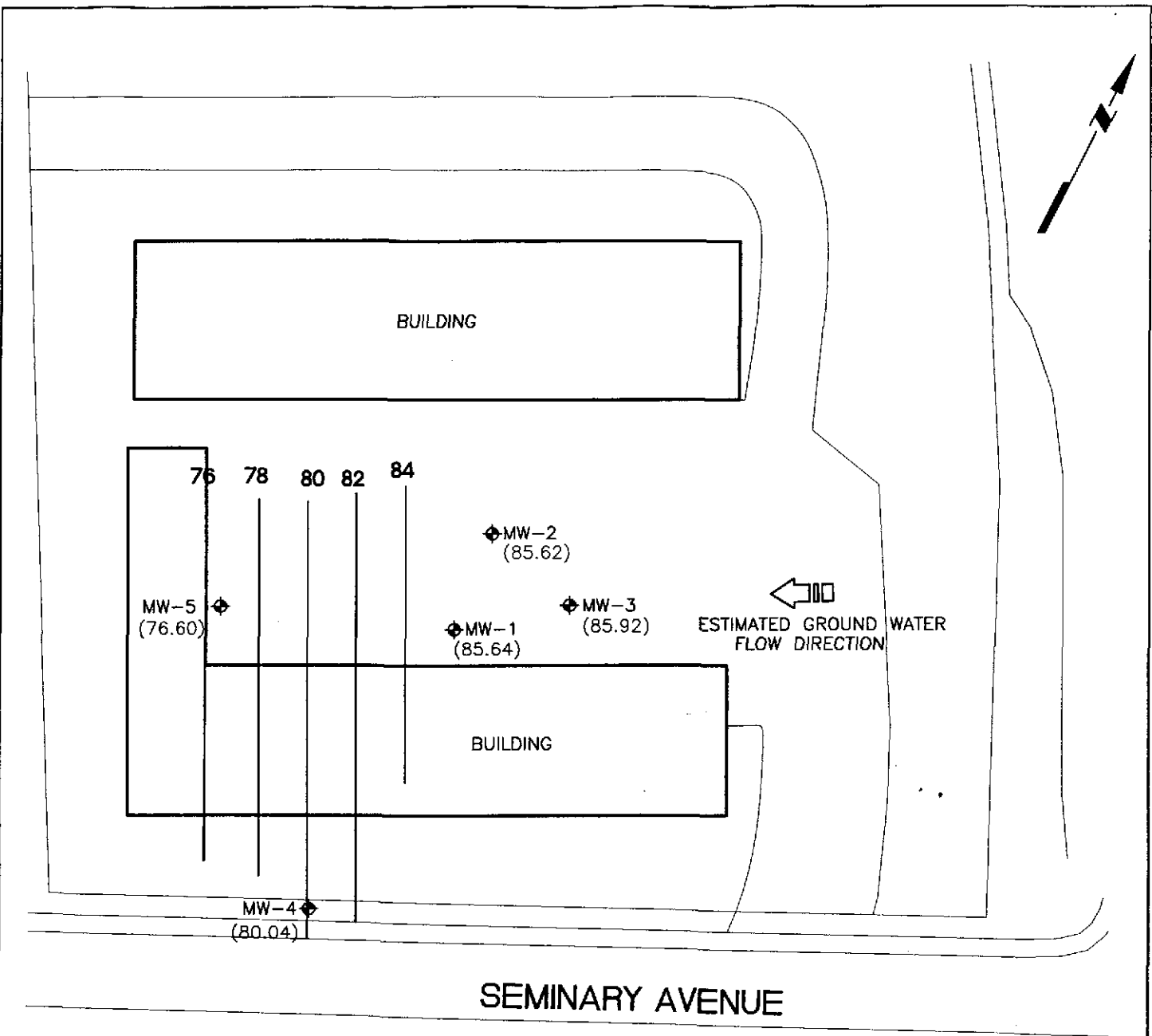

SEMINARY AVENUE

**LEGEND**

- MW-5 ◊ MONITORING WELL LOCATION WITH RELATIVE GROUND WATER ELEVATION MEASURED 5/7/97
- 74 ——— GROUND WATER CONTOUR

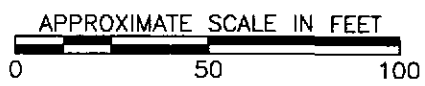

G:\ACAD\CADWORK\EK275H\98-5-2

Rev.	Drawn By	Chk'd By	Date
0	H.H.	M.A.	6/4/98

**HARZA**

SITE PLAN	Figure
MILLS COLLEGE CORPORATION YARD FACILITY Oakland, California	<b>2</b> Project No. K275-H

**APPENDIX A**  
Laboratory Analytical Reports

---

**HARZA**



# American Environmental Network

## Certificate of Analysis

DOHS Certification: 1172

AIHA Accreditation: 11134

PAGE 1

HARZA  
425 ROLAND WAY  
OAKLAND, CA 94621

ATTN: MARY ANDERS  
CLIENT PROJ. ID: K275-H  
CLIENT PROJ. NAME: MILLS COLLEGE

REPORT DATE: 05/19/98

DATE(S) SAMPLED: 05/07/98

DATE RECEIVED: 05/07/98

AEN WORK ORDER: 9805082

### PROJECT SUMMARY:

On May 7, 1998, this laboratory received 5 water sample(s).

Client requested sample(s) be analyzed for chemical parameters. Results of analysis are summarized on the following page(s). Please see quality control report for a summary of QC data pertaining to this project.

Samples will be stored for 30 days after completion of analysis, then disposed of in accordance with State and Federal regulations. Samples may be archived by prior arrangement.

If you have any questions, please contact Client Services at (510) 930-9090.

Reviewed by:



## HARZA

SAMPLE ID: MW-1  
AEN LAB NO: 9805082-01  
AEN WORK ORDER: 9805082  
CLIENT PROJ. ID: K275-H

DATE SAMPLED: 05/07/98  
DATE RECEIVED: 05/07/98  
REPORT DATE: 05/19/98

---

ANALYTE	METHOD/ CAS#	RESULT	REPORTING LIMIT	UNITS	DATE ANALYZED
BTEX & Gasoline HCs	EPA 8020				
Benzene	71-43-2	160 *	0.5	ug/L	05/14/98
Toluene	108-88-3	41 *	0.5	ug/L	05/14/98
Ethylbenzene	100-41-4	45 *	0.5	ug/L	05/14/98
Xylenes, Total	1330-20-7	22 *	2	ug/L	05/14/98
Purgeable HCs as Gasoline	5030/GCFID	0.51 *	0.05	mg/L	05/14/98

ND = Not detected at or above the reporting limit  
\* = Value at or above reporting limit

## HARZA

SAMPLE ID: MW-2  
AEN LAB NO: 9805082-02  
AEN WORK ORDER: 9805082  
CLIENT PROJ. ID: K275-H

DATE SAMPLED: 05/07/98  
DATE RECEIVED: 05/07/98  
REPORT DATE: 05/19/98

---

ANALYTE	METHOD/ CAS#	RESULT	REPORTING LIMIT	UNITS	DATE ANALYZED
BTEX & Gasoline HCs	EPA 8020				
Benzene	71-43-2	12 *	0.5	ug/L	05/14/98
Toluene	108-88-3	ND	0.5	ug/L	05/14/98
Ethylbenzene	100-41-4	ND	0.5	ug/L	05/14/98
Xylenes, Total	1330-20-7	ND	2	ug/L	05/14/98
Purgeable HCs as Gasoline	5030/GCFID	ND	0.05	mg/L	05/14/98

---

ND = Not detected at or above the reporting limit  
\* = Value at or above reporting limit

## HARZA

SAMPLE ID: MW-3  
AEN LAB NO: 9805082-03  
AEN WORK ORDER: 9805082  
CLIENT PROJ. ID: K275-H

DATE SAMPLED: 05/07/98  
DATE RECEIVED: 05/07/98  
REPORT DATE: 05/19/98

ANALYTE	METHOD/ CAS#	RESULT	REPORTING LIMIT	UNITS	DATE ANALYZED
BTEX & Gasoline HCs	EPA 8020				
Benzene	71-43-2	4.9 *	0.5	ug/L	05/14/98
Toluene	108-88-3	ND	0.5	ug/L	05/14/98
Ethylbenzene	100-41-4	ND	0.5	ug/L	05/14/98
Xylenes, Total	1330-20-7	ND	2	ug/L	05/14/98
Purgeable HCs as Gasoline	5030/GCFID	ND	0.05	mg/L	05/14/98

ND = Not detected at or above the reporting limit

\* = Value at or above reporting limit

## HARZA

SAMPLE ID: MW-3  
AEN LAB NO: 9805082-03  
AEN WORK ORDER: 9805082  
CLIENT PROJ. ID: K275-H

DATE SAMPLED: 05/07/98  
DATE RECEIVED: 05/07/98  
REPORT DATE: 05/19/98

ANALYTE	METHOD/ CAS#	RESULT	REPORTING LIMIT	UNITS	DATE ANALYZED
BTEX & Gasoline HCs	EPA 8020				
Benzene	71-43-2	4.9 *	0.5	ug/L	05/14/98
Toluene	108-88-3	ND	0.5	ug/L	05/14/98
Ethylbenzene	100-41-4	ND	0.5	ug/L	05/14/98
Xylenes, Total	1330-20-7	ND	2	ug/L	05/14/98
Purgeable HCs as Gasoline	5030/GCFID	ND	0.05	mg/L	05/14/98

ND = Not detected at or above the reporting limit

\* = Value at or above reporting limit

## HARZA

SAMPLE ID: MW-4  
AEN LAB NO: 9805082-04  
AEN WORK ORDER: 9805082  
CLIENT PROJ. ID: K275-H

DATE SAMPLED: 05/07/98  
DATE RECEIVED: 05/07/98  
REPORT DATE: 05/19/98

---

ANALYTE	METHOD/ CAS#	RESULT	REPORTING LIMIT	UNITS	DATE ANALYZED
BTEX & Gasoline HCs	EPA 8020				
Benzene	71-43-2	ND	0.5	ug/L	05/14/98
Toluene	108-88-3	ND	0.5	ug/L	05/14/98
Ethylbenzene	100-41-4	ND	0.5	ug/L	05/14/98
Xylenes, Total	1330-20-7	ND	2	ug/L	05/14/98
Purgeable HCs as Gasoline	5030/GCFID	ND	0.05	mg/L	05/14/98

---

ND = Not detected at or above the reporting limit  
\* = Value at or above reporting limit

## HARZA

SAMPLE ID: MW-5  
AEN LAB NO: 9805082-05  
AEN WORK ORDER: 9805082  
CLIENT PROJ. ID: K275-H

DATE SAMPLED: 05/07/98  
DATE RECEIVED: 05/07/98  
REPORT DATE: 05/19/98

---

ANALYTE	METHOD/ CAS#	RESULT	REPORTING LIMIT	UNITS	DATE ANALYZED
BTEX & Gasoline HCs	EPA 8020				
Benzene	71-43-2	ND	0.5	ug/L	05/14/98
Toluene	108-88-3	ND	0.5	ug/L	05/14/98
Ethylbenzene	100-41-4	ND	0.5	ug/L	05/14/98
Xylenes, Total	1330-20-7	ND	2	ug/L	05/14/98
Purgeable HCs as Gasoline	5030/GCFID	ND	0.05	mg/L	05/14/98

---

ND = Not detected at or above the reporting limit  
\* = Value at or above reporting limit

AEN (CALIFORNIA)  
QUALITY CONTROL REPORT

AEN JOB NUMBER: 9805082

CLIENT PROJECT ID: K275-H

Quality Control and Project Summary

All laboratory quality control parameters were found to be within established limits.

Definitions

Laboratory Control Sample (LCS)/Method Spike(s): Control samples of known composition. LCS and Method Spike data are used to validate batch analytical results.

Matrix Spike(s): Aliquot of a sample (aqueous or solid) with added quantities of specific compounds and subjected to the entire analytical procedure. Matrix spike and matrix spike duplicate QC data are advisory.

Method Blank: An analytical control consisting of all reagents, internal standards, and surrogate standards carried through the entire analytical process. Used to monitor laboratory background and reagent contamination.

Not Detected (ND): Not detected at or above the reporting limit.

Relative Percent Difference (RPD): An indication of method precision based on duplicate analysis.

Reporting Limit (RL): The lowest concentration routinely determined during laboratory operations. The RL is generally 1 to 10 times the Method Detection Limit (MDL). Reporting limits are matrix, method, and analyte dependent and take into account any dilutions performed as part of the analysis.

Surrogates: Organic compounds which are similar to analytes of interest in chemical behavior, but are not found in environmental samples. Surrogates are added to all blanks, calibration and check standards, samples, and spiked samples. Surrogate recovery is monitored as an indication of acceptable sample preparation and instrumental performance.

D: Surrogates diluted out.

#: Indicates result outside of established laboratory QC limits.



## QUALITY CONTROL DATA

METHOD: EPA 8020, 5030 GCFID

AEN JOB NO: 9805082  
 INSTRUMENT: F  
 MATRIX: WATER

## Surrogate Standard Recovery Summary

Date Analyzed	Client Id.	Lab Id.	Percent Recovery
			Fluorobenzene
05/14/98	MW-1	01	104
05/14/98	MW-2	02	98
05/14/98	MW-3	03	97
05/14/98	MW-4	04	96
05/14/98	MW-5	05	96

QC Limits: 70-130

DATE ANALYZED: 05/14/98  
 SAMPLE SPIKED: LCS  
 INSTRUMENT: F

## Laboratory Control Sample Recovery

Analyte	Spike Added (ug/L)	Percent Recovery	RPD	QC Limits	
				Percent Recovery	RPD
Benzene	200	107	<1	70-130	20
Toluene	200	109	<1	70-130	20
Ethylbenzene	200	109	1	70-130	20
Total Xylenes	600	109	<1	70-130	20

Daily method blanks for all associated analytical runs showed no contamination at or above the reporting limit.

\*\*\* END OF REPORT \*\*\*

R353

Contact: Derek Armentrout

**HARZA** Consulting Engineers and Scientists  
425 Roland Way (510) 568-4001  
Oakland, CA 94621 (510) 568-2205 Fax

Project Number  
K275-17

Lab Project Number  
9805082

Project Name  
Mills College

Sampler's Name (printed)  
M. Anders

Harza Sample ID	Lab Sample ID	Date	Time	Sample Type	Number/Type of Container
<u>MW-1</u>	<u>1ABC</u>	<u>5/7/98</u>	<u>1300</u>	<u>WTR</u>	<u>(3) VOAs</u>
<u>MW-2</u>	<u>2ABC</u>	↓	<u>1225</u>	↓	↓
<u>MW-3</u>	<u>3ABC</u>	↓	<u>1152</u>	↓	↓
<u>MW-4</u>	<u>4ABC</u>	↓	<u>1045</u>	↓	↓
<u>MW-5</u>	<u>5ABC</u>	↓	<u>1120</u>	↓	↓

TPH as Gasoline / BTEX  
 TPH as Diesel / Motor Oil / Fuel Scan /  
 Method 418.1 - TPH  
 Method 8240 - Volatile Organic Compounds  
 Method 8010 - Halogenated VOCs  
 Method 8020 - BTEX  
 Method 8270 - Semivolatile Organic Compounds  
 Method 8080 - Organochlorine Pesticides / PCBs  
 Metals

Remarks

Relinquished by: (Signature) [Signature]

Date 5/7/98 Time 16:50

Received by: (Signature) Rich Gilmore

Date 5-7-98 Time 16:50

Relinquished by: (Signature) Rich Gilmore

Date 5-7-98 Time 18:35

Received by: (Signature) Greg Glaser

Date 5/7 Time 1835

Relinquished by: (Signature)

Date

Received by: (Signature)

Date

Requested Turnaround Time:  Standard  3-Day  2-Day  24-Hour  other

FAX Results

NOTES Bill Mills College DIRECTLY