

ALAMEDA COUNTY  
HEALTH CARE SERVICES

AGENCY  
DAVID J. KEARS, Agency Director



June 19, 2001

Scott DeMuth  
Sears, Roebuck, & Co.  
333 Beverly Rd., Dept. 824ev, A2-245A  
Hoffman Estates, IL 60179

ENVIRONMENTAL HEALTH SERVICES  
ENVIRONMENTAL PROTECTION  
1131 Harbor Bay Parkway, Suite 250  
Alameda, CA 94502-6577  
(510) 567-6700  
FAX (510) 337-9335

Dear Mr. DeMuth:

Subject: Sears Store #1039, 1911 Telegraph Ave., Oakland, CA 94612  
RO0000508 147

"4<sup>th</sup> Quarter 2000, Groundwater Monitoring and Sampling Report" dated January 9, 2001 by IT Corporation was reviewed. Monitoring wells MW-1, MW-2, MW-3, MW-4, MW-5, MW-6 MW-7, MW-8, and MW-9 were sampled on November 6, 2000 and analyzed for total petroleum hydrocarbons as gasoline (TPH-G), benzene, toluene, ethyl benzene, xylene (BTEX), methyl tertiary-butyl ether (MTBE), and halocarbons. Monitoring well MW-7 continues to have the highest concentrations of TPH-G and BTEX. MW-7 had 6,000 ug/l TPH-G, 3,400 ug/l, 29 ug/l, 230 ug/l, and 330 ug/l BTEX. All purgeable halocarbon concentrations were less than the Oakland Tier 1 Risk Based Screening Levels (RBSL) for groundwater inhalation of indoor and outdoor air vapors, commercial/industrial land use, carcinogenic risk. Oil & grease was analyzed for MW-4 and MW-6 samples. The concentrations for oil & grease for MW-4 and MW-6 was <1,000 ug/l, same as for the prior quarter.

Concentrations of TPH-G and benzene in MW-7 have not shown a decline. Therefore, if the results for MW-7 for the next round of sampling are consistent with those obtained recently, then a Corrective Action Plan, which includes an assessment of impacts, a feasibility study, and applicable cleanup levels should be considered. Also, well installation information for monitoring wells MW-1, MW-5, MW-6, and MW-7, requested in our letters dated December 13, 1990 and December 1, 2000 have not been provided. (In regards to MW-1, a letter dated January 11, 1991 by Dames & Moore referred us to their report entitled "Toxics and Underground Tank Removals, Post Construction Report, Emporium Capwell, Oakland, CA" dated March 21, 1988. This report lacked construction details.) If you have any questions, please call me at (510) 567-6746.

Sincerely,

Don Hwang  
Hazardous Materials Specialist

u  
C: David Bero, IT Corporation, 4005 Port Chicago Highway, Concord, CA 94520-1120  
File

ALAMEDA COUNTY  
HEALTH CARE SERVICES

AGENCY  
DAVID J. KEARS, Agency Director



ENVIRONMENTAL HEALTH SERVICES  
ENVIRONMENTAL PROTECTION  
1131 Harbor Bay Parkway, Suite 250  
Alameda, CA 94502-6577  
(510) 567-6700  
FAX (510) 337-9335

December 1, 2000

Scott DeMuth  
Sears, Roebuck, & Co.  
333 Beverly Rd., Dept. 824ev, A2-245A  
Hoffman Estates, IL 60179

Dear Mr. DeMuth:

Subject: Sears Store #1039, 1911 Telegraph Ave., Oakland, CA 94612  
StId 1650

A review of the Leaking Underground Storage Tank Oversight Program (LOP) file for the aforementioned site did not find well installation information for monitoring wells, MW-5, MW-6, and MW-7. Please submit the well installation report for monitoring wells, MW-5, MW-6, and MW-7. The report should include at a minimum:

- A. The drilling method for the construction of the monitoring wells and decontamination procedures.
1. Depth and diameter of the monitoring wells.
  2. The sampling method and the sampling interval for the borings.
  3. Soil classification system.
  4. The well design and construction specifications.
  5. Depth interval and type of seal.
  6. Construction diagram for the wells.
  7. Well development method and criteria used for assessing adequacy of development.
  8. Plans for characterizing and disposing of cutting spoils logs and development water.
  9. Surveying plan for wells installation diagrams.

If you have any questions, please call me at (510) 567-6746.

Sincerely,

Don Hwang  
Hazardous Materials Specialist

*u*  
✓ C: file

LOP - CHANGE RECORD REQUEST FORM

printed:  
02/01/2000

Mark Out What Needs Changing and Hand to LOP Data Entry  
(Name/Address changes go to Annual Programs Data Entry)

Insp:

AGENCY # : 10000      SOURCE OF FUNDS: F      SUBSTANCE: 12035  
 StID : 1630      LOC:  
 SITE NAME: Capwell's Chevron      DATE REPORTED : 02/23/1988  
 ADDRESS : 1911 Telegraph Ave      DATE CONFIRMED: 02/23/1988  
 CITY/ZIP : Oakland      94612      MULTIPLE RPs : Y

SITE STATUS

CASE TYPE: S CONTRACT STATUS: 9      PRIOR CODE:1C2      EMERGENCY RESP:  
 RP SEARCH: S      DATE COMPLETED: 03/13/1992  
 PRELIMINARY ASMNT: C      DATE UNDERWAY: 03/21/1988      DATE COMPLETED: 12/05/1990  
 REM INVESTIGATION: C      DATE UNDERWAY: 03/21/1988      DATE COMPLETED: 02/08/1991  
 REMEDIAL ACTION: C      DATE UNDERWAY: 02/23/1988      DATE COMPLETED: 03/23/1988  
 POST REMED ACT MON: C      DATE UNDERWAY: 03/23/1988      DATE COMPLETED: 04/12/1988

ENFORCEMENT ACTION TYPE: 2      DATE ENFORCEMENT ACTION TAKEN: 06/22/1995  
 LUFT FIELD MANUAL CONSID: 2HSCA  
 CASE CLOSED:      DATE CASE CLOSED:  
 DATE EXCAVATION STARTED : 02/22/1988      REMEDIAL ACTIONS TAKEN: ED,ET

RESPONSIBLE PARTY INFORMATION

RP#1-CONTACT NAME: Nick Carpenter  
 COMPANY NAME: Emporium Capwell Co.  
 ADDRESS: 3880 N. Mission Rd.  
 CITY/STATE: Los Angeles, Ca 90031-3179

RP#2-CONTACT NAME: Scott M. Demuth  
 COMPANY NAME: Sears, Roebuck & Co.  
 ADDRESS: 3333 Beverly Rd. Dep 824c  
 CITY/STATE: Hoffman Estates, IL 60179

INSPECTOR VERIFICATION:

NAME _____	SIGNATURE _____	DATE _____
------------	-----------------	------------

DATA ENTRY INPUT:

Name/Address Changes Only

Case Progress Changes

ANPNPGMS \_\_\_\_\_ LOP \_\_\_\_\_ DATE \_\_\_\_\_

LOP \_\_\_\_\_ DATE \_\_\_\_\_

Page 1 925-288-2117

white -env.health  
yellow -facility  
pink -files

ALAMEDA COUNTY, DEPARTMENT OF ENVIRONMENTAL HEALTH  
Hazardous Materials Inspection Form

80 Swan Way, #200  
Oakland, CA 94621  
(415) 271-4320

II, III

Site ID # 1130 Site Name Sears Today's Date 11/02/99

II.A BUSINESS PLANS (Title 19)

- \_\_\_ 1. Immediate Reporting 2703
- \_\_\_ 2. Bus. Plan Stds 25503(b)
- \_\_\_ 3. RR Cars > 30 days 25503.7
- \_\_\_ 4. Inventory Information 25504(a)
- \_\_\_ 5. Inventory Complete 2730
- \_\_\_ 6. Emergency Response 25504(b)
- \_\_\_ 7. Training 25504(c)
- \_\_\_ 8. Deficiency 25505(d)
- \_\_\_ 9. Modification 25505(b)

Site Address 1911 Telegraph Ave.

City Oakland Zip 94612 Phone \_\_\_\_\_

\_\_\_ MAX AMT stored > 500 lbs, 55 gal., 200 cft.?

Inspection Categories:

- \_\_\_ I. Haz. Mat/Waste GENERATOR/TRANSPORTER
- \_\_\_ II. Business Plans, Acute Hazardous Materials
- \_\_\_ III. Underground Tanks

II.B ACUTELY HAZ. MATLS

- \_\_\_ 10. Registration Form Filed 25533(a)
- \_\_\_ 11. Form Complete 25533(b)
- \_\_\_ 12. RMPP Contents 25534(c)
- \_\_\_ 13. Implement Sch. Req'd? (Y/N) \_\_\_\_\_
- \_\_\_ 14. OnSite Conseq. Assess 25524(c)
- \_\_\_ 15. Probable Risk Assessment 25534(d)
- \_\_\_ 16. Persons Responsible 25534(g)
- \_\_\_ 17. Certification 25534(f)
- \_\_\_ 18. Exemption Request? (Y/N) 25536(b)
- \_\_\_ 19. Trade Secret Requested? 25538

\* Calif. Administration Code (CAC) or the Health & Safety Code (HS&C)

III. UNDERGROUND TANKS (Title 23)

- |                               |   |      |
|-------------------------------|---|------|
| General                       | ___ 1. Permit Application 25284 (H&S)   |      |
|                               | ___ 2. Pipeline Leak Detection 25292 (H&S)  |      |
|                               | ___ 3. Records Maintenance 2712   |      |
|                               | ___ 4. Release Report 2651  |      |
|                               | ___ 5. Closure Plans 2670   |      |
| Monitoring for Existing Tanks | ___ 6. Method   |      |
|                               | 1) Monthly Test   |      |
|                               | 2) Daily Vadose<br>Semi-annual groundwater<br>One time soils                            | 10   |
|                               | 3) Daily Vadose<br>One time soils<br>Annual tank test                                   | 25   |
|                               | 4) Monthly Groundwater<br>One time soils  | 30   |
|                               | 5) Daily Inventory<br>Annual tank testing<br>Cont pipe leak det<br>Vadose/gndwater mon. | 10   |
|                               | 6) Daily Inventory<br>Annual tank testing<br>Cont pipe leak det                         | 45   |
|                               | 7) Weekly Tank Gauge<br>Annual tank testing   | 47   |
|                               | 8) Annual Tank Testing<br>Daily Inventory   |      |
|                               | 9) Other  |      |
| New Tanks                     | ___ 7. Precs Tank Test<br>Date: _____   | 2643 |
|                               | ___ 8. Inventory Rec.   | 2644 |
|                               | ___ 9. Soil Testing   | 2646 |
|                               | ___ 10. Ground Water.   | 2647 |
|                               | ___ 11. Monitor Plan  | 2632 |
|                               | ___ 12. Access, Secure  | 2634 |
|                               | ___ 13. Plans Submit<br>Date: _____   | 2711 |
|                               | ___ 14. As Built<br>Date: _____   | 2635 |

Comments:  
 Came out to site @ 8 AM to oversee drilling of Wells MW-8 and MW-8.  
 Met David Foley, IT Corp (925-288-2117) and Gregg Drilling was set out at site.  
 Blow counts for 5' sample in MW-8 were (5, 8, 10). (3 1/2 - 5'). Soil sample collected for analysis from 4 1/2 to 5'. Sample was a silty clay. No apparent odor or stains.  
 Next soil sample for analysis was collected from 9 1/2' bgs. Fine sand w/ no odor or staining. Blow counts for sample collected from 14 1/2' bgs were (10, 45, 47). Sample was a silty sand w/ no odor or stains (slightly moist). Soil sample was collected from 15' to 16 1/2' bgs in order to collect a capillary fringe sample (Blow counts were 15, 30, 35). Wasn't certain if the 16 1/2' soil sample was an adequate capillary fringe soil sample, so they will drive another sample from 16 1/2' to 18' bgs for observation.

Contact: David Foley, IT Corp.

Title: \_\_\_\_\_  
 Signature: [Signature]

Inspector: Juliet Shin

Signature: [Signature]

II, III

Pg 2

white -env.health  
yellow -facility  
pink -files

# ALAMEDA COUNTY, DEPARTMENT OF ENVIRONMENTAL HEALTH

80 Swan Way, #200  
Oakland, CA 94621  
(415) 271-4320

## Hazardous Materials Inspection Form

II, III

Site ID # 1630 Site Name Sears Today's Date 11/02/99

### II.A BUSINESS PLANS (Title 19)

- 1. Immediate Reporting 2703
- 2. Bus Plan Stds 25503(b)
- 3. RR Cars > 30 days 25503.7
- 4. Inventory Information 25504(a)
- 5. Inventory Complete 2730
- 6. Emergency Response 25504(b)
- 7. Training 25504(c)
- 8. Deficiency 25505(a)
- 9. Modification 25505(b)

Site Address 1911 Telegraph Ave.

City Oakland Zip 94612 Phone \_\_\_\_\_

\_\_\_ MAX AMT stored > 500 lbs, 55 gal., 200 cft.?

### Inspection Categories:

- I. Haz. Mat/Waste GENERATOR/TRANSPORTER
- II. Business Plans, Acute Hazardous Materials
- III. Underground Tanks

### II.B ACUTELY HAZ. MATLS

- 10. Registration Form Filed 25533(a)
- 11. Form Complete 25533(b)
- 12. RMPP Contents 25534(c)
- 13. Implement Sch. Req'd? (Y/N) \_\_\_\_\_
- 14. OffSite Conseq. Assess. 25524(c)
- 15. Probable Risk Assessment 25534(d)
- 16. Persons Responsible 25534(g)
- 17. Certification 25534(i)
- 18. Exemption Request? (Y/N) 25536(b)
- 19. Trade Secret Requested? 25538

\* Calif. Administration Code (CAC) or the Health & Safety Code (HS&C)

### III. UNDERGROUND TANKS (Title 23)

- |  |   |
|--|---|
| General  | <input type="checkbox"/> 1. Permit Application 25284 (H&S)      |
|  | <input type="checkbox"/> 2. Pipeline Leak Detection 25292 (H&S) |
|  | <input type="checkbox"/> 3. Records Maintenance 2712            |
|  | <input type="checkbox"/> 4. Release Report 2651                 |
|  | <input type="checkbox"/> 5. Closure Plans 2670                  |
| Monitoring for Existing Tanks                    | <input type="checkbox"/> 6. Method                              |
|  | 1) Monthly Test   |
|  | 2) Daily Vadose<br>Semi-annual groundwater<br>One time soils    |
|  | 3) Daily Vadose<br>One time soils                               |
|  | Annual tank test  |
|  | 4) Monthly Gndwater<br>One time soils                           |
|  | 5) Daily Inventory<br>Annual tank testing<br>Cont pipe leak det |
|  | Vadose/gndwater mon.  |
|  | 6) Daily Inventory<br>Annual tank testing<br>Cont pipe leak det |
|  | 7) Weekly Tank Gauge<br>Annual tank testing                     |
|  | 8) Annual Tank Testing<br>Daily Inventory                       |
|  | 9) Other _____  |
| New Tanks  | <input type="checkbox"/> 7. Precip Tank Test 2643               |
|  | Date: _____   |
|  | <input type="checkbox"/> 8. Inventory Rec. 2644                 |
|  | <input type="checkbox"/> 9. Soil Testing 2646                   |
| <input type="checkbox"/> 10. Ground Water. 2647  |   |
| <input type="checkbox"/> 11. Monitor Plan 2632   |   |
| <input type="checkbox"/> 12. Access. Secure 2634 |   |
| <input type="checkbox"/> 13. Plans Submit 2711   |   |
| Date: _____                                      |   |
| <input type="checkbox"/> 14. As Built 2635       |   |
| Date: _____                                      |   |

23  
47  
32  
12  
4  
28  
12  
24  
36

### Comments:

The soil sample collected from 17 1/2 to 18' bgs was used as a capillary fringe sample. Soil sample collected from 20' to 20' bgs had a blow count of (23, 47, 32). Soil sample collected from ~25' bgs was silty sand & wet. Screen interval for Well MW-8 will be 10-25' bgs. Left site @ 11:15AM & returned @ 1PM. Duller, collected soil sample from 15' bgs in Well MW-9. Fine Blow counts were (12, 14, 28). Fine sand w/ no odor or stains. Sample was moist. Soil sample collected from 15 1/2 to 16' bgs was more wet sand and the 16' to 16 1/2' was wet. The 15 1/2 to 16 will be analyzed as capillary fringe sample. Two other samples, one from 9 1/2 to 10' & one from 14 1/2 to 15' will also be analyzed. Three soil samples from Well MW-9 will also be analyzed (18', 18 1/2', & 15'). The 20' sample from MW-8 was wet silty sand

II, III

Contact: David Poley, IT Corp

Title: \_\_\_\_\_  
Signature: [Signature]

Inspector: Juliet Shin  
Signature: [Signature]

Pg 3.

white -env.health  
yellow -facility  
pink -files

# ALAMEDA COUNTY, DEPARTMENT OF ENVIRONMENTAL HEALTH

## Hazardous Materials Inspection Form

80 Swan Way, #200  
Oakland, CA 94621  
(415) 271-4320

II, III

Site ID # 1630 Site Name Sears Today's Date 11/02/99

### II.A BUSINESS PLANS (Title 19)

- 1. Immediate Reporting 2703
- 2. Bus. Plan Stds. 25503(b)
- 3. RR Cars > 30 days 25503.7
- 4. Inventory Information 25504(a)
- 5. Inventory Complete 2730
- 6. Emergency Response 25504(b)
- 7. Training 25504(c)
- 8. Deficiency 25505(a)
- 9. Modification 25505(b)

Site Address 1911 Telegraph Ave

City Oakland Zip 94612 Phone \_\_\_\_\_

\_\_\_ MAX AMT stored > 500 lbs, 55 gal., 200 cft.?

### Inspection Categories:

- I. Haz. Mat/Waste GENERATOR/TRANSPORTER
- II. Business Plans, Acute Hazardous Materials
- III. Underground Tanks

### II.B ACUTELY HAZ. MATLS

- 10. Registration Form Filed 25533(a)
- 11. Form Complete 25533(b)
- 12. RMPP Contents 25534(c)
- 13. Implement Sch. Req'd? (Y/N) \_\_\_\_\_
- 14. OffSite Conseq. Assess 25524(c)
- 15. Probable Risk Assessment 25534(d)
- 16. Persons Responsible 25534(g)
- 17. Certification 25534(f)
- 18. Exemption Request? (Y/N) 25536(b)
- 19. Trade Secret Requested? 25538

\* Calif. Administration Code (CAC) or the Health & Safety Code (HS&C)

### III. UNDERGROUND TANKS (Title 23)

- General
- 1. Permit Application 25284 (H&S)
  - 2. Pipeline Leak Detection 25292 (H&S)
  - 3. Records Maintenance 2712
  - 4. Release Report 2651
  - 5. Closure Plans 2670

- Monitoring for Existing Tanks
- 6 Method
    - 1) Monthly Test
    - 2) Daily Vadose  
Semi-annual groundwater  
One time soils
    - 3) Daily Vadose  
One time soils  
Annual tank test
    - 4) Monthly Gndwater  
One time soils
    - 5) Daily Inventory  
Annual tank testing  
Cont pipe leak det  
Vadose/gndwater mon.
    - 6) Daily Inventory  
Annual tank testing  
Cont pipe leak det
    - 7) Weekly Tank Gauge  
Annual tank testing
    - 8) Annual Tank Testing  
Daily Inventory
    - 9) Other \_\_\_\_\_

- 7. Precip Tank Test 2643  
Date: \_\_\_\_\_
- 8. Inventory Rec. 2644
- 9. Soil Testing. 2646
- 10. Ground Water. 2647

- New Tanks
- 11 Monitor Plan 2632
  - 12 Access, Secure 2634
  - 13 Plans Submit 2711  
Date: \_\_\_\_\_
  - 14 As Built 2635  
Date: \_\_\_\_\_

### Comments:

No 25' soil sample could be collected from MW-8 because hammer was accidentally dropped into hole and needed to be drilled out. One 15' screen will also be placed in MW-8. Two wells will be developed on Thursday, 11/04/99, and all wells will be sampled next week (Wednesday, 11/05/99). Friday

Rev 6/88

Contact: David Poley, FT Corp.

Title: \_\_\_\_\_  
Signature: D. Poley

Inspector: Juliet Shin

Signature: Juliet Shin

II, III

ALAMEDA COUNTY  
HEALTH CARE SERVICES

AGENCY  
DAVID J. KEARS, Agency Director



ENVIRONMENTAL HEALTH SERVICES  
ENVIRONMENTAL PROTECTION  
1131 Harbor Bay Parkway, Suite 250  
Alameda, CA 94502-6577  
(510) 567-6700

October 28, 1999

Scott DeMuth  
Sears, Roebuck, and Co.  
333 Beverly Rd., Dept 824ev, A2-245A  
Hoffman Estates, IL 60179

STID: 1630

Re: Workplan for investigations at Sears Store No. 1039, located at 1911 Telegraph Avenue,  
Oakland, California

Dear Mr. DeMuth,

This office has reviewed the October 21, 1999 workplan, prepared by IT Corporation for the above site. This workplan is acceptable to this office with the requirement that at least one soil sample be collected from above the capillary fringe from each of the two proposed well locations for VOC analysis in order to assist us in determining whether the VOC-contaminated groundwater is resulting from leaching of VOC-contaminated soils on site.

Additionally, this office received IT Group's letter today, which provided copies of the well logs for Wells MW-5 through MW-7.

The workplan should be implemented within 45 days of the date of this letter (i.e., by December 09, 1999). Any requests for extensions of the schedule, or modifications to the required work, should be submitted in writing to this office.

Thank you for your cooperation. If you have any questions or comments, please contact this office at (510) 567-6763.

Sincerely,

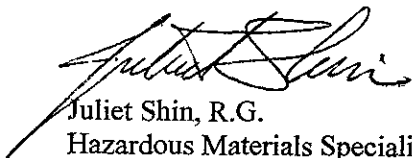
  
Juliet Shin, R.G.  
Hazardous Materials Specialist

Cc: Melissa Gossell  
IT Corporation  
757 Arnold Drive, Ste D  
Martinez, CA 94553-6526

Leroy Griffin  
City of Oakland Fire Dept., OES  
1605 Martin Luther King Jr. Way  
Oakland, CA 94612-1393

TRANSMIT REPORT

1999, 10-28 11:26  
510 337 9335  
ALAMEDA CO EHS HAZ-OPS

COM No.	REMOTE STATION	START TIME	DURATION	PAGES	RESULT	USER ID	REMARKS
378	19252880888	10-28 11:25	00' 55	00/01	D282		

7499402046

ALAMEDA COUNTY  
HEALTH CARE SERVICES

AGENCY  
DAVID J. KEARS, Agency Director



Post-It™ brand fax transmittal memo 7671 # of pages ▶ 1

To	Melissa Grosell	From	Sukiet Shin
Co.	IT Corp	Co.	Alameda City
Dept.		Phone #	510-567-6763
Fax #	925-288-0888	Fax #	510-337-9335

ENVIRONMENTAL HEALTH SERVICES  
ENVIRONMENTAL PROTECTION  
1131 Harbor Bay Parkway, Suite 250  
Alameda, CA 94502-6577  
(510) 567-6700

October 28, 1999

Scott DeMuth  
Sears, Roebuck, and Co.  
333 Beverly Rd., Dept 824ev, A2-245A  
Hoffman Estates, IL 60179

STID: 1630

Re: Workplan for investigations at Sears Store No. 1039, located at 1911 Telegraph Avenue, Oakland, California

Dear Mr. DeMuth,

This office has reviewed the October 21, 1999 workplan, prepared by IT Corporation for the above site. This workplan is acceptable to this office with the requirement that at least one soil sample be collected from above the capillary fringe from each of the two proposed well locations for VOC analysis in order to assist us in determining whether the VOC-contaminated groundwater is resulting from leaching of VOC-contaminated soils on site.

Additionally, this office received IT Group's letter today, which provided copies of the well logs for Wells MW-5 through MW-7.

The workplan should be implemented within 45 days of the date of this letter (i.e., by December 09, 1999). Any requests for extensions of the schedule, or modifications to the required work, should be submitted in writing to this office.

Thank you for your cooperation. If you have any questions or comments, please contact this office at (510) 567-6763.

Sincerely,



TRANSMIT REPORT

1999.10-28 11:29  
510 337 9335  
ALAMEDA CO EHS HAZ-OPS

COM No.	REMOTE STATION	START TIME	DURATION	PAGES	RESULT	USER ID	REMARKS
379	19252880888	10-28 11:28	00' 56	00/01	D282		

7499402045

ALAMEDA COUNTY  
HEALTH CARE SERVICES

AGENCY  
DAVID J. KEARS, Agency Director



Post-It™ brand fax transmittal memo 7671		# of pages > 1	
To	Melissa Gossell	From	Juliet Shin
Co.	IT Corp	Co.	Alameda City
Dept.		Phone #	
Fax #	925-288-0888	Fax #	

ENVIRONMENTAL HEALTH SERVICES  
ENVIRONMENTAL PROTECTION  
1131 Harbor Bay Parkway, Suite 250  
Alameda, CA 94502-6577  
(510) 567-6700

October 28, 1999

Scott DeMuth  
Sears, Roebuck, and Co.  
333 Beverly Rd., Dept 824ev, A2-245A  
Hoffman Estates, IL 60179

STHD: 1630

Re: Workplan for investigations at Sears Store No. 1039, located at 1911 Telegraph Avenue, Oakland, California

Dear Mr. DeMuth,

This office has reviewed the October 21, 1999 workplan, prepared by IT Corporation for the above site. This workplan is acceptable to this office with the requirement that at least one soil sample be collected from above the capillary fringe from each of the two proposed well locations for VOC analysis in order to assist us in determining whether the VOC-contaminated groundwater is resulting from leaching of VOC-contaminated soils on site.

Additionally, this office received IT Group's letter today, which provided copies of the well logs for Wells MW-5 through MW-7.

The workplan should be implemented within 45 days of the date of this letter (i.e., by December 09, 1999). Any requests for extensions of the schedule, or modifications to the required work, should be submitted in writing to this office.

Thank you for your cooperation. If you have any questions or comments, please contact this office at (510) 567-6763.

Sincerely,

ALAMEDA COUNTY  
HEALTH CARE SERVICES

AGENCY

DAVID J. KEARS, Agency Director



ENVIRONMENTAL HEALTH SERVICES

1131 Harbor Bay Parkway, Suite 250  
Alameda, CA 94502-6577  
(510) 567-6700  
(510) 337-9335 (FAX)

September 10, 1999

Scott DeMuth  
Sears, Roebuck, and Co.  
333 Beverly Rd., Dept 824ev, A2-245A  
Hoffman Estates, IL 60179

STID: 1630

Re: Investigations at Sears 1039, located at 1901-1911 Telegraph Avenue, Oakland, CA .

Dear Mr. DeMuth,

Thank you for IT Corporation's (IT) July 19, 1999 response letter to our May 11, 1999 letter, and the Second Quarter 1999 Groundwater Monitoring Report, dated July 15, 1999. Based on the fact that no well logs could be found for Wells MW-5, MW-6, and MW-7 on site, this office is requesting that the screened intervals for these wells be determined through the use of gamma-ray logs or down-hole cameras to confirm that these wells are screening properly, and therefore, that groundwater samples collected from these wells are truly representative of site conditions.

Concentrations of chlorinated hydrocarbons (VOCs) identified in groundwater samples collected from your site are exceeding the California Maximum Contaminant Level (MCL) drinking water threshold values. In this last sampling event, up to 14 parts per billion (ppb) tetrachloroethylene (PCE), 65ppb 1,2-dichloroethane (1,2-DCA), and 7ppb trichloroethene (TCE) were identified in groundwater samples exceeding the corresponding MCLs of 5ppb, 0.5ppb, and 5ppb. As mentioned in our May 11, 1999 letter to your office, the San Francisco Bay-Regional Water Quality Control Board (RWQCB) is not currently closing any cases with VOC concentrations exceeding MCLs, unless it can be adequately shown that the VOC contamination is not coming from the site, but rather an off-site source. To date, no soil samples collected from the site have been analyzed for VOCs. Analysis of shallow soil samples, above the water table, is strongly recommended to try and determine whether the VOC-contaminated groundwater at the site is resulting from the leaching of any VOC-contaminated soil on site. Additionally, it is strongly recommended that a survey be conducted of the area to try and locate any potential off-site sources, such as a former or existing dry cleaning facility, and that an upgradient "grab" groundwater sample be collected for comparison purposes.

Due to the fact that benzene concentrations increased appreciably in Well MW-7 during this last sampling event to levels exceeding the ASTM RBCA Tier 1 table threshold value for a commercial site at a  $10^{-5}$  risk, this office is requesting that quarterly groundwater monitoring continue at this site. The next groundwater sampling event is due to take place in September 1999.

A workplan addressing the work to identify the well screen intervals of Wells MW-5 through MW-7 must be submitted to this office within 45 days of the date of this letter (i.e., by October 22, 1999).

Scott DeMuth  
Re: 1911 Telegraph Ave.  
September 10, 1999  
Page 2 of 2

Thank you for your cooperation. If you have any questions or comments, please contact me at (510) 567-6763.

Sincerely,

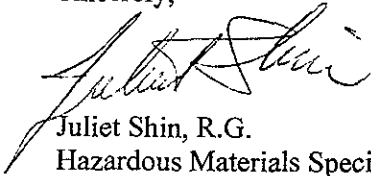

Juliet Shin, R.G.  
Hazardous Materials Specialist

Cc: Melissa Gossell  
IT Corporation  
757 Arnold Drive, Ste D  
Martinez, CA 94553-6526

Leroy Griffin  
Oakland Hazardous Materials  
505 14<sup>th</sup> St., Ste 702  
Oakland, CA 94612



ENVIRONMENTAL PROTECTION

99 JUL 21 AM 9:09

**IT Corporation**

757 Arnold Drive, Suite D  
Martinez, CA 94553-6526  
Tel. 925.370.3990  
Fax. 925.370.3991

A Member of The IT Group

### Transmittal Letter

Date: July 20, 1999

To: Juliet Shin

Company: Alameda County Health Care Services

Address: 1131 Harbor Bay Parkway, Suite 250

City: Alameda State/Zip: CA 94502-6577

We are sending via:

Courier     U.S. Mail     UPS     Overnight Mail     Other \_\_\_\_\_

The following:

Report                       Shop Drawings                       Samples

Proposal                       Specifications                       Other Response Letter

Transmitted as checked:

Approved                       For Approval                       Approved as Noted

For Correction                       For Your Use                       As Requested

For Comments                       For Your Records                       For Distribution

Comments:

Ms. Shin –

Attached is a response to comments made in your correspondence dated May 11, 1999 regarding Sears Store No. 1039, located at 1911 Telegraph Avenue in Oakland, CA. Please call with any questions or comments.

Sincerely,  
IT Corporation

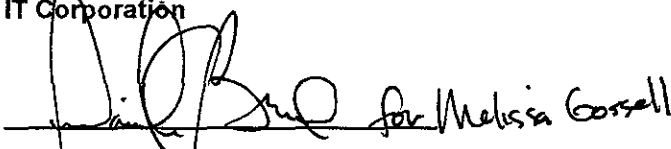

Melissa Gossell  
West Zone Project Manager

c: Scott DeMuth, Sears, Roebuck, and Co.  
Russ Zora, Central Files, Lenexa, KS  
Project Files



**IT Corporation**

757 Arnold Drive, Suite D  
Martinez, CA 94553-6526  
Tel. 925.370.3990  
Fax. 925.370.3991

A Member of The IT Group

July 19, 1999

Ms. Juliet Shin  
Hazardous Materials Specialist  
Alameda County Health Care Services  
1131 Harbor Bay Parkway, Suite 250  
Alameda, CA 94502-6577

Subject: Response to Comments  
Sears Store No. 1039, STID: 1630  
1911 Telegraph Avenue, Oakland, CA 94612  
IT Corporation Project 1176601

Dear Ms. Shin:

IT Corporation, on behalf of Sears, Roebuck and Co. (Sears), presents the following responses to comments made in your correspondence dated May 11, 1999, regarding the above referenced site. Below are your comments in italics followed by our response. Please note that the response to comments 1, 2 and 3 below are based on the site technical reports and data sent to your office on June 7, 1999.

*1. The laboratory analytical results contained in the Dames & Moore's March 21, 1988 report lists elevated contaminant levels for a Sample #7B, however, it is uncertain where this sample was collected from. Additionally, it is uncertain where Sample #17 was collected. Please provide information on the sample locations.*

Sears did not hire Dames & Moore to do the testing in 1988, although we know that Dames & Moore is still in business. On June 7, 1999, Sears sent copies of the technical reports acquired from Federated Department Stores, Inc., during Sears' acquisition of the property in 1996 (by Sears Development Company).

*2. Please provide a copy of the Hazardous Waste Manifest(s) for the four tanks that were hauled off site in 1988.*

As above, Sears has provided what technical information it has. Sears did not own or operate at the property until 1996. In Appendix A, Attachment II of the November 9, 1992 Dames & Moore report forwarded to your office on June 7, 1999, copies of the Underground Tank Closure/Modification Plans, submitted to Alameda County Health Care Services Agency, Department of Environmental Health, Hazardous Materials Division dated January 19[29], 1988, indicate that four (4) Underground Storage Tanks (USTs) had been removed from the site located at the 1911 Telegraph Avenue, Oakland site. A map is also provided in Attachment II showing the former location of the four USTs as well as the location of the former pump island. Attachment III of the Dames & Moore report contains the chain-of-custody document for soil samples collected within the two UST tank excavations and the soil sample analytical

results from Sequoia Analytical Laboratory dated February 3, 1988. Copies of the Uniform Hazardous Waste Manifest for removal of both soil (dated January 27, 1988) and liquid (dated January 28, 1988) waste from the site are also provided in Attachment III of the report.

3. *This office is missing copies of all reports that may have been generated between the Dames & Moore October 20, 1993 report and the Gale/Jordan Associates' November 7, 1995 report, including the report documenting the installation of Wells MW-5, MW-6, and MW-7. Please provide our office with this information.*

Sears has provided a copy of a "Work Plan" dated February 7, 1994, submitted to Alameda County by "Subsurface Consultants, Inc.", on June 7, 1999. Subsurface Consultants was not hired by Sears. Sears has also provided a copy of a monitoring report by "gale/jordan associates, inc." dated February 28, 1996 that appears to have been submitted to Federated. No reports could be found in either Sears nor IT Corporation records regarding installation of MW-5, 6 and 7, although the February 7, 1994 Work Plan (referred to above) indicates that Subsurface Consultants, Inc. may have installed these wells.

4. *All of Fluor Daniel GTI's Reports, beginning in July 1996, indicate the locations of two soil probes on their site plans. Please provide information on these soil probes, including information on when they were drilled, how many samples were collected, etc.*

Fluor Daniel GTI (now IT Corporation) began environmental work on the site in 1996 after Sears purchased the property. The original map that Fluor Daniel GTI prepared for the site in 1996, which shows the location of the soil probes, was based on a previous site plan which was produced by Environmental Science & Engineering, Inc. (ESE) and dated 12/27/95. No additional information regarding the soil probes could be found in either Sears nor IT Corporation records.

5. *Contaminant concentrations began increasing significantly in Well 7 beginning in the February 1997 sampling event. Was this due to a spill or other known release?*

To the best knowledge of Sears and IT Corporation, the increase of petroleum hydrocarbon concentrations in monitoring well MW-7, beginning in February 1997, has not been due to a surface spill or other known release.

6. *Please provide information on the zoning for the site so that this office can determine whether a risk assessment is required for the contaminant levels at the site. Currently the benzene concentrations at the site do not exceed the Tier 1 table threshold values for a commercial site at a 10-5 risk given in American Society for Testing and Materials' Risk-Based Corrective Action guidelines (E 1739-95). However, the benzene concentrations exceed Tier 1 table threshold values for a residential site at 10-5 risk.*

According to the Oakland Division of the Community and Economic Development Agency, the subject site, located at 1911 Telegraph Avenue, Oakland CA, is within commercial zone C-55. Chapter 17 of the Oakland Planning Regulations defines commercial zone C-55 as falling within the Oakland Central Core Commercial Zone.

Regarding new land ownership notification and participation requirements by the state, Sears submitted a letter to your office dated May 21, 1999, indicating that Sears Development Company is the sole land owner of the referenced property.

Quarterly groundwater monitoring will continue at the site, and the second quarter groundwater monitoring report will be submitted to your office by July 15, 1999. A review of feasible preventative remedial methods will be conducted by IT Corporation to provide Sears with a path to site closure. IT Corporation is submitting this letter to provide responses to comments in your correspondence dated May 11, 1999. If you have any additional questions or further comments, please call Melissa Gossell at (925) 370-3990, ext. 266.

Sincerely,  
IT CORPORATION



Melissa Gossell  
West Zone Project Manager

IT CORPORATION

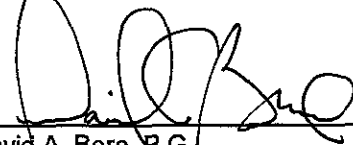

David A. Bero, P.G.  
Senior Geologist

c: Scott DeMuth, Sears, Roebuck and Co.  
Russ Zora, Central Files, Lenexa, KS  
Project Files

Scott M. DeMuth  
Sears, Roebuck and Co.  
3333 Beverly Road, A2-245A  
Hoffman Estates, IL 60179

# Sears, Roebuck and Co.

May 21, 1999

Ms. Juliet Shin  
Hazardous Materials Specialist  
Alameda County Health Care Services Agency  
Environmental Health Services  
Environmental Protection  
1131 Harbor Bay Parkway, Suite 250  
Alameda, CA 94502-6577

RE: Sears #1039  
1911 Telegraph Avenue  
Oakland  
CERTIFIED LIST OF RECORD FEE TITLE OWNERS

Dear Ms. Shin:

In accordance with section 25297.15(a) of Chapter 6.7 of the Health & Safety Code, I certify that Sears Development Company is the sole landowner of the referenced property. Sears Development Company is a subsidiary of Sears, Roebuck and Co.

Sincerely,  
Sears, Roebuck and Co.

Scott M. DeMuth  
Senior Environmental Engineer

99 MAY -27 PM 4:45  
ENVIRONMENTAL  
PROTECTION



ALAMEDA COUNTY  
HEALTH CARE SERVICES

AGENCY  
DAVID J. KEARS, Agency Director



ENVIRONMENTAL HEALTH SERVICES  
ENVIRONMENTAL PROTECTION (LOP)  
1131 Harbor Bay Parkway, Suite 250  
Alameda, CA 94502-6577  
(510) 567-6700  
FAX (510) 337-9335

May 11, 1999

Scott DeMuth  
Sears, Roebuck, and Co.  
333 Beverly Rd., Dept 824ev, A2-245A  
Hoffman Estates, IL 60179

STID: 1630

Re: Investigations at the site located at 1911 Telegraph Avenue, Oakland, CA 94612

Dear Mr. DeMuth,

I, Juliet Shin, have recently taken over as the new Alameda County Hazardous Materials Specialist overseeing investigations at the above site. In response to my recent review of the County's case files, I am requesting that you respond to the following questions and requests for missing reports/information:

- The laboratory analytical results contained in the Dames & Moore's March 21, 1988 report lists elevated contaminant levels for a Sample #7B, however, it is uncertain where this sample was collected from. Additionally, it is uncertain where Sample #17 was collected. Please provide information on the sample locations.
- Please provide a copy of the Hazardous Waste Manifest(s) for the four tanks that were hauled off site in 1988.
- This office is missing copies of all reports that may have been generated between the Dames & Moore October 20, 1993 report and the Gale/Jordan Associates' November 7, 1995 report, including the report documenting the installation of Wells MW-5, MW-6, and MW-7. Please provide our office with this information.
- All of Fluor Daniel GTI's Reports, beginning in July 1996, indicate the locations of two soil probes on their site plans. Please provide information on these soil probes, including information on when they were drilled, how many samples were collected, etc.
- Contaminant concentrations began increasing significantly in Well 7 beginning in the February 1997 sampling event. Was this due to a spill or other known release?
- Please provide information on the zoning for the site so that this office can determine whether a risk assessment is required for the contaminant levels at the site. Currently the benzene concentrations at the site do not exceed the Tier 1 table threshold values for a commercial site at a 10-5 risk given in American Society for Testing and Materials' Risk-Based Corrective Action guidelines (E 1739-95). However, the benzene concentrations exceed Tier 1 table threshold values for a residential site at 10-5 risk.

Quarterly groundwater monitoring is required to continue at the site. The San Francisco Bay-Regional Water Quality Control Board is currently requiring on-going investigations for sites with chlorinated hydrocarbon concentrations exceeding California's Maximum Contaminant Level (MCL) drinking water standards. Currently, concentrations of chlorinated hydrocarbons in Wells MW-1, MW-2, MW-6, and MW-7 are exceeding the MCL values.

Mr. Scott DeMuth  
Re: 1911 Telegraph  
May 11, 1999  
Page 2 of 3

The next Quarterly Groundwater Monitoring report is due to this office in July 1999. Groundwater samples shall continue to be analyzed for the same constituents as in the past. In the last Quarterly Groundwater Monitoring Report, dated March 19, 1999, the water table elevation given for Well MW-7 on the Potentiometric Surface Map was incorrect, and the groundwater flow direction and gradient value provided on the map were incorrect. This office determined the gradient to be roughly 0.014, which is steeper than the gradient of 0.005 that was given on the map. Please be sure to check your calculations in the future.

Recently, new landowner notification and participation requirements were promulgated by the State. Section 25297.15(a) of Ch. 6.7 of the Health & Safety Code requires the primary or active responsible party to notify all current record owners of fee title to the site of: 1) a site cleanup proposal; 2) a site closure proposal; 3) a local agency intention to make a determination that no further action is required; and 4) a local agency intention to issue a closure letter. Section 25297.15(b) requires the local agency to take all reasonable steps to accommodate responsible landowners' participation in the cleanup or site closure process and to consider their input and recommendations.

For purposes of implementing these sections, you have been identified as the primary or active responsible party. Please provide to this agency, within twenty (20) calendar days of receipt of this notice, a complete mailing list of all current record owners of fee title to the site. You may use the enclosed forms as a template to comply with the requirements. If the list of current record owners of fee title to the site changes, you must notify the local agency of the change within 20 calendar days from when you are notified of the change. If you are the sole landowner, please indicate that on the landowner list form.

Before approving a cleanup proposal or site closure proposal, determining that no further action is required, or issuing a closure letter, the local agency will take all reasonable steps necessary to accommodate responsible landowner participation in the cleanup and site closure process and will consider all input and recommendations from any responsible landowner.

Lastly, the State Water Resources Control Board manages an Underground Storage Tank Cleanup Fund (Fund) to help eligible Responsible Parties to obtain reimbursement for costs of investigating and remediating releases from petroleum underground storage tanks. You are encouraged to apply. To obtain an Application Package, contact the Fund at the following:

State Water Resources Control Board  
Division of Clean Water Programs  
UST Cleanup Fund  
P.O. Box 944212  
Sacramento, CA 944212  
Telephone: (916) 227-4307

You may contact Cheryl Gordon at (916) 227-4539 with any specific questions regarding the Fund.

Mr. Scott DeMuth  
Re: 1911 Telegraph  
May 11, 1999  
Page 3 of 3

You are required to respond to the above questions and requests for information/reports within 45 days of the date of this letter, (i.e., **by June 22, 1999**). If you have any questions or comments, please contact me at (510) 567-6763.

Sincerely,

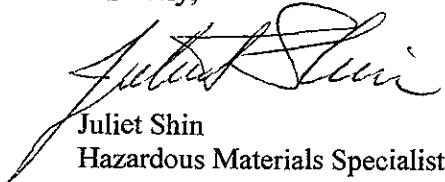

Juliet Shin  
Hazardous Materials Specialist

**ATTACHMENTS**

Cc: Melissa Gossell  
IT Corporation  
757 Arnold Drive, Ste D  
Martinez, CA 94553-6526

cc ⇒ David Bero  
IT Corp

Name of local agency  
Street address  
City

SUBJECT: NOTICE OF PROPOSED ACTION SUBMITTED TO LOCAL AGENCY  
FOR *(Site Name and Address)*

In accordance with section 25297,15(a) of Chapter 6.7 of the Health & Safety Code, I, *(name of primary responsible party)*, certify that I have notified all responsible landowners of the enclosed proposed action. Check space for applicable proposed action(s):

cleanup proposal (corrective action plan)

site closure proposal

local agency intention to make a determination that no further action is required

local agency intention to issue a closure letter

Sincerely,

Signature of primary responsible party

Name of primary responsible party

cc: Names and addresses of all record fee title owners

Name of local agency  
Street address  
City

SUBJECT: CERTIFIED LIST OF RECORD FEE TITLE OWNERS FOR (*Site Name and Address*)

(Note: Fill out item 1 if there are multiple site landowners. If you are the sole site landowner, skip item 1 and fill out item 2.)

1. In accordance with section 25297.15(a) of Chapter 6.7 of the Health & Safety Code, I, (*name of primary responsible party*), certify that the following is a complete list of current record fee title owners and their mailing addresses for the above site:
  
  
  
  
  
  
  
  
  
  
2. In accordance with section 25297.15(a) of Chapter 6.7 of the Health & Safety Code, I, (*name of primary responsible party*), certify that I am the sole landowner for the above site.

Sincerely,

Signature of primary responsible party

Name of primary responsible party

1999.05-11 17:21  
 510 337 9335  
 ALAMEDA CO EHS HAZ-OPS

COM No.	REMOTE STATION	START TIME	DURATION	PAGES	RESULT	USER ID	REMARKS
492	510 565 9148	05-11 17:19	01' 52	05/05	OK		

7499402046

ALAMEDA COUNTY  
 HEALTH CARE SERVICES

AGENCY  
 DAVID J. KEARS, Agency Director



Post-It™ brand fax transmittal memo 7671		# of pages	5
To	Melissa Gossell	From	Juliet Shin
Co.	IT Corp	Co.	Alameda City
Dept.		Phone #	510-567-6763
Fax #	925-370-3791	Fax #	510-337-9335

ENVIRONMENTAL PROTECTION (LOP)  
 1131 Harbor Bay Parkway, Suite 250  
 Alameda, CA 94502-6577  
 (510) 567-6700  
 FAX (510) 337-9335

May 11, 1999

Scott DeMuth  
 Sears, Roebuck, and Co.  
 333 Beverly Rd., Dept 824ev, A2-245A  
 Hoffman Estates, IL 60179

STID: 1630

Re: Investigations at the site located at 1911 Telegraph Avenue, Oakland, CA 94612

Dear Mr. DeMuth,

I, Juliet Shin, have recently taken over as the new Alameda County Hazardous Materials Specialist overseeing investigations at the above site. In response to my recent review of the County's case files, I am requesting that you respond to the following questions and requests for missing reports/information:

- The laboratory analytical results contained in the Dames & Moore's March 21, 1988 report lists elevated contaminant levels for a Sample #7B, however, it is uncertain where this sample was collected from. Additionally, it is uncertain where Sample #17 was collected. Please provide information on the sample locations.
- Please provide a copy of the Hazardous Waste Manifest(s) for the four tanks that were hauled off site in 1988.
- This office is missing copies of all reports that may have been generated between the Dames & Moore October 20, 1993 report and the Gale/Jordan Associates' November 7, 1995 report, including the report documenting the installation of Wells MW-5, MW-6, and MW-7. Please provide our office with this information.
- All of Fluor Daniel GTI's Reports, beginning in July 1996, indicate the locations of two soil probes on their site plans. Please provide information on these soil probes, including information on when they were drilled, how many samples were collected, etc.
- Contaminant concentrations began increasing significantly in Well 7 beginning in the February 1997 sampling event. Was this due to a spill or other known release?

ALAMEDA COUNTY  
HEALTH CARE SERVICES

AGENCY  
DAVID J. KEARS, Agency Director



ENVIRONMENTAL HEALTH SERVICES

1131 Harbor Bay Parkway, Suite 250  
Alameda CA 94502-6577  
(510) 567-6700  
(510) 337-9335 (FAX)

February 4, 1999  
STID 1630

Scott DeMuth  
Sears, Roebuck and Co.  
333 Beverly Rd., Dept. 824ev, A2-245A  
Hoffman Estates, IL 60179

Re: 1911 Telegraph Ave., Oakland, CA 94612

Dear Scott DeMuth:

This office has received and reviewed a Quarterly Groundwater Monitoring and Sampling Report dated October 15, 1998, an on-site assessment report dated January 7, 1999, and a Quarterly Groundwater Monitoring and Sampling Report dated January 15, 1999. The first two are by Fluor Daniel GTI and the last by IT Corporation (formerly Fluor Daniel GTI). The following are comments concerning these reports:

1. It is good to see that there are no separate phase hydrocarbons.
2. The site assessment says on page 1 that the lead agency is San Mateo County Health Services. This should be corrected to Alameda County.
3. It may not be necessary to purge wells prior to monitoring them. There are a number of studies done that do not show a benefit of doing this.
4. It appears that the plume is defined and that the levels of contamination are dropping rather dramatically. Continued monitoring will hopefully see this continue.

Please contact me at (510) 567-6782, if you have any questions.

Sincerely,

  
Thomas Peacock, Manager

c: Melissa Gossell, Fluor Daniel GTI, 757 Arnold Dr., Suite D, Martinez, CA 94553  
Nick Carpenter, Emporium Capwell Co., 3880 N. Mission Rd., Los Angeles, CA  
90031-3179  
Dick Pantages - Files (TP)



ALAMEDA COUNTY  
**HEALTH CARE SERVICES AGENCY**  
Environmental Health Services  
Environmental Protection  
1131 Harbor Bay Parkway  
Alameda, CA 94502-6577

4580  
EMERGENCY  
99 FEB 16 PM 11:00

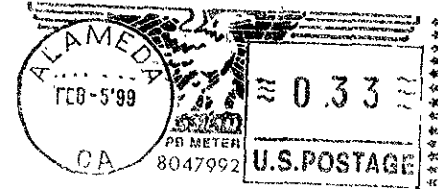

NICK CARPENTER  
**PLEASE REMOVE FROM  
MAILING LIST.**  
ADDRESSEE NO LONGER AT THIS  
ADDRESS.

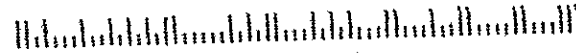



ALAMEDA COUNTY  
HEALTH CARE SERVICES

AGENCY  
DAVID J. KEARS, Agency Director



ENVIRONMENTAL HEALTH SERVICES

1131 Harbor Bay Parkway, Suite 250  
Alameda, CA 94502-6577  
(510) 567-6700  
(510) 337-9335 (FAX)

February 4, 1999  
STID 1630

Scott DeMuth  
Sears, Roebuck and Co.  
333 Beverly Rd., Dept. 824ev, A2-245A  
Hoffman Estates, IL 60179

Re: 1911 Telegraph Ave., Oakland, CA 94612

Dear Scott DeMuth:

This office has received and reviewed a Quarterly Groundwater Monitoring and Sampling Report dated October 15, 1998, an on-site assessment report dated January 7, 1999, and a Quarterly Groundwater Monitoring and Sampling Report dated January 15, 1999. The first two are by Fluor Daniel GTI and the last by IT Corporation (formerly Fluor Daniel GTI). The following are comments concerning these reports:

1. It is good to see that there are no separate phase hydrocarbons.
2. The site assessment says on page 1 that the lead agency is San Mateo County Health Services. This should be corrected to Alameda County.
3. It may not be necessary to purge wells prior to monitoring them. There are a number of studies done that do not show a benefit of doing this.
4. It appears that the plume is defined and that the levels of contamination are dropping rather dramatically. Continued monitoring will hopefully see this continue.

Please contact me at (510) 567-6782, if you have any questions.

Sincerely,

Thomas Peacock, Manager

- c: ✓ Melissa Gossell, Fluor Daniel GTI, 757 Arnold Dr., Suite D, Martinez, CA 94553  
✓ Nick Carpenter, Emporium Capwell Co., 3880 N. Mission Rd., Los Angeles, CA  
90031-3179  
Dick Pantages - Files (TP)

ALAMEDA COUNTY  
HEALTH CARE SERVICES

AGENCY  
DAVID J. KEARS, Agency Director



August 18, 1998  
STID 1630

ENVIRONMENTAL HEALTH SERVICES  
1131 Harbor Bay Parkway, Suite 250  
Alameda, CA 94502-6577  
(510) 567-6700  
(510) 337-9335 (FAX)

Scott DeMuth  
Sears, Roebuck and Co.  
333 Beverly Rd., Dep 824c  
Hoffman Estates, IL 60179

Re: 1911 Telegraph Ave., Oakland, CA 94612

Dear Scott DeMuth:

This office has received and reviewed a Workplan for Additional Groundwater Characterization dated June 22, 1998 and a Quarterly Groundwater Monitoring and Sampling Report dated July 14, 1998, both by Fluor Daniel GTI. The following are comments concerning these reports:

1. The workplan is acceptable for implementation. This workplan has been mentioned in previous reports.
2. Purging of monitoring wells may not be needed. There are many studies on the benefits of purging. None are conclusive except that the cost is usually not warranted. There is no evidence that purging gets more accurate data.
3. The highest contamination levels are found in MW-07 (at 2,100 ppb of benzene) which is the most downgradient well.

Please contact me at (510) 567-6782 if you have any questions.

Sincerely,

Thomas Peacock, Manager

c: Melissa Gossell and Brian Pierskalla, Fluor Daniel GTI, 757 Arnold Dr., Suite D,  
Martinez, CA 94553  
Nick Carpenter, Emporium Capwell Co., 3880 N. Mission Rd., Los Angeles, CA  
90031-3179  
Dick Pantages - Files

ALAMEDA COUNTY  
HEALTH CARE SERVICES

AGENCY  
DAVID J. KEARS, Agency Director



April 23, 1998  
STID 1630

Scott DeMuth  
Sears, Roebuck and Co.  
333 Beverly Rd., Dep 824c  
Hoffman Estates, IL 60179

ENVIRONMENTAL HEALTH SERVICES  
ENVIRONMENTAL PROTECTION (LOP)  
1131 Harbor Bay Parkway, Suite 250  
Alameda, CA 94502-6577  
(510) 567-6700  
FAX (510) 337-9335

Re: 1911 Telegraph Ave., Oakland, CA 94612

Dear Scott DeMuth:

This office has received and reviewed two Quarterly Groundwater Monitoring and Sampling Reports dated January 23, 1998 and April 14, 1998 by Fluor Daniel GTI. The following are comments concerning these reports:

1. Purging of monitoring wells may not be needed. There are many studies on the benefits of purging. None are conclusive except that the cost is usually not warranted. There is no evidence that purging gets more accurate data.
2. The highest contamination levels are found in MW-07 (at 3,800 ppb of benzene) which is the most downgradient well. In fact, the level of benzene in this well have continuous increased for 6 sampling periods since 1/96. This office agrees with the comment on the first page concerning development of a workplan to address this issue, which was mentioned also in the January report. **This office expects a work plan to be submitted within 60 days.**

Please contact me at (510) 567-6782 if you have any questions.

Sincerely,

Thomas Peacock, Manager

c: Eileen Brennan, Fluor Daniel GTI, 757 Arnold Dr., Suite D,  
Martinez, CA 94553  
Dick Pantages Files

ALAMEDA COUNTY  
HEALTH CARE SERVICES

AGENCY

DAVID J. KILBERS, Agency Director



September 5, 1997

SAID 1630

Scott DeMuth  
Sears, Roebuck and Co.  
333 Beverly Rd., Dep 824c  
Hoffman Estates, IL 60179

ENVIRONMENTAL HEALTH SERVICES  
ENVIRONMENTAL PROTECTION (LOP)  
1131 Harbor Bay Parkway, Suite 250  
Alameda, CA 94502-6577  
(510) 567-6700  
FAX (510) 337-9335

*Capwell's-Chemtron  
1911 Telegraph Ave*

Dear Scott DeMuth:

This office has received and reviewed two Quarterly Groundwater Monitoring and Sampling Reports dated April 15, 1997 and July 15, 1997 by Fluor Daniel GTI. The following are comments concerning these reports:

1. Although the contaminants in MW-1, MW-3, MW-4, and MW-6 are not significant, the benzene in MW-2, MW-5, and MW-7 is significant. In fact, especially in MW-7 contamination is rising with benzene reported last at 1700 ppb. This would not indicate plume stability.
2. The fact the MW-7 is the downgradient well would require further investigation in the downgradient direction.

Please provide a work plan addressing these items for County review within (45) days of receipt of this letter. This is a formal request of technical documents pursuant to the California Water Code Section 13267 (b) and failure to respond may subject you to civil liabilities.

Please contact me at (510) 567-6782 if you have any questions regarding this letter.

Sincerely,

Thomas Peacock, Manager

c: Eileen Brennan, Fluor Daniel GTI, 757 Arnold Dr., Suite D,  
Martinez, CA 94553  
~~Gordon Coleman~~ Files

LOP - CHANGE RECORD REQUEST FORM

printed:  
09/05/97

Mark Out What Needs Changing and Hand to LOP Data Entry  
(Name/Address changes go to Annual Programs Data Entry)

Insp:

AGENCY # : 10000      SOURCE OF FUNDS: F      SUBSTANCE: 12035  
 StID : 1630      LOC:  
 SITE NAME: Capwell's Chevron      DATE REPORTED : 02/23/88  
 ADDRESS : 1911 Telegraph Ave      DATE CONFIRMED: 02/23/88  
 CITY/ZIP : Oakland      94612      MULTIPLE RPs : Y

SITE STATUS

-----  
 CASE TYPE: S      CONTRACT STATUS: 9      PRIOR CODE:1C2      EMERGENCY RESP:  
 RP SEARCH: S      DATE COMPLETED: 03/13/92  
 PRELIMINARY ASMNT: C      DATE UNDERWAY: 03/21/88      DATE COMPLETED: 12/05/90  
 REM INVESTIGATION: C      DATE UNDERWAY: 03/21/88      DATE COMPLETED: 02/08/91  
 REMEDIAL ACTION: C      DATE UNDERWAY: 02/23/88      DATE COMPLETED: 03/23/88  
 POST REMED ACT MON:C      DATE UNDERWAY: 03/23/88      DATE COMPLETED: 04/12/88

ENFORCEMENT ACTION TYPE: 2      DATE ENFORCEMENT ACTION TAKEN: 06/22/95  
 LUFT FIELD MANUAL CONSID: 2HSCA  
 CASE CLOSED:      DATE CASE CLOSED:  
 DATE EXCAVATION STARTED : 02/22/88      REMEDIAL ACTIONS TAKEN: ED,ET

RESPONSIBLE PARTY INFORMATION

-----  
 RP#1-CONTACT NAME: Nick Carpenter  
 COMPANY NAME: Emporium Capwell Co.  
 ADDRESS: 3880 N. Mission Rd.  
 CITY/STATE: Los Angeles, Ca 90031-3179

RP# -CONTACT NAME: Scott M. Demuth  
 COMPANY NAME: Sears, Roebuck & Co.  
 ADDRESS: 3333 Beverly Rd. Dep 824c  
 CITY/STATE: Hoffman Estates, IL 60179

INSPECTOR VERIFICATION:

NAME \_\_\_\_\_ SIGNATURE \_\_\_\_\_ DATE \_\_\_\_\_

DATA ENTRY INPUT:

Name/Address Changes Only      Case Progress Changes

ANNPGMS \_\_\_\_\_ LOP \_\_\_\_\_ DATE \_\_\_\_\_      LOP \_\_\_\_\_ DATE \_\_\_\_\_

*Granida*

370- 3890- 2274

ALAMEDA COUNTY  
HEALTH CARE SERVICES

AGENCY  
DAVID J KEARS, Agency Director



ENVIRONMENTAL HEALTH SERVICES  
ENVIRONMENTAL PROTECTION (LOP)  
1131 Harbor Bay Parkway, Suite 250  
Alameda, CA 94502-6577  
(510) 567-6700  
FAX (510) 337-9335

STID 1630

January 27, 1997

Sears Roebuck & Company  
3333 Beverly Road  
Department. 824C, Building A2-281A  
Hoffman Estates, IL 60179  
ATTN: Bernadine Palka

RE: 1911 TELEGRAPH AVENUE, OAKLAND, CALIFORNIA 94612

Dear Bernadine Palka:

This office is in receipt of and has completed review of the case file for this site, up to and including the January 14, 1997, Fluor Daniel GTI (GTI) "Quarterly Groundwater Monitoring and Sampling Report".

This office has the following comment on the GTI report:

- ◆ The GTI report states that "The analytical results from groundwater samples collected in September were generally consistent with past results."

This information is correct, however, groundwater samples were collected most recently on 12/3/96. The report makes no attempt to explain the elevated concentrations of benzene detected in the "confirmed" down-gradient well MW-7 (benzene concentrations increased from 1.2 ug/L on 9/5/96 to 850 ug/L on 12/3/96).

The groundwater data collected from well MW-7 was analyzed using a limited ASTM Risk-Based Corrective Action (RBCA) Tier 1 Risk Based Screening Level (RBSL) evaluation as referenced in the ASTM E 1739 - 95 document "Standard Guide for Risk-Based Corrective Action Applied at Petroleum Release Sites". The ASTM E 1739 - 95 document is a consistent decision-making process for the assessment and response to a petroleum release, and is based on the protection of human health and the environment. The Tier I risk assessment compares the chemicals of concern (COCs) documented at the site with Tier 1 RBSLs as presented in the published Look-up Table (ASTM E 1739-95 - Table X2.1 "Example Tier 1 Risk-Based Screening Level (RBSL) Look-up Table). *Note: Hazard Quotients (HQ) are used in the development of RBSLs for non-carcinogenic compounds only (examples: toluene, ethyl benzene, total xylenes, etc.), and are not used in determining RBSLs for carcinogens such as benzene.*

Bernadine Palka  
RE: 1911 Telegraph Avenue, Oakland CA  
January 27, 1997  
Page 2 of 2

This evaluation determined that for the following risk exposure scenario, benzene contaminant levels exceed the CA-modified Tier 1 RBSLs:

- ◆ "Groundwater-Vapor Intrusion from Groundwater to Buildings" at a target level of  $1E-05$  (0.214 mg/L, 1 in 100,000 excess cancer risk) for a commercial/industrial receptor scenario.

**Please be advised that the extent of the groundwater contamination is not sufficiently defined.** After the documentation of the next (first quarter- 1997) quarter of groundwater reporting, Alameda County Health Care Services Agency will re-evaluate the site to determine whether additional investigations/remediations are warranted for this site.

Should you have any questions or comments, please feel free to call Thomas Peacock directly at (510)567-6782.

Sincerely,



Dale Klettke, CHMM  
Hazardous Materials Specialist

c: Mr. Michael Wray, Groundwater Technology, Inc., 4057 Port Chicago Highway,  
Concord, CA 94520  
Thomas Peacock, LOP Manager--files

1082plum.def



ALAMEDA COUNTY  
HEALTH CARE SERVICES

AGENCY  
DAVID J. KEARS, Agency Director



ENVIRONMENTAL HEALTH SERVICES  
ENVIRONMENTAL PROTECTION (LOP)  
1131 Harbor Bay Parkway, Suite 250  
Alameda, CA 94502-6577  
(510) 567-6700  
FAX (510) 337-9335

STID 1630

January 27, 1997

Sears Roebuck & Company  
3333 Beverly Road  
Department. 824C, Building A2-281A  
Hoffman Estates, IL 60179  
ATTN: Bernadine Palka

RE: 1911 TELEGRAPH AVENUE, OAKLAND, CALIFORNIA 94612

Dear Bernadine Palka:

This office is in receipt of and has completed review of the case file for this site, up to and including the January 14, 1997, Fluor Daniel GTI (GTI) "Quarterly Groundwater Monitoring and Sampling Report".

This office has the following comment on the GTI report:

- ◆ The GTI report states that "The analytical results from groundwater samples collected in September were generally consistent with past results."

This information is correct, however, groundwater samples were collected most recently on 12/3/96. The report makes no attempt to explain the elevated concentrations of benzene detected in the "confirmed" down-gradient well MW-7 (benzene concentrations increased from 1.2 ug/L on 9/5/96 to 850 ug/L on 12/3/96).

The groundwater data collected from well MW-7 was analyzed using a limited ASTM Risk-Based Corrective Action (RBCA) Tier 1 Risk Based Screening Level (RBSL) evaluation as referenced in the ASTM E 1739 - 95 document "Standard Guide for Risk-Based Corrective Action Applied at Petroleum Release Sites". The ASTM E 1739 - 95 document is a consistent decision-making process for the assessment and response to a petroleum release, and is based on the protection of human health and the environment. The Tier I risk assessment compares the chemicals of concern (COCs) documented at the site with Tier 1 RBSLs as presented in the published Look-up Table (ASTM E 1739-95 - Table X2.1 "Example Tier 1 Risk-Based Screening Level (RBSL) Look-up Table). *Note: Hazard Quotients (HQ) are used in the development of RBSLs for non-carcinogenic compounds only (examples: toluene, ethyl benzene, total xylenes, etc.), and are not used in determining RBSLs for carcinogens such as benzene.*



Bernadine Palka  
RE: 1911 Telegraph Avenue, Oakland CA  
January 27, 1997  
Page 2 of 2

This evaluation determined that for the following risk exposure scenario, benzene contaminant levels exceed the CA-modified Tier 1 RBSLs:

- ◆ "Groundwater-Vapor Intrusion from Groundwater to Buildings" at a target level of 1E-05 (0.214 mg/L, 1 in 100,000 excess cancer risk) for a commercial/industrial receptor scenario.

**Please be advised that the extent of the groundwater contamination is not sufficiently defined.** After the documentation of the next (first quarter- 1997) quarter of groundwater reporting, Alameda County Health Care Services Agency will re-evaluate the site to determine whether additional investigations/remediations are warranted for this site.

Should you have any questions or comments, please feel free to call Thomas Peacock directly at (510)567-6782.

Sincerely,



Dale Klettke, CHMM  
Hazardous Materials Specialist

c: Mr. Michael Wray, Groundwater Technology, Inc., 4057 Port Chicago Highway,  
Concord, CA 94520  
Thomas Peacock, LOP Manager--files

1082plum.def



ALAMEDA COUNTY  
HEALTH CARE SERVICES

AGENCY  
DAVID J. KEARS, Agency Director



ENVIRONMENTAL HEALTH SERVICES  
ENVIRONMENTAL PROTECTION (LOP)  
1131 Harbor Bay Parkway, Suite 250  
Alameda, CA 94502-6577  
(510) 567-6700  
FAX (510) 337-9335

STID 1630

January 27, 1997

Sears Roebuck & Company  
3333 Beverly Road  
Department. 824C, Building A2-281A  
Hoffman Estates, IL 60179  
ATTN: Bernadine Palka

RE: 1911 TELEGRAPH AVENUE, OAKLAND, CALIFORNIA 94612

Dear Bernadine Palka:

This office is in receipt of and has completed review of the case file for this site, up to and including the January 14, 1997, Fluor Daniel GTI (GTI) "Quarterly Groundwater Monitoring and Sampling Report".

This office has the following comment on the GTI report:

- ◆ The GTI report states that "The analytical results from groundwater samples collected in September were generally consistent with past results."

This information is correct, however, groundwater samples were collected most recently on 12/3/96. The report makes no attempt to explain the elevated concentrations of benzene detected in the "confirmed" down-gradient well MW-7 (benzene concentrations increased from 1.2 ug/L on 9/5/96 to 850 ug/L on 12/3/96).

The groundwater data collected from well MW-7 was analyzed using a limited ASTM Risk-Based Corrective Action (RBCA) Tier 1 Risk Based Screening Level (RBSL) evaluation as referenced in the ASTM E 1739 - 95 document "Standard Guide for Risk-Based Corrective Action Applied at Petroleum Release Sites". The ASTM E 1739 - 95 document is a consistent decision-making process for the assessment and response to a petroleum release, and is based on the protection of human health and the environment. The Tier I risk assessment compares the chemicals of concern (COCs) documented at the site with Tier 1 RBSLs as presented in the published Look-up Table (ASTM E 1739-95 - Table X2.1 "Example Tier 1 Risk-Based Screening Level (RBSL) Look-up Table). *Note: Hazard Quotients (HQ) are used in the development of RBSLs for non-carcinogenic compounds only (examples: toluene, ethyl benzene, total xylenes, etc.), and are not used in determining RBSLs for carcinogens such as benzene.*

Bernadine Palka  
RE: 1911 Telegraph Avenue, Oakland CA  
January 27, 1997  
Page 2 of 2

This evaluation determined that for the following risk exposure scenario, benzene contaminant levels exceed the CA-modified Tier 1 RBSLs:

- ◆ "Groundwater-Vapor Intrusion from Groundwater to Buildings" at a target level of  $1E-05$  (0.214 mg/L, 1 in 100,000 excess cancer risk) for a commercial/industrial receptor scenario.

**Please be advised that the extent of the groundwater contamination is not sufficiently defined.** After the documentation of the next (first quarter- 1997) quarter of groundwater reporting, Alameda County Health Care Services Agency will re-evaluate the site to determine whether additional investigations/remediations are warranted for this site.

Should you have any questions or comments, please feel free to call Thomas Peacock directly at (510)567-6782.

Sincerely,



Dale Klettke, CHMM  
Hazardous Materials Specialist

c: Mr. Michael Wray, Groundwater Technology, Inc., 4057 Port Chicago Highway,  
Concord, CA 94520  
Thomas Peacock, LOP Manager--files

1082plum.def





**ALAMEDA COUNTY  
HEALTH CARE SERVICES AGENCY**

Department Of Environmental Health  
Environmental Protection Division  
1131 Harbor Bay Parkway, Suite 250  
Alameda, CA 94502-6577

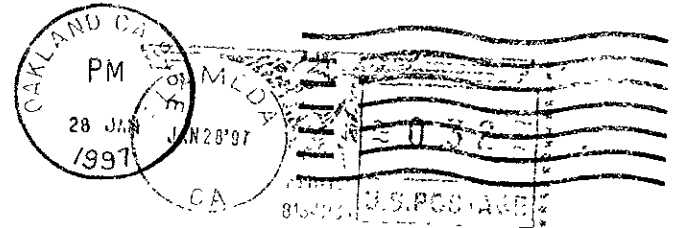

*Klettke*

MR. MICHEAL WRAY  
GROUNDWATER TECHNOLOGY  
4057 PORT CHICAGO HWY.  
CONCORD, CA 94520

*not here*

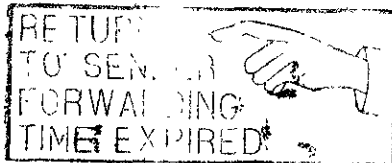

94526>1144

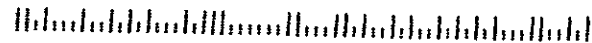

57101630

**gale/jordan associates, inc.**

ENVIRONMENTAL MANAGEMENT SERVICES

December 10, 1995

Mr. Tom Peacock  
Manager, Local Oversight Program  
Alameda County Environmental Health Department  
1131 Harbor Bay Road  
Alameda, CA 94502

Re: Groundwater Monitoring - 1914 Telegraph Avenue, Oakland, CA  
g/ja Project No. CE95039

Dear Mr. Peacock:

Per our conversation the other week, please find enclosed gale/jordan associates, inc.'s report for the above-referenced project. The report was initially sent to Kevin Graves at the San Francisco Bay RWQCB.

The current owner of the property is Broadway Stores Inc. The contact there is:

Tom Pestal  
Operations Manager  
Broadway Stores Inc.  
20<sup>th</sup> and Broadway  
Oakland, CA 94642  
(510) 891-5000 x 2247

Please contact this office if you have any questions or require additional information.

Sincerely,

  
Joanie Keiser  
Client Services

JEK/asj

cc: L. Emmerson

ENVIRONMENTAL  
PROTECTION  
93 DEC 13 PM 11:32

ALAMEDA COUNTY  
HEALTH CARE SERVICES  
AGENCY

DAVID J. KEARS, Agency Director



RAFAT A. SHAHID, DIRECTOR

DEPARTMENT OF ENVIRONMENTAL HEALTH  
State Water Resources Control Board  
Division of Clean Water Programs  
UST Local Oversight Program  
1131 Harbor Bay Parkway  
Alameda, CA 94502-6577  
(510) 567-6700

June 22, 1995  
STID 1630

Ed Haylett  
Carter Hawley Hale  
3880 North Mission Rd.  
Los Angeles, CA 90031

RE: 1911 Telegraph Ave., Oakland, CA 94612

Dear Ed Haylett:

**NOTICE OF VIOLATION**

This office sent a letter to you dated February 24, 1994 concerning a Work Plan for Soil and Groundwater Investigation dated February 7, 1994 by Subsurface Consultants, Inc. for the above site. You were reminded that well monitoring should be done quarterly. The last monitoring was done in October 1993 and a report is well overdue by a year and a half. Quarterly reports, which state actions taken during the last 90 days are required to be submitted to this office. We have not received any communication from you for a year and a half.

Please contact this office at least 48 hours prior to commencing with field work.

If you have any questions, please contact this office at (510) 567-6782.

Sincerely,

A handwritten signature in black ink, appearing to read 'Thomas Peacock', written over a horizontal line.

Thomas Peacock, Supervising HMS  
Hazardous Material Division

c: Jun Makishima, Acting Chief - files  
Marianne Watada, Subsurface Consultants, Inc., 171 12th St.,  
Suite 201, Oakland, CA 94607  
Nick Carpenter, Emporium Capwell Co., 444 S. Flower St.,  
Los Angeles, CA 90071  
Gil Jensen, Alameda County District Attorney's Office

ALAMEDA COUNTY  
HEALTH CARE SERVICES  
AGENCY

DAVID J. KEARS, Agency Director



RAFAT A. SHAHID, DIRECTOR

DEPARTMENT OF ENVIRONMENTAL HEALTH  
State Water Resources Control Board  
Division of Clean Water Programs  
UST Local Oversight Program  
1131 Harbor Bay Parkway  
Alameda, CA 94502-6577  
(510) 567-6700

June 22, 1995  
STID 1630

Ed Haylett  
Carter Hawley Hale  
3880 North Mission Rd.  
Los Angeles, CA 90031

RE: 1911 Telegraph Ave., Oakland, CA 94612

Dear Ed Haylett:

**NOTICE OF VIOLATION**

This office sent a letter to you dated February 24, 1994 concerning a Work Plan for Soil and Groundwater Investigation dated February 7, 1994 by Subsurface Consultants, Inc. for the above site. You were reminded that well monitoring should be done quarterly. The last monitoring was done in October 1993 and a report is well overdue by a year and a half. Quarterly reports which state actions taken during the last 90 days are required to be submitted to this office. We have not received any communication from you for a year and a half.

Please contact this office at least 48 hours prior to commencing with field work.

If you have any questions, please contact this office at (510) 567-6782.

Sincerely,

A handwritten signature in black ink, appearing to read 'Thomas Peacock', written over a horizontal line.

Thomas Peacock, Supervising HMS  
Hazardous Material Division

c: Jun Makishima, Acting Chief - files  
Marianne Watada, Subsurface Consultants, Inc., 171 12th St.,  
Suite 201, Oakland, CA 94607  
Nick Carpenter, Emporium Capwell Co., 444 S. Flower St.,  
Los Angeles, CA 90071  
Gil Jensen, Alameda County District Attorney's Office



ALAMEDA COUNTY  
**HEALTH CARE SERVICES AGENCY**  
Department Of Environmental Health  
Environmental Protection Division  
1131 Harbor Bay Parkway, Suite 250...  
Alameda, CA 94502-6577

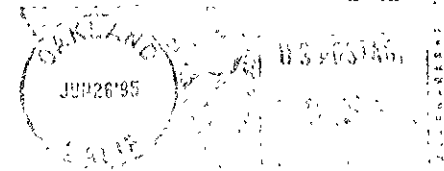

RETURNED TO SENDER  
ATTEMPTED  
NOT KNOWN  
NO SUCH NUMBER  
DATE \_\_\_\_\_ RT / 5 INIT *PC*

Nick Carpenter  
Emporium Capwell Co.  
444 S. Flower Street  
Los Angeles CA 90071

95071-2961 15

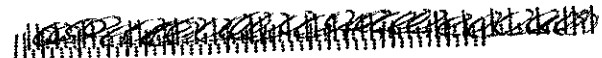



ALAMEDA COUNTY  
HEALTH CARE SERVICES  
AGENCY

DAVID J. KEARS, Agency Director



RAFAT A. SHAHID, ASST. AGENCY DIRECTOR

DEPARTMENT OF ENVIRONMENTAL HEALTH  
State Water Resources Control Board  
Division of Clean Water Programs  
UST Local Oversight Program  
80 Swan Way, Rm 200  
Oakland, CA 94621  
(510) 271-4530

February 24, 1994  
STID 1630

Ed Haylett  
Carter Hawley Hale  
3880 North Mission Rd.  
Los Angeles, CA 90031

RE: 1911 Telegraph Ave., Oakland, CA 94612

Dear Ed Haylett:

This office has received and reviewed a Work Plan for Soil and Groundwater Investigation dated February 7, 1994 by Subsurface Consultants, Inc. concerning the above site. The following comments are to be considered:

1. Well monitoring should be done quarterly. The last monitoring was done in October 1993 and a report is due now.
2. Please contact this office at least 48 hours prior to commencing with field work. Your workplan is acceptable. in their present form.

Thank you for your cooperation. If you have any questions, please contact this office at (510) 271-4530.

Sincerely,

Thomas Peacock, Supervising HMS  
Hazardous Material Division

cc: Edgar Howell, Chief - files  
Marianne Watada, Subsurface Consultants, Inc., 171 12th St.,  
Suite 201, Oakland, CA 94607  
Nick Carpenter, Emporium Capwell Co., 444 S. Flower St.,  
Los Angeles, CA 90071

ALCO  
HAZMAT

94 FEB -9 PM 3: 08

February 7, 1994  
SCI 895.001

Mr. Thomas Peacock  
Alameda County Health Care Services Agency  
80 Swan Way, Room 200  
Oakland, California 94621

**Work Plan**  
**Soil and Groundwater Investigation**  
**1911 Telegraph Avenue**  
**Oakland, California**

Dear Mr. Peacock:

Presented herein is a proposed work plan prepared by Subsurface Consultants, Inc. (SCI) to preliminarily define the extent of groundwater contamination resulting from release(s) from a former waste oil tank and three former gasoline tanks at the referenced site.

#### **Background**

In 1988, one underground waste oil tank and three underground gasoline tanks were removed. Reportedly, contaminated soil was removed and disposed of, and a monitoring well was installed and sampled. No "significant contamination" was detected, therefore the Alameda County Health Care Services Agency (ACHCSA) recommended to the Regional Water Quality Control Board (RWQCB) that the site be closed.

In October 1992, the RWQCB, requested an additional investigation of groundwater quality. Dames and Moore responded in June 1993 by installing and sampling three monitoring wells (MW-2, MW-3 and MW-4) as shown on the Site Plan, Plate 1. After two monitoring events, it appears that MW-2 and MW-4 contain elevated levels of gasoline, benzene and TCE. Additionally, groundwater flow direction appears to fluctuate in the area. During a recent site visit SCI located the 3 monitoring wells installed by Dames and Moore and an additional well, assumed to be the well installed in 1988. Well locations are shown on the Site Plan. The wells were surveyed and groundwater level measurements were obtained. The

■ **Subsurface Consultants, Inc.**

Mr. Thomas Peacock  
Alameda County Health Care Services Agency  
February 7, 1994  
SCI 895.001  
Page 2

current and previous groundwater flow directions are presented on the Site Plan.

In a letter dated December 21, 1993, the ACHCSA requested additional groundwater studies to determine the extent of the groundwater contamination. In response to the ACHCSA request, SCI proposes to install three additional monitoring wells, as outlined below.

### Field Investigation - Test Borings and Monitoring Wells

The monitoring wells will be installed in test borings drilled using truck-mounted, 8-inch-diameter, hollow-stem auger equipment. Proposed test boring locations are presented on the Site Plan. Our engineer will observe drilling operations and prepare detailed logs of the borings. Soil samples will be obtained from the borings using a California Drive Sampler having an outside diameter of 2.5 inches and an inside diameter of 2.0 inches. Soil samples will be obtained at frequent intervals and at major lithologic changes. An organic vapor meter (OVM) will be used to screen all samples obtained from the test borings.

Soil samples will be retained in brass sample liners. Teflon sheeting will be placed on the ends of the liners prior to capping and sealing with tape. Upon sealing and labeling, the samples will be promptly refrigerated on-site in an ice chest. Samples will remain under refrigeration until delivery to the laboratory.

All augers, drill rods, sampling equipment, well casings, etc., that will be placed in the test borings will be cleaned prior to their initial use and prior to each subsequent use to reduce the likelihood of cross-contamination between borings and/or samples. Upon completion of drilling, the borings will be converted to monitoring wells.

The groundwater monitoring wells will be constructed of 2-inch-diameter, Schedule 40 PVC pipe having flush threaded joints. The lower 15 feet of the wells will consist of machine slotted well screen having 0.020 inch slots. The annular space around the screened section will be backfilled with Lonestar #3 sand. A bentonite seal, approximately 12 inches thick, will be placed above the sand. The annular space above the bentonite seal will be backfilled with cement/bentonite grout. The wells will be finished below grade in a traffic rated utility box and will be secured by a locking cap.

Mr. Thomas Peacock  
Alameda County Health Care Services Agency  
February 7, 1994  
SCI 895.001  
Page 3

Groundwater levels will be measured in each well prior to development/purging. The new wells will be developed by bailing or pumping, until the water becomes relatively free of turbidity. The existing wells will be purged of approximately 3 well volumes, or until temperature, conductivity and pH have stabilized. When the wells have recharged to at least 80 percent of their original volume, groundwater samples from all 7 wells will be obtained using disposable, pre-cleaned samplers. Water samples will be placed in pre-cleaned containers and refrigerated until delivery to the analytical laboratory. The soil and water samples will be accompanied by Chain-of-Custody records.

Soil cuttings and water generated during drilling and well development will be placed in steel drums and left on-site for later disposal. A level survey will be performed to determine the elevation of the top of well casings (TOC) in relation to the existing on-site wells. The TOC elevations and groundwater depths will be used to evaluate groundwater flow direction and gradient.

#### Analytical Testing

Soil and groundwater samples will be analyzed by a California Department of Health Services (DHS) certified analytical laboratory. Selected soil and groundwater samples will be analyzed for:

1. Total volatile hydrocarbons, as gasoline - EPA 5030/8015,
2. Benzene, toluene, ethylbenzene and xylenes, (BTEX) - EPA 5030/8020,
3. Halogenated volatile organics - EPA 5030/8010, and
4. Oil and grease SMWW 17:5520 BF.

#### Report

Based upon the results of the investigation, SCI will prepare a report recording our conclusions/recommendations regarding:

1. Soil and groundwater conditions;
2. The extent of soil and groundwater contamination;
3. The significance of contaminant levels with respect to local and state criteria;

■ Subsurface Consultants, Inc.

Mr. Thomas Peacock  
Alameda County Health Care Services Agency  
February 7, 1994  
SCI 895.001  
Page 4

4. Remediation alternatives; and
5. The scope of subsequent phases of investigation, if required.

The report will include boring logs, analytical test reports and Chain-of-Custody records.

We look forward to your favorable review of our work plan. If you have any questions, please call.

Yours very truly,

Subsurface Consultants, Inc.

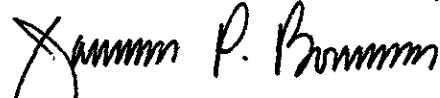

James P. Bowers  
Geotechnical Engineer 157 (expires 3/31/96)

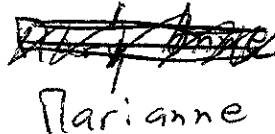

Parianne

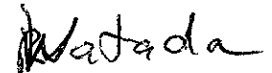

MFW:JPB:sld

4 copies: Mr. George Caesar  
EnviroGroup

Attachments: Plate 1 - Site Plan

WILLIAMS STREET

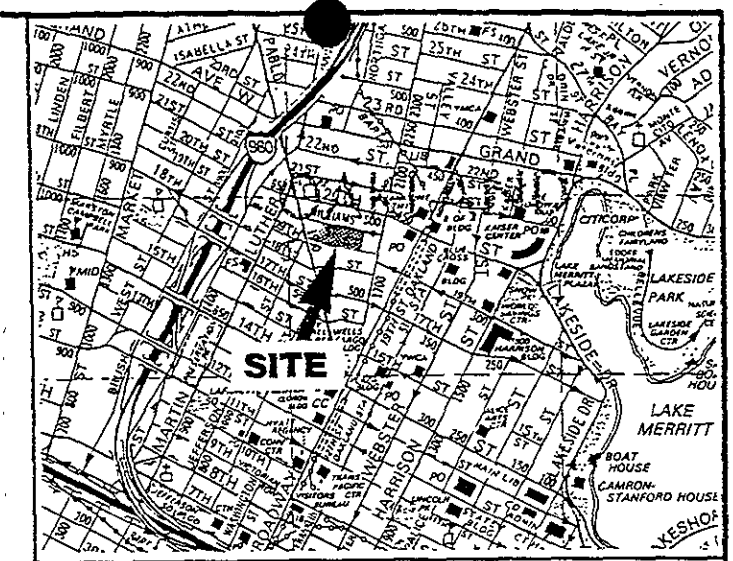
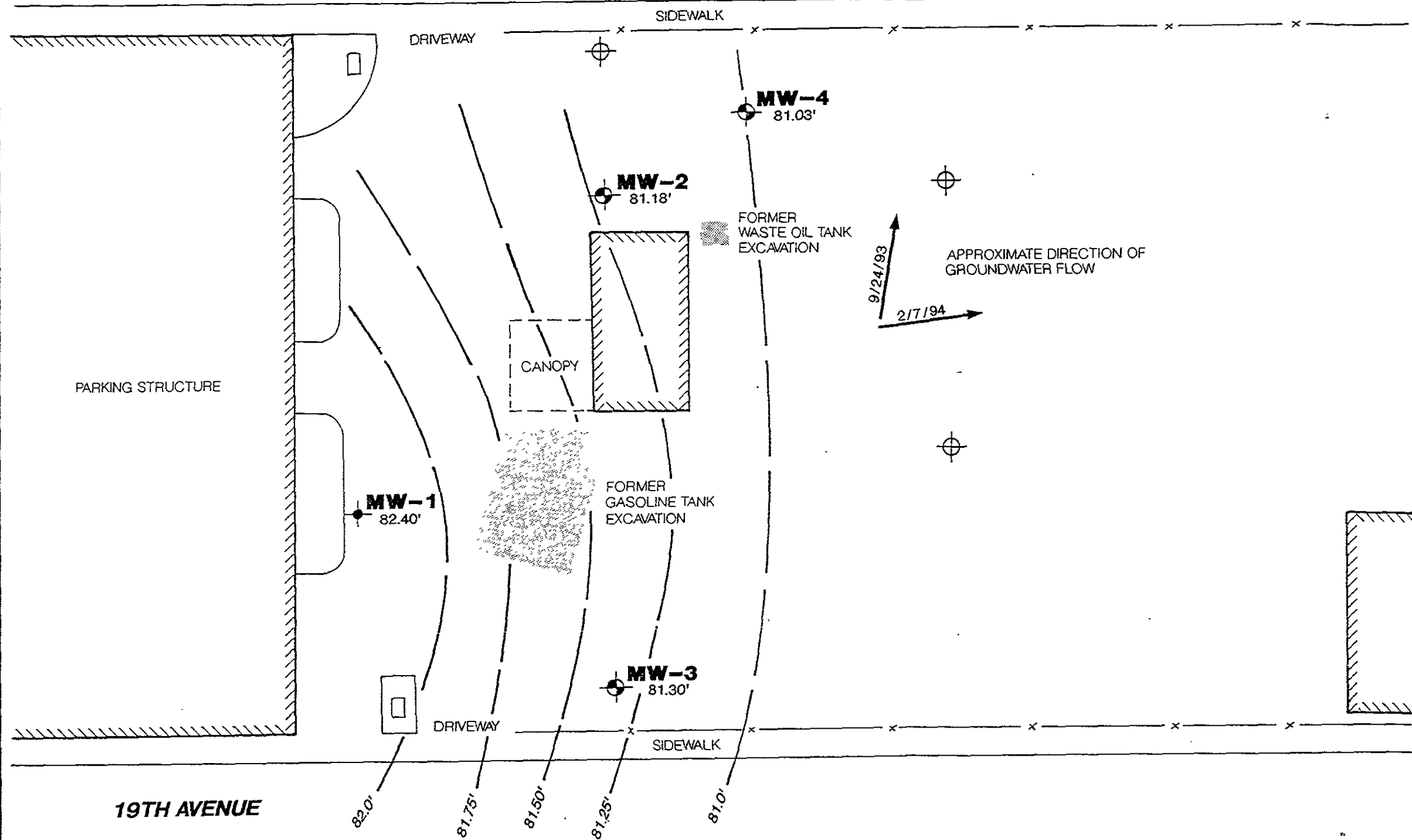

VICINITY MAP

- 4" DIAMETER MONITORING WELL
- 2" DIAMETER MONITORING WELL
- FORMER TANK EXCAVATIONS
- EXISTING STRUCTURE
- FENCE
- PROPOSED WELL LOCATION
- GROUNDWATER ELEVATION CONTOURS (FEET) 2/7/94
- GROUNDWATER ELEVATIONS (FEET) 2/7/94

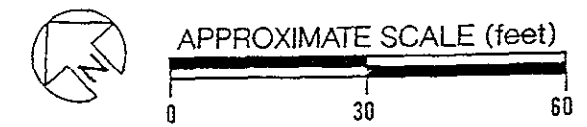
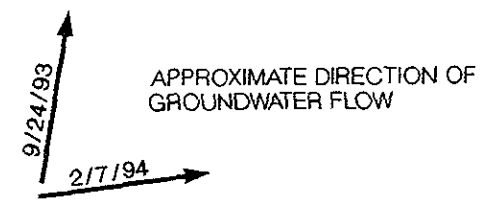

SITE PLAN		
1911 TELEGRAPH AVENUE - OAKLAND, CA		PLATE
JOB NUMBER	DATE	APPROVED
865.001	2/7/94	<b>1</b>

Subsurface Consultants

REFERENCE ELEVATION: TOP OF CASING OF MW-3 ASSUMED TO BE 100.00 FEET.

5710 1630

**Subsurface Consultants, Inc.**  
Consulting Engineers

**FAX TRANSMISSION COVER SHEET**

To: George Casar

Receiver's Fax: 930-8340

Company: Environ Group

From: Jim Bowers

**RUSH!**  
Please Deliver Immediately

Date: 2/8/94 SCI Job No.: 895.001

Pages Transmitted: 6

Project: 1911 Telegraph Avenue

Subject: Work Plan

- For Your Review and Comment
- Original Will Be Mailed
- For Your Information
- As Requested
- Please Return an Executed Copy
- \_\_\_\_\_

Copies have also been sent to: Thomas Peacock, 569-4757  
ACHCSA

Remarks: \_\_\_\_\_  
\_\_\_\_\_  
\_\_\_\_\_  
\_\_\_\_\_  
\_\_\_\_\_

**Subsurface Consultants, Inc.**  
171 - 12th Street, Suite 201  
Oakland, California 94607  
510-268-0461 FAX 510-268-0137

ALAMEDA COUNTY  
HEALTH CARE SERVICES  
AGENCY

DAVID J. KEARS, Agency Director



RAFAT A. SHAHID, ASST. AGENCY DIRECTOR

DEPARTMENT OF ENVIRONMENTAL HEALTH  
State Water Resources Control Board  
Division of Clean Water Programs  
UST Local Oversight Program  
80 Swan Way, Rm 200  
Oakland, CA 94621  
(510) 271-4530

StID 1630

December 21, 1993

Mr. Ed Haylett  
Carter Hawley Hale  
3880 North Mission Rd  
Los Angeles, CA 90031

**Subject: SWI for Former Chevron Site, 1911 Telegraph Ave.,  
Oakland 94612**

This office has completed review of Dames & Moore's October 1993 Groundwater Monitoring Report for the above referenced site. After two consecutive quarters of monitoring, it appears ground water flow direction fluctuates significantly. And monitoring wells MW-2 and MW-4 exhibit elevated levels of TPH-G, benzene, and TCE (up to 7,600 ppb, 4,000 ppb, and 78 ppb, respectively, in September 1993).

At this time additional investigations are required to determine the extent of the groundwater contamination due to petroleum hydrocarbon and solvent release from the former underground storage tanks at this site. Such an investigation shall be in the form of a **Soil and Groundwater Investigation**, or SWI. The information gathered by the SWI will be used to determine an appropriate course of action to remediate the site, if deemed necessary. The SWI must be conducted in accordance with the RWQCB Staff Recommendations for the Initial Evaluation and Investigation of Underground Tanks, and Article 11 of Title 23, California Code of Regulations.

The SWI proposal is due **within 45 days** of the date of this letter. Once the proposal is approved, field work should commence within 60 days. A report must be submitted within 45 days after the completion of this phase of work at the site. Subsequent reports are to be submitted quarterly until this site qualifies for RWQCB "sign off." All reports and proposals must be submitted under seal of a California Registered Geologist, Certified Engineering Geologist, or Registered Civil Engineer.

**Please be advised that this is a formal request for technical reports pursuant to Title 23, CCR, Section 2722(c). Any extensions of the stated deadlines, or modifications of the required tasks, must be confirmed in writing by this agency.**



Should you have any questions about the content of this letter,  
please contact me at (510) 271-4530.

Sincerely,

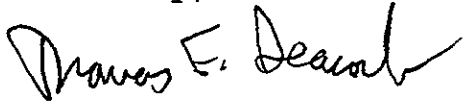

Thomas F. Peacock, Supervising HMS  
Hazardous Materials Division

cc: Charles Snell, Dames & Moore, 221 Main St., Suite 600,  
San Francisco, CA 94105-1917  
files

emporium1

# DAMES & MOORE

6 HUTTON CENTRE DRIVE, SUITE 700, SANTA ANA, CALIFORNIA 92707  
(714) 433-2000 FAX: (714) 433-2364 (714) 433-2365

March 16, 1993

Mr. Richard Hiett  
California Regional Water Quality  
Control Board - San Francisco Bay Region  
2101 Webster Street, Suite 500  
Oakland, California 94612

Subject: Former Chevron Site  
Adjacent to Campwell Emporium  
Oakland, California

*New Contact:*  
*Chuck Gruell*  
*@ D&M: SF*  
*ph: (2)*  
*6/14/93*  
*work begins*

Dear Richard:

This letter is to summarize our telephone conversation of a few weeks ago regarding the subject site. This letter is being submitted by the prior knowledge and concurrence of Carter Hawley Hale. As you are aware, Dames & Moore removed three Underground Storage Tanks (USTs) at the subject site in 1988. Soil contamination was found in the UST excavation, which was subsequently remediated. In addition, at the request and direction of a representative of the Alameda County Department of Environmental Health (ACDEH), the lead regulatory agency for UST removal at the time, Dames & Moore installed and sampled a single groundwater monitoring well at the site. Based on the results of Dames & Moore's activities, the ACDEH recommended closure of the site. However, recently the RWQCB's review of the files has raised few issues that in the RWQCB's opinion must be addressed prior to closure of the site.

At the request of Mr. Ed Haylett of Carter Hawley Hale, Dames & Moore initiated the telephone conversation to discuss the concerns that RWQCB may have about the site. The results of the conversation can be summarized as follows:

- During the remediation, the affected soil was removed from the UST excavation. However, a limited amount of soil with very low hydrocarbon concentrations was left in place due to the impracticality of removal. Mr. Hiett does not have any concern regarding those low concentrations.
- The groundwater table in the site area is shallow, about 15 to 20 feet below ground surface (bgs). Mr. Hiett believes that due to shallowness of the groundwater at the site and presence of hydrocarbons in soil observed during UST removal, the groundwater should be investigated further. The scope of groundwater investigation should include installation of three monitoring wells, at locations shown on the attached site sketch. The wells will be about 25 to 30 feet deep. The wells should be sampled and initially analyzed for volatile organic compounds (VOCs), using EPA method 8240. If detectable VOCs are not found

Mr. Hiatt  
March 16, 1993  
Page 2

in the first round, another round will be necessary within a three month period. For the second round, the samples will be analyzed using EPA method 8020. If no detectable VOCs are found in the second round, then RWQCB will concur with closing the site.

Please inform Carter Hawley Hale and/or Dames & Moore whether this letter reflects your recollection of our telephone conversation and/or any discrepancies exist. Upon your approval of the scope of work outlined above, Dames & Moore will submit a proposal to Carter Hawley Hale and with their authorization will implement the groundwater investigation.

Please don't hesitate to call me if you have any questions about this letter.

Sincerely,

DAMES & MOORE

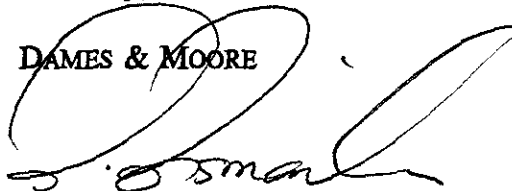

E. Essi Esmaili, Ph.D, R.G.  
Associate

Enclosure

cc: Mr. Ed Haylett, Carter Hawley Hale

19<sup>th</sup> Street

55'

EXCAVATION PERIMETER

3000 GL

5000 GL

7000 GL

20'

38'

20-25'

25'

2900'

Chemrol Gas Station

15'

500 GL

WASTE OIL

Proposed Location of monitoring wells

300'

Former MONITOR WELL

North

Not To Scale

20<sup>th</sup> Street

Telegraph Ave

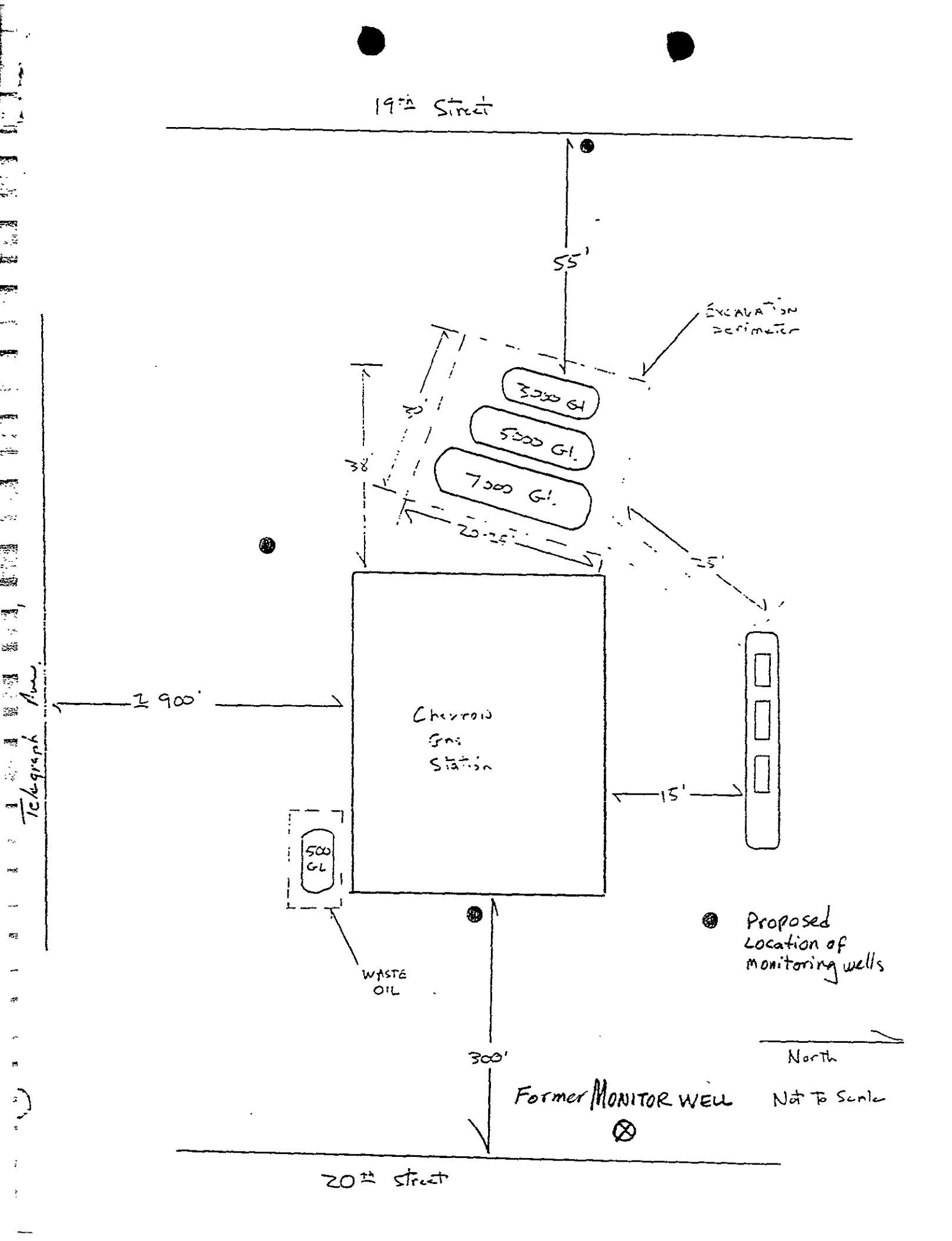

CALIFORNIA REGIONAL WATER QUALITY CONTROL BOARD  
SAN FRANCISCO BAY REGION  
2101 WEBSTER STREET, SUITE 500  
OAKLAND, CA 94612

Phone: (510) 286-1255  
Fax: (510) 286-1380



Carter Hawley Hale  
444 South Flower Street  
P.O. Box 17902  
Los Angeles, CA 90017  
Attn: Mr Nick Carpenter

October 13, 1992  
File: 2198.17 (UST)

RE: Former Capwells Chevron site at 1911 Telegraph Street, Oakland 94612

Dear Mr. Carpenter,

The Alameda County Department of Environmental Health has submitted letters on July 17, 1992 and August 5, 1992, recommending closure for your site involving the removal and subsequent investigation of four underground storage tanks.

Regional Board staff have reviewed the file for your site and **do not** concur with this recommendation. The following information is needed to consider the county's recommendation for closure:

- 1) Determine the lateral and vertical extent of contamination in soil.
- 2) Determine the hydraulic gradient.
- 3) Determine the extent of contamination in groundwater. 3500 ppb TPH is a confirmed release that appears to have resulted from the former UST's on your property.

I have included a copy of both the Tri-Regional Guidelines Board staff recommendations for the preliminary evaluation and investigation of underground storage tanks and our office's recommended format for case closure. **All** items in the case closure recommendations need to be met for a groundwater contamination case to be considered for closure.

Please contact me if you have any questions regarding the contents of this letter at (510) 286-4359.

Sincerely,

A handwritten signature in black ink, appearing to read "Richard C. Hiatt", is written over a horizontal line.

Richard C. Hiatt  
Water Resource  
Control Engineer

cc: Thomas Peacock, ACHD, 80 Swan Way, Suite 200, Oakland CA 94612



Carter Hawley Hale

RECEIVED  
AUG 25 1992  
C. H. HALE

August 25, 1992

Mr. Rich Hiatt  
REGIONAL WATER QUALITY CONTROL BOARD  
2101 Webster Street, Suite 500  
Oakland, California 94612

Re: Former Capwells Chevron Station  
1911 Telegraph, Oakland, California

Dear Rich:

Attached is report information as requested during our telephone conversation this morning.

If I can be of further assistance, please let me know.

Thank you.

Sincerely,

CARTER HAWLEY HALE

*Nick Carpenter*  
Nick Carpenter, F.I.S.P.  
Director, Construction Management

NC/ckj

Enclosure

cc: H. Wallach w/o encl.  
J. Healy w/o encl.  
J. Hanson w/o encl.

C:00006

*Report*

ALAMEDA COUNTY  
HEALTH CARE SERVICES

AGENCY  
DAVID J. KEARS, Agency Director



State Water Resources Control Board  
Division of Clean Water Programs  
UST Local Oversight Program

RAFAT A. SHAHID, Assistant Agency Director

August 5, 1992  
STID# 3796

DEPARTMENT OF ENVIRONMENTAL HEALTH  
Hazardous Materials Division  
80 Swan Way, Rm. 200  
Oakland, CA 94621  
(510) 271-4320

**REGIONAL BOARD REFERRAL**

Regional Water Quality Control Board  
San Francisco Bay Region  
2101 Webster St., 4th Floor  
Oakland, CA 94612

SUBJECT: Emporium Capwell, 20th St. & Broadway, Oakland, CA 94612

This office has reviewed site investigation and remedial action for the underground storage tanks at the above site. With the provision that the information provided to this agency was accurate and representative of existing conditions, it is the position of this office that no further action is required at this time.

This office requests that the Regional Water Quality Control Board reviews this site and gives final site closure and/or remedial action completion. This agency also requests notification of final site closure.

If you have any questions regarding this matter, please contact this office.

Sincerely,

Thomas F. Peacock, Supervising HMS  
Hazardous Material Division

cc: Nick Carpenter, Carter Hawley Hale, 444 S. Flower St., Los Angeles, CA 90071

Files

ALAMEDA COUNTY  
HEALTH CARE SERVICES

AGENCY  
DAVID J. KEARS, Agency Director



State Water Resources Control Board  
Division of Clean Water Programs  
UST Local Oversight Program

RAFAT A. SHAHID, Assistant Agency Director

August 5, 1992  
STID# 1630

DEPARTMENT OF ENVIRONMENTAL HEALTH  
Hazardous Materials Division  
80 Swan Way, Rm. 200  
Oakland, CA 94621  
(510) 271-4320

**REGIONAL BOARD REFERRAL**

Regional Water Quality Control Board  
San Francisco Bay Region  
2101 Webster St., 4th Floor  
Oakland, CA 94612

SUBJECT: former Capwells Chevron site, 1911 Telegraph, Oakland, 94612

This office has reviewed site investigation and remedial action for the underground storage tanks at the above site. With the provision that the information provided to this agency was accurate and representative of existing conditions, it is the position of this office that no further action is required at this time.

This office requests that the Regional Water Quality Control Board reviews this site and gives final site closure and/or remedial action completion. This agency also requests notification of final site closure.

If you have any questions regarding this matter, please contact this office.

Sincerely,

Thomas F. Peacock, Supervising HMS  
Hazardous Material Division

cc: Nick Carpenter, Carter Hawley Hale, 444 S. Flower St., Los Angeles, CA 90071

*Files*



ALAMEDA COUNTY  
HEALTH CARE SERVICES

AGENCY  
DAVID J. KEARS, Agency Director



State Water Resources Control Board  
Division of Clean Water Programs  
DEPARTMENT OF ENVIRONMENTAL HEALTH  
UST Local Oversight Program  
Hazardous Materials Division  
80 Swan Way, Rm. 200  
Oakland, CA 94621  
(510) 271-4320

July 17, 1992

San Francisco Bay Region  
Regional Water Quality Control Board  
ATTN: Rich Hiett  
2101 Webster St., 4th Floor  
Oakland, CA 94612

Re: former Capwells Chevron site (STID 1630, 1911 Telegraph,  
Oakland)

Dear Rich Hiett:

**LETTER OF RECOMMENDATION FOR UST CASE CLOSURE**

**INTRODUCTION**

During 1987, a Phase I Investigation was done at the above site by Dames & Moore. Four underground tanks were removed from the above site on Jan. 29, 1988. Contaminated soil was over-excavated and monitoring wells were installed.

**SITE DESCRIPTION**

Former gas station across the street from the Emporium Capwell Building. 3 fuel tanks and 1 waste oil tank were removed. Site is no longer a service station.

**PREVIOUS WORK**

All work was done by Dames & Moore, as the consultant and Trace Environmental Services as the contractor.

**INVESTIGATIVE METHODS**

Initial soil samples showed low to medium boiling point hydrocarbons of as high as 3,300 ppm in 13 samples. There was also benzene as high as 230 ppm, toluene as high as 140 ppm, and xylene as high as 770 ppm. The highest TPHg was 21 ppm. After over-excavation of the site there was 1 sample of 6 with 30 ppm hydrocarbons and 0.51 ppm benzene. At the time the action level for TPH was 100 and for benzene was 0.7 ppm. Construction of Monitoring Wells: 1 well was installed.

Well Development: unknown

Groundwater Sampling: 3 consecutive days

Analytical Methods: Sampled for TPHg and BTX, with no significant contamination found.

Groundwater Samples: 1 sample had 3.5 ppm TPHg

**EXTENT OF HYDROCARBON PRESENCE IN SOIL AND GROUNDWATER**

Hydrocarbons in Soil: below action levels after over-excavation

RECEIVED  
JUL 28 1992  
QUALITY CONTROL BOARD

Hydrocarbons in Groundwater: 3.5 ppm in 1 sample  
Floating Product: NA  
Dissolved Hydrocarbons: NA

**HYDROLOGY**

Regional Hydrology: San Francisco Bay Plane  
Local Hydrology: not elaborated  
Groundwater Gradient: only 1 well  
Seasonal Variations of Groundwater: NA  
Aquifer Characteristics: not elaborated

**BENEFICIAL USES OF GROUNDWATER**

Well Inventory: NA  
Contaminant Fate Transport: NA  
Sources of Drinking Water Policy Determination: NA

**REMEDIATION ACTIVITIES AND EFFECTIVENESS**

Soil Remediation: NA  
Groundwater Remediation: NA  
Impact of Residual Hydrocarbons on Beneficial Uses: NA

**SUMMARY AND CONCLUSIONS**

Site was recommended for closure by Alameda County Representative in May of 1988. Single monitoring well apparently has been destroyed. Site survey in June of 1992 discovered approximate former location but found no evidence of any existing well.

**RECOMMENDATIONS**

The site should be closed by the Regional Water Quality Control Board.

**TABLES ATTACHED**

Results of Analysis of Soil Samples: attached  
Cumulative Results of Groundwater Elevation and Flow Direction: NA  
Cumulative Results of Analyses of Water Samples: attached  
Wells within 1/2-Mile Radius of the Site: NA

Sincerely,



Thomas Peacock, Supervising HMS  
Hazardous Material Division

cc: Carter Hawley Hale, ATTN:Nick Carpenter, 444 S. Flower  
St., Los Angeles, CA 90071



August 3, 1992  
STID# 1630

DEPARTMENT OF ENVIRONMENTAL HEALTH  
Hazardous Materials Division  
80 Swan Way, Rm. 200  
Oakland, CA 94621  
(510) 271-4320

REMEDIAL ACTION COMPLETION CERTIFICATE

Nick Carpenter  
Emporium Capwell Co.  
444 S. Flower St.  
Los Angeles, CA 90071

Dear Nick Carpenter:

SUBJECT: former Capwells Chevron site, 1911 Telegraph, Oakland, 94612

This letter confirms the completion of site investigation and remedial action for the underground storage tanks at the above site. With the provision that the information provided to this agency was accurate and representative of existing conditions, it is the position of this office that no further action is required at this time.

Please be advised that this letter does not relieve you of any liability under the California Health and Safety Code or Water Code for past, present, or future operations at the site. Nor does it relieve you of the responsibility to clean up existing, additional or previously unidentified conditions at the site, which cause or threaten to cause pollution or nuisance or otherwise pose a threat to water quality or public health.

Additionally, be advised that changes in the present or proposed use of the site may require further site characterization and mitigation activities. You may also be required to satisfy requirements of the Regional Water Quality Control Board for final site closure. Please check with that office as necessary. It is the property owner's responsibility to notify this agency of any changes in report content, future contamination findings, or site usage.

If you have any questions regarding this matter, please contact this office.

Sincerely,

Thomas F. Peacock, Supervising HMS  
Hazardous Material Division

cc: Regional Water Quality Control Board



March 30, 1992  
STID# 1630

DEPARTMENT OF ENVIRONMENTAL HEALTH  
Hazardous Materials Division  
80 Swan Way, Rm. 200  
Oakland, CA 94621  
(510) 271-4320

REMEDIAL ACTION COMPLETION CERTIFICATE  
(Without Regional Board Concurrence)

Nick Carpenter  
Emporium Capwell Co.  
444 S. Flower St.  
Los Angeles, CA 90071

Dear Nick Carpenter:

SUBJECT: Capwell's Chevron, 1911 Telegraph Ave., Oakland, CA 94612

This letter confirms the completion of site investigation and remedial action for the underground storage tanks at the above site. With the provision that the information provided to this agency was accurate and representative of existing conditions, it is the position of this office that no further action is required at this time.

Please be advised that this letter does not relieve you of any liability under the California Health and Safety Code or Water Code for past, present, or future operations at the site. Nor does it relieve you of the responsibility to clean up existing, additional or previously unidentified conditions at the site, which cause or threaten to cause pollution or nuisance or otherwise pose a threat to water quality or public health.

Additionally, be advised that changes in the present or proposed use of the site may require further site characterization and migration activity. It is the property owner's responsibility to notify this agency of any changes in report content, future contamination findings, or site usage.

If you have any questions regarding this matter, please contact this office.

Sincerely,

A handwritten signature in cursive script that reads "Thomas F. Peacock".

Thomas F. Peacock, Supervising HMS  
Hazardous Material Division

ALAMEDA COUNTY  
HEALTH CARE SERVICES

AGENCY

DAVID J. KEARS, Agency Director



State Water Resources Control Board  
Division of Clean Water Programs  
USF Local Oversight Program

RAFAT A. SHAHID, Assistant Agency Director

DEPARTMENT OF ENVIRONMENTAL HEALTH  
Hazardous Materials Division  
80 Swan Way, Rm. 200  
Oakland, CA 94621  
(510) 271-4320

April 1, 1992

San Francisco Bay Region  
Regional Water Quality Control Board  
ATTN: Rich Hiatt  
2101 Webster St., 4th Floor  
Oakland, CA 94612

Re: Emporium Capwell sites (STID #'s 1630 @ 1911 Telegraph and 3796 @  
20th and Telegraph, both in Oakland

Dear Rich Hiatt:

This office has reviewed the files of the above sites and has issued  
REMEDIAL ACTION COMPLETION CERTIFICATES (without Regional Board  
Concurrence) on both sites. Attached find additional documentation  
which you may need for the Board to also concur. There is other  
information in our files that was not determined to be important  
enough to copy at this time.

If you have any questions please contact this office at 271-4530.

Sincerely,

Thomas F. Peacock, Supervising HMS  
Hazardous Material Division

c: Nick Carpenter, Emporium Capwell, 444 S. Flower St., Los Angeles,  
CA 90071



Carter Hawley Hale

91 FEB 15 11:48

February 8, 1991

ALAMEDA COUNTY HEALTH CARE SERVICES AGENCY  
Department of Environmental Health  
80 Swan Way, Room 200  
Oakland, CA 94621  
ATTN: Paul M. Smith

Re: Former Capwells Chevron  
1911 Telegraph Ave.  
Oakland, CA 94612

Dear Mr. Smith:

In reference to your letter dated December 13, 1990, and Mr. Howard Wallach's (CHH) letter dated December 28, 1990, we have had Dames & Moore check their files on referenced project.

Attached is Dames & Moore (Essi Esmaili) letter dated January 11, 1991, with their Site Remediation Report dated March 21, 1988. I hope this will answer any questions you had on this project.

If you have further questions, please do not hesitate to contact me.

Thank you.

Sincerely,

CARTER HAWLEY HALE STORES, INC.

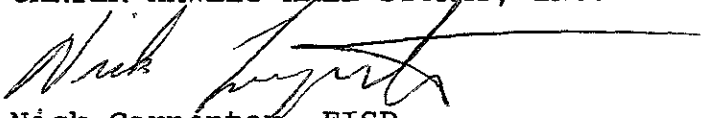
  
Nick Carpenter, FISP  
Director Construction Management

NC:slp

cc: Howard Wallach  
John Healy  
Essi Esmaili



# DAMES & MOORE

A PROFESSIONAL LIMITED PARTNERSHIP

6 HUTTON CENTRE DRIVE, SUITE 700, SANTA ANA, CALIFORNIA 92707 (714) 433-2000  
FAX (714) 433-2364 FAX (714) 433-2365

January 11, 1991

Carter Hawley Hale  
444 South Flower Street  
Los Angeles, CA 90017-2900

Attention: Mr. Howard Wallach, Vice President  
Construction Management

Subject: Former Emporium Capwells Chevron  
1911 Telegraph Avenue  
Oakland, California 94612

Dear Howard:

We received and reviewed a letter from Alameda County Health Care Services Agency (ACHCSA), dated December 13, 1990, regarding former Capwells Chevron, 1911 Telegraph Avenue, in Oakland, California (site). The letter states that there are some data gaps in ACHCSA files on the specifics of what remedial measures had been implemented at the site.

We reviewed a Dames & Moore report entitled "Toxics and Underground Tank Removals, Post Construction Report, Emporium Capwell, Oakland, California" dated March 21, 1988, a copy of which is attached. Review of the Dames & Moore report indicates that the site was remediated in concurrence and with approval of the ACHCSA. The attached report summarizes the investigations and remedial activities.

We suggest that you submit a copy of this report to the ACHCSA so that they can have all the pertinent facts.

Please do not hesitate to call use if there are any questions regarding this letter.

Sincerely,

DAMES & MOORE

E. Essi Esmaili, Ph.D.

EEE:mdm

A:128\1-11.L



**DAMES & MOORE**

A PROFESSIONAL LIMITED PARTNERSHIP

6 HUTTON CENTRE DRIVE, SUITE 700, SANTA ANA, CALIFORNIA 92707 (714) 433-2000  
FAX (714) 433-2364 FAX (714) 433-2365

January 11, 1991

Carter Hawley Hale  
444 South Flower Street  
Los Angeles, CA 90017-2900

Attention: Mr. Howard Wallach, Vice President  
Construction Management

Subject: Former Emporium Capwells Chevron  
1911 Telegraph Avenue  
Oakland, California 94612

Dear Howard:

We received and reviewed a letter from Alameda County Health Care Services Agency (ACHCSA), dated December 13, 1990, regarding former Capwells Chevron, 1911 Telegraph Avenue, in Oakland, California (site). The letter states that there are some data gaps in ACHCSA files on the specifics of what remedial measures had been implemented at the site.

We reviewed a Dames & Moore report entitled "Toxics and Underground Tank Removals, Post Construction Report, Emporium Capwell, Oakland, California" dated March 21, 1988, a copy of which is attached. Review of the Dames & Moore report indicates that the site was remediated in concurrence and with approval of the ACHCSA. The attached report summarizes the investigations and remedial activities.

We suggest that you submit a copy of this report to the ACHCSA so that they can have all the pertinent facts.

Please do not hesitate to call use if there are any questions regarding this letter.

Sincerely,

DAMES & MOORE

E. Essi Esmaili, Ph.D.

EEE:mdm

A:128M-11.L



DEPARTMENT OF ENVIRONMENTAL HEALTH

APPLICATION FORM

MFR Sent \_\_\_\_\_ (date)

PURPOSE: Permit Application  Service  Renewal

Computer No. \_\_\_\_\_

TYPE OF ACTION: New Premises  Change of Owner  Change of Name  Change of Status  Change of Mailing Address  Inactivate  Delete  Unincorp.

Site Search Premises Name Chevron (former) SUPV. DIST. \_\_\_\_\_ C.T. 4

A. Premises Address 1911 Telegraph Ave Oakland 94612  
Number Street City Zip Code Phone

Owner/Applicant Ms Jennifer Hymen Woodward Clyde Consultants  
If corporation, also show name of corporation president Phone

B. Mailing Address 500 12th Street Suite 100 Oakland 94607-4014  
Number Street City Zip Code

SEND BILLING TO ADDRESS: A, B (circle one)

Prior Business Name \_\_\_\_\_ Prior Owner's Name \_\_\_\_\_

Property Owner \_\_\_\_\_  
If corporation, also show name of corporation president Phone

Address \_\_\_\_\_  
Number Street City Zip Code

E.U. NO.	_____	C.P. CODE	_____
<b>FOOD CATEGORIES</b>			
<b>Bakery</b>	<b>Temporary Food Operation</b>	<b>Private Waste Disposal</b>	
___ Under 2,000 sq. ft. (130)	___ Special Event Facility (113)	___ Site Evaluation	
___ 2,000 - 6,000 sq. ft. (131)	___ (not to exceed 3 days)	___ Percolation Test	
___ Over 6,000 sq. ft. (132)	___ Temporary Food Facility (108)	___ Plan Review	
<b>Food Market, Retail</b>	___ (not to exceed 21 days)	___ Installation	
___ Under 3,000 sq. ft. (120)	___ Seasonal Food Facility (129)	<b>Holding Tank</b>	
___ 3,000 - 10,000 sq. ft. (121)	___ (not to exceed 45 days)	___ Site Evaluation	
___ Over 10,000 sq. ft. (122)	<b>Food Vehicle</b>	___ Installation	
___ Confectionary (125)	___ Vehicle Application Fee	___ Inspection	
<b>Restaurant</b>	___ Mobile Food Prep. Unit (107)	<b>Water Supply-Utility</b>	
___ Tavern, Cocktail lounge (104)	___ Stationary M.F.P.U. (117)	___ Community System	
___ Snack Bar (105)	___ Retail Food Vehicle (112)	___ Non-Community System	
___ Drive-In, Take Out (110)	___ Itinerant Vehicle (128)	___ State Small Water System	
___ Catering Commissary (111)		___ Local Small Water System	
___ Under 26 seats (100)		<b>Private Water Supply</b>	
___ 26 - 50 seats (101)		___ Flow, Bacti. & Chem. Anal.	
___ 51 - 75 seats (102)		<b>Drinking Water Analysis</b>	
___ Over 75 seats (103)		___ Bacterial	
___ In Plant Feeding (114)		___ Chemical	
___ Bed & Breakfast (Cont.) (115)		___ Flow Rate	
___ Bed & Breakfast (Reg.) (116)		<b>Other</b>	
___ Vending Machine		_____	
<b>Other Food</b>	<b>GENERAL CATEGORIES</b>		
_____	___ Plan Review		
	___ Special Service		
	___ Public Swimming Area		
	___ Commercial Spa		
	___ Mobilehome Park		
	No. Spaces _____		

Number of Units/Hrs. 1.0 Fee Per Unit/Hr. \$ 60.00 Total Fee \$ 60.00

REMARKS: site search one hour

You will receive a BILL in accordance with Article 11 of Chapter 6, Title 3 of the Ordinance Code of Alameda County

Owner/Applicant Haz Mat Specialist Sanitarian Paul M. Brink Date 12/31/90  
Phone 271-4320

12/31/90

To: Jen Hyman

Woodward Clyde Consultants

500 12th Street Suite 100

Oakland, CA 94607-4014

RE: site search 1911 Telegraph Ave - <sup>former</sup> Chevron

Dear Ms. Hyman,

This information is in response to your request for information on the above site.

On January 25, 1988 (4) UST's were removed  
samples were taken in former tank excavations 1/29/88

Results found TPH(g) levels of 110, 140, 1400 ppm

It appears that over excavation occurred in areas where initial contamination was found.

Analytical data collected on 2/4/88 revealed low levels of contamination remained on site. The highest TPH value was 30 ppm, highest benzene level was 0.1 ppm.

It appears that 1 mw (2" pvc) was installed on site.

It was not readily apparent that groundwater gradient has been established for this site.

No well borings are available.

On 12/13/90 a letter from Alameda Co. Env. Health, Haz Mat Div. was sent to the property owner requesting workplans, tank closure reports, methodology for delineating lat & vert extent of contamination, or quarterly reports.

As of the date of this letter no response has been received by this office.

Cameron Tank

19th Street

55'

Excavation perimeter

Reverse tank position

7 gallon

5 gallon

20 gallon

Well One

Chevron Gas Station

Telegraph Ave.

3900'



15'

Soil sample here

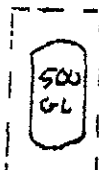

Boring One

WASTE OIL

Monitoring well here

300'

20th Street

(NOT TO SCALE)

NORTH

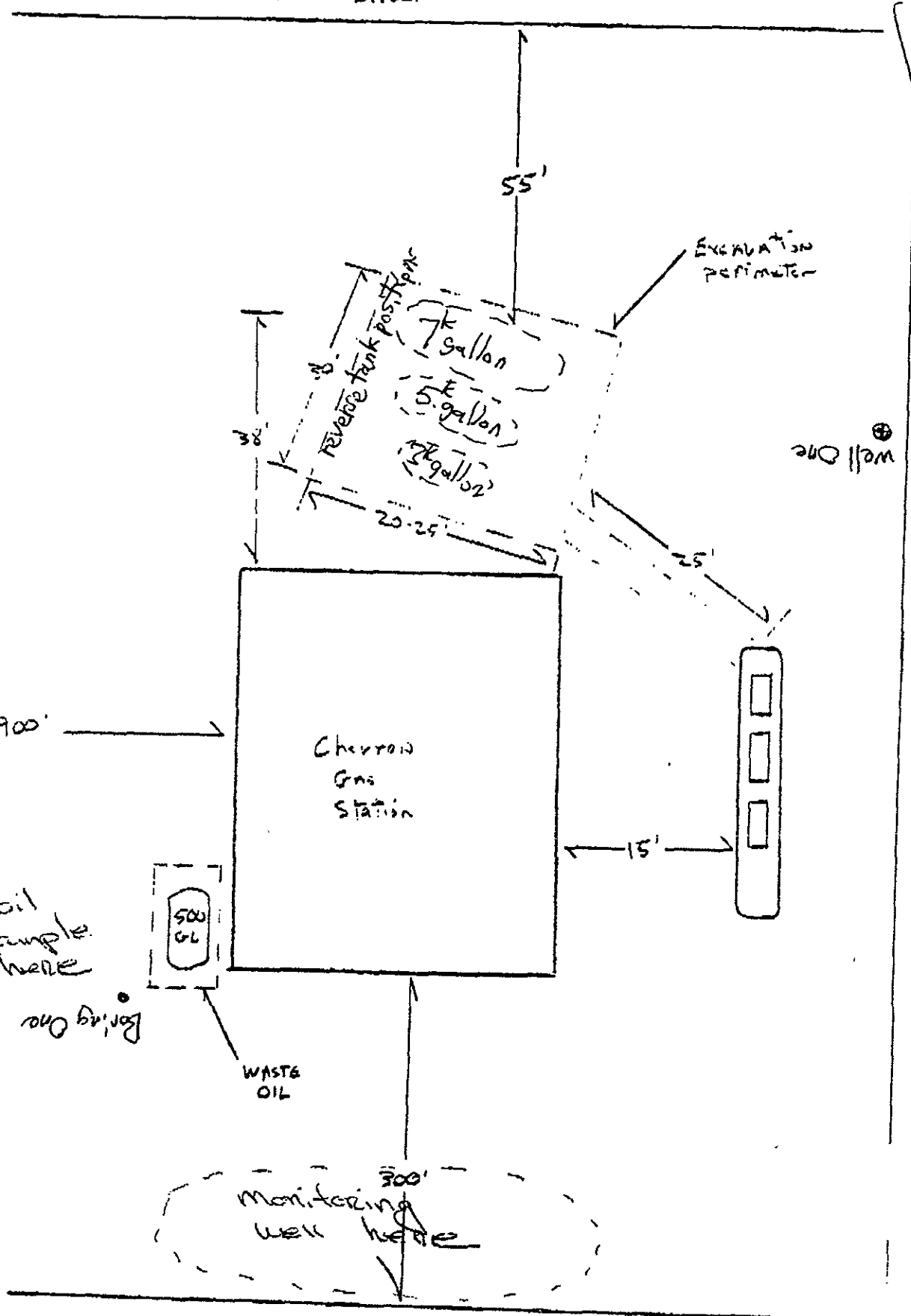



Howard Wallach  
Vice President

CO DEC 33 PM 1:42

December 28, 1990

VIA EXPRESS MAIL

Mr. Paul M. Smith  
Hazardous Materials Specialist  
**ALAMEDA COUNTY HEALTH CARE SERVICES AGENCY**  
Department of Environmental Health  
Hazardous Materials Program  
80 Swan Way, Room 200  
Oakland, California 94621

**RE: FORMER EMPORIUM CAPWELLS CHEVRON  
1911 TELEGRAPH AVENUE  
OAKLAND, CALIFORNIA 94612**

Dear Mr. Smith:

In reference to your letter dated December 13, 1990 (copy attached) we are searching our files for information concerning your request, as soon as the information is located, we will submit posthaste. We recently moved our offices and this is an old file, we will need approximately two weeks to recover all the data. We will get the information to you as quickly as possible.

Best regards,

**CARTER HAWLEY HALE STORES, INC.**

Howard Wallach  
Vice President Construction

HW:lh  
Attachments

cc: S. Meyer (with attachments)  
J. Healy " "  
E. Esmaili " "

(dictated but not read)  
HOW028

444 South Flower Street  
P.O. Box 17902  
Los Angeles, California 90017  
213/620-0150 Telex 67-264

The Broadway-Southern California  
The Broadway-Southwest  
Emporium Capwell  
Thalhmers  
Weinstock's

ALAMEDA COUNTY  
HEALTH CARE SERVICES

AGENCY  
DAVID J. KEARS, Agency Director



DEPARTMENT OF ENVIRONMENTAL HEALTH  
Hazardous Materials Program  
80 Swan Way, Rm. 200  
Oakland, CA 94621  
(415)

Certified Mailer # P 062 128 235

December 13, 1990

DEC 20 1990

John M. Healy  
Carter-Hawley-Hale Stores Inc.  
550 South Flower St.  
Los Angeles, CA 90071

**RE: Former Capwells Chevron, 1911 Telegraph Ave., Oakland CA  
94612**

Dear Mr. Healy:

This letter is with regard to the site remediation at the above location. In examining documentation of this site currently available in this office it appears that some data gaps exist of information on the specifics of what remedial measures have been taken.

Initial soil results taken beneath the tank excavations indicated Total Petroleum Hydrocarbon (TPH) contamination of 110, 140 and 1400 ppm.

Correspondence to this office from Dames and Moore dated March 23, 1988 provided groundwater analytical results reported from a "Waste Monitoring Well". However, no workplan for the installation of the groundwater monitoring wells, proposed methodology for establishing hydraulic gradient, or proposed methods for delineating the lateral or vertical extent of soil or groundwater contamination are available.

The only information available with regard to the monitoring well installed at this site is a Department of Water Resources Well Drillers Report and a rough sketch of the position of the well relative to the site.

Mr. Healy  
December 13, 1990  
page 2 of 2

You are requested provide to this office copies of any information such as workplans, tank closure reports or quarterly groundwater monitoring reports which would describe the efforts taken regarding the remediation of the soil or groundwater at the above site. You are requested to respond to this request for information within 14 days of the receipt of this letter.

If you have any questions please direct them to me at (415) 271-4320.

Sincerely,

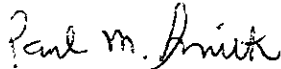

Paul M. Smith  
Hazardous Materials Specialist

cc:

Nancy Vukelich, Chevron USA Inc.  
Gil Jensen, Alameda County District Attorney's Office of  
Consumer and Environmental Affairs  
Lester Feldman, SFRWQCB  
Howard Hatayama, DHS  
Rafat A. Shahid, Assistant Agency Director, Alameda County  
Environmental Health Dept.  
Files

ALAMEDA COUNTY  
HEALTH CARE SERVICES

AGENCY  
DAVID J. KEARS, Agency Director



DEPARTMENT OF ENVIRONMENTAL HEALTH  
Hazardous Materials Program  
80 Swan Way, Rm. 200  
Oakland, CA 94621  
(415)

Certified Mailer # P 062 128 235

December 13, 1990

DEC 20 1990

John M. Healy  
Carter-Hawley-Hale Stores Inc.  
550 South Flower St.  
Los Angeles, CA 90071

**RE: Former Capwells Chevron, 1911 Telegraph Ave., Oakland CA  
94612**

Dear Mr. Healy:

This letter is with regard to the site remediation at the above location. In examining documentation of this site currently available in this office it appears that some data gaps exist of information on the specifics of what remedial measures have been taken.

Initial soil results taken beneath the tank excavations indicated Total Petroleum Hydrocarbon (TPH) contamination of 110, 140 and 1400 ppm.

Correspondence to this office from Dames and Moore dated March 23, 1988 provided groundwater analytical results reported from a "Waste Monitoring Well". However, no workplan for the installation of the groundwater monitoring wells, proposed methodology for establishing hydraulic gradient, or proposed methods for delineating the lateral or vertical extent of soil or groundwater contamination are available.

The only information available with regard to the monitoring well installed at this site is a Department of Water Resources Well Drillers Report and a rough sketch of the position of the well relative to the site.

Mr. Healy  
December 13, 1990  
page 2 of 2

You are requested provide to this office copies of any information such as workplans, tank closure reports or quarterly groundwater monitoring reports which would describe the efforts taken regarding the remediation of the soil or groundwater at the above site. You are requested to respond to this request for information within 14 days of the receipt of this letter.

If you have any questions please direct them to me at (415) 271-4320.

Sincerely,

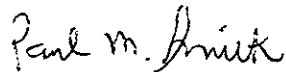

Paul M. Smith  
Hazardous Materials Specialist

cc:

Nancy Vukelich, Chevron USA Inc.  
Gil Jensen, Alameda County District Attorney's Office of  
Consumer and Environmental Affairs  
Lester Feldman, SFRWQCB  
Howard Hatayama, DHS  
Rafat A. Shahid, Assistant Agency Director, Alameda County  
Environmental Health Dept.  
Files



ALAMEDA COUNTY  
HEALTH CARE SERVICES

AGENCY  
DAVID J. KEARS, Agency Director



DEPARTMENT OF ENVIRONMENTAL HEALTH  
Hazardous Materials Program  
80 Swan Way, Rm. 200  
Oakland, CA 94621  
(415)

Certified Mailer # P 062 128 235

December 13, 1990

John M. Healy  
Carter-Hawley-Hale Stores Inc.  
550 South Flower St.  
Los Angeles, CA 90071

**RE: Former Capwells Chevron, 1911 Telegraph Ave., Oakland CA  
94612**

Dear Mr. Healy:

This letter is with regard to the site remediation at the above location. In examining documentation of this site currently available in this office it appears that some data gaps exist of information on the specifics of what remedial measures have been taken.

Initial soil results taken beneath the tank excavations indicated Total Petroleum Hydrocarbon (TPH) contamination of 110, 140 and 1400 ppm.

Correspondence to this office from Dames and Moore dated March 23, 1988 provided groundwater analytical results reported from a "Waste Monitoring Well". However, no workplan for the installation of the groundwater monitoring wells, proposed methodology for establishing hydraulic gradient, or proposed methods for delineating the lateral or vertical extent of soil or groundwater contamination are available.

The only information available with regard to the monitoring well installed at this site is a Department of Water Resources Well Drillers Report and a rough sketch of the position of the well relative to the site.

Mr. Healy  
December 13, 1990  
page 2 of 2

You are requested provide to this office copies of any information such as workplans, tank closure reports or quarterly groundwater monitoring reports which would describe the efforts taken regarding the remediation of the soil or groundwater at the above site. You are requested to respond to this request for information within 14 days of the receipt of this letter.

If you have any questions please direct them to me at (415) 271-4320.

Sincerely,



Paul M. Smith  
Hazardous Materials Specialist

cc:

Nancy Vukelich, Chevron USA Inc.  
Gil Jensen, Alameda County District Attorney's Office of  
Consumer and Environmental Affairs  
Lester Feldman, SFRWQCB  
Howard Hatayama, DHS  
Rafat A. Shahid, Assistant Agency Director, Alameda County  
Environmental Health Dept.  
Files

P 062 126 235

RECEIPT FOR CERTIFIED MAIL  
NO INSURANCE COVERAGE PROVIDED  
NOT FOR INTERNATIONAL MAIL  
(See Reverse)

Sent to	
Street and No	
P. O., State and ZIP Code	
Postage	\$
Certified Fee	
Special Delivery Fee	
Extraordinary Delivery Fee	
Postmark (Receipt showing to whom and Date Delivered)	
Actual Receipt showing to whom Date, and Address of Delivery	
U. S. A. Postage and Fees	\$
Postmark or Date	

PS Form 3800

500 12th Street  
Suite 100  
Oakland CA 94607-4014  
(415) 893-3600

# Woodward-Clyde Consultants

December 5, 1990  
90C0217A-0200

90 DEC -6 11:12:08

Mr. Paul Smith  
Hazardous Materials Specialist  
Alameda County Department of Environmental Health  
Division of Hazardous Materials  
80 Swan Way, Suite 200  
Oakland, CA 94621

Re: Fuel Leak Case at  
Capwell's Parking/Chevron  
1911 Telegraph Ave.  
Oakland, CA 94612

Dear Mr. Smith:

The aforementioned site is currently the subject of an environmental site assessment. We are interested in obtaining specific details regarding this site at which your office is currently overseeing remediation, as per our phone conversation of Monday, December 3, 1990. We understand this information is available through the Freedom of Information Act.

We are aware that in early 1988 four underground storage tanks (USTs) were removed, a 7,000, a 5,000, a 3,000 and a 500-gallon tank. One tank that had contained waste oil was found to be perforated. Contaminated soil was over-excavated and monitoring wells were installed. No groundwater remediation has been performed. This case was subsequently closed, presumably because the site was considered "safe" by county officials. We are specifically interested in the following:

1. Verification of the aforementioned site information.
2. The number and location of monitoring wells installed (provide map if possible).
3. The groundwater direction and gradient.
4. Soil lithology encountered.
5. Data on the maximum contaminant concentrations in the groundwater.
6. Data on the most recent contaminant concentrations in the groundwater (post-excavation of soil).
7. Data on the most recent contaminant concentrations in the soil (post-excavation).

Consulting Engineers, Geologists  
and Environmental Scientists

Offices in Other Principal Cities



Mr. Paul Smith  
Alameda County Department of Environmental Health  
December 5, 1990  
Page 2

8. The possibility of accessing the monitoring wells for sampling by Woodward-Clyde.

The results of this inquiry need not be typed up in a report or letter format, as long as they are legible. Our understanding is that your Department charges a sixty dollar (\$60.00) per hour files search fee. Please notify me by telephone (415) 874-3058 if you will not be able to complete this request by Monday, December 17, 1990 or if your efforts will require more than two (2) hours of research. Thank you for your cooperation in this matter.

Sincerely,

WOODWARD-CLYDE CONSULTANTS



Jennifer A. Hyman  
Senior Staff Engineer

JAH:adg  
90C0217AL2/ADG

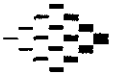

Carter Hawley Hale

February 22, 1989

Real Estate

ALAMEDA COUNTY  
DEPT. OF ENVIRONMENTAL HEALTH  
HAZARDOUS MATERIALS

2/27/89

Alameda County Department of Environmental Health  
Hazardous Materials Division  
80 Swan Way, Room 200  
Oakland, CA 94621

Re: Capwell's Parking

Gentlemen:

This is to inform you that the service station once operating in conjunction with the above-named business was closed by us in January 1988. All underground storage tanks were removed in February 1988.

We have completed the enclosed forms and trust this answers all your questions.

Sincerely,

Linda Dorman  
Real Estate Coordinator

ld

Encl.

ALAMEDA COUNTY HEALTH CARE SERVICES AGENCY  
 DEPARTMENT OF ENVIRONMENTAL HEALTH  
 HAZARDOUS MATERIALS DIVISION

**DRAFT**

ACCEPTED  
 DEPARTMENT OF ENVIRONMENTAL HEALTH  
 470 - 27th Street, Third Floor  
 Oakland, CA 94612  
 Telephone: (415) 874-7237

470 - 27th St., RM 322  
 OAKLAND, CA 94612  
 PHONE NO. 415/874-7237

These plans have been reviewed and found to be acceptable and essentially meet the requirements of State and local health laws. Changes to your plans indicated by this Department are to assure compliance with State and local laws. The project proposed herein is now released for issuance of any required building permits for construction.

Copy of these accepted plans must be on the job site available to all contractors and craftsmen involved in the construction and installation.

Any change or alteration of these plans and specifications must be submitted to this Department and to the Building Department for their review and determination. Changes may be required at State and local levels.

Notify this Department at least 48 hours prior to the following required inspections:

- Pre-Covering of Tank and Pipelines
- Final Inspection

Issuance of a permit to operate is dependent on compliance with accepted plans and all applicable regulations.

THERE IS A FINANCIAL PENALTY FOR VIOLATING THESE INSPECTIONS

*Sehnam*

*1-19-88*

Project # \_\_\_\_\_  
 Paid \_\_\_\_\_  
 Date \_\_\_\_\_

UNDERGROUND TANK CLOSURE/MODIFICATION PLANS

- Business Name Chevron (Previous)  
 Business Owner Carter - Hawley - Hale
- Site Address 1911 Telegraph Ave  
 City Oakland CA Zip 94612 Phone \_\_\_\_\_
- Mailing Address 40 Hillside Mall  
 City San Mateo CA Zip 94403 Phone (415) 572-5666
- Land Owner Carter Hawley - Hale  
 Address 40 Hillside Mall city, state CA zip 94403
- EPA I.D. No. ~~CAD 982357170~~ CAC 000059613
- Contractor TRACE Environmental Services, Inc.  
 Address 3084 Sunrise Blvd, Suite 9  
 City Rancho Cordova, CA Phone 916 638-8045  
 License Type A
- Other (Specify) DAMES & MOORE (consultant)  
 Address 221 Main St. Suite 600  
 City San Francisco Phone 415 296-5858

DRAFT

8. Contact Person for Investigation

Name Jim Curtis Title Staff Engineer  
Phone 415 896 5858

9. Total No. of Tanks at facility 4

10. Have permit applications for all tanks been submitted to this office? Yes [] No []

11. State Registered Hazardous Waste Transporters/Facilities

a) Product/Waste Tranporter

~~HEH~~

Name ~~Trace Environmental Services, Inc.~~ EPA I.D. No. CAD982357170  
Address 3084 Sunrise Blvd, Suite 9  
City Rancho Cordova State CA Zip 95742

b) Rinsate Transporter

Name Trace Environmental Services, Inc. EPA I.D. No. CAD982357170  
Address SAME  
City - State - Zip -

c) Tank Transporter

Name Trace Env. Services, Inc. EPA I.D. No. CAD982357170  
Address SAME  
City - State - Zip -

d) Contaminated Soil Transporter

Name Trace Env. Services, Inc. EPA I.D. No. CAD982357170  
Address SAME  
City - State - Zip -

Tanks to C&C Graymeyer (SR)  
- cad 2' Spales in SR & physically examine tanks

12. Sample Collector

Name Jim Curtis  
Company DAMES & MOORE  
Address 221 Main Street  
City S.F. State CA Zip 94105-1917 Phone 415 896 5858

13. Sampling Information for each tank or area

Tank or Area		Material sampled	Location & Depth
Capacity	Historic Contents (past 5 years)		
7000 gal.	Reg. leaded gas	soil beneath tank	2' below bottom of excavated tank - 1 sample at each end of tank. Repeat process for each individual tank.
5000 gal.	unleaded	"	
3000 gal.	super unleaded	"	
500 gal.	waste oil	"	

14. Have tanks or pipes leaked in the past? Yes [ ] No  (unknown)

If yes, describe. n/a

15. NFPA methods used for rendering tank inert? Yes  No [ ]

If yes, describe. triple rinse with high pressure washer and vacuum dry - repeat with detergent to break film on inner tank wall. Place 10 lbs of dry ice per 1000 gallon capacity upon completion of rinse. Measure tank with sniffer for L.E.L. concentrations

16. Laboratories

Name Acurex Soil Testing

Address 405 Clyde Ave

City Mountain View State CA zip 94039

State Certification No. 125

(415) 961-5700



17. Chemical Methods to be used for Analyzing Samples

**DRAFT**

Contaminant Sought	EPA, DHS, or Other Sample Preparation Method Number	EPA, DHS, or Other Analysis Number
TFP/TPA gas, diesel, Benzene, Toluene, Xylene, Ethylbenzene Volatile Organics W.D. - Aromatic Volatile Organics PCB's JTOG Total Organic lead	8015m, 8020, 8080, <del>410.1</del> , 7421 Sample @ Jantz, E @ 20' m.	n/A

18. Site Safety Plan submitted? Yes [ ] No

19. Workman's Compensation: Yes  No [ ]

Copy of Certificate enclosed? Yes [ ] No

Name of Insurer Argonaut Ins. Policy # WC50466538821

20. Plot Plan submitted? Yes  No [ ]

21. Deposit enclosed? Yes  No [ ]

22. Please forward to this office the following information within 60 days after receipt of sample results.

- a) Chain of Custody Sheets
- b) Original Signed Laboratory Reports
- c) TSD to Generator copies of wastes shipped and received
- d) Attachment A summarizing laboratory results

**DRAFT**

I declare that to the best of my knowledge and belief the statements and information provided above are correct and true. I understand that information in addition to that provided above may be needed in order to obtain an approval from the Department of Environmental Health and that no work is to begin on this project until this plan is approved.

I understand that any changes in design, materials or equipment will void this plan if prior approval is not obtained.

I will notify the Department of Environmental Health at least two (2) working days (48 hours) in advance to schedule any required inspections. I understand that site and worker safety are solely the responsibility of the property owner or his agent and that this responsibility is not shared nor assumed by the County of Alameda.

Signature of Contractor

Name (please type) Edward V. Rose / TRACE Environmental Serv. Inc.  
Signature Edward V. Rose  
Date 1/19/88

Signature of Site Owner or Operator

Name (please type) Jim Curtis, agent for Carter-Hawley-Hale  
Signature Jim Curtis  
Date 1/19/88

NOTES:

1. Any changes in this document must be approved by this Department.
2. Any leaks discovered must be submitted to this office on an underground storage tank unauthorized leak/contamination site report form within 5 days of its discovery.
3. Three (3) copies of this plan must be submitted to this Department. One copy must be at the construction site at all times.
4. A copy of your approved plan must be sent to the landowner.

**CRAFT**

**UNDERGROUND TANK CLOSURE/MODIFICATION PLANS**

**ATTACHMENT A  
SAMPLING RESULTS**

Tank or Area	Contaminant	Location & Depth	Results (specify units)

**CRATT**

INSTRUCTIONS

2. SITE ADDRESS

Address at which closure or modification is taking place.

5. EPA I.D. NO.

This number may be obtained from the State Department of Health Services, 916/324-1781.

6. CONTRACTOR

Prime contractor for the project.

7. OTHER

List professional consultants here.

12. SAMPLE COLLECTOR

Persons who are collecting samples.

13. SAMPLING INFORMATION

Historic contents - the principal product(s) used in the last 5 years.

Material sampled - i.e., water, oil, sludge, soil, etc.

16. LABORATORIES

Laboratories used for chemical and geotechnical analyses.

17. CHEMICAL METHODS:

All sample collection methods and analyses should conform to EPA or DHS methods.

Contaminant - Specify the chemical to be analyzed.

Sample Preparation Method Number - The means used to prepare the sample prior to analyses - i.e., digestion techniques, solvent extraction, etc. Specify number of method and reference if not an EPA or DHS method.

Analysis Method Number - The means used to analyze the sample - i.e., GC, GC-MS, AA, etc. Specify number of method and reference if not a DHS or EPA method.

NOTE:

Method Numbers are available from certified laboratories.

18. SITE SAFETY PLAN

A plan outlining protective equipment and additional specialized personnel in the event that significant amount of hazardous materials are found. The plan should consider the availability of respirators, respirator cartridges, self-contained breathing apparatus (SCBA) and industrial hygienists.

**DRAFT**

19. ATTACH COPY OF WORKMAN'S COMPENSATION

20. PLOT PLAN

The plan should consists of a scaled view of the facility at which the tank(s) are located and should include the following information:

- a) Scale
- b) North Arrow
- c) Property Line
- d) Location of all Structures
- e) Location of all relevant existing equipment including tanks and piping to be removed
- f) Streets
- g) Underground conduits, sewers, water lines, utilities
- h) Existing wells (drinking, monitoring, etc.)
- i) Depth to ground water
- j) All existing tanks in addition to the ones being pulled

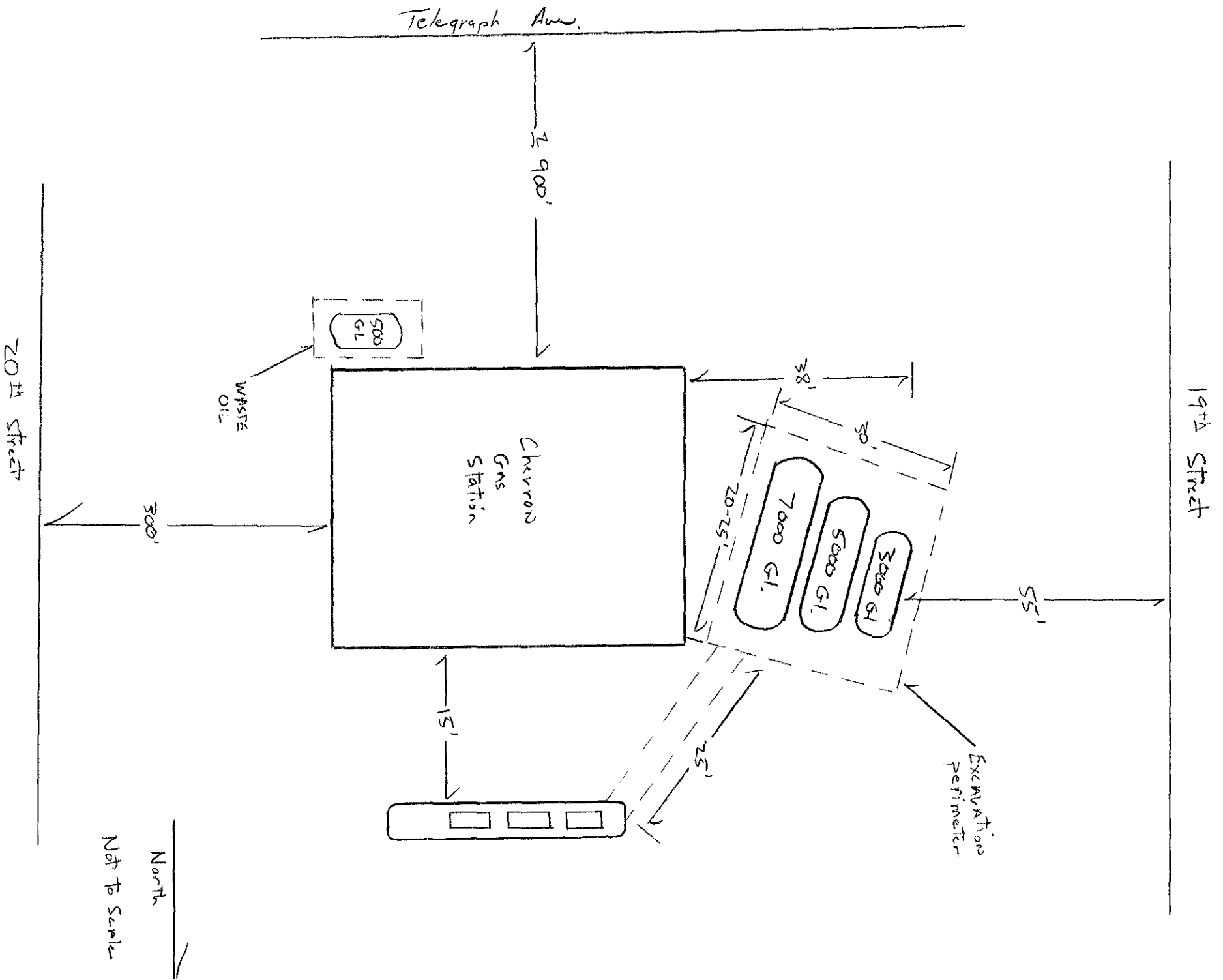



# Hydro-Chem Services, Inc.

Hunters Point Shipyard, Bldg. 418, Box 76  
San Francisco, Ca. 94124

(415) 822-1181

DEC 26 1986

Hageman & Schank  
2723 Crow Canyon Rd.  
Suite 210  
San Ramon, Ca 94583

December 22, 1986

Emporium Capwell, Telegraph Ave.

We propose hereby to furnish labor, material and equipment to complete in accordance with specification below for the sum of:  
FOUR THOUSAND NINE HUNDRED SIX DOLLARS \$4,906.00.

- (1) Removal of existing material from (2) tanks.
- (2) Dispose of same.
- (3) Pressure wash (2) tanks.
- (4) Remove & dispose of wash water.

All work to be done in accordance with State, Federal and local regulations. This bid quotation is based on job site inspection and information provided during inspection. To ensure a safe working environment, Hydro-Chem Services will barricade the area in which the work is to be performed. Also, we will require an adequate set-up and staging area for equipment and a vacuum truck.

Hydro-Chem Services, Inc.

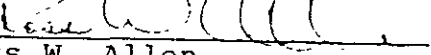
By   
Ross W. Allen  
President, General Manager

Carter Hawley Hale Stores, Inc.

550 South Flower Street, Los Angeles, California 90071

(213) 620-0150

Telex 67-264

October 14, 1986

*yes  
permit TANKS*

**RECEIVED**  
OCT 16 1986

**ENVIRONMENTAL HEALTH  
ADMINISTRATION**

Mr. Ted Gerow  
Alameda County Health Care Services Agency  
Alameda County Water Resources Control District  
470 27th Street  
3rd Floor  
Oakland, CA 94612

Re: Capwell's Parking  
1911 Telegraph Ave.

Dear Mr. Gerow:

Enclosed are four permit applications for our under-ground storage tanks at the above referenced location. Please proceed with the processing of the applications.

I am available to answer any questions you may have.

Sincerely,



John M. Healy  
Manager of Properties

JMH:fsr  
Enclosure

cc: G. S. Kelleher  
S. E. Onorato Garages  
2000 Van Ness Ave.  
Suite 101  
San Francisco, CA 94109



# Permit Application



<input checked="" type="checkbox"/> 01 New Permit	<input checked="" type="checkbox"/> 03 Installed before July 1, 1984	<input type="checkbox"/> 05 Renewed Permit	<input type="checkbox"/> 06 Amended Permit
<input type="checkbox"/> 02 Provisional Permit	<input type="checkbox"/> 04 Installed after July 1, 1984		

## I Owner

Name (Corporation Individual or Public Agency) <b>CARTER HAWLEY HALE STORES, INC.</b>			
Street Address <b>550 South Flower Street</b>	City <b>Los Angeles</b>	State <b>CA</b>	ZIP <b>90071</b>

## II Facility

Facility Name <b>CAPWELL'S PARKING GARAGE</b>		Dealer/Foreman/Supervisor <b>Woody Johnsen</b>	
Street Address <b>1911 Telegraph Ave.</b>		Nearest Cross Street <b>19th</b>	
City <b>Oakland</b>		County <b>Alameda</b>	ZIP <b>94612</b>
Mailing Address <b>- Same -</b>		City	State ZIP
Phone w/area code <b>(415) 444-7662</b>		Type of Business <input checked="" type="checkbox"/> 01 Gasoline Station <input type="checkbox"/> 02 Other: _____	
NUMBER OF CONTAINERS AT THIS FACILITY <b>4</b>	Rural Areas Only:	Township	Range
			Section

## III 24 Hour Emergency Contact Person

Days Name (last name first) and Phone w/area code <b>Johnsen, Woody (415) 444-7662</b>	Nights Name (last name first) and Phone w/area code <b>Johnsen, Woody (415) 657-0293</b>
---	---

**COMPLETE THE FOLLOWING ON A SEPARATE FORM FOR EACH CONTAINER**

## IV Description

A. <input checked="" type="checkbox"/> 01 Tank <input type="checkbox"/> 02 Other: _____	Container Number (If there is no number assign one) <b>1</b>
B. Manufacturer (if appropriate): _____ Year of Mfg: _____	C. Year Installed <b>1963</b> <input type="checkbox"/> Unknown
D. Container Capacity: <b>7500</b> gallons <input type="checkbox"/> Unknown	E. Does the Container Store (Check One) <input type="checkbox"/> 01 Waste <input checked="" type="checkbox"/> 02 Product
F. Does the Container Store Motor Vehicle Fuel or Waste Oil? <input checked="" type="checkbox"/> 01 Yes <input type="checkbox"/> 02 No    If Yes, Check appropriate box(es). <input checked="" type="checkbox"/> 01 Unleaded <input type="checkbox"/> 02 Regular <input checked="" type="checkbox"/> 03 Premium <input type="checkbox"/> 04 Diesel <input type="checkbox"/> 05 Waste Oil <input type="checkbox"/> 06 Other (List): _____ If you answered yes; do not complete Part VIII.	

## V Container Construction

A. Thickness of Primary Containment: _____ <input type="checkbox"/> Gauge <input type="checkbox"/> Inches <input type="checkbox"/> cm <input checked="" type="checkbox"/> Unknown
B. <input type="checkbox"/> 01 Vaulted (Located in an underground Vault.) <input type="checkbox"/> 02 Non-vaulted <input checked="" type="checkbox"/> 03 Unknown
C. <input type="checkbox"/> 01 Double Walled <input type="checkbox"/> 02 Single Walled <input type="checkbox"/> 03 Lined
D. <input type="checkbox"/> 01 Carbon Steel <input type="checkbox"/> 02 Stainless Steel <input type="checkbox"/> 03 Fiberglass <input type="checkbox"/> 04 Polyvinyl Chloride <input type="checkbox"/> 05 Concrete <input type="checkbox"/> 06 Aluminum <input type="checkbox"/> 07 Steel Clad <input type="checkbox"/> 08 Bronze <input type="checkbox"/> 09 Composite <input type="checkbox"/> 10 Non-metallic <input type="checkbox"/> 11 Earthen Walls <input checked="" type="checkbox"/> 12 Unknown <input type="checkbox"/> 13 Other: _____

**Container Construction**

E  01 Rubber Lined     02 Alkyd Lining     03 Epoxy Lining     04 Phenolic Lining     05 Glass Lining     06 Clay Lining

07 Unlined     08 Unknown     09 Other: \_\_\_\_\_

---

F.  01 Polyethylene Wrap     02 Vinyl Wrapping     03 Cathodic Protection

04 Unknown     05 None     06 tar or asphalt     09 Other

**VI Piping**

A. Aboveground Piping:  01 Double-walled pipe     02 Concrete-lined trench     03 Gravity     04 Pressure     05 Suction

(Check) appropriate box(es)     06 Unknown     07 None

---

B. Underground Piping:  01 Double-walled pipe     02 Concrete-lined trench     03 Gravity     04 Pressure     05 Suction

(Check) appropriate box(es)     06 Unknown     07 None

**VII Leak Detection**

01 Visual     02 Stock Inventory     03 Tile Drain     04 Vapor Sniff Wells     05 Sensor Instrument

06 Ground Water Monitoring Wells     07 Pressure Test     08 Internal Inspection     09 None

10 Other: \_\_\_\_\_

**VIII Chemical Composition of Materials Currently or Previously Stored in Underground Containers**  
 If you checked yes to IV -F you are not required to complete this section.

currently stored	previously stored	CAS # (if known)	Chemical Do Not Use Commercial Name (Use additional paper for more room)
<input type="checkbox"/> 01	<input type="checkbox"/> 02		
<input type="checkbox"/> 01	<input type="checkbox"/> 02		
<input type="checkbox"/> 01	<input type="checkbox"/> 02		

Is Container located on an Agricultural Farm?  01 Yes     02 No

Person Filing (Signature) *J M Healy*    Phone w/area code (213) 239-6772

**For Local Agency Use Only**

AGENCY NAME	CITY	COUNTY
CONTACT PERSON	PHONE W/AREA CODE	
INSPECTION DATE (1ST INSPECTION)	PERMIT APPROVAL DATE	PERMIT ID. NUMBER

**FOR STATE USE ONLY**

STATE ID. NUMBER	Accounting Number	County Number
Date Received	<input type="checkbox"/> 01	<input type="checkbox"/> 02 <input type="checkbox"/> 03

# Permit Application



<input checked="" type="checkbox"/> 01 New Permit	<input checked="" type="checkbox"/> 03 Installed before July 1, 1984	<input type="checkbox"/> 05 Renewed Permit	<input type="checkbox"/> 06 Amended Permit
<input type="checkbox"/> 02 Provisional Permit	<input type="checkbox"/> 04 Installed after July 1, 1984		

## I Owner

Name (Corporation, Individual or Public Agency) <b>CARTER HAWLEY HALE STORES, INC.</b>			
Street Address <b>550 South Flower Street</b>	City <b>Los Angeles</b>	State <b>CA</b>	ZIP <b>90071</b>

## II Facility

Facility Name <b>CAPWELL'S PARKING GARAGE</b>		Dealer/Foreman/Supervisor <b>Woody Johnsen</b>	
Street Address <b>1911 Telegraph Ave.</b>		Nearest Cross Street <b>19th</b>	
City <b>Oakland</b>		County <b>Alameda</b>	ZIP <b>94612</b>
Mailing Address <b>- Same -</b>		City	State ZIP
Phone w/area code <b>(415) 444-7662</b>		Type of Business <input checked="" type="checkbox"/> 01 Gasoline Station <input type="checkbox"/> 02 Other: _____	
NUMBER OF CONTAINERS AT THIS FACILITY <b>4</b>	Rural Areas Only:	Township	Range
			Section

## III 24 Hour Emergency Contact Person

Days: Name (last name first) and Phone w/area code <b>Johnsen, Woody (415) 444-7662</b>	Nights: Name (last name first) and Phone w. area code <b>Johnsen, Woody (415) 657-0293</b>
--	---

**COMPLETE THE FOLLOWING ON A SEPARATE FORM FOR EACH CONTAINER**

## IV Description

A. <input checked="" type="checkbox"/> 01 Tank <input type="checkbox"/> 02 Other: _____	Container Number (if there is no number assign one) <b>2 -</b>
B. Manufacturer (if appropriate): _____ Year of Mfg.: _____	C. Year Installed: <b>1963</b> <input type="checkbox"/> Unknown
D. Container Capacity: <b>5000</b> gallons <input type="checkbox"/> Unknown	E. Does the Container Store (Check One): <input type="checkbox"/> 01 Waste <input checked="" type="checkbox"/> 02 Product
F. Does the Container Store Motor Vehicle Fuel or Waste Oil? <input checked="" type="checkbox"/> 01 Yes <input type="checkbox"/> 02 No    If Yes, Check appropriate box(es): <input checked="" type="checkbox"/> 01 Unleaded <input checked="" type="checkbox"/> 02 Regular <input type="checkbox"/> 03 Premium <input type="checkbox"/> 04 Diesel <input type="checkbox"/> 05 Waste Oil <input type="checkbox"/> 06 Other (List): _____ If you answered yes; do not complete Part VIII.	

## V Container Construction

A. Thickness of Primary Containment: _____ <input type="checkbox"/> Gauge <input type="checkbox"/> Inches <input type="checkbox"/> cm <input checked="" type="checkbox"/> Unknown
B. <input type="checkbox"/> 01 Vaulted (Located in an underground Vault.) <input type="checkbox"/> 02 Non-vaulted <input checked="" type="checkbox"/> 03 Unknown
C. <input type="checkbox"/> 01 Double Walled <input type="checkbox"/> 02 Single Walled <input type="checkbox"/> 03 Lined
D. <input type="checkbox"/> 01 Carbon Steel <input type="checkbox"/> 02 Stainless Steel <input type="checkbox"/> 03 Fiberglass <input type="checkbox"/> 04 Polyvinyl Chloride <input type="checkbox"/> 05 Concrete <input type="checkbox"/> 06 Aluminum
<input type="checkbox"/> 07 Steel Clad <input type="checkbox"/> 08 Bronze <input type="checkbox"/> 09 Composite <input type="checkbox"/> 10 Non-metallic <input type="checkbox"/> 11 Earthen Walls
<input checked="" type="checkbox"/> 12 Unknown <input type="checkbox"/> 13 Other: _____

**Container Construction**

E.  01 Rubber Lined     02 Alkyd Lining     03 Epoxy Lining     04 Phenolic Lining     05 Glass Lining     06 Clay Lining

07 Unlined     08 Unknown     09 Other: \_\_\_\_\_

---

F.  01 Polyethylene Wrap     02 Vinyl Wrapping     03 Cathodic Protection

04 Unknown     05 None     06 tar or asphalt     09 Other

**VI Piping**

A. Aboveground Piping:  01 Double-walled pipe     02 Concrete-lined trench     03 Gravity     04 Pressure     05 Suction

(Check) appropriate box(es)     06 Unknown     07 None

---

B. Underground Piping:  01 Double-walled pipe     02 Concrete-lined trench     03 Gravity     04 Pressure     05 Suction

(Check) appropriate box(es)     06 Unknown     07 None

**VII Leak Detection**

01 Visual     02 Stock Inventory     03 Tile Drain     04 Vapor Sniff Wells     05 Sensor Instrument

06 Ground Water Monitoring Wells     07 Pressure Test     08 Internal Inspection     09 None

10 Other: \_\_\_\_\_

**VIII Chemical Composition of Materials Currently or Previously Stored in Underground Containers**  
 If you checked yes to IV -F you are not required to complete this section.

currently stored	previously stored	CAS # (if known)	Chemical Do Not Use Commercial Name (Use additional paper for more room)
<input type="checkbox"/> 01	<input type="checkbox"/> 02		
<input type="checkbox"/> 01	<input type="checkbox"/> 02		
<input type="checkbox"/> 01	<input type="checkbox"/> 02		

Is Container located on an Agricultural Farm?  01 Yes     02 No

Person Filing (Signature) *J M Healy*    Phone w/area code (213) 239-6772

**For Local Agency Use Only**

AGENCY NAME	CITY	COUNTY
CONTACT PERSON		PHONE W/AREA CODE
INSPECTION DATE (1ST INSPECTION)	PERMIT APPROVAL DATE	PERMIT ID. NUMBER

**FOR STATE USE ONLY**

STATE ID. NUMBER	Accounting Number	County Number
Date Received	<input type="checkbox"/> 01	<input type="checkbox"/> 02 <input type="checkbox"/> 03

# Permit Application



<input checked="" type="checkbox"/> 01 New Permit	<input checked="" type="checkbox"/> 03 Installed before July 1, 1984	<input type="checkbox"/> 05 Renewed Permit	<input type="checkbox"/> 06 Amended Permit
<input type="checkbox"/> 02 Provisional Permit	<input type="checkbox"/> 04 Installed after July 1, 1984		

## I Owner

Name (Corporation Individual or Public Agency) <b>CARTER HAWLEY HALE STORES, INC.</b>			
Street Address <b>550 South Flower Street</b>	City <b>Los Angeles</b>	State <b>CA</b>	ZIP <b>90071</b>

## II Facility

Facility Name <b>CAPWELL'S PARKING GARAGE</b>		Dealer/Foreman/Supervisor <b>Woody Johnsen</b>	
Street Address <b>1911 Telegraph Ave.</b>		Nearest Cross Street <b>19th</b>	
City <b>Oakland</b>	County <b>Alameda</b>	ZIP <b>94612</b>	
Mailing Address <b>- Same -</b>	City	State	ZIP
Phone w/area code <b>(415) 444-7662</b>	Type of Business <input checked="" type="checkbox"/> 01 Gasoline Station <input type="checkbox"/> 02 Other: _____		
NUMBER OF CONTAINERS AT THIS FACILITY <b>4</b>	Rural Areas Only:	Township	Range
			Section

## III 24 Hour Emergency Contact Person

Days: Name (last name first) and Phone w/area code <b>Johnsen, Woody (415) 444-7662</b>	Nights: Name (last name first) and Phone w/area code <b>Johnsen, Woody (415) 657-0293</b>
--	--

**COMPLETE THE FOLLOWING ON A SEPARATE FORM FOR EACH CONTAINER**

## IV Description

A. <input checked="" type="checkbox"/> 01 Tank <input type="checkbox"/> 02 Other: _____	Container Number (If there is no number assign one) <b>3</b>
B. Manufacturer (if appropriate): _____ Year of Mfg.: _____	C. Year Installed: <b>1963</b> <input type="checkbox"/> Unknown
D. Container Capacity: <b>3000</b> gallons <input type="checkbox"/> Unknown	E. Does the Container Store (Check One). <input type="checkbox"/> 01 Waste <input checked="" type="checkbox"/> 02 Product
F. Does the Container Store Motor Vehicle Fuel or Waste Oil? <input checked="" type="checkbox"/> 01 Yes <input type="checkbox"/> 02 No    If Yes, Check appropriate box(es): <input checked="" type="checkbox"/> 01 Unleaded <input checked="" type="checkbox"/> 02 Regular <input type="checkbox"/> 03 Premium <input type="checkbox"/> 04 Diesel <input type="checkbox"/> 05 Waste Oil <input type="checkbox"/> 06 Other (List) _____ If you answered yes; do not complete Part VIII.	

## V Container Construction

A. Thickness of Primary Containment: _____ <input type="checkbox"/> Gauge <input type="checkbox"/> Inches <input type="checkbox"/> cm <input checked="" type="checkbox"/> Unknown
B. <input type="checkbox"/> 01 Vaulted (Located in an underground Vault.) <input type="checkbox"/> 02 Non-vaulted <input checked="" type="checkbox"/> 03 Unknown
C. <input type="checkbox"/> 01 Double Walled <input type="checkbox"/> 02 Single Walled <input type="checkbox"/> 03 Lined
D. <input type="checkbox"/> 01 Carbon Steel <input type="checkbox"/> 02 Stainless Steel <input type="checkbox"/> 03 Fiberglass <input type="checkbox"/> 04 Polyvinyl Chloride <input type="checkbox"/> 05 Concrete <input type="checkbox"/> 06 Aluminum <input type="checkbox"/> 07 Steel Clad <input type="checkbox"/> 08 Bronze <input type="checkbox"/> 09 Composite <input type="checkbox"/> 10 Non-metallic <input type="checkbox"/> 11 Earthen Walls <input checked="" type="checkbox"/> 12 Unknown <input type="checkbox"/> 13 Other: _____

**Container Construction**

E.  01 Rubber Lined     02 Alkyd Lining     03 Epoxy Lining     04 Phenolic Lining     05 Glass Lining     06 Clay Lining

07 Unlined     08 Unknown     09 Other: \_\_\_\_\_

F.  01 Polyethylene Wrap     02 Vinyl Wrapping     03 Cathodic Protection

04 Unknown     05 None     06 tar or asphalt     09 Other

**VI Piping**

A. Aboveground Piping:  01 Double-walled pipe     02 Concrete-lined trench     03 Gravity     04 Pressure     05 Suction

(Check) appropriate box(es)     06 Unknown     07 None

B. Underground Piping:  01 Double-walled pipe     02 Concrete-lined trench     03 Gravity     04 Pressure     05 Suction

(Check) appropriate box(es)     06 Unknown     07 None

**VII Leak Detection**

01 Visual     02 Stock Inventory     03 Tile Drain     04 Vapor Sniff Wells     05 Sensor Instrument

06 Ground Water Monitoring Wells     07 Pressure Test     08 Internal Inspection     09 None

10 Other: \_\_\_\_\_

**VIII Chemical Composition of Materials Currently or Previously Stored in Underground Containers**

If you checked yes to IV -F you are not required to complete this section.

currently stored	previously stored	CAS # (if known)	Chemical Do Not Use Commercial Name (Use additional paper for more room)
<input type="checkbox"/> 01	<input type="checkbox"/> 02		
<input type="checkbox"/> 01	<input type="checkbox"/> 02		
<input type="checkbox"/> 01	<input type="checkbox"/> 02		

Is Container located on an Agricultural Farm?  01 Yes     02 No

Person Filing (Signature) *J. M. Healy*    Phone w/area code (213) 239-6772

**For Local Agency Use Only**

AGENCY NAME	CITY	COUNTY
CONTACT PERSON		PHONE W/AREA CODE
INSPECTION DATE (1ST INSPECTION)	PERMIT APPROVAL DATE	PERMIT ID. NUMBER

**FOR STATE USE ONLY**

STATE ID. NUMBER	Accounting Number	County Number
Date Received	<input type="checkbox"/> 01	<input type="checkbox"/> 02 <input type="checkbox"/> 03

# Permit Application



<input checked="" type="checkbox"/> 01 New Permit	<input checked="" type="checkbox"/> 03 Installed before July 1, 1984	<input type="checkbox"/> 05 Renewed Permit	<input type="checkbox"/> 06 Amended Permit
<input type="checkbox"/> 02 Provisional Permit	<input type="checkbox"/> 04 Installed after July 1, 1984		

## I Owner

Name (Corporation Individual or Public Agency) <b>CARTER HAWLEY HALE STORES, INC.</b>			
Street Address <b>550 South Flower Street</b>	City <b>Los Angeles</b>	State <b>CA</b>	ZIP <b>90071</b>

## II Facility

Facility Name <b>CAPWELL'S PARKING GARAGE</b>		Dealer/Foreman/Supervisor <b>Woody Johnsen</b>	
Street Address <b>1911 Telegraph Ave.</b>		Nearest Cross Street <b>19th</b>	
City <b>Oakland</b>		County <b>Alameda</b>	ZIP <b>94612</b>
Mailing Address <b>- Same -</b>		City	State ZIP
Phone w/area code <b>(415) 444-7662</b>		Type of Business <input checked="" type="checkbox"/> 01 Gasoline Station <input type="checkbox"/> 02 Other: _____	
NUMBER OF CONTAINERS AT THIS FACILITY <b>4</b>	Rural Areas Only:	Township	Range Section

## III 24 Hour Emergency Contact Person

Days: Name (last name first) and Phone w/area code <b>Johnsen, Woody (415) 444-7662</b>	Nights: Name (last name first) and Phone w/area code <b>Johnsen, Woody (415) 657-0293</b>
--	--

**COMPLETE THE FOLLOWING ON A SEPARATE FORM FOR EACH CONTAINER**

## IV Description

A. <input checked="" type="checkbox"/> 01 Tank <input type="checkbox"/> 02 Other: _____		Container Number (if there is no number assign one) <b>4</b>
B. Manufacturer (if appropriate): _____	Year of Mfg.: _____	C. Year Installed: <b>1963</b> <input type="checkbox"/> Unknown
D. Container Capacity: <b>550</b> gallons <input type="checkbox"/> Unknown	E. Does the Container Store (Check One): <input checked="" type="checkbox"/> 01 Waste <input type="checkbox"/> 02 Product	
F. Does the Container Store Motor Vehicle Fuel or Waste Oil? <input checked="" type="checkbox"/> 01 Yes <input type="checkbox"/> 02 No    If Yes, Check appropriate box(es): <input type="checkbox"/> 01 Unleaded <input type="checkbox"/> 02 Regular <input type="checkbox"/> 03 Premium <input type="checkbox"/> 04 Diesel <input checked="" type="checkbox"/> 05 Waste Oil <input type="checkbox"/> 06 Other (List) _____ If you answered yes; do not complete Part VIII.		

## V Container Construction

A. Thickness of Primary Containment: _____ <input type="checkbox"/> Gauge <input type="checkbox"/> Inches <input type="checkbox"/> cm <input checked="" type="checkbox"/> Unknown
B. <input type="checkbox"/> 01 Vaulted (Located in an underground Vault.) <input type="checkbox"/> 02 Non-vaulted <input checked="" type="checkbox"/> 03 Unknown
C. <input type="checkbox"/> 01 Double Walled <input type="checkbox"/> 02 Single Walled <input type="checkbox"/> 03 Lined
D. <input type="checkbox"/> 01 Carbon Steel <input type="checkbox"/> 02 Stainless Steel <input type="checkbox"/> 03 Fiberglass <input type="checkbox"/> 04 Polyvinyl Chloride <input type="checkbox"/> 05 Concrete <input type="checkbox"/> 06 Aluminum <input type="checkbox"/> 07 Steel Clad <input type="checkbox"/> 08 Bronze <input type="checkbox"/> 09 Composite <input type="checkbox"/> 10 Non-metallic <input type="checkbox"/> 11 Earthen Walls <input checked="" type="checkbox"/> 12 Unknown <input type="checkbox"/> 13 Other: _____

**Container Construction**

E.  01 Rubber Lined     02 Alkyd Lining     03 Epoxy Lining     04 Phenolic Lining     05 Glass Lining     06 Clay Lining

07 Unlined     08 Unknown     09 Other: \_\_\_\_\_

---

F.  01 Polyethylene Wrap     02 Vinyl Wrapping     03 Cathodic Protection

04 Unknown     05 None     06 tar or asphalt     09 Other

**VI Piping**

A. Aboveground Piping:  01 Double-walled pipe     02 Concrete-lined trench     03 Gravity     04 Pressure     05 Suction

(Check) appropriate box(es)     06 Unknown     07 None

---

B. Underground Piping:  01 Double-walled pipe     02 Concrete-lined trench     03 Gravity     04 Pressure     05 Suction

(Check) appropriate box(es)     06 Unknown     07 None

**VII Leak Detection**

01 Visual     02 Stock Inventory     03 Tile Drain     04 Vapor Sniff Wells     05 Sensor Instrument

06 Ground Water Monitoring Wells     07 Pressure Test     08 Internal Inspection     09 None

10 Other: \_\_\_\_\_

**VIII Chemical Composition of Materials Currently or Previously Stored in Underground Containers**  
 If you checked yes to IV -F you are not required to complete this section.

currently stored	previously stored	CAS # (if known)	Chemical Do Not Use Commercial Name (Use additional paper for more room)
<input type="checkbox"/> 01	<input type="checkbox"/> 02		
<input type="checkbox"/> 01	<input type="checkbox"/> 02		
<input type="checkbox"/> 01	<input type="checkbox"/> 02		

Is Container located on an Agricultural Farm?  01 Yes     02 No

Person Filing (Signature) *J M Healy*    Phone w/area code (213) 239-6772

**For Local Agency Use Only**

AGENCY NAME	CITY	COUNTY
CONTACT PERSON	PHONE W/AREA CODE	
INSPECTION DATE (1ST INSPECTION)	PERMIT APPROVAL DATE	PERMIT ID. NUMBER

**FOR STATE USE ONLY**

STATE ID. NUMBER	Accounting Number	County Number
Date Received	<input type="checkbox"/> 01	<input type="checkbox"/> 02 <input type="checkbox"/> 03