



RECEIVED

9:06 am, Mar 04, 2010

Alameda County
Environmental Health

Stacie H. Frerichs
Team Lead
Marketing Business Unit

**Chevron Environmental
Management Company**
6001 Bollinger Canyon Road
San Ramon, CA 94583
Tel (925) 842-9655
Fax (925) 842-8370

March 3, 2010
(date)

Alameda County Environmental Health
1131 Harbor Bay Parkway, Suite 250
Alameda, CA 94502-6577

Re: Chevron Facility # 9-0517

Address: 3900 Piedmont Avenue, Oakland, California

I have reviewed the attached report titled Work Plan Addendum and dated March 3, 2010.

I agree with the conclusions and recommendations presented in the referenced report. The information in this report is accurate to the best of my knowledge and all local Agency/Regional Board guidelines have been followed. This report was prepared by Conestoga-Rovers & Associates, upon whose assistance and advice I have relied.

This letter is submitted pursuant to the requirements of California Water Code Section 13267(b)(1) and the regulating implementation entitled Appendix A pertaining thereto.

I declare under penalty of perjury that the foregoing is true and correct.

Sincerely,

Stacie H. Frerichs
Project Manager

Enclosure: Report



**CONESTOGA-ROVERS
& ASSOCIATES**

10969 Trade Center Drive, Suite 106, Rancho Cordova, CA 95670
Telephone: 916-889-8900 Facsimile: 916-889-8999
www.CRAworld.com

March 3, 2010

Reference No. 611995

Mr. Mark Detterman, PG, CEG
Alameda County Environmental Health
1131 Harbor Bay Parkway, Suite 250
Alameda, California 94502-6577

Re: Work Plan Addendum
Former Chevron Service Station No. 9-0517
3900 Piedmont Avenue
Oakland, California
LOP Case #RO0000138

Dear Mr. Detterman:

Conestoga-Rovers & Associates (CRA) has prepared this *Work Plan Addendum* for the site referenced above on behalf of Chevron Environmental Management Company (Chevron). CRA previously prepared and submitted to Alameda County Environmental Health (ACEH) the July 16, 2009 *Work Plan for Additional Site Investigation* (work plan), that proposed additional investigation at the site we anticipated would be necessary to move the site toward case closure. The proposed investigation included the drilling of two additional downgradient exploratory borings in the vicinity of previous boring SB-2 to further evaluate the offsite extent of impacted groundwater, and the installation and sampling of three soil vapor wells onsite to evaluate potential vapor intrusion concerns. However, upon further review of the site conditions and the results of the previous investigation, we propose to move the two exploratory borings further downgradient to increase the likelihood plume definition can be achieved, as further described below.

To avoid potential delays due to access issues with private property owners, CRA proposes to move the two exploratory borings further downgradient to Howe Street, as shown on the attached Figure 2. All other details and procedures outlined in the July 16, 2009 work plan remain in place and will be followed during the investigation.

Equal
Employment
Opportunity Employer



**CONESTOGA-ROVERS
& ASSOCIATES**

March 3, 2010

Reference No. 611995

- 2 -

Please let us know if ACEH concurs with the proposed changes. We appreciate your assistance on this project and look forward to your reply. Please contact Mr. James Kiernan at (916) 889-8917 if you have any questions or require any additional information.

Sincerely,

CONESTOGA-ROVERS & ASSOCIATES

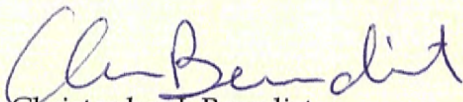
Christopher J. Benedict

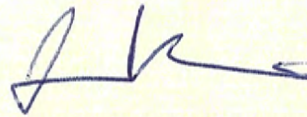

James P. Kiernan, P.E. #C68498

CB/jt/6
Encl.

Figure 1 Vicinity Map
Figure 2 Site Plan

cc: Ms. Stacie Frerichs, Chevron
 Mr. Neil B. and Mrs. Diane C. Goodhue

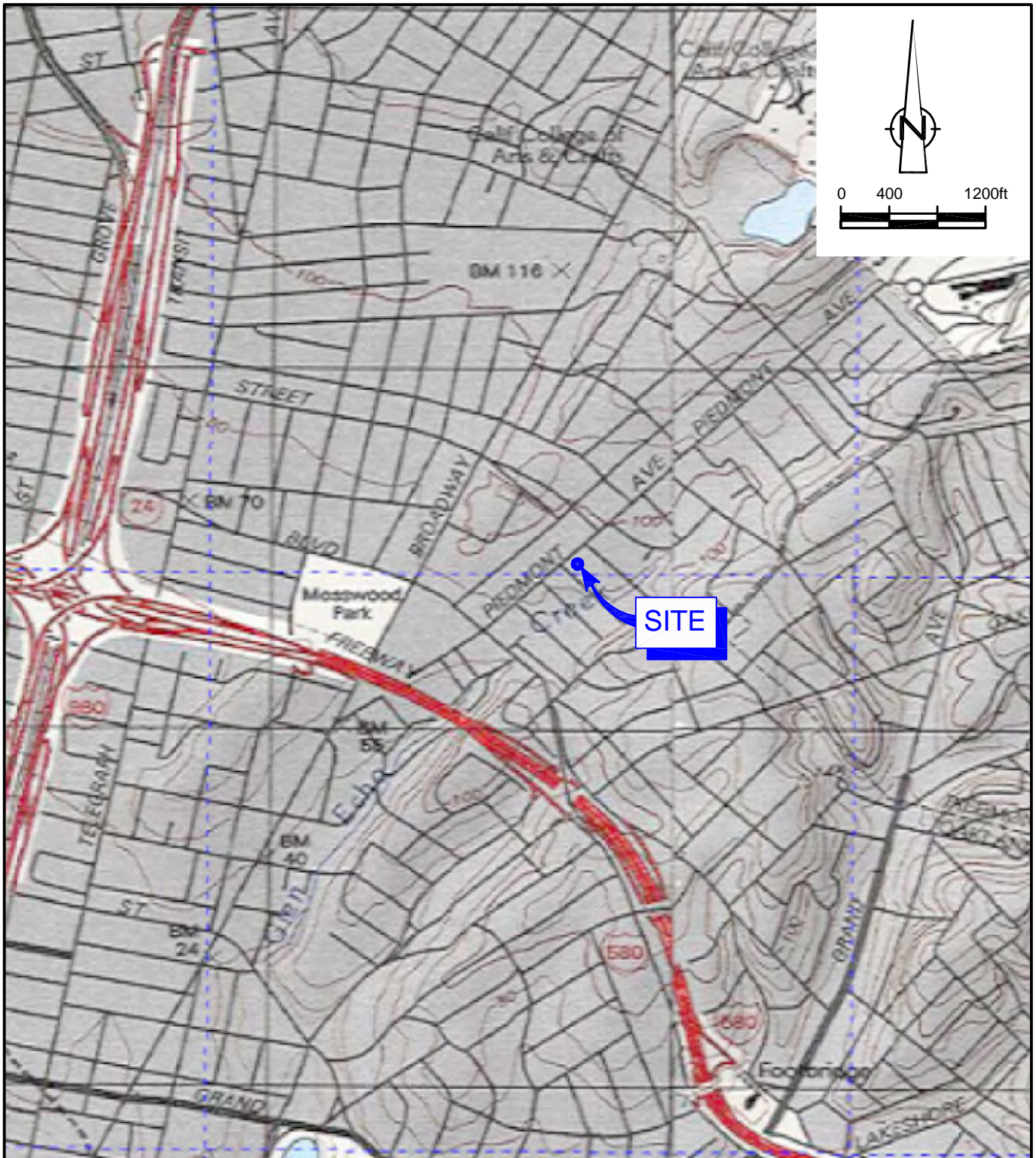



SOURCE: TOPO! MAPS.

figure 1
 VICINITY MAP
 FORMER CHEVRON SERVICE 9-0517
 3900 PIEDMONT AVENUE
 Oakland, California



