

ENVIRONMENTAL  
PROTECTION

00 JAN 19 PM 3:47

SDP

6241 DH



**Chevron**

Chevron U.S.A. Products Company  
6001 Bollinger Canyon Rd. Bldg. L  
P. O. Box 6004  
San Ramon, CA 94583-0804

Site Assessment and  
Remediation Group  
Phone (510) 842-9500  
Fax (510) 842-3570

Date: January 7, 2000  
To: Distribution  
Re: Groundwater Monitoring Report , 9-0517

The enclosed groundwater monitoring report has been properly reviewed by a Chevron authorized representative. Agency guidelines have been followed. Blaine Tech Services is authorized to distribute the report directly to interested parties.

If you have any questions, please call me at (510) 842-8695.

Sincerely,

Brett Hunter  
Site Assessment and Remediation  
Project Manager

**BLAINE**  
TECH SERVICES INC.



1680 ROGERS AVENUE  
SAN JOSE, CALIFORNIA 95112-1105  
(408) 573-7771 FAX  
(408) 573-0555 PHONE

January 6, 2000

Brett Hunter  
Chevron U.S.A. Products Company  
P.O. Box 6004  
San Ramon, CA 94583-0904

#### **4th Quarter 1999 Monitoring at 9-0517**

Fourth Quarter 1999 Groundwater Monitoring at  
Former Chevron Service Station Number 9-0517  
3900 Piedmont Ave.  
Oakland, CA

Monitoring Performed on November 3, 1999

---

#### **Groundwater Sampling Report 991103-J-2**

This report covers the routine monitoring of groundwater wells at this Chevron facility. Blaine Tech Services, Inc.'s work at the site includes inspection, gauging, evacuation, purgewater containment, sample collection and sample handling in accordance with standard procedures that conform to Regional Water Quality Control Board requirements.

Routine field data collection includes depth to water, total well depth, thickness of any separate immiscible layer, water column volume, calculated volume of a three-case volume purge, elapsed evacuation time, total volume of water removed, and standard water parameter instrument readings. Sample material is collected, contained, stored, and transported to the laboratory in conformance with EPA standards. Purgewater is, likewise, collected and transported to McKittrick Waste Treatment Site for disposal.

Basic field information is presented alongside analytical values excerpted from the laboratory report in the cumulative table of **WELL DATA AND ANALYTICAL RESULTS**. The full analytical report for the most recent samples is located in the **Analytical Appendix**. The table also contains new groundwater elevation calculations taken from the computer plotted gradient map which is located in the **Professional Engineering Appendix**.

At a minimum, Blaine Tech Services, Inc. field personnel are certified upon completion of a forty-hour Hazardous Materials and Emergency Response training course per 29 CFR 1910.120. Field personnel are also enrolled in annual eight hour refresher courses.

Blaine Tech Services, Inc. conducts sampling and documentation assignments of this type as an independent third party. In order to avoid compromising the objectivity necessary for the proper and disinterested performance of this work, Blaine Tech Services, Inc. concentrates on objective data collection and does not participate in the interpretation of analytical results, the definition of geological or hydrological conditions, the formulation of recommendations, or the marketing of remedial systems.

Please call if you have any questions.

Yours truly,



Scott Boor  
Project Coordinator

SDB/cm

attachments: Professional Engineering Appendix  
Cumulative Table of Well Data and Analytical Results  
Analytical Appendix  
Field Data Sheets

cc: ~~Michelle~~ Logan, Alameda County Health Care Services  
Neil B. & Diane C. Goodhue  
Greg Gurss, Gettler-Ryan, Inc.  
Bette Owen, Chevron Products Company (w/o enclosure)



# **Professional Engineering Appendix**

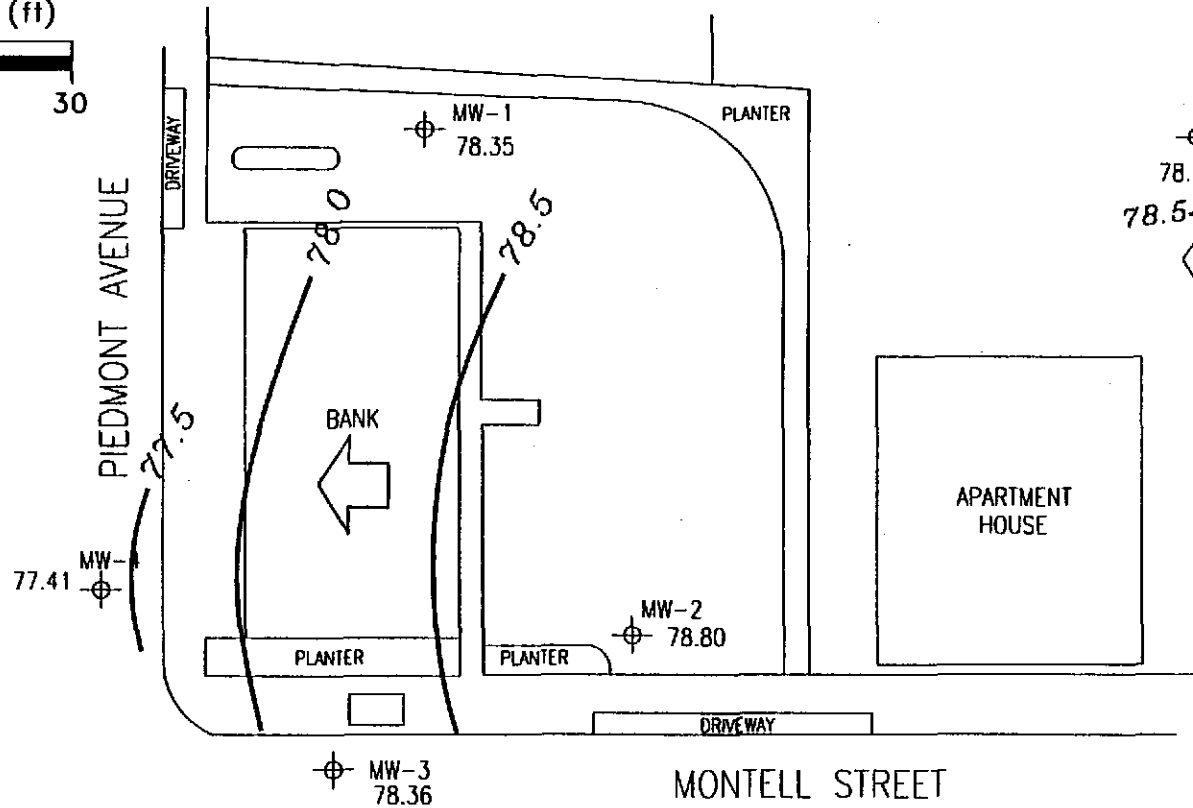
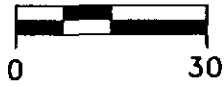

SCALE (ft)



**EXPLANATION**

-  MONITORING WELL
- 78.35 GROUNDWATER ELEVATION (FT, MSL)
- 78.5 — GROUNDWATER ELEVATION CONTOUR (FT, MSL)
-  APPROXIMATE GROUNDWATER FLOW DIRECTION;  
APPROXIMATE GRADIENT = 0.01



Ref. 0517-qm.dwg  
Base map from Geller-Ryan, Inc.

PREPARED BY  
**RRM**  
engineering contracting firm

**Former Chevron Station 9-0517**  
3900 Piedmont Avenue  
Oakland, California

**GROUNDWATER ELEVATION CONTOUR MAP,**  
NOVEMBER 3, 1999

**FIGURE:**  
**1**  
**PROJECT:**  
DAC04

# **Table of Well Data and Analytical Results**

## Cumulative Table of Well Data and Analytical Results

Vertical Measurements are in feet.

Analytical results are in parts per billion (ppb)

| DATE        | Well Head Elev. | Ground Water Elev. | Depth To Water | Notes | TPH-Gasoline | Benzene | Toluene | Ethyl-Benzene | Xylene | MTBE |
|-------------|-----------------|--------------------|----------------|-------|--------------|---------|---------|---------------|--------|------|
| <b>MW-1</b> |                 |                    |                |       |              |         |         |               |        |      |
| 08/03/98    | 87.89           | 75.46              | 12.43          | --    | <50          | <0.5    | <0.5    | <0.5          | <0.5   | <2.5 |
| 11/23/98    | 87.89           | 78.84              | 9.05           | --    | <50          | <0.5    | <0.5    | <0.5          | <0.5   | <2.0 |
| 02/08/99    | 87.89           | 81.39              | 6.50           | --    | <50          | <0.5    | <0.5    | <0.5          | <0.5   | <2.5 |
| 05/07/99    | 87.89           | 80.76              | 7.13           | --    | <50          | <0.5    | <0.5    | <0.5          | <0.5   | <5.0 |
| 08/23/99    | 87.89           | 78.74              | 9.15           | --    | <50          | <0.5    | <0.5    | <0.5          | <0.5   | <2.5 |
| 11/03/99    | 87.89           | 78.35              | 9.54           | --    | <50          | <0.5    | <0.5    | <0.5          | <0.5   | <2.5 |
| <b>MW-2</b> |                 |                    |                |       |              |         |         |               |        |      |
| 08/03/98    | 86.09           | 74.75              | 11.34          | --    | <50          | <0.5    | <0.5    | <0.5          | <0.5   | 3.4  |
| 11/23/98    | 86.09           | 79.19              | 6.90           | --    | <50          | <0.5    | <0.5    | <0.5          | <0.5   | <2.0 |
| 02/08/99    | 86.09           | 80.86              | 5.23           | --    | <50          | <0.5    | <0.5    | <0.5          | <0.5   | <2.5 |
| 05/07/99    | 86.09           | 79.97              | 6.12           | --    | <50          | <0.5    | <0.5    | <0.5          | <0.5   | <5.0 |
| 08/23/99    | 86.09           | 79.68              | 6.41           | --    | <50          | <0.5    | <0.5    | <0.5          | <0.5   | <2.5 |
| 11/03/99    | 86.09           | 78.80              | 7.29           | --    | <50          | <0.5    | <0.5    | <0.5          | <0.5   | <2.5 |
| <b>MW-3</b> |                 |                    |                |       |              |         |         |               |        |      |
| 08/03/98    | 86.28           | 74.20              | 12.08          | --    | 4000         | 160     | <5.0    | <5.0          | 73     | 180  |
| 11/23/98    | 86.28           | 78.59              | 7.69           | --    | 4000         | 67.7    | 7.56    | 17.1          | 24.5   | 41.2 |
| 02/08/99    | 86.28           | 80.01              | 6.27           | --    | <50          | <0.5    | <0.5    | <0.5          | <0.5   | <2.5 |
| 05/07/99    | 86.28           | 79.32              | 6.96           | --    | 1800         | 53.6    | 8.96    | 33            | 18.6   | 21.4 |
| 08/23/99    | 86.28           | 78.36              | 7.92           | --    | 3970         | 155     | 24      | 88.8          | 39.8   | 185  |
| 11/03/99    | 86.28           | 78.36              | 7.92           | --    | 3320         | 108     | 19.9    | 98.4          | 44.8   | <25  |

## Cumulative Table of Well Data and Analytical Results

Vertical Measurements are in feet.

Analytical results are in parts per billion (ppb)

| DATE        | Well Head Elev. | Ground Water Elev. | Depth To Water | Notes            | TPH-Gasoline | Benzene | Toluene | Ethyl-Benzene | Xylene | MTBE |
|-------------|-----------------|--------------------|----------------|------------------|--------------|---------|---------|---------------|--------|------|
| <b>MW-4</b> |                 |                    |                |                  |              |         |         |               |        |      |
| 08/03/98    | 87.22           | 74.30              | 12.92          | --               | 1900         | 110     | 12      | <0.5          | 55     | 130  |
| 11/23/98    | 87.22           | 77.82              | 9.40           | --               | 4080         | 136     | 17.8    | 37.2          | 30.1   | 51.8 |
| 02/08/99    | 87.22           | 79.40              | 7.82           | *                | 2900         | 150     | 16      | <5.0          | 15     | 230  |
| 02/08/99    | 87.22           | 79.40              | 7.82           | Confirmation Run | --           | --      | --      | --            | --     | 30.7 |
| 05/07/99    | 87.22           | 79.80              | 7.42           | --               | 6050         | 161     | <25     | 39.8          | 36.9   | <250 |
| 05/07/99    | 87.22           | 79.80              | 7.42           | Confirmation Run | --           | --      | --      | --            | --     | 30.2 |
| 08/23/99    | 87.22           | 77.83              | 9.39           | --               | 3930         | 203     | 37.6    | 58.6          | 42.2   | 255  |
| 11/03/99    | 87.22           | 77.41              | 9.81           | --               | 5350         | 324     | 44.7    | 91.5          | 56.1   | <50  |

\* Chromatogram pattern indicates gas and an unidentified hydrocarbon.



## Cumulative Table of Well Data and Analytical Results

Vertical Measurements are in feet.

Analytical results are in parts per billion (ppb)

| DATE              | Well Head Elev. | Ground Water Elev. | Depth To Water | Notes | TPH-Gasoline | Benzene | Toluene | Ethyl-Benzene | Xylene | MTBE  |
|-------------------|-----------------|--------------------|----------------|-------|--------------|---------|---------|---------------|--------|-------|
| <b>TRIP BLANK</b> |                 |                    |                |       |              |         |         |               |        |       |
| 08/03/98          | --              | --                 | --             | --    | < 50         | < 0.5   | < 0.5   | < 0.5         | < 0.5  | < 2.5 |
| 11/23/98          | --              | --                 | --             | --    | < 50         | < 0.5   | < 0.5   | < 0.5         | < 0.5  | < 2.0 |
| 02/08/99          | --              | --                 | --             | --    | < 50         | < 0.5   | < 0.5   | < 0.5         | < 0.5  | < 2.5 |
| 05/07/99          | --              | --                 | --             | --    | < 50         | < 0.5   | < 0.5   | < 0.5         | < 0.5  | < 5.0 |
| 08/23/99          | --              | --                 | --             | --    | < 50         | < 0.5   | < 0.5   | < 0.5         | < 0.5  | < 2.5 |
| 11/03/99          | --              | --                 | --             | --    | < 50         | < 0.5   | < 0.5   | < 0.5         | < 0.5  | < 2.5 |

Note: Blaine Tech Services, Inc. began routine monitoring of the groundwater wells at this site on November 23, 1998. Earlier field data and analytical results are drawn from the August 3, 1998, Gettler-Ryan, Inc. report.

### ABBREVIATIONS:

TPH = Total Petroleum Hydrocarbons

ND = Not detected at or above the minimum quantitation limit. See laboratory reports for minimum quantitation limits.

MTBE = Methyl-tert-butyl ether

# **Analytical Appendix**



November 18, 1999

Scott Boor  
Blaine Tech Services (Chev)  
1680 Rogers Avenue  
San Jose, CA 95112

RE: Chevron 9-0517/M911161

Dear Scott Boor

Enclosed are the results of analyses for sample(s) received by the laboratory on November 4, 1999. If you have any questions concerning this report, please feel free to contact me.

Sincerely,

Wendy Bonnes  
Project Manager

CA ELAP Certificate Number 1210





|   |   |   |
|---|---|---|
| Blaine Tech Services (Chev)<br>1680 Rogers Avenue<br>San Jose, CA 95112 | Project: Chevron 9-0517 (3900 Piedmont Ave., Oakland)<br>Project Number: 991103-J2<br>Project Manager: Scott Boor | Sampled: 11/3/99<br>Received: 11/4/99<br>Reported: 11/18/99 |
|---|---|---|

## ANALYTICAL REPORT FOR M911161

| Sample Description | Laboratory Sample Number | Sample Matrix | Date Sampled |
|--------------------|--------------------------|---------------|--------------|
| MW-1               | M911161-01               | Water         | 11/3/99      |
| MW-2               | M911161-02               | Water         | 11/3/99      |
| MW-3               | M911161-03               | Water         | 11/3/99      |
| MW-4               | M911161-04               | Water         | 11/3/99      |
| TB                 | M911161-05               | Water         | 11/3/99      |





|   |   |   |
|---|---|---|
| Blaine Tech Services (Chev)<br>1680 Rogers Avenue<br>San Jose, CA 95112 | Project: Chevron 9-0517 (3900 Piedmont Ave., Oakland)<br>Project Number: 991103-J2<br>Project Manager: Scott Boor | Sampled: 11/3/99<br>Received: 11/4/99<br>Reported: 11/18/99 |
|---|---|---|

**Total Purgeable Hydrocarbons (C6-C12), BTEX and MTBE by DHS LUFT  
Sequoia Analytical - Morgan Hill**

| Analyte                           | Batch Number | Date Prepared     | Date Analyzed | Surrogate Limits | Reporting Limit | Result       | Units | Notes* |
|-----------------------------------|--------------|-------------------|---------------|------------------|-----------------|--------------|-------|--------|
| <b>MW-1</b>                       |              | <b>M911161-01</b> |               |                  |                 | <b>Water</b> |       |        |
| Purgeable Hydrocarbons            | 9110466      | 11/15/99          | 11/15/99      |                  | 50.0            | ND           | ug/l  |        |
| Benzene                           | "            | "                 | "             |                  | 0.500           | ND           | "     |        |
| Toluene                           | "            | "                 | "             |                  | 0.500           | ND           | "     |        |
| Ethylbenzene                      | "            | "                 | "             |                  | 0.500           | ND           | "     |        |
| Xylenes (total)                   | "            | "                 | "             |                  | 0.500           | ND           | "     |        |
| Methyl tert-butyl ether           | "            | "                 | "             |                  | 2.50            | ND           | "     |        |
| Surrogate: a,a,a-Trifluorotoluene | "            | "                 | "             | 70.0-130         |                 | 93.4         | %     |        |
| <b>MW-2</b>                       |              | <b>M911161-02</b> |               |                  |                 | <b>Water</b> |       |        |
| Purgeable Hydrocarbons            | 9110466      | 11/15/99          | 11/15/99      |                  | 50.0            | ND           | ug/l  |        |
| Benzene                           | "            | "                 | "             |                  | 0.500           | ND           | "     |        |
| Toluene                           | "            | "                 | "             |                  | 0.500           | ND           | "     |        |
| Ethylbenzene                      | "            | "                 | "             |                  | 0.500           | ND           | "     |        |
| Xylenes (total)                   | "            | "                 | "             |                  | 0.500           | ND           | "     |        |
| Methyl tert-butyl ether           | "            | "                 | "             |                  | 2.50            | ND           | "     |        |
| Surrogate: a,a,a-Trifluorotoluene | "            | "                 | "             | 70.0-130         |                 | 93.6         | %     |        |
| <b>MW-3</b>                       |              | <b>M911161-03</b> |               |                  |                 | <b>Water</b> |       |        |
| Purgeable Hydrocarbons            | 9110466      | 11/15/99          | 11/15/99      |                  | 500             | 3320         | ug/l  | 1,D    |
| Benzene                           | "            | "                 | "             |                  | 5.00            | 108          | "     | D      |
| Toluene                           | "            | "                 | "             |                  | 5.00            | 19.9         | "     | D      |
| Ethylbenzene                      | "            | "                 | "             |                  | 5.00            | 98.4         | "     | D      |
| Xylenes (total)                   | "            | "                 | "             |                  | 5.00            | 44.8         | "     | D      |
| Methyl tert-butyl ether           | "            | "                 | "             |                  | 25.0            | ND           | "     | D      |
| Surrogate: a,a,a-Trifluorotoluene | "            | "                 | "             | 70.0-130         |                 | 97.7         | %     |        |
| <b>MW-4</b>                       |              | <b>M911161-04</b> |               |                  |                 | <b>Water</b> |       |        |
| Purgeable Hydrocarbons            | 9110466      | 11/15/99          | 11/15/99      |                  | 1000            | 5350         | ug/l  | 1,D    |
| Benzene                           | "            | "                 | "             |                  | 10.0            | 324          | "     | D      |
| Toluene                           | "            | "                 | "             |                  | 10.0            | 44.7         | "     | D      |
| Ethylbenzene                      | "            | "                 | "             |                  | 10.0            | 91.5         | "     | D      |
| Xylenes (total)                   | "            | "                 | "             |                  | 10.0            | 56.1         | "     | D      |
| Methyl tert-butyl ether           | "            | "                 | "             |                  | 50.0            | ND           | "     | D      |
| Surrogate: a,a,a-Trifluorotoluene | "            | "                 | "             | 70.0-130         |                 | 101          | %     |        |
| <b>TB</b>                         |              | <b>M911161-05</b> |               |                  |                 | <b>Water</b> |       |        |
| Purgeable Hydrocarbons            | 9110466      | 11/15/99          | 11/15/99      |                  | 50.0            | ND           | ug/l  |        |
| Benzene                           | "            | "                 | "             |                  | 0.500           | ND           | "     |        |
| Toluene                           | "            | "                 | "             |                  | 0.500           | ND           | "     |        |
| Ethylbenzene                      | "            | "                 | "             |                  | 0.500           | ND           | "     |        |
| Xylenes (total)                   | "            | "                 | "             |                  | 0.500           | ND           | "     |        |





|   |   |   |
|---|---|---|
| Blaine Tech Services (Chev)<br>1680 Rogers Avenue<br>San Jose, CA 95112 | Project: Chevron 9-0517 (3900 Piedmont Ave., Oakland)<br>Project Number: 991103-J2<br>Project Manager: Scott Boor | Sampled: 11/3/99<br>Received: 11/4/99<br>Reported: 11/18/99 |
|---|---|---|

**Total Purgeable Hydrocarbons (C6-C12), BTEX and MTBE by DHS LUFT  
Sequoia Analytical - Morgan Hill**

| Analyte                                   | Batch<br>Number | Date<br>Prepared | Date<br>Analyzed | Surrogate<br>Limits | Reporting<br>Limit | Result | Units | Notes* |
|---|-----------------|------------------|------------------|---------------------|--------------------|--------|-------|--------|
| <b>TB (continued)</b>                     |                 |                  |                  | <b>M911161-05</b>   |                    |        |       |        |
| Methyl tert-butyl ether                   | 9110466         | 11/15/99         | 11/15/99         |                     | 2.50               | ND     | ug/l  |        |
| Surrogate: <i>o,a,a</i> -Trifluorotoluene | "               | "                | "                | 70.0-130            |                    | 98.9   | %     |        |





|   |   |   |
|---|---|---|
| Blaine Tech Services (Chev)<br>1680 Rogers Avenue<br>San Jose, CA 95112 | Project: Chevron 9-0517 (3900 Piedmont Ave., Oakland)<br>Project Number: 991103-J2<br>Project Manager: Scott Boor | Sampled: 11/3/99<br>Received: 11/4/99<br>Reported: 11/18/99 |
|---|---|---|

**Total Purgeable Hydrocarbons (C6-C12), BTEX and MTBE by DHS LUFT/Quality Control  
Sequoia Analytical - Morgan Hill**

| Analyte                                  | Date Analyzed | Spike Level                    | Sample Result | QC Result | Units                                     | Reporting Limit<br>Recov. Limits | Recov. % | RPD Limit | RPD % | Notes* |
|--|---------------|--------------------------------|---------------|-----------|---|----------------------------------|----------|-----------|-------|--------|
| <b>Batch: 9110466</b>                    |               | <b>Date Prepared: 11/15/99</b> |               |           | <b>Extraction Method: EPA 5030B (P/T)</b> |                                  |          |           |       |        |
| <b>Blank</b>                             |               | <b>9110466-BLK1</b>            |               |           |   |                                  |          |           |       |        |
| Purgeable Hydrocarbons                   | 11/15/99      |                                |               | ND        | ug/l                                      | 50.0                             |          |           |       |        |
| Benzene                                  | "             |                                |               | ND        | "   | 0.500                            |          |           |       |        |
| Toluene                                  | "             |                                |               | ND        | "   | 0.500                            |          |           |       |        |
| Ethylbenzene                             | "             |                                |               | ND        | "   | 0.500                            |          |           |       |        |
| Xylenes (total)                          | "             |                                |               | ND        | "   | 0.500                            |          |           |       |        |
| Methyl tert-butyl ether                  | "             |                                |               | ND        | "   | 2.50                             |          |           |       |        |
| Surrogate: <i>a,a,a-Trifluorotoluene</i> | "             | 10.0                           |               | 9.80      | "   | 70.0-130                         | 98.0     |           |       |        |
| <b>LCS</b>                               |               | <b>9110466-BS1</b>             |               |           |   |                                  |          |           |       |        |
| Purgeable Hydrocarbons                   | 11/15/99      | 250                            |               | 231       | ug/l                                      | 70.0-130                         | 92.4     |           |       |        |
| Surrogate: <i>a,a,a-Trifluorotoluene</i> | "             | 10.0                           |               | 9.97      | "   | 70.0-130                         | 99.7     |           |       |        |
| <b>LCS Dup</b>                           |               | <b>9110466-BSD1</b>            |               |           |   |                                  |          |           |       |        |
| Purgeable Hydrocarbons                   | 11/15/99      | 250                            |               | 247       | ug/l                                      | 70.0-130                         | 98.8     | 25.0      | 6.69  |        |
| Surrogate: <i>a,a,a-Trifluorotoluene</i> | "             | 10.0                           |               | 10.2      | "   | 70.0-130                         | 102      |           |       |        |





|   |   |   |
|---|---|---|
| Blaine Tech Services (Chev)<br>1680 Rogers Avenue<br>San Jose, CA 95112 | Project: Chevron 9-0517 (3900 Piedmont Ave., Oakland)<br>Project Number: 991103-J2<br>Project Manager: Scott Boor | Sampled: 11/3/99<br>Received: 11/4/99<br>Reported: 11/18/99 |
|---|---|---|

**Notes and Definitions**

| # | Note |
|---|------|
|---|------|

- D Data reported from a dilution.
- 1 Chromatogram Pattern: Gasoline C6-C12
- DET Analyte DETECTED
- ND Analyte NOT DETECTED at or above the reporting limit
- NR Not Reported
- dry Sample results reported on a dry weight basis
- Recov. Recovery
- RPD Relative Percent Difference





Fax copy of Lab Report and COC to Chevron Contact:

Yes  
 No

**Chain-of-Custody-Record**

|   |   |   |
|---|---|---|
| Chevron Products Co.<br>P.O. BOX 6004<br>San Ramon, CA 94583<br>FAX (925)842-8370 | Chevron Facility Number <u>9-0517</u>               | Chevron Contact Name) <u>Brett Hunter</u> |
|   | Facility Address <u>3900 Piedmont Ave., Oakland</u> | (Phone) <u>(925) 842-8695</u>             |
|   | Consultant Project Number <u>991103-JZ</u>          | Laboratory Name <u>Sequoia</u>            |
|   | Consultant Name <u>Blaine Tech Services, Inc.</u>   | Laboratory Service Order <u>9144488</u>   |
|   | Address <u>1680 Rogers Ave., San Jose</u>           | Laboratory Service Code <u>ZZ02790</u>    |
| Project Contact (Name) <u>Scott Boor</u>  | Samples collected by (Name) <u>Josh Kerns</u>       | Signature <u>[Signature]</u>              |
| (Phone) <u>408-573-0555</u> (Fax) <u>408-573-7771</u>                             |   |   |

| Sample Number  | Number of Containers | Matrix<br>S = Soil<br>W = Water C = Charcoal | Sample Preservation | Date/Time        | State Method: <input checked="" type="checkbox"/> CA <input type="checkbox"/> OR <input type="checkbox"/> WA <input type="checkbox"/> NW Series <input type="checkbox"/> CO <input type="checkbox"/> UT |                              |                   |                   |                              |                           |                             |                       |  |             |  |            |                  | Remarks |                |
|--|----------------------|--|---------------------|------------------|---|------------------------------|-------------------|-------------------|------------------------------|---------------------------|-----------------------------|-----------------------|--|-------------|--|------------|------------------|---------|----------------|
|  |                      |  |                     |                  | BTEX/MTBE + TPH GAS (8020 + 8015)   | BTEX + TPH GAS (8020 + 8015) | TPH Diesel (8015) | Oxygenates (8260) | Purgeable Halocarbons (8010) | Purgeable Organics (8270) | Extractable Organics (8270) | Oil and Grease (5520) | Metals (ICAP or AA) Cd, Cr, Pb, Zn, Ni | BTEX (8020) | BTEX/MTBE/Naph. (8020)   | TPH - HCID | TPH - D Extended |         | Lab Sample No. |
| MW-1   | 3                    | W  | HCl                 | 11-03-99<br>1340 | X   |                              |                   |                   |                              |                           |                             |                       |  |             |  |            |                  | 01      |                |
| MW-2   | ↓                    | ↓  | ↓                   | 11-03-99<br>1400 | X   |                              |                   |                   |                              |                           |                             |                       |  |             |  |            |                  | 02      |                |
| MW-3   | ↓                    | ↓  | ↓                   | 11-03-99<br>1420 | X   |                              |                   |                   |                              |                           |                             |                       |  |             |  |            |                  | 03      |                |
| MW-4   | ↓                    | ↓  | ↓                   | 11-03-99<br>1440 | X   |                              |                   |                   |                              |                           |                             |                       |  |             |  |            |                  | 04      |                |
| TO   | ↓                    | ↓  | ↓                   | 11-03-99         | X   |                              |                   |                   |                              |                           |                             |                       |  |             |  |            |                  | 05      |                |
| Relinquished By (Signature) <u>[Signature]</u> Organization _____ Date/Time <u>11-28</u> |                      |  |                     |                  | Received By (Signature) <u>[Signature]</u> Organization _____ Date/Time <u>11-28</u>  |                              |                   |                   |                              | Iced Y/N _____            |                             |                       |  |             | Turn Around Time (Circle One)<br>24 Hrs.<br>48 Hrs.<br>5 Days<br>10 Days<br><u>As Contracted</u> |            |                  |         |                |
| Relinquished By (Signature) <u>[Signature]</u> Organization _____ Date/Time _____        |                      |  |                     |                  | Received By (Signature) <u>[Signature]</u> Organization _____ Date/Time <u>11-29</u>  |                              |                   |                   |                              | Iced Y/N _____            |                             |                       |  |             |  |            |                  |         |                |
| Relinquished By (Signature) <u>[Signature]</u> Organization _____ Date/Time _____        |                      |  |                     |                  | Received For Laboratory By (Signature) <u>[Signature]</u> Organization _____ Date/Time <u>11-29</u>   |                              |                   |                   |                              | Iced Y/N _____            |                             |                       |  |             |  |            |                  |         |                |

COC-3.DWG07.96/HCH

# **Field Data Sheets**



## CHEVRON WELL MONITORING DATA SHEET

|                                   |                                   |
|-----------------------------------|-----------------------------------|
| Project #: <u>991103-J2</u>       | Station #: <u>9-0517</u>          |
| Sampler: <u>Josh</u>              | Date: <u>11-03-99</u>             |
| Well I.D.: <u>MW-2</u>            | Well Diameter: <u>(2)</u> 3 4 6 8 |
| Total Well Depth: <u>16.40</u>    | Depth to Water: <u>7.29</u>       |
| Depth to Free Product:            | Thickness of Free Product (feet): |
| Referenced to: <u>(PVC)</u> Grade | D.O. Meter (if req'd): YSI HACH   |

| Well Diameter | Multiplier | Well Diameter | Multiplier                  |
|---------------|------------|---------------|-----------------------------|
| 2"            | 0.16       | 5"            | 1.02                        |
| 3"            | 0.37       | 6"            | 1.47                        |
| 4"            | 0.65       | Other         | radius <sup>2</sup> * 0.163 |

Purge Method: Bailer      Sampling Method: Bailer  
Disposable Bailer      Disposable Bailer  
 Middleburg      Extraction Port  
 Electric Submersible      Other: \_\_\_\_\_  
 Extracation Pump

|                       |   |                   |   |                   |
|-----------------------|---|-------------------|---|-------------------|
| <u>1.5</u>            | x | <u>3</u>          | = | <u>4.5</u> Gals.  |
| 1 Case Volume (Gals.) |   | Specified Volumes |   | Calculated Volume |

| Time | Temp (°F) | pH  | Cond. | Gals. Removed | Observations |
|------|-----------|-----|-------|---------------|--------------|
| 1351 | 71.6      | 7.0 | 456'  | 1.5           |              |
| 1354 | 72.3      | 6.7 | 447   | 3.0           |              |
| 1356 | 72.3      | 6.7 | 448   | 4.5           |              |
|      |           |     |       |               |              |
|      |           |     |       |               |              |

Did well dewater? Yes  No      Gallons actually evacuated: 4.5

Sampling Time: 1400      Sampling Date: 11-03-99

Sample I.D.: MW-2      Laboratory: (Sequoia) CORE N. Creek Assoc. Labs

Analyzed for: (TPH-G) (BTEX) (MTBE) TPH-D Other:

Duplicate I.D.:      Analyzed for: TPH-G BTEX MTBE TPH-D Other:

|                    |            |      |             |      |
|--------------------|------------|------|-------------|------|
| D.O. (if req'd):   | Pre-purge: | mg/L | Post-purge: | mg/L |
| O.R.P. (if req'd): | Pre-purge: | mV   | Post-purge: | mV   |

## CHEVRON WELL MONITORING DATA SHEET

|                            |                                   |
|----------------------------|-----------------------------------|
| Project #: 991103-J3       | Station #: 9-0517                 |
| Sampler: Josh              | Date: 11-03-99                    |
| Well I.D.: MW-3            | Well Diameter: (2) 3 4 6 8        |
| Total Well Depth: 17.51    | Depth to Water: 7.92              |
| Depth to Free Product:     | Thickness of Free Product (feet): |
| Referenced to: (PVC) Grade | D.O. Meter (if req'd): YSI HACH   |

| Well Diameter | Multiplier | Well Diameter | Multiplier                  |
|---------------|------------|---------------|-----------------------------|
| 2"            | 0.16       | 5"            | 1.02                        |
| 3"            | 0.37       | 6"            | 1.47                        |
| 4"            | 0.65       | Other         | radius <sup>2</sup> * 0.165 |

Purge Method:

Bailer  
 Disposable Bailer  
 Middleburg  
 Electric Submersible  
 Extraction Pump  
 Other: \_\_\_\_\_

Sampling Method:

Bailer  
 Disposable Bailer  
 Extraction Port  
 Other: \_\_\_\_\_

|                       |   |                   |   |                   |       |
|-----------------------|---|-------------------|---|-------------------|-------|
| 1.6                   | x | 3                 | = | 4.8               | Gals. |
| 1 Case Volume (Gals.) |   | Specified Volumes |   | Calculated Volume |       |

| Time            | Temp (°F)       | pH             | Cond.          | Gals. Removed  | Observations |
|-----------------|-----------------|----------------|----------------|----------------|--------------|
| 1412            | 70.2            | 7.1            | 538            | 2              | odor         |
| <del>1415</del> | <del>70.6</del> | <del>6.9</del> | <del>600</del> | <del>3.5</del> |              |
| 1418            | 70.6            | 6.9            | 642            | 5              |              |
|                 |                 |                |                |                |              |
|                 |                 |                |                |                |              |

Did well dewater? Yes   No Gallons actually evacuated: 5

Sampling Time: 1420 Sampling Date: 11-03-99

Sample I.D.: MW-3 Laboratory: (Sequoia) CORE N. Creek Assoc. Labs

Analyzed for: (TPH-G) (BTEX) (MTBE) TPH-D Other:

Duplicate I.D.: Analyzed for: TPH-G BTEX MTBE TPH-D Other:

D.O. (if req'd): Pre-purge: mg/L Post-purge: mg/L

O.R.P. (if req'd): Pre-purge: mV Post-purge: mV

# CHEVRON WELL MONITORING DATA SHEET

|                            |                                   |
|----------------------------|-----------------------------------|
| Project #: 991103-53       | Station #: 9-0517                 |
| Sampler: Josh              | Date: 11-03-99                    |
| Well I.D.: MW-4            | Well Diameter: (2) 3 4 6 8        |
| Total Well Depth: 1630     | Depth to Water: 9.81              |
| Depth to Free Product:     | Thickness of Free Product (feet): |
| Referenced to: (PVC) Grade | D.O. Meter (if req'd): YSI HACH   |

| Well Diameter | Multiplier | Well Diameter | Multiplier                  |
|---------------|------------|---------------|-----------------------------|
| 2"            | 0.16       | 5"            | 1.02                        |
| 3"            | 0.37       | 6"            | 1.47                        |
| 4"            | 0.65       | Other         | radius <sup>2</sup> * 0.163 |

Purge Method: Bailer  
 Disposable Bailer  
 Middleburg  
 Electric Submersible  
 Extraction Pump  
 Other: \_\_\_\_\_

Sampling Method: Bauer  
 Disposable Bailer  
 Extraction Port  
 Other: \_\_\_\_\_

|                       |   |                   |   |                   |       |
|-----------------------|---|-------------------|---|-------------------|-------|
| 1.0                   | x | 3                 | = | 3                 | Gals. |
| 1 Case Volume (Gals.) |   | Specified Volumes |   | Calculated Volume |       |

| Time | Temp (°F) | pH  | Cond. | Gals. Removed | Observations |
|------|-----------|-----|-------|---------------|--------------|
| 1430 | 69.3      | 7.1 | 616   | 1             |              |
| 1432 | 69.6      | 6.9 | 624   | 2             |              |
| 1434 | 69.6      | 6.9 | 623   | 3             |              |
|      |           |     |       |               |              |
|      |           |     |       |               |              |

Did well dewater? Yes  No Gallons actually evacuated: 3

Sampling Time: 1440 Sampling Date: 11-03-99

Sample I.D.: MW-4 Laboratory: Sequoia CORE N. Creek Assoc. Labs

Analyzed for: TPH-G BTEX MTBE TPH-D Other: \_\_\_\_\_

Duplicate I.D.: \_\_\_\_\_ Analyzed for: TPH-G BTEX MTBE TPH-D Other: \_\_\_\_\_

|                    |            |      |             |      |
|--------------------|------------|------|-------------|------|
| D.O. (if req'd):   | Pre-purge: | mg/L | Post-purge: | mg/L |
| O.R.P. (if req'd): | Pre-purge: | mV   | Post-purge: | mV   |