

facsimile
TRANSMITTAL

to: Jennifer Eberly
fax #: (510) 337-9335
re: Douglas Parking
date: August 18, 1995
pages: 4, including this cover sheet.

Dear Jennifer,

Here is the survey data on the Douglas Parking wells. I do apologise for not responding sooner, however, (by choice) we are no longer the consultant of record for this client. We have forwarded all data to the owner. Please feel free to call me if you have any questions.

Very truly yours,



Stuart G. Solomon

From the desk of...

Stuart G. Solomon
President
PIERS Environmental Services, Inc.
3131 S. Bascom Ave. Suite 5
Campbell, CA 95008

(408) 559-1248
Fax: (408) 559-1224

JAMES WILLIAM RASP P.E.
5134 Elrose Avenue
San Jose, California 95124
(408) 448-6768

November 20, 1994
Project No. 94113

Gen-Tech Environmental
1936 Camden Avenue, Suite 1
San Jose, California 95124

Subject: Monitoring Wells, Douglas Parking, 1721 Webster Street
Oakland, California

Gentlemen,

At your direction we determined the locations and elevations of the 3 monitoring wells at the Douglas Parking Garage, 1721 Webster Street, Oakland, California. The locations and elevations of the wells are shown on the attached sketch along with the calculated distances between the wells. The elevations of the wells are also listed below.

MW-1	29.73' 29.50'	Top of Handhole PVC Casing
MW-2	27.41' 27.10'	Top of Handhole PVC Casing
MW-3	29.59' 29.25'	Top of Handhole PVC Casing

Elevations were determined to Mean Sea Level (MSL) utilizing as a benchmark the top of curb at the easterly end of the northerly curb return at the intersection of 17th Street and Webster Street. The elevation of the top of curb, 30.97 ft. was provided by the Public Works Department of the City of Oakland.

All the PVC casings were marked with a black marker at the locations where the elevations were taken. All the wells were accessible and no problems or difficulties were encountered.

Gen-Tech Environmental
Page 2
November 20, 1994

We trust that the information that we have provided meets your needs. Should you have any questions or comments concerning this information please do not hesitate to contact us.

Very Truly Yours,



James W. Rasp P.E.



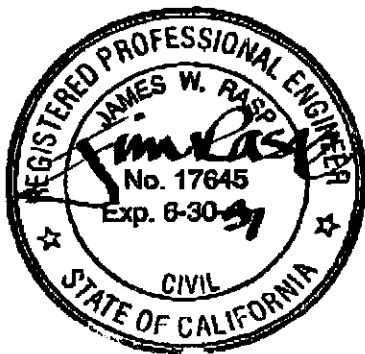
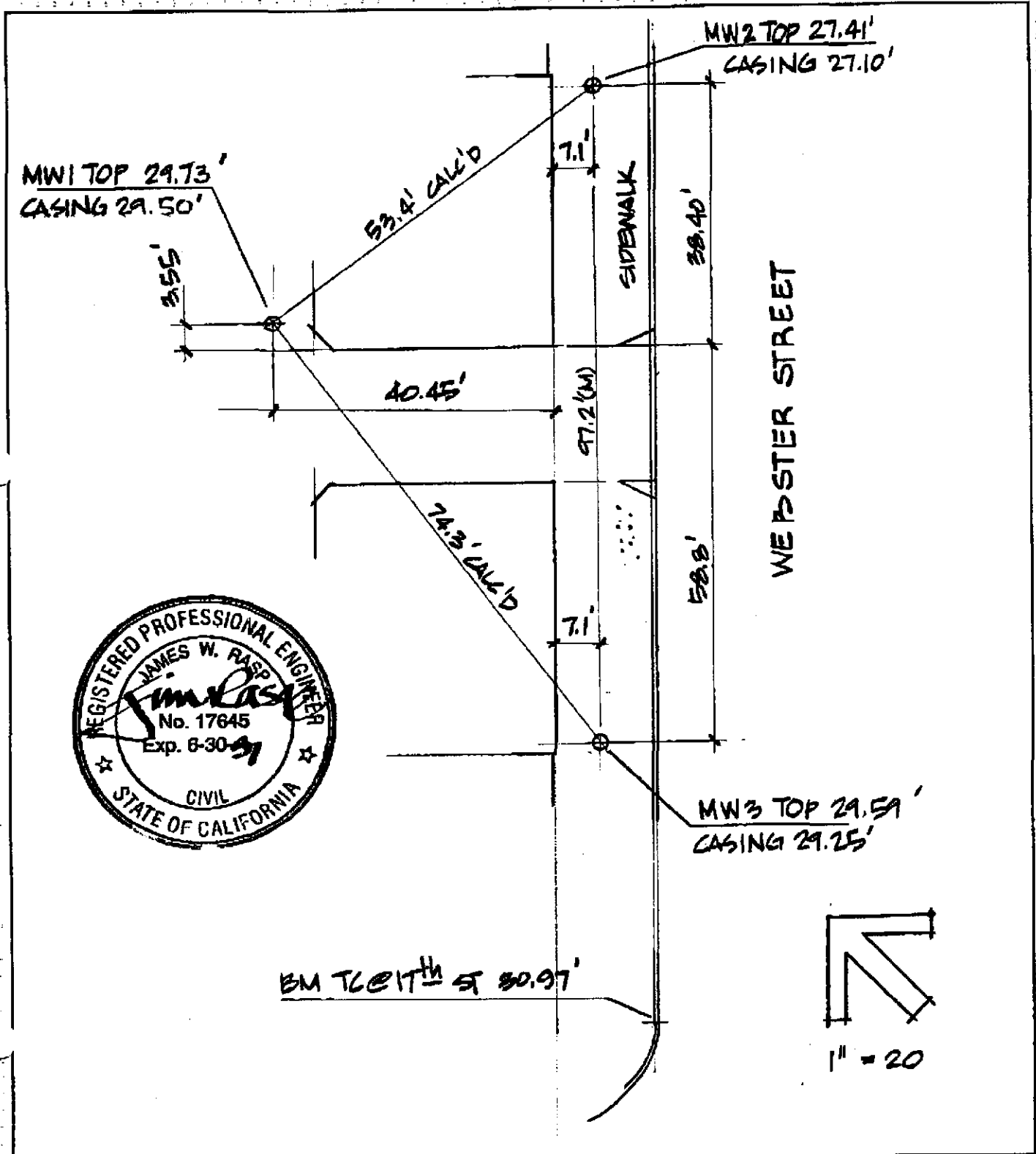

JAMES RASP P.E.
 Civil and Structural Engineering
 5134 Elrose Avenue
 San Jose, California 95124
 (408) 448-6768

JOB 94113/GENTECH/DOUGLAS PARKING
 SHEET NO. 1 OF _____
 CALCULATED BY JIM RASP DATE 11/20/94
 CHECKED BY _____ DATE _____
 SCALE 1" = 20'



BM TCEITH ST 30.97'

