



**RECEIVED**

3:06 pm, Dec 23, 2008

Alameda County  
Environmental Health

**Denis L. Brown**

Jerry Wickham  
Alameda County Health Care Services Agency  
1131 Harbor Bay Parkway, Suite 250  
Alameda, California 94502-6577

**Shell Oil Products US**

HSE – Environmental Services  
20945 S. Wilmington Ave.  
Carson, CA 90810-1039  
Tel (707) 865 0251  
Fax (707) 865 2542

Email [denis.l.brown@shell.com](mailto:denis.l.brown@shell.com)

Re: Shell-branded Service Station  
999 San Pablo Avenue  
Albany, California  
SAP Code 135037  
Incident No. 98995143  
ACHCSA Case No. RO0000121

Dear Mr. Wickham:

The attached document is provided for your review and comment. Upon information and belief, I declare, under penalty of perjury, that the information contained in the attached document is true and correct.

If you have any questions or concerns, please call me at (707) 865-0251.

Sincerely,

A handwritten signature in black ink, appearing to read "Denis L. Brown", is written over a horizontal line.

Denis L. Brown  
Project Manager



## **GROUNDWATER MONITORING REPORT - FOURTH QUARTER 2008**

**SHELL-BRANDED SERVICE STATION  
999 SAN PABLO AVENUE  
ALBANY, CALIFORNIA**

**SAP CODE            135037  
INCIDENT NO.      98995143  
AGENCY NO.        RO0000121**

**DECEMBER 22, 2008**

**REF. NO. 240366 (1)**

This report is printed on recycled paper.

**Prepared by:  
Conestoga-Rovers  
& Associates**

19449 Riverside Dr, Suite 230  
Sonoma, California  
U.S.A. 95476

Office: (707) 935-4850  
Fax: (707) 935-6649

web: <http://www.CRAworld.com>

TABLE OF CONTENTS

	<u>Page</u>
1.0 INTRODUCTION .....	1
1.1 SITE INFORMATION.....	1
2.0 SITE ACTIVITIES, FINDINGS, AND DISCUSSION .....	2
2.1 CURRENT QUARTER'S ACTIVITIES .....	2
2.2 CURRENT QUARTER'S FINDINGS.....	2
2.3 PROPOSED ACTIVITIES FOR NEXT QUARTER.....	2
2.4 DISCUSSION .....	2

LIST OF FIGURES  
(Following Text)

- FIGURE 1           VICINITY MAP
- FIGURE 2           GROUNDWATER CONTOUR AND CHEMICAL CONCENTRATION MAP

LIST OF APPENDICES

- APPENDIX A           BLAINE TECH SERVICES, INC. - GROUNDWATER MONITORING  
REPORT
- APPENDIX B           GROUNDWATER MONITORING RESULTS FOR ARCO #2035 AT  
1001 SAN PABLO AVE

## 1.0 INTRODUCTION

Conestoga-Rovers & Associates (CRA) prepared this report on behalf of Equilon Enterprises LLC dba Shell Oil Products US (Shell) in accordance with the quarterly reporting requirements of 23 CCR 2652d.

### 1.1 SITE INFORMATION

Site Address	999 San Pablo Avenue, Albany
Site Use	Shell-branded Service Station
Shell Project Manager	Denis Brown
CRA Project Manager	Dennis Baertschi
Lead Agency and Contact	ACHCSA, Jerry Wickham
Agency Case No.	RO0000121
Shell SAP Code	135037
Shell Incident No.	98995143

Date of most recent agency correspondence was June 28, 2001.

## 2.0 SITE ACTIVITIES, FINDINGS, AND DISCUSSION

### 2.1 CURRENT QUARTER'S ACTIVITIES

Blaine Tech Services, Inc. (Blaine) gauged and sampled the wells according to the established monitoring program for this site.

CRA prepared a vicinity map (Figure 1) and a groundwater contour and chemical concentration map (Figure 2). The Blaine report, presenting the analytical data, is included in Appendix A.

Groundwater monitoring activities were coordinated with monitoring at the adjacent ARCO Station located at 1001 San Pablo Avenue. The report for the ARCO site, presenting groundwater elevations and laboratory analytical data, is included in Appendix B.

### 2.2 CURRENT QUARTER'S FINDINGS

Groundwater Flow Direction	Southwesterly
Hydraulic Gradient	0.03
Depth to Water	7.30 to 10.91 feet below top of well casing

### 2.3 PROPOSED ACTIVITIES FOR NEXT QUARTER

Blaine will gauge and sample wells during the third month of the quarter, according to the established monitoring program for this site, and CRA will prepare a report.

Blaine will continue to conduct monthly gauging and bailing of separate phase hydrocarbons (SPH) from onsite well S-8.

### 2.4 DISCUSSION

*Separate Phase Hydrocarbons in Well S-8:* Due to the presence of SPH in onsite well S-8, first measured on August 29, 2007 at 0.04 feet thick, well S-8 has not been sampled since August 30, 2007. Since then Blaine has conducted monthly gauging and bailing of SPH from S-8. Maximum thickness of SPH was measured in this well at 0.32 feet on

September 25, 2007. The thickness of SPH in well S-8 this quarter was measured at 0.03, 0.25, and 0.20 feet in September, October, and November, 2008, respectively. During this quarter approximately 1.2 liters of SPH was bailed from S-8 and placed in a drum at the site. The drum is properly labeled and its contents are recycled at Shell's Martinez Refinery every ninety days. Since August 30, 2007, a total of approximately 5 liters (or approximately 1.3 gallons) of SPH has been removed from well S-8. Monthly gauging and bailing of SPH from S-8 will continue until such time as no SPH is observed for three consecutive events.

All of Which is Respectfully Submitted,  
CONESTOGA-ROVERS & ASSOCIATES



Dennis Baertschi



Ana Friel, PG



## FIGURES

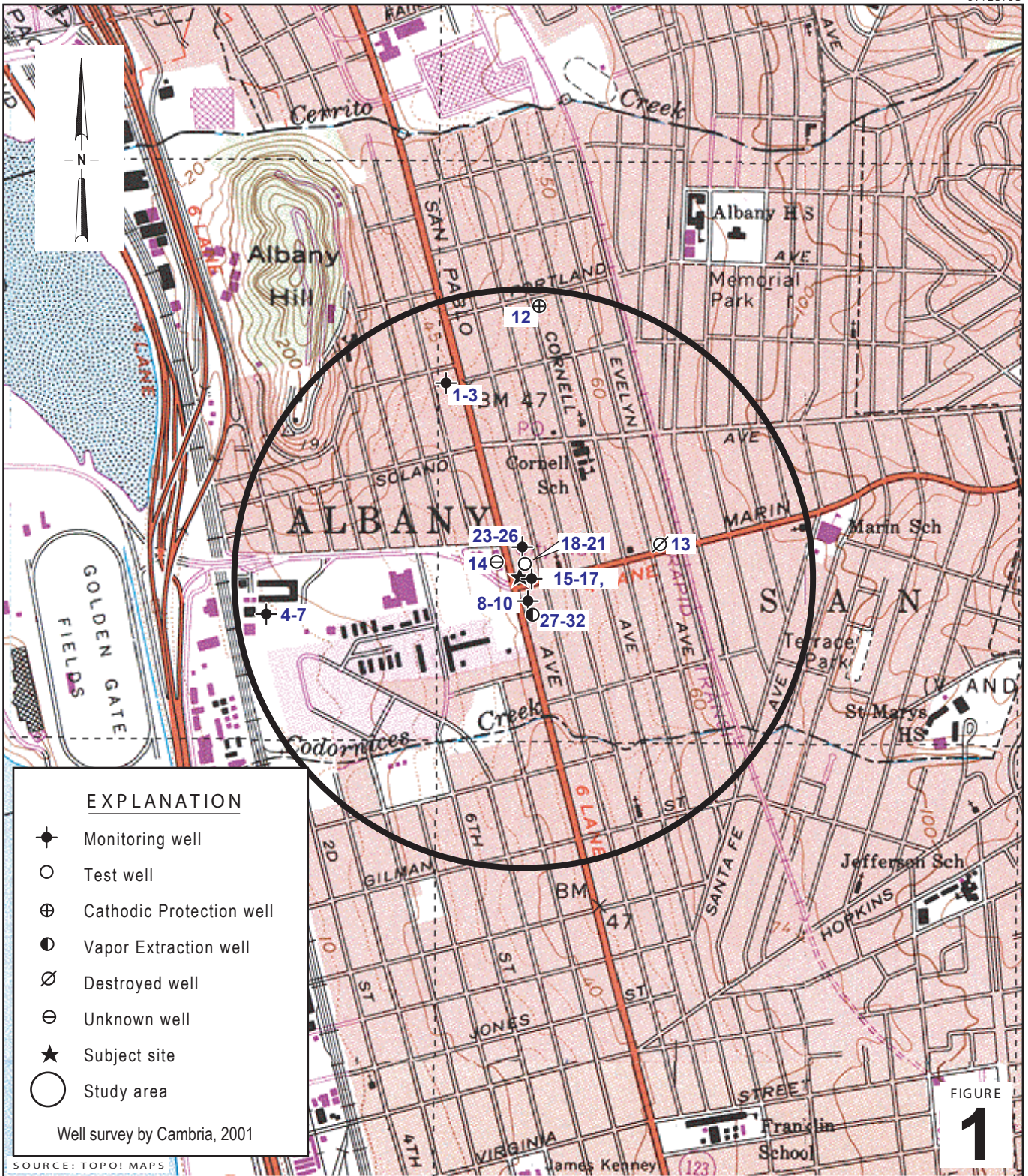

FIGURE  
**1**

**Shell-branded Service Station**  
999 San Pablo Avenue  
Albany, California



**CONESTOGA-ROVERS  
& ASSOCIATES**

**Vicinity Map**  
(1/2-Mile Radius)

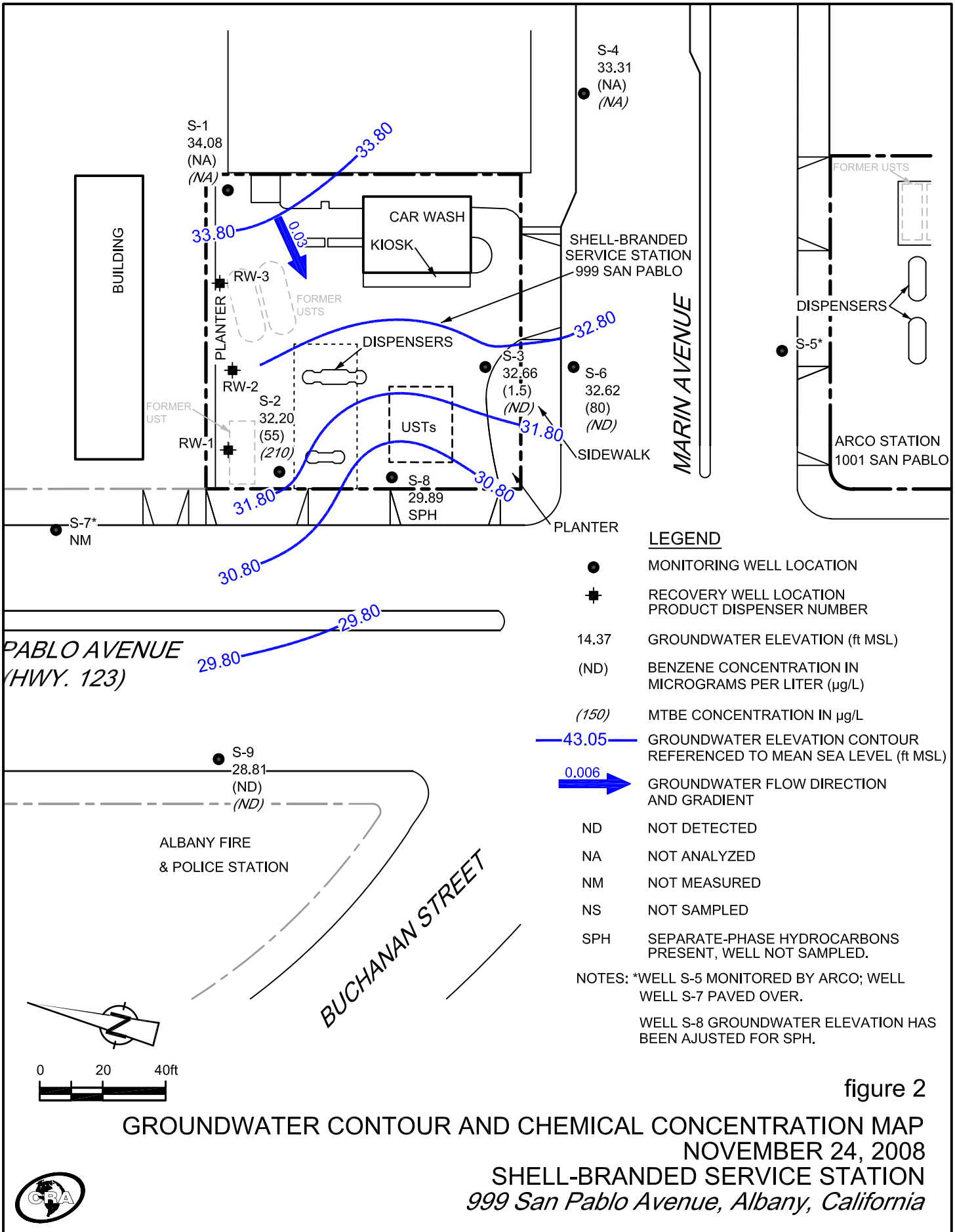

APPENDIX A

BLAINE TECH SERVICES, INC. -  
GROUNDWATER MONITORING REPORT

---

# BLAINE

TECH SERVICES INC.

---

GROUNDWATER SAMPLING SPECIALISTS  
SINCE 1985

December 15, 2008

Denis Brown  
Shell Oil Products US  
20945 South Wilmington Avenue  
Carson, CA 90810

Fourth Quarter 2008 Groundwater Monitoring at  
Shell-branded Service Station  
999 San Pablo Avenue  
Albany, CA

Monitoring performed on September 30, October 31 and  
November 24, 2008

---

## Groundwater Monitoring Report **081124-MT-1**

This report covers the routine monitoring of groundwater wells at this Shell-branded facility. In accordance with standard procedures that conform to Regional Water Quality Control Board requirements, routine field data collection includes depth to water, total well depth, thickness of any separate immiscible layer, water column volume, calculated purge volume (if applicable), elapsed evacuation time (if applicable), total volume of water removed (if applicable), and standard water parameter instrument readings. Sample material is collected, contained, stored, and transported to the laboratory in conformance with EPA standards. Purgewater (if applicable) is, likewise, collected and transported to the Martinez Refining Company.

Basic field information is presented alongside analytical values excerpted from the laboratory report in the cumulative table of **WELL CONCENTRATIONS**. The full analytical report for the most recent samples and the field data sheets are attached to this report.

At a minimum, Blaine Tech Services, Inc. field personnel are certified on completion of a forty-hour Hazardous Materials and Emergency Response training course per 29 CFR 1910.120. Field personnel are also enrolled in annual eight-hour refresher courses.

Blaine Tech Services, Inc. conducts sampling and documentation assignments of this type as an independent third party. Our activities at this site consisted of objective data and sample collection only. No interpretation of analytical results, defining of hydrological conditions or formulation of recommendations was performed.

Please call if you have any questions.

Yours truly,

Mike Ninokata  
Project Manager

MN/tm

attachments: Cumulative Table of WELL CONCENTRATIONS  
Certified Analytical Report  
Field Data Sheets

cc: Dennis Baertschi  
Conestoga-Rovers & Associates  
19449 Riverside Dr., Suite 230  
Sonoma, CA 95476

**WELL CONCENTRATIONS**  
**Shell-branded Service Station**  
**999 San Pablo Avenue**  
**Albany, CA**

Well ID	Date	TPPH (ug/L)	B (ug/L)	T (ug/L)	E (ug/L)	X (ug/L)	MTBE 8020 (ug/L)	MTBE 8260 (ug/L)	DIPE (ug/L)	ETBE (ug/L)	TAME (ug/L)	TBA (ug/L)	TOC (MSL)	Depth to Water (ft.)	GW Elevation (MSL)	SPH Thickness (ft.)	DO Reading (ppm)
S-1	5/13/1991	1,500	20	2.6	86	74	NA	NA	NA	NA	NA	NA	42.73	8.24	34.49	NA	NA
S-1	8/23/1991	2,900	27	<2.5	75	18	NA	NA	NA	NA	NA	NA	42.73	8.37	34.36	NA	NA
S-1	11/7/1991	2,900	8	2.5	46	26	NA	NA	NA	NA	NA	NA	42.73	8.30	34.43	NA	NA
S-1	1/28/1992	2,000	11	<2.5	60	20	NA	NA	NA	NA	NA	NA	42.73	7.84	34.89	NA	NA
S-1	5/6/1992	1,200	5.5	<2.5	80	36	NA	NA	NA	NA	NA	NA	42.73	7.95	34.78	NA	NA
S-1	8/26/1992	2,000	9.4	<2.5	130	<2.5	NA	NA	NA	NA	NA	NA	42.73	8.24	34.49	NA	NA
S-1	10/28/1992	1,300	27	3.2	72	13	NA	NA	NA	NA	NA	NA	42.73	8.52	34.21	NA	NA
S-1	1/19/1993	1,500	13	3	29	31	NA	NA	NA	NA	NA	NA	42.73	6.54	36.19	NA	NA
S-1	4/29/1993	2,000	15	<2.5	82	<65	NA	NA	NA	NA	NA	NA	42.73	7.93	34.80	NA	NA
S-1	7/22/1993	620	1.1	4.2	3.5	13	NA	NA	NA	NA	NA	NA	42.73	8.09	34.64	NA	NA
S-1	10/21/1993	1,200	34	25	15	9.5	NA	NA	NA	NA	NA	NA	42.73	9.43	33.30	NA	NA
S-1	1/4/1994	860	<2.5	<2.5	5.7	5.3	NA	NA	NA	NA	NA	NA	42.73	8.25	34.48	NA	NA
S-1	4/13/1994	NA	NA	NA	NA	NA	NA	NA	NA	NA	NA	NA	42.73	8.02	34.71	NA	NA
S-1	7/25/1994	1,200	8.3	7.4	15	20	NA	NA	NA	NA	NA	NA	42.73	8.22	34.51	NA	NA
S-1	10/10/1994	NA	NA	NA	NA	NA	NA	NA	NA	NA	NA	NA	42.73	8.29	34.44	NA	NA
S-1	1/26/1995	1,000	12	0.6	12	420	NA	NA	NA	NA	NA	NA	42.73	6.88	35.85	NA	NA
S-1	4/21/1995	NA	NA	NA	NA	NA	NA	NA	NA	NA	NA	NA	42.73	7.65	35.08	NA	NA
S-1	7/28/1995	660	7.2	1	11	8.9	NA	NA	NA	NA	NA	NA	42.73	7.90	34.83	NA	4
S-1	10/31/1995	NA	NA	NA	NA	NA	NA	NA	NA	NA	NA	NA	42.73	7.72	35.01	NA	NA
S-1	1/10/1996	1,100	3.5	7	5.1	9.4	NA	NA	NA	NA	NA	NA	42.73	8.24	34.49	NA	7.4
S-1	4/25/1996	NA	NA	NA	NA	NA	NA	NA	NA	NA	NA	NA	42.73	7.74	34.99	NA	NA
S-1	7/23/1996	<50	<0.5	<0.5	<0.5	<0.5	<2.5	NA	NA	NA	NA	NA	42.73	7.92	34.81	NA	2.7
S-1	12/10/1996	NA	NA	NA	NA	NA	NA	NA	NA	NA	NA	NA	42.73	7.56	35.17	NA	0.6
S-1	2/20/1997	<50	<0.50	<0.50	<0.50	<0.50	<2.5	NA	NA	NA	NA	NA	42.73	7.95	34.78	NA	3
S-1	5/22/1997	NA	NA	NA	NA	NA	NA	NA	NA	NA	NA	NA	42.73	8.11	34.62	NA	0.5
S-1	8/22/1997	810	18	<2.0	5.1	4.4	18	NA	NA	NA	NA	NA	42.73	7.86	34.87	NA	3
S-1	11/3/1997	NA	NA	NA	NA	NA	NA	NA	NA	NA	NA	NA	42.73	8.35	34.38	NA	1.1
S-1	2/20/1998	<50	<0.50	<0.50	<0.50	<0.50	<2.5	NA	NA	NA	NA	NA	42.73	6.09	36.64	NA	2.9

**WELL CONCENTRATIONS**  
**Shell-branded Service Station**  
**999 San Pablo Avenue**  
**Albany, CA**

Well ID	Date	TPPH (ug/L)	B (ug/L)	T (ug/L)	E (ug/L)	X (ug/L)	MTBE 8020 (ug/L)	MTBE 8260 (ug/L)	DIPE (ug/L)	ETBE (ug/L)	TAME (ug/L)	TBA (ug/L)	TOC (MSL)	Depth to Water (ft.)	GW Elevation (MSL)	SPH Thickness (ft.)	DO Reading (ppm)
S-1	5/18/1998	NA	NA	NA	NA	NA	NA	NA	NA	NA	NA	NA	42.73	7.69	35.04	NA	1.1
S-1	8/20/1998	390	6.7	<0.50	0.64	<0.50	14	NA	NA	NA	NA	NA	42.73	8.20	34.53	NA	1.9
S-1	11/6/1998	NA	NA	NA	NA	NA	NA	NA	NA	NA	NA	NA	42.73	8.23	34.50	NA	NA
S-1	2/16/1999	<50	<0.50	<0.50	<0.50	<0.50	<2.5	NA	NA	NA	NA	NA	42.73	7.47	35.26	NA	1.5
S-1	5/28/1999	NA	NA	NA	NA	NA	NA	NA	NA	NA	NA	NA	42.73	7.60	35.13	NA	1.3
S-1	8/24/1999	72.4	<0.500	<0.500	<0.500	<0.500	<2.50	NA	NA	NA	NA	NA	42.73	7.95	34.78	NA	1.4
S-1	11/16/1999	NA	NA	NA	NA	NA	NA	NA	NA	NA	NA	NA	42.73	7.87	34.86	NA	1.3
S-1	2/2/2000	<50.0	<0.500	<0.500	<0.500	<0.500	<5.00	NA	NA	NA	NA	NA	42.73	7.26	35.47	NA	1.4
S-1	5/9/2000	NA	NA	NA	NA	NA	NA	NA	NA	NA	NA	NA	42.73	8.13	34.60	NA	1.0
S-1	8/3/2000	209	6.42	<0.500	<0.500	<0.500	<2.50	NA	NA	NA	NA	NA	42.73	8.12	34.61	NA	1.4
S-1	11/15/2000	NA	NA	NA	NA	NA	NA	NA	NA	NA	NA	NA	42.73	8.06	34.67	NA	1.0
S-1	2/14/2001	179	4.46	<0.500	<0.500	<0.500	8.72	NA	NA	NA	NA	NA	42.73	8.08	34.65	NA	1.1
S-1	5/31/2001	NA	NA	NA	NA	NA	NA	NA	NA	NA	NA	NA	42.73	8.05	34.68	NA	1.0
S-1	8/15/2001	270	<0.50	<0.50	<0.50	<0.50	NA	<5.0	NA	NA	NA	NA	42.73	8.40	34.33	NA	1.3
S-1	12/31/2001	NA	NA	NA	NA	NA	NA	NA	NA	NA	NA	NA	42.73	7.42	35.31	NA	0.4
S-1	2/6/2002	<50	<0.50	<0.50	<0.50	<0.50	NA	<5.0	NA	NA	NA	NA	42.73	7.60	35.13	NA	2.2
S-1	6/4/2002	NA	NA	NA	NA	NA	NA	NA	NA	NA	NA	NA	42.73	8.16	34.57	NA	0.8
S-1	7/25/2002	230	<0.50	<0.50	<0.50	<0.50	NA	<5.0	NA	NA	NA	NA	42.57	7.84	34.73	NA	0.9
S-1	11/27/2002	NA	NA	NA	NA	NA	NA	NA	NA	NA	NA	NA	42.57	8.01	34.56	NA	0.6
S-1	1/30/2003	310	<0.50	<0.50	3.6	1.6	NA	<5.0	NA	NA	NA	NA	42.57	7.56	35.01	NA	1.5
S-1	6/3/2003	NA	NA	NA	NA	NA	NA	NA	NA	NA	NA	NA	42.57	7.87	34.70	NA	1.6
S-1	8/8/2003	730	<0.50	<0.50	12	6.4	NA	<0.50	NA	NA	NA	NA	42.57	7.95	34.62	NA	1.3
S-1	11/13/2003	NA	NA	NA	NA	NA	NA	NA	NA	NA	NA	NA	42.57	7.90	34.67	NA	0.8
S-1	2/4/2004	220	<0.50	<0.50	1.8	1.1	NA	<0.50	NA	NA	NA	NA	42.57	7.37	35.20	NA	1.2
S-1	5/12/2004	NA	NA	NA	NA	NA	NA	NA	NA	NA	NA	NA	42.57	8.05	34.52	NA	1.1
S-1	8/23/2004	110 g	<0.50	<0.50	<0.50	<1.0	NA	<0.50	NA	NA	NA	NA	42.57	8.10	34.47	NA	0.6
S-1	12/1/2004	NA	NA	NA	NA	NA	NA	NA	NA	NA	NA	NA	42.57	7.84	34.73	NA	NA
S-1	2/7/2005	53 h	<0.50	<0.50	<0.50	<1.0	NA	<0.50	NA	NA	NA	NA	42.57	7.48	35.09	NA	0.49



**WELL CONCENTRATIONS**  
**Shell-branded Service Station**  
**999 San Pablo Avenue**  
**Albany, CA**

Well ID	Date	TPPH (ug/L)	B (ug/L)	T (ug/L)	E (ug/L)	X (ug/L)	MTBE 8020 (ug/L)	MTBE 8260 (ug/L)	DIPE (ug/L)	ETBE (ug/L)	TAME (ug/L)	TBA (ug/L)	TOC (MSL)	Depth to Water (ft.)	GW Elevation (MSL)	SPH Thickness (ft.)	DO Reading (ppm)
S-1	5/2/2005	NA	NA	NA	NA	NA	NA	NA	NA	NA	NA	NA	42.57	8.05	34.52	NA	NA
S-1	8/4/2005	850	<0.50	<0.50	4.5	1.0	NA	<0.50	NA	NA	NA	NA	42.57	8.05	34.52	NA	0.01
S-1	11/16/2005	NA	NA	NA	NA	NA	NA	NA	NA	NA	NA	NA	42.57	8.19	34.38	NA	NA
S-1	3/2/2006	170	<0.50	<0.50	2.4	0.91	NA	<0.50	NA	NA	NA	NA	42.57	7.58	34.99	NA	0.32
S-1	5/31/2006	NA	NA	NA	NA	NA	NA	NA	NA	NA	NA	NA	42.57	8.03	34.54	NA	NA
S-1	8/29/2006	<50.0	<0.500	<0.500	<0.500	<0.500	NA	<0.500	NA	NA	NA	NA	42.57	7.99	34.58	NA	1.05
S-1	12/6/2006	NA	NA	NA	NA	NA	NA	NA	NA	NA	NA	NA	42.57	8.07	34.50	NA	0.4
S-1	1/30/2007	640	<0.50	<0.50	1.9	<1.0	NA	<0.50	NA	NA	NA	NA	42.57	8.32	34.25	NA	1.20
S-1	5/15/2007	NA	NA	NA	NA	NA	NA	NA	NA	NA	NA	NA	42.57	7.85	34.72	NA	0.16
S-1	8/29/2007	980 j	0.37 l	<1.0	3.3	<1.0	NA	<1.0	<2.0	<2.0	<2.0	<10	42.57	7.87	34.70	NA	2.54
S-1	11/29/2007	NA	NA	NA	NA	NA	NA	NA	NA	NA	NA	NA	42.57	8.18	34.39	NA	0.28
S-1	2/21/2008	430 j	<0.50	<1.0	<1.0	<1.0	NA	<1.0	NA	NA	NA	NA	42.57	7.94	34.63	NA	0.27
S-1	5/6/2008	NA	NA	NA	NA	NA	NA	NA	NA	NA	NA	NA	42.57	8.00	34.57	NA	0.1
S-1	8/27/2008	170	<0.50	<1.0	<1.0	<1.0	NA	<1.0	NA	NA	NA	NA	42.57	8.45	34.12	NA	0.21
<b>S-1</b>	<b>11/24/2008</b>	<b>NA</b>	<b>NA</b>	<b>NA</b>	<b>NA</b>	<b>NA</b>	<b>NA</b>	<b>NA</b>	<b>NA</b>	<b>NA</b>	<b>NA</b>	<b>NA</b>	<b>42.57</b>	<b>8.49</b>	<b>34.08</b>	<b>NA</b>	<b>0.06</b>

S-2	5/13/1991	23,000	3,900	230	1,100	3,200	NA	NA	NA	NA	NA	NA	40.73	8.50	32.23	NA	NA
S-2	8/23/1991	23,000	4,400	260	1,900	2,400	NA	NA	NA	NA	NA	NA	40.73	8.80	31.93	NA	NA
S-2	11/7/1991	40,000	4,000	160	1,020	3,400	NA	NA	NA	NA	NA	NA	40.73	8.61	32.12	NA	NA
S-2	1/28/1992	22,000	1,600	70	420	1,700	NA	NA	NA	NA	NA	NA	40.73	7.80	32.93	NA	NA
S-2	5/6/1992	20,000	2,600	110	860	1,900	NA	NA	NA	NA	NA	NA	40.73	8.10	32.63	NA	NA
S-2	8/26/1992	42,000	5,000	160	1,100	3,500	NA	NA	NA	NA	NA	NA	40.73	8.37	32.36	NA	NA
S-2	10/28/1992	34,000	4,800	330	1,600	2,900	NA	NA	NA	NA	NA	NA	40.73	8.64	32.09	NA	NA
S-2	1/19/1993	20,000	2,300	370	660	1,300	NA	NA	NA	NA	NA	NA	40.73	5.82	34.91	NA	NA
S-2	4/29/1993	40,000	2,000	67	900	1,900	NA	NA	NA	NA	NA	NA	40.73	7.70	33.03	NA	NA
S-2	7/22/1993	22,000	3,000	120	1,000	1,600	NA	NA	NA	NA	NA	NA	40.73	8.38	32.35	NA	NA
S-2 (D)	7/22/1993	17,000	3,000	110	1,000	1,500	NA	NA	NA	NA	NA	NA	40.73	8.38	32.35	NA	NA
S-2	10/21/1993	14,000	2,800	74	870	1,100	NA	NA	NA	NA	NA	NA	40.73	8.58	32.15	NA	NA

**WELL CONCENTRATIONS**  
**Shell-branded Service Station**  
**999 San Pablo Avenue**  
**Albany, CA**

Well ID	Date	TPPH (ug/L)	B (ug/L)	T (ug/L)	E (ug/L)	X (ug/L)	MTBE 8020 (ug/L)	MTBE 8260 (ug/L)	DIPE (ug/L)	ETBE (ug/L)	TAME (ug/L)	TBA (ug/L)	TOC (MSL)	Depth to Water (ft.)	GW Elevation (MSL)	SPH Thickness (ft.)	DO Reading (ppm)
S-2 (D)	10/21/1993	13,000	3,200	53	960	820	NA	NA	NA	NA	NA	NA	40.73	8.58	32.15	NA	NA
S-2	1/4/1994	21,000	2,100	67	990	770	NA	NA	NA	NA	NA	NA	40.73	7.70	33.03	NA	NA
S-2 (D)	1/4/1994	22,000	2,000	64	910	750	NA	NA	NA	NA	NA	NA	40.73	7.70	33.03	NA	NA
S-2	4/13/1994	NA	NA	NA	NA	NA	NA	NA	NA	NA	NA	NA	40.73	7.62	33.11	NA	NA
S-2	7/25/1994	43,000	2,600	490	990	1,300	NA	NA	NA	NA	NA	NA	40.73	7.86	32.87	NA	NA
S-2	10/10/1994	NA	NA	NA	NA	NA	NA	NA	NA	NA	NA	NA	40.73	8.12	32.61	NA	NA
S-2	1/26/1995	21,000	790	12	290	570	NA	NA	NA	NA	NA	NA	40.73	6.38	34.35	NA	5.5
S-2	4/21/1995	NA	NA	NA	NA	NA	NA	NA	NA	NA	NA	NA	40.73	7.01	33.72	NA	NA
S-2	7/28/1995	14,000	2,400	360	960	370	NA	NA	NA	NA	NA	NA	40.73	7.82	32.91	NA	4
S-2	10/31/1995	NA	NA	NA	NA	NA	NA	NA	NA	NA	NA	NA	40.73	7.57	33.16	NA	NA
S-2	1/10/1996	17,000	1,400	<50	480	170	NA	NA	NA	NA	NA	NA	40.73	8.13	32.60	NA	7.2
S-2	4/25/1996	NA	NA	NA	NA	NA	NA	NA	NA	NA	NA	NA	40.73	7.72	33.01	NA	NA
S-2	7/23/1996	16,000	2,700	69	1,100	110	9,500	NA	NA	NA	NA	NA	40.73	8.10	32.63	NA	2.2
S-2 (D)	7/23/1996	11,000	2,600	68	1,000	96	10,000	11,000	NA	NA	NA	NA	40.73	8.10	32.63	NA	2.2
S-2	12/10/1996	NA	NA	NA	NA	NA	NA	NA	NA	NA	NA	NA	40.73	8.57	32.16	NA	0.5
S-2	2/20/1997	10,000	500	<10	90	130	6,400	NA	NA	NA	NA	NA	40.73	8.15	32.58	NA	4
S-2	5/22/1997	NA	NA	NA	NA	NA	NA	NA	NA	NA	NA	NA	40.73	8.79	31.94	NA	1.1
S-2	8/22/1997	23,000	1,300	65	740	290	4,500	NA	NA	NA	NA	NA	40.73	8.05	32.68	NA	3.2
S-2 (D)	8/22/1997	20,000	1,200	<100	630	250	3,900	NA	NA	NA	NA	NA	40.73	8.05	32.68	NA	3.2
S-2	11/3/1997	NA	NA	NA	NA	NA	NA	NA	NA	NA	NA	NA	40.73	8.75	31.98	NA	1.2
S-2	2/20/1998	450	28	1.3	7.4	12	35	NA	NA	NA	NA	NA	40.73	6.34	34.39	NA	0.4
S-2	5/18/1998	NA	NA	NA	NA	NA	NA	NA	NA	NA	NA	NA	40.73	7.95	32.78	NA	0.8
S-2	8/20/1998	22,000	290	44	420	410	7,300	NA	NA	NA	NA	NA	40.73	7.73	33.00	NA	1.9
S-2	11/6/1998	NA	NA	NA	NA	NA	NA	NA	NA	NA	NA	NA	40.73	8.47	32.26	NA	NA
S-2	2/16/1999	27,000	200	<200	770	840	5,400	NA	NA	NA	NA	NA	40.73	7.24	33.49	NA	1.4
S-2	5/28/1999	NA	NA	NA	NA	NA	NA	NA	NA	NA	NA	NA	40.73	7.82	32.91	NA	1.3
S-2	8/24/1999	13,400	196	<25.0	439	113	597	NA	NA	NA	NA	NA	40.73	8.61	32.12	NA	1.2
S-2	11/16/1999	NA	NA	NA	NA	NA	NA	NA	NA	NA	NA	NA	40.73	8.17	32.56	NA	1.1

**WELL CONCENTRATIONS**  
**Shell-branded Service Station**  
**999 San Pablo Avenue**  
**Albany, CA**

Well ID	Date	TPPH (ug/L)	B (ug/L)	T (ug/L)	E (ug/L)	X (ug/L)	MTBE 8020 (ug/L)	MTBE 8260 (ug/L)	DIPE (ug/L)	ETBE (ug/L)	TAME (ug/L)	TBA (ug/L)	TOC (MSL)	Depth to Water (ft.)	GW Elevation (MSL)	SPH Thickness (ft.)	DO Reading (ppm)
S-2	2/2/2000	7,850	176	88.0	134	111	540	NA	NA	NA	NA	NA	40.73	7.57	33.16	NA	1.2
S-2	5/9/2000	NA	NA	NA	NA	NA	NA	NA	NA	NA	NA	NA	40.73	7.94	32.79	NA	1.3
S-2	8/3/2000	35,000	255	122	842	224	905	726e	NA	NA	NA	NA	40.73	8.07	32.66	NA	1.1
S-2	11/15/2000	NA	NA	NA	NA	NA	NA	NA	NA	NA	NA	NA	40.73	8.13	32.60	NA	1.3
S-2	2/14/2001	13,000	147	<25.0	309	54.4	581	NA	NA	NA	NA	NA	40.73	6.39	34.34	NA	1.4
S-2	5/31/2001	NA	NA	NA	NA	NA	NA	NA	NA	NA	NA	NA	40.73	7.21	33.52	NA	1.5
S-2	8/15/2001	15,000	67	4.1	220	33	NA	440	NA	NA	NA	NA	40.73	8.27	32.46	NA	0.6
S-2	12/31/2001	NA	NA	NA	NA	NA	NA	270	NA	NA	NA	NA	40.73	6.07	34.66	NA	0.2
S-2	2/6/2002	15,000	53	2.8	120	31	NA	220	NA	NA	NA	NA	40.73	7.98	32.75	NA	1.8
S-2	6/4/2002	NA	NA	NA	NA	NA	NA	NA	NA	NA	NA	NA	40.73	6.70	34.03	NA	0.2
S-2	7/25/2002	9,000	75	4.0	180	24	NA	460	NA	NA	NA	NA	40.63	7.67	32.96	NA	0.9
S-2	11/27/2002	NA	NA	NA	NA	NA	NA	NA	NA	NA	NA	NA	40.63	7.84	32.79	NA	0.7
S-2	1/30/2003	15,000	26	<2.5	92	22	NA	210	NA	NA	NA	NA	40.63	7.29	33.34	NA	15.6
S-2	6/3/2003	17,000	<25	<25	130	<50	NA	290	NA	NA	NA	NA	40.63	7.87	32.76	NA	5.4
S-2	8/8/2003	4,500	<2.5	<2.5	9.4	<5.0	NA	140	NA	NA	NA	NA	40.63	8.18	32.45	NA	16.2
S-2	11/13/2003	10,000	18	<10	47	21	NA	180	NA	NA	NA	NA	40.63	7.98	32.65	NA	19.5
S-2	2/4/2004	5,700	54	<10	54	<20	NA	270	NA	NA	NA	NA	40.63	7.21	33.42	NA	>15
S-2	5/12/2004	8,200	18	<10	<10	<20	NA	250	NA	NA	NA	NA	40.63	8.07	32.56	NA	3.1
S-2	8/23/2004	4,100	<10	<10	<10	<20	NA	84	<40	<40	<40	<100	40.63	8.52	32.11	NA	10.7
S-2	12/1/2004	2,000	3.4	<2.5	6.2	<5.0	NA	77	NA	NA	NA	NA	40.63	8.70	31.93	NA	11.8
S-2	2/7/2005	7,400	32	1.6	29	3.1	NA	210	NA	NA	NA	NA	40.63	7.58	33.05	NA	0.11
S-2	5/2/2005	8,100	84	4.9	83	5.5	NA	320	NA	NA	NA	NA	40.63	7.45	33.18	NA	0.6
S-2	8/4/2005	4,900	48	2.1	19	2.8	NA	330	<4.0	<4.0	<4.0	55	40.63	7.90	32.73	NA	0.4
S-2	11/16/2005	13,700	43.8	2.79	25.1	5.92	NA	156	NA	NA	NA	NA	40.63	8.33	32.30	NA	0.5
S-2	3/2/2006	5,800	44	3.2	20	5.6	NA	190	NA	NA	NA	NA	40.63	6.74	33.89	NA	0.63
S-2	5/31/2006	11,100	72.0	4.20	22.4	5.36	NA	308	NA	NA	NA	NA	40.63	7.46	33.17	NA	0.6
S-2	8/29/2006	37,400	72.1	5.08	39.6	6.89	NA	377	<0.500	<0.500	<0.500	46.7	40.63	8.02	32.61	NA	0.70
S-2	12/6/2006	5,000	41	3.2	11	5.2	NA	170	NA	NA	NA	NA	40.63	8.04	32.59	NA	0.5

**WELL CONCENTRATIONS**  
**Shell-branded Service Station**  
**999 San Pablo Avenue**  
**Albany, CA**

Well ID	Date	TPPH (ug/L)	B (ug/L)	T (ug/L)	E (ug/L)	X (ug/L)	MTBE 8020 (ug/L)	MTBE 8260 (ug/L)	DIPE (ug/L)	ETBE (ug/L)	TAME (ug/L)	TBA (ug/L)	TOC (MSL)	Depth to Water (ft.)	GW Elevation (MSL)	SPH Thickness (ft.)	DO Reading (ppm)
S-2	1/30/2007	4,200	24	1.7	5.9	2.3	NA	140	NA	NA	NA	NA	40.63	8.08	32.55	NA	0.11
S-2	5/15/2007	8,100 j	48	3.5	19	6.2 l	NA	180	NA	NA	NA	NA	40.63	8.05	32.58	NA	0.11
S-2	8/29/2007	8,400 j	60	3.8	12	4.68 l	NA	270	<4.0	<4.0	<4.0	64	40.63	8.01	32.62	NA	1.02
S-2	11/29/2007	4,100 j	48	4.8 m	11	12.3	NA	280	NA	NA	NA	NA	40.63	8.25	32.38	NA	0.55
S-2	2/21/2008	7,300 j	57	4.0	13	4.7	NA	250	NA	NA	NA	NA	40.63	7.25	33.38	NA	0.40
S-2	5/6/2008	8,900	42	3.1	9.8	4.1	NA	270	NA	NA	NA	NA	40.63	6.30	34.34	0.01	0.10/2.0
S-2	8/27/2008	9,400	67	<5.0	27	6.0	NA	240	<10	<10	<10	67	40.63	8.33	32.30	NA	0.15
<b>S-2</b>	<b>11/24/2008</b>	<b>7,100</b>	<b>55</b>	<b>&lt;5.0</b>	<b>9.3</b>	<b>&lt;5.0</b>	<b>NA</b>	<b>210</b>	<b>NA</b>	<b>NA</b>	<b>NA</b>	<b>NA</b>	<b>40.63</b>	<b>8.43</b>	<b>32.20</b>	<b>NA</b>	<b>0.7</b>

S-3	5/13/1991	3,300	30	3.6	26	13	NA	NA	NA	NA	NA	NA	41.46	7.90	33.56	NA	NA
S-3	8/23/1991	2,000	25	4	9.3	4.5	NA	NA	NA	NA	NA	NA	41.46	8.14	33.32	NA	NA
S-3	11/7/1991	4,000	20	3.9	5	4.9	NA	NA	NA	NA	NA	NA	41.46	7.91	33.55	NA	NA
S-3	1/28/1992	2,100	21	7.6	6.7	15	NA	NA	NA	NA	NA	NA	41.46	7.53	33.93	NA	NA
S-3 (D)	1/28/1992	2,100	18	6.1	7.1	14	NA	NA	NA	NA	NA	NA	41.46	7.53	33.93	NA	NA
S-3	5/6/1992	6,600	38	51	45	65	NA	NA	NA	NA	NA	NA	41.46	7.55	33.91	NA	NA
S-3	8/26/1992	5,800	18	12	29	60	NA	NA	NA	NA	NA	NA	41.46	7.53	33.93	NA	NA
S-3	10/28/1992	3,000	55	11	16	32	NA	NA	NA	NA	NA	NA	41.46	7.95	33.51	NA	NA
S-3	1/19/1993	3,100	<5	5.1	11	16	NA	NA	NA	NA	NA	NA	41.46	6.12	35.34	NA	NA
S-3	4/29/1993	3,000	31	22	<5	14	NA	NA	NA	NA	NA	NA	41.46	7.27	34.19	NA	NA
S-3	7/22/1993	2,600	3.1	43	23	53	NA	NA	NA	NA	NA	NA	41.46	7.62	33.84	NA	NA
S-3	10/21/1993	2,500	73	14	16	32	NA	NA	NA	NA	NA	NA	41.46	7.81	33.65	NA	NA
S-3	1/4/1994	4,800	13	21	<12.5	33	NA	NA	NA	NA	NA	NA	41.46	7.49	33.97	NA	NA
S-3	4/13/1994	NA	NA	NA	NA	NA	NA	NA	NA	NA	NA	NA	41.46	7.32	34.14	NA	NA
S-3	7/25/1994	2,600	6.1	4	3.8	12	NA	NA	NA	NA	NA	NA	41.46	7.66	33.80	NA	NA
S-3	10/10/1994	NA	NA	NA	NA	NA	NA	NA	NA	NA	NA	NA	41.46	7.49	33.97	NA	NA
S-3	1/26/1995	3,600	30	6.8	5.6	19	NA	NA	NA	NA	NA	NA	41.46	6.50	34.96	NA	NA
S-3 (D)	1/26/1995	2,200	9.9	15	14	22	NA	NA	NA	NA	NA	NA	41.46	6.50	34.96	NA	NA
S-3	4/21/1995	NA	NA	NA	NA	NA	NA	NA	NA	NA	NA	NA	41.46	6.79	34.67	NA	NA

**WELL CONCENTRATIONS**  
**Shell-branded Service Station**  
**999 San Pablo Avenue**  
**Albany, CA**

Well ID	Date	TPPH (ug/L)	B (ug/L)	T (ug/L)	E (ug/L)	X (ug/L)	MTBE 8020 (ug/L)	MTBE 8260 (ug/L)	DIPE (ug/L)	ETBE (ug/L)	TAME (ug/L)	TBA (ug/L)	TOC (MSL)	Depth to Water (ft.)	GW Elevation (MSL)	SPH Thickness (ft.)	DO Reading (ppm)
S-3	7/28/1995	3,700	27	9.3	20	34	NA	NA	NA	NA	NA	NA	41.46	7.28	34.18	NA	4
S-3	10/31/1995	NA	NA	NA	NA	NA	NA	NA	NA	NA	NA	NA	41.46	6.74	34.72	NA	NA
S-3	1/10/1996	4,000	10	<0.5	13	28	NA	NA	NA	NA	NA	NA	41.46	7.48	33.98	NA	6.1
S-3	4/25/1996	NA	NA	NA	NA	NA	NA	NA	NA	NA	NA	NA	41.46	6.90	34.56	NA	NA
S-3	7/23/1996	2,100	20	<0.5	<0.5	<0.5	<25	NA	NA	NA	NA	NA	41.46	7.04	34.42	NA	2.1
S-3	12/10/1996	NA	NA	NA	NA	NA	NA	NA	NA	NA	NA	NA	41.46	7.96	33.50	NA	0.7
S-3	2/20/1997	3,500	83	<5.0	18	16	130	NA	NA	NA	NA	NA	41.46	7.44	34.02	NA	3
S-3 (D)	2/20/1997	3,000	69	<5.0	14	12	70	NA	NA	NA	NA	NA	41.46	7.44	34.02	NA	3
S-3	5/22/1997	NA	NA	NA	NA	NA	NA	NA	NA	NA	NA	NA	41.46	7.13	34.33	NA	0.6
S-3	8/22/1997	4,700	60	12	19	21	40	NA	NA	NA	NA	NA	41.46	6.81	34.65	NA	2.9
S-3	11/3/1997	NA	NA	NA	NA	NA	NA	NA	NA	NA	NA	NA	41.46	7.40	34.06	NA	0.9
S-3	2/20/1998	3,400	<10	<10	14	18	85	NA	NA	NA	NA	NA	41.46	6.55	34.91	NA	0.8
S-3 (D)	2/20/1998	3,100	8.6	7.8	12	16	57	NA	NA	NA	NA	NA	41.46	6.55	34.91	NA	0.8
S-3	5/18/1998	NA	NA	NA	NA	NA	NA	NA	NA	NA	NA	NA	41.46	6.81	34.65	NA	0.7
S-3	8/20/1998	4,400	67	23	9.8	22	240	NA	NA	NA	NA	NA	41.46	6.98	34.48	NA	2.2
S-3	11/6/1998	NA	NA	NA	NA	NA	NA	NA	NA	NA	NA	NA	41.46	6.96	34.50	NA	NA
S-3	2/16/1999	2,000	6.9	6.2	3.7	4.8	47	NA	NA	NA	NA	NA	41.46	6.93	34.53	NA	2.0
S-3	5/28/1999	NA	NA	NA	NA	NA	NA	NA	NA	NA	NA	NA	41.46	6.74	34.72	NA	1.8
S-3	8/24/1999	4,170	54.8	14.2	6.65	13.7	43.4	NA	NA	NA	NA	NA	41.46	9.05	32.41	NA	1.9
S-3	11/16/1999	NA	NA	NA	NA	NA	NA	NA	NA	NA	NA	NA	41.46	7.09	34.37	NA	1.6
S-3	2/2/2000	2,410	133	112	24.9	104	46.0	NA	NA	NA	NA	NA	41.46	6.59	34.87	NA	1.9
S-3	5/9/2000	NA	NA	NA	NA	NA	NA	NA	NA	NA	NA	NA	41.46	7.13	34.33	NA	1.9
S-3	8/3/2000	3,890	17.2	21.9	<10.0	<10.0	166	NA	NA	NA	NA	NA	41.46	6.82	34.64	NA	1.8
S-3	11/15/2000	NA	NA	NA	NA	NA	NA	NA	NA	NA	NA	NA	41.46	6.98	34.48	NA	1.6
S-3	2/14/2001	2,800	35.8	5.57	3.83	2.94	1,070	1,250	NA	NA	NA	NA	41.46	6.57	34.89	NA	1.1
S-3	5/31/2001	NA	NA	NA	NA	NA	NA	NA	NA	NA	NA	NA	41.46	6.72	34.74	NA	1.6
S-3	8/15/2001	2,700	2.0	0.52	<0.50	2.0	NA	140	NA	NA	NA	NA	41.46	7.44	34.02	NA	0.6
S-3	12/31/2001	2,300	<2.0	<2.0	<2.0	<2.0	NA	470	NA	NA	NA	NA	41.46	6.62	34.84	NA	0.6

**WELL CONCENTRATIONS**  
**Shell-branded Service Station**  
**999 San Pablo Avenue**  
**Albany, CA**

Well ID	Date	TPPH (ug/L)	B (ug/L)	T (ug/L)	E (ug/L)	X (ug/L)	MTBE 8020 (ug/L)	MTBE 8260 (ug/L)	DIPE (ug/L)	ETBE (ug/L)	TAME (ug/L)	TBA (ug/L)	TOC (MSL)	Depth to Water (ft.)	GW Elevation (MSL)	SPH Thickness (ft.)	DO Reading (ppm)
S-3	2/6/2002	2,000	2.6	1.6	4.3	7.8	NA	170	NA	NA	NA	NA	41.46	7.22	34.24	NA	2.2
S-3	6/4/2002	2,400	1.0	1.1	0.54	4.5	NA	120	NA	NA	NA	NA	41.46	7.34	34.12	NA	0.5
S-3	7/25/2002	3,100	0.86	<0.50	<0.50	2.0	NA	92	NA	NA	NA	NA	41.37	6.98	34.39	NA	1.0
S-3	11/27/2002	2,600	2.0	0.55	<0.50	2.1	NA	44	NA	NA	NA	NA	41.37	7.62	33.75	NA	0.7
S-3	1/30/2003	1,200	2.1	1.3	1.6	3.4	NA	42	NA	NA	NA	NA	41.37	7.14	34.23	NA	13.6
S-3	6/3/2003	2,700	2.9	<0.50	0.50	2.8	NA	43	NA	NA	NA	NA	41.37	7.25	34.12	NA	1.7
S-3	8/8/2003	1,400	2.4	0.71	<0.50	2.2	NA	32	NA	NA	NA	NA	41.37	7.67	33.70	NA	>20
S-3	11/13/2003	5,200	5.1	2.4	<1.0	5.6	NA	69	NA	NA	NA	NA	41.37	7.56	33.81	NA	19.6
S-3	2/4/2004	2,800	1.9	<1.0	1.0	2.6	NA	20	NA	NA	NA	NA	41.37	7.12	34.25	NA	>15
S-3	5/12/2004	1,900	2.8	<1.0	<1.0	2.2	NA	9.7	NA	NA	NA	NA	41.37	7.94	33.43	NA	4.0
S-3	8/23/2004	1,400	7.6	1.1	<1.0	2.9	NA	13	<4.0	<4.0	<4.0	<10	41.37	8.09	33.28	NA	13.3
S-3	12/1/2004	950	1.9	<1.0	<1.0	<2.0	NA	5.6	NA	NA	NA	NA	41.37	8.21	33.16	NA	13.0
S-3	2/7/2005	1,800	1.4	<1.0	<1.0	2.1	NA	9.9	NA	NA	NA	NA	41.37	7.69	33.68	NA	0.25
S-3	5/2/2005	4,000	2.3	1.1	1.6	3.0	NA	9.9	NA	NA	NA	NA	41.37	7.20	34.17	NA	0.5
S-3	8/4/2005	3,600	2.1	<1.0	<2.0	3.6	NA	8.5	<4.0	<4.0	<4.0	33	41.37	8.14	33.23	NA	0.2
S-3	11/16/2005	6,000	2.24	0.800	0.660	3.35	NA	3.83	NA	NA	NA	NA	41.37	8.39	32.98	NA	0.6
S-3	3/2/2006	1,500	1.3	<0.50	0.57	2.0	NA	5.1	NA	NA	NA	NA	41.37	7.09	34.28	NA	0.52
S-3	5/31/2006	5,560	1.71	0.730	1.24	3.89	NA	8.01 i	NA	NA	NA	NA	41.37	7.95	33.42	NA	0.5
S-3	8/29/2006	4,850	1.82	0.680	1.19	2.22	NA	3.16	<0.500	<0.500	<0.500	<10.0	41.37	6.35	35.02	NA	0.88
S-3	12/6/2006	2,900	1.1	<0.50	<0.50	2.2	NA	<0.50	NA	NA	NA	NA	41.37	8.41	32.96	NA	0.3
S-3	1/30/2007	2,100	1.0	<0.50	0.53	1.8	NA	5.7	NA	NA	NA	NA	41.37	8.31	33.06	NA	0.36
S-3	5/15/2007	3,500 j	1.1	0.51 l	0.76 l	2.38 l	NA	8.0	NA	NA	NA	NA	41.37	7.60	33.77	NA	0.11
S-3	8/29/2007	<50 j	1.5	0.48 l	0.50 l	2.81 l	NA	<1.0	<2.0	<2.0	<2.0	<10	41.37	8.64	32.73	NA	0.57
S-3	11/29/2007	3,800 j	1.8	0.80 l,m	0.65 l	3.34 l	NA	5.9	NA	NA	NA	NA	41.37	8.36	33.01	NA	0.22
S-3	2/21/2008	2,900 j	0.60	<1.0	<1.0	1.2	NA	5.0	NA	NA	NA	NA	41.37	7.35	34.02	NA	0.44
S-3	5/6/2008	2,400	1.2	<1.0	<1.0	1.7	NA	<1.0	NA	NA	NA	NA	41.37	8.00	33.37	NA	0.2/1.4
S-3	8/27/2008	3,100	1.5	<1.0	<1.0	2.3	NA	<1.0	<2.0	<2.0	<2.0	<10	41.37	8.56	32.81	NA	0.13
<b>S-3</b>	<b>11/24/2008</b>	<b>2,900</b>	<b>1.5</b>	<b>&lt;1.0</b>	<b>&lt;1.0</b>	<b>2.2</b>	<b>NA</b>	<b>&lt;1.0</b>	<b>NA</b>	<b>NA</b>	<b>NA</b>	<b>NA</b>	<b>41.37</b>	<b>8.71</b>	<b>32.66</b>	<b>NA</b>	<b>0.32</b>

**WELL CONCENTRATIONS**  
**Shell-branded Service Station**  
**999 San Pablo Avenue**  
**Albany, CA**

Well ID	Date	TPPH (ug/L)	B (ug/L)	T (ug/L)	E (ug/L)	X (ug/L)	MTBE 8020 (ug/L)	MTBE 8260 (ug/L)	DIPE (ug/L)	ETBE (ug/L)	TAME (ug/L)	TBA (ug/L)	TOC (MSL)	Depth to Water (ft.)	GW Elevation (MSL)	SPH Thickness (ft.)	DO Reading (ppm)
S-4	5/13/1991	<50	<0.5	<0.5	<0.5	<0.5	NA	NA	NA	NA	NA	NA	41.10	7.44	33.66	NA	NA
S-4	8/23/1991	<50	<0.5	<0.5	<0.5	<0.5	NA	NA	NA	NA	NA	NA	41.10	8.32	32.78	NA	NA
S-4	11/7/1991	260	<0.5	<0.5	<0.5	<0.5	NA	NA	NA	NA	NA	NA	41.10	8.32	32.78	NA	NA
S-4	1/28/1992	110c	<0.5	<0.5	<0.5	<0.5	NA	NA	NA	NA	NA	NA	41.10	7.40	33.70	NA	NA
S-4	5/6/1992	54	<0.5	<0.5	<0.5	<0.5	NA	NA	NA	NA	NA	NA	41.10	7.21	33.89	NA	NA
S-4	8/26/1992	67	<0.5	<0.5	<0.5	<0.5	NA	NA	NA	NA	NA	NA	41.10	8.13	32.97	NA	NA
S-4	10/28/1992	<50	<0.5	<0.5	<0.5	<0.5	NA	NA	NA	NA	NA	NA	41.10	8.73	32.37	NA	NA
S-4	1/19/1993	86	1.2	0.7	2.7	15	NA	NA	NA	NA	NA	NA	41.10	5.86	35.24	NA	NA
S-4	4/29/1993	<50	<0.5	<0.5	<0.5	<0.5	NA	NA	NA	NA	NA	NA	41.10	7.02	34.08	NA	NA
S-4 (D)	4/29/1993	<50	<0.5	<0.5	<0.5	<0.5	NA	NA	NA	NA	NA	NA	41.10	7.02	34.08	NA	NA
S-4	7/22/1993	<50	<0.5	<0.5	<0.5	<0.5	NA	NA	NA	NA	NA	NA	41.10	7.76	33.34	NA	NA
S-4	10/21/1993	<50	<0.5	<0.5	<0.5	<0.5	NA	NA	NA	NA	NA	NA	41.10	8.53	32.57	NA	NA
S-4	1/4/1994	<50	<0.5	<0.5	<0.5	<0.5	NA	NA	NA	NA	NA	NA	41.10	7.92	33.18	NA	NA
S-4	4/13/1994	NA	NA	NA	NA	NA	NA	NA	NA	NA	NA	NA	41.10	7.71	33.39	NA	NA
S-4	7/25/1994	NA	NA	NA	NA	NA	NA	NA	NA	NA	NA	NA	41.10	7.82	33.28	NA	NA
S-4	10/10/1994	NA	NA	NA	NA	NA	NA	NA	NA	NA	NA	NA	41.10	8.15	32.95	NA	NA
S-4	1/26/1995	<50	<0.5	<0.5	<0.5	<0.5	NA	NA	NA	NA	NA	NA	41.10	5.73	35.37	NA	NA
S-4	4/21/1995	NA	NA	NA	NA	NA	NA	NA	NA	NA	NA	NA	41.10	6.26	34.84	NA	NA
S-4	7/28/1995	NA	NA	NA	NA	NA	NA	NA	NA	NA	NA	NA	41.10	7.80	33.30	NA	NA
S-4	10/31/1995	NA	NA	NA	NA	NA	NA	NA	NA	NA	NA	NA	41.10	8.45	32.65	NA	NA
S-4	1/10/1996	<50	1	2.8	<0.5	2.1	NA	NA	NA	NA	NA	NA	41.10	8.26	32.84	NA	2.8
S-4	4/25/1996	NA	NA	NA	NA	NA	NA	NA	NA	NA	NA	NA	41.10	7.14	33.96	NA	NA
S-4	7/23/1996	<50	<0.5	<0.5	<0.5	<0.5	<2.5	NA	NA	NA	NA	NA	41.10	8.18	32.92	NA	3.8
S-4	12/10/1996	NA	NA	NA	NA	NA	NA	NA	NA	NA	NA	NA	41.10	7.04	34.06	NA	3.9
S-4	2/20/1997	<50	<0.50	<0.50	<0.50	<0.50	6.7	NA	NA	NA	NA	NA	41.10	7.07	34.03	NA	5
S-4	5/22/1997	NA	NA	NA	NA	NA	NA	NA	NA	NA	NA	NA	41.10	6.63	34.47	NA	0.8
S-4	8/22/1997	NA	NA	NA	NA	NA	NA	NA	NA	NA	NA	NA	41.10	7.69	33.41	NA	3.7

**WELL CONCENTRATIONS**  
**Shell-branded Service Station**  
**999 San Pablo Avenue**  
**Albany, CA**

Well ID	Date	TPPH (ug/L)	B (ug/L)	T (ug/L)	E (ug/L)	X (ug/L)	MTBE 8020 (ug/L)	MTBE 8260 (ug/L)	DIPE (ug/L)	ETBE (ug/L)	TAME (ug/L)	TBA (ug/L)	TOC (MSL)	Depth to Water (ft.)	GW Elevation (MSL)	SPH Thickness (ft.)	DO Reading (ppm)
S-4	11/3/1997	NA	NA	NA	NA	NA	NA	NA	NA	NA	NA	NA	41.10	8.26	32.84	NA	1.3
S-4	2/20/1998	130	6.9	4.6	5.2	17	2.8	NA	NA	NA	NA	NA	41.10	5.57	35.53	NA	1.8
S-4	5/18/1998	NA	NA	NA	NA	NA	NA	NA	NA	NA	NA	NA	41.10	7.13	33.97	NA	1.4
S-4	8/20/1998	NA	NA	NA	NA	NA	NA	NA	NA	NA	NA	NA	41.10	7.77	33.33	NA	4.0
S-4	11/6/1998	NA	NA	NA	NA	NA	NA	NA	NA	NA	NA	NA	41.10	7.85	33.25	NA	NA
S-4	2/16/1999	<50	<0.50	<0.50	<0.50	<0.50	23	NA	NA	NA	NA	NA	41.10	6.51	34.59	NA	3.6
S-4	5/28/1999	NA	NA	NA	NA	NA	NA	NA	NA	NA	NA	NA	41.10	7.00	34.10	NA	3.2
S-4	8/24/1999	NA	NA	NA	NA	NA	NA	NA	NA	NA	NA	NA	41.10	9.13	31.97	NA	1.9
S-4	11/16/1999	NA	NA	NA	NA	NA	NA	NA	NA	NA	NA	NA	41.10	7.79	33.31	NA	1.7
S-4	2/2/2000	<50.0	<0.500	<0.500	<0.500	<0.500	<5.00	NA	NA	NA	NA	NA	41.10	7.19	33.91	NA	1.9
S-4	5/9/2000	NA	NA	NA	NA	NA	NA	NA	NA	NA	NA	NA	41.10	7.51	33.59	NA	1.8
S-4	8/3/2000	NA	NA	NA	NA	NA	NA	NA	NA	NA	NA	NA	41.10	7.83	33.27	NA	1.9
S-4	11/15/2000	NA	NA	NA	NA	NA	NA	NA	NA	NA	NA	NA	41.10	7.69	33.41	NA	1.5
S-4	2/14/2001	<50.0	<0.500	<0.500	<0.500	<0.500	<2.50	NA	NA	NA	NA	NA	41.10	6.20	34.90	NA	1.6
S-4	5/31/2001	NA	NA	NA	NA	NA	NA	NA	NA	NA	NA	NA	41.10	6.56	34.54	NA	1.6
S-4	8/15/2001	NA	NA	NA	NA	NA	NA	NA	NA	NA	NA	NA	41.10	7.90	33.20	NA	0.6
S-4	12/31/2001	NA	NA	NA	NA	NA	NA	NA	NA	NA	NA	NA	41.10	5.62	35.48	NA	2.7
S-4	2/6/2002	<50	<0.50	<0.50	<0.50	<0.50	NA	<5.0	NA	NA	NA	NA	41.10	7.29	33.81	NA	0.2
S-4	6/4/2002	NA	NA	NA	NA	NA	NA	NA	NA	NA	NA	NA	41.10	7.45	33.65	NA	0.6
S-4	7/25/2002	NA	NA	NA	NA	NA	NA	NA	NA	NA	NA	NA	41.04	7.39	33.65	NA	0.8
S-4	11/27/2002	NA	NA	NA	NA	NA	NA	NA	NA	NA	NA	NA	41.04	7.60	33.44	NA	NA
S-4	1/30/2003	<50	<0.50	<0.50	<0.50	<0.50	NA	<5.0	NA	NA	NA	NA	41.04	8.45	32.59	NA	NA
S-4	6/3/2003	NA	NA	NA	NA	NA	NA	NA	NA	NA	NA	NA	41.04	6.82	34.22	NA	NA
S-4	8/8/2003	NA	NA	NA	NA	NA	NA	NA	NA	NA	NA	NA	41.04	7.36	33.68	NA	NA
S-4	11/13/2003	NA	NA	NA	NA	NA	NA	NA	NA	NA	NA	NA	41.04	7.56	33.48	NA	NA
S-4	2/4/2004	<50	<0.50	<0.50	<0.50	<1.0	NA	<0.50	NA	NA	NA	NA	41.04	6.47	34.57	NA	NA
S-4	5/12/2004	NA	NA	NA	NA	NA	NA	NA	NA	NA	NA	NA	41.04	7.10	33.94	NA	NA
S-4	8/23/2004	NA	NA	NA	NA	NA	NA	NA	NA	NA	NA	NA	41.04	7.60	33.44	NA	NA



**WELL CONCENTRATIONS**  
**Shell-branded Service Station**  
**999 San Pablo Avenue**  
**Albany, CA**

Well ID	Date	TPPH (ug/L)	B (ug/L)	T (ug/L)	E (ug/L)	X (ug/L)	MTBE 8020 (ug/L)	MTBE 8260 (ug/L)	DIPE (ug/L)	ETBE (ug/L)	TAME (ug/L)	TBA (ug/L)	TOC (MSL)	Depth to Water (ft.)	GW Elevation (MSL)	SPH Thickness (ft.)	DO Reading (ppm)
S-4	12/1/2004	NA	NA	NA	NA	NA	NA	NA	NA	NA	NA	NA	41.04	7.23	33.81	NA	NA
S-4	2/7/2005	<50	<0.50	<0.50	<0.50	<1.0	NA	<0.50	NA	NA	NA	NA	41.04	6.12	34.92	NA	NA
S-4	5/2/2005	NA	NA	NA	NA	NA	NA	NA	NA	NA	NA	NA	41.04	6.50	34.54	NA	NA
S-4	8/4/2005	NA	NA	NA	NA	NA	NA	NA	NA	NA	NA	NA	41.04	7.13	33.91	NA	NA
S-4	11/16/2005	NA	NA	NA	NA	NA	NA	NA	NA	NA	NA	NA	41.04	7.43	33.61	NA	NA
S-4	3/2/2006	<50	<0.50	<0.50	<0.50	<0.50	NA	<0.50	NA	NA	NA	NA	41.04	6.05	34.99	NA	NA
S-4	5/31/2006	NA	NA	NA	NA	NA	NA	NA	NA	NA	NA	NA	41.04	6.64	34.40	NA	NA
S-4	8/29/2006	NA	NA	NA	NA	NA	NA	NA	NA	NA	NA	NA	41.04	7.25	33.79	NA	NA
S-4	12/6/2006	NA	NA	NA	NA	NA	NA	NA	NA	NA	NA	NA	41.04	7.39	33.65	NA	NA
S-4	1/30/2007	<50	<0.50	<0.50	<0.50	<1.0	NA	<0.50	NA	NA	NA	NA	41.04	7.24	33.80	NA	NA
S-4	5/15/2007	NA	NA	NA	NA	NA	NA	NA	NA	NA	NA	NA	41.04	6.60	34.44	NA	NA
S-4	8/29/2007	NA	NA	NA	NA	NA	NA	NA	NA	NA	NA	NA	41.04	7.42	33.62	NA	NA
S-4	11/29/2007	NA	NA	NA	NA	NA	NA	NA	NA	NA	NA	NA	41.04	7.22	33.82	NA	NA
S-4	2/21/2008	<50 j	<0.50	<1.0	<1.0	<1.0	NA	<1.0	NA	NA	NA	NA	41.04	6.20	34.84	NA	NA
S-4	5/6/2008	NA	NA	NA	NA	NA	NA	NA	NA	NA	NA	NA	41.04	7.19	33.85	NA	NA
S-4	8/27/2008	NA	NA	NA	NA	NA	NA	NA	NA	NA	NA	NA	41.04	7.52	33.52	NA	NA
<b>S-4</b>	<b>11/24/2008</b>	<b>NA</b>	<b>NA</b>	<b>NA</b>	<b>NA</b>	<b>NA</b>	<b>NA</b>	<b>NA</b>	<b>NA</b>	<b>NA</b>	<b>NA</b>	<b>NA</b>	<b>41.04</b>	<b>7.73</b>	<b>33.31</b>	<b>NA</b>	<b>NA</b>

S-5	5/13/1991	NA	NA	NA	NA	NA	NA	NA	NA	NA	NA	NA	39.99	14.60	30.57	6.48	NA
S-5	8/23/1991	NA	NA	NA	NA	NA	NA	NA	NA	NA	NA	NA	39.99	15.14	29.25	5.50	NA
S-5	11/7/1991	NA	NA	NA	NA	NA	NA	NA	NA	NA	NA	NA	39.99	15.10	29.17	5.35	NA
S-5	1/28/1992	NA	NA	NA	NA	NA	NA	NA	NA	NA	NA	NA	39.99	14.05	29.86	4.90	NA
S-5	5/6/1992	NA	NA	NA	NA	NA	NA	NA	NA	NA	NA	NA	39.99	14.31	30.21	5.66	NA
S-5	8/26/1992	NA	NA	NA	NA	NA	NA	NA	NA	NA	NA	NA	39.99	14.26	28.77	3.80	NA
S-5	10/28/1992	NA	NA	NA	NA	NA	NA	NA	NA	NA	NA	NA	39.99	14.22	28.82	3.81	NA
S-5	1/19/1993	NA	NA	NA	NA	NA	NA	NA	NA	NA	NA	NA	39.99	12.36	30.80	3.96	NA
S-5	4/29/1993	NA	NA	NA	NA	NA	NA	NA	NA	NA	NA	NA	39.99	9.64	31.07	0.90	NA
S-5	7/22/1993	NA	NA	NA	NA	NA	NA	NA	NA	NA	NA	NA	39.99	9.55	31.16	0.90	NA

**WELL CONCENTRATIONS**  
**Shell-branded Service Station**  
**999 San Pablo Avenue**  
**Albany, CA**

Well ID	Date	TPPH (ug/L)	B (ug/L)	T (ug/L)	E (ug/L)	X (ug/L)	MTBE 8020 (ug/L)	MTBE 8260 (ug/L)	DIPE (ug/L)	ETBE (ug/L)	TAME (ug/L)	TBA (ug/L)	TOC (MSL)	Depth to Water (ft.)	GW Elevation (MSL)	SPH Thickness (ft.)	DO Reading (ppm)
S-5	10/21/1993	NA	NA	NA	NA	NA	NA	NA	NA	NA	NA	NA	39.99	11.23	29.34	0.73	NA
S-5	1/4/1994	NA	NA	NA	NA	NA	NA	NA	NA	NA	NA	NA	39.99	11.69	29.82	1.90	NA
S-5	4/13/1994	NA	NA	NA	NA	NA	NA	NA	NA	NA	NA	NA	39.99	11.42	29.87	1.62	NA
S-5	7/25/1994	NA	NA	NA	NA	NA	NA	NA	NA	NA	NA	NA	39.99	12.01	29.41	1.79	NA
S-5	10/10/1994	NA	NA	NA	NA	NA	NA	NA	NA	NA	NA	NA	39.99	12.05	29.38	1.80	NA
S-5	1/26/1995	NA	NA	NA	NA	NA	NA	NA	NA	NA	NA	NA	39.99	8.42	32.95	1.72	NA
S-5	4/21/1995	NA	NA	NA	NA	NA	NA	NA	NA	NA	NA	NA	39.99	10.03	30.90	1.17	NA
S-5	7/28/1995	NA	NA	NA	NA	NA	NA	NA	NA	NA	NA	NA	39.99	11.42	30.07	1.87	NA
S-5	10/31/1995	NA	NA	NA	NA	NA	NA	NA	NA	NA	NA	NA	39.99	13.21	27.21	0.54	NA
S-5	1/10/1996	NA	NA	NA	NA	NA	NA	NA	NA	NA	NA	NA	39.99	12.05	28.04	0.13	NA
S-5	4/25/1996	NA	NA	NA	NA	NA	NA	NA	NA	NA	NA	NA	39.99	9.68	30.33	0.03	NA
S-5	7/23/1996	NA	NA	NA	NA	NA	NA	NA	NA	NA	NA	NA	39.99	9.82	30.20	0.04	NA
S-5	12/10/1996	270,000	8,800	29,000	5,200	37,000	<2,500	NA	NA	NA	NA	NA	39.99	9.10	30.91	0.03	NA
S-5 (D)	12/10/1996	400,000	9,200	32,000	7,200	50,000	<2,500	NA	NA	NA	NA	NA	39.99	9.10	30.91	0.03	NA
S-5	2/20/1997	88,000	2,000	11,000	1,600	19,000	<500	NA	NA	NA	NA	NA	39.99	8.93	31.06	NA	5
S-5	5/22/1997	NA	NA	NA	NA	NA	NA	NA	NA	NA	NA	NA	39.99	10.07	29.94	0.02	NA
S-5	8/22/1997	NA	NA	NA	NA	NA	NA	NA	NA	NA	NA	NA	39.99	10.24	29.77	0.02	NA
S-5	11/3/1997	NA	NA	NA	NA	NA	NA	NA	NA	NA	NA	NA	39.99	10.91	29.10	0.02	NA
S-5	2/20/1998	NA	NA	NA	NA	NA	NA	NA	NA	NA	NA	NA	39.99	7.81	32.20	0.03	NA
S-5	5/18/1998	NA	NA	NA	NA	NA	NA	NA	NA	NA	NA	NA	39.99	9.64	30.37	0.02	NA
S-5	5/31/2001	NA	NA	NA	NA	NA	NA	NA	NA	NA	NA	NA	39.99	10.13	29.86	NA	NA
S-6	5/13/1991	13,000	600	140	210	310	NA	NA	NA	NA	NA	NA	40.12	7.82	32.30	NA	NA
S-6	8/23/1991	9,800	480	80	120	150	NA	NA	NA	NA	NA	NA	40.12	9.58	30.54	NA	NA
S-6	11/7/1991	6,200	240	23	25	27	NA	NA	NA	NA	NA	NA	40.12	10.86	29.26	NA	NA
S-6	1/28/1992	5,600	250	15	41	36	NA	NA	NA	NA	NA	NA	40.12	8.97	31.15	NA	NA
S-6	5/6/1992	7,100	330	29	110	210	NA	NA	NA	NA	NA	NA	40.12	8.27	31.85	NA	NA
S-6	8/26/1992	13,000	240	<50	56	780	NA	NA	NA	NA	NA	NA	40.12	9.57	31.55	NA	NA

**WELL CONCENTRATIONS**  
**Shell-branded Service Station**  
**999 San Pablo Avenue**  
**Albany, CA**

Well ID	Date	TPPH (ug/L)	B (ug/L)	T (ug/L)	E (ug/L)	X (ug/L)	MTBE 8020 (ug/L)	MTBE 8260 (ug/L)	DIPE (ug/L)	ETBE (ug/L)	TAME (ug/L)	TBA (ug/L)	TOC (MSL)	Depth to Water (ft.)	GW Elevation (MSL)	SPH Thickness (ft.)	DO Reading (ppm)
S-6	10/28/1992	10,000	470	210	67	170	NA	NA	NA	NA	NA	NA	40.12	8.90	32.22	NA	NA
S-6	1/19/1993	4,800	100	26	27	45	NA	NA	NA	NA	NA	NA	40.12	4.84	35.28	NA	NA
S-6	4/29/1993	7,000	430	20	<12.5	42	NA	NA	NA	NA	NA	NA	40.12	5.61	34.51	NA	NA
S-6	7/22/1993	5,800	260	120	65	150	NA	NA	NA	NA	NA	NA	40.12	6.56	33.56	NA	NA
S-6	10/21/1993	5,500	270	69	120	140	NA	NA	NA	NA	NA	NA	40.12	8.73	31.39	NA	NA
S-6	1/4/1994	7,100	180	58	63	62	NA	NA	NA	NA	NA	NA	40.12	7.14	32.98	NA	NA
S-6	4/13/1994	NA	NA	NA	NA	NA	NA	NA	NA	NA	NA	NA	40.12	7.21	32.91	NA	NA
S-6	7/25/1994	12,000	190	52	30	39	NA	NA	NA	NA	NA	NA	40.12	6.85	33.27	NA	NA
S-6 (D)	7/25/1994	7,200	170	32	31	34	NA	NA	NA	NA	NA	NA	40.12	6.85	33.27	NA	NA
S-6	10/10/1994	NA	NA	NA	NA	NA	NA	NA	NA	NA	NA	NA	40.12	6.20	33.92	NA	NA
S-6	1/26/1995	5,800	120	23	24	44	NA	NA	NA	NA	NA	NA	40.12	4.89	35.23	NA	NA
S-6	4/21/1995	NA	NA	NA	NA	NA	NA	NA	NA	NA	NA	NA	40.12	5.61	34.51	NA	NA
S-6	7/28/1995	4,400	210	23	34	60	NA	NA	NA	NA	NA	NA	40.12	5.30	34.82	NA	3
S-6 (D)	7/28/1995	6,100	230	20	38	59	NA	NA	NA	NA	NA	NA	40.12	5.30	34.82	NA	3
S-6	10/31/1995	NA	NA	NA	NA	NA	NA	NA	NA	NA	NA	NA	40.12	4.98	35.14	NA	NA
S-6	1/10/1996	6,800	170	87	35	105	NA	NA	NA	NA	NA	NA	40.12	5.67	34.45	NA	2.2
S-6 (D)	1/10/1996	7,800	230	120	50	210	NA	NA	NA	NA	NA	NA	40.12	5.67	34.45	NA	2.2
S-6	4/25/1996	NA	NA	NA	NA	NA	NA	NA	NA	NA	NA	NA	40.12	5.23	34.89	NA	NA
S-6	7/23/1996	2,600	170	<0.5	<0.5	8.5	<25	NA	NA	NA	NA	NA	40.12	5.40	34.72	NA	1.4
S-6	12/10/1996	NA	NA	NA	NA	NA	NA	NA	NA	NA	NA	NA	40.12	6.68	33.44	NA	0.7
S-6	2/20/1997	6,300	160	7.7	14	31	77	NA	NA	NA	NA	NA	40.12	5.70	34.42	NA	2
S-6	5/22/1997	NA	NA	NA	NA	NA	NA	NA	NA	NA	NA	NA	40.12	5.49	34.63	NA	0.9
S-6	8/22/1997	6,200	160	26	15	27	49	NA	NA	NA	NA	NA	40.12	5.71	34.41	NA	2.8
S-6	11/3/1997	NA	NA	NA	NA	NA	NA	NA	NA	NA	NA	NA	40.12	6.15	33.97	NA	1.4
S-6	2/20/1998	4,100	150	<10	<10	15	55	NA	NA	NA	NA	NA	40.12	5.25	34.87	NA	0.4
S-6	5/18/1998	NA	NA	NA	NA	NA	NA	NA	NA	NA	NA	NA	40.12	5.69	34.43	NA	0.4
S-6	8/20/1998	7,800	240	38	16	39	110	NA	NA	NA	NA	NA	40.12	6.04	34.08	NA	1.5
S-6 (D) b	8/20/1998	8,400	270	30	19	31	130	NA	NA	NA	NA	NA	40.12	6.04	34.08	NA	1.5

**WELL CONCENTRATIONS**  
**Shell-branded Service Station**  
**999 San Pablo Avenue**  
**Albany, CA**

Well ID	Date	TPPH (ug/L)	B (ug/L)	T (ug/L)	E (ug/L)	X (ug/L)	MTBE 8020 (ug/L)	MTBE 8260 (ug/L)	DIPE (ug/L)	ETBE (ug/L)	TAME (ug/L)	TBA (ug/L)	TOC (MSL)	Depth to Water (ft.)	GW Elevation (MSL)	SPH Thickness (ft.)	DO Reading (ppm)
S-6	11/6/1998	NA	NA	NA	NA	NA	NA	NA	NA	NA	NA	NA	40.12	6.10	34.02	NA	NA
S-6	2/16/1999	6,000	190	19	14	20	<2.5	NA	NA	NA	NA	NA	40.12	5.84	34.28	NA	1.7
S-6	5/28/1999	NA	NA	NA	NA	NA	NA	NA	NA	NA	NA	NA	40.12	9.51	30.61	NA	1.9
S-6	8/24/1999	6,870	193	32.1	18.8	36.4	<25.0	NA	NA	NA	NA	NA	40.12	8.29	31.83	NA	2.7
S-6	11/16/1999	NA	NA	NA	NA	NA	NA	NA	NA	NA	NA	NA	40.12	5.93	34.19	NA	2.6
S-6	2/2/2000	2,310	164	122	28.6	133	63.1	NA	NA	NA	NA	NA	40.12	5.33	34.79	NA	2.6
S-6	5/9/2000	NA	NA	NA	NA	NA	NA	NA	NA	NA	NA	NA	40.12	6.41	33.71	NA	2.4
S-6	8/3/2000	5,600	188	27.4	<10.0	25.2	174	NA	NA	NA	NA	NA	40.12	5.84	34.28	NA	2.7
S-6	11/15/2000	NA	NA	NA	NA	NA	NA	NA	NA	NA	NA	NA	40.12	5.58	34.54	NA	2.3
S-6	2/14/2001	6,140	126	13.2	8.01	18.0	205	NA	NA	NA	NA	NA	40.12	5.50	34.62	NA	1.3
S-6	5/31/2001	NA	NA	NA	NA	NA	NA	NA	NA	NA	NA	NA	40.12	5.52	34.60	NA	1.2
S-6	8/15/2001	6,000	160	9.1	5.8	24	NA	51	NA	NA	NA	NA	40.12	6.04	34.08	NA	0.4
S-6	12/31/2001	6,900	120	12	6.6	24	NA	44	NA	NA	NA	NA	40.12	5.52	34.60	NA	0.4
S-6	2/6/2002	4,300	110	7.3	4.8	18	NA	39	NA	NA	NA	NA	40.12	6.34	33.78	NA	0.5
S-6	6/4/2002	4,300	140	8.4	4.9	22	NA	26	NA	NA	NA	NA	40.12	6.19	33.93	NA	0.4
S-6	7/25/2002	3,900	140	9.0	5.5	23	NA	31	NA	NA	NA	NA	39.92	6.05	33.87	NA	0.7
S-6	11/27/2002	5,200	160	9.6	4.9	24	NA	26	NA	NA	NA	NA	39.92	6.26	33.66	NA	NA
S-6	1/30/2003	4,700	200	9.6	5.5	25	NA	30	NA	NA	NA	NA	39.92	5.73	34.19	NA	NA
S-6	6/3/2003	3,900	160	10	<10	25	NA	30	NA	NA	NA	NA	39.92	5.52	34.40	NA	NA
S-6	8/8/2003	2,900	150	8.8	3.6	18	NA	18	NA	NA	NA	NA	39.92	6.14	33.78	NA	NA
S-6	11/13/2003	8,300	220	19	11	35	NA	28	NA	NA	NA	NA	39.92	5.85	34.07	NA	NA
S-6	2/4/2004	7,400	310	17	10	31	NA	30	NA	NA	NA	NA	39.92	5.51	34.41	NA	NA
S-6	5/12/2004	4,000	230	10	5.5	24	NA	21	NA	NA	NA	NA	39.92	6.10	33.82	NA	NA
S-6	8/23/2004	6,000	260	16	9.0	32	NA	19	NA	NA	NA	NA	39.92	6.38	33.54	NA	NA
S-6	12/1/2004	9,600	280	23	11	47	NA	24	NA	NA	NA	NA	39.92	6.41	33.51	NA	NA
S-6	2/7/2005	7,100	300	14	8.4	35	NA	21	NA	NA	NA	NA	39.92	5.94	33.98	NA	NA
S-6	5/2/2005	6,100	250	12	8.1	30	NA	16	NA	NA	NA	NA	39.92	5.90	34.02	NA	NA
S-6	8/4/2005	5,200	180	13	8.0	31	NA	15	NA	NA	NA	NA	39.92	6.67	33.25	NA	NA

**WELL CONCENTRATIONS**  
**Shell-branded Service Station**  
**999 San Pablo Avenue**  
**Albany, CA**

Well ID	Date	TPPH (ug/L)	B (ug/L)	T (ug/L)	E (ug/L)	X (ug/L)	MTBE 8020 (ug/L)	MTBE 8260 (ug/L)	DIPE (ug/L)	ETBE (ug/L)	TAME (ug/L)	TBA (ug/L)	TOC (MSL)	Depth to Water (ft.)	GW Elevation (MSL)	SPH Thickness (ft.)	DO Reading (ppm)
S-6	11/16/2005	9,950	147	15.3	9.82	32.3	NA	10.8	NA	NA	NA	NA	39.92	6.64	33.28	NA	NA
S-6	3/2/2006	2,400	72	9.2	7.0	21	NA	6.4	NA	NA	NA	NA	39.92	5.92	34.00	NA	NA
S-6	5/31/2006	9,460	182	13.6	8.80	33.5	NA	11.4 i	NA	NA	NA	NA	39.92	6.28	33.64	NA	NA
S-6	8/29/2006	8,840	108	26.6	12.4	37.7	NA	10.1	NA	NA	NA	NA	39.92	7.19	32.73	NA	NA
S-6	12/6/2006	4,900	130	17	8.2	35	NA	9.4	NA	NA	NA	NA	39.92	7.06	32.86	NA	NA
S-6	1/30/2007	4,500	100	22	12	38	NA	8.1	NA	NA	NA	NA	39.92	6.94	32.98	NA	NA
S-6	5/15/2007	6,900 j	120	9.2	6.7	27.6	NA	6.4	NA	NA	NA	NA	39.92	6.30	33.62	NA	NA
S-6	8/29/2007	9,300 j	110	30	14	52	NA	6.4	5.3 l	<10	<10	<50	39.92	7.27	32.65	NA	NA
S-6	11/29/2007	4,300 j	110	19 m	14	53	NA	8.7	NA	NA	NA	NA	39.92	6.87	33.05	NA	NA
S-6	2/21/2008	5,600 j	110	8.6	5.0	28.3	NA	6.4	NA	NA	NA	NA	39.92	5.75	34.17	NA	NA
S-6	5/6/2008	5,900	110	12	7.5	30.1	NA	<1.0	NA	NA	NA	NA	39.92	6.60	33.32	NA	NA
S-6	8/27/2008	6,200	58	15	7.0	27.9	NA	<2.0	NA	NA	NA	NA	39.92	7.40	32.52	NA	NA
<b>S-6</b>	<b>11/24/2008</b>	<b>6,100</b>	<b>80</b>	<b>20</b>	<b>12</b>	<b>40.0</b>	<b>NA</b>	<b>&lt;2.0</b>	<b>NA</b>	<b>NA</b>	<b>NA</b>	<b>NA</b>	<b>39.92</b>	<b>7.30</b>	<b>32.62</b>	<b>NA</b>	<b>NA</b>

S-7	5/13/1991	<50	<0.5	<0.5	<0.5	<0.5	NA	NA	NA	NA	NA	NA	40.10	10.56	29.54	NA	NA
S-7	8/23/1991	<50	<0.5	<0.5	<0.5	<0.5	NA	NA	NA	NA	NA	NA	40.10	11.16	28.94	NA	NA
S-7	11/7/1991	<50	<0.5	<0.5	<0.5	<0.5	NA	NA	NA	NA	NA	NA	40.10	11.48	28.62	NA	NA
S-7	1/28/1992	<50	<0.5	<0.5	<0.5	<0.5	NA	NA	NA	NA	NA	NA	40.10	10.72	29.38	NA	NA
S-7	5/6/1992	<50	<0.5	<0.5	<0.5	<0.5	NA	NA	NA	NA	NA	NA	40.10	10.34	29.76	NA	NA
S-7	8/26/1992	160	<0.5	<0.5	<0.5	<0.5	NA	NA	NA	NA	NA	NA	40.10	11.13	28.97	NA	NA
S-7	10/28/1992	<50	<0.5	<0.5	<0.5	<0.5	NA	NA	NA	NA	NA	NA	40.10	11.52	28.58	NA	NA
S-7	1/19/1993	50	1.1	0.6	1.9	9.2	NA	NA	NA	NA	NA	NA	40.10	8.68	31.42	NA	NA
S-7	4/29/1993	<50	<0.5	<0.5	<0.5	<0.5	NA	NA	NA	NA	NA	NA	40.10	9.90	30.20	NA	NA
S-7	7/22/1993	Well inaccessible		NA	NA	NA	NA	NA	NA	NA	NA	NA	40.10	NA	NA	NA	NA
S-7	10/21/1993	<50	<0.5	<0.5	<0.5	<0.5	NA	NA	NA	NA	NA	NA	40.10	11.10	29.00	NA	NA
S-7	1/4/1994	<50	<0.5	<0.5	<0.5	<0.5	NA	NA	NA	NA	NA	NA	40.10	10.40	29.70	NA	NA
S-7	4/13/1994	<50	1.4	0.61	<0.5	0.64	NA	NA	NA	NA	NA	NA	40.10	10.20	29.90	NA	NA
S-7 (D)	4/13/1994	<50	1.4	0.61	<0.5	0.66	NA	NA	NA	NA	NA	NA	40.10	10.20	29.90	NA	NA

**WELL CONCENTRATIONS**  
**Shell-branded Service Station**  
**999 San Pablo Avenue**  
**Albany, CA**

Well ID	Date	TPPH (ug/L)	B (ug/L)	T (ug/L)	E (ug/L)	X (ug/L)	MTBE 8020 (ug/L)	MTBE 8260 (ug/L)	DIPE (ug/L)	ETBE (ug/L)	TAME (ug/L)	TBA (ug/L)	TOC (MSL)	Depth to Water (ft.)	GW Elevation (MSL)	SPH Thickness (ft.)	DO Reading (ppm)
S-7	7/25/1994	<50	<0.5	<0.5	<0.5	<0.5	NA	NA	NA	NA	NA	NA	40.10	10.48	29.62	NA	NA
S-7 a	10/10/1994	<50	<0.5	<0.5	<0.5	<0.5	NA	NA	NA	NA	NA	NA	40.10	10.64	29.46	NA	NA
S-7	1/26/1995	<50	<0.5	<0.5	<0.5	<0.5	NA	NA	NA	NA	NA	NA	40.10	7.75	32.35	NA	4.6
S-7	4/21/1995	<50	<0.5	<0.5	<0.5	<0.5	NA	NA	NA	NA	NA	NA	40.10	8.51	31.59	NA	NA
S-7	7/28/1995	<50	<0.5	<0.5	<0.5	<0.5	NA	NA	NA	NA	NA	NA	40.10	10.20	29.90	NA	3
S-7	10/31/1995	<50	<0.5	<0.5	<0.5	<0.5	NA	NA	NA	NA	NA	NA	40.10	10.86	29.24	NA	4.9
S-7	1/10/1996	<50	<0.5	2	<0.5	2.6	NA	NA	NA	NA	NA	NA	40.10	10.33	29.77	NA	7.6
S-7	4/25/1996	<50	<0.5	<0.5	<0.5	<0.5	<2.5	NA	NA	NA	NA	NA	40.10	9.13	30.97	NA	6.2
S-7	7/23/1996	<50	<0.5	<0.5	<0.5	<0.5	14	NA	NA	NA	NA	NA	40.10	10.18	29.92	NA	3.7
S-7	12/10/1996	<50	<0.5	<0.5	<0.5	<0.5	<2.5	NA	NA	NA	NA	NA	40.10	9.04	31.06	NA	4.6
S-7	2/20/1997	<50	<0.50	<0.50	<0.50	<0.50	<2.5	NA	NA	NA	NA	NA	40.10	9.60	30.50	NA	5
S-7	5/22/1997	<50	1.3	<0.50	<0.50	<0.50	5.5	NA	NA	NA	NA	NA	40.10	10.63	29.47	NA	0.8
S-7	8/22/1997	<50	<0.50	<0.50	<0.50	<0.50	<2.5	NA	NA	NA	NA	NA	40.10	10.95	29.15	NA	2.6
S-7	11/3/1997	<50	2.2	1.7	0.58	3.4	<2.5	NA	NA	NA	NA	NA	40.10	11.29	28.81	NA	2.6
S-7	2/20/1998	350	23	13	14	42	3.8	NA	NA	NA	NA	NA	40.10	7.73	32.37	NA	4.6
S-7	5/18/1998	<50	<0.50	<0.50	<0.50	<0.50	<2.5	NA	NA	NA	NA	NA	40.10	10.29	29.81	NA	4.4
S-7	8/20/1998	Well inaccessible		NA	NA	NA	NA	NA	NA	NA	NA	NA	40.10	11.00	29.10	NA	5.4
S-7	11/6/1998	<50	<0.50	<0.50	<0.50	<0.50	<2.5	NA	NA	NA	NA	NA	40.10	11.19	28.91	NA	5.2
S-7	2/16/1999	Well inaccessible		NA	NA	NA	NA	NA	NA	NA	NA	NA	40.10	NA	NA	NA	NA
S-7	5/28/1999	<50.0	<0.500	<0.500	<0.500	<0.500	<5.00	NA	NA	NA	NA	NA	40.10	9.76	30.34	NA	2.7
S-7	8/24/1999	<50.0	<0.500	<0.500	<0.500	<0.500	<2.50	NA	NA	NA	NA	NA	40.10	10.61	29.49	NA	2.1
S-7	11/16/1999	<50.0	<0.500	<0.500	<0.500	<0.500	3.68	NA	NA	NA	NA	NA	40.10	10.90	29.20	NA	2.3
S-7	2/2/2000	<50.0	<0.500	<0.500	<0.500	<0.500	<5.00	NA	NA	NA	NA	NA	40.10	10.30	29.80	NA	2.1
S-7	5/9/2000	<50.0	<0.500	<0.500	<0.500	<0.500	<2.50	NA	NA	NA	NA	NA	40.10	10.25	29.85	NA	2.7
S-7	8/3/2000	<50.0	<0.500	<0.500	<0.500	<0.500	<2.50	NA	NA	NA	NA	NA	40.10	10.65	29.45	NA	2.5
S-7	11/15/2000	<50.0	<0.500	<0.500	<0.500	<0.500	<2.50	NA	NA	NA	NA	NA	40.10	10.53	29.57	NA	4.6
S-7	2/14/2001	Well inaccessible		NA	NA	NA	NA	NA	NA	NA	NA	NA	40.10	NA	NA	NA	NA
S-7	5/31/2001	<50	<0.50	<0.50	<0.50	0.77	NA	4.6	NA	NA	NA	NA	40.10	9.46	30.64	NA	2.1

**WELL CONCENTRATIONS**  
**Shell-branded Service Station**  
**999 San Pablo Avenue**  
**Albany, CA**

Well ID	Date	TPPH (ug/L)	B (ug/L)	T (ug/L)	E (ug/L)	X (ug/L)	MTBE 8020 (ug/L)	MTBE 8260 (ug/L)	DIPE (ug/L)	ETBE (ug/L)	TAME (ug/L)	TBA (ug/L)	TOC (MSL)	Depth to Water (ft.)	GW Elevation (MSL)	SPH Thickness (ft.)	DO Reading (ppm)
S-7	8/15/2001	<50	<0.50	<0.50	<0.50	<0.50	NA	<5.0	NA	NA	NA	NA	40.10	10.93	29.17	NA	2.0
S-7	12/31/2001	<50	<0.50	<0.50	<0.50	<0.50	NA	6.0	NA	NA	NA	NA	40.10	9.14	30.96	NA	3.0
S-7	2/6/2002	<50	<0.50	<0.50	<0.50	<0.50	NA	<5.0	NA	NA	NA	NA	40.10	8.61	31.49	NA	3.2
S-7	6/4/2002	<50	<0.50	<0.50	<0.50	<0.50	NA	<5.0	NA	NA	NA	NA	40.10	10.41	29.69	NA	0.9
S-7	7/25/2002	<50	<0.50	<0.50	<0.50	<0.50	NA	<5.0	NA	NA	NA	NA	39.91	10.37	29.54	NA	1.1
S-7	11/27/2002	<50	<0.50	<0.50	<0.50	<0.50	NA	<5.0	NA	NA	NA	NA	39.91	10.52	29.39	NA	NA
S-7	1/30/2003	<50	<0.50	<0.50	<0.50	<0.50	NA	<5.0	NA	NA	NA	NA	39.91	9.38	30.53	NA	NA
S-7	6/3/2003	<50	<0.50	<0.50	<0.50	<1.0	NA	0.72	NA	NA	NA	NA	39.91	10.18	29.73	NA	NA
S-7	8/8/2003	<50	<0.50	<0.50	<0.50	<1.0	NA	<0.50	NA	NA	NA	NA	39.91	10.43	29.48	NA	NA
S-7	11/13/2003	<50	<0.50	<0.50	<0.50	<1.0	NA	<0.50	NA	NA	NA	NA	39.91	10.39	29.52	NA	NA
S-7	2/4/2004	<50	<0.50	<0.50	<0.50	<1.0	NA	<0.50	NA	NA	NA	NA	39.91	9.17	30.74	NA	NA
S-7	5/12/2004	<50	<0.50	<0.50	<0.50	<1.0	NA	<0.50	NA	NA	NA	NA	39.91	10.20	29.71	NA	NA
S-7	8/23/2004	<50	<0.50	<0.50	<0.50	<1.0	NA	<0.50	NA	NA	NA	NA	39.72 f	10.53	29.19	NA	NA
S-7	12/1/2004	<50	<0.50	<0.50	<0.50	<1.0	NA	<0.50	NA	NA	NA	NA	39.72	10.36	29.36	NA	NA
S-7	2/7/2005	<50	<0.50	<0.50	<0.50	<1.0	NA	<0.50	NA	NA	NA	NA	39.72	8.78	30.94	NA	NA
S-7	5/2/2005	<50	<0.50	<0.50	<0.50	<1.0	NA	<0.50	NA	NA	NA	NA	39.72	9.46	30.26	NA	NA
S-7	8/4/2005	Well paved over		NA	NA	NA	NA	NA	NA	NA	NA	NA	NA	NA	NA	NA	NA
S-7	11/16/2005	Well paved over		NA	NA	NA	NA	NA	NA	NA	NA	NA	NA	NA	NA	NA	NA
S-7	3/2/2006	Well paved over		NA	NA	NA	NA	NA	NA	NA	NA	NA	NA	NA	NA	NA	NA
S-7	5/31/2006	Well paved over		NA	NA	NA	NA	NA	NA	NA	NA	NA	NA	NA	NA	NA	NA
S-7	8/29/2006	Well paved over		NA	NA	NA	NA	NA	NA	NA	NA	NA	NA	NA	NA	NA	NA
S-7	12/6/2006	Well paved over		NA	NA	NA	NA	NA	NA	NA	NA	NA	NA	NA	NA	NA	NA
S-7	1/30/2007	Well paved over		NA	NA	NA	NA	NA	NA	NA	NA	NA	NA	NA	NA	NA	NA
S-7	5/15/2007	Well paved over		NA	NA	NA	NA	NA	NA	NA	NA	NA	NA	NA	NA	NA	NA
S-7	8/29/2007	Well paved over		NA	NA	NA	NA	NA	NA	NA	NA	NA	NA	NA	NA	NA	NA
S-7	11/29/2007	Well paved over		NA	NA	NA	NA	NA	NA	NA	NA	NA	NA	NA	NA	NA	NA
S-7	2/21/2008	Well paved over		NA	NA	NA	NA	NA	NA	NA	NA	NA	NA	NA	NA	NA	NA
S-7	5/6/2008	Well paved over		NA	NA	NA	NA	NA	NA	NA	NA	NA	NA	NA	NA	NA	NA

**WELL CONCENTRATIONS**  
**Shell-branded Service Station**  
**999 San Pablo Avenue**  
**Albany, CA**

Well ID	Date	TPPH (ug/L)	B (ug/L)	T (ug/L)	E (ug/L)	X (ug/L)	MTBE 8020 (ug/L)	MTBE 8260 (ug/L)	DIPE (ug/L)	ETBE (ug/L)	TAME (ug/L)	TBA (ug/L)	TOC (MSL)	Depth to Water (ft.)	GW Elevation (MSL)	SPH Thickness (ft.)	DO Reading (ppm)
---------	------	----------------	-------------	-------------	-------------	-------------	------------------------	------------------------	----------------	----------------	----------------	---------------	--------------	----------------------------	--------------------------	---------------------------	------------------------

S-7	8/27/2008	Well paved over	NA	NA	NA	NA	NA	NA	NA	NA	NA	NA	NA	NA	NA	NA	NA
<b>S-7</b>	<b>11/24/2008</b>	<b>Well paved over</b>	<b>NA</b>	<b>NA</b>	<b>NA</b>	<b>NA</b>	<b>NA</b>	<b>NA</b>	<b>NA</b>	<b>NA</b>	<b>NA</b>	<b>NA</b>	<b>NA</b>	<b>NA</b>	<b>NA</b>	<b>NA</b>	<b>NA</b>

S-8	5/10/2004	NA	NA	NA	NA	NA	NA	NA	NA	NA	NA	NA	40.52	10.85	29.67	NA	NA
S-8	5/12/2004	<1,300	<13	<13	<13	<25	NA	2,500	NA	NA	NA	NA	40.52	10.95	29.57	NA	NA
S-8	8/23/2004	1,300	15	<13	<13	<25	NA	2,500	<50	<50	<50	570	40.52	11.40	29.12	NA	NA
S-8	12/1/2004	1,400 h	<13	<13	<13	<25	NA	2,700	NA	NA	NA	NA	40.52	11.10	29.42	NA	NA
S-8	2/7/2005	6,400	240	27	290	100	NA	370	NA	NA	NA	NA	40.52	10.22	30.30	NA	NA
S-8	5/2/2005	6,300	160	25	200	74	NA	190	NA	NA	NA	NA	40.52	10.05	30.47	NA	NA
S-8	8/4/2005	2,500	130	7.5	<6.0	14	NA	290	<8.0	<8.0	<8.0	92	40.52	10.88	29.64	NA	NA
S-8	11/16/2005	27,700	43.2	4.36	637	1,200	NA	638	NA	NA	NA	NA	40.52	11.28	29.24	NA	NA
S-8	3/2/2006	9,900	160	13	490	530	NA	110	NA	NA	NA	NA	40.52	8.85	31.67	NA	NA
S-8	5/31/2006	14,300	270	53.1	283	246	NA	102 i	NA	NA	NA	NA	40.52	10.34	30.18	NA	NA
S-8	8/29/2006	14,700	107	9.42	196	195	NA	278	<0.500	<0.500	<0.500	36.1	40.52	11.17	29.35	NA	NA
S-8	12/6/2006	7,800	150	8.6	120	110	NA	200	NA	NA	NA	NA	40.52	11.21	29.31	NA	NA
S-8	1/30/2007	7,500	220	18	180	96	NA	170	NA	NA	NA	NA	40.52	10.72	29.80	NA	NA
S-8	5/15/2007	9,600 j	NA	24	160	112	NA	130	NA	NA	NA	NA	40.52	10.50	30.02	NA	NA
S-8	8/29/2007	NA	NA	NA	NA	NA	NA	NA	NA	NA	NA	NA	40.52	11.44	29.11	0.04	NA
S-8	8/30/2007	6,100 j	35	2.7	140	234	NA	170	<4.0	<4.0	<4.0	820	40.52	11.37	29.25	0.13	NA
S-8	9/25/2007	NA	NA	NA	NA	NA	NA	NA	NA	NA	NA	NA	40.52	11.56	29.22	0.32	NA
S-8	10/29/2007	NA	NA	NA	NA	NA	NA	NA	NA	NA	NA	NA	40.52	11.23	29.50	0.26	NA
S-8	11/29/2007	NA	NA	NA	NA	NA	NA	NA	NA	NA	NA	NA	40.52	11.08	29.60	0.20	NA
S-8	12/11/2007	NA	NA	NA	NA	NA	NA	NA	NA	NA	NA	NA	40.52	10.61	30.03	0.15	NA
S-8	1/24/2008	NA	NA	NA	NA	NA	NA	NA	NA	NA	NA	NA	40.52	9.61	30.97	0.08	NA
S-8	2/21/2008	NA	NA	NA	NA	NA	NA	NA	NA	NA	NA	NA	40.52	9.11	31.43	0.03	NA
S-8	3/20/2008	NA	NA	NA	NA	NA	NA	NA	NA	NA	NA	NA	40.52	10.22	30.40	0.12	NA
S-8	4/30/2008	NA	NA	NA	NA	NA	NA	NA	NA	NA	NA	NA	40.52	10.91	29.67	0.07	NA
S-8	5/6/2008	NA	NA	NA	NA	NA	NA	NA	NA	NA	NA	NA	40.52	10.50	30.05	0.04	NA



**WELL CONCENTRATIONS**  
**Shell-branded Service Station**  
**999 San Pablo Avenue**  
**Albany, CA**

Well ID	Date	TPPH (ug/L)	B (ug/L)	T (ug/L)	E (ug/L)	X (ug/L)	MTBE 8020 (ug/L)	MTBE 8260 (ug/L)	DIPE (ug/L)	ETBE (ug/L)	TAME (ug/L)	TBA (ug/L)	TOC (MSL)	Depth to Water (ft.)	GW Elevation (MSL)	SPH Thickness (ft.)	DO Reading (ppm)
S-8	6/4/2008	NA	NA	NA	NA	NA	NA	NA	NA	NA	NA	NA	40.52	11.34	29.24	0.07	NA
S-8	7/29/2008	NA	NA	NA	NA	NA	NA	NA	NA	NA	NA	NA	40.52	11.83	28.71	0.03	NA
S-8	8/27/2008	NA	NA	NA	NA	NA	NA	NA	NA	NA	NA	NA	40.52	11.40	29.14	0.03	NA
S-8	9/30/2008	NA	NA	NA	NA	NA	NA	NA	NA	NA	NA	NA	40.52	12.08	28.46	0.03	NA
S-8	10/31/2008	NA	NA	NA	NA	NA	NA	NA	NA	NA	NA	NA	40.52	11.35	29.37	0.25	NA
S-8	11/24/2008	NA	NA	NA	NA	NA	NA	NA	NA	NA	NA	NA	40.52	10.79	29.89	0.20	NA
S-9	5/10/2004	NA	NA	NA	NA	NA	NA	NA	NA	NA	NA	NA	39.72	10.34	29.38	NA	NA
S-9	5/12/2004	<50	<0.50	<0.50	<0.50	<1.0	NA	<0.50	NA	NA	NA	NA	39.72	10.42	29.30	NA	NA
S-9	8/23/2004	<50	<0.50	<0.50	<0.50	<1.0	NA	<0.50	NA	NA	NA	NA	39.72	11.32	28.40	NA	NA
S-9	12/1/2004	Unable to locate		NA	NA	NA	NA	NA	NA	NA	NA	NA	39.72	NA	NA	NA	NA
S-9	2/7/2005	<50	<0.50	<0.50	<0.50	<1.0	NA	<0.50	NA	NA	NA	NA	39.72	8.74	30.98	NA	NA
S-9	5/2/2005	Well inaccessible		NA	NA	NA	NA	NA	NA	NA	NA	NA	39.72	NA	NA	NA	NA
S-9	8/4/2005	<50	<0.50	<0.50	<0.50	<1.0	NA	<0.50	NA	NA	NA	NA	39.72	8.79	30.93	NA	NA
S-9	11/16/2005	<50.0	<0.500	<0.500	<0.500	<0.500	NA	<0.500	NA	NA	NA	NA	39.72	10.30	29.42	NA	NA
S-9	3/2/2006	<50	<0.50	<0.50	<0.50	<0.50	NA	<0.50	NA	NA	NA	NA	39.72	5.86	33.86	NA	NA
S-9	5/31/2006	<50.0	<0.500	<0.500	<0.500	0.540	NA	<0.500	NA	NA	NA	NA	39.72	9.85	29.87	NA	NA
S-9	8/29/2006	<50.0	<0.500	<0.500	<0.500	<0.500	NA	<0.500	NA	NA	NA	NA	39.72	10.75	28.97	NA	NA
S-9	12/6/2006	<50	<0.50	<0.50	<0.50	<1.0	NA	<0.50	NA	NA	NA	NA	39.72	10.60	29.12	NA	NA
S-9	1/30/2007	<50	<0.50	<0.50	<0.50	<1.0	NA	<0.50	NA	NA	NA	NA	39.72	10.45	29.27	NA	NA
S-9	5/15/2007	61 j,k	<0.50	<1.0	<1.0	<1.0	NA	<1.0	NA	NA	NA	NA	39.72	10.15	29.57	NA	NA
S-9	8/29/2007	71 j	<0.50	<1.0	1.3	2.1	NA	<1.0	<2.0	<2.0	<2.0	<10	39.72	10.96	28.76	NA	NA
S-9	11/29/2007	Well inaccessible		NA	NA	NA	NA	NA	NA	NA	NA	NA	39.72	NA	NA	NA	NA
S-9	2/21/2008	<50 j	<0.50	<1.0	<1.0	<1.0	NA	<1.0	NA	NA	NA	NA	39.72	7.36	32.36	NA	NA
S-9	5/6/2008	<50	<0.50	<1.0	<1.0	<1.0	NA	<1.0	NA	NA	NA	NA	39.72	10.49	29.23	NA	NA
S-9	8/27/2008	<50	<0.50	<1.0	<1.0	<1.0	NA	<1.0	NA	NA	NA	NA	39.72	11.19	28.53	NA	NA
S-9	11/24/2008	<50	<0.50	<1.0	<1.0	<1.0	NA	<1.0	NA	NA	NA	NA	39.72	10.91	28.81	NA	NA

**WELL CONCENTRATIONS**  
**Shell-branded Service Station**  
**999 San Pablo Avenue**  
**Albany, CA**

Well ID	Date	TPPH (ug/L)	B (ug/L)	T (ug/L)	E (ug/L)	X (ug/L)	MTBE 8020 (ug/L)	MTBE 8260 (ug/L)	DIPE (ug/L)	ETBE (ug/L)	TAME (ug/L)	TBA (ug/L)	TOC (MSL)	Depth to Water (ft.)	GW Elevation (MSL)	SPH Thickness (ft.)	DO Reading (ppm)
---------	------	----------------	-------------	-------------	-------------	-------------	------------------------	------------------------	----------------	----------------	----------------	---------------	--------------	----------------------------	--------------------------	---------------------------	------------------------

**WELL CONCENTRATIONS**  
**Shell-branded Service Station**  
**999 San Pablo Avenue**  
**Albany, CA**

<b>Well ID</b>	<b>Date</b>	<b>TPPH</b> (ug/L)	<b>B</b> (ug/L)	<b>T</b> (ug/L)	<b>E</b> (ug/L)	<b>X</b> (ug/L)	<b>MTBE</b> <b>8020</b> (ug/L)	<b>MTBE</b> <b>8260</b> (ug/L)	<b>DIPE</b> (ug/L)	<b>ETBE</b> (ug/L)	<b>TAME</b> (ug/L)	<b>TBA</b> (ug/L)	<b>TOC</b> (MSL)	<b>Depth to</b> <b>Water</b> (ft.)	<b>GW</b> <b>Elevation</b> (MSL)	<b>SPH</b> <b>Thickness</b> (ft.)	<b>DO</b> <b>Reading</b> (ppm)
----------------	-------------	-----------------------	--------------------	--------------------	--------------------	--------------------	--------------------------------------	--------------------------------------	-----------------------	-----------------------	-----------------------	----------------------	---------------------	--	--	---	--------------------------------------

Abbreviations:

TPPH = Total petroleum hydrocarbons as gasoline by EPA Method 8260B; prior to May 31, 2001, analyzed by EPA Method 8015.

BTEX = Benzene, toluene, ethylbenzene, xylenes by EPA Method 8260B; prior to May 31, 2001, analyzed by EPA Method 8020.

MTBE = Methyl tertiary butyl ether

DIPE = Di-isopropyl ether, analyzed by EPA Method 8260B

ETBE = Ethyl tertiary butyl ether, analyzed by EPA Method 8260B

TAME = Tertiary amyl methyl ether, analyzed by EPA Method 8260B

TBA = Tertiary butyl alcohol, analyzed by EPA Method 8260B

TOC = Top of Casing Elevation

TOB = Top of Wellbox Elevation

SPH = Separate-Phase Hydrocarbons

GW = Groundwater

DO = Dissolved Oxygen

ug/L = Parts per billion

mg/L = Parts per million

MSL = Mean sea level

ft. = Feet

ppm = Parts per million

<n = Below detection limit

(D) = Duplicate sample

NA = Not applicable

**WELL CONCENTRATIONS**  
**Shell-branded Service Station**  
**999 San Pablo Avenue**  
**Albany, CA**

Well ID	Date	TPPH (ug/L)	B (ug/L)	T (ug/L)	E (ug/L)	X (ug/L)	MTBE 8020 (ug/L)	MTBE 8260 (ug/L)	DIPE (ug/L)	ETBE (ug/L)	TAME (ug/L)	TBA (ug/L)	TOC (MSL)	Depth to Water (ft.)	GW Elevation (MSL)	SPH Thickness (ft.)	DO Reading (ppm)
---------	------	----------------	-------------	-------------	-------------	-------------	------------------------	------------------------	----------------	----------------	----------------	---------------	--------------	----------------------------	--------------------------	---------------------------	------------------------

Notes:

a = Sample analyzed for total dissolved solids (450 mg/L).

b = Surrogate recovery outside QC limits due to matrix effect.

c = Chromatogram pattern indicated an unidentified hydrocarbon.

d = This sample analyzed outside of EPA recommended hold time.

e = Concentration is an estimate value above the linear quantitation range.

f = Top of casing elevation lowered 0.19 feet on June 22, 2004 due to wellhead maintenance.

g = Hydrocarbon reported does not match the laboratory standard.

h = Quantity of unknown hydrocarbon(s) in sample based on gasoline.

i = Secondary ion abundances were outside method requirements. Identification based on analytical judgement.

j = Analyzed by EPA Method 8015B (M).

k = The sample chromatographic pattern for TPH does not match the chromatographic pattern of the specified standard. Quantitation of the unknown hydrocarbon(s) in the sample was based upon the specified standard.

l = Analyte was detected at a concentration below the reporting limit and above the laboratory method detection limit. Reported value is estimated.

m = Analyte was present in the associated method blank.

When separate-phase hydrocarbons are present, ground water elevation is adjusted using the relation:

Corrected ground water elevation = Top-of-casing elevation - depth to water + (0.8 x hydrocarbon thickness).

Ownership of well S-5 is being transferred to Arco.

Beginning July 25, 2002 depth to waters referenced to Top of Casing.

Site surveyed January 9, 2002 by Virgil Chavez Land Surveying of Vallejo, CA.

Wells S-8 and S-9 surveyed May 11, 2004 by Virgil Chavez Land Surveying of Vallejo, CA.

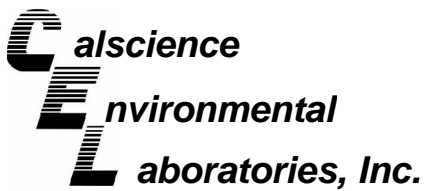

December 04, 2008

Michael Ninokata  
Blaine Tech Services, Inc.  
1680 Rogers Avenue  
San Jose, CA 95112-1105

Subject: **CalScience Work Order No.: 08-11-2368**  
**Client Reference: 999 San Pablo Ave., Albany, CA**

Dear Client:

Enclosed is an analytical report for the above-referenced project. The samples included in this report were received 11/26/2008 and analyzed in accordance with the attached chain-of-custody.

Unless otherwise noted, all analytical testing was accomplished in accordance with the guidelines established in our Quality Systems Manual, applicable standard operating procedures, and other related documentation. The original report of subcontracted analysis, if any, is provided herein, and follows the standard CalScience data package. The results in this analytical report are limited to the samples tested and any reproduction thereof must be made in its entirety.

If you have any questions regarding this report, please do not hesitate to contact the undersigned.

Sincerely,

A handwritten signature in black ink, appearing to read "Jessie Kim". The signature is fluid and cursive, with a large loop at the end.

CalScience Environmental  
Laboratories, Inc.  
Jessie Kim  
Project Manager

## Analytical Report



Blaine Tech Services, Inc.  
1680 Rogers Avenue  
San Jose, CA 95112-1105

Date Received: 11/26/08  
Work Order No: 08-11-2368  
Preparation: EPA 5030B  
Method: LUFT GC/MS / EPA 8260B  
Units: ug/L

Project: 999 San Pablo Ave., Albany, CA

Page 1 of 2

Client Sample Number	Lab Sample Number	Date/Time Collected	Matrix	Instrument	Date Prepared	Date/Time Analyzed	QC Batch ID
S-2	08-11-2368-1-A	11/24/08 14:00	Aqueous	GC/MS R	12/02/08	12/02/08 16:39	081202L01

Parameter	Result	RL	DF	Qual	Parameter	Result	RL	DF	Qual
Benzene	55	2.5	5		o-Xylene	ND	5.0	5	
Ethylbenzene	9.3	5.0	5		Methyl-t-Butyl Ether (MTBE)	210	5.0	5	
Toluene	ND	5.0	5		TPPH	7100	250	5	
p/m-Xylene	ND	5.0	5						
Surrogates:	REC (%)	Control Limits		Qual	Surrogates:	REC (%)	Control Limits		Qual
Dibromofluoromethane	94	74-140			1,2-Dichloroethane-d4	88	74-146		
Toluene-d8	98	88-112			Toluene-d8-TPPH	98	88-112		
1,4-Bromofluorobenzene	92	74-110							

Client Sample Number	Lab Sample Number	Date/Time Collected	Matrix	Instrument	Date Prepared	Date/Time Analyzed	QC Batch ID
S-3	08-11-2368-2-A	11/24/08 13:07	Aqueous	GC/MS R	12/02/08	12/02/08 17:08	081202L01

Parameter	Result	RL	DF	Qual	Parameter	Result	RL	DF	Qual
Benzene	1.5	0.50	1		o-Xylene	ND	1.0	1	
Ethylbenzene	ND	1.0	1		Methyl-t-Butyl Ether (MTBE)	ND	1.0	1	
Toluene	ND	1.0	1		TPPH	2900	50	1	
p/m-Xylene	2.2	1.0	1						
Surrogates:	REC (%)	Control Limits		Qual	Surrogates:	REC (%)	Control Limits		Qual
Dibromofluoromethane	93	74-140			1,2-Dichloroethane-d4	87	74-146		
Toluene-d8	101	88-112			Toluene-d8-TPPH	101	88-112		
1,4-Bromofluorobenzene	95	74-110							

Client Sample Number	Lab Sample Number	Date/Time Collected	Matrix	Instrument	Date Prepared	Date/Time Analyzed	QC Batch ID
S-6	08-11-2368-3-A	11/24/08 10:05	Aqueous	GC/MS R	12/02/08	12/02/08 17:37	081202L01

Parameter	Result	RL	DF	Qual	Parameter	Result	RL	DF	Qual
Benzene	80	1.0	2		o-Xylene	9.0	2.0	2	
Ethylbenzene	12	2.0	2		Methyl-t-Butyl Ether (MTBE)	ND	2.0	2	
Toluene	20	2.0	2		TPPH	6100	100	2	
p/m-Xylene	31	2.0	2						
Surrogates:	REC (%)	Control Limits		Qual	Surrogates:	REC (%)	Control Limits		Qual
Dibromofluoromethane	95	74-140			1,2-Dichloroethane-d4	86	74-146		
Toluene-d8	99	88-112			Toluene-d8-TPPH	99	88-112		
1,4-Bromofluorobenzene	94	74-110							

RL - Reporting Limit , DF - Dilution Factor , Qual - Qualifiers

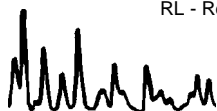

## Analytical Report



Blaine Tech Services, Inc.  
1680 Rogers Avenue  
San Jose, CA 95112-1105

Date Received: 11/26/08  
Work Order No: 08-11-2368  
Preparation: EPA 5030B  
Method: LUFT GC/MS / EPA 8260B  
Units: ug/L

Project: 999 San Pablo Ave., Albany, CA

Page 2 of 2

Client Sample Number	Lab Sample Number	Date/Time Collected	Matrix	Instrument	Date Prepared	Date/Time Analyzed	QC Batch ID
S-9	08-11-2368-4-A	11/24/08 10:37	Aqueous	GC/MS R	12/02/08	12/02/08 14:14	081202L01

Parameter	Result	RL	DF	Qual	Parameter	Result	RL	DF	Qual
Benzene	ND	0.50	1		o-Xylene	ND	1.0	1	
Ethylbenzene	ND	1.0	1		Methyl-t-Butyl Ether (MTBE)	ND	1.0	1	
Toluene	ND	1.0	1		TPPH	ND	50	1	
p/m-Xylene	ND	1.0	1						
Surrogates:	REC (%)	Control Limits		Qual	Surrogates:	REC (%)	Control Limits		Qual
Dibromofluoromethane	93	74-140			1,2-Dichloroethane-d4	89	74-146		
Toluene-d8	96	88-112			Toluene-d8-TPPH	96	88-112		
1,4-Bromofluorobenzene	89	74-110							

Method Blank	Lab Sample Number	Date/Time Collected	Matrix	Instrument	Date Prepared	Date/Time Analyzed	QC Batch ID
Method Blank	099-12-767-519	N/A	Aqueous	GC/MS R	12/02/08	12/02/08 13:45	081202L01

Parameter	Result	RL	DF	Qual	Parameter	Result	RL	DF	Qual
Benzene	ND	0.50	1		o-Xylene	ND	1.0	1	
Ethylbenzene	ND	1.0	1		Methyl-t-Butyl Ether (MTBE)	ND	1.0	1	
Toluene	ND	1.0	1		TPPH	ND	50	1	
p/m-Xylene	ND	1.0	1						
Surrogates:	REC (%)	Control Limits		Qual	Surrogates:	REC (%)	Control Limits		Qual
Dibromofluoromethane	96	74-140			1,2-Dichloroethane-d4	88	74-146		
Toluene-d8	97	88-112			Toluene-d8-TPPH	97	88-112		
1,4-Bromofluorobenzene	89	74-110							

RL - Reporting Limit , DF - Dilution Factor , Qual - Qualifiers

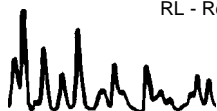



## Quality Control - Spike/Spike Duplicate



Blaine Tech Services, Inc.  
1680 Rogers Avenue  
San Jose, CA 95112-1105

Date Received: 11/26/08  
Work Order No: 08-11-2368  
Preparation: EPA 5030B  
Method: LUFT GC/MS / EPA  
8260B

Project 999 San Pablo Ave., Albany, CA

Quality Control Sample ID	Matrix	Instrument	Date Prepared	Date Analyzed	MS/MSD Batch Number
S-9	Aqueous	GC/MS R	12/02/08	12/02/08	081202S01

Parameter	MS %REC	MSD %REC	%REC CL	RPD	RPD CL	Qualifiers
Benzene	95	100	88-118	5	0-7	
Carbon Tetrachloride	90	96	67-145	6	0-11	
Chlorobenzene	101	105	88-118	5	0-7	
1,2-Dibromoethane	97	102	70-130	5	0-30	
1,2-Dichlorobenzene	97	102	86-116	4	0-8	
1,1-Dichloroethene	98	104	70-130	6	0-25	
Ethylbenzene	99	104	70-130	5	0-30	
Toluene	99	103	87-123	4	0-8	
Trichloroethene	97	102	79-127	5	0-10	
Vinyl Chloride	93	103	69-129	10	0-13	
Methyl-t-Butyl Ether (MTBE)	85	87	71-131	2	0-13	
Tert-Butyl Alcohol (TBA)	83	81	36-168	3	0-45	
Diisopropyl Ether (DIPE)	85	90	81-123	5	0-9	
Ethyl-t-Butyl Ether (ETBE)	80	84	72-126	5	0-12	
Tert-Amyl-Methyl Ether (TAME)	84	88	72-126	5	0-12	
Ethanol	88	95	53-149	7	0-31	

RPD - Relative Percent Difference , CL - Control Limit

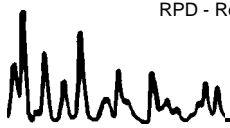





## Quality Control - LCS/LCS Duplicate



Blaine Tech Services, Inc.  
1680 Rogers Avenue  
San Jose, CA 95112-1105

Date Received: N/A  
Work Order No: 08-11-2368  
Preparation: EPA 5030B  
Method: LUFT GC/MS / EPA 8260B

Project: 999 San Pablo Ave., Albany, CA

Quality Control Sample ID	Matrix	Instrument	Date Prepared	Date Analyzed	LCS/LCSD Batch Number		
099-12-767-519	Aqueous	GC/MS R	12/02/08	12/02/08	081202L01		
Parameter	LCS %REC	LCSD %REC	%REC CL	ME CL	RPD	RPD CL	Qualifiers
Benzene	98	101	84-120	78-126	3	0-8	
Carbon Tetrachloride	92	98	63-147	49-161	6	0-10	
Chlorobenzene	101	106	89-119	84-124	5	0-7	
1,2-Dibromoethane	93	98	80-120	73-127	5	0-20	
1,2-Dichlorobenzene	99	102	89-119	84-124	3	0-9	
1,1-Dichloroethene	102	104	77-125	69-133	1	0-16	
Ethylbenzene	100	105	80-120	73-127	4	0-20	
Toluene	102	105	83-125	76-132	3	0-9	
Trichloroethene	102	103	89-119	84-124	2	0-8	
Vinyl Chloride	101	104	63-135	51-147	4	0-13	
Methyl-t-Butyl Ether (MTBE)	83	87	82-118	76-124	5	0-13	
Tert-Butyl Alcohol (TBA)	90	95	46-154	28-172	6	0-32	
Diisopropyl Ether (DIPE)	84	87	81-123	74-130	3	0-11	
Ethyl-t-Butyl Ether (ETBE)	79	82	74-122	66-130	4	0-12	
Tert-Amyl-Methyl Ether (TAME)	83	86	76-124	68-132	3	0-10	
Ethanol	94	102	60-138	47-151	8	0-32	
TPPH	86	91	65-135	53-147	6	0-30	

Total number of LCS compounds : 17

Total number of ME compounds : 0

Total number of ME compounds allowed : 1

LCS ME CL validation result : Pass

RPD - Relative Percent Difference , CL - Control Limit

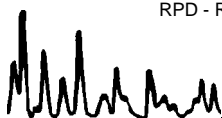

Work Order Number: 08-11-2368

<u>Qualifier</u>	<u>Definition</u>
*	See applicable analysis comment.
1	Surrogate compound recovery was out of control due to a required sample dilution, therefore, the sample data was reported without further clarification.
2	Surrogate compound recovery was out of control due to matrix interference. The associated method blank surrogate spike compound was in control and, therefore, the sample data was reported without further clarification.
3	Recovery of the Matrix Spike (MS) or Matrix Spike Duplicate (MSD) compound was out of control due to matrix interference. The associated LCS and/or LCSD was in control and, therefore, the sample data was reported without further clarification.
4	The MS/MSD RPD was out of control due to matrix interference. The LCS/LCSD RPD was in control and, therefore, the sample data was reported without further clarification.
5	The PDS/PDSD associated with this batch of samples was out of control due to a matrix interference effect. The associated batch LCS/LCSD was in control and, hence, the associated sample data was reported with no further corrective action required.
A	Result is the average of all dilutions, as defined by the method.
B	Analyte was present in the associated method blank.
C	Analyte presence was not confirmed on primary column.
E	Concentration exceeds the calibration range.
H	Sample received and/or analyzed past the recommended holding time.
J	Analyte was detected at a concentration below the reporting limit and above the laboratory method detection limit. Reported value is estimated.
ME	LCS Recovery Percentage is within LCS ME Control Limit range.
N	Nontarget Analyte.
ND	Parameter not detected at the indicated reporting limit.
Q	Spike recovery and RPD control limits do not apply resulting from the parameter concentration in the sample exceeding the spike concentration by a factor of four or greater.
U	Undetected at the laboratory method detection limit.
X	% Recovery and/or RPD out-of-range.
Z	Analyte presence was not confirmed by second column or GC/MS analysis.



LAB (LOCATION)

- CALSCIENCE ( \_\_\_\_\_ )
- SPL ( \_\_\_\_\_ )
- XENCO ( \_\_\_\_\_ )
- TEST AMERICA ( \_\_\_\_\_ )
- OTHER ( \_\_\_\_\_ )



# Shell Oil Products Chain Of Custody Record

**Please Check Appropriate Box:**

<input checked="" type="checkbox"/> ENV. SERVICES	<input type="checkbox"/> MOTIVA RETAIL	<input type="checkbox"/> SHELL RETAIL
<input type="checkbox"/> MOTIVA SD&CM	<input type="checkbox"/> CONSULTANT	<input type="checkbox"/> LUBES
<input type="checkbox"/> SHELL PIPELINE	<input type="checkbox"/> OTHER _____	

**Print Bill To Contact Name:** Denis Brown

**INCIDENT # (ENV SERVICES):** 9 8 9 9 5 1 4 3

**PO #** \_\_\_\_\_ **SAP #** \_\_\_\_\_

CHECK IF NO INCIDENT # APPLIES

DATE: 11/24/08

PAGE: 1 of 1

**SAMPLING COMPANY:** Blaine Tech Services

**LOG CODE:** BTSS

**ADDRESS:** 1680 Rogers Ave, San Jose, CA 95112

**PROJECT CONTACT (Hardcopy or PDF Report to):** Michael Ninokata

**TELEPHONE:** (408)573-0555 **FAX:** (408)573-7771 **E-MAIL:** mninokata@blainetech.com

**TURNAROUND TIME (CALENDAR DAYS):**

STANDARD (14 DAY)  5 DAYS  3 DAYS  2 DAYS  24 HOURS  RESULTS NEEDED ON WEEKEND

LA - RWQCB REPORT FORMAT  UST AGENCY:

**SITE ADDRESS: Street and City:** 999 San Pablo Ave., Albany

**State:** CA **GLOBAL ID NO.:** T0600101277

**EDF DELIVERABLE TO (Name, Company, Office Location):** Dennis Baertshi, CRA, Eureka Office

**PHONE NO.:** 707-268-3813 **E-MAIL:** sonomaedf@craworld.com

**CONSULTANT PROJECT NO.:** 081124-1M7

**BTS #** \_\_\_\_\_

**SAMPLER NAME(S) (Print):** J. PARKER, M. TODI

**LAB USE ONLY:** 08-11-2368

**SPECIAL INSTRUCTIONS OR NOTES :**

Run TPH-d w/Silica Gel Clean Up

SHELL CONTRACT RATE APPLIES

STATE REIMBURSEMENT RATE APPLIES

EDD NOT NEEDED

RECEIPT VERIFICATION REQUESTED

LAB USE ONLY	Field Sample Identification	SAMPLING		MATRIX	PRESERVATIVE					NO. OF CONT.	REQUESTED ANALYSIS													TEMPERATURE ON RECEIPT °C	Container PID Readings or Laboratory Notes			
		DATE	TIME		HCL	HNO3	H2SO4	NONE	OTHER		TPH - Purgeable (8260B)	TPH - Extractable (8015M)	BTEX (8260B)	5 Oxygenates (8260B)	MTBE (8260B)	TBA (8260B)	DIPE (8260B)	TAME (8260B)	ETBE (8260B)	1,2 DCA (8260B)	EDB (8260B)	Ethanol (8260B)	Methanol (8015M)					
	S-2	11/24	1400	W	X						3	X	X	X														
	S-3	11/24	1307	W	X						3	X	X	X														
	S-6	11/24	1005	W	X						3	X	X	X														
	S-9	11/24	1037	W	X						3	X	X	X														

Relinquished by (Signature): <i>[Signature]</i>	Received by (Signature): <i>[Signature]</i> (SAMPLE CUSTODIAN)	Date: 11/24/08	Time: 1535
Relinquished by (Signature): <i>[Signature]</i>	Received by (Signature): Tom O'Reilly CEL	Date: 11/25/08	Time: 1504
Relinquished by (Signature): <i>[Signature]</i>	Received by (Signature): <i>[Signature]</i>	Date: 11/26/08	Time: 1100

510810958

05/2006 Revision

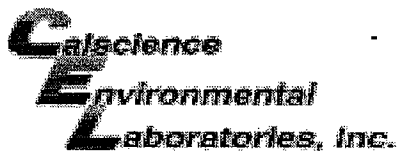

WORK ORDER #: 08-11-2368

**SAMPLE RECEIPT FORM**

Cooler 1 of 1

CLIENT: BTS

DATE: 11/26/08

**TEMPERATURE:** (Criteria: 0.0 °C – 6.0 °C, not frozen)

Temperature 2.1 °C - 0.2 °C (CF) = 1.9 °C     Blank     Sample

Sample(s) outside temperature criteria (PM/APM contacted by: \_\_\_\_\_).

Sample(s) outside temperature criteria but received on ice/chilled on same day of sampling.

Received at ambient temperature, placed on ice for transport by Courier.

Ambient Temperature:     Air     Filter     Metals Only     PCBs Only    Initial: NC

**CUSTODY SEALS INTACT:**

Cooler     \_\_\_\_\_     No (Not Intact)     Not Present     N/A    Initial: NZ

Sample     \_\_\_\_\_     No (Not Intact)     Not Present    Initial: RN

SAMPLE CONDITION:	Yes	No	N/A
Chain-Of-Custody document(s) received with samples.....	<input checked="" type="checkbox"/>	<input type="checkbox"/>	<input type="checkbox"/>
COC document(s) received complete.....	<input checked="" type="checkbox"/>	<input type="checkbox"/>	<input type="checkbox"/>
Sampler's name indicated on COC.....	<input checked="" type="checkbox"/>	<input type="checkbox"/>	<input type="checkbox"/>
Sample container label(s) consistent with COC.....	<input checked="" type="checkbox"/>	<input type="checkbox"/>	<input type="checkbox"/>
Sample container(s) intact and good condition.....	<input checked="" type="checkbox"/>	<input type="checkbox"/>	<input type="checkbox"/>
Correct containers and volume for analyses requested.....	<input checked="" type="checkbox"/>	<input type="checkbox"/>	<input type="checkbox"/>
Analyses received within holding time.....	<input checked="" type="checkbox"/>	<input type="checkbox"/>	<input type="checkbox"/>
Proper preservation noted on sample label(s).....	<input checked="" type="checkbox"/>	<input type="checkbox"/>	<input type="checkbox"/>
Volatile analysis container(s) free of headspace.....	<input checked="" type="checkbox"/>	<input type="checkbox"/>	<input type="checkbox"/>
Tedlar bag(s) free of condensation.....	<input type="checkbox"/>	<input type="checkbox"/>	<input checked="" type="checkbox"/>

**CONTAINER TYPE:**

**Solid:**     4ozCGJ     8ozCGJ     16ozCGJ     Sleeve     EnCores®     TerraCores®     \_\_\_\_\_

**Water:**     VOA     VOA<sup>3</sup>h     VOAna<sub>2</sub>     125AGB     125AGBh     125AGBpo<sub>4</sub>     1AGB     1AGBna<sub>2</sub>

1AGBs     500AGB     500AGBs     250CGB     250CGBs     1PB     500PB     500PBna     250PB

250PBn     125PB     125PBz<sub>2</sub>na     100PBsterile     100PBna<sub>2</sub>     \_\_\_\_\_     \_\_\_\_\_     \_\_\_\_\_

**Air:**     Tedlar®     Summa®     \_\_\_\_\_

Container:    C:Clear    A:Amber    P:Poly/Plastic    G:Glass    J:Jar    B:Bottle

Preservative:    h:HCL    n:HNO<sub>3</sub>    na<sub>2</sub>:Na<sub>2</sub>S<sub>2</sub>O<sub>3</sub>    na:NaOH    po<sub>4</sub>:H<sub>3</sub>PO<sub>4</sub>    s:H<sub>2</sub>SO<sub>4</sub>    z<sub>2</sub>na:ZnAc<sub>2</sub>+NaOH

Checked/Labeled by: RN

Reviewed by: LSC

Scanned by: RN

# SHELL WELLHEAD INSPECTION FORM

## (FOR SAMPLE TECHNICIAN)

Site Address 999 SAN PABLO AVE, ALBANY Date 11/24/08

Job Number 081124-MT1 Technician MT Page 1 of 1

Well ID	Well Inspected - No Corrective Action Required	Well Box Meets Compliance Requirements *See Below	Water Bailed From Wellbox	Cap Replaced	Lock Replaced	Well Not Inspected (explain in notes)	New Deficiency Identified	Previously Identified Deficiency Persists	Notes
S-2	X	X							
S-3	X	X							4100/2 3800/1
S-6	X	X							4300/9
S-7	<del>X</del>	<del>X</del>							PAVED OVER
S-8	X	X		X					N/A
S-9	X	X							N/A
St1	X	X							N/A
S-4	X	X							N/A

\*Well box must meet all three criteria to be compliant: 1) WELL IS SECURABLE BY DESIGN (12" or less) 2) WELL IS MARKED WITH THE WORDS "MONITORING WELL" (12" or less) 3) WELL TAG IS PRESENT, SECURE, AND CORRECT

Notes: \_\_\_\_\_

# WELL GAUGING DATA

Project # 081124-MT1 Date 11/24/08 Client SHELL

Site 999 SAN PABLO, ALBANY

Well ID	Time	Well Size (in.)	Sheen / Odor	Depth to Immiscible Liquid (ft.)	Thickness of Immiscible Liquid (ft.)	Volume of Immiscibles Removed (ml)	Depth to water (ft.)	Depth to well bottom (ft.)	Survey Point: TOB or <u>TOC</u>	Notes
S-2	0916	3					8.43	11.75		6
S-3	0913	3				8.71	11.88	5		
S-6	0951	3				7.30	14.64	7		
S-7	PAVED OVER									
S-8	855	4		10.59	.20	492	10.79	←		1
S-9	1023	2					10.91	15.90		2
S-1	0904	3					08.49	11.35		3
S-4	0943	3					7.73	13.61	✖	4

.20 x well multiplier x 3785 = ml or SPH

## SHELL WELL MONITORING DATA SHEET

BTS #: 081124-MT1	Site: 999 SAN PABLO
Sampler: JP	Date: 11/24/08
Well I.D.: S-1	Well Diameter: 2 (3) 4 6 8 _____
Total Well Depth (TD):	Depth to Water (DTW): 08.49
Depth to Free Product:	Thickness of Free Product (feet):
Referenced to: (PVC) Grade	D.O. Meter (if req'd): (YSI) HACH
DTW with 80% Recharge [(Height of Water Column x 0.20) + DTW]:	

Purge Method: Bailer Disposable Bailer Positive Air Displacement Electric Submersible	Water: Peristaltic Extraction Pump Other _____	Sampling Method: Bailer Disposable Bailer Extraction Port Dedicated Tubing Other: _____
--	--	---

_____ (Gals.) X _____	= _____ Gals.
1 Case Volume	Specified Volumes      Calculated Volume

Well Diameter	Multiplier	Well Diameter	Multiplier
1"	0.04	4"	0.65
2"	0.16	6"	1.47
3"	0.37	Other	radius <sup>2</sup> * 0.163

Time	Temp (°F)	pH	Cond. (mS or µS)	Turbidity (NTUs)	Gals. Removed	Observations
						PRE-PURGE DO ONLY

Did well dewater? Yes No	Gallons actually evacuated: _____
Sampling Date: _____	Sampling Time: _____
Sample I.D.: _____	Laboratory: STL Other _____
Analyzed for: TPH-G BTEX MTBE TPH-D Other: _____	
EB I.D. (if applicable): _____ @ _____ Time	Duplicate I.D. (if applicable): _____
Analyzed for: TPH-G BTEX MTBE TPH-D Other: _____	
D.O. (if req'd): Pre-purge: 0.06 mg/L	Post-purge: _____ mg/L
O.R.P. (if req'd): Pre-purge: _____ mV	Post-purge: _____ mV

## SHELL WELL MONITORING DATA SHEET

BTS #: 081124-MT1	Site: 999 SAN PABLO
Sampler: JP	Date: 11/24/08
Well I.D.: S-9	Well Diameter: (2) 3 4 6 8 _____
Total Well Depth (TD): 15.90	Depth to Water (DTW): 10.91
Depth to Free Product:	Thickness of Free Product (feet):
Referenced to: (PVC) Grade	D.O. Meter (if req'd): YSI HACH
DTW with 80% Recharge [(Height of Water Column x 0.20) + DTW]: TRAFFIK	

Purge Method:  Bailer Waterra Sampling Method:  Bailer  
 Disposable Bailer Peristaltic Disposable Bailer  
 Positive Air Displacement Extraction Pump Extraction Port  
 Electric Submersible Other \_\_\_\_\_ Dedicated Tubing

Other: \_\_\_\_\_

.8	(Gals.) X	3	=	2.4	Gals.
1 Case Volume		Specified Volumes		Calculated Volume	

Well Diameter	Multiplier	Well Diameter	Multiplier
1"	0.04	4"	0.65
2"	0.16	6"	1.47
3"	0.37	Other	radius <sup>2</sup> * 0.163

Time	Temp (°F)	pH	Cond. (mS or <del>AS</del> )	Turbidity (NTUs)	Gals. Removed	Observations
1027	65.6	7.7	643.9	143	.8	
1029	66.4	6.59	644.0	946	1.6	
1032	66.2	6.22	651.3	666	2.4	
1034	66.4	6.21	654.9	735	3.2	

Did well dewater? Yes  No  Gallons actually evacuated: 3.2

Sampling Date: 11/24      Sampling Time: 1037      Depth to Water: TRAFFIK

Sample I.D.: S-9      Laboratory: STL      Other: CAL SCIENCE

Analyzed for: TPH-G BTEX MTBE TPH-D      Other: SEE COL

EB I.D. (if applicable): @ Time      Duplicate I.D. (if applicable):

Analyzed for: TPH-G BTEX MTBE TPH-D      Other:

D.O. (if req'd):	Pre-purge:	mg/L	Post-purge:	mg/L
O.R.P. (if req'd):	Pre-purge:	mV	Post-purge:	mV



## SHELL WELL MONITORING DATA SHEET

BTS #: 081124-MT1	Site: 9919 SAN PABLO
Sampler: JP	Date: 11/24
Well I.D.: 5-6	Well Diameter: 2 (3) 4 6 8
Total Well Depth (TD): 14.64	Depth to Water (DTW): 7.30
Depth to Free Product:	Thickness of Free Product (feet):
Referenced to: <span style="border: 1px solid black; border-radius: 50%; padding: 2px;">PVC</span> Grade	D.O. Meter (if req'd): YSI HACH
DTW with 80% Recharge [(Height of Water Column x 0.20) + DTW]: TRAFFIC	

Purge Method: Bailer	Water: Watterra	Sampling Method: X Bailer
Disposable Bailer	Peristaltic	Disposable Bailer
Positive Air Displacement	Extraction Pump	Extraction Port
X Electric Submersible	Other _____	Dedicated Tubing

Other: \_\_\_\_\_

2.7 (Gals.)	X 3 Specified Volumes	= 8.15 Gals. Calculated Volume
-------------	-----------------------	--------------------------------

Well Diameter	Multiplier	Well Diameter	Multiplier
1"	0.04	4"	0.65
2"	0.16	6"	1.47
3"	0.37	Other	radius <sup>2</sup> * 0.163

Time	Temp (°F)	pH	Cond. (mS or µS)	Turbidity (NTUs)	Gals. Removed	Observations
0957	61.1	6.87	1254	>1000	2.7	
0957		WELL DEWATERED @		3.5 GAL		
1005	61.8	6.85	1300	>1000		

Did well dewater? <span style="border: 1px solid black; border-radius: 50%; padding: 2px;">Yes</span> No	Gallons actually evacuated: 3.5
Sampling Date: 11/24/08	Sampling Time: 1005
Depth to Water: TRAFFIC	
Sample I.D.: 5-6	Laboratory: STL Other: CARBENCE
Analyzed for: TPH-G BTEX MTBE TPH-D	Other: SEE COE
EB I.D. (if applicable): @ Time	Duplicate I.D. (if applicable):
Analyzed for: TPH-G BTEX MTBE TPH-D	Other:
D.O. (if req'd): Pre-purge:	mg/L Post-purge: mg/L
O.R.P. (if req'd): Pre-purge:	mV Post-purge: mV

## SHELL WELL MONITORING DATA SHEET

BTS #: <u>081124-MT1</u>	Site: <u>999 SAN J PABLO</u>
Sampler: <u>JP, MT</u>	Date: <u>11/24/08</u>
Well I.D.: <u>S-3</u>	Well Diameter: 2 <b>(3)</b> 4 6 8 <u>    </u>
Total Well Depth (TD): <u>118.8</u>	Depth to Water (DTW): <u>8.71</u>
Depth to Free Product:	Thickness of Free Product (feet):
Referenced to: <u>PVC</u> Grade	D.O. Meter (if req'd): <u>YSI</u> HACH
DTW with 80% Recharge [(Height of Water Column x 0.20) + DTW]: <u>9.3</u>	

Purge Method: <input checked="" type="checkbox"/> Bailer	Waterra	Sampling Method: <input checked="" type="checkbox"/> Bailer
<input type="checkbox"/> Disposable Bailer	<input type="checkbox"/> Peristaltic	<input type="checkbox"/> Disposable Bailer
<input type="checkbox"/> Positive Air Displacement	<input type="checkbox"/> Extraction Pump	<input type="checkbox"/> Extraction Port
<input type="checkbox"/> Electric Submersible	Other: _____	<input type="checkbox"/> Dedicated Tubing

$1.17$  (Gals.) X  $3$  =  $3.5$  Gals.  
 I Case Volume      Specified Volumes      Calculated Volume

Well Diameter	Multiplier	Well Diameter	Multiplier
1"	0.04	4"	0.65
2"	0.16	6"	1.47
3"	0.37	Other	radius <sup>2</sup> * 0.163

Time	Temp (°F)	pH	Cond. (mS or $\mu$ S)	Turbidity (NTUs)	Gals. Removed	Observations
1247	68.5	6.72	565.1	49	1.2	
1250	70.2	6.47	565.9	120	2.4	
1250	*WELL DE-WATERED @			3.0 GALLONS		
1307	70.2	6.41	565.7	55	—	

Did well dewater? <b>(Yes)</b> No	Gallons actually evacuated: <u>3.0</u>
Sampling Date: <u>11/24/08</u>	Sampling Time: <u>1307</u> Depth to Water: <u>9.3</u>
Sample I.D.: <u>S-3</u>	Laboratory: <u>STL</u> Other: <u>EALSCIENCE</u>
Analyzed for: TPH-G BTEX MTBE TPH-D	Other: <u>SEE COC</u>
EB I.D. (if applicable):	@ Time Duplicate I.D. (if applicable):
Analyzed for: TPH-G BTEX MTBE TPH-D	Other:
D.O. (if req'd): Pre-purge: <u>.32</u> <small>mg/L</small>	Post-purge: <u>    </u> <small>mg/L</small>
O.R.P. (if req'd): Pre-purge: <u>    </u> <small>mV</small>	Post-purge: <u>    </u> <small>mV</small>

**Blaine Tech Services, Inc. 1680 Rogers Ave., San Jose, CA 95112 (800) 545-7558**

## SHELL WELL MONITORING DATA SHEET

BTS #: 08112d-MT1	Site: 999 SAN PABLO
Sampler: MT, JP	Date: 11/24/08
Well I.D.: S-2	Well Diameter: 2 (3) 4 6 8 _____
Total Well Depth (TD): 11.78	Depth to Water (DTW): 8.43
Depth to Free Product:	Thickness of Free Product (feet):
Referenced to: PVC Grade	D.O. Meter (if req'd): YSI HACH
DTW with 80% Recharge [(Height of Water Column x 0.20) + DTW]: 9.1	

Purge Method:  Bailer      Waterra      Sampling Method:       Bailer  
 Disposable Bailer      Peristaltic       Disposable Bailer  
 Positive Air Displacement      Extraction Pump       Extraction Port  
 Electric Submersible      Other \_\_\_\_\_       Dedicated Tubing

Other: \_\_\_\_\_

$\frac{1.2}{1 \text{ Case Volume}} \text{ (Gals.)} \times \frac{3}{\text{Specified Volumes}} = \frac{3.6}{\text{Calculated Volume}} \text{ Gals.}$	<table border="1" style="width: 100%; border-collapse: collapse; font-size: small;"> <thead> <tr> <th>Well Diameter</th> <th>Multiplier</th> <th>Well Diameter</th> <th>Multiplier</th> </tr> </thead> <tbody> <tr> <td>1"</td> <td>0.04</td> <td>4"</td> <td>0.65</td> </tr> <tr> <td>2"</td> <td>0.16</td> <td>6"</td> <td>1.47</td> </tr> <tr> <td>3"</td> <td>0.37</td> <td>Other</td> <td>radius<sup>2</sup> * 0.163</td> </tr> </tbody> </table>	Well Diameter	Multiplier	Well Diameter	Multiplier	1"	0.04	4"	0.65	2"	0.16	6"	1.47	3"	0.37	Other	radius <sup>2</sup> * 0.163
Well Diameter	Multiplier	Well Diameter	Multiplier														
1"	0.04	4"	0.65														
2"	0.16	6"	1.47														
3"	0.37	Other	radius <sup>2</sup> * 0.163														

Time	Temp (°F)	pH	Cond. (mS or $\mu$ S)	Turbidity (NTUs)	Gals. Removed	Observations
1122	66.5	6.90	908.5	3.4	1.2	
1125				1.9 GALLONS	<del>2.4</del> JP	DTW @ 11:11
1400	66.7	6.91	765.8	21.0	3.6 JP	

Did well dewater?  Yes    No      Gallons actually evacuated: 1.9

Sampling Date: 11/24/08      Sampling Time: 1400      Depth to Water: ~~11.11~~ 10.33

Sample I.D.: S-2      Laboratory: STL    Other: CAL SCIENCE

Analyzed for: TPH-G    BTEX    MTBE    TPH-D    Other: SEE COC

EB I.D. (if applicable): @ Time      Duplicate I.D. (if applicable):

Analyzed for: TPH-G    BTEX    MTBE    TPH-D    Other:

D.O. (if req'd):	Pre-purge:	0.7 mg/L	Post-purge:	mg/L
------------------	------------	----------	-------------	------

O.R.P. (if req'd):	Pre-purge:	mV	Post-purge:	mV
--------------------	------------	----	-------------	----

## SHELL WELL MONITORING DATA SHEET

BTS #: 081124-MT1	Site: 999 SAN PABLO
Sampler: SP MT	Date: 11/24/08
Well I.D.: 3-8	Well Diameter: 2 3 ④ 6 8
Total Well Depth (TD):	Depth to Water (DTW): 10.79
Depth to Free Product: 10.59	Thickness of Free Product (feet): .20
Referenced to: PVC Grade	D.O. Meter (if req'd): YSI HACH
DTW with 80% Recharge [(Height of Water Column x 0.20) + DTW]:	

Purge Method: <del>                     Bailer                      Disposable Bailer                      Positive Air Displacement                      Electric Submersible                 </del>	<del>                     Waterra                      Peristaltic                      Extraction Pump                      Other _____                 </del>	Sampling Method: <del>                     Bailer                      Disposable Bailer                      Extraction Port                      Dedicated Tubing                      Other: _____                 </del>
---	---	--

(Gals.) X	=	Gals.	
1 Case Volume	Specified Volumes	Calculated Volume	

Well Diameter	Multiplier	Well Diameter	Multiplier
1"	0.04	4"	0.65
2"	0.16	6"	1.47
3"	0.37	Other	radius <sup>2</sup> * 0.163

Time	Temp (°F)	pH	Cond. (mS or µS)	Turbidity (NTUs)	Gals. Removed	Observations
	BAILED	492 ml				

Did well dewater? Yes No	Gallons actually evacuated:
Sampling Date:	Sampling Time: Depth to Water:
Sample I.D.:	Laboratory: STL Other _____
Analyzed for: TPH-G BTEX MTBE TPH-D Other:	
EB I.D. (if applicable): @ Time	Duplicate I.D. (if applicable):
Analyzed for: TPH-G BTEX MTBE TPH-D Other:	
D.O. (if req'd): Pre-purge: <span style="float: right;">mg/L</span>	Post-purge: <span style="float: right;">mg/L</span>
O.R.P. (if req'd): Pre-purge: <span style="float: right;">mV</span>	Post-purge: <span style="float: right;">mV</span>

# SHELL WELLHEAD INSPECTION FORM

(FOR SAMPLE TECHNICIAN)

Site Address 999 San Pablo Ave Albany CA Date 10/31/08

Job Number 09031-BD1 Technician B. Decker Page 1 of 1

Well ID	Well Inspected - No Corrective Action Required	Well Box Meets Compliance Requirements *See Below	Water Bailed From Wellbox	Cap Replaced	Lock Replaced	Well Not Inspected (explain in notes)	New Deficiency Identified	Previously Identified Deficiency Persists	Notes
S-8	X	X							

\*Well box must meet all three criteria to be compliant: 1) WELL IS SECURABLE BY DESIGN (12" or less) 2) WELL IS MARKED WITH THE WORDS "MONITORING WELL" (12" or less) 3) WELL TAG IS PRESENT, SECURE, AND CORRECT

Notes: \_\_\_\_\_

# WELL GAUGING DATA

Project # 081051-BD1 Date 10/31/08 Client Shell

Site 999 San Pablo Ave Albany CA

Well ID	Time	Well Size (in.)	Sheen / Odor	Depth to Immiscible Liquid (ft.)	Thickness of Immiscible Liquid (ft.)	Volume of Immiscibles Removed (ml)	Depth to water (ft.)	Depth to well bottom (ft.)	Survey Point: TOB or <u>FOC</u>	Notes
5-B	0835	4	yes	11.10	.25		11.35	-		
					$\pi \cdot .65 \times .25 \times 3785$ <small>with thickness</small>	$\Rightarrow$				615 ml/sph

## SHELL WELL MONITORING DATA SHEET

BTS #: <u>081031-501</u>	Site: <u>98995143</u>
Sampler: <u>BD</u>	Date: <u>10/31/08</u>
Well I.D.: <u>5-8</u>	Well Diameter: 2 3 4 6 8 <u>    </u>
Total Well Depth (TD): <u>    </u>	Depth to Water (DTW): <u>11.35</u>
Depth to Free Product: <u>11.10</u>	Thickness of Free Product (feet): <u>.25</u>
Referenced to: <u>PVC</u> Grade	D.O. Meter (if req'd): YSI HACH
DTW with 80% Recharge [(Height of Water Column x 0.20) + DTW]: <u>    </u>	

Purge Method: Bailer <input checked="" type="checkbox"/> Disposable Bailer <input type="checkbox"/> Positive Air Displacement <input type="checkbox"/> Electric Submersible <input type="checkbox"/>	Water <input checked="" type="checkbox"/> Peristaltic <input type="checkbox"/> Extraction Pump <input type="checkbox"/> Other <input type="checkbox"/>	Sampling Method: Bailer <input checked="" type="checkbox"/> Disposable Bailer <input type="checkbox"/> Extraction Port <input type="checkbox"/> Dedicated Tubing <input type="checkbox"/> Other: <input type="checkbox"/>
---	---	---

$\underline{\quad\quad\quad} \text{ (Gals.) } \times \underline{\quad\quad\quad} = \underline{\quad\quad\quad} \text{ Gals.}$ 1 Case Volume                      Specified Volumes                      Calculated Volume	<table border="1" style="width: 100%; border-collapse: collapse;"> <thead> <tr> <th>Well Diameter</th> <th>Multiplier</th> <th>Well Diameter</th> <th>Multiplier</th> </tr> </thead> <tbody> <tr> <td>1"</td> <td>0.04</td> <td>4"</td> <td>0.65</td> </tr> <tr> <td>2"</td> <td>0.16</td> <td>6"</td> <td>1.47</td> </tr> <tr> <td>3"</td> <td>0.37</td> <td>Other</td> <td>radius<sup>2</sup> * 0.163</td> </tr> </tbody> </table>	Well Diameter	Multiplier	Well Diameter	Multiplier	1"	0.04	4"	0.65	2"	0.16	6"	1.47	3"	0.37	Other	radius <sup>2</sup> * 0.163
Well Diameter	Multiplier	Well Diameter	Multiplier														
1"	0.04	4"	0.65														
2"	0.16	6"	1.47														
3"	0.37	Other	radius <sup>2</sup> * 0.163														

Time	Temp (°F)	pH	Cond. (mS or µS)	Turbidity (NTUs)	Gals. Removed	Observations
<u>0845</u>	<u>    </u>	<u>    </u>	<u>    </u>	<u>    </u>	<u>    </u>	<u>sph bail, 615 ml/gal calculated</u>
<u>0905</u>	<u>    </u>	<u>    </u>	<u>    </u>	<u>    </u>	<u>    </u>	<u>stopped sph bail, bailed ~ 615 ml/sph @ 1 gal H<sub>2</sub>O</u>
						<u>DTP - 12.00                      DTW - &lt; 12.01</u>
						<u>sph thickness ⇒ &lt; .01</u>

Did well dewater? Yes <input checked="" type="checkbox"/> No <input type="checkbox"/>	Gallons actually evacuated: <u>    </u>
Sampling Date: <u>    </u>	Sampling Time: <u>    </u> Depth to Water: <u>    </u>
Sample I.D.: <u>    </u>	Laboratory: STL Other <u>    </u>
Analyzed for: TPH-G BTEX MTBE TPH-D Other: <u>    </u>	
EB I.D. (if applicable): <u>    </u> @ <u>    </u> Time	Duplicate I.D. (if applicable): <u>    </u>
Analyzed for: TPH-G BTEX MTBE TPH-D Other: <u>    </u>	
D.O. (if req'd): Pre-purge: <u>    </u> mg/L	Post-purge: <u>    </u> mg/L
O.R.P. (if req'd): Pre-purge: <u>    </u> mV	Post-purge: <u>    </u> mV

# SHELL WELLHEAD INSPECTION FORM

(FOR SAMPLE TECHNICIAN)

Site Address 999 San Pablo Ave Albany CA Date 9/30/08  
Job Number 080930-WW2 Technician WW/SD Page 1 of 1

Well ID	Well Inspected - No Corrective Action Required	Well Box Meets Compliance Requirements *See Below	Water Bailed From Wellbox	Cap Replaced	Lock Replaced	Well Not Inspected (explain in notes)	New Deficiency Identified	Previously Identified Deficiency Persists	Notes
S-8	X								

\*Well box must meet all three criteria to be compliant: 1) WELL IS SECURABLE BY DESIGN (12" or less) 2) WELL IS MARKED WITH THE WORDS "MONITORING WELL" (12" or less) 3) WELL TAG IS PRESENT, SECURE, AND CORRECT

Notes: \_\_\_\_\_



### WELL GAUGING DATA

Project # 080930-WWZ Date 9/30/08 Client Shell

Site 999 San Pablo Wc Albany CA.

Well ID	Time	Well Size (in.)	Sheen / Odor	Depth to Immiscible Liquid (ft.)	Thickness of Immiscible Liquid (ft.)	Volume of Immiscibles Removed (ml)	Depth to water (ft.)	Depth to well bottom (ft.)	Survey Point: TOB or <del>TOC</del>	Notes
S-8	1025	4	X	12.05	0.03	74	12.08	—	TJC	

## SHELL WELL MONITORING DATA SHEET

BTS #: <u>080930-ww2</u>	Site: <u>999 San Pablo Ave Albany CA</u>
Sampler: <u>ww/jd</u>	Date: <u>9/30/08</u>
Well I.D.: <u>S-8</u>	Well Diameter: 2 3 <b>(4)</b> 6 8 <u>   </u>
Total Well Depth (TD):	Depth to Water (DTW): <u>12.08</u>
Depth to Free Product: <u>12.05</u>	Thickness of Free Product (feet): <u>0.03</u>
Referenced to: <u>(PVC)</u> Grade	D.O. Meter (if req'd):            YSI            HACH
DTW with 80% Recharge [(Height of Water Column x 0.20) + DTW]:	

Purge Method: <u>Bailer</u>	Waters	Sampling Method:	Bailer
<u>Disposable Bailer</u>	Peristaltic		Disposable Bailer
Positive Air Displacement	Extraction Pump		Extraction Port
Electric Submersible	Other _____		Dedicated Tubing
		Other: _____	

SPH Bui

\_\_\_\_\_ (Gals.) X \_\_\_\_\_ = \_\_\_\_\_ Gals.  
 1 Case Volume            Specified Volumes            Calculated Volume

Well Diameter	Multiplier	Well Diameter	Multiplier
1"	0.04	4"	0.65
2"	0.16	6"	1.47
3"	0.37	Other	radius <sup>2</sup> * 0.163

Time	Temp (°F)	pH	Cond. (mS or µS)	Turbidity (NTUs)	Gals. Removed	Observations
<del>* Bui 74</del>		<del>milliliters</del>	<del>SPH</del>	<del>+ 1 Gallon H<sub>2</sub>O</del>		
<del>post thickness</del>		<del>0.01</del>				
<del>post DTW</del>			<del>12.42</del>			

Did well dewater?    Yes    No	Gallons actually evacuated:
Sampling Date:	Sampling Time:            Depth to Water:
Sample I.D.:	Laboratory:    STL    Other _____
Analyzed for:    TPH-G    BTEX    MTBE    TPH-D    Other:	
EB I.D. (if applicable):            @            Time	Duplicate I.D. (if applicable):
Analyzed for:    TPH-G    BTEX    MTBE    TPH-D    Other:	
D.O. (if req'd):    Pre-purge:	<u>   </u> mg/L            Post-purge: <u>   </u> mg/L
O.R.P. (if req'd):    Pre-purge:	<u>   </u> mV            Post-purge: <u>   </u> mV

APPENDIX B

GROUNDWATER MONITORING RESULTS FOR  
ARCO #2035 AT 1001 SAN PABLO AVE

**Table 1. Summary of Ground-Water Monitoring Data: Relative Water Elevations and Laboratory Analyses**  
**Station #2035, 1001 San Pablo Ave., Albany, CA**

Well and Sample Date	P/NP	TOC Elevation (feet msl)	Depth to Water (feet bgs)	Product Thickness (feet)	Water Level Elevation (feet msl)	Concentrations in (µg/L)						DO (mg/L)	Lab	pH	Comments
						GRO/TPHg	Benzene	Toluene	Ethyl-Benzene	Total Xylenes	MTBE				
<b>MW-1</b>															
4/11/2002	P	41.41	10.73	--	30.68	800	360	<5.0	<5.0	<5.0	<50	--	--	--	
11/27/2002	P	41.41	10.22	--	31.19	<50	<0.50	<0.50	<0.50	<0.50	1.7	1.1	--	--	
6/3/2003	--	41.41	9.14	--	32.27	1,700	430	<5.0	24	11	8.6	1.7	--	--	
11/13/2003	P	43.55	10.17	--	33.38	<50	<0.50	<0.50	<0.50	<0.50	0.95	2.3	SEQM	6.5	a
05/12/2004	P	43.55	9.28	--	34.27	120	7.2	<0.50	<0.50	<0.50	3.0	1.6	SEQM	6.0	
12/01/2004	P	43.55	9.16	--	34.39	<50	0.94	<0.50	<0.50	1.1	2.4	5.2	SEQM	6.6	
05/02/2005	P	43.55	8.58	--	34.97	1,300	390	<5.0	12	6.4	8.8	2.8	SEQM	6.5	
11/16/2005	P	43.55	9.50	--	34.05	<50	<0.50	<0.50	<0.50	0.54	0.92	1.7	SEQM	6.4	
5/31/2006	P	43.55	7.36	--	36.19	850	200	<2.5	5.4	<2.5	4.0	2.4	SEQM	6.5	
12/6/2006	P	43.55	9.91	--	33.64	<50	0.52	<0.50	<0.50	<0.50	0.72	4.50	TAMC	6.99	
5/15/2007	P	43.55	9.65	--	33.90	67	6.6	<0.50	<0.50	<0.50	1.8	2.43	TAMC	6.96	
11/29/2007	P	43.55	9.11	--	34.44	<50	<0.50	<0.50	<0.50	<0.50	0.98	4.51	TAMC	6.81	
5/6/2008	P	43.55	8.25	--	35.30	890	140	0.53	5.4	5.8	<0.50	1.89	CEL	6.61	
<b>11/24/2008</b>	<b>P</b>	<b>43.55</b>	<b>10.55</b>	<b>--</b>	<b>33.00</b>	<b>&lt;50</b>	<b>&lt;0.50</b>	<b>&lt;0.50</b>	<b>&lt;0.50</b>	<b>&lt;0.50</b>	<b>&lt;0.50</b>	<b>1.83</b>	<b>CEL</b>	<b>6.67</b>	
<b>MW-2</b>															
4/11/2002	P	40.38	11.05	--	29.33	<50	<0.50	<0.50	<0.50	<0.50	24	--	--	--	
11/27/2002	P	40.38	10.51	--	29.87	<50	<0.50	<0.50	<0.50	<0.50	5.4	2.6	--	--	
6/3/2003	--	40.38	9.78	--	30.60	<50	<0.50	<0.50	<0.50	<0.50	23	1.7	--	--	
11/13/2003	P	42.52	10.69	--	31.83	<50	<0.50	<0.50	<0.50	<0.50	9.5	2.3	SEQM	6.5	a
05/12/2004	P	42.52	10.34	--	32.18	<250	<2.5	<2.5	<2.5	<2.5	27	2.2	SEQM	6.6	
12/01/2004	P	42.52	10.28	--	32.24	<50	<0.50	<0.50	<0.50	0.70	17	3.9	SEQM	6.6	
05/02/2005	P	42.52	9.50	--	33.02	<50	<0.50	<0.50	<0.50	<0.50	25	3.1	SEQM	6.6	
11/16/2005	P	42.52	10.50	--	32.02	<50	<0.50	<0.50	<0.50	0.50	7.6	2.8	SEQM	6.4	
5/31/2006	P	42.52	10.03	--	32.49	<50	<0.50	<0.50	<0.50	<0.50	24	2.0	SEQM	6.6	
12/6/2006	P	42.52	10.28	--	32.24	<50	<0.50	<0.50	<0.50	<0.50	1.6	3.72	TAMC	6.91	
5/15/2007	P	42.52	10.00	--	32.52	<50	<0.50	<0.50	<0.50	<0.50	44	2.90	TAMC	6.69	
11/29/2007	P	42.52	10.13	--	32.39	<50	<0.50	<0.50	<0.50	<0.50	1.9	4.83	TAMC	6.89	
5/6/2008	P	42.52	9.55	--	32.97	<50	<0.50	<0.50	<0.50	<0.50	35	1.88	CEL	6.62	
<b>11/24/2008</b>	<b>P</b>	<b>42.52</b>	<b>10.70</b>	<b>--</b>	<b>31.82</b>	<b>&lt;50</b>	<b>&lt;0.50</b>	<b>&lt;0.50</b>	<b>&lt;0.50</b>	<b>&lt;0.50</b>	<b>4.3</b>	<b>1.83</b>	<b>CEL</b>	<b>6.74</b>	

**Table 1. Summary of Ground-Water Monitoring Data: Relative Water Elevations and Laboratory Analyses**  
**Station #2035, 1001 San Pablo Ave., Albany, CA**

Well and Sample Date	P/NP	TOC Elevation (feet msl)	Depth to Water (feet bgs)	Product Thickness (feet)	Water Level Elevation (feet msl)	Concentrations in (µg/L)						DO (mg/L)	Lab	pH	Comments
						GRO/TPHg	Benzene	Toluene	Ethyl-Benzene	Total Xylenes	MTBE				
<b>MW-3</b>															
4/11/2002	P	41.44	11.05	--	30.39	250	9.4	<0.50	<0.50	<0.50	120	--	--	--	
11/27/2002	P	41.44	10.49	--	30.95	<100	<1.0	<1.0	<1.0	2.5	56	2.2	--	--	
6/3/2003	--	41.44	9.44	--	32.00	130	<0.50	<0.50	<0.50	<0.50	47	4.1	--	--	
11/13/2003	P	43.62	10.68	--	32.94	53	<0.50	<0.50	<0.50	<0.50	36	3.8	SEQM	6.8	a
05/12/2004	P	43.62	9.95	--	33.67	65	<0.50	<0.50	<0.50	<0.50	39	4.2	SEQM	6.9	
12/01/2004	P	43.62	10.32	--	33.30	140	<0.50	<0.50	<0.50	<0.50	37	4.3	SEQM	6.9	
05/02/2005	P	43.62	9.12	--	34.50	140	<0.50	<0.50	<0.50	<0.50	23	3.1	SEQM	6.7	
11/16/2005	P	43.62	10.58	--	33.04	<50	<0.50	<0.50	<0.50	<0.50	32	4.1	SEQM	6.5	
5/31/2006	P	43.62	9.41	--	34.21	<50	<0.50	<0.50	<0.50	<0.50	20	4.3	SEQM	6.8	
12/6/2006	P	43.62	10.25	--	33.37	<50	<0.50	<0.50	<0.50	<0.50	20	2.71	TAMC	7.00	
5/15/2007	P	43.62	9.70	--	33.92	<50	<0.50	<0.50	<0.50	<0.50	40	5.89	TAMC	7.07	
11/29/2007	P	43.62	10.08	--	33.54	90	<0.50	<0.50	<0.50	<0.50	35	4.74	TAMC	6.61	
5/6/2008	P	43.62	10.02	--	33.60	<50	<0.50	<0.50	<0.50	<0.50	14	2.05	CEL	6.61	
<b>11/24/2008</b>	<b>P</b>	<b>43.62</b>	<b>10.80</b>	<b>--</b>	<b>32.82</b>	<b>&lt;50</b>	<b>&lt;1.0</b>	<b>&lt;1.0</b>	<b>&lt;1.0</b>	<b>&lt;1.0</b>	<b>28</b>	<b>1.98</b>	<b>CEL</b>	<b>6.77</b>	
<b>MW-4</b>															
4/11/2002	NP	40.33	10.81	--	29.52	<50	<0.50	<0.50	<0.50	<0.50	11	--	--	--	
11/27/2002	NP	40.33	10.09	--	30.24	<50	<0.50	<0.50	<0.50	<0.50	6.5	1.8	--	--	
6/3/2003	--	40.33	8.62	--	31.71	<250	<2.5	<2.5	<2.5	<2.5	120	1.1	--	--	
11/13/2003	NP	42.48	9.98	--	32.50	<50	<0.50	<0.50	<0.50	<0.50	20	1.3	SEQM	6.2	a
05/12/2004	P	42.48	9.48	--	33.00	<250	<2.5	<2.5	<2.5	<2.5	79	2.9	SEQM	6.6	
12/01/2004	NP	42.48	9.60	--	32.88	<50	<0.50	<0.50	<0.50	<0.50	1.8	1.9	SEQM	6.7	
05/02/2005	NP	42.48	8.67	--	33.81	<50	<0.50	<0.50	<0.50	<0.50	11	2.8	SEQM	6.6	
11/16/2005	NP	42.48	10.00	--	32.48	<50	<0.50	<0.50	<0.50	<0.50	0.93	1.7	SEQM	6.3	
5/31/2006	NP	42.48	8.52	--	33.96	<50	<0.50	<0.50	<0.50	<0.50	2.4	1.0	SEQM	7.0	
12/6/2006	NP	42.48	9.90	--	32.58	<50	<0.50	<0.50	<0.50	<0.50	7.8	0.85	TAMC	7.10	
5/15/2007	NP	42.48	9.18	--	33.30	<50	<0.50	<0.50	<0.50	<0.50	2.2	1.37	TAMC	6.85	
11/29/2007	NP	42.48	9.10	--	33.38	<50	<0.50	<0.50	<0.50	<0.50	9.1	1.81	TAMC	7.14	
5/6/2008	P	42.48	9.40	--	33.08	<50	<0.50	<0.50	<0.50	<0.50	10	2.61	CEL	6.91	
<b>11/24/2008</b>	<b>NP</b>	<b>42.48</b>	<b>10.20</b>	<b>--</b>	<b>32.28</b>	<b>&lt;50</b>	<b>&lt;0.50</b>	<b>&lt;0.50</b>	<b>&lt;0.50</b>	<b>&lt;0.50</b>	<b>&lt;0.50</b>	<b>2.67</b>	<b>CEL</b>	<b>6.88</b>	

**Table 1. Summary of Ground-Water Monitoring Data: Relative Water Elevations and Laboratory Analyses**  
**Station #2035, 1001 San Pablo Ave., Albany, CA**

Well and Sample Date	P/NP	TOC Elevation (feet msl)	Depth to Water (feet bgs)	Product Thickness (feet)	Water Level Elevation (feet msl)	Concentrations in (µg/L)						DO (mg/L)	Lab	pH	Comments
						GRO/TPHg	Benzene	Toluene	Ethyl-Benzene	Total Xylenes	MTBE				
<b>MW-5</b>															
4/11/2002	NP	41.84	10.63	--	31.21	<50	<0.50	<0.50	<0.50	<0.50	<5.0	--	--	--	
11/27/2002	NP	41.84	10.65	--	31.19	--	--	--	--	--	--	--	--	--	
6/3/2003	--	41.84	8.92	--	32.92	<50	<0.50	<0.50	<0.50	<0.50	<0.50	1.8	--	--	
11/13/2003	NP	44.03	10.58	--	33.45	<50	<0.50	<0.50	<0.50	<0.50	0.79	1.4	SEQM	5.7	a
05/12/2004	--	44.03	9.95	--	34.08	--	--	--	--	--	--	--	--	--	
12/01/2004	NP	44.03	10.05	--	33.98	<50	<0.50	<0.50	<0.50	<0.50	0.55	1.8	SEQM	6.3	
05/02/2005	--	44.03	8.75	--	35.28	--	--	--	--	--	--	--	--	--	
11/16/2005	NP	44.03	10.37	--	33.66	<50	<0.50	<0.50	<0.50	<0.50	<0.50	1.3	SEQM	6.2	
5/31/2006	--	44.03	9.07	--	34.96	--	--	--	--	--	--	--	--	--	
12/6/2006	NP	44.03	10.25	--	33.78	<50	<0.50	<0.50	<0.50	<0.50	0.99	1.24	TAMC	6.88	
5/15/2007	--	44.03	9.51	--	34.52	--	--	--	--	--	--	--	--	--	
11/29/2007	NP	44.03	9.95	--	34.08	<50	<0.50	<0.50	<0.50	<0.50	<0.50	1.93	TAMC	6.98	
5/6/2008	--	44.03	9.67	--	34.36	--	--	--	--	--	--	--	--	--	
<b>11/24/2008</b>	<b>NP</b>	<b>44.03</b>	<b>10.62</b>	<b>--</b>	<b>33.41</b>	<b>&lt;50</b>	<b>&lt;0.50</b>	<b>&lt;0.50</b>	<b>&lt;0.50</b>	<b>&lt;0.50</b>	<b>&lt;0.50</b>	<b>2.43</b>	<b>CEL</b>	<b>6.52</b>	
<b>MW-6</b>															
4/11/2002	NP	40.13	11.42	--	28.71	<50	<0.50	<0.50	<0.50	<0.50	<5.0	--	--	--	
11/27/2002	NP	40.13	13.11	--	27.02	<50	<0.50	<0.50	<0.50	<0.50	<0.50	1.3	--	--	
6/3/2003	--	40.13	12.48	--	27.65	<50	<0.50	<0.50	<0.50	<0.50	<0.50	1.1	--	--	
11/13/2003	NP	42.26	13.11	--	29.15	<50	<0.50	<0.50	<0.50	<0.50	<0.50	1.2	SEQM	6.8	a
05/12/2004	--	42.26	12.68	--	29.58	--	--	--	--	--	--	--	--	--	
12/01/2004	NP	42.26	12.68	--	29.58	<50	<0.50	<0.50	<0.50	<0.50	<0.50	1.7	SEQM	7.3	
05/02/2005	--	42.26	12.25	--	30.01	--	--	--	--	--	--	--	--	--	
11/16/2005	NP	42.26	12.98	--	29.28	<50	<0.50	<0.50	<0.50	<0.50	<0.50	1.2	SEQM	6.7	
5/31/2006	--	42.26	12.35	--	29.91	--	--	--	--	--	--	--	--	--	
12/6/2006	NP	42.26	12.98	--	29.28	<50	<0.50	<0.50	<0.50	<0.50	<0.50	1.24	TAMC	6.86	
5/15/2007	--	42.26	12.55	--	29.71	--	--	--	--	--	--	--	--	--	
11/29/2007	NP	42.26	12.75	--	29.51	<50	<0.50	<0.50	<0.50	<0.50	<0.50	--	TAMC	6.93	
5/6/2008	--	42.26	12.91	--	29.35	--	--	--	--	--	--	--	--	--	
<b>11/24/2008</b>	<b>NP</b>	<b>42.26</b>	<b>13.20</b>	<b>--</b>	<b>29.06</b>	<b>&lt;50</b>	<b>&lt;0.50</b>	<b>&lt;0.50</b>	<b>&lt;0.50</b>	<b>&lt;0.50</b>	<b>&lt;0.50</b>	<b>2.28</b>	<b>CEL</b>	<b>7.25</b>	

**Table 1. Summary of Ground-Water Monitoring Data: Relative Water Elevations and Laboratory Analyses**  
**Station #2035, 1001 San Pablo Ave., Albany, CA**

Well and Sample Date	P/NP	TOC Elevation (feet msl)	Depth to Water (feet bgs)	Product Thickness (feet)	Water Level Elevation (feet msl)	Concentrations in (µg/L)						DO (mg/L)	Lab	pH	Comments
						GRO/TPHg	Benzene	Toluene	Ethyl-Benzene	Total Xylenes	MTBE				
<b>RW-1</b>															
4/11/2002	P	40.33	9.20	--	31.13	15,000	750	2,000	380	2,000	1,500	--	--	--	
11/27/2002	P	40.33	10.31	--	30.02	<2,500	720	<25	<25	<25	<25	1.8	--	--	
6/3/2003	--	40.33	9.54	--	30.79	470	78	0.97	4.3	9	48	1.4	--	--	
11/13/2003	P	42.35	10.35	--	32.00	130	29	<0.50	<0.50	<0.50	44	1.3	SEQM	6.6	a
05/12/2004	P	42.35	9.80	--	32.55	<250	66	<2.5	<2.5	<2.5	<2.5	1.9	SEQM	6.9	
09/02/2004	--	42.35	10.42	--	31.93	--	--	--	--	--	--	--	--	--	
10/07/2004	--	42.35	10.36	--	31.99	--	--	--	--	--	--	--	--	--	
11/04/2004	--	42.35	9.93	--	32.42	--	--	--	--	--	--	--	--	--	
12/01/2004	P	42.35	10.02	--	32.33	<250	96	<2.5	<2.5	<2.5	16	1.8	SEQM	6.7	
05/02/2005	P	42.35	9.20	--	33.15	230	100	<1.0	<1.0	<1.0	50	2.5	SEQM	6.6	
11/16/2005	P	42.35	10.96	--	31.39	<100	28	<1.0	<1.0	<1.0	32	1.0	SEQM	6.5	
5/31/2006	P	42.35	9.34	--	33.01	320	32	<0.50	<0.50	<0.50	28	1.3	SEQM	6.8	
12/6/2006	P	42.35	10.10	--	32.25	50	27	<0.50	<0.50	<0.50	19	1.49	TAMC	7.54	
5/15/2007	P	42.35	9.42	--	32.93	280	32	<0.50	<0.50	<0.50	18	2.61	TAMC	7.10	
11/29/2007	P	42.35	9.75	--	32.60	<50	14	<0.50	<0.50	<0.50	18	4.86	TAMC	8.14	
5/6/2008	P	42.35	9.71	--	32.64	610	110	<2.5	<2.5	<2.5	2.6	2.48	CEL	6.95	
<b>11/24/2008</b>	<b>P</b>	<b>42.35</b>	<b>10.48</b>	<b>--</b>	<b>31.87</b>	<b>73</b>	<b>31</b>	<b>&lt;0.50</b>	<b>&lt;0.50</b>	<b>&lt;0.50</b>	<b>11</b>	<b>2.53</b>	<b>CEL</b>	<b>6.88</b>	
<b>S-5</b>															
4/11/2002	P	40.33	10.17	--	30.16	30,000	390	1,400	410	7,400	<500	--	--	--	
11/27/2002	P	40.33	9.77	--	30.56	55,000	1,300	450	1,400	13,000	<50	4.3	--	--	
6/3/2003	--	40.33	9.12	--	31.21	--	--	--	--	--	--	1.4	--	--	
6/3/2003	--	40.33	9.03	--	31.30	44,000	680	260	1,100	9,900	<25	1.9	--	--	
11/13/2003	P	41.83	9.12	--	32.71	31,000	520	120	690	5,900	<50	1.4	SEQM	6.5	a
05/12/2004	P	41.83	9.95	--	31.88	28,000	760	79	910	5,000	<50	1.9	SEQM	6.6	
12/01/2004	P	41.83	9.61	--	32.22	26,000	1,500	64	1,400	4,000	<25	--	SEQM	6.5	b
05/02/2005	P	41.83	8.80	--	33.03	13,000	700	18	260	1,300	<5.0	1.8	SEQM	6.4	
11/16/2005	P	41.83	9.80	--	32.03	15,000	1,400	25	570	850	<5.0	1.1	SEQM	6.3	
5/31/2006	P	41.83	8.89	--	32.94	9,800	170	<5.0	490	390	<5.0	1.4	SEQM	6.6	
12/6/2006	P	41.83	9.65	--	32.18	16,000	1,100	<25	1,700	970	<25	1.23	TAMC	6.95	
5/15/2007	P	41.83	8.89	--	32.94	10,000	140	<5.0	340	310	<5.0	3.63	TAMC	7.10	

**Table 1. Summary of Ground-Water Monitoring Data: Relative Water Elevations and Laboratory Analyses  
Station #2035, 1001 San Pablo Ave., Albany, CA**

Well and Sample Date	P/NP	TOC Elevation (feet msl)	Depth to Water (feet bgs)	Product Thickness (feet)	Water Level Elevation (feet msl)	Concentrations in (µg/L)						DO (mg/L)	Lab	pH	Comments
						GRO/TPHg	Benzene	Toluene	Ethyl-Benzene	Total Xylenes	MTBE				
<b>S-5 Cont.</b>															
11/29/2007	P	41.83	9.48	--	32.35	13,000	770	8.6	500	360	<2.5	5.42	TAMC	7.28	c (Benzene)
5/6/2008	P	41.83	9.30	--	32.53	7,400	320	2.8	580	130	<0.50	3.37	CEL	6.88	
<b>11/24/2008</b>	<b>P</b>	<b>41.83</b>	<b>10.00</b>	<b>--</b>	<b>31.83</b>	<b>7,700</b>	<b>400</b>	<b>&lt;10</b>	<b>390</b>	<b>14</b>	<b>&lt;10</b>	<b>3.22</b>	<b>CEL</b>	<b>6.43</b>	



ABBREVIATIONS & SYMBOLS:

-- = Not analyzed/applicable/measured/available  
< = Not detected at or above laboratory reporting limit  
ft bgs = Feet below ground surface  
ft MSL = Feet above mean sea level  
BTEX = Benzene, toluene, ethylbenzene and xylenes  
DO = Dissolved oxygen  
DTW = Depth to water in ft bgs  
GRO = Gasoline range organics, range C4-C12  
GWE = Groundwater elevation measured in ft MSL  
mg/L = Milligrams per liter  
MTBE = Methyl tert butyl ether  
NP = Not purged before sampling  
P = Purged before sampling  
TOC = Top of casing measured in ft MSL  
TPH-g = Total petroleum hydrocarbons as gasoline, analyzed using EPA Method 8015, Modified  
µg/L = Micrograms per liter  
SEQ/SEQM = Sequoia Analytical/Sequoia Morgan Hill Laboratories

FOOTNOTES:

a = Site resurveyed by URS on 10/15/03 to NAVD '88  
b = Sheen in well  
c = Sample taken from VOA vial with air bubble >6mm

NOTES:

No sampling occurs at this site during the first and third quarters of each calendar year.

TPH-g analyzed using EPA Method 8015, Modified and BTEX and MTBE by EPA method 8260B.

Beginning in the fourth quarter 2003, the laboratory modified the reported analyte list. TPH-g was changed to GRO. The resulting data may be impacted by the potential of non-TPH-g analytes within the requested fuel range resulting in a higher concentration being reported.

Beginning in the second quarter 2004, the carbon range for GRO was changed from C6-C10 to C4-C12.

Values for DO and pH were obtained through field measurements.

GRO analysis was completed by EPA method 8260B (C4-C12) for samples collected from the time period April 2006 through February 4, 2008. The analysis for GRO was changed to EPA method 8015B (C6-C12) for samples collected from the time period February 5, 2008 through the present.

Note: The data within this table collected prior to April 2006 was provided to Broadbent & Associates, Inc. by Atlantic Richfield Company and their previous consultants. Broadbent & Associates, Inc. has not verified the accuracy of this information.

**Table 2. Summary of Fuel Additives Analytical Data**  
**Station #2035, 1001 San Pablo Ave., Albany, CA**

Well and Sample Date	Concentrations in (µg/L)								Comments
	Ethanol	TBA	MTBE	DIPE	ETBE	TAME	1,2-DCA	EDB	
<b>MW-1</b>									
6/3/2003	<1000	<200	8.6	<5.0	<5.0	<5.0	<5.0	<5.0	
11/13/2003	<100	<20	0.95	<0.50	<0.50	<0.50	--	--	
05/12/2004	<100	<20	3.0	<0.50	<0.50	<0.50	<0.50	<0.50	
12/01/2004	<100	<20	2.4	<0.50	<0.50	<0.50	<0.50	<0.50	
05/02/2005	<1,000	220	8.8	<5.0	<5.0	<5.0	<5.0	<5.0	
11/16/2005	<100	<20	0.92	<0.50	<0.50	<0.50	<0.50	<0.50	a
5/31/2006	<1,500	<100	4.0	<2.5	<2.5	<2.5	<2.5	<2.5	a
12/6/2006	<300	<20	0.72	<0.50	<0.50	<0.50	<0.50	<0.50	
5/15/2007	<300	<20	1.8	<0.50	<0.50	<0.50	<0.50	<0.50	
11/29/2007	<300	<20	0.98	<0.50	<0.50	<0.50	<0.50	<0.50	
5/6/2008	<300	<10	<0.50	<0.50	<0.50	<0.50	<0.50	<0.50	
<b>11/24/2008</b>	<b>&lt;300</b>	<b>&lt;10</b>	<b>&lt;0.50</b>	<b>&lt;0.50</b>	<b>&lt;0.50</b>	<b>&lt;0.50</b>	<b>&lt;0.50</b>	<b>&lt;0.50</b>	
<b>MW-2</b>									
6/3/2003	<100	<20	23	<0.50	<0.50	<0.50	0.94	<0.50	
11/13/2003	<100	<20	9.5	<0.50	<0.50	<0.50	--	--	
05/12/2004	<500	<100	27	<2.5	<2.5	<2.5	<2.5	<2.5	
12/01/2004	<100	<20	17	<0.50	<0.50	<0.50	0.74	<0.50	
05/02/2005	<100	75	25	<0.50	<0.50	<0.50	<0.50	<0.50	
11/16/2005	<100	<20	7.6	<0.50	<0.50	<0.50	0.79	<0.50	a
5/31/2006	<300	<20	24	<0.50	<0.50	<0.50	0.66	<0.50	a
12/6/2006	<300	<20	1.6	<0.50	<0.50	<0.50	<0.50	<0.50	a
5/15/2007	<300	<20	44	<0.50	<0.50	<0.50	1.2	<0.50	
11/29/2007	<300	<20	1.9	<0.50	<0.50	<0.50	<0.50	<0.50	
5/6/2008	<300	<10	35	<0.50	<0.50	<0.50	0.93	<0.50	
<b>11/24/2008</b>	<b>&lt;300</b>	<b>&lt;10</b>	<b>4.3</b>	<b>&lt;0.50</b>	<b>&lt;0.50</b>	<b>&lt;0.50</b>	<b>&lt;0.50</b>	<b>&lt;0.50</b>	
<b>MW-3</b>									
6/3/2003	<100	<20	47	<0.50	<0.50	<0.50	<0.50	<0.50	
11/13/2003	<100	<20	36	<0.50	<0.50	<0.50	--	--	
05/12/2004	<100	<20	39	<0.50	<0.50	<0.50	<0.50	<0.50	
12/01/2004	<100	<20	37	<0.50	<0.50	<0.50	<0.50	<0.50	

**Table 2. Summary of Fuel Additives Analytical Data  
Station #2035, 1001 San Pablo Ave., Albany, CA**

Well and Sample Date	Concentrations in (µg/L)								Comments
	Ethanol	TBA	MTBE	DIPE	ETBE	TAME	1,2-DCA	EDB	
<b>MW-3 Cont.</b>									
05/02/2005	<100	<20	23	<0.50	<0.50	<0.50	<0.50	<0.50	
11/16/2005	<100	<20	32	<0.50	<0.50	<0.50	<0.50	<0.50	a
5/31/2006	<300	<20	20	<0.50	<0.50	<0.50	<0.50	<0.50	a
12/6/2006	<300	<20	20	<0.50	<0.50	<0.50	<0.50	<0.50	a
5/15/2007	<300	<20	40	<0.50	<0.50	<0.50	<0.50	<0.50	
11/29/2007	<300	<20	35	<0.50	<0.50	<0.50	<0.50	<0.50	
5/6/2008	<300	<10	14	<0.50	<0.50	<0.50	<0.50	<0.50	
<b>11/24/2008</b>	<b>&lt;600</b>	<b>&lt;20</b>	<b>28</b>	<b>&lt;1.0</b>	<b>&lt;1.0</b>	<b>&lt;1.0</b>	<b>&lt;1.0</b>	<b>&lt;1.0</b>	
<b>MW-4</b>									
6/3/2003	<500	<100	120	<2.5	<2.5	<2.5	<2.5	<2.5	
11/13/2003	<100	<20	20	<0.50	<0.50	<0.50	--	--	
05/12/2004	<500	<100	79	<2.5	<2.5	<2.5	<2.5	<2.5	
12/01/2004	<100	<20	1.8	<0.50	<0.50	<0.50	<0.50	<0.50	
05/02/2005	<100	75	11	<0.50	<0.50	<0.50	<0.50	<0.50	
11/16/2005	<100	<20	0.93	<0.50	<0.50	<0.50	<0.50	<0.50	a
5/31/2006	<300	<20	2.4	<0.50	<0.50	<0.50	<0.50	<0.50	a
12/6/2006	<300	<20	7.8	<0.50	<0.50	<0.50	<0.50	<0.50	a
5/15/2007	<300	<20	2.2	<0.50	<0.50	<0.50	<0.50	<0.50	
11/29/2007	<300	<20	9.1	<0.50	<0.50	<0.50	<0.50	<0.50	
5/6/2008	<300	<10	10	<0.50	<0.50	<0.50	<0.50	<0.50	
<b>11/24/2008</b>	<b>&lt;300</b>	<b>&lt;10</b>	<b>&lt;0.50</b>	<b>&lt;0.50</b>	<b>&lt;0.50</b>	<b>&lt;0.50</b>	<b>&lt;0.50</b>	<b>&lt;0.50</b>	
<b>MW-5</b>									
6/3/2003	<100	<20	<0.50	<0.50	<0.50	<0.50	<0.50	<0.50	
11/13/2003	<100	<20	0.79	<0.50	<0.50	<0.50	--	--	
12/01/2004	<100	<20	0.55	<0.50	<0.50	<0.50	<0.50	<0.50	
11/16/2005	<100	<20	<0.50	<0.50	<0.50	<0.50	<0.50	<0.50	a
12/6/2006	<300	<20	0.99	<0.50	<0.50	<0.50	<0.50	<0.50	a
11/29/2007	<300	<20	<0.50	<0.50	<0.50	<0.50	<0.50	<0.50	
<b>11/24/2008</b>	<b>&lt;300</b>	<b>&lt;10</b>	<b>&lt;0.50</b>	<b>&lt;0.50</b>	<b>&lt;0.50</b>	<b>&lt;0.50</b>	<b>&lt;0.50</b>	<b>&lt;0.50</b>	
<b>MW-6</b>									

**Table 2. Summary of Fuel Additives Analytical Data  
Station #2035, 1001 San Pablo Ave., Albany, CA**

Well and Sample Date	Concentrations in (µg/L)								Comments
	Ethanol	TBA	MTBE	DIPE	ETBE	TAME	1,2-DCA	EDB	
<b>MW-6 Cont.</b>									
6/3/2003	<100	<20	<0.50	<0.50	<0.50	<0.50	<0.50	<0.50	
11/13/2003	<100	<20	<0.50	<0.50	<0.50	<0.50	--	--	
12/01/2004	<100	<20	<0.50	<0.50	<0.50	<0.50	<0.50	<0.50	
11/16/2005	<100	<20	<0.50	<0.50	<0.50	<0.50	<0.50	<0.50	a
12/6/2006	<300	<20	<0.50	<0.50	<0.50	<0.50	<0.50	<0.50	a
11/29/2007	<300	<20	<0.50	<0.50	<0.50	<0.50	<0.50	<0.50	
<b>11/24/2008</b>	<b>&lt;300</b>	<b>&lt;10</b>	<b>&lt;0.50</b>	<b>&lt;0.50</b>	<b>&lt;0.50</b>	<b>&lt;0.50</b>	<b>&lt;0.50</b>	<b>&lt;0.50</b>	
<b>RW-1</b>									
6/3/2003	<100	22	48	<0.50	<0.50	<0.50	<0.50	<0.50	
11/13/2003	<100	<20	44	<0.50	<0.50	<0.50	--	--	
05/12/2004	<500	<100	<2.5	<2.5	<2.5	<2.5	<2.5	<2.5	
12/01/2004	<500	<100	16	<2.5	<2.5	<2.5	<2.5	<2.5	
05/02/2005	<200	<40	50	<1.0	<1.0	<1.0	<1.0	<1.0	
11/16/2005	<200	<40	32	<1.0	<1.0	<1.0	<1.0	<1.0	a
5/31/2006	<300	<20	28	<0.50	<0.50	<0.50	<0.50	<0.50	a
12/6/2006	<300	<20	19	<0.50	<0.50	<0.50	<0.50	<0.50	a
5/15/2007	<300	<20	18	<0.50	<0.50	<0.50	<0.50	<0.50	
11/29/2007	<300	<20	18	<0.50	<0.50	<0.50	<0.50	<0.50	
5/6/2008	<1,500	<50	2.6	<2.5	<2.5	<2.5	<2.5	<2.5	
<b>11/24/2008</b>	<b>&lt;300</b>	<b>&lt;10</b>	<b>11</b>	<b>&lt;0.50</b>	<b>&lt;0.50</b>	<b>&lt;0.50</b>	<b>&lt;0.50</b>	<b>&lt;0.50</b>	
<b>S-5</b>									
6/3/2003	<5,000	<1,000	<25	<25	<25	<25	<25	<25	
11/13/2003	<10,000	<2,000	<50	<50	<50	<50	--	--	
05/12/2004	<10,000	<2,000	<50	<50	<50	<50	<50	<50	
12/01/2004	<5,000	<1,000	<25	<25	<25	<25	<25	<25	
05/02/2005	<1,000	<200	<5.0	<5.0	<5.0	<5.0	<5.0	<5.0	
11/16/2005	<1,000	<200	<5.0	<5.0	<5.0	<5.0	<5.0	<5.0	a
5/31/2006	<3,000	<200	<5.0	<5.0	<5.0	<5.0	<5.0	<5.0	a
12/6/2006	<15,000	<1,000	<25	<25	<25	<25	<25	<25	a
5/15/2007	<3,000	<200	<5.0	<5.0	<5.0	<5.0	<5.0	<5.0	

**Table 2. Summary of Fuel Additives Analytical Data  
Station #2035, 1001 San Pablo Ave., Albany, CA**

Well and Sample Date	Concentrations in (µg/L)								Comments
	Ethanol	TBA	MTBE	DIPE	ETBE	TAME	1,2-DCA	EDB	
<b>S-5 Cont.</b>									
11/29/2007	<1,500	<100	<2.5	<2.5	<2.5	<2.5	<2.5	<2.5	
5/6/2008	<300	<10	<0.50	<0.50	<0.50	<0.50	<0.50	<0.50	
<b>11/24/2008</b>	<b>&lt;6,000</b>	<b>&lt;200</b>	<b>&lt;10</b>	<b>&lt;10</b>	<b>&lt;10</b>	<b>&lt;10</b>	<b>&lt;10</b>	<b>&lt;10</b>	

ABBREVIATIONS & SYMBOLS:

-- = Not analyzed/applicable/measured/available

< = Not detected at or above the laboratory reporting limit

1,2-DCA = 1,2-Dichloroethane

DIPE = Di-isopropyl ether

EDB = 1,2-Dibromoethane

ETBE = Ethyl tert-butyl ether

MTBE = Methyl tert-butyl ether

TAME = tert-Amyl methyl ether

TBA = tert-Butyl alcohol

µg/L = Micrograms per Liter

FOOTNOTE:

a = Calibration verification for ethanol was within method limits but outside contract limits.

NOTES:

All volatile organic compounds analyzed using EPA Method 8260B.

Note: The data within this table collected prior to April 2006 was provided to Broadbent & Associates, Inc. by Atlantic Richfield Company and their previous consultants. Broadbent & Associates, Inc. has not verified the accuracy of this information.