

20121
PH

CAMBRIA

February 20, 2002

Susan Hugo
Alameda County Health Care Services Agency
1131 Harbor Bay Parkway, Suite 250
Alameda, California 94502-6577

FEB 25 2002

Re: **Fourth Quarter 2001 Monitoring Report**
Shell-branded Service Station
999 San Pablo Avenue
Albany, California
Incident #98995143
Cambria Project #244-0366-002



Dear Ms. Hugo:

On behalf of Equiva Services LLC, Cambria Environmental Technology, Inc. (Cambria) is submitting this groundwater monitoring report in accordance with the reporting requirements of 23 CCR 2652d.

FOURTH QUARTER 2001 ACTIVITIES

Groundwater Monitoring: Blaine Tech Services, Inc. (Blaine) of San Jose, California gauged and sampled the site wells, calculated groundwater elevations, and compiled the analytical data. Cambria prepared a vicinity map which includes previously submitted well survey information (Figure 1) and a groundwater elevation contour map (Figure 2). Blaine's report, presenting the laboratory report and supporting field documents, is included as Attachment A.

Additional Oxygenate Analysis: In addition to the regular quarterly analysis for total petroleum hydrocarbons as gasoline, benzene, toluene, ethylbenzene, xylenes and methyl tertiary butyl ether (MTBE), groundwater samples from monitoring wells S-2 and S-7 were analyzed for four extra oxygenates and ethanol. Analytical results for MTBE, diisopropyl ether, ethyl tertiary butyl ether, tertiary amyl methyl ether, tertiary butyl alcohol, and ethanol are presented on Table 1.

Well S-5 Ownership Transfer: An October 26, 2000 letter and a May 29, 2001 letter from the Alameda County Health Care Services Agency required ARCO to take over the sampling and remediation of well S-5. Samples collected from well S-5 during the second quarter 2001

Oakland, CA
San Ramon, CA
Sonoma, CA

**Cambria
Environmental
Technology, Inc.**

1144 65th Street
Suite B
Oakland, CA 94608
Tel (510) 420-0700
Fax (510) 420-9170



monitoring event were transferred to an ARCO-contracted laboratory and results were presented by ARCO. Sampling of well S-5 as part of the site monitoring program is suspended pending ownership transfer to ARCO.

ANTICIPATED FIRST QUARTER 2002 ACTIVITIES

Groundwater Monitoring: Blaine will gauge and sample selected site wells and tabulate the data. Cambria will prepare a monitoring report.



CLOSING

We appreciate the opportunity to work with you on this project. Please call Jacquelyn Jones at (510) 420-3316 if you have any questions or comments.

Sincerely,
Cambria Environmental Technology, Inc

for: *Stephan A. Bork*
Jacquelyn L. Jones
Project Geologist

[Signature]
Stephan A. Bork, C.E.G., C.HG.
Associate Hydrogeologist

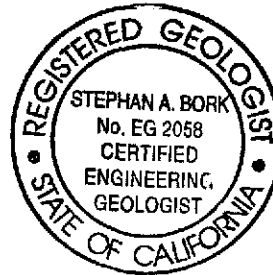

Figures: 1 - Vicinity/Area Well Survey Map
2 - Groundwater Elevation Contour Map

Table: 1 - Groundwater Analytical Data - Oxygenates

Attachment: A - Blaine Groundwater Monitoring Report and Field Notes

cc: Karen Petryna, Equiva Services LLC, P.O. Box 7869, Burbank, California 91510-7869





G:\ALBANY 999\FIGURES\VIC-WELL-SURVEY.A1

EXPLANATION

- 4 ◆ Monitoring well
- 18 ○ Test well
- 12 ⊕ Cathodic Protection well
- 27 ● Vapor Extraction well
- 13 ⊘ Destroyed well
- 14 ⊖ Unknown well
- ★ Subject site
- Study area

SOURCE: TOPOI MAPS

0 1/8 1/4 1/2 1
SCALE : 1" = 1/4 MILE

FIGURE
1

Shell-branded Service Station
 999 San Pablo Avenue
 Albany, California
 Incident #98995143



Vicinity / Area Well Survey Map
 (1/2-Mile Radius)

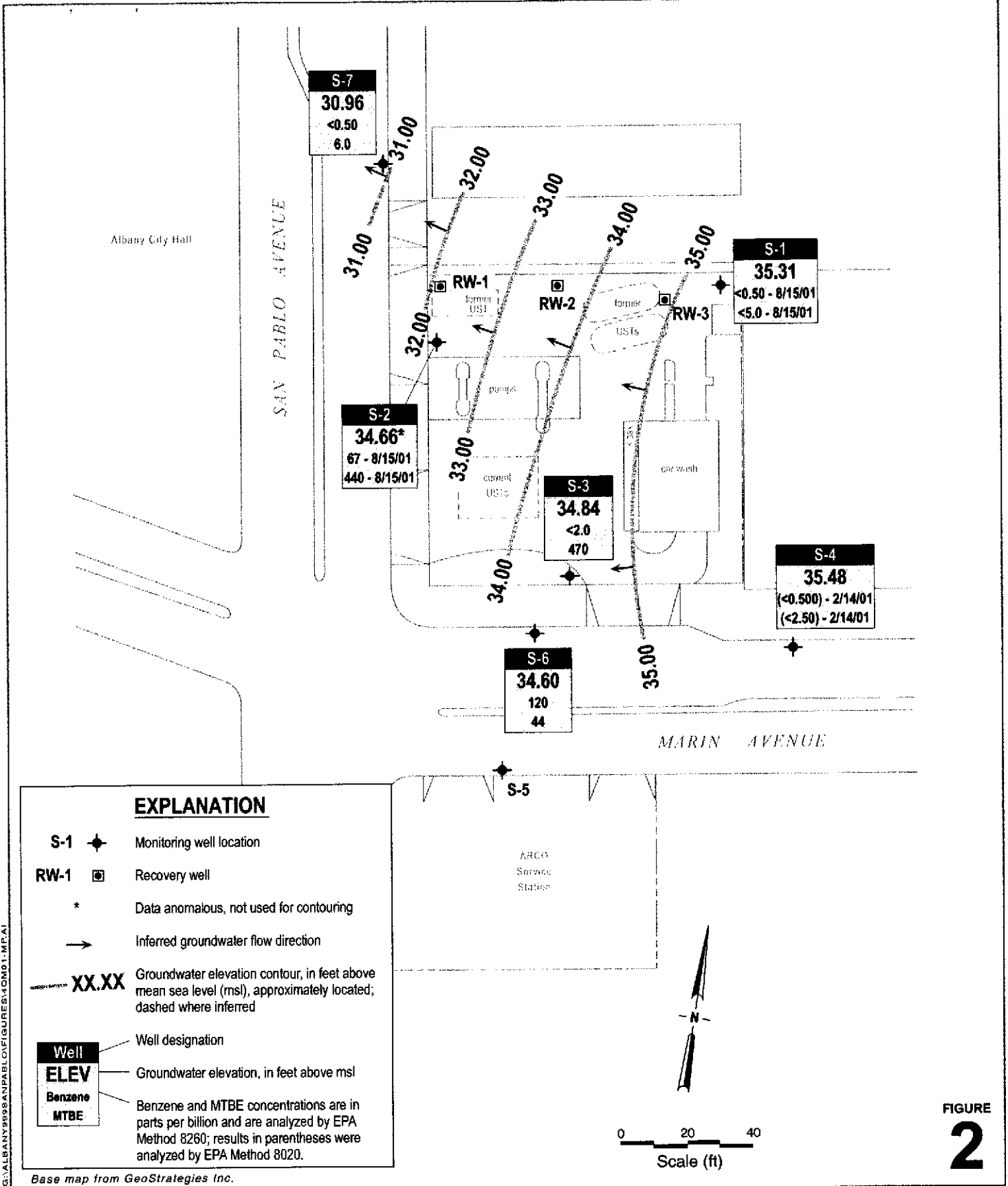

FIGURE
2

Shell-branded Service Station
 999 San Pablo Avenue
 Albany, California
 Incident #98995143



CAMBRIA

**Groundwater Elevation
 Contour Map**

December 31, 2001



CAMBRIA

Table 1. Groundwater Analytical Data - Oxygenates - Shell-branded Service Station, Incident #98995143, 999 San Pablo Avenue, Albany, California

Sample ID	Date Sampled	MTBE	DIPE	ETBE	TAME	TBA	Ethanol
(Concentrations in ppb)							
S-2	12/31/01	270	<2.0	<2.0	<2.0	110	<500
S-7	12/31/01	6.0	<2.0	<2.0	<2.0	<50	<500

Abbreviations:

MTBE = Methyl tert-butyl ether, analyzed by EPA Method 8260
 DIPE = Di-isopropyl ether, analyzed by EPA Method 8260
 ETBE = Ethyl tert-butyl ether, analyzed by EPA Method 8260
 TAME = Tert-amyl methyl ether, analyzed by EPA Method 8260
 TBA = Tert-butyl alcohol, analyzed by EPA Method 8260
 Ethanol analyzed by EPA Method 8260
 ppb = Parts per billion

ATTACHMENT A
Blaine Groundwater Monitoring Report
and Field Notes

BLAINE
TECH SERVICES, INC.



1680 ROGERS AVENUE
SAN JOSE, CA 95112-1105
(408) 573-7771 FAX
(408) 573-0555 PHONE
CONTRACTOR'S LICENSE #746684
www.blainetech.com

January 22, 2002

Karen Petryna
Equiva Services LLC
P.O. Box 7869
Burbank, CA 91510-7869

Fourth Quarter 2001 Groundwater Monitoring at
Shell-branded Service Station
999 San Pablo Avenue
Albany, CA

Monitoring performed on December 31, 2001

Groundwater Monitoring Report 011231-CW-2

This report covers the routine monitoring of groundwater wells at this Shell-branded facility. In accordance with standard procedures that conform to Regional Water Quality Control Board requirements, routine field data collection includes depth to water, total well depth, thickness of any separate immiscible layer, water column volume, calculated purge volume (if applicable), elapsed evacuation time (if applicable), total volume of water removed (if applicable), and standard water parameter instrument readings. Sample material is collected, contained, stored, and transported to the laboratory in conformance with EPA standards. Purgewater (if applicable) is, likewise, collected and transported to the Martinez Refining Company.

Basic field information is presented alongside analytical values excerpted from the laboratory report in the cumulative table of **WELL CONCENTRATIONS**. The full analytical report for the most recent samples and the field data sheets are attached to this report.

At a minimum, Blaine Tech Services, Inc. field personnel are certified on completion of a forty hour Hazardous Materials and Emergency Response training course per 29 CFR 1910.120. Field personnel are also enrolled in annual eight hour refresher courses.

Blaine Tech Services, Inc. conducts sampling and documentation assignments of this type as an independent third party. Our activities at this site consisted of objective data and sample collection only. No interpretation of analytical results, defining of hydrological conditions or formulation of recommendations was performed.

Please call if you have any questions.

Yours truly,

Leon Gearhart
Project Coordinator

LG/mrb

attachments: Cumulative Table of WELL CONCENTRATIONS
Certified Analytical Report
Field Data Sheets

cc: Anni Kreml
Cambria Environmental Technology, Inc.
1144 65th Street, Suite C
Oakland, CA 94608-2411

WELL CONCENTRATIONS
Shell-branded Service Station
999 San Pablo Avenue
Albany, CA

Wic #204-0079-0109

Well ID	Date	TPPH (ug/L)	B (ug/L)	T (ug/L)	E (ug/L)	X (ug/L)	MTBE 8020 (ug/L)	MTBE 8260 (ug/L)	TOB (MSL)	Depth to Water (ft.)	GW Elevation (MSL)	SPH Thickness (ft.)	DO Reading (ppm)
S-1	05/13/1991	1,500	20	2.6	86	74	NA	NA	42.73	8.24	34.49	NA	NA
S-1	08/23/1991	2,900	27	<2.5	75	18	NA	NA	42.73	8.37	34.36	NA	NA
S-1	11/07/1991	2,900	8	2.5	46	26	NA	NA	42.73	8.30	34.43	NA	NA
S-1	01/28/1992	2,000	11	<2.5	60	20	NA	NA	42.73	7.84	34.89	NA	NA
S-1	05/06/1992	1,200	5.5	<2.5	80	36	NA	NA	42.73	7.95	34.78	NA	NA
S-1	08/26/1992	2,000	9.4	<2.5	130	<2.5	NA	NA	42.73	8.24	34.49	NA	NA
S-1	10/28/1992	1,300	27	3.2	72	13	NA	NA	42.73	8.52	34.21	NA	NA
S-1	01/19/1993	1,500	13	3	29	31	NA	NA	42.73	6.54	36.19	NA	NA
S-1	04/29/1993	2,000	15	<2.5	82	<65	NA	NA	42.73	7.93	34.80	NA	NA
S-1	07/22/1993	620	1.1	4.2	3.5	13	NA	NA	42.73	8.09	34.64	NA	NA
S-1	10/21/1993	1,200	34	25	15	9.5	NA	NA	42.73	9.43	33.30	NA	NA
S-1	01/04/1994	860	<2.5	<2.5	5.7	5.3	NA	NA	42.73	8.25	34.48	NA	NA
S-1	04/13/1994	NA	NA	NA	NA	NA	NA	NA	42.73	8.02	34.71	NA	NA
S-1	07/25/1994	1,200	8.3	7.4	15	20	NA	NA	42.73	8.22	34.51	NA	NA
S-1	10/10/1994	NA	NA	NA	NA	NA	NA	NA	42.73	8.29	34.44	NA	NA
S-1	01/26/1995	1,000	12	0.6	12	420	NA	NA	42.73	6.88	35.85	NA	NA
S-1	04/21/1995	NA	NA	NA	NA	NA	NA	NA	42.73	7.65	35.08	NA	NA
S-1	07/28/1995	660	7.2	1	11	8.9	NA	NA	42.73	7.90	34.83	NA	4
S-1	10/31/1995	NA	NA	NA	NA	NA	NA	NA	42.73	7.72	35.01	NA	NA
S-1	01/10/1996	1,100	3.5	7	5.1	9.4	NA	NA	42.73	8.24	34.49	NA	7.4
S-1	04/25/1996	NA	NA	NA	NA	NA	NA	NA	42.73	7.74	34.99	NA	NA
S-1	07/23/1996	<50	<0.5	<0.5	<0.5	<0.5	<2.5	NA	42.73	7.92	34.81	NA	2.7
S-1	12/10/1996	NA	NA	NA	NA	NA	NA	NA	42.73	7.56	35.17	NA	0.6
S-1	02/20/1997	<50	<0.50	<0.50	<0.50	<0.50	<2.5	NA	42.73	7.95	34.78	NA	3
S-1	05/22/1997	NA	NA	NA	NA	NA	NA	NA	42.73	8.11	34.62	NA	0.5
S-1	08/22/1997	810	18	<2.0	5.1	4.4	18	NA	42.73	7.86	34.87	NA	3

WELL CONCENTRATIONS
Shell-branded Service Station
999 San Pablo Avenue
Albany, CA

Wic #204-0079-0109

Well ID	Date	TPPH (ug/L)	B (ug/L)	T (ug/L)	E (ug/L)	X (ug/L)	MTBE 8020 (ug/L)	MTBE 8260 (ug/L)	TOB (MSL)	Depth to Water (ft.)	GW Elevation (MSL)	SPH Thickness (ft.)	DO Reading (ppm)
---------	------	-------------	----------	----------	----------	----------	------------------	------------------	-----------	----------------------	--------------------	---------------------	------------------

S-1	11/03/1997	NA	NA	NA	NA	NA	NA	NA	42.73	8.35	34.38	NA	1.1
S-1	02/20/1998	<50	<0.50	<0.50	<0.50	<0.50	<2.5	NA	42.73	6.09	36.64	NA	2.9
S-1	05/18/1998	NA	NA	NA	NA	NA	NA	NA	42.73	7.69	35.04	NA	1.1
S-1	08/20/1998	390	6.7	<0.50	0.64	<0.50	14	NA	42.73	8.20	34.53	NA	1.9
S-1	11/06/1998	NA	NA	NA	NA	NA	NA	NA	42.73	8.23	34.50	NA	NA
S-1	02/16/1999	<50	<0.50	<0.50	<0.50	<0.50	<2.5	NA	42.73	7.47	35.26	NA	1.5
S-1	05/28/1999	NA	NA	NA	NA	NA	NA	NA	42.73	7.60	35.13	NA	1.3
S-1	08/24/1999	72.4	<0.50	<0.50	<0.50	<0.50	<2.50	NA	42.73	7.95	34.78	NA	1.4
S-1	11/16/1999	NA	NA	NA	NA	NA	NA	NA	42.73	7.87	34.86	NA	1.3
S-1	02/02/2000	<50.0	<0.50	<0.50	<0.50	<0.50	<5.00	NA	42.73	7.26	35.47	NA	1.4
S-1	05/09/2000	NA	NA	NA	NA	NA	NA	NA	42.73	8.13	34.60	NA	1.0
S-1	08/03/2000	209	6.42	<0.50	<0.50	<0.50	<2.50	NA	42.73	8.12	34.61	NA	1.4
S-1	11/15/2000	NA	NA	NA	NA	NA	NA	NA	42.73	8.06	34.67	NA	1.0
S-1	02/14/2001	179	4.46	<0.50	<0.50	<0.50	8.72	NA	42.73	8.08	34.65	NA	1.1
S-1	05/31/2001	NA	NA	NA	NA	NA	NA	NA	42.73	8.05	34.68	NA	1.0
S-1	08/15/2001	270	<0.50	<0.50	<0.50	<0.50	NA	<5.0	42.73	8.40	34.33	NA	1.3
S-1	12/31/2001	NA	NA	NA	NA	NA	NA	NA	42.73	7.42	35.31	NA	0.4

S-2	05/13/1991	23,000	3,900	230	1,100	3,200	NA	NA	40.73	8.50	32.23	NA	NA
S-2	08/23/1991	23,000	4,400	260	1,900	2,400	NA	NA	40.73	8.80	31.93	NA	NA
S-2	11/07/1991	40,000	4,000	160	1,020	3,400	NA	NA	40.73	8.61	32.12	NA	NA
S-2	01/28/1992	22,000	1,600	70	420	1,700	NA	NA	40.73	7.80	32.93	NA	NA
S-2	05/06/1992	20,000	2,600	110	860	1,900	NA	NA	40.73	8.10	32.63	NA	NA
S-2	08/26/1992	42,000	5,000	160	1,100	3,500	NA	NA	40.73	8.37	32.36	NA	NA
S-2	10/28/1992	34,000	4,800	330	1,600	2,900	NA	NA	40.73	8.64	32.09	NA	NA
S-2	01/19/1993	20,000	2,300	370	660	1,300	NA	NA	40.73	5.82	34.91	NA	NA

WELL CONCENTRATIONS
Shell-branded Service Station
999 San Pablo Avenue
Albany, CA

Wic #204-0079-0109

Well ID	Date	TPPH (ug/L)	B (ug/L)	T (ug/L)	E (ug/L)	X (ug/L)	MTBE 8020 (ug/L)	MTBE 8260 (ug/L)	TOB (MSL)	Depth to Water (ft.)	GW Elevation (MSL)	SPH Thickness (ft.)	DO Reading (ppm)
S-2	04/29/1993	40,000	2,000	67	900	1,900	NA	NA	40.73	7.70	33.03	NA	NA
S-2	07/22/1993	22,000	3,000	120	1,000	1,600	NA	NA	40.73	8.38	32.35	NA	NA
S-2 (D)	07/22/1993	17,000	3,000	110	1,000	1,500	NA	NA	40.73	8.38	32.35	NA	NA
S-2	10/21/1993	14,000	2,800	74	870	1,100	NA	NA	40.73	8.58	32.15	NA	NA
S-2 (D)	10/21/1993	13,000	3,200	53	960	820	NA	NA	40.73	8.58	32.15	NA	NA
S-2	01/04/1994	21,000	2,100	67	990	770	NA	NA	40.73	7.70	33.03	NA	NA
S-2 (D)	01/04/1994	22,000	2,000	64	910	750	NA	NA	40.73	7.70	33.03	NA	NA
S-2	04/13/1994	NA	NA	NA	NA	NA	NA	NA	40.73	7.62	33.11	NA	NA
S-2	07/25/1994	43,000	2,600	490	990	1,300	NA	NA	40.73	7.86	32.87	NA	NA
S-2	10/10/1994	NA	NA	NA	NA	NA	NA	NA	40.73	8.12	32.61	NA	NA
S-2	01/26/1995	21,000	790	12	290	570	NA	NA	40.73	6.38	34.35	NA	5.5
S-2	04/21/1995	NA	NA	NA	NA	NA	NA	NA	40.73	7.01	33.72	NA	NA
S-2	07/28/1995	14,000	2,400	360	960	370	NA	NA	40.73	7.82	32.91	NA	4
S-2	10/31/1995	NA	NA	NA	NA	NA	NA	NA	40.73	7.57	33.16	NA	NA
S-2	01/10/1996	17,000	1,400	<50	480	170	NA	NA	40.73	8.13	32.60	NA	7.2
S-2	04/25/1996	NA	NA	NA	NA	NA	NA	NA	40.73	7.72	33.01	NA	NA
S-2	07/23/1996	16,000	2,700	69	1,100	110	9,500	NA	40.73	8.10	32.63	NA	2.2
S-2 (D)	07/23/1996	11,000	2,600	68	1,000	96	10,000	11,000	40.73	8.10	32.63	NA	2.2
S-2	12/10/1996	NA	NA	NA	NA	NA	NA	NA	40.73	8.57	32.16	NA	0.5
S-2	02/20/1997	10,000	500	<10	90	130	6,400	NA	40.73	8.15	32.58	NA	4
S-2	05/22/1997	NA	NA	NA	NA	NA	NA	NA	40.73	8.79	31.94	NA	1.1
S-2	08/22/1997	23,000	1,300	65	740	290	4,500	NA	40.73	8.05	32.68	NA	3.2
S-2 (D)	08/22/1997	20,000	1,200	<100	630	250	3,900	NA	40.73	8.05	32.68	NA	3.2
S-2	11/03/1997	NA	NA	NA	NA	NA	NA	NA	40.73	8.75	31.98	NA	1.2
S-2	02/20/1998	450	28	1.3	7.4	12	35	NA	40.73	6.34	34.39	NA	0.4
S-2	05/18/1998	NA	NA	NA	NA	NA	NA	NA	40.73	7.95	32.78	NA	0.8

WELL CONCENTRATIONS
Shell-branded Service Station
999 San Pablo Avenue

Albany, CA

Wic #204-0079-0109

Well ID	Date	TPPH (ug/L)	B (ug/L)	T (ug/L)	E (ug/L)	X (ug/L)	MTBE 8020 (ug/L)	MTBE 8260 (ug/L)	TOB (MSL)	Depth to Water (ft.)	GW Elevation (MSL)	SPH Thickness (ft.)	DO Reading (ppm)
---------	------	-------------	----------	----------	----------	----------	------------------	------------------	-----------	----------------------	--------------------	---------------------	------------------

S-2	08/20/1998	22,000	290	44	420	410	7,300	NA	40.73	7.73	33.00	NA	1.9
S-2	11/06/1998	NA	NA	NA	NA	NA	NA	NA	40.73	8.47	32.26	NA	NA
S-2	02/16/1999	27,000	200	<200	770	840	5,400	NA	40.73	7.24	33.49	NA	1.4
S-2	05/28/1999	NA	NA	NA	NA	NA	NA	NA	40.73	7.82	32.91	NA	1.3
S-2	08/24/1999	13,400	196	<25.0	439	113	597	NA	40.73	8.61	32.12	NA	1.2
S-2	11/16/1999	NA	NA	NA	NA	NA	NA	NA	40.73	8.17	32.56	NA	1.1
S-2	02/02/2000	7,850	176	88.0	134	111	540	NA	40.73	7.57	33.16	NA	1.2
S-2	05/09/2000	NA	NA	NA	NA	NA	NA	NA	40.73	7.94	32.79	NA	1.3
S-2	08/03/2000	35,000	255	122	842	224	905	726e	40.73	8.07	32.66	NA	1.1
S-2	11/15/2000	NA	NA	NA	NA	NA	NA	NA	40.73	8.13	32.60	NA	1.3
S-2	02/14/2001	13,000	147	<25.0	309	54.4	581	NA	40.73	6.39	34.34	NA	1.4
S-2	05/31/2001	NA	NA	NA	NA	NA	NA	NA	40.73	7.21	33.52	NA	1.5
S-2	08/15/2001	15,000	67	4.1	220	33	NA	440	40.73	8.27	32.46	NA	0.6
S-2	12/31/2001	NA	NA	NA	NA	NA	NA	270	40.73	6.07	34.66	NA	0.2

S-3	05/13/1991	3,300	30	3.6	26	13	NA	NA	41.46	7.90	33.56	NA	NA
S-3	08/23/1991	2,000	25	4	9.3	4.5	NA	NA	41.46	8.14	33.32	NA	NA
S-3	11/07/1991	4,000	20	3.9	5	4.9	NA	NA	41.46	7.91	33.55	NA	NA
S-3	01/28/1992	2,100	21	7.6	6.7	15	NA	NA	41.46	7.53	33.93	NA	NA
S-3 (D)	01/28/1992	2,100	18	6.1	7.1	14	NA	NA	41.46	7.53	33.93	NA	NA
S-3	05/06/1992	6,600	38	51	45	65	NA	NA	41.46	7.55	33.91	NA	NA
S-3	08/26/1992	5,800	18	12	29	60	NA	NA	41.46	7.53	33.93	NA	NA
S-3	10/28/1992	3,000	55	11	16	32	NA	NA	41.46	7.95	33.51	NA	NA
S-3	01/19/1993	3,100	<5	5.1	11	16	NA	NA	41.46	6.12	36.34	NA	NA
S-3	04/29/1993	3,000	31	22	<5	14	NA	NA	41.46	7.27	34.19	NA	NA
S-3	07/22/1993	2,600	3.1	43	23	53	NA	NA	41.46	7.62	33.84	NA	NA

WELL CONCENTRATIONS
Shell-branded Service Station
999 San Pablo Avenue
Albany, CA

Wic #204-0079-0109

Well ID	Date	TPPH (ug/L)	B (ug/L)	T (ug/L)	E (ug/L)	X (ug/L)	MTBE 8020 (ug/L)	MTBE 8260 (ug/L)	TOB (MSL)	Depth to Water (ft.)	GW Elevation (MSL)	SPH Thickness (ft.)	DO Reading (ppm)
S-3	10/21/1993	2,500	73	14	16	32	NA	NA	41.46	7.81	33.65	NA	NA
S-3	01/04/1994	4,800	13	21	<12.5	33	NA	NA	41.46	7.49	33.97	NA	NA
S-3	04/13/1994	NA	NA	NA	NA	NA	NA	NA	41.46	7.32	34.14	NA	NA
S-3	07/25/1994	2,600	6.1	4	3.8	12	NA	NA	41.46	7.66	33.80	NA	NA
S-3	10/10/1994	NA	NA	NA	NA	NA	NA	NA	41.46	7.49	33.97	NA	NA
S-3	01/26/1995	3,600	30	6.8	5.6	19	NA	NA	41.46	6.50	34.96	NA	NA
S-3 (D)	01/26/1995	2,200	9.9	15	14	22	NA	NA	41.46	6.50	34.96	NA	NA
S-3	04/21/1995	NA	NA	NA	NA	NA	NA	NA	41.46	6.79	34.67	NA	NA
S-3	07/28/1995	3,700	27	9.3	20	34	NA	NA	41.46	7.28	34.18	NA	4
S-3	10/31/1995	NA	NA	NA	NA	NA	NA	NA	41.46	6.74	34.72	NA	NA
S-3	01/10/1996	4,000	10	<0.5	13	28	NA	NA	41.46	7.48	33.98	NA	6.1
S-3	04/25/1996	NA	NA	NA	NA	NA	NA	NA	41.46	6.90	34.56	NA	NA
S-3	07/23/1996	2,100	20	<0.5	<0.5	<0.5	<25	NA	41.46	7.04	34.42	NA	2.1
S-3	12/10/1996	NA	NA	NA	NA	NA	NA	NA	41.46	7.96	33.50	NA	0.7
S-3	02/20/1997	3,500	83	<5.0	18	16	130	NA	41.46	7.44	34.02	NA	3
S-3 (D)	02/20/1997	3,000	69	<5.0	14	12	70	NA	41.46	7.44	34.02	NA	3
S-3	05/22/1997	NA	NA	NA	NA	NA	NA	NA	41.46	7.13	34.33	NA	0.6
S-3	08/22/1997	4,700	60	12	19	21	40	NA	41.46	6.81	34.65	NA	2.9
S-3	11/03/1997	NA	NA	NA	NA	NA	NA	NA	41.46	7.40	34.06	NA	0.9
S-3	02/20/1998	3,400	<10	<10	14	18	85	NA	41.46	6.55	34.91	NA	0.8
S-3 (D)	02/20/1998	3,100	8.6	7.8	12	16	57	NA	41.46	6.55	34.91	NA	0.8
S-3	05/18/1998	NA	NA	NA	NA	NA	NA	NA	41.46	6.81	34.65	NA	0.7
S-3	08/20/1998	4,400	67	23	9.8	22	240	NA	41.46	6.98	34.48	NA	2.2
S-3	11/06/1998	NA	NA	NA	NA	NA	NA	NA	41.46	6.96	34.50	NA	NA
S-3	02/16/1999	2,000	6.9	6.2	3.7	4.8	47	NA	41.46	6.93	34.53	NA	2.0
S-3	05/28/1999	NA	NA	NA	NA	NA	NA	NA	41.46	6.74	34.72	NA	1.8

WELL CONCENTRATIONS
Shell-branded Service Station
999 San Pablo Avenue
Albany, CA

Wic #204-0079-0109

Well ID	Date	TPPH (ug/L)	B (ug/L)	T (ug/L)	E (ug/L)	X (ug/L)	MTBE 8020 (ug/L)	MTBE 8260 (ug/L)	TOB (MSL)	Depth to Water (ft.)	GW Elevation (MSL)	SPH Thickness (ft.)	DO Reading (ppm)
---------	------	-------------	----------	----------	----------	----------	------------------	------------------	-----------	----------------------	--------------------	---------------------	------------------

S-3	08/24/1999	4,170	54.8	14.2	6.65	13.7	43.4	NA	41.46	9.05	32.41	NA	1.9
S-3	11/16/1999	NA	NA	NA	NA	NA	NA	NA	41.46	7.09	34.37	NA	1.6
S-3	02/02/2000	2,410	133	112	24.9	104	46.0	NA	41.46	6.59	34.87	NA	1.9
S-3	05/09/2000	NA	NA	NA	NA	NA	NA	NA	41.46	7.13	34.33	NA	1.9
S-3	08/03/2000	3,890	17.2	21.9	<10.0	<10.0	166	NA	41.46	6.82	34.64	NA	1.8
S-3	11/15/2000	NA	NA	NA	NA	NA	NA	NA	41.46	6.98	34.48	NA	1.6
S-3	02/14/2001	2,800	35.8	5.57	3.83	2.94	1,070	1,250	41.46	6.57	34.89	NA	1.1
S-3	05/31/2001	NA	NA	NA	NA	NA	NA	NA	41.46	6.72	34.74	NA	1.6
S-3	08/15/2001	2,700	2.0	0.52	<0.50	2.0	NA	140	41.46	7.44	34.02	NA	0.6
S-3	12/31/2001	2,300	<2.0	<2.0	<2.0	<2.0	NA	470	41.46	6.62	34.84	NA	0.6

S-4	05/13/1991	<50	<0.5	<0.5	<0.5	<0.5	NA	NA	41.10	7.44	33.66	NA	NA
S-4	08/23/1991	<50	<0.5	<0.5	<0.5	<0.5	NA	NA	41.10	8.32	32.78	NA	NA
S-4	11/07/1991	260	<0.5	<0.5	<0.5	<0.5	NA	NA	41.10	8.32	32.78	NA	NA
S-4	01/28/1992	110c	<0.5	<0.5	<0.5	<0.5	NA	NA	41.10	7.40	33.70	NA	NA
S-4	05/06/1992	54	<0.5	<0.5	<0.5	<0.5	NA	NA	41.10	7.21	33.89	NA	NA
S-4	08/26/1992	67	<0.5	<0.5	<0.5	<0.5	NA	NA	41.10	8.13	32.97	NA	NA
S-4	10/28/1992	<50	<0.5	<0.5	<0.5	<0.5	NA	NA	41.10	8.73	32.37	NA	NA
S-4	01/19/1993	86	1.2	0.7	2.7	15	NA	NA	41.10	5.86	35.24	NA	NA
S-4	04/29/1993	<50	<0.5	<0.5	<0.5	<0.5	NA	NA	41.10	7.02	34.08	NA	NA
S-4 (D)	04/29/1993	<50	<0.5	<0.5	<0.5	<0.5	NA	NA	41.10	7.02	34.08	NA	NA
S-4	07/22/1993	<50	<0.5	<0.5	<0.5	<0.5	NA	NA	41.10	7.76	33.34	NA	NA
S-4	10/21/1993	<50	<0.5	<0.5	<0.5	<0.5	NA	NA	41.10	8.53	32.57	NA	NA
S-4	01/04/1994	<50	<0.5	<0.5	<0.5	<0.5	NA	NA	41.10	7.92	33.18	NA	NA
S-4	04/13/1994	NA	NA	NA	NA	NA	NA	NA	41.10	7.71	33.39	NA	NA
S-4	07/25/1994	NA	NA	NA	NA	NA	NA	NA	41.10	7.82	33.28	NA	NA

WELL CONCENTRATIONS
Shell-branded Service Station
999 San Pablo Avenue
Albany, CA

Wic #204-0079-0109

Well ID	Date	TPPH (ug/L)	B (ug/L)	T (ug/L)	E (ug/L)	X (ug/L)	MTBE 8020 (ug/L)	MTBE 8260 (ug/L)	TOB (MSL)	Depth to Water (ft.)	GW Elevation (MSL)	SPH Thickness (ft.)	DO Reading (ppm)
S-4	10/10/1994	NA	NA	NA	NA	NA	NA	NA	41.10	8.15	32.95	NA	NA
S-4	01/26/1995	<50	<0.5	<0.5	<0.5	<0.5	NA	NA	41.10	5.73	35.37	NA	NA
S-4	04/21/1995	NA	NA	NA	NA	NA	NA	NA	41.10	6.26	34.84	NA	NA
S-4	07/28/1995	NA	NA	NA	NA	NA	NA	NA	41.10	7.80	33.30	NA	NA
S-4	10/31/1995	NA	NA	NA	NA	NA	NA	NA	41.10	8.45	32.65	NA	NA
S-4	01/10/1996	<50	1	2.8	<0.5	2.1	NA	NA	41.10	8.26	32.84	NA	2.8
S-4	04/25/1996	NA	NA	NA	NA	NA	NA	NA	41.10	7.14	33.96	NA	NA
S-4	07/23/1996	<50	<0.5	<0.5	<0.5	<0.5	<2.5	NA	41.10	8.18	32.92	NA	3.8
S-4	12/10/1996	NA	NA	NA	NA	NA	NA	NA	41.10	7.04	34.06	NA	3.9
S-4	02/20/1997	<50	<0.50	<0.50	<0.50	<0.50	6.7	NA	41.10	7.07	34.03	NA	5
S-4	05/22/1997	NA	NA	NA	NA	NA	NA	NA	41.10	6.63	34.47	NA	0.8
S-4	08/22/1997	NA	NA	NA	NA	NA	NA	NA	41.10	7.69	33.41	NA	3.7
S-4	11/03/1997	NA	NA	NA	NA	NA	NA	NA	41.10	8.26	32.84	NA	1.3
S-4	02/20/1998	130	6.9	4.6	5.2	17	2.8	NA	41.10	5.57	35.53	NA	1.8
S-4	05/18/1998	NA	NA	NA	NA	NA	NA	NA	41.10	7.13	33.97	NA	1.4
S-4	08/20/1998	NA	NA	NA	NA	NA	NA	NA	41.10	7.77	33.33	NA	4.0
S-4	11/06/1998	NA	NA	NA	NA	NA	NA	NA	41.10	7.85	33.25	NA	NA
S-4	02/16/1999	<50	<0.50	<0.50	<0.50	<0.50	23	NA	41.10	6.51	34.59	NA	3.6
S-4	05/28/1999	NA	NA	NA	NA	NA	NA	NA	41.10	7.00	34.10	NA	3.2
S-4	08/24/1999	NA	NA	NA	NA	NA	NA	NA	41.10	9.13	31.97	NA	1.9
S-4	11/16/1999	NA	NA	NA	NA	NA	NA	NA	41.10	7.79	33.31	NA	1.7
S-4	02/02/2000	<50.0	<0.500	<0.500	<0.500	<0.500	<5.00	NA	41.10	7.19	33.91	NA	1.9
S-4	05/09/2000	NA	NA	NA	NA	NA	NA	NA	41.10	7.51	33.59	NA	1.8
S-4	08/03/2000	NA	NA	NA	NA	NA	NA	NA	41.10	7.83	33.27	NA	1.9
S-4	11/15/2000	NA	NA	NA	NA	NA	NA	NA	41.10	7.69	33.41	NA	1.5
S-4	02/14/2001	<50.0	<0.500	<0.500	<0.500	<0.500	<2.50	NA	41.10	6.20	34.90	NA	1.6

WELL CONCENTRATIONS
Shell-branded Service Station
999 San Pablo Avenue
Albany, CA

Wic #204-0079-0109

Well ID	Date	TPPH (ug/L)	B (ug/L)	T (ug/L)	E (ug/L)	X (ug/L)	MTBE 8020 (ug/L)	MTBE 8260 (ug/L)	TOB (MSL)	Depth to Water (ft.)	GW Elevation (MSL)	SPH Thickness (ft.)	DO Reading (ppm)
---------	------	-------------	----------	----------	----------	----------	------------------	------------------	-----------	----------------------	--------------------	---------------------	------------------

S-4	05/31/2001	NA	NA	NA	NA	NA	NA	NA	41.10	6.56	34.54	NA	1.6
S-4	08/15/2001	NA	NA	NA	NA	NA	NA	NA	41.10	7.90	33.20	NA	0.6
S-4	12/31/2001	NA	NA	NA	NA	NA	NA	NA	41.10	5.62	35.48	NA	2.7

S-5	05/13/1991	NA	NA	NA	NA	NA	NA	NA	39.99	14.60	30.57	6.48	NA
S-5	08/23/1991	NA	NA	NA	NA	NA	NA	NA	39.99	15.14	29.25	5.50	NA
S-5	11/07/1991	NA	NA	NA	NA	NA	NA	NA	39.99	15.10	29.17	5.35	NA
S-5	01/28/1992	NA	NA	NA	NA	NA	NA	NA	39.99	14.05	29.86	4.90	NA
S-5	05/06/1992	NA	NA	NA	NA	NA	NA	NA	39.99	14.31	30.21	5.66	NA
S-5	08/26/1992	NA	NA	NA	NA	NA	NA	NA	39.99	14.26	28.77	3.80	NA
S-5	10/28/1992	NA	NA	NA	NA	NA	NA	NA	39.99	14.22	28.82	3.81	NA
S-5	01/19/1993	NA	NA	NA	NA	NA	NA	NA	39.99	12.36	30.80	3.96	NA
S-5	04/29/1993	NA	NA	NA	NA	NA	NA	NA	39.99	9.64	31.07	0.90	NA
S-5	07/22/1993	NA	NA	NA	NA	NA	NA	NA	39.99	9.55	31.16	0.90	NA
S-5	10/21/1993	NA	NA	NA	NA	NA	NA	NA	39.99	11.23	29.34	0.73	NA
S-5	01/04/1994	NA	NA	NA	NA	NA	NA	NA	39.99	11.69	29.82	1.90	NA
S-5	04/13/1994	NA	NA	NA	NA	NA	NA	NA	39.99	11.42	29.87	1.62	NA
S-5	07/25/1994	NA	NA	NA	NA	NA	NA	NA	39.99	12.01	29.41	1.79	NA
S-5	10/10/1994	NA	NA	NA	NA	NA	NA	NA	39.99	12.05	29.38	1.80	NA
S-5	01/26/1995	NA	NA	NA	NA	NA	NA	NA	39.99	8.42	32.95	1.72	NA
S-5	04/21/1995	NA	NA	NA	NA	NA	NA	NA	39.99	10.03	30.90	1.17	NA
S-5	07/28/1995	NA	NA	NA	NA	NA	NA	NA	39.99	11.42	30.07	1.87	NA
S-5	10/31/1995	NA	NA	NA	NA	NA	NA	NA	39.99	13.21	27.21	0.54	NA
S-5	01/10/1996	NA	NA	NA	NA	NA	NA	NA	39.99	12.05	28.04	0.13	NA
S-5	04/25/1996	NA	NA	NA	NA	NA	NA	NA	39.99	9.68	30.33	0.03	NA
S-5	07/23/1996	NA	NA	NA	NA	NA	NA	NA	39.99	9.82	30.20	0.04	NA

WELL CONCENTRATIONS
Shell-branded Service Station
999 San Pablo Avenue
Albany, CA

Wic #204-0079-0109

Well ID	Date	TPPH (ug/L)	B (ug/L)	T (ug/L)	E (ug/L)	X (ug/L)	MTBE 8020 (ug/L)	MTBE 8260 (ug/L)	TOB (MSL)	Depth to Water (ft.)	GW Elevation (MSL)	SPH Thickness (ft.)	DO Reading (ppm)
S-5	12/10/1996	270,000	8,800	29,000	5,200	37,000	<2,500	NA	39.99	9.10	30.91	0.03	NA
S-5 (D)	12/10/1996	400,000	9,200	32,000	7,200	50,000	<2,500	NA	39.99	9.10	30.91	0.03	NA
S-5	02/20/1997	88,000	2,000	11,000	1,600	19,000	<500	NA	39.99	8.93	31.06	NA	5
S-5	05/22/1997	NA	NA	NA	NA	NA	NA	NA	39.99	10.07	29.94	0.02	NA
S-5	08/22/1997	NA	NA	NA	NA	NA	NA	NA	39.99	10.24	29.77	0.02	NA
S-5	11/03/1997	NA	NA	NA	NA	NA	NA	NA	39.99	10.91	29.10	0.02	NA
S-5	02/20/1998	NA	NA	NA	NA	NA	NA	NA	39.99	7.81	32.20	0.03	NA
S-5	05/18/1998	NA	NA	NA	NA	NA	NA	NA	39.99	9.64	30.37	0.02	NA
S-5	05/31/2001	NA	NA	NA	NA	NA	NA	NA	39.99	10.13	29.86	NA	NA
S-6	05/13/1991	13,000	600	140	210	310	NA	NA	40.12	7.82	32.30	NA	NA
S-6	08/23/1991	9,800	480	80	120	150	NA	NA	40.12	9.58	30.54	NA	NA
S-6	11/07/1991	6,200	240	23	25	27	NA	NA	40.12	10.86	29.26	NA	NA
S-6	01/28/1992	5,600	250	15	41	36	NA	NA	40.12	8.97	31.15	NA	NA
S-6	05/06/1992	7,100	330	29	110	210	NA	NA	40.12	8.27	31.85	NA	NA
S-6	08/26/1992	13,000	240	<50	56	780	NA	NA	40.12	9.57	31.55	NA	NA
S-6	10/28/1992	10,000	470	210	67	170	NA	NA	40.12	8.90	32.22	NA	NA
S-6	01/19/1993	4,800	100	26	27	45	NA	NA	40.12	4.84	35.28	NA	NA
S-6	04/29/1993	7,000	430	20	<12.5	42	NA	NA	40.12	5.61	34.51	NA	NA
S-6	07/22/1993	5,800	260	120	65	150	NA	NA	40.12	6.56	33.56	NA	NA
S-6	10/21/1993	5,500	270	69	120	140	NA	NA	40.12	8.73	31.39	NA	NA
S-6	01/04/1994	7,100	180	58	63	62	NA	NA	40.12	7.14	32.98	NA	NA
S-6	04/13/1994	NA	NA	NA	NA	NA	NA	NA	40.12	7.21	32.91	NA	NA
S-6	07/25/1994	12,000	190	52	30	39	NA	NA	40.12	6.85	33.27	NA	NA
S-6 (D)	07/25/1994	7,200	170	32	31	34	NA	NA	40.12	6.85	33.27	NA	NA
S-6	10/10/1994	NA	NA	NA	NA	NA	NA	NA	40.12	6.20	33.92	NA	NA

WELL CONCENTRATIONS
Shell-branded Service Station
999 San Pablo Avenue
Albany, CA

Wic #204-0079-0109

Well ID	Date	TPPH (ug/L)	B (ug/L)	T (ug/L)	E (ug/L)	X (ug/L)	MTBE 8020 (ug/L)	MTBE 8260 (ug/L)	TOB (MSL)	Depth to Water (ft.)	GW Elevation (MSL)	SPH Thickness (ft.)	DO Reading (ppm)
S-6	01/26/1995	5,800	120	23	24	44	NA	NA	40.12	4.89	35.23	NA	NA
S-6	04/21/1995	NA	NA	NA	NA	NA	NA	NA	40.12	5.61	34.51	NA	NA
S-6	07/28/1995	4,400	210	23	34	60	NA	NA	40.12	5.30	34.82	NA	3
S-6 (D)	07/28/1995	6,100	230	20	38	59	NA	NA	40.12	5.30	34.82	NA	3
S-6	10/31/1995	NA	NA	NA	NA	NA	NA	NA	40.12	4.98	35.14	NA	NA
S-6	01/10/1996	6,800	170	87	35	105	NA	NA	40.12	5.67	34.45	NA	2.2
S-6 (D)	01/10/1996	7,800	230	120	50	210	NA	NA	40.12	5.67	34.45	NA	2.2
S-6	04/25/1996	NA	NA	NA	NA	NA	NA	NA	40.12	5.23	34.89	NA	NA
S-6	07/23/1996	2,600	170	<0.5	<0.5	8.5	<25	NA	40.12	5.40	34.72	NA	1.4
S-6	12/10/1996	NA	NA	NA	NA	NA	NA	NA	40.12	6.68	33.44	NA	0.7
S-6	02/20/1997	6,300	160	7.7	14	31	77	NA	40.12	5.70	34.42	NA	2
S-6	05/22/1997	NA	NA	NA	NA	NA	NA	NA	40.12	5.49	34.63	NA	0.9
S-6	08/22/1997	6,200	160	26	15	27	49	NA	40.12	5.71	34.41	NA	2.8
S-6	11/03/1997	NA	NA	NA	NA	NA	NA	NA	40.12	6.15	33.97	NA	1.4
S-6	02/20/1998	4,100	150	<10	<10	15	55	NA	40.12	5.25	34.87	NA	0.4
S-6	05/18/1998	NA	NA	NA	NA	NA	NA	NA	40.12	5.69	34.43	NA	0.4
S-6	08/20/1998	7,800	240	38	16	39	110	NA	40.12	6.04	34.08	NA	1.5
S-6 (D) b	08/20/1998	8,400	270	30	19	31	130	NA	40.12	6.04	34.08	NA	1.5
S-6	11/06/1998	NA	NA	NA	NA	NA	NA	NA	40.12	6.10	34.02	NA	NA
S-6	02/16/1999	6,000	190	19	14	20	<2.5	NA	40.12	5.84	34.28	NA	1.7
S-6	05/28/1999	NA	NA	NA	NA	NA	NA	NA	40.12	9.51	30.61	NA	1.9
S-6	08/24/1999	6,870	193	32.1	18.8	36.4	<25.0	NA	40.12	8.29	31.83	NA	2.7
S-6	11/16/1999	NA	NA	NA	NA	NA	NA	NA	40.12	5.93	34.19	NA	2.6
S-6	02/02/2000	2,310	164	122	28.6	133	63.1	NA	40.12	5.33	34.79	NA	2.6
S-6	05/09/2000	NA	NA	NA	NA	NA	NA	NA	40.12	6.41	33.71	NA	2.4
S-6	08/03/2000	5,600	188	27.4	<10.0	25.2	174	NA	40.12	5.84	34.28	NA	2.7

WELL CONCENTRATIONS
Shell-branded Service Station
999 San Pablo Avenue
Albany, CA

Wic #204-0079-0109

Well ID	Date	TPPH (ug/L)	B (ug/L)	T (ug/L)	E (ug/L)	X (ug/L)	MTBE 8020 (ug/L)	MTBE 8260 (ug/L)	TOB (MSL)	Depth to Water (ft.)	GW Elevation (MSL)	SPH Thickness (ft.)	DO Reading (ppm)
S-6	11/15/2000	NA	NA	NA	NA	NA	NA	NA	40.12	5.58	34.54	NA	2.3
S-6	02/14/2001	6,140	126	13.2	8.01	18.0	205	NA	40.12	5.50	34.62	NA	1.3
S-6	05/31/2001	NA	NA	NA	NA	NA	NA	NA	40.12	5.52	34.60	NA	1.2
S-6	08/15/2001	6,000	160	9.1	5.8	24	NA	51	40.12	6.04	34.08	NA	0.4
S-6	12/31/2001	6,900	120	12	6.6	24	NA	44	40.12	5.52	34.60	NA	0.4

S-7	05/13/1991	<50	<0.5	<0.5	<0.5	<0.5	NA	NA	40.10	10.56	29.54	NA	NA
S-7	08/23/1991	<50	<0.5	<0.5	<0.5	<0.5	NA	NA	40.10	11.16	28.94	NA	NA
S-7	11/07/1991	<50	<0.5	<0.5	<0.5	<0.5	NA	NA	40.10	11.48	28.62	NA	NA
S-7	01/28/1992	<50	<0.5	<0.5	<0.5	<0.5	NA	NA	40.10	10.72	29.38	NA	NA
S-7	05/06/1992	<50	<0.5	<0.5	<0.5	<0.5	NA	NA	40.10	10.34	29.76	NA	NA
S-7	08/26/1992	160	<0.5	<0.5	<0.5	<0.5	NA	NA	40.10	11.13	28.97	NA	NA
S-7	10/28/1992	<50	<0.5	<0.5	<0.5	<0.5	NA	NA	40.10	11.52	28.58	NA	NA
S-7	01/19/1993	50	1.1	0.6	1.9	9.2	NA	NA	40.10	8.68	31.42	NA	NA
S-7	04/29/1993	<50	<0.5	<0.5	<0.5	<0.5	NA	NA	40.10	9.90	30.20	NA	NA
S-7	07/22/1993	Well inaccessible		NA	NA	NA	NA	NA	40.10	NA	NA	NA	NA
S-7	10/21/1993	<50	<0.5	<0.5	<0.5	<0.5	NA	NA	40.10	11.10	29.00	NA	NA
S-7	01/04/1994	<50	<0.5	<0.5	<0.5	<0.5	NA	NA	40.10	10.40	29.70	NA	NA
S-7	04/13/1994	<50	1.4	0.61	<0.5	0.64	NA	NA	40.10	10.20	29.90	NA	NA
S-7 (D)	04/13/1994	<50	1.4	0.61	<0.5	0.66	NA	NA	40.10	10.20	29.90	NA	NA
S-7	07/25/1994	<50	<0.5	<0.5	<0.5	<0.5	NA	NA	40.10	10.48	29.62	NA	NA
S-7 a	10/10/1994	<50	<0.5	<0.5	<0.5	<0.5	NA	NA	40.10	10.64	29.46	NA	NA
S-7	01/26/1995	<50	<0.5	<0.5	<0.5	<0.5	NA	NA	40.10	7.75	32.35	NA	4.6
S-7	04/21/1995	<50	<0.5	<0.5	<0.5	<0.5	NA	NA	40.10	8.51	31.59	NA	NA
S-7	07/28/1995	<50	<0.5	<0.5	<0.5	<0.5	NA	NA	40.10	10.20	29.90	NA	3
S-7	10/31/1995	<50	<0.5	<0.5	<0.5	<0.5	NA	NA	40.10	10.86	29.24	NA	4.9

WELL CONCENTRATIONS
Shell-branded Service Station
999 San Pablo Avenue
Albany, CA

Wic #204-0079-0109

Well ID	Date	TPPH (ug/L)	B (ug/L)	T (ug/L)	E (ug/L)	X (ug/L)	MTBE 8020 (ug/L)	MTBE 8260 (ug/L)	TOB (MSL)	Depth to Water (ft.)	GW Elevation (MSL)	SPH Thickness (ft.)	DO Reading (ppm)
S-7	01/10/1996	<50	<0.5	2	<0.5	2.6	NA	NA	40.10	10.33	29.77	NA	7.6
S-7	04/25/1996	<50	<0.5	<0.5	<0.5	<0.5	<2.5	NA	40.10	9.13	30.97	NA	6.2
S-7	07/23/1996	<50	<0.5	<0.5	<0.5	<0.5	14	NA	40.10	10.18	29.92	NA	3.7
S-7	12/10/1996	<50	<0.5	<0.5	<0.5	<0.5	<2.5	NA	40.10	9.04	31.06	NA	4.6
S-7	02/20/1997	<50	<0.50	<0.50	<0.50	<0.50	<2.5	NA	40.10	9.60	30.50	NA	5
S-7	05/22/1997	<50	1.3	<0.50	<0.50	<0.50	5.5	NA	40.10	10.63	29.47	NA	0.8
S-7	08/22/1997	<50	<0.50	<0.50	<0.50	<0.50	<2.5	NA	40.10	10.95	29.15	NA	2.6
S-7	11/03/1997	<50	2.2	1.7	0.58	3.4	<2.5	NA	40.10	11.29	28.81	NA	2.6
S-7	02/20/1998	350	23	13	14	42	3.8	NA	40.10	7.73	32.37	NA	4.6
S-7	05/18/1998	<50	<0.50	<0.50	<0.50	<0.50	<2.5	NA	40.10	10.29	29.81	NA	4.4
S-7	08/20/1998	Well inaccessible		NA	NA	NA	NA	NA	40.10	11.00	29.10	NA	5.4
S-7	11/06/1998	<50	<0.50	<0.50	<0.50	<0.50	<2.5	NA	40.10	11.19	28.91	NA	5.2
S-7	02/16/1999	Well inaccessible		NA	NA	NA	NA	NA	40.10	NA	NA	NA	NA
S-7	05/28/1999	<50.0	<0.500	<0.500	<0.500	<0.500	<5.00	NA	40.10	9.76	30.34	NA	2.7
S-7	08/24/1999	<50.0	<0.500	<0.500	<0.500	<0.500	<2.50	NA	40.10	10.61	29.49	NA	2.1
S-7	11/16/1999	<50.0	<0.500	<0.500	<0.500	<0.500	3.68	NA	40.10	10.90	29.20	NA	2.3
S-7	02/02/2000	<50.0	<0.500	<0.500	<0.500	<0.500	<5.00	NA	40.10	10.30	29.80	NA	2.1
S-7	05/09/2000	<50.0	<0.500	<0.500	<0.500	<0.500	<2.50	NA	40.10	10.25	29.85	NA	2.7
S-7	08/03/2000	<50.0	<0.500	<0.500	<0.500	<0.500	<2.50	NA	40.10	10.65	29.45	NA	2.5
S-7	11/15/2000	<50.0	<0.500	<0.500	<0.500	<0.500	<2.50	NA	40.10	10.53	29.57	NA	4.6
S-7	02/14/2001	Well inaccessible		NA	NA	NA	NA	NA	40.10	NA	NA	NA	NA
S-7	05/31/2001	<50	<0.50	<0.50	<0.50	0.77	NA	4.6	40.10	9.46	30.64	NA	2.1
S-7	08/15/2001	<50	<0.50	<0.50	<0.50	<0.50	NA	<5.0	40.10	10.93	29.17	NA	2.0
S-7	12/31/2001	<50	<0.50	<0.50	<0.50	<0.50	NA	6.0	40.10	9.14	30.96	NA	3.0

WELL CONCENTRATIONS
Shell-branded Service Station
999 San Pablo Avenue
Albany, CA

Wic #204-0079-0109

Well ID	Date	TPPH (ug/L)	B (ug/L)	T (ug/L)	E (ug/L)	X (ug/L)	MTBE 8020 (ug/L)	MTBE 8260 (ug/L)	TOB (MSL)	Depth to Water (ft.)	GW Elevation (MSL)	SPH Thickness (ft.)	DO Reading (ppm)

Abbreviations:

TPPH = Total petroleum hydrocarbons as gasoline by modified EPA Method 8260B; prior to May 31, 2001, analyzed by EPA Method 8015.

BTEX = Benzene, toluene, ethylbenzene, xylenes by EPA Method 8260B; prior to May 31, 2001, analyzed by EPA Method 8020.

MTBE = Methyl-tertiary-butyl ether

TOB = Top of Wellbox Elevation

SPH = Separate-Phase Hydrocarbons

GW = Groundwater

DO = Dissolved Oxygen

ug/L = parts per billion

msl = Mean sea level

ft = Feet

ppm = parts per million

<n = Below detection limit

D = Duplicate sample

NA = Not applicable

Notes:

a = Sample analyzed for total dissolved solids (450 mg/L).

b = Surrogate recovery outside QC limits due to matrix effect.

c = Chromatogram pattern indicated an unidentified hydrocarbon.

d = This sample analyzed outside of EPA recommended hold time.

e = Concentration is an estimate value above the linear quantitation range.

Ownership of well S-5 is being transferred to Arco.

When separate-phase hydrocarbons are present, ground water elevation is adjusted using the relation:

Corrected ground water elevation = Top-of-casing elevation - depth to water + (0.8 x hydrocarbon thickness).



Report Number : 24137

Date : 1/10/2002

Nick Sudano
Blaine Tech Services
1680 Rogers Avenue
San Jose, CA 95112-1105

Subject : 4 Water Samples
Project Name : 999 San Pablo Avenue, Albany
Project Number : 011231-CW-2
P.O. Number : 98995143

Dear Mr. Sudano,

Chemical analysis of the samples referenced above has been completed. Summaries of the data are contained on the following pages. Sample(s) were received under documented chain-of-custody. US EPA protocols for sample storage and preservation were followed.

Kiff Analytical is certified by the State of California (# 2236). If you have any questions regarding procedures or results, please call me at 530-297-4800.

Sincerely,

Joel Kiff



Report Number : 24137

Date : 1/10/2002

Project Name : 999 San Pablo Avenue, Albany

Project Number : 011231-CW-2

Sample : S-2

Matrix : Water

Lab Number : 24137-01

Sample Date :12/31/2001

Parameter	Measured Value	Method Reporting Limit	Units	Analysis Method	Date Analyzed
Methyl-t-butyl ether (MTBE)	270	2.0	ug/L	EPA 8260B	1/8/2002
Diisopropyl ether (DIPE)	< 2.0	2.0	ug/L	EPA 8260B	1/8/2002
Ethyl-t-butyl ether (ETBE)	< 2.0	2.0	ug/L	EPA 8260B	1/8/2002
Tert-amyl methyl ether (TAME)	< 2.0	2.0	ug/L	EPA 8260B	1/8/2002
Tert-Butanol	110	50	ug/L	EPA 8260B	1/8/2002
Ethanol	< 500	500	ug/L	EPA 8260B	1/8/2002
4-Bromofluorobenzene (Surr)	104		% Recovery	EPA 8260B	1/8/2002
1,2-Dichlorobenzene - d4 (Surr)	100		% Recovery	EPA 8260B	1/8/2002

Approved By:  Joel Kiff



Report Number : 24137

Date : 1/10/2002

Project Name : 999 San Pablo Avenue, Albany

Project Number : 011231-CW-2

Sample : S-3

Matrix : Water

Lab Number : 24137-02

Sample Date :12/31/2001

Parameter	Measured Value	Method Reporting Limit	Units	Analysis Method	Date Analyzed
Benzene	< 2.0	2.0	ug/L	EPA 8260B	1/7/2002
Toluene	< 2.0	2.0	ug/L	EPA 8260B	1/7/2002
Ethylbenzene	< 2.0	2.0	ug/L	EPA 8260B	1/7/2002
Total Xylenes	< 2.0	2.0	ug/L	EPA 8260B	1/7/2002
Methyl-t-butyl ether (MTBE)	470	20	ug/L	EPA 8260B	1/7/2002
TPH as Gasoline	2300	200	ug/L	EPA 8260B	1/7/2002
Toluene - d8 (Surr)	102		% Recovery	EPA 8260B	1/7/2002
4-Bromofluorobenzene (Surr)	105		% Recovery	EPA 8260B	1/7/2002

Approved By:  Joel Kiff



Report Number : 24137

Date : 1/10/2002

Project Name : 999 San Pablo Avenue, Albany

Project Number : 011231-CW-2

Sample : S-6

Matrix : Water

Lab Number : 24137-03

Sample Date :12/31/2001

Parameter	Measured Value	Method Reporting Limit	Units	Analysis Method	Date Analyzed
Benzene	120	0.50	ug/L	EPA 8260B	1/6/2002
Toluene	12	2.0	ug/L	EPA 8260B	1/8/2002
Ethylbenzene	6.6	0.50	ug/L	EPA 8260B	1/6/2002
Total Xylenes	24	0.50	ug/L	EPA 8260B	1/6/2002
Methyl-t-butyl ether (MTBE)	44	5.0	ug/L	EPA 8260B	1/6/2002
TPH as Gasoline	6900	200	ug/L	EPA 8260B	1/8/2002
Toluene - d8 (Surr)	87.9		% Recovery	EPA 8260B	1/6/2002
4-Bromofluorobenzene (Surr)	90.8		% Recovery	EPA 8260B	1/6/2002

Approved By:  Joel Kiff



Report Number : 24137

Date : 1/10/2002

Project Name : 999 San Pablo Avenue, Albany

Project Number : 011231-CW-2

Sample : S-7

Matrix : Water

Lab Number : 24137-04

Sample Date :12/31/2001

Parameter	Measured Value	Method Reporting Limit	Units	Analysis Method	Date Analyzed
Benzene	< 0.50	0.50	ug/L	EPA 8260B	1/4/2002
Toluene	< 0.50	0.50	ug/L	EPA 8260B	1/4/2002
Ethylbenzene	< 0.50	0.50	ug/L	EPA 8260B	1/4/2002
Total Xylenes	< 0.50	0.50	ug/L	EPA 8260B	1/4/2002
Methyl-t-butyl ether (MTBE)	6.0	0.50	ug/L	EPA 8260B	1/4/2002
Diisopropyl ether (DIPE)	< 2.0	2.0	ug/L	EPA 8260B	1/4/2002
Ethyl-t-butyl ether (ETBE)	< 2.0	2.0	ug/L	EPA 8260B	1/4/2002
Tert-amyl methyl ether (TAME)	< 2.0	2.0	ug/L	EPA 8260B	1/4/2002
Tert-Butanol	< 50	50	ug/L	EPA 8260B	1/4/2002
Ethanol	< 500	500	ug/L	EPA 8260B	1/4/2002
TPH as Gasoline	< 50	50	ug/L	EPA 8260B	1/4/2002
Toluene - d8 (Surr)	99.6		% Recovery	EPA 8260B	1/4/2002
4-Bromofluorobenzene (Surr)	102		% Recovery	EPA 8260B	1/4/2002

Approved By:  Joel Kiff

Report Number : 24137

Date : 1/10/2002

QC Report : Method Blank Data
Project Name : 999 San Pablo Avenue, Albany
Project Number : 011231-CW-2

Parameter	Measured Value	Method Reporting Limit	Units	Analysis Method	Date Analyzed	Parameter	Measured Value	Method Reporting Limit	Units	Analysis Method	Date Analyzed
Benzene	< 0.50	0.50	ug/L	EPA 8260B	1/7/2002	Benzene	< 0.50	0.50	ug/L	EPA 8260B	1/4/2002
Toluene	0.65	0.50	ug/L	EPA 8260B	1/7/2002	Toluene	< 0.50	0.50	ug/L	EPA 8260B	1/4/2002
Ethylbenzene	< 0.50	0.50	ug/L	EPA 8260B	1/7/2002	Ethylbenzene	< 0.50	0.50	ug/L	EPA 8260B	1/4/2002
Total Xylenes	< 0.50	0.50	ug/L	EPA 8260B	1/7/2002	Total Xylenes	< 0.50	0.50	ug/L	EPA 8260B	1/4/2002
Methyl-t-butyl ether (MTBE)	< 0.50	0.50	ug/L	EPA 8260B	1/7/2002	Methyl-t-butyl ether (MTBE)	< 0.50	0.50	ug/L	EPA 8260B	1/4/2002
Diisopropyl ether (DIPE)	< 2.0	2.0	ug/L	EPA 8260B	1/7/2002	Diisopropyl ether (DIPE)	< 2.0	2.0	ug/L	EPA 8260B	1/4/2002
Ethyl-t-butyl ether (ETBE)	< 2.0	2.0	ug/L	EPA 8260B	1/7/2002	Ethyl-t-butyl ether (ETBE)	< 2.0	2.0	ug/L	EPA 8260B	1/4/2002
Tert-amyl methyl ether (TAME)	< 2.0	2.0	ug/L	EPA 8260B	1/7/2002	Tert-amyl methyl ether (TAME)	< 2.0	2.0	ug/L	EPA 8260B	1/4/2002
Tert-Butanol	< 50	50	ug/L	EPA 8260B	1/7/2002	Tert-Butanol	< 50	50	ug/L	EPA 8260B	1/4/2002
Ethanol	< 500	500	ug/L	EPA 8260B	1/7/2002	Ethanol	< 500	500	ug/L	EPA 8260B	1/4/2002
TPH as Gasoline	< 50	50	ug/L	EPA 8260B	1/7/2002	TPH as Gasoline	< 50	50	ug/L	EPA 8260B	1/4/2002
4-Bromofluorobenzene (Surr)	113		%	EPA 8260B	1/7/2002	4-Bromofluorobenzene (Surr)	99.6		%	EPA 8260B	1/4/2002
Toluene - d8 (Surr)	99.9		%	EPA 8260B	1/7/2002	Toluene - d8 (Surr)	102		%	EPA 8260B	1/4/2002
Benzene	< 0.50	0.50	ug/L	EPA 8260B	1/4/2002	Benzene	< 0.50	0.50	ug/L	EPA 8260B	1/4/2002
Toluene	< 0.50	0.50	ug/L	EPA 8260B	1/4/2002	Toluene	< 0.50	0.50	ug/L	EPA 8260B	1/4/2002
Ethylbenzene	< 0.50	0.50	ug/L	EPA 8260B	1/4/2002	Ethylbenzene	< 0.50	0.50	ug/L	EPA 8260B	1/4/2002
Total Xylenes	< 0.50	0.50	ug/L	EPA 8260B	1/4/2002	Total Xylenes	< 0.50	0.50	ug/L	EPA 8260B	1/4/2002
Methyl-t-butyl ether (MTBE)	< 0.50	0.50	ug/L	EPA 8260B	1/4/2002	Methyl-t-butyl ether (MTBE)	< 0.50	0.50	ug/L	EPA 8260B	1/4/2002
Diisopropyl ether (DIPE)	< 2.0	2.0	ug/L	EPA 8260B	1/4/2002	Diisopropyl ether (DIPE)	< 2.0	2.0	ug/L	EPA 8260B	1/4/2002
Ethyl-t-butyl ether (ETBE)	< 2.0	2.0	ug/L	EPA 8260B	1/4/2002	Ethyl-t-butyl ether (ETBE)	< 2.0	2.0	ug/L	EPA 8260B	1/4/2002
Tert-amyl methyl ether (TAME)	< 2.0	2.0	ug/L	EPA 8260B	1/4/2002	Tert-amyl methyl ether (TAME)	< 2.0	2.0	ug/L	EPA 8260B	1/4/2002
Tert-Butanol	< 50	50	ug/L	EPA 8260B	1/4/2002	Tert-Butanol	< 50	50	ug/L	EPA 8260B	1/4/2002
Ethanol	< 500	500	ug/L	EPA 8260B	1/4/2002	Ethanol	< 500	500	ug/L	EPA 8260B	1/4/2002
TPH as Gasoline	< 50	50	ug/L	EPA 8260B	1/4/2002	TPH as Gasoline	< 50	50	ug/L	EPA 8260B	1/4/2002
Toluene - d8 (Surr)	99.6		%	EPA 8260B	1/4/2002	Toluene - d8 (Surr)	99.6		%	EPA 8260B	1/4/2002
4-Bromofluorobenzene (Surr)	102		%	EPA 8260B	1/4/2002	4-Bromofluorobenzene (Surr)	102		%	EPA 8260B	1/4/2002

Approved By: Joel Kiff

KIFF ANALYTICAL, LLC

720 Olive Drive, Suite D Davis, CA 95616 530-297-4800

Report Number : 24137

Date : 1/10/2002

QC Report : Matrix Spike/ Matrix Spike Duplicate

Project Name : 999 San Pablo Avenue,

Project Number : 011231-CW-2

Parameter	Spiked Sample	Sample Value	Spike Level	Spike Dup. Level	Spiked Sample Value	Duplicate Spiked Sample Value	Units	Analysis Method	Date Analyzed	Spiked Sample Percent Recov.	Duplicate Spiked Sample Percent Recov.	Relative Percent Diff.	Spiked Sample Percent Recov. Limit	Relative Percent Diff. Limit
Tert-Butanol	24134-01	5.5	195	195	173	172	ug/L	8260B	1/7/2002	86.0	85.4	0.718	70-130	25
Tert-amyl-methyl	24134-01	<0.50	39.0	39.0	39.4	39.7	ug/L	8260B	1/7/2002	101	102	0.912	70-130	25
Benzene	24134-01	0.66	39.0	39.0	38.6	38.9	ug/L	EPA 8260B	1/7/2002	97.4	98.0	0.639	70-130	25
Toluene	24134-01	4.7	39.0	39.0	42.3	42.0	ug/L	EPA 8260B	1/7/2002	96.4	95.6	0.807	70-130	25
Methyl-t-Butyl Ether	24134-01	<0.50	39.0	39.0	40.6	40.1	ug/L	EPA 8260B	1/7/2002	104	103	1.11	70-130	25
Benzene	24137-04	<0.50	40.0	40.0	37.6	37.4	ug/L	EPA 8260B	1/4/2002	94.0	93.4	0.587	70-130	25
Toluene	24137-04	<0.50	40.0	40.0	37.8	37.9	ug/L	EPA 8260B	1/4/2002	94.4	94.6	0.212	70-130	25
Tert-Butanol	24137-04	<5.0	200	200	173	177	ug/L	EPA 8260B	1/4/2002	86.6	88.4	2.02	70-130	25
Methyl-t-Butyl Ether	24137-04	6.0	40.0	40.0	45.4	45.7	ug/L	EPA 8260B	1/4/2002	98.4	99.3	0.936	70-130	25

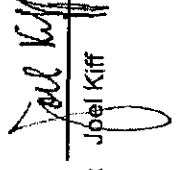

Approved By: Joel Kiff

KIFF ANALYTICAL, LLC

720 Olive Drive, Suite D Davis, CA 95616 530-297-4800

Report Number : 24137

Date : 1/10/2002

QC Report : Laboratory Control Sample (LCS)

Project Name : **999 San Pablo Avenue,**

Project Number : **011231-CW-2**

Parameter	Spike Level	Units	Analysis Method	Date Analyzed	LCS Percent Recov.	LCS Percent Recov. Limit
Tert-Butanol	100	ug/L	EPA 8260B	1/7/2002	88.6	70-130
Tert-amyl-methyl	20.0	ug/L	EPA 8260B	1/7/2002	107	70-130
Benzene	20.0	ug/L	EPA 8260B	1/7/2002	97.9	70-130
Toluene	20.0	ug/L	EPA 8260B	1/7/2002	98.9	70-130
Methyl-t-Butyl Ether	20.0	ug/L	EPA 8260B	1/7/2002	105	70-130
Benzene	40.0	ug/L	EPA 8260B	1/4/2002	96.5	70-130
Toluene	40.0	ug/L	EPA 8260B	1/4/2002	97.5	70-130
Tert-Butanol	200	ug/L	EPA 8260B	1/4/2002	87.9	70-130
Methyl-t-Butyl Ether	40.0	ug/L	EPA 8260B	1/4/2002	100	70-130

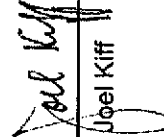

Approved By:

KIFF ANALYTICAL, LLC

720 Olive Drive, Suite D Davis, CA 95616 530-297-4800

WELL GAUGING DATA

Project # 011291-C2-2 Date 12-31-01 Client Equi

Site 499 San Pablo Ave, Albany

Well ID	Well Size (in.)	Sheen / Odor	Depth to Immiscible Liquid (ft.)	Thickness of Immiscible Liquid (ft.)	Volume of Immiscibles Removed (ml)	Depth to water (ft.)	Depth to well bottom (ft.)	Survey Point: <u>TOB</u> or TOC	Pre-Purge <u>120</u>
S-1	3					7.42	11.86	↓	0.4
S-2	3					6.07	12.11		0.2
S-3	3					6.62	12.20		0.6
S-4	3					5.62	14.26		2.7
S-6	3	odor				5.52	15.04		0.4
S-7	3					9.14	15.11		3.0

EQUIVA WELL MONITORING DATA SHEET

BTS #: <u>01231-cw-2</u>	Site: <u>999 San Pablo Ave Albany</u>
Sampler: <u>Chris W.</u>	Date: <u>12.31.01</u>
Well I.D.: <u>S-2</u>	Well Diameter: 2 <u>3</u> 4 6 8
Total Well Depth: <u>12.20</u>	Depth to Water: <u>6.07</u>
Depth to Free Product:	Thickness of Free Product (feet):
Referenced to: PVC <u>Grade</u>	D.O. Meter (if req'd): <u>YSI</u> HACH

Purge Method: Bailer
 Disposable Bailer
 Middleburg
Electric Submersible

Water
 Peristaltic
 Extraction Pump
 Other _____

Sampling Method: Bailer
 Disposable Bailer
 Extraction Port
 Dedicated Tubing

Other: _____

$$2.3 \text{ (Gals.)} \times 3 = 6.9 \text{ Gals.}$$
 Case Volume Specified Volumes Calculated Volume

Well Diameter	Multipier	Well Diameter	Multipier
1"	0.04	4"	0.65
2"	0.16	6"	1.47
3"	<u>0.37</u>	Other	radius ² * 0.163

Time	Temp (°F)	pH	Cond.	Turbidity	Gals. Removed	Observations
1532	62.7	7.5	875	7200	2.3	Muddy / odor
1533	63.4	7.6	915	7200	4.6	"
1534	63.0	7.5	906	196	6.9	clearing up

Did well dewater? Yes No Gallons actually evacuated: 6.9

Sampling Time: 1541 Sampling Date: 12.31.01

Sample I.D.: S-2 Laboratory: Kiff Sequoia Other _____

Analyzed for: TPH-G BTEX MTBE TPH-D Other: Oxygenates (5) + Ethanol by 8260

3B I.D. (if applicable): @ _____ Time Duplicate I.D. (if applicable): _____

Analyzed for: TPH-G BTEX MTBE TPH-D Other: _____

D.O. (if req'd):	Pre-purge: <u>0.2</u> mg/L	Post-purge:	mg/L
	D.R.P. (if req'd):	Pre-purge:	Post-purge: mV

EQUIVA WELL MONITORING DATA SHEET

BTS #: 011231-CW-2	Site: 999 San Pablo Ave. Albany.
Sampler: Chris W.	Date: 12.31.01
Well I.D.: 5-3	Well Diameter: 2 <u>3</u> 4 6 8
Total Well Depth: 12.20	Depth to Water: 6.62
Depth to Free Product:	Thickness of Free Product (feet):
Referenced to: PVC <u>Grade</u>	D.O. Meter (if req'd): <u>YSI</u> HACH

Purge Method: Bailer
 Disposable Bailer
 Middleburg
Electric Submersible

Water
 Peristaltic
 Extraction Pump
 Other _____

Sampling Method: Bailer
 Disposable Bailer
 Extraction Port
 Dedicated Tubing

Other: _____

$$2.1 \text{ (Gals.)} \times 3 = 6.3 \text{ Gals.}$$
 1 Case Volume Specified Volumes Calculated Volume

Well Diameter	Multiplier	Well Diameter	Multiplier
1"	0.04	4"	0.65
2"	0.16	5"	1.47
3"	<u>0.37</u>	Other	radius ² * 0.163

Time	Temp (°F)	pH	Cond.	Turbidity	Gals. Removed	Observations
1347	64.6	7.1	634	7200	2.1	cloudy / odor
1348	66.2	7.0	538	>200	4.2	"
1349	66.5	7.0	556	117		odor gone / clear

Did well dewater? Yes No Gallons actually evacuated: 6.3

Sampling Time: 1356 Sampling Date: 12.31.01

Sample I.D.: 5-3 Laboratory: Kiff Sequoia Other _____

Analyzed for: TPH-G BTEX MTBE TPH-D Other: _____

IB I.D. (if applicable): _____ Duplicate I.D. (if applicable): _____

Analyzed for: TPH-G BTEX MTBE TPH-D Other: _____

D.O. (if req'd): <u>Pre-purge:</u> 0.6 mg/L	Post-purge: _____ mg/L
R.P. (if req'd): Pre-purge: _____ mV	Post-purge: _____ mV

EQUIVA WELL MONITORING DATA SHEET

BTS #: 011231-CW-2	Site: 999 San Pablo Ave. Albany.
Sampler: Chris W.	Date: 12-31-01
Well I.D.: 5-6	Well Diameter: 2 <u>3</u> 4 6 8
Total Well Depth: 15.04	Depth to Water: 5.52
Depth to Free Product:	Thickness of Free Product (feet):
Referenced to: PVC <u>Grade</u>	D.O. Meter (if req'd): <u>YSI</u> HACH

Purge Method: Bailer
 Disposable Bailer
 Middleburg
Electric Submersible

Water
 Peristaltic
 Extraction Pump
 Other _____

Sampling Method: Bailer
 Disposable Bailer
 Extraction Port
 Dedicated Tubing

Other: _____

3.5	(Gals.) X	<u>3</u>	=	10.5	Gals.
1 Case Volume	Specified Volumes	Calculated Volumes			

Well Diameter	Multiplier	Well Diameter	Multiplier
1"	0.04	4"	0.65
2"	0.16	5"	1.47
3"	<u>0.37</u>	Other	radius ² * 0.163

Time	Temp (°F)	pH	Cond.	Turbidity	Gals. Removed	Observations
1404	64.5	7.3	811	>200	3.5	muddy / odor
1406	65.1	7.3	810	>200	7.0	"
1408	65.1	7.4	809	>200	10.5	"

Did well dewater? Yes No Gallons actually evacuated: 10.5

Sampling Time: 1426 Sampling Date: 12-31-01

Sample I.D.: 5-6 Laboratory: Kiff Sequoia Other _____

Analyzed for: TPH-G BTEX MTBE TPH-D Other: _____

3B I.D. (if applicable): @ Time Duplicate I.D. (if applicable): _____

Analyzed for: TPH-G BTEX MTBE TPH-D Other: _____

D.O. (if req'd):	Pre-purge: <u>0.4</u> mg/L	Post-purge:	mg/L
R.P. (if req'd):	Pre-purge: mV	Post-purge:	mV

EQUIVA WELL MONITORING DATA SHEET

BTS #: 011231-CW-2	Site: 999 San Pablo Ave. Albany
Sampler: Chris W.	Date: 12-31-01
Well I.D.: 5-7	Well Diameter: 2 <u>3</u> 4 6 8
Total Well Depth: 15.11	Depth to Water: 9.14
Depth to Free Product:	Thickness of Free Product (feet):
Referenced to: PVC <u>Grade</u>	D.O. Meter (if req'd): <u>YSI</u> HACH

Purge Method: Bailer
 Disposable Bailer
 Middleburg
Electric Submersible

Water
 Peristaltic
 Extraction Pump
 Other _____

Sampling Method: Bailer
 Disposable Bailer
 Extraction Port
 Dedicated Tubing

Other: _____

2.2	(Gals.) X	<u>3</u>	=	<u>6.6</u>	Gals.
Case Volume	Specified Volume	Calculated Volume			

Well Diameter	Multiplier	Well Diameter	Multiplier
1"	0.04	4"	0.65
2"	0.16	6"	1.47
3"	<u>0.37</u>	Other:	radius ² * 0.163

Time	Temp (°F)	pH	Cond.	Turbidity	Gals. Removed	Observations
1308	62.3	7.7	983	46	2.2	
1309	62.4	7.4	788	20	4.4	
1310	62.5	7.3	713	11	6.6	

Did well dewater? Yes No Gallons actually evacuated: 6.6

Sampling Time: 1315 Sampling Date: 12-31-01

Sample I.D.: 5-7 Laboratory: KIT Sequoia Other _____

Analyzed for: TPH-G BTEX MTBE TPH-D Other: _____

EB I.D. (if applicable): _____ @ _____ Time Duplicate I.D. (if applicable): _____

Analyzed for: TPH-G BTEX MTBE TPH-D Other: _____

D.O. (if req'd):	<u>Pre-purge:</u>	<u>3.0</u> mg/L	Post-purge:	mg/L
D.R.P. (if req'd):	<u>Pre-purge:</u>	mV	Post-purge:	mV

