

October 16, 1998

Ms. Susan Hugo
Alameda County Department of Environmental Health
1131 Harbor Bay Parkway, Suite 250
Alameda, California 94502-6577

Re: **Third Quarter 1998 Monitoring Report**
Shell-branded Service Station
999 San Pablo Avenue
Albany, California
WIC #204-0079-0109
Cambria Project #24-314-398



Dear Ms. Hugo:

On behalf of Equilon Enterprises LLC (Equilon), Cambria Environmental Technology, Inc. (Cambria) is submitting this ground water monitoring report in accordance with the reporting requirements of 23 CCR 2652d.

THIRD QUARTER 1998 ACTIVITIES

Ground Water Monitoring: Blaine Tech Services, Inc. (Blaine) of San Jose, California gauged and sampled selected site wells. Cambria calculated ground water elevations (Table 1), compiled the analytical data (Table 2), and prepared a ground water elevation contour map (Figure 1). The Blaine report is included as Attachment A.

ANTICIPATED FOURTH QUARTER 1998 ACTIVITIES

Ground Water Monitoring: Blaine will gauge and sample selected site wells. Cambria will tabulate the data and prepare a monitoring report.

Oakland, CA
Sonoma, CA
Portland, OR
Seattle, WA

**Cambria
Environmental
Technology, Inc.**

1144 65th Street
Suite B
Oakland, CA 94608
Tel (510) 420-0700
Fax (510) 420-9170

DISCUSSION

Monitoring well S-5 is located immediately adjacent to the Arco Service Station across Marin Avenue south of the Shell-branded station and has historically contained separate-phase hydrocarbons (SPH). However, wells S-3 and S-6, which are located along the southern property boundary of the Shell-branded station, have never contained SPH and the aqueous-phase hydrocarbon concentrations are not indicative of SPH. Therefore, it is apparent that the SPH detected in well S-5 originates from the Arco station immediately adjacent to well S-5, and not the Shell-branded station. Therefore, Cambria discontinued monitoring of well S-5 and requests permission to either abandon the well or transfer ownership to the owner of the Arco station.



CLOSING

We appreciate the opportunity to work with you on this project. Please call Darryk Ataide at (510) 420-3339 if you have any questions or comments.

Sincerely,
Cambria Environmental Technology, Inc.

Darryk Ataide
Project Environmental Scientist

Diane M. Lundquist, P.E.
Principal Engineer



Attachment: A - Blaine Ground Water Monitoring Report

cc: Karen Petryna, Equiva Services LLC, P.O. Box 8080, Martinez, California 94553

G:\Albany 999\QM\3q98qm.wpd



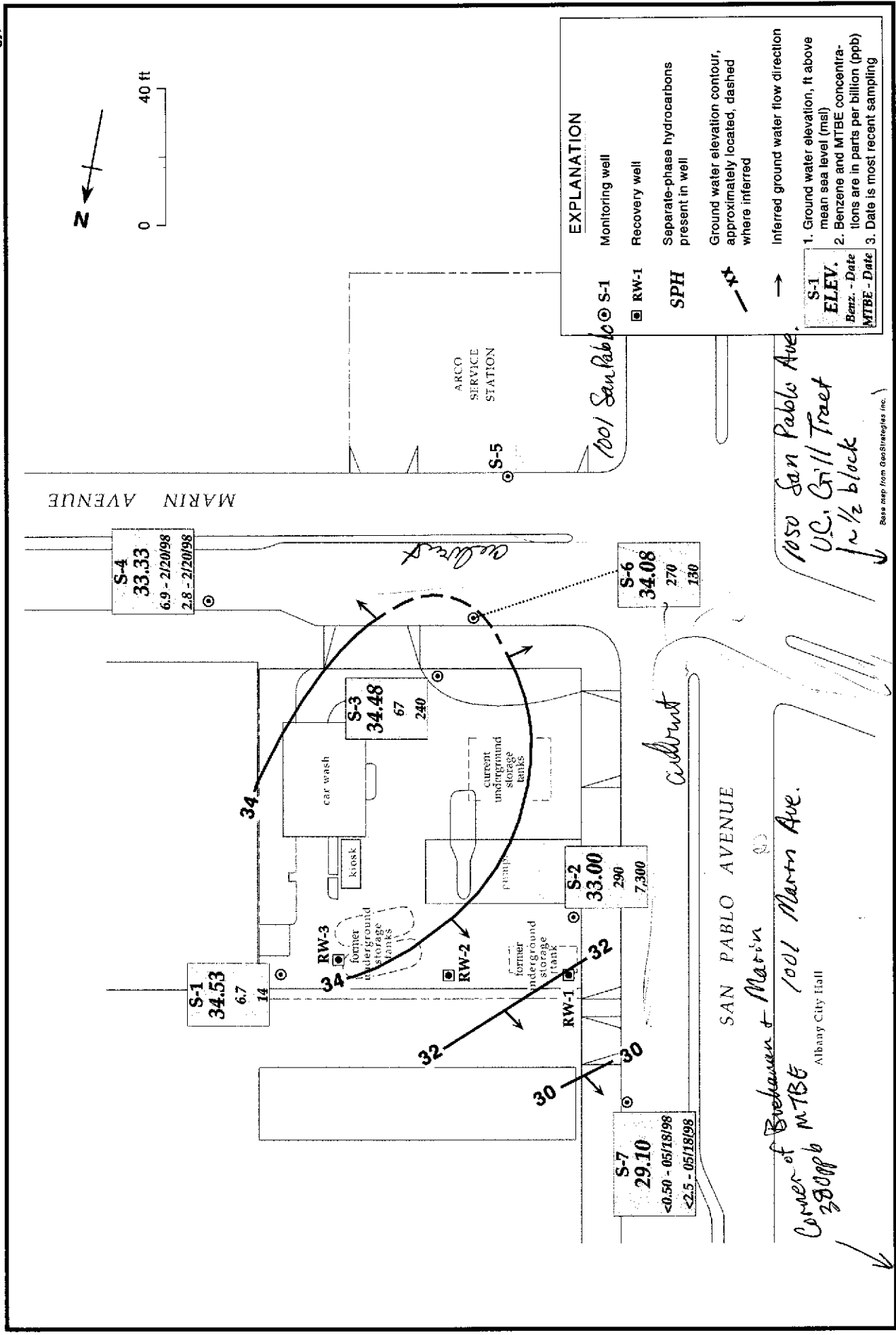

Figure 1. Ground Water Elevation Contours - August 20, 1998 - Shell-branded Service Station WIC #204-0079-0109, 999 San Pablo Avenue, Albany, California

Residents

CAMBRIA

Table 1. Ground Water Elevations – Shell-branded Service Station WIC# 204-0079-0109, 999 San Pablo Avenue, Albany, California

Well ID	Date	Top-of-Vault Elevation (ft above msl)	Depth to Water (ft below TOV)	Separate-Phase Hydrocarbon Thickness (ft)	Ground Water Elevation ^a (ft above msl)
S-1	05/13/91	42.73	8.24	---	34.49
	08/23/91		8.37	---	34.36
	11/07/91		8.30	---	34.43
	01/28/92		7.84	---	34.89
	05/06/92		7.95	---	34.78
	08/26/92		8.24	---	34.49
	10/28/92		8.52	---	34.21
	01/19/93		6.54	---	36.19
	04/29/93		7.93	---	34.80
	07/22/93		8.09	---	34.64
	10/21/93		9.43	---	33.30
	01/04/94		8.25	---	34.48
	04/13/94		8.02	---	34.71
	07/25/94		8.22	---	34.51
	10/10/94		8.29	---	34.44
	01/26/95		6.88	---	35.85
	04/21/95		7.65	---	35.08
	07/28/95		7.90	---	34.83
	10/31/95		7.72	---	35.01
	01/10/96		8.24	---	34.49
	04/25/96		7.74	---	34.99
	07/23/96		7.92	---	34.81
	12/10/96		7.56	---	35.17
	02/20/97		7.95	---	34.78
	05/22/97		8.11	---	34.62
	08/22/97		7.86	---	34.87
	11/03/97		8.35	---	34.38
	02/20/98		6.09	---	36.64
05/18/98	7.69	---	35.04		
08/20/98	8.20	---	34.53		
S-2	05/13/91	40.73	8.50	---	32.23
	08/23/91		8.80	---	31.93
	11/07/91		8.61	---	32.12
	01/28/92		7.80	---	32.93
	05/06/92		8.10	---	32.63
	08/26/92		8.37	---	32.36
	10/28/92		8.64	---	32.09
	01/19/93		5.82	---	34.91
	04/29/93		7.70	---	33.03
	07/22/93		8.38	---	32.35
	10/21/93		8.58	---	32.15
	01/04/94		7.70	---	33.03
	04/13/94		7.62	---	33.11
	07/25/94		7.86	---	32.87

CAMBRIA

Table 1. Ground Water Elevations – Shell-branded Service Station WIC# 204-0079-0109, 999 San Pablo Avenue, Albany, California

Well ID	Date	Top-of-Vault Elevation (ft above msl)	Depth to Water (ft below TOV)	Separate-Phase Hydrocarbon Thickness (ft)	Ground Water Elevation ^a (ft above msl)
	10/10/94		8.12	---	32.61
	01/26/95		6.38	---	34.35
	04/21/95		7.01	---	33.72
	07/28/95		7.82	---	32.91
	10/31/95		7.57	---	33.16
	01/10/96		8.13	---	32.60
	04/25/96		7.72	---	33.01
	07/23/96		8.10	---	32.63
	12/10/96		8.57	---	32.16
	02/20/97		8.15	---	32.58
	05/22/97		8.79	---	31.94
	08/22/97		8.05	---	32.68
	11/03/97		8.75	---	31.98
	02/20/98		6.34	---	34.39
	05/18/98		7.95	---	32.78
	08/20/98		7.73	---	33.00
S-3	05/13/91	41.46	7.90	---	33.56
	08/23/91		8.14	---	33.32
	11/07/91		7.91	---	33.55
	01/28/92		7.53	---	33.93
	05/06/92		7.55	---	33.91
	08/26/92		7.53	---	33.93
	10/28/92		7.95	---	33.51
	01/19/93		6.12	---	35.34
	04/29/93		7.27	---	34.19
	07/22/93		7.62	---	33.84
	10/21/93		7.81	---	33.65
	01/04/94		7.49	---	33.97
	04/13/94		7.32	---	34.14
	07/25/94		7.66	---	33.80
	10/10/94		7.49	---	33.97
	01/26/95		6.50	---	34.96
	04/21/95		6.79	---	34.67
	07/28/95		7.28	---	34.18
	10/31/95		6.74	---	34.72
	01/10/96		7.48	---	33.98
	04/25/96		6.90	---	34.56
	07/23/96		7.04	---	34.42
	12/10/96		7.96	---	33.50
	02/20/97		7.44	---	34.02
	05/22/97		7.13	---	34.33
	08/22/97		6.81	---	34.65
	11/03/97		7.40	---	34.06
	02/20/98		6.55	---	34.91

CAMBRIA

Table 1. Ground Water Elevations – Shell-branded Service Station WIC# 204-0079-0109, 999 San Pablo Avenue, Albany, California

Well ID	Date	Top-of-Vault Elevation (ft above msl)	Depth to Water (ft below TOV)	Separate-Phase Hydrocarbon Thickness (ft)	Ground Water Elevation ^a (ft above msl)
	05/18/98		6.81	---	34.65
	08/20/98		6.98	---	34.48
S-4	05/13/91	41.10	7.44	---	33.66
	08/23/91		8.32	---	32.78
	11/07/91		8.32	---	32.78
	01/28/92		7.40	---	33.70
	05/06/92		7.21	---	33.89
	08/26/92		8.13	---	32.97
	10/28/92		8.73	---	32.37
	01/19/93		5.86	---	35.24
	04/29/93		7.02	---	34.08
	07/22/93		7.76	---	33.34
	10/21/93		8.53	---	32.57
	01/04/94		7.92	---	33.18
	04/13/94		7.71	---	33.39
	07/25/94		7.82	---	33.28
	10/10/94		8.15	---	32.95
	01/26/95		5.73	---	35.37
	04/21/95		6.26	---	34.84
	07/28/95		7.80	---	33.30
	10/31/95		8.45	---	32.65
	01/10/96		8.26	---	32.84
	04/25/96		7.14	---	33.96
	07/23/96		8.18	---	32.92
	12/10/96		7.04	---	34.06
	02/20/97		7.07	---	34.03
	05/22/97		6.63	---	34.47
	08/22/97		7.69	---	33.41
	11/03/97		8.26	---	32.84
	02/20/98		5.57	---	35.53
	05/18/98		7.13	---	33.97
	08/20/98		7.77	---	33.33
S-5 (Discontinued)	05/13/91	39.99	14.60	6.48	30.57
	08/23/91		15.14	5.50	29.25
	11/07/91		15.10	5.35	29.17
	01/28/92		14.05	4.90	29.86
	05/06/92		14.31	5.66	30.21
	08/26/92		14.26	3.80	28.77
	10/28/92		14.22	3.81	28.82
	01/19/93		12.36	3.96	30.80
	04/29/93		9.64	0.90	31.07
	07/22/93		9.55	0.90	31.16
	10/21/93		11.23	0.73	29.34

CAMBRIA

Table 1. Ground Water Elevations – Shell-branded Service Station WIC# 204-0079-0109, 999 San Pablo Avenue, Albany, California

Well ID	Date	Top-of-Vault Elevation (ft above msl)	Depth to Water (ft below TOV)	Separate-Phase Hydrocarbon Thickness (ft)	Ground Water Elevation ^a (ft above msl)
	01/04/94		11.69	1.90	29.82
	04/13/94		11.42	1.62	29.87
	07/25/94		12.01	1.79	29.41
	10/10/94		12.05	1.80	29.38
	01/26/95		8.42	1.72	32.95
	04/21/95		10.03	1.17	30.90
	07/28/95		11.42	1.87	30.07
	10/31/95		13.21	0.54	27.21
	01/10/96		12.05	0.13	28.04
	04/25/96		9.68	0.03	30.33
	07/23/96		9.82	0.04	30.20
	12/10/96		9.10	0.03	30.91
	02/20/97		8.93	---	31.06
	05/22/97		10.07	0.02	29.94
	08/22/97		10.24	0.02	29.77
	11/03/97		10.91	0.02	29.10
	02/20/98		7.81	0.03	32.20
	05/18/98		9.64	0.02	30.37
S-6	05/13/91	40.12	7.82	---	32.30
	08/23/91		9.58	---	30.54
	11/07/91		10.86	---	29.26
	01/28/92		8.97	---	31.15
	05/06/92		8.27	---	31.85
	08/26/92		9.57	---	31.55
	10/28/92		8.90	---	32.22
	01/19/93		4.84	---	35.28
	04/29/93		5.61	---	34.51
	07/22/93		6.56	---	33.56
	10/21/93		8.73	---	31.39
	01/04/94		7.14	---	32.98
	04/13/94		7.21	---	32.91
	07/25/94		6.85	---	33.27
	10/10/94		6.20	---	33.92
	01/26/95		4.89	---	35.23
	04/21/95		5.61	---	34.51
	07/28/95		5.30	---	34.82
	10/31/95		4.98	---	35.14
	01/10/96		5.67	---	34.45
	04/25/96		5.23	---	34.89
	07/23/96		5.40	---	34.72
	12/10/96		6.68	---	33.44
	02/20/97		5.70	---	34.42
	05/22/97		5.49	---	34.63
	08/22/97		5.71	---	34.41

CAMBRIA

Table 1. Ground Water Elevations – Shell-branded Service Station WIC# 204-0079-0109, 999 San Pablo Avenue, Albany, California

Well ID	Date	Top-of-Vault Elevation (ft above msl)	Depth to Water (ft below TOV)	Separate-Phase Hydrocarbon Thickness (ft)	Ground Water Elevation ^a (ft above msl)
	11/03/97		6.15	---	33.97
	02/20/98		5.25	---	34.87
	05/18/98		5.69	---	34.43
	08/20/98		6.04	---	34.08
S-7	05/13/91	40.10	10.56	---	29.54
	08/23/91		11.16	---	28.94
	11/07/91		11.48	---	28.62
	01/28/92		10.72	---	29.38
	05/06/92		10.34	---	29.76
	08/26/92		11.13	---	28.97
	10/28/92		11.52	---	28.58
	01/19/93		8.68	---	31.42
	04/29/93		9.90	---	30.20
	07/22/93		---	---	---
	10/21/93		11.10	---	29.00
	01/04/94		10.40	---	29.70
	04/13/94		10.20	---	29.90
	07/25/94		10.48	---	29.62
	10/10/94		10.64	---	29.46
	01/26/95		7.75	---	32.35
	04/21/95		8.51	---	31.59
	07/28/95		10.20	---	29.90
	10/31/95		10.86	---	29.24
	01/10/96		10.33	---	29.77
	04/25/96		9.13	---	30.97
	07/23/96		10.18	---	29.92
	12/10/96		9.04	---	31.06
	02/20/97		9.60	---	30.50
	05/22/97		10.63	---	29.47
	08/22/97		10.95	---	29.15
	11/03/97		11.29	---	28.81
	02/20/98		7.73	---	32.37
	05/18/98		10.29	---	29.81
	08/20/98		11.00	---	29.10

Abbreviations and Notes:

ft = Feet

msl = Mean sea level

TOV = Top of vault

a = When separate-phase hydrocarbons are present, ground water elevation is corrected using the following relation:

Ground water elevation = top of casing elevation - depth to water + (0.8 x hydrocarbon thickness)

--- = No hydrocarbons present in well / Not available

CAMBRIA

Table 2. Ground Water Analytical Results – Shell-branded Service Station WIC# 204-0079-0109, 999 San Pablo Avenue, Albany, California

Well ID (Qtrs Sampled)	Date	Depth to Water (ft)	TPH-G ←	B	T (Concentrations in µg/L)	E	X	MTBE →	HDM Units (units/L)	DO (mg/L)
S-1 (1st & 3rd)	05/13/91	8.24	1,500	20	2.6	86	74	---	---	---
	08/23/91	8.37	2,900	27	<2.5	75	18	---	---	---
	11/07/91	8.30	2,900	8	2.5	46	26	---	---	---
	01/28/92	7.84	2,000	11	<2.5	60	20	---	---	---
	05/06/92	7.95	1,200	5.5	<2.5	80	36	---	---	---
	07/29/92	8.24	2,000	9.4	<2.5	130	<2.5	---	---	---
	10/28/92	8.52	1,300	27	3.2	72	13	---	---	---
	01/19/93	6.54	1,500	13	3	29	31	---	---	---
	04/29/93	7.93	2,000	15	<2.5	82	<65	---	---	---
	07/22/93	8.09	620	1.1	4.2	3.5	13	---	---	---
	10/21/93	9.43	1,200	34	25	15	9.5	---	---	---
	01/04/94	8.25	860	<2.5	<2.5	5.7	5.3	---	---	---
	07/25/94	8.22	1,200	8.3	7.4	15	20	---	---	---
	01/26/95	6.88	1,000	12	0.6	12	420	---	---	---
	07/28/95	7.90	660	7.2	1.0	11	8.9	---	---	4.0
	01/10/96	8.24	1,100	3.5	7.0	5.1	9.4	---	---	7.4
	07/23/96	7.92	<50	<0.5	<0.5	<0.5	<0.5	<2.5	---	2.7
12/10/96	7.56	---	---	---	---	---	---	---	0.6	
02/20/97	7.95	<50	<0.5	<0.5	<0.5	<0.5	<2.5	---	3.0	
05/22/97	8.11	---	---	---	---	---	---	---	0.5	
08/22/97	7.86	810	18	<2.0	5.1	4.4	18	---	3.0	
11/03/97	8.35	---	---	---	---	---	---	---	1.1	
02/20/98	6.09	<50	<0.5	<0.5	<0.5	<0.5	<2.5	---	2.9	
05/18/98	7.69	---	---	---	---	---	---	---	1.1	
08/20/98	8.20	390	6.7	<0.50	0.64	<0.50	14	<0.50	---	1.9
S-2 (1st & 3rd)	05/13/91	8.50	23,000	3,900	230	1,100	3,200	---	---	---
	08/23/91	8.80	23,000	4,400	260	1,900	2,400	---	---	---
	11/07/91	8.61	40,000	4,000	160	1,020	3,400	---	---	---
	01/28/92	7.80	22,000	1,600	70	420	1,700	---	---	---
	05/06/92	8.10	20,000	2,600	110	860	1,900	---	---	---
07/29/92	8.37	42,000	5,000	160	1,100	3,500	---	---	---	

CAMBRIA

Table 2. Ground Water Analytical Results – Shell-branded Service Station WIC# 204-0079-0109, 999 San Pablo Avenue, Albany, California (continued)

Well ID (Qtrs Sampled)	Date	Depth to Water (ft)	TPH-G ←	B	T (Concentrations in µg/L)	E	X	MTBE →	HDM Units (units/L)	DO (mg/L)
	10/28/92	8.64	34,000	4,800	330	1,600	2,900	---	---	---
	01/19/93	5.82	20,000	2,300	370	660	1,300	---	---	---
	04/29/93	7.70	40,000	2,000	67	900	1,900	---	---	---
	07/22/93	8.38	22,000	3,000	120	1,000	1,600	---	---	---
	07/22/93 ^{dup}	8.38	17,000	3,000	110	1,000	1,500	---	---	---
	10/21/93	8.58	14,000	2,800	74	870	1,100	---	---	---
	10/21/93 ^{dup}	8.58	13,000	3,200	53	960	820	---	---	---
	01/04/94	7.70	21,000	2,100	67	990	770	---	---	---
	01/04/94 ^{dup}	7.70	22,000	2,000	64	910	750	---	---	---
	07/25/94	7.86	43,000	2,600	490	990	1,300	---	---	---
	01/26/95	6.38	21,000	790	12	290	570	---	10 ⁴ to 10 ⁵ a, b	5.5
	07/28/95	7.82	14,000	2,400	360	960	370	---	---	4.0
	01/10/96	8.13	17,000	1,400	<50	480	170	---	---	7.2
	07/23/96	8.10	16,000	2,700	69	1,100	110	9,500	---	2.2
	07/23/96 ^{dup}	8.10	11,000	2,600	68	1,000	96	10,000(11,000)	10 ⁵ f	2.2
	12/10/96	8.57	---	---	---	---	---	---	---	0.5
	02/20/97	8.15	10,000	500	<10	90	130	6,400	---	4.0
	05/22/97	8.79	---	---	---	---	---	---	---	1.1
	08/22/97	8.05	23,000	1,300	65	740	290	4,500	---	3.2
	08/22/97 ^{dup}	8.05	20,000	1,200	<100	630	250	3,900	---	3.2
	11/03/97	8.75	---	---	---	---	---	---	---	1.2
	02/20/98	6.34	450	28	1.3	7.4	12	35	---	0.4
	05/18/98	7.95	---	---	---	---	---	---	---	0.8
	08/20/98	7.73	22,000	290	44	420	410	7,300	---	1.9
S-3 (1st & 3rd)	05/13/91	7.90	3,300	30	3.6	26	13	---	---	---
	08/23/91	8.14	2,000	25	4	9.3	4.5	---	---	---
	11/07/91	7.91	4,000	20	3.9	5	4.9	---	---	---
	01/28/92	7.53	2,100	21	7.6	6.7	15	---	---	---
	01/28/92 ^{dup}	7.53	2,100	18	6.1	7.1	14	---	---	---
	05/06/92	7.55	6,600	38	51	45	65	---	---	---
	07/29/92	7.53	5,800	18	12	29	60	---	---	---

CAMBRIA

Table 2. Ground Water Analytical Results -- Shell-branded Service Station WIC# 204-0079-0109, 999 San Pablo Avenue, Albany, California (continued)

Well ID (Qtrs Sampled)	Date	Depth to Water (ft)	TPH-G ←	B	T	E (Concentrations in µg/L)	X	MTBE →	HDM Units (units/L)	DO (mg/L)
	10/28/92	7.95	3,000	55	11	16	32	---	---	---
	01/19/93	6.12	3,100	<5	5.1	11	16	---	---	---
	04/29/93	7.27	3,000	31	22	<5	14	---	---	---
	07/22/93	7.62	2,600	3.1	43	23	53	---	---	---
	10/21/93	7.81	2,500	73	14	16	32	---	---	---
	01/04/94	7.49	4,800	13	21	<12.5	33	---	---	---
	07/25/94	7.66	2,600	6.1	4.0	3.8	12	---	---	---
	01/26/95	6.50	3,600	30	6.8	5.6	19	---	---	---
	01/26/95 ^{dup}	6.50	2,200	9.9	15	14	22	---	---	---
	07/28/95	7.28	3,700	27	9.3	20	34	---	---	4.0
	01/10/96	7.48	4,000	10	<0.5	13	28	---	---	6.1
	07/23/96	7.04	2,100	20	<0.5	<0.5	<0.5	<25	---	2.1
	12/10/96	7.56	---	---	---	---	---	---	---	0.7
	02/20/97	7.44	3,500	83	<5.0	18	16	130	---	3.0
	02/20/97 ^{dup}	7.44	3,000	69	<5.0	14	12	70	---	3.0
	05/22/97	7.13	---	---	---	---	---	---	---	0.6
	08/22/97	6.81	4,700	60	12	19	21	40	---	2.9
	11/03/97	7.40	---	---	---	---	---	---	---	0.9
	02/20/98	6.55	3,400	<10	<10	14	18	85	---	0.8
	02/20/98 ^{dup}	6.55	3,100	8.6	7.8	12	16	57	---	0.8
	05/18/98	6.81	---	---	---	---	---	---	---	0.7
	08/20/98	6.98	4,400	67	23	9.8	22	240	---	2.2
S-4 (1st)	05/13/91	7.44	<50	<0.5	<0.5	<0.5	<0.5	---	---	---
	08/23/91	8.32	<50	<0.5	<0.5	<0.5	<0.5	---	---	---
	11/07/91	8.32	260	<0.5	<0.5	<0.5	<0.5	---	---	---
	01/28/92	7.40	110 ^c	<0.5	<0.5	<0.5	<0.5	---	---	---
	05/06/92	7.21	54	<0.5	<0.5	<0.5	<0.5	---	---	---
	07/29/92	8.13	67	<0.5	<0.5	<0.5	<0.5	---	---	---
	10/28/92	8.73	<50	<0.5	<0.5	<0.5	<0.5	---	---	---
	01/19/93	5.86	86	1.2	0.7	2.7	15	---	---	---
	04/29/93	7.02	<50	<0.5	<0.5	<0.5	<0.5	---	---	---

CAMBRIA

Table 2. Ground Water Analytical Results – Shell-branded Service Station WIC# 204-0079-0109, 999 San Pablo Avenue, Albany, California (continued)

Well ID (Qtrs Sampled)	Date	Depth to Water (ft)	TPH-G ←	B	T (Concentrations in µg/L)	E	X	MTBE →	HDM Units (units/L)	DO (mg/L)
	04/29/93 ^{dup}	7.02	<50	<0.5	<0.5	<0.5	<0.5	---	---	---
	07/22/93	7.76	<50	<0.5	<0.5	<0.5	<0.5	---	---	---
	10/21/93	8.53	<50	<0.5	<0.5	<0.5	<0.5	---	---	---
	01/04/94	7.92	<50	<0.5	<0.5	<0.5	<0.5	---	---	---
	01/26/95	5.73	<50	<0.5	<0.5	<0.5	<0.5	---	---	---
	07/28/95	7.80	---	---	---	---	---	---	---	---
	01/10/96	8.26	<50	1.0	2.8	<0.5	2.1	---	---	2.8
	07/23/96	8.18	<50	<0.5	<0.5	<0.5	<0.5	<2.5	---	3.8
	12/10/96	7.04	---	---	---	---	---	---	---	3.9
	02/20/97	7.07	<50	<0.50	<0.50	<0.50	<0.50	6.7	---	5.0
	05/22/97	6.63	---	---	---	---	---	---	---	0.8
	08/22/97	7.69	---	---	---	---	---	---	---	3.7
	11/03/97	8.26	---	---	---	---	---	---	---	1.3
	02/20/98	5.57	130	6.9	4.6	5.2	17	2.8	---	1.8
	05/18/98	7.13	---	---	---	---	---	---	---	1.4
	08/20/98	7.77	---	---	---	---	---	---	---	4.0
S-5 (Discontinued)	05/13/91 ^{SPH}	14.60	---	---	---	---	---	---	---	---
	08/23/91 ^{SPH}	15.14	---	---	---	---	---	---	---	---
	11/07/91 ^{SPH}	15.10	---	---	---	---	---	---	---	---
	01/28/92 ^{SPH}	14.05	---	---	---	---	---	---	---	---
	05/06/92 ^{SPH}	14.31	---	---	---	---	---	---	---	---
	07/29/92 ^{SPH}	14.26	---	---	---	---	---	---	---	---
	10/28/92 ^{SPH}	14.22	---	---	---	---	---	---	---	---
	01/19/93 ^{SPH}	12.36	---	---	---	---	---	---	---	---
	04/29/93 ^{SPH}	9.64	---	---	---	---	---	---	---	---
	07/22/93 ^{SPH}	9.55	---	---	---	---	---	---	---	---
	10/21/93 ^{SPH}	11.23	---	---	---	---	---	---	---	---
	01/04/94 ^{SPH}	11.69	---	---	---	---	---	---	---	---
	07/25/94 ^{SPH}	12.01	---	---	---	---	---	---	---	---
	10/10/94 ^{SPH}	12.05	---	---	---	---	---	---	---	---
	01/26/95 ^{SPH}	9.80	---	---	---	---	---	---	---	---

CAMBRIA

Table 2. Ground Water Analytical Results – Shell-branded Service Station WIC# 204-0079-0109, 999 San Pablo Avenue, Albany, California (continued)

Well ID (Qtrs Sampled)	Date	Depth to Water (ft)	TPH-G ←	B	T (Concentrations in µg/L)	E	X	MTBE →	HDM Units (units/L)	DO (mg/L)
	04/21/95 ^{SPH}	10.03	---	---	---	---	---	---	---	---
	07/28/95 ^{SPH}	11.42	---	---	---	---	---	---	---	---
	10/31/95 ^{SPH}	---	---	---	---	---	---	---	---	---
	01/10/96 ^{SPH}	12.05	---	---	---	---	---	---	---	---
	04/25/96 ^{SPH}	9.68	---	---	---	---	---	---	---	---
	07/23/96	9.82	---	---	---	---	---	---	---	---
	12/10/96	9.10	270,000	8,800	29,000	5,200	37,000	<2,500	---	---
	12/10/96 ^{dup}	9.10	400,000	9,200	32,000	7,200	50,000	<2,500	---	---
	05/22/97 ^{SPH}	---	---	---	---	---	---	---	---	---
	02/20/97	8.93	88,000	2,000	11,000	1,600	19,000	<500	---	5.0
	08/22/97 ^{SPH}	10.24	---	---	---	---	---	---	---	---
	11/03/97 ^{SPH}	10.91	---	---	---	---	---	---	---	---
	02/20/98 ^{SPH}	7.81	---	---	---	---	---	---	---	---
	05/18/98 ^{SPH}	9.64	---	---	---	---	---	---	---	---
S-6 (1st & 3rd)	05/13/91	7.82	13,000	600	140	210	310	---	---	---
	08/23/91	9.58	9,800	480	80	120	150	---	---	---
	11/07/91	10.86	6,200	240	23	25	27	---	---	---
	01/28/92	8.97	5,600	250	15	41	36	---	---	---
	05/06/92	8.27	7,100	330	29	110	210	---	---	---
	07/29/92	9.57	13,000	240	<50	56	780	---	---	---
	10/28/92	8.90	10,000	470	210	67	170	---	---	---
	01/19/93	4.84	4,800	100	26	27	45	---	---	---
	04/29/93	5.61	7,000	430	20	<12.5	42	---	---	---
	07/22/93	6.56	5,800	260	120	65	150	---	---	---
	10/21/93	8.73	5,500	270	69	120	140	---	---	---
	01/04/94	7.14	7,100	180	58	63	62	---	---	---
	07/25/94	6.85	12,000	190	52	30	39	---	---	---
	07/25/94 ^{dup}	6.85	7,200	170	32	31	34	---	---	---
	01/26/95	4.89	5,800	120	23	24	44	---	---	---
	07/28/95	5.30	4,400	210	23	34	60	---	---	3.0
	07/28/95 ^{dup}	5.30	6,100	230	20	38	59	---	---	3.0

CAMBRIA

Table 2. Ground Water Analytical Results – Shell-branded Service Station WIC# 204-0079-0109, 999 San Pablo Avenue, Albany, California (continued)

Well ID (Qrs Sampled)	Date	Depth to Water (ft)	TPH-G ←	B	T (Concentrations in µg/L)	E	X	MTBE →	HDM Units (units/L)	DO (mg/L)
	01/10/96	5.67	6,800	170	87	35	105	---	---	2.2
	01/10/96 ^{dup}	5.67	7,800	230	120	50	210	---	---	2.2
	07/23/96	5.40	2,600	170	<0.5	<0.5	8.5	<25	---	1.4
	12/10/96	6.68	---	---	---	---	---	---	---	0.7
	02/20/97	5.70	6,300	160	7.7	14	31	77	---	2.0
	05/22/97	5.49	---	---	---	---	---	---	---	0.9
	08/22/97	5.71	6,200	160	26	15	27	49	---	2.8
	11/03/97	6.15	---	---	---	---	---	---	---	1.4
	02/20/98	5.25	4,100	150	<10	<10	15	55	---	0.4
	05/18/98	5.69	---	---	---	---	---	---	---	0.4
	08/20/98	6.04	7,800	240	38	16	39	110	---	1.5
	08/20/98 ^{dup, g}	6.04	8,400	270	30	19	31	130	---	1.5
S-7 (All)	05/13/91	10.56	<50	<0.5	<0.5	<0.5	<0.5	---	---	---
	08/23/91	11.16	<50	<0.5	<0.5	<0.5	<0.5	---	---	---
	11/07/91	11.48	<50	<0.5	<0.5	<0.5	<0.5	---	---	---
	01/28/92	10.72	<50	<0.5	<0.5	<0.5	<0.5	---	---	---
	05/06/92	10.34	<50	<0.5	<0.5	<0.5	<0.5	---	---	---
	07/29/92	11.13	160	<0.5	<0.5	<0.5	<0.5	---	---	---
	10/28/92	11.52	<50	<0.5	<0.5	<0.5	<0.5	---	---	---
	01/19/93	8.68	50	1.1	0.6	1.9	9.2	---	---	---
	04/29/93	9.90	<50	<0.5	<0.5	<0.5	<0.5	---	---	---
	07/22/93 ^d	---	---	---	---	---	---	---	---	---
	10/21/93	11.10	<50	<0.5	<0.5	<0.5	<0.5	---	---	---
	01/04/94	10.40	<50	<0.5	<0.5	<0.5	<0.5	---	---	---
	04/13/94	10.20	<50	1.4	0.61	<0.5	0.64	---	---	---
	04/13/94 ^{dup}	10.20	<50	1.4	0.61	<0.5	0.66	---	---	---
	07/25/94	10.48	<50	<0.5	<0.5	<0.5	<0.5	---	---	---
	10/10/94 ^e	10.64	<50	<0.5	<0.5	<0.5	<0.5	---	---	---
	01/26/95	7.75	<50	<0.5	<0.5	<0.5	<0.5	---	10 ³ to 10 ⁵ ^{a, b}	4.6
	04/21/95	8.51	<50	<0.5	<0.5	<0.5	<0.5	---	---	---
	07/28/95	10.20	<50	<0.5	<0.5	<0.5	<0.5	---	---	3.0

CAMBRIA

Table 2. Ground Water Analytical Results – Shell-branded Service Station WIC# 204-0079-0109, 999 San Pablo Avenue, Albany, California (continued)

Well ID (Qtrs Sampled)	Date	Depth to Water (ft)	TPH-G ←	B	T (Concentrations in µg/L)	E	X	MTBE →	HDM Units (units/L)	DO (mg/L)
	10/31/95	10.86	<50	<0.5	<0.5	<0.5	<0.5	---	---	4.9
	01/10/96	10.33	<50	<0.5	2.0	<0.5	2.6	---	---	7.6
	04/25/96	9.13	<50	<0.5	<0.5	<0.5	<0.5	<2.5	10 ⁰ to 10 ⁵ a, b	6.2
	07/23/96	10.18	<50	<0.5	<0.5	<0.5	<0.5	14	10 ⁰ f	3.7
	12/10/96	9.04	<50	<0.5	<0.5	<0.5	<0.5	<2.5	---	4.6
	02/20/97	9.60	<50	<0.50	<0.50	<0.50	<0.50	<2.5	---	5.0
	05/22/97	10.63	<50	1.3	<0.50	<0.50	<0.50	5.5	---	0.8
	08/22/97	10.95	<50	<0.50	<0.50	<0.50	<0.50	<2.5	---	2.6
	11/03/97	11.29	<50	2.2	1.7	0.58	3.4	<2.5	---	2.6
	02/20/98	7.73	350	23	13	14	42	3.8	---	4.6
	05/18/98	10.29	<50	<0.50	<0.50	<0.50	<0.50	<2.5	---	4.4
	08/20/98^d	11.00	---	---	---	---	---	---	---	5.4
Trip Blank	01/28/92		<50	<0.5	<0.5	<0.5	<0.5	---	---	---
	04/29/93		<50	<0.5	<0.5	<0.5	<0.5	---	---	---
	07/22/93		<50	<0.5	<0.5	<0.5	<0.5	---	---	---
	10/21/93		<50	<0.5	<0.5	<0.5	<0.5	---	---	---
	01/04/94		<50	<0.5	<0.5	<0.5	<0.5	---	---	---
	04/13/94		<50	<0.5	<0.5	<0.5	<0.5	---	---	---
	07/25/94		<50	<0.5	<0.5	<0.5	<0.5	---	---	---
	10/10/94		<50	<0.5	<0.5	<0.5	<0.5	---	---	---
	01/26/95		<50	<0.5	0.7	<0.5	<0.5	---	---	---
	04/21/95		<50	<0.5	<0.5	<0.5	<0.5	---	---	---
	07/28/95		<50	<0.5	<0.5	<0.5	<0.5	---	---	---
	10/31/95		<50	<0.5	<0.5	<0.5	<0.5	---	---	---
MCLs			NE	1	150	700	1,750	NE		

Table 2. Ground Water Analytical Results – Shell-branded Service Station WIC# 204-0079-0109, 999 San Pablo Avenue, Albany, California (continued)

Abbreviations:

- ft = Feet
- TPH-G = Total petroleum hydrocarbons as gasoline by modified EPA Method 8015
- B = Benzene by EPA Method 8020
- T = Toluene by EPA Method 8020
- E = Ethylbenzene by EPA Method 8020
- X = Xylenes by EPA Method 8020
- MTBE = Methyl tert-butyl ether by Method 8020. Results in parentheses indicates MTBE by EPA Method 8260
- HDM = Hydrocarbon degrading microbes
- µg/L = Micrograms per liter
- mg/L = Milligrams per liter
- DO = Dissolved oxygen
- dup = Duplicate sample
- SPH = Separate-phase hydrocarbons detected, no sample collected
- MCL = California primary maximum contaminant level for drinking water (22 CCR 64444)
- NE = MCL not established

Notes:

- a = Simple method
- b = Estimated number
- c = Compounds detected and calculated as TPH-G are not characteristic of the standard gasoline chromatographic pattern
- d = Well inaccessible
- e = Sample analyzed for total dissolved solids (450 mg/L)
- f = Estimated BTEX degrading units per liter
- g = Surrogate recovery outside QC limits due to matrix effect
- <n = Below detection limits of n µg/L
- ... = Data not available/Not analyzed

ATTACHMENT A

Blaine Ground Water Monitoring Report

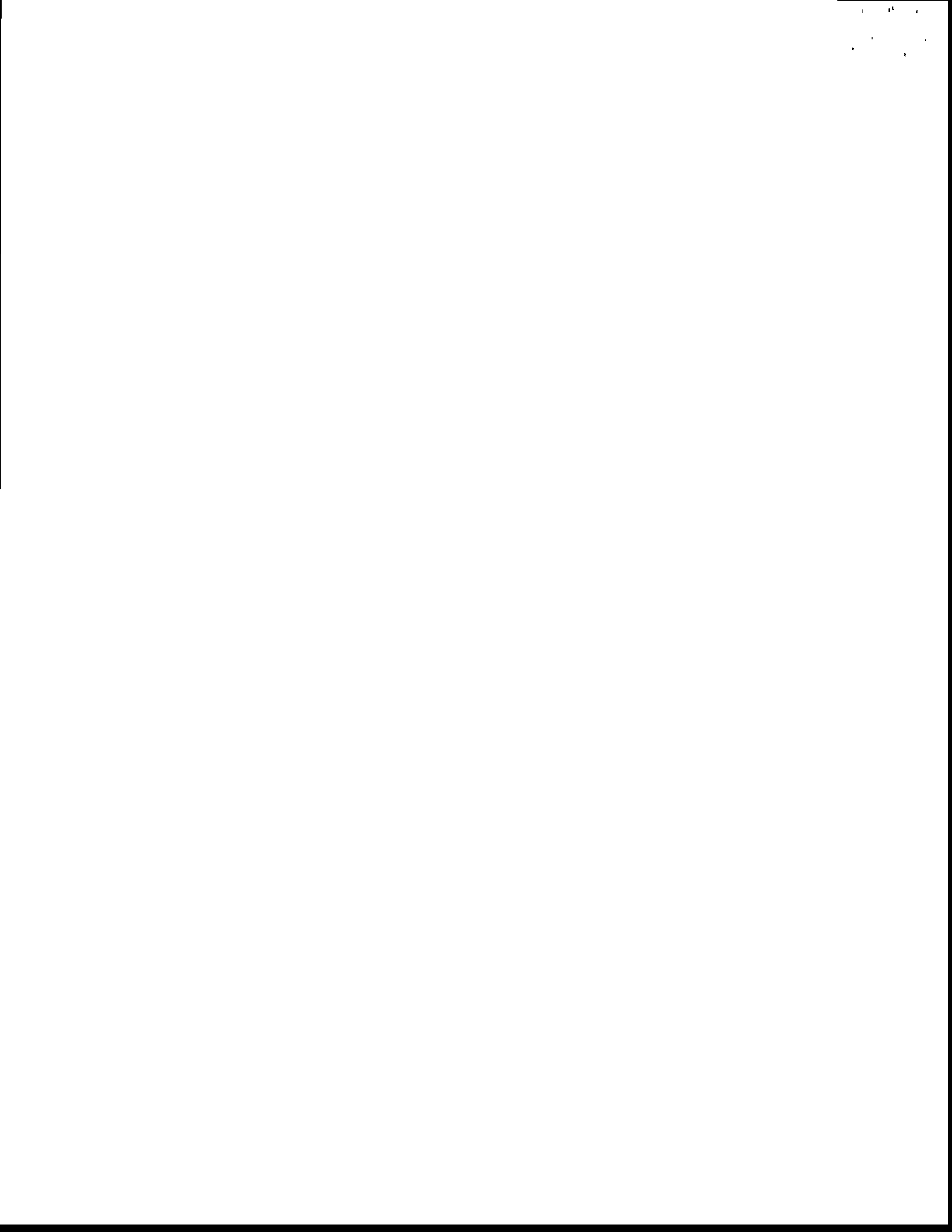

BLAINE
TECH SERVICES INC.

1680 ROGERS AVENUE
SAN JOSE, CALIFORNIA 95112
(408) 573-7771 FAX
(408) 573-0555 PHONE



September 11, 1998

Equilon Enterprises, L.L.C.
P.O. Box 8080
Martinez, CA 94553

Attn: Karen Petryna

Shell WIC #204-0079-0109
999 San Pablo Avenue
Albany, California

3rd Quarter 1998

Groundwater Monitoring Report 980820-G-1

Blaine Tech Services, Inc. performs environmental monitoring and documentation as an independent third party. Copies of our Monitoring Report along with the laboratory's Certified Analytical Report are forwarded to the consultant overseeing work at this site. Submission of the assembled documents to interested regulatory agencies will be made by the designated consultant.

Groundwater monitoring at this site was performed in accordance with Standard Operating Procedures provided to the interested regulatory agencies. If you have any questions about the work performed at this site please call me at (408) 573-0555 ext. 201.

Yours truly,

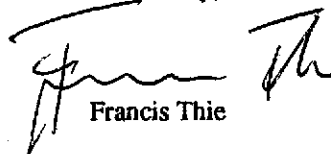

Francis Thie

attachments: Table of Well Gauging Data
Chain of Custody
Field Data Sheets
Certified Analytical Report

cc: Cambria Environmental Technology, Inc.
1144 65th Street, Suite C
Oakland, CA 94608-2411
Attn: Aubrey Cool

(Any professional evaluations or recommendations will be made by the consultant under separate cover.)

TABLE OF WELL GAUGING DATA

WELL I.D.	DATA COLLECTION DATE	MEASUREMENT REFERENCED TO	QUALITATIVE OBSERVATIONS (sheen)	DEPTH TO FIRST IMMISCIBLES LIQUID (FPZ) (feet)		THICKNESS OF IMMISCIBLES LIQUID ZONE (feet)		VOLUME OF IMMISCIBLES REMOVED (ml)	DEPTH TO WATER (feet)	DEPTH TO WELL BOTTOM (feet)
				IMMISCIBLES LIQUID (FPZ) (feet)	IMMISCIBLES LIQUID ZONE (feet)	IMMISCIBLES LIQUID ZONE (feet)	IMMISCIBLES LIQUID ZONE (feet)			
S-1	08/20/98	TOB	-	NONE	-	-	-	8.20	11.74	
S-2	08/20/98	TOB	ODOR	NONE	-	-	-	7.73	12.03	
S-3	08/20/98	TOB	-	NONE	-	-	-	6.98	12.11	
S-4	08/20/98	TOB	-	NONE	-	-	-	7.77	14.13	
S-6*	08/20/98	TOB	ODOR	NONE	-	-	-	6.04	15.04	
S-7	08/20/98	TOB	-	NONE	-	-	-	11.00	14.96	

* Sample DUP was a duplicate sample taken at well S-6.



SHELL OIL COMPANY
RETAIL ENVIRONMENTAL ENGINEERING - WEST

Site Address: 999 San Pablo Ave., Albany, CA

WIC#: 204-0079-0109

Shell Engineer: Alex Perez
 Phone No.: (510) 675-6168
 Fax #: 675-6172

Consultant Name & Address:
 Blaine Tech Services, Inc.
 1680 Rogers Ave., San Jose, CA 95112

Consultant Contact: Fran Thie
 Phone No.: (408) 573-0555
 Fax #: 573-7771

Comments:

Sampled by: ~~_____~~

Printed Name: *Morgan Gillies*

Sample ID	Date	Sludge	Soil	Water	Air	No. of conis.
S-1	9/20/98			X		3
S-2	09					
S-3	01					
S-6	01					
EB	05					
Dep	06					

CHAIN OF CUSTODY RECORD

Serial No: *78830-81*

Date: *8/20/98*
 Page 1 of 1

LAB: <i>Seprora</i>		CT/DI	TURF AROUND TIME
CHECK ONE (1) BOX ONLY			
G.W. Monitoring <input checked="" type="checkbox"/> 4441			24 hours <input type="checkbox"/>
Site Investigation <input type="checkbox"/> 4441			48 hours <input type="checkbox"/>
Soil Classify/Disposal <input type="checkbox"/> 4442			16 days <input checked="" type="checkbox"/> (Normal)
Water Classify/Disposal <input type="checkbox"/> 4443			Other <input type="checkbox"/>
Soil/Air Rem. or Sys. O & M <input type="checkbox"/> 4452			
Water Rem. or Sys. O & M <input type="checkbox"/> 4463			
Other <input type="checkbox"/>			

NOTE: Notify Lab as soon as possible of 24/48 hrs. TAT.

UST AGENCY: **9808E28**

Analysis Required

Analysis Required	Asbestos	Container Size	Preparation Used	Composite Y/N
TPH (EPA 8015 Mod. Gas)				
TPH (EPA 8015 Mod. Diesel)				
BTEX (EPA 8020/602)				
Volatile Organics (EPA 8240)				
Test for Disposal				
Combination TPH 8015 & BTEX 8020	X			
	X			
	X			
	X			
	X			
	X			

Relinquished By (signature):	Printed Name:	Date:	Time:
<i>[Signature]</i>	<i>Morgan Gillies</i>	<i>8/20/98</i>	<i>9:30</i>
Relinquished By (signature):	Printed Name:	Date:	Time:
<i>[Signature]</i>	<i>JOHN FRICK</i>	<i>8/21/98</i>	
Relinquished By (signature):	Printed Name:	Date:	Time:
<i>[Signature]</i>	<i>Ava DeMar</i>	<i>8/21/98</i>	<i>11:30</i>

THE LABORATORY MUST PROVIDE A COPY OF THIS CHAIN-OF-CUSTODY WITH INVOICE AND RESULTS



Sequoia Analytical

680 Chesapeake Drive
404 N. Wiget Lane
819 Striker Avenue, Suite 8
1455 McDowell Blvd. North, Ste. D

Redwood City, CA 94063
Walnut Creek, CA 94598
Sacramento, CA 95834
Petaluma, CA 94954

(650) 364-9600
(925) 988-9600
(916) 921-9600
(707) 792-1865

FAX (650) 364-9233
FAX (925) 988-9673
FAX (916) 921-0100
FAX (707) 792-0342

Blaine Tech Services
1680 Rogers Avenue
San Jose, CA 95112
Attention: Fran Thie

Project: Shell 999 San Pablo Ave.

Enclosed are the results from samples received at Sequoia Analytical on August 21, 1998.
The requested analyses are listed below:

<u>SAMPLE #</u>	<u>SAMPLE DESCRIPTION</u>	<u>DATE COLLECTED</u>	<u>TEST METHOD</u>
9808E28 -01	LIQUID, S-1	08/20/98	Purgeable TPH/BTEX/MTBE
9808E28 -02	LIQUID, S-2	08/20/98	Purgeable TPH/BTEX/MTBE
9808E28 -03	LIQUID, S-3	08/20/98	Purgeable TPH/BTEX/MTBE
9808E28 -04	LIQUID, S-6	08/20/98	Purgeable TPH/BTEX/MTBE
9808E28 -05	LIQUID, EB	08/20/98	Purgeable TPH/BTEX/MTBE
9808E28 -06	LIQUID, Dup	08/20/98	Purgeable TPH/BTEX/MTBE

Please contact me if you have any questions. In the meantime, thank you for the opportunity to work with you on this project.

Very truly yours,

SEQUOIA ANALYTICAL

Peggy Penner
Project Manager





Blaine Tech Services 1680 Rogers Avenue San Jose, CA 95112	Client Proj. ID: Shell 999 San Pablo Ave. Sample Descript: S-1 Matrix: LIQUID Analysis Method: 8015Mod/8020 Lab Number: 9808E28-01	Sampled: 08/20/98 Received: 08/21/98 Analyzed: 08/27/98 Reported: 09/01/98
--	--	---

QC Batch Number: GC082798BTEX21A
Instrument ID: GCHP21

Total Purgeable Petroleum Hydrocarbons (TPPH) with BTEX and MTBE

Analyte	Detection Limit ug/L	Sample Results ug/L
TPPH as Gas	50	390
Methyl t-Butyl Ether	2.5	14
Benzene	0.50	6.7
Toluene	0.50	N.D.
Ethyl Benzene	0.50	0.64
Xylenes (Total)	0.50	N.D.
Chromatogram Pattern:		C6-C12
Surrogates	Control Limits %	% Recovery
Trifluorotoluene	70 130	136 Q

Analytes reported as N.D. were not present above the stated limit of detection.

SEQUOIA ANALYTICAL - ELAP #1210

Peggy Penner
Project Manager





Blaine Tech Services 1680 Rogers Avenue San Jose, CA 95112	Client Proj. ID: Shell 999 San Pablo Ave. Sample Descript: S-2 Matrix: LIQUID Analysis Method: 8015Mod/8020 Lab Number: 9808E28-02	Sampled: 08/20/98 Received: 08/21/98 Analyzed: 08/28/98 Reported: 09/01/98
--	--	---

QC Batch Number: GC082898BTEX03A
Instrument ID: GCHP03

Total Purgeable Petroleum Hydrocarbons (TPPH) with BTEX and MTBE

Analyte	Detection Limit ug/L	Sample Results ug/L
TPPH as Gas	2500	22000
Methyl t-Butyl Ether	125	7300
Benzene	25	290
Toluene	25	44
Ethyl Benzene	25	420
Xylenes (Total)	25	410
Chromatogram Pattern:		C6-C12
Surrogates	Control Limits %	% Recovery
Trifluorotoluene	70 130	109

Analytes reported as N.D. were not present above the stated limit of detection.

SEQUOIA ANALYTICAL - ELAP #1210

Peggy Penner
Project Manager





Sequoia Analytical

680 Chesapeake Drive
404 N. Wiget Lane
819 Striker Avenue, Suite 8
1455 McDowell Blvd. North, Ste. D

Redwood City, CA 94063
Walnut Creek, CA 94598
Sacramento, CA 95834
Petaluma, CA 94954

(650) 364-9600
(925) 988-9600
(916) 921-9600
(707) 792-1865

FAX (650) 364-9233
FAX (925) 988-9673
FAX (916) 921-0100
FAX (707) 792-0342

Blaine Tech Services 1680 Rogers Avenue San Jose, CA 95112	Client Proj. ID: Shell 999 San Pablo Ave. Sample Descript: S-3 Matrix: LIQUID Analysis Method: 8015Mod/8020 Lab Number: 9808E28-03	Sampled: 08/20/98 Received: 08/21/98 Analyzed: 08/28/98 Reported: 09/01/98
Attention: Fran Thie		

QC Batch Number: GC082898BTEX03A
Instrument ID: GCHP03

Total Purgeable Petroleum Hydrocarbons (TPPH) with BTEX and MTBE

Analyte	Detection Limit ug/L	Sample Results ug/L
TPPH as Gas	250	4400
Methyl t-Butyl Ether	12	240
Benzene	2.5	67
Toluene	2.5	23
Ethyl Benzene	2.5	9.8
Xylenes (Total)	2.5	22
Chromatogram Pattern:		C6-C12
Surrogates	Control Limits %	% Recovery
Trifluorotoluene	70 130	107

Analytes reported as N.D. were not present above the stated limit of detection.

SEQUOIA ANALYTICAL - ELAP #1210

Peggy Penner
Project Manager





Blaine Tech Services
1680 Rogers Avenue
San Jose, CA 95112

Client Proj. ID: Shell 999 San Pablo Ave.
Sample Descript: S-6
Matrix: LIQUID
Analysis Method: 8015Mod/8020
Lab Number: 9808E28-04

Sampled: 08/20/98
Received: 08/21/98
Analyzed: 08/28/98
Reported: 09/01/98

Attention: Fran Thie

QC Batch Number: GC082898BTEX03A
Instrument ID: GCHP03

Total Purgeable Petroleum Hydrocarbons (TPPH) with BTEX and MTBE

Analyte	Detection Limit ug/L	Sample Results ug/L
TPPH as Gas	500	7800
Methyl t-Butyl Ether	25	110
Benzene	5.0	240
Toluene	5.0	38
Ethyl Benzene	5.0	16
Xylenes (Total)	5.0	39
Chromatogram Pattern:		C6-C12
Surrogates	Control Limits %	% Recovery
Trifluorotoluene	70 130	109

Analytes reported as M.D. were not present above the stated limit of detection.

SEQUOIA ANALYTICAL - ELAP #1210

Peggy Penner
Project Manager





Blaine Tech Services 1680 Rogers Avenue San Jose, CA 95112	Client Proj. ID: Shell 999 San Pablo Ave. Sample Descript: EB Matrix: LIQUID Analysis Method: 8015Mod/8020 Lab Number: 9808E28-05	Sampled: 08/20/98 Received: 08/21/98 Analyzed: 08/30/98 Reported: 09/01/98
--	---	---

QC Batch Number: GC082998BTEX30A
Instrument ID: GCHP30

Total Purgeable Petroleum Hydrocarbons (TPPH) with BTEX and MTBE

Analyte	Detection Limit ug/L	Sample Results ug/L
TPPH as Gas	50	N.D.
Methyl t-Butyl Ether	2.5	N.D.
Benzene	0.50	N.D.
Toluene	0.50	N.D.
Ethyl Benzene	0.50	N.D.
Xylenes (Total)	0.50	N.D.
Chromatogram Pattern:		
Surrogates	Control Limits %	% Recovery
Trifluorotoluene	70 130	95

Analytes reported as N.D. were not present above the stated limit of detection.

SEQUOIA ANALYTICAL - ELAP #1210

Peggy Renner
Project Manager





Sequoia Analytical

680 Chesapeake Drive
404 N. Wiget Lane
819 Striker Avenue, Suite 8
1455 McDowell Blvd. North, Ste. D

Redwood City, CA 94063
Walnut Creek, CA 94598
Sacramento, CA 95834
Petaluma, CA 94954

(650) 364-9600
(925) 988-9600
(916) 921-9600
(707) 792-1865

FAX (650) 364-9233
FAX (925) 988-9673
FAX (916) 921-0100
FAX (707) 792-0342

Blaine Tech Services 1680 Rogers Avenue San Jose, CA 95112	Client Proj. ID: Shell 999 San Pablo Ave. Sample Descript: Dup Matrix: LIQUID Analysis Method: 8015Mod/8020 Lab Number: 9808E28-06	Sampled: 08/20/98 Received: 08/21/98 Analyzed: 08/30/98 Reported: 09/01/98
--	--	---

QC Batch Number: GC082998BTEX21A
Instrument ID: GCHP21

Total Purgeable Petroleum Hydrocarbons (TPPH) with BTEX and MTBE

Analyte	Detection Limit ug/L	Sample Results ug/L
TPPH as Gas	500	8400
Methyl t-Butyl Ether	25	130
Benzene	5.0	270
Toluene	5.0	30
Ethyl Benzene	5.0	19
Xylenes (Total)	5.0	31
Chromatogram Pattern:		C6-C12
Surrogates	Control Limits %	% Recovery
Trifluorotoluene	70 130	191 Q

Analytes reported as N.D. were not present above the stated limit of detection.

SEQUOIA ANALYTICAL - ELAP #1210

Peggy Penner
Project Manager





Sequoia Analytical

680 Chesapeake Drive
404 N. Wiget Lane
819 Striker Avenue, Suite 8
1455 McDowell Blvd. North, Ste. D

Redwood City, CA 94063
Walnut Creek, CA 94598
Sacramento, CA 95834
Petaluma, CA 94954

(650) 364-9600
(925) 988-9600
(916) 921-9600
(707) 792-1865

FAX (650) 364-9233
FAX (925) 988-9673
FAX (916) 921-0100
FAX (707) 792-0342

Blaine Tech Services
1680 Rogers Ave.
San Jose, CA 95112
Attention: Fran Thie

Client Project ID: Shell 999 San Pablo Ave.

QC Sample Group: 9808E28-01

Reported: Sep 1, 1998

QUALITY CONTROL DATA REPORT

Matrix: Liquid
Method: EPA 8015
Analyst: D.B.

ANALYTE Gasoline

QC Batch #: GC082798BTEX21A

Sample No.: GW9808853-01

Date Prepared: 8/27/98
Date Analyzed: 8/27/98
Instrument I.D.#: GCHP21

Sample Conc., ug/L: N.D.
Conc. Spiked, ug/L: 250

Matrix Spike, ug/L: 360
% Recovery: 144

Matrix
pike Duplicate, ug/L: 350
% Recovery: 140

relative % Difference: 2.8

RPD Control Limits: 0-25

LCS Batch#: GWLCS082798A

Date Prepared: 8/27/98
Date Analyzed: 8/27/98
Instrument I.D.#: GCHP21

Conc. Spiked, ug/L: 250

LCS Recovery, ug/L: 290
LCS % Recovery: 116

Percent Recovery Control Limits:

MS/MSD	60-140
LCS	70-130

Quality Assurance Statement: All standard operating procedures and quality control requirements have been met.

SEQUOIA ANALYTICAL

Peggy Penner
Project Manager

Please Note:

The LCS is a control sample of known, interferent free matrix that is analyzed using the same reagents, preparation, and analytical methods employed for the samples. The matrix spike is an aliquot of sample fortified with known quantities of specific compounds and subjected to the entire analytical procedure. If the recovery of analytes from the matrix spike does not fall within specified control limits due to matrix interference, the LCS recovery is to be used to validate the batch.





Blaine Tech Services
1680 Rogers Ave.
San Jose, CA 95112
Attention: Fran Thie

Client Project ID: Shell 999 San Pablo Ave.

QC Sample Group: 9808E28-02-04

Reported: Sep 1, 1998

QUALITY CONTROL DATA REPORT

Matrix: Liquid
Method: EPA 8020
Analyst: A.M.

ANALYTE Benzene Toluene Ethylbenzene Xylenes

QC Batch #: GC082998BTEX03A

Sample No.: GW9808E17-08

Date Prepared:	8/29/98	8/29/98	8/29/98	8/29/98
Date Analyzed:	8/29/98	8/29/98	8/29/98	8/29/98
Instrument I.D.#:	GCHP03	GCHP03	GCHP03	GCHP03
Sample Conc., ug/L:	N.D.	N.D.	N.D.	N.D.
Conc. Spiked, ug/L:	10	10	10	30
Matrix Spike, ug/L:	10.0	9.7	9.6	30
% Recovery:	100.0	97	96	100.0
Matrix Duplicate, ug/L:	10.0	10.0	10.0	31
% Recovery:	100.0	100.0	100.0	103
Relative % Difference:	0.0	3.0	4.1	3.0
RPD Control Limits:	0-25	0-25	0-25	0-25

LCS Batch#: GWLCS082998A

Date Prepared:	8/29/98	8/29/98	8/29/98	8/29/98
Date Analyzed:	8/29/98	8/29/98	8/29/98	8/29/98
Instrument I.D.#:	GCHP03	GCHP03	GCHP03	GCHP03
Conc. Spiked, ug/L:	10	10	10	30
LCS Recovery, ug/L:	9.8	9.6	9.6	30
LCS % Recovery:	98	96	96	100.0

Percent Recovery Control Limits:

MS/MSD	60-140	60-140	60-140	60-140
LCS	70-130	70-130	70-130	70-130

Quality Assurance Statement: All standard operating procedures and quality control requirements have been met.

Please Note:

The LCS is a control sample of known, interferent free matrix that is analyzed using the same reagents, preparation, and analytical methods employed for the samples. The matrix spike is an aliquot of sample fortified with known quantities of specific compounds and subjected to the entire analytical procedure. If the recovery of analytes from the matrix spike does not fall within specified control limits due to matrix interference, the LCS recovery is to be used to validate the batch.

SEQUOIA ANALYTICAL

Peggy Fenner
Project Manager





**Sequoia
Analytical**

680 Chesapeake Drive
404 N. Wiget Lane
819 Striker Avenue, Suite B
1455 McDowell Blvd. North, Ste. D

Redwood City, CA 94063
Walnut Creek, CA 94598
Sacramento, CA 95834
Petaluma, CA 94954

(650) 364-9600
(925) 988-9600
(916) 921-9600
(707) 792-1865

FAX (650) 364-9233
FAX (925) 988-9673
FAX (916) 921-0100
FAX (707) 792-0342

Blaine Tech Services
1680 Rogers Avenue
San Jose, CA 95112
Attention: Fran Thie

Client Proj. ID: Shell 999 San Pablo Ave.

Received: 08/21/98

Lab Proj. ID: 9808E28

Reported: 09/01/98

LABORATORY NARRATIVE

In order to properly interpret this report, it must be reproduced in its entirety. This report contains a total of _____ pages including the laboratory narrative, sample results, quality control, and related documents as required (cover page, COC, raw data, etc.).

Q = Surrogate outside QC limits for sample 9808E28-06 due to matrix effect.

SEQUOIA ANALYTICAL

Peggy Penner
Project Manager



