



Texaco Refining
and Marketing Inc

108 Cutting Boulevard
Richmond CA 94804

97 AUG 12 PM 3:02
Blaine Tech
Professional
97 AUG 12 PM 3:02

August 4, 1997

ENV - STUDIES, SURVEYS, & REPORTS
1127 Lincoln Avenue, Alameda, California
Quarterly Monitoring Report

STIP 3566

LS/back

1127 Lincoln Ave
Alameda 94501

Ms. Juliet Shin
Alameda County
Hazardous Materials
1131 Harbor Bay Pky
Alameda, CA 94502-6577

Dear Ms. Shin:

This letter presents the results of groundwater monitoring and sampling conducted by Blaine Tech Services, Inc. on May 2, 1997, at the site referenced above (see Plate 1, Site Vicinity Map). Based on groundwater level measurements, the areal hydraulic gradient was estimated to be north-northwest (see Plate 2, Groundwater Gradient Map). TPHg and benzene concentrations are shown on Plate 3. Tables 1 and 2 list historical groundwater monitoring data and analytical results, respectively.

The certified analytical report, chain-of-custody, field data sheets, bill of lading and quarterly summary report are in the Appendix. Texaco's Standard Operating Procedures may be found in the first quarter, 1995 monitoring report.

If you have any questions or comments regarding this site, please call the Texaco Project Coordinator, Ms. Karen Petryna at (510) 236-9139.

Best Regards,
Texaco Refining and Marketing Inc

Rebecca Digerness
Groundwater Program Analyst



Karen E. Petryna, P. E.
Civil Engineer
Environment, Health and Safety

RBD hs

C:\QMR\1127L QMR LET

Enclosure

cc: Mr. Richard Hiatt
CRWQCB - San Francisco Bay Region
2101 Webster St., Suite 500
Oakland, CA 94621

Mr. Leo Pagano
1127 Lincoln Avenue
Alameda, CA 94602

Mr. Sarkis Soghomonian
Kaprealian Engineering, Inc.
2401 Stanwell Dr., Suite 400
Concord, CA 94520

RAOFile-UCPFile (w/enclosure)

A handwritten signature in black ink, appearing to be "R. Soghomonian", with a stylized flourish at the end.

GROUNDWATER MONITORING AND SAMPLING
Second Quarter, 1997
at the
Former Texaco Service Station
1127 Lincoln Avenue
Alameda, California

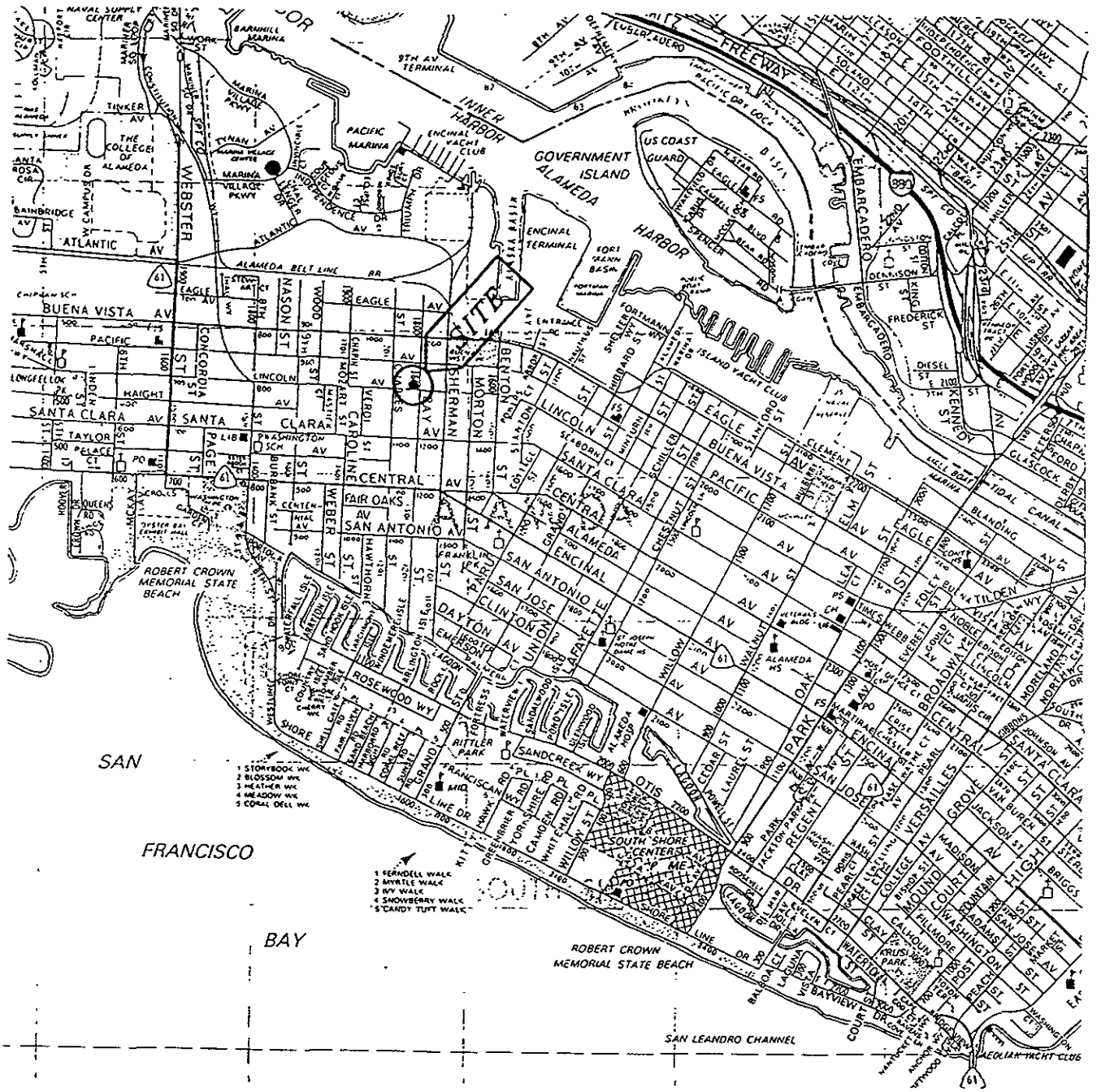

SAN

FRANCISCO

BAY

- 1 STORVICK WALK
- 2 BLOSSOM WALK
- 3 HEATHER WALK
- 4 MEADOW WALK
- 5 CORAL OAK WALK

- 1 BERDELL WALK
- 2 MYRTLE WALK
- 3 IVY WALK
- 4 SNOWBERRY WALK
- 5 CANDY TUTT WALK

SOURCE:

1993 THE THOMAS GUIDE
ALAMEDA COUNTY PAGE 14 (B3)



TEXACO

REFINING AND MARKETING INC.
TEXACO ENVIRONMENTAL SERVICES

PLATE 1

SITE VICINITY MAP
FORMER TEXACO SERVICE STATION
1177 LINCOLN ST. - 945 ST.
ALAMEDA, CALIFORNIA

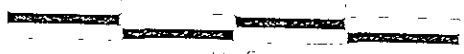

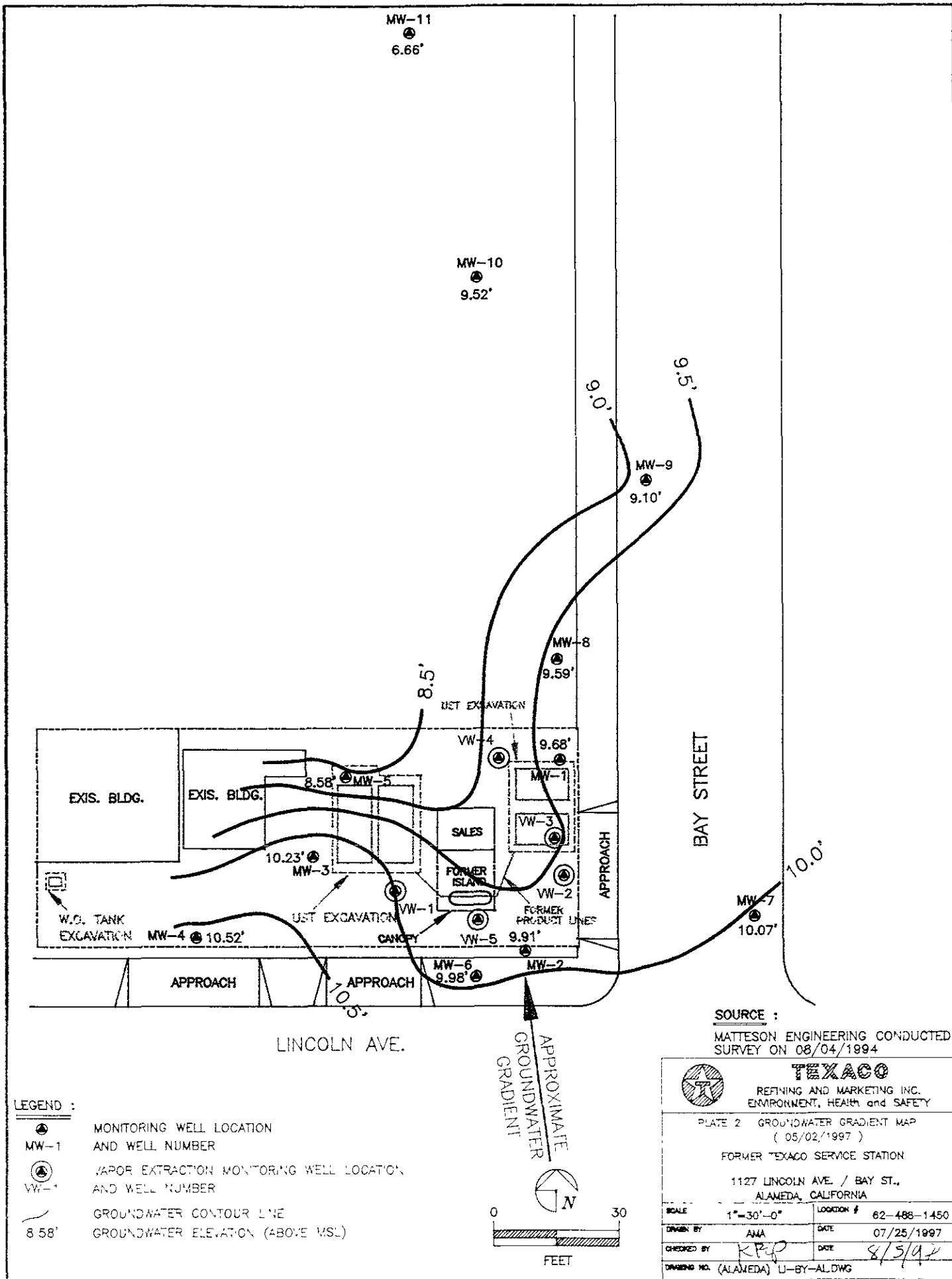

SOURCE :
 MATTESON ENGINEERING CONDUCTED
 SURVEY ON 08/04/1994

TEXACO
 REFINING AND MARKETING INC.
 ENVIRONMENT, HEALTH and SAFETY

PLATE 2 GROUNDWATER GRADIENT MAP
 (05/02/1997)

FORMER TEXACO SERVICE STATION

1127 LINCOLN AVE. / BAY ST.,
 ALAMEDA, CALIFORNIA

SCALE 1"=30'-0"	LOCATION # 62-488-1450
DRAWN BY AMA	DATE 07/25/1997
CHECKED BY KPP	DATE 8/5/97
DRAWING NO. (ALAMEDA) U-BY-ALDWG	

- LEGEND :
- MONITORING WELL LOCATION AND WELL NUMBER
 - VAPOR EXTRACTION MONITORING WELL LOCATION AND WELL NUMBER
 - GROUNDWATER CONTOUR LINE
 - 8.58' GROUNDWATER ELEVATION (ABOVE MSL)

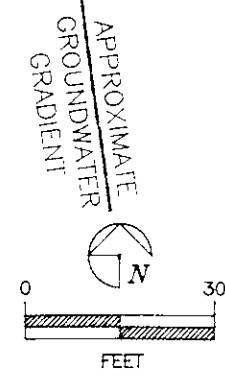

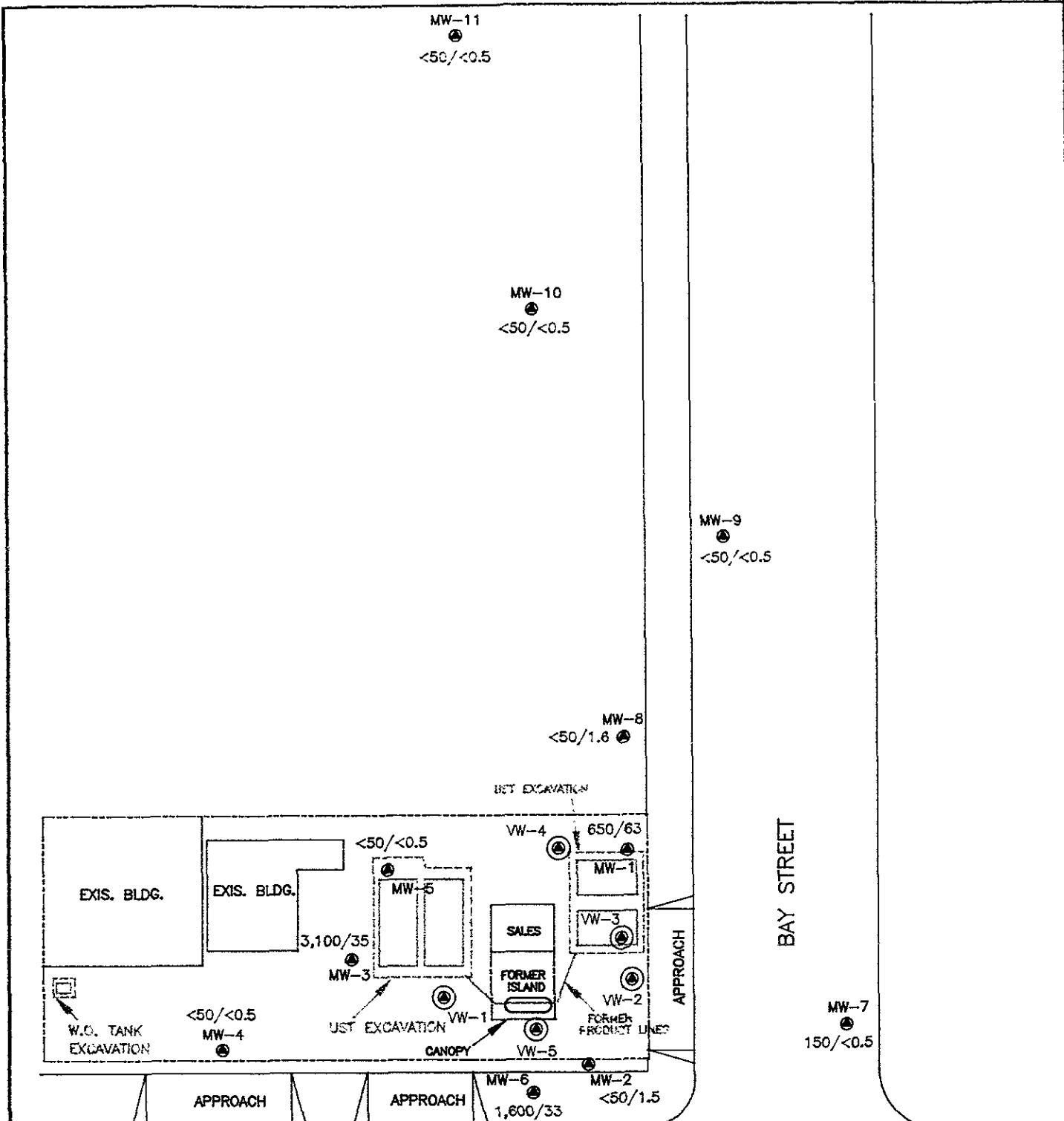

SOURCE :
 MATTESON ENGINEERING CONDUCTED SURVEY ON 08/04/1994

TEXACO
 REFINING AND MARKETING INC.
 ENVIRONMENT, HEALTH and SAFETY

PLATE 3 : TPH1/BENZENE CONCENTRATION IN GROUNDWATER
 (05/02/1997)

FORMER TEXACO SERVICE STATION

1127 LINCOLN AVE. / BAY ST.,
 ALAMEDA, CALIFORNIA

SCALE	1"=30'-0"	LOCATION #	62-488-1450
DRAWN BY	ANA	DATE	07/25/1997
CHECKED BY	KTP	DATE	8/5/97
DRAWING NO. (ALAMEDA) LI-BY-AL.DWG			

LEGEND :

- MONITORING WELL LOCATION AND WELL NUMBER
- ⊙ VAPOR EXTRACTION MONITORING WELL LOCATION AND WELL NUMBER

<50/<0.5 TPH1/BENZENE CONCENTRATION IN GROUNDWATER (ppb)

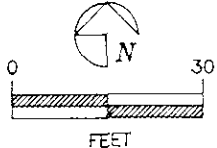

Table 1
Groundwater Elevation Data
1127 Lincoln Avenue, Alameda, CA

Well Number	Date Gauged	Top of Casing Elevation (feet, MSL)	Depth to Water (feet, TOC)	Groundwater Elevation (feet, MSL)
MW-1	1/26/1993	16.14	5.63	10.51
MW-1	2/4/1993	16.14	6.02	10.12
MW-1	3/9/1993	16.14	5.92	10.22
MW-1	5/6/1993	16.14	6.76	9.38
MW-1	6/15/1993	16.14	6.81	9.33
MW-1	7/26/1993	16.14	Inaccessible - VES	
MW-1	8/31/1993	16.14	Inaccessible - VES	
MW-1	9/27/1993	16.14	Inaccessible - VES	
MW-1	10/19/1993	16.14	Inaccessible - VES	
MW-1	11/15/1993	16.14	Inaccessible - VES	
MW-1	12/17/1993	16.14	Inaccessible - VES	
MW-1	2/7/1994	16.14	Inaccessible - VES	
MW-1	5/20/1994	16.14	Inaccessible - VES	
MW-1	8/22/1994	16.14	7.78	8.36
MW-1	11/2/1994	16.14	Inaccessible - VES	
MW-1	2/14/1995	16.14	15.16	0.98
MW-1	5/19/1995	16.14	13.90	2.24
MW-1	8/22/1995	16.14	7.06	9.08
MW-1	10/25/1995	16.14	Inaccessible	
MW-1	2/9/1996	16.14	Inaccessible	
MW-1	4/11/1996	16.14	Inaccessible	
MW-1	8/1/1996	16.14	Inaccessible	
MW-1	11/11/1996	16.14	Inaccessible	
MW-1	2/4/1997	16.14	5.40	10.74
MW-1	5/2/1997	16.14	6.46	9.68
MW-2	1/26/1993	16.84	6.29	10.55
MW-2	2/4/1993	16.84	6.60	10.24
MW-2	3/9/1993	16.84	6.36	10.48
MW-2	5/6/1993	16.84	6.37	10.47
MW-2	6/15/1993	16.84	7.04	9.80
MW-2	7/26/1993	16.84	Inaccessible - VES	
MW-2	8/31/1993	16.84	Inaccessible - VES	
MW-2	9/27/1993	16.84	Inaccessible - VES	
MW-2	10/19/1993	16.84	Inaccessible - VES	
MW-2	11/15/1993	16.84	Inaccessible - VES	
MW-2	12/17/1993	16.84	Inaccessible - VES	
MW-2	2/7/1994	16.84	Inaccessible - VES	
MW-2	5/20/1994	16.84	Inaccessible - VES	
MW-2	8/22/1994	16.84	8.08	8.76
MW-2	11/2/1994	16.84	Inaccessible - VES	
MW-2	2/14/1995	16.84	Inaccessible - VES	
MW-2	5/19/1995	16.84	11.77	5.07
MW-2	8/22/1995	16.84	7.22	9.62
MW-2	10/25/1995	16.84	12.11	4.73
MW-2	2/9/1996	16.84	Inaccessible	
MW-2	4/11/1996	16.84	11.20	5.64
MW-2	8/1/1996	16.84	7.00	9.84

Table 1
Groundwater Elevation Data
1127 Lincoln Avenue, Alameda, CA

Well Number	Date Gauged	Top of Casing Elevation (feet, MSL)	Depth to Water (feet, TOC)	Groundwater Elevation (feet, MSL)
MW-2	11/11/1996	16.84	Inaccessible	
MW-2	2/4/1997	16.84	5.48	11.36
MW-2	5/2/1997	16.84	6.93	9.91
MW-3	1/26/1993	16.86	5.82	11.04
MW-3	2/4/1993	16.86	6.01	10.85
MW-3	3/9/1993	16.86	5.88	10.98
MW-3	5/6/1993	16.86	6.38	10.48
MW-3	6/15/1993	16.86	Inaccessible - VES	
MW-3	7/26/1993	16.86	7.22	9.64
MW-3	8/31/1993	16.86	7.87	8.99
MW-3	9/27/1993	16.86	8.58	8.28
MW-3	10/19/1993	16.86	9.13	7.73
MW-3	11/15/1993	16.86	8.84	8.02
MW-3	12/17/1993	16.86	7.80	9.06
MW-3	2/7/1994	16.86	8.43	8.43
MW-3	5/20/1994	16.86	6.79	10.07
MW-3	8/22/1994	16.86	8.32	8.54
MW-3	11/2/1994	16.86	10.98	5.88
MW-3	2/14/1995	16.86	7.93	8.93
MW-3	5/19/1995	16.86	8.44	8.42
MW-3	8/22/1995	16.86	7.54	9.32
MW-3	10/25/1995	16.86	9.03	7.83
MW-3	2/9/1996	16.86	7.05	9.81
MW-3	4/11/1996	16.86	7.44	9.42
MW-3	8/1/1996	16.86	7.08	9.78
MW-3	11/11/1996	16.86	7.84	9.02
MW-3	2/4/1997	16.86	5.17	11.69
MW-3	5/2/1997	16.86	6.63	10.23
MW-4	1/26/1993	17.13	5.91	11.22
MW-4	2/4/1993	17.13	6.14	10.99
MW-4	3/9/1993	17.13	5.81	11.32
MW-4	5/6/1993	17.13	6.49	10.64
MW-4	6/15/1993	17.13	6.34	10.79
MW-4	7/26/1993	17.13	7.29	9.84
MW-4	8/31/1993	17.13	8.02	9.11
MW-4	9/27/1993	17.13	Inaccessible - Car On Well	
MW-4	10/19/1993	17.13	9.14	7.99
MW-4	11/15/1993	17.13	9.01	8.12
MW-4	12/17/1993	17.13	7.91	9.22
MW-4	2/7/1994	17.13	8.02	9.11
MW-4	5/20/1994	17.13	6.85	10.28
MW-4	8/22/1994	17.13	8.48	8.65
MW-4	11/2/1994	17.13	10.52	6.61
MW-4	2/14/1995	17.13	6.99	10.14
MW-4	5/19/1995	17.13	7.61	9.52
MW-4	8/22/1995	17.13	7.62	9.51

Table 1
Groundwater Elevation Data
1127 Lincoln Avenue, Alameda, CA

Well Number	Date Gauged	Top of Casing Elevation (feet, MSL)	Depth to Water (feet, TOC)	Groundwater Elevation (feet, MSL)
MW-4	10/25/1995	17.13	8.62	8.51
MW-4	2/9/1996	17.13	6.60	10.53
MW-4	4/11/1996	17.13	6.54	10.59
MW-4	8/1/1996	17.13	7.04	10.09
MW-4	11/11/1996	17.13	7.95	9.18
MW-4	2/4/1997	17.13	5.24	11.89
MW-4	5/2/1997	17.13	6.61	10.52
MW-5	1/26/1993	15.59	Not Monitored	
MW-5	2/4/1993	15.59	Inaccessible	
MW-5	3/9/1993	15.59	5.45	10.14
MW-5	5/6/1993	15.59	6.00	9.59
MW-5	6/15/1993	15.59	7.81	7.78
MW-5	7/26/1993	15.59	Inaccessible - VES	
MW-5	8/31/1993	15.59	Inaccessible - VES	
MW-5	9/27/1993	15.59	Inaccessible - VES	
MW-5	10/19/1993	15.59	Inaccessible - VES	
MW-5	11/15/1993	15.59	Inaccessible - VES	
MW-5	12/17/1993	15.59	Inaccessible - VES	
MW-5	2/7/1994	15.59	Inaccessible - VES	
MW-5	5/20/1994	15.59	Inaccessible - VES	
MW-5	8/22/1994	15.59	7.27	8.32
MW-5	11/2/1994	15.59	Inaccessible - VES	
MW-5	2/14/1995	15.59	Inaccessible - VES	
MW-5	5/19/1995	15.59	11.55	4.04
MW-5	8/22/1995	15.59	6.02	9.57
MW-5	10/25/1995	15.59	11.05	4.54
MW-5	2/9/1996	15.59	6.70	8.89
MW-5	4/11/1996	15.59	12.21	3.38
MW-5	8/1/1996	15.59	2.80	12.79
MW-5	11/11/1996	15.59	Inaccessible	
MW-5	2/4/1997	15.59	Inaccessible	
MW-5	5/2/1997	15.59	7.01	8.58
MW-6	1/26/1993	17.05	6.63	10.42
MW-6	2/4/1993	17.05	6.48	10.57
MW-6	3/9/1993	17.05	6.68	10.37
MW-6	5/6/1993	17.05	6.93	10.12
MW-6	6/15/1993	17.05	7.00	10.05
MW-6	7/26/1993	17.05	7.25	9.80
MW-6	8/31/1993	17.05	7.83	9.22
MW-6	9/27/1993	17.05	8.38	8.67
MW-6	10/19/1993	17.05	8.76	8.29
MW-6	11/15/1993	17.05	8.65	8.40
MW-6	12/17/1993	17.05	7.78	9.27
MW-6	2/7/1994	17.05	7.90	9.15
MW-6	5/20/1994	17.05	6.95	10.10
MW-6	8/22/1994	17.05	8.17	8.88

Table 1
Groundwater Elevation Data
1127 Lincoln Avenue, Alameda, CA

Well Number	Date Gauged	Top of Casing Elevation (feet, MSL)	Depth to Water (feet, TOC)	Groundwater Elevation (feet, MSL)
MW-6	11/2/1994	17.05	10.56	6.49
MW-6	2/14/1995	17.05	8.08	8.97
MW-6	5/19/1995	17.05	8.51	8.54
MW-6	8/22/1995	17.05	7.50	9.55
MW-6	10/25/1995	17.05	8.61	8.44
MW-6	2/9/1996	17.05	7.26	9.79
MW-6	4/11/1996	17.05	7.41	9.64
MW-6	8/1/1996	17.05	7.10	9.95
MW-6	11/11/1996	17.05	8.04	9.01
MW-6	2/4/1997	17.05	6.10	10.95
MW-6	5/2/1997	17.05	7.07	9.98
MW-7	1/26/1993	16.65	6.53	10.12
MW-7	2/4/1993	16.65	6.40	10.25
MW-7	3/9/1993	16.65	6.52	10.13
MW-7	5/6/1993	16.65	Inaccessible	
MW-7	6/15/1993	16.65	6.69	9.96
MW-7	7/26/1993	16.65	Inaccessible	
MW-7	8/31/1993	16.65	Inaccessible	
MW-7	9/27/1993	16.65	7.97	8.68
MW-7	10/19/1993	16.65	8.24	8.41
MW-7	11/15/1993	16.65	8.22	8.43
MW-7	12/17/1994	16.65	Inaccessible	
MW-7	2/7/1994	16.65	Inaccessible	
MW-7	5/20/1994	16.65	Inaccessible	
MW-7	8/22/1994	16.65	7.78	8.87
MW-7	11/2/1994	16.65	9.70	6.95
MW-7	2/14/1995	16.65	Inaccessible	
MW-7	5/19/1995	16.65	7.33	9.32
MW-7	8/22/1995	16.65	6.72	9.93
MW-7	10/25/1995	16.65	Inaccessible	
MW-7	2/9/1996	16.65	7.06	9.59
MW-7	4/11/1996	16.65	Inaccessible	
MW-7	8/1/1996	16.65	6.94	9.71
MW-7	11/11/1996	16.65	Inaccessible	
MW-7	2/4/1997	16.65	Inaccessible	
MW-7	5/2/1997	16.65	6.58	10.07
MW-8	1/26/1993	15.87	5.30	10.57
MW-8	2/4/1993	15.87	5.62	10.25
MW-8	3/9/1993	15.87	5.56	10.31
MW-8	5/6/1993	15.87	5.99	9.88
MW-8	6/15/1993	15.87	6.32	9.55
MW-8	7/26/1993	15.87	6.75	9.12
MW-8	8/31/1993	15.87	7.35	8.52
MW-8	9/27/1993	15.87	7.86	8.01
MW-8	10/19/1993	15.87	8.27	7.60
MW-8	11/15/1993	15.87	8.17	7.70

Table 1
Groundwater Elevation Data
1127 Lincoln Avenue, Alameda, CA

Well Number	Date Gauged	Top of Casing Elevation (feet, MSL)	Depth to Water (feet, TOC)	Groundwater Elevation (feet, MSL)
MW-8	12/17/1993	15.87	7.14	8.73
MW-8	2/7/1994	15.87	7.26	8.61
MW-8	5/20/1994	15.87	6.17	9.70
MW-8	8/22/1994	15.87	7.63	8.24
MW-8	11/2/1994	15.87	10.16	5.71
MW-8	2/14/1995	15.87	7.32	8.55
MW-8	5/19/1995	15.87	7.83	8.04
MW-8	8/22/1995	15.87	6.98	8.89
MW-8	10/25/1995	15.87	8.16	7.71
MW-8	2/9/1996	15.87	4.89	10.98
MW-8	4/11/1996	15.87	8.48	7.39
MW-8	8/1/1996	15.87	6.60	9.27
MW-8	11/11/1996	15.87	7.28	8.59
MW-8	2/4/1997	15.87	5.39	10.48
MW-8	5/2/1997	15.87	6.28	9.59
MW-9	8/22/1995	14.44	6.00	8.44
MW-9	10/25/1995	14.44	6.71	7.73
MW-9	2/9/1996	14.44	4.87	9.57
MW-9	4/11/1996	14.44	5.40	9.04
MW-9	8/1/1996	14.44	5.69	8.75
MW-9	11/11/1996	14.44	6.44	8.00
MW-9	2/4/1997	14.44	4.30	10.14
MW-9	5/2/1997	14.44	5.34	9.10
MW-10	8/22/1995	15.04	6.86	8.18
MW-10	10/25/1995	15.04	7.91	7.13
MW-10	2/9/1996	15.04	4.45	10.59
MW-10	4/11/1996	15.04	4.61	10.43
MW-10	8/1/1996	15.04	6.25	8.79
MW-10	11/11/1996	15.04	7.42	7.62
MW-10	2/4/1997	15.04	4.00	11.04
MW-10	5/2/1997	15.04	5.52	9.52
MW-11	8/22/1995	10.61	5.12	5.49
MW-11	10/25/1995	10.61	Inaccessible	
MW-11	2/9/1996	10.61	2.73	7.88
MW-11	4/11/1996	10.61	3.00	7.61
MW-11	8/1/1996	10.61	4.66	5.95
MW-11	11/11/1996	10.61	5.85	4.76
MW-11	2/4/1997	10.61	2.20	8.41
MW-11	5/2/1997	10.61	3.95	6.66
VW-1	2/19/1992	16.83		
VW-1	1/26/93 - 5/2/97	16.83	Not Monitored	
VW-2	2/19/1992	17.00		
VW-2	1/26/93 - 5/2/97	17.00	Not Monitored	

Table 1
Groundwater Elevation Data
1127 Lincoln Avenue, Alameda, CA

Well Number	Date Gauged	Top of Casing Elevation (feet, MSL)	Depth to Water (feet, TOC)	Groundwater Elevation (feet, MSL)
VW-3	2/19/1992	16.94		
VW-3	1/26/93 - 5/2/97	16.94	Not Monitored	
VW-4	2/19/1992	16.81	5.76	11.05
VW-4	1/26/93 - 5/2/97	16.81	Not Monitored	
VW-5	2/19/1992	17.20		
VW-5	1/26/93 - 5/2/97	17.20	Not Monitored	
MSL = Mean Sea Level				
TOC = Top of Casing				
VES = Vapor Extraction System				

Table 2
Groundwater Analytical Data
1127 Lincoln Avenue, Alameda, CA

Well Number	Date Sampled	TPHg (ppb)	Benzene (ppb)	Toluene (ppb)	Ethyl-Benzene (ppb)	Xylenes (ppb)	MTBE (ppb)	
MW-1	2/4/1993	120	22	3.1	3.3	10	NA	
MW-1	5/6/1993	710	320	3.1	4.2	20	NA	
MW-1	9/28/1993	Not Accessible - Connected to Vapor Extraction System						
MW-1	11/15/1993	Not Accessible - Connected to Vapor Extraction System						
MW-1	2/7/1994	Not Accessible - Connected to Vapor Extraction System						
MW-1	5/20/1994	Not Accessible - Connected to Vapor Extraction System						
MW-1	8/22/1994	Not Accessible - Connected to Vapor Extraction System						
MW-1	11/3/1994	<50	<0.5	<0.5	<0.5	<0.5	NA	
MW-1	2/14/1995	350	40	1.6	15	31	NA	
MW-1	5/19/1995	220	35	2.4	7.2	23	NA	
MW-1	8/22/1995	330	44	1.2	14	21	<10	
MW-1	10/25/1995	<50	1.6	<0.5	<0.5	<0.5	NA	
MW-1	2/9/1996	160	3.2	1.5	0.89	2.7	NA	
MW-1	4/11/1996	1,300	300	85	25	110	NA	
MW-1	8/1/1996	3,700	1,100	80	46	210	NA	
MW-1	11/11/1996	Not Sampled						
MW-1	2/4/1997	Not Sampled						
MW-1	5/2/1997	650	63	<3	4.3	2.2	<30	
MW-2	2/4/1993	430	45	0.5	20	30	NA	
MW-2	5/6/1993	2,000	460	2.4	160	66	NA	
MW-2	9/28/1993	Not Accessible - Connected to Vapor Extraction System						
MW-2	11/15/1993	Not Accessible - Connected to Vapor Extraction System						
MW-2	2/7/1994	Not Accessible - Connected to Vapor Extraction System						
MW-2	5/20/1994	Not Accessible - Connected to Vapor Extraction System						
MW-2	8/22/1994	Not Accessible - Connected to Vapor Extraction System						
MW-2	11/2/1994	Not Sampled						
MW-2	2/14/1995	Not Sampled						
MW-2	5/19/1995	580	75	19	5.1	30	NA	
MW-2	8/22/1995	1,200	130	8.3	84	86	<10	
MW-2	10/25/1995	350	79	1.2	55	13	NA	
MW-2	2/9/1996	<50	1.5	0.53	1.1	1.5	NA	
MW-2	4/11/1996	80	1.5	<0.5	<0.5	<0.5	NA	
MW-2	8/1/1996	330	42	0.55	20	8.1	NA	
MW-2	11/11/1996	Not Sampled						
MW-2	2/4/1997	Not Sampled						
MW-2	5/2/1997	<50	1.5	<0.5	<0.5	0.50	<30	
MW-3	2/4/1993	2,900	180	13	210	350	NA	
MW-3	5/6/1993	2,700	270	6.2	300	720	NA	
MW-3	9/28/1993	1,800	92	1.7	99	240	NA	
MW-3	11/15/1993	1,900	100	2.4	85	280	NA	
MW-3	2/7/1994	1,400	69	3.3	100	320	NA	
MW-3	5/20/1994	1,100	64	19	120	180	NA	
MW-3	8/22/1994	77	4.3	<0.5	2.0	5.6	NA	
MW-3	11/2/1994	<50	0.75	<0.5	<0.5	<0.5	NA	
MW-3	2/14/1995	1,300	24	5.2	85	360	NA	
MW-3	5/19/1995	5,300	98	28	650	1,700	NA	

Table 2
Groundwater Analytical Data
1127 Lincoln Avenue, Alameda, CA

Well Number	Date Sampled	TPHg (ppb)	Benzene (ppb)	Toluene (ppb)	Ethyl-Benzene (ppb)	Xylenes (ppb)	MTBE (ppb)	
MW-3	8/22/1995	700	4.1	1.1	50	72	<10	
MW-3	10/25/1995	<50	2.4	<0.5	<0.5	1.6	NA	
MW-3	2/9/1996	<50	<0.5	<0.5	<0.5	<0.5	NA	
MW-3	4/11/1996	2,000	11	3.9	190	500	NA	
MW-3	8/1/1996	1,500	8.4	<0.5	160	150	NA	
MW-3	11/11/1996	<50	<0.5	<0.5	<0.5	<0.5	<30	
MW-3	2/4/1997	1,500	12	1.3	210	330	<30	
MW-3	5/2/1997	3,100	35	<3	520	540	<30	
MW-4	2/4/1993	<50	<0.5	<0.5	<0.5	<0.5	NA	
MW-4	5/6/1993	<50	1.6	<0.5	1	2.1	NA	
MW-4	9/28/1993	Not Accessible - Auto on Well						
MW-4	11/15/1993	<50	<0.5	<0.5	<0.5	<0.5	NA	
MW-4	2/7/1994	<50	<0.5	<0.5	<0.5	2.6	NA	
MW-4	5/20/1994	82	6.2	7.6	3.3	17	NA	
MW-4	8/22/1994	<50	<0.5	<0.5	<0.5	<0.5	NA	
MW-4	11/2/1994	<50	<0.5	0.56	<0.5	<0.5	NA	
MW-4	2/14/1995	<50	<0.5	<0.5	<0.5	<0.5	NA	
MW-4	5/19/1995	66	0.77	0.63	0.87	3.6	NA	
MW-4	8/22/1995	<50	<0.5	<0.5	<0.5	<0.5	<10	
MW-4	10/25/1995	<50	<0.5	<0.5	<0.5	<0.5	NA	
MW-4	2/9/1996	<50	<0.5	<0.5	<0.5	<0.5	NA	
MW-4	4/11/1996	Not Sampled						
MW-4	8/1/1996	<50	<0.5	<0.5	<0.5	<0.5	NA	
MW-4	11/11/1996	<50	<0.5	<0.5	<0.5	<0.5	<30	
MW-4	2/4/1997	<50	<0.5	<0.5	<0.5	<0.5	<30	
MW-4	5/2/1997	<50	<0.5	<0.5	<0.5	<0.5	<30	
MW-5	2/4/1993	Not Sampled						
MW-5	5/6/1993	6,200	460	980	300	1,200	NA	
MW-5	9/28/1993	Not Accessible - Connected to Vapor Extraction System						
MW-5	11/15/1993	Not Accessible - Connected to Vapor Extraction System						
MW-5	2/7/1994	Not Accessible - Connected to Vapor Extraction System						
MW-5	5/20/1994	Not Accessible - Connected to Vapor Extraction System						
MW-5	8/22/1994	Not Accessible - Connected to Vapor Extraction System						
MW-5	11/3/1994	5,700	800	400	4.7	600	NA	
MW-5	2/14/1995	1,300	290	76	21	140	NA	
MW-5	5/19/1995	600	83	20	5.7	33	NA	
MW-5	8/22/1995	8,100	650	720	54	1,700	<50	
MW-5	10/25/1995	1,500	290	85	15	170	NA	
MW-5	2/9/1996	1,000	120	49	26	130	NA	
MW-5	4/11/1996	210	5.7	<0.5	9.2	22	NA	
MW-5	8/1/1996	86	<0.5	<0.5	<0.5	5.3	NA	
MW-5	11/11/1996	Not Sampled						
MW-5	2/4/1997	Not Sampled						
MW-5	5/2/1997	<50	<0.5	<0.5	<0.5	<0.5	<30	
MW-6	2/4/1993	2,300	19	5.4	27	220	NA	

Table 2
Groundwater Analytical Data
1127 Lincoln Avenue, Alameda, CA

Well Number	Date Sampled	TPHg (ppb)	Benzene (ppb)	Toluene (ppb)	Ethyl-Benzene (ppb)	Xylenes (ppb)	MTBE (ppb)	
MW-6	5/6/1993	540	44	0.9	7	6.7	NA	
MW-6	9/28/1993	180	2.7	0.73	6.3	13	NA	
MW-6	11/15/1993	180	2.2	0.91	5.4	16	NA	
MW-6	2/7/1994	240	2.9	1.2	3.9	7.1	NA	
MW-6	5/20/1994	600	4.5	2.2	24	66	NA	
MW-6	8/22/1994	400	3.2	1	7.9	40	NA	
MW-6	11/2/1994	150	1.6	1.3	6.5	27	NA	
MW-6	2/14/1995	770	4.0	2.9	42	130	NA	
MW-6	5/19/1995	2,400	6.9	11	99	350	NA	
MW-6	8/22/1995	190	1.0	1.7	5.2	18	<10	
MW-6	10/25/1995	910	5.5	3.3	50	160	NA	
MW-6	2/9/1996	4,100	3.8	9.9	60	270	NA	
MW-6	4/11/1996	Not Sampled						
MW-6	8/1/1996	2,200	5.1	2.4	160	170	NA	
MW-6	11/11/1996	1,000	3.7	1.5	38	1,100	<30	
MW-6	2/4/1997	2,500	21	3.1	180	320	<30	
MW-6	5/2/1997	1,600	33	1.6	92	180	<30	
MW-7	2/4/1993	<50	<0.5	<0.5	<0.5	<0.5	NA	
MW-7	5/6/1993	Not Sampled						
MW-7	9/28/1993	<50	<0.5	<0.5	<0.5	<0.5	NA	
MW-7	11/15/1993	<50	<0.5	<0.5	<0.5	<0.5	NA	
MW-7	2/7/1994	Not Sampled						
MW-7	5/20/1994	Not Sampled						
MW-7	8/22/1994	130	<0.5	<0.5	<0.5	<0.5	NA	
MW-7	11/2/1994	73	<0.5	<0.5	<0.5	<0.5	NA	
MW-7	2/14/1995	Not Sampled						
MW-7	5/19/1995	<50	<0.5	<0.5	<0.5	2.3	NA	
MW-7	8/22/1995	400	<0.5	<0.5	<0.5	0.76	<10	
MW-7	10/25/1995	Not Sampled						
MW-7	2/9/1996	Not Sampled						
MW-7	4/11/1996	Not Sampled						
MW-7	8/1/1996	460	<0.5	<0.5	<0.5	<0.5	NA	
MW-7	11/11/1996	Not Sampled						
MW-7	2/4/1997	Not Sampled						
MW-7	5/2/1997	150	<0.5	<0.5	<0.5	<0.5	<30	
MW-8	2/4/1993	540	150	3.7	5.2	10	NA	
MW-8	5/6/1993	22,000	9,400	46	390	520	NA	
MW-8	9/28/1993	8,000	1,700	22	30	75	NA	
MW-8	11/15/1993	2,000	840	8.8	15	42	NA	
MW-8	2/7/1994	1,700	460	0.6	13	5	NA	
MW-8	5/20/1994	110	98	1.4	1.3	3.4	NA	
MW-8	8/22/1994	51	16	<0.5	<0.5	<0.5	NA	
MW-8	11/2/1994	<50	<0.5	<0.5	<0.5	<0.5	NA	
MW-8	2/14/1995	<50	<0.5	<0.5	<0.5	<0.5	NA	
MW-8	5/19/1995	<50	<0.5	<0.5	<0.5	<0.5	NA	
MW-8	8/22/1995	<50	<0.5	<0.5	<0.5	<0.5	<10	

Table 2
Groundwater Analytical Data
1127 Lincoln Avenue, Alameda, CA

Well Number	Date Sampled	TPHg (ppb)	Benzene (ppb)	Toluene (ppb)	Ethyl-Benzene (ppb)	Xylenes (ppb)	MTBE (ppb)
MW-8	10/25/1995	<50	<0.5	<0.5	<0.5	<0.5	NA
MW-8	2/9/1996	<50	<0.5	<0.5	<0.5	<0.5	NA
MW-8	4/11/1996	<50	<0.5	<0.5	<0.5	<0.5	NA
MW-8	8/1/1996	<50	<0.5	<0.5	<0.5	<0.5	NA
MW-8	11/11/1996	<50	1.3	<0.5	<0.5	0.67	<30
MW-8	2/4/1997	<50	<0.5	<0.5	<0.5	<0.5	<30
MW-8	5/2/1997	<50	1.6	<0.5	<0.5	<0.5	<30
MW-9	8/22/1995	<50	<0.5	<0.5	<0.5	<0.5	<10
MW-9	10/25/1995	<50	<0.5	<0.5	<0.5	<0.5	NA
MW-9	2/9/1996	<50	<0.5	<0.5	<0.5	<0.5	NA
MW-9	4/11/1996	<50	<0.5	<0.5	<0.5	<0.5	NA
MW-9	8/1/1996	<50	<0.5	<0.5	<0.5	<0.5	NA
MW-9	11/11/1996	<50	<0.5	<0.5	<0.5	<0.5	<30
MW-9	2/4/1997	<50	<0.5	<0.5	<0.5	<0.5	<30
MW-9	5/2/1997	<50	<0.5	<0.5	<0.5	<0.5	<30
MW-10	8/22/1995	<50	<0.5	<0.5	<0.5	<0.5	<10
MW-10	10/25/1995	<50	<0.5	<0.5	<0.5	<0.5	NA
MW-10	2/9/1996	<50	<0.5	<0.5	<0.5	<0.5	NA
MW-10	4/11/1996	<50	0.67	1.8	1.3	7.7	NA
MW-10	8/1/1996	<50	<0.5	<0.5	<0.5	<0.5	NA
MW-10	11/11/1996	<50	<0.5	<0.5	<0.5	<0.5	<30
MW-10	2/4/1997	<50	<0.5	<0.5	<0.5	<0.5	<30
MW-10	5/2/1997	<50	<0.5	<0.5	<0.5	<0.5	<30
MW-11	8/22/1995	<50	<0.5	<0.5	<0.5	<0.5	<10
MW-11	10/25/1995	Not Sampled					
MW-11	2/9/1996	<50	<0.5	<0.5	<0.5	<0.5	NA
MW-11	4/11/1996	<50	<0.5	<0.5	<0.5	<0.5	NA
MW-11	8/1/1996	76	6.8	5.3	2.7	9.1	NA
MW-11	11/11/1996	<50	<0.5	<0.5	<0.5	<0.5	<30
MW-11	2/4/1997	<50	<0.5	<0.5	<0.5	<0.5	<30
MW-11	5/2/1997	<50	<0.5	<0.5	<0.5	<0.5	<30
MTBE = Methyl-tert-butylether							
< = Less than the detection limit for the specified method of analysis							
NA = Not available							
ppb = parts per billion							

APPENDIX

801 Western Avenue
 Glendale, CA 91201
 818/247-5737
 Fax: 818/247-9797

LOG NO: G97-05-119

Received: 05 MAY 97
 Mailed : 15 MAY 97

Ms. Rebecca Digerness
 Texaco Environmental Services
 108 Cutting Boulevard
 Richmond, CA 94804

Purchase Order: 94-1446346+4370

Requisition: 624881450
 Project: FKEP9001L

REPORT OF ANALYTICAL RESULTS

AQUEOUS

SAMPLE DESCRIPTION	DATE SAMPLED	TPH/BTEX (CADHS/8020)	Date Analyzed Date	Dilution Factor Times	TPH-g ug/L	Benzene ug/L	Toluene ug/L	Ethyl-Benzene ug/L	Total Xylenes Isomers ug/L	Carbon Range	Methyl-tert-butylether ug/L
RDI				1	50	0.5	0.5	0.5	0.5		30
1*MW-1	05/02/97	05/12/97		1	650	63	<3	4.3	2.2	C6-C12	<30
2*MW-2	05/02/97	05/08/97		1	<50	1.5	<0.5	<0.5	0.50	C6-C12	<30
3*MW-3	05/02/97	05/12/97		5	3100	35	<3	520	540	C6-C12	<30
4*MW-4	05/02/97	05/08/97		1	<50	<0.5	<0.5	<0.5	<0.5	C6-C12	<30
5*MW-5	05/02/97	05/09/97		1	<50	<0.5	<0.5	<0.5	<0.5	C6-C12	<30
6*MW-6	05/02/97	05/09/97		1	1600	33	1.6	92	180	C6-C12	<30
7*MW-7	05/02/97	05/09/97		1	150	<0.5	<0.5	<0.5	<0.5	C6-C12	<30
8*MW-8	05/02/97	05/09/97		1	<50	1.6	<0.5	<0.5	<0.5	C6-C12	<30
9*MW-9	05/02/97	05/09/97		1	<50	<0.5	<0.5	<0.5	<0.5	C6-C12	<30
10*MW-10	05/02/97	05/09/97		1	<50	<0.5	<0.5	<0.5	<0.5	C6-C12	<30
11*MW-11	05/02/97	05/09/97		1	<50	<0.5	<0.5	<0.5	<0.5	C6-C12	<30

Karen Petryna
 1127 Lincoln Ave., Alameda

Please note that the result for Toluene for sample MW-1 is report in 1:5 dilution factor due to matrix interference.

Amended Report:-
 This report is being reissued to reflect the MTBE results for all of the samples which were not attach on the original report.
 06-26-97 P. Reed-Flynn



801 Western Avenue
Glendale, CA 91201
818/247-5737
Fax: 818/247-9797

LOG NO: G97-05-119

Received: 05 MAY 97
Mailed : 15 MAY 97

Ms. Rebecca Digerness
Texaco Environmental Services
108 Cutting Boulevard
Richmond, CA 94804

Purchase Order: 94-1446346+4370

Requisition: 624881450
Project: FKEP9001L

REPORT OF ANALYTICAL RESULTS

Page 2

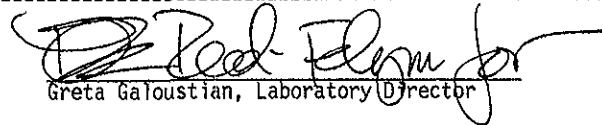
Greta Galoustian, Laboratory Director

The analytical results within this report relate only to the specific compounds and samples investigated and may not necessarily reflect other apparently similar material from the same or a similar location.

This report shall not be reproduced, except in full, without the written approval of VOC. No use of this report for promotional or advertising purposes is permitted without prior written VOC approval.



: ORDER PLACED FOR CLIENT: Texaco Environmental Services 9705119 :
: VOC ANALYTICAL : GLEN LAB : 13:56:39 26 JUN 1997 - P. 1 :
=====

SAMPLES...	SAMPLE DESCRIPTION..	DETERM.....	DATE.....	METHOD.....	EQUIP.	BATCH..	ID.NO
			ANALYZED				
9705119*1	MW-1	GAS.BTX.TESNC	05.12.97	8015M.TX	536-21	976045	8866
9705119*2	MW-2	GAS.BTX.TESNC	05.08.97	8015M.TX	536-21	976044	8171
9705119*3	MW-3	GAS.BTX.TESNC	05.12.97	8015M.TX	536-21	976045	8866
9705119*4	MW-4	GAS.BTX.TESNC	05.08.97	8015M.TX	536-21	976044	8171
9705119*5	MW-5	GAS.BTX.TESNC	05.09.97	8015M.TX	536-21	976044	8171
9705119*6	MW-6	GAS.BTX.TESNC	05.09.97	8015M.TX	536-21	976044	8171
9705119*7	MW-7	GAS.BTX.TESNC	05.09.97	8015M.TX	536-21	976044	8171
9705119*8	MW-8	GAS.BTX.TESNC	05.09.97	8015M.TX	536-21	976044	7424
9705119*9	MW-9	GAS.BTX.TESNC	05.09.97	8015M.TX	536-21	976044	8171
9705119*10	MW-10	GAS.BTX.TESNC	05.09.97	8015M.TX	536-21	976044	8171
9705119*11	MW-11	GAS.BTX.TESNC	05.09.97	8015M.TX	536-21	976044	8171

Notes: Equipment = VOC Analytical identification number for a particular piece of analytical equipment.

ID.NO = VOC Analytical employee identification number of analyst.

AQUEOUS SAMPLES

METHOD BLANK				LAB CONTROL								MATRIX QC									
UNITS	RESULT	RDL	FLG	LCS %REC	FLG	LCS %REC	FLG	LCL	UCL	RPD	UCL	FLG	MS %REC	FLG	MSD %REC	FLG	LCL	UCL	RPD	UCL	FLG

Batch: GAS*976044 Method: 8015M.TX - Modified 8015

Benzene	ug/L	0	0.5	-	103	-	98	-	76	155	5	25	-	-	-	-	-	-	-	-	-	-
Toluene	ug/L	0.2	0.5	-	106	-	101	-	72	121	5	25	-	-	-	-	-	-	-	-	-	-
Ethylbenzene	ug/L	0	0.5	-	103	-	99	-	72	115	5	25	-	-	-	-	-	-	-	-	-	-
Methyl-tert-butylether	ug/L	0	30	-	90	-	84	-	62	159	8	25	-	-	-	-	-	-	-	-	-	-
Total Xylene Isomers	ug/L	0.4	0.5	-	107	-	102	-	68	115	5	25	-	-	-	-	-	-	-	-	-	-
TPH (Gasoline Range)	ug/L	0	50	-	95	-	98	-	85	120	3	25	-	-	-	-	-	-	-	-	-	-
[a,a,a-Trifluorotoluene]	Percent	117	-	-	110	-	102	-	85	118	-	-	-	-	-	-	-	-	-	-	-	-

Batch: GAS*976045 Method: 8015M.IX - Modified 8015

Benzene	ug/L	0	0.5	-	99	-	110	-	76	155	10	-	-	91	-	80	-	70	153	11	25	-
Toluene	ug/L	0	0.5	-	103	-	114	-	72	121	10	-	-	92	-	93	-	69	119	1	25	-
Ethylbenzene	ug/L	0	0.5	-	102	-	113	-	72	115	10	-	-	91	-	92	-	68	116	2	25	-
Methyl-tert-butylether	ug/L	0	30	-	96	-	104	-	62	159	8	-	-	-	-	-	-	-	-	-	-	-
Total Xylene Isomers	ug/L	0	0.5	-	103	-	114	-	68	115	10	-	-	78	-	79	-	61	118	1	25	-
TPH (Gasoline Range)	ug/L	0	50	-	106	-	102	-	85	120	4	-	-	-	-	-	-	-	-	-	-	-
[a,a,a-Trifluorotoluene]	Percent	105	-	-	100	-	112	-	85	118	-	-	-	124	Q	125	Q	85	118	-	-	-

: SURROGATE RECOVERIES :
: BC ANALYTICAL : GLEN LAB : 13:57:17 26 JUN 1997 - P. 1 :
=====

METHOD	ANALYTE	BATCH	ANALYZED	REPORTED	TRUE	%REC	FLAG
9705119*1							
8015M.TXa	a,a-Trifluorotoluene	Re976045	05/12/97	51.2	50.0	102	
9705119*2							
8015M.TXa	a,a-Trifluorotoluene	Re976044	05/08/97	48.6	50.0	97	
9705119*3							
8015M.TXa	a,a-Trifluorotoluene	Re976045	05/12/97	293	250	117	
9705119*4							
8015M.TXa	a,a-Trifluorotoluene	Re976044	05/08/97	48.6	50.0	97	
9705119*5							
8015M.TXa	a,a-Trifluorotoluene	Re976044	05/09/97	48.5	50.0	97	
9705119*6							
8015M.TXa	a,a-Trifluorotoluene	Re976044	05/09/97	46.6	50.0	93	
9705119*7							
8015M.TXa	a,a-Trifluorotoluene	Re976044	05/09/97	46.9	50.0	94	
9705119*8							
8015M.TXa	a,a-Trifluorotoluene	Re976044	05/09/97	48.8	50.0	98	
9705119*9							
8015M.TXa	a,a-Trifluorotoluene	Re976044	05/09/97	47.9	50.0	96	
9705119*10							
8015M.TXa	a,a-Trifluorotoluene	Re976044	05/09/97	46.9	50.0	94	
9705119*11							
8015M.TXa	a,a-Trifluorotoluene	Re976044	05/09/97	48.4	50.0	97	

G97-05-119 / 1

Chain-of-Custody

Texaco Environmental Services

108 Cutting Boulevard
 Richmond, California 94804
 Phone: (510) 238-3541
 FAX: (510) 237-7821

Forward Results to the Attention of Rebecca Digerness
 Texaco Project Coordinator Karen Petryna

Site Name: Texaco Loc. # 624881450
 Site Address: 1127 Lincoln Ave. Alameda, CA
 Contractor Project Number: 970502-H1
 Contractor Name: Blaine Tech Services, Inc.
 Address: 1680 Rogers Ave., San Jose, CA 95112
 Project Contact: Kent Brown
 Phone/FAX: (408) 573-0555 / (408) 573-7771

Laboratory: B C Analytical
 Turn Around Time: normal (10 day)
 Samplers (PRINT NAME): TRC/ HORNER
 Sampler Signature: TRC/ HORNER
 Date Samples Collected: 5-2-97

ANALYSIS															
Sample Number	Lab Sample Number	Date/Time Collected	No. of Containers	Type of Containers	Sample Matrix	Preservative	TPH gas/BTEX	TPH Diesel	O&G/TPH (418.1)	TPH Ex. (C8-C36 +)	VOCs 8240/824	P. Halocarbons 8010/60	P. Aromatics. 8020/602	Organic Lead	Comments
MW-1		5-2-97/1335	3	VGA	W	HCL	X								
MW-2		1250					X								
MW-3		1215					X								
MW-4		1030					X								
MW-5		1230					X								
MW-6		1320					X								
MW-7		1305					X								
MW-8		1145					X								
MW-9		1130					X								
MW-10		1110					X								
MW-11		1055					X								
EB		1045					X								NO SAMPLES 5/5/97/WEB

Relinquished by: [Signature] Date: 5/5/97 Time: 12:40 Received by: [Signature] Date: 5/5/97 Time: 12:40
 Relinquished by: [Signature] Date: 5/5/97 Time: 5:30 Received by: [Signature] Date: 5/6/97 Time: 0800
 Relinquished by: _____ Date: _____ Time: _____ Received by: _____ Date: _____ Time: _____
 Method of Shipment: _____ Lab Comments: _____

TEXACO WELL MONITORING DATA SHEET

Project #: <u>970502-41</u>	Texaco ID#: <u>624881450</u>
Sampler: <u>TNH</u>	Date: <u>5/2/97</u>
Well I.D.: <u>MW-2</u>	Well Diameter: 2 3 <u>4</u> 6 8 _____
Total Well Depth: <u>18.02</u>	Depth to Water: <u>6.93</u>
Depth to Free Product:	Thickness of Free Product:
All Measurements are referenced to TOC. Meter used is Myron LpDS pH/EC Meter. All temperatures taken in degrees Fahrenheit.	

Well Diameter	Multiplier	Well Diameter	Multiplier
2"	0.17	5"	1.02
3"	0.38	6"	1.50
4"	0.66	8"	2.60
4.5"	0.83	Other	radius ² * 0.164

Purge Method: S.S. Bailer Teflon Bailer Middleburg Electric Submersible <input checked="" type="checkbox"/> Extraction Pump Other: _____	Sampling Method: S.S. Bailer <input checked="" type="checkbox"/> Teflon Bailer Extraction Port Other: _____
--	--

<u>6.6</u>	x	<u>3</u>	=	<u>19.8</u>	Gals.
1 Case Volume (Gals.)		Specified Volumes		Calculated Volume	

Time	Temp (°F)	pH	Cond.	Turbidity	Gals. Removed	Color/Odor
<u>1241</u>	<u>67.2</u>	<u>7.2</u>	<u>800</u>	<u>307</u>	<u>7</u>	
<u>1242</u>	<u>67.4</u>	<u>7.0</u>	<u>900</u>	<u>216</u>	<u>14</u>	
<u>1243</u>	<u>67.4</u>	<u>6.8</u>	<u>960</u>	<u>253</u>	<u>20</u>	

Did well de-water? Yes (No) Gallons actually evacuated: 20

Sampling Time: 1:50 Sampling Date: 5/2/97

Sample I.D.: MW-2 Laboratory: BC Analytical

Analyzed for: BTEX TPH-D Other: _____

Equipment Blank ID: _____ Analyzed for same as primary sample

TEXACO WELL MONITORING DATA SHEET

Project #: <u>970502-111</u>	Texaco ID#: <u>624881450</u>
Sampler: <u>TNH</u>	Date: <u>5/2/79</u>
Well I.D.: <u>AW-8</u>	Well Diameter: 2 3 <u>(4)</u> 6 8 <u> </u>
Total Well Depth: <u>17.68</u>	Depth to Water: <u>6.28</u>
Depth to Free Product:	Thickness of Free Product:
All Measurements are referenced to TOC. Meter used is Myron LpDS pH/EC Meter. All temperatures taken in degrees Fahrenheit.	

Well Diameter	Multiplier	Well Diameter	Multiplier
2"	0.17	5"	1.02
3"	0.38	6"	1.50
4"	0.66	8"	2.60
4.5"	0.83	Other	radius ² * 0.164

Purge Method: S.S. Bailer Teflon Bailer Middleburg Electric Submersible <input checked="" type="checkbox"/> Extraction Pump Other: _____	Sampling Method: S.S. Bailer <input checked="" type="checkbox"/> Teflon Bailer Extraction Port Other: _____
--	--

<u>8.7</u>	x	<u>3</u>	=	<u>26.1</u>	Gals.
1 Case Volume (Gals.)		Specified Volumes		Calculated Volume	

Time	Temp (°F)	pH	Cond.	Turbidity	Gals. Removed	Color/Odor
<u>1136</u>	<u>64.6</u>	<u>7.3</u>	<u>141</u>	<u>107.8</u>	<u>9</u>	
<u>1137</u>	<u>65.0</u>	<u>7.1</u>	<u>160</u>	<u>116.0</u>	<u>18</u>	
<u>1138</u>	<u>65.6</u>	<u>7.2</u>	<u>140</u>	<u>147.3</u>	<u>27</u>	

Did well dewater? Yes <input type="checkbox"/> No <input checked="" type="checkbox"/>	Gallons actually evacuated: <u>27</u>
Sampling Time: <u>1145</u>	Sampling Date: <u>5/2/79</u>
Sample I.D.: <u>111-8</u>	Laboratory: <u>BC Analytical</u>
Analyzed for: <input checked="" type="checkbox"/> TPH-G <input checked="" type="checkbox"/> BTEX <input type="checkbox"/> TSS-D <input type="checkbox"/> Other	
Equipment Blank I.D.:	Analyzed for same as primary sample

QUARTERLY SUMMARY REPORT
Former Texaco Service Station
1127 Lincoln Avenue, Alameda, California
Alameda County
Second Quarter, 1997

HISTORY OF INVESTIGATIVE AND REMEDIAL ACTIONS

Four underground fuel tanks and one underground waste oil tank were removed in September 1989. Eleven soil borings were drilled in March 1981 and eight of the borings were converted into three groundwater monitoring wells (MW-1 through MW-3) and five vapor extraction wells (VW-1 through VW-5). Five additional ground water monitoring wells (MW-4 through MW-8) and (MW-9 through MW-11) were installed in June 1992 and May 1995, respectively. Nine soil borings were also drilled in February 1995. A dual soil vapor extraction and groundwater extraction remedial system operated from September 1993 through September 1996. Monitoring well MW-5 was connected to the vapor extraction system in September 1993 and MW-1 and MW-2 were connected to the extraction system in November 1993. MW-1, MW-2, and MW-5 were used as combined extraction/recovery wells.

WORK PERFORMED DURING THIS QUARTER

Ground water monitoring and sampling of the monitoring wells was performed.

CHARACTERIZATION STATUS

SOIL: The extent of petroleum hydrocarbons in soil have been delineated.

GROUND WATER: The extent of petroleum hydrocarbons appears to be predominantly defined.

WATER WELL SURVEY

A water well survey has not been conducted for the site. The predominant ground water flow direction is to the north-northwest.

REMEDICATION STATUS

A dual soil vapor extraction and groundwater extraction system previously operated at the site (see above).

WORK TO BE PERFORMED NEXT QUARTER

Continuation of the quarterly ground water monitoring and sampling program.

SITE CONTACTS

Texaco: Karen Petryna (510) 236-9139
Property Owner: Leo Pagano
Lead Agency: Juliet Shin (510) 567-6763 (ACDEH)

b \QSR1127 972