

HK2, INC./SEMCO

1751 LESLIE STREET • SAN MATEO, CA 94402 • (415) 572-8033 • (415) 572-9734 FAX

GENERAL ENGINEERING & ENVIRONMENTAL CONTRACTORS LICENSE NO. 719103 (A, B, C57, C61, D40, HAZ, ASB)

October 2, 1996

ref: 96-0236.2

Juliet Shin
Alameda County
Department of Environmental Health
1131 Harbor Bay Parkway
Alameda, California 94502
(510) 567-6700 phone
(510) 337-9335 fax

re: Gasoline tank removal at 845 Pacific Ave., Alameda, California.

Dear Ms. Juliet Shin,

Enclosed is the tank removal report for the site referenced above. Please let us know if you have any questions.

Sincerely,

HK2, Inc./SEMCO



Mark Dysert
Environmental Specialist

cc: William Sheehan

Tank Removal Report

Site Location:

**845 Pacific Ave.
Alameda, California**

Prepared For:

**William Sheehan
1236 Bay Street
Alameda, California 94501
(510) 522-0978 phone**

Submitted To:

**Juliet Shin
Alameda County Department of Environmental Health
1131 Harbor Bay Parkway
Alameda, California 94502
(510) 567-6700 phone
(510) 337-9335 fax**

Prepared By:

**HK2, Inc./SEMCO
1751 Leslie Street
San Mateo, California 94402
(415) 572-8033 phone
(415) 572-9734 fax**

Job # 96-0236.2

CERTIFICATION

This report was prepared by HK2, Inc./SEMCO under the professional direction and review of the person whose name and seal are shown below.

The recommendations and professional opinions presented herein, are within the limits prescribed by the client and were prepared in accordance with generally accepted professional engineering and industrial hygiene practices. There is no other warranty either expressed or implied.

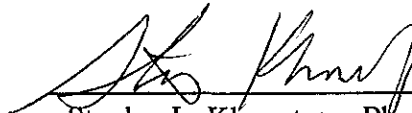
Stanley L. Klemetson, Ph. D., P.E.



**Tank Removal Report
845 Pacific Ave.
Alameda, California**

Also, own 750 gallon
leaking oil tank removed
from site & elevated
levels of BTEX
identified in soil
samples. Refer
to results in
files

SEMCO/HK2, Inc. was contracted to remove one (1) 120 gallon gasoline tank (UST) from the residential site located at 845 Pacific Ave., Alameda, California. The tank was installed in June 1926 according to records at Alameda Fire Department. This report covers the tank removal, soil sampling activities.

On September 25, 1996 HK2, Inc. removed the concrete surface in order to access the tank. The soil was removed from the top and along one side of the tank and stockpiled on site. The tank was free of any residual product. The tank was inerted with 50 lbs. of solid carbon dioxide (dry ice) until acceptable levels of oxygen and lower explosive limits were reached to meet safety requirements.

Juliet Shin of the Alameda County Department of Environmental Health and Captain Steve McKinnley of the Alameda Fire Department were both on site to verify the tank readings and witness the removal, loading and sampling activities.

There was some large holes in the bottom of the tank. The soil had no odor or discoloration. The excavation was explored with the backhoe and there was no odor or discoloration noted. The tank was loaded onto Dexanna Ltd. and transported to Erickson, Inc. for disposal under manifest number 95269999.

Two (2) soil samples were collected. Sample #1-120-G@6' was collected from the bottom of the excavation 6' below ground surface (bgs), approximately 2' below the former tank in native sandy soil. Sample #2-SP-COMP, a four (4) tube composite, was collected from the excavated material.

Soil samples were collected in clean brass tubes, which were sealed with Teflon tape, pre-formed plastic end caps and masking tape. The samples were properly labeled, entered onto a chain of custody and placed in an iced cooler for transportation to North State Environmental for the analysis of Total Petroleum Hydrocarbons as Gasoline (TPH-G), Benzene, Toluene, Ethylbenzene, Xylenes (BTEX) and Total Lead. Analytical results are presented in the Appendix.

This report was prepared from field technicians worksheets, inspector's field notes and analytical data pertaining to this site.

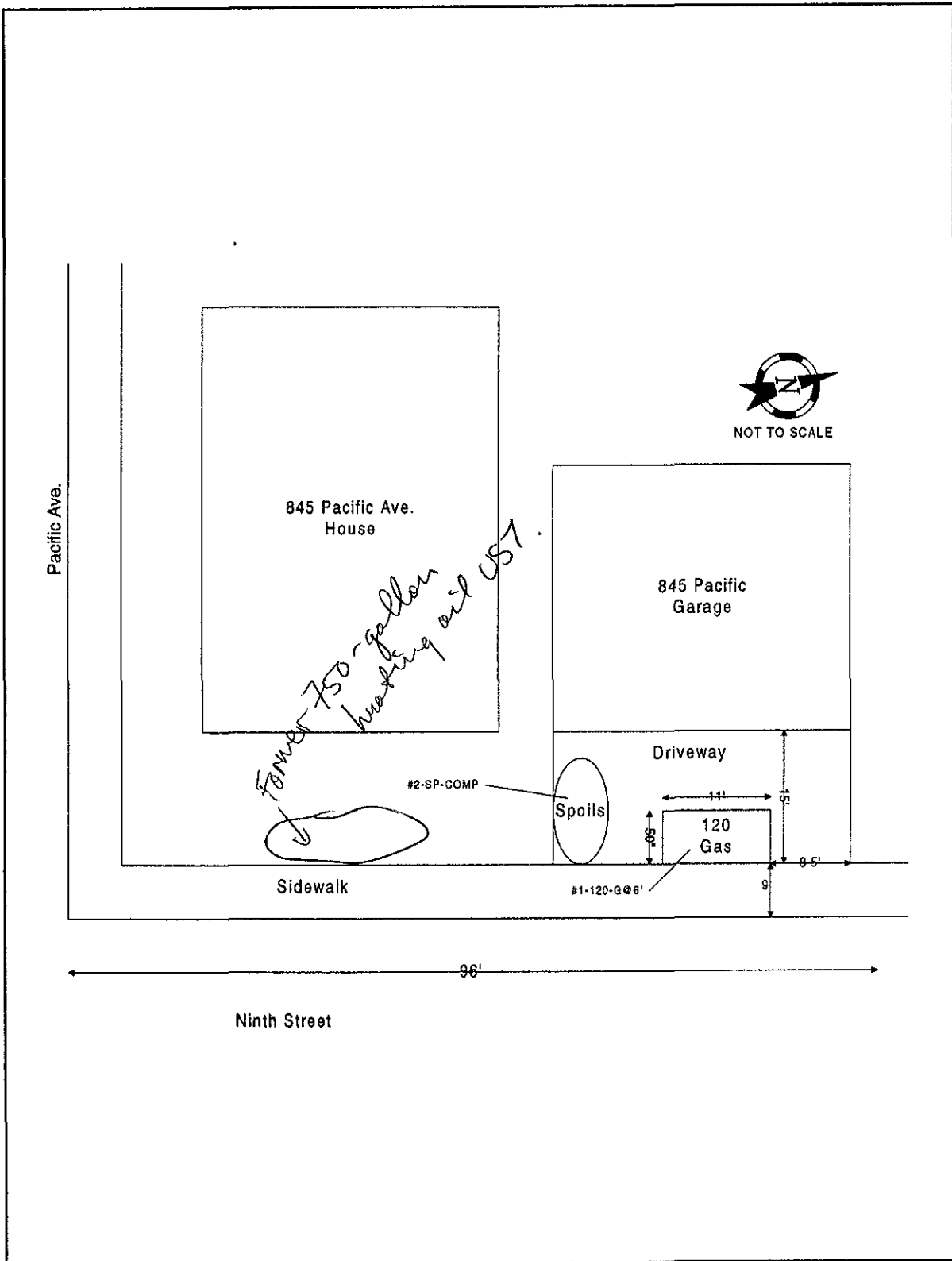

Site Layout and Sampling Locations

Appendix



North State Environmental
Chemical Waste Disposal · Trucking · Consulting

CERTIFICATE OF ANALYSIS

Lab No:	96-702	Date Sampled:	09-25-96
Client:	SEMCO	Date Analyzed:	09-26-96
Project:	845 PACIFIC AVE.	Date Reported:	09-27-96

Total Lead by Method Atomic Absorbtion Spectroscopy Samples prepared by Method 3050
Benzene, Toluene, Ethylbenzene and Xylenes by Method 8020
Gasoline range hydrocarbons by EPA method 8015M

SAMPLE NO	CLIENT ID	ANALYTE	METHOD	RESULT
96-702-01	#1-120-G @ 6' SOIL	Benzene	8020	ND
		Toluene	8020	ND
		Ethylbenzene	8020	ND
		Xylenes	8020	ND
		Gasoline	8015M	ND
		Lead	7420	25 mg/Kg
96-702-02	#2-SP- COMP SOIL	Benzene	8020	ND
		Toluene	8020	ND
		Ethylbenzene	8020	ND
		Xylenes	8020	ND
		Gasoline	8015M	ND
		Lead	7420	31 mg/Kg

Quality Control/Quality Assurance Summary-Soil

Analyte	Method	Reporting Limit	Blank	MS/MSD Recovery	RPD
Benzene	8020	0.005 mg/Kg	ND	122	3
Toluene	8020	0.005 mg/Kg	ND	111	3
Ethylbenzene	8020	0.005 mg/Kg	ND	102	2
Xylenes	8020	0.010 mg/Kg	ND	149	5
Gasoline	8015M	0.5 mg/Kg	ND	101	4
Lead	7420	1 mg/Kg	ND	103/101	2

ELAP Certificate NO: 1753

Reviewed and Approved:

John A. Murphy, Laboratory Director

P.O. Box 5624 • South San Francisco, California 94083 • 415-588-2838 FAX 588-1950



BAY AREA AIR QUALITY MANAGEMENT DISTRICT

939 ELLIS STREET
SAN FRANCISCO, CALIFORNIA 94109
(415) 771-6000

REGULATION 8, RULE 40 NOTIFICATION FORM

Check (✓) Removal or Replacement of Tanks
 Excavation of Contaminated Soil

SITE INFORMATION

Site Address 845 Pacific Avenue
City, State Alameda, California Zip 94501
Owner Name William Sheehan
Specific Location of Project Northeast side of property

Tank Removal

Contaminated Soil Excavation

Scheduled Startup Date 9-25-96 Scheduled Startup Date _____

Vapors Removed By:
[✓] Water Wash *high pressure hot water detergent wash*
[✓] Vapor Freeing (CO₂) *20 lbs per 100 gal. dry ice*
[✓] Ventilation *purge w/air*

Stockpiles Will Be Covered? Yes _____ No _____

Indicate below the method used to comply with Regulation 8, Rule 40, Section 402.4:

Check (✓) 8-40-301 [✓] 8-40-302 [] (Permit Required)
A/C or PIO # 96-0236

What other public agency have you notified (e.g., Fire District, Hazardous Materials Department, city or county)?

Agency Alameda County En. Health Contact Juliet Shin Phone # (510) 507-6700

BAAQMD # _____

CONTRACTOR INFORMATION

Name _____ Contact _____
Address _____ Phone () _____
City, State, Zip _____

CONSULTANT INFORMATION (If applicable)

Name _____ Contact _____
Address _____ Phone () _____
City, State, Zip _____

For Office Use Only

Date Received Fax _____ Date Postmarked _____
Inspector No. _____ Date _____ By _____ (init)
Update: Contact Name _____ Date _____ By _____ (init)
Update: Contact Name _____ Date _____ By _____ (init)

6. Contractor HKA, INC / SEMCO
Address 1751 Leslie Street
City San Mateo, CA 94402 Phone 415-572-8033
License Type A, B, C61/D40, C57, HAZ ID# 719103

*Effective January 1, 1992, Business and Professional Code Section 7058.7 requires prime contractors to also hold Hazardous Waste Certification issued by the State Contractors License Board.

7. Consultant (if applicable) N/A
Address _____
City, State _____ Phone _____

8. Main Contact Person for Investigation (if applicable)
Name Chuck Krew Title President
Company HKA, INC / SEMCO
Phone 415-572-8033

9. Number of underground tanks being closed with this plan 1
Length of piping being removed under this plan unk.
Total number of underground tanks at this facility (**confirmed with owner or operator) 1

10. State Registered Hazardous Waste Transporters/Facilities (see instructions).

** Underground storage tanks must be handled as hazardous waste **

a) Product/Residual Sludge/Rinsate Transporter
Name Evergreen Environmental EPA I.D. No. CAD980695761
Hauler License No. 0242 License Exp. Date 7/97
Address 6880 Smith Avenue
City Newark State CA Zip 94560

b) Product/Residual Sludge/Rinsate Disposal Site
Name Evergreen Environmental EPA ID# CAD980695761
Address 6880 Smith Ave.
City Newark State CA Zip 94560

c) Tank and Piping Transporter

Name Dexannco LTD EPA I.D. No. CA0982438566
Hauler License No. 2883 License Exp. Date 4/97
Address 3104 Athens Ct.
City Concord State CA Zip 94519

d) Tank and Piping Disposal Site

Name Erickson, cnc EPA I.D. No. CA0009466392
Address 255 Parr Blvd.
City Richmond State CA Zip 94801

11. Sample Collector

Name Chuck Kasper or Mark Rupert
Company HKA, INC / SEMCO
Address 1751 Leslie St.
City San Mateo State CA Zip 94402 Phone 415-572-8033

12. Laboratory

Name North State Environmental
Address 90 S. Spruce
City So. San Francisco State CA Zip _____
State Certification No. 1753

13. Have tanks or pipes leaked in the past? Yes [] No [] Unknown []

If yes, describe. _____

14. Describe methods to be used for rendering tank(s) inert:

*High pressure hot water deluge wash,
20 lbs dry ice, per 1000 gallons*

Before tanks are pumped out and inerted, all associated piping must be flushed out into the tanks. All accessible associated piping must then be removed. Inaccessible piping must be permanently plugged.

The Bay Area Air Quality Management District, 415/771-6000, along with local Fire and Building Departments, must also be contacted for tank removal permits. Fire departments typically require the use of a combustible gas indicator to verify tank inertness. It is the contractor's responsibility to bring a working combustible gas indicator on-site to verify that the tank is inert.

15. Tank History and Sampling Information *** (see instructions) ***

Tank		Material to be sampled (tank contents, soil, groundwater)	Location and Depth of Samples
Capacity	Use History include date last used (estimated)		
<i>120</i>	<i>gasoline</i> <i>Also, one leaking removed & identified of BTEX.</i> <i>750 gallon oil UBT & surplus elevated levels</i>	<i>Soil and or water</i>	<i>2 foot below end of tank into Native Soil - or at soil/water interface</i>

One soil sample must be collected for every 20 linear feet of piping that is removed. A ground water sample must be collected if any ground water is present in the excavation.

stockpiled Soil Volume (estimated) <i>Est.</i> 5 yards <i>One discreet sample per every 20 yds & to be reused on site.</i>	Sampling Plan Soil Samples Taken from tank excavation will be collected, placed in brass tubes, sealed with Teflon Tape, caps and placed on ice, transported to a State Certified lab under chain of custody and analyzed for the constituents of the tank.
--	---

Stockpiled soil must be placed on bermed plastic and must be completely covered by plastic sheeting.

Will the excavated soil be returned to the excavation immediately after tank removal? [] yes [] no [] unknown

If yes, explain reasoning _____

If unknown at this point in time, please be aware that excavated soil may not be returned to the excavation without prior approval from Alameda County. This means that the contractor, consultant, or responsible party must communicate with the Specialist IN ADVANCE of backfilling operations.

16. Chemical methods and associated detection limits to be used for analyzing samples:
 The Tri-Regional Board recommended minimum verification analyses and practical quantitation reporting limits should be followed. See attached Table 2.

17. Submit Site Health and Safety Plan (See Instructions)

Contaminant Sought	EPA or Other Sample Preparation Method Number	EPA or Other Analysis Method Number	Method Detection Limit
Leaded Gas	TPH G BTX&E TPH AND BTX&E 8260 TOTAL LEAD AA -----Optional----- TEL EDB	GCFID(5030) 8020 OR 8240 -----Optional----- DHS-LUFT DHS-AB1803	TPH G BTX&E TOTAL LEAD AA TEL EDB DHS-LUFT DHS-AB1803
	<i>MTBE</i>		

18. Submit Worker's Compensation Certificate copy

Name of Insurer UAC Comp

19. Submit Plot Plan ***** (See Instructions) *****

20. Enclose Deposit (See Instructions)

21. Report any leaks or contamination to this office within 5 days of discovery.

The written report shall be made on an Underground Storage Tank Unauthorized Leak/Contamination Site Report (ULR) form.

22. Submit a closure report to this office within 60 days of the tank removal. The report must contain all information listed in item 22 of the instructions.

23. Submit State (Underground Storage Tank Permit Application) Forms A and B (one B form for each UST to be removed) (mark box 8 for "tank removed" in the upper right hand corner)

I declare that to the best of my knowledge and belief that the statements and information provided above are correct and true.

I understand that information, in addition to that provided above, may be needed in order to obtain approval from the Environmental Protection Division and that no work is to begin on this project until this plan is approved.

I understand that any changes in design, materials or equipment will void this plan if prior approval is not obtained.

I understand that all work performed during this project will be done in compliance with all applicable OSHA (Occupational Safety and Health Administration) requirements concerning personnel health and safety. I understand that site and worker safety are solely the responsibility of the property owner or his agent and that this responsibility is not shared nor assumed by the County of Alameda.

Once I have received my stamped, accepted closure plan, I will contact the project Hazardous Materials Specialist at least three working days in advance of site work to schedule the required inspections.

CONTRACTOR INFORMATION

Name of Business HKA, INC / SEMCO

Name of Individual Rhonda Reames-Kiper

Signature Rhonda Reames-Kiper Date _____

PROPERTY OWNER OR MOST RECENT TANK OPERATOR (Circle one)

Name of Business _____

Name of Individual William Sheehan

Signature William Sheehan Date 9-19-96
by Rhonda Reames-Kiper

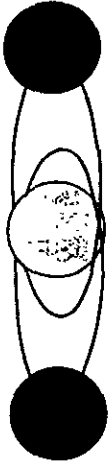

Abel Carbonic

CUSTOMER NUMBER	PURCHASE ORDER NO.	DATE	DELIVERY NUMBER
96-0236.2	845 Sheehan Pacific	11-9-78	9-954368

BY ACCEPTING THIS ORDER, CUSTOMER AGREES TO ALL OF THE TERMS AND CONDITIONS SET FORTH HEREIN, INCLUDING THOSE PRINTED ON THE REVERSE SIDE.

NAME	11K2	ACCEPTED BY:	
SHIPPED TO			

20 SOLID	21 HALF	22 SLICES	23 PELLETS	24 AIRPORT	29 WET ICE	
UNIT	DESCRIPTION				CODE	POUNDS
	DRY ICE	ORM-A	UN1845		13	5.5
			21111111			

This Memorandum is an acknowledgment that a Bill of Lading has been issued and is not the Original Bill of Lading, nor a copy or duplicate, covering the property named herein, and is intended solely for filing or record.

William Sheehy
~~845~~ *845 Pacific Avenue*

Shipper's No. *700 96-0236.2*

Carrier **Dexanna** Agent's No. **0981**

RECEIVED, subject to the classifications and tariffs in effect on the date of the receipt by the carrier of the property described in the Original Bill of Lading,
 at *Alameda, Calif.* *9/25* 19 *96* from *Senco HK²*

the property described below, in apparent good order, except as noted hereon and conditions of contents, of packages unknown, marked, contained and desired as shown below, which said company (the word company being understood throughout this contract as meaning any person or corporation in possession of the property under the contract) agrees to carry to its usual place of delivery, at said destination, if on its own railroad, water line, highway, route or route or within the territory of its highway operations, otherwise to deliver to another carrier on the road, to said destination. It is mutually agreed, as to each carrier of all or any of said property over all or any portion of said route to destination, and as to each party at any time, interested in all or any of said property, that every service to be performed hereunder shall be subject to all the conditions not prohibited by law whether printed or written, herein contained including the conditions on back hereof, which are hereby agreed to by the shipper and accepted for himself and his assigns.

Consigned to **Erickson, Inc.** (Mail or street address of consignee—For purposes of notification only)
255 Parr Blvd.
 Destination **Richmond,** State of **Calif.** Zip Code **94801** County of **Contra Costa**
 Street City
 Routing **Dexanna** Delivering Carrier **Dexanna** Vehicle or Car Initial **2** No. **T-1**

Collect On Delivery \$ _____ and remit to: _____ C. O. D. charge to be paid by Shipper Consignee

Street _____ City _____ State _____

No Packages	Description of Articles, Special Marks and Exceptions	*Weight (Sub to Cor)	Class or Rate	Check Column
1	Waste Empty Storage Tank NON-RCRA Hazardous Waste Solid. Manifest # 95269999 Tank # 18892 Loading Time: 13:00 to 13:30 = 1/2 Hr.	<i>150 lbs.</i>		

Subject to Section 7 of conditions, if this shipment is to be delivered to the consignee without recourse on the consignor, the consignor shall sign the following statements
 The carrier shall not make delivery of this shipment without payment of freight and all other lawful charges.

(Signature of Consignor)
 If charges are to be prepaid, write or stamp here, "TO BE PREPAID"

Received \$ _____ to apply to prepayment of the charges on the property described hereon

Agent or Cashier
 Per _____ (the signature here acknowledges only the amount Prepaid)

*If the shipment moves between two ports by a carrier by water, the law requires that the bill of lading shall state whether it is "carrier's or shipper's weight." NOTE—Where the rate is dependent on value, shippers are required to state specifically in writing the agreed or declared value of the property

The agreed or declared value of the property is hereby specifically stated by the shipper to be not exceeding _____ per \$ _____

Senco HK² Shipper, Per *MWD* **Dexanna** Agent, Per *[Signature]*

Permanent post-office address of shipper, _____

IN CASE OF EMERGENCY OR SPILL, CALL THE NATIONAL RESPONSE CENTER 1-800-424-8802; WITHIN CALIFORNIA, CALL 1-800-852-7550

UNIFORM HAZARDOUS WASTE MANIFEST		1. Generator's US EPA ID No. CAC001061448		Manifest Document No. 0 0 9 8 1		2. Page 1 of 1		Information in the shaded areas is not required by Federal law.							
3. Generator's Name and Mailing Address William Sheehan 1236 Bay Street - Alameda, California 94501						A. State Manifest Document Number 95269999									
4. Generator's Phone (510) 532-0978						B. State Generator's ID									
5. Transporter 1 Company Name Dexanna				6. US EPA ID Number CAD1982438566		C. State Transporter's ID									
7. Transporter 2 Company Name						D. Transporter's Phone (510) 687-1292									
8. US EPA ID Number						E. State Transporter's ID									
9. Designated Facility Name and Site Address Erickson, Inc. - 255 Parr Blvd. Richmond, California 94801						10. US EPA ID Number CAD1009466392									
10. US EPA ID Number						F. Transporter's Phone									
11. US DOT Description (including Proper Shipping Name, Hazard Class, and ID Number)						12. Containers		13. Total Quantity		14. Unit Wt/Vol		i. Waste Number			
a. Waste Empty Storage Tank NOI-RCRA Hazardous Waste Solid.						No.		Type		P		State			
						0 0 1		T P				0 0 1 5 0		512	
														EPA/Other	
														NONE	
b.												State			
c.												EPA/Other			
d.												State			
												EPA/Other			
J. Additional Descriptions for Materials Listed Above Qty. 1 Empty Storage Tank # 18892. Tank has been inerted with 15 lbs. DRY ICE per 1000 gallons capacity.						K. Handling Codes for Wastes Listed Above									
						a.		b.							
						c.		d.							
15. Special Handling Instructions and Additional Information Keep away from sources of ignition. Site Location: 845 Pacific Avenue - Alameda, California 24 Hr. Contact Name: William Sheehan & Phone # (510) 532-0978															
16. GENERATOR'S CERTIFICATION: I hereby declare that the contents of this consignment are fully and accurately described above by proper shipping name and are classified, packed, marked, and labeled, and are in all respects in proper condition for transport by highway according to applicable international and national government regulations. If I am a large quantity generator, I certify that I have a program in place to reduce the volume and toxicity of waste generated to the degree I have determined to be economically practicable and that I have selected the practicable method of treatment, storage, or disposal currently available to me which minimizes the present and future threat to human health and the environment; OR, if I am a small quantity generator, I have made a good faith effort to minimize my waste generation and select the best waste management method that is available to me and that I can afford.															
Printed/Typed Name WILLIAM J. SHEEHAN				Signature <i>William J. Sheehan</i>				Month Day Year 0 9 1 5 9		Yes					
17. Transporter 1 Acknowledgement of Receipt of Materials Printed/Typed Name James R. Cox				Signature <i>James R. Cox</i>				Month Day Year 0 9 1 5 9		Yes					
18. Transporter 2 Acknowledgement of Receipt of Materials Printed/Typed Name				Signature				Month Day Year		Yes					
19. Discrepancy Indication Space															
20. Facility Owner or Operator Certification of receipt of hazardous materials covered by this manifest except as noted in Item 19. Printed/Typed Name															
Signature				Month Day Year		Yes									

DO NOT WRITE BELOW THIS LINE.

SEMCO
1741 Leslie Street
San Mateo, Calif. 94402
(415) 572-8033

License No. 449864
A, B, & C-61/D40
Hazardous Substance Certificate

SEMCO
431 W. Hatch Rd.
Modesto, Calif. 95351
(209) 524-9653

SITE PLAN

SUBMITTED TO:		DESCRIPTION OF JOB:	
		Job <i>845 Pacific Ave. #96-0236.2</i>	
		Address	
		City <i>Alameda</i>	State <i>CA</i>
		Phone	Date <i>9/25/96</i>

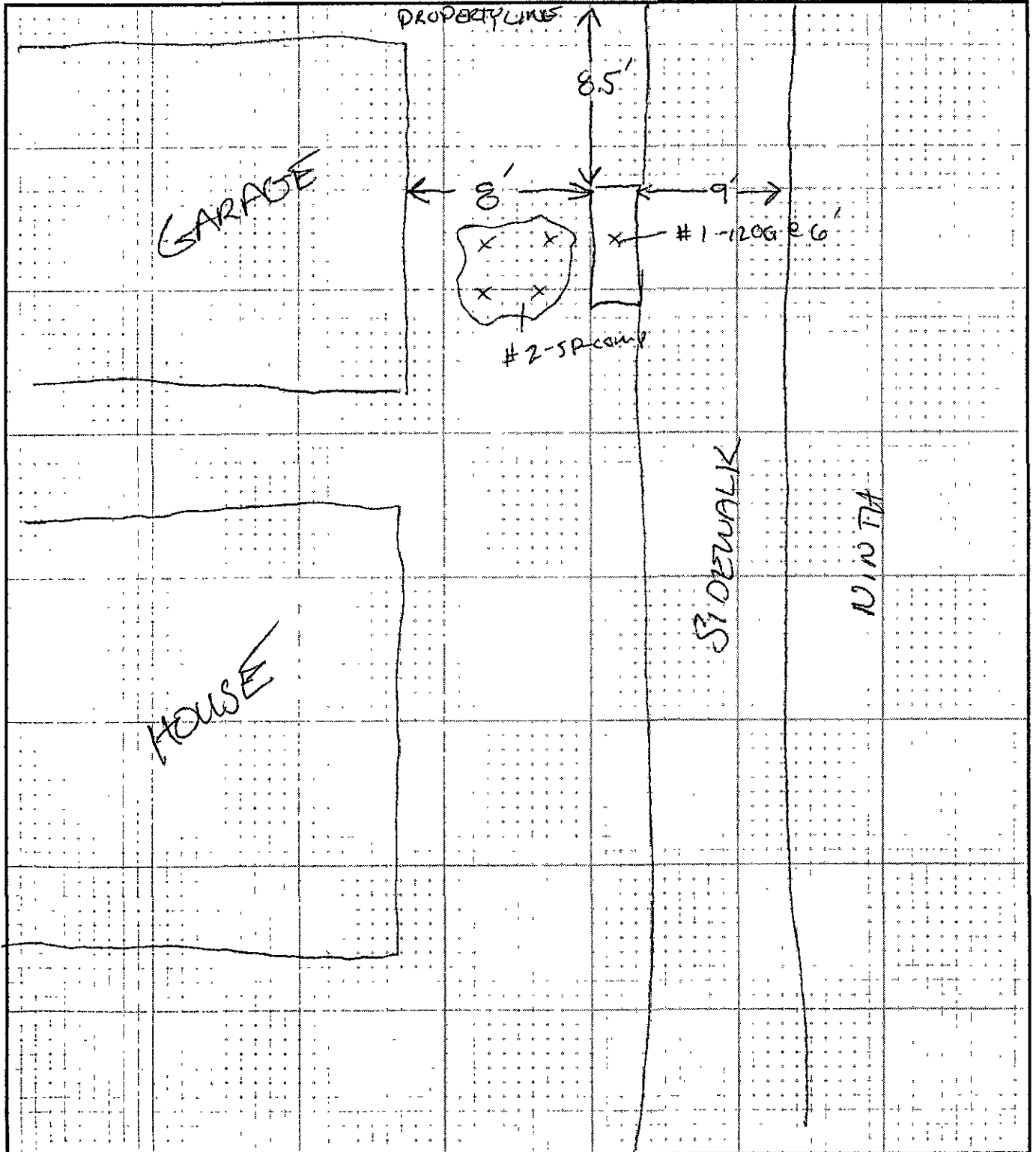

white -env.health
 yellow -facility
 pink -files

ALAMEDA COUNTY, DEPARTMENT OF ENVIRONMENTAL HEALTH
 Hazardous Materials Inspection Form

1131 Harbor Bay Pkwy.
 Suite 250
 Alameda, CA 94502-6577
 (510) 567-6700

II, III

Site ID # 6063 Site Name Residence Today's Date 9/25/96

Site Address 845 Pacific Ave

City Alameda Zip 94501 Phone _____

MAX AMT stored > 500 lbs, 55 gal., 200 cft.?

Inspection Categories:

- I. Haz. Mat/Waste GENERATOR/TRANSPORTER
- II. Business Plans, Acute Hazardous Materials
- III. Underground Tanks

* Calif. Administration Code (CAC) or the Health & Safety Code (HS&C)

Comments:

Came out to site to witness removal of 120-gallon gas UST. (~1:00PM). Steve McKinley, Alameda Fire Dept., was out at site. Tank corroded w/ no tar wrapping. Large holes, (upto ~2 inches diameter), were noted in bottom of tank (below south end of UST). Tank was installed in June 1976. The seams along the north face of UST were cracked. Tank was dry upon discovery. The tank has been out of service for at least 18 years, per property owner Mr. Sheehan. Soil sample collected from beneath the tank was sandy soil w/ no odor or stains. This sample was collected from ~6 1/2' bgs. The backhoe explored pit in other areas & no odor or stains were noted. One composite sample collected from excavated soil.

Manifest # 95269999

II.A BUSINESS PLANS (Title 19)

- 1. Immediate Reporting 2703
- 2. Bus. Plan Plans 25503(b)
- 3. RR Cars > 30 days 25503.7
- 4. Inventory Information 25504(a)
- 5. Inventory Complete 2730
- 6. Emergency Response 25504(b)
- 7. Training 25504(c)
- 8. Deficiency 25505(a)
- 9. Modification 25505(b)

II.B ACUTELY HAZ. MATLS

- 10. Registration Form Filed 25533(a)
- 11. Form Complete 25533(b)
- 12. RMPP Contents 25534(c)
- 13. Implement Sch. Req'd? (Y/N)
- 14. OffSite Conseq. Assess. 25524(c)
- 15. Probable Risk Assessment 25534(d)
- 16. Persons Responsible 25534(g)
- 17. Certification 25534(m)
- 18. Exemption Request? (Y/N) 25536(b)
- 19. Trade Secret Requested? 25538

III. UNDERGROUND TANKS (Title 23)

- General
- 1. Permit Application 25284 (H&S)
 - 2. Pipeline Leak Detection 25292 (H&S)
 - 3. Records Maintenance 2712
 - 4. Release Report 2651
 - 5. Closure Plans 2670

- Monitoring for Existing Tanks
- 6. Method
 - 1) Monthly Test
 - 2) Daily Vadose Semi-annual groundwater One time soils
 - 3) Daily Vadose One time soils Annual tank test
 - 4) Monthly Gndwater One time soils
 - 5) Daily inventory Annual tank testing Cont pipe leak det Vadose/gndwater mon.
 - 6) Daily inventory Annual tank testing Cont pipe leak det
 - 7) Weekly Tank Gauge Annual tank testing
 - 8) Annual Tank Testing Daily inventory
 - 9) Other

- 7. Precs Tank Test Date: 2643
- 8. Inventory Rec. 2644
- 9. Soil Testing . 2646
- 10. Ground Water. 2647

- New Tanks
- 11. Monitor Plan 2632
 - 12. Access. Secure 2634
 - 13. Plans Submit Date: 2711
 - 14. As Built Date: 2635

Contact: Mark Dyser

Title: _____

Signature: Mark Dyser

Inspector: Juliet Shyn

Signature: Juliet Shyn

II, III