



ENVIRONMENTAL HEALTH SERVICES
ENVIRONMENTAL PROTECTION
1131 Harbor Bay Parkway, Suite 250
Alameda, CA 94502-6577
(510) 567-6700
FAX (510) 337-9335

**PUBLIC NOTIFICATION OF POTENTIAL CLOSURE OF FUEL LEAK CASE
845 PACIFIC AVENUE, ALAMEDA
July 29, 2010**

**Site Name: Sheehan Property
Site Location: 845 Pacific Avenue, Alameda, CA 94501
Fuel Leak Case RO0000081 and Geotracker Global ID T0600102127**

Summary – This fact sheet has been prepared to inform community members and other interested parties of potential case closure for a fuel leak case at 845 Pacific Avenue in Alameda, California (see map on back of this page). Site investigation and cleanup activities have been completed and it does not appear that the fuel release presents a significant risk to human health or the environment under current conditions.

Background – The site is a residential property located at the intersection of Pacific Avenue and Ninth Street in Alameda, CA. A 750-gallon heating oil tank was removed from beneath the sidewalk east of the residence in September 1996. Several holes up to ¼-inch in diameter were observed in the underground storage tank (UST) during removal. Odor and staining were observed in soils surrounding the UST with the most apparent presence of petroleum hydrocarbons observed in the south end of the excavation at the fill end of the tank. Three soil samples collected during UST removal contained up to 800 parts per million (ppm) of Total Petroleum Hydrocarbons as diesel and 3.6 ppm of benzene. Site investigation activities conducted in 1997 and 2002 have indicated that petroleum hydrocarbons, primarily in the diesel fuel or heating oil range, are present in soil below a depth of approximately 7 feet bgs in the area east of the residence. Petroleum hydrocarbons are also present in groundwater beneath the sidewalk and the area east of the residence at 845 Pacific Avenue. Groundwater monitoring that was conducted from 2002 to 2003 indicates that petroleum hydrocarbons in groundwater are generally limited in extent to the area east of the residence extending to approximately the center of Ninth Street (see map on back of this page). Based on this limited extent, the petroleum hydrocarbons in groundwater do pose a risk to nearby residents. The concentrations of petroleum hydrocarbons in groundwater appear to be decreasing and further restoration of groundwater quality is expected to take place over a long period of time by natural attenuation processes.

On September 25, 1996, one 120-gallon gasoline UST was removed from the driveway east of the garage at the residence. The gasoline UST was reportedly installed in 1926 and had not been used for more than 18 years prior to removal in 1996. No residual product was present and the UST had several large holes in the bottom of the tank. Soils surrounding the UST had no odor or staining. Two soil samples collected below the UST did not contain petroleum hydrocarbons at concentrations above the reporting limits. No further investigation or cleanup was necessary for the 120-gallon gasoline UST.

Next Step – The public is invited to review and comment on the potential closure of the fuel leak case. The entire case file can be viewed over the Internet on the ACEH website (<http://www.acgov.org/aceh/lop/ust.htm>) or the State of California Water Resources Control Board Geotracker website (<http://geotracker.swrcb.ca.gov>). Please send written comments to Jerry Wickham at the address below; all comments will be forwarded to the responsible party. **Comments received by August 31, 2010** will be considered and responded to prior to a final determination on the proposed case closure.

Additional information: Contact Jerry Wickham of the Alameda County Department of Environmental Health, 1131 Harbor Bay Parkway, Alameda, CA 94502 at 510-567-6791 or by email at jerry.wickham@acgov.org

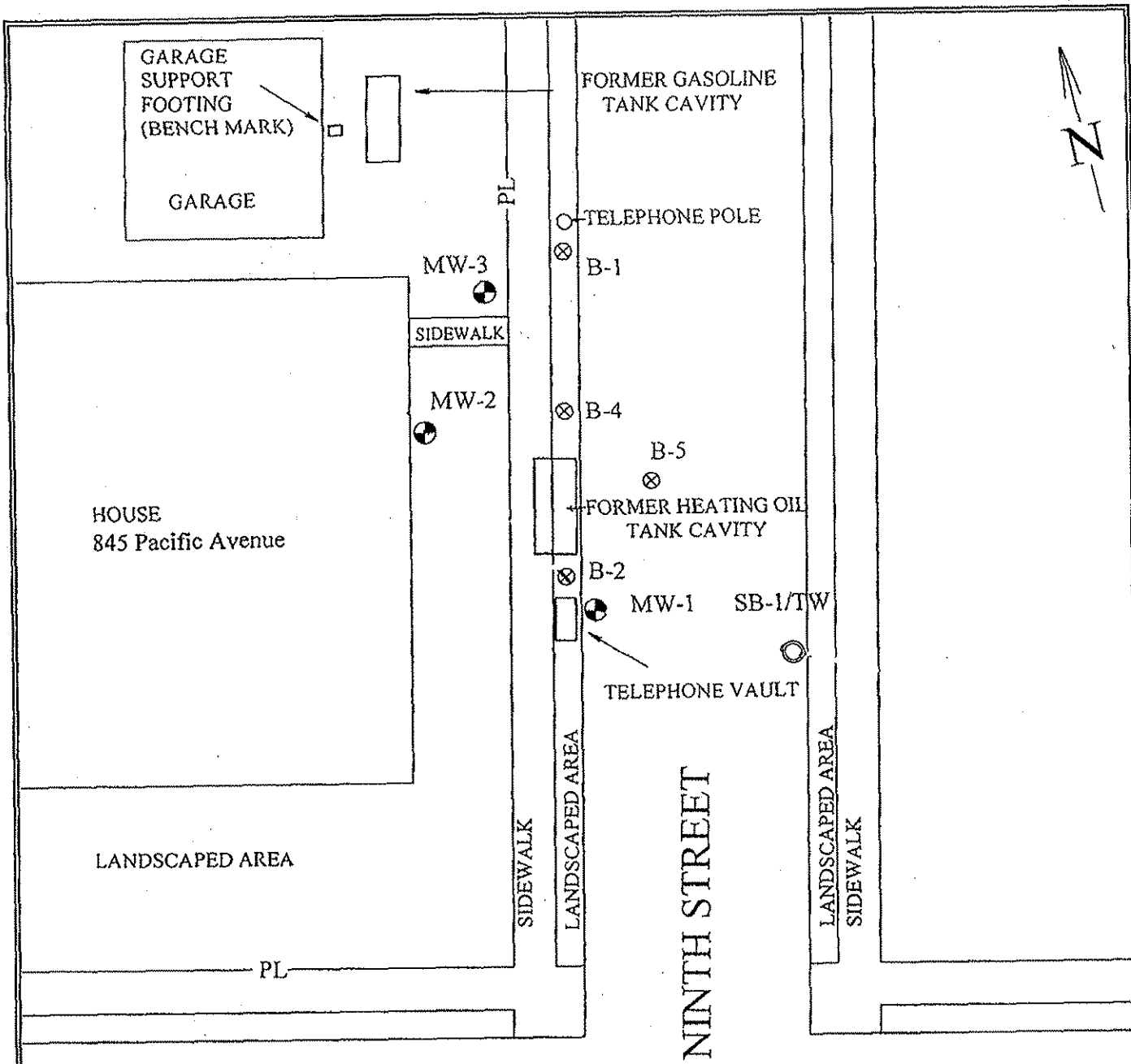

PACIFIC AVENUE

NINTH STREET

LEGEND



- ⊗ B-1 Soil Boring by HK2, Inc.
- MW-1 Monitoring Well
- SB-1/TW Soil Boring/ Temporary Well
- PL Property Line

Source of the Base Map:
HK2, Inc./ SEMCO report

FIGURE 2: SITE PLAN
SHEEHAN PROPERTY
845 Pacific Avenue
Alameda, California

**ADVANCED ASSESSMENT AND
REMEDATION SERVICES**
2380 Salvio Street, Suite 202
Concord, California 94520

ABBOTT RONALD &
Parcel #: 73-409-27
829 PACIFIC AVE
ALAMEDA CA 94501

AGADIER ALBERT F JR ETAL
Parcel #: 73-407-31
836 PACIFIC AVE
ALAMEDA CA 94501

ARTH GEORGE W JR TR &
Parcel #: 73-408-1
10 WEE BLYTHEN
OAKLAND CA 94619

BADUA ROMEO S & LEILA A
Parcel #: 73-409-14
1718 9TH ST
ALAMEDA CA 94501

BURTON JOHN G & MARIANI
Parcel #: 73-409-23-1
841 PACIFIC AVE
ALAMEDA CA 94501

CHAIREZ RAYMOND J &
Parcel #: 73-409-1
1728 9TH ST
ALAMEDA CA 94501

COOPER JOHN TR
Parcel #: 73-409-26
1138 LARCH AVE
MORAGA CA 94556

COOPER JOHN TR
Parcel #: 73-409-25
1138 LARCH AVE
MORAGA CA 94556

DESCHNER PAMELA A &
Parcel #: 73-409-17
830 BUENA VISTA AVE
ALAMEDA CA 94501

FRAATZ CLARIE M TR
Parcel #: 73-407-1
844 PACIFIC AVE
ALAMEDA CA 94501

FREDERICK DIANE M
Parcel #: 73-407-30
1287 CAROLINE ST
ALAMEDA CA 94501

FREDERICK KEITH R & DIANE
Parcel #: 73-407-29
1287 CAROLINE ST
ALAMEDA CA 94501

FREDERICK KEITH R & DIANE
Parcel #: 73-409-29
1287 CAROLINE ST
ALAMEDA CA 94501

GRANDY DANIEL & VALERIE
Parcel #: 73-409-13
1714 9TH ST
ALAMEDA CA 94501

HENNEMAN JOSEPH J & RIKKI
Parcel #: 73-409-30
1716 NASON ST
ALAMEDA CA 94501

HINKLEYRECK MICHAEL &
Parcel #: 73-407-32
840 PACIFIC AVE
ALAMEDA CA 94501

KUGLER ELIZABETH L &
Parcel #: 73-409-15
1724 9TH ST
ALAMEDA CA 94501

LANTICAN LEO D & LOIDA L
Parcel #: 73-409-18
832 BUENA VISTA AVE
ALAMEDA CA 94501

LARSEN URSULA S TR
Parcel #: 73-409-11
905 PACIFIC AVE
ALAMEDA CA 94501

MEDEIROS MARTIN &
Parcel #: 73-409-12
901 PACIFIC AVE
ALAMEDA CA 94501

MRAZ J D TR
Parcel #: 73-409-10
909 PACIFIC AVE
ALAMEDA CA 94501

OHLER BARBARA J
Parcel #: 73-409-31
1720 NASON ST
ALAMEDA CA 94501

PERKINS KRISTY &
Parcel #: 73-409-21
1713 9TH ST
ALAMEDA CA 94501

RESIDENT
Parcel #: 73-408-1
1630 NINTH ST
ALAMEDA CA 94501

RESIDENT
Parcel #: 73-407-29
826 PACIFIC AVE
ALAMEDA CA 94501

RESIDENT
Parcel #: 73-407-30
830 PACIFIC AVE
ALAMEDA CA 94501

RESIDENT
Parcel #: 73-409-16
1726 NASON ST
ALAMEDA CA 94501

RESIDENT
Parcel #: 73-409-20
1719 9TH ST
ALAMEDA CA 94501

RESIDENT
Parcel #: 73-409-26
833 PACIFIC AVE
ALAMEDA CA 94501

RESIDENT
Parcel #: 73-409-22-3
845 PACIFIC AVE
ALAMEDA CA 94501

RESIDENT
Parcel #: 73-409-25
837 PACIFIC AVE
ALAMEDA CA 94501

RESIDENT
Parcel #: 73-409-29
1714 NASON ST
ALAMEDA CA 94501

SHEEHAN WILLIAM J &
Parcel #: 73-409-22-3
1236 BAY ST
ALAMEDA CA 94501

TAPADO CONRADO &
Parcel #: 73-409-16
605 GRAND ST
ALAMEDA CA 94501

TENORIO DANIEL C &
Parcel #: 73-409-19
1725 9TH ST
ALAMEDA CA 94501

WANG DIANA
Parcel #: 73-409-20
390 BRAMBLE CT
FOSTER CITY CA 94404