

Atlantic Richfield Company

Chuck Carmel

Remediation Management Project Manager

PO Box 1257
San Ramon, CA 94583
Phone: (925) 275-3804
Fax: (925) 275-3815
E-Mail: chuck.carmel@bp.com

January 15, 2015

RECEIVED

By Alameda County Environmental Health at 3:38 pm, Jan 15, 2015

Re: Fourth Quarter 2014 Monitoring Report
Atlantic Richfield Company Station #374
6407 Telegraph Avenue, Oakland, California
ACEH Case #RO0000078

"I declare, that to the best of my knowledge at the present time, that the information and/or recommendations contained in the attached document are true and correct."

Submitted by,



Chuck Carmel
Remediation Management Project Manager

Attachment



**FOURTH QUARTER 2014 STATUS REPORT
Atlantic Richfield Company Station #374
6407 Telegraph Avenue
Oakland, Alameda County, California**

Prepared for:

Mr. Chuck Carmel
Atlantic Richfield Company
P.O. Box 1257
San Ramon, CA 94583

Prepared by:

Broadbent & Associates, Inc.
4820 Business Center Drive, Suite 110
Fairfield, California 94534
(707) 455-7290

January 15, 2015

No. 06-88-602



4820 Business Center Drive, Suite 110
Fairfield, CA 94534
[T] 707 455 7290 [F] 707 863 9046
broadbenlinc.com

Creating Solutions. Building Trust.

January 15, 2015

Project No. 06-88-602

Atlantic Richfield Company
P.O. Box 1257
San Ramon, CA 94583
Submitted via ENFOS

Attn.: Mr. Chuck Carmel

Re: Fourth Quarter 2014 Status Report, Atlantic Richfield Company Station #374,
6407 Telegraph Avenue, Oakland, Alameda County, California
ACEH Case #RO0000078

Dear Mr. Carmel

Attached is the *Fourth Quarter 2014 Status Report* for Atlantic Richfield Company (a BP affiliated company) for Station #374 located at 6407 Telegraph Avenue, Oakland, California (Site). Should you have questions regarding the work performed or results obtained, please do not hesitate to contact us at (707) 455-7290.

Sincerely,
BROADBENT & ASSOCIATES, INC.

A handwritten signature in black ink, appearing to read 'Kristene Tidwell', is written over a horizontal line.

Kristene Tidwell, P.G., C.H.G.
Associate Hydrogeologist

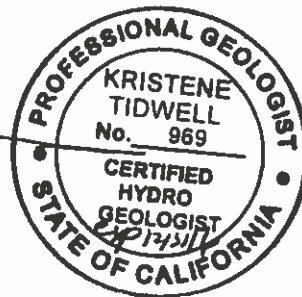

Enclosures

cc: Ms. Karel Detterman, Alameda County Environmental Health (Submitted via ACEH ftp site)
Electronic copy uploaded to GeoTracker

**FOURTH QUARTER 2014
STATUS REPORT
ATLANTIC RICHFIELD COMPANY STATION #374
OAKLAND, CALIFORNIA**

Broadbent & Associates, Inc. (Broadbent) is pleased to present this *Fourth Quarter 2014 Status Report* on behalf of Atlantic Richfield Company (ARC, a BP affiliated company) for Station #374 located at 6407 Telegraph Avenue, Oakland, Alameda County, California (the Site). Monitoring activities at the Site were performed in accordance with an agency directive issued by the Alameda County Environmental Health (ACEH). Details of work performed, discussion of results, and recommendations are provided below.

Facility Name / Address:	Station #374 / 6407 Telegraph Avenue, Oakland, California
Client Project Manager / Title:	Mr. Chuck Carmel / Operations Project Manager
Broadbent Contact:	Ms. Kristene Tidwell, P.G., C.HG.
Broadbent Project No.:	06-88-602
Primary Regulatory Agency / ID No.:	ACEH / Case #RO0000078
Current phase of project:	Monitoring
List of Acronyms / Abbreviations:	See end of report text for list of acronyms/abbreviations used in report.

WORK PERFORMED THIS QUARTER (Fourth Quarter 2014):

1. Submitted *Third Quarter 2014 Monitoring Report* on October 31, 2014.
2. Performed field activities described in the conditionally approved *Second Addendum to Soil Vapor Investigation Work Plan* (submitted June 27, 2014) between the dates of December 2 and December 10, 2014.

WORK SCHEDULED FOR NEXT QUARTER (First Quarter 2015):

1. Submit *Fourth Quarter 2014 Status Report* (contained herein).
2. Complete field activities started during Q4 2014.
3. Submit an *Updated Site Conceptual Model and Soil and Groundwater Investigation Report* within 60 days of securing offsite access.

ACTIVITIES CONDUCTED & RESULTS:

Borings and vapor wells were installed in accordance with the *Second Addendum to Soil Vapor Investigation Work Plan* (submitted June 27, 2014). Boring B-1-141204 hit refusal above the required depth and will be completed during First Quarter 2015.

DISCUSSION:

A Site Location Map is provided as Drawing 1. A current site plan with Additional Soil Vapor Probe and Soil Boring Locations is provided as Drawing 2. The next semi-annual groundwater monitoring/sampling event is scheduled to be conducted during the First Quarter of 2015.

RECOMMENDATIONS:

The next semi-annual groundwater monitoring and sampling event is scheduled to be conducted during First Quarter 2015. An Updated Site Conceptual Model and Soil and Groundwater Investigation Report will be submitted within 60 days of completing the pertinent environmental work.

LIMITATIONS:

The findings presented in this report are based upon observations of field personnel, points investigated, results of laboratory tests performed by Test America and our understanding of ACEH guidelines. Our services were performed in accordance with the generally accepted standard of practice at the time this report was written. No other warranty, expressed or implied was made. This report has been prepared for the exclusive use of Atlantic Richfield Company (a BP affiliated company). It is possible that variations in soil or groundwater conditions could exist beyond points explored in this investigation. Also, changes in site conditions could occur in the future due to variations in rainfall, temperature, regional water usage, or other factors.

ATTACHMENTS:

- Drawing 1: Site Location Map
- Drawing 2: Site Map with Additional Soil Vapor Probe and Soil Boring Locations

LIST OF COMMONLY USED ACRONYMS/ABBREVIATIONS:

ACEH	Alameda County Environmental Health	gal:	Gallons
ARC:	Atlantic Richfield Company	GRO:	Gasoline Range Organics (C6-12)
BAI:	Broadbent & Associates, Inc.	LNAPL:	Light Non-Aqueous Phase Liquid
BTEX:	Benzene, Toluene, Ethylbenzene, Total Xylenes	MTBE:	Methyl Tertiary Butyl Ether
1,2-DCA:	1,2-Dichloroethane	TAME:	Tert-Amyl Methyl Ether
DIPE:	Di-Isopropyl Ether	TBA:	Tert-Butyl Alcohol
EDB:	1,2-Dibromomethane	TOC:	Top Of Casing
ft/ft:	Feet Per Foot	µg/L:	Micrograms Per Liter
UST:	Underground Storage Tank	ft bgs:	Feet Below Ground Surface

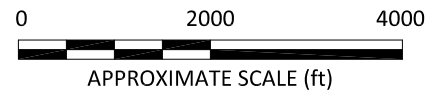
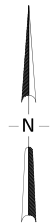
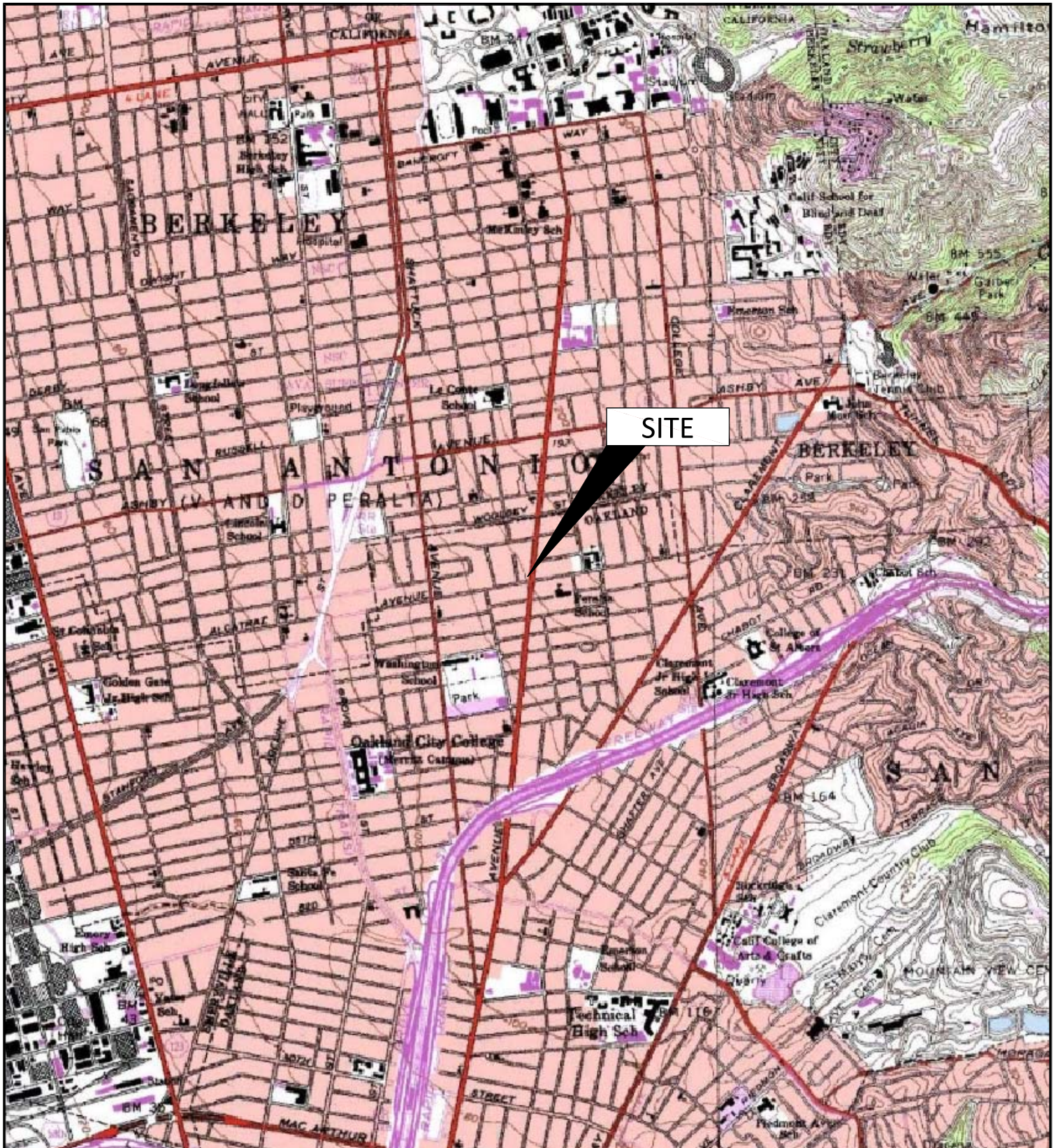

IMAGE SOURCE: USGS

BROADBENT
 875 Cotting Lane, Suite G
 Vacaville, California 95688
 Project No.: 06-88-602 Date: 3/8/2013

Station #374
 6407 Telegraph Ave.
 Oakland, California

Site Location Map

Drawing

1

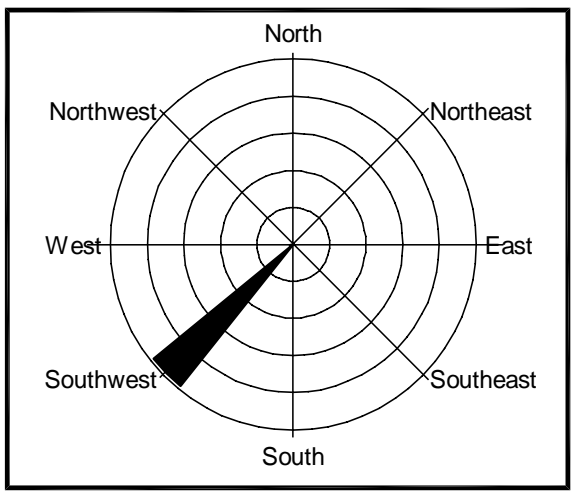
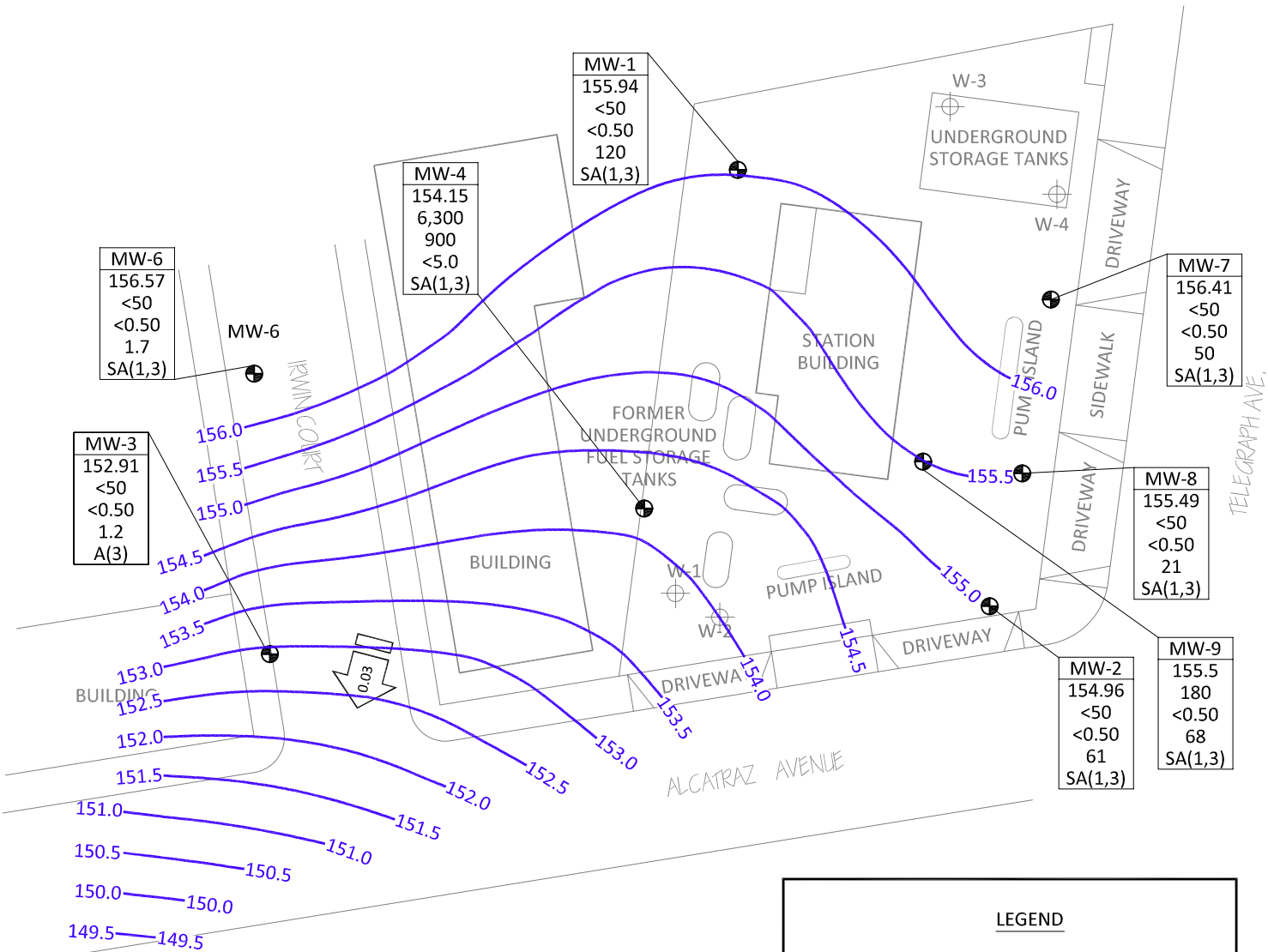

LEGEND

- Monitor Well Location
- Tank Pit Monitor Well Location
- Groundwater Elevation Contour (Feet Above Site Datum)
- Groundwater Gradient (ft/ft)
- A(3) Sampled Annually - Third Quarter
- SA(1,3) Sampled Semi-Annually - First and Third Quarter

WELL	Well Designation
ELEV	Groundwater Elevation (ft)
GRO	GRO, Benzene, and MTBE
BZ	Concentrations (µg/L)
MTBE	
A/SA/Q	Sampling Frequency

NS Not Sampled



NOTE: SITE MAP ADAPTED FROM IT CORPORATION FIGURES. SITE DIMENSIONS AND FACILITY LOCATIONS NOT VERIFIED.