



Atlantic Richfield Company
(a BP affiliated company)

P.O. Box 1257
San Ramon, CA 94583
Phone: (925) 275-3801
Fax: (925) 275-3815

23 January 2009

Re: Fourth Quarter 2008 Ground-Water Monitoring Report
Atlantic Richfield Company Station #374
6407 Telegraph Avenue
Oakland, California
ACEH Case # RO0000078

“I declare, that to the best of my knowledge at the present time, that the information and/or recommendations contained in the attached document are true and correct.”

Submitted by:

Paul Supple
Environmental Business Manger

RECEIVED

2:18 pm, Jan 29, 2009

Alameda County
Environmental Health



Fourth Quarter 2008 Ground-Water Monitoring Report

Atlantic Richfield Company Station #374

6407 Telegraph Avenue

Oakland, California

Prepared for

Mr. Paul Supple
Environmental Business Manager
Atlantic Richfield Company
P.O. Box 1257
San Ramon, California 94583

Prepared by



1324 Mangrove Avenue, Suite 212
Chico, California 95926
(530) 566-1400
www.broadbentinc.com

23 January 2009

Project No. 06-08-602

23 January 2009

Project No. 06-08-602

Atlantic Richfield Company
P.O. Box 1257
San Ramon, CA 94583
Submitted via ENFOS

Attn.: Mr. Paul Supple

Re: Fourth Quarter 2008 Ground-Water Monitoring Report, Atlantic Richfield Company
(a BP affiliated company) Station #374, 6407 Telegraph Avenue, Oakland, Alameda
County, California. ACEH Case #RO0000078

Dear Mr. Supple:

Attached is the *Fourth Quarter 2008 Ground-Water Monitoring Report* for Atlantic Richfield Company Station #374 located at 6407 Telegraph Avenue, Oakland, California (Site). This report presents results of ground-water monitoring conducted at the Site during the Fourth Quarter of 2008.

Should you have questions regarding the work performed or results obtained, please do not hesitate to contact us at (530) 566-1400.

Sincerely,

BROADBENT & ASSOCIATES, INC.



Thomas A. Venus, P.E.
Senior Engineer



Robert H. Miller, P.G., C.HG.
Principal Hydrogeologist

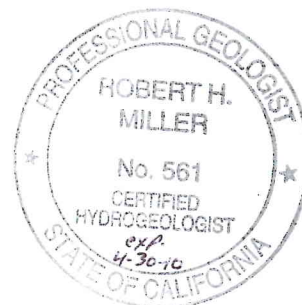

Enclosures

cc: Mr. Paresh Khatri, Alameda County Environmental Health (Submitted via ACEH ftp site)
Electronic copy uploaded to GeoTracker

STATION #374 QUARTERLY GROUND-WATER MONITORING REPORT

Facility: #374	Address:	6407 Telegraph Avenue, Oakland, California
Environmental Business Manager:		Mr. Paul Supple
Consulting Co./Contact Persons:		Broadbent & Associates, Inc.(BAI)/Rob Miller & Tom Venus (530) 566-1400
Consultant Project No.:		06-08-602
Primary Agency/Regulatory ID No.:		Alameda County Environmental Health (ACEH) ACEH Case #RO0000078
Facility Permits/Permitting Agency:		NA

WORK PERFORMED THIS QUARTER (Fourth Quarter 2008):

1. Prepared and submitted *Third Quarter 2008 Ground-Water Monitoring Report* (BAI, 10/15/2008).
2. Conducted ground-water monitoring/sampling for Fourth Quarter 2008. Work performed on 19 November 2008 by Stratus.
3. Conducted subsurface soil investigation as approved by ACEH. Work performed on 12 and 13 November 2008 by Stratus Environmental, Inc. (Stratus).
4. Prepared and submitted *Soil Investigation Report* (BAI, 12/26/2008).
5. Collected compliance soil samples following product line/fuel dispenser upgrades under observation of City of Oakland Fire Department inspection personnel. Work performed by Stratus on 4 and 9 December 2008.

WORK PROPOSED FOR NEXT QUARTER (First Quarter 2009):

1. Prepared and submitted this *Fourth Quarter 2008 Ground-Water Monitoring Report* (contained herein).
2. Prepare and submit product line/fuel dispenser upgrade compliance soil sampling report to City of Oakland Fire Department.
3. Conduct quarterly ground-water monitoring/sampling for First Quarter 2009.

QUARTERLY RESULTS SUMMARY:

Current phase of project:	Ground-water monitoring/sampling
Frequency of ground-water monitoring:	Quarterly: MW-1, MW-2, MW-3, MW-4, MW-5, MW-6
Frequency of ground-water sampling:	Quarterly: MW-1 Semi-Annually (1Q and 3Q): MW-2 and MW-4 Annually (3Q): MW-3, MW-5, and MW-6
Is free product (FP) present on-site:	No
Current remediation techniques:	NA
Depth to ground water (below TOC):	5.94 ft (MW-6) to 11.86 ft (MW-5)
General ground-water flow direction:	Southwest
Approximate hydraulic gradient:	0.03 ft/ft

DISCUSSION:

Fourth quarter 2008 ground-water monitoring and sampling was conducted at Station #374 on 19 November 2008 by Stratus. Water levels were gauged in each of the six wells at the Site. No irregularities were noted in the field during this quarter's water level gauging. Depth-to-water measurements ranged from 5.94 ft at MW-6 to 11.86 ft at MW-5. Resulting ground-water surface

elevations ranged from 155.69 ft above mean sea level (msl) in well MW-1 to 139.47 ft at well MW-5. Water level elevations were between historic minimum and maximum ranges for each well, as summarized in Table 1, with the following exception: the water level elevation reached a historic minimum value of 139.47 ft above msl in well MW-5. Water level elevations yielded a potentiometric ground-water flow direction and gradient to the southwest at approximately 0.03 ft/ft, consistent with historical data reported in Table 3. Ground-water monitoring field data sheets are provided within Appendix A. Measured depths to ground water and respective ground-water elevations are summarized in Table 1. Potentiometric ground-water elevation contours are presented in Drawing 1.

Consistent with the current ground-water sampling schedule, a water sample was collected from well MW-1 at the Site. No irregularities were reported during sampling. Samples were submitted under chain-of-custody protocol to Calscience Environmental Laboratories, Inc. (Garden Grove, California), for analysis of Gasoline Range Organics (GRO, C6-12) by EPA Method 8015B; for Benzene, Toluene, Ethylbenzene, and Total Xylenes (BTEX) by EPA Method 8260B; and tert-Amyl methyl ether (TAME), tert-Butyl alcohol (TBA), Di-isopropyl ether (DIPE), 1,2-Dibromomethane (EDB), 1,2-Dichloroethane (1,2-DCA), Ethanol, Ethyl tert-butyl ether (ETBE), and Methyl tert-butyl ether (MTBE) by EPA Method 8260B. No significant irregularities were noted during laboratory analysis of the samples. Ground-water sampling field data sheets and the laboratory analytical report, including chain-of-custody documentation, are provided in Appendix A.

MTBE was detected above the laboratory reporting limits in well MW-1 at a concentration of 30 milligrams per liter ($\mu\text{g/L}$). The remaining fuel additives and oxygenates were not detected above their laboratory reporting limits in well MW-1. Detected analyte concentrations were within the historic minimum and maximum ranges recorded for well MW-1 with the following exception: MTBE reached a historic minimum concentration of 30 $\mu\text{g/L}$. Historic laboratory analytical results are summarized in Table 1 and Table 2. The most recent GRO, Benzene, and MTBE concentrations are also presented in Drawing 1. A copy of the laboratory analytical report, including chain-of-custody documentation is provided in Appendix A. Ground-water monitoring data (GEO_WELL) and laboratory analytical results (EDF) were uploaded to the GeoTracker AB2886 database. Upload confirmation pages are provided in Appendix B.

CLOSURE:

The findings presented in this report are based upon: observations of Stratus field personnel (see Appendix A), the points investigated, and results of laboratory tests performed by Calscience Environmental Laboratories, Inc. (Garden Grove, California). Our services were performed in accordance with the generally accepted standard of practice at the time this report was written. No other warranty, expressed or implied was made. This report has been prepared for the exclusive use of Atlantic Richfield Company. It is possible that variations in soil or ground-water conditions could exist beyond points explored in this investigation. Also, changes in site conditions could occur in the future due to variations in rainfall, temperature, regional water usage, or other factors.

ATTACHMENTS:

- Drawing 1. Ground-Water Elevation Contours and Analytical Summary Map, 19 November 2008, Station #374, 6407 Telegraph Avenue, Oakland, California
- Table 1. Summary of Ground-Water Monitoring Data: Relative Water Elevations and Laboratory Analyses, Station #374, 6407 Telegraph Ave., Oakland, California

Table 2. Summary of Fuel Additives Analytical Data, Station #374, 6407 Telegraph Ave., Oakland, California

Table 3. Historical Ground-Water Flow Direction and Gradient, Station #374, 6407 Telegraph Ave., Oakland, California

Appendix A. Stratus Ground-Water Sampling Data Package (Includes Field Data Sheets, Laboratory Analytical Report with Chain-of-Custody Documentation, and Field Procedures)

Appendix B. GeoTracker Upload Confirmations

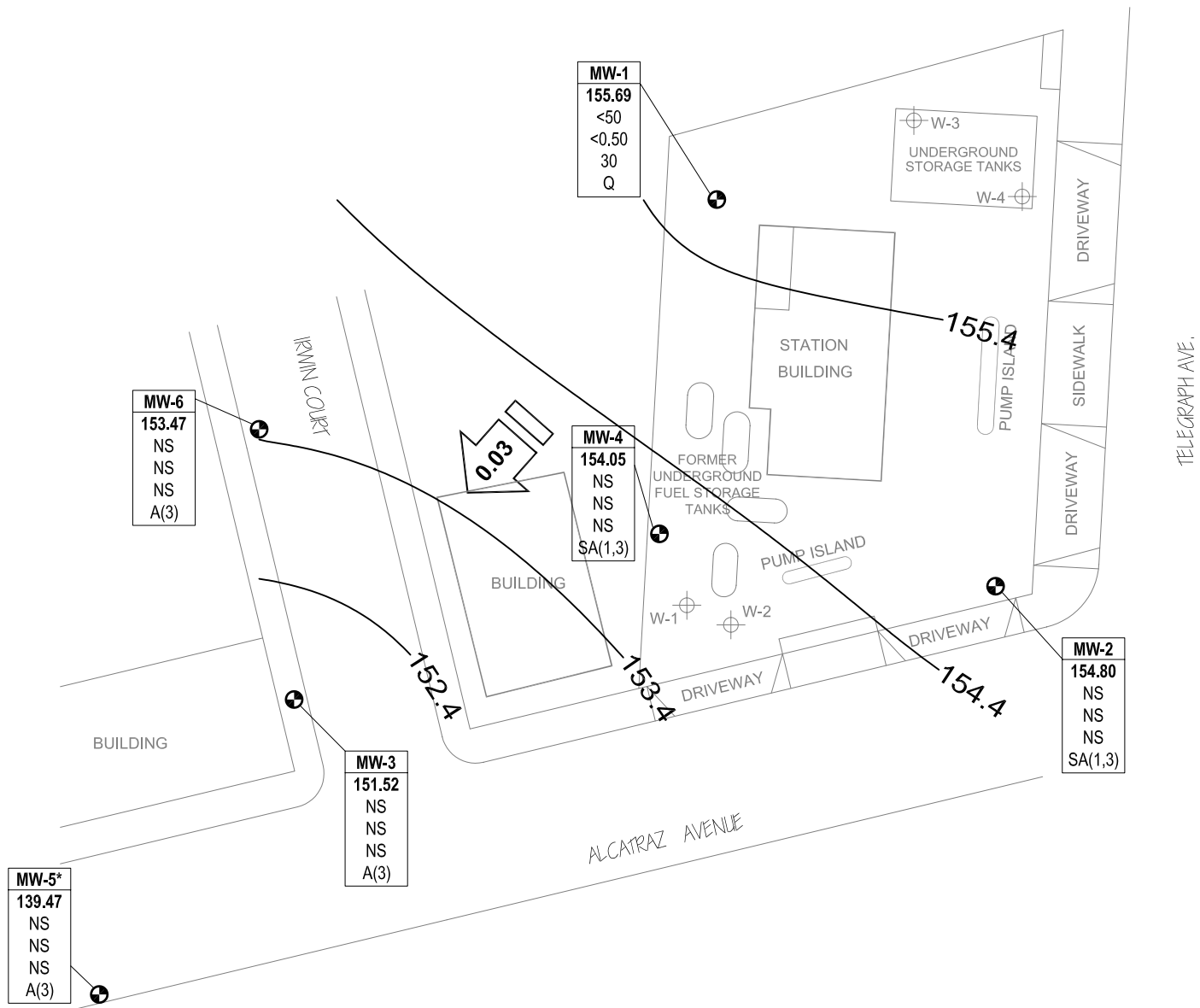

LEGEND

- MONITORING WELL
- TANK PIT MONITORING WELL
- Well** — WELL DESIGNATION
- ELEV** — GROUND-WATER ELEVATION (FT MSL)
- GRO** — GRO, BENZENE & MTBE CONCENTRATIONS IN GROUND WATER (µg/L)
- Benzene**
- MTBE**
- A/Q/SA** — SAMPLING FREQUENCY
- < — NOT DETECTED AT OR ABOVE LABORATORY LIMITS
- Q — SAMPLED QUARTERLY
- SA(1,3) — SAMPLED SEMI-ANNUALLY, 1ST & 3RD QUARTERS
- A(3) — SAMPLED ANNUALLY, 3RD QUARTER
- NS — NOT SAMPLED
- APPROXIMATE GROUND-WATER FLOW AND DIRECTION (FT/FT)
- 152.4 — GROUND-WATER ELEVATION CONTOUR (FT MSL)
- * — Elevation not used for contours

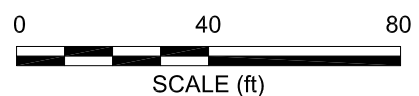

NOTE: SITE MAP ADAPTED FROM IT CORPORATION FIGURES. SITE DIMENSIONS AND FACILITY LOCATIONS NOT VERIFIED.

Table 1. Summary of Ground-Water Monitoring Data: Relative Water Elevations and Laboratory Analyses
Station #374, 6407 Telegraph Ave., Oakland, CA

Well and Sample Date	P/NP	Comments	TOC (feet msl)	Top of Screen (ft bgs)	Bottom of Screen (ft bgs)	DTW (feet bgs)	Water Level Elevation (feet msl)	Concentrations in (µg/L)						DO (mg/L)	pH
								GRO/TPHg	Benzene	Toluene	Ethyl-Benzene	Total Xylenes	MTBE		
MW-1															
6/20/2000	--		158.91	7.00	27.0	6.86	152.05	--	--	--	--	--	--	--	--
9/28/2000	--		158.91	7.00	27.0	7.50	151.41	--	--	--	--	--	--	--	--
12/17/2000	--		158.91	7.00	27.0	7.49	151.42	--	--	--	--	--	--	--	--
3/23/2001	--		158.91	7.00	27.0	5.90	153.01	<50	<0.5	<0.5	<0.5	<0.5	2,710	--	--
6/21/2001	--		158.91	7.00	27.0	7.45	151.46	--	--	--	--	--	--	--	--
9/23/2001	--		158.91	7.00	27.0	8.46	150.45	--	--	--	--	--	--	--	--
12/31/2001	--		158.91	7.00	27.0	5.50	153.41	--	--	--	--	--	--	--	--
3/21/2002	--		158.91	7.00	27.0	4.71	154.20	<5,000	<50	<50	<50	<50	2,000	--	--
4/17/2002	--		158.91	7.00	27.0	5.54	153.37	--	--	--	--	--	--	--	--
8/12/2002	--		158.91	7.00	27.0	7.77	151.14	--	--	--	--	--	--	--	--
12/6/2002	--		158.91	7.00	27.0	7.65	151.26	--	--	--	--	--	--	--	--
1/29/2003	--	b	158.91	7.00	27.0	5.88	153.03	--	--	--	--	--	--	--	--
5/23/2003	--		158.91	7.00	27.0	5.62	153.29	<10,000	<100	<100	<100	<100	1,600	1.3	7.1
9/4/2003	--		158.91	7.00	27.0	7.85	151.06	--	--	--	--	--	--	--	--
11/20/2003	P		158.91	7.00	27.0	8.17	150.74	1,600	<10	<10	<10	<10	1,500	1.7	6.7
02/02/2004	P	f	164.57	7.00	27.0	6.71	157.86	--	--	--	--	--	--	1.0	--
05/14/2004	P		164.57	7.00	27.0	7.08	157.49	<2,500	<25	<25	<25	<25	1,200	1.4	6.6
09/02/2004	P		164.57	7.00	27.0	8.12	156.45	580	<5.0	<5.0	<5.0	<5.0	660	3.8	6.7
11/04/2004	P		164.57	7.00	27.0	7.38	157.19	1,700	<10	<10	<10	<10	580	6.0	6.5
02/08/2005	P		164.57	7.00	27.0	6.60	157.97	<1,000	<10	<10	<10	<10	610	0.71	6.5
05/09/2005	P	e	164.57	7.00	27.0	6.84	157.73	540	<5.0	<5.0	<5.0	5.5	620	3.12	6.6
08/11/2005	P		164.57	7.00	27.0	7.36	157.21	540	<2.5	<2.5	<2.5	4.0	390	0.8	6.6
11/18/2005	P	e	164.57	7.00	27.0	8.02	156.55	350	<2.5	<2.5	<2.5	<2.5	340	2.6	6.7
02/16/2006	P	e	164.57	7.00	27.0	6.44	158.13	350	<2.5	<2.5	<2.5	<2.5	340	1.6	6.7
5/30/2006	P		164.57	7.00	27.0	6.87	157.70	270	<2.5	<2.5	<2.5	<2.5	420	4.73	6.4
8/24/2006	P		164.57	7.00	27.0	7.75	156.82	95	<5.0	<5.0	<5.0	<5.0	180	0.65	6.9
11/1/2006	P		164.57	7.00	27.0	8.28	156.29	120	<5.0	<5.0	<5.0	<5.0	220	1.65	7.07
2/7/2007	NP	e	164.57	7.00	27.0	7.40	157.17	120	<5.0	<5.0	<5.0	<5.0	190	1.88	7.45
5/8/2007	P		164.57	7.00	27.0	6.50	158.07	<500	<5.0	<5.0	<5.0	<5.0	420	1.21	6.94
8/8/2007	NP	e	164.57	7.00	27.0	8.17	156.40	82	<0.50	<0.50	<0.50	<0.50	110	1.16	7.00
11/14/2007	NP		164.57	7.00	27.0	8.01	156.56	170	<2.5	<2.5	<2.5	<2.5	210	1.92	6.49

Table 1. Summary of Ground-Water Monitoring Data: Relative Water Elevations and Laboratory Analyses

Station #374, 6407 Telegraph Ave., Oakland, CA

Well and Sample Date	P/NP	Comments	TOC (feet msl)	Top of Screen (ft bgs)	Bottom of Screen (ft bgs)	DTW (feet bgs)	Water Level Elevation (feet msl)	Concentrations in (µg/L)						DO (mg/L)	pH
								GRO/TPHg	Benzene	Toluene	Ethyl-Benzene	Total Xylenes	MTBE		
MW-1 Cont.															
2/22/2008	P		164.57	7.00	27.0	6.00	158.57	<50	<0.50	<0.50	<0.50	<0.50	250	2.57	6.65
5/24/2008	NP		164.57	7.00	27.0	7.58	156.99	<50	<5.0	<5.0	<5.0	<5.0	380	2.28	6.81
8/21/2008	NP		164.57	7.00	27.0	8.60	155.97	<50	<2.5	<2.5	<2.5	<2.5	170	2.16	6.98
11/19/2008	NP		164.57	7.00	27.0	8.88	155.69	<50	<0.50	<0.50	<0.50	<0.50	30	2.12	7.27
MW-2															
6/20/2000	--		157.92	7.00	27.0	7.67	150.25	--	--	--	--	--	--	--	--
9/28/2000	--		157.92	7.00	27.0	8.51	149.41	--	--	--	--	--	--	--	--
12/17/2000	--		157.92	7.00	27.0	8.14	149.78	--	--	--	--	--	--	--	--
3/23/2001	--		157.92	7.00	27.0	7.21	150.71	<50	<0.5	<0.5	<0.5	<0.5	<2.5	--	--
6/21/2001	--		157.92	7.00	27.0	7.99	149.93	--	--	--	--	--	--	--	--
9/23/2001	--		157.92	7.00	27.0	8.52	149.40	--	--	--	--	--	--	--	--
12/31/2001	--		157.92	7.00	27.0	6.01	151.91	--	--	--	--	--	--	--	--
3/21/2002	--		157.92	7.00	27.0	5.95	151.97	<50	<0.5	<0.5	<0.5	<0.5	45	--	--
4/17/2002	--		157.92	7.00	27.0	6.45	151.47	--	--	--	--	--	--	--	--
8/12/2002	--		157.92	7.00	27.0	8.08	149.84	--	--	--	--	--	--	--	--
12/6/2002	--		157.92	7.00	27.0	8.29	149.63	--	--	--	--	--	--	--	--
1/29/2003	--	b	157.92	7.00	27.0	7.22	150.70	--	--	--	--	--	--	--	--
5/23/2003	--		157.92	7.00	27.0	6.85	151.07	<50	<0.50	<0.50	<0.50	<0.50	55	1.4	7.2
9/4/2003	--		157.92	7.00	27.0	7.94	149.98	--	--	--	--	--	--	--	--
11/20/2003	--		157.92	7.00	27.0	8.05	149.87	--	--	--	--	--	--	--	--
02/02/2004	P	f	163.46	7.00	27.0	7.00	156.46	74	<0.50	<0.50	<0.50	<0.50	37	1.1	8.9
05/14/2004	--		163.46	7.00	27.0	7.97	155.49	--	--	--	--	--	--	--	--
09/02/2004	P		163.46	7.00	27.0	8.19	155.27	<250	<2.5	<2.5	<2.5	<2.5	67	2.7	6.9
11/04/2004	--		163.46	7.00	27.0	7.54	155.92	--	--	--	--	--	--	--	--
02/08/2005	P		163.46	7.00	27.0	6.72	156.74	<50	<0.50	<0.50	<0.50	<0.50	30	0.86	6.7
05/09/2005	--		163.46	7.00	27.0	7.16	156.30	--	--	--	--	--	--	--	--
08/11/2005	P		163.46	7.00	27.0	7.85	155.61	<50	<0.50	<0.50	<0.50	<0.50	35	1.0	6.6
11/18/2005	--		163.46	7.00	27.0	8.23	155.23	--	--	--	--	--	--	--	--
02/16/2006	P		163.46	7.00	27.0	6.82	156.64	<50	<0.50	<0.50	<0.50	<0.50	39	1.3	7.0
5/30/2006	--		163.46	7.00	27.0	7.23	156.23	--	--	--	--	--	--	--	--

Table 1. Summary of Ground-Water Monitoring Data: Relative Water Elevations and Laboratory Analyses

Station #374, 6407 Telegraph Ave., Oakland, CA

Well and Sample Date	P/NP	Comments	TOC (feet msl)	Top of Screen (ft bgs)	Bottom of Screen (ft bgs)	DTW (feet bgs)	Water Level Elevation (feet msl)	Concentrations in (µg/L)						DO (mg/L)	pH
								GRO/TPHg	Benzene	Toluene	Ethyl-Benzene	Total Xylenes	MTBE		
MW-2 Cont.															
8/24/2006	P		163.46	7.00	27.0	8.00	155.46	60	<0.50	<0.50	<0.50	<0.50	25	0.90	6.8
11/1/2006	--		163.46	7.00	27.0	8.38	155.08	--	--	--	--	--	--	--	--
2/7/2007	NP		163.46	7.00	27.0	7.88	155.58	<50	0.50	<0.50	<0.50	<0.50	7.2	0.94	7.39
5/8/2007	--		163.46	7.00	27.0	7.28	156.18	--	--	--	--	--	--	--	--
8/8/2007	NP		163.46	7.00	27.0	8.38	155.08	88	3.2	<0.50	<0.50	<0.50	7.2	0.94	7.75
11/14/2007	--		163.46	7.00	27.0	8.10	155.36	--	--	--	--	--	--	--	--
2/22/2008	P		163.46	7.00	27.0	6.75	156.71	<50	<0.50	<0.50	<0.50	<0.50	24	2.18	7.02
5/24/2008	--		163.46	7.00	27.0	7.98	155.48	--	--	--	--	--	--	--	--
8/21/2008	NP		163.46	7.00	27.0	8.58	154.88	<50	2.6	<0.50	<0.50	<0.50	4.9	2.20	7.11
11/19/2008	--		163.46	7.00	27.0	8.66	154.80	--	--	--	--	--	--	--	--
MW-3															
6/20/2000	--		153.64	7.00	27.0	6.42	147.22	<50	<0.5	<0.5	<0.5	<1.0	<10	--	--
9/28/2000	--		153.64	7.00	27.0	7.31	146.33	--	--	--	--	--	--	--	--
12/17/2000	--		153.64	7.00	27.0	6.45	147.19	<50	<0.5	<0.5	<0.5	<0.5	<2.5	--	--
3/23/2001	--		153.64	7.00	27.0	6.01	147.63	--	--	--	--	--	--	--	--
6/21/2001	--		153.64	7.00	27.0	6.80	146.84	110	5.5	<0.5	5.4	4.1	2.5	--	--
9/23/2001	--		153.64	7.00	27.0	7.32	146.32	--	--	--	--	--	--	--	--
12/31/2001	--		153.64	7.00	27.0	4.48	149.16	<50	<0.5	<0.5	<0.5	<0.5	4.9	--	--
3/21/2002	--		153.64	7.00	27.0	4.36	149.28	--	--	--	--	--	--	--	--
4/17/2002	--		153.64	7.00	27.0	5.31	148.33	<50	<0.5	<0.5	<0.5	<0.5	8.7	--	--
8/12/2002	--		153.64	7.00	27.0	7.00	146.64	--	--	--	--	--	--	--	--
12/6/2002	--		153.64	7.00	27.0	7.32	146.32	<50	<0.5	<0.5	<0.5	<0.5	6.2	1.4	6.7
1/29/2003	--	b	153.64	7.00	27.0	6.07	147.57	--	--	--	--	--	--	--	--
5/23/2003	--		153.64	7.00	27.0	6.45	147.19	<50	<0.50	<0.50	<0.50	<0.50	1.6	0.9	7.7
9/4/2003	--	c	153.64	7.00	27.0	6.93	146.71	--	--	--	--	--	--	--	--
11/20/2003	--	c	153.64	7.00	27.0	7.04	146.60	--	--	--	--	--	--	--	--
02/02/2004	--	f	159.21	7.00	27.0	5.92	153.29	--	--	--	--	--	--	--	--
05/14/2004	--		159.21	7.00	27.0	7.52	151.69	--	--	--	--	--	--	--	--
09/02/2004	P		159.21	7.00	27.0	7.19	152.02	<50	<0.50	<0.50	<0.50	<0.50	6.5	9.3	8.9
11/04/2004	--		159.21	7.00	27.0	6.40	152.81	--	--	--	--	--	--	--	--

Table 1. Summary of Ground-Water Monitoring Data: Relative Water Elevations and Laboratory Analyses

Station #374, 6407 Telegraph Ave., Oakland, CA

Well and Sample Date	P/NP	Comments	TOC (feet msl)	Top of Screen (ft bgs)	Bottom of Screen (ft bgs)	DTW (feet bgs)	Water Level Elevation (feet msl)	Concentrations in (µg/L)						DO (mg/L)	pH
								GRO/TPHg	Benzene	Toluene	Ethyl-Benzene	Total Xylenes	MTBE		
MW-3 Cont.															
02/08/2005	--		159.21	7.00	27.0	6.01	153.20	--	--	--	--	--	--	--	--
05/09/2005	--		159.21	7.00	27.0	6.74	152.47	--	--	--	--	--	--	--	--
08/11/2005	P		159.21	7.00	27.0	6.77	152.44	<50	<0.50	<0.50	<0.50	<0.50	11	1.9	6.5
11/18/2005	--		159.21	7.00	27.0	7.83	151.38	--	--	--	--	--	--	--	--
02/16/2006	--		159.21	7.00	27.0	7.26	151.95	--	--	--	--	--	--	--	--
5/30/2006	--		159.21	7.00	27.0	5.82	153.39	--	--	--	--	--	--	--	--
8/24/2006	P		159.21	7.00	27.0	7.00	152.21	<50	<0.50	<0.50	<0.50	<0.50	7.6	1.15	6.4
11/1/2006	--		159.21	7.00	27.0	7.50	151.71	--	--	--	--	--	--	--	--
2/7/2007	--		159.21	7.00	27.0	6.90	152.31	--	--	--	--	--	--	--	--
5/8/2007	--		159.21	7.00	27.0	5.95	153.26	--	--	--	--	--	--	--	--
8/8/2007	NP		159.21	7.00	27.0	7.47	151.74	<50	<0.50	<0.50	<0.50	<0.50	1.2	1.21	6.93
11/14/2007	--		159.21	7.00	27.0	7.05	152.16	--	--	--	--	--	--	--	--
2/22/2008	--		159.21	7.00	27.0	5.50	153.71	--	--	--	--	--	--	--	--
5/24/2008	--		159.21	7.00	27.0	7.03	152.18	--	--	--	--	--	--	--	--
8/21/2008	NP		159.21	7.00	27.0	7.80	151.41	<50	<0.50	<0.50	<0.50	<0.50	3.1	2.11	6.84
11/19/2008	--		159.21	7.00	27.0	7.69	151.52	--	--	--	--	--	--	--	--
MW-4															
6/20/2000	--	c	156.53	7.00	27.0	7.50	149.03	20,000	5,100	440	1,000	1,700	<250	--	--
9/28/2000	--		156.53	7.00	27.0	8.20	148.33	--	--	--	--	--	--	--	--
12/17/2000	--		156.53	7.00	27.0	8.11	148.42	4,320	1,240	<20	27.2	249	<100	--	--
3/23/2001	--		156.53	7.00	27.0	6.69	149.84	--	--	--	--	--	--	--	--
6/21/2001	--		156.53	7.00	27.0	8.01	148.52	2,800	470	16	19	160	130	--	--
9/23/2001	--		156.53	7.00	27.0	8.91	147.62	--	--	--	--	--	--	--	--
12/31/2001	--		156.53	7.00	27.0	4.42	152.11	4,600	1,500	100	160	210	160	--	--
3/21/2002	--		156.53	7.00	27.0	4.98	151.55	--	--	--	--	--	--	--	--
4/17/2002	--		156.53	7.00	27.0	6.23	150.30	7,100	2,200	110	290	450	<250	--	--
8/12/2002	--		156.53	7.00	27.0	8.24	148.29	--	--	--	--	--	--	--	--
12/6/2002	--	a	156.53	7.00	27.0	8.42	148.11	1,500	410	6.8	20	29	43	1.1	6.7
1/29/2003	--	b	156.53	7.00	27.0	7.20	149.33	--	--	--	--	--	--	--	--
5/23/2003	--		156.53	7.00	27.0	7.18	149.35	<5,000	1,300	89	210	260	<50	1.4	6.9

Table 1. Summary of Ground-Water Monitoring Data: Relative Water Elevations and Laboratory Analyses
Station #374, 6407 Telegraph Ave., Oakland, CA

Well and Sample Date	P/NP	Comments	TOC (feet msl)	Top of Screen (ft bgs)	Bottom of Screen (ft bgs)	DTW (feet bgs)	Water Level Elevation (feet msl)	Concentrations in (µg/L)						DO (mg/L)	pH
								GRO/TPHg	Benzene	Toluene	Ethyl-Benzene	Total Xylenes	MTBE		
MW-4 Cont.															
9/4/2003	--	c	156.53	7.00	27.0	8.15	148.38	--	--	--	--	--	--	--	--
11/20/2003	--	c	156.53	7.00	27.0	8.73	147.80	--	--	--	--	--	--	--	--
02/02/2004	P	c, f, g	163.25	7.00	27.0	6.25	157.00	980	280	21	29	38	29	1.4	10.6
05/14/2004	--	g	163.25	7.00	27.0	8.38	154.87	--	--	--	--	--	--	--	--
09/02/2004	P	g	163.25	7.00	27.0	8.36	154.89	260	11	<1.0	5.5	14	28	2.4	7.4
11/04/2004	--	c, g	163.25	7.00	27.0	7.71	155.54	--	--	--	--	--	--	--	--
02/08/2005	P	g	163.25	7.00	27.0	6.27	156.98	7,500	1,700	320	480	920	45	0.65	6.5
05/09/2005	--	g	163.25	7.00	27.0	5.90	157.35	--	--	--	--	--	--	--	--
08/11/2005	P	g	163.25	7.00	27.0	7.96	155.29	3,100	1,100	41	160	110	32	0.6	6.5
11/18/2005	--	g	163.25	7.00	27.0	8.57	154.68	--	--	--	--	--	--	--	--
02/16/2006	P	g	163.25	7.00	27.0	6.28	156.97	9,400	1,800	130	600	420	35	0.5	6.8
5/30/2006	--	g	163.25	7.00	27.0	7.02	156.23	--	--	--	--	--	--	--	--
8/24/2006	P	g	162.47	7.00	27.0	8.26	154.21	3,600	1,400	21	110	70	39	1.00	6.8
11/1/2006	--		163.25	7.00	27.0	8.67	154.58	--	--	--	--	--	--	--	--
2/7/2007	NP		163.25	7.00	27.0	8.02	155.23	3,100	570	17	170	110	67	0.95	7.07
5/8/2007	--		163.25	7.00	27.0	7.03	156.22	--	--	--	--	--	--	--	--
8/8/2007	NP		163.25	7.00	27.0	8.60	154.65	2,900	630	22	67	57	72	0.93	6.79
11/14/2007	--		163.25	7.00	27.0	8.53	154.72	--	--	--	--	--	--	--	--
2/22/2008	P		163.25	7.00	27.0	6.25	157.00	3,900	880	39	180	92	70	2.31	6.87
5/24/2008	--	d	163.25	7.00	27.0	--	--	--	--	--	--	--	--	--	--
8/21/2008	NP		163.25	7.00	27.0	8.96	154.29	3,700	1,100	26	85	130	53	2.26	6.80
11/19/2008	--		163.25	7.00	27.0	9.20	154.05	--	--	--	--	--	--	--	--
MW-5															
6/20/2000	--		151.33	10.00	23.0	7.84	143.49	<50	<0.5	<0.5	<0.5	<1.0	<10	--	--
9/28/2000	--		151.33	10.00	23.0	8.37	142.96	<50	<0.5	<0.5	<0.5	<0.5	<2.5	--	--
12/17/2000	--		151.33	10.00	23.0	8.36	142.97	<50	<0.5	<0.5	<0.5	<0.5	<2.5	--	--
3/23/2001	--		151.33	10.00	23.0	7.55	143.78	<50	<0.5	<0.5	<0.5	<0.5	<2.5	--	--
6/21/2001	--		151.33	10.00	23.0	8.20	143.13	<50	<0.5	<0.5	<0.5	<0.5	<2.5	--	--
9/23/2001	--		151.33	10.00	23.0	8.68	142.65	<50	<0.5	<0.5	<0.5	<0.5	<2.5	--	--
12/31/2001	--		151.33	10.00	23.0	7.57	143.76	<50	<0.5	<0.5	<0.5	<0.5	<2.5	--	--

Table 1. Summary of Ground-Water Monitoring Data: Relative Water Elevations and Laboratory Analyses
Station #374, 6407 Telegraph Ave., Oakland, CA

Well and Sample Date	P/NP	Comments	TOC (feet msl)	Top of Screen (ft bgs)	Bottom of Screen (ft bgs)	DTW (feet bgs)	Water Level Elevation (feet msl)	Concentrations in (µg/L)					DO (mg/L)	pH	
								GRO/TPHg	Benzene	Toluene	Ethyl-Benzene	Total Xylenes			MTBE
MW-5 Cont.															
3/21/2002	--		151.33	10.00	23.0	6.12	145.21	<50	<0.5	<0.5	<0.5	<0.5	3.2	--	--
4/17/2002	--		151.33	10.00	23.0	6.61	144.72	<50	<0.5	<0.5	<0.5	<0.5	<2.5	--	--
8/12/2002	--		151.33	10.00	23.0	8.14	143.19	<50	<0.5	<0.5	<0.5	<0.5	<2.5	4.1	7.6
12/6/2002	--		151.33	10.00	23.0	8.65	142.68	<50	<0.5	<0.5	<0.5	<0.5	<2.5	1.1	6.8
1/29/2003	--	b	151.33	10.00	23.0	7.22	144.11	<50	<0.5	<0.5	<0.5	<0.5	<0.5	1	6.6
5/23/2003	--		151.33	10.00	23.0	7.31	144.02	<50	<0.50	<0.50	<0.50	<0.50	<0.50	1.1	6.6
9/4/2003	--		151.33	10.00	23.0	9.50	141.83	<50	<0.50	<0.50	<0.50	<0.50	<0.50	3.2	6.7
11/20/2003	--		151.33	10.00	23.0	8.31	143.02	--	--	--	--	--	--	--	--
02/02/2004	--	c, f, h	151.33	10.00	23.0	6.92	144.41	--	--	--	--	--	--	--	--
05/14/2004	--	h	151.33	10.00	23.0	8.56	142.77	--	--	--	--	--	--	--	--
09/02/2004	P	h	151.33	10.00	23.0	8.79	142.54	<50	<0.50	<0.50	<0.50	<0.50	<0.50	3.5	6.8
11/04/2004	--	c, h	151.33	10.00	23.0	8.33	143.00	--	--	--	--	--	--	--	--
02/08/2005	--	h	151.33	10.00	23.0	7.28	144.05	--	--	--	--	--	--	--	--
05/09/2005	--	h	151.33	10.00	23.0	8.19	143.14	--	--	--	--	--	--	--	--
08/11/2005	P	h	151.33	10.00	23.0	8.39	142.94	<50	<0.50	<0.50	<0.50	<0.50	<0.50	1.2	6.6
11/18/2005	--	h	151.33	10.00	23.0	11.25	140.08	--	--	--	--	--	--	--	--
02/16/2006	--	h	151.33	10.00	23.0	9.22	142.11	--	--	--	--	--	--	--	--
5/30/2006	--	h	151.33	10.00	23.0	7.52	143.81	--	--	--	--	--	--	--	--
8/24/2006	P	h	--	10.00	23.0	7.95	--	<50	<0.50	<0.50	<0.50	<0.50	<0.50	2.60	6.6
11/1/2006	--		151.33	10.00	23.0	8.32	143.01	--	--	--	--	--	--	--	--
2/7/2007	--		151.33	10.00	23.0	8.25	143.08	--	--	--	--	--	--	--	--
5/8/2007	--		151.33	10.00	23.0	7.60	143.73	--	--	--	--	--	--	--	--
8/8/2007	P		151.33	10.00	23.0	8.12	143.21	<50	<0.50	<0.50	<0.50	<0.50	<0.50	3.26	7.31
11/14/2007	--		151.33	10.00	23.0	9.10	142.23	--	--	--	--	--	--	--	--
2/22/2008	--		151.33	10.00	23.0	7.48	143.85	--	--	--	--	--	--	--	--
5/24/2008	--		151.33	10.00	23.0	8.12	143.21	--	--	--	--	--	--	--	--
8/21/2008	P		151.33	10.00	23.0	8.65	142.68	<50	<0.50	<0.50	<0.50	<0.50	<0.50	2.14	6.54
11/19/2008	--		151.33	10.00	23.0	11.86	139.47	--	--	--	--	--	--	--	--
MW-6															
6/20/2000	--		153.84	5.00	15.0	4.79	149.05	--	--	--	--	--	--	--	--

**Table 1. Summary of Ground-Water Monitoring Data: Relative Water Elevations and Laboratory Analyses
Station #374, 6407 Telegraph Ave., Oakland, CA**

Well and Sample Date	P/NP	Comments	TOC (feet msl)	Top of Screen (ft bgs)	Bottom of Screen (ft bgs)	DTW (feet bgs)	Water Level Elevation (feet msl)	Concentrations in (µg/L)						DO (mg/L)	pH
								GRO/TPHg	Benzene	Toluene	Ethyl-Benzene	Total Xylenes	MTBE		
MW-6 Cont.															
9/28/2000	--		153.84	5.00	15.0	5.39	148.45	--	--	--	--	--	--	--	--
12/17/2000	--		153.84	5.00	15.0	4.71	149.13	--	--	--	--	--	--	--	--
3/23/2001	--		153.84	5.00	15.0	4.69	149.15	<50	<0.5	<0.5	<0.5	<0.5	<2.5	--	--
6/21/2001	--		153.84	5.00	15.0	5.22	148.62	--	--	--	--	--	--	--	--
9/23/2001	--		153.84	5.00	15.0	5.40	148.44	--	--	--	--	--	--	--	--
12/31/2001	--		153.84	5.00	15.0	3.95	149.89	--	--	--	--	--	--	--	--
3/21/2002	--		153.84	5.00	15.0	2.94	150.90	<50	<0.5	<0.5	<0.5	<0.5	5.2	--	--
4/17/2002	--		153.84	5.00	15.0	5.11	148.73	--	--	--	--	--	--	--	--
8/12/2002	--		153.84	5.00	15.0	5.23	148.61	--	--	--	--	--	--	--	--
12/6/2002	--		153.84	5.00	15.0	5.29	148.55	--	--	--	--	--	--	--	--
1/29/2003	--	b	153.84	5.00	15.0	4.79	149.05	--	--	--	--	--	--	--	--
5/23/2003	--		153.84	5.00	15.0	4.31	149.53	<50	<0.50	<0.50	<0.50	<0.50	9.4	1	6.7
09/04/03	--	d	153.84	5.00	15.0	--	--	--	--	--	--	--	--	--	--
11/20/2003	--		153.84	5.00	15.0	6.31	147.53	--	--	--	--	--	--	--	--
02/02/2004	--		159.41	5.00	15.0	4.78	154.63	--	--	--	--	--	--	--	--
05/14/2004	--		159.41	5.00	15.0	6.29	153.12	--	--	--	--	--	--	--	--
09/02/2004	--	d	159.41	5.00	15.0	5.79	153.62	--	--	--	--	--	--	--	--
11/04/2004	--	d	159.41	5.00	15.0	--	--	--	--	--	--	--	--	--	--
02/08/2005	--		159.41	5.00	15.0	5.13	154.28	--	--	--	--	--	--	--	--
05/09/2005	--		159.41	5.00	15.0	4.52	154.89	--	--	--	--	--	--	--	--
08/11/2005	P		159.41	5.00	15.0	5.02	154.39	<50	<0.50	<0.50	<0.50	<0.50	7.9	2.1	6.6
11/18/2005	--		159.41	5.00	15.0	6.31	153.10	--	--	--	--	--	--	--	--
02/16/2006	--		159.41	5.00	15.0	4.24	155.17	--	--	--	--	--	--	--	--
5/30/2006	--		159.41	5.00	15.0	4.45	154.96	--	--	--	--	--	--	--	--
8/24/2006	P		159.41	5.00	15.0	5.18	154.23	<50	<0.50	<0.50	<0.50	<0.50	12	3.4	6.8
11/1/2006	--		159.41	5.00	15.0	6.05	153.36	--	--	--	--	--	--	--	--
2/7/2007	--		159.41	5.00	15.0	5.00	154.41	--	--	--	--	--	--	--	--
5/8/2007	--		159.41	5.00	15.0	4.30	155.11	--	--	--	--	--	--	--	--
8/8/2007	NP		159.41	5.00	15.0	5.51	153.90	<50	<0.50	<0.50	<0.50	<0.50	0.57	2.94	6.87
11/14/2007	--		159.41	5.00	15.0	5.38	154.03	--	--	--	--	--	--	--	--
2/22/2008	--		159.41	5.00	15.0	4.70	154.71	--	--	--	--	--	--	--	--

Table 1. Summary of Ground-Water Monitoring Data: Relative Water Elevations and Laboratory Analyses
Station #374, 6407 Telegraph Ave., Oakland, CA

Well and Sample Date	P/NP	Comments	TOC (feet msl)	Top of Screen (ft bgs)	Bottom of Screen (ft bgs)	DTW (feet bgs)	Water Level Elevation (feet msl)	Concentrations in (µg/L)						DO (mg/L)	pH
								GRO/TPHg	Benzene	Toluene	Ethyl-Benzene	Total Xylenes	MTBE		
MW-6 Cont.															
5/24/2008	--		159.41	5.00	15.0	5.25	154.16	--	--	--	--	--	--	--	--
8/21/2008	NP		159.41	5.00	15.0	6.14	153.27	<50	<0.50	<0.50	<0.50	<0.50	1.9	1.99	7.13
11/19/2008	--		159.41	5.00	15.0	5.94	153.47	--	--	--	--	--	--	--	--

SYMBOLS AND ABBREVIATIONS:

-- = Not analyzed/applicable/measured/available
< = Not detected at or above laboratory reporting limit
DO = Dissolved oxygen
DTW = Depth to water in ft bgs
ft bgs = Feet below ground surface
ft MSL = Feet above mean sea level
GRO = Gasoline range organics
GWE = Groundwater elevation measured in ft MSL
mg/L = Milligrams per liter
MTBE = Methyl tert-butyl ether
NP = Well was not purged prior to sampling
P = Well was purged prior to sampling
TOC = Top of casing measured in ft MSL
TPH-g = Total petroleum hydrocarbons as gasoline
µg/L = Micrograms per liter
BTEX = Benzene, toluene, ethylbenzene and xylenes

FOOTNOTES:

a = Chromatogram pattern: Gasoline C6-C10 for GRO/TPH-g.
b = Beginning this quarter, groundwater samples were analyzed by EPA method 8260B for TPH-g, BTEX, and fuel oxygenates.
c = Wells gauged with ORC sock in well.
d = Well inaccessible
e = The hydrocarbon result for GRO was partly due to individual peaks in the quantitative range.
f = Well resurveyed on 1/27/2004
g = Upon review of survey data (1/27/2004), TOC elevation for MW-4 is actually 162.47 ft.
h = Upon review of survey data (1/27/2004), MW-5 was not surveyed from the TOC. MW-5 was surveyed from the pavement due to inaccessibility to the TOC. Therefore, survey data for MW-5 from the TOC is unavailable.

NOTES:

Beginning in the fourth quarter 2003, the laboratory modified the reported analyte list. TPH-g was changed to GRO. The resulting data may be impacted by the potential of non-TPH-g analytes within the requested fuel range resulting in a higher concentration being reported.

Beginning in the second quarter 2004, the carbon range for GRO was changed from C6-C10 to C4-C12.

Values for DO and pH were obtained through field measurements.

The DTW's and TOC's for wells MW-5 and MW-6 were taken from Delta Environmental sampling sheets because the well logs were not available.

GRO analysis was completed by EPA method 8260B (C4-C12) for samples collected from the time period April 2006 through February 4, 2008. The analysis for GRO was changed to EPA method 8015B (C6-C12) for samples collected from the time period February 5, 2008 through the present.

Note: The data within this table collected prior to April 2006 was provided to Broadbent & Associates, Inc. by Atlantic Richfield Company and their previous consultants. Broadbent & Associates, Inc. has not verified the accuracy of this information.

**Table 2. Summary of Fuel Additives Analytical Data
Station #374, 6407 Telegraph Ave., Oakland, CA**

Well and Sample Date	Concentrations in (µg/L)								Comments
	Ethanol	TBA	MTBE	DIPE	ETBE	TAME	1,2-DCA	EDB	
MW-1									
5/23/2003	<20,000	<4,000	1,600	<100	<100	<100	--	--	
11/20/2003	<2,000	<400	1,500	<10	<10	<10	--	--	a
05/14/2004	<5,000	<1,000	1,200	<25	<25	<25	<25	<25	
09/02/2004	<1,000	<200	660	<5.0	<5.0	<5.0	<5.0	<5.0	
11/04/2004	<2,000	<400	580	<10	<10	<10	<10	<10	
02/08/2005	<2,000	<400	610	<10	<10	<10	<10	<10	
05/09/2005	<1,000	<200	620	<5.0	<5.0	<5.0	<5.0	<5.0	a
08/11/2005	<500	250	390	<2.5	<2.5	2.6	<2.5	<2.5	a
11/18/2005	<500	<100	340	<2.5	<2.5	<2.5	<2.5	<2.5	a
02/16/2006	<1,500	<100	340	<2.5	<2.5	<2.5	<2.5	<2.5	
5/30/2006	<1,500	<100	420	<2.5	<2.5	<2.5	<2.5	<2.5	a
8/24/2006	<3,000	<200	180	<5.0	<5.0	<5.0	<5.0	<5.0	
11/1/2006	<3,000	<200	220	<5.0	<5.0	<5.0	<5.0	<5.0	a
2/7/2007	<3,000	<200	190	<5.0	<5.0	<5.0	<5.0	<5.0	
5/8/2007	<3,000	<200	420	<5.0	<5.0	<5.0	<5.0	<5.0	
8/8/2007	<300	<20	110	<0.50	<0.50	<0.50	<0.50	<0.50	
11/14/2007	<1,500	<100	210	<2.5	<2.5	<2.5	<2.5	<2.5	
2/22/2008	<300	<10	250	<0.50	<0.50	1.5	<0.50	<0.50	
5/24/2008	<3,000	<100	380	<5.0	<5.0	<5.0	<5.0	<5.0	
8/21/2008	<1,500	<50	170	<2.5	<2.5	<2.5	<2.5	<2.5	
10/19/2008	<300	<10	30	<0.50	<0.50	<0.50	<0.50	<0.50	
MW-2									
5/23/2003	<100	<20	55	<0.50	<0.50	0.53	--	--	
02/02/2004	<100	<20	37	<0.50	<0.50	<0.50	<0.50	<0.50	
09/02/2004	<500	<100	67	<2.5	<2.5	<2.5	<2.5	<2.5	
02/08/2005	<100	<20	30	<0.50	<0.50	<0.50	<0.50	<0.50	
08/11/2005	<100	<20	35	<0.50	<0.50	<0.50	<0.50	<0.50	a
02/16/2006	<300	<20	39	<0.50	<0.50	<0.50	<0.50	<0.50	
8/24/2006	<300	<20	25	<0.50	<0.50	<0.50	<0.50	<0.50	
2/7/2007	<300	<20	7.2	<0.50	<0.50	<0.50	<0.50	<0.50	
8/8/2007	<300	<20	7.2	<0.50	<0.50	<0.50	<0.50	<0.50	

**Table 2. Summary of Fuel Additives Analytical Data
Station #374, 6407 Telegraph Ave., Oakland, CA**

Well and Sample Date	Concentrations in (µg/L)								Comments
	Ethanol	TBA	MTBE	DIPE	ETBE	TAME	1,2-DCA	EDB	
MW-2 Cont.									
2/22/2008	<300	<10	24	<0.50	<0.50	<0.50	<0.50	<0.50	
8/21/2008	<300	<10	4.9	<0.50	<0.50	<0.50	<0.50	<0.50	
MW-3									
5/23/2003	<100	<20	1.6	<0.50	<0.50	<0.50	--	--	
09/02/2004	<100	<20	6.5	<0.50	<0.50	<0.50	<0.50	<0.50	
08/11/2005	<100	<20	11	<0.50	<0.50	<0.50	<0.50	<0.50	a
8/24/2006	<300	<20	7.6	<0.50	<0.50	<0.50	<0.50	<0.50	
8/8/2007	<300	<20	1.2	<0.50	<0.50	<0.50	<0.50	<0.50	
8/21/2008	<300	<10	3.1	<0.50	<0.50	<0.50	<0.50	<0.50	
MW-4									
5/23/2003	<10,000	<2,000	<50	<50	<50	<50	--	--	
02/02/2004	<500	<100	29	<2.5	<2.5	2.6	<2.5	<2.5	
09/02/2004	<200	<40	28	<1.0	<1.0	<1.0	<1.0	<1.0	
02/08/2005	<5,000	<1,000	45	<25	<25	<25	<25	<25	
08/11/2005	<2,000	<400	32	<10	<10	<10	<10	<10	
02/16/2006	<6,000	<400	35	<10	<10	<10	<10	<10	
8/24/2006	<1,500	<100	39	<2.5	<2.5	<2.5	<2.5	<2.5	
2/7/2007	<6,000	<400	67	<10	<10	<10	<10	<10	
8/8/2007	<6,000	<400	72	<10	<10	<10	<10	<10	
2/22/2008	<6,000	<200	70	<10	<10	<10	<10	<10	
8/21/2008	<12,000	<400	53	<20	<20	<20	<20	<20	
MW-5									
1/29/2003	<40	<20	<0.50	<0.50	<0.50	<0.50	--	--	
5/23/2003	<100	<20	<0.50	<0.50	<0.50	<0.50	--	--	
9/4/2003	<100	<20	<0.50	<0.50	<0.50	<0.50	<0.50	<0.50	
09/02/2004	<100	<20	<0.50	<0.50	<0.50	<0.50	<0.50	<0.50	
08/11/2005	<100	<20	<0.50	<0.50	<0.50	<0.50	<0.50	<0.50	
8/24/2006	<300	<20	<0.50	<0.50	<0.50	<0.50	<0.50	<0.50	
8/8/2007	<300	<20	<0.50	<0.50	<0.50	<0.50	<0.50	<0.50	
8/21/2008	<300	<10	<0.50	<0.50	<0.50	<0.50	<0.50	<0.50	

**Table 2. Summary of Fuel Additives Analytical Data
Station #374, 6407 Telegraph Ave., Oakland, CA**

Well and Sample Date	Concentrations in (µg/L)								Comments
	Ethanol	TBA	MTBE	DIPE	ETBE	TAME	1,2-DCA	EDB	
MW-6									
5/23/2003	<100	<20	9.4	<0.50	<0.50	<0.50	--	--	
08/11/2005	<100	<20	7.9	<0.50	<0.50	<0.50	<0.50	<0.50	a
8/24/2006	<300	<20	12	<0.50	<0.50	<0.50	<0.50	<0.50	
8/8/2007	<300	<20	0.57	<0.50	<0.50	<0.50	<0.50	<0.50	
8/21/2008	<300	<10	1.9	<0.50	<0.50	<0.50	<0.50	<0.50	

SYMBOLS AND ABBREVIATIONS:

-- = Not analyzed/applicable/measured/available

< = Not detected at or above the laboratory reporting limit

1,2-DCA = 1,2-Dichloroethane

DIPE = Di-isopropyl ether

EDB = 1,2-Dibromoethane

ETBE = Ethyl tert-butyl ether

MTBE = Methyl tert-butyl ether

TAME = tert-Amyl methyl ether

TBA = tert-Butyl alcohol

µg/L = Micrograms per Liter

FOOTNOTES:

a = The continuing calibration verification for ethanol was outside of client contractual limits, however, it was within method acceptance limits. The data should still be useful for its intended purpose.

NOTES:

All volatile organic compounds analyzed using EPA Method 8260B.

Note: The data within this table collected prior to April 2006 was provided to Broadbent & Associates, Inc. by Atlantic Richfield Company and their previous consultants. Broadbent & Associates, Inc. has not verified the accuracy of this information.

**Table 3. Historical Ground-Water Flow Direction and Gradient
Station #374, 6407 Telegraph Ave., Oakland, CA**

Date Sampled	Approximate Flow Direction	Approximate Hydraulic Gradient
1/31/1996	Southwest	0.04
4/10/1996	Southwest	0.04
7/16/1996	Southwest	0.03
10/14/1996	Southwest	0.03
3/27/1997	Southwest	0.04
5/27/1997	Southwest	0.03
8/12/1997	Southwest	0.04
11/17/1997	Southwest	0.03
3/16/1998	Southwest	0.03
5/12/1998	Southwest	0.04
7/27/1998	Southwest	0.04
10/15/1998	Southwest	0.02
2/18/1999	Southwest	0.05
5/24/1999	Southwest	0.03
8/27/1999	Southwest	0.03
10/26/1999	Southwest	0.03
2/3/2000	Southwest	0.047
6/20/2000	Southwest	0.035
9/28/2000	Southwest	0.034
12/17/2000	Southwest	0.032
3/23/2001	Southwest	0.034
6/21/2001	Southwest	0.032
9/23/2001	Southwest	0.029
12/31/2001	Southwest	0.043
3/21/2002	Southwest	0.038
4/17/2002	Southwest	0.031
8/12/2002	Southwest	0.032
12/6/2002	Southwest	0.020
1/29/2003	Southwest	0.027
5/23/2003	Southwest	0.039
9/4/2003	Southwest	0.033
11/20/2003	Southwest	0.029
2/2/2004	Southwest	0.043 (a)
5/14/2004	Southwest	0.037 (a)
9/2/2004	Southwest	0.027 (a)
11/4/2004	Southwest	0.034 (a)
2/8/2005	Southwest	0.061 (a)
5/9/2005	Southwest	0.08 (a)
8/11/2005	Southwest	0.06 (a)
11/18/2005	Southwest	0.07 (a)
2/16/2006	Southwest	0.09 (a)
5/30/2006	Southwest	0.06 (a)

**Table 3. Historical Ground-Water Flow Direction and Gradient
Station #374, 6407 Telegraph Ave., Oakland, CA**

Date Sampled	Approximate Flow Direction	Approximate Hydraulic Gradient
8/24/2006	Southwest	0.03
11/1/2006	Southwest	0.02
2/7/2007	Southwest	0.03
5/8/2007	Southwest	0.03
8/8/2007	Southwest	0.03
11/14/2007	Southwest	0.03
2/22/2008	Southwest	0.03
5/24/2008	Southwest	0.03
8/21/2008	Southwest	0.03
11/19/2008	Southwest	0.03

a = Gradients potentially suspect due to error in MW-4 and MW-5 TOC measuring point elevations discovered third quarter 2006.

Note: The data within this table collected prior to April 2006 was provided to Broadbent & Associates, Inc. by Atlantic Richfield Company and their previous consultants. Broadbent & Associates, Inc. has not verified the accuracy of this information.

APPENDIX A

**STRATUS GROUND-WATER SAMPLING DATA PACKAGE
(INCLUDES FIELD DATA SHEETS, LABORATORY ANALYTICAL REPORT WITH
CHAIN-OF-CUSTODY DOCUMENTATION, AND FIELD PROCEDURES)**



3330 Cameron Park Drive, Ste 550
Cameron Park, California 95682
(530) 676-6004 ~ Fax: (530) 676-6005

December 12, 2008

Mr. Rob Miller
Broadbent & Associates, Inc.
2000 Kirman Avenue
Reno, NV 89502

Re: Groundwater Sampling Data Package, ARCO Service Station No. 374, located at
6407 Telegraph Avenue, Oakland, California.

General Information

Data Submittal Prepared / Reviewed by: Becky Carroll / Jay Johnson

Phone Number: (530) 676-6000

On-Site Supplier Representative: Roberto Heimlich

Sampling Date: November 19, 2008

Arrival: 11:30 *Departure:* 12:40

Weather Conditions: Clear

Unusual Field Conditions: None noted.

Scope of Work Performed: Quarterly monitoring and sampling.

Variations from Work Scope: None noted.

This submittal presents the tabulation of data collected in association with routine groundwater monitoring. The attachments include field data sheets, non-hazardous waste data form, chain of custody documentation, certified analytical results, and field procedures for groundwater sampling. The information is being provided to BP-ARCO's Scoping Supplier for use in preparing a report for regulatory submittal. This submittal is limited to presentation of collected data and does not include data interpretation or conclusions or recommendations. Any questions concerning this submittal should be addressed to the Preparer/Reviewer identified above.

Sincerely,

STRATUS ENVIRONMENTAL, INC.

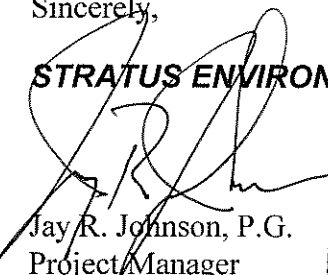
Jay R. Johnson, P.G.
Project Manager

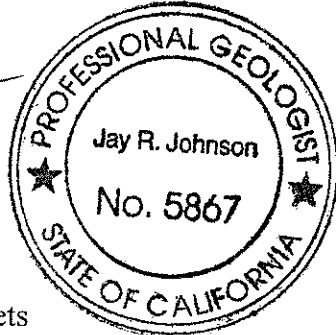

Attachments:

- Field Data Sheets
- Non-Hazardous Waste Data Form
- Chain of Custody Documentation
- Certified Analytical Results
- Field Procedures for Groundwater Monitoring

CC: Mr. Paul Supple, BP/ARCO

BP Alameda Portfolio
HYDROLOGIC DATA SHEET

AR-1115

Gauge Date: 11/19/08

Project Name: 6407 Telegraph Ave, Oakland

Field Technician: ROBERTO

Project Number: 374

TOC = Top of Well Casing Elevation
TOS = Depth to Top of Screen
DTW = Depth to Groundwater Below TOC
DTB = Depth to Bottom of Well Casing Below TOC

DIA = Well Casing Diameter
ELEV = Groundwater Elevation
DUP = Duplicate

WELL OR LOCATION	TIME	MEASUREMENT					PURGE & SAMPLE	SHEEN CONFIRMATION <small>(w/baller)</small>	COMMENTS
		TOC	TOS	DTW	DTB	DIA			
MW-1	12:14			8.88	26.55	4"	YES		
MW-2	12:07			8.66	26.15	4"			
MW-3	11:49			7.69	26.65	4"			
MW-4	12:01			9.20	26.80	4"		LARGE LID	
MW-5	11:54			11.86	22.95	4"			
MW-6	11:42			5.94	14.45	4"			

Fw Arturo Heimlich Calibration Date
pH/Conductivity/temperature Meter - YSI Model 63 pH 11/19/08
DO Meter - YSI 55 Series (DO is always measured before purge) Conductivity 11/19/08
Please refer to groundwater sampling field procedures DO 11/19/08

BP ALAMEDA PORTFOLIO

WATER SAMPLE FIELD DATA SHEET

PROJECT #: 374 PURGED BY: RH WELL I.D.: MW-1
 CLIENT NAME: _____ SAMPLED BY: RH SAMPLE I.D.: MW-1
 LOCATION: Oakland - 6407 Telegraph Ave QA SAMPLES: _____

DATE PURGED 11/19/08 NA START (2400hr) 12:21 END (2400hr) 12:30
 DATE SAMPLED 11/19/08 SAMPLE TIME (2400hr) 12:27
 SAMPLE TYPE: Groundwater Surface Water _____ Treatment Effluent _____ Other _____

CASING DIAMETER: 2" _____ 3" _____ 4" 5" _____ 6" _____ 8" _____ Other _____
 Casing Volume: (gallons per foot) (0.17) (0.38) (0.67) (1.02) (1.50) (2.60) _____

DEPTH TO BOTTOM (feet) = 26.55 CASING VOLUME (gal) = _____
 DEPTH TO WATER (feet) = 8.88 CALCULATED PURGE (gal) = NP
 WATER COLUMN HEIGHT (feet) = 17.6 ACTUAL PURGE (gal) = _____

FIELD MEASUREMENTS

DATE	TIME (2400hr)	VOLUME (gal)	TEMP. (degrees C)	CONDUCTIVITY (umhos/cm)	pH (units)	COLOR (visual)	TURBIDITY (NTU)
<u>11/19/08</u>	<u>12:24</u>	<u>NP</u>	<u>17.3</u>	<u>834</u>	<u>7.27</u>	<u>clear</u>	_____
_____	_____	_____	_____	_____	_____	_____	_____
_____	_____	_____	_____	_____	_____	_____	_____
_____	_____	_____	_____	_____	_____	_____	_____
_____	_____	_____	_____	_____	_____	_____	_____
_____	_____	_____	_____	_____	_____	_____	_____
_____	_____	_____	_____	_____	_____	_____	_____

NO PURGE

SAMPLE DEPTH TO WATER: 8.88 SAMPLE INFORMATION SAMPLE TURBIDITY: clear

80% RECHARGE: YES _____ NO ANALYSES: SWD
 ODOR: NO SAMPLE VESSEL / PRESERVATIVE: 6 VOAS/HCL

PURGING EQUIPMENT
 Bladder Pump _____ Bailer (Teflon) _____
 Centrifugal Pump NA _____ Bailer (PVC) _____
 Submersible Pump _____ Bailer (Stainless Steel) _____
 Peristaltic Pump _____ Dedicated _____
 Other: _____
 Pump Depth: NA

SAMPLING EQUIPMENT
 Bladder Pump _____ Bailer (Teflon) _____
 Centrifugal Pump _____ Bailer (_____ PVC or disposable) _____
 Submersible Pump _____ Bailer (Stainless Steel) _____
 Peristaltic Pump _____ Dedicated _____
 Other: _____

WELL INTEGRITY: GOOD LOCK# MASTER

REMARKS: DO 2.12

SIGNATURE: [Signature] Page _____ of _____

WELLHEAD OBSERVATION FORM

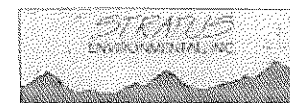

Site Name/Number: 374

Date: 11/19/08

Technician: ROBERTO

Well I.D.	Box in Good Condition? <small>X = Yes Blank = No</small>	Lock Missing? <small>X = Yes (replace) Blank = No</small>	Water in Wellbox? <small>X = Yes Blank = No</small>	Water Level Relative to Cap? <small>X = Above cap B = Below cap L = Level w/ cap</small>	Well Cap? <small>I = Inset M = Missing or Compromised (replace)</small>	Bolts Missing? <small>X = Yes Blank = No</small>	Bolts Stripped? <small>X = Yes Blank = No</small>	Bolt Holes Stripped? <small>X = Yes Blank = No</small>	Cracked or Broken Lid? <small>X = Yes Blank = No</small>	Cracked or Broken Box? <small>X = Yes Blank = No</small>	Grout Level more than 1ft below TOC? <small>X = Yes Blank = No</small>	Additional Comments <small>(such as missing lid, concrete needs replacement, or other - replace)</small>
MW-1	X	—	—	—	I	—	—	—	—	—	—	
MW-2	X	—	—	—	I	—	—	—	—	—	—	
MW-3	X	—	—	—	I	X	—	—	—	—	—	
MW-4	X	—	—	—	I	—	—	—	—	—	—	
MW-5	X	—	—	—	I	—	—	—	—	—	—	
MW-6	X	—	X	B	I	—	—	—	—	—	—	

DRUM INVENTORY

Drums on site? (Yes) No (circle)
 Type and # / Steel: 1 Plastic: _____

Note whether drums are full or empty, solids or liquids:
1/2 FULL GIL / WATER

Drum label info (description, date, contact info):
12/3/2008 - TCEP / DST

GENERAL SITE CONDITIONS

Make notes on housekeeping conditions (such as trash around remediation system enclosure/compound, bent or missing bollards, signs missing from compound fences, graffiti on compound, etc.)

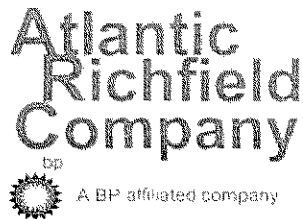

Chain of Custody Record

Project Name: BP 374
 BP BU/AR Region/Enfos Segment: BP - Americas > West > Retail > CA > Alameda-374
 State or Lead Regulatory Agency: _____
 Requested Due Date (mm/dd/yy): _____

On-site Time:	<u>11:30</u>	Temp:	<u>66</u>
Off-site Time:	<u>12:40</u>	Temp:	<u>68</u>
Sky Conditions:	<u>clear</u>		
Meteorological Events:	<u>NA</u>		
Wind Speed:	<u>0</u>	Direction:	<u>NA</u>

Lab Name: <u>Calscience</u>	BP/AR Facility No.: <u>374</u>	Consultant/Contractor: <u>Stratus Environmental, Inc.</u>
Address: <u>7440 Lincoln Way</u> <u>Garden Grove, CA 92841</u>	BP/AR Facility Address: <u>6407 Telegraph Ave., Oakland</u>	Address: <u>3330 Cameron Park Drive, Suite 550</u> <u>Cameron Park, CA 95682</u>
Lab PM: <u>Linda Scharpenberg</u>	Site Lat/Long:	Consultant/Contractor Project No.: <u>E374-04</u>
Tele/Fax: <u>714-895-5494</u> <u>714-895-7501(fax)</u>	California Global ID #: <u>T0600100106</u>	Consultant/Contractor PM: <u>Jay Johnson</u>
BP/AR PM Contact: <u>Paul Supple</u>	Enfos Project No.: <u>G0C21-0021</u>	Tele/Fax: <u>(530) 676-6000 / (530) 676-6005</u>
Address: <u>2010 Crow Canyon Place, Suite 150</u> <u>San Ramon, CA</u>	Provision or RCOP (circle one) <u>Provision</u>	Report Type & QC Level: <u>Level 1 with EDF</u>
Tele/Fax: <u>925-275-3506</u>	Phase/WBS: <u>04-Monitoring</u>	E-mail EDF To: <u>bcarroll@stratusinc.net</u>
	Sub Phase/Task: <u>03-Analytical</u>	Invoice to: <u>Atlantic Richfield Co.</u>
	Cost Element: <u>01-Contractor labor</u>	

Lab Bottle Order No:				Matrix			Laboratory No.	No. of Containers	Preservative					Requested Analysis					Sample Point Lat/Long and Comments *Oxy = MTBD, TAME, ETBE, DIPE, TBA			
Item No.	Sample Description	Time	Date	Soil/Solid	Water/Liquid	Air			Unpreserved	H ₂ SO ₄	HNO ₃	HCl	Methanol	BTEX/Oxy* by 8260	1,2 DCA	Ethanol	EDB	GR0 by 8015m				
1	MW-1	12:27	11/19/08	X			6			X		X	X	X	X							
2	TB-374	11/19/08	5:00	✓	X		2			X		X	X	X	X							HOLD
3																						
4																						
5																						
6																						
7																						
8																						
9																						
10																						

Sampler's Name: <u>ROBERTO HEIMLICH</u>	Relinquished By / Affiliation	Date	Time	Accepted By / Affiliation	Date	Time
Sampler's Company: <u>DOUGLAS ENV</u>						
Shipment Date:						
Shipment Method:						
Shipment Tracking No:						

Special Instructions: Please see results to: rmillen@broadbentinc.com

Custody Seals In Place: Yes / No Temp Blank: Yes / No Cooler Temp on Receipt: °F/C Trip Blank: Yes / No MS/MSD Sample Submitted: Yes / No

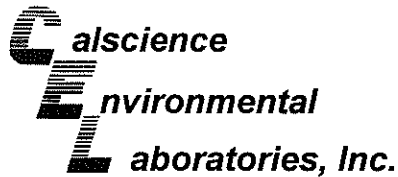

December 03, 2008

Jay Johnson
Stratus Environmental, inc.
3330 Cameron Park Drive, Suite 550
Cameron Park, CA 95682-8861

Subject: **Calscience Work Order No.: 08-11-1825**
Client Reference: BP 374

Dear Client:

Enclosed is an analytical report for the above-referenced project. The samples included in this report were received 11/20/2008 and analyzed in accordance with the attached chain-of-custody.

Unless otherwise noted, all analytical testing was accomplished in accordance with the guidelines established in our Quality Systems Manual, applicable standard operating procedures, and other related documentation. The original report of subcontracted analysis, if any, is provided herein, and follows the standard Calscience data package. The results in this analytical report are limited to the samples tested and any reproduction thereof must be made in its entirety.

If you have any questions regarding this report, please do not hesitate to contact the undersigned.

Sincerely,

Calscience Environmental
Laboratories, Inc.
Richard Villafania
Project Manager

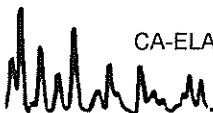

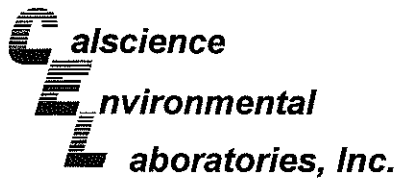

Analytical Report



Stratus Environmental, inc.
3330 Cameron Park Drive, Suite 550
Cameron Park, CA 95682-8861

Date Received: 11/20/08
Work Order No: 08-11-1825
Preparation: EPA 5030B
Method: EPA 8015B (M)

Project: BP 374

Page 1 of 1

Client Sample Number	Lab Sample Number	Date/Time Collected	Matrix	Instrument	Date Prepared	Date/Time Analyzed	QC Batch ID
MW-1	08-11-1825-1-D	11/19/08 12:27	Aqueous	GC 30	11/21/08	11/21/08 13:25	081121B01

Parameter	Result	RL	DF	Qual	Units
Gasoline Range Organics (C6-C12)	ND	50	1		ug/L
<u>Surrogates:</u>	<u>REC (%)</u>	<u>Control Limits</u>		<u>Qual</u>	
1,4-Bromofluorobenzene	79	38-134			

Method Blank	099-12-695-343	N/A	Aqueous	GC 30	11/21/08	11/21/08 11:45	081121B01
--------------	----------------	-----	---------	-------	----------	-------------------	-----------

Parameter	Result	RL	DF	Qual	Units
Gasoline Range Organics (C6-C12)	ND	50	1		ug/L
<u>Surrogates:</u>	<u>REC (%)</u>	<u>Control Limits</u>		<u>Qual</u>	
1,4-Bromofluorobenzene	86	38-134			

RL - Reporting Limit , DF - Dilution Factor , Qual - Qualifiers

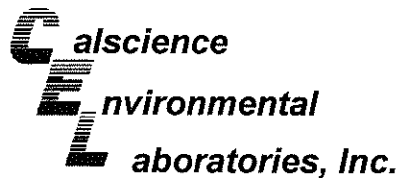

Analytical Report

11/21/08
14:54

Stratus Environmental, inc.
3330 Cameron Park Drive, Suite 550
Cameron Park, CA 95682-8861

Date Received: 11/20/08
Work Order No: 08-11-1825
Preparation: EPA 5030B
Method: EPA 8260B
Units: ug/L

Project: BP 374

Page 1 of 1

Client Sample Number	Lab Sample Number	Date/Time Collected	Matrix	Instrument	Date Prepared	Date/Time Analyzed	QC Batch ID
MW-1	08-11-1825-1-B	11/19/08 12:27	Aqueous	GC/MS BB	11/21/08	11/21/08 18:13	081121L01

Parameter	Result	RL	DF	Qual	Parameter	Result	RL	DF	Qual
Benzene	ND	0.50	1		Methyl-t-Butyl Ether (MTBE)	30	0.50	1	
1,2-Dibromoethane	ND	0.50	1		Tert-Butyl Alcohol (TBA)	ND	10	1	
1,2-Dichloroethane	ND	0.50	1		Diisopropyl Ether (DIPE)	ND	0.50	1	
Ethylbenzene	ND	0.50	1		Ethyl-t-Butyl Ether (ETBE)	ND	0.50	1	
Toluene	ND	0.50	1		Tert-Amyl-Methyl Ether (TAME)	ND	0.50	1	
Xylenes (total)	ND	0.50	1		Ethanol	ND	300	1	
<u>Surrogates:</u>	<u>REC (%)</u>	<u>Control Limits</u>		<u>Qual</u>	<u>Surrogates:</u>	<u>REC (%)</u>	<u>Control Limits</u>		<u>Qual</u>
1,2-Dichloroethane-d4	122	73-157			Dibromofluoromethane	108	82-142		
Toluene-d8	101	82-112			1,4-Bromofluorobenzene	86	75-105		

Method Blank	Lab Sample Number	Date/Time Collected	Matrix	Instrument	Date Prepared	Date/Time Analyzed	QC Batch ID
	099-12-703-571	N/A	Aqueous	GC/MS BB	11/21/08	11/21/08 14:54	081121L01

Parameter	Result	RL	DF	Qual	Parameter	Result	RL	DF	Qual
Benzene	ND	0.50	1		Methyl-t-Butyl Ether (MTBE)	ND	0.50	1	
1,2-Dibromoethane	ND	0.50	1		Tert-Butyl Alcohol (TBA)	ND	10	1	
1,2-Dichloroethane	ND	0.50	1		Diisopropyl Ether (DIPE)	ND	0.50	1	
Ethylbenzene	ND	0.50	1		Ethyl-t-Butyl Ether (ETBE)	ND	0.50	1	
Toluene	ND	0.50	1		Tert-Amyl-Methyl Ether (TAME)	ND	0.50	1	
Xylenes (total)	ND	0.50	1		Ethanol	ND	300	1	
<u>Surrogates:</u>	<u>REC (%)</u>	<u>Control Limits</u>		<u>Qual</u>	<u>Surrogates:</u>	<u>REC (%)</u>	<u>Control Limits</u>		<u>Qual</u>
1,2-Dichloroethane-d4	115	73-157			Dibromofluoromethane	103	82-142		
Toluene-d8	102	82-112			1,4-Bromofluorobenzene	84	75-105		

RL - Reporting Limit , DF - Dilution Factor , Qual - Qualifiers

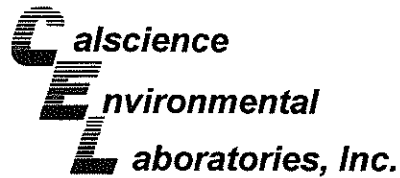

Quality Control - Spike/Spike Duplicate



Stratus Environmental, inc.
 3330 Cameron Park Drive, Suite 550
 Cameron Park, CA 95682-8861

Date Received: 11/20/08
 Work Order No: 08-11-1825
 Preparation: EPA 5030B
 Method: EPA 8015B (M)

Project BP 374

Quality Control Sample ID	Matrix	Instrument	Date Prepared	Date Analyzed	MS/MSD Batch Number
MW-1	Aqueous	GC 30	11/21/08	11/21/08	081121S01

Parameter	MS %REC	MSD %REC	%REC CL	RPD	RPD CL	Qualifiers
Gasoline Range Organics (C6-C12)	104	106	38-134	2	0-25	

RPD - Relative Percent Difference, CL - Control Limit

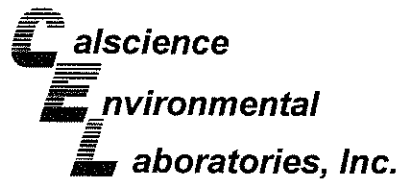

Quality Control - Spike/Spike Duplicate

08-11-1825
EPA 5030B
EPA 8260B

Stratus Environmental, inc.
3330 Cameron Park Drive, Suite 550
Cameron Park, CA 95682-8861

Date Received: 11/20/08
Work Order No: 08-11-1825
Preparation: EPA 5030B
Method: EPA 8260B

Project BP 374

Quality Control Sample ID	Matrix	Instrument	Date Prepared	Date Analyzed	MS/MSD Batch Number
08-11-1709-5	Aqueous	GC/MS BB	11/21/08	11/21/08	081121S01

Parameter	MS %REC	MSD %REC	%REC CL	RPD	RPD CL	Qualifiers
Benzene	97	99	86-122	2	0-8	
Carbon Tetrachloride	117	120	78-138	3	0-9	
Chlorobenzene	101	97	90-120	4	0-9	
1,2-Dibromoethane	93	91	70-130	3	0-30	
1,2-Dichlorobenzene	94	96	89-119	1	0-10	
1,1-Dichloroethene	93	95	52-142	1	0-23	
Ethylbenzene	97	92	70-130	5	0-30	
Toluene	98	96	85-127	2	0-12	
Trichloroethene	95	95	78-126	0	0-10	
Vinyl Chloride	73	78	56-140	7	0-21	
Methyl-t-Butyl Ether (MTBE)	92	98	64-136	7	0-28	
Tert-Butyl Alcohol (TBA)	119	100	27-183	18	0-60	
Diisopropyl Ether (DIPE)	85	92	78-126	7	0-16	
Ethyl-t-Butyl Ether (ETBE)	87	95	67-133	9	0-21	
Tert-Amyl-Methyl Ether (TAME)	92	95	63-141	3	0-21	
Ethanol	119	79	11-167	40	0-64	

RPD - Relative Percent Difference, CL - Control Limit

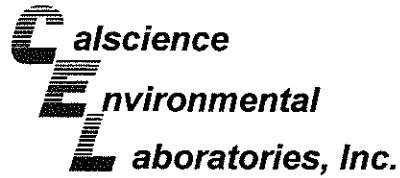

Quality Control - LCS/LCS Duplicate



Stratus Environmental, inc.
 3330 Cameron Park Drive, Suite 550
 Cameron Park, CA 95682-8861

Date Received: N/A
 Work Order No: 08-11-1825
 Preparation: EPA 5030B
 Method: EPA 8015B (M)

Project: BP 374

Quality Control Sample ID	Matrix	Instrument	Date Prepared	Date Analyzed	LCS/LCSD Batch Number
099-12-695-343	Aqueous	GC 30	11/21/08	11/21/08	081121B01

Parameter	LCS %REC	LCSD %REC	%REC CL	RPD	RPD CL	Qualifiers
Gasoline Range Organics (C6-C12)	113	110	78-120	2	0-20	

RPD - Relative Percent Difference , CL - Control Limit

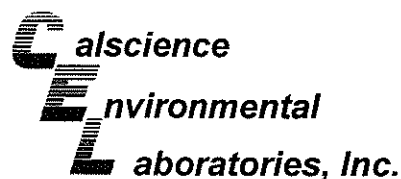

Quality Control - LCS/LCS Duplicate

Stratus Environmental, inc.
3330 Cameron Park Drive, Suite 550
Cameron Park, CA 95682-8861

Date Received: N/A
Work Order No: 08-11-1825
Preparation: EPA 5030B
Method: EPA 8260B

Project: BP 374

Quality Control Sample ID	Matrix	Instrument	Date Prepared	Date Analyzed	LCS/LCSD Batch Number		
099-12-703-571	Aqueous	GC/MS BB	11/21/08	11/21/08	081121L01		
Parameter	LCS %REC	LCSD %REC	%REC CL	ME CL	RPD	RPD CL	Qualifiers
Benzene	96	102	87-117	82-122	6	0-7	
Carbon Tetrachloride	120	123	78-132	69-141	3	0-8	
Chlorobenzene	100	100	88-118	83-123	0	0-8	
1,2-Dibromoethane	86	93	80-120	73-127	8	0-20	
1,2-Dichlorobenzene	95	98	88-118	83-123	3	0-8	
1,1-Dichloroethene	99	101	71-131	61-141	2	0-14	
Ethylbenzene	96	96	80-120	73-127	0	0-20	
Toluene	95	100	85-127	78-134	5	0-7	
Trichloroethene	96	101	85-121	79-127	4	0-11	
Vinyl Chloride	79	81	64-136	52-148	3	0-10	
Methyl-t-Butyl Ether (MTBE)	92	103	67-133	56-144	11	0-16	
Tert-Butyl Alcohol (TBA)	103	101	34-154	14-174	2	0-19	
Diisopropyl Ether (DIPE)	89	97	80-122	73-129	8	0-8	
Ethyl-t-Butyl Ether (ETBE)	89	99	73-127	64-136	10	0-11	
Tert-Amyl-Methyl Ether (TAME)	89	100	69-135	58-146	11	0-12	
Ethanol	95	91	34-124	19-139	4	0-44	

Total number of LCS compounds : 16

Total number of ME compounds : 0

Total number of ME compounds allowed : 1

LCS ME CL validation result : Pass

RPD - Relative Percent Difference , CL - Control Limit



Work Order Number: 08-11-1825

<u>Qualifier</u>	<u>Definition</u>
AX	Sample too dilute to quantify surrogate.
DU	There was no MS/MSD analyzed with this batch due to insufficient sample volume (NR = not reported). See Blank Spike/Blank Spike Duplicate.
BA,AY	Relative percent difference out of control, matrix interference suspected.
BB	Sample > 4x spike concentration.
BF	Reporting limits raised due to high hydrocarbon background.
BH	Reporting limits raised due to high level of non-target analytes.
BU	Sample analyzed after holding time expired.
BV	Sample received after holding time expired.
BY	Sample received at improper temperature.
CL	Initial analysis within holding time but required dilution.
CQ	Analyte concentration greater than 10 times the blank concentration.
CU	Surrogate concentration diluted to not detectable during analysis.
DF	Reporting limits elevated due to matrix interferences.
ET	Sample was extracted past end of recommended max. holding time.
EY	Result exceeds normal dynamic range; reported as a min est.
GS	Internal standard recovery is outside method recovery limit.
IB	CCV recovery above limit; analyte not detected.
IH	Calibrtn. verif. recov. below method CL for this analyte.
IJ	Calibrtn. verif. recov. above method CL for this analyte.
J,DX	J=EPA Flag -Estimated value; DX= Value < lowest standard (MQL), but > than MDL.
LA	Confirmatory analysis was past holding time.
LG	Surrogate recovery below the acceptance limit.
LH	Surrogate recovery above the acceptance limit.
LM,AY	MS and/or MSD above acceptance limits. See Blank Spike (LCS). Matrix interference suspected.
LN,AY	MS and/or MSD below acceptance limits. See Blank Spike (LCS). Matrix interference suspected.
LQ	LCS recovery above method control limits.
LR	LCS recovery below method control limits.

Work Order Number: 08-11-1825

<u>Qualifier</u>	<u>Definition</u>
MB	Analyte present in the method blank.
MG	Analyte is a suspected lab contaminate.
PC	Sample taken from VOA vial with air bubble > 6mm diameter.
PI	Primary and confirm results varied by > than 40% RPD.
RB	RPD exceeded method control limit; % recoveries within limits.

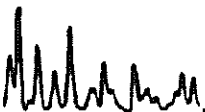



bp
A BP affiliated company

Chain of Custody Record

Project Name: BP 374
 BP BU/AR Region/Enfos Segment: BP > Americas > West > Retail > CA > Alameda>374
 State or Lead Regulatory Agency: _____
 Requested Due Date (mm/dd/yy): _____

(1825)

On-site Time:	11:30	Temp:	66
Off-site Time:	12:40	Temp:	68
Sky Conditions:	clear		
Meteorological Events:	NA		
Wind Speed:	0	Direction:	NA

Lab Name: Calscience	BP/AR Facility No.: 374	Consultant/Contractor: Stratus Environmental, Inc.
Address: 7440 Lincoln Way Garden Grove, CA 92841	BP/AR Facility Address: 6407 Telegraph Ave., Oakland	Address: 3330 Cameron Park Drive, Suite 550 Cameron Park, CA 95682
Lab PM: Linda Scharpenberg	Site Lat/Long:	Consultant/Contractor Project No.: E374-04
Tele/Fax: 714-895-5494 714-895-7501(fax)	California Global ID #: T0600100106	Consultant/Contractor PM: Jay Johnson
BP/AR PM Contact: Paul Supple	Enfos Project No.: G0C21-0021	Tele/Fax: (530) 676-6000 / (530) 676-6005
Address: 2010 Crow Canyon Place, Suite 150 San Ramon, CA	Provision or RCOP (circle one) Provision	Report Type & QC Level: Level 1 with EDF
Tele/Fax: 925-275-3506	Phase/WBS: 04-Monitoring	E-mail EDD To: bcarroll@stratusinc.net
	Sub Phase/Task: 03-Analytical	Invoice to: Atlantic Richfield Co.
	Cost Element: 01-Contractor labor	

Item No.	Sample Description	Time	Date	Matrix			Laboratory No.	No. of Containers	Preservative					Requested Analysis					Sample Point Lat/Long and Comments *Oxy = MTBD, TAME, ETBE, DIPE, TBA	
				Soil/Solid	Water/Liquid	Air			Unpreserved	H ₂ SO ₄	HNO ₃	HCl	Methanol	BTEX/Oxy* by 8260	1,2 DCA	Ethanol	EDB	GRO by 8015m		
1	MW-1	12:27	11/19/08	X				6						X	X	X	X	X		
2	TB-374 11/19/08	5:00	✓	X				2						X	X	X	X	X		HOLD
3																				
4																				
5																				
6																				
7																				
8																				
9																				
10																				

Sampler's Name: <u>ROBERTO HEIMLICH</u>	Relinquished By / Affiliation	Date	Time	Accepted By / Affiliation	Date	Time
Sampler's Company: <u>DOULOS ENV</u>						
Shipment Date:						
Shipment Method:						
Shipment Tracking No: <u>100193012</u>	<u>G50</u>	<u>11/20/08</u>	<u>0900</u>	<u>Wdawat as</u>	<u>11/20/08</u>	<u>0900</u>

Special Instructions: Please cc results to: rmler@broadbentinc.com

Custody Seals In Place: Yes / No | Temp Blank: Yes / No | Cooler Temp on Receipt: °F/C | Trip Blank: Yes / No | MS/MSD Sample Submitted: Yes / No

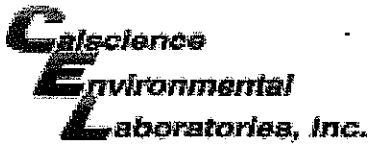

WORK ORDER #: 08-11-1825

SAMPLE RECEIPT FORM

Cooler 1 of 1

CLIENT: Stratus Environmental

DATE: 11/20/08

TEMPERATURE: (Criteria: 0.0 °C – 6.0 °C, not frozen)

Temperature 3.4 °C - 0.2 °C (CF) = 3.2 °C Blank Sample

Sample(s) outside temperature criteria (PM/APM contacted by: _____).

Sample(s) outside temperature criteria but received on ice/chilled on same day of sampling.

Received at ambient temperature, placed on ice for transport by Courier.

Ambient Temperature: Air Filter Metals Only PCBs Only Initial: WB

CUSTODY SEALS INTACT:

Cooler _____ No (Not Intact) Not Present N/A Initial: WB

Sample _____ No (Not Intact) Not Present Initial: ML

SAMPLE CONDITION:

	Yes	No	N/A
Chain-Of-Custody (COC) document(s) received with samples.....	<input checked="" type="checkbox"/>	<input type="checkbox"/>	<input type="checkbox"/>
COC document(s) received complete.....	<input type="checkbox"/>	<input checked="" type="checkbox"/>	<input type="checkbox"/>
Sampler's name indicated on COC.....	<input checked="" type="checkbox"/>	<input type="checkbox"/>	<input type="checkbox"/>
Sample container label(s) consistent with COC.....	<input checked="" type="checkbox"/>	<input type="checkbox"/>	<input type="checkbox"/>
Sample container(s) intact and good condition.....	<input checked="" type="checkbox"/>	<input type="checkbox"/>	<input type="checkbox"/>
Correct containers and volume for analyses requested.....	<input checked="" type="checkbox"/>	<input type="checkbox"/>	<input type="checkbox"/>
Analyses received within holding time.....	<input checked="" type="checkbox"/>	<input type="checkbox"/>	<input type="checkbox"/>
Proper preservation noted on sample label(s).....	<input checked="" type="checkbox"/>	<input type="checkbox"/>	<input type="checkbox"/>
Volatile analysis container(s) free of headspace.....	<input checked="" type="checkbox"/>	<input type="checkbox"/>	<input type="checkbox"/>
Tedlar bag(s) free of condensation.....	<input type="checkbox"/>	<input type="checkbox"/>	<input checked="" type="checkbox"/>

CONTAINER TYPE:

Solid: 4ozCGJ 8ozCGJ 16ozCGJ Sleeve EnCores® TerraCores® _____

Water: VOA VOA_h VOA_{na2} 125AGB 125AGB_h 125AGB_{po4} 1AGB 1AGB_{na2}

1AGB_s 500AGB 500AGB_s 250CGB 250CGB_s 1PB 500PB 500PB_{na} 250PB

250PB_n 125PB 125PB_{znna} 100PBsterile 100PB_{na2} _____ _____ _____

Air: Tedlar® Summa® _____

Container: C:Clear A:Amber P:Poly/Plastic G:Glass J:Jar B: Bottle

Preservative: h:HCL n:HNO₃ na₂:Na₂S₂O₃ na:NaOH po₄:H₃PO₄ s:H₂SO₄ znna:ZnAc₂+NaOH

Checked/Labeled by: ML

Reviewed by: PS

Scanned by: ML

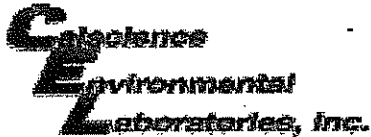

WORK ORDER #: 08-111-1825

SAMPLE ANOMALY FORM

CHAIN OF CUSTODY (COC):

- Not relinquished by client – no signature
- No date/time relinquished
- COC not received with samples – notify PM
- Incomplete information regarding samples, tests, etc.

Comments:

SAMPLES - CONTAINERS & LABELS:

- Samples NOT RECEIVED but listed on COC
- Samples received but NOT LISTED on COC
- Holding time expired – list sample ID(s) and test
- Insufficient quantities for analysis – list test
- Improper container(s) used – list test
- No preservative noted on label – list test and notify lab
- Sample labels illegible – note test/container type
- Sample labels do not match COC – Note in comments
 - Sample ID's
 - Date and Time Collected
 - Project Information
 - # of containers
- Sample containers compromised – Note in comments
 - Leaking
 - Broken
 - Without Labels
- Other: _____

Comments:

HEADSPACE – Containers with Bubble > 6mm or ¼ inch:

Sample #	Container ID(s)	# of Vials Received	Sample #	Container ID(s)	# of Vials Received	Sample #	Container ID(s)	# of RSK or CO ₂ or DO or Organic Lead Received

Comments:

Initial / Date NC 11/20/08

ATTACHMENT

FIELD PROCEDURES FOR GROUNDWATER SAMPLING

The sampling procedures for groundwater monitoring events are contained in this appendix.

Equipment Calibration

Standard groundwater sampling equipment – pH/Conductivity/Temperature meter, and dissolved oxygen (DO) meters are calibrated prior to all field work. All calibration is conducted in accordance with equipment manufacturer's recommended procedure and buffer solutions. MSDS for all buffer solutions are maintained in Stratus vehicles. Calibration is completed everyday prior to field work and also once a week. The pH probe is calibrated for a pH of 7.0 daily and for 4.0, 7.0 and 10.0 weekly. The conductivity probe is calibrated for 1413 μ s daily and 1413 μ s and 447 μ s weekly. The temperature probe is calibrated weekly with a NIST-traceable thermometer. The DO probe is calibrated for 100% oxygen daily and 0% and 100% oxygen weekly. All calibration logs are maintained in the Stratus office.

Groundwater and Liquid-Phase Petroleum Hydrocarbon Depth Assessment

Prior to measuring the depth to liquid in the well, the well caps are removed and the liquid level allowed to stabilize. A water/hydrocarbon interface probe is used to assess the liquid-phase petroleum hydrocarbon (LPH) thickness, if present, and a water level indicator is used to measure the groundwater depth in monitoring wells that do not contain LPH. Depth to groundwater or LPH is measured from a datum point at the top of each monitoring well casing. The datum point is typically a notch cut in the north side of the casing edge. If a water level indicator is used, the tip is subjectively analyzed for hydrocarbon sheen.

Subjective Analysis of Groundwater

Prior to purging, a water sample is collected from the monitoring well for subjective assessment. The sample is retrieved by gently lowering a clean, disposable bailer to approximately one-half the bailer length past the air/liquid interface. The bailer is then retrieved, and the sample contained within the bailer is examined for floating LPH and the appearance of a LPH sheen.

Monitoring Well Sampling

In many cases, determining whether to purge or not to purge wells prior to sample collection is made in the field and is often based on depth to water relative to the screen interval of the well. Site-specific field data sheets present details associated with the purge method and equipment used.

Monitoring wells, when purged, use a pump or bailer until pH, temperature, and conductivity of the purge water has stabilized and a minimum of three well volumes of water has been removed. Field measuring equipment is calibrated and maintained according to the manufacturer's instructions. If three well volumes cannot be removed in one half hour's time the well is allowed to recharge to 80% of original level. After recharging, a groundwater sample is then collected from each of the wells using disposable bailers.

A Teflon bailer, electric submersible or bladder pump will be the only equipment used for well sampling. When samples for volatile organic analysis are being collected, the pump flow will be regulated at approximately 100 milliliters per minute to minimize pump effluent turbulence and aeration. Glass bottles of at least 40-milliliters volume and fitted with Teflon-lined septa will be used in sampling for volatile organics. These bottles will be filled completely to prevent air accumulation in the bottle. A positive meniscus forms when the bottle is completely full. A convex Teflon septum will be placed over the positive meniscus to eliminate air. After the bottle is capped, it is inverted and tapped to verify that it contains no air bubbles. The sample containers for other parameters will be filled, filtered as required, and capped. Glass and plastic bottles used by Stratus to collect groundwater samples are supplied by the laboratory.

Groundwater Sample Labeling and Preservation

Samples are collected in appropriate containers supplied by the laboratory. All required chemical preservation is added to the bottles prior to delivery to Stratus. Sample label information includes a unique sample identification number, job identification number, date, and time. After labeling, all groundwater samples are placed in a Ziploc[®] type bag and placed in an ice chest cooled to approximately 4° Celsius. Upon arriving at Stratus' office the samples are transferred to a locked refrigerator cooled to approximately 4° Celsius. Chemical preservation is controlled by the required analysis and is noted on the chain-of-custody form. Trip and temperature blanks supplied by the laboratory accompany the groundwater sample containers and groundwater samples.

Sample Identification and Chain-of-Custody Procedures

Sample identification and chain-of-custody procedures document sample possession from the time of collection to ultimate disposal. Each sample container submitted for analysis has a label affixed to identify the job number, sampler, date and time of sample collection, and a sample number unique to that sample. This information, in addition to a description of the sample, field measurements made, sampling methodology, names of on-site personnel, and any other pertinent field observations, is recorded in the field records. The samples are analyzed by a California-certified laboratory.

A chain-of-custody form is used to record possession of the sample from time of collection to its arrival at the laboratory. When the samples are shipped, the person in custody of them relinquishes the samples by signing the chain-of-custody form and noting the time. The sample-control officer at the laboratory verifies sample integrity and confirms that the samples are collected in the proper containers, preserved correctly, and

contain adequate volumes for analysis. These conditions are noted on a Laboratory Sample Receipt Checklist that becomes part of the laboratory report upon request.

If these conditions are met, each sample is assigned a unique log number for identification throughout analysis and reporting. The log number is recorded on the chain-of-custody form and in the legally-required log book maintained by the laboratory. The sample description, date received, client's name, and other relevant information is also recorded.

Equipment Cleaning

All reusable sampling equipments are cleaned using phosphate-free detergents and rinsed with de-ionized water.

APPENDIX B

GEOTRACKER UPLOAD CONFIRMATIONS

STATE WATER RESOURCES CONTROL BOARD
GEOTRACKER ESI

UPLOADING A GEO_WELL FILE

SUCCESS

Processing is complete. No errors were found!
Your file has been successfully submitted!

<u>Submittal Type:</u>	GEO_WELL
<u>Submittal Title:</u>	4Q08 GEO_WELL 374
<u>Facility Global ID:</u>	T0600100106
<u>Facility Name:</u>	ARCO #0374
<u>File Name:</u>	GEO_WELL.zip
<u>Organization Name:</u>	Broadbent & Associates, Inc.
<u>Username:</u>	BROADBENT-C
<u>IP Address:</u>	67.118.40.90
<u>Submittal Date/Time:</u>	1/14/2009 10:36:22 AM
<u>Confirmation Number:</u>	9407082676

STATE WATER RESOURCES CONTROL BOARD
GEOTRACKER ESI

UPLOADING A EDF FILE

SUCCESS

Processing is complete. No errors were found!
Your file has been successfully submitted!

<u>Submittal Type:</u>	EDF - Monitoring Report - Quarterly
<u>Submittal Title:</u>	4Q08 GW Monitoring
<u>Facility Global ID:</u>	T0600100106
<u>Facility Name:</u>	ARCO #0374
<u>File Name:</u>	08111825.zip
<u>Organization Name:</u>	Broadbent & Associates, Inc.
<u>Username:</u>	BROADBENT-C
<u>IP Address:</u>	67.118.40.90
<u>Submittal Date/Time:</u>	1/14/2009 10:42:15 AM
<u>Confirmation Number:</u>	7445024788

[VIEW QC REPORT](#)

[VIEW DETECTIONS REPORT](#)