



Atlantic Richfield Company
(a BP affiliated company)

P.O. Box 1257
San Ramon, CA 94583
Phone: (925) 275-3801
Fax: (925) 275-3815

27 July 2007

Re: Second Quarter 2007 Ground-Water Monitoring Report
Atlantic Richfield Company Station #374
6407 Telegraph Avenue
Oakland, California
ACEH Case # RO0000078

“I declare, that to the best of my knowledge at the present time, that the information and/or recommendations contained in the attached document are true and correct.”

Submitted by:

Paul Supple
Environmental Business Manger

RECEIVED

2:55 pm, Jul 31, 2007

Alameda County
Environmental Health



Second Quarter 2007 Ground-Water Monitoring Report
Atlantic Richfield Company Station #374
6407 Telegraph Avenue
Oakland, California

Prepared for

Mr. Paul Supple
Environmental Business Manager
Atlantic Richfield Company
P.O. Box 1257
San Ramon, California 94583

Prepared by



1324 Mangrove Avenue, Suite 212
Chico, California 95926
(530) 566-1400
www.broadbentinc.com

27 July 2007

Project No. 06-08-602

27 July 2007

Project No. 06-08-602

Atlantic Richfield Company
P.O. Box 1257
San Ramon, CA 94583
Submitted via ENFOS

Attn.: Mr. Paul Supple

Re: Second Quarter 2007 Ground-Water Monitoring Report, Atlantic Richfield Company (a BP affiliated company) Station #374, 6407 Telegraph Avenue, Oakland, Alameda County, California. ACEH Case #RO0000078

Dear Mr. Supple:

Attached is the *Second Quarter 2007 Ground-Water Monitoring Report* for Atlantic Richfield Company Station #374 (herein referred to as Station #374) located at 6407 Telegraph Avenue, Oakland, California (Property). This report presents results of ground-water monitoring conducted during the Second Quarter of 2007.

Should you have questions regarding the work performed or results obtained, please do not hesitate to contact us at (530) 566-1400.

Sincerely,

BROADBENT & ASSOCIATES, INC.

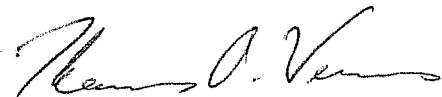

Thomas A. Venus, P.E.
Senior Engineer

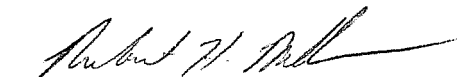

Robert H. Miller, P.G., C.HG.
Principal Hydrogeologist

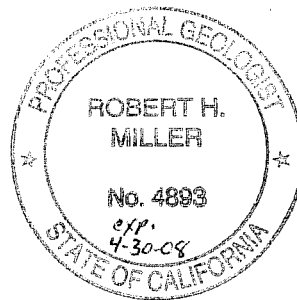

Enclosures

cc: Mr. Steven Plunkett, Alameda County Environmental Health (Submitted via ACEH ftp site)
Electronic copy uploaded to GeoTracker

STATION #374 QUARTERLY GROUND-WATER MONITORING REPORT

Facility: #374	Address:	6407 Telegraph Avenue, Oakland, California
Environmental Business Manager:		Mr. Paul Supple
Consulting Co./Contact Persons:		Broadbent & Associates, Inc.(BAI)/Rob Miller & Tom Venus (530) 566-1400
Consultant Project No.:		06-08-602
Primary Agency/Regulatory ID No.:		Alameda County Environmental Health (ACEH) ACEH Case #RO0000078
Facility Permits/Permitting Agency:		NA

WORK PERFORMED THIS QUARTER (Second Quarter 2007):

1. Prepared and submitted First Quarter 2007 Ground-Water Monitoring Report.
2. Conducted ground-water monitoring/sampling for Second Quarter 2007. Work performed on 8 May 2007 by Stratus Environmental, Inc (Stratus).

WORK PROPOSED FOR NEXT QUARTER (Third Quarter 2007):

1. Prepared and submitted this Second Quarter 2007 Ground-Water Monitoring Report (contained herein).
2. Conduct quarterly ground-water monitoring/sampling for Third Quarter 2007.

QUARTERLY RESULTS SUMMARY:

Current phase of project:	Ground-water monitoring/sampling
Frequency of ground-water monitoring:	Quarterly: MW-1, MW-2, MW-3, MW-4, MW-5, MW-6
Frequency of ground-water sampling:	Quarterly: MW-1 Semi-Annually (1Q and 3Q): MW-2 and MW-4 Annually (3Q): MW-3, MW-5, and MW-6
Is free product (FP) present on-site:	No
Current remediation techniques:	NA
Depth to ground water (below TOC):	4.30 ft (MW-6) to 7.60 ft (MW-5)
General ground-water flow direction:	Southwest
Approximate hydraulic gradient:	0.03 ft/ft

DISCUSSION:

Second quarter 2007 ground-water monitoring and sampling was conducted at Station #374 on 8 May 2007 by Stratus. Water levels were gauged in the six wells at the Site. No irregularities were noted in the field during this quarter's water level gauging. Depth to water measurements ranged from 4.30 ft at MW-6 to 7.60 ft at MW-5. Resulting ground-water surface elevations ranged from 158.07 ft above mean sea level in well MW-1 to 153.26 ft at well MW-3. Water level elevations were between historic minimum and maximum ranges for each well, as summarized in Table 1. Water level elevations yielded a potentiometric ground-water flow direction and gradient to the southwest at approximately 0.03 ft/ft, consistent with historical data reported in Table 3. Ground-water monitoring field data sheets are provided within Appendix A. Measured depths to ground-water and respective ground-water elevations are summarized in Table 1. Potentiometric ground-water elevation contours are presented in Drawing 1.

Consistent with the current ground-water sampling schedule, water samples were collected from well MW-1 at the Site. No irregularities were reported during sampling. Samples were submitted under chain of custody protocol to Test America Analytical Testing Corporation (Morgan Hill, California), for analysis of Gasoline Range Organics (GRO, C4-12) by the LUFT GCMS Method; for Benzene, Toluene, Ethylbenzene, and Total Xylenes (BTEX) by EPA Method 8260B; and tert-Amyl methyl ether (TAME), tert-Butyl alcohol (TBA), Di-isopropyl ether (DIPE), 1,2-Dibromomethane (EDB), 1,2-Dichloroethane (1,2-DCA), Ethanol, Ethyl tert-butyl ether (ETBE), and Methyl tert-butyl ether (MTBE) by EPA Method 8260B. No irregularities were encountered during laboratory analysis of the samples. Ground-water sampling field data sheets and the laboratory analytical report, including chain of custody documentation, are provided in Appendix A.

MTBE was detected above the laboratory reporting limit in well MW-1 at a concentration of 420 micrograms per liter. The remaining fuel additives and oxygenates were not detected above their laboratory reporting limits in well MW-1 sampled this quarter. Detected analyte concentrations were within the historic minimum and maximum ranges recorded for each well. Historic laboratory analytical results are summarized in Table 1 and Table 2. The most recent GRO, Benzene, and MTBE concentrations are also presented in Drawing 1. A copy of the Laboratory Analytical Report, including chain-of-custody documentation is provided in Appendix A. Ground-water monitoring data (GEO_WELL) and laboratory analytical results (EDF) were uploaded to the GeoTracker AB2886 database. Upload confirmation pages are provided in Appendix B.

CLOSURE:

The findings presented in this report are based upon: observations of Stratus field personnel (see Appendix A), the points investigated, and results of laboratory tests performed by Test America (Morgan Hill, California). Our services were performed in accordance with the generally accepted standard of practice at the time this report was written. No other warranty, expressed or implied was made. This report has been prepared for the exclusive use of Atlantic Richfield Company. It is possible that variations in soil or ground-water conditions could exist beyond points explored in this investigation. Also, changes in site conditions could occur in the future due to variations in rainfall, temperature, regional water usage, or other factors.

ATTACHMENTS:

- Drawing 1. Ground-Water Elevation Contours and Analytical Summary Map, 8 May 2007, Station #374, 6407 Telegraph Avenue, Oakland, California
- Table 1. Summary of Ground-Water Monitoring Data: Relative Water Elevations and Laboratory Analyses, Station #374, 6407 Telegraph Ave., Oakland, CA
- Table 2. Summary of Fuel Additives Analytical Data, Station #374, 6407 Telegraph Ave., Oakland, CA
- Table 3. Historical Ground-Water Flow Direction and Gradient, Station #374, 6407 Telegraph Ave., Oakland, CA
- Appendix A. Stratus Ground-Water Sampling Data Package (Includes Field Data Sheets and Laboratory Analytical Report with Chain-of-Custody Documentation)
- Appendix B. GeoTracker Upload Confirmation

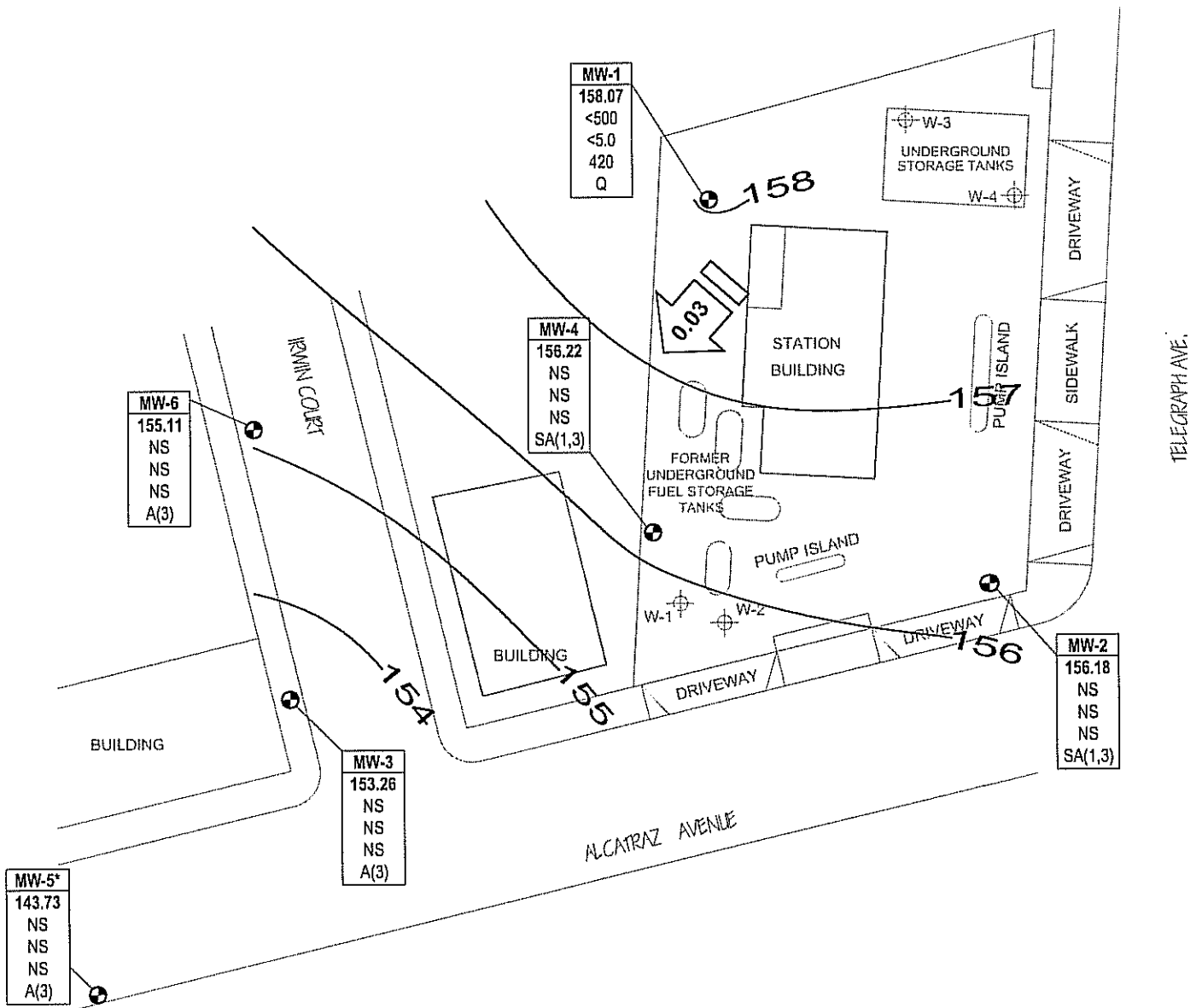

LEGEND

- MONITORING WELL
 - TANK PIT MONITORING WELL
- | | |
|---------|---|
| Well | WELL DESIGNATION |
| ELEV | GROUND-WATER ELEVATION (FT MSL) |
| GRO | GRO, BENZENE & MTBE CONCENTRATIONS IN GROUND WATER (µg/L) |
| Benzene | |
| MTBE | |
| A/Q/SA | SAMPLING FREQUENCY |
- < NOT DETECTED AT OR ABOVE LABORATORY LIMITS
 - Q SAMPLED QUARTERLY
 - SA(1,3) SAMPLED SEMI-ANNUALLY, 1ST & 3RD QUARTERS
 - A(3) SAMPLED ANNUALLY, 3RD QUARTER
 - NS NOT SAMPLED
 - APPROXIMATE GROUND-WATER FLOW AND DIRECTION (FT/FT)
 - 155 GROUND-WATER ELEVATION CONTOUR (FT MSL)
 - * Elevation not used for contours

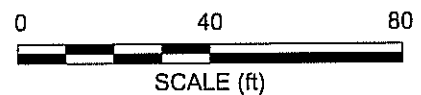
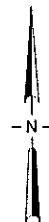

NOTE: SITE MAP ADAPTED FROM IT CORPORATION FIGURES. SITE DIMENSIONS AND FACILITY LOCATIONS NOT VERIFIED.

Table 1. Summary of Ground-Water Monitoring Data: Relative Water Elevations and Laboratory Analyses

Station #374, 6407 Telegraph Ave., Oakland, CA

Well and Sample Date	P/NP	Comments	TOC (feet msl)	Top of Screen (ft bgs)	Bottom of Screen (ft bgs)	DTW (feet bgs)	Water Level Elevation (feet msl)	Concentrations in (µg/L)					DO (mg/L)	pH
								GRO/TPHg	Benzene	Toluene	Ethyl-Benzene	Total Xylenes		
MW-1														
6/20/2000			158.91	7.00	27.0	6.86	152.05	--	--	--	--	--	--	--
9/28/2000	--		158.91	7.00	27.0	7.50	151.41	--	--	--	--	--	--	--
12/17/2000	--		158.91	7.00	27.0	7.49	151.42	--	--	--	--	--	--	--
3/23/2001	--		158.91	7.00	27.0	5.90	153.01	<50	<0.5	<0.5	<0.5	<0.5	2,710	--
6/21/2001	--		158.91	7.00	27.0	7.45	151.46	--	--	--	--	--	--	--
9/23/2001	--		158.91	7.00	27.0	8.46	150.45	--	--	--	--	--	--	--
12/31/2001	--		158.91	7.00	27.0	5.50	153.41	--	--	--	--	--	--	--
3/21/2002	--		158.91	7.00	27.0	4.71	154.20	<5,000	<50	<50	<50	<50	2,000	--
4/17/2002	--		158.91	7.00	27.0	5.54	153.37	--	--	--	--	--	--	--
8/12/2002	--		158.91	7.00	27.0	7.77	151.14	--	--	--	--	--	--	--
12/6/2002			158.91	7.00	27.0	7.65	151.26	--	--	--	--	--	--	--
1/29/2003	--	b	158.91	7.00	27.0	5.88	153.03	--	--	--	--	--	--	--
5/23/2003	--		158.91	7.00	27.0	5.62	153.29	<10,000	<100	<100	<100	<100	1,600	1.3
9/4/2003	--		158.91	7.00	27.0	7.85	151.06	--	--	--	--	--	--	--
11/20/2003	P		158.91	7.00	27.0	8.17	150.74	1,600	<10	<10	<10	<10	1,500	1.7
02/02/2004	P	f	164.57	7.00	27.0	6.71	157.86	--	--	--	--	--	--	1.0
05/14/2004	P		164.57	7.00	27.0	7.08	157.49	<2,500	<25	<25	<25	<25	1,200	1.4
09/02/2004	P		164.57	7.00	27.0	8.12	156.45	580	<5.0	<5.0	<5.0	<5.0	660	3.8
11/04/2004	P		164.57	7.00	27.0	7.38	157.19	1,700	<10	<10	<10	<10	580	6.0
02/08/2005	P		164.57	7.00	27.0	6.60	157.97	<1,000	<10	<10	<10	<10	610	0.71
05/09/2005	P	e	164.57	7.00	27.0	6.84	157.73	540	<5.0	<5.0	<5.0	5.5	620	3.12
08/11/2005	P		164.57	7.00	27.0	7.36	157.21	540	<2.5	<2.5	<2.5	4.0	390	0.8
11/18/2005	P	e	164.57	7.00	27.0	8.02	156.55	350	<2.5	<2.5	<2.5	<2.5	340	2.6
02/16/2006	P	e	164.57	7.00	27.0	6.44	158.13	350	<2.5	<2.5	<2.5	<2.5	340	1.6
5/30/2006	P		164.57	7.00	27.0	6.87	157.70	270	<2.5	<2.5	<2.5	<2.5	420	4.73
8/24/2006	P		164.57	7.00	27.0	7.75	156.82	95	<5.0	<5.0	<5.0	<5.0	180	0.65
11/1/2006	P		164.57	7.00	27.0	8.28	156.29	120	<5.0	<5.0	<5.0	<5.0	220	1.65
2/7/2007	NP	e	164.57	7.00	27.0	7.40	157.17	120	<5.0	<5.0	<5.0	<5.0	190	1.88
5/8/2007	P		164.57	7.00	27.0	6.50	158.07	<500	<5.0	<5.0	<5.0	<5.0	420	1.21
MW-2														

Table 1. Summary of Ground-Water Monitoring Data: Relative Water Elevations and Laboratory Analyses

Station #374, 6407 Telegraph Ave., Oakland, CA

Well and Sample Date	P/NP	Comments	TOC (feet msl)	Top of Screen (ft bgs)	Bottom of Screen (ft bgs)	DTW (feet bgs)	Water Level Elevation (feet msl)	Concentrations in (µg/L)						DO (mg/L)	pH
								GRO/TPHg	Benzene	Toluene	Ethyl-Benzene	Total Xylenes	MTBE		
MW-2 Cont.															
6/20/2000	--		157.92	7.00	27.0	7.67	150.25	--	--	--	--	--	--	--	--
9/28/2000	--		157.92	7.00	27.0	8.51	149.41	--	--	--	--	--	--	--	--
12/17/2000	--		157.92	7.00	27.0	8.14	149.78	--	--	--	--	--	--	--	--
3/23/2001	--		157.92	7.00	27.0	7.21	150.71	<50	<0.5	<0.5	<0.5	<0.5	<2.5	--	--
6/21/2001	--		157.92	7.00	27.0	7.99	149.93	--	--	--	--	--	--	--	--
9/23/2001	--		157.92	7.00	27.0	8.52	149.40	--	--	--	--	--	--	--	--
12/31/2001	--		157.92	7.00	27.0	6.01	151.91	--	--	--	--	--	--	--	--
3/21/2002	--		157.92	7.00	27.0	5.95	151.97	<50	<0.5	<0.5	<0.5	<0.5	45	--	--
4/17/2002	--		157.92	7.00	27.0	6.45	151.47	--	--	--	--	--	--	--	--
8/12/2002	--		157.92	7.00	27.0	8.08	149.84	--	--	--	--	--	--	--	--
12/6/2002	--		157.92	7.00	27.0	8.29	149.63	--	--	--	--	--	--	--	--
1/29/2003	--	b	157.92	7.00	27.0	7.22	150.70	--	--	--	--	--	--	--	--
5/23/2003	--		157.92	7.00	27.0	6.85	151.07	<50	<0.50	<0.50	<0.50	<0.50	55	1.4	7.2
9/4/2003	--		157.92	7.00	27.0	7.94	149.98	--	--	--	--	--	--	--	--
11/20/2003	--		157.92	7.00	27.0	8.05	149.87	--	--	--	--	--	--	--	--
02/02/2004	P	f	163.46	7.00	27.0	7.00	156.46	74	<0.50	<0.50	<0.50	<0.50	37	1.1	8.9
05/14/2004	--		163.46	7.00	27.0	7.97	155.49	--	--	--	--	--	--	--	--
09/02/2004	P		163.46	7.00	27.0	8.19	155.27	<250	<2.5	<2.5	<2.5	<2.5	67	2.7	6.9
11/04/2004	--		163.46	7.00	27.0	7.54	155.92	--	--	--	--	--	--	--	--
02/08/2005	P		163.46	7.00	27.0	6.72	156.74	<50	<0.50	<0.50	<0.50	<0.50	30	0.86	6.7
05/09/2005	--		163.46	7.00	27.0	7.16	156.30	--	--	--	--	--	--	--	--
08/11/2005	P		163.46	7.00	27.0	7.85	155.61	<50	<0.50	<0.50	<0.50	<0.50	35	1.0	6.6
11/18/2005	--		163.46	7.00	27.0	8.23	155.23	--	--	--	--	--	--	--	--
02/16/2006	P		163.46	7.00	27.0	6.82	156.64	<50	<0.50	<0.50	<0.50	<0.50	39	1.3	7.0
5/30/2006	--		163.46	7.00	27.0	7.23	156.23	--	--	--	--	--	--	--	--
8/24/2006	P		163.46	7.00	27.0	8.00	155.46	60	<0.50	<0.50	<0.50	<0.50	25	0.90	6.8
11/1/2006	--		163.46	7.00	27.0	8.38	155.08	--	--	--	--	--	--	--	--
2/7/2007	NP		163.46	7.00	27.0	7.88	155.58	<50	0.50	<0.50	<0.50	<0.50	7.2	0.94	7.39
5/8/2007	--		163.46	7.00	27.0	7.28	156.18	--	--	--	--	--	--	--	--
MW-3															

Table 1. Summary of Ground-Water Monitoring Data: Relative Water Elevations and Laboratory Analyses

Station #374, 6407 Telegraph Ave., Oakland, CA

Well and Sample Date	P/NP	Comments	TOC (feet msl)	Top of Screen (ft bgs)	Bottom of Screen (ft bgs)	DTW (feet bgs)	Water Level Elevation (feet msl)	Concentrations in (µg/L)						DO (mg/L)	pH
								GRO/TPHg	Benzene	Toluene	Ethyl-Benzene	Total Xylenes	MTBE		
MW-3 Cont.															
6/20/2000	--		153.64	7.00	27.0	6.42	147.22	<50	<0.5	<0.5	<0.5	<1.0	<1.0	--	--
9/28/2000	--		153.64	7.00	27.0	7.31	146.33	--	--	--	--	--	--	--	--
12/17/2000	--		153.64	7.00	27.0	6.45	147.19	<50	<0.5	<0.5	<0.5	<0.5	<2.5	--	--
3/23/2001	--		153.64	7.00	27.0	6.01	147.63	--	--	--	--	--	--	--	--
6/21/2001	--		153.64	7.00	27.0	6.80	146.84	110	5.5	<0.5	5.4	4.1	2.5	--	--
9/23/2001	--		153.64	7.00	27.0	7.32	146.32	--	--	--	--	--	--	--	--
12/31/2001	--		153.64	7.00	27.0	4.48	149.16	<50	<0.5	<0.5	<0.5	<0.5	4.9	--	--
3/21/2002	--		153.64	7.00	27.0	4.36	149.28	--	--	--	--	--	--	--	--
4/17/2002	--		153.64	7.00	27.0	5.31	148.33	<50	<0.5	<0.5	<0.5	<0.5	8.7	--	--
8/12/2002	--		153.64	7.00	27.0	7.00	146.64	--	--	--	--	--	--	--	--
12/6/2002	--		153.64	7.00	27.0	7.32	146.32	<50	<0.5	<0.5	<0.5	<0.5	6.2	1.4	6.7
1/29/2003	--	b	153.64	7.00	27.0	6.07	147.57	--	--	--	--	--	--	--	--
5/23/2003	--		153.64	7.00	27.0	6.45	147.19	<50	<0.50	<0.50	<0.50	<0.50	1.6	0.9	7.7
9/4/2003	--	c	153.64	7.00	27.0	6.93	146.71	--	--	--	--	--	--	--	--
11/20/2003	--	e	153.64	7.00	27.0	7.04	146.60	--	--	--	--	--	--	--	--
02/02/2004	--	f	159.21	7.00	27.0	5.92	153.29	--	--	--	--	--	--	--	--
05/14/2004	--		159.21	7.00	27.0	7.52	151.69	--	--	--	--	--	--	--	--
09/02/2004	P		159.21	7.00	27.0	7.19	152.02	<50	<0.50	<0.50	<0.50	<0.50	6.5	9.3	8.9
11/04/2004	--		159.21	7.00	27.0	6.40	152.81	--	--	--	--	--	--	--	--
02/08/2005	--		159.21	7.00	27.0	6.01	153.20	--	--	--	--	--	--	--	--
05/09/2005	--		159.21	7.00	27.0	6.74	152.47	--	--	--	--	--	--	--	--
08/11/2005	P		159.21	7.00	27.0	6.77	152.44	<50	<0.50	<0.50	<0.50	<0.50	11	1.9	6.5
11/18/2005	--		159.21	7.00	27.0	7.83	151.38	--	--	--	--	--	--	--	--
02/16/2006	--		159.21	7.00	27.0	7.26	151.95	--	--	--	--	--	--	--	--
5/30/2006	--		159.21	7.00	27.0	5.82	153.39	--	--	--	--	--	--	--	--
8/24/2006	P		159.21	7.00	27.0	7.00	152.21	<50	<0.50	<0.50	<0.50	<0.50	7.6	1.15	6.4
11/1/2006	--		159.21	7.00	27.0	7.50	151.71	--	--	--	--	--	--	--	--
2/7/2007	--		159.21	7.00	27.0	6.90	152.31	--	--	--	--	--	--	--	--
5/8/2007	--		159.21	7.00	27.0	5.95	153.26	--	--	--	--	--	--	--	--
MW-4															

Table 1. Summary of Ground-Water Monitoring Data: Relative Water Elevations and Laboratory Analyses

Station #374, 6407 Telegraph Ave., Oakland, CA

Well and Sample Date	P/NP	Comments	TOC (feet msl)	Top of Screen (ft bgs)	Bottom of Screen (ft bgs)	DTW (feet bgs)	Water Level Elevation (feet msl)	Concentrations in (µg/L)						DO (mg/L)	pH
								GRO/TPHg	Benzene	Toluene	Ethyl-Benzene	Total Xylenes	MTBE		
MW-4 Cont.															
6/20/2000	--	c	156.53	7.00	27.0	7.50	149.03	20,000	5,100	440	1,000	1,700	<250	--	--
9/28/2000	--		156.53	7.00	27.0	8.20	148.33	--	--	--	--	--	--	--	--
12/17/2000	--		156.53	7.00	27.0	8.11	148.42	4,320	1,240	<20	27.2	249	<100	--	--
3/23/2001	--		156.53	7.00	27.0	6.69	149.84	--	--	--	--	--	--	--	--
6/21/2001	--		156.53	7.00	27.0	8.01	148.52	2,800	470	16	19	160	130	--	--
9/23/2001	--		156.53	7.00	27.0	8.91	147.62	--	--	--	--	--	--	--	--
12/31/2001	--		156.53	7.00	27.0	4.42	152.11	4,600	1,500	100	160	210	160	--	--
3/21/2002	--		156.53	7.00	27.0	4.98	151.55	--	--	--	--	--	--	--	--
4/17/2002	--		156.53	7.00	27.0	6.23	150.30	7,100	2,200	110	290	450	<250	--	--
8/12/2002	--		156.53	7.00	27.0	8.24	148.29	--	--	--	--	--	--	--	--
12/6/2002	--	a	156.53	7.00	27.0	8.42	148.11	1,500	410	6.8	20	29	43	1.1	6.7
1/29/2003	--	b	156.53	7.00	27.0	7.20	149.33	--	--	--	--	--	--	--	--
5/23/2003	--		156.53	7.00	27.0	7.18	149.35	<5,000	1,300	89	210	260	<50	1.4	6.9
9/4/2003	--	c	156.53	7.00	27.0	8.15	148.38	--	--	--	--	--	--	--	--
11/20/2003	--	c	156.53	7.00	27.0	8.73	147.80	--	--	--	--	--	--	--	--
02/02/2004	P	c, f, g	163.25	7.00	27.0	6.25	157.00	980	280	21	29	38	29	1.4	10.6
05/14/2004	--	g	163.25	7.00	27.0	8.38	154.87	--	--	--	--	--	--	--	--
09/02/2004	P	g	163.25	7.00	27.0	8.36	154.89	260	11	<1.0	5.5	14	28	2.4	7.4
11/04/2004	--	c, g	163.25	7.00	27.0	7.71	155.54	--	--	--	--	--	--	--	--
02/08/2005	P	g	163.25	7.00	27.0	6.27	156.98	7,500	1,700	320	480	920	45	0.65	6.5
05/09/2005	--	g	163.25	7.00	27.0	5.90	157.35	--	--	--	--	--	--	--	--
08/11/2005	P	g	163.25	7.00	27.0	7.96	155.29	3,100	1,100	41	160	110	32	0.6	6.5
11/18/2005	--	g	163.25	7.00	27.0	8.57	154.68	--	--	--	--	--	--	--	--
02/16/2006	P	g	163.25	7.00	27.0	6.28	156.97	9,400	1,800	130	600	420	35	0.5	6.8
5/30/2006	--	g	163.25	7.00	27.0	7.02	156.23	--	--	--	--	--	--	--	--
8/24/2006	P	g	162.47	7.00	27.0	8.26	154.21	3,600	1,400	21	110	70	39	1.00	6.8
11/17/2006	--		163.25	7.00	27.0	8.67	154.58	--	--	--	--	--	--	--	--
2/7/2007	NP		163.25	7.00	27.0	8.02	155.23	3,100	570	17	170	110	67	0.95	7.07
5/8/2007	--		163.25	7.00	27.0	7.03	156.22	--	--	--	--	--	--	--	--
MW-5															

Table 1. Summary of Ground-Water Monitoring Data: Relative Water Elevations and Laboratory Analyses

Station #374, 6407 Telegraph Ave., Oakland, CA

Well and Sample Date	P/NP	Comments	TOC (feet msl)	Top of Screen (ft bgs)	Bottom of Screen (ft bgs)	DTW (feet bgs)	Water Level Elevation (feet msl)	Concentrations in (µg/L)						DO (mg/L)	pH
								GRO/TPHg	Benzene	Toluene	Ethyl-Benzene	Total Xylenes	MTBE		
MW-5 Cont.															
6/20/2000	--		151.33	10.00	23.0	7.84	143.49	<50	<0.5	<0.5	<0.5	<1.0	<10	--	--
9/28/2000	--		151.33	10.00	23.0	8.37	142.96	<50	<0.5	<0.5	<0.5	<0.5	<2.5	--	--
12/17/2000	--		151.33	10.00	23.0	8.36	142.97	<50	<0.5	<0.5	<0.5	<0.5	<2.5	--	--
3/23/2001	--		151.33	10.00	23.0	7.55	143.78	<50	<0.5	<0.5	<0.5	<0.5	<2.5	--	--
6/21/2001	--		151.33	10.00	23.0	8.20	143.13	<50	<0.5	<0.5	<0.5	<0.5	<2.5	--	--
9/23/2001	--		151.33	10.00	23.0	8.68	142.65	<50	<0.5	<0.5	<0.5	<0.5	<2.5	--	--
12/31/2001	--		151.33	10.00	23.0	7.57	143.76	<50	<0.5	<0.5	<0.5	<0.5	<2.5	--	--
3/21/2002	--		151.33	10.00	23.0	6.12	145.21	<50	<0.5	<0.5	<0.5	<0.5	3.2	--	--
4/17/2002	--		151.33	10.00	23.0	6.61	144.72	<50	<0.5	<0.5	<0.5	<0.5	<2.5	--	--
8/12/2002	--		151.33	10.00	23.0	8.14	143.19	<50	<0.5	<0.5	<0.5	<0.5	<2.5	4.1	7.6
12/6/2002	--		151.33	10.00	23.0	8.65	142.68	<50	<0.5	<0.5	<0.5	<0.5	<2.5	1.1	6.8
1/29/2003	--	b	151.33	10.00	23.0	7.22	144.11	<50	<0.5	<0.5	<0.5	<0.5	<0.5	1	6.6
5/23/2003	--		151.33	10.00	23.0	7.31	144.02	<50	<0.50	<0.50	<0.50	<0.50	<0.50	1.1	6.6
9/4/2003	--		151.33	10.00	23.0	9.50	141.83	<50	<0.50	<0.50	<0.50	<0.50	<0.50	3.2	6.7
11/20/2003	--		151.33	10.00	23.0	8.31	143.02	--	--	--	--	--	--	--	--
02/02/2004	--	c, f, h	151.33	10.00	23.0	6.92	144.41	--	--	--	--	--	--	--	--
05/14/2004	--	h	151.33	10.00	23.0	8.56	142.77	--	--	--	--	--	--	--	--
09/02/2004	P	h	151.33	10.00	23.0	8.79	142.54	<50	<0.50	<0.50	<0.50	<0.50	<0.50	3.5	6.8
11/04/2004	--	c, h	151.33	10.00	23.0	8.33	143.00	--	--	--	--	--	--	--	--
02/08/2005	--	h	151.33	10.00	23.0	7.28	144.05	--	--	--	--	--	--	--	--
05/09/2005	--	h	151.33	10.00	23.0	8.19	143.14	--	--	--	--	--	--	--	--
08/11/2005	P	h	151.33	10.00	23.0	8.39	142.94	<50	<0.50	<0.50	<0.50	<0.50	<0.50	1.2	6.6
11/18/2005	--	h	151.33	10.00	23.0	11.25	140.08	--	--	--	--	--	--	--	--
02/16/2006	--	h	151.33	10.00	23.0	9.22	142.11	--	--	--	--	--	--	--	--
5/30/2006	--	h	151.33	10.00	23.0	7.52	143.81	--	--	--	--	--	--	--	--
8/24/2006	P	h	--	10.00	23.0	7.95	--	<50	<0.50	<0.50	<0.50	<0.50	<0.50	2.60	6.6
11/1/2006	--		151.33	10.00	23.0	8.32	143.01	--	--	--	--	--	--	--	--
2/7/2007	--		151.33	10.00	23.0	8.25	143.08	--	--	--	--	--	--	--	--
5/8/2007	--		151.33	10.00	23.0	7.60	143.73	--	--	--	--	--	--	--	--
MW-6															

Table 1. Summary of Ground-Water Monitoring Data: Relative Water Elevations and Laboratory Analyses

Station #374, 6407 Telegraph Ave., Oakland, CA

Well and Sample Date	P/NP	Comments	TOC (feet msl)	Top of Screen (ft bgs)	Bottom of Screen (ft bgs)	DTW (feet bgs)	Water Level Elevation (feet msl)	Concentrations in (µg/L)						DO (mg/L)	pH
								GRO/TPHg	Benzene	Toluene	Ethyl-Benzene	Total Xylenes	MTBE		
MW-6 Cont.															
6/20/2000	--		153.84	5.00	15.0	4.79	149.05	--	--	--	--	--	--	--	--
9/28/2000	--		153.84	5.00	15.0	5.39	148.45	--	--	--	--	--	--	--	--
12/17/2000	--		153.84	5.00	15.0	4.71	149.13	--	--	--	--	--	--	--	--
3/23/2001	--		153.84	5.00	15.0	4.69	149.15	<50	<0.5	<0.5	<0.5	<0.5	<2.5	--	--
6/21/2001	--		153.84	5.00	15.0	5.22	148.62	--	--	--	--	--	--	--	--
9/23/2001	--		153.84	5.00	15.0	5.40	148.44	--	--	--	--	--	--	--	--
12/31/2001	--		153.84	5.00	15.0	3.95	149.89	--	--	--	--	--	--	--	--
3/21/2002	--		153.84	5.00	15.0	2.94	150.90	<50	<0.5	<0.5	<0.5	<0.5	5.2	--	--
4/17/2002	--		153.84	5.00	15.0	5.11	148.73	--	--	--	--	--	--	--	--
8/12/2002	--		153.84	5.00	15.0	5.23	148.61	--	--	--	--	--	--	--	--
12/6/2002	--		153.84	5.00	15.0	5.29	148.35	--	--	--	--	--	--	--	--
1/29/2003	--	b	153.84	5.00	15.0	4.79	149.05	--	--	--	--	--	--	--	--
5/23/2003	--		153.84	5.00	15.0	4.31	149.53	<50	<0.50	<0.50	<0.50	<0.50	9.4	1	6.7
09/04/03	--	d	153.84	5.00	15.0	--	--	--	--	--	--	--	--	--	--
11/20/2003	--		153.84	5.00	15.0	6.31	147.53	--	--	--	--	--	--	--	--
02/02/2004	--		159.41	5.00	15.0	4.78	154.63	--	--	--	--	--	--	--	--
05/14/2004	--		159.41	5.00	15.0	6.29	153.12	--	--	--	--	--	--	--	--
09/02/2004	--	d	159.41	5.00	15.0	5.79	153.62	--	--	--	--	--	--	--	--
11/04/2004	--	d	159.41	5.00	15.0	--	--	--	--	--	--	--	--	--	--
02/08/2005	--		159.41	5.00	15.0	5.13	154.28	--	--	--	--	--	--	--	--
05/09/2005	--		159.41	5.00	15.0	4.52	154.89	--	--	--	--	--	--	--	--
08/11/2005	P		159.41	5.00	15.0	5.02	154.39	<50	<0.50	<0.50	<0.50	<0.50	7.9	2.1	6.6
11/18/2005	--		159.41	5.00	15.0	6.31	153.10	--	--	--	--	--	--	--	--
02/16/2006	--		159.41	5.00	15.0	4.24	155.17	--	--	--	--	--	--	--	--
5/30/2006	--		159.41	5.00	15.0	4.45	154.96	--	--	--	--	--	--	--	--
8/24/2006	P		159.41	5.00	15.0	5.18	154.23	<50	<0.50	<0.50	<0.50	<0.50	12	3.4	6.8
11/1/2006	--		159.41	5.00	15.0	6.05	153.36	--	--	--	--	--	--	--	--
2/7/2007	--		159.41	5.00	15.0	5.00	154.41	--	--	--	--	--	--	--	--
5/8/2007	--		159.41	5.00	15.0	4.30	155.11	--	--	--	--	--	--	--	--

SYMBOLS AND ABBREVIATIONS:

-- = Not analyzed/applicable/measured/available
< = Not detected at or above laboratory reporting limit
DO = Dissolved oxygen
DTW = Depth to water in ft bgs
ft bgs = Feet below ground surface
ft MSL = Feet above mean sea level
GRO = Gasoline range organics
GWE = Groundwater elevation measured in ft MSL
mg/L = Milligrams per liter
MTBE = Methyl tert-butyl ether
NP = Well was not purged prior to sampling
P = Well was purged prior to sampling
TOC = Top of casing measured in ft MSL
TPH-g = Total petroleum hydrocarbons as gasoline
µg/L = Micrograms per liter
BTEX = Benzene, toluene, ethylbenzene and xylenes

FOOTNOTES:

a = Chromatogram pattern: Gasoline C6-C10 for GRO/TPH-g.
b = Beginning this quarter, groundwater samples were analyzed by EPA method 8260B for TPH-g, BTEX, and fuel oxygenates.
c = Wells gauged with ORC sock in well.
d = Well inaccessible
e = The hydrocarbon result for GRO was partly due to individual peaks in the quantitative range.
f = Well resurveyed on 1/27/2004
g = Upon review of survey data (1/27/2004), TOC elevation for MW-4 is actually 162.47 ft.
h = Upon review of survey data (1/27/2004), MW-5 was not surveyed from the TOC. MW-5 was surveyed from the pavement due to inaccessibility to the TOC. Therefore, survey data for MW-5 from the TOC is unavailable.

NOTES:

Beginning in the fourth quarter 2003, the laboratory modified the reported analyte list. TPH-g was changed to GRO. The resulting data may be impacted by the potential of non-TPH-g analytes within the requested fuel range resulting in a higher concentration being reported.

Beginning in the second quarter 2004, the carbon range for GRO was changed from C6-C10 to C4-C12.

Values for DO and pH were obtained through field measurements.

The DTW's and TOC's for wells MW-5 and MW-6 were taken from Delta Environmental sampling sheets because the well logs were not available.

Note: The data within this table collected prior to April 2006 was provided to Broadbent & Associates, Inc. by Atlantic Richfield Company and their previous consultants. Broadbent & Associates, Inc. has not verified the accuracy of this information.

Table 2. Summary of Fuel Additives Analytical Data
Station #374, 6407 Telegraph Ave., Oakland, CA

Well and Sample Date	Concentrations in (µg/L)								Comments
	Ethanol	TBA	MTBE	DIPE	ETBE	TAME	1,2-DCA	EDB	
MW-1									
5/23/2003	<2,000	<4,000	1,600	<100	<100	<100	—	—	
11/20/2003	<2,000	<400	1,500	<10	<10	<10	—	—	a
05/14/2004	<5,000	<1,000	1,200	<25	<25	<25	<25	<25	
09/02/2004	<1,000	<200	660	<5.0	<5.0	<5.0	<5.0	<5.0	
11/04/2004	<2,000	<400	580	<10	<10	<10	<10	<10	
02/08/2005	<2,000	<400	610	<10	<10	<10	<10	<10	
05/09/2005	<1,000	<200	620	<5.0	<5.0	<5.0	<5.0	<5.0	a
08/11/2005	<500	250	390	<2.5	<2.5	2.6	<2.5	<2.5	a
11/18/2005	<500	<100	340	<2.5	<2.5	<2.5	<2.5	<2.5	a
02/16/2006	<1,500	<100	340	<2.5	<2.5	<2.5	<2.5	<2.5	
5/30/2006	<1,500	<100	420	<2.5	<2.5	<2.5	<2.5	<2.5	a
8/24/2006	<3,000	<200	180	<5.0	<5.0	<5.0	<5.0	<5.0	
11/1/2006	<3,000	<200	220	<5.0	<5.0	<5.0	<5.0	<5.0	a
2/7/2007	<3,000	<200	190	<5.0	<5.0	<5.0	<5.0	<5.0	
5/8/2007	<3,000	<200	420	<5.0	<5.0	<5.0	<5.0	<5.0	
MW-2									
5/23/2003	<100	<20	55	<0.50	<0.50	0.53	—	—	
02/02/2004	<100	<20	37	<0.50	<0.50	<0.50	<0.50	<0.50	
09/02/2004	<500	<100	67	<2.5	<2.5	<2.5	<2.5	<2.5	
02/08/2005	<100	<20	30	<0.50	<0.50	<0.50	<0.50	<0.50	
08/11/2005	<100	<20	35	<0.50	<0.50	<0.50	<0.50	<0.50	a
02/16/2006	<300	<20	39	<0.50	<0.50	<0.50	<0.50	<0.50	
8/24/2006	<300	<20	25	<0.50	<0.50	<0.50	<0.50	<0.50	
2/7/2007	<300	<20	7.2	<0.50	<0.50	<0.50	<0.50	<0.50	
MW-3									
5/23/2003	<100	<20	1.6	<0.50	<0.50	<0.50	—	—	
09/02/2004	<100	<20	6.5	<0.50	<0.50	<0.50	<0.50	<0.50	
08/11/2005	<100	<20	11	<0.50	<0.50	<0.50	<0.50	<0.50	a
8/24/2006	<300	<20	7.6	<0.50	<0.50	<0.50	<0.50	<0.50	
MW-4									

Table 2. Summary of Fuel Additives Analytical Data
 Station #374, 6407 Telegraph Ave., Oakland, CA

Well and Sample Date	Concentrations in (µg/L)								Comments
	Ethanol	TBA	MTBE	DIPE	ETBE	TAME	1,2-DCA	EDB	
MW-4 Cont.									
5/23/2003	<10,000	<2,000	<50	<50	<50	<50	-	-	
02/02/2004	<500	<100	29	<2.5	<2.5	2.6	<2.5	<2.5	
09/02/2004	<200	<40	28	<1.0	<1.0	<1.0	<1.0	<1.0	
02/08/2005	<5,000	<1,000	45	<25	<25	<25	<25	<25	
08/11/2005	<2,000	<400	32	<10	<10	<10	<10	<10	
02/16/2006	<6,000	<400	35	<10	<10	<10	<10	<10	
8/24/2006	<1,500	<100	39	<2.5	<2.5	<2.5	<2.5	<2.5	
2/7/2007	<6,000	<400	67	<10	<10	<10	<10	<10	
MW-5									
1/29/2003	<40	<20	<0.50	<0.50	<0.50	<0.50	-	-	
5/23/2003	<100	<20	<0.50	<0.50	<0.50	<0.50	--	--	
9/4/2003	<100	<20	<0.50	<0.50	<0.50	<0.50	<0.50	<0.50	
09/02/2004	<100	<20	<0.50	<0.50	<0.50	<0.50	<0.50	<0.50	
08/11/2005	<100	<20	<0.50	<0.50	<0.50	<0.50	<0.50	<0.50	
8/24/2006	<300	<20	<0.50	<0.50	<0.50	<0.50	<0.50	<0.50	
MW-6									
5/23/2003	<100	<20	9.4	<0.50	<0.50	<0.50	-	-	
08/11/2005	<100	<20	7.9	<0.50	<0.50	<0.50	<0.50	<0.50	a
8/24/2006	<300	<20	12	<0.50	<0.50	<0.50	<0.50	<0.50	

SYMBOLS AND ABBREVIATIONS:

-- = Not analyzed/applicable/measured/available

< = Not detected at or above the laboratory reporting limit

1,2-DCA = 1,2-Dichloroethane

DIPE = Di-isopropyl ether

EDB = 1,2-Dibromoethane

ETBE = Ethyl tert-butyl ether

MTBE = Methyl tert-butyl ether

TAME = tert-Amyl methyl ether

TBA = tert-Butyl alcohol

µg/L = Micrograms per Liter

FOOTNOTES:

a = The continuing calibration verification for ethanol was outside of client contractual limits, however, it was within method acceptance limits. The data should still be useful for its intended purpose.

NOTES:

All volatile organic compounds analyzed using EPA Method 8260B.

Note: The data within this table collected prior to April 2006 was provided to Broadbent & Associates, Inc. by Atlantic Richfield Company and their previous consultants. Broadbent & Associates, Inc. has not verified the accuracy of this information.

Table 3. Historical Ground-Water Flow Direction and Gradient
Station #374, 6407 Telegraph Ave., Oakland, CA

Date Sampled	Approximate Flow Direction	Approximate Hydraulic Gradient
1/31/1996	Southwest	0.04
4/10/1996	Southwest	0.04
7/16/1996	Southwest	0.03
10/14/1996	Southwest	0.03
3/27/1997	Southwest	0.04
5/27/1997	Southwest	0.03
8/12/1997	Southwest	0.04
11/17/1997	Southwest	0.03
3/16/1998	Southwest	0.03
5/12/1998	Southwest	0.04
7/27/1998	Southwest	0.04
10/15/1998	Southwest	0.02
2/18/1999	Southwest	0.05
5/24/1999	Southwest	0.03
8/27/1999	Southwest	0.03
10/26/1999	Southwest	0.03
2/3/2000	Southwest	0.047
6/20/2000	Southwest	0.035
9/28/2000	Southwest	0.034
12/17/2000	Southwest	0.032
3/23/2001	Southwest	0.034
6/21/2001	Southwest	0.032
9/23/2001	Southwest	0.029
12/31/2001	Southwest	0.043
3/21/2002	Southwest	0.038
4/17/2002	Southwest	0.031
8/12/2002	Southwest	0.032
12/6/2002	Southwest	0.020
1/29/2003	Southwest	0.027
5/23/2003	Southwest	0.039
9/4/2003	Southwest	0.033
11/20/2003	Southwest	0.029
2/2/2004	Southwest	0.043 (a)
5/14/2004	Southwest	0.037 (a)
9/2/2004	Southwest	0.027 (a)
11/4/2004	Southwest	0.034 (a)
2/8/2005	Southwest	0.061 (a)
5/9/2005	Southwest	0.08 (a)
8/11/2005	Southwest	0.06 (a)
11/18/2005	Southwest	0.07 (a)
2/16/2006	Southwest	0.09 (a)
5/30/2006	Southwest	0.06 (a)

Table 3. Historical Ground-Water Flow Direction and Gradient
Station #374, 6407 Telegraph Ave., Oakland, CA

Date Sampled	Approximate Flow Direction	Approximate Hydraulic Gradient
8/24/2006	Southwest	0.03
11/1/2006	Southwest	0.02
2/7/2007	Southwest	0.03
5/8/2007	Southwest	0.03

a = Gradients potentially suspect due to error in MW-4 and MW-5 TOC measuring point elevations discovered third quarter 2006.

Note: The data within this table collected prior to April 2006 was provided to Broadbent & Associates, Inc. by Atlantic Richfield Company and their previous consultants. Broadbent & Associates, Inc. has not verified the accuracy of this information.

APPENDIX A

**STRATUS GROUND-WATER SAMPLING DATA PACKAGE
(INCLUDES FIELD DATA SHEETS AND LABORATORY ANALYTICAL REPORT
WITH CHAIN-OF-CUSTODY DOCUMENTATION)**

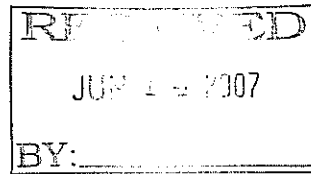

3330 Cameron Park Drive, Ste 550
Cameron Park, California 95682
(530) 676-6004 ~ Fax: (530) 676-6005

June 11, 2007

Mr. Rob Miller
Broadbent & Associates, Inc.
2000 Kirman Avenue
Reno, NV 89502

Re: Groundwater Sampling Data Package, BP Service Station No. 374, located at 6407 Telegraph Avenue, Oakland, California (Quarterly Monitoring performed on May 7 and 8, 2007)

General Information

Data Submittal Prepared / Reviewed by: Sandy Hayes / Jay Johnson

Phone Number: (530) 676-6000

On-Site Supplier Representative: Jerry Gonzales

Date: May 8, 2007

Arrival: 17:00 *Departure:* 18:00

Weather Conditions: Clear

Unusual Field Conditions: None

Scope of Work Performed: Quarterly monitoring and sampling

Variations from Work Scope: None noted

This submittal presents the tabulation of data collected in association with routine groundwater monitoring. The attachments include bill of lading, field data sheets, chain of custody documentation, and certified analytical results. The information is being provided to BP-ARCO's Scoping Supplier for use in preparing a report for regulatory submittal. This submittal is limited to presentation of collected data and does not include data interpretation or conclusions or recommendations. Any questions concerning this submittal should be addressed to the Preparer/Reviewer identified above.

Sincerely,

STRATUS ENVIRONMENTAL, INC.

Jay R. Johnson, P.G.
Project Manager



Attachments:

- Bill of Lading
- Field Data Sheets
- Chain of Custody Documentation
- Certified Analytical Results

CC: Mr. Paul Supple, BP/ARCO

BP GEM OIL COMPANY

TYPE **A** BILL OF LADING

SOURCE RECORD BILL OF LADING FOR NON-HAZARDOUS PURGEWATER RECOVERED FROM GROUNDWATER WELLS AT BP GEM OIL COMPANY FACILITIES IN THE STATE OF CALIFORNIA. THE NON-HAZARDOUS PURGEWATER WHICH HAS BEEN RECOVERED FROM GROUNDWATER WELLS IS COLLECTED BY THE CONTRACTOR, MADE UP INTO LOADS OF APPROPRIATE SIZE AND HAULED BY BELSHIRE ENVIRONMENTAL TO SEAPORT ENVIRONMENTAL IN REDWOOD CITY, CALIFORNIA.

The contractors performing this work are Stratus Environmental, Inc. [Stratus, 3330 Cameron Park Drive, Suite 550, Cameron Park, CA 95682, (530) 676-6004], and Doulos Environmental, Inc. [Doulos, PO Box 2559, Orangevale, CA 95662, (916) 990-0333]. Stratus is authorized by BP GEM OIL COMPANY to recover, collect, and apportion into loads the non-hazardous well purgewater that is drawn from wells at BP GEM Oil Company facilities and deliver that purgewater to BP GEM Oil Company facility 5786 located in West Sacramento, California. Doulos also performs these services under subcontract to Stratus. Transport routing of the non-hazardous well purgewater may be direct from one BP GEM facility to the designated destination point; from one BP GEM facility to the designated destination point via another BP GEM facility; from a BP GEM facility to the designated destination point via the contractor's facility, or any combination thereof. The non-hazardous well purgewater is and remains the property of BP GEM Oil Company.

This Source Record BILL OF LADING was initiated to cover the recovery of non-hazardous well purgewater from wells at the BP GEM Oil Company facility described below:

374

Station #

Oakland - 6407 Telegraph Ave.

Station Address

Total Gallons Collected From Groundwater Monitoring Wells:

41

Added Equipment Rinse Water

5

Any Other Adjustments

0

TOTAL GALS. RECOVERED

46

loaded onto Stratus vehicle #

Stratus Project #

time

date

1815

51 8107

Signature

Jerry G.

RECEIVED AT

time

date

1 1

Unloaded by Signature

BP ALAMEDA PORTFOLIO

HYDROLOGIC DATA SHEET

AK-15:50 DP-1800

Gauge Date: 5-8-07

Project Name: Oakland - 6407 Telegraph Ave.

Field Technician: Jerry

Project Number: 374

TOC = Top of Well Casing Elevation
 DTP = Depth to Free Product (FP or NAPL) Below TOC
 DTW = Depth to Groundwater Below TOC
 DTB = Depth to Bottom of Well Casing Below TOC

DIA = Well Casing Diameter
 ELEV = Groundwater Elevation
 DUP = Duplicate

WELL OR LOCATION	TIME	MEASUREMENT						PURGE & SAMPLE	SHEEN CONFIRMATION (w/bailer)	COMMENTS
		TOC	DTP	DTW	DTB	DIA	ELEV			
MW-1	16:15			6.50	26.55					
MW-2	16:09			7.28	26.15					
MW-3	16:05			5.95	26.65					
MW-4	16:17			7.03	26.80					
MW-5	15:55			7.60	22.95					
MW-6	16:00			4.30	14.95					

BP ALAMEDA PORTFOLIO
WATER SAMPLE FIELD DATA SHEET

PROJECT #: 374 PURGED BY: Jc WELL I.D.: MW-1
 CLIENT NAME: _____ SAMPLED BY: J SAMPLE I.D.: MW-1
 LOCATION: Oakland - 6407 Telegraph Ave. QA SAMPLES: _____

DATE PURGED 5.8.07 START (2400hr) 16:30 END (2400hr) _____
 DATE SAMPLED 5.8.07 SAMPLE TIME (2400hr) 17:30
 SAMPLE TYPE: Groundwater Surface Water _____ Treatment Effluent _____ Other _____

CASING DIAMETER: 2" _____ 3" _____ 4" 5" _____ 6" _____ 8" _____ Other _____
 Casing Volume: (gallons per foot) (0.17) (0.38) (0.67) (1.02) (1.50) (2.60) ()

DEPTH TO BOTTOM (feet) = 26.55 CASING VOLUME (gal) = 13.4
 DEPTH TO WATER (feet) = 6.50 CALCULATED PURGE (gal) = 40.3
 WATER COLUMN HEIGHT (feet) = 20.0 ACTUAL PURGE (gal) = 41.0

FIELD MEASUREMENTS

DATE	TIME (2400hr)	VOLUME (gal)	TEMP. (degrees F)	CONDUCTIVITY (umhos/cm)	pH (units)	COLOR (visual)	TURBIDITY (NTU)
<u>5.8.07</u>	<u>16:33</u>	<u>13.5</u>	<u>19.7</u>	<u>900</u>	<u>6.98</u>	<u>clear</u>	
<u>1</u>	<u>16:36</u>	<u>27.3</u>	<u>19.7</u>	<u>896</u>	<u>7.13</u>	<u>1</u>	
<u>1</u>	<u>16:39</u>	<u>41.0</u>	<u>19.8</u>	<u>870</u>	<u>6.94</u>		

SAMPLE INFORMATION

SAMPLE DEPTH TO WATER: 19.71 SAMPLE TURBIDITY: clear

80% RECHARGE: YES NO ANALYSES: See work order
 ODOR: NS SAMPLE VESSEL / PRESERVATIVE: 6 Vol-HCL

PURGING EQUIPMENT

Bladder Pump _____ Bailer (Teflon) _____
 Centrifugal Pump _____ Bailer (PVC) _____
 Submersible Pump _____ Bailer (Stainless Steel) _____
 Peristaltic Pump _____ Dedicated _____

Other: _____

Pump Depth: 20

SAMPLING EQUIPMENT

Bladder Pump _____ Bailer (Teflon) _____
 Centrifugal Pump _____ Bailer (PVC or disposable) _____
 Submersible Pump _____ Bailer (Stainless Steel) _____
 Peristaltic Pump _____ Dedicated _____

Other: _____

WELL INTEGRITY: COO9 LOCK#: MW-1

REMARKS: D.O 1.21 slow recharge

SIGNATURE: [Signature]



Chain of Custody Record

Project Name: BP 374
 BP BU/AR Region/Enfos Segment: BP > Americas > West > Retail > CA > Alameda > 374
 State or Lead Regulatory Agency: _____
 Requested Due Date (mm/dd/yy): _____

On-site Time: <u>1700</u>	Temp: <u>80</u>
Off-site Time: <u>1800</u>	Temp: <u>60</u>
Sky Conditions: <u>clear</u>	
Meteorological Events: <u>none</u>	
Wind Speed: <u>0</u>	Direction: <u>NA</u>

Lab Name: TestAmerica
 Address: 885 Jarvis Drive
Morgan Hill, CA 95937
 Lab PM: Lisa Race
 Tele/Fax: 408-782-8156 408-782-6308 (fax)
 BP/AR PM Contact: Paul Supple
 Address: 2010 Crow Canyon Place, Suite 150
San Ramon, CA
 Tele/Fax: 925-275-3506

BP/AR Facility No.: 374
 BP/AR Facility Address: 6407 Telegraph Ave., Oakland
 Site Lat/Long: _____
 California Global ID #: T0600100106
 Enfos Project No.: G0C21-0015
 Provision or RCOP (circle one) Provision
 Phase/WBS: 04-Monitoring
 Sub Phase/Task: 03-Analytical
 Cost Element: 01-Contractor labor

Consultant/Contractor: Stratus Environmental, Inc.
 Address: 3330 Cameron Park Drive, Suite 550
Cameron Park, CA 95682
 Consultant/Contractor Project No.: E374-04
 Consultant/Contractor PM: Jay Johnson
 Tele/Fax: (530) 676-6000 / (530) 676-6005
 Report Type & QC Level: Level 1 with EDF
 E-mail EDD To: shayes@stratusinc.net
 Invoice to: Atlantic Richfield Co.

Item No.	Sample Description	Time	Date	Matrix			Laboratory No.	No. of Containers	Preservative					Requested Analysis					Sample Point Lat/Long and Comments *Oxy = MTBD, TAME, ETBE, DIPE, TBA	
				Soil/Solid	Water/Liquid	Air			Unpreserved	H ₂ SO ₄	HNO ₃	HCl	Methanol	GRO/BTEX/Oxy*	1,2 DCA	Ethanol	EDB	DRO		
1	MW-1																			
2	TB 374 5807	1730	5-30-07	X				26												
3		500	1	X																
4																				
5																				

Collector's Name: Jerry Gonzalez
 Collector's Company: Douglas EW
 Collection Date: _____
 Collection Method: _____
 Collection Tracking No.: _____
 Instructions: _____

Relinquished By / Affiliation: <u>[Signature]</u>	Date: <u>5/21/07</u>	Time: <u>1315</u>	Accepted By / Affiliation: <u>[Signature]</u>	Date: <u>5/21/07</u>	Time: <u>1315</u>
---	----------------------	-------------------	---	----------------------	-------------------

25 May, 2007

Jay Johnson
Stratus Environmental Inc. [Arco]
3330 Cameron Park Dr., Suite 550
Cameron Park, CA 95682

RE: ARCO #0374, Oakland, CA
Work Order: MQE0418

Enclosed are the results of analyses for samples received by the laboratory on 05/09/07 20:45. If you have any questions concerning this report, please feel free to contact me.

Sincerely,



Lisa Race
Senior Project Manager

CA ELAP Certificate # 1210

The results in this laboratory report pertain only to the samples tested in the laboratory. The analyses contained in this report were performed in accordance with the BPGCLN Technical Specifications, applicable Federal, State, local regulations and certification requirements as well as the methodologies as described in laboratory SOPs reviewed by the BPGCLN. This entire report was reviewed and approved for release.

Stratus Environmental Inc. [Arco] 3330 Cameron Park Dr., Suite 550 Cameron Park CA, 95682	Project: ARCO #0374, Oakland, CA Project Number: G0C21-0015 Project Manager: Jay Johnson	MQE0418 Reported: 05/25/07 16:20
---	--	--

ANALYTICAL REPORT FOR SAMPLES

Sample ID	Laboratory ID	Matrix	Date Sampled	Date Received
MW-1	MQE0418-01	Water	05/08/07 17:30	05/09/07 20:45
TB 374 5807	MQE0418-02	Water	05/08/07 05:00	05/09/07 20:45

The carbon range for the TPH-GRO has been changed from C6-C10 to C4-C12. The carbon range for TPH-DRO has been changed from C10-C28 to C10-C36. EPA 8015B has been modified to better meet the requirements of California regulatory agencies. These samples were received with no custody seals.

Stratus Environmental Inc. [Arco]
3330 Cameron Park Dr., Suite 550
Cameron Park CA, 95682

Project: ARCO #0374, Oakland, CA
Project Number: G0C21-0015
Project Manager: Jay Johnson

MQE0418
Reported:
05/25/07 16:20

Total Purgeable Hydrocarbons by GC/MS (CA LUFT)
TestAmerica - Morgan Hill, CA

Analyte	Result	Reporting Limit	Units	Dilution	Batch	Prepared	Analyzed	Method	Notes
MW-1 (MQE0418-01) Water Sampled: 05/08/07 17:30 Received: 05/09/07 20:45									
Gasoline Range Organics (C4-C12)	ND	500	ug/l	10	7E17020	05/17/07	05/18/07	LUFT GCMS	
Surrogate: 1,2-Dichloroethane-d4		112 %	60-125		"	"	"	"	
Surrogate: Dibromofluoromethane		109 %	75-120		"	"	"	"	
Surrogate: Toluene-d8		102 %	80-120		"	"	"	"	
Surrogate: 4-Bromofluorobenzene		94 %	60-135		"	"	"	"	

Stratus Environmental Inc. [Arco]
3330 Cameron Park Dr., Suite 550
Cameron Park CA, 95682

Project: ARCO #0374, Oakland, CA
Project Number: G0C21-0015
Project Manager: Jay Johnson

MQE0418
Reported:
05/25/07 16:20

Volatile Organic Compounds by EPA Method 8260B

TestAmerica - Morgan Hill, CA

Analyte	Result	Reporting Limit	Units	Dilution	Batch	Prepared	Analyzed	Method	Notes
MW-1 (MQE0418-01) Water Sampled: 05/08/07 17:30 Received: 05/09/07 20:45									
tert-Amyl methyl ether	ND	5.0	ug/l	10	7E17020	05/17/07	05/18/07	EPA 8260B	
Benzene	ND	5.0	"	"	"	"	"	"	
tert-Butyl alcohol	ND	200	"	"	"	"	"	"	
Di-isopropyl ether	ND	5.0	"	"	"	"	"	"	
1,2-Dibromoethane (EDB)	ND	5.0	"	"	"	"	"	"	
1,2-Dichloroethane	ND	5.0	"	"	"	"	"	"	
Ethanol	ND	3000	"	"	"	"	"	"	
Ethyl tert-butyl ether	ND	5.0	"	"	"	"	"	"	
Ethylbenzene	ND	5.0	"	"	"	"	"	"	
Methyl tert-butyl ether	420	5.0	"	"	"	"	"	"	
Toluene	ND	5.0	"	"	"	"	"	"	
Xylenes (total)	ND	5.0	"	"	"	"	"	"	
<i>Surrogate: Dibromofluoromethane</i>		109 %		75-120	"	"	"	"	
<i>Surrogate: 1,2-Dichloroethane-d4</i>		112 %		60-125	"	"	"	"	
<i>Surrogate: Toluene-d8</i>		102 %		80-120	"	"	"	"	
<i>Surrogate: 4-Bromofluorobenzene</i>		94 %		60-135	"	"	"	"	

Stratus Environmental Inc. [Arco]
3330 Cameron Park Dr., Suite 550
Cameron Park CA, 95682

Project: ARCO #0374, Oakland, CA
Project Number: G0C21-0015
Project Manager: Jay Johnson

MQE0418
Reported:
05/25/07 16:20

Total Purgeable Hydrocarbons by GC/MS (CA LUFT) - Quality Control
TestAmerica - Morgan Hill, CA

Analyte	Result	Reporting Limit	Units	Spike Level	Source Result	%REC	%REC Limits	RPD	RPD Limit	Notes
---------	--------	-----------------	-------	-------------	---------------	------	-------------	-----	-----------	-------

Batch 7E17020 - EPA 5030B P/T / LUFT GCMS

Blank (7E17020-BLK1)

Prepared & Analyzed: 05/17/07

Gasoline Range Organics (C4-C12)	ND	50	ug/l							
Surrogate: 1,2-Dichloroethane-d4	2.76		"	2.50		110	60-125			
Surrogate: Dibromofluoromethane	2.71		"	2.50		108	75-120			
Surrogate: Toluene-d8	2.57		"	2.50		103	80-120			
Surrogate: 4-Bromofluorobenzene	2.37		"	2.50		95	60-135			

Laboratory Control Sample (7E17020-BS2)

Prepared & Analyzed: 05/17/07

Gasoline Range Organics (C4-C12)	421	50	ug/l	500		84	65-120			
Surrogate: 1,2-Dichloroethane-d4	2.77		"	2.50		111	60-125			
Surrogate: Dibromofluoromethane	2.70		"	2.50		108	75-120			
Surrogate: Toluene-d8	2.66		"	2.50		106	80-120			
Surrogate: 4-Bromofluorobenzene	2.65		"	2.50		106	60-135			

Laboratory Control Sample Dup (7E17020-BSD2)

Prepared & Analyzed: 05/17/07

Gasoline Range Organics (C4-C12)	411	50	ug/l	500		82	65-120	2	20	
Surrogate: 1,2-Dichloroethane-d4	2.77		"	2.50		111	60-125			
Surrogate: Dibromofluoromethane	2.74		"	2.50		110	75-120			
Surrogate: Toluene-d8	2.63		"	2.50		105	80-120			
Surrogate: 4-Bromofluorobenzene	2.67		"	2.50		107	60-135			

Stratus Environmental Inc. [Arco]
3330 Cameron Park Dr., Suite 550
Cameron Park CA, 95682

Project: ARCO #0374, Oakland, CA
Project Number: G0C21-0015
Project Manager: Jay Johnson

MQE0418
Reported:
05/25/07 16:20

Volatile Organic Compounds by EPA Method 8260B - Quality Control
TestAmerica - Morgan Hill, CA

Analyte	Result	Reporting Limit	Units	Spike Level	Source Result	%REC	%REC Limits	RPD	RPD Limit	Notes
---------	--------	-----------------	-------	-------------	---------------	------	-------------	-----	-----------	-------

Batch 7E17020 - EPA 5030B P/T / EPA 8260B

Blank (7E17020-BLK1)

Prepared & Analyzed: 05/17/07

tert-Amyl methyl ether	ND	0.50	ug/l							
Benzene	ND	0.50	"							
tert-Butyl alcohol	ND	20	"							
Di-isopropyl ether	ND	0.50	"							
1,2-Dibromoethane (EDB)	ND	0.50	"							
1,2-Dichloroethane	ND	0.50	"							
Ethanol	ND	300	"							
Ethyl tert-butyl ether	ND	0.50	"							
Ethylbenzene	ND	0.50	"							
Methyl tert-butyl ether	ND	0.50	"							
Toluene	ND	0.50	"							
Xylenes (total)	ND	0.50	"							
<i>Surrogate: Dibromofluoromethane</i>	2.71		"	2.50		108	75-120			
<i>Surrogate: 1,2-Dichloroethane-d4</i>	2.76		"	2.50		110	60-125			
<i>Surrogate: Toluene-d8</i>	2.57		"	2.50		103	80-120			
<i>Surrogate: 4-Bromofluorobenzene</i>	2.37		"	2.50		95	60-135			

Laboratory Control Sample (7E17020-BS1)

Prepared & Analyzed: 05/17/07

tert-Amyl methyl ether	11.7	0.50	ug/l	10.0		117	65-135			
Benzene	11.6	0.50	"	10.0		116	75-120			
tert-Butyl alcohol	212	20	"	200		106	60-135			
Di-isopropyl ether	10.0	0.50	"	10.0		100	70-130			
1,2-Dibromoethane (EDB)	12.7	0.50	"	10.0		127	80-135			
1,2-Dichloroethane	11.8	0.50	"	10.0		118	70-125			
Ethanol	187	300	"	200		94	15-150			
Ethyl tert-butyl ether	11.0	0.50	"	10.0		110	65-130			
Ethylbenzene	11.3	0.50	"	10.0		113	75-120			
Methyl tert-butyl ether	12.0	0.50	"	10.0		120	50-140			
Toluene	11.5	0.50	"	10.0		115	75-120			
Xylenes (total)	34.7	0.50	"	30.0		116	75-120			
<i>Surrogate: Dibromofluoromethane</i>	2.73		"	2.50		109	75-120			
<i>Surrogate: 1,2-Dichloroethane-d4</i>	2.73		"	2.50		109	60-125			
<i>Surrogate: Toluene-d8</i>	2.63		"	2.50		105	80-120			
<i>Surrogate: 4-Bromofluorobenzene</i>	2.68		"	2.50		107	60-135			

Stratus Environmental Inc. [Arco]
3330 Cameron Park Dr., Suite 550
Cameron Park CA, 95682

Project: ARCO #0374, Oakland, CA
Project Number: G0C21-0015
Project Manager: Jay Johnson

MQE0418
Reported:
05/25/07 16:20

Volatile Organic Compounds by EPA Method 8260B - Quality Control
TestAmerica - Morgan Hill, CA

Analyte	Result	Reporting Limit	Units	Spike Level	Source Result	%REC	%REC Limits	RPD	RPD Limit	Notes
---------	--------	-----------------	-------	-------------	---------------	------	-------------	-----	-----------	-------

Batch 7E17020 - EPA 5030B P/T / EPA 8260B

Matrix Spike (7E17020-MS1)	Source: MQE0416-02	Prepared: 05/17/07	Analyzed: 05/18/07							
tert-Amyl methyl ether	12.2	0.50	ug/l	10.0	0.57	116	65-135			
Benzene	12.2	0.50	"	10.0	ND	122	75-120			LM
tert-Butyl alcohol	311	20	"	200	85	113	60-135			
Di-isopropyl ether	10.8	0.50	"	10.0	ND	108	70-130			
1,2-Dibromoethane (EDB)	13.8	0.50	"	10.0	ND	138	80-135			LM
1,2-Dichloroethane	12.8	0.50	"	10.0	ND	128	70-125			LM
Ethanol	191	300	"	200	ND	96	15-150			
Ethyl tert-butyl ether	11.7	0.50	"	10.0	ND	117	65-130			
Ethylbenzene	12.0	0.50	"	10.0	ND	120	75-120			
Methyl tert-butyl ether	13.0	0.50	"	10.0	ND	130	50-140			
Toluene	12.3	0.50	"	10.0	ND	123	75-120			LM
Xylenes (total)	36.5	0.50	"	30.0	ND	122	75-120			LM
Surrogate: Dibromofluoromethane	2.84		"	2.50		114	75-120			
Surrogate: 1,2-Dichloroethane-d4	2.79		"	2.50		112	60-125			
Surrogate: Toluene-d8	2.61		"	2.50		104	80-120			
Surrogate: 4-Bromofluorobenzene	2.55		"	2.50		102	60-135			

Matrix Spike Dup (7E17020-MSD1)	Source: MQE0416-02	Prepared: 05/17/07	Analyzed: 05/18/07							
tert-Amyl methyl ether	12.2	0.50	ug/l	10.0	0.57	116	65-135	0	25	
Benzene	12.0	0.50	"	10.0	ND	120	75-120	2	20	
tert-Butyl alcohol	315	20	"	200	85	115	60-135	1	25	
Di-isopropyl ether	10.6	0.50	"	10.0	ND	106	70-130	2	25	
1,2-Dibromoethane (EDB)	13.4	0.50	"	10.0	ND	134	80-135	3	30	
1,2-Dichloroethane	12.7	0.50	"	10.0	ND	127	70-125	0.8	25	LM
Ethanol	198	300	"	200	ND	99	15-150	4	25	
Ethyl tert-butyl ether	11.6	0.50	"	10.0	ND	116	65-130	0.9	25	
Ethylbenzene	11.8	0.50	"	10.0	ND	118	75-120	2	20	
Methyl tert-butyl ether	12.7	0.50	"	10.0	ND	127	50-140	2	25	
Toluene	12.0	0.50	"	10.0	ND	120	75-120	2	25	
Xylenes (total)	36.0	0.50	"	30.0	ND	120	75-120	1	20	
Surrogate: Dibromofluoromethane	2.85		"	2.50		114	75-120			
Surrogate: 1,2-Dichloroethane-d4	2.86		"	2.50		114	60-125			
Surrogate: Toluene-d8	2.60		"	2.50		104	80-120			
Surrogate: 4-Bromofluorobenzene	2.75		"	2.50		110	60-135			

Stratus Environmental Inc. [Arco]
3330 Cameron Park Dr., Suite 550
Cameron Park CA, 95682

Project: ARCO #0374, Oakland, CA
Project Number: G0C21-0015
Project Manager: Jay Johnson

MQE0418
Reported:
05/25/07 16:20

Notes and Definitions

LM MS and/or MSD above acceptance limits. See Blank Spike(LCS).
DET Analyte DETECTED
ND Analyte NOT DETECTED at or above the reporting limit or MDL, if MDL is specified
NR Not Reported
dry Sample results reported on a dry weight basis
RPD Relative Percent Difference



bp
A BP affiliated company

Chain of Custody Record

Project Name: BP 374
 BP BU/AR Region/Enfos Segment: BP > Americas > West > Retail > CA > Alameda > 374
 State or Lead Regulatory Agency: _____
 Requested Due Date (mm/dd/yy): _____

On-site Time: <u>1700</u>	Temp: <u>80</u>
Off-site Time: <u>1800</u>	Temp: <u>60</u>
Sky Conditions: <u>clear</u>	
Meteorological Events: <u>none</u>	
Wind Speed: <u>0</u>	Direction: <u>NA</u>

Lab Name: <u>TestAmerica</u>	BP/AR Facility No.: <u>374</u>	Consultant/Contractor: <u>Stratus Environmental, Inc.</u>
Address: <u>885 Jarvis Drive</u> <u>Morgan Hill, CA 95937</u>	BP/AR Facility Address: <u>6407 Telegraph Ave., Oakland</u>	Address: <u>3330 Cameron Park Drive, Suite 550</u> <u>Cameron Park, CA 95682</u>
Lab PM: <u>Lisa Race</u>	California Global ID #: <u>T0600100106</u>	Consultant/Contractor Project No.: <u>E374-04</u>
Tele/Fax: <u>408-782-8156 408-782-6308 (fax)</u>	Enfos Project No.: <u>G0C21-0015</u>	Consultant/Contractor PM: <u>Jay Johnson</u>
BP/AR PM Contact: <u>Paul Supple</u>	Provision or RCOP (circle one) <u>Provision</u>	Tele/Fax: <u>(530) 676-6000 / (530) 676-6005</u>
Address: <u>2010 Crow Canyon Place, Suite 150</u> <u>San Ramon, CA</u>	Phase/WBS: <u>04-Monitoring</u>	Report Type & QC Level: <u>Level 1 with EDF</u>
Tele/Fax: <u>925-275-3506</u>	Sub Phase/Task: <u>03-Analytical</u>	E-mail EDD To: <u>shaves@stratusinc.net</u>
	Cost Element: <u>01-Contractor labor</u>	Invoice to: <u>Atlantic Richfield Co.</u>

Lab Bottle Order No:				Matrix			Laboratory No.	No. of Containers	Preservative					Requested Analysis					Sample Point Lat/Long and Comments *Oxy = MTBD, TAME, ETBE, DIPE, TBA
Item No.	Sample Description	Time	Date	Soil/Solid	Water/Liquid	Air			Unpreserved	F ₂ SO ₄	HNO ₃	HCl	Methanol	GRO/BTEX/Oxy*	1,2 DCA	Ethanol	EDB	DRO	
1	MW-1	1730	5-8-07	X			01	6			X	X	X	X					
2	TB 374 5807	500	1	X			02	2		X		X	X	X	X				hold
3																			
4																			
5																			
6																			
7																			
8																			
9																			
10																			

Sampler's Name: <u>Jerry Gonzalez</u>	Relinquished By / Affiliation		Date	Time	Accepted By / Affiliation		Date	Time
Sampler's Company: <u>Douglas ENR</u>	<u>[Signature]</u>		5/9/07	1315	<u>[Signature]</u>		5/9/07	1315
Shipment Date:	<u>[Signature]</u>		5/9/07	1600	<u>[Signature]</u>		5/9/07	1620
Shipment Method:	<u>Q&S Test</u>		5/9/07	2415	<u>Julie Ng.</u>		5/9	2045
Shipment Tracking No:								

Special Instructions: Please cc results to: rmiller@broadbentinc.com

Custody Seals In Place: Yes / (No) | Temp Blank: Yes / (No) | Cooler Temp on Receipt: 4.2 °F/C | Trip Blank: Yes / No | MS/MSD Sample Submitted: Yes / No

TEST AMERICA SAMPLE RECEIPT LOG

CLIENT NAME: BP (374)
 REC. BY (PRINT) JULIE NG.
 WORKORDER: MQE 0418

DATE REC'D AT LAB: 5/9/07
 TIME REC'D AT LAB: 2045
 DATE LOGGED IN: 5/12/07

For Regulatory Purposes?
 DRINKING WATER YES / NO
 WASTE WATER YES / NO

CIRCLE THE APPROPRIATE RESPONSE		LAB SAMPLE #	CLIENT ID	CONTAINER DESCRIPTION	PRESERVATIVE	pH	SAMPLE MATRIX	DATE SAMPLED	REMARKS: CONDITION (ETC.)
1. Custody Seal(s)	Present / Absent Intact / Broken*								<div style="transform: rotate(-45deg); font-size: 2em; font-weight: bold;"> Julie Ng 5/10/07 SEE COC </div>
2. Chain-of-Custody	Present / Absent*								
3. Traffic Reports or Packing List:	Present / Absent								
4. Airbill:	Airbill / Sticker Present / Absent								
5. Airbill #:	—								
6. Sample Labels:	Present / Absent								
7. Sample IDs:	Listed / Not Listed on Chain-of-Custody								
8. Sample Condition:	Intact / Broken* / Leaking*								
9. Does information on chain-of-custody, traffic reports and sample labels agree?	Yes / No*								
10. Sample received within hold time?	Yes / No*								
11. Adequate sample volume received?	Yes / No*								
12. Proper preservatives used?	Yes / No*								
13. Trip Blank / Temp Blank Received? (circle which, if yes)	Yes / No*								
14. Read Temp: <u>4.2°C</u> Corrected Temp: Is corrected temp 4 +/-2°C?	Yes / No**								

(Acceptance range for samples requiring thermal pres.)

**Exception (if any): METALS / OFF ON ICE or Problem COC

*IF CIRCLED, CONTACT PROJECT MANAGER AND ATTACH RECORD OF RESOLUTION.

APPENDIX B

GEOTRACKER UPLOAD CONFIRMATION

Electronic Submittal Information

[Main Menu](#) | [View/Add Facilities](#) | [Upload EDD](#) | [Check EDD](#)

UPLOADING A GEO_WELL FILE

Processing is complete. No errors were found!
Your file has been successfully submitted!

<u>Submittal Title:</u>	2Q07 GEO_WELL 374
<u>Facility Global ID:</u>	T0600100106
<u>Facility Name:</u>	ARCO #0374
<u>Submittal Date/Time:</u>	7/3/2007 2:36:14 PM
<u>Confirmation Number:</u>	8949065983

[Back to Main Menu](#)

Logged in as BROADBENT-C
(CONTRACTOR)

CONTACT SITE [ADMINISTRATOR](#).

Electronic Submittal Information

[Main Menu](#) | [View/Add Facilities](#) | [Upload EDD](#) | [Check EDD](#)

Your EDF file has been successfully uploaded!

Confirmation Number: 8745161771

Date/Time of Submittal: 6/22/2007 2:11:53 PM

Facility Global ID: T0600100106

Facility Name: ARCO #0374

Submittal Title: 2Q07 GW Monitoring

Submittal Type: GW Monitoring Report

Click [here](#) to view the detections report for this upload.

ARCO #0374
6407 TELEGRAPH
OAKLAND, CA 94609

Regional Board - Case #: 01-0114
SAN FRANCISCO BAY RWQCB (REGION 2)
Local Agency (lead agency) - Case #: RO0000078
ALAMEDA COUNTY LOP - (SP)

<u>CONF #</u>	<u>TITLE</u>	<u>QUARTER</u>
8745161771	2Q07 GW Monitoring	Q2 2007
<u>SUBMITTED BY</u>	<u>SUBMIT DATE</u>	<u>STATUS</u>
Broadbent & Associates, Inc.	6/22/2007	PENDING REVIEW

SAMPLE DETECTIONS REPORT

# FIELD POINTS SAMPLED	1
# FIELD POINTS WITH DETECTIONS	1
# FIELD POINTS WITH WATER SAMPLE DETECTIONS ABOVE MCL	1
SAMPLE MATRIX TYPES	WATER

METHOD QA/QC REPORT

METHODS USED	8260FA,8260TPH
TESTED FOR REQUIRED ANALYTES?	Y
LAB NOTE DATA QUALIFIERS	Y

QA/QC FOR 8021/8260 SERIES SAMPLES

TECHNICAL HOLDING TIME VIOLATIONS	0
METHOD HOLDING TIME VIOLATIONS	0
LAB BLANK DETECTIONS ABOVE REPORTING DETECTION LIMIT	0
LAB BLANK DETECTIONS	0
DO ALL BATCHES WITH THE 8021/8260 SERIES INCLUDE THE FOLLOWING?	
- LAB METHOD BLANK	Y
- MATRIX SPIKE	N
- MATRIX SPIKE DUPLICATE	N
- BLANK SPIKE	Y
- SURROGATE SPIKE	Y

WATER SAMPLES FOR 8021/8260 SERIES

MATRIX SPIKE / MATRIX SPIKE DUPLICATE(S) % RECOVERY BETWEEN 65-135%	N
MATRIX SPIKE / MATRIX SPIKE DUPLICATE(S) RPD LESS THAN 30%	Y
SURROGATE SPIKES % RECOVERY BETWEEN 85-115%	Y
BLANK SPIKE / BLANK SPIKE DUPLICATES % RECOVERY BETWEEN 70-130%	Y

SOIL SAMPLES FOR 8021/8260 SERIES

MATRIX SPIKE / MATRIX SPIKE DUPLICATE(S) % RECOVERY BETWEEN 65-135% n/a
MATRIX SPIKE / MATRIX SPIKE DUPLICATE(S) RPD LESS THAN 30% n/a
SURROGATE SPIKES % RECOVERY BETWEEN 70-125% n/a
BLANK SPIKE / BLANK SPIKE DUPLICATES % RECOVERY BETWEEN 70-130% n/a

FIELD QC SAMPLES

<u>SAMPLE</u>	<u>COLLECTED</u>	<u>DETECTIONS > REPD</u>
QCTB SAMPLES	N	0
QCEB SAMPLES	N	0
QCAB SAMPLES	N	0

Logged in as BROADBENT-C (CONTRACTOR)

CONTACT SITE ADMINISTRATOR.