



Bo 13
20-0076

June 7, 2004

Alameda County
JUN 18 2004
Environmental Health

Mr. Don Hwang
Alameda County Health Care Services Agency
1131 Harbor Bay Parkway, Suite 250
Alameda, CA 94502-6577

**Re: Second Quarter 2004 Groundwater Monitoring Report
Atlantic Richfield Company Service Station #4931
731 West MacArthur Boulevard
Oakland, California
URS Project #38486722**

Dear Mr. Hwang:

On behalf of Atlantic Richfield Company (RM), a BP affiliated company, URS Corporation (URS) is submitting the *Second Quarter 2004 Groundwater Monitoring Report* for Atlantic Richfield Company Service Station #4931, located at 731 West MacArthur Boulevard, Oakland, California.

If you have any questions regarding this submission, please call (510) 874-3280.

Sincerely,

URS CORPORATION

Scott Robinson
Project Manager

James F. Durkin, C.Hg.
Senior Geologist

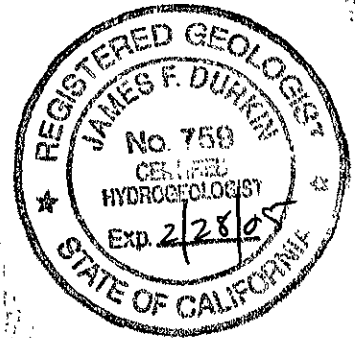

Enclosure: Second Quarter 2004 Groundwater Monitoring Report

cc: Mr. Paul Supple, RM (electronic copy uploaded to ENFOS)
Mr. Chuck Headlee, Regional Water Quality Control Board - San Francisco Bay Region, 1515
Clay Street, Suite 1400, Oakland, CA 94612



Atlantic Richfield Company
(a BP affiliated company)

P.O. Box 6549
Moraga, California 94570
Phone: (925) 299-8891
Fax: (925) 299-8872

Alameda County
JUN 18 2004
Environmental Health

June 7, 2004

RE: Second Quarter 2004 Groundwater Monitoring Report
Atlantic Richfield Company Service Station \$4931
731 West MacArthur Boulevard
Oakland, CA
URS Project #38486722

I declare that, to the best of my knowledge at the present time, the information and/or recommendations contained in the attached document are true and correct.

Submitted by:

Paul Supple
Environmental Business Manager

R E P O R T

**SECOND QUARTER 2004
GROUNDWATER MONITORING**

**ATLANTIC RICHFIELD COMPANY
SERVICE STATION #4931
731 WEST MACARTHUR BOULEVARD
OAKLAND, CALIFORNIA**

Prepared for
Atlantic Richfield Company

June 7, 2004

URS

URS Corporation
1333 Broadway, Suite 800
Oakland, California 94612

38486722



Date: June 7, 2004
Quarter: 2Q 04

ATLANTIC RICHFIELD COMPANY QUARTERLY GROUNDWATER MONITORING REPORT

Facility No.: 4931 Address: 731 West MacArthur Boulevard, Oakland, California
RM Environmental Business Manager: Paul Supple
Consulting Co./Contact Person: URS Corporation / Scott Robinson
Consultant Project No.: 38486722
Primary Agency: Alameda County Health Care Services Agency (ACHCSA)

WORK PERFORMED THIS QUARTER (Second – 2004):

1. Performed second quarter 2004 groundwater monitoring event on May 4, 2004.
2. Prepared and submitted second quarter 2004 groundwater monitoring report.
3. Oxygen Releasing Compound (ORC) socks replaced in wells A-4, A-8, A-9, and AR-1 on May 4, 2004

WORK PROPOSED FOR NEXT QUARTER (Third– 2004):

1. Perform third quarter 2004 groundwater monitoring event.
2. Prepare and submit third quarter 2004 groundwater monitoring report.
3. Work to have well A-6 uncovered.
4. Remove ORC sock from well A-9

Current Phase of Project: Remediation/Groundwater monitoring/sampling
Frequency of Groundwater Sampling: Annual (3rd Quarter): A-2, A-7, A-9, A-10, A-11, A-13
Semi-Annual (1st/3rd Quarter): A-3, A-5, A-12
Quarterly: A-4, A-6, A-8
Frequency of Groundwater Monitoring: Quarterly
Free Product (FP) Present On-Site: No
Current Remediation Techniques: Intrinsic Bioremediation Enhancement using ORC in A-4, A-8, A-9,
and AR-1
Approximate Depth to Groundwater: 6.01 (AR-2) to 10.17 (AR-1) feet
Groundwater Gradient (direction): West to North
Groundwater Gradient (magnitude): 0.025- 0.033 feet per foot

DISCUSSION:

Gasoline Range Organics (GRO) were not detected above the laboratory reporting limit in either well sampled this quarter. Laboratory reporting limits in both wells were elevated due to the presence of other contaminants of concern. Benzene was detected above the laboratory reporting limit in one wells at a concentration 490 µg/L (A-8). Methyl tert-butyl ether (MTBE) was detected above the laboratory reporting limit in both wells at concentrations of 2,300 µg/L (A-4) and 1,600 µg/L (A-8). Tert-Amyl methyl ether (TAME) was detected above the laboratory reporting limit in both wells at concentrations of 510 µg/L (A-4) to 440 µg/L (A-8). No other fuel oxygenates were detected above laboratory reporting limits. Well A-6 was inaccessible for sampling as it appears to have been paved over.

ATTACHMENTS:

- Figure 1 – Groundwater Elevation Contour and Analytical Summary Map – May 4, 2004
- Table 1 – Groundwater Elevation and Analytical Data
- Table 2 – Groundwater Flow Direction and Gradient
- Table 3 – Oxygenate Analytical Data
- Attachment A – Field Procedures and Field Data Sheets
- Attachment B – Laboratory Procedures, Certified Analytical Reports and Chain-of-Custody Records
- Attachment C – Historic Groundwater Data
- Attachment D – EDCC and EDF/Geowell Submittal Confirmation

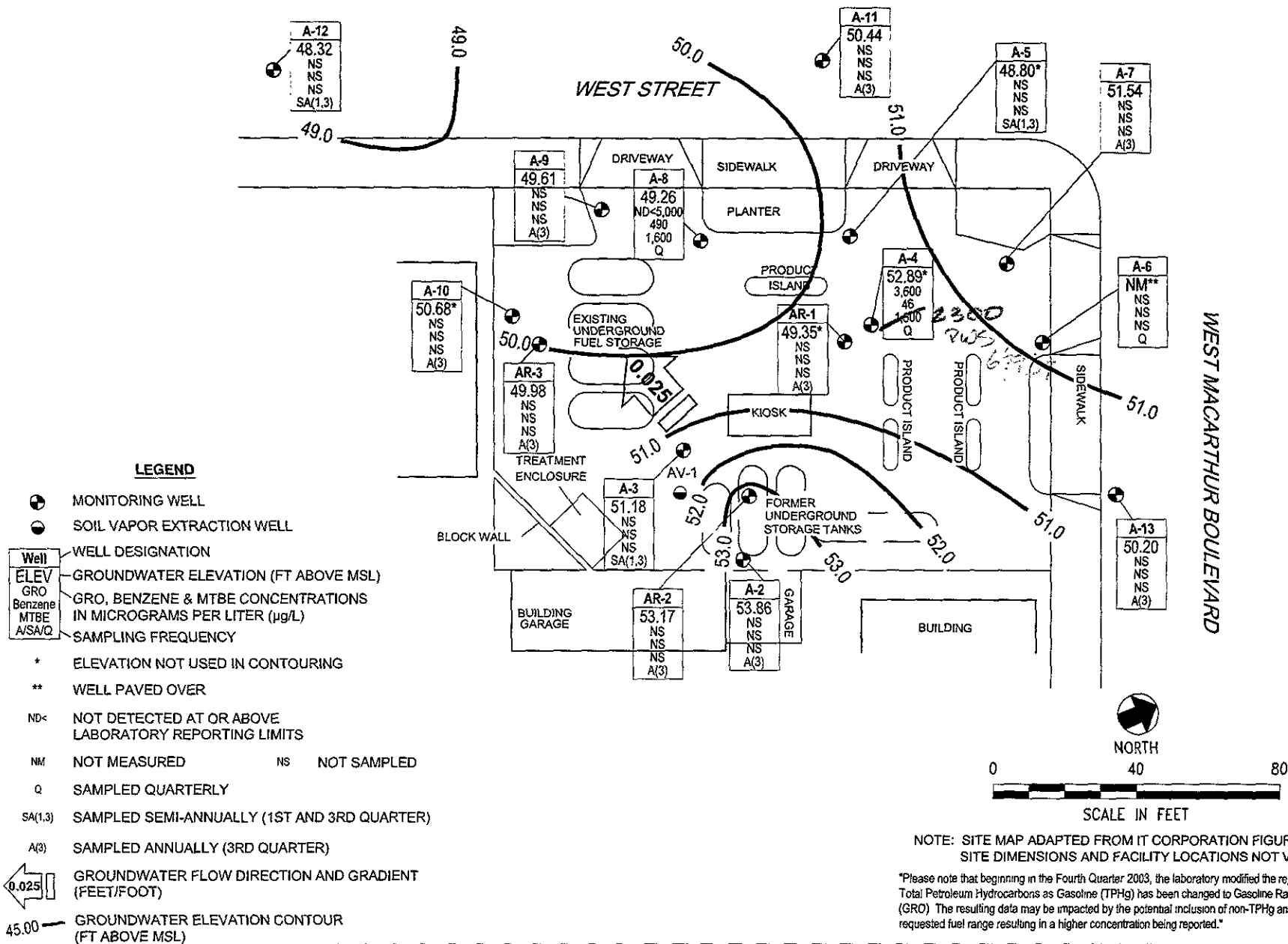

URS	Project No. 38486722	GROUNDWATER ELEVATION CONTOUR AND ANALYTICAL SUMMARY MAP Second Quarter 2004 (May 4, 2004)	FIGURE 1
	Arco Service Station #4931 731 West MacArthur Boulevard Oakland, California		

**Table 1
Groundwater Elevation and Analytical Data**

Atlantic Richfield Company
Service Station #4931
731 West MacArthur Boulevard
Oakland, California

Well Number	Date Sampled	Purged/Not Purged (P/NP)	TOC Elevation (ft)	Top of Screen (ft. BGS)	Bottom of Casing (ft. BGS)	Depth to Groundwater (ft. BGS)	Groundwater Elevation (ft)	GRO/TPH-g (µg/L)	Benzene (µg/L)	Toluene (µg/L)	Ethylbenzene (µg/L)	Total Xylenes (µg/L)	MTBE (µg/L)	DO ^e (mg/L)	pH ^e
A-2	06/21/00		55.48	5.0	19.0	6.85	48.63	ND<50	ND<0.5	ND<0.5	ND<0.5	ND<1.0	ND<3.0	NA	NA
	09/20/00					10.45	45.03	ND<50	ND<0.5	ND<0.5	ND<0.5	ND<0.5	ND<2.5	NA	NA
	12/26/00					6.27	49.21	ND<50	ND<0.5	ND<0.5	ND<0.5	ND<0.5	ND<2.5	NA	NA
	03/20/01					4.57	50.91	ND<50	ND<0.5	ND<0.5	ND<0.5	ND<0.5	ND<2.5	NA	NA
	06/12/01					9.27	46.21	ND<50	ND<0.5	ND<0.5	ND<0.5	ND<0.5	ND<2.5	NA	NA
	09/23/01					10.75	44.73	ND<50	ND<0.5	ND<0.5	ND<0.5	ND<0.5	ND<2.5	NA	NA
	12/31/01					4.13	51.35	ND<50	ND<0.5	ND<0.5	1	3.2	ND<2.5	NA	NA
	03/21/02					3.26	52.22	ND<50	ND<0.5	ND<0.5	ND<0.5	ND<0.5	ND<2.5	NA	NA
	04/17/02					3.72	51.76	ND<50	ND<0.5	ND<0.5	ND<0.5	ND<0.5	3.1	NA	NA
	08/12/02	NP				9.95	45.53	ND<10	ND<0.10	ND<0.10	ND<0.10	ND<0.10	ND<0.50	3.1	7.7
	12/06/02	NP				10.01	45.47	ND<50	ND<0.50	ND<0.50	ND<0.50	ND<0.50	6.0	3.1	6.1
	01/30/03*	NP				5.08	50.40	ND<50	ND<0.50	ND<0.50	ND<0.50	ND<0.50	ND<0.50	2.6	6.7
	05/28/03	NP				4.82	50.66	ND<50	ND<0.50	ND<0.50	ND<0.50	ND<0.50	1.1	5.7	6.8
	08/06/03	NP				9.73	45.75	ND<50	ND<0.50	ND<0.50	ND<0.50	ND<0.50	ND<0.50	2.3	7.7
	11/14/03					9.36	46.12	Sampled Annually During the 3rd Quarter							
2/2/2004 [§]		60.65			4.45	56.20	Sampled Annually During the 3rd Quarter								
05/04/04					6.79	53.86	Sampled Annually During the 3rd Quarter								
A-3	06/21/00		54.66	5.0	19.3	9.48	45.18	ND<50	ND<0.5	ND<0.5	ND<0.5	ND<1.0	46	NA	NA
	09/20/00					10.24	44.42	ND<50	ND<0.5	ND<0.5	ND<0.5	ND<0.5	89.6	NA	NA
	12/26/00					9.58	45.08	ND<50	ND<0.5	ND<0.5	ND<0.5	ND<0.5	7.11	NA	NA
	03/20/01					6.34	48.32	NS	NS	NS	NS	NS	NS	NS	NS
	06/12/01					9.76	44.90	ND<50	ND<0.5	ND<0.5	ND<0.5	ND<0.5	86	NA	NA
	09/23/01					10.55	44.11	NS	NS	NS	NS	NS	NS	NS	NS
	12/31/01					3.70	50.96	ND<50	ND<0.5	ND<0.5	ND<0.5	1	60	NA	NA
	03/21/02					5.75	48.91	NS	NS	NS	NS	NS	NS	NS	NS
	04/17/02					7.27	47.39	ND<50	ND<0.5	ND<0.5	ND<0.5	ND<0.5	45	NA	NA
	08/12/02					9.71	44.95	NS	NS	NS	NS	NS	NS	NS	NS
	12/06/02	P				9.55	45.11	ND<500	ND<5.0	ND<5.0	ND<5.0	ND<5.0	150	2.4	6.6
	01/30/03*					6.05	48.61	NS	NS	NS	NS	NS	NS	NS	NS
	08/06/03					9.91	44.75	NS	NS	NS	NS	NS	NS	NS	NS
	11/14/03					9.52	45.14	NS	NS	NS	NS	NS	NS	NS	NS
	2/2/2004 [§]	P	59.32			5.63	53.69	ND<50	ND<0.50	ND<0.50	ND<0.50	ND<0.50	13	1.2	7.1
05/04/04					8.14	51.18	Sampled Semi-annually During the 1st and 3rd Quarters								

**Table 1
Groundwater Elevation and Analytical Data**

Atlantic Richfield Company
Service Station #4931
731 West MacArthur Boulevard
Oakland, California

Well Number	Date Sampled	Purged/N of Purged (P/NP)	TOC Elevation (ft)	Top of Screen (ft. BGS)	Bottom of Casing (ft. BGS)	Depth to Groundwater (ft. BGS)	Groundwater Elevation (ft)	GRO/TPH-g (µg/L)	Benzene (µg/L)	Toluene (µg/L)	Ethyl-benzene (µg/L)	Total Xylenes (µg/L)	MTBE (µg/L)	DO ^c (mg/L)	pH ^e
A-4	06/21/00		54.73	5.0	19.6	9.49	45.24	2,100	110	2.1	11	5.9	2,000	NA	NA
	09/20/00					10.33	44.40	1,540	127	ND<5.0	9.07	7.42	1,940	NA	NA
	12/26/00					9.34	45.39	1,550	42.7	ND<5.0	11	10.9	1,210	NA	NA
	03/20/01					7.56	47.17	913	40.9	ND<5.0	15.5	14.6	ND<25	NA	NA
	06/12/01					9.83	44.90	2,000	230	ND<20	21	ND<20	4,700	NA	NA
	09/23/01					10.54	44.19	1,600	35	ND<10	ND<10	ND<10	3,000	NA	NA
	12/31/01					5.42	49.31	ND<500	ND<5.0	ND<5.0	ND<5.0	ND<5.0	880	NA	NA
	03/21/02					6.18	48.55	ND<5,000	ND<50	ND<50	ND<50	ND<50	1,400	NA	NA
	04/17/02					7.34	47.39	1,300	79	31	17	55	2,200	NA	NA
	08/12/02	P				9.56	45.17	2,400 ^a	120	ND<5.0	ND<5.0	ND<5.0	2,100	2.0	7.2
	12/06/02	P				10.02	44.71	2,200	110	10	42	56	2,000	NA	6.7
	01/30/03*	P				7.55	47.18	6,000	180	ND<50	85	ND<50	2,100	1.8	6.8
	05/28/03	P				8.94	45.79	6,000	120	ND<50	ND<50	ND<50	2,500	1.5	6.7
	08/06/03	P				10.03	44.70	5,800	100	ND<25	ND<25	33	2,500	1.5	6.7
	11/14/03 ^f	P			SHEEN	10.37	44.36	1,000	17	ND<5.0	ND<5.0	ND<5.0	310	1.6	6.8
02/02/04 ^g	P		59.59		6.70	52.89	3,600	46	ND<25	ND<25	ND<25	1,500	1.0	7.1	
05/04/04 ^f	P				9.12	50.47	ND<5,000	ND<50	ND<50	ND<50	ND<50	2,300	6.4	6.8	
A-5	06/21/00		54.17	3.0	24.0	9.29	44.88	980	ND<0.5	ND<0.5	ND<0.5	ND<1.0	2,000	NA	NA
	09/20/00					10.23	43.94	NS	NS	NS	NS	NS	NS	NS	NS
	12/26/00					9.65	44.52	525	ND<0.5	ND<0.5	ND<0.5	ND<0.5	1,200	NA	NA
	03/20/01					8.05	46.12	NS	NS	NS	NS	NS	NS	NS	NS
	06/12/01					9.81	44.36	830	ND<5.0	ND<5.0	ND<5.0	ND<5.0	3,200	NA	NA
	09/23/01					10.42	43.75	NS	NS	NS	NS	NS	NS	NS	NS
	12/31/01					6.03	48.14	320	ND<0.5	ND<0.5	ND<0.5	ND<0.5	60	NA	NA
	03/21/02					6.71	47.46	NS	NS	NS	NS	NS	NS	NS	NS
	04/17/02					8.01	46.16	1,600	ND<10	ND<10	ND<10	ND<10	3,200	NA	NA
	08/12/02					9.87	44.30	NS	NS	NS	NS	NS	NS	NS	NS
	12/06/02	P				9.66	44.51	310	ND<0.50	ND<0.50	ND<0.50	ND<0.50	330	1.9	6.6
	01/30/03*	P				7.67	46.50	NS	NS	NS	NS	NS	NS	NS	NS
	05/28/03	P				8.56	45.61	ND<5,000	ND<50	ND<50	ND<50	ND<50	1,500	1.6	6.6
	08/06/03					9.58	44.59	NS	NS	NS	NS	NS	NS	NS	NS
	11/14/03	P				9.81	44.36	Sampled Semi-annually During the 1st and 3rd Quarters							
02/02/04 ^g	P		58.78		7.43	51.35	390	ND<2.5	9.2	ND<2.5	2.6	140	1.0	6.8	
05/04/04					9.98	48.80	Sampled Semi-annually During the 1st and 3rd Quarters								

**Table 1
Groundwater Elevation and Analytical Data**

Atlantic Richfield Company
Service Station #4931
731 West Macarthur Boulevard
Oakland, California

Well Number	Date Sampled	Purged/Not Purged (P/NP)	TOC Elevation (ft)	Top of Screen (ft. BGS)	Bottom of Casing (ft. BGS)	Depth to Groundwater (ft. BGS)	Groundwater Elevation (ft)	GRO/TPH-g (µg/L)	Benzene (µg/L)	Toluene (µg/L)	Ethylbenzene (µg/L)	Total Xylenes (µg/L)	MTBE (µg/L)	DO ^c (mg/L)	pH ^c
A-6	06/21/00		55.17	2.0	25.0	8.67	46.50	ND<50	ND<0.5	ND<0.5	ND<0.5	ND<1.0	ND<3.0	NA	NA
	09/20/00					9.34	45.83	ND<50	ND<0.5	ND<0.5	ND<0.5	ND<0.5	ND<2.5	NA	NA
	12/26/00					8.65	46.52	ND<50	ND<0.5	ND<0.5	ND<0.5	ND<0.5	ND<2.5	NA	NA
	03/20/01					6.84	48.33	ND<50	ND<0.5	ND<0.5	ND<0.5	ND<0.5	ND<2.5	NA	NA
	06/12/01					8.93	46.24	ND<50	ND<0.5	ND<0.5	ND<0.5	ND<0.5	7	NA	NA
	09/23/01					9.74	45.43	ND<50	ND<0.5	ND<0.5	ND<0.5	ND<0.5	ND<2.5	NA	NA
	12/31/01					4.81	50.36	ND<50	ND<0.5	ND<0.5	ND<0.5	ND<0.5	3.2	NA	NA
	03/21/02					5.44	49.73	ND<50	ND<0.5	ND<0.5	ND<0.5	ND<0.5	ND<2.5	NA	NA
	04/17/02					6.95	48.22	ND<50	ND<0.5	ND<0.5	ND<0.5	ND<0.5	3.1	NA	NA
	08/12/02	NP				8.90	46.27	ND<50	ND<0.5	ND<0.5	ND<0.5	ND<0.5	ND<2.5	4.3	7.9
	12/06/02					Unable to Sample, Well Paved Over									
	01/30/03*					Unable to Sample, Well Paved Over									
	05/28/03					Unable to Sample, Well Paved Over									
	08/06/03					Unable to Sample, Well Paved Over									
	11/14/03					Unable to Sample, Well Paved Over									
	02/02/04 ^e					Unable to Sample, Well Paved Over									
	05/04/04					Unable to Sample, Well Paved Over									
A-7	06/21/00		54.71	4.8	22.6	8.58	46.13	ND<50	ND<0.5	ND<0.5	ND<0.5	ND<1.0	ND<3.0	NA	NA
	09/20/00					9.19	45.52	NS	NS	NS	NS	NS	NS	NS	NS
	12/26/00					8.50	46.21	NS	NS	NS	NS	NS	NS	NS	NS
	03/20/01					6.75	47.96	NS	NS	NS	NS	NS	NS	NS	NS
	06/12/01					8.80	45.91	ND<50	ND<0.5	ND<0.5	ND<0.5	ND<0.5	ND<2.5	NA	NA
	09/23/01					9.59	45.12	NS	NS	NS	NS	NS	NS	NS	NS
	12/31/01					4.78	49.93	NS	NS	NS	NS	NS	NS	NS	NS
	03/21/02					5.35	49.36	NS	NS	NS	NS	NS	NS	NS	NS
	04/17/02					6.88	47.83	ND<50	ND<0.5	ND<0.5	ND<0.5	ND<0.5	2.5	NA	NA
	08/12/02					8.77	45.94	NS	NS	NS	NS	NS	NS	NS	NS
	12/06/02					9.07	45.64	NS	NS	NS	NS	NS	NS	NS	NS
	01/30/03*					6.65	48.06	NS	NS	NS	NS	NS	NS	NS	NS
	05/28/03	P				7.63	47.08	ND<50	ND<0.50	ND<0.50	ND<0.50	ND<0.50	3.8	2.3	6.7
	08/06/03					8.90	45.81	Sampled Annually During the 3rd Quarter							
11/14/03					9.08	45.63	Sampled Annually During the 3rd Quarter								
02/02/04 ^e			59.75		5.96	53.79	Sampled Annually During the 3rd Quarter								
05/04/04					8.21	51.54	Sampled Annually During the 3rd Quarter								

**Table 1
Groundwater Elevation and Analytical Data**

Atlantic Richfield Company
Service Station #4931
731 West MacArthur Boulevard
Oakland, California

Well Number	Date Sampled	Purged/Not Purged (P/NP)	TOC Elevation (ft)	Top of Screen (ft. BGS)	Bottom of Casing (ft. BGS)	Depth to Groundwater (ft. BGS)	Groundwater Elevation (ft)	GRO/TPH-g (µg/L)	Benzene (µg/L)	Toluene (µg/L)	Ethylbenzene (µg/L)	Total Xylenes (µg/L)	MTBE (µg/L)	DO ^c (mg/L)	pH ^e
A-8	06/21/00		53.77	2.0	20.0	9.07	44.70	810	ND<0.5	ND<0.5	ND<0.5	810	1,500	NA	NA
	09/20/00					9.72	44.05	10,800	2,680	46	439	370	4,410	NA	NA
	12/26/00					9.20	44.57	7,700	1,440	ND<50	202	106	2,230	NA	NA
	03/20/01					7.51	46.26	ND<5,000	1,280	ND<50	53.9	ND<50	2,880	NA	NA
	06/12/01					9.53	44.24	5,600	1,700	ND<50	61	54	2,900	NA	NA
	09/23/01					10.08	43.69	10,000	3,500	ND<50	110	64	6,500	NA	NA
	12/31/01					4.34	49.43	4,300	610	ND<10	60	24	520	NA	NA
	03/21/02					6.67	47.10	6,600	1400	ND<50	130	ND<50	2,700	NA	NA
	04/17/02					7.72	46.05	3,800	540	ND<10	ND<10	12	3,100	NA	NA
	08/12/02	NP				9.64	44.13	9,400	1,800	ND<20	35	28	4,200	1.0	6.7
	12/06/02	NP				9.62	44.15	5,300	1,100	11	11	ND<10	2,200 ^b	1.4	6.7
	01/30/03*	NP				7.49	46.28	ND<10,000	1,100	ND<100	ND<100	ND<100	2,200	1.5	6.9
	05/28/03	NP				9.17	44.60	7,700	1,700	ND<50	ND<50	ND<50	2,100	1.0	6.8
	08/06/03	NP				9.67	44.10	13,000	2,400	ND<50	ND<50	ND<50	3,000	0.9	6.5
	11/14/03 ^f	NP				9.80	43.97	3,100	570	ND<5.0	ND<5.0	ND<5.0	850	2.3	6.2
02/02/04 ^g	NP	58.70			7.10	51.60	3,900	300	ND<25	ND<25	ND<25	1,100	1.1	6.8	
05/04/04	NP				9.44	49.26	ND<5,000	490	ND<50	ND<50	ND<50	1,600	1.0	6.9	
A-9	06/21/00		53.04	5.0	38.0	8.56	44.48	ND<50	ND<0.5	ND<0.5	ND<0.5	ND<1.0	5.0	NA	NA
	09/20/00					9.05	43.99	ND<50	ND<0.5	ND<0.5	ND<0.5	ND<0.5	ND<2.5	NA	NA
	12/26/00					8.49	44.55	ND<50	ND<0.5	ND<0.5	ND<0.5	ND<0.5	ND<2.5	NA	NA
	03/20/01					6.95	46.09	ND<50	ND<0.5	ND<0.5	ND<0.5	ND<0.5	ND<2.5	NA	NA
	06/12/01					8.67	44.37	ND<50	ND<0.5	ND<0.5	ND<0.5	ND<0.5	4.8	NA	NA
	09/23/01					9.21	43.83	ND<50	ND<0.5	ND<0.5	ND<0.5	ND<0.5	ND<2.5	NA	NA
	12/31/01					4.57	48.47	ND<50	ND<0.5	ND<0.5	ND<0.5	ND<0.5	ND<2.5	NA	NA
	03/21/02					5.60	47.44	ND<50	ND<0.5	ND<0.5	ND<0.5	ND<0.5	ND<2.5	NA	NA
	04/17/02					6.89	46.15	ND<50	ND<0.5	ND<0.5	ND<0.5	ND<0.5	ND<2.5	NA	NA
	08/12/02	P				8.71	44.33	ND<50	ND<0.50	ND<0.50	ND<0.50	ND<0.50	ND<2.5	4.0	7.6
	12/06/02	P				8.77	44.27	ND<50	ND<0.50	ND<0.50	ND<0.50	ND<0.50	ND<2.0	1.1	6.7
	01/30/03*	P				6.88	46.16	ND<50	ND<0.50	ND<0.50	ND<0.50	ND<0.50	1.1	0.9	6.8
	05/28/03	P				9.75	43.29	ND<50	ND<0.50	ND<0.50	ND<0.50	ND<0.50	0.74	1.9	6.8
	08/06/03	P				9.00	44.04	ND<50	ND<0.50	ND<0.50	ND<0.50	ND<0.50	1.8	2.2	6.7
	11/14/03 ^f					8.82	44.22	Sampled Annually During the 3rd Quarter							
02/02/04 ^g		57.73			7.10	50.63	Sampled Annually During the 3rd Quarter								
05/04/04 ^h					8.12	49.61	Sampled Annually During the 3rd Quarter								

**Table 1
Groundwater Elevation and Analytical Data**

Atlantic Richfield Company
Service Station #4931
731 West Macarthur Boulevard
Oakland, California

Well Number	Date Sampled	Purged/Not Purged (P/NP)	TOC Elevation (ft)	Top of Screen (ft. BGS)	Bottom of Casing (ft. BGS)	Depth to Groundwater (ft. BGS)	Groundwater Elevation (ft)	GRO/TPH-g (µg/L)	Benzene (µg/L)	Toluene (µg/L)	Ethylbenzene (µg/L)	Total Xylenes (µg/L)	MTBE (µg/L)	DO ^e (mg/L)	pH ^f
A-10	06/21/00		54.26	NA	NA	10.47	43.79	NS	NS	NS	NS	NS	NS	NS	NS
	09/20/00					10.76	43.50	NS	NS	NS	NS	NS	NS	NS	NS
	12/26/00					NM	NC	NS	NS	NS	NS	NS	NS	NS	NS
	03/20/01					NM	NC	NS	NS	NS	NS	NS	NS	NS	NS
	09/23/01					NM	NC	NS	NS	NS	NS	NS	NS	NS	NS
	12/31/01					NM	NC	NS	NS	NS	NS	NS	NS	NS	NS
	03/21/02					NM	NC	NS	NS	NS	NS	NS	NS	NS	NS
	04/17/02					NM	NC	NS	NS	NS	NS	NS	NS	NS	NS
	08/12/02					NM	NC	NS	NS	NS	NS	NS	NS	NS	NS
	12/06/02					NM	NC	NS	NS	NS	NS	NS	NS	NS	NS
	01/30/03*					NM	NC	NS	NS	NS	NS	NS	NS	NS	NS
	05/28/03					NM	NC	NS	NS	NS	NS	NS	NS	NS	NS
	08/06/03					NM	NC	NS	NS	NS	NS	NS	NS	NS	NS
	11/14/03					10.37	43.89	Sampled Annually During the 3rd Quarter							
02/02/04 ^g			59.37		7.97	51.40	Sampled Annually During the 3rd Quarter								
05/04/04					8.69	50.68	Sampled Annually During the 3rd Quarter								
A-11	06/21/00		53.74	5.0	28.0	9.54	44.20	ND<50	ND<0.5	ND<0.5	ND<0.5	ND<1.0	4.0	NA	NA
	09/20/00					10.62	43.12	NS	NS	NS	NS	NS	NS	NS	NS
	12/26/00					10.03	43.71	ND<50	ND<0.5	ND<0.5	ND<0.5	ND<0.5	ND<2.5	NA	NA
	03/20/01					8.49	45.25	NS	NS	NS	NS	NS	NS	NS	NS
	06/12/01					10.21	43.53	ND<50	ND<0.5	ND<0.5	ND<0.5	ND<0.5	ND<2.5	NA	NA
	09/23/01					10.77	42.97	NS	NS	NS	NS	NS	NS	NS	NS
	12/31/01					6.06	47.68	ND<50	ND<0.5	ND<0.5	ND<0.5	ND<0.5	ND<2.5	NA	NA
	03/21/02					7.14	46.60	NS	NS	NS	NS	NS	NS	NS	NS
	04/17/02					8.41	45.33	ND<50	ND<0.5	ND<0.5	ND<0.5	ND<0.5	ND<2.5	NA	NA
	08/12/02					10.25	43.49	NS	NS	NS	NS	NS	NS	NS	NS
	12/06/02	P				10.43	43.31	ND<50	ND<0.50	ND<0.50	ND<0.50	ND<0.50	ND<2.0	2.4	6.7
	01/30/03*					8.42	45.32	NS	NS	NS	NS	NS	NS	NS	NS
	05/28/03	P				9.30	44.44	ND<50	ND<0.50	ND<0.50	ND<0.50	ND<0.50	0.53	1.8	7.0
	08/06/03					10.28	43.46	NS	NS	NS	NS	NS	NS	NS	NS
11/14/03					10.40	43.34	Sampled Annually During the 3rd Quarter								
02/02/04 ^g			59.16		7.95	51.21	Sampled Annually During the 3rd Quarter								
05/04/04					8.72	50.44	Sampled Annually During the 3rd Quarter								

**Table 1
Groundwater Elevation and Analytical Data**

Atlantic Richfield Company
Service Station #4931
731 West MacArthur Boulevard
Oakland, California

Well Number	Date Sampled	Purged/N of Purged (P/NP)	TOC Elevation (ft)	Top of Screen (ft. BGS)	Bottom of Casing (ft. BGS)	Depth to Groundwater (ft. BGS)	Groundwater Elevation (ft)	GRO/TPH-g (µg/L)	Benzene (µg/L)	Toluene (µg/L)	Ethyl-benzene (µg/L)	Total Xylenes (µg/L)	MTBE (µg/L)	DO ^c (mg/L)	pH ^e
A-12	06/21/00		52.05	5.0	30.0	9.28	42.77	ND<50	ND<0.5	ND<0.5	ND<0.5	ND<1.0	18	NA	NA
	09/20/00					9.55	42.50	NS	NS	NS	NS	NS	NS	NS	NS
	12/26/00					9.05	43.00	ND< 50	ND< 0.5	ND< 0.5	ND< 0.5	ND<0.5	17.3	NA	NA
	03/20/01					7.92	44.13	NS	NS	NS	NS	NS	NS	NS	NS
	06/12/01					9.26	42.79	ND< 50	ND< 0.5	ND< 0.5	ND< 0.5	ND<0.5	25	NA	NA
	09/23/01					9.68	42.37	NS	NS	NS	NS	NS	NS	NS	NS
	12/31/01					5.74	46.31	ND< 50	ND< 0.5	ND< 0.5	ND< 0.5	ND<0.5	9.5	NA	NA
	03/21/02					6.64	45.41	NS	NS	NS	NS	NS	NS	NS	NS
	04/17/02					7.68	44.37	ND<50	ND<0.5	ND<0.5	ND<0.5	ND<0.5	29	NA	NA
	08/12/02					9.30	42.75	NS	NS	NS	NS	NS	NS	NS	NS
	12/06/02 ^c	P				9.38	42.67	ND<50	ND<0.50	ND<0.50	ND<0.50	ND<0.50	13	2.3	6.5
	01/30/03*					7.87	44.18	NS	NS	NS	NS	NS	NS	NS	NS
	05/28/03	P				8.51	43.54	50	ND<0.50	ND<0.50	ND<0.50	ND<0.50	10	1.4	7.0
	08/06/03					9.28	42.77	NS	NS	NS	NS	NS	NS	NS	NS
	11/14/03					9.37	42.68	Sampled Semi-annually During the 1st and 3rd Quarters							
	02/02/04 ^e			57.06		7.90	49.16	ND<50	ND<0.50	ND<0.50	ND<0.50	ND<0.50	0.91	1.0	6.9
05/04/04					8.74	48.32	Sampled Semi-annually During the 1st and 3rd Quarters								
A-13	06/21/00		55.11	10.0	29.5	NM	NC	NS	NS	NS	NS	NS	NS	NS	NS
	09/20/00					NM	NC	NS	NS	NS	NS	NS	NS	NS	NS
	12/26/00					NM	NC	NS	NS	NS	NS	NS	NS	NS	NS
	03/20/01					NM	NC	NS	NS	NS	NS	NS	NS	NS	NS
	06/12/01					NM	NC	NS	NS	NS	NS	NS	NS	NS	NS
	09/23/01					NM	NC	NS	NS	NS	NS	NS	NS	NS	NS
	12/31/01					NM	NC	NS	NS	NS	NS	NS	NS	NS	NS
	03/21/02					6.70	48.41	NS	NS	NS	NS	NS	NS	NS	NS
	04/17/02					7.95	47.16	ND<50	ND<0.5	ND<0.5	ND<0.5	ND<0.5	ND<2.5	NA	NA
	08/12/02					10.11	45.00	NS	NS	NS	NS	NS	NS	NS	NS
	12/06/02					10.26	44.85	NS	NS	NS	NS	NS	NS	NS	NS
	01/30/03*					7.81	47.30	NS	NS	NS	NS	NS	NS	NS	NS
	05/28/03	P				9.06	46.05	ND<50	ND<0.50	ND<0.50	ND<0.50	ND<0.50	ND<0.50	1.9	6.5
	08/06/03					10.22	44.89	NS	NS	NS	NS	NS	NS	NS	NS
	11/14/03					10.27	44.84	Sampled Annually During the 3rd Quarter							
	02/02/04 ^e			60.26		7.92	52.34	Sampled Annually During the 3rd Quarter							
05/04/04					10.06	50.20	Sampled Annually During the 3rd Quarter								

**Table 1
Groundwater Elevation and Analytical Data**

Atlantic Richfield Company
Service Station #4931
731 West Macarthur Boulevard
Oakland, California

Well Number	Date Sampled	Purged/Not Purged (P/NP)	TOC Elevation (ft)	Top of Screen (ft. BGS)	Bottom of Casing (ft. BGS)	Depth to Groundwater (ft. BGS)	Groundwater Elevation (ft)	GRO/TPH-g (µg/L)	Benzene (µg/L)	Toluene (µg/L)	Ethyl-benzene (µg/L)	Total Xylenes (µg/L)	MTBE (µg/L)	DO ^e (mg/L)	pH ^f
AR-1	06/21/00		54.72	10.0	31.5	NM	NC	NS	NS	NS	NS	NS	NS	NS	NS
	09/20/00					NM	NC	NS	NS	NS	NS	NS	NS	NS	NS
	12/26/00					9.95	44.77	NS	NS	NS	NS	NS	NS	NS	NS
	03/20/01					8.34	46.38	NS	NS	NS	NS	NS	NS	NS	NS
	06/12/01					10.17	44.55	NS	NS	NS	NS	NS	NS	NS	NS
	09/23/01					10.72	44.00	NS	NS	NS	NS	NS	NS	NS	NS
	12/31/01					5.91	48.81	NS	NS	NS	NS	NS	NS	NS	NS
	03/21/02					7.00	47.72	NS	NS	NS	NS	NS	NS	NS	NS
	04/17/02					8.33	46.39	NS	NS	NS	NS	NS	NS	NS	NS
	08/12/02					10.18	44.54	NS	NS	NS	NS	NS	NS	NS	NS
	12/06/02					10.21	44.51	NS	NS	NS	NS	NS	NS	NS	NS
	01/30/03*					8.22	46.50	NS	NS	NS	NS	NS	NS	NS	NS
	05/28/03					9.62	45.10	NS	NS	NS	NS	NS	NS	NS	NS
	08/06/03					10.47	44.25	NS	NS	NS	NS	NS	NS	NS	NS
	11/14/03 ^f					10.40	44.32	NS	NS	NS	NS	NS	NS	NS	NS
02/02/04 ^{g, s}		59.52			7.96	51.56	NS	NS	NS	NS	NS	NS	NS	NS	
05/04/04 ^f					10.17	49.35	NS	NS	NS	NS	NS	NS	NS	NS	
AR-2	06/21/00		54.77	10.0	21.5	NM	NC	NS	NS	NS	NS	NS	NS	NS	NS
	09/20/00					NM	NC	NS	NS	NS	NS	NS	NS	NS	NS
	12/26/00					NM	NC	NS	NS	NS	NS	NS	NS	NS	NS
	03/20/01					3.13	51.64	NS	NS	NS	NS	NS	NS	NS	NS
	06/12/01					4.51	50.26	NS	NS	NS	NS	NS	NS	NS	NS
	09/23/01					6.05	48.72	NS	NS	NS	NS	NS	NS	NS	NS
	12/31/01					2.79	51.98	NS	NS	NS	NS	NS	NS	NS	NS
	03/21/02					7.75	47.02	NS	NS	NS	NS	NS	NS	NS	NS
	04/17/02					2.24	52.53	NS	NS	NS	NS	NS	NS	NS	NS
	08/12/02					4.93	49.84	NS	NS	NS	NS	NS	NS	NS	NS
	12/06/02					6.09	48.68	NS	NS	NS	NS	NS	NS	NS	NS
	01/30/03*					3.89	50.88	NS	NS	NS	NS	NS	NS	NS	NS
	05/28/03					3.33	51.44	NS	NS	NS	NS	NS	NS	NS	NS
	08/06/03					5.05	49.72	NS	NS	NS	NS	NS	NS	NS	NS
	11/14/03					6.01	48.76	NS	NS	NS	NS	NS	NS	NS	NS
02/02/04 ^s		59.18			3.88	55.30	NS	NS	NS	NS	NS	NS	NS	NS	
05/04/04					6.01	53.17	NS	NS	NS	NS	NS	NS	NS	NS	

**Table 1
Groundwater Elevation and Analytical Data**

Atlantic Richfield Company
Service Station #4931
731 West Macarthur Boulevard
Oakland, California

Well Number	Date Sampled	Purged/N of Purged (P/NP)	TOC Elevation (ft)	Top of Screen (ft. BGS)	Bottom of Casing (ft. BGS)	Depth to Groundwater (ft. BGS)	Groundwater Elevation (ft)	GRO/TPH-g (µg/L)	Benzene (µg/L)	Toluene (µg/L)	Ethyl-benzene (µg/L)	Total Xylenes (µg/L)	MTBE (µg/L)	DO ^f (mg/L)	pH ^e
AR-3	06/21/00		54.19	10.0	27.0	NM	NC	NS	NS	NS	NS	NS	NS	NS	NS
	09/20/00					NM	NC	NS	NS	NS	NS	NS	NS	NS	NS
	12/26/00					9.70	44.49	NS	NS	NS	NS	NS	NS	NS	NS
	03/20/01					NM	NC	NS	NS	NS	NS	NS	NS	NS	NS
	06/12/01					NM	NC	NS	NS	NS	NS	NS	NS	NS	NS
	09/23/01					10.43	43.76	NS	NS	NS	NS	NS	NS	NS	NS
	12/31/01					5.18	49.01	NS	NS	NS	NS	NS	NS	NS	NS
	03/21/02					6.78	47.41	NS	NS	NS	NS	NS	NS	NS	NS
	04/17/02					8.06	46.13	NS	NS	NS	NS	NS	NS	NS	NS
	08/12/02					9.94	44.25	NS	NS	NS	NS	NS	NS	NS	NS
	12/06/02					9.99	44.20	NS	NS	NS	NS	NS	NS	NS	NS
	01/30/03*					7.96	46.23	NS	NS	NS	NS	NS	NS	NS	NS
	05/28/03					8.94	45.25	NS	NS	NS	NS	NS	NS	NS	NS
	08/06/03					9.94	44.25	NS	NS	NS	NS	NS	NS	NS	NS
	11/14/03					10.03	44.16	NS	NS	NS	NS	NS	NS	NS	NS
02/02/04 ^g			59.10			6.90	52.20	NS	NS	NS	NS	NS	NS	NS	
05/04/04						9.12	49.98	NS	NS	NS	NS	NS	NS	NS	

Table 1
Groundwater Elevation and Analytical Data

Atlantic Richfield Company
Service Station #4931
731 West Macarthur Boulevard
Oakland, California

Note: Please note that beginning in the Fourth Quarter 2003, the laboratory modified the reported analyte list. Total Petroleum Hydrocarbons as Gasoline (TPH-g) has been changed to Gasoline Range Organics (GRO). The resulting data may be impacted by the potential inclusion of non-TPHg analytes within the requested fuel range resulting in a higher concentration being reported. Beginning in the Second Quarter 2004, the carbon range for GRO was changed from C6- C10 to C4- C12.

Samples taken 12/06/02 analyzed using DHS LUFT

BGS = Below ground surface
DO = Dissolved oxygen
ft = feet
GRO = Gasoline range organics (C4 - C12)
mg/L = Milligrams per liter
MTBE = Methyl tertiary butyl ether analyzed by EPA Method 8021B unless otherwise noted (before 1/30/03)
NA = Not available
NC = Not calculated
ND< = Not detected at or above the specified laboratory reporting limit
NM = Not measured
NP = Not purged
NS = Not sampled
P = Purge
TOC = Top of casing
TPH-g = Total petroleum hydrocarbons as gasoline analyzed using EPA Method 8015B modified (before 1/30/03)
µg/L = Micrograms per liter

a = Hydrocarbon pattern is present in the requested fuel quantitation range but does not resemble the pattern of the requested fuel.
b = The concentration indicated for this analyte is an estimated value above the calibration range of the instrument.
c = This sample was analyzed beyond the EPA recommended holding time. The results may still be useful for their intended purpose.
d = The result was reported with a possible high bias due to the continuing calibration verification falling outside acceptance criteria.
e = DO and pH are field measurements
f = ORC sock in well
g = Well surveyed to NAVD '88 datum on January 28, 2004
* = Beginning in the Fourth Quarter 2003, groundwater samples were analyzed by EPA method 8260B for TPH-g, BTEX, and fuel oxygenates.

Source: The data within this table collected prior to August 2002 was provided to URS by Atlantic Richfield Company and their previous consultants. URS has not verified the accuracy of this information.

**Table 2
Groundwater Flow Direction and Gradient**

Atlantic Richfield Company
Service Station #4931
731 West Macarthur Boulevard
Oakland, California

Date Measured	Average Flow Direction	Average Hydraulic Gradient (feet per foot)
06/21/00	West-Southwest	0.031
09/20/00	Southwest	0.013
12/26/00	West	0.028
03/20/01	West	0.046
06/12/01	West	0.014
09/23/01	West	0.012
12/31/01	West	0.024
03/21/02	West	0.047
04/17/02	West	0.03
08/12/02	West	0.016
12/06/02	West	0.015
01/30/03	West	Variable
05/28/03	Westward	0.022 ^a
08/06/03	West-Southwest	0.018
11/14/03	West	0.02
02/02/04	West	0.04
05/04/04	West to North	0.025 to 0.033

a = using wells AR-1 and A-9

Source: The data within this table collected prior to August 2002 was provided to URS by Atlantic Richfield Company and their previous consultants. URS has not verified the accuracy of this information.

**Table 3
Fuel Oxygenate Analytical Data**

Atlantic Richfield Company Service Station #4931
731 West MacArthur Boulevard
Oakland, California

Well Number	Date Sampled	Ethanol (µg/L)	TBA (µg/L)	MTBE (µg/L)	DIPE (µg/L)	ETBE (µg/L)	TAME (µg/L)	1,2-DCA (µg/L)	EDB (µg/L)
A-2	01/30/03	ND<40	ND<20 ^a	ND<0.50	ND<0.50	ND<0.50	ND<0.50	NA	NA
	05/28/03	ND<100	ND<20	1.1	ND<0.50	ND<0.50	ND<0.50	NA	NA
	08/06/03	ND<100	ND<20	ND<0.50	ND<0.50	ND<0.50	ND<0.50	ND<0.50	ND<0.50
A-3	05/28/03	ND<100	ND<20	43	ND<0.50	ND<0.50	24	NA	NA
	02/02/04	ND<100	ND<20	13	ND<0.50	ND<0.50	4.6	ND<0.50	ND<0.50
A-4	01/30/03	ND<4,000	ND<2,000 ^a	2,100	ND<50	ND<50	530	NA	NA
	05/28/03	ND<10,000	ND<2,000	2,500	ND<50	ND<50	590	NA	NA
	08/06/03	ND<5,000	ND<1,000	2,500	ND<25	ND<25	560	ND<25	ND<25
	11/14/03	ND<1,000	320	310	ND<5.0	ND<5.0	76	NA	NA
	02/02/04	ND<5,000	ND<1,000	1,500	ND<25	ND<25	350	ND<25	ND<25
	05/04/04	ND<10,000	ND<2,000	2,300	ND<50	ND<50	510	ND<50	ND<50
A-5	05/28/03	ND<10,000	ND<2,000	1,500	ND<50	ND<50	620	NA	NA
	02/02/04	ND<500	170	140	ND<2.5	ND<2.5	54	ND<2.5	ND<2.5
A-7	05/28/03	ND<100	ND<20	3.8	ND<0.50	ND<0.50	0.94	NA	NA
A-8	01/30/03	ND<8,000	ND<4,000 ^a	2,200	ND<100	ND<100	900	NA	NA
	05/28/03	ND<10,000	ND<2,000	2,100	ND<50	ND<50	1,100	NA	NA
	08/06/03	ND<10,000	ND<2,000	3,000	ND<50	ND<50	1,200	ND<50	ND<50
	11/14/03	ND<1,000	ND<200	850	ND<5.0	ND<5.0	320	NA	NA
	02/02/04	ND<5,000	ND<1,000	1,100	ND<25	ND<25	380	ND<25	ND<25
	05/04/04	ND<10,000	ND<2,000	1,600	ND<50	ND<50	440	ND<50	ND<50
A-9	01/30/03	ND<40	ND<20	1.1	ND<0.50	ND<0.50	ND<0.50	NA	NA
	05/28/03	ND<100	ND<20	0.74	ND<0.50	ND<0.50	ND<0.50	NA	NA
	08/06/03	ND<100	ND<20	1.8	ND<0.50	ND<0.50	ND<0.50	ND<0.50	ND<0.50
A-11	05/28/03	ND<100	ND<20	0.53	ND<0.50	ND<0.50	ND<0.50	NA	NA
A-12	05/28/03	ND<100	ND<20	10	ND<0.50	ND<0.50	2.5	NA	NA
	02/02/04	ND<100	ND<20	0.91	ND<0.50	ND<0.50	ND<0.50	ND<0.50	ND<0.50
A-13	05/28/03	ND<100	ND<20	ND<0.50	ND<0.50	ND<0.50	ND<0.50	NA	NA

Table 3
Fuel Oxygenate Analytical Data

Atlantic Richfield Company Service Station #4931
731 West MacArthur Boulevard
Oakland, California

Note = All fuel oxygenate compounds analyzed using EPA Method 8260B

1,2-DCA = 1,2-Dichloroethane
DIPE = Di-isopropyl ether
EDB = 1,2-Dibromoethane
ETBE = Ethyl tert butyl ether
MTBE = Methyl tert-butyl ether
NA = Not analyzed
ND< = Not detected at or above laboratory reporting limits
NS = Not sampled
TAME = tert-Amyl methyl ether
TBA = tert-Butyl alcohol
µg/L = micrograms per liter

a = The result was reported with a possible high bias due to the continuing calibration verification falling outside acceptance criteria.

ATTACHMENT A
FIELD PROCEDURES AND FIELD DATA SHEETS

FIELD PROCEDURES

Sampling Procedures

The sampling procedure for each well consists first of measuring the water level and depth to bottom, and checking for the presence of free phase petroleum product (free product), using either an electronic indicator and a clear Teflon™ bailer or an oil-water interface probe. Wells not containing free product are purged approximately three casing volumes of water (or until dewatered) using a centrifugal pump, gas displacement pump, or bailer. Equipment and purging method used for the current sampling event is noted on the attached field data sheets. During purging, temperature, pH, and electrical conductivity are monitored to document that these parameters are stable prior to collecting samples. After purging, water levels are allowed to partially (approximately 80%) recover. Groundwater samples (both purge and no purge) are collected using a Teflon bailer, placed into appropriate Environmental Protection Agency- (EPA) approved containers, labeled, logged onto chain-of-custody records, and transported on ice to a California State-certified laboratory. Wells with free product are not sampled and free product is removed according to California Code of Regulation, Title 23, Div. 3, Chap. 16, Section 2655, UST Regulations.

WELL GAUGING DATA

Project # 04050A-AC2 Date 5/4/04 Client 4931

Site 731 W. MacArthur Blvd. Oakland

Well ID	Well Size (in.)	Sheen / Odor	Depth to Immiscible Liquid (ft.)	Thickness of Immiscible Liquid (ft.)	Volume of Immiscibles Removed (ml)	Depth to water (ft.)	Depth to well bottom (ft.)	Survey Point: TOB or TOC	
A-2	4					6.79	19.42	TOC	
A-3	4					8.14	16.25		
A-4	4		—	⊖		9.12	19.42		S
A-5	3					9.98	24.60		
A-6	—	Well is paved over				—	—		S NPO @ 2'
A-7	3					8.21	22.25		
A-8	3					9.44	16.76		ORL S NPO @ 2'
A-9	6					8.12	37.80		ORL
A-10	3					8.69	29.73		
A-11	3					8.72	29.70		
A-12	3					8.74	29.84		
A-13	3					10.06	29.05		
AR-1	6					10.17	29.40		ORL
AR-2	6					6.01	26.31		
AR-3	4					9.12	28.95	↓	

ARCO / BP WELL MONITORING DATA SHEET

BTS #: <u>0A0504-Ac2</u>	Station # <u>4931</u>
Sampler: <u>Ac</u>	Date: <u>5/4/04</u>
Well I.D.: <u>A-4</u>	Well Diameter: 2 3 <u>4</u> 6 8 <u> </u>
Total Well Depth: <u>19.42</u>	Depth to Water: <u>9.12</u>
Depth to Free Product:	Thickness of Free Product (feet):
Referenced to: <u>PVC</u> Grade	D.O. Meter (if req'd): <u>YSI</u> HACH

Well Diameter	Multiplier	Well Diameter	Multiplier
1"	0.04	4"	0.65
2"	0.16	6"	1.47
3"	0.37	Other	radius ² * 0.163

Purge Method: <u>Bailer</u>	Sampling Method: <u>Bailer</u>
<u>Disposable Bailer</u>	<u>Disposable Bailer</u>
<u>Positive Air Displacement</u>	<u>Extraction Port</u>
<u>Electric Submersible</u>	Other: <u> </u>
<u>Extraction Pump</u>	
Other: <u> </u>	

Top of Screen: If well is listed as a no-purge, confirm that water level is below the top of screen. Otherwise, the well must be purged.

<u>7</u>	X	<u>3</u>	=	<u>21</u>	Gals.
1 Case Volume (Gals.)		Specified Volumes		Calculated Volume	

Time	Temp (°F)	pH	Conductivity (mS or μ S)	Gals. Removed	Observations
<u>1329</u>	<u>68.1</u>	<u>6.6</u>	<u>1362</u>	<u>7</u>	<u>clear, odor</u>
				<u>8 gal</u>	<u>DTW = 16.09</u>
<u>1420</u>	<u>68.5</u>	<u>6.8</u>	<u>1649</u>	<u> </u>	<u>DTW = 10.14</u>

Did well dewater? <u>Yes</u> No	Gallons actually evacuated: <u>8</u>
Sampling Time: <u>1420</u>	Sampling Date: <u>5/4/04</u>
Sample I.D.: <u>A-4</u>	Laboratory: Pace <u>Sequoia</u> Other <u> </u>
Analyzed for: TPH-G BTEX MTBE TPH-D Other: <u>Refer to COC</u>	
D.O. (if req'd):	Pre-purge: <u> </u> mg/L
	Post-purge: <u>6.4</u> mg/L
O.R.P. (if req'd):	Pre-purge: <u> </u> mV
	Post-purge: <u> </u> mV

ARCO / BP WELL MONITORING DATA SHEET

BTS #: <u>040504-AC2</u>	Station # <u>4931</u>
Sampler: <u>Ac</u>	Date: <u>5/4/04</u>
Well I.D.: <u>A-6</u>	Well Diameter: 2 3 4 6 8 <u> </u>
Total Well Depth: <u> </u>	Depth to Water: <u> </u>
Depth to Free Product: <u> </u>	Thickness of Free Product (feet): <u> </u>
Referenced to: <u>PVC</u> <u>Grade</u>	D.O. Meter (if req'd): <u>YSI</u> <u>HACH</u>

Well Diameter	Multiplier	Well Diameter	Multiplier
1"	0.04	4"	0.65
2"	0.16	6"	1.47
3"	0.37	Other	radius ² * 0.163

Purge Method:

- Bailer
- Disposable Bailer
- Positive Air Displacement
- Electric Submersible Extraction Pump
- Other:

Sampling Method:

- Bailer
- Disposable Bailer
- Extraction Port
- Other:

Top of Screen:

If well is listed as a no-purge, confirm that water level is below the top of screen. Otherwise, the well must be purged.

<u> </u>	X	<u> </u>	=	<u> </u> Gals.
1 Case Volume (Gals.)		Specified Volumes		Calculated Volume

Time	Temp (°F)	pH	Conductivity (mS or µS)	Gals. Removed	Observations
					<u>Well is paved over - Did not sample</u>

Did well dewater? Yes <input type="checkbox"/> No <input checked="" type="checkbox"/>	Gallons actually evacuated: <u> </u>
Sampling Time: <u> </u>	Sampling Date: <u> </u>
Sample I.D.: <u> </u>	Laboratory: <u>Pace</u> <u>Sequoia</u> <u>Other</u> <u> </u>
Analyzed for: <u>TPH-G</u> <u>BTEX</u> <u>MTBE</u> <u>TPH-D</u> <u>Other</u> <u> </u>	
D.O. (if req'd):	Pre-purge: <u> </u> mg/L Post-purge: <u> </u> mg/L
O.R.P. (if req'd):	Pre-purge: <u> </u> mV Post-purge: <u> </u> mV

ARCO / BP WELL MONITORING DATA SHEET

BTS #: <u>040504-AC2</u>	Station # <u>4931</u>
Sampler: <u>Ac</u>	Date: <u>5/4/04</u>
Well I.D.: <u>A-8</u>	Well Diameter: 2 <u>(3)</u> 4 6 8 <u> </u>
Total Well Depth: <u>16.76</u>	Depth to Water: <u>9.44</u>
Depth to Free Product:	Thickness of Free Product (feet):
Referenced to: <u>(PVC)</u> Grade	D.O. Meter (if req'd): <u>(YS)</u> HACH

Well Diameter	Multiplier	Well Diameter	Multiplier
1"	0.04	4"	0.65
2"	0.16	6"	1.47
3"	0.37	Other	radius ² * 0.163

Purge Method:

- Bailer
- Disposable Bailer
- Positive Air Displacement
- Electric Submersible Extraction Pump
- Other: _____

Sampling Method:

- Bailer
- Disposable Bailer
- Extraction Port
- Other: _____

Top of Screen: 2'

If well is listed as a no-purge, confirm that water level is below the top of screen. Otherwise, the well must be purged.

<u>No Purge</u>	x	_____	=	_____	Gals.
1 Case Volume (Gals.)		Specified Volumes		Calculated Volume	

Time	Temp (°F)	pH	Conductivity (mS or <u>(uS)</u>)	Gals. Removed	Observations
<u>1415</u>	<u>68.3</u>	<u>6.9</u>	<u>1112</u>	<u> </u>	<u>odor</u>

Did well dewater? Yes No

Gallons actually evacuated:

Sampling Time: 1415

Sampling Date: 5/4/04

Sample I.D.: A-8

Laboratory: Pace (Sequoia) Other _____

Analyzed for: TPH-G BTEX MTBE TPH-D Other: Refer to LOC

D.O. (if req'd):	Pre-purge:	mg/L	Post-purge:	<u>1.0</u>	mg/L
	O.R.P. (if req'd):	Pre-purge:	mV	Post-purge:	mV

BP GEM OIL COMPANY TYPE A BILL OF LADING

SOURCE RECORD BILL OF LADING FOR NON-
HAZARDOUS PURGEWATER RECOVERED FROM
GROUNDWATER WELLS AT BP GEM OIL COMPANY
FACILITIES IN THE STATE OF CALIFORNIA. THE NON-
HAZARDOUS PURGE- WATER WHICH HAS BEEN
RECOVERED FROM GROUND- WATER WELLS IS
COLLECTED BY THE CONTRACTOR, MADE UP INTO
LOADS OF APPROPRIATE SIZE AND HAULED BY
DILLARD ENVIRONMENTAL TO THE ALTAMONT
LANDFILL AND RESOURCE RECOVERY FACILITY IN
LIVERMORE, CALIFORNIA.

The contractor performing this work is BLAINE TECH
SERVICES, INC. (BTS), 1680 Rogers Avenue, San Jose, CA
95112 (phone [408] 573-0555). Blaine Tech Services, Inc. is
authorized by BP GEM OIL COMPANY to recover, collect,
apportion into loads the Non-Hazardous Well Purgewater that is
drawn from wells at the BP GEM Oil Company facility indicated
below and deliver that purgewater to BTS. Transport routing of
the Non-Hazardous Well Purgewater may be direct from one BP
GEM facility to the designated destination point; from one BP
GEM facility to the designated destination point via another BP
GEM facility; from a BP GEM facility to the designated
destination point via the contractor's facility, or any combination
thereof. The Non-Hazardous Well Purgewater is and remains the
property of BP GEM Oil Company.

This Source Record BILL OF LADING was initiated to
cover the recovery of Non-Hazardous Well Purgewater from wells
at the BP GEM Oil Company facility described below:

Arld 4931

Station #

731 W. MacArthur Blvd. Oakland

Station Address

Total Gallons Collected From Groundwater Monitoring Wells:

10

added equip.
rinse water 5

any other
adjustments _____

TOTAL GALS.
RECOVERED 15

loaded onto
BTS vehicle # 52

BTS event #

time date

040504-ACZ

5/4/04

signature

[Signature]

REC'D AT

time

date

/ /

unloaded by
signature _____

ATTACHMENT B

**LABORATORY PROCEDURES,
CERTIFIED ANALYTICAL REPORTS,
AND CHAIN-OF-CUSTODY RECORDS**

LABORATORY PROCEDURES

Laboratory Procedures

The groundwater samples were analyzed for the presence of the chemicals mentioned in the chain of custody using standard EPA methods. The methods of analysis for the groundwater samples are documented in the certified analytical report. The certified analytical reports and chain-of-custody record are presented in this attachment. The analytical data provided by the laboratory approved by Atlantic Richfield Company have been reviewed and verified by that laboratory.



25 May, 2004

Scott Robinson
URS Corporation [Arco]
1333 Broadway, Suite 800
Oakland, CA 94612

RE: ARCO #4931, Oakland, CA
Work Order: MNE0142

Enclosed are the results of analyses for samples received by the laboratory on 05/05/04 16:30. If you have any questions concerning this report, please feel free to contact me.

Sincerely,

Lisa Race
Senior Project Manager

CA ELAP Certificate #1210

URS Corporation [Arco]
1333 Broadway, Suite 800
Oakland CA, 94612

Project: ARCO #4931, Oakland, CA
Project Number: N/P
Project Manager: Scott Robinson

MNE0142
Reported:
05/25/04 16:52

ANALYTICAL REPORT FOR SAMPLES

Sample ID	Laboratory ID	Matrix	Date Sampled	Date Received
A-4	MNE0142-01	Water	05/04/04 14:20	05/05/04 16:30
A-8	MNE0142-02	Water	05/04/04 14:15	05/05/04 16:30
TB-4931-05042004	MNE0142-03	Water	05/04/04 00:00	05/05/04 16:30

The carbon range for the TPH-GRO has been changed from C6-C10 to C4-C12. The carbon range for TPH-DRO has been changed from C10-C28 to C10-C36. EPA 8015B has been modified to better meet the requirements of California regulatory agencies.

These samples were received with intact custody seals.

URS Corporation [Arco]
1333 Broadway, Suite 800
Oakland CA, 94612

Project: ARCO #4931, Oakland, CA
Project Number: N/P
Project Manager: Scott Robinson

MNE0142
Reported:
05/25/04 16:52

**Volatile Organic Compounds by EPA Method 8260B
Sequoia Analytical - Morgan Hill**

Analyte	Result	Reporting Limit	Units	Dilution	Batch	Prepared	Analyzed	Method	Notes
A-4 (MNE0142-01) Water Sampled: 05/04/04 14:20 Received: 05/05/04 16:30									
Ethanol	ND	10000	ug/l	100	4E18003	05/18/04	05/18/04	EPA 8260B	
tert-Butyl alcohol	ND	2000	"	"	"	"	"	"	
Methyl tert-butyl ether	2300	50	"	"	"	"	"	"	
Di-isopropyl ether	ND	50	"	"	"	"	"	"	
Ethyl tert-butyl ether	ND	50	"	"	"	"	"	"	
tert-Amyl methyl ether	510	50	"	"	"	"	"	"	
1,2-Dichloroethane	ND	50	"	"	"	"	"	"	
1,2-Dibromoethane (EDB)	ND	50	"	"	"	"	"	"	
Benzene	ND	50	"	"	"	"	"	"	
Toluene	ND	50	"	"	"	"	"	"	
Ethylbenzene	ND	50	"	"	"	"	"	"	
Xylenes (total)	ND	50	"	"	"	"	"	"	
Gasoline Range Organics (C4-C12)	ND	5000	"	"	"	"	"	"	
<i>Surrogate: 1,2-Dichloroethane-d4</i>		98.0 %	78-129	"	"	"	"	"	
A-8 (MNE0142-02) Water Sampled: 05/04/04 14:15 Received: 05/05/04 16:30									
Ethanol	ND	10000	ug/l	100	4E18003	05/18/04	05/18/04	EPA 8260B	
tert-Butyl alcohol	ND	2000	"	"	"	"	"	"	
Methyl tert-butyl ether	1600	50	"	"	"	"	"	"	
Di-isopropyl ether	ND	50	"	"	"	"	"	"	
Ethyl tert-butyl ether	ND	50	"	"	"	"	"	"	
tert-Amyl methyl ether	440	50	"	"	"	"	"	"	
1,2-Dichloroethane	ND	50	"	"	"	"	"	"	
1,2-Dibromoethane (EDB)	ND	50	"	"	"	"	"	"	
Benzene	490	50	"	"	"	"	"	"	
Toluene	ND	50	"	"	"	"	"	"	
Ethylbenzene	ND	50	"	"	"	"	"	"	
Xylenes (total)	ND	50	"	"	"	"	"	"	
Gasoline Range Organics (C4-C12)	ND	5000	"	"	"	"	"	"	
<i>Surrogate: 1,2-Dichloroethane-d4</i>		95.6 %	78-129	"	"	"	"	"	

URS Corporation [Arco]
 1333 Broadway, Suite 800
 Oakland CA, 94612

 Project ARCO #4931, Oakland, CA
 Project Number N/P
 Project Manager Scott Robinson

 MNE0142
 Reported:
 05/25/04 16:52

**Volatile Organic Compounds by EPA Method 8260B - Quality Control
Sequoia Analytical - Morgan Hill**

Analyte	Result	Reporting Limit	Units	Spike Level	Source Result	%REC	%REC Limits	RPD	RPD Limit	Notes
---------	--------	-----------------	-------	-------------	---------------	------	-------------	-----	-----------	-------

Batch 4E18003 - EPA 5030B P/T
Blank (4E18003-BLK1)

Prepared & Analyzed: 05/18/04

Ethanol	ND	100	ug/l							
tert-Butyl alcohol	ND	5.0	"							
Methyl tert-butyl ether	ND	0.50	"							
Di-isopropyl ether	ND	0.50	"							
Ethyl tert-butyl ether	ND	0.50	"							
tert-Amyl methyl ether	ND	0.50	"							
1,2-Dichloroethane	ND	0.50	"							
1,2-Dibromoethane (EDB)	ND	0.50	"							
Benzene	ND	0.50	"							
Toluene	ND	0.50	"							
Ethylbenzene	ND	0.50	"							
Xylenes (total)	ND	0.50	"							
Gasoline Range Organics (C4-C12)	ND	50	"							

Surrogate: 1,2-Dichloroethane-d4

4.91

"

5.00

98.2

78-129

Laboratory Control Sample (4E18003-BS1)

Prepared & Analyzed: 05/18/04

Ethanol	282	100	ug/l	200		141	31-186			
tert-Butyl alcohol	51.0	5.0	"	50.0		102	0-206			
Methyl tert-butyl ether	9.80	0.50	"	10.0		98.0	63-137			
Di-isopropyl ether	9.47	0.50	"	10.0		94.7	76-130			
Ethyl tert-butyl ether	9.98	0.50	"	10.0		99.8	61-141			
tert-Amyl methyl ether	10.0	0.50	"	10.0		100	56-140			
1,2-Dichloroethane	10.0	0.50	"	10.0		100	77-136			
1,2-Dibromoethane (EDB)	10.2	0.50	"	10.0		102	77-132			
Benzene	9.77	0.50	"	10.0		97.7	78-124			
Toluene	10.0	0.50	"	10.0		100	78-129			
Ethylbenzene	11.2	0.50	"	10.0		112	84-117			
Xylenes (total)	33.9	0.50	"	30.0		113	83-125			

Surrogate: 1,2-Dichloroethane-d4

4.83

"

5.00

96.6

78-129

URS Corporation [Arco]
 1333 Broadway, Suite 800
 Oakland CA, 94612

 Project: ARCO #4931, Oakland, CA
 Project Number: N/P
 Project Manager: Scott Robinson

 MNE0142
 Reported:
 05/25/04 16:52

Volatile Organic Compounds by EPA Method 8260B - Quality Control
Sequoia Analytical - Morgan Hill

Analyte	Result	Reporting Limit	Units	Spike Level	Source Result	%REC	%REC Limits	RPD	RPD Limit	Notes
Batch 4E18003 - EPA 5030B P/T										
Laboratory Control Sample (4E18003-BS2)					Prepared & Analyzed: 05/18/04					
Gasoline Range Organics (C4-C12)	472	50	ug/l	440		107	70-124			
Surrogate: 1,2-Dichloroethane-d4	4.83		"	5.00		96.6	78-129			
Laboratory Control Sample Dup (4E18003-BSD1)					Prepared: 05/18/04 Analyzed: 05/19/04					
Ethanol	284	100	ug/l	200		142	31-186	0.707	37	
tert-Butyl alcohol	49.1	5.0	"	50.0		98.2	0-206	3.80	22	
Methyl tert-butyl ether	8.41	0.50	"	10.0		84.1	63-137	15.3	13	QC21
Di-isopropyl ether	9.35	0.50	"	10.0		93.5	76-130	1.28	9	
Ethyl tert-butyl ether	9.27	0.50	"	10.0		92.7	61-141	7.38	9	
tert-Amyl methyl ether	9.48	0.50	"	10.0		94.8	56-140	5.34	12	
1,2-Dichloroethane	10.3	0.50	"	10.0		103	77-136	2.96	13	
1,2-Dibromoethane (EDB)	10.1	0.50	"	10.0		101	77-132	0.985	9	
Benzene	9.74	0.50	"	10.0		97.4	78-124	0.308	12	
Toluene	9.89	0.50	"	10.0		98.9	78-129	1.11	10	
Ethylbenzene	10.8	0.50	"	10.0		108	84-117	3.64	10	
Xylenes (total)	32.8	0.50	"	30.0		109	83-125	3.30	11	
Surrogate: 1,2-Dichloroethane-d4	4.98		"	5.00		99.6	78-129			
Laboratory Control Sample Dup (4E18003-BSD2)					Prepared: 05/18/04 Analyzed: 05/19/04					
Gasoline Range Organics (C4-C12)	464	50	ug/l	440		105	70-124	1.71	20	
Surrogate: 1,2-Dichloroethane-d4	5.02		"	5.00		100	78-129			

URS Corporation [Arco]
1333 Broadway, Suite 800
Oakland CA, 94612

Project: ARCO #4931, Oakland, CA
Project Number: N/P
Project Manager: Scott Robinson

MNE0142
Reported:
05/25/04 16:52

Notes and Definitions

QC21 The RPD result exceeded the control limits; however, both percent recoveries were acceptable. Sample results for the QC batch were accepted based on percent recoveries and completeness of QC data.

DET Analyte DETECTED

ND Analyte NOT DETECTED at or above the reporting limit

NR Not Reported

dry Sample results reported on a dry weight basis

RPD Relative Percent Difference

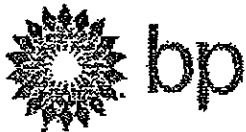

Chain of Custody Record

MNE0142

Project Name 4931 GWM
 BP BU/GEM CO Portfolio Retail

BP Laboratory Contract Number: Atlantic Richfield Company

Date: 5/4/04

Requested Due Date (mm/dd/yy) 14 day TAT

On-site Time: 1315 Temp: 70°
 Off-site Time: 1520 Temp: 70°
 Sky Conditions: Sunny
 Meteorological Events:
 Wind Speed: 5 mph Direction: W

Send To:	BP/GEM Facility No.: ARCO 4931	Consultant/Contractor: URS
Lab Name: SEQUOIA	BP/GEM Facility Address: 731 W. MACARTHUR BLVD, OAKLAND, CA	Address: 1333 Broadway, Suite 800
Lab Address: 885 Jarvis Dr. Morgan Hill, CA 95037	Site ID No. ARCO 4931	Oakland, CA 94612
Lab PM Lisa Race	Site Lat/Long:	e-mail EDD: donna.casper@URSCorp.com
Tel/Fax: 408-776-9600 / 408-782-6308	California Global ID #: T0600100107	Consultant/Contractor Project No.: J5-00004931.01 00427
Report Type & QC Level: 1 Send EDD Reports	BP/GEM PM Contact: PAUL SUPPLE	Consultant Tele/Fax: 510-893-3600/510-874-3268
BP/GEM Account No.:	Address: P.O. Box 6549 Moraga, CA 94570	Consultant/Contractor PM: Scott Robinson
Lab Bottle Order No.:	Tele/Fax: 925-299-8891/925-299-8872	Invoice to: Consultant/Contractor or BP/GEM (Circle one)
		BP/GEM Work Release No.:

Item No.	Sample Description	Time	Matrix				Laboratory No.	No. of containers	Preservatives			Requested Analysis						Sample Point Lat/Long and Comments	
			Soil/Solid	Water/Liquid	Sediments	Air			Unpreserved	H ₂ SO ₄	HNO ₃	HCl	GRO / BTEX (8215/8821/8260)	DRO w/SGC (8015)	MTBE (8021)	MTBE (8260)	MTBE, TAME, ETBE DPE, TBA (8260)		1,2-DCA & EDB (8260)
1	A-4	1420		X			01	3					X			X	X		
2	A-8	1415		X			02	3					X			X	X		
3	TS 4931/05042004			X			03	2											On Hold
4																			
5																			
6																			
7																			
8																			
9																			
10																			

Sampler's Name: <u>Aaron Costa</u>	Relinquished By / Affiliation: <u>Paul Supple / Blaine Tech</u>	Date: <u>5-5-04</u>	Time: <u>14:30</u>	Accepted By / Affiliation: <u>[Signature]</u>	Date: <u>5/3/04</u>	Time: <u>19:32</u>
Sampler's Company: <u>Blaine Tech</u>						
Equipment Date:						
Equipment Method:						
Equipment Tracking No.:						

Instructions: Address Invoice to BP/GEM but send to URS for approval

Place Yes No Temperature Blank Yes No Cooler Temperature on Receipt 9.4 °C Trip Blank Yes No

* White Copy - Laboratory / Yellow Copy - BP/GEM / Pink Copy - Consultant/Contractor

SEQUOIA ANALYTICAL SAMPLE RECEIPT LOG

CLIENT NAME: WRS
 REC-BY (PRINT): AS
 WORKORDER: MNE0142

DATE REC'D AT LAB: 5-5-04
 TIME REC'D AT LAB: 1630
 DATE LOGGED IN: 5-7-04

DRINKING WATER for regulatory purposes: YES NO
 WASTE WATER for regulatory purposes: YES NO

CIRCLE THE APPROPRIATE RESPONSE	LAB SAMPLE #	DASH #	CLIENT ID	CONTAINER DESCRIPTION	PRESERVATIVE	SAMPLE MATRIX	DATE SAMPLED	REMARKS: CONDITION (ETC.)
1. Custody Seal(s) <u>on bag</u> <input checked="" type="radio"/> Present / Absent <input checked="" type="radio"/> Intact / Broken*	01		A-4	3-VOCs	HCl	L	5-4-04	10-HA 40710
2. Chain-of-Custody <input checked="" type="radio"/> Present / Absent*	02		A-8	↓	↓	↓		
3. Traffic Reports or Packing List: <input checked="" type="radio"/> Present / Absent	03		TB-4931-05000	2-VOCs	↓	↓	↓	
4. Airbill: Airbill / Sticker <input checked="" type="radio"/> Present / Absent								
5. Airbill #:								
6. Sample Labels: <input checked="" type="radio"/> Present / Absent								
7. Sample IDs: <input checked="" type="radio"/> Listed / Not Listed on Chain-of-Custody								
8. Sample Condition: <input checked="" type="radio"/> Intact / Broken* / Leaking*								
9. Does information on chain-of-custody, traffic reports and sample labels agree? <input checked="" type="radio"/> Yes / No*								
10. Sample received within hold time: <input checked="" type="radio"/> Yes / No*								
11. Adequate sample volume received? <input checked="" type="radio"/> Yes / No*								
12. Proper Preservatives used: <input checked="" type="radio"/> Yes / No*								
13. Temp Rec. at Lab: Is temp $4 \pm 2^{\circ}\text{C}$? <input checked="" type="radio"/> Yes / No**								

(Acceptance range for samples requiring thermal pres.)
 **Exception (if any): METALS / DFF ON ICE or Problem COC

***IF CIRCLED, CONTACT PROJECT MANAGER AND ATTACH RECORD OF RESOLUTION.**

ATTACHMENT C

HISTORIC GROUNDWATER DATA

Table 1
Groundwater Elevation and Analytical Data
Total Purgeable Petroleum Hydrocarbons
(TPPH as Gasoline, BTEX Compounds, and MTBE)

ARCO Service Station 4931
731 West MacArthur Boulevard, Oakland, California

Well Number	Date Gauged/ Sampled	Well Elevation (feet, MSL)	Depth to Water (feet, TOB)	Groundwater Elevation (feet, MSL)	TPH Gasoline (ppb)	Benzene (ppb)	Toluene (ppb)	Ethyl- benzene (ppb)	Total Xylenes (ppb)	MTBE 8021B* (ppb)	MTBE 8260 (ppb)	Dissolved Oxygen (ppm)	Purged/ Not Purged (P/NP)
A-2	03/26/96	55.48	5.37	50.11	<50	<0.5	<0.5	<0.5	<0.5	NA	NA		
A-2	05/22/96	55.48	5.25	50.23	<50	<0.5	<0.5	<0.5	<0.5	NA	NA	NM	
A-2	08/22/96	55.48	10.45	45.03	<50	1.1	1.8	<0.5	1.3	<2.5	NA	NM	
A-2	12/19/96	55.48	5.53	49.95	<50	<0.5	<0.5	<0.5	<0.5	2.7	NA	NM	
A-2	04/01/97	55.48	8.77	46.71	<50	<0.5	<0.5	<0.5	<0.5	<2.5	NA	NM	
A-2	05/27/97	55.48	9.87	45.61	<50	<0.5	<0.5	<0.5	<0.5	4.6	NA	NM	
A-2	08/12/97	55.48	11.11	44.37	<50	<0.5	<0.5	<0.5	<0.5	5.6	NA	NM	
A-2	11/14/97	55.48	10.63	44.85	<50	0.9	2.8	<0.5	2.4	27	NA	2.6	
A-2	03/18/98	55.48	3.58	51.90	<50	<0.5	<0.5	<0.5	<0.5	<3	NA	NM	
A-2	05/19/98	55.48	4.82	50.66	<50	<0.5	<0.5	<0.5	<0.5	<3	NA	NM	
A-2	07/29/98	55.48	8.94	46.54	<50	<0.5	<0.5	<0.5	<0.5	<3	NA	1.30	P
A-2	10/09/98	55.48	10.82	44.66	<50	<0.5	<0.5	<0.5	<0.5	<3	NA	1.2	NP
A-2	02/19/99	55.48	4.46	51.02	<50	<0.5	<0.5	<0.5	<0.5	<3	NA	0.5	NP
A-2	06/02/99	55.48	5.59	49.89	<50	<0.5	<0.5	<0.5	<0.5	<3	NA	3.0	P
A-2	08/26/99	55.48	10.67	44.81	<50	<0.5	0.6	<0.5	<0.5	<3	NA	5.35	NP
A-2	10/26/99	55.48	4.61	50.87	<50	<0.5	<0.5	<0.5	<0.5	<3	NA	0.79	NP
A-2	02/25/00	55.48	3.10	52.38	<50	<0.5	<0.5	<0.5	<1	<3	NA	2.14	P
A-3	03/26/96	54.66	7.20	47.46	Not Sampled: Well Sampled Semiannually				<1	<3	NA	4.21	NP
A-3	05/22/96	54.66	7.70	46.96	<50	1.2	1.9	0.7	1.3	NA	NA	NM	
A-3	08/22/96	54.66	10.88	43.78	Not Sampled: Well Sampled Semiannually				<2.5	NA	5,300	NM	
A-3	12/19/96	54.66	7.70	46.96	5,900	<2.5	<2.5	<2.5	<2.5	NA		NM	
A-3	04/01/97	54.66	9.78	44.88	Not Sampled: Well Sampled Semiannually				<20	3,800	NA	NM	
A-3	05/27/97	54.66	10.55	44.11	2,300	<20	<20	<20	<20				
A-3	08/12/97	54.66	11.12	43.54	Not Sampled: Well Sampled Semiannually				<10	1,500	NA	3.8	
A-3	11/14/97	54.66	8.24	46.42	<1,000	<10	<10	<10	<10				
A-3	03/18/98	54.66	5.05	49.61	Not Sampled: Well Sampled Semiannually				<2.5	220	NA	4.60	P
A-3	05/19/98	54.66	9.00	45.66	<250	<2.5	<2.5	<2.5	<2.5				
A-3	07/29/98	54.66	9.86	44.80	Not Sampled: Well Sampled Semiannually				<2.5				
A-3	10/09/98	54.66	11.36	43.30	<250	<2.5	<2.5	<2.5	<2.5	260	NA	1.0	NP
A-3	02/19/99	54.66	6.19	48.47	<50	<0.5	<0.5	<0.5	<0.5	<3	NA	2.5	NP
A-3	06/02/99	54.66	10.82	43.84	120	<1	<1	<1	<1	160	NA	2.78	NP

OAKC:\ARCO\4931\QTRLY\4931q100.xls:1
 Recasted from electronic data provided by IT Corporation.

Table 1
Groundwater Elevation and Analytical Data
Total Purgeable Petroleum Hydrocarbons
(TPPH as Gasoline, BTEX Compounds, and MTBE)

ARCO Service Station 4931
731 West MacArthur Boulevard, Oakland, California

Well Number	Date Gauged/ Sampled	Well Elevation (feet, MSL)	Depth to Water (feet, TOB)	Groundwater Elevation (feet, MSL)	TPH Gasoline (ppb)	Benzene (ppb)	Toluene (ppb)	Ethyl- benzene (ppb)	Total Xylenes (ppb)	MTBE 8021B* (ppb)	MTBE 8260 (ppb)	Dissolved Oxygen (ppm)	Purged/ Not Purged (P/NP)	
A-3	08/26/99	54.66	10.73	43.93	Not Sampled: Well Sampled Semiannually									
A-3	10/26/99	54.66	6.58	48.08	<50	<0.5	<0.5	<0.5	<1	32	NA	0.95	NP	
A-3	02/25/00	54.66	5.41	49.25	Not Sampled: Well Sampled Semiannually									
A-4	03/26/96	54.73	7.95	46.78	8,900	1,200	21	200	220	NA	NA	NM	P NP NP NP NP NP NP NP NP NP NP NP NP NP NP NP NP NP	
A-4	05/22/96	54.73	8.35	46.38	5,300	700	<10	170	130	NA	NA	NM		
A-4	08/22/96	54.73	11.03	43.70	3,000	480	<5.0	75	26	150	NA	NM		
A-4	12/19/96	54.73	8.67	46.06	<2,000	<20	<20	<20	<20	NA	15,000	NM		
A-4	04/01/97	54.73	11.95	42.78	8,900	1,700	22	310	260	6,900	NA	NM		
A-4	05/27/97	54.73	10.80	43.93	7,100	960	<20	150	74	7,900	NA	NM		
A-4	08/12/97	54.73	11.38	43.35	4,300	670	12	51	27	2,800	NA	NM		
A-4	11/14/97	54.73	7.74	46.99	<20,000	300	500	<200	<200	27,000	NA	2.2		
A-4	03/18/98	54.73	6.80	47.93	4,700	600	<20	99	94	1,200	NA	1.0		
A-4	05/19/98	54.73	9.06	45.67	<2000	<20	<20	<20	720	2,000	NA	1.28		
A-4	07/29/98	54.73	10.05	44.68	8,400	1,300	<20	290	130	1,800	NA	0.7		
A-4	10/09/98	54.73	11.20	43.53	3,500	400	<20	54	<20	1,700	NA	1.0		
A-4	02/19/99	54.73	6.85	47.88	<1,000	<10	<10	<10	12	650	NA	0.1		
A-4	08/26/99	54.73	10.80	43.93	6,100	760	16	260	89	2,300	NA	1.12		
A-4	10/26/99	54.73	10.11	44.62	1,100	68	5	8	4	1,400	NA	1.15		
A-4	02/25/00	54.73	5.90	48.83	1,500	39	2.3	9.0	5	1,700	NA	10.12		
A-5	03/26/96	54.17	7.93	46.24	870	53	1.1	4.6	20	600	NA	1.72		
A-5	05/22/96	54.17	8.20	45.97	Not Sampled: Well Sampled Semiannually									
A-5	08/22/96	54.17	10.70	43.47	<50	<0.5	<0.5	<0.5	<0.5	NA	NA	NM		
A-5	12/19/96	54.17	8.39	45.78	Not Sampled: Well Sampled Semiannually									
A-5	04/01/97	54.17	10.83	43.34	9,900	1,100	330	230	700	NA	24	NM		
A-5	05/27/97	54.17	10.65	43.52	Not Sampled: Well Sampled Semiannually									
A-5	08/12/97	54.17	11.05	43.12	100	<0.5	<0.5	<0.5	<0.5	120	NA	NM		
A-5	11/14/97	54.17	10.51	43.66	Not Sampled: Well Sampled Semiannually									
A-5	03/18/98	54.17	8.10	46.07	<50	<0.5	<0.5	<0.5	<0.5	41	NA	4.8		
A-5	05/19/98	54.17	9.31	44.86	Not Sampled: Well Sampled Semiannually									
					590	<5	<5	<5	<5	710	NA	2.48	P	

OAKC:\ARCO\4931\QTRLY\4931q:00.xls\wb:1
 Recasted from electronic data provided by IT Corporation.

IT CORPORATION

Table 1
Groundwater Elevation and Analytical Data
Total Purgeable Petroleum Hydrocarbons
(TPPH as Gasoline, BTEX Compounds, and MTBE)

ARCO Service Station 4931
731 West MacArthur Boulevard, Oakland, California

Well Number	Date Gauged/ Sampled	Well Elevation (feet, MSL)	Depth to Water (feet, TOB)	Groundwater Elevation (feet, MSL)	TPH Gasoline (ppb)	Benzene (ppb)	Toluene (ppb)	Ethyl- benzene (ppb)	Total Xylenes (ppb)	MTBE 8021B* (ppb)	MTBE 8260 (ppb)	Dissolved Oxygen (ppm)	Purged/ Not Purged (P/NP)
A-5	07/29/98	54.17	9.89	44.28	Not Sampled: Well Sampled Semiannually								
A-5	10/09/98	54.17	11.02	43.15	690	<5	<5	<5	<5	710	NA	1.0	NP
A-5	02/19/99	54.17	6.82	47.35	<2,000	<20	<20	<20	<20	2,300	NA	0.6	NP
A-5	06/02/99	54.17	10.82	43.35	1,500	<0.5	2.3	<0.5	<0.5	2,400	NA	2.81	NP
A-5	08/26/99	54.17	10.65	43.52	Not Sampled: Well Sampled Semiannually								
A-5	10/26/99	54.17	10.35	43.82	380	<0.5	<0.5	<0.5	<1	440	NA	0.49	NP
A-5	02/25/00	54.17	6.89	47.28	Not Sampled: Well Sampled Semiannually								
A-6	03/26/96	55.17	7.15	48.02	52	2.7	<0.5	1.1	2.0	NA	NA	NM	
A-6	05/22/96	55.17	7.35	47.82	<50	2.4	<0.5	0.88	1.7	NA	NA	NM	
A-6	08/22/96	55.17	10.12	45.05	<50	<0.5	<0.5	<0.5	<0.5	<2.5	NA	NM	
A-6	12/19/96	55.17	7.43	47.74	<50	1.7	<0.5	0.78	1.5	<2.5	NA	NM	
A-6	04/01/97	55.17	9.97	45.20	<50	4.7	<0.5	1.9	3.2	<2.5	NA	NM	
A-6	05/27/97	55.17	9.66	45.51	<50	0.69	<0.5	<0.5	<0.5	<2.5	NA	NM	
A-6	08/12/97	55.17	10.43	44.74	<50	<0.5	<0.5	<0.5	<0.5	<2.5	NA	NM	
A-6	11/14/97	55.17	9.76	45.41	<50	<0.5	<0.5	<0.5	<0.5	<2.5	NA	NM	
A-6	03/18/98	55.17	7.00	48.17	<50	6.2	0.5	2.3	2.6	<3	NA	<1.0	
A-6	05/19/98	55.17	8.27	46.90	<50	<0.5	<0.5	1.3	4.7	<3	NA	3.0	
A-6	07/29/98	55.17	8.96	46.21	<50	<0.5	<0.5	<0.5	<0.5	<3	NA	2.16	P
A-6	10/09/98	55.17	10.23	44.94	<50	<0.5	<0.5	<0.5	<0.5	<3	NA	0.8	NP
A-6	02/19/99	55.17	5.79	49.38	<50	<0.5	<0.5	<0.5	<0.5	<3	NA	1.0	NP
A-6	06/02/99	55.17	9.71	45.46	<50	<0.5	<0.5	<0.5	<0.5	5	NA	0.4	NP
A-6	08/26/99	55.17	9.79	45.38	<50	<0.5	<0.5	<0.5	<0.5	<3	NA	2.00	NP
A-6	10/26/99	55.17	9.70	45.47	<50	<0.5	<0.5	<0.5	0.7	<3	NA	0.66	NP
A-6	02/25/00	55.17	5.68	49.49	<50	<0.5	<0.5	<0.5	<1	<3	NA	1.66	NP
A-7	03/26/96	54.71	6.90	47.81	Not Sampled: Well Sampled Semiannually								
A-7	05/22/96	54.71	8.27	46.44	<50	<0.5	<0.5	<0.5	<0.5	NA	NA	NM	
A-7	08/22/96	54.71	9.80	44.91	Not Sampled: Well Sampled Semiannually								
A-7	12/19/96	54.71	7.19	47.52	Not Sampled: Well Sampled Annually								
A-7	04/01/97	54.71	9.63	45.08	Not Sampled: Well Sampled Annually								
A-7	05/27/97	54.71	9.34	45.37	<50	<0.5	<0.5	<0.5	<0.5	<2.5	NA	NM	

OAKC:\ARCO\4931\QTRLY\4931q100.xls\sh:l
 Recreated from electronic data provided by IT Corporation.

IT CORPORATION

Table 1
Groundwater Elevation and Analytical Data
Total Purgeable Petroleum Hydrocarbons
(TPPH as Gasoline, BTEX Compounds, and MTBE)

ARCO Service Station 4931
731 West MacArthur Boulevard, Oakland, California

Well Number	Date Gauged/ Sampled	Well Elevation (feet, MSL)	Depth to Water (feet, TOB)	Groundwater Elevation (feet, MSL)	TPH Gasoline (ppb)	Benzene (ppb)	Toluene (ppb)	Ethyl- benzene (ppb)	Total Xylenes (ppb)	MTBE 8021B* (ppb)	MTBE 8260 (ppb)	Dissolved Oxygen (ppm)	Purged/ Not Purged (P/NP)
A-7	08/12/97	54.71	10.10	44.61	Not Sampled: Well Sampled Annually								
A-7	11/14/97	54.71	9.35	45.36	Not Sampled: Well Sampled Annually								
A-7	03/18/98	54.71	6.75	47.96	Not Sampled: Well Sampled Annually								
A-7	05/19/98	54.71	8.85	45.86	<50	<0.5	<0.5	<0.5	<0.5	<3	NA	1.82	P
A-7	07/29/98	54.71	8.84	45.87	Not Sampled: Well Sampled Annually								
A-7	10/09/98	54.71	10.05	44.66	Not Sampled: Well Sampled Annually								
A-7	02/19/99	54.71	5.57	49.14	<50	<0.5	<0.5	<0.5	<0.5	<3	NA	4.7	NP
A-7	06/02/99	54.71	9.56	45.15	<50	<0.5	<0.5	<0.5	<0.5	<3	NA	2.17	NP
A-7	08/26/99	54.71	9.66	45.05	Not Sampled: Well Sampled Annually								
A-7	10/26/99	54.71	9.54	45.17	Not Sampled: Well Sampled Annually								
A-7	02/25/00	54.71	5.60	49.11	Not Sampled: Well Sampled Annually								
A-8	03/26/96	53.77	7.10	46.67	48,000	2,600	<100	650	1,100	NA	NA	NM	
A-8	05/22/96	53.77	7.20	46.57	14,000	2,800	160	320	190	NA	NA	NM	
A-8	08/22/96	53.77	11.57	42.20	8,000	1,000	76	150	96	4,300	NA	NM	
A-8	12/19/96	53.77	8.04	45.73	12,000	450	110	210	230	<500	NA	NM	
A-8	04/01/97	53.77	9.98	43.79	Not Sampled: Well Sampled Semiannually								
A-8	05/27/97	53.77	11.45	42.32	11,000	1,600	100	220	210	2,300	NA	NM	
A-8	08/12/97	53.77	11.59	42.18	Not Sampled: Well Sampled Semiannually								
A-8	11/14/97	53.77	9.85	43.92	26,000	2,300	<200	400	400	4,100	NA	2.2	
A-8	03/18/98	53.77	7.80	45.97	Not Sampled: Well Sampled Semiannually								
A-8	05/19/98	53.77	8.78	44.99	88,000	4,200	150	640	600	6,700	NA	1.36	P
A-8	07/29/98	53.77	9.59	44.18	46,000	4,900	160	620	580	13,000	NA	0.5	NP
A-8	10/09/98	53.77	11.23	42.54	130,000	3,700	110	500	770	7,300	NA	1.0	NP
A-8	02/19/99	53.77	6.51	47.26	<1,000	39	<10	<10	<10	840	NA	0.2	NP
A-8	06/02/99	53.77	10.68	43.09	8,500	1,300	32	180	110	6,700	NA	1.31	NP
A-8	08/26/99	53.77	10.43	43.34	6,200	870	17	64	60	3,700	NA	0.69	NP
A-8	10/26/99	53.77	10.23	43.54	15,000	2,800	140	370	360	480	NA	0.62	NP
A-8	02/25/00	53.77	5.93	47.84	2,600	330	6.6	18	26	1,100	NA	1.43	NP
A-9	03/26/96	53.04	7.05	45.99	<50	<0.5	<0.5	<0.5	<0.5	NA	NA	NM	
A-9	05/22/96	53.04	7.20	45.84	<50	<0.5	<0.5	<0.5	<0.5	NA	NA	NM	

OAKIC\ARCO\4931\QTRLY\4931q100.xls\sh:1
 Recated from electronic data provided by IT Corporation.

IT CORPORATION

Table 1
Groundwater Elevation and Analytical Data
Total Purgeable Petroleum Hydrocarbons
(TPPH as Gasoline, BTEX Compounds, and MTBE)

ARCO Service Station 4931
731 West MacArthur Boulevard, Oakland, California

Well Number	Date Gauged/ Sampled	Well Elevation (feet, MSL)	Depth to Water (feet, TOB)	Groundwater Elevation (feet, MSL)	TPH				Total Xylenes (ppb)	MTBE 8021B* (ppb)	MTBE 8260 (ppb)	Dissolved Oxygen (ppm)	Purged/ Not Purged (P/NP)	
					Gasoline (ppb)	Benzene (ppb)	Toluene (ppb)	Ethyl- benzene (ppb)						
A-9	08/22/96	53.04	9.68	43.36	<50	<0.5	<0.5	<0.5	<0.5	8.5	NA	NM		
A-9	12/19/96	53.04	7.43	45.61	<50	<0.5	<0.5	<0.5	<0.5	2.6	NA	NM		
A-9	04/01/97	53.04	9.95	43.09	Not Sampled: Well Sampled Semiannually				<0.5	45	NA	NM		
A-9	05/27/97	53.04	9.56	43.48	<50	2.3	<0.5	<0.5	<0.5					
A-9	08/12/97	53.04	10.15	42.89	Not Sampled: Well Sampled Semiannually				<0.5					
A-9	11/14/97	53.04	8.64	44.40	<200	<2.0	<2.0	<2.0	<2.0	190	NA	9.6		
A-9	03/18/98	53.04	6.45	46.59	Not Sampled: Well Sampled Semiannually				<0.5					
A-9	05/19/98	53.04	8.35	44.69	<50	<0.5	<0.5	<0.5	<0.5	7	NA	1.27	P	
A-9	07/29/98	53.04	8.74	44.30	<50	<0.5	<0.5	<0.5	<0.5	<3	NA	0.99	NP	
A-9	10/09/98	53.04	10.05	42.99	<50	<0.5	<0.5	<0.5	<0.5	<3	NA	1.0	NP	
A-9	02/19/99	53.04	6.91	46.13	<50	<0.5	<0.5	<0.5	<0.5	<3	NA	2.0	NP	
A-9	06/02/99	53.04	9.72	43.32	<50	<0.5	<0.5	<0.5	<0.5	<3	NA	2.32	NP	
A-9	08/26/99	53.04	9.48	43.56	<50	<0.5	<0.5	<0.5	<0.5	16	NA	0.71	NP	
A-9	10/26/99	53.04	9.17	43.87	1,500	6.2	0.7	78	11	91	NA	2.15	NP	
A-9	02/25/00	53.04	5.84	47.20	<50	<0.5	<0.5	<0.5	<1	<3	NA	1.55	NP	
A-10	03/26/96	54.26	8.28	45.98	Not Sampled: Well Removed from Sampling Program									
A-10	05/22/96	54.26	8.60	45.66	Not Sampled: Well Removed from Sampling Program									
A-10	08/22/96	54.26	10.98	43.28	Not Sampled: Well Removed from Sampling Program									
A-10	12/19/96	54.26	8.80	45.46	Not Sampled: Well Removed from Sampling Program									
A-10	04/01/97	54.26	11.15	43.11	Not Sampled: Well Removed from Sampling Program									
A-10	05/27/97	54.26	10.90	43.36	Not Sampled: Well Removed from Sampling Program									
A-10	08/12/97	54.26	11.30	42.96	Not Sampled: Well Removed from Sampling Program									
A-10	11/14/97	54.26	10.80	43.46	Not Sampled: Well Removed from Sampling Program									
A-10	03/18/98				Well Removed from Survey Program									
A-11	03/26/96	53.74	8.10	45.64	Not Sampled: Well Sampled Semiannually									
A-11	05/22/96	53.74	8.25	45.49	<50	<0.5	<0.5	<0.5	<0.5	NA	NA	NM		
A-11	08/22/96	53.74	10.58	43.16	Not Sampled: Well Sampled Semiannually									
A-11	12/19/96	53.74	8.37	45.37	<50	<0.5	<0.5	<0.5	<0.5	<2.5	NA	NM		
A-11	04/01/97	53.74	10.95	42.79	Not Sampled: Well Sampled Semiannually									
A-11	05/27/97	53.74	10.60	43.14	<50	<0.5	<0.5	<0.5	<0.5	3.1	NA	NM		

OAKIC:\ARCOM4931\QTRLY4931\q100.xls\ahz1
 Recreated from electronic data provided by IT Corporation.

IT CORPORATION

Table 1
Groundwater Elevation and Analytical Data
Total Purgeable Petroleum Hydrocarbons
(TPPH as Gasoline, BTEX Compounds, and MTBE)

ARCO Service Station 4931
731 West MacArthur Boulevard, Oakland, California

Well Number	Date Gauged/ Sampled	Well Elevation (feet, MSL)	Depth to Water (feet, TOB)	Groundwater Elevation (feet, MSL)	TPH Gasoline (ppb)	Benzene (ppb)	Toluene (ppb)	Ethyl- benzene (ppb)	Total Xylenes (ppb)	MTBE 8021B* (ppb)	MTBE 8260 (ppb)	Dissolved Oxygen (ppm)	Purged/ Not Purged (P/NP)
A-11	08/12/97	53.74	11.07	42.67	Not Sampled: Well Sampled Semiannually								
A-11	11/14/97	53.74	10.58	43.16	<50	<0.5	<0.5	<0.5	<0.5	<3	NA	1.6	
A-11	03/18/98	53.74	8.14	45.60	Not Sampled: Well Sampled Semiannually								
A-11	05/19/98	53.74	9.40	44.34	<50	<0.5	<0.5	<0.5	<0.5	<3	NA	1.13	P
A-11	07/29/98	53.74	10.32	43.42	Not Sampled: Well Sampled Semiannually								
A-11	10/09/98	53.74	10.91	42.83	<50	<0.5	<0.5	<0.5	<0.5	<3	NA	2.0	NP
A-11	02/19/99	53.74	6.77	46.97	<50	<0.5	<0.5	<0.5	<0.5	<3	NA	1.8	NP
A-11	06/02/99	53.74	10.95	42.79	<50	<0.5	<0.5	<0.5	<0.5	6	NA	1.38	NP
A-11	08/26/99	53.74	11.05	42.69	Not Sampled: Well Sampled Semiannually								
A-11	10/26/99	53.74	10.81	42.93	<50	<0.5	<0.5	<0.5	<1	4	NA	0.49	NP
A-11	02/25/00	53.74	6.70	47.04	Not Sampled: Well Sampled Semiannually								
A-12	03/26/96	52.05	7.83	44.22	Not Sampled: Well Sampled Semiannually								
A-12	05/22/96	52.05	7.80	44.25	<50	<0.5	<0.5	<0.5	<0.5	NA	NA	NM	
A-12	08/22/96	52.05	9.97	42.08	Not Sampled: Well Sampled Semiannually								
A-12	12/19/96	52.05	8.18	43.87	85	<0.5	<0.5	<0.5	<0.5	170	NA	NM	
A-12	04/01/97	52.05	10.30	41.75	Not Sampled: Well Sampled Semiannually								
A-12	05/27/97	52.05	10.05	42.00	50	12	<0.5	<0.5	<0.5	96	NA	NM	
A-12	08/12/97	52.05	10.46	41.59	Not Sampled: Well Sampled Semiannually								
A-12	11/14/97	52.05	9.70	42.35	<50	<0.5	<0.5	<0.5	<0.5	75	NA	7.0	
A-12	03/18/98	52.05	8.15	43.90	Not Sampled: Well Sampled Semiannually								
A-12	05/19/98	52.05	9.15	42.90	<50	<0.5	<0.5	<0.5	<0.5	29	NA	1.47	P
A-12	07/29/98	52.05	9.38	42.67	Not Sampled: Well Sampled Semiannually								
A-12	10/09/98	52.05	10.21	41.84	<50	<0.5	<0.5	<0.5	<0.5	7	NA	2.0	NP
A-12	02/19/99	52.05	6.96	45.09	<50	<0.5	<0.5	<0.5	<0.5	<3	NA	5.2	NP
A-12	06/02/99	52.05	10.25	41.80	<50	<0.5	<0.5	<0.5	<0.5	7	NA	1.38	NP
A-12	08/26/99	52.05	9.91	42.14	Not Sampled: Well Sampled Semiannually								
A-12	10/26/99	52.05	9.73	42.32	<50	<0.5	<0.5	<0.5	<1	12	NA	0.51	NP
A-12	02/25/00	52.05	6.97	45.08	Not Sampled: Well Sampled Semiannually								
A-13	03/26/96	55.11			Well Inaccessible								
A-13	05/22/96	55.11			Well Inaccessible								

DAKIC:\ARCOM931\QTRLYM931q102.xls\wh:1
 Recreated from electronic data provided by IT Corporation.

IT CORPORATION

Table 1
Groundwater Elevation and Analytical Data
Total Purgeable Petroleum Hydrocarbons
(TPPH as Gasoline, BTEX Compounds, and MTBE)
ARCO Service Station 4931
731 West MacArthur Boulevard, Oakland, California

Well Number	Date Gauged/ Sampled	Well Elevation (feet, MSL)	Depth to Water (feet, TOB)	Groundwater Elevation (feet, MSL)	TPH Gasoline (ppb)	Benzene (ppb)	Toluene (ppb)	Ethyl- benzene (ppb)	Total Xylenes (ppb)	MTBE 8021B* (ppb)	MTBE 8260 (ppb)	Dissolved Oxygen (ppm)	Purged/ Not Purged (P/NP)
A-13	08/22/96	55.11											
A-13	12/19/96	55.11											Well Inaccessible
A-13	04/01/97	55.11											Well Inaccessible
A-13	05/27/97	55.11											Well Inaccessible
A-13	08/12/97	55.11											Well Inaccessible
A-13	11/14/97	55.11											Well Inaccessible
A-13	03/18/98	55.11											Well Inaccessible
A-13	05/19/98	55.11											Well Inaccessible
A-13	07/29/98	55.11											Well Inaccessible
A-13	10/09/98	55.11											Well Inaccessible
A-13	02/19/99	55.11											Well Inaccessible
A-13	06/02/99	55.11											Well Inaccessible
A-13	08/26/99	55.11											Well Inaccessible
A-13	10/26/99	55.11											Well Inaccessible
A-13	02/25/00	55.11											Well Inaccessible
AR-1	03/26/96	54.72	8.13	46.59	6,200	110	64	38	520	NA	NA		NM
AR-1	05/22/96	54.72	8.57	46.15	NS	NS	NS	NS	NS	NS	NS		NM
AR-1	08/22/96	54.72	10.97	43.75	5,600	100	28	29	310	960	NA		NM
AR-1	12/19/96	54.72	8.93	45.79	Not Sampled: Well Removed from Sampling Program								
AR-1	04/01/97	54.72	11.78	42.94	Not Sampled: Well Removed from Sampling Program								
AR-1	05/27/97	54.72	10.76	43.96	Not Sampled: Well Removed from Sampling Program								
AR-1	08/12/97	54.72	11.40	43.32	Not Sampled: Well Removed from Sampling Program								
AR-1	11/14/97	54.72	10.80	43.92	Not Sampled: Well Removed from Sampling Program								
AR-1	03/18/98	54.72	NM	NM	Not Sampled: Well Removed from Sampling Program								
AR-1	05/19/98	54.72	NM	NM	Not Sampled: Well Removed from Sampling Program								
AR-1	07/29/98	54.72	10.17	44.55	Not Sampled: Well Removed from Sampling Program								
AR-1	10/09/98	54.72	11.25	43.47	Not Sampled: Well Removed from Sampling Program								
AR-1	02/19/99	54.72	7.02	47.70	Not Sampled: Well Removed from Sampling Program								
AR-1	06/02/99	54.72	11.00	43.72	Not Sampled: Well Removed from Sampling Program								
AR-1	08/26/99	54.72	10.96	43.76	Not Sampled: Well Removed from Sampling Program								
AR-1	10/26/99	54.72	10.68	44.04	Not Sampled: Well Removed from Sampling Program								0.39
													1.39

OAKC:\ARCOM93\QTRLY4931q100.xls#uh:1
 Recreated from electronic data provided by IT Corporation.

Table 1
Groundwater Elevation and Analytical Data
Total Purgeable Petroleum Hydrocarbons
(TPPH as Gasoline, BTEX Compounds, and MTBE)

ARCO Service Station 4931
731 West MacArthur Boulevard, Oakland, California

Well Number	Date Gauged/ Sampled	Well Elevation (feet, MSL)	Depth to Water (feet, TOB)	Groundwater Elevation (feet, MSL)	TPH Gasoline (ppb)	Benzene (ppb)	Toluene (ppb)	Ethyl- benzene (ppb)	Total Xylenes (ppb)	MTBE 8021B* (ppb)	MTBE 8260 (ppb)	Dissolved Oxygen (ppm)	Purged/ Not Purged (P/NP)
AR-1	02/25/00	54.72	7.15	47.57	Not Sampled: Well Removed from Sampling Program								
AR-2	03/26/96	54.77	4.93	49.84	<50	<0.5	<0.5	<0.5	<0.5	NA	NA	NM	
AR-2	05/22/96	54.77	5.65	49.12	NS	NS	NS	NS	NS	NS	NS	NM	
AR-2	08/22/96	54.77	7.27	47.50	<50	<0.5	<0.5	<0.5	<0.5	200	NA	NM	
AR-2	12/19/96	54.77	7.78	46.99	Not Sampled: Well Removed from Sampling Program								
AR-2	04/01/97	54.77	6.80	47.97	Not Sampled: Well Removed from Sampling Program								
AR-2	05/27/97	54.77	6.32	48.45	Not Sampled: Well Removed from Sampling Program								
AR-2	08/12/97	54.77	7.43	47.34	Not Sampled: Well Removed from Sampling Program								
AR-2	11/14/97	54.77	8.95	45.82	Not Sampled: Well Removed from Sampling Program								
AR-2	03/18/98	54.77	NM	NM	Not Sampled: Well Removed from Sampling Program								
AR-2	05/19/98	54.77	NM	NM	Not Sampled: Well Removed from Sampling Program								
AR-2	07/29/98	54.77	4.47	50.30	Not Sampled: Well Removed from Sampling Program								
AR-2	10/09/98	54.77	6.90	47.87	Not Sampled: Well Removed from Sampling Program								
AR-2	02/19/99	54.77	3.80	50.97	Not Sampled: Well Removed from Sampling Program								
AR-2	06/02/99	54.77	4.61	50.16	Not Sampled: Well Removed from Sampling Program								
AR-2	08/26/99	54.77	5.22	49.55	Not Sampled: Well Removed from Sampling Program								
AR-2	10/26/99	54.77	3.20	51.57	Not Sampled: Well Removed from Sampling Program								
AR-2	02/25/00	54.77	2.33	52.44	Not Sampled: Well Removed from Sampling Program								
AR-3	03/26/96	54.19	7.95	46.24	<50	<0.5	<0.5	<0.5	<0.5	NA	NA	NM	
AR-3	05/22/96	54.19	8.30	45.89	NS	NS	NS	NS	NS	NS	NS	NM	
AR-3	08/22/96	54.19	10.84	43.35	Not Sampled: Well Removed from Sampling Program								
AR-3	12/19/96	54.19	8.56	45.63	Not Sampled: Well Removed from Sampling Program								
AR-3	04/01/97	54.19	11.24	42.95	Not Sampled: Well Removed from Sampling Program								
AR-3	05/27/97	54.19	10.67	43.52	Not Sampled: Well Removed from Sampling Program								
AR-3	08/12/97	54.19	11.10	43.09	Not Sampled: Well Removed from Sampling Program								
AR-3	11/14/97	54.19	10.60	43.59	Not Sampled: Well Removed from Sampling Program								
AR-3	03/18/98	54.19	NM	NM	Not Sampled: Well Removed from Sampling Program								
AR-3	05/19/98	54.19	NM	NM	Not Sampled: Well Removed from Sampling Program								
AR-3	07/29/98	54.19	9.95	44.24	Not Sampled: Well Removed from Sampling Program								
AR-3	10/09/98	54.19	11.20	42.99	Not Sampled: Well Removed from Sampling Program								

OAKV:ARCO4931QTRLY4931q100.xls:tbl1
 Recasted from electronic data provided by IT Corporation.

IT CORPORATION

Table 1
Groundwater Elevation and Analytical Data
Total Purgeable Petroleum Hydrocarbons
(TPPH as Gasoline, BTEX Compounds, and MTBE)

ARCO Service Station 4931
731 West MacArthur Boulevard, Oakland, California

Well Number	Date Ganged/ Sampled	Well Elevation (feet, MSL)	Depth to Water (feet, TOB)	Groundwater Elevation (feet, MSL)	TPH Gasoline (ppb)	Benzene (ppb)	Toluene (ppb)	Ethyl- benzene (ppb)	Total Xylenes (ppb)	MTBE 8021B* (ppb)	MTBE 8260 (ppb)	Dissolved Oxygen (ppm)	Purged/ Not Purged (P/NP)
AR-3	02/19/99	54.19	6.98	47.21	Not Sampled: Well Removed from Sampling Program								
AR-3	06/02/99	54.19	10.80	43.39	Not Sampled: Well Removed from Sampling Program								
AR-3	08/26/99	54.19	10.69	43.50	Not Sampled: Well Removed from Sampling Program								
AR-3	10/26/99	54.19	NM	NM	Not Sampled: Well Removed from Sampling Program							0.40	
AR-3	02/25/00	54.19	7.21	46.98	Not Sampled: Well Removed from Sampling Program								

TPH	- Total petroleum hydrocarbons by modified EPA method 8015
BTEX	- Benzene, toluene, ethylbenzene, total xylenes by EPA method 8021B. (EPA method 8020 prior to 10/26/99).
MTBE	- Methyl tert-butyl ether
*	- EPA method 8020 prior to 10/26/99
MSL	- Mean sea level
TOB	- Top of box
ppb	- Parts per billion
ppm	- Parts per million
<	- Less than laboratory detection limit stated to the right
NA	- Not analyzed
NM	- Not measured
NS	- Not sampled

Table 2
Groundwater Flow Direction and Gradient

ARCO Service Station 4931
731 West MacArthur Boulevard, Oakland, California

Date Measured	Average Flow Direction	Average Hydraulic Gradient
03/26/96	Southwest	0.03
05/22/96	Southwest	0.04
08/22/96	Southwest	0.02
12/19/96	Southwest	0.03
04/01/97	Southwest	0.03
05/27/97	Southwest	0.04
08/12/97	Southwest	0.02
11/14/97	Southwest	0.02
03/18/98	West	0.03
05/19/98	West-Southwest	0.02
07/29/98	West-Southwest	0.02
10/09/98	Southwest	0.007
02/19/99	Southwest	0.04
06/02/99	West	0.04
08/26/99	West-Southwest	0.02
10/26/99	West-Northwest	0.13
02/25/00	West-Southwest	0.05

ATTACHMENT D

EDCC REPORT AND EDF/GEOWELL SUBMITTAL CONFIRMATION

<h2>AB2886 Electronic Delivery</h2> <p>Main Menu View/Add Facilities Upload EDD Check EDD</p>	
UPLOADING A GEO_WELL FILE	
Processing is complete. No errors were found! Your file has been successfully submitted!	
<u>Submittal Title:</u>	QMR Geowell Q2 2004 Site 4931
<u>Submittal Date/Time:</u>	5/26/2004 10:12:00 AM
<u>Confirmation Number:</u>	5050979435
Back to Main Menu	

Logged in as URSCORP-OAKLAND
(CONTRACTOR)

CONTACT SITE [ADMINISTRATOR](#).

AB2886 Electronic Delivery

[Main Menu](#) | [View/Add Facilities](#) | [Upload EDD](#) | [Check EDD](#)

Your EDF file has been successfully uploaded!

Confirmation Number: 1004078567

Date/Time of Submittal: 5/26/2004 10:02:48 AM

Facility Global ID: T0600100110

Facility Name: ARCO

Submittal Title: QMR Q2 2004 Site 4931

Submittal Type: GW Monitoring Report

Logged in as URSCORP-OAKLAND
(CONTRACTOR)

CONTACT SITE [ADMINISTRATOR](#).

Error Summary Log

05/27/04

EDF 1.2i All files present in deliverable.

Laboratory:	Sequoia Analytical Laboratories, Inc., Morgan Hill, CA
Project Name:	ARCO #4931, Oakland, CA
Work Order Number:	MNE0142
Global ID:	T0600100107
Lab Report Number:	MNE0142052520041652

Report Summary

Labreport	Sampid	Labsampid	Mtrx	QC	Anmcode	Exmcode	Logdate	Extdate	Anadate	Lablotcti	Run Sub
MNE01420525200 A-4 41652		MNE014201	W	CS	8260FA	SW5030B	05/04/04	05/18/04	05/18/04	4E18003	1
MNE01420525200 A-8 41652		MNE014202	W	CS	8260FA	SW5030B	05/04/04	05/18/04	05/18/04	4E18003	1
		4E18003BSD1	WQ	BD1	8260FA	SW5030B	//	05/18/04	05/19/04	4E18003	1
		4E18003BSD2	WQ	BD2	8260FA	SW5030B	//	05/18/04	05/19/04	4E18003	1
		4E18003BS1	WQ	BS1	8260FA	SW5030B	//	05/18/04	05/18/04	4E18003	1
		4E18003BS2	WQ	BS2	8260FA	SW5030B	//	05/18/04	05/18/04	4E18003	1
		4E18003BLK1	WQ	LB1	8260FA	SW5030B	//	05/18/04	05/18/04	4E18003	1

EDFSAMP: Error Summary Log

05/27/04

Error type	Logcode	Projname	Npd/wo	Sampid	Matrix
There are no errors in this data file					

EDFTEST: Error Summary Log

05/27/04

Error type	Labsampid	Qccode	Anmcode	Exmcode	Anadate	Run number
There are no errors in this data file					//	0

EDFRES: Error Summary Log

05/27/04

Error type	Labsampid	Qccode	Matrix	Anmcode	Pvccode	Anadate	Run number	Partabel
Warning: extra parameter	MNE014201	CS	W	8260FA	PR	05/18/04	1	BZ
Warning: extra parameter	MNE014201	CS	W	8260FA	PR	05/18/04	1	BZME
Warning: extra parameter	MNE014201	CS	W	8260FA	PR	05/18/04	1	DCA12D4
Warning: extra parameter	MNE014201	CS	W	8260FA	PR	05/18/04	1	EBZ
Warning: extra parameter	MNE014201	CS	W	8260FA	PR	05/18/04	1	GROC4C12
Warning: extra parameter	MNE014201	CS	W	8260FA	PR	05/18/04	1	XYLENES
Warning: extra parameter	MNE014202	CS	W	8260FA	PR	05/18/04	1	BZ
Warning: extra parameter	MNE014202	CS	W	8260FA	PR	05/18/04	1	BZME
Warning: extra parameter	MNE014202	CS	W	8260FA	PR	05/18/04	1	DCA12D4
Warning: extra parameter	MNE014202	CS	W	8260FA	PR	05/18/04	1	EBZ
Warning: extra parameter	MNE014202	CS	W	8260FA	PR	05/18/04	1	GROC4C12
Warning: extra parameter	MNE014202	CS	W	8260FA	PR	05/18/04	1	XYLENES
Warning: extra parameter	4E18003BLK1	LB1	WQ	8260FA	PR	05/18/04	1	BZ
Warning: extra parameter	4E18003BLK1	LB1	WQ	8260FA	PR	05/18/04	1	BZME
Warning: extra parameter	4E18003BLK1	LB1	WQ	8260FA	PR	05/18/04	1	DCA12D4
Warning: extra parameter	4E18003BLK1	LB1	WQ	8260FA	PR	05/18/04	1	EBZ
Warning: extra parameter	4E18003BLK1	LB1	WQ	8260FA	PR	05/18/04	1	GROC4C12
Warning: extra parameter	4E18003BLK1	LB1	WQ	8260FA	PR	05/18/04	1	XYLENES
Warning: extra parameter	4E18003BS1	BS1	WQ	8260FA	PR	05/18/04	1	BZ
Warning: extra parameter	4E18003BS1	BS1	WQ	8260FA	PR	05/18/04	1	BZME
Warning: extra parameter	4E18003BS1	BS1	WQ	8260FA	PR	05/18/04	1	DCA12D4
Warning: extra parameter	4E18003BS1	BS1	WQ	8260FA	PR	05/18/04	1	EBZ
Warning: extra parameter	4E18003BS1	BS1	WQ	8260FA	PR	05/18/04	1	XYLENES
Warning: extra parameter	4E18003BS2	BS2	WQ	8260FA	PR	05/18/04	1	DCA12D4
Warning: extra parameter	4E18003BS2	BS2	WQ	8260FA	PR	05/18/04	1	GROC4C12

Error type	Labsampid	Qccode	Matrix	Anmcode	Pvccode	Anadate	Run number	Parlabel
Warning: extra parameter	4E18003BSD1	BD1	WQ	8260FA	PR	05/19/04	1	BZ
Warning: extra parameter	4E18003BSD1	BD1	WQ	8260FA	PR	05/19/04	1	BZME
Warning: extra parameter	4E18003BSD1	BD1	WQ	8260FA	PR	05/19/04	1	DCA12D4
Warning: extra parameter	4E18003BSD1	BD1	WQ	8260FA	PR	05/19/04	1	EBZ
Warning: extra parameter	4E18003BSD1	BD1	WQ	8260FA	PR	05/19/04	1	XYLENES
Warning: extra parameter	4E18003BSD2	BD2	WQ	8260FA	PR	05/19/04	1	DCA12D4
Warning: extra parameter	4E18003BSD2	BD2	WQ	8260FA	PR	05/19/04	1	GROC4C12

EDFQC: Error Summary Log

05/27/04

Error type	Lablotctf	Anmcode	Parlabel	Qccode	Labqid
There are no errors in this data files					

EDFCL: Error Summary Log

05/27/04

Error type	Cirevdate	Anmcode	Exmcode	Parlabel	Cicode
There are no errors in this data file	//				