

RO-075



3330 Cameron Park Drive, Ste 550  
Cameron Park, California 95682  
(530) 676-6004 ~ Fax: (530) 676-6005

April 30, 2003  
Project No. 2002-0945-01

Ms. Eva Chu  
Hazardous Materials Specialist  
Alameda County Health Care Services  
Environmental Health Services  
1131 Harbor Bay Parkway, Suite 250  
Alameda, CA 94502-6577

Alameda County  
MAY 06 2003  
Environmental Health

Re: Well Abandonment Report  
Interstate Brands Corporation Facility  
945 53<sup>rd</sup> Street  
Oakland, California

Stratus Environmental, Inc. (Stratus) has prepared this letter, on behalf of Interstate Brands Corporation (IBC), to document the abandonment of three groundwater monitoring wells at the IBC Facility, located at 945 53<sup>rd</sup> Street, Oakland, California (Figure 1).

In a letter dated January 14, 2002, Stratus proposed the site for closure. Alameda County Health Care Services (ACHCS) concurred with the closure request in a letter dated September 17, 2001, stating a "No Further Action" letter would be issued after monitoring wells at the site were properly abandoned. Monitoring wells MW-1, MW-2, and MW-3 are 4-inch diameter groundwater monitoring wells situated adjacent to the former underground storage tank (UST) pit. Well locations are shown on Figure 2.

**Field Activities**

Prior to implementation of field activities, permits to abandon the groundwater monitoring wells were obtained from Alameda County Public Works Agency (ACPWA). Underground Service Alert, ACHCS and ACPWA were notified 48 hours prior to beginning work activities. Copies of the approved well destruction permit application forms are presented in Appendix A.

Doulos Environmental, Inc. of Orangevale, California (C57 #730042), abandoned monitoring wells MW-1, MW-2, and MW-3 on April 10, 2003. Each well was abandoned by pressure grouting to 20 feet below ground surface. Wells MW-1, MW-2, and MW-3 took 40, 44, and 41 gallons of grout, respectively. All borings were subsequently backfilled with neat cement up to surface grade. The upper 3 feet of well casing was destroyed with a jackhammer and removed from the boreholes. The well boxes of each abandoned well

were removed and the surface was finished to match the surrounding area. Stratus completed California Department of Water Resources (DWR) well destruction forms and returned the completed forms to DWR. Copies of the well destruction permits and DWR well destruction forms are presented in Appendix A. A copy of Doulos Environmental's field data sheet is included in Appendix B.

Sincerely,

*STRATUS ENVIRONMENTAL, INC.*

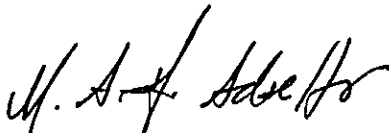

Marie H. Adsetts  
Staff Geologist

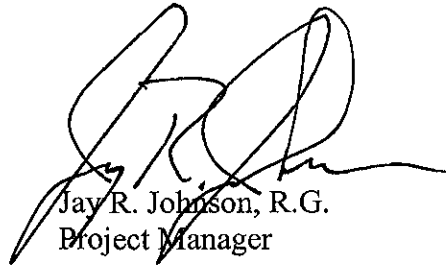

Jay R. Johnson, R.G.  
Project Manager

Attachments: Figure 1 Site Location Map  
Figure 2 Site Plan  
Appendix A Permits to Abandon Wells and DWR Well Completion Forms  
Appendix B Field Data Sheet

cc: Mr. Travis Bryant, Interstate Brands Corporation

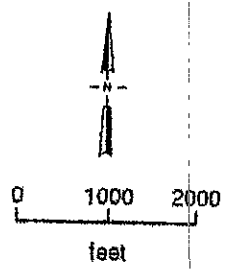
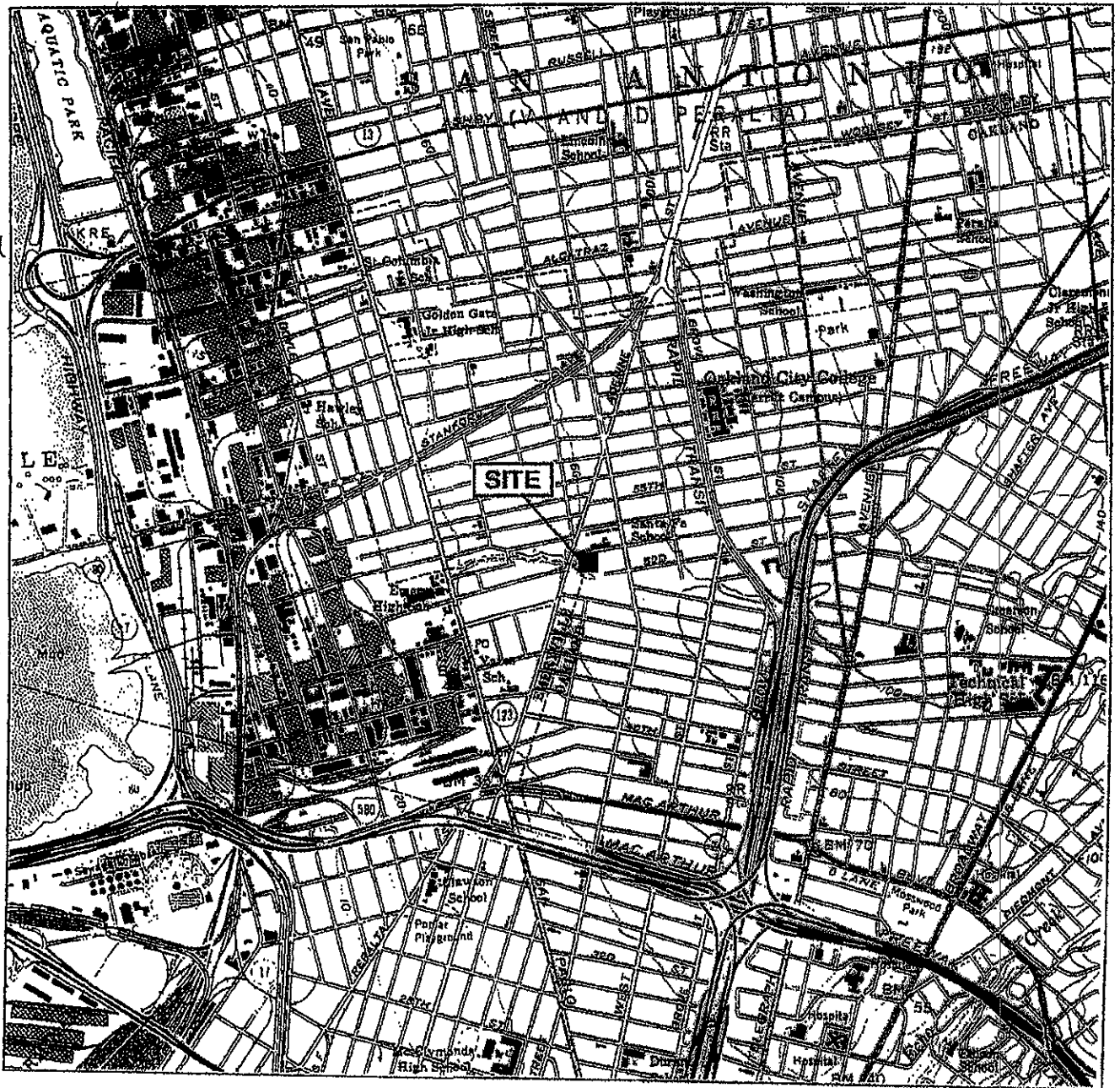

|                            |   |               |             |
|----------------------------|---|---------------|-------------|
| Project No.<br>92CB040     | Interstate Brands Corporation<br>1010 46th St., Oakland, CA | SITE LOCATION | Figure<br>1 |
| Woodward-Clyde Consultants |   |               |             |

92CB040 0000061803

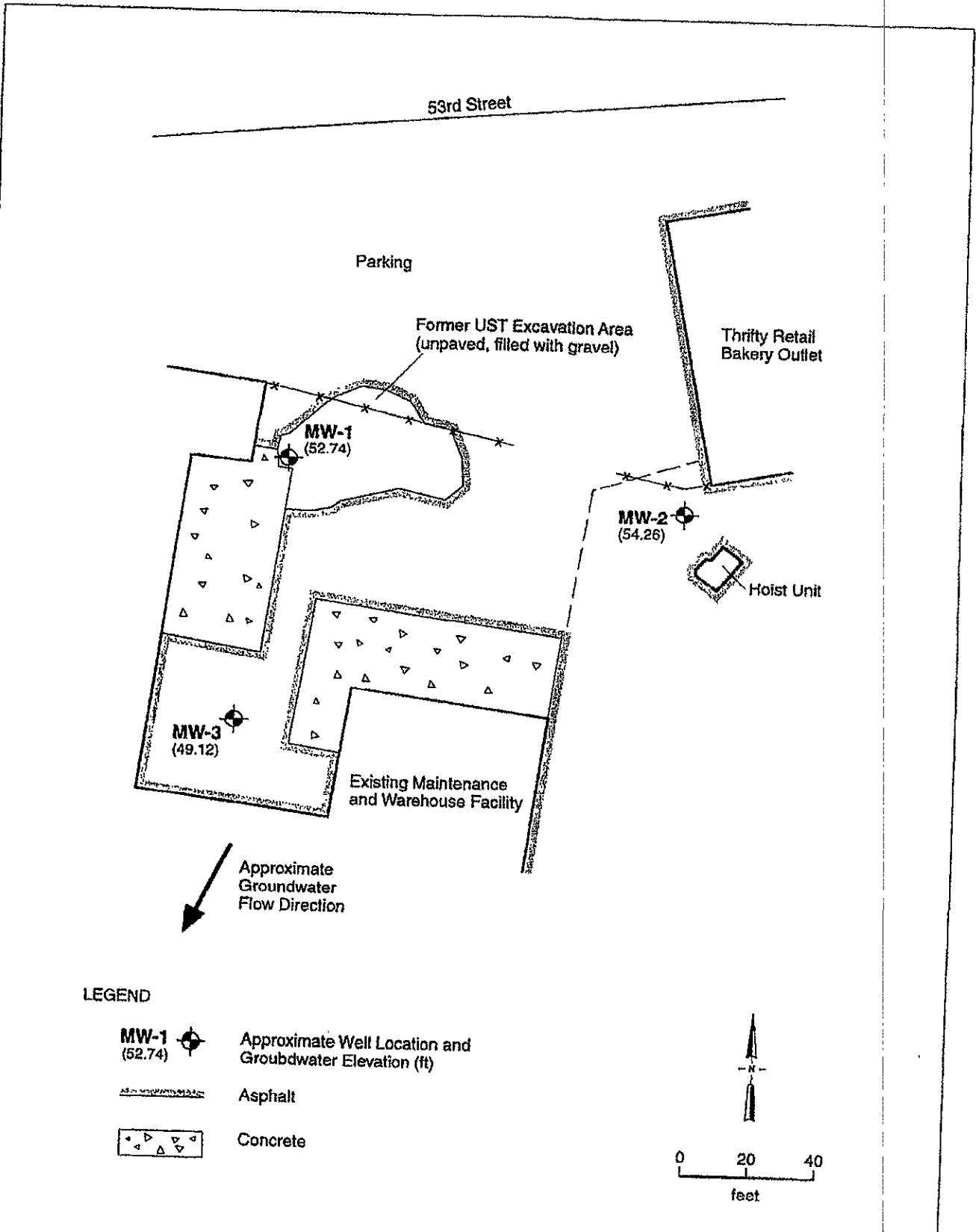

|                                   |  |   |             |
|-----------------------------------|--|---|-------------|
| Project No.<br>92CB040            | Interstate Brands Corporation<br>1010 46th Street, Oakland, CA | <b>MONITORING WELL LOCATIONS AND<br/>GROUNDWATER ELEVATIONS</b><br>JULY 8, 1996 | Figure<br>2 |
| <b>Woodward-Clyde Consultants</b> |  |   |             |

**APPENDIX A**

**PERMITS TO ABANDON WELLS  
AND  
DWR WELL COMPLETION FORMS**

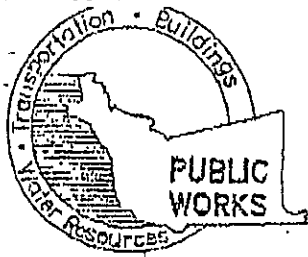

**FILE COPY**

COUNTY OF ALAMEDA  
PUBLIC WORKS AGENCY  
WATER RESOURCES SECTION  
399 Elmhurst Street, Hayward, CA 94544-1395  
James Yoo P/E: (510) 670-6633 FAX (510) 782-1939

*IBC-Oakland  
(permits)*

## FAX TRANSMITTAL

TO: *Stratus Env't, Inc*  
Attn: *Scott Bittinger*

DATE: *3/8-03*

FAX NO.: *(530) 696-6005*  
TRANSMITTING THE FOLLOWING:

SHEETS      DATED      TITLE/DESCRIPTION

*1 - DPA-103-0199-0207*

*(5)* TOTAL PAGES INCLUDING THIS SHEET.

FROM WATER RESOURCES SECTION:

NAME: JAMES YOO

TEL: (510) 670-6633

FAX: (510) 782-1939

E-MAIL: jamesy@acpwa.mail.co.alameda.ca.us

IF YOU EXPERIENCE PROBLEMS WITH THIS TRANSMISSION, PLEASE CALL ME.

REMARKS:

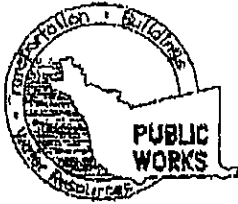

# ALAMEDA COUNTY PUBLIC WORKS AGENCY

WATER RESOURCES SECTION  
399 ELMHURST ST. HAYWARD CA. 94544-1395  
PHONE: (510) 670-6633 JMW:Voa  
FAX: (510) 782-1930

APPLICANTS: PLEASE ATTACH A SITE MAP FOR ALL DRILLING PERMIT APPLICATIONS  
DESTRUCTION OF WELLS OVER 45 FEET REQUIRES A SEPARATE PERMIT APPLICATION

## DRILLING PERMIT APPLICATION

FOR APPLICANT TO COMPLETE

FOR OFFICE USE

LOCATION OF PROJECT 945 53rd Street, Oakland

PERMIT NUMBER W03-0199  
WELL NUMBER \_\_\_\_\_  
APN \_\_\_\_\_

CLIENT  
Name International Brands Corporation  
Address 945 53rd St. Phone \_\_\_\_\_  
City Oakland, CA Zip \_\_\_\_\_

APPLICANT  
Name Dr. Frank's Environmental, Inc.  
Address 2310 Canyon Peak Dr. #100 Phone 530-427-6005  
City Concord, CA Zip 94562

TYPE OF PROJECT  
Well Construction  Geotechnical Investigation   
Cathodic Protection  General   
Water Supply  Contamination   
Monitoring  Well Destruction

PROPOSED WATER SUPPLY WELL USE  
New Domestic  Replacement Domestic   
Municipal  Irrigation   
Industrial  Other

DRILLING METHOD:  
Mud Rotary  Air Rotary  Auger   
Cable  Other  pressure grout

DRILLER'S NAME Dr. Frank's Environmental, Inc.

DRILLER'S LICENSE NO. C57# 730042

WELL PROJECTS  
Drill Hole Diameter 10 in. Maximum Depth 20 ft.  
Casing Diameter 4 in. Owner's Well Number MW-1  
Surface Seal Depth 5 ft.

GEOTECHNICAL PROJECTS  
Number of Borings \_\_\_\_\_ Maximum Hole Diameter \_\_\_\_\_ ft. Depth \_\_\_\_\_ ft.

STARTING DATE 4-7-03 (probably complete on 4-8-03)

COMPLETION DATE 4-9-03

I hereby agree to comply with all requirements of this permit and Alameda County Ordinance No. 73-68.

APPLICANT'S SIGNATURE Scott Bittinger DATE 3-13-03

PLEASE PRINT NAME Scott Bittinger Rev. 9-18-02

### PERMIT CONDITIONS

Circled Permit Requirements Apply

#### A. GENERAL

1. A permit application should be submitted so as to arrive at the ACPWA office five days prior to proposed starting date.
2. Submit to ACPWA within 60 days after completion of permitted original Department of Water Resources Well Completion Report.
3. Permit is void if project not begun within 90 days of approval date.

#### B. WATER SUPPLY WELLS

1. Minimum surface seal thickness is two inches of cement grout placed by tremie.
2. Minimum seal depth is 50 feet for municipal and industrial wells or 30 feet for domestic and irrigation wells unless a lesser depth is specially approved.

#### C. GROUNDWATER MONITORING WELLS INCLUDING PIEZOMETERS

1. Minimum surface seal thickness is two inches of cement grout placed by tremie.
2. Minimum seal depth for monitoring wells is the maximum depth practicable or 20 feet.

#### D. GEOTECHNICAL

Backfill bore hole by tremie with cement grout or cement grout/sand mixture. Upper two-inch seal replaced in place or with compacted cuttings.

#### E. CATHODIC

Fill hole anodic zone with concrete placed by tremie.

#### F. WELL DESTRUCTION - PG#1 Attached.

Send a map of work site. A separate permit is required for wells deeper than 45 feet.

#### G. SPECIAL CONDITIONS

NOTE: One application may be submitted for each well or well destruction. Multiple borings on one application are acceptable for geotechnical and contamination investigations.

APPROVED \_\_\_\_\_

DATE 3-18-03

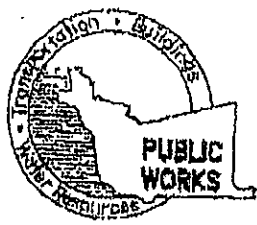

# ALAMEDA COUNTY PUBLIC WORKS AGENCY

**WATER RESOURCES SECTION**  
399 ELMHURST ST. HAYWARD CA. 94544-1395  
PHONE (510) 670-6633 James You  
FAX (510) 782-1939

APPLICANTS: PLEASE ATTACH A SITE MAP FOR ALL DRILLING PERMIT APPLICATIONS  
DESTRUCTION OF WELLS OVER 45 FEET REQUIRES A SEPARATE PERMIT APPLICATION

## DRILLING PERMIT APPLICATION

FOR APPLICANT TO COMPLETE

FOR OFFICE USE

LOCATION OF PROJECT 945 53rd Street, Oakland

\_\_\_\_\_  
\_\_\_\_\_

CLIENT  
Name International Brands Corporation  
Address 945 53rd St. Phone \_\_\_\_\_  
City Oakland, CA Zip \_\_\_\_\_

APPLICANT  
Name Stratus Environmental, Inc.  
Address 3070 Cuneo Park Dr. #700 Phone 510-676-1004  
City Castroville, CA Zip 95682

TYPE OF PROJECT  
Well Construction  Geotechnical Investigation   
Cathodic Protection  General   
Water Supply  Contamination   
Monitoring  Well Destruction

PROPOSED WATER SUPPLY WELL USE  
New Domestic  Replacement Domestic   
Municipal  Irrigation   
Industrial  Other \_\_\_\_\_

DRILLING METHOD:  
Mud Rotary  Air Rotary  Auger \_\_\_\_\_  
Cable  Other  pressure grout

DRILLER'S NAME Douglas Emission Control, Inc.

DRILLER'S LICENSE NO. C-57# 730042

WELL PROJECTS  
Drill Hole Diameter 10 in. Maximum Depth 20 ft.  
Casing Diameter 4 in. Owner's Well Number MW-7  
Surface Seal Depth 5 ft.

GEO TECHNICAL PROJECTS  
Number of Borings \_\_\_\_\_ Maximum Depth \_\_\_\_\_ ft.  
Hole Diameter \_\_\_\_\_ in.

STARTING DATE 4-7-03 (probably complete on 4-8-03)

COMPLETION DATE 4-9-03

I hereby agree to comply with all requirements of this permit and Alameda County Ordinance No. 73-6E.

APPLICANT'S SIGNATURE Scott Bittinger DATE 3-13-03

PLEASE PRINT NAME Scott Bittinger Rev. 9-18-02

PERMIT NUMBER W03-0200  
WELL NUMBER \_\_\_\_\_  
APN \_\_\_\_\_

### PERMIT CONDITIONS

Circled Permit Requirements Apply

- A. GENERAL
1. A permit application should be submitted so as to arrive at the ACPWA office five days prior to proposed starting date.
  2. Submit to ACPWA within 60 days after completion of permitted original Department of Water Resources-Well Completion Report.
  3. Permit is void if project not begun within 90 days of approval date.

- B. WATER SUPPLY WELLS
1. Minimum surface seal thickness is two inches of cement grout placed by tremie.
  2. Minimum seal depth is 50 feet for municipal and industrial wells or 20 feet for domestic and irrigation wells unless a lesser depth is specially approved.
- C. GROUNDWATER MONITORING WELLS INCLUDING PIEZOMETERS

1. Minimum surface seal thickness is two inches of cement grout placed by tremie.
  2. Minimum seal depth for monitoring wells is the maximum depth practicable or 20 feet.
- D. GEOTECHNICAL
- Backfill bore hole by tremie with cement grout or cement grout/sand mixture. Upper two-thirds feet replaced in kind or with compacted cuttings.

E. CATHODIC

Fill hole anode zone with concrete placed by tremie.

**F. WELL DESTRUCTION - PG# 7 Attached.**  
Send a map of work site. A separate permit is required for wells deeper than 45 feet.

### G. SPECIAL CONDITIONS

NOTE: One application must be submitted for each well or well destruction. Multiple borings on one application are acceptable for geotechnical and contamination investigations.

APPROVED [Signature] DATE 3-18-03



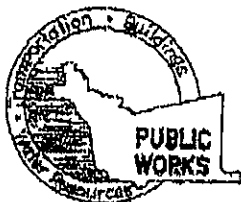

# ALAMEDA COUNTY PUBLIC WORKS AGENCY

WATER RESOURCES SECTION  
399 ELMHURST ST. HAYWARD CA. 94544-1993  
PHONE (510) 670-6633 James Yoo  
FAX (510) 782-1939

APPLICANTS: PLEASE ATTACH A SITE MAP FOR ALL DRILLING PERMIT APPLICATIONS  
DESTRUCTION OF WELLS OVER 45 FEET REQUIRES A SEPARATE PERMIT APPLICATION

## DRILLING PERMIT APPLICATION

FOR APPLICANT TO COMPLETE

FOR OFFICE USE

LOCATION OF PROJECT 945 53rd Street, Oakland

PERMIT NUMBER W03-0201  
WELL NUMBER \_\_\_\_\_  
APPN \_\_\_\_\_

CLIENT  
Name International Brands Corporation  
Address 945 53rd St. Phone \_\_\_\_\_  
City Oakland, CA Zip \_\_\_\_\_

APPLICANT  
Name Stratus Environmental, Inc.  
Address 8770 Cassman Park Dr. #150 Phone 530-461-6005  
City Castroville, CA Zip 95622

### TYPE OF PROJECT

|                     |                          |                            |                                     |
|---------------------|--------------------------|----------------------------|-------------------------------------|
| Well Construction   | <input type="checkbox"/> | Geotechnical Investigation | <input type="checkbox"/>            |
| Cathodic Protection | <input type="checkbox"/> | General                    | <input type="checkbox"/>            |
| Water Supply        | <input type="checkbox"/> | Contamination              | <input type="checkbox"/>            |
| Monitoring          | <input type="checkbox"/> | Well Destruction           | <input checked="" type="checkbox"/> |

### PROPOSED WATER SUPPLY WELL USE

|              |                          |                        |                          |
|--------------|--------------------------|------------------------|--------------------------|
| New Domestic | <input type="checkbox"/> | Aggricultural Domestic | <input type="checkbox"/> |
| Municipal    | <input type="checkbox"/> | Irrigation             | <input type="checkbox"/> |
| Industrial   | <input type="checkbox"/> | Other                  | <input type="checkbox"/> |

### DRILLING METHOD:

|            |                          |            |                                     |                |                          |
|------------|--------------------------|------------|-------------------------------------|----------------|--------------------------|
| Mud Rotary | <input type="checkbox"/> | Air Rotary | <input type="checkbox"/>            | Auger          | <input type="checkbox"/> |
| Cable      | <input type="checkbox"/> | Other      | <input checked="" type="checkbox"/> | pressure grout |                          |

DRILLER'S NAME Dubs Environmental, Inc.

DRILLER'S LICENSE NO. C57# 730042

### WELL PROJECTS

|                     |               |                     |               |
|---------------------|---------------|---------------------|---------------|
| Drill Hole Diameter | <u>10</u> in. | Maximum             |               |
| Casing Diameter     | <u>4</u> in.  | Depth               | <u>20</u> ft. |
| Surface Seal Depth  | <u>5</u> ft.  | Owner's Well Number | <u>MW-3</u>   |

### GEOTECHNICAL PROJECTS

|                   |           |         |           |
|-------------------|-----------|---------|-----------|
| Number of Borings | _____     | Maximum |           |
| Hole Diameter     | _____ in. | Depth   | _____ ft. |

STARTING DATE 4-7-03 (probably complete on 4-8-03)

COMPLETION DATE 4-9-03

I hereby agree to comply with all requirements of this permit and Alameda County Ordinance No. 73-68.

APPLICANT'S SIGNATURE Scott Bittinger DATE 3-13-03

PLEASE PRINT NAME Scott Bittinger Rev. 9-18-02

### PERMIT CONDITIONS

Circled Permit Requirements Apply

#### A. GENERAL

1. A permit application should be submitted so as to arrive at the ACPWA office five days prior to proposed starting date.
2. Submit to ACPWA within 60 days after completion of permitted original Department of Water Resources Well Completion Report.
3. Permit is void if project not begun within 90 days of approval date.

#### B. WATER SUPPLY WELLS

1. Minimum surface seal thickness is two inches of cement grout placed by tremie.
2. Minimum seal depth is 30 feet for municipal and industrial wells or 20 feet for domestic and irrigation wells unless a lesser depth is specially approved.

#### C. GROUNDWATER MONITORING WELLS INCLUDING PIETOMETERS

1. Minimum surface seal thickness is two inches of cement grout placed by tremie.
2. Minimum seal depth for monitoring wells is the maximum depth practicable or 20 feet.

#### D. GEOTECHNICAL

Backfill base hole by tremie with cement grout or cement grout/sand mixture. Upper two-three feet replaced in kind or with compacted cuttings.

#### E. CATHODIC

Fill hole and/or seal with concrete placed by tremie.  
F. WELL DESTRUCTION - P6-A-1 Attached.  
Send a map of work site. A separate permit is required for wells deeper than 45 feet.

#### G. SPECIAL CONDITIONS

NOTE: One application must be submitted for each well or well destruction. Multiple borings on one application are acceptable for geotechnical and contamination investigations.

APPROVED \_\_\_\_\_ DATE 3-18-03

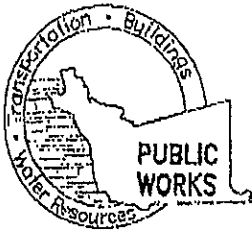

## ALAMEDA COUNTY PUBLIC WORKS AGENCY

### WATER RESOURCES SECTION

399 ELMHURST ST. HAYWARD, CA. 94544-1395

PHONE (510) 670-6633 James Yoo FAX (510) 782-1939

PERMIT NO. W03-0199-0201

---

### WATER RESOURCES SECTION GROUNDWATER PROTECTION ORDINANCE Destruction of Monitoring Wells (Less than 45 feet in depth)

#### Destruction Requirements: **PRESSURE GROUTING # 1**

1. Remove any casing(s) and annular seal to 3-5 feet below finished grade of original ground, whichever is the lower elevation.
2. Destroy well by grouting neat cement with a tremie pipe or pressure grouting (25 psi for 5min.) to the bottom of the well and by filling with neat cement to three (3-5) feet below surface grade. Allow the sealing material to spill over the top of the casing to fill any annular space between casing and soil.
3. After the seal has set, backfill the remaining hole with concrete or compacted material to match existing conditions.
4. Drilling permits are valid from the start date to the completion date. Permits can be extended by a phone call, but drilling permit applications will not be extended beyond 90 days from the approved start date.
5. Compliance with the above well-sealing specifications shall not exempt the well-sealing contractor from complying with appropriate state reporting-requirements related to well destruction (Sections 13750 through 13755 (Division 7, Chapter 10, Article 3) of the California Water Code). Contractor must complete State DWR Form 188 and mail original to the Alameda County Public Works Agency, Water Resources Section, within 60 days.
6. Permittee shall assume entire responsibility for all activities and uses under this permit and shall indemnify, defend and save the Alameda County Public Works Agency, its officers, agents, and employees free and harmless from any and all expense, cost, liability in connection with or resulting from the exercise of this Permit including, but not limited to, property damage, personal injury and wrongful death.

**CONFIDENTIAL**

STATE OF CALIFORNIA DWR  
WELL COMPLETION REPORT  
(WELL LOGS)

**REMOVED**

**APPENDIX B**  
**FIELD DATA SHEET**

P.O. Box 2559  
Orangevale, CA 95662  
Phone: (916) 990-0333  
FAX: (916) 990-0332



# Fax

To: Scott From: Hal Hansen  
 Fax: 1-530 676-6005 Pages: 1  
 Phone: 1-530 676-6009 Date: 4-11-03  
 Re: \_\_\_\_\_ CC: \_\_\_\_\_

- Urgent     For Review     Please Comment     Please Reply     Please Recycle

• Comments:

| well# | dia<br>inches | Total<br>Depth | calculated<br>volume of<br>Grout(gallons) | actual volume<br>of grout used<br>(gallons) |
|-------|---------------|----------------|---|---|
| MW-1  | 4             | 20             | 36.4                                      | 40  |
| MW-2  | 4             | 20             | 36.4                                      | 44  |
| MW-3  | 4             | 20             | 36.4                                      | 41  |

Wells were abandoned on 4-10-03

Hal Hansen