

**PARSONS ENGINEERING SCIENCE, INC.**

290 Elwood Davis Road, Suite 312 • Liverpool, New York 13088 • (315) 451-9560 • Fax (315) 451-9570

September 25, 1995

Ms. Susan Hugo  
Alameda County Department  
of Environmental Health  
1131 Harbor Bay Parkway  
Alameda, California 94502

Re: Greyhound Terminal  
Location 8934  
Oakland, California

Dear Ms. Hugo:

On behalf of Greyhound Lines, Inc. (Greyhound), Parsons Engineering Science, Inc. (Parsons ES) is pleased to submit the August 1995 monthly monitoring report for the Greyhound Terminal in Oakland. Table 1 (attached) lists the water levels and free-product thicknesses measured in the onsite wells during our site visit. Figure 1 shows the locations of the monitoring wells.

During our site visit on August 10, residual free-phase hydrocarbons were observed in recovery wells ES-1 and ES-2. Groundwater samples collected from the monitoring wells and recovery wells were clear. A total of 1,015 gallons of diesel fuel and contaminated groundwater have been recovered to date. No additional measureable volume of product has been recovered since the July site visit. Our next site visit is scheduled for the week of September 11, 1995.

Greyhound will keep your office informed of our progress with this site. In the interim, if you have any questions or require additional information, please call us at (315) 451-9560.

Sincerely,  
PARSONS ENGINEERING SCIENCE, INC.

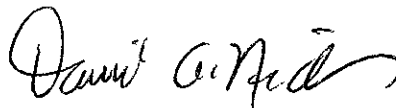

David A. Nickerson  
Project Manager



David L. Chaffin, R.G.  
California Registered Geologist (No. 4885)

cc: Mr. Kevin Graves, RWQCB  
Rita Felton, GLI, Dallas, TX

**TABLE 1**  
**MONITORING WELL DATA SUMMARY**  
**GREYHOUND TERMINAL, OAKLAND, CALIFORNIA**  
**AUGUST 10, 1995**

<b>Location</b>	<b>Elevation of T.O.C.<sup>1</sup> (Ft.)</b>	<b>Depth to Groundwater (Ft.)</b>	<b>Groundwater Elevation<sup>2</sup> (Ft.)</b>	<b>Product Layer Thickness (Ft.)</b>
ES-1 <sup>3</sup>	96.64	17.61	79.03	0.01
ES-2 <sup>3</sup>	96.44	18.10	78.34	0.01
ES-3	96.96	18.40	78.56	0
ES-4	95.70	17.84	77.86	0
ES-5 <sup>3</sup>	95.85	17.44	78.41	0
ES-6	97.84	20.81	77.03	0
ES-7	96.40	18.77	77.63	0
ES-8	96.64	17.89	78.75	0
ES-9	95.78	16.67	79.11	0
ES-10	95.24	16.21	79.03	0
ES-11	95.92	17.85	78.07	0
BC-1 <sup>3</sup>	96.16	17.89	78.27	0
BC-2 <sup>4</sup>	96.32	17.55	78.77	0
BC-3 <sup>4</sup>	96.20	17.54	78.66	0

<sup>1</sup> Elevations of top of PVC casing measured with respect to onsite datum (97.50 feet, measured on steel grate for storm sewer near wash rack).

<sup>2</sup> Elevation of T.O.C. - depth to groundwater.

<sup>3</sup> Recovery Wells.

<sup>4</sup> Elevation approximate - well casing not vertical.

FIGURE 1

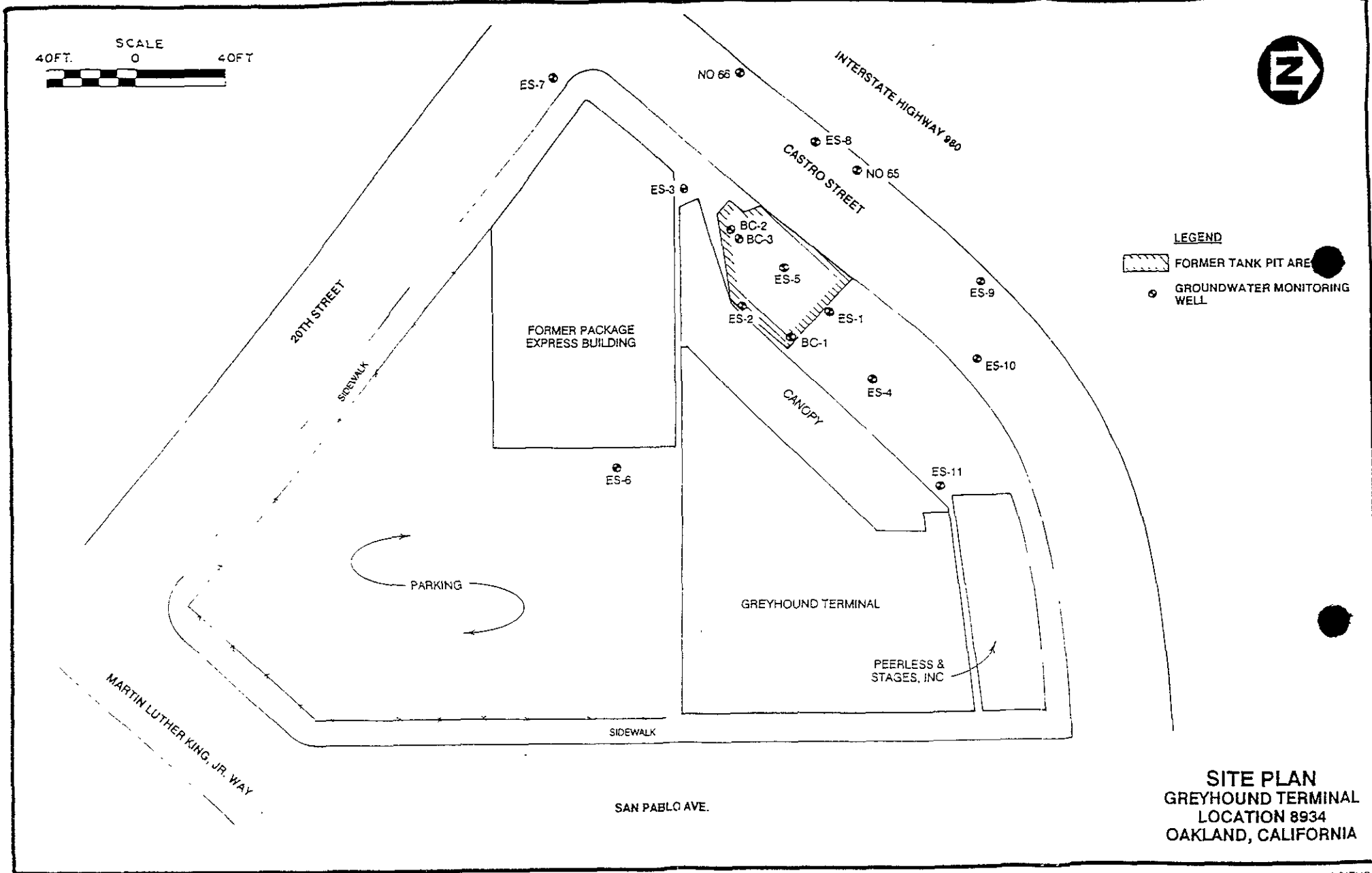

SITE PLAN  
GREYHOUND TERMINAL  
LOCATION 8934  
OAKLAND, CALIFORNIA