

PARSONS ENGINEERING SCIENCE, INC.

290 Elwood Davis Road, Suite 312 • Liverpool, New York 13088 • (315) 451-9560 • Fax (315) 451-9570

June 7, 1995

Ms. Susan Hugo
Alameda County Department
of Environmental Health
1131 Harbor Bay Parkway
Alameda, California 94502

Re: Greyhound Terminal
Location 8934
Oakland, California

Dear Ms. Hugo:

On behalf of Greyhound Lines, Inc. (Greyhound), Parsons Engineering Science, Inc. (Parsons ES) is pleased to submit the May 1995 monthly monitoring report for the Greyhound Terminal in Oakland. Table 1 (attached) lists the measured water levels and free-product thicknesses from on-site wells monitored during our site visit. Figure 1 shows the locations of the monitoring wells.

During our site visit on May 9, residual free-phase hydrocarbons were observed in recovery well BC-1. A hydrocarbon sheen was observed in groundwater samples collected from recovery wells ES-1, ES-2, ES-5, ES-9, and ES-11. A total of 1,015 gallons of diesel fuel and contaminated groundwater have been recovered to date. Our next site visit is scheduled for the week of June 12, 1995.

Greyhound will keep your office informed of our progress with this site. In the interim, if you have any questions or require additional information, please call us at (315) 451-9560.

Sincerely,
PARSONS ENGINEERING SCIENCE, INC.



David A. Nickerson
Project Manager



David L. Chaffin, R.G.
California Registered Geologist (No. 4885)

cc: Mr. Kevin Graves, RWQCB
Tom Portele, GLI, Dallas, TX

TABLE 1
MONITORING WELL DATA SUMMARY
GREYHOUND TERMINAL, OAKLAND, CALIFORNIA
MAY 9, 1995

Location	Elevation of T.O.C. ¹ (Ft.)	Depth to Groundwater (Ft.)	Groundwater Elevation ² (Ft.)	Product Layer Thickness (Ft.)
ES-1 ³	96.64	16.66	79.98	0
ES-2 ³	96.44	17.15	79.29	0
ES-3	96.96	17.39	79.57	0
ES-4	95.70	16.57	79.13	0
ES-5 ³	95.85	16.45	79.40	0
ES-6	97.84	19.95	77.89	0
ES-7	96.40	17.79	78.61	0
ES-8	96.64	16.92	79.72	0
ES-9	95.78	15.72	80.06	0
ES-10	95.24	15.26	79.98	0
ES-11	95.92	16.95	78.97	0
BC-1 ³	96.16	17.00	79.16	0.01
BC-2 ⁴	96.32	15.81	80.51	0
BC-3 ⁴	96.20	16.92	79.28	0

¹ Elevations of top of PVC casing measured with respect to on-site datum (97.50 feet, measured on steel grate for storm sewer near wash rack).

² Elevation of T.O.C. - depth to groundwater.

³ Recovery Wells.

⁴ Elevation approximate - well casing not vertical.

FIGURE 1

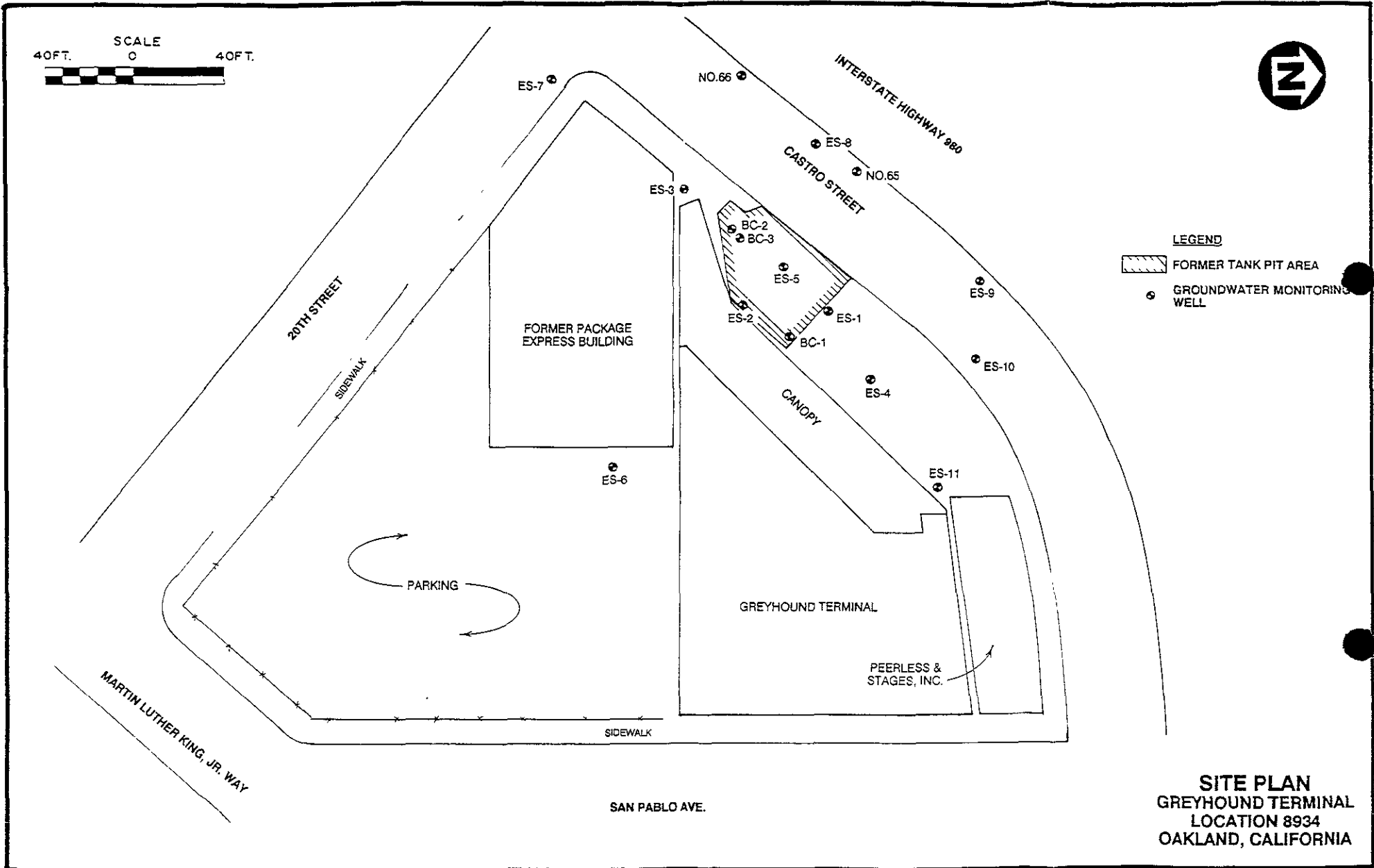

LEGEND
FORMER TANK PIT AREA
GROUNDWATER MONITORING WELL

SITE PLAN
GREYHOUND TERMINAL
LOCATION 8934
OAKLAND, CALIFORNIA