

**ENGINEERING-SCIENCE, INC.**

290 Elwood Davis Road, Suite 312 • Liverpool, New York 13088 • (315) 451-9560 • Fax (315) 451-9561

**ENVIRONMENTAL  
PROTECTION**

February 23, 1995

95 MAR 15 PM 1:12

Ms. Susan Hugo  
Alameda County Department  
of Environmental Health  
80 Swan Way, Room 200  
Oakland, California 94621

ST10 3809

Re: Greyhound Terminal  
Location 8934  
Oakland, California

Dear Ms. Hugo:

On behalf of Greyhound Lines, Inc. (Greyhound), Engineering-Science, Inc. (ES) is pleased to submit the February 1995 monthly monitoring report for the Greyhound Terminal in Oakland. Table 1 (attached) lists the measured water levels and free-product thicknesses from on-site wells monitored during our site visit. Figure 1 shows the locations of the monitoring wells.

During our site visit on February 14, residual free-phase hydrocarbons were observed in recovery well ES-1 and BC-1. A hydrocarbon sheen was observed in groundwater samples collected from recovery wells ES-2 and ES-5. A total of 1,015 gallons of diesel fuel and contaminated groundwater have been recovered to date. Our next site visit is scheduled for the week of March 6, 1995.

Greyhound requests a response from the Alameda County Department of Environmental Health regarding the Supplemental Site Assessment and Preliminary Risk Evaluation reports submitted in November and February, 1993. If you have any questions or require additional information, please feel free to contact us at (315) 451-9560.

Sincerely,  
ENGINEERING-SCIENCE, INC.

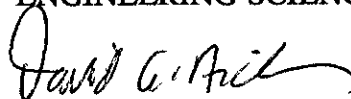

David A. Nickerson  
Project Manager



David L. Chaffin, R.G.  
California Registered Geologist (No. 4885)

cc: Mr. Richard Hiatt, RWQCB  
Tom Portele, GLI, Dallas, TX

TABLE 1

MONITORING WELL DATA SUMMARY  
 GREYHOUND TERMINAL, OAKLAND, CALIFORNIA  
 FEBRUARY 14, 1995

Location	Elevation of T.O.C. <sup>1</sup> (Ft.)	Depth to Groundwater (Ft.)	Groundwater Elevation <sup>2</sup> (Ft.)	Product Layer Thickness (Ft.)
ES-1 <sup>3</sup>	96.64	16.45	80.19	0.01
ES-2 <sup>3</sup>	96.44	16.92	79.52	0
ES-3	96.96	17.22	79.74	0
ES-4	95.70	16.37	79.33	0
ES-5 <sup>3</sup>	95.85	16.45	79.40	0
ES-6	97.84	19.82	78.02	0
ES-7	96.40	17.63	78.77	0
ES-8	96.64	16.67	79.97	0
ES-9	95.78	15.49	80.29	0
ES-10	95.24	15.05	80.19	0
ES-11	95.92	16.76	79.16	0
BC-1 <sup>3</sup>	96.16	16.80	79.36	0.04
BC-2 <sup>4</sup>	96.32	15.11	81.21	0
BC-3 <sup>4</sup>	96.20	15.86	80.34	0

<sup>1</sup> Elevations of top of PVC casing measured with respect to on-site datum (97.50 feet, measured on steel grate for storm sewer near wash rack).

<sup>2</sup> Elevation of T.O.C. - depth to groundwater.



<sup>3</sup> Recovery Wells.

<sup>4</sup> Elevation approximate - well casings not vertical.

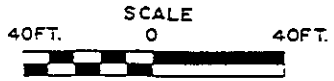
FIGURE 1



LEGEND

-  FORMER TANK PIT AREA
-  GROUNDWATER MONITORING WELL

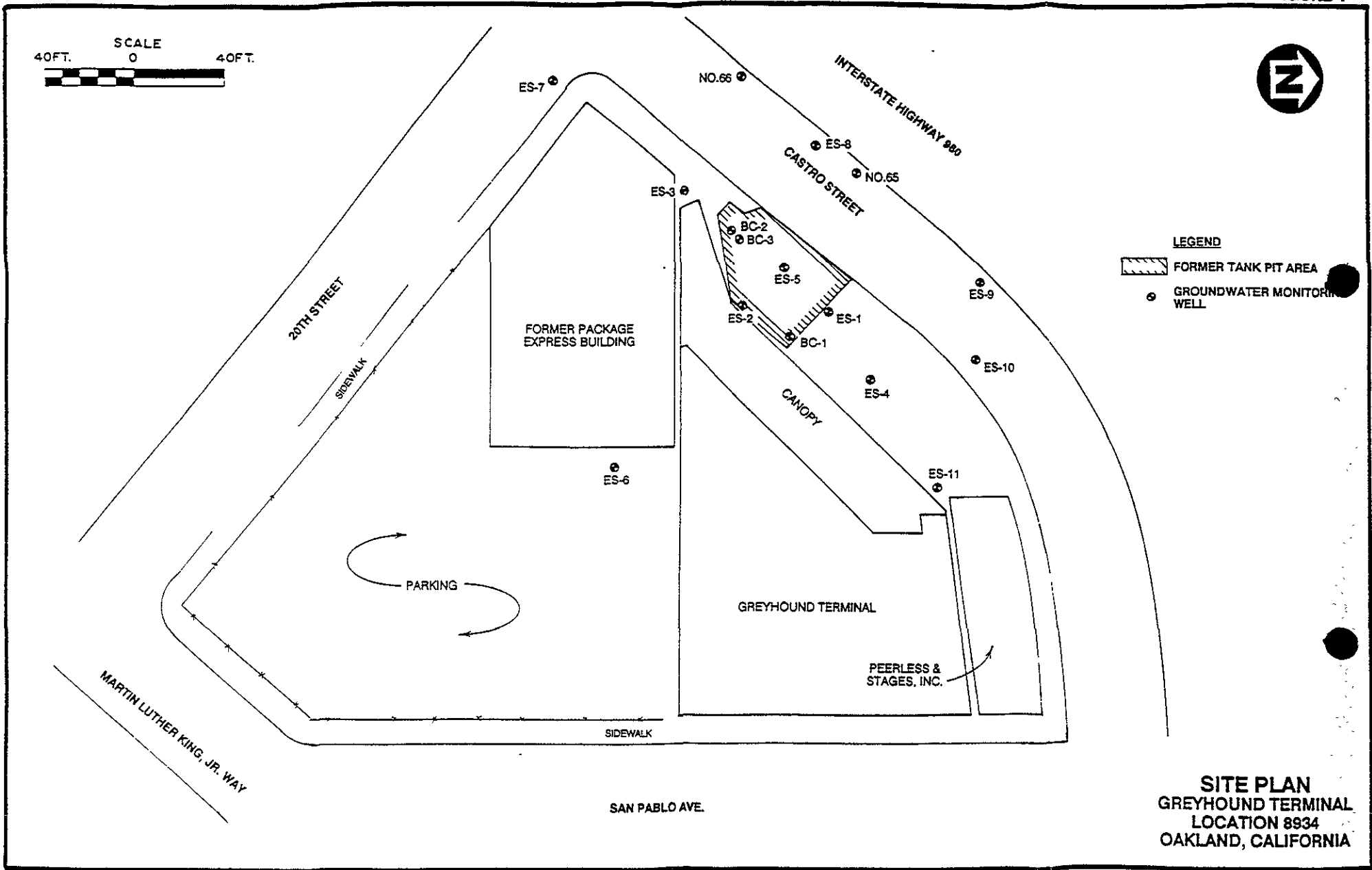

**SITE PLAN**  
**GREYHOUND TERMINAL**  
**LOCATION 8934**  
**OAKLAND, CALIFORNIA**