

ENGINEERING-SCIENCE, INC.

290 Elwood Davis Road, Suite 312 • Liverpool, New York 13088 • (315) 451-9560 • Fax (315) 451-9570

July 8, 1994
94 JUL 26 PM 3:48

Ms. Susan Hugo
Alameda County Department
of Environmental Health
80 Swan Way, Room 200
Oakland, California 94621

Re: Greyhound Terminal
Location 8934
Oakland, California

Dear Ms. Hugo:

On behalf of Greyhound Lines, Inc., Engineering-Science, Inc. (ES) is pleased to submit the June 1994 monthly monitoring report for the Greyhound Terminal in Oakland. Table 1 (attached) lists the measured water levels and free-product thicknesses from on-site wells monitored during our site visit. Figure 1 shows the locations of the monitoring wells.

During our site visit on June 7, residual free phase hydrocarbons were observed in recovery wells ES-1, BC-1, and ES-5. A total of 850 gallons of diesel fuel and contaminated groundwater have been recovered to date. This represents an increase of 50 gallons since the April reporting period.

Our next site visit is scheduled for July 13, 1994. At this time, we will collect groundwater samples as part of Greyhound's quarterly sampling and analysis program. Analytical data will be reported to you in the format shown in Appendix A of "Tri-Regional Board Staff Recommendations for Preliminary Evaluation and Investigation of Underground Storage Tank Sites (August 1990).

Greyhound requests a response from the Alameda County Department of Environmental Health regarding the Supplemental Site Assessment and Preliminary Risk Evaluation reports submitted in November and December, 1993 so that any additional remedial measures, if required, can be evaluated. If you have any questions or require additional information, please feel free to contact us at (315) 451-9560.

Sincerely,
ENGINEERING-SCIENCE, INC.

J. Miller
Martin N. Miller
Environmental Technician

J. Nickerson
David A. Nickerson
Project Manager

J. Chaffin
David L. Chaffin, R.G.
California Registered Geologist (No. 4885)

cc: Mr. Richard Hiatt, RWQCB
Tom Portele, GLI, Dallas, TX



TABLE 1
MONITORING SUMMARY
GREYHOUND LINES, INC.
OAKLAND, CA

JUNE 7, 1994

Location	Depth to Liquid (feet)	Depth to Water (feet)	Product Thickness (feet)	Remarks
ES-1*	18.04	18.21	0.18	Free Product
ES-2*	18.61	18.61	0	Sheen
ES-3	18.90	18.90	0	Clear
ES-4	17.94	17.94	0	Clear
ES-5*	18.25	18.27	0.01	Free Product
ES-6	21.20	21.20	0	Clear
ES-7	19.33	19.33	0	Clear
ES-8	18.32	18.32	0	Clear
ES-9	17.06	17.06	0	Clear
ES-10	17.50	17.50	0	Clear
ES-11	18.28	18.28	0	Clear
BC-1*	18.25	18.52	0.27	Free Product
BC-2**	17.70	17.70	0	Clear
BC-3**	17.34	17.34	0	Clear

* Recovery Well

** Well casings deviated from vertical.

NA Not accessible; automobile parked over well.

SITE PLAN
GREYHOUND TERMINAL
LOCATION 8934
OAKLAND, CALIFORNIA

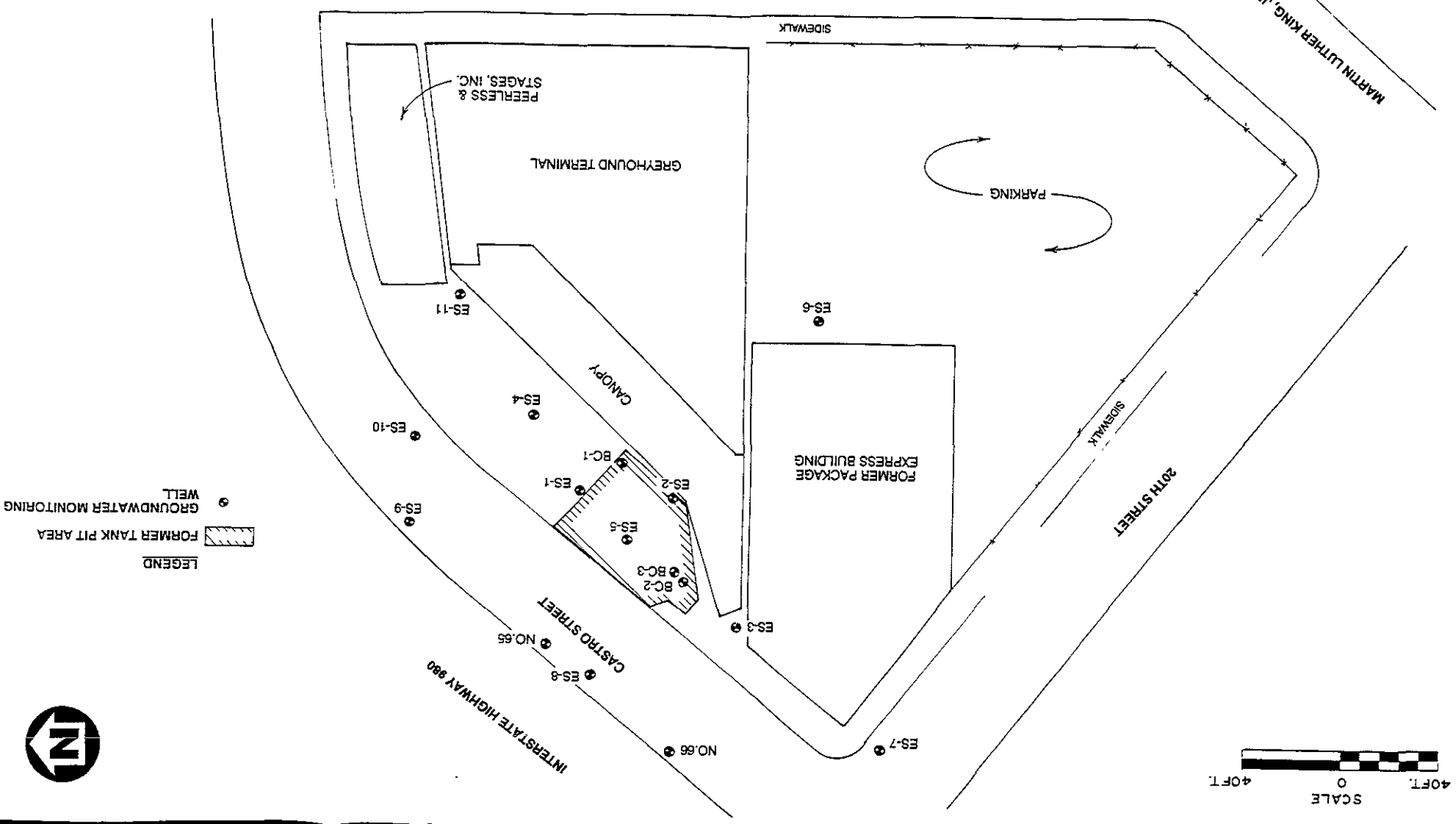

FIGURE 1