

50 APR 13 11:05

April 13, 1993

Ms. Susan Hugo
Alameda County Department of Environmental Health
80 Swan Way, Room 200
Oakland, California 94621

Re: Greyhound Terminal
Location 8934
Oakland, California

Dear Ms. Hugo:

On behalf of Greyhound Lines, Inc., Engineering-Science, Inc. (ES) is pleased to submit the March 1993, monthly monitoring report for the Greyhound Terminal in Oakland. Attached you will find Table 1 which lists the measured water levels and free-product thicknesses from on-site wells monitored during our site visit. Figure 1 shows the locations of the monitoring wells.

During our site visit on March 5, free phase hydrocarbons were observed in BC-1, ES-2 and ES-5. A hydrocarbon sheen was present in recovery well ES-1. The hydrocarbon recovery system in operation at this facility continues to work effectively reducing product thicknesses in recovery wells ES-1, ES-2, ES-5 and BC-1. A total of 505 gallons of diesel fuel and contaminated groundwater have been recovered to date.

Our next site visit is scheduled during the week of April 5. At that time we will be collecting groundwater samples as part of Greyhound's quarterly sampling and analysis program. Analytical results will be submitted to your office in the format of a quarterly report in accordance with all quarterly reporting requirements.

Greyhound is currently preparing a supplemental site assessment work plan to determine the full extent of soil and groundwater contamination at and near the facility. This plan will be submitted to the Alameda County Department of Environmental Health (ACDEH) for approval prior to conducting any additional assessment activities. Greyhound still awaits ACDEH approval and/or comments to the closure documentation submitted in December 1992 and the current remediation program in progress at this facility.

Ms. Susan Hugo
Alameda Co. Dept. of Environmental Health
April 13, 1993
Page 2

If you have any questions or require additional information, please feel free to contact us at (315) 451-9560.

Sincerely,
ENGINEERING-SCIENCE, INC.

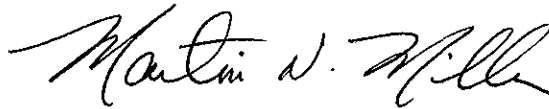

Martin N. Miller
Environmental Technician

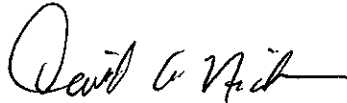

David A. Nickerson
Project Manager



David L. Chaffin, R.G.
California Registered Geologist (No. 4885)

MNM/DAN/DLC/lml

cc: Mr. Richard Hiatt, RWQCB
Tom Portele, GLI, Dallas, TX

TABLE 1
MONITORING SUMMARY
GREYHOUND LINES, INC.
OAKLAND, CA
MARCH 5, 1993

Location	Depth to Liquid (feet)	Depth to Water (feet)	Product Thickness (feet)	Remarks
ES-1*	17.95	17.95	0	Sheen
ES-2*	18.25	18.31	.06	Free Product
ES-3	17.98	17.98	0	Clear
ES-4	17.32	17.32	0	Clear
ES-5*	17.40	17.99	.59	Free Product
BC-1*	18.05	18.06	.01	Free Product
BC-2	14.58	14.58	0	Clear
BC-3	15.50	15.50	0	Clear

* Recovery Well

FIGURE 1

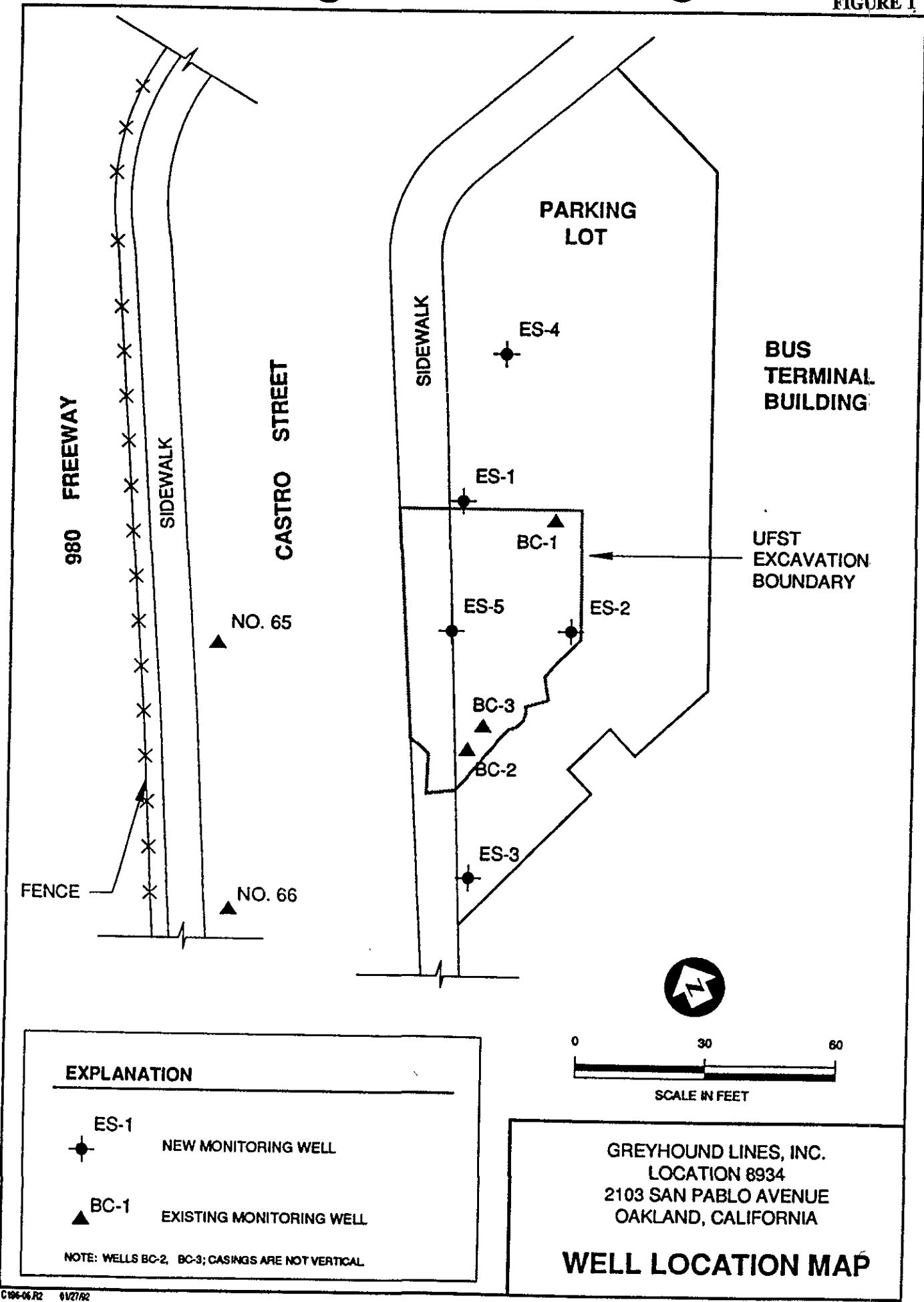

EXPLANATION

 ES-1
 NEW MONITORING WELL

 BC-1
 EXISTING MONITORING WELL

NOTE: WELLS BC-2, BC-3; CASINGS ARE NOT VERTICAL



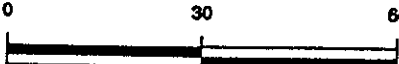

SCALE IN FEET

GREYHOUND LINES, INC.
 LOCATION 8934
 2103 SAN PABLO AVENUE
 OAKLAND, CALIFORNIA

WELL LOCATION MAP