

January 11, 1993

Ms. Susan Hugo  
Alameda County Department of Environmental Health  
80 Swan Way, Room 200  
Oakland, California 94621

Re: Greyhound Terminal  
Location 8934  
Oakland, California

Dear Ms. Hugo:

On behalf of Greyhound Lines, Inc., Engineering-Science, Inc. (ES) is pleased to submit the December 1992 monthly monitoring report for the Greyhound Terminal in Oakland. Attached you will find Table 1 which lists the measured water levels and free-product thicknesses from on-site wells monitored during our site visit. Figure 1 shows the locations of the monitoring wells.

During our site visit, on December 12, free-phase hydrocarbons were observed in ES-2, ES-5, and BC-1. All other wells were found to be clear.

During our next site visit, scheduled for January 5, 1993, the third round of groundwater samples will be collected as part of Greyhound's quarterly groundwater sampling and analysis program. The results of this sampling will be included in our January letter report which will follow the format requested in your letter to Greyhound dated October 23, 1992.

Based upon authorization from the East Bay Municipal Utility District (EBMUD), Greyhound started full time operation of the recently installed free product recovery system on-site on January 4, 1993. Future reports will include information regarding recovery system operation and volume of product recovered.

93 JAN 21 10 06

Ms. Susan Hugo  
Alameda Co. Dept. of Environmental Health  
January 11, 1993  
Page 2

Greyhound is currently preparing a supplemental site assessment plan to determine the full extent of soil and groundwater contamination at and near the facility. This plan will be submitted to the Alameda County Department of Environmental Health for approval prior to conducting any additional assessment activities.

If you have any questions or require additional information, please feel free to contact us at (315) 451-9560.

Sincerely,

ENGINEERING-SCIENCE, INC.

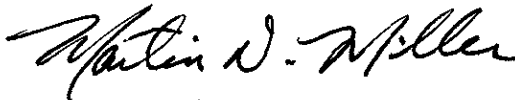

Martin N. Miller  
Environmental Technician

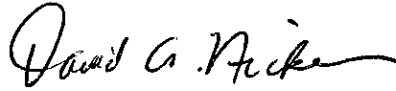

David A. Nickerson, P.G.  
Project Manager



David L. Chaffin, R.G.  
California Registered Geologist (No.  
4885)

MNM/DAN/DLC/tcc

cc: Mr. Richard Hiatt, RWQCB  
Tom Portele, GLI, Dallas, TX

**TABLE 1**  
**GREYHOUND LINES, INC.**  
**OAKLAND, CA**  
**MONITORING SUMMARY**  
**DECEMBER 12, 1992**

<b>Location</b>	<b>Depth to Liquid (feet)</b>	<b>Depth to Water (feet)</b>	<b>Product Thickness (feet)</b>	<b>Remarks</b>
ES-1	18.55	18.55	0	Clear
ES-2	18.75	19.10	.35	Free Product
ES-3	19.10	19.10	0	Clear
ES-4	18.51	18.51	0	Clear
ES-5	17.50	20.35	2.85	Free Product
BC-1	18.25	20.75	2.50	Free Product
BC-2	12.17	12.17	0	Clear
BC-3	17.84	17.84	0	Clear

FIGURE 1

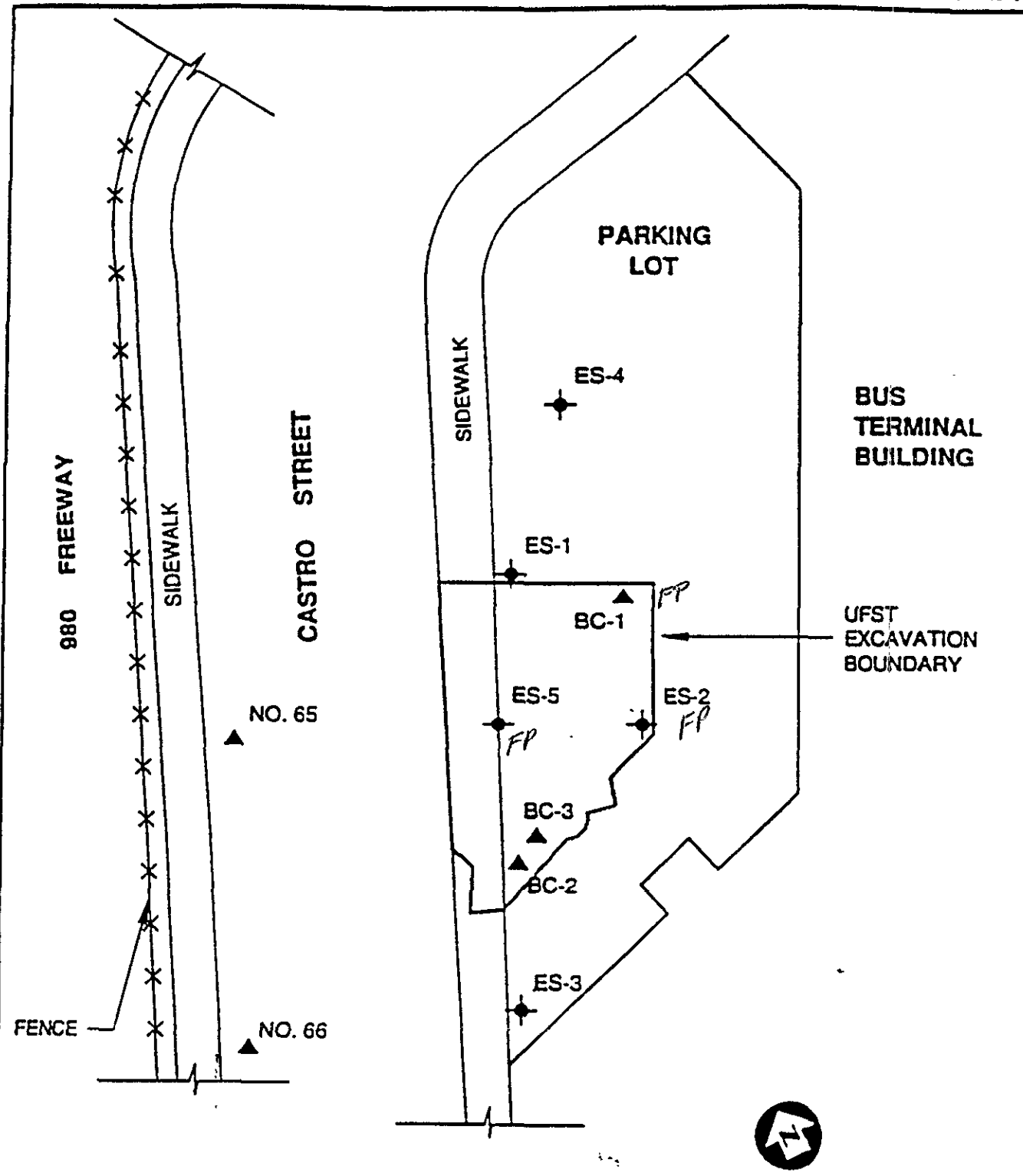

**EXPLANATION**

- 
 ES-1  
 NEW MONITORING WELL
- 
 BC-1  
 EXISTING MONITORING WELL

NOTE: WELLS BC-2, BC-3; CASINGS ARE NOT VERTICAL

GREYHOUND LINES, INC.  
 LOCATION 8934  
 2103 SAN PABLO AVENUE  
 OAKLAND, CALIFORNIA

**WELL LOCATION MAP**