

October 6, 1992

Ms. Susan Hugo
Alameda County Department
of Environmental Health
80 Swan Way, Room 200
Oakland, California 94621

Re: Greyhound Terminal
Location 8934
Monthly Monitoring

Dear Ms. Hugo:

On behalf of Greyhound Lines, Inc., Engineering-Science, Inc. (ES) is pleased to submit the September 1992 monthly monitoring report for the Greyhound Terminal in Oakland. Attached you will find Table 1 which lists the measured water levels and free-product thicknesses from on-site wells monitored during our site visit. Figure 1 shows the locations of the monitoring wells.

During our site visit on August 31, free-phase hydrocarbons were observed in ES-1, ES-2, ES-5, and BC-1. All other wells were found to be clear.

During our next site visit, scheduled for October 5, the second round of groundwater samples will be collected for Greyhound's quarterly groundwater sampling and analysis program. The results of this sampling will be included in our October letter report.

Greyhound is currently finalizing plans and obtaining the required permits to install a hydrocarbon recovery system to address the free product plume at the facility. As we discussed during our recent telephone conversation, Greyhound awaits your review of the file for this location and any comments you may have regarding the proposed free product recovery and groundwater treatment system.

Ms. Susan Hugo
October 6, 1992
Page 2

If you have any questions or require additional information, please feel free to contact us at (315) 451-9560.

Sincerely,

ENGINEERING-SCIENCE, INC.

Martin N. Miller /bar

Martin N. Miller
Environmental Technician

David A. Nickerson

David A. Nickerson, P.G.
Project Manager

D. Chaffin

David L. Chaffin
California Registered Geologist (No.
4885)

MNM/DAN/DLC/lml



cc: Mr. Richard Hiatt, RWQCB
Tom Portele, GLI, Dallas, TX

TABLE 1
GREYHOUND LINES, INC.
OAKLAND, CA
MONITORING SUMMARY
AUGUST 31, 1992

Location	Depth to Liquid (feet)	Depth to Water (feet)	Product Thickness (feet)	Remarks
ES-1	18.96	18.97	.01	Free Product
ES-2	19.29	19.90	.61	Free Product
ES-3	19.80	19.80	0	Clear
ES-4	18.79	18.79	0	Clear
ES-5	18.24	20.80	2.56	Free Product
BC-1	18.68	21.02	2.34	Free Product
BC-2	18.89	18.89	0	Clear
BC-3	19.10	19.10	0	Clear

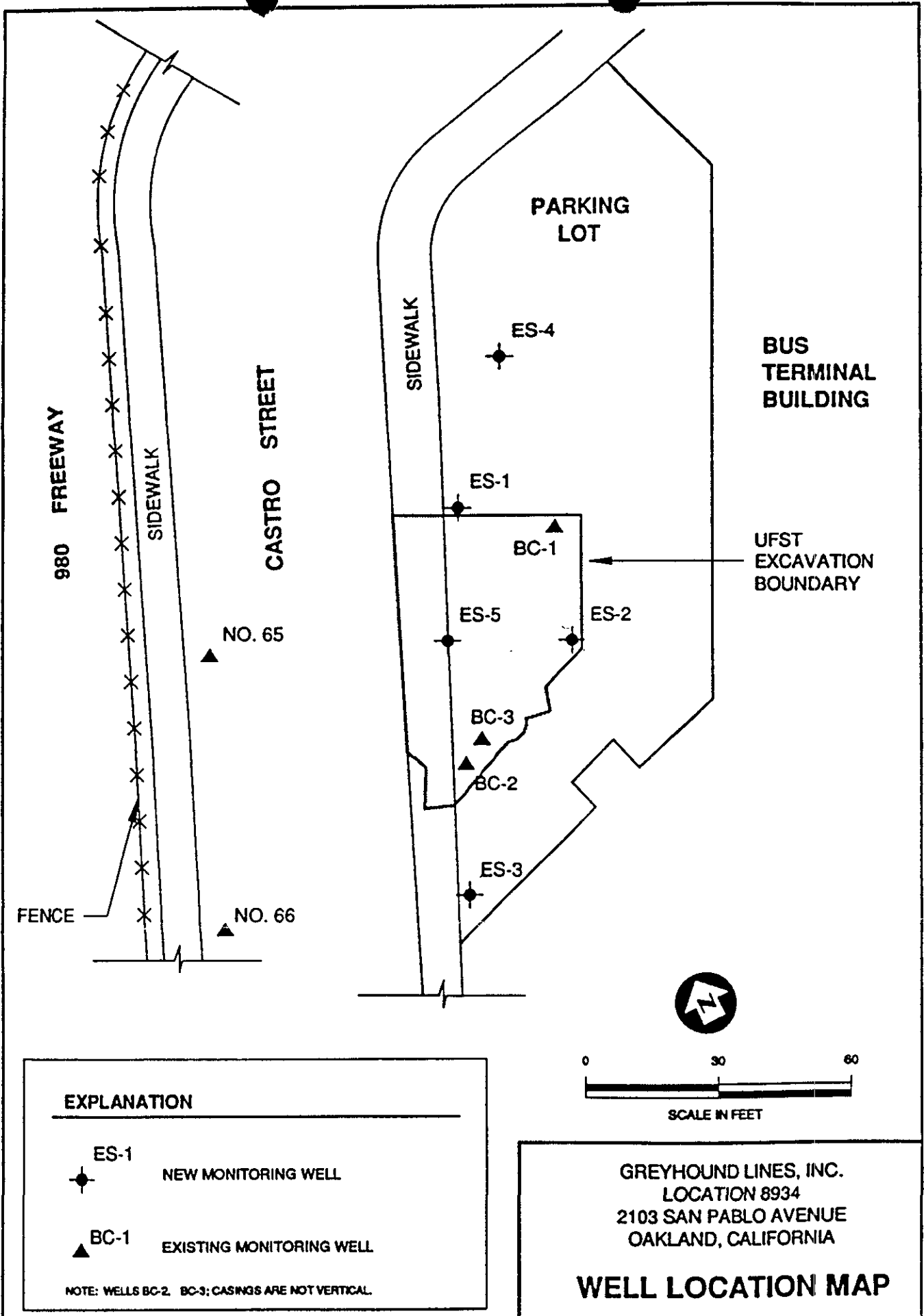
FIGURE 1



EXPLANATION	
	ES-1 NEW MONITORING WELL
	BC-1 EXISTING MONITORING WELL
NOTE: WELLS BC-2, BC-3; CASINGS ARE NOT VERTICAL.	

GREYHOUND LINES, INC.
 LOCATION 8934
 2103 SAN PABLO AVENUE
 OAKLAND, CALIFORNIA

WELL LOCATION MAP