



ENGINEERING-SCIENCE, INC.

290 ELWOOD DAVIS ROAD
SUITE 312
LIVERPOOL, NY 13088
TEL: (315) 451-9560
FAX: (315) 451-9570

August 19, 1992

Mr. Dennis Byrne
Alameda County Department
of Environmental Health
80 Swan Way, Room 200
Oakland, California 94621

Re: Greyhound Terminal
Location 8934
Monthly Monitoring

9211001 111322

Dear Mr. Byrne:

On behalf of Greyhound Lines, Inc., Engineering-Science, Inc. (ES) is pleased to submit the August 1992, monthly monitoring report for the Greyhound Terminal in Oakland. Attached you will find Table 1 which lists the measured water levels and free-product thicknesses from on-site wells monitored during our site visit. Figure 1 shows the locations of the monitoring wells.

During our site visit on August 4, product was observed in ES-1, ES-2, ES-5, and BC-1; all other wells were found to be clear.

Greyhound is currently finalizing plans and obtaining the required permits to install a hydrocarbon recovery system to address the free product plume at the facility. Greyhound will keep the Alameda County Department of Environmental Health informed of continuing remediation activities.

If you have any questions or require additional information, please feel free to contact us at (315) 451-9560.

Sincerely,
ENGINEERING-SCIENCE, INC.

Martin N. Miller
Martin N. Miller
Environmental Technician

David A. Nickerson
David A. Nickerson, P.G.
Project Manager

D. Chaffin
David L. Chaffin
California Registered Geologist (No. 4885)

Kevin L. McIlvenna
Senior Environmental Technician

BC **Brown and Caldwell**
Consultants

3480 Buskirk Avenue
Pleasant Hill
California 94523-4342
(415) 937-9010
FAX (415) 937-9026

cc: Mr. Richard Hiatt, RWQCB
Tom Portele, GLI, Dallas, TX



TABLE 1
GREYHOUND LINES, INC.
OAKLAND, CA
MONITORING SUMMARY
AUGUST 4, 1992

Location	Depth to Liquid (feet)	Depth to Water (feet)	Product Thickness (feet)	Remarks
ES-1	18.80	18.81	.01	Free Product
ES-2	19.17	19.76	.59	Free Product
ES-3	19.68	19.68	0	Clear
ES-4	18.66	18.66	0	Clear
ES-5	18.16	20.43	2.27	Free Product
BC-1	18.47	20.90	2.43	Free Product
BC-2	18.46	18.46	0	Clear
BC-3	19.24	19.24	0	Clear

Oct

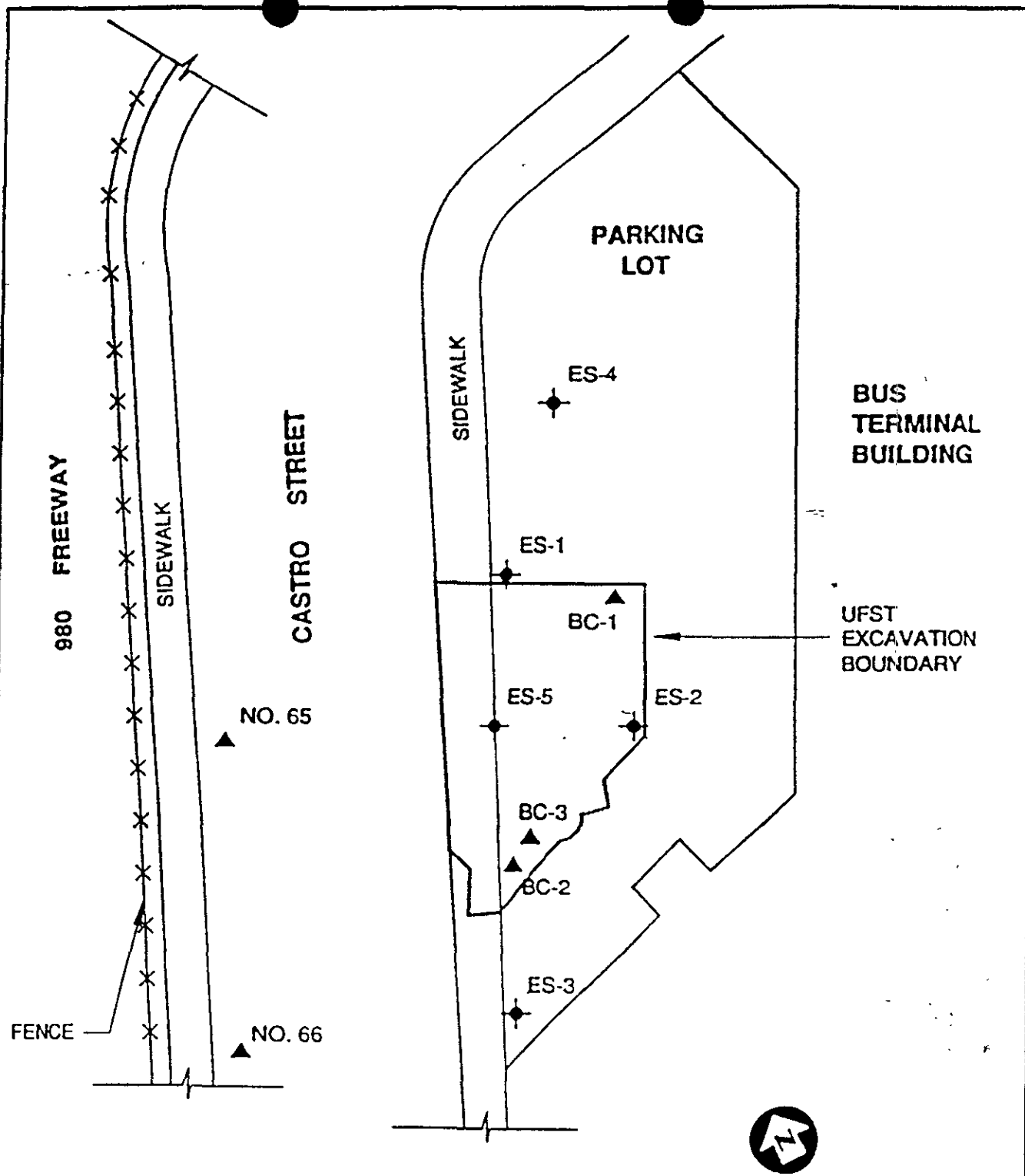
FIGURE 1



EXPLANATION	
	ES-1 NEW MONITORING WELL
	BC-1 EXISTING MONITORING WELL
NOTE: WELLS BC-2, BC-3; CASINGS ARE NOT VERTICAL.	

GREYHOUND LINES, INC.
 LOCATION 8934
 2103 SAN PABLO AVENUE
 OAKLAND, CALIFORNIA

WELL LOCATION MAP