

Atlantic Richfield Company

Chuck Carmel
Environmental Business Manager

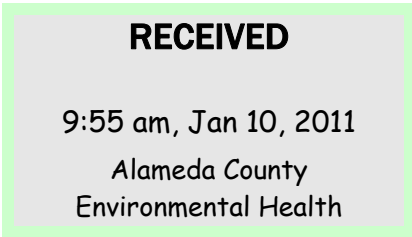

PO Box 1257
San Ramon, CA 94583
Phone: (925) 275-3803
Fax: (925) 275-3815
E-Mail: charles.carmel@bp.com

5 January 2011

Re: Fourth Quarter 2010 Status Report
Atlantic Richfield Company Station #2169
889 West Grand Avenue, Oakland, California
ACEH Case #RO0000072

"I declare, that to the best of my knowledge at the present time, that the information and/or recommendations contained in the attached document are true and correct.

Submitted by,

A handwritten signature in black ink, appearing to be "Chuck Carmel", enclosed within a hand-drawn oval.

Chuck Carmel
Environmental Business Manager

Attachment

Broadbent & Associates, Inc.
1324 Mangrove Ave., Suite 212
Chico, CA 95926
Voice (530) 566-1400
Fax (530) 566-1401



5 January 2011

Project No. 06-88-621

Atlantic Richfield Company
P.O. Box 1257
San Ramon, California 94583
Submitted via ENFOS

Attn.: Mr. Chuck Carmel

Re: Fourth Quarter 2010 Status Report, Atlantic Richfield Company Station #2169
889 West Grand Avenue, Oakland, Alameda County, California;
ACEH Case #RO0000072

Dear Mr. Carmel:

Provided herein is the *Fourth Quarter 2010 Status Report* for Atlantic Richfield Company (a BP affiliated company) Station #2169 located at 889 West Grand Avenue, Oakland, Alameda County, California (Site). This report presents a summary of current developments at the Site through the Fourth Quarter of 2010.

Should you have questions regarding this submittal, please do not hesitate to contact me at (530) 566-1400.

Sincerely,

BROADBENT & ASSOCIATES, INC.

A handwritten signature in blue ink that reads 'Thomas A. Venus'.

Thomas A. Venus, PE
Senior Engineer

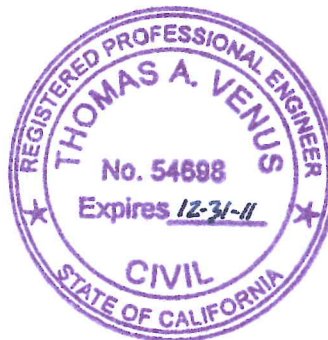

Enclosures

cc: Ms. Donna Dragos, Alameda County Environmental Health (Submitted via ACEH ftp Site)
Electronic copy uploaded to GeoTracker

STATION #2169 QUARTERLY STATUS REPORT

Facility: #2169	Address: 889 West Grand Avenue, Oakland
Environmental Business Manager:	Mr. Chuck Carmel
Consulting Co./Contact Person:	Broadbent & Associates, Inc. (BAI)/Mr. Tom Venus, PE (530) 566-1400
Primary Agency/Regulatory ID No.:	Alameda County Environmental Health (ACEH) ACEH Case #RO0000072
Consultant Project No.:	06-88-621
Facility Permits/Permitting Agency:	NA

WORK PERFORMED THIS QUARTER (Fourth Quarter 2010):

1. Prepared and submitted *Third Quarter 2010 Status Report* (BAI, 10/5/2010).
2. Attempted to perform scheduled Fourth Quarter 2010 ground-water monitoring from wells remaining following start of raze and rebuild station renovation activities.
3. Attempted to acquire off-site property access in order to complete the soil and ground-water investigation as proposed in the *Preferential Pathway Evaluation and Soil and Ground-Water Investigation Work Plan* (BAI, 4/6/2009).

WORK PROPOSED FOR NEXT QUARTER (First Quarter 2011):

1. Prepared and submitted this *Fourth Quarter 2010 Status Report* (contained herein).
2. Confirm status of five onsite wells requested to be preserved during raze and rebuild construction activities. Conduct ground-water monitoring/sampling following station reopening scheduled for 7 January 2011.
3. Continue attempts to obtain off-site property access to begin implementation of the soil and water investigation.
4. Initiate off-site soil and ground-water investigation work activities once signed property access agreements are received.

DISCUSSION:

Since June 2010, significant raze and rebuild renovation activities have been occurring at Station #2169. As during the Third Quarter of 2010, several attempts were made during the Fourth Quarter of 2010 to sample the remaining on-site wells that were requested to be preserved for future use (A-1, A-2, AR-2, ADR-1, and ADR-2) however station reconstruction activities prevented safe access to the on-site wells. It was decided against sampling just the two offsite wells during the Fourth Quarter 2010. Station renovation activities are scheduled to be complete with a ribbon-cutting scheduled for 7 January 2011. BAI intends to resume the previous semi-annual ground-water monitoring and sampling schedule during the First Quarter of 2011.

As reported in the Third Quarter 2010 Status Report, a 550-gallon single-walled steel underground storage tank was discovered on the Site, near the southeast corner of the former station building. The environmental consultant brought in by the general contractor and the new station owner was supposed to prepare and submit a compliance soil sampling report to satisfy the requirements of the City of Oakland Fire Department CUPA. BAI has requested copies of the compliance sampling reports on behalf of Atlantic Richfield Company. Standard procedure would have the City of Oakland Fire Department CUPA forward copies of these reports to the ACEH.

Requests for off-site property access required to implement the remaining scope of work within the *Preferential Pathway Evaluation and Soil and Ground-Water Investigation Work Plan* (BAI,

4/6/2009) have continued. Proposed access agreements have been sent to the owners of record of the properties at 885 22nd Street and 949 West Grand Avenue. According to the Alameda County Assessor's Office, Mr. Harold Williams Sr. (given contact address of 866 54th Street, Oakland, CA 94608) is the owner of record for 885 22nd Street, also known as Alameda County Assessor's Parcel Number (APN) 3-29-15. Also according to the Alameda County Assessor's Office, Mr. Myung S. Kim (given contact address of 2601 Telegraph Avenue, Oakland, CA 94612) is the owner of record for the city block across Market Street from the Site with the address of 949 West Grand Avenue, also known as Alameda County APN 5-411-1-4. In mid-September 2010, Mr. Myung S. "George" Kim contacted BAI and Atlantic Richfield Company and opened a dialogue regarding property access. No replies have been received from Mr. Williams. In light of the continued offsite property access stalemate, BAI suggests that the ACEH be enlisted to assist with acquiring the necessary offsite property access from Mr. Harold Williams Sr. Furthermore, it may be necessary to enlist the assistance of ACEH in obtaining offsite access from Mr. George Kim should negotiations be nonproductive.

The most recent monitoring/sampling data for the Site can be reviewed in the *First Quarter 2010 Semi-Annual Ground-Water Monitoring Report* (BAI, 4/30/2010). For immediate reference, a Site Location Map is provided as Drawing 1 and a Ground-Water Elevation Contour and Analytical Summary Map from First Quarter 2010 is provided as Drawing 2. The former Site layout plan with the location of existing and recently abandoned wells, and recently completed and still proposed soil borings are shown in Drawing 3.

ATTACHMENTS:

- Drawing 1. Site Location Map, ARCO Service Station #2169, 889 West Grand Avenue, Oakland, California
- Drawing 2. Ground-Water Elevation Contour and Analytical Summary Map, 3 March 2010, ARCO Service Station #2169, 889 West Grand Avenue, Oakland, California
- Drawing 3. Former Site Layout Plan with Well and Soil Boring Locations, ARCO Service Station #2169, 889 West Grand Avenue, Oakland, California

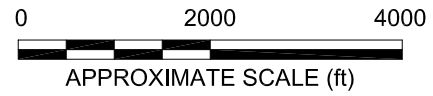
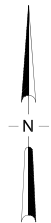
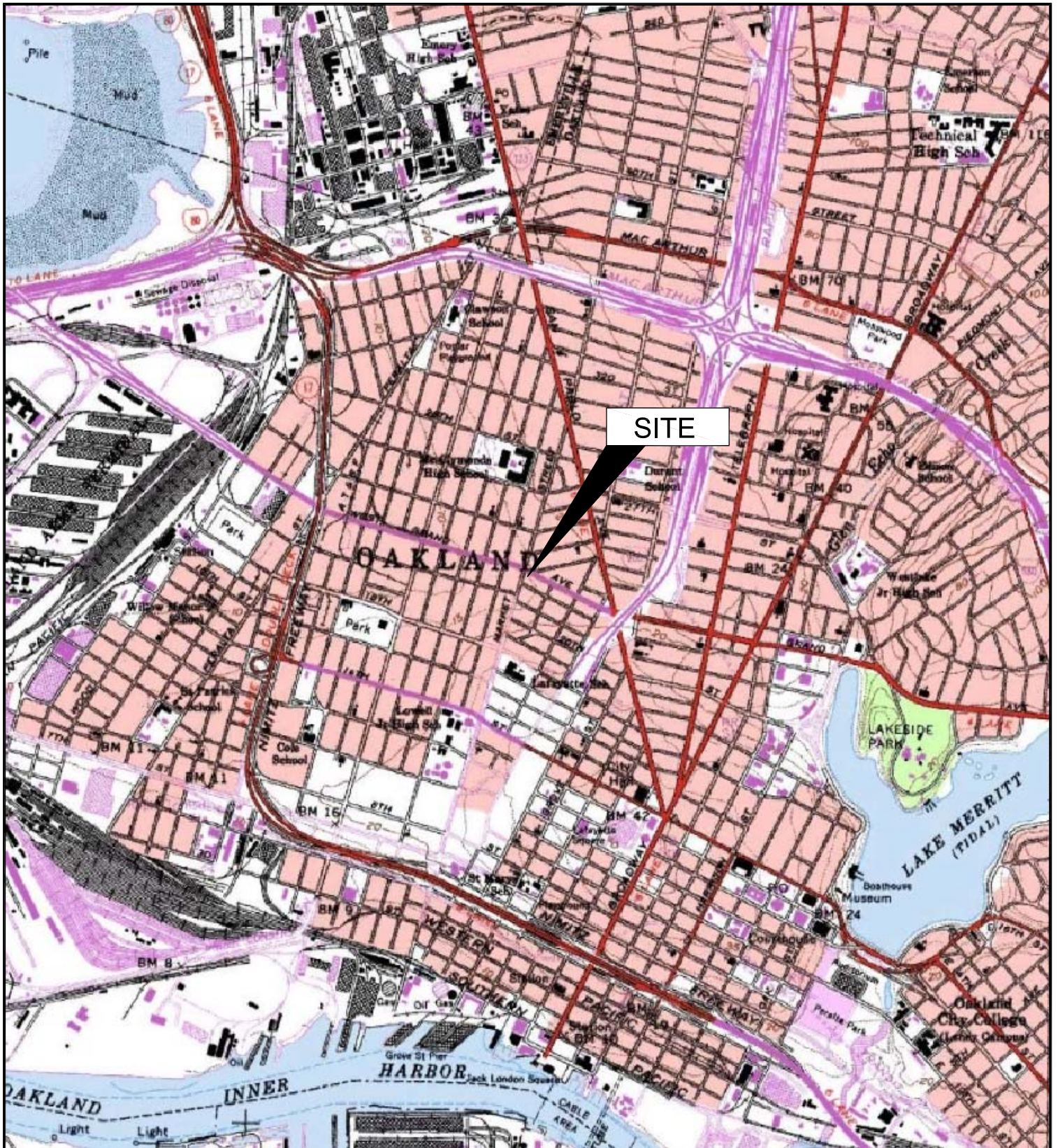
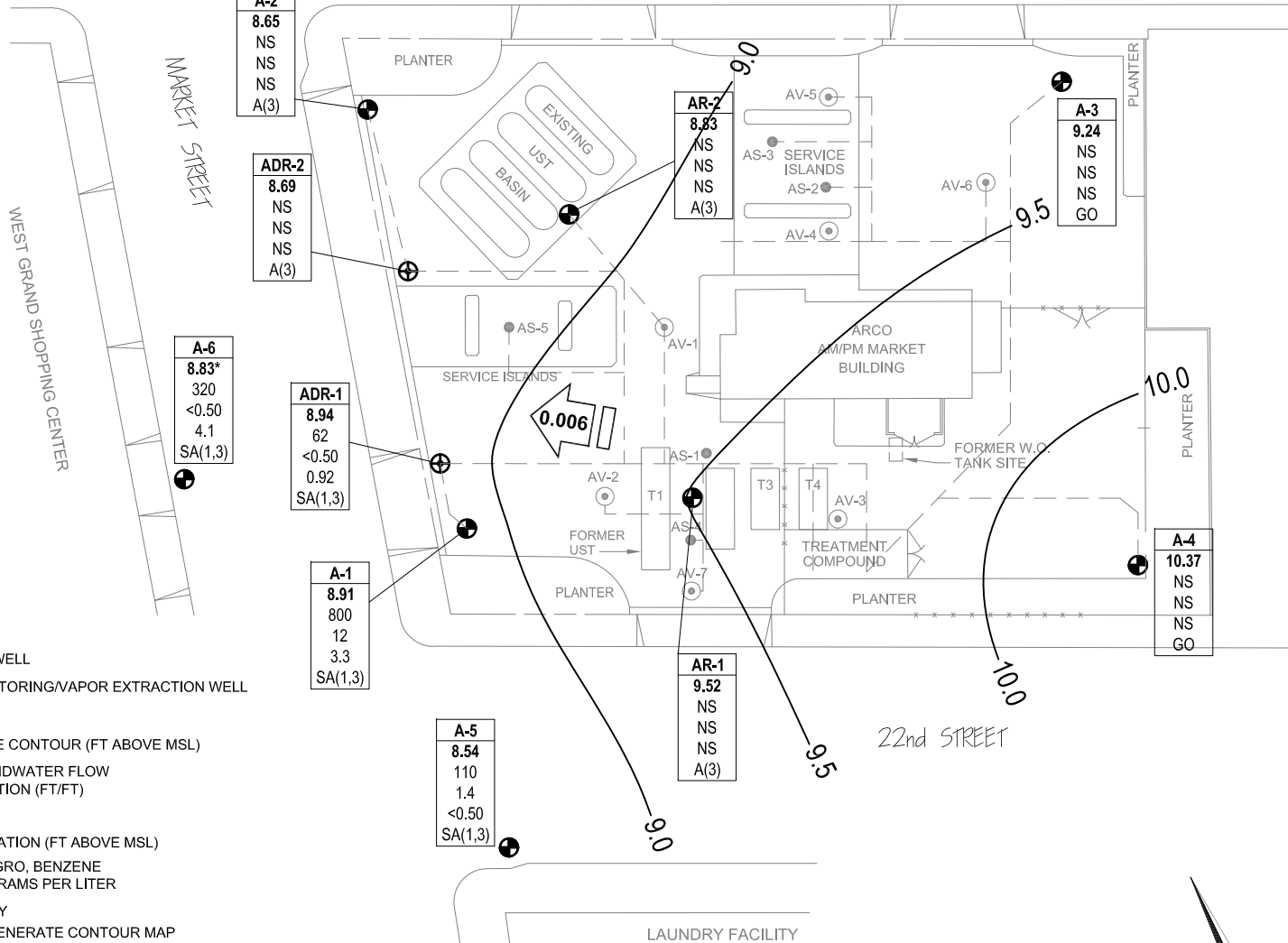

IMAGE SOURCE: USGS

WEST GRAND AVENUE



LEGEND

- MONITORING WELL
 - VAPOR EXTRACTION WELL
 - GROUNDWATER MONITORING/VAPOR EXTRACTION WELL
 - AIR SPARGING WELL
 - 9.0 GROUNDWATER TABLE CONTOUR (FT ABOVE MSL)
 - APPROXIMATE GROUNDWATER FLOW GRADIENT AND DIRECTION (FT/FT)
- | Well | WELL DESIGNATION |
|---------|--|
| ELEV | GROUNDWATER ELEVATION (FT ABOVE MSL) |
| GRO | CONCENTRATION OF GRO, BENZENE AND MTBE IN MICROGRAMS PER LITER |
| Benzene | |
| MTBE | |
| A/Q | SAMPLING FREQUENCY |
- * WELL NOT USED TO GENERATE CONTOUR MAP
 - < NOT DETECTED AT OR ABOVE LABORATORY REPORTING LIMIT
 - NS NOT SAMPLED
 - A(3) SAMPLED ANNUALLY, 3RD QUARTER
 - SA SAMPLED SEMI-ANNUALLY, 1ST & 3RD QUARTERS
 - GO GAUGE ONLY
 - — REMEDIATION PIPING

NOTE: SITE MAP ADAPTED FROM IT CORPORATION FIGURES.
SITE DIMENSIONS AND FACILITY LOCATIONS NOT VERIFIED.

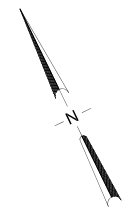

BROADBENT & ASSOCIATES, INC.
ENGINEERING, WATER RESOURCES & ENVIRONMENTAL
1324 Mangrove Ave. Suite 212, Chico, California 95926
Project No.: 06-88-621 Date: 3/23/2010

ARCO Service Station #2169
889 West Grand Avenue
Oakland, California

Ground-Water Elevation Contour
and Analytical Summary Map
3 March 2010

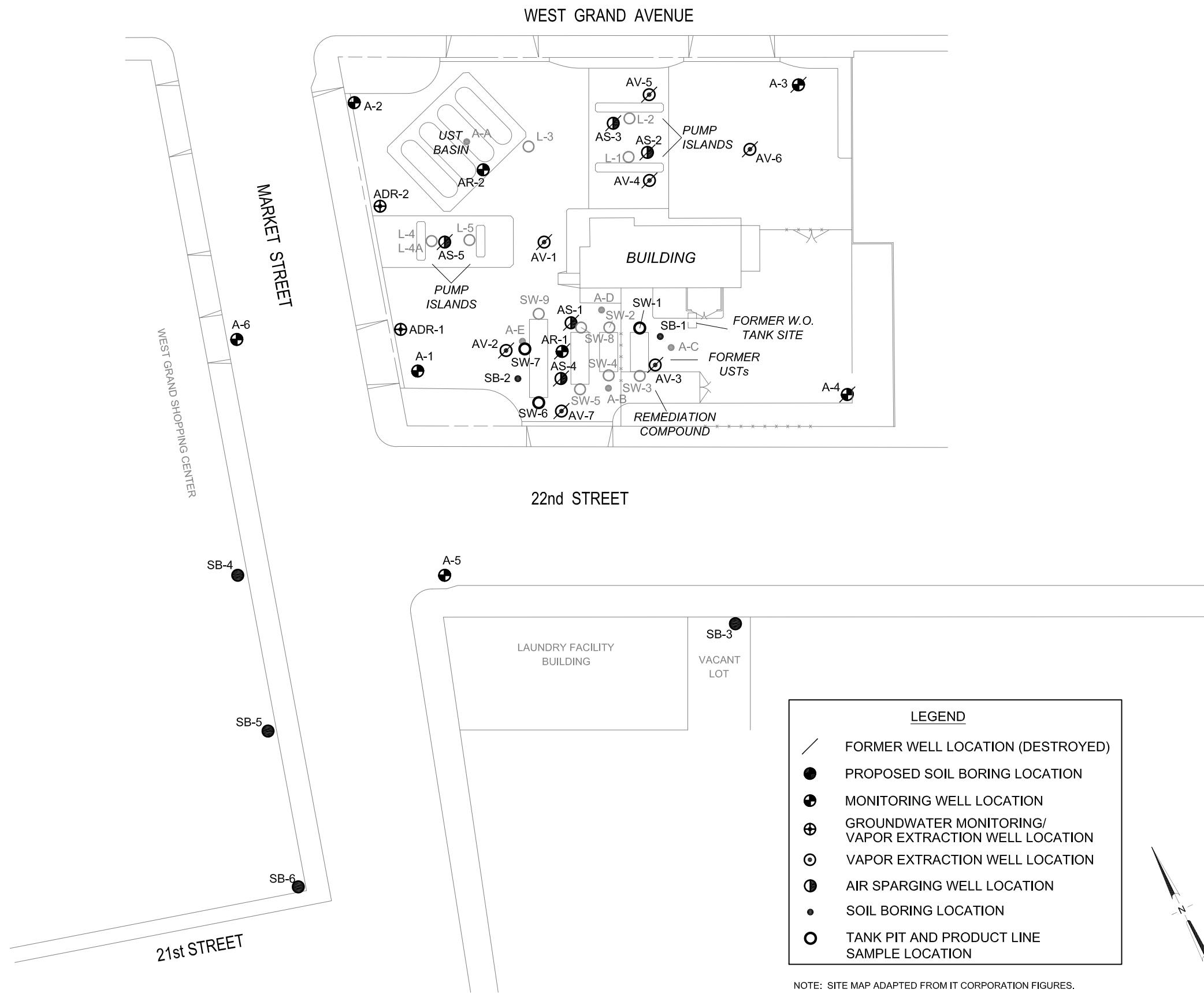

LEGEND	
	FORMER WELL LOCATION (DESTROYED)
	PROPOSED SOIL BORING LOCATION
	MONITORING WELL LOCATION
	GROUNDWATER MONITORING/ VAPOR EXTRACTION WELL LOCATION
	VAPOR EXTRACTION WELL LOCATION
	AIR SPARGING WELL LOCATION
	SOIL BORING LOCATION
	TANK PIT AND PRODUCT LINE SAMPLE LOCATION

NOTE: SITE MAP ADAPTED FROM IT CORPORATION FIGURES.

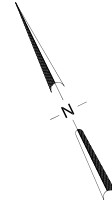

BROADBENT & ASSOCIATES, INC.
 ENGINEERING, WATER RESOURCES & ENVIRONMENTAL
 1324 Mangrove Avenue, Suite 212 Chico, CA
 Project No.: 06-08-621 Date: 9/17/2010

ARCO Service Station #2169
 889 West Grand Avenue
 Oakland, California

Former Site Layout Plan with
 Well and Soil Boring Locations