

RECEIVED
 2:27 pm, Apr 15, 2009
 Alameda County
 Environmental Health

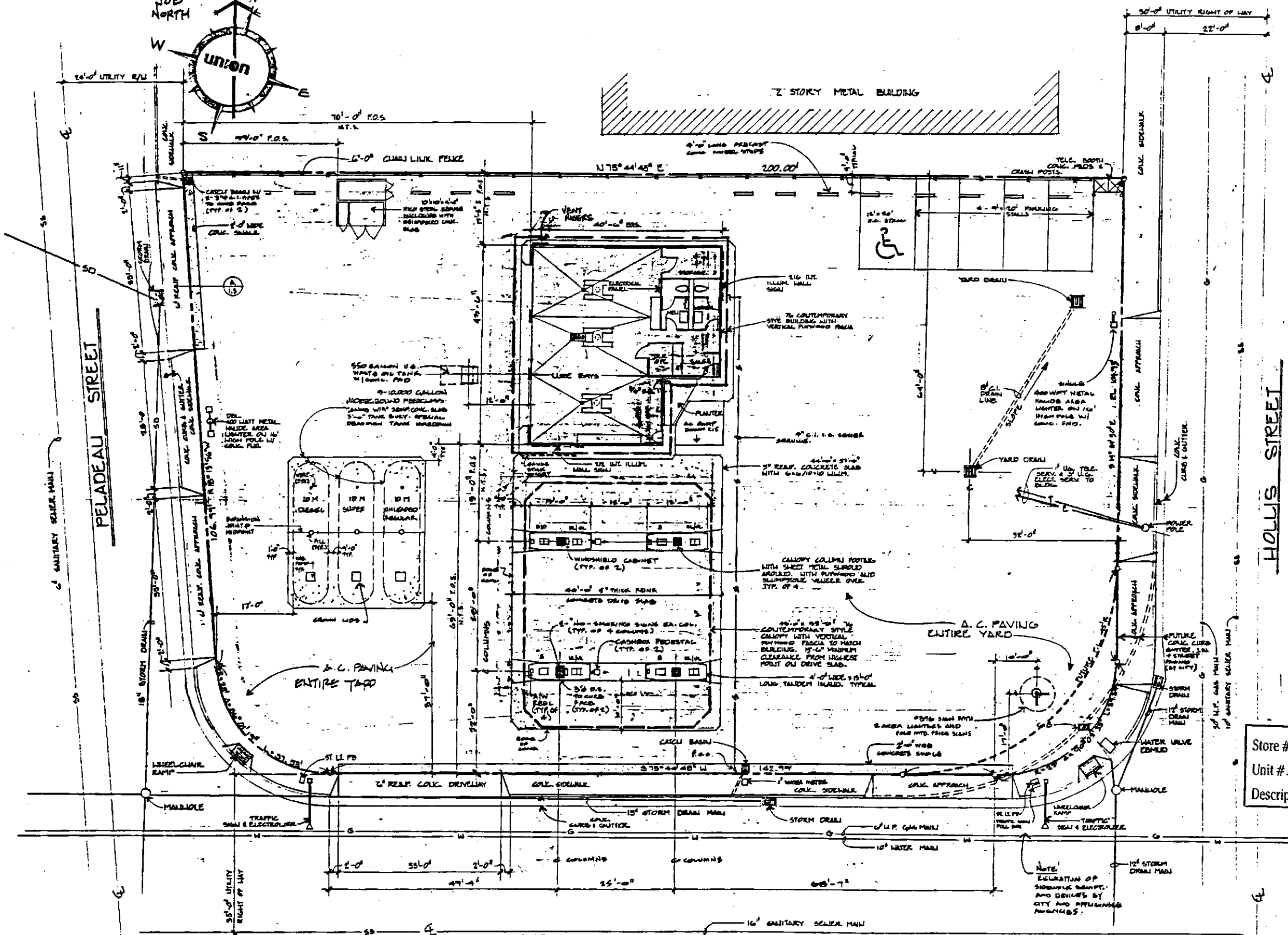

WESTERN REGION DUX:
 #9532

Store # 253737 Date: 7/27/79
 Unit # 3737 Code: GEN Color
 Description: GEN ARRANGEMENT

6-7-85 CASE OFFICE ARCHITECT
 8-15-82 AS BUILT DWG.
 7-6-81 FINISHED FOR BID
 6-15-81 REVIEW FOR BUILDING PERMIT

**GENERAL ARRANGEMENT
 SERVICE STATION # 3737**
 1400 POWELL STREET & HOLLIS STREET
 EMERYVILLE, CALIFORNIA

PROPERTY OWNED BY UNION OIL COMPANY
 BOUNDED THIS
 GRAPHIC SCALE:
 1" = 10'-0"
 COMPLETION DATE: DEC. 1980 PETROLEUM ENGR.

UNION
 ST 1210
 7-27-79

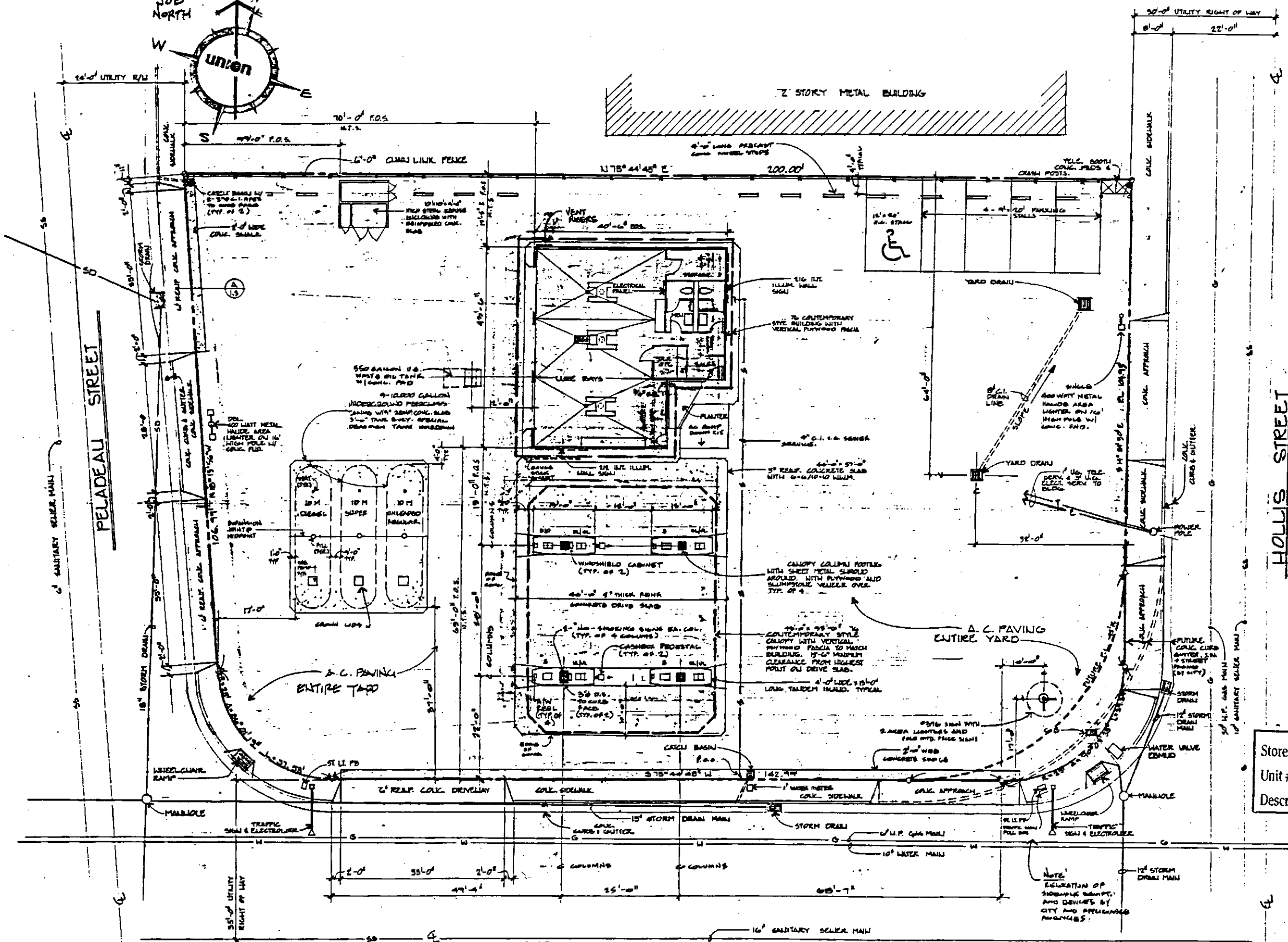
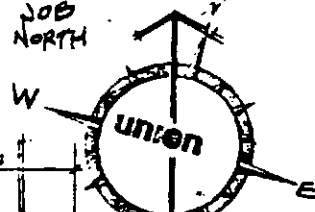

WESTERN REGION DUX:
#9532

Store # 253737 Date: 7/27/79
 Unit # 3737 Code: GEN Color
 Description: GEN ARRANGEMENT

6-7-88 CASE OFFICE ACTION
 8-15-82 AS BUILT DWG.
 7-6-81 FINISHED FOR BID
 6-15-81 REVISED FOR BUILDING PERMIT

**GENERAL ARRANGEMENT
 SERVICE STATION # 3737**
 1400 POWELL STREET & HOLLIS STREET
 EMERYVILLE, CALIFORNIA

PROPERTY OWNED BY UNION OIL COMPANY
 BOUNDED THIS

GRAPHIC SCALE:
 0 10 20 30 40 50

COMPLETION DATE: DEC. 1980 PETROLEUM ENGR.



ST 1:10
 7-27-79

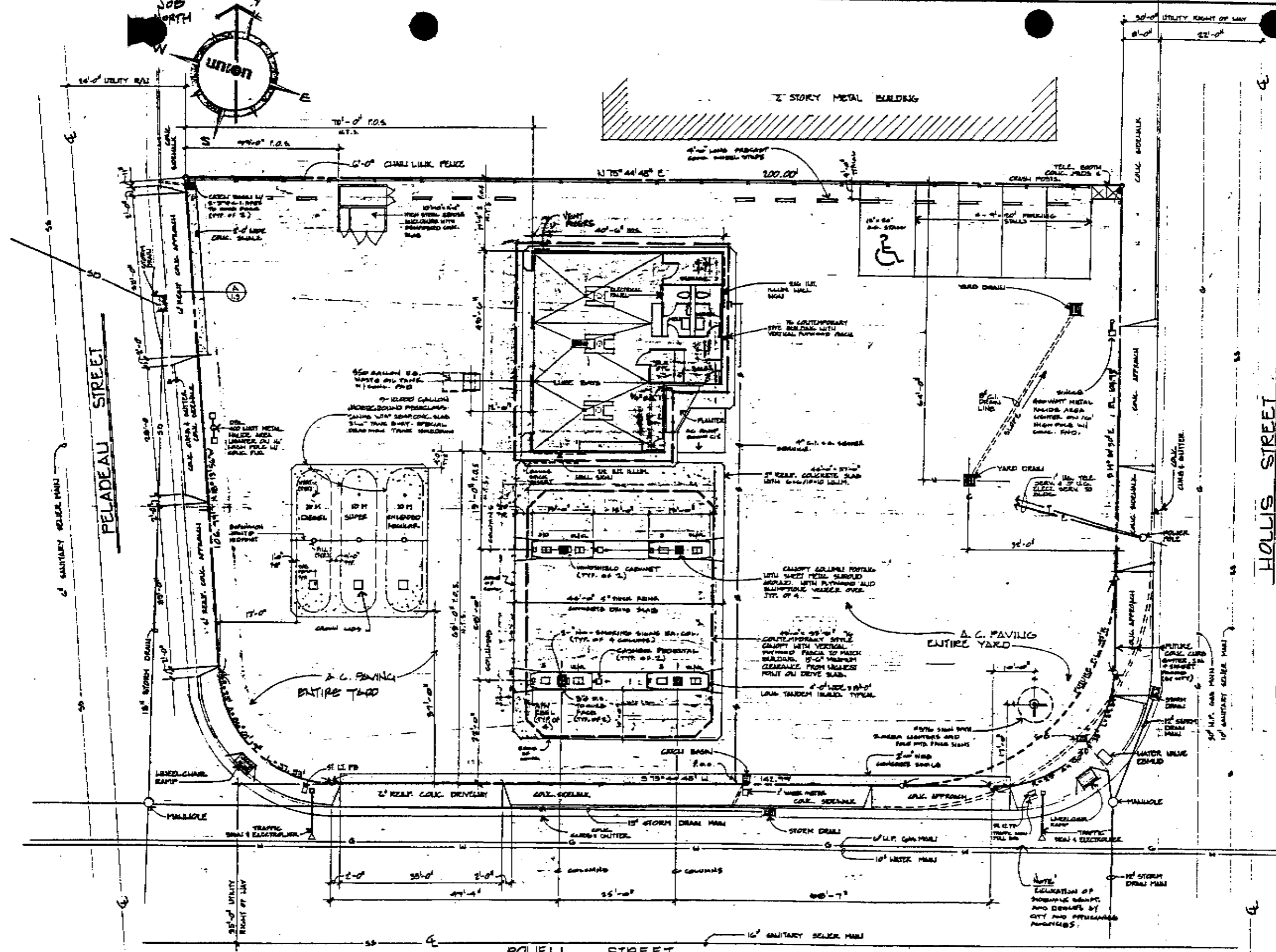

6-7-55 DATE OF PLAN
 8-15-55 AS BUILT DWG.
 7-6-51 FINISHED FOR BID
 6-7-51 REFER TO FOR BUILDING PERMIT

**GENERAL ARRANGEMENT
 SERVICE STATION # 3137**
 1400 POWELL STREET & HOLLIS STREET
 EMERYVILLE, CALIFORNIA

UNION
 ST. 12-21-79

PROPERTY OWNED BY UNION OIL COMPANY
 BOUNDED TRUG

GRAPHIC SCALE:
 1" = 20'-0"

COMPLETION DATE: DEC. 1950 PETROLEUM CORP.

3137