



December 15, 1997

Mr. Larry Seto  
Alameda County Department of Environmental Health  
1131 Harbor Bay Parkway, Room #250  
Alameda, California 94502-6577

Re: **Site Investigation Update**  
Former Shell Service Station  
2300 Santa Clara Avenue  
Alameda, California  
WIC# 204-0072-0908  
Cambria Project No. 240-0477

Dear Mr. Peacock:

On behalf of Shell Oil Products Company (Shell), Cambria Environmental Technology, Inc. (Cambria) is presenting an update on the subsurface investigation for the site referenced above. This investigation was outlined in Cambria's November 8, 1996 work plan, which was approved by your office in a letter dated November 20, 1996. This letter includes the results of our historical review, proposed boring locations, and an updated schedule.

The site is presently a parking lot for the Long's Drugstore located immediately to the east of the site along Santa Clara Avenue. Cambria performed a historical review to determine the locations for the proposed GeoProbe<sup>®</sup> borings at the site of the former Shell station. The historical review was only able to determine the location of the station building and canopies, not the location of the underground tanks. The 1950 site layout is shown in Figure 1.

The proposed boring locations based on the historical review are shown on Figure 1. Our work plan stated that eight to twelve borings would be installed. The exact number and location of the borings will be determined in the field based on site conditions.

We plan to install the borings in January 1998, and submit a report on the work by the end of February 1998. We will call you at least 48 hours before the field work is performed. Shell has obtained an access agreement from Long's Drugstores to perform the work onsite. Cambria will obtain boring permits from the Alameda County Public Works Department

CAMBRIA  
ENVIRONMENTAL  
TECHNOLOGY, INC.

1144 65TH STREET,

Mr. Larry Seto  
December 15, 1997

CAMBRIA

We appreciate this opportunity to work with you on this project. Please call if you have any questions or comments.

Sincerely,  
Cambria Environmental Technology, Inc.

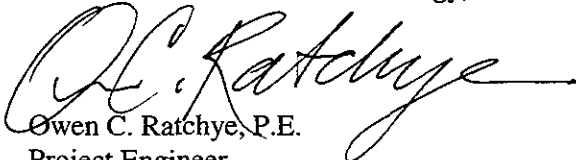

Owen C. Ratchye, P.E.  
Project Engineer

cc: Mr. A. E. (Alex) Perez, Shell Oil Products Company, P.O. Box 8080, Martinez, California 94553

\\Serverf\_drive\PROJECTSHELL\ALA2300\97 Correspondence\Ltr\_locations\_GeoProbes.wpd

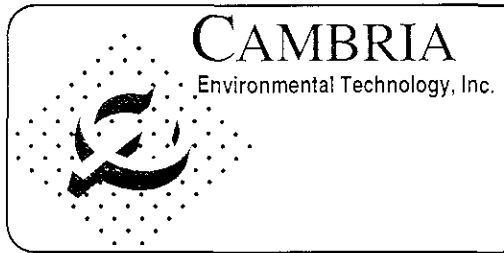
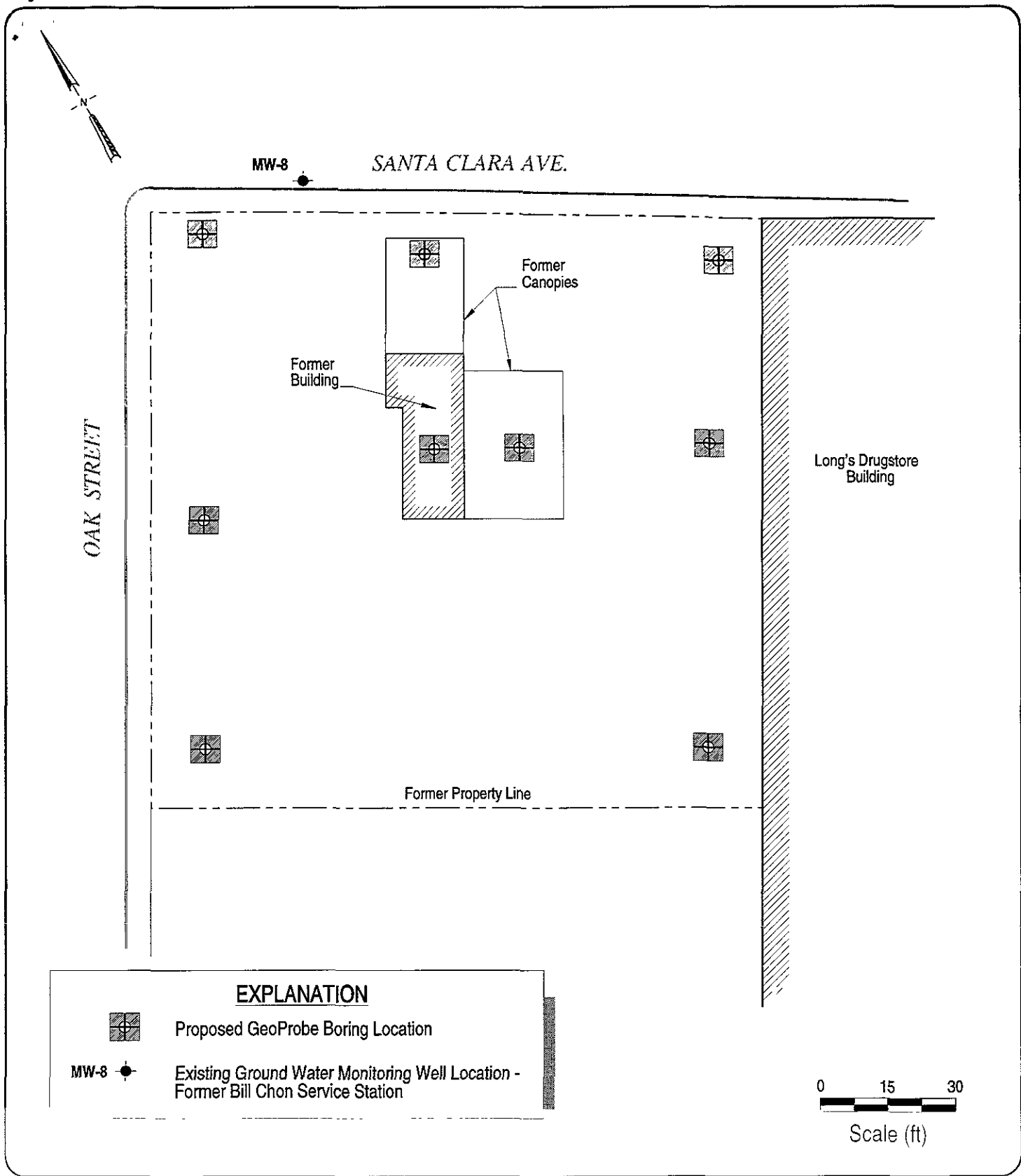

Former Shell Service Station  
2300 Santa Clara Avenue  
Alameda, California

F:\PROJECTS\ELL\_A\2300\FIGURES\PROP BOR.DWG

Site Map With  
Proposed Boring Locations

FIGURE  
**1**