

Ro 58



720 Southpoint Blvd. Suite 207  
Petaluma, CA 94954  
Phone (707) 765-0466, Fax (707) 765-0366

# TRANSMITTAL

TO: Mr. Donald Hwang  
Alameda County Dept. of Public Health  
1131 Harbor Bay Parkway, Suite 250  
Alameda, CA 94502

DATE: October 12, 2004  
PROJECT NO. 06-459-6129-03  
SUBJECT: 76 Service Station 6129  
Oakland, California

From: Jeremy Smith

GC: 1-1-2004

### WE ARE SENDING YOU:

COPIES	DATED	DESCRIPTION
1	10/11/04	Subsurface Utility Survey

### THESE ARE TRANSMITTED as checked below:

- For review and comment
- As Requested
- For Approval
- Approved as submitted
- Approved as noted
- Returned for corrections
- For your files
- For your use
- As noted below

### COMMENTS:

Attached is a copy of the Subsurface Utility Survey for the above referenced site. The attached report includes the locations of sensitive utilities and due to security issues, should not be made available for public viewing. Please call with questions.  
Thanks.

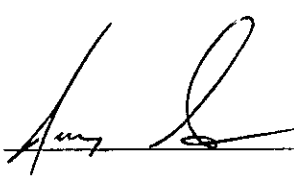
Signed: 

COPIES TO: Mr. Thomas Kosel, (electronic copy)



76 Broadway  
Sacramento, CA 95818  
phone 916.558.7676  
fax 916.558.7639

October 11, 2004

Mr. Don Hwang  
Alameda County Health Agency  
1131 Harbor Bay Parkway, Suite 250  
Alameda, CA 94502

Re: **Document Transmittal**  
Fuel Leak Case No. RO0000058  
76 Station 6129  
3420 35th Avenue  
Oakland, California

Dear Mr. Hwang:

Please find attached the *Subsurface Utility Survey, dated 10/11/04* for the above referenced site. I declare, under penalty of perjury, that to the best of my knowledge the information and/or recommendations contained in the attached proposal or report is true and correct.

If you have any questions or need additional information, please call me at (916) 558-7666.

Sincerely,

A handwritten signature in black ink, appearing to read "Thomas H. Kosel".

Thomas H. Kosel  
Site Manger, Risk Management and Remediation  
ConocoPhillips  
76 Broadway, Sacramento, CA 95818

Attachment

cc: Jed Douglas, Miller Brooks



October 11, 2004

Mr. Thomas Kosel  
ConocoPhillips  
76 Broadway  
Sacramento, California 95818

SITE: 76 STATION 6129  
3420 35<sup>th</sup> AVENUE  
OAKLAND, CALIFORNIA

RE: SUBSURFACE UTILITY SURVEY

Dear Mr. Kosel:

Miller Brooks Environmental, Inc. (Miller Brooks), on behalf of ConocoPhillips Company (ConocoPhillips), submits this report detailing the results of a subsurface utility survey. The requested public well search is in progress, and the results will be transmitted under separate cover.

#### **SITE DESCRIPTION**

The site is currently an operating 76 Service Station that dispenses gasoline stored in two 12,000-gallon underground storage tanks (USTs) from two dispenser islands. An automotive repair building is present at the site, which contains three service bays. Additionally, there is one used-oil UST, three hydraulic lifts, and three groundwater monitoring wells (MW-1 through MW-3) present at the site. There was previously one former used-oil UST, one former clarifier was present beneath the central hydraulic lift, and two floor drains have previously been removed. Pertinent current and former site features are displayed on Figure 1. A former Exxon service station is located to the northeast immediately across Quigley Street.

#### **SUBSURFACE UTILITY SURVEY**

Miller Brooks performed a subsurface utility survey of the area around the site, as requested by the Alameda County Environmental Health Services (ACEHS). Utility maps were available for review at Pacific Gas and Electric Company and the City of Oakland. The maps of natural gas, electric, sanitary sewer and storm drains were utilized to prepare the utility survey map (Figure 1). Maps of the locations of water and telephone utilities were not available due to security concerns. The utility survey map shows the location, diameter, flow direction (where applicable) and approximate depth of the reviewed utilities. Precise depths are not available, although gas, electric, water and communication utilities are typically encountered within three to four feet of the surface. The deepest utility in the site vicinity appears to be the storm sewer line, located at a depth of approximately 16 feet below ground surface (bgs). Since groundwater is present at approximately 30 feet bgs, Miller Brooks believes that the presence of subsurface utilities does not provide a conduit for the potential migration of hydrocarbon impacted groundwater.

If you have any questions regarding this report, please call us at (707) 765-0466.

Sincerely,

MILLER BROOKS ENVIRONMENTAL, INC.

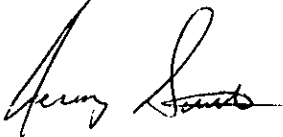

Jeremy A. Smith  
Senior Staff Scientist

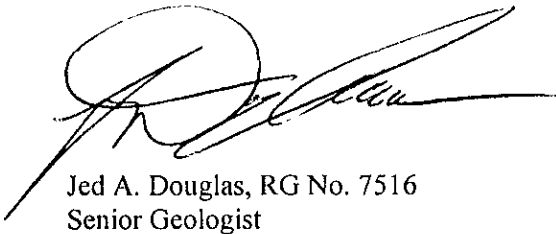
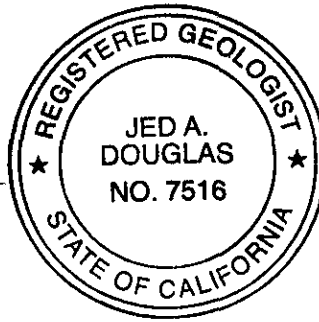

Jed A. Douglas, RG No. 7516  
Senior Geologist

Attachments:                    Figure 1 – Subsurface Utility Map

cc: Mr. Don Hwang, ACHCS, 1131 Harbor Bay Parkway, Alameda, CA 94502

**LEGEND**

GROUNDWATER MONITORING WELL

SOIL BORING LOCATIONS (2003)

SB 2 ⊕ ATTEMPTED SOIL BORING

EB1 ⊕ SOIL BORING LOCATIONS (1990)

GASOLINE UNDERGROUND STORAGE TANK

DISPENSER ISLAND

H HOIST

UTILITY	SYMBOL	DEPTH (APPROXIMATE)
STORM DRAIN	SD →	16
GAS	G ---	3 FT
ELEC.	E ---	3-4 FT
SANITARY SEWER	S ---	8 FT

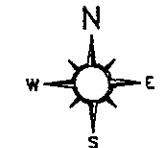
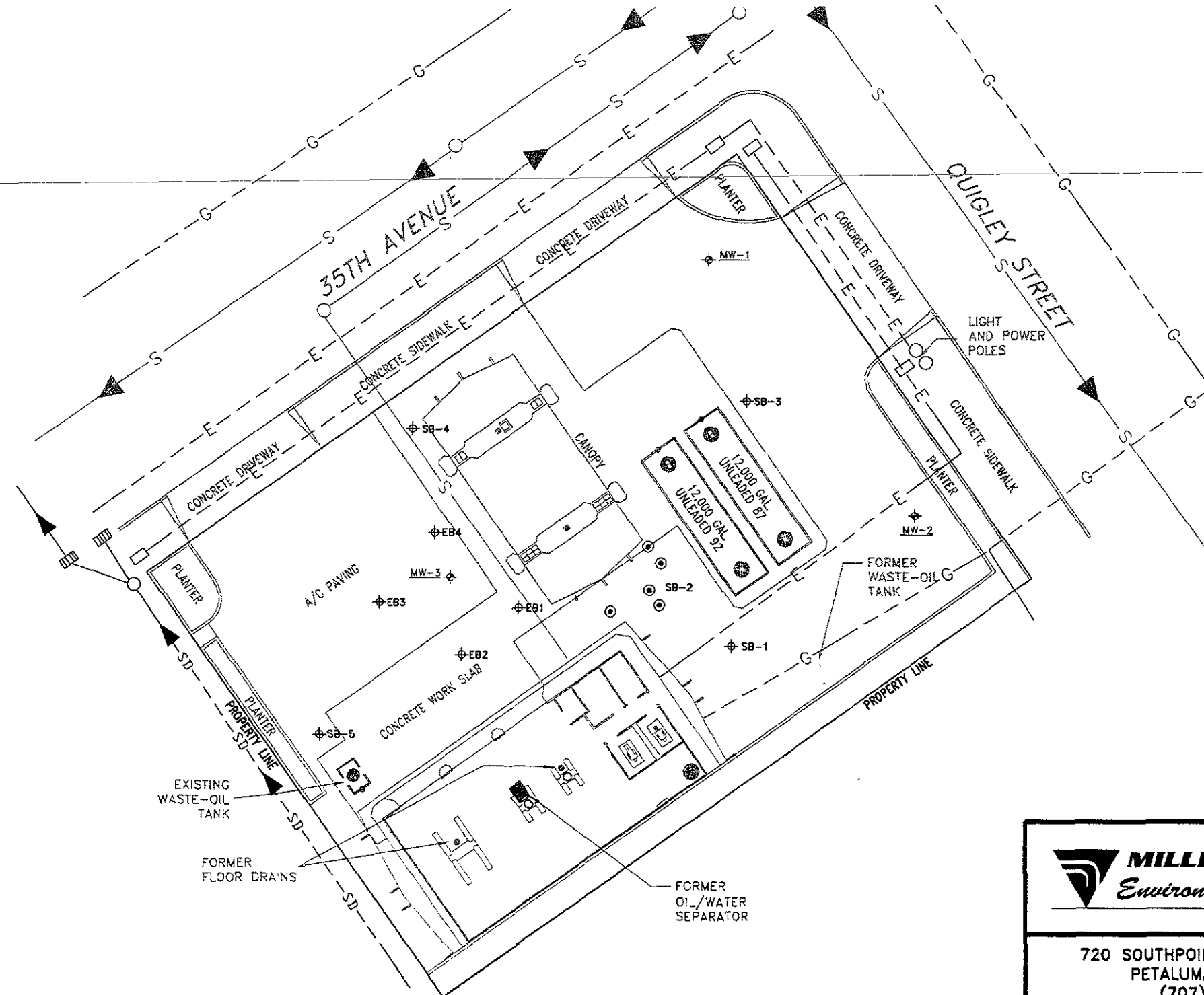

	DRAWN BY: AIL	SUBSURFACE UTILITY MAP	<b>FIGURE</b>  <b>1</b>
	DATE: 11/19/03		
720 SOUTHPOINT BLVD., SUITE 207 PETALUMA, CA. 94954 (707) 765-0466	REVISED BY: JAS	76 STATION NO. 6129 3420 35TH AVENUE OAKLAND, CA.	FILE: K:\DWGS\C-P\NO. 6129 (3420 35TH ST. OAKLAND)\SITE PLAN DATE PLOTTED: 11/20/03
	REVISED: 10/4/04		
PROJECT NO. 06-459-6129-03	APPROVED BY: JAD		
	DATE: 11/20/03		