

LOSS



ENVIRONMENTAL STRATEGIES CONSULTING LLC
2025 Gateway Place, Suite 280 ▪ San Jose, CA 95110 ▪ (408) 453-6100

RECEIVED

JUN 23 2005

June 23, 2005

Barney Chan
Alameda County Environmental Health
1131 Harbor Bay Parkway
Alameda, CA 94502-6577

ENVIRONMENTAL HEALTH SERVICES

Re: Groundwater Well Destruction at the Former Clearprint Paper Company, Inc. located at 1482 67th Street in Emeryville, California

Dear Mr. Chan:

On behalf of the former Clearprint Paper Company (Clearprint), Environmental Strategies Consulting LLC (Environmental Strategies) undertook the destruction of two groundwater monitoring wells at the referenced site as part of the Leaking Underground Fuel Storage Tank – Local Oversight Program case closure activities requested by Alameda County Environmental Health (ACEH). Monitoring wells MW-1 and MW-2 are plotted on Figure 1. Monitoring well MW-3 was formerly part of Clearprint's groundwater monitoring program. MW-3 was paved over by an unknown entity, creating a thin asphalt cover over the well. Environmental Strategies documented the well's uncovering and inspection in a letter to ACEH dated June 17, 2005.

A drilling permit was obtained from the Alameda County Public Works Agency, Water Resources (ACPWA) before destruction of the two groundwater monitoring wells (Permit W2005-0633 to W2005-0634; Enclosure A). Before field activities commenced, an encroachment permit was obtained from the City of Emeryville, Department of Public Works for access to MW-1, which is located on the sidewalk (Permit No. PW060603; Enclosure B). Drilling activities were performed by Hew Drilling Company, a C57 licensed drilling contractor (C57-604987) from East Palo Alto, California.

Groundwater monitoring wells MW-1 and MW-2 were destroyed on June 22, 2005, in accordance with the drilling permit conditions. All work was performed under the direction of a California registered geologist. Access to MW-1 was conducted in accordance with the general provisions of the encroachment permit provided by the City of Emeryville. Both MW-1 and MW-2 have total depths of less than 30 feet each; therefore, in accordance with the permit conditions, both wells were pressure grouted with cement. George Bolton, inspector of ACPWA, was present during well destruction activities and inspected the process. According to Mr. Bolton, the drilling permit serves as proof of well destruction for monitoring wells MW-1 and MW-2 (see "permit valid date" of June 22, 2005 in Enclosure A).

June 23, 2005

We look forward to obtaining the closure certification for the referenced site no later than June 30, 2005.

Sincerely,

A handwritten signature in black ink that reads "Richard E. Freudenberger / for". The signature is written in a cursive, flowing style.

Richard E. Freudenberger
Partner

SNH:snh:gmb

Enclosures

g:\\$client\\$\archive\4101-4199\41031.doc

cc/encl.: Donna Drogos, Alameda County Environmental Health
Gail Port, Esquire, Proskauer Rose LLP

I certify under penalty of law that I have personally examined and am familiar with the information submitted in this document and all attachments and that, based on my inquiry of those individuals immediately responsible for obtaining the information, I believe that the information is true, accurate, and complete. I am aware that there are significant penalties for submitting false information, including the possibility of fine and imprisonment.

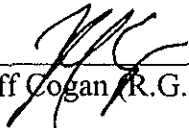

Jeff Cogan (R.G. 6182)

6/23/05
Date

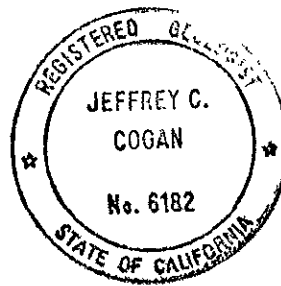

Figure 1 – Site Layout

LEGEND

- SB-1 ⊕ SOIL BORING
- MW-1 ⊕ MONITORING WELL
- A.C. ASPHALT CONCRETE
- CVR. ELEVATION ON STEEL COVER
- PVC ELVEATION ON TOP OF WELL CASING AT NOTCH NORTH SIDE.

BENCHMARK INFORMATION

EMERYVILLE CITY BM#5, DESCRIBED AS:
 EBM 15 NGS AZIMUTH MARK FOR S. BERKELY BASE
 (DESTROYED) AT 65th ST. AND W. LINE OF SP R/W
 9FT N. OF S. LINE OF BAY ST.
 ADJUSTED ELEVATION = 16.17

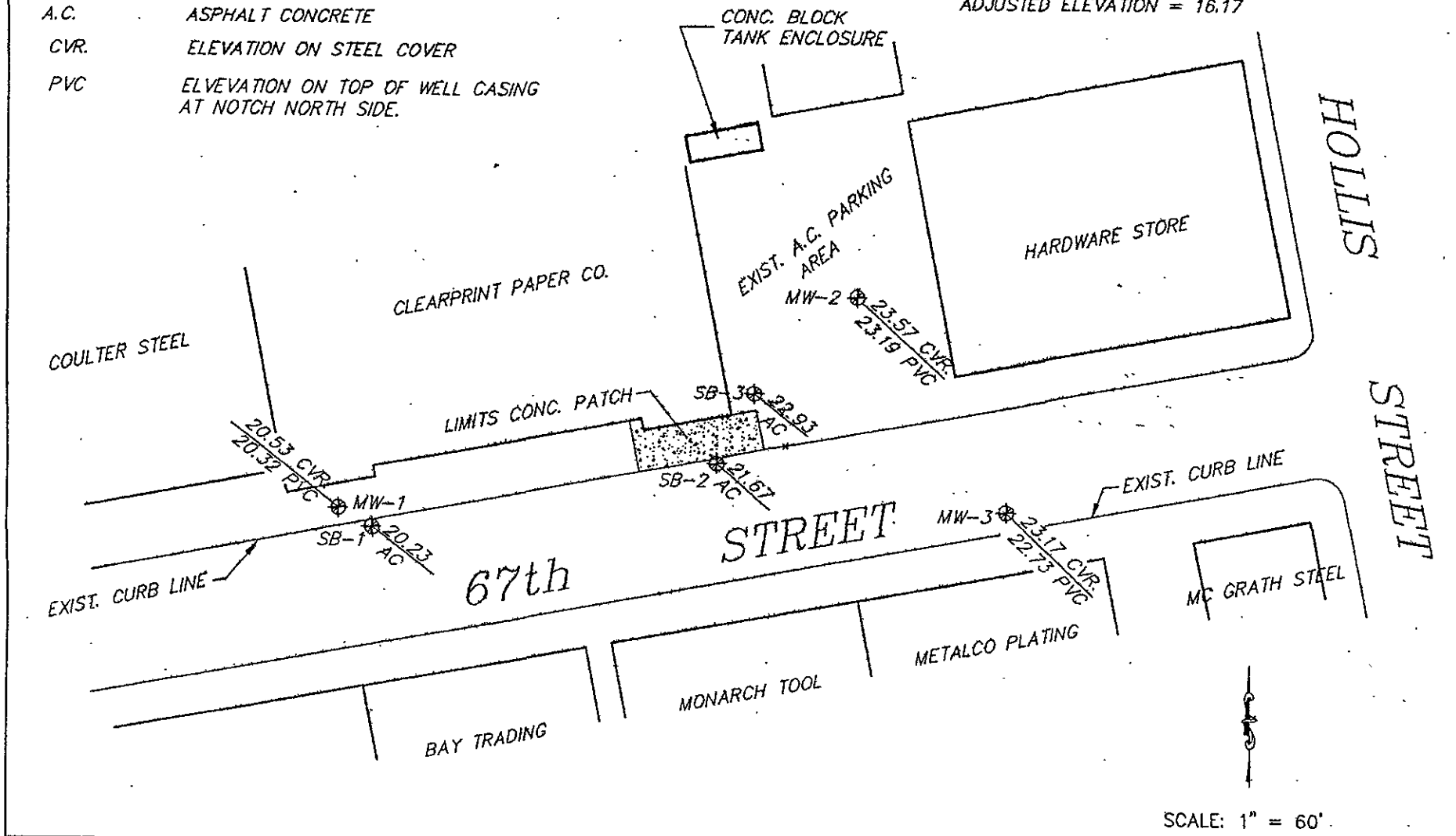

ENVIRONMENTAL STRATEGIES CONSULTING LLC
 2025 GATEWAY PLACE, SUITE 280
 SAN JOSE, CALIFORNIA 95110
 408-453-6100

Figure 1
Site Layout
Former Clearprint Paper Company Facility
Emeryville, California

Enclosure A – Drilling Permit

Alameda County Public Works Agency - Water Resources Well Permit



399 Elmhurst Street
Hayward, CA 94544-1395
Telephone: (510)670-6633 Fax:(510)782-1939

Application Approved on: 06/10/2005 **By:** jamesy
Permits Issued: W2005-0633 to W2005-0634

Permits Valid from: 06/22/2005 to 06/22/2005

Application Id: 1118440922067
Site Location: 1482 67th Street
Project Start Date: 06/22/2005

City of Project Site: Emeryville

Completion Date: 06/22/2005

Applicant: Environmental Strategies Consulting, Inc -
Robert Bealkowski
2025 Gateway Place, Suite 280, San Jose, CA 95110

Phone: 408-453-6100

Property Owner: Clear Print Company
1482 67th Street, Emeryville, CA 94608

Phone: --

Client: ** same as Property Owner **

Total Due: \$600.00
Total Amount Paid: \$600.00
Paid By: CHECK **PAID IN FULL**

Works Requesting Permits:

Well Destruction-Monitoring - 2 Wells

Driller: HEW Drilling - Lic #: 604987 - Method: press

Work Total: \$600.00

Specifications

Permit #	Issued Date	Expire Date	Owner Well Id	Hole Diam.	Casing Diam.	Seal Depth	Max. Depth	State Well #	Orig. Permit #	DWR #
W2005-0633	06/10/2005	09/20/2005	MW-1	8.00 in.	2.00 in.	0.00 ft	23.00 ft			
W2005-0634	06/10/2005	09/20/2005	MW-2	8.00 in.	2.00 in.	0.00 ft	27.00 ft			

Specific Work Permit Conditions

1. Drilling Permit(s) can be voided/ cancelled only in writing. It is the applicant's responsibilities to notify Alameda County Public Works Agency, Water Resources Section in writing for an extension or to cancel the drilling permit application. No drilling permit application(s) shall be extended beyond ninety (90) days from the original start date. Applicants may not cancel a drilling permit application after the completion date of the permit issued has passed.

2. Compliance with the well-sealing specifications shall not exempt the well-sealing contractor from complying with appropriate State reporting-requirements related to well destruction (Sections 13750 through 13755 (Division 7, Chapter 10, Article 3) of the California Water Code). Contractor must complete State DWR Form 188 and mail original to the Alameda County Public Works Agency, Water Resources Section, within 60 days. Including permit number and site map.

3. Pressure Grout with Cement (Less than 30 ft in depth)

4. Applicant shall contact George Bolton for a inspection time at 510-670-5594 at least five (5) working days prior to starting, once the permit has been approved. Confirm the scheduled date(s) at least 24 hours prior to drilling.

Enclosure B – Encroachment Permit



City of Emeryville • Department of Public Works
Encroachment Permit

PW060603

Environmental Strategies

APPLICANT Bob Beckowski
 CONTACT PERSON Bob Beckowski
 ADDRESS 2025 Gateway Place # 280 San Jose CA 95110
 PHONE 408-453-6100
 FAX 408-453-0496

Permit No. 20060603 Date Jan 10 05
 Permit Admin. Fee \$150
 Permit Inspection Deposit \$100
 Required Security Deposit \$1000
 \$10,000 Bond Bond #
 \$1000 Permit Bond
 Bond # Bond #
 Total Payment Required
 Received CA Date 6/10/05
 Receipt # 11827
 Failure to obtain approval of final inspection of the work covered by this Encroachment Permit within one (1) year of the estimated completion date shall result in the loss of the security deposit which shall be retained by the City of Emeryville.

OWNER/DEVELOPER OF FACILITIES
Clear Print Paper Co. c/o GPL International
 ADDRESS 1482 67th St, Emeryville, CA 94608
 PHONE (631) 752-9600
 FAX (631) 752-9618

CONTRACTOR DOING WORK
HEW Drilling
 CONTACT PERSON Henry
 ADDRESS P.O. Box 51182 Palo Alto, CA 94303 PHONE 650-322-2851 FAX 650-322-0339
 LICENSE NO. 604987 CLASS C57

Yes No CURRENT CITY BUSINESS LICENSE ON FILE
 Yes No PROVIDE PROOF OF INSURANCE
 EST. START DATE 7-22 EST. COMPLETION DATE 8-22 EST. COST IN CITY R/W \$1,000

LOCATION OF WORK 1482 67th Street, Emeryville, CA 94608 on sidewalk

- CHECK ALL THAT APPLY
- Traffic Control Survey Sidewalk Detour Dumpster Temporary No Parking
 - Private Facilities on Public Right of Way Construction Sidewalk Driveway Approach Curb & Gutter Pedestrian Ramp Water Service Utility Maintenance Fence Excavation Obstruction Access Road Monitoring Well Sewer Lateral Storm Drain

FULLY DESCRIBE PROPOSED WORK WITHIN CITY RIGHT-OF-WAY (additional space on reverse if needed): Attach 3 complete sets of plans 8 1/2 X 11, if applicable.

Abandon 1 groundwater monitoring well on sidewalk (MW-1) see attached map. Also attached is permit application w/ Alameda County Public Works. No traffic control or sidewalk detour necessary. 8 hours.