

**Drogos, Donna, Env. Health**

---

**From:** Rick Freudenberger [rfreudenberger@escsj.com]  
**Sent:** Monday, June 27, 2005 5:13 PM  
**To:** Drogos, Donna, Env. Health  
**Cc:** gport@proskauer.com; hkindler@olshanlaw.com; michael@northamericancapital.com; Sharon Harichandran; Chan, Barney, Env. Health  
**Subject:** 1482 67th., Emeryville - Former Clearprint Site-ACEH Closure Certification

Donna,

I spoke with Barney Chan late today and he had taken the closure letters to the Director's office today for signature and found that the Director is on vacation until "Wednesday or Thursday." Barney suggested I check with you as to whether someone else was authorized to sign the documents in the Director's absence. I will call you on Tuesday morning, 6/28 to check with you about this.

Thanks.

Rick Freudenberger  
Environmental Strategies Consulting LLC  
2025 Gateway Place Suite 280  
San Jose, CA 95110  
408-453-6100  
fax 408-453-0496

Important Notice: The information contained in this e-mail, including any attachments, is not intended and should not be construed as an official confirmation of any transaction unless expressly provided. Furthermore, this e-mail may contain information that is confidential, non-public and protected by privilege from disclosure. If you are not the intended recipient, please delete this e-mail, including attachments, and notify the sender. The unauthorized use, dissemination, distribution or reproduction of this e-mail, including attachments, is prohibited and may be unlawful.

**Drogos, Donna, Env. Health**

---

**From:** Sharon Harichandran [sharichan@escsj.com]  
**Sent:** Thursday, June 23, 2005 10:15 AM  
**To:** Drogos, Donna, Env. Health  
**Cc:** Rick Freudenberger; Chan, Barney, Env. Health; gport@proskauer.com; hkindler@olshanlaw.com; michael@northamericancapital.com  
**Subject:** 1482 67th Street, Emeryville - Former Clearprint Site - ACEH Closure Certificatio

Donna,

As a follow up to Rick Freudenberger's e-mail dated June 20, 2005, monitoring wells MW-1 and MW-2 were destroyed at the referenced site on June 22, 2005. The ACDPW inspector was present during well destruction activities. As previously noted, Environmental Strategies will drop off a copy of the letter documenting the well destruction activities to ACEH this afternoon.

In addition, we will also drop off a copy of Environmental Strategies' letter dated June 17, 2005, which documented the uncovering and inspection of MW-3 and was provided to Mr. Barney Chan of ACEH.

We plan to meet with Barney on Monday, June 27, 2005 to assist in any way possible to expedite the closure certification. The purchase agreement for the property transaction requires the closure certification by June 30, 2005 and we appreciate your assistance in helping us meet this deadline.

Best,  
Sharon

---

Sharon Harichandran  
Consultant  
Environmental Strategies Consulting LLC  
2025 Gateway Place, Suite 280  
San Jose, CA 95110  
Tel. (408) 453-6100  
Cell (408) 892-1253  
Fax (408) 453-0496

**Important Notice:** The information contained in this e-mail, including any attachments, is not intended and should not be construed as an official confirmation of any transaction unless expressly provided. Furthermore, this e-mail may contain information that is confidential, non-public and protected by privilege from disclosure. If you are not the intended recipient, please delete this e-mail, including attachments, and notify the sender. The unauthorized use, dissemination, distribution or reproduction of this e-mail, including attachments, is prohibited and may be unlawful.

7055

**Drogos, Donna, Env. Health**

---

**From:** Rick Freudenberger [rfreudenberger@escsj.com]  
**Sent:** Monday, June 20, 2005 11:48 AM  
**To:** Drogos, Donna, Env. Health  
**Cc:** Chan, Barney, Env. Health; Sharon Harichandran; gport@proskauer.com; hkindler@olshanlaw.com; michael@northamericacapital.com  
**Subject:** 1482 67th., Emeryville - Former Clearprint Site-ACEH Closure Certification

Donna,

As a follow-up to our telephone discussions/e-mails on the referenced site over the past two weeks, I spoke with Barney Chan on Friday, 6/17 before he left for vacation. He indicated he had not yet received the referenced file from you---is it possible to ensure that he has the file upon his return on Monday, 6/27?

I dropped off a letter for Barney on Friday 6/17 with the MW-3 information....we located and uncovered the MW-3 well on Thursday, 6/16 and it was intact and undamaged. The letter includes this information as well as photographs of the well location and the well itself.

Monitoring wells MW-1 and MW-2 are undergoing destruction on Wednesday, 6/22 and we will drop off the ACDPW inspector's report on the well destruction on or before Friday, June 24.

We plan to visit with Barney on Monday, 6/27 to assist in any way possible expediting the closure certification. As we previously noted, the purchase agreement for the property transaction requires the closure certification by 6/30.

Thanks again for your kind assistance in helping us meet a critical deadline. If you have any questions or information, please don't hesitate to call. If you can't reach me, please speak with Sharon Harichandran in our office at 408-453-6100.

Rick Freudenberger  
Environmental Strategies Consulting LLC  
2025 Gateway Place Suite 280  
San Jose, CA 95110  
408-453-6100  
fax 408-453-0496

**Important Notice:** The information contained in this e-mail, including any attachments, is not intended and should not be construed as an official confirmation of any transaction unless expressly provided. Furthermore, this e-mail may contain information that is confidential, non-public and protected by privilege from disclosure. If you are not the intended recipient, please delete this e-mail, including attachments, and notify the sender. The unauthorized use, dissemination, distribution or reproduction of this e-mail, including attachments, is prohibited and may be unlawful.

**Drogos, Donna, Env. Health**

---

**From:** Rick Freudenberger [rfreudenberger@escsj.com]  
**Sent:** Monday, June 13, 2005 10:15 AM  
**To:** Chan, Barney, Env. Health; Drogos, Donna, Env. Health  
**Cc:** Sharon Harichandran; gport@proskauer.com  
**Subject:** Re: Site Closure--1482 67th Street, Emeryville, CA

Barney/Donna,

Per a call from Donna this morning re: the referenced site, we are making arrangements to locate MW-3 and uncover it to determine its' condition this week. Should the well be unusable, we will make arrangements to replace it, probably on June 22. We will document all of the activities associated with MW-3 and plan to also provide this information to ACEH on June 23 or June 24.

Thanks again for your help.

Rick Freudenberger  
Environmental Strategies Consulting LLC  
2025 Gateway Place Suite 280  
San Jose, CA 95110  
408-453-6100  
fax 408-453-0496

Important Notice: The information contained in this e-mail, including any attachments, is not intended and should not be construed as an official confirmation of any transaction unless expressly provided. Furthermore, this e-mail may contain information that is confidential, non-public and protected by privilege from disclosure. If you are not the intended recipient, please delete this e-mail, including attachments, and notify the sender. The unauthorized use, dissemination, distribution or reproduction of this e-mail, including attachments, is prohibited and may be unlawful.

ROSS

**Drogos, Donna, Env. Health**

---

**From:** Rick Freudenberger [rfreudenberger@escsj.com]  
**Sent:** Monday, June 13, 2005 9:22 AM  
**To:** Chan, Barney, Env. Health; Drogos, Donna, Env. Health  
**Cc:** gport@proskauer.com; acinamon@proskauer.com; Hyman Kindler; michael@northamericancapital.com; Sharon Harichandran  
**Subject:** Site Closure--1482 67th Street, Emeryville, CA

Barney/Donna,

Per a phone conversation with Barney this morning, he indicated that he had not yet received the referenced file. Assuming that he will receive it this week, the following schedule was discussed. The schedule is based on a deadline date to receive the closure certification letter by June 30, which date was established in the property sales agreement:

1. Environmental Strategies (Sharon Harichandran will be the person in the field) will proceed with the destruction of the two onsite wells (MW-1 and MW-2) on June 22. We have received the required permit and have scheduled an inspector from the Alameda County DPW to be onsite on June 22. We will also provide McGrath Steel with location information for MW-3 on or before June 22.
2. Barney will set up the paperwork by Friday, June 17 (before he leaves for vacation) so that the closure certification will be ready for issuance (pending the submittals noted below) when he returns from vacation on June 27.
3. Upon receipt of the well destruction report from Alameda County DPW, Environmental Strategies will hand carry the DPW report and the transmittal documentation to McGrath Steel, to ACEH in person, likely on June 23 or June 24.
4. On Monday, June 27, Environmental Strategies will come to ACEH in person to meet with Barney and coordinate the finalization of the closure certification letter.

We will give Barney a call later this week to verify the above schedule and any other requirements. **If at anytime, you need further information, please do not hesitate to contact myself, or Sharon Harichandran at 408-453-6100.**

Thank you in advance for assisting us in meeting the critical deadline. Your assistance is very, very much appreciated.

Rick Freudenberger  
Environmental Strategies Consulting LLC  
2025 Gateway Place Suite 280  
San Jose, CA 95110  
408-453-6100  
fax 408-453-0496

**Important Notice:** The information contained in this e-mail, including any attachments, is not intended and should not be construed as an official confirmation of any transaction unless expressly provided. Furthermore, this e-mail may contain information that is confidential, non-public and protected by privilege from disclosure. If you are not the intended recipient, please delete this e-mail, including attachments, and notify the sender. The unauthorized use, dissemination, distribution or reproduction of this e-mail, including attachments, is prohibited and may be unlawful.

7/13/2005

**Drogos, Donna, Env. Health**

---

**From:** Rick Freudenberger [rfreudenberger@escsj.com]  
**Sent:** Friday, June 03, 2005 1:42 PM  
**To:** Drogos, Donna, Env. Health  
**Cc:** gport@proskauer.com  
**Subject:** RO55: 1482 67th., Emeryville - Former Clearprint Site-ACEH Closure Certifica

Donna,

As a follow-up to previous e-mail sent on May 25, I represent Clearprint and wondered if you could let me know the status of the referenced case closure request and certification. This project was forwarded by ACEH to Cherie at the RWQCB on May 12 by Bob Schultz of ACEH. I spoke with Cherie this week and she signed off it and returned it to Bob the same day.

Can you let me know when we can expect the closure certification letter from ACEH? Clearprint is very anxious to have the case officially closed since they are selling the property.

I will be in the Oakland area on Tuesday, 6/7 and may stop by to see you personally if I don't hear back from you before then. Thanks very much in advance for your help. You may call or e-mail me with information.

Rick Freudenberger  
Environmental Strategies Consulting LLC  
2025 Gateway Place Suite 280  
San Jose, CA 95110  
408-453-6100  
fax 408-453-0496

Important Notice: The information contained in this e-mail, including any attachments, is not intended and should not be construed as an official confirmation of any transaction unless expressly provided. Furthermore, this e-mail may contain information that is confidential, non-public and protected by privilege from disclosure. If you are not the intended recipient, please delete this e-mail, including attachments, and notify the sender. The unauthorized use, dissemination, distribution or reproduction of this e-mail, including attachments, is prohibited and may be unlawful.

**Drogos, Donna, Env. Health**

---

**From:** Rick Freudenberger [rfreudenberger@escsj.com]  
**Sent:** Wednesday, May 25, 2005 9:29 AM  
**To:** Drogos, Donna, Env. Health  
**Cc:** gport@proskauer.com  
**Subject:** RO55: 1482 67th., Emeryville - Former Clearprint Site-ACEH Closure Certification

Donna,

As a follow-up to a voice mail I left for you about 9:20 a.m. today, I represent Clearprint and wondered if you could let me know the status of the referenced case closure request and certification. This project was forwarded by ACEH to Cherie at the RWQCB on May 12 by Bob Schultz of ACEH. I spoke with Cherie this week and she signed off it and returned it to Bob the same day.

Can you let me know when we can expect the closure certification letter from ACEH? Clearprint is very anxious to have the case officially closed since they are selling the property.

Thanks very much in advance for your help. You may call or e-mail me with information.

Rick Freudenberger  
Environmental Strategies Consulting LLC  
2025 Gateway Place Suite 280  
San Jose, CA 95110  
408-453-6100  
fax 408-453-0496

Important Notice: The information contained in this e-mail, including any attachments, is not intended and should not be construed as an official confirmation of any transaction unless expressly provided. Furthermore, this e-mail may contain information that is confidential, non-public and protected by privilege from disclosure. If you are not the intended recipient, please delete this e-mail, including attachments, and notify the sender. The unauthorized use, dissemination, distribution or reproduction of this e-mail, including attachments, is prohibited and may be unlawful.

**Drogos, Donna, Env. Health**

---

**From:** Rick Freudenberger [rfreudenberger@escsj.com]  
**Sent:** Monday, May 02, 2005 10:55 AM  
**To:** Drogos, Donna, Env. Health  
**Subject:** Status of Case Closure Review--Clearprint Paper Company, Emeryville, CA

Donna,

Just a follow-up to a voice mail I left you this morning. Our client, Clearprint, has entered into a contract for the sale of the property and is obviously very anxious regarding case closure.

If you can provide the status of the case review, it would be very much appreciated.

Thanks for your help.

Rick Freudenberger  
Environmental Strategies Consulting LLC  
2025 Gateway Place Suite 280  
San Jose, CA 95110  
408-453-6100  
fax 408-453-0496

Important Notice: The information contained in this e-mail, including any attachments, is not intended and should not be construed as an official confirmation of any transaction unless expressly provided. Furthermore, this e-mail may contain information that is confidential, non-public and protected by privilege from disclosure. If you are not the intended recipient, please delete this e-mail, including attachments, and notify the sender. The unauthorized use, dissemination, distribution or reproduction of this e-mail, including attachments, is prohibited and may be unlawful.



white -env.health  
 yellow -facility  
 pink -files

ALAMEDA COUNTY, DEPARTMENT OF ENVIRONMENTAL HEALTH  
 Hazardous Materials Inspection Form

80 Swan Way, #200  
 Oakland, CA 94621  
 (415) 271-4320

II, III

Site ID # \_\_\_\_\_ Site Name CLEAR PRINT Today's Date 10/6/97

II.A BUSINESS PLANS (Title 19)

- \_\_\_ 1. Immediate Reporting 2703
- \_\_\_ 2. Bus. Plan Slids. 25503(b)
- \_\_\_ 3. RR Cars > 30 days 25503.7
- \_\_\_ 4. Inventory Information 25504(a)
- \_\_\_ 5. Inventory Complete 2730
- \_\_\_ 6. Emergency Response 25504(b)
- \_\_\_ 7. Training 25504(c)
- \_\_\_ 8. Deficiency 25505(a)
- \_\_\_ 9. Modification 25505(b)

Site Address 1482. 67th Street

City Emeryville Zip 94608 Phone \_\_\_\_\_

\_\_\_ MAX AMT stored > 500 lbs, 55 gal., 200 cft.?

Inspection Categories:

- \_\_\_ I. Haz. Mat/Waste GENERATOR/TRANSPORTER
- II. Business Plans, Acute Hazardous Materials
- \_\_\_ III. Underground Tanks

II.B ACUTELY HAZ. MATLS

- \_\_\_ 10. Registration Form Filed 25533(a)
- \_\_\_ 11. Form Complete 25533(b)
- \_\_\_ 12. RMPP Contents 25534(c)
- \_\_\_ 13. Implement Sch. Req'd? (Y/N)
- \_\_\_ 14. OnSite Conseq. Assess. 25524(c)
- \_\_\_ 15. Probable Risk Assessment 25534(d)
- \_\_\_ 16. Persons Responsible 25534(g)
- \_\_\_ 17. Certification 25534(i)
- \_\_\_ 18. Exemption Request? (Y/N) 25536(b)
- \_\_\_ 19. Trade Secret Requested? 25538

\* Calif. Administration Code (CAC) or the Health & Safety Code (HS&C)

III. UNDERGROUND TANKS (Title 23)

- General
- \_\_\_ 1. Permit Application 25284 (H&S)
  - \_\_\_ 2. Pipeline Leak Detection 25292 (H&S)
  - \_\_\_ 3. Records Maintenance 2712
  - \_\_\_ 4. Release Report 2651
  - \_\_\_ 5. Closure Plans 2670

- Monitoring for Existing Tanks
- \_\_\_ 6. Method
    - 1) Monthly Test
    - 2) Daily Vadose
      - Semi-annual groundwater
      - One time soil
    - 3) Daily Vadose
      - One time soils
      - Annual tank test
    - 4) Monthly Gndwater
      - One time soil
    - 5) Daily Inventory
      - Annual tank testing
      - Cont pipe leak det
      - Vadose/gndwater mon.
    - 6) Daily Inventory
      - Annual tank testing
      - Cont pipe leak det
    - 7) Weekly Tank Gauge
      - Annual tank testing
    - 8) Annual Tank Testing
      - Daily Inventory
    - 9) Other \_\_\_\_\_

- \_\_\_ 7. Precs Tank Test Date: \_\_\_\_\_ 2643
- \_\_\_ 8. Inventory Rec. 2644
- \_\_\_ 9. Soil Testing 2646
- \_\_\_ 10. Ground Water. 2647

- New Tanks
- \_\_\_ 11. Monitor Plan 2632
  - \_\_\_ 12. Access Secure 2634
  - \_\_\_ 13. Plans Submit 2711
  - Date: \_\_\_\_\_
  - \_\_\_ 14. As Built 2635
  - Date: \_\_\_\_\_

Comments:  
 On Site: 3-7 PM  
 Tank pit #2 - groundwater with free product present in the pit. Pumped out. Limited over excavation - strong soil staining in the east wall near the waterline. It appeared that the former tank was used to store solvent. 1 bottom soil sample collected (13.6 ft bgs) - West wall at 10ft bgs. Sand layer appeared to be present in the 4-6 ft layer of about 2ft. South wall (10ft bgs); north wall at (10ft bgs); east wall at  
 Tank pit #4 - pumping the groundwater free product. Limited over excavation strong soil discoloration & HC odor & soil samples fr. the north wall (12ft bgs); west wall at south wall (9.6 ft bgs)

Rev 8/88

II, III

Contact: \_\_\_\_\_

Title: \_\_\_\_\_

Signature: \_\_\_\_\_

Inspector: \_\_\_\_\_

Signature: Jason L. Boyd

white -env.health  
 yellow -facility  
 pink -files

ALAMEDA COUNTY, DEPARTMENT OF ENVIRONMENTAL HEALTH  
 Hazardous Materials Inspection Form

80 Swan Way, #200  
 Oakland, CA 94621  
 (415) 271-4320

II, III

Site ID # \_\_\_\_\_ Site Name Clearprint Today's Date 10/1/94

II.A BUSINESS PLANS (Title 19)

- \_\_\_ 1. Immediate Reporting 2703
- \_\_\_ 2. Bus. Plan Stds. 25503(b)
- \_\_\_ 3. Rpt Cors > 30 days 25503.7
- \_\_\_ 4. Inventory Information 25504(a)
- \_\_\_ 5. Inventory Complete 2730
- \_\_\_ 6. Emergency Response 25504(b)
- \_\_\_ 7. Training 25504(c)
- \_\_\_ 8. Deficiency 25505(a)
- \_\_\_ 9. Modification 25505(b)

Site Address 1482 - 67th Street

City Emeryville Zip 94608 Phone \_\_\_\_\_

MAX AMT stored > 500 lbs, 55 gal., 200 cff.?

Inspection Categories:

- \_\_\_ I. Haz. Mat/Waste GENERATOR/TRANSPORTER
- \_\_\_ II. Business Plans, Acute Hazardous Materials
- III. Underground Tanks

On Site: 1:30 PM -

Calif. Administration Code (CAC) or the Health & Safety Code (HS&C)

II.B ACUTELY HAZ. MATLS

- \_\_\_ 10. Registration Form Filed 25533(a)
- \_\_\_ 11. Form Complete 25533(b)
- \_\_\_ 12. RMPP Contents 25534(c)
- \_\_\_ 13. Implement Sch. Req'd? (Y/N)
- \_\_\_ 14. OffSite Conseq. Assess. 25524(c)
- \_\_\_ 15. Probable Risk Assessment 25534(d)
- \_\_\_ 16. Persons Responsible 25534(g)
- \_\_\_ 17. Certification 25534(f)
- \_\_\_ 18. Exemption Request? (Y/N) 25536(b)
- \_\_\_ 19. Trade Secret Requested? 25538

III. UNDERGROUND TANKS (Title 23)

- |                               |   |
|-------------------------------|---|
| General                       | ___ 1. Permit Application 25284 (H&S)   |
|                               | ___ 2. Pipeline Leak Detection 25292 (H&S)  |
|                               | ___ 3. Records Maintenance 2712   |
|                               | ___ 4. Release Report 2651  |
|                               | ___ 5. Closure Plans 2670   |
| Monitoring for Existing Tanks | ___ 6. Method   |
|                               | 1) Monthly Test   |
|                               | 2) Daily Vadose<br>Semi-annual groundwater<br>One time soils                            |
|                               | 3) Daily Vadose<br>One time soils<br>Annual tank test                                   |
|                               | 4) Monthly Groundwater<br>One time soils  |
|                               | 5) Daily Inventory<br>Annual tank testing<br>Cont pipe leak det<br>Vadose/gndwater mon. |
|                               | 6) Daily Inventory<br>Annual tank testing<br>Cont pipe leak det                         |
|                               | 7) Weekly Tank Gauge<br>Annual tank testing   |
|                               | 8) Annual Tank Testing<br>Daily Inventory   |
|                               | 9) Other _____  |
| New Tanks                     | ___ 7. Precls Tank Test Date: 2643  |
|                               | ___ 8. Inventory Rec. 2644  |
|                               | ___ 9. Soil Testing 2646  |
|                               | ___ 10. Ground Water. 2647  |
|                               | ___ 11. Monitor Plan 2632   |
| ___ 12. Access. Secure 2634   |   |
| ___ 13. Plans Submit 2711     |   |
| ___ 14. As Built 2635         |   |

SAMPLING:  
 Comments:  
 Tank pit # 3 (1,000 G - mineral oil) One soil sample collected at the east end of the tank. Limited overexposed performed in the tank pit. Strong discoloration, 5 soil samples for confirmation collected 1 bottom & 4 sidewalls. Strong HC odor.

Tank pit # 2 - ground water pumped out - strong soil discoloration & solvent odor present.  
 - Stockpiled soil from this pit must be piled separately & characterized & covered with Visqueen & bermed & disposed properly.

Rev 6/88

Contact: Robert F Flory  
 Title: \_\_\_\_\_  
 Signature: Robert F Flory

Inspector: \_\_\_\_\_  
 Signature: Jessica J. Hugo

II, III

white -env.health  
 yellow -facility  
 pink -files

ALAMEDA COUNTY, DEPARTMENT OF ENVIRONMENTAL HEALTH

80 Swan Way, #200  
 Oakland, CA 94621  
 (415) 271-4320

Hazardous Materials Inspection Form

II, III

II.A BUSINESS PLANS (Title 19)

- \_\_\_ 1. Immediate Reporting 2703
- \_\_\_ 2. Bus Plan Stds 25503(b)
- \_\_\_ 3. RR Cars > 30 days 25503.7
- \_\_\_ 4. Inventory Information 25504(a)
- \_\_\_ 5. Inventory Complete 2730
- \_\_\_ 6. Emergency Response 25504(b)
- \_\_\_ 7. Training 25504(c)
- \_\_\_ 8. Deficiency 25505(a)
- \_\_\_ 9. Modification 25505(b)

II.B ACUTELY HAZ. MATLS

- \_\_\_ 10. Registration Form Filed 25533(a)
- \_\_\_ 11. Form Complete 25533(b)
- \_\_\_ 12. RMPP Contents 25534(c)
- \_\_\_ 13. Implement Sch. Req'd? (Y/N)
- \_\_\_ 14. OffSite Conseq. Assess. 25524(c)
- \_\_\_ 15. Probable Risk Assessment 25534(d)
- \_\_\_ 16. Persons Responsible 25534(g)
- \_\_\_ 17. Certification 25534(f)
- \_\_\_ 18. Exemption Request? (Y/N) 25536(b)
- \_\_\_ 19. Trade Secret Requested? 25538

III. UNDERGROUND TANKS (Title 23)

- |                               |   |
|-------------------------------|---|
| General                       | ___ 1. Permit Application 25284 (H&S)   |
|                               | ___ 2. Pipeline Leak Detection 25292 (H&S)  |
|                               | ___ 3. Records Maintenance 2712   |
|                               | ___ 4. Release Report 2651  |
|                               | ___ 5. Closure Plans 2670   |
| Monitoring for Existing Tanks | ___ 6. Method   |
|                               | 1) Monthly Test   |
|                               | 2) Daily Vadose<br>Semi-annual groundwater<br>One time soils                            |
|                               | 3) Daily Vadose<br>One time soils<br>Annual tank test                                   |
|                               | 4) Monthly Gndwater<br>One time soils   |
|                               | 5) Daily Inventory<br>Annual tank testing<br>Cont pipe leak det<br>Vadose/gndwater mon. |
|                               | 6) Daily Inventory<br>Annual tank testing<br>Cont pipe leak det                         |
|                               | 7) Weekly Tank Gauge<br>Annual tank testing   |
|                               | 8) Annual Tank Testing<br>Daily Inventory   |
|                               | 9) Other _____  |
|                               | ___ 7. Precip Tank Test 2643<br>Date: _____   |
|                               | ___ 8. Inventory Rec. 2644  |
|                               | ___ 9. Soil Testing . 2646  |
| ___ 10. Ground Water. 2647    |   |
| New Tanks                     | ___ 11 Monitor Plan 2632  |
|                               | ___ 12 Access, Secure 2634  |
|                               | ___ 13 Plans Submit 2711<br>Date: _____   |
|                               | ___ 14. As Built 2635<br>Date: _____  |

Site ID # \_\_\_\_\_ Site Name Clearprint Today's Date 10/4/94  
 Site Address 1482 - 67th Street  
 City Emeryville Zip 94608 Phone \_\_\_\_\_  
 \_\_\_ MAX AMT stored > 500 lbs, 55 gal., 200 cft.?

Inspection Categories:

- \_\_\_ I. Haz. Mat/Waste GENERATOR/TRANSPORTER
- II. Business Plans, Acute Hazardous Materials
- \_\_\_ III. Underground Tanks

16:30

On Site: Removal of tank #2

\* Calif. Administration Code (CAC) or the Health & Safety Code (HS&C)

Comments: HEH - Tank's hauler # 428038 4/1/94  
Manifest # 93617697; LEL = 0; O<sub>2</sub> = 5.8%  
George Warren (Emeryville Fire Dept) on site.

Tank #2 - 8,000 gallon steel tank for mineral oil; no tar wrappings present; visible rust/corrosion at tank's ends & bottom; some pitting present.

Groundwater pumped out by Consolidated Inc from pit #4 & #1. Free product present in the pits.

\* All pipings associated with the tanks must be removed &/or plugged.

\* Strong HC odor (gasoline) & soil staining present in all tank pits; #4 had the strongest odor.

\* 4 soil samples collected from tank pit #1 (2 bottom samples & 2 sidewall samples). This pit was approved to be backfilled with clean fill.

\* Groundwater sample will be waived (due to freeproduct & heavy rain) but monitoring wells will be required.

Contact: Robert F. [Signature] Title: R.S. Inspector: \_\_\_\_\_  
 Signature: [Signature] Signature: Susan F. [Signature]

\* UHR must be completed & submitted within 5 working days.

white -env.health  
 yellow -facility  
 pink -files

ALAMEDA COUNTY, DEPARTMENT OF ENVIRONMENTAL HEALTH  
 Hazardous Materials Inspection Form

80 Swan Way, #200  
 Oakland, CA 94621  
 (415) 271-4320

II, III

Site ID # \_\_\_\_\_ Site Name Clearprint Today's Date 10/3/94

II.A BUSINESS PLANS (Title 19)

- \_\_\_ 1. Immediate Reporting 2703
- \_\_\_ 2. Bus Plan Stds 25503(b)
- \_\_\_ 3. RR Cars > 30 days 25503.7
- \_\_\_ 4. Inventory Information 25504(a)
- \_\_\_ 5. Inventory Complete 2730
- \_\_\_ 6. Emergency Response 25504(b)
- \_\_\_ 7. Training 25504(c)
- \_\_\_ 8. Deficiency 25505(a)
- \_\_\_ 9. Modification 25505(b)

Site Address 1482 - 67th Street  
 City Emeryville Zip 94608 Phone \_\_\_\_\_

MAX AMT stored. > 500 lbs, 55 gal., 200 cft.?

12:00 - 8:00 PM (4 hrs @ 1.5)

Inspection Categories:

- \_\_\_ I. Haz. Mat/Waste GENERATOR/TRANSPORTER
- II. Business Plans, Acute Hazardous Materials
- III. Underground Tanks

Tank Hauler = H & H (4280374) 1/95 Manifest # Yanks # 183  
#93617689

Calif. Administration Code (CAC) or the Health & Safety Code (HS&C)

II.B ACUTELY HAZ. MATLS

- \_\_\_ 10. Registration Form Filed 25533(a)
- \_\_\_ 11. Form Complete 25533(b)
- \_\_\_ 12. RMPP Contents 25534(c)
- \_\_\_ 13. Implement Sch. Req'd? (Y/N)
- \_\_\_ 14. OffSite Conseq. Assess. 25524(c)
- \_\_\_ 15. Probable Risk Assessment 25534(d)
- \_\_\_ 16. Persons Responsible 25534(g)
- \_\_\_ 17. Certification 25534(f)
- \_\_\_ 18. Exemption Request? (Y/N) 25536(b)
- \_\_\_ 19. Trade Secret Requested? 25538

ON SITE @ H & H (428039) 9/95 - #4  
 Comments:

4 Underground Storage tanks removed  
- all tanks underneath the sidewalk

III. UNDERGROUND TANKS (Title 23)

- General
- \_\_\_ 1. Permit Application 25284 (H&S)
  - \_\_\_ 2. Pipeline Leak Detection 25292 (H&S)
  - \_\_\_ 3. Records Maintenance 2712
  - \_\_\_ 4. Release Report 2651
  - \_\_\_ 5. Closure Plans 2670

- Monitoring for Existing Tanks
- \_\_\_ 6. Method
    - 1) Monthly Test
    - 2) Daily Vadose  
Semi-annual groundwater  
One time soils
    - 3) Daily Vadose  
One time soils  
Annual tank test
    - 4) Monthly Gndwater  
One time soils
    - 5) Daily Inventory  
Annual tank testing  
Cont pipe leak det  
Vadose/gndwater mon.
    - 6) Daily Inventory  
Annual tank testing  
Cont pipe leak det
    - 7) Weekly Tank Gauge  
Annual tank testing
    - 8) Annual Tank Testing  
Daily Inventory
    - 9) Other \_\_\_\_\_

- \_\_\_ 7. Precs Tank Test 2643  
Date: \_\_\_\_\_
- \_\_\_ 8. Inventory Rec. 2644
- \_\_\_ 9. Soil Testing 2646
- \_\_\_ 10. Ground Water. 2647

- New Tanks
- \_\_\_ 11. Monitor Plan 2632
  - \_\_\_ 12. Access. Secure 2634
  - \_\_\_ 13. Plans Submit 2711  
Date: \_\_\_\_\_
  - \_\_\_ 14. As Built 2635  
Date: \_\_\_\_\_

Revised 8/88  
 Clearprint  
 67th Street

Contact: Robert F Flory 2,000 gal. product pumped out  
 Title: Reg. Field Inspector: \_\_\_\_\_  
 Signature: [Signature] Signature: [Signature]

Tank #1 - 9450 gallon fiber glass tank LEL=8.9%, O2=6.3%  
residuals found at the ribs of the tank.

Tank #2 - 8,000 gallon Steel tank ~~just~~ tank to be  
11.2% = O2 O = LEL pulled 10/11/94

Tank #3 - 1,000 gallon Steel tank (mineral oil & water)  
2.0% = LEL 5.6% = O2 ~~residual~~  
- hole found underneath (bottom) of tank  
tank appeared to be wrapped with tar,  
rust & some pitting visible. Soil  
staining present in the pit.

Tank #4 - 10,000 gallon steel tank (mineral  
oil) ~~XXXXXX~~  
11.3% = O2 O = LEL  
Strong HC (gasoline) odor  
- soil staining present in the pit  
- tank wrapped in tar paper

II, III

white -env.health  
 yellow -facility  
 pink -files

# ALAMEDA COUNTY, DEPARTMENT OF ENVIRONMENTAL HEALTH

80 Swan Way, #200  
 Oakland, CA 94621  
 (415) 271-4320

## Hazardous Materials Inspection Form

II, III

Site ID # \_\_\_\_\_ Site Name Clean print Today's Date 10/3/94

Site Address 1482 - 67th Street

City Emeryville Zip 94608 Phone \_\_\_\_\_

MAX AMT stored > 500 lbs, 55 gal., 200 cft.?

**Inspection Categories:**

- I. Haz. Mat/Waste GENERATOR/TRANSPORTER
- II. Business Plans, Acute Hazardous Materials
- III. Underground Tanks

Page 2

Calif. Administration Code (CAC) or the Health & Safety Code (HS&C)

**Comments:**

→ Tank #4 → manifest # 9361 7688  
 - groundwater present in the pit  
 free product present

**II.A BUSINESS PLANS (Title 19)**

- 1. Immediate Reporting 2703
- 2. Bus. Plan Stds 25503(b)
- 3. RR Cars > 30 days 25503.7
- 4. Inventory Information 25504(a)
- 5. Inventory Complete 2730
- 6. Emergency Response 25504(b)
- 7. Training 25504(c)
- 8. Deficiency 25505(a)
- 9. Modification 25505(b)

**II.B ACUTELY HAZ. MATLS**

- 10. Registration Form Filed 25533(a)
- 11. Form Complete 25533(b)
- 12. RMPP Contents 25534(c)
- 13. Implement Sch. Req'd? (Y/N) \_\_\_\_\_
- 14. OffSite Conseq. Assess. 25524(c)
- 15. Probable Risk Assessment 25534(d)
- 16. Persons Responsible 25534(g)
- 17. Certification 25534(i)
- 18. Exemption Request? (Y/N) \_\_\_\_\_
- 19. Trade Secret Requested? 25538

**III. UNDERGROUND TANKS (Title 23)**

- |   |   |
|---|---|
| General   | <input type="checkbox"/> 1. Permit Application 25284 (H&S)                              |
|   | <input type="checkbox"/> 2. Pipeline Leak Detection 25292 (H&S)                         |
|   | <input type="checkbox"/> 3. Records Maintenance 2712                                    |
|   | <input type="checkbox"/> 4. Release Report 2651   |
|   | <input type="checkbox"/> 5. Closure Plans 2670  |
| Monitoring for Existing Tanks                   | <input type="checkbox"/> 6. Method  |
|   | 1) Monthly Test   |
|   | 2) Daily Vadose<br>Semi-annual groundwater<br>One time soils                            |
|   | 3) Daily Vadose<br>One time soils<br>Annual tank test                                   |
|   | 4) Monthly Gndwater<br>One time soils   |
|   | 5) Daily Inventory<br>Annual tank testing<br>Cont pipe leak det<br>Vadose/gndwater mon. |
|   | 6) Daily Inventory<br>Annual tank testing<br>Cont pipe leak det                         |
|   | 7) Weekly Tank Gauge<br>Annual tank testing   |
|   | 8) Annual Tank Testing<br>Daily Inventory   |
|   | 9) Other _____  |
|   | <input type="checkbox"/> 7. Precis Tank Test 2643                                       |
|   | Date: _____   |
|   | <input type="checkbox"/> 8. Inventory Rec. 2644   |
|   | <input type="checkbox"/> 9. Soil Testing 2646   |
| <input type="checkbox"/> 10. Ground Water. 2647 |   |
| New Tanks                                       | <input type="checkbox"/> 11 Monitor Plan 2632   |
|   | <input type="checkbox"/> 12 Access. Secure 2634   |
|   | <input type="checkbox"/> 13. Plans Submit 2711  |
|   | Date: _____   |
| <input type="checkbox"/> 14. As Built 2635      |   |
| Date: _____                                     |   |

Rev 8/88

Contact: Robert F. Florey

Title: R. F. Florey

Signature: [Signature]

Inspector: \_\_\_\_\_

Signature: [Signature]

II, III

white -env.health  
 yellow -facility  
 pink -files

ALAMEDA COUNTY, DEPARTMENT OF ENVIRONMENTAL HEALTH

80 Swan Way, #200  
 Oakland, CA 94621  
 (415) 271-4320

Hazardous Materials Inspection Form

II, III

Site ID # \_\_\_\_\_ Site Name Cherpoint Today's Date 9/23/94

Site Address 1482 67th St

City Emeryville Zip 94608 Phone \_\_\_\_\_

MAX AMT stored > 500 lbs, 55 gal., 200 cft.?

Inspection Categories:

- I. Haz. Mat/Waste GENERATOR/TRANSPORTER
- II. Business Plans, Acute Hazardous Materials
- III. Underground Tanks

\* Calif. Administration Code (CAC) or the Health & Safety Code (HS&C)

Comments:

*On site:*  
 all 4 UGTs had been uncovered.  
 Stockpiled soil hauled off site.  
 will remove tanks - Thurs 9/29/94.

II.A BUSINESS PLANS (Title 19)

- 1. Immediate Reporting 2703
- 2. Bus Plan Stds 25503(b)
- 3. RR Cars > 30 days 25503.7
- 4. Inventory Information 25504(a)
- 5. Inventory Complete 2730
- 6. Emergency Response 25504(b)
- 7. Training 25504(c)
- 8. Deficiency 25505(a)
- 9. Modification 25505(b)

II.B ACUTELY HAZ. MATLS

- 10. Registration Form Filed 25533(a)
- 11. Form Complete 25533(b)
- 12. HMPP Contents 25534(c)
- 13. Implement Sch. Req'd? (Y/N)
- 14. OffSite Conseq. Assess 25524(c)
- 15. Probable Risk Assessment 25534(d)
- 16. Persons Responsible 25534(g)
- 17. Certification 25534(i)
- 18. Exemption Request? (Y/N) 25536(b)
- 19. Trade Secret Requested? 25538

III. UNDERGROUND TANKS (Title 23)

- General**
- 1. Permit Application 25284 (H&S)
- 2. Pipeline Leak Detection 25292 (H&S)
- 3. Records Maintenance 2712
- 4. Release Report 2651
- 5. Closure Plans 2670
- 6. Method
- 1) Monthly Test
- 2) Daily Vadose  
Semi-annual groundwater  
One time soils
- 3) Daily Vadose  
One time soils  
Annual tank test
- 4) Monthly Gndwater  
One time soils
- 5) Daily Inventory  
Annual tank testing  
Cont pipe leak det  
Vadose/gndwater mon.
- 6) Daily Inventory  
Annual tank testing  
Cont pipe leak det
- 7) Weekly Tank Gauge  
Annual tank testing
- 8) Annual Tank Testing  
Daily Inventory
- 9) Other \_\_\_\_\_
- 7. Precls Tank Test 2643  
Date: \_\_\_\_\_
- 8. Inventory Rec. 2644
- 9. Soil Testing 2646
- 10. Ground Water. 2647
- New Tanks**
- 11. Monitor Plan 2632
- 12. Access. Secure 2634
- 13. Plans Submit 2711  
Date: \_\_\_\_\_
- 14. As Built 2635  
Date: \_\_\_\_\_

Rev 8/88

II, III

Contact: \_\_\_\_\_

Title: \_\_\_\_\_

Signature: \_\_\_\_\_

Inspector: Susan L. Hays

Signature: \_\_\_\_\_



**ENVIRONMENTAL STRATEGIES CORPORATION**

101 Metro Drive • Suite 650 • San Jose, California 95110 • (408) 453-6100 • FAX (408) 453-0496

January 23, 1996

Ms. Susan L. Hugo  
Senior Hazardous Waste Specialist  
Alameda County Department of Environmental Health  
1131 Harbor Bay Parkway  
Alameda, California, 94502-6577

Re: Documentation of Waste Disposal from the Supplemental Investigation Conducted  
at the Clearprint Paper Company, Inc., Facility, Emeryville, California

Dear Ms. Hugo:

As required by the Alameda County Department of Environmental Health, in the letter dated September 26, 1995, Environmental Strategies Corporation, on behalf of Clearprint Paper Company, Inc., is submitting the documentation for the disposal of the wastes generated during the supplemental investigation conducted at the Emeryville facility.

If you have any questions or require further information.

Sincerely yours,

A handwritten signature in cursive script that reads "Rick Freudenberger".

Richard E. Freudenberger  
Senior Vice President

REF:jwb:bl  
2142

Enclosures

cc: Ira Weinberg, Clearprint Paper Company, Inc.  
Earl Mau, Clearprint Paper Company, Inc.  
Gail S. Port, Esquire, Proskauer Rose Goetz & Mendelsohn LLP

55 JAN 24 PM 3:17  
ENVIRONMENTAL STRATEGIES CORPORATION  
101 METRO DRIVE  
SAN JOSE, CA 95110

IN CASE OF EMERGENCY OR SPILL, CALL THE NATIONAL RESPONSE CENTER 1-800-424-8802. WITHIN CALIFORNIA, CALL 1-800-852-7550

<b>UNIFORM HAZARDOUS WASTE MANIFEST</b>		Generator's US EPA ID No. <b>CAD982012772</b>		Manifest Document <b>117</b>		2. Page 1 of 1		Information in the shaded areas is not required by Federal law.					
3. Generator's Name and Mailing Address <b>CLEARPRINT PAPER CO 1482 67TH STREET EMERYVILLE CA 94608</b>						A. State Manifest Document Number <b>95587147</b>							
4. Generator's Phone (1408) 453-6496						B. State Generator's ID							
5. Transporter 1 Company Name <b>ASHLAND CHEMICAL (FAIRFIELD)</b>			6. US EPA ID Number <b>UTD048406144</b>			C. State Transporter's ID <b>618 012</b>		D. Transporter's Phone <b>(801) 776-0095</b>					
7. Transporter 2 Company Name						E. State Transporter's ID							
8. US EPA ID Number						F. Transporter's Phone							
9. Designated Facility Name and Site Address <b>ASHLAND CHEMICAL FREEPORT CENTER, BLDG. 12 CLEARFIELD UT 84016</b>						10. US EPA ID Number <b>UTD048406144</b>							
11. US DOT Description (including Proper Shipping Name, Hazard Class, and ID Number) <b>NON-RCRA, HAZARDOUS WASTE, SOLID</b>						12. Containers No. Type		13. Total Quantity		14. Unit Wt/Vol		1. Waste Number State <b>611, *</b> EPA/Other <b>N/R</b>	
b.												State EPA/Other	
c.												State EPA/Other	
d.												State EPA/Other	
J. Additional Descriptions for Materials Listed Above <b>A: ASH44-7855 *352, 181</b>						K. Handling Codes for Wastes Listed Above a. <b>SC1</b> b. c. d.							
15. Special Handling Instructions and Additional Information <b>EVERY SPILL, INCIDENT OR RELEASE INVOLVING ASHLAND CHEMICAL MUST BE REPORTED TO CHENTREC, DAY OR NIGHT, AT 800-424-9300.</b>													
16. GENERATOR'S CERTIFICATION: I hereby declare that the contents of this consignment are fully and accurately described above by proper shipping name and are classified, packed, marked, and labeled, and are in all respects in proper condition for transport by highway according to applicable international and national government regulations.  If I am a large quantity generator, I certify that I have a program in place to reduce the volume and toxicity of waste generated to the degree I have determined to be economically practicable and that I have selected the practicable method of treatment, storage, or disposal currently available to me which minimizes the present and future threat to human health and the environment; OR, if I am a small quantity generator, I have made a good faith effort to minimize my waste generation and select the best waste management method that is available to me and that I can afford.													
Printed/Typed Name				Signature				Month		Day		Year	
								12		13		19	
17. Transporter 1 Acknowledgement of Receipt of Materials													
Printed/Typed Name				Signature				Month		Day		Year	
								11		17		11	
18. Transporter 2 Acknowledgement of Receipt of Materials													
Printed/Typed Name				Signature				Month		Day		Year	
19. Discrepancy Indication Space													
20. Facility Owner or Operator Certification of receipt of hazardous materials covered by this manifest except as noted in Item 19.													
Printed/Typed Name <b>Bonnie Olson</b>				Signature <i>Bonnie Olson</i>				Month		Day		Year	
								12		21		89	

DO NOT WRITE BELOW THIS LINE.



ASHLAND ENVIRONMENTAL  
LAND DISPOSAL RESTRICTION NOTIFICATION/CERTIFICATION FORM

CALIFORNIA-ONLY HAZARDOUS WASTE (NON-RCRA) TABLE

1. This table must only be completed when the NON-RCRA Hazardous Waste is generated within the state of California.
2. If the waste is only a RCRA Characteristic Hazardous Waste (D-Waste), it must also meet the treatment standards for California Hazardous Waste in accordance with 22 CCR 66268.9(b); thus, this table must be completed.
3. Check all boxes in the table that apply to the California-Only Hazardous Waste (NON-RCRA).

1 1 WASTE DOES NOT COMPLY WITH CALIFORNIA TREATMENT STANDARDS FOR NON-RCRA HAZARDOUS WASTE.  
Manifest Item #'s: \_\_\_\_\_

X

WASTE COMPLIES WITH CALIFORNIA TREATMENT STANDARDS FOR NON-RCRA HAZARDOUS WASTE.

"I certify under penalty of law that I personally have examined and am familiar with the waste through analysis and testing or knowledge of the waste to support this certification that the waste complies with the treatment standards specified in CCR, 7 division 4.5, chapter 18, article 11. I believe that the information I submitted is true, accurate and complete. I am aware that are significant penalties for submitting a false certification, including the possibility of a fine and imprisonment."  
Manifest Item #'s: 44-855 95581147 Clearprint Paper Co.

CHECK	NON-RCRA WASTE CATEGORY	TREATMENT STANDARDS	TREATMENT STANDARD REFERENCE
	Metal-Containing <u>Aqueous</u> Waste.	Antimony(15.0 mg/L), Arsenic(5.0), Barium(100.0), Beryllium(0.75), Cadmium(1.0), Chromium(VI)(5.0), Chromium(III)(560.0), Cobalt(80.0), Copper(25.0), Lead(5.0), Mercury(0.2), Molybdenum(350.0), Nickel(20.0), Selenium(1.0), Silver(5.0), Thallium(7.0), Vanadium(24.0), and Zinc(250.0).	22 CCR 66268 Table II, CCV.
	Metal-Containing <u>Solid</u> Waste.	Antimony(15.0 mg/L), Arsenic(5.0), Barium(100.0), Beryllium(0.75), Cadmium(1.0), Chromium(VI)(5.0), Chromium(III)(560.0), Cobalt(80.0), Copper(230.0), Lead(67.0), Mercury(0.2), Molybdenum(350.0), Nickel(20.0), Selenium(1.0), Silver(5.0), Thallium(7.0), Vanadium(24.0), and Zinc(250.0).	22 CCR 66268 Table I-C, CC.
	Organic-Containing <u>Aqueous or Liquid</u> Waste.	Chlorinated Hydrocarbons(0.5 mg/L), Organochlorine Pesticides(0.5), Organophosphorus Pesticides(0.5), PCB's as Arochlor(0.5), Semi-Volatile Organics(0.5), and Volatile Organics(0.5).	22 CCR 66268
	Organic-Containing <u>Solid</u> Waste.	Oil and Grease(1% by weight), Semi-Volatile Organics(435 mg/kg), and Volatile Organics(64 mg/kg).	22 CCR 66268
	Nonwastewater Solvent Waste.	Acetone(10.0 mg/kg), Benzene(2.0), n-Butane(10.0), Carbon Tetrachloride(2.0), Chlorobenzene(2.0), Chloroform(2.0), Chloromethane(2.5), Cresols(0.5), Cyclohexanone(2.0), o-Dichlorobenzene(2.0), 1,2-Dichloroethane(2.0), 1,1-Dichloroethylene(10.0), Diethyl Phthalate(5.0), Ethyl Acetate(2.0), Ethyl Benzene(1.5), Ethyl Ether(2.0), Hexachlorobutadiene(10.0), Hexachloroethane(10.0), Isobutane(10.0), Isophorone(5.0), Methanol(10.0), Methyl Ethyl Ketone(10.0), Methyl Isobutyl Ketone(10.0), Naphthalene(5.0), Methylene Chloride(10.0), Phenol(5.0), Pyridine(5.0), 1,1,2,2-Tetrachloroethane(2.0), Tetrachloroethylene(3.0), Toluene(2.0), Total Organic Carbon(100.0), 1,2,4-Trichlorobenzene(5.0), 1,1,1-Trichloroethane(2.0), Trichloroethylene(2.0), Trichloromonofluoromethane(2.0), 1,1,2-Trichloro-1,2,2-Trifluoroethane(10.0), and Xylene(2.0).	22 CCR 66268 Table III.
	PCB-Containing Waste.	Liquid PCB's > 5 ppm, Oranges PCB or PCB-Contaminated Transformer Casings, PCB-Containing Electrical Equipment that is not regulated under TSCA (e.g., Small Capacitors, Light Ballasts, and Fixtures.) Refer to regulations for treatment standards.	22 CCR 66268
	Asbestos-Containing Waste.	Frable Asbestos must be wetted or processed into a non-friable form <u>without</u> visible emissions; then placed into leak tight containers or wrapping.	22 CCR 66268
	Auto Shop/Wash Waste.	Cadmium(1.0 mg/L), Chromium(VI)(5.0), Chromium Total(560.0), Copper(25.0), Lead(5.0), Mercury(0.2), Nickel(20.0), and Zinc(250.0).	22 CCR 66268 Table I-A, CC
	Foundry Sand Waste.	Cadmium(1.0 mg/L), Copper(200.0), Lead(30.0), Nickel(20.0), and Zinc(250.0).	22 CCR 66268 Table I-B, CC
	Metal-Containing Foundry Baghouse Waste.	Arsenic(15.0 mg/L), Cadmium(1.0), Copper(350.0), Lead(70.0), Nickel(20.0), Selenium(1.0), Vanadium(24.0), Zinc(250.0).	22 CCR 66268 Table I-E, CC
	Metal-Containing Fly Ash, Bottom Ash, Retort Ash, or Baghouse Ash.	Arsenic(15.0 mg/L), Cadmium(1.0), Copper(40.0), Lead(20.0), Nickel(20.0), Selenium(1.0), Vanadium(24.0), Zinc(250.0).	22 CCR 66268 Table I-D, CC
	Btu's > 3,000.	Btu's > 3,000 must be incinerated or processed by other approved methods.	22 CCR 66268
	Volatile Organic Compounds > 1% by Weight.	Volatile Organic Compounds > 1% by weight must be incinerated or processed by other approved methods.	22 CCR 66268

Please print or type. Form designed for use on elite (12-pitch) typewriter.

**UNIFORM HAZARDOUS WASTE MANIFEST**

Generator's US EPA ID No.

Manifest Document

2. Page 1

Information in the shaded areas is not required by Federal law.

UTD 848406144 000177

of 1

3. Generator's Name and Mailing Address **ASHLAND CHEMICAL**  
**PO BOX 1526**  
**CLEARFIELD** **UT 84016**

4. Generator's Phone ( **801**) **776-0895**

5. Transporter 1 Company Name **ASHLAND CHEMICAL (CLEARFIELD)** 6. US EPA ID Number **UTD 848406144**

7. Transporter 2 Company Name **ASHLAND CHEMICAL (FAIRFIELD)** 8. US EPA ID Number **UTD 848406144**

9. Designated Facility Name and Site Address **CHEMICAL WASTE MANAGEMENT** 10. US EPA ID Number **CAT 8080546117**  
**35251 OLD SKYLINE ROAD**  
**KETTLEMAN CITY CA 93239**

11. US DOT Description (including Proper Shipping Name, Hazard Class, and ID Number)

12. Containers		13. Total Quantity	14. Unit Wt/Vol
No.	Type		
003	DRUM	003100	P
007	DRUM	049100	P

**NON RCRA, HAZARDOUS WASTE, SOLID (ALUMINA, ABSORBED HYDRAULIC OIL)**

**NON-RCRA, HAZARDOUS WASTE, SOLID**

**EVERY SPILL, INCIDENT OR RELEASE INVOLVING ASHLAND CHEMICAL MUST BE REPORTED TO CHEMTREC, DAY OR NIGHT, AT 800-424-9300.**

16. GENERATOR'S CERTIFICATION: I hereby declare that the contents of this consignment are fully and accurately described above by proper shipping name and are classified, packed, marked, and labeled, and are in all respects in proper condition for transport by highway according to applicable international and national government regulations.

If I am a large quantity generator, I certify that I have a program in place to reduce the volume and toxicity of waste generated to the degree I have determined to be economically practicable and that I have selected the practicable method of treatment, storage, or disposal currently available to me which minimizes the present and future threat to human health and the environment; OR, if I am a small quantity generator, I have made a good faith effort to minimize my waste generation and select the best waste management method that is available to me and that I can afford.

Printed/Typed Name **Bill Jones** Signature *[Signature]* Month **01** Day **12** Year **96**

17. Transporter 1 Acknowledgement of Receipt of Materials  
 Printed/Typed Name **Blaine Bourne** Signature *[Signature]* Month **01** Day **12** Year **96**

18. Transporter 2 Acknowledgement of Receipt of Materials  
 Printed/Typed Name **Steve Baker** Signature *[Signature]* Month **01** Day **16** Year **96**

19. Discrepancy Indication Space

20. Facility Owner or Operator Certification of receipt of hazardous materials covered by this manifest except as noted in item 19.  
 Printed/Typed Name *[Signature]* Signature *[Signature]* Month **01** Day **16** Year **96**

**DO NOT WRITE BELOW THIS LINE.**

IN CASE OF EMERGENCY OR SPILL, CALL THE NATIONAL RESPONSE CENTER 1-800-424-9802. WITHIN CALIFORNIA, CALL 1-800-852-7550



ENVIRONMENTAL STRATEGIES CORPORATION

San Jose, California 95110 • (408) 453-6100 • FAX (408) 453-0496

FAX COVER SHEET

STD 320

TO SUSAN HUGO

FAX No 510 337 9335

DATE 10/4/95

TOTAL NO OF PAGES. 8  
(including cover sheet)

Hard Copy to Follow

FROM JEFF BENSON

RE HEALTH & SAFETY PLAN FOR CLEARPRINT INVESTIGATION

Message ATTACHED IS THE H&S PLAN.  
PLEASE LET ME KNOW IF YOU  
REQUIRE FURTHER INFO.

\* WE PLAN ON PERFORMING THE  
WORK TUESDAY (10/10/95) ✓

*10/4/95  
Talked to Rick Friedberger  
H&S P acceptable -  
can proceed w/ scheduled  
work 10/10/95*

### HEALTH AND SAFETY PLAN FOR SITE INVESTIGATION

#### 1.0 SITE INFORMATION

Site Name: Clearprint Paper Company Project No: 212428-02

Location: 1482 67th Street, Emeryville, California

Site Contact: Earl Mau Phone No.: (510) 652-4762

Plan Prepared By: Jeff Benson Date: October 4, 1995

Scope of Work:

Drill six soil borings and collect samples for lab analysis. Three of the borings are to completed as 2" diameter monitoring wells. Groundwater sampling will follow development of the monitoring wells.

Proposed Date of

Investigation: October 10, 1995 - Drilling Activities. Groundwater sampling to follow at later dates.

#### 2.0 REVIEWS AND APPROVALS:

Project Manager	<u>Jeff Benson</u>	<u>10/4/95</u> (date)
Health and Safety Coordinator	<u>[Signature]</u>	<u>10/4/95</u> (date)
Project Health and Safety Officer	<u>Jeff Benson</u>	<u>10/4/95</u> (date)

#### 3.0 FACILITY DESCRIPTION:

The Clearprint Paper Company is located west of Hollis Street and north of 67th Street Emeryville, California. The facility is currently operational and manufactures specialty paper products.

##### 3.1 Principal Operations:

Clearprint Paper manufactures specialty paper products such as transparent drafting paper.

##### 3.2 Unusual Features (containers, buildings, dikes, power lines, terrain, etc.):

An area that formerly contained underground storage tanks is located between the southern side of the Clearprint building and 67th Street. There are overhead power line and underground utilities in the area where the work is to be performed.

4.0 HAZARD ASSESSMENT

4.1 Waste Types:

Liquid X Solid X Sludge \_\_\_ Gas \_\_\_

Describe: Soils possibly contaminated with total petroleum hydrocarbons (TPH) and/or benzene, toluene, ethyl benzene, and xylene (BTEX) compounds. Contaminated groundwater will also be handled.

4.2 Characteristics:

Corrosive \_\_\_ Flammable \_\_\_ Radioactive \_\_\_ Toxic X Volatile X  
 Reactive \_\_\_ Inert \_\_\_ Oily Wastes X

4.3 Overall Hazard Is:

High \_\_\_ Moderate X Low \_\_\_ Unknown \_\_\_

4.4 Hazards of Concern (check as many as apply):

( ) Heat Stress (X) Volatile Compounds (X) Cold Stress (Attachment A)  
 ( ) Inorganic Chemicals (X) Explosion/Flammable (X) Organic Chemicals  
 ( ) Confined Space ( ) Radiological ( ) Oxygen Deficient ( ) Biological  
 ( ) General Construction (X) Noise (X) Other, Specify: Burn/scalding hazard associated with drill rig steam cleaning procedures. Electrical associated with working near or with electrical power lines.

4.5 Hazard Assessment:

Describe possible hazards taking into account toxic effects, reactivity, stability, flammability, operational concerns, sampling, steam cleaning, etc.:

Physical injuries may result from the improper operation of heavy equipment and decontamination equipment. The potential for injuries inherent in operating heavy equipment is multiplied when operators are wearing restrictive personal protective equipment. Onsite personnel must be aware of their surroundings at all times and

aware of the activities of other personnel. Personnel working with or around the construction equipment may be exposed to excessive noise from the construction operations. Appropriate ear protection will be provided to minimize noise levels. Contact with overhead lines and prolonged skin contact with chemicals also present a potential physical hazard. If threatening hazards are noted during field activities, the work area will be evacuated. No personnel will return unless instrumentation, engineering judgment, or an emergency response official indicates that it is safe and proper to do so.

5.0 MONITORING PROCEDURES (describe):

The air in the breathing zone of onsite personnel will be monitored for organic compounds using a photoionization detector. Sustained elevated readings 25 parts per million (ppm) above background will dictate the upgrade of personal protective equipment from level D to level C. Sustained elevated readings 250 ppm above background will require the work area to be evacuated of personnel until the situation can be further evaluated.

6.0 PERSONAL PROTECTION:

6.1 Primary:

Level B     Level C     Level D     Other, describe:

6.2 Contingency:

Level B     Level C     Level D     Other, describe:

6.3 Protective Equipment

Level D: Level D protection is designed for use when only minor skin and eye protection is needed and airborne contamination is unlikely. Personal equipment requirements for Level D includes:

- Hard hat
- Eye Protection
- Work gloves
- Steel-toe safety boots

- Gloves, chemical resistant (optional)
- Ear protection (optional)

Level C: Level C protection is designed for use when minor skin and eye protection is needed with the addition of respiratory protection. The personal protection equipment required for Level C includes:

- Hard hat
- Air purifying respirator with appropriate cartridges
- Gloves, chemical resistant
- Long sleeved shirt or coveralls
- Steel-toe safety boots
- Overboots, chemical resistant (optional)
- Ear protection (optional)

## 7.0 DECONTAMINATION AND DISPOSAL

### 7.1 Personnel Decontamination:

Personal protective equipment will be used to protect personnel from exposure to contamination. Hands and face will be washed thoroughly after leaving the work area and before eating, drinking, or any other hand-to-mouth activities. If conditions require an upgrade of personal protective equipment from level D to level C, proper procedures will be followed to assure minimal exposure to contaminants and personnel involved in the work activities will shower as soon as feasible after removing Level C protective garments. Whenever possible, contact with with contaminated or suspected contaminated surfaces will be avoided. Used disposable personal protection equipment will be collected in a specified container that will be properly disposed of.

## 7.2 Equipment Decontamination:

Drilling augers and sampling devices and containers will be decontaminated using a portable steam cleaner.

## 8.0 EMERGENCY CONTACTS:

Site Contact	<u>Earl Mau (Clearprint)</u>
Site Telephone	<u>(510) 652-4762</u>
Additional Phone	<u>mobile phone - ESC vehicle</u>
Site Water Supply	<u>Drill rig</u>

Ambulance: 911

Police: Emeryville Police Department  
2449 Powell  
911/(510) 596-3737

Fire department: Emeryville Fire Department  
4331 San Pablo Avenue  
911/(510) 652-2222

Poison control center: 911

Hospital: Merritt Hospital  
Hawthorn Avenue & Webster  
(510) 655-4000

Directions to hospital: Go north on Hollis Street, turn right (east) on Folger, left (north) on 7th Street, and right (east) on Ashby. Follow Ashby to San Pablo Avenue exit and go south. Turn left onto 34th street, turn right onto Webster. Merritt Hospital is located at the corner of Hawthorn and Webster.

A map showing the work site and route to the hospital is included as Figure 1.





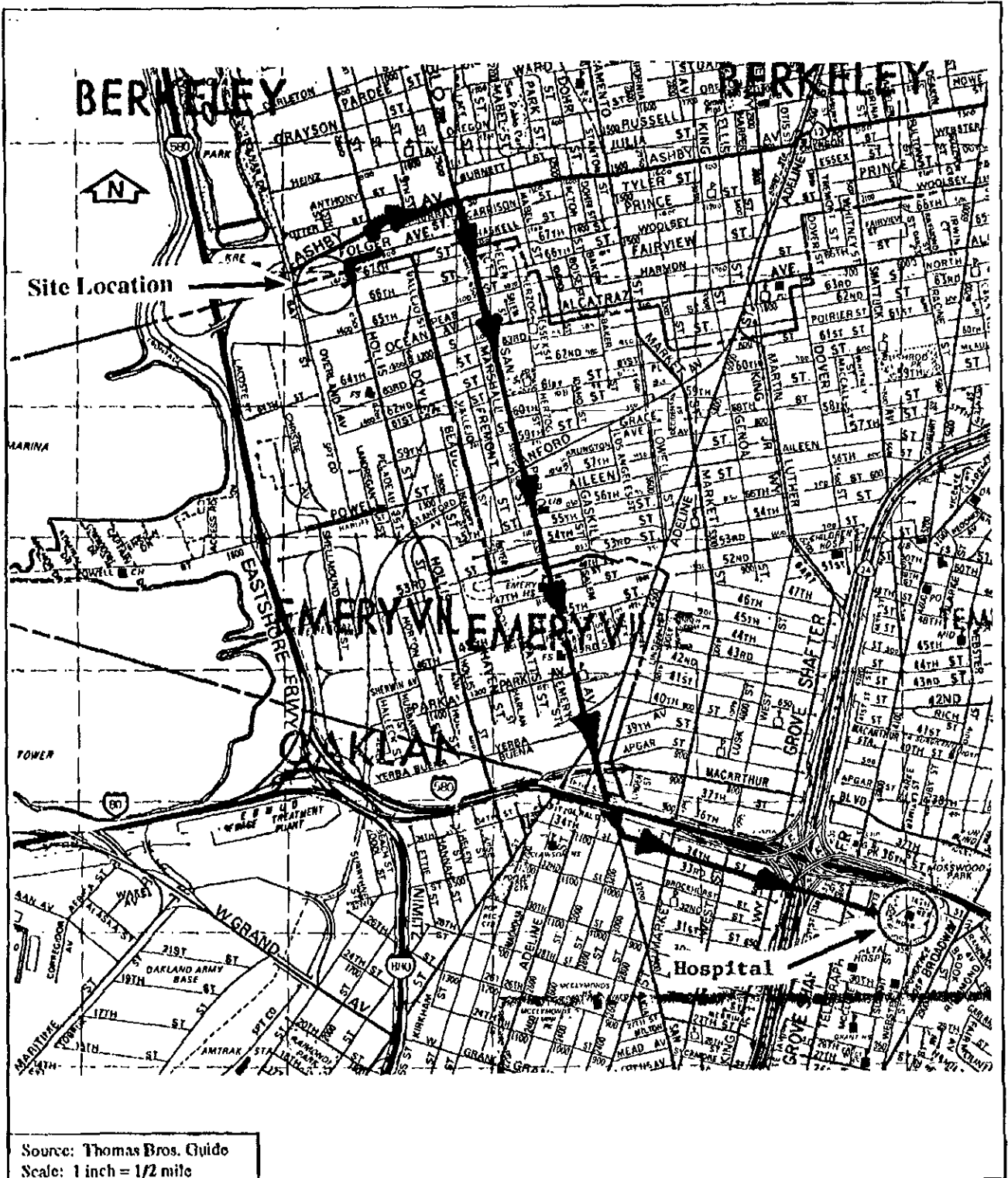

**ENVIRONMENTAL STRATEGIES CORPORATION**  
 101 Metro Drive, Suite 650  
 San Jose, California 95110  
 (408) 453-6100

Figure 1  
 Site Location  
 Hospital Route  
 Clearprint Paper Company  
 Emeryville, California

ALAMEDA COUNTY  
HEALTH CARE SERVICES  
AGENCY

DAVID J. KEARS, Agency Director



RAFAT A. SHAHID, DIRECTOR

September 26, 1995  
STID# 320

DEPARTMENT OF ENVIRONMENTAL HEALTH  
State Water Resources Control Board  
Division of Clean Water Programs  
UST Local Oversight Program  
1131 Harbor Bay Parkway  
Alameda, CA 94502-6577  
(510) 567-6700

Mr. Earl Mau  
Clearprint Paper Company, Inc.  
1482 67th Street  
Emeryville, California 94608

**RE: Final Work Plan for Supplemental Soil and Groundwater  
Investigation at Clearprint Paper Company, Inc.  
1482 67th Street, Emeryville, CA 94608**

Dear Mr. Mau:

This office has recently reviewed the Final Work Plan for Supplemental Soil and Groundwater Investigation (September 7, 1995) prepared and submitted by Environmental Strategies Corporation for the referenced site.

Based on this review, the workplan is acceptable to this office provided the following items are addressed:

- 1) During borehole advancement, soil samples must be collected at a minimum of every five feet in the unsaturated zone, significant changes in lithology and where field screening identifies the presence of contaminants. The selection of samples chosen for laboratory analysis should be based primarily on field evidence. A minimum of one sample submitted for analysis from the boring must be from the saturated/unsaturated zone interface.
- 2) Wells should be surveyed to an accuracy of 0.01 foot and referenced to mean sea level (MSL).
- 3) Groundwater monitoring wells must be sampled at a minimum of every quarter and groundwater elevation readings must be incorporated in the monitoring program. Groundwater flow direction shall be established at the site.
- 4) Soil and groundwater samples shall be analyzed for TPH as gasoline, TPH as diesel, TPH as mineral oil and BTEX.
- 5) Any waste (hazardous or non-hazardous) generated at the site must be characterized and disposed appropriately. Documents of all waste disposal must be provided to this office.
- 6) A site health and safety plan shall be submitted to this office prior to implementation of the work plan.

Mr. Earl Mau  
RE: 1482 67th Street, Emeryville, CA 94608  
September 26, 1995  
Page 2 of 3

- 7) Please notify this office at least 72 hours in advance for the start up of the work plan implementation so a site visit can be arranged by a representative from this office.

A report must be submitted to this agency within **60 days** after completion of the work performed at the site.

Until cleanup is complete, you will need to submit quarterly reports to this office and the following items must be incorporated in your future reports or workplans:

- a cover letter from the responsible party or tank owner stating the accuracy of the report and whether he/she concurs with the conclusions and recommendations in the report or workplan
- site map delineating contamination contours for soil and groundwater based on recent data should be included and the status of the investigation and cleanup must be identified
- proposed continuing or next phase of investigation / cleanup activities must be included to inform this department of the responsible party or tank owner's intention
- any changes in the groundwater flow direction and gradient based on the measured data since the last sampling event must be explained
- historical records of groundwater level in each well must be tabulated to indicate the fluctuation in water levels
- tabulate analytical results from all previous sampling events; provide laboratory reports (including quality control/quality assurance) and chain of custody documentation

All reports and proposals must be submitted under seal of a California Registered Geologist or Registered Civil Engineer with a statement of qualifications for each lead professionals involved with the project.

Mr. Earl Mau  
RE: 1482 67th Street, Emeryville, CA 94608  
September 26, 1995  
Page 3 of 3

If you have any questions concerning this letter, please call me at  
(510) 567-6780.

Sincerely,



Susan L. Hugo  
Senior Hazardous Materials Specialist

cc: Jun Makishima, Interim Director, Environmental Health  
George Young, Acting Chief, Environmental Protection Div/files  
Kevin Graves, San Francisco Bay RWQCB  
Richard Freudenberger, Environmental Strategies Corporation  
101 Metro Dr., Suite 650, San Jose, CA 95110



ENVIRONMENTAL

ENVIRONMENTAL STRATEGIES CORPORATION

101 Metro Drive • Suite 650 • San Jose, California 95110 • (408) 453-6100 • FAX (408) 453-0496

August 21, 1995

Ms. Susan L. Hugo  
Senior Hazardous Waste Specialist  
Alameda County Department of Environmental Health  
1131 Harbor Bay Parkway  
Alameda, CA 94502-6577

Re: Underground Storage Tank Contamination Investigation -  
Clearprint Paper Company, Inc., Emeryville, California

Dear Susan:

Per the previous letter dated July 25, 1995 from Clearprint Paper Company, Inc. and our telephone conversation on Monday, August 21, 1995, this letter is to confirm that the investigation workplan for the referenced site will be forwarded to your office by September 8, 1995.

We look forward to working with you on this project. Please call if you have any questions.

Sincerely yours,

A handwritten signature in cursive script that reads 'Rick Freudenberger'. The signature is written in black ink and is positioned above the typed name.

Richard E. Freudenberger  
Senior Vice President

REF:ljw  
1906

cc: Gail Port, Esquire  
Ira Weinberg

ALAMEDA COUNTY  
HEALTH CARE SERVICES  
AGENCY

DAVID J. KEARS, Agency Director



RAFAT A. SHAHID, DIRECTOR

DEPARTMENT OF ENVIRONMENTAL HEALTH  
State Water Resources Control Board  
Division of Clean Water Programs  
UST Local Oversight Program  
1131 Harbor Bay Parkway  
Alameda, CA 94502-6577  
(510) 567-6700

June 1, 1995  
STID# 320

Mr. Earl Mau  
Clearprint Paper Company, Inc.  
1482 67th Street  
Emeryville, California 94608

**RE: Underground Storage Tank Removals at Clearprint Paper  
Company, Inc. - 1482 67th Street, Emeryville, CA 94608**

Dear Mr. Mau:

This office has recently reviewed the Clearprint Paper Company Closure Report (March 10, 1995) prepared and submitted by Marcor Environmental concerning the removal of four underground storage tanks at the referenced site.

Three underground storage tanks (10,000 gallon steel, 1000 gallon steel and 9450 gallon fiberglass) were removed on October 3, 1994 at the subject site. The fourth tank (8000 gallon steel) was removed on October 4, 1994. Corrosion was present in the three steel tanks and a hole was observed at the bottom of the 1,000 gallon tank. Strong hydrocarbon odor and soil staining were observed during the removal of the tanks. The tanks were all located underneath the sidewalk next to the building along 67th Street.

Limited overexcavation was performed on October 5, 1994 along the perimeter on the excavation. Soil samples collected from the bottom and sidewalls exhibited petroleum hydrocarbon contamination as high as 610 ppm TPH gasoline, 340 ppm TPH diesel, 930 ppm TOG, 14 ppm benzene, 320 ppm toluene, 190 ppm ethyl benzene, and 58 ppm xylene. Low levels of PNA's were detected in the soil samples ( 1.3 ppm naphthalene, 1.1 ppm anthracene, 1.1 ppm fluoranthene, and 0.96 ppm pyrene. Metals were also detected in the soil samples up to 10 ppm arsenic, 210 ppm barium, 0.34 ppm beryllium, 20 ppm chromium, 13 ppm cobalt, 14 ppm copper, 31 ppm lead, 31 ppm nickel, 16 ppm vanadium, and 33 ppm zinc.

Groundwater was pumped out from the excavation and stored in Baker tanks. Groundwater samples found contamination up to 19,000 ppb TPH diesel, and 12,000 ppb TOG.

Mr. Earl Mau  
RE: 1482 67th Street, Emeryville, CA 94608  
June 1, 1995  
Page 2 of 3

Clearly, a release associated with the former underground storage tanks had occurred at the referenced site. The vertical and lateral extent of the soil and /or groundwater contamination must be determined. At a minimum, one groundwater monitoring well must be installed within ten feet of the former tanks in the verified downgradient direction. A work plan must be submitted to this office **no later than July 31, 1995.**

Additionally, please submit a site map showing the location of all the soil sampling points collected during the removal of the tanks. You may incorporate this map in the workplan.

Until cleanup is complete, you will need to submit reports to this office every three months (or at a more frequent interval, if specified at any time by this agency). In addition, the following items must be incorporated in your future reports or workplans:

- a cover letter from the responsible party or tank owner stating the accuracy of the report and whether he/she concurs with the conclusions and recommendations in the report or workplan
- site map delineating contamination contours for soil and groundwater based on recent data should be included and the status of the investigation and cleanup must be identified
- proposed continuing or next phase of investigation / cleanup activities must be included to inform this department of the responsible party or tank owner's intention
- any changes in the groundwater flow direction and gradient based on the measured data since the last sampling event must be explained
- historical records of groundwater level in each well must be tabulated to indicate the fluctuation in water levels
- tabulate analytical results from all previous sampling events; provide laboratory reports (including quality control/quality assurance) and chain of custody documentation

All reports and proposals must be submitted under seal of a California Registered Geologist or Registered Civil Engineer with a statement of qualifications for each lead professionals involved with the project.



Mr. Earl Mau  
RE: 1482 67th Street, Emeryville, CA 94608  
June 1, 1995  
Page 3 of 3

Please contact me at (510) 567-6780 if you have any questions concerning this letter.

Sincerely,

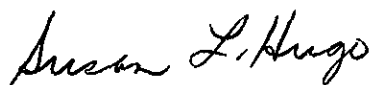

Susan L. Hugo  
Senior Hazardous Materials Specialist

cc: Rafat A. Shahid, Director, Environmental Health  
Gil Jensen, Alameda County District Attorney's Office  
Mee Ling Tung, Acting Chief, Environmental Protection  
Division / files  
Kevin Graves, San Francisco Bay RWQCB  
Blaine Frost, Marcor Environmental, 2601 Barrington Court  
Hayward, CA 94545

ALAMEDA COUNTY  
HEALTH CARE SERVICES  
AGENCY

DAVID J. KEARS, Agency Director



RAFAT A. SHAHID, DIRECTOR

DEPARTMENT OF ENVIRONMENTAL HEALTH  
State Water Resources Control Board  
Division of Clean Water Programs  
UST Local Oversight Program  
1131 Harbor Bay Parkway  
Alameda, CA 94502-6577  
(510) 567-6700

June 1, 1995  
STID# 320

Mr. Earl Mau  
Clearprint Paper Company, Inc.  
1482 67th Street  
Emeryville, California 94608

**RE: Underground Storage Tank Removals at Clearprint Paper  
Company, Inc. - 1482 67th Street, Emeryville, CA 94608**

Dear Mr. Mau:

This office has recently reviewed the Clearprint Paper Company Closure Report (March 10, 1995) prepared and submitted by Marcor Environmental concerning the removal of four underground storage tanks at the referenced site.

Three underground storage tanks (10,000 gallon steel, 1000 gallon steel and 9450 gallon fiberglass) were removed on October 3, 1994 at the subject site. The fourth tank (8000 gallon steel) was removed on October 4, 1994. Corrosion was present in the three steel tanks and a hole was observed at the bottom of the 1,000 gallon tank. Strong hydrocarbon odor and soil staining were observed during the removal of the tanks. The tanks were all located underneath the sidewalk next to the building along 67th Street.

Limited overexcavation was performed on October 5, 1994 along the perimeter on the excavation. Soil samples collected from the bottom and sidewalls exhibited petroleum hydrocarbon contamination as high as 610 ppm TPH gasoline, 340 ppm TPH diesel, 930 ppm TOG, 14 ppm benzene, 320 ppm toluene, 190 ppm ethyl benzene, and 58 ppm xylene. Low levels of PNA's were detected in the soil samples ( 1.3 ppm naphthalene, 1.1 ppm anthracene, 1.1 ppm fluoranthene, and 0.96 ppm pyrene. Metals were also detected in the soil samples up to 10 ppm arsenic, 210 ppm barium, 0.34 ppm beryllium, 20 ppm chromium, 13 ppm cobalt, 14 ppm copper, 31 ppm lead, 31 ppm nickel, 16 ppm vanadium, and 33 ppm zinc.

Groundwater was pumped out from the excavation and stored in Baker tanks. Groundwater samples found contamination up to 19,000 ppb TPH diesel, and 12,000 ppb TOG.

Mr. Earl Mau  
RE: 1482 67th Street, Emeryville, CA 94608  
June 1, 1995  
Page 2 of 3

Clearly, a release associated with the former underground storage tanks had occurred at the referenced site. The vertical and lateral extent of the soil and /or groundwater contamination must be determined. At a minimum, one groundwater monitoring well must be installed within ten feet of the former tanks in the verified downgradient direction. A work plan must be submitted to this office **no later than July 31, 1995.**

Additionally, please submit a site map showing the location of all the soil sampling points collected during the removal of the tanks. You may incorporate this map in the workplan.

Until cleanup is complete, you will need to submit reports to this office every three months (or at a more frequent interval, if specified at any time by this agency). In addition, the following items must be incorporated in your future reports or workplans:

- a cover letter from the responsible party or tank owner stating the accuracy of the report and whether he/she concurs with the conclusions and recommendations in the report or workplan
- site map delineating contamination contours for soil and groundwater based on recent data should be included and the status of the investigation and cleanup must be identified
- proposed continuing or next phase of investigation / cleanup activities must be included to inform this department of the responsible party or tank owner's intention
- any changes in the groundwater flow direction and gradient based on the measured data since the last sampling event must be explained
- historical records of groundwater level in each well must be tabulated to indicate the fluctuation in water levels
- tabulate analytical results from all previous sampling events; provide laboratory reports (including quality control/quality assurance) and chain of custody documentation

All reports and proposals must be submitted under seal of a California Registered Geologist or Registered Civil Engineer with a statement of qualifications for each lead professionals involved with the project.

Mr. Earl Mau  
RE: 1482 67th Street, Emeryville, CA 94608  
June 1, 1995  
Page 3 of 3

Please contact me at (510) 567-6780 if you have any questions concerning this letter.

Sincerely,

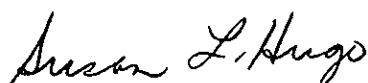

Susan L. Hugo  
Senior Hazardous Materials Specialist

cc: Rafat A. Shahid, Director, Environmental Health  
Gil Jensen, Alameda County District Attorney's Office  
Mee Ling Tung, Acting Chief, Environmental Protection  
Division / files  
Kevin Graves, San Francisco Bay RWQCB  
Blaine Frost, Marcor Environmental, 2601 Barrington Court  
Hayward, CA 94545

ALAMEDA COUNTY  
HEALTH CARE SERVICES

AGENCY

DAVID J. KEARS, Agency Director



RAFAT A. SHAHID, Assistant Agency Director

October 26, 1994

Mr. Earl Mau  
Clear Print Paper Company  
1482 67th Street  
Emeryville, California 94608

ALAMEDA COUNTY CC4580  
DEPT. OF ENVIRONMENTAL HEALTH  
ENVIRONMENTAL PROTECTION DIVISION  
1131 HARBOR BAY PKWY., #250  
ALAMEDA CA 94502-6577

**Subject: Underground Storage Tank Removals at  
Clear Print Paper Company  
1482 67th Street, Emeryville, California 94608**

Dear Mr. Mau:

This letter confirms that the four underground storage tanks (1 -10,000 gallon mineral oil, 1 -8000 gallon solvent, 1 -1000 gallon mineral oil/water, and 1 -9450 gallon mineral oil) at the referenced site had been permanently closed. The four underground storage tanks were removed on October 3 - 4, 1994 under our department's oversight. A Tank Closure Report will be submitted to our office within 60 days of the tank removal.

Physical evidence collected during the tanks' removal ( apparent holes in some of the tanks, strong hydrocarbon and solvent odor, floating product in the groundwater, soil discoloration, etc. ) indicates the presence of soil and groundwater contamination. An Underground Storage Tank Unauthorized Release(Leak) / Contamination Site Report was filed on October 9, 1994.

Further site characterization and investigation is required to determine the vertical and lateral extent of the contamination at the subject property.

Please contact me at (510) 567-6780 if you have any questions concerning this letter.

Sincerely,

A handwritten signature in cursive script that reads "Susan L. Hugo".

Susan L. Hugo  
Senior Hazardous Materials Specialist

cc: Edgar B. Howell, Chief, Hazardous Materials Division - files  
John Pruett III, MARCOR of California, Inc.  
2601 Barrington Court, Hayward CA 94545

SUSAN L. HUGO

ACCEPTED

DEPARTMENT OF ENVIRONMENTAL HEALTH  
470 - 27th Street, Third Floor  
Oakland, CA 94612  
Telephone: (415) 874-7237

These plans have been reviewed and found to be acceptable and essentially meet the requirements of State and local health laws. Changes to your plans indicated by this Department are to assure compliance with State and local laws. The project proposed herein is now released for issuance of any required building permits for construction.

One copy of these accepted plans must be on the job and available to all contractors and craftsmen involved with the removal.

Any change or alterations of these plans and specifications must be submitted to this Department and to the Fire and Building Inspection Department to determine if such changes meet the requirements of State and local laws. Notify this Department at least 48 hours prior to the following required inspections:

- Removal of Tank and Piping
- Sampling
- Final Inspection

Issuance of a permit to operate is dependent on compliance with accepted plans and all applicable laws and regulations.

THERE IS A FINANCIAL PENALTY FOR NOT OBTAINING THESE INSPECTIONS.

*Please note change made.  
on page 2, 495.*

*Susan L. Hugo  
8/5/94*

07/26/94

**UNDERGROUND TANK CLOSURE PLAN**

**\* \* \* Complete according to attached instructions \* \* \***

1. Business Name CLEAR PRINT PAPER COMPANY  
Business Owner CLEAR PRINT PAPER COMPANY
2. Site Address 1482 67TH. STREET  
city EMERYVILLE, CA. zip 94608 Phone (510)652-4762
3. Mailing Address 1482 67TH. STREET  
city EMERYVILLE, CA. zip 94608 Phone (510)652-4762
4. Land Owner CLEAR PRINT PAPER COMPANY  
Address 1482 67TH. STREET city, state EMERYVILLE, CA. zip 94608
5. Generator name under which tank will be manifested CLEAR PRINT PAPER COMPANY  
EPA I.D. No. under which tank will be manifested CAD982018772

*\* Fire extinguisher must be on site.*

6. Contractor MARCOR OF CALIFORNIA  
Address 2601 BARRINGTON COURT  
city HAYWARD CA. 94545 Phone (510) 732-7888  
License Type\* A, AB, ASB, C2 ID# 52037 520037  
HAZMAT *2/10/95*

\*Effective January 1, 1992, Business and Professional Code Section 7058.7 requires prime contractors to also hold Hazardous Waste Certification issued by the State Contractors License Board. Indicate that the certificate has been received, in addition, to holding the appropriate contractors license type.

7. Consultant MARCOR OF CALIFORNIA  
Address 2601 BARRINGTON COURT  
city HAYWARD, CA. Phone (510) 732-7888

8. Contact Person for Investigation  
Name ROBERT F. FLORY Title REGISTERED GEOLOGIST  
Phone (510) 732-7888

9. Number of tanks being closed under this plan 4 ✓  
Length of piping being removed under this plan 40 FT. ✓  
Total number of tanks at facility 4

10. State Registered Hazardous Waste Transporters/Facilities (see instructions).

\*\* Underground tanks are hazardous waste and must be handled \*\*  
as hazardous waste

a) Product/Residual Sludge/Rinsate Transporter  
Name H&H ENVIRONMENTAL EPA I.D. No. CAD004771168  
Hauler License No. 0334 License Exp. Date 1-31-95  
Address 220 PERRY A. FRANCOIS  
city SAN FRANCISCO, state CA. zip 94107

b) Product/Residual Sludge/Rinsate Disposal Site  
Name H&H ENVIRONMENTAL EPA I.D. No. CAD004771168  
Address 220 PERRY A. FRANCOIS  
city SAN FRANCISCO, state CA. zip 94107

c) Tank and Piping Transporter

Name H&H ENVIRONMENTAL EPA I.D. No. CAD004771168  
Hauler License No. 0334 - License Exp. Date 1-31-95  
Address 220 PERRY A. FRANCOIS  
city SAN FRANCISCO, state CA. zip 94107

d) Tank and Piping Disposal Site

Name H&H ENVIRONMENTAL EPA I.D. No. CAD004771168  
Address 220 PERRY A. FRANCOIS  
city SAN FRANCISCO, state CA. zip 94107

11. Experienced Sample collector

Name ROBERT F. FLORY (R.G.)  
Company MARCOR OF CALIFORNIA  
Address 2601 BARRINGTON COURT.  
city HAYWARD, state CA. zip 94545 Phone (510)732-7888

12. Laboratory

Name TRACE ANALYSIS (783-6960)  
Address 3423 INVESTMENT WAY.  
city HAYWARD, state CA. zip 94545  
State Certification No. 1199

13. Have tanks or pipes leaked in the past? Yes [ ] No []

If yes, describe. NOT TO OUR KNOWLEDGE



14. Describe methods to be used for rendering tank inert

AFTER REMOVAL OF ALL POSSIBLE CONTENTS THE TANKS WILL BE INERTED - USING  $\frac{15}{100}$  DRY ICE PER 1,000 GAL. TANK CAPACITY.

Before tanks are pumped out and inerted, all associated piping must be flushed out into the tanks. All accessible associated piping must then be removed. Inaccessible piping must be plugged.

The Bay Area Air Quality Management District (771-6000), along with local Fire and Building Departments, must also be contacted for tank removal permits. Fire departments typically require the use of explosion proof combustible gas meters to verify tank inertness. It is the contractor's responsibility to bring a working combustible gas meter on site to verify tank inertness.

15. Tank History and Sampling Information

Tank		Material to be sampled (tank contents, soil, ground-water, etc.)	Location and Depth of Samples
Capacity	Use History (see instructions)		
✓ 1,000	MINERAL OIL	2-SAMPLES JUST ABOVE GROUND WATER	SITE WALL JUST ABOVE GROUND WATER AT EACH END OF TANK, APPR. 6FT. & ONE WATER SAMPLE
8,000	SOLTROL	2-SAMPLES JUST ABOVE GROUND WATER	SAME AS ABOVE
10,000	MINERAL OIL	SAME AS ABOVE	SAME AS ABOVE
10,000	MINERAL OIL	SAME AS ABOVE	SAME AS ABOVE

One soil sample must be collected for every 20 feet of piping that is removed. A ground water sample must be collected should any ground water be present in the excavation.

Excavated/Stockpiled Soil	
Stockpiled Soil Volume (Estimated)	Sampling Plan
150 YDS.	SOIL TO BE BACK FILLED, CUBIC / DISCRETE SAMPLE 20 YDS.
	SOIL FOR DISPOSAL 4 SAMPLES COMPOSITED BY LAB / 50 CUBIC YDS.

Stockpiled soil must be placed on bermed plastic and must be completely covered by plastic sheeting.

16. Chemical methods and associated detection limits to be used for analyzing samples

The Tri-Regional Board recommended minimum verification analyses and practical quantitation reporting limits should be followed. See attached Table 2.

Contaminant Sought	EPA, DHS, or Other Sample Preparation Method Number	EPA, DHS, or Other Analysis Method Number	Method Detection Limit
MINERAL OIL	5520 DBF 5520 CBF INFRARED		SOIL 50 PPM
SOLVENT <i>Chlorinated</i> - TPH gas - TPH diesel - TPH mineral <i>oil</i> ✓ BTEX <i>oil &amp; grease</i>	MODIFIED 80-15 USING A 150 OCTANE STANDARD TP		1 PPM

*Louis (dupes)*  
*need to confirm*

17. Submit Site Health and Safety Plan (See Instructions)

ATTACHED

18. Submit Worker's Compensation Certificate  
 Name of Insurer GOLDEN EAGLE INSURANCE
19. Submit Plot Plan (See Instructions)
20. Enclose Deposit (See Instructions)-
21. Report any leaks or contamination to this office within 5 days of discovery. The report shall be made on an Underground Storage Tank Unauthorized Leak/Contamination Site Report form. (see Instructions)
22. Submit a closure report to this office within 60 days of the tank removal. This report must contain all the information listed in item 22 of the instructions.

I declare that to the best of my knowledge and belief the statements and information provided above are correct and true.

I understand that information in addition to that provided above may be needed in order to obtain an approval from the Department of Environmental Health and that no work is to begin on this project until this plan is approved.

I understand that any changes in design, materials or equipment will void this plan if prior approval is not obtained.

I understand that all work performed during this project will be done in compliance with all applicable OSHA (Occupational Safety and Health Administration) requirements concerning personnel health and safety. I understand that site and worker safety are solely the responsibility of the property owner or his agent and that this responsibility is not shared nor assumed by the County of Alameda.

Once I have received my stamped, accepted closure plan, I will contact the project Hazardous Materials Specialist at least three working days in advance of site work to schedule the required inspections.

Signature of Contractor

Name (please type) JOHN PRUETT III

Signature [Handwritten Signature]

Date 7-26-94

Signature of Site Owner or Operator

Name (please type) EARL MAU

Signature Earl Mau per John P

Date 7-26-94

## INSTRUCTIONS

### General Instructions

- \* Three (3) copies of this plan plus attachments and deposit must be submitted to this Department.
- \* Any cutting into tanks requires local fire department approval.
- \* One complete copy of your approved plan must be at the construction site at all times; a copy of your approved plan must also be sent to the landowner.

### Item Specific Instructions

2. SITE ADDRESS  
Address at which closure is taking place.
5. EPA I.D. NO. under which the tanks will be manifested  
EPA I.D. numbers may be obtained from the State Department of Health Services, 916/324-1781.
6. CONTRACTOR  
Prime contractor for the project.
10. STATE REGISTERED HAZARDOUS WASTE TRANSPORTERS/FACILITIES
  - a) All residual liquids and sludges are to be removed from tanks before tanks are inerted.
  - c) Tanks must be hauled as hazardous waste.
  - d) This is the place where tanks will be taken for cleaning.
15. TANK HISTORY AND SAMPLING INFORMATION  
Use History - This information is essential and must be accurate. Include tank installation date, products stored in the tank, and the date when the tank was last used.

Material to be sampled - e.g. water, oil, sludge, soil, etc.

Location and depth of samples - e.g. beneath the tank a maximum of two feet below the native soil/backfill interface, side wall at the high water mark, etc.

16. CHEMICAL METHODS AND ASSOCIATED DETECTION LIMITS  
See attached Table 2.

17. SITE HEALTH AND SAFETY PLAN

A site specific Health and safety plan must be submitted. We advocate the site health and safety plan include the following items, at a minimum:

- a) The name and responsibilities of the site health and safety officer;
- b) An outline of briefings to be held before work each day to appraise employees of site health and safety hazards;
- c) Identification of health and safety hazards of each work task. Include potential fire, explosion, physical, and chemical hazards;
- d) For each hazard, identify the action levels (contaminant concentrations in air) or physical conditions which will trigger changes in work habits to ensure workers are not exposed to unsafe chemical levels or physical conditions;
- e) Description of the work habit changes triggered by the above action levels or physical conditions;
- f) Frequency and types of air and personnel monitoring - along with the environmental sampling techniques and instrumentation - to be used to detect the above action levels. Include instrumentation maintenance and calibration methods and frequencies;
- g) Confined space entry procedures (if applicable);
- h) Decontamination procedures;
- i) Measures to be taken to secure the site, excavation and stockpiled soil during and after work hours (e.g. barricades, caution tape, fencing, trench plates, plastic sheeting, security guards, etc.);
- j) Spill containment/emergency/contingency plan. Be sure to include emergency phone numbers, the location of the phone nearest the site, and directions to the hospital nearest the site;
- k) Documentation that all site workers have received the appropriate OSHA approved trainings and participate in appropriate medical surveillance per 29 CFR 1910.120; and
- l) Page for employees to sign indicating they have read and will comply with the site health and safety plan.

The safety plan must be distributed to all employees and contractors working in hazardous waste operations on site. A complete copy of the site health and safety plan along with any standard operating procedures shall be on site and accessible at all times.

NOTE: These requirements are excerpted from 1910.120(b)(1), Hazardous Waste Operations and Emergency Response; Final Rule, March 6, 1989. Safety plans of certain underground tank sites may need to meet the complete requirements of this Rule.

19. PLOT PLAN

The plan should consist of a scaled view of the facility at which the tank(s) are located and should include the following information:

- a) Scale;
- b) North Arrow;
- c) Property Lines;
- d) Location of all Structures;
- e) Location of all relevant existing equipment including tanks and piping to be removed and dispensers;
- f) Streets;
- g) Underground conduits, sewers, water lines, utilities;
- h) Existing wells (drinking, monitoring, etc.);
- i) Depth to ground water; and
- j) All existing tanks and piping in addition to the ones being pulled.

20. DEPOSIT

A deposit, payable to Alameda County for the amount indicated on the Alameda County Underground Storage Tank Fee Schedule, must accompany the plans.

21. Blank Unauthorized Leak/Contamination Site Report forms may be obtained in limited quantities from our office and from the San Francisco Bay Regional Water Quality Control Board (415/464-1255). Larger quantities may be obtained directly from the State Water Resources Control Board at (916) 739-2421.

22. TANK CLOSURE REPORT

The tank closure report should contain the following information:

- a) General description of the closure activities;
- b) Description of tank, fittings and piping conditions. Indicate tank size and former contents; note any corrosion, pitting, holes, etc.;

- c) Description of the excavation itself. Include the tank and excavation depth, a log of the stratigraphic units encountered within the excavation, a description of root holes or other potential contaminant pathways, the depth to any observed ground water, descriptions and locations of stained or odor-bearing soil, and descriptions of any observed free product or sheen;
- d) Description of sampling methods;
- e) Description of any remedial measures conducted at the time of tank removal;
- f) To-scale figures showing the excavation size and depth, nearby buildings, sample locations and depths, and tank and piping locations. Include a copy of the plot plan prepared for the Tank Closure Plan under item 19;
- g) Chain of custody records;
- h) Copies of signed laboratory reports;
- i) Copies of "TSDF to Generator" Manifests for all hazardous wastes hauled offsite (sludge, rinsate, tanks and piping, contaminated soil, etc.); and
- j) Tabulation of the volume and final destination of all non-manifested contaminated soil hauled offsite.

**TABLE #2**  
**RECOMMENDED MINIMUM VERIFICATION ANALYSES FOR**  
**UNDERGROUND TANK LEAKS**

<u>HYDROCARBON LEAK</u>	<u>SOIL ANALYSIS</u>	<u>WATER ANALYSIS</u>
Unknown Fuel	TPH G GCFID(5030) TPH D GCFID(3550) BTX&E 8020 or 8240 TPH AND BTX&E 8260	TPH G GCFID(5030) TPH D GCFID(3510) BTX&E 602, 624 or 8260
Leaded Gas	TPH G GCFID(5030) BTX&E 8020 OR 8240 TPH AND BTX&E 8260 TOTAL LEAD AA -----Optional----- TEL DHS-LUFT EDB DHS-AB1803	TPH G GCFID(5030) BTX&E 602 or 624 TOTAL LEAD AA  TEL DHS-LUFT EDB DHS-AB1803
Unleaded Gas	TPH G GCFID(5030) BTX&E 8020 or 8240 TPH AND BTX&E 8260	TPH G GCFID(5030) BTX&E 602, 624 or 8260
Diesel, Jet Fuel and Kerosene	TPH D GCFID(3550) BTX&E 8020 or 8240 TPH AND BTX&E 8260	TPH D GCFID(3510) BTX&E 602, 624 or 8260
Fuel/Heating Oil	TPH D GCFID(3550) BTX&E 8020 or 8240 TPH AND BTX&E 8260	TPH D GCFID(3510) BTX&E 602, 624 or 8260
Chlorinated Solvents	CL HC 8010 or 8240 BTX&E 8020 or 8240 CL HC AND BTX&E 8260	CL HC 601 or 624 BTX&E 602 or 624 CL HC AND BTX&E 8260
Non-chlorinated Solvents	TPH D GCFID(3550) BTX&E 8020 or 8240 TPH AND BTX&E 8260	TPH D GCFID(3510) BTX&E 602 or 624 TPH and BTX&E 8260
Waste and Used Oil or Unknown (All analyses must be completed and submitted)	TPH G GCFID(5030) TPH D GCFID(3550) TPH AND BTX&E 8260 O & G 5520 D & F BTX&E 8020 or 8240  CL HC 8010 or 8240	TPH G GCFID(5030) TPH D GCFID(3510)  O & G 5520 C & F BTX&E 602, 624 or 8260  CL HC 601 or 624

ICAP or AA TO DETECT METALS: Cd, Cr, Pb, Zn, Ni  
METHOD 8270 FOR SOIL OR WATER TO DETECT:  
PCB\*  
PCP\*  
PNA  
CREOSOTE

\* If found, analyze for dibenzofurans (PCBs) or dioxins (PCP)

Reference: Tri-Regional Board Staff Recommendations for Preliminary Evaluation and Investigation of Underground Tank Sites, 10 August 1990



**EXPLANATION FOR TABLE #2: MINIMUM VERIFICATION ANALYSIS**

1. OTHER METHODOLOGIES are continually being developed and as methods are accepted by EPA or DHS, they also can be used.
2. For DRINKING WATER SOURCES, EPA recommends that the 500 series for volatile organics be used in preference to the 600 series because the detection limits are lower and the QA/QC is better.
3. APPROPRIATE STANDARDS for the materials stored in the tank are to be used for all analyses on Table #2. For instance, seasonally, there may be five different jet fuel mixtures to be considered.
4. To AVOID FALSE POSITIVE detection of benzene, benzene-free solvents are to be used.
5. TOTAL PETROLEUM HYDROCARBONS (TPH) as gasoline (G) and diesel (D) ranges (volatile and extractible, respectively) are to be analyzed and characterized by GCFID with a fused capillary column and prepared by EPA method 5030 (purge and trap) for volatile hydrocarbons, or extracted by sonication using 3550 methodology for extractable hydrocarbons. Fused capillary columns are preferred to packed columns; a packed column may be used as a "first cut" with "dirty" samples or once the hydrocarbons have been characterized and proper QA/QC is followed.
6. TETRAETHYL LEAD (TEL) analysis may be required if total lead is detected unless the determination is made that the total lead concentration is geogenic (naturally occurring).
7. CHLORINATED HYDROCARBONS (CL HC) AND BENZENE, TOLUENE, XYLENE AND ETHYLBENZENE (BTX&E) are analyzed in soil by EPA methods 8010 and 8020 respectively, (or 8240) and in water, 601 and 602, respectively (or 624).
8. OIL AND GREASE (O & G) may be used when heavy, straight chain hydrocarbons may be present. Infrared analysis by method 418.1 may also be acceptable for O & G if proper standards are used. Standard Methods" 17th Edition, 1989, has changed the 503 series to 5520.
9. PRACTICAL QUANTITATION REPORTING LIMITS are influenced by matrix problems and laboratory QA/QC procedures. Following are the Practical Quantitation Reporting Limits:

	<u>SOIL PPM</u>	<u>WATER PPB</u>
TPH G	1.0	50.0
TPH D	1.0	50.0
BTX&E	0.005	0.5
O & G	50.0	5,000.0

Tri-Regional Board Staff Recommendations  
Preliminary UST Site Investigations

Based upon a Regional Board survey of Department of Health Services Certified Laboratories, the Practical Quantitation Reporting Limits are attainable by a majority of laboratories with the exception of diesel fuel in soils. The Diesel Practical Quantitation Reporting Limits, shown by the survey, are:

ROUTINE	MODIFIED PROTOCOL
≤ 10 ppm (42%)	≤ 10 ppm (10%)
≤ 5 ppm (19%)	≤ 5 ppm (21%)
≤ 1 ppm (35%)	≤ 1 ppm (60%)

When the Practical Quantitation Reporting Limits are not achievable, an explanation of the problem is to be submitted on the laboratory data sheets.

- LABORATORY DATA SHEETS are to be signed and submitted and include the laboratory's assessment of the condition of the samples on receipt including temperature, suitable container type, air bubbles present/absent in VOA bottles, proper preservation, etc. The sheets are to include the dates sampled, submitted, prepared for analysis, and analyzed.
- IF PEAKS ARE FOUND, when running samples, that do not conform to the standard, laboratories are to report the peaks, including any unknown complex mixtures that elute at times varying from the standards. Recognizing that these mixtures may be contrary to the standard, they may not be readily identified; however, they are to be reported. At the discretion of the LIA or Regional Board the following information is to be contained in the laboratory report:

The relative retention time for the unknown peak(s) relative to the reference peak in the standard, copies of the chromatogram(s), the type of column used, initial temperature, temperature program is C/minute, and the final temperature.

- REPORTING LIMITS FOR TPH are: gasoline standard ≤ 20 carbon atoms, diesel and jet fuel (kerosene) standard ≤ 50 carbon atoms. It is not necessary to continue the chromatography beyond the limit, standard, or EPA/DHS method protocol (whichever time is greater).

#### EPILOGUE

ADDITIVES: Major oil companies are being encouraged or required by the federal government to reformulate gasoline as cleaner burning fuels to reduce air emissions. MTBE (Methyl-tertiary butyl ether), ETHANOL (ethyl alcohol), and other chemicals may be added to reformulate gasolines to increase the oxygen content in the fuel and thereby decrease undesirable emissions (about four percent with MTBE). MTBE and ethanol are, for practical purposes, soluble in water. The removal from the water column will be difficult. Other compounds are being added by the oil companies for various purposes. The refinements for detection and analysis for all of these additives are still being worked out. If you have any questions about the methodology, please call your Regional Board representative.

320

TANKS REMOVED

10/3-4/94



STATE OF CALIFORNIA  
STATE WATER RESOURCES CONTROL BOARD  
UNDERGROUND STORAGE TANK PERMIT APPLICATION - FORM A

COMPLETE THIS FORM FOR EACH FACILITY/SITE

MARK ONLY ONE ITEM	<input type="checkbox"/> 1 NEW PERMIT	<input type="checkbox"/> 3 RENEWAL PERMIT	<input type="checkbox"/> 5 CHANGE OF INFORMATION	<input checked="" type="checkbox"/> 7 PERMANENTLY CLOSED SITE
	<input type="checkbox"/> 2 INTERIM PERMIT	<input type="checkbox"/> 4 AMENDED PERMIT	<input type="checkbox"/> 6 TEMPORARY SITE CLOSURE	

I. FACILITY/SITE INFORMATION & ADDRESS - (MUST BE COMPLETED)

DBA OR FACILITY NAME Clear Print Paper Company		NAME OF OPERATOR Clear Print Paper Company		
ADDRESS 1482 67th Street		NEAREST CROSS STREET	PARCEL # (OPTIONAL)	
CITY NAME Emeryville	STATE CA	ZIP CODE 94608	SITE PHONE # WITH AREA CODE 510-652-4762	
<input checked="" type="checkbox"/> BOX TO INDICATE <input checked="" type="checkbox"/> CORPORATION <input type="checkbox"/> INDIVIDUAL <input type="checkbox"/> PARTNERSHIP <input type="checkbox"/> LOCAL-AGENCY DISTRICTS* <input type="checkbox"/> COUNTY-AGENCY* <input type="checkbox"/> STATE-AGENCY* <input type="checkbox"/> FEDERAL-AGENCY*				
* If owner of UST is a public agency, complete the following: name of Supervisor of division, section, or office which operates the UST _____				
TYPE OF BUSINESS		<input type="checkbox"/> IF INDIAN RESERVATION OR TRUST LANDS	# OF TANKS AT SITE	E. P. A. I. D. # (optional)
<input type="checkbox"/> 1 GAS STATION <input type="checkbox"/> 2 DISTRIBUTOR <input type="checkbox"/> 3 FARM <input checked="" type="checkbox"/> 4 PROCESSOR <input type="checkbox"/> 5 OTHER			0	

EMERGENCY CONTACT PERSON (PRIMARY)

EMERGENCY CONTACT PERSON (SECONDARY) - optional

DAYS: NAME (LAST, FIRST) Mau, Earl	PHONE # WITH AREA CODE 510-652-4762	DAYS: NAME (LAST, FIRST) Contreras, Jesse	PHONE # WITH AREA CODE 800-805-4890
NIGHTS: NAME (LAST, FIRST) Pruett III, John	PHONE # WITH AREA CODE 510-448-4502	NIGHTS: NAME (LAST, FIRST) Flory, Robert	PHONE # WITH AREA CODE 510-539-1650

II. PROPERTY OWNER INFORMATION - (MUST BE COMPLETED)

NAME Clear Print Paper Company		CARE OF ADDRESS INFORMATION Clear Print Paper Company		
MAILING OR STREET ADDRESS 1482 67th Street		<input checked="" type="checkbox"/> box to indicate <input checked="" type="checkbox"/> CORPORATION <input type="checkbox"/> INDIVIDUAL <input type="checkbox"/> LOCAL-AGENCY <input type="checkbox"/> STATE-AGENCY <input type="checkbox"/> PARTNERSHIP <input type="checkbox"/> COUNTY-AGENCY <input type="checkbox"/> FEDERAL-AGENCY		
CITY NAME Emeryville	STATE CA	ZIP CODE 94608	PHONE # WITH AREA CODE 510-652-4762	

III. TANK OWNER INFORMATION - (MUST BE COMPLETED)

NAME OF OWNER Clear Print Paper Company		CARE OF ADDRESS INFORMATION Clear Print Paper Company		
MAILING OR STREET ADDRESS 1482 67th Street		<input checked="" type="checkbox"/> box to indicate <input checked="" type="checkbox"/> CORPORATION <input type="checkbox"/> INDIVIDUAL <input type="checkbox"/> LOCAL-AGENCY <input type="checkbox"/> STATE-AGENCY <input type="checkbox"/> PARTNERSHIP <input type="checkbox"/> COUNTY-AGENCY <input type="checkbox"/> FEDERAL-AGENCY		
CITY NAME Emeryville	STATE CA	ZIP CODE 94608	PHONE # WITH AREA CODE 510-652-4762	

IV. BOARD OF EQUALIZATION UST STORAGE FEE ACCOUNT NUMBER - Call (916) 322-9669 if questions arise.

TY (TK) HQ 44-0000250

V. PETROLEUM UST FINANCIAL RESPONSIBILITY - (MUST BE COMPLETED) - IDENTIFY THE METHOD(S) USED

<input checked="" type="checkbox"/> box to indicate	<input checked="" type="checkbox"/> 1-SELF-INSURED	<input type="checkbox"/> 2 GUARANTEE	<input type="checkbox"/> 3 INSURANCE	<input type="checkbox"/> 4 SURETY BOND
	<input type="checkbox"/> 5 LETTER OF CREDIT	<input type="checkbox"/> 6 EXEMPTION	<input type="checkbox"/> 99 OTHER	

VI. LEGAL NOTIFICATION AND BILLING ADDRESS

Legal notification and billing will be sent to the tank owner unless box I or II is checked.

CHECK ONE BOX INDICATING WHICH ABOVE ADDRESS SHOULD BE USED FOR LEGAL NOTIFICATIONS AND BILLING: I.  II.  III.

THIS FORM HAS BEEN COMPLETED UNDER PENALTY OF PERJURY, AND TO THE BEST OF MY KNOWLEDGE, IS TRUE AND CORRECT

OWNER'S NAME (PRINTED & SIGNED) Earl Mau	OWNER'S TITLE Manager	DATE MONTH/DAY/YEAR 07-25-94
---	--------------------------	---------------------------------

LOCAL AGENCY USE ONLY

COUNTY # 01	JURISDICTION # 000	FACILITY # 0196666
LOCATION CODE - OPTIONAL	CENSUS TRACT # - OPTIONAL	SUPVISOR - DISTRICT CODE - OPTIONAL

THIS FORM MUST BE ACCOMPANIED BY AT LEAST (1) OR MORE PERMIT APPLICATION - FORM B, UNLESS THIS IS A CHANGE OF SITE INFORMATION ONLY.  
OWNER MUST FILE THIS FORM WITH THE LOCAL AGENCY IMPLEMENTING THE UNDERGROUND STORAGE TANK REGULATIONS

STATE OF CALIFORNIA  
STATE WATER RESOURCES CONTROL BOARD  
**UNDERGROUND STORAGE TANK PERMIT APPLICATION - FORM B**



COMPLETE A SEPARATE FORM FOR EACH TANK SYSTEM.

MARK ONLY ONE ITEM	<input type="checkbox"/> 1 NEW PERMIT	<input type="checkbox"/> 3 RENEWAL PERMIT	<input type="checkbox"/> 5 CHANGE OF INFORMATION	<input type="checkbox"/> 7 PERMANENTLY CLOSED ON SITE
	<input type="checkbox"/> 2 INTERIM PERMIT	<input type="checkbox"/> 4 AMENDED PERMIT	<input type="checkbox"/> 6 TEMPORARY TANK CLOSURE	<input checked="" type="checkbox"/> 8 TANK REMOVED

DBA OR FACILITY NAME WHERE TANK IS INSTALLED: **Clear Print Paper Company**

**I. TANK DESCRIPTION** COMPLETE ALL ITEMS -- SPECIFY IF UNKNOWN

A. OWNER'S TANK I.D.# <b>CAD982#18772</b>	B. MANUFACTURED BY: <b>Unknown</b>
C. DATE INSTALLED (MO/DAY/YEAR) <b>1979</b>	D. TANK CAPACITY IN GALLONS: <b>8,000</b>

**II. TANK CONTENTS** IF A-1 IS MARKED, COMPLETE ITEM C.

A. <input type="checkbox"/> 1 MOTOR VEHICLE FUEL	<input type="checkbox"/> 4 OIL	B. <input checked="" type="checkbox"/> 1 PRODUCT	C. <input type="checkbox"/> 1a REGULAR UNLEADED
<input type="checkbox"/> 2 PETROLEUM	<input checked="" type="checkbox"/> 80 EMPTY	<input type="checkbox"/> 2 WASTE	<input type="checkbox"/> 1b PREMIUM UNLEADED
<input type="checkbox"/> 3 CHEMICAL PRODUCT	<input type="checkbox"/> 95 UNKNOWN		<input type="checkbox"/> 2 LEADED
D. IF (A.1) IS NOT MARKED, ENTER NAME OF SUBSTANCE STORED <b>Mineral Oil</b>			<input type="checkbox"/> 3 DIESEL
			<input type="checkbox"/> 4 GASAHOL
			<input type="checkbox"/> 5 JET FUEL
			<input checked="" type="checkbox"/> 99 OTHER (DESCRIBE IN ITEM D. BELOW)
			<input type="checkbox"/> 6 AVIATION GAS
			<input type="checkbox"/> 7 METHANOL
			C. A. S. #: <b>540-84-1</b>

**III. TANK CONSTRUCTION** MARK ONE ITEM ONLY IN BOXES A, B, AND C, AND ALL THAT APPLIES IN BOX D AND E

A. TYPE OF SYSTEM	<input type="checkbox"/> 1 DOUBLE WALL	<input type="checkbox"/> 3 SINGLE WALL WITH EXTERIOR LINER	<input type="checkbox"/> 95 UNKNOWN
	<input checked="" type="checkbox"/> 2 SINGLE WALL	<input type="checkbox"/> 4 SECONDARY CONTAINMENT (VAULTED TANK)	<input type="checkbox"/> 99 OTHER
B. TANK MATERIAL (Primary Tank)	<input checked="" type="checkbox"/> 1 BARE STEEL	<input type="checkbox"/> 2 STAINLESS STEEL	<input type="checkbox"/> 3 FIBERGLASS
	<input type="checkbox"/> 5 CONCRETE	<input type="checkbox"/> 8 POLYVINYL CHLORIDE	<input type="checkbox"/> 7 ALUMINUM
	<input type="checkbox"/> 9 BRONZE	<input type="checkbox"/> 10 GALVANIZED STEEL	<input type="checkbox"/> 95 UNKNOWN
			<input type="checkbox"/> 99 OTHER
C. INTERIOR LINING	<input type="checkbox"/> 1 RUBBER LINED	<input type="checkbox"/> 2 ALKYD LINING	<input type="checkbox"/> 3 EPOXY LINING
	<input type="checkbox"/> 5 GLASS LINING	<input checked="" type="checkbox"/> 6 UNLINED	<input type="checkbox"/> 95 UNKNOWN
			<input type="checkbox"/> 4 PHENOLIC LINING
			<input type="checkbox"/> 99 OTHER
	IS LINING MATERIAL COMPATIBLE WITH 100% METHANOL? YES ___ NO ___		
D. CORROSION PROTECTION	<input type="checkbox"/> 1 POLYETHYLENE WRAP	<input type="checkbox"/> 2 COATING	<input type="checkbox"/> 3 VINYL WRAP
	<input type="checkbox"/> 5 CATHODIC PROTECTION	<input checked="" type="checkbox"/> 91 NONE	<input checked="" type="checkbox"/> 95 UNKNOWN
			<input type="checkbox"/> 4 FIBERGLASS REINFORCED PLASTIC
			<input type="checkbox"/> 99 OTHER
E. SPILL AND OVERFILL	SPILL CONTAINMENT INSTALLED (YEAR) _____		OVERFILL PREVENTION EQUIPMENT INSTALLED (YEAR) _____

**IV. PIPING INFORMATION** CIRCLE A IF ABOVE GROUND OR U IF UNDERGROUND, BOTH IF APPLICABLE

A. SYSTEM TYPE	A <input checked="" type="checkbox"/> 1 SUCTION	U <input checked="" type="checkbox"/> 2 PRESSURE	A U <input type="checkbox"/> 3 GRAVITY	A U <input type="checkbox"/> 99 OTHER
B. CONSTRUCTION	<input checked="" type="checkbox"/> U 1 SINGLE WALL	A U <input type="checkbox"/> 2 DOUBLE WALL	A U <input type="checkbox"/> 3 LINED TRENCH	A U <input type="checkbox"/> 95 UNKNOWN
				A U <input type="checkbox"/> 99 OTHER
C. MATERIAL AND CORROSION PROTECTION	<input checked="" type="checkbox"/> A U 1 BARE STEEL	A U <input type="checkbox"/> 2 STAINLESS STEEL	A U <input type="checkbox"/> 3 POLYVINYL CHLORIDE (PVC)	A U <input type="checkbox"/> 4 FIBERGLASS PIPE
	A U <input type="checkbox"/> 5 ALUMINUM	A U <input type="checkbox"/> 6 CONCRETE	A U <input type="checkbox"/> 7 STEEL W/ COATING	A U <input type="checkbox"/> 8 100% METHANOL COMPATIBLE W/FRP
	A U <input type="checkbox"/> 9 GALVANIZED STEEL	A U <input type="checkbox"/> 10 CATHODIC PROTECTION	<input checked="" type="checkbox"/> A U 95 UNKNOWN	A U <input type="checkbox"/> 99 OTHER
D. LEAK DETECTION	<input type="checkbox"/> 1 AUTOMATIC LINE LEAK DETECTOR	<input checked="" type="checkbox"/> 2 LINE TIGHTNESS TESTING	<input type="checkbox"/> 3 INTERSTITIAL MONITORING	<input type="checkbox"/> 99 OTHER

**V. TANK LEAK DETECTION**

<input type="checkbox"/> 1 VISUAL CHECK	<input type="checkbox"/> 2 INVENTORY RECONCILIATION	<input type="checkbox"/> 3 VADOZE MONITORING	<input type="checkbox"/> 4 AUTOMATIC TANK GAUGING	<input type="checkbox"/> 5 GROUND WATER MONITORING
<input checked="" type="checkbox"/> 6 TANK TESTING	<input type="checkbox"/> 7 INTERSTITIAL MONITORING	<input type="checkbox"/> 91 NONE	<input type="checkbox"/> 95 UNKNOWN	<input type="checkbox"/> 99 OTHER

**VI. TANK CLOSURE INFORMATION**

1. ESTIMATED DATE LAST USED (MO/DAY/YR) <b>8-1-94</b>	2. ESTIMATED QUANTITY OF SUBSTANCE REMAINING <b>0</b> GALLONS	3. WAS TANK FILLED WITH INERT MATERIAL? YES <input type="checkbox"/> NO <input checked="" type="checkbox"/>
--	---	---

THIS FORM HAS BEEN COMPLETED UNDER PENALTY OF PERJURY, AND TO THE BEST OF MY KNOWLEDGE, IS TRUE AND CORRECT

APPLICANT'S NAME (PRINTED & SIGNATURE) <i>Earl V. M... ..</i>	DATE <b>7-25-94</b>
--	------------------------

**LOCAL AGENCY USE ONLY** THE STATE I.D. NUMBER IS COMPOSED OF THE FOUR NUMBERS BELOW

STATE I.D.#	COUNTY #	JURISDICTION #	FACILITY #	TANK #
	<b>01</b>	<b>000</b>	<b>019666</b>	<b>000001</b>
PERMIT NUMBER	PERMIT APPROVED BY/DATE		PERMIT EXPIRATION DATE	

THIS FORM MUST BE ACCOMPANIED BY A PERMIT APPLICATION - FORM A, UNLESS A CURRENT FORM A HAS BEEN FILED.  
FILE THIS FORM WITH THE LOCAL AGENCY IMPLEMENTING THE UNDERGROUND STORAGE TANK REGULATIONS

STATE OF CALIFORNIA  
STATE WATER RESOURCES CONTROL BOARD  
**UNDERGROUND STORAGE TANK PERMIT APPLICATION - FORM B**



COMPLETE A SEPARATE FORM FOR EACH TANK SYSTEM.

MARK ONLY ONE ITEM	<input type="checkbox"/> 1 NEW PERMIT	<input type="checkbox"/> 3 RENEWAL PERMIT	<input type="checkbox"/> 5 CHANGE OF INFORMATION	<input type="checkbox"/> 7 PERMANENTLY CLOSED ON SITE
	<input type="checkbox"/> 2 INTERIM PERMIT	<input type="checkbox"/> 4 AMENDED PERMIT	<input type="checkbox"/> 6 TEMPORARY TANK CLOSURE	<input checked="" type="checkbox"/> 8 TANK REMOVED

DBA OR FACILITY NAME WHERE TANK IS INSTALLED: \_\_\_\_\_

**I. TANK DESCRIPTION** COMPLETE ALL ITEMS -- SPECIFY IF UNKNOWN

A. OWNER'S TANK I.D.# <b>CAD982018772</b>	B. MANUFACTURED BY: <b>Unknown</b>
C. DATE INSTALLED (MO/DAY/YEAR) <b>79</b>	D. TANK CAPACITY IN GALLONS: <b>10,000</b>

**II. TANK CONTENTS** IF A-1 IS MARKED, COMPLETE ITEM C.

A. <input type="checkbox"/> 1 MOTOR VEHICLE FUEL	<input type="checkbox"/> 4 OIL	B. <input checked="" type="checkbox"/> 1 PRODUCT	C. <input type="checkbox"/> 1a REGULAR UNLEADED
<input type="checkbox"/> 2 PETROLEUM	<input checked="" type="checkbox"/> 80 EMPTY	<input type="checkbox"/> 2 WASTE	<input type="checkbox"/> 1b PREMIUM UNLEADED
<input type="checkbox"/> 3 CHEMICAL PRODUCT	<input type="checkbox"/> 95 UNKNOWN		<input type="checkbox"/> 2 LEADED

D. IF (A.1) IS NOT MARKED, ENTER NAME OF SUBSTANCE STORED **Mineral Oil** C.A.S.#: **540-84-1**

**III. TANK CONSTRUCTION** MARK ONE ITEM ONLY IN BOXES A, B, AND C, AND ALL THAT APPLIES IN BOX D AND E

A. TYPE OF SYSTEM	<input type="checkbox"/> 1 DOUBLE WALL	<input type="checkbox"/> 3 SINGLE WALL WITH EXTERIOR LINER	<input type="checkbox"/> 95 UNKNOWN
	<input checked="" type="checkbox"/> 2 SINGLE WALL	<input type="checkbox"/> 4 SECONDARY CONTAINMENT (VAULTED TANK)	<input type="checkbox"/> 99 OTHER

B. TANK MATERIAL (Primary Tank)	<input type="checkbox"/> 1 BARE STEEL	<input type="checkbox"/> 2 STAINLESS STEEL	<input type="checkbox"/> 3 FIBERGLASS
	<input type="checkbox"/> 5 CONCRETE	<input type="checkbox"/> 6 POLYVINYL CHLORIDE	<input type="checkbox"/> 7 ALUMINUM
	<input type="checkbox"/> 9 BRONZE	<input type="checkbox"/> 10 GALVANIZED STEEL	<input type="checkbox"/> 95 UNKNOWN
	<input checked="" type="checkbox"/> 99 OTHER <b>Fiberglass</b>		

C. INTERIOR LINING	<input type="checkbox"/> 1 RUBBER LINED	<input type="checkbox"/> 2 ALKYD LINING	<input type="checkbox"/> 3 EPOXY LINING
	<input type="checkbox"/> 5 GLASS LINING	<input checked="" type="checkbox"/> 6 UNLINED	<input type="checkbox"/> 4 PHENOLIC LINING
	<input type="checkbox"/> 95 UNKNOWN		
	<input type="checkbox"/> 99 OTHER		

IS LINING MATERIAL COMPATIBLE WITH 100% METHANOL? YES \_\_\_ NO \_\_\_

D. CORROSION PROTECTION	<input type="checkbox"/> 1 POLYETHYLENE WRAP	<input type="checkbox"/> 2 COATING	<input type="checkbox"/> 3 VINYL WRAP
	<input type="checkbox"/> 5 CATHODIC PROTECTION	<input checked="" type="checkbox"/> 91 NONE	<input type="checkbox"/> 4 FIBERGLASS REINFORCED PLASTIC
	<input type="checkbox"/> 95 UNKNOWN		
	<input type="checkbox"/> 99 OTHER		

E. SPILL AND OVERFILL SPILL CONTAINMENT INSTALLED (YEAR) \_\_\_\_\_ OVERFILL PREVENTION EQUIPMENT INSTALLED (YEAR) \_\_\_\_\_

**IV. PIPING INFORMATION** CIRCLE A IF ABOVE GROUND OR U IF UNDERGROUND, BOTH IF APPLICABLE

A. SYSTEM TYPE	A U 1 SUCTION	A U 2 PRESSURE	A U 3 GRAVITY	A U 99 OTHER
B. CONSTRUCTION	A U 1 SINGLE WALL	A U 2 DOUBLE WALL	A U 3 LINED TRENCH	A U 95 UNKNOWN
C. MATERIAL AND CORROSION PROTECTION	A U 1 BARE STEEL	A U 2 STAINLESS STEEL	A U 3 POLYVINYL CHLORIDE (PVC)	A U 4 FIBERGLASS PIPE
	A U 5 ALUMINUM	A U 6 CONCRETE	A U 7 STEEL W/ COATING	A U 8 100% METHANOL COMPATIBLE W/FRP
	A U 9 GALVANIZED STEEL	A U 10 CATHODIC PROTECTION	A U 95 UNKNOWN	A U 99 OTHER

D. LEAK DETECTION  1 AUTOMATIC LINE LEAK DETECTOR  2 LINE TIGHTNESS TESTING  3 INTERSTITIAL MONITORING  99 OTHER

**V. TANK LEAK DETECTION**

<input type="checkbox"/> 1 VISUAL CHECK	<input type="checkbox"/> 2 INVENTORY RECONCILIATION	<input type="checkbox"/> 3 VADOZE MONITORING	<input type="checkbox"/> 4 AUTOMATIC TANK GAUGING	<input type="checkbox"/> 5 GROUND WATER MONITORING
<input checked="" type="checkbox"/> 6 TANK TESTING	<input type="checkbox"/> 7 INTERSTITIAL MONITORING	<input type="checkbox"/> 91 NONE	<input type="checkbox"/> 95 UNKNOWN	<input type="checkbox"/> 99 OTHER

**VI. TANK CLOSURE INFORMATION**

1. ESTIMATED DATE LAST USED (MO/DAY/YR) <b>8-1-94</b>	2. ESTIMATED QUANTITY OF SUBSTANCE REMAINING <b>0</b> GALLONS	3. WAS TANK FILLED WITH INERT MATERIAL? YES <input type="checkbox"/> NO <input checked="" type="checkbox"/>
--	---	---

THIS FORM HAS BEEN COMPLETED UNDER PENALTY OF PERJURY, AND TO THE BEST OF MY KNOWLEDGE, IS TRUE AND CORRECT

APPLICANT'S NAME (PRINTED & SIGNATURE) <i>Earl J. McLaw</i>	DATE <b>7-25-94</b>
--	------------------------

**LOCAL AGENCY USE ONLY** THE STATE I.D. NUMBER IS COMPOSED OF THE FOUR NUMBERS BELOW

STATE I.D.#	COUNTY #	JURISDICTION #	FACILITY #	TANK #
	<b>01</b>	<b>000</b>	<b>019666</b>	<b>000007</b>

PERMIT NUMBER	PERMIT APPROVED BY/DATE	PERMIT EXPIRATION DATE
---------------	-------------------------	------------------------

THIS FORM MUST BE ACCOMPANIED BY A PERMIT APPLICATION - FORM A, UNLESS A CURRENT FORM A HAS BEEN FILED.  
FILE THIS FORM WITH THE LOCAL AGENCY IMPLEMENTING THE UNDERGROUND STORAGE TANK REGULATIONS

STATE OF CALIFORNIA  
STATE WATER RESOURCES CONTROL BOARD  
**UNDERGROUND STORAGE TANK PERMIT APPLICATION - FORM B**



COMPLETE A SEPARATE FORM FOR EACH TANK SYSTEM.

MARK ONLY ONE ITEM	<input type="checkbox"/> 1 NEW PERMIT	<input type="checkbox"/> 3 RENEWAL PERMIT	<input type="checkbox"/> 5 CHANGE OF INFORMATION	<input type="checkbox"/> 7 PERMANENTLY CLOSED ON SITE
	<input type="checkbox"/> 2 INTERIM PERMIT	<input type="checkbox"/> 4 AMENDED PERMIT	<input type="checkbox"/> 6 TEMPORARY TANK CLOSURE	<input checked="" type="checkbox"/> 8 TANK REMOVED

DBA OR FACILITY NAME WHERE TANK IS INSTALLED: Clear Print Paper Company

**I. TANK DESCRIPTION** COMPLETE ALL ITEMS -- SPECIFY IF UNKNOWN

A. OWNER'S TANK I. D. # <u>CAD982018772</u>	B. MANUFACTURED BY: <u>Unknown</u>
C. DATE INSTALLED (MO/DAY/YEAR) <u>79</u>	D. TANK CAPACITY IN GALLONS: <u>10,000</u>

**II. TANK CONTENTS** IF A-1 IS MARKED, COMPLETE ITEM C.

A. <input type="checkbox"/> 1 MOTOR VEHICLE FUEL	<input type="checkbox"/> 4 OIL	B. <input checked="" type="checkbox"/> 1 PRODUCT	C. <input type="checkbox"/> 1a REGULAR UNLEADED	<input type="checkbox"/> 3 DIESEL	<input type="checkbox"/> 6 AVIATION GAS
<input type="checkbox"/> 2 PETROLEUM	<input type="checkbox"/> 80 EMPTY	<input type="checkbox"/> 2 WASTE	<input type="checkbox"/> 1b PREMIUM UNLEADED	<input type="checkbox"/> 4 GASAHOL	<input type="checkbox"/> 7 METHANOL
<input checked="" type="checkbox"/> 3 CHEMICAL PRODUCT	<input type="checkbox"/> 95 UNKNOWN		<input type="checkbox"/> 2 LEADED	<input checked="" type="checkbox"/> 5 JET FUEL	
D. IF (A.1) IS NOT MARKED, ENTER NAME OF SUBSTANCE STORED <u>Mineral Oil</u>					C. A. S. #: <u>540-84-1</u>

**III. TANK CONSTRUCTION** MARK ONE ITEM ONLY IN BOXES A, B, AND C, AND ALL THAT APPLIES IN BOX D AND E

A. TYPE OF SYSTEM	<input type="checkbox"/> 1 DOUBLE WALL	<input type="checkbox"/> 3 SINGLE WALL WITH EXTERIOR LINER	<input type="checkbox"/> 95 UNKNOWN
	<input checked="" type="checkbox"/> 2 SINGLE WALL	<input type="checkbox"/> 4 SECONDARY CONTAINMENT (VAULTED TANK)	<input type="checkbox"/> 99 OTHER
B. TANK MATERIAL (Primary Tank)	<input checked="" type="checkbox"/> 1 BARE STEEL	<input type="checkbox"/> 2 STAINLESS STEEL	<input type="checkbox"/> 3 FIBERGLASS
	<input type="checkbox"/> 5 CONCRETE	<input type="checkbox"/> 6 POLYVINYL CHLORIDE	<input type="checkbox"/> 7 ALUMINUM
	<input type="checkbox"/> 9 BRONZE	<input type="checkbox"/> 10 GALVANIZED STEEL	<input type="checkbox"/> 95 UNKNOWN
C. INTERIOR LINING	<input type="checkbox"/> 1 RUBBER LINED	<input type="checkbox"/> 2 ALKYD LINING	<input type="checkbox"/> 3 EPOXY LINING
	<input type="checkbox"/> 5 GLASS LINING	<input checked="" type="checkbox"/> 6 UNLINED	<input type="checkbox"/> 95 UNKNOWN
	IS LINING MATERIAL COMPATIBLE WITH 100% METHANOL? YES ___ NO ___		
D. CORROSION PROTECTION	<input type="checkbox"/> 1 POLYETHYLENE WRAP	<input type="checkbox"/> 2 COATING	<input type="checkbox"/> 3 VINYL WRAP
	<input type="checkbox"/> 5 CATHODIC PROTECTION	<input type="checkbox"/> 91 NONE	<input checked="" type="checkbox"/> 95 UNKNOWN
E. SPILL AND OVERFILL	SPILL CONTAINMENT INSTALLED (YEAR) _____		OVERFILL PREVENTION EQUIPMENT INSTALLED (YEAR) _____

**IV. PIPING INFORMATION** CIRCLE A IF ABOVE GROUND OR U IF UNDERGROUND, BOTH IF APPLICABLE

A. SYSTEM TYPE	A <input checked="" type="checkbox"/> 1 SUCTION	A <input checked="" type="checkbox"/> U 2 PRESSURE	A <input type="checkbox"/> U 3 GRAVITY	A <input type="checkbox"/> U 99 OTHER
B. CONSTRUCTION	A <input checked="" type="checkbox"/> U 1 SINGLE WALL	A <input type="checkbox"/> U 2 DOUBLE WALL	A <input type="checkbox"/> U 3 LINED TRENCH	A <input type="checkbox"/> U 95 UNKNOWN
C. MATERIAL AND CORROSION PROTECTION	A <input checked="" type="checkbox"/> U 1 BARE STEEL	A <input type="checkbox"/> U 2 STAINLESS STEEL	A <input type="checkbox"/> U 3 POLYVINYL CHLORIDE (PVC)	A <input type="checkbox"/> U 4 FIBERGLASS PIPE
	A <input type="checkbox"/> U 5 ALUMINUM	A <input type="checkbox"/> U 6 CONCRETE	A <input type="checkbox"/> U 7 STEEL W/ COATING	A <input type="checkbox"/> U 8 100% METHANOL COMPATIBLE W/FRP
	A <input type="checkbox"/> U 9 GALVANIZED STEEL	A <input type="checkbox"/> U 10 CATHODIC PROTECTION	A <input type="checkbox"/> U 95 UNKNOWN	A <input type="checkbox"/> U 99 OTHER
D. LEAK DETECTION	<input type="checkbox"/> 1 AUTOMATIC LINE LEAK DETECTOR	<input checked="" type="checkbox"/> 2 LINE TIGHTNESS TESTING	<input type="checkbox"/> 3 INTERSTITIAL MONITORING	<input checked="" type="checkbox"/> 99 OTHER <u>None</u>

**V. TANK LEAK DETECTION**

<input type="checkbox"/> 1 VISUAL CHECK	<input type="checkbox"/> 2 INVENTORY RECONCILIATION	<input type="checkbox"/> 3 VADOZE MONITORING	<input type="checkbox"/> 4 AUTOMATIC TANK GAUGING	<input type="checkbox"/> 5 GROUND WATER MONITORING
<input checked="" type="checkbox"/> 6 TANK TESTING	<input type="checkbox"/> 7 INTERSTITIAL MONITORING	<input type="checkbox"/> 91 NONE	<input type="checkbox"/> 95 UNKNOWN	<input type="checkbox"/> 99 OTHER

**VI. TANK CLOSURE INFORMATION**

1. ESTIMATED DATE LAST USED (MO/DAY/YR) <u>8-1-94</u>	2. ESTIMATED QUANTITY OF SUBSTANCE REMAINING <u>5,000</u> GALLONS	3. WAS TANK FILLED WITH INERT MATERIAL? YES <input type="checkbox"/> NO <input checked="" type="checkbox"/>
--	---	---

THIS FORM HAS BEEN COMPLETED UNDER PENALTY OF PERJURY, AND TO THE BEST OF MY KNOWLEDGE, IS TRUE AND CORRECT

APPLICANT'S NAME (PRINTED & SIGNATURE) <u>E. J. Miller</u>	DATE <u>7-25-94</u>
---	------------------------

**LOCAL AGENCY USE ONLY** THE STATE I.D. NUMBER IS COMPOSED OF THE FOUR NUMBERS BELOW

STATE I.D.#	COUNTY # <u>01</u>	JURISDICTION # <u>000</u>	FACILITY # <u>019666</u>	TANK # <u>000003</u>
PERMIT NUMBER	PERMIT APPROVED BY/DATE	PERMIT EXPIRATION DATE		

THIS FORM MUST BE ACCOMPANIED BY A PERMIT APPLICATION - FORM A, UNLESS A CURRENT FORM A HAS BEEN FILED.  
FILE THIS FORM WITH THE LOCAL AGENCY IMPLEMENTING THE UNDERGROUND STORAGE TANK REGULATIONS

STATE OF CALIFORNIA  
STATE WATER RESOURCES CONTROL BOARD  
**UNDERGROUND STORAGE TANK PERMIT APPLICATION - FORM B**



COMPLETE A SEPARATE FORM FOR EACH TANK SYSTEM.

MARK ONLY ONE ITEM

<input type="checkbox"/> 1 NEW PERMIT	<input type="checkbox"/> 3 RENEWAL PERMIT	<input type="checkbox"/> 5 CHANGE OF INFORMATION	<input type="checkbox"/> 7 PERMANENTLY CLOSED ON SITE
<input type="checkbox"/> 2 INTERIM PERMIT	<input type="checkbox"/> 4 AMENDED PERMIT	<input type="checkbox"/> 6 TEMPORARY TANK CLOSURE	<input checked="" type="checkbox"/> 8 TANK REMOVED

DBA OR FACILITY NAME WHERE TANK IS INSTALLED: **Clear Print Paper Company**

**I. TANK DESCRIPTION** COMPLETE ALL ITEMS - SPECIFY IF UNKNOWN

A. OWNER'S TANK I.D.# <b>CAD982018772</b>	B. MANUFACTURED BY: <b>Unknown</b>
C. DATE INSTALLED (MO/DAY/YEAR) <b>79</b>	D. TANK CAPACITY IN GALLONS: <b>1,000</b>

**II. TANK CONTENTS** IF A-1 IS MARKED, COMPLETE ITEM C.

A. <input type="checkbox"/> 1 MOTOR VEHICLE FUEL	<input type="checkbox"/> 4 OIL	B. <input checked="" type="checkbox"/> 1 PRODUCT	C. <input type="checkbox"/> 1a REGULAR UNLEADED	<input type="checkbox"/> 3 DIESEL	<input type="checkbox"/> 6 AVIATION GAS
<input type="checkbox"/> 2 PETROLEUM	<input checked="" type="checkbox"/> 80 EMPTY	<input type="checkbox"/> 2 WASTE	<input type="checkbox"/> 1b PREMIUM UNLEADED	<input type="checkbox"/> 4 GASAHOL	<input type="checkbox"/> 7 METHANOL
<input type="checkbox"/> 3 CHEMICAL PRODUCT	<input type="checkbox"/> 95 UNKNOWN		<input type="checkbox"/> 2 LEADED	<input checked="" type="checkbox"/> 99 OTHER (DESCRIBE IN ITEM D. BELOW)	

D. IF (A.1) IS NOT MARKED, ENTER NAME OF SUBSTANCE STORED **Mineral Oil** C. A. S. #: **540-84-1**

**III. TANK CONSTRUCTION** MARK ONE ITEM ONLY IN BOXES A, B, AND C, AND ALL THAT APPLIES IN BOX D AND E

A. TYPE OF SYSTEM	<input type="checkbox"/> 1 DOUBLE WALL	<input type="checkbox"/> 3 SINGLE WALL WITH EXTERIOR LINER	<input type="checkbox"/> 95 UNKNOWN
	<input checked="" type="checkbox"/> 2 SINGLE WALL	<input type="checkbox"/> 4 SECONDARY CONTAINMENT (VAULTED TANK)	<input type="checkbox"/> 99 OTHER
B. TANK MATERIAL (Primary Tank)	<input checked="" type="checkbox"/> 1 BARE STEEL	<input type="checkbox"/> 2 STAINLESS STEEL	<input type="checkbox"/> 3 FIBERGLASS
	<input type="checkbox"/> 5 CONCRETE	<input type="checkbox"/> 6 POLYVINYL CHLORIDE	<input type="checkbox"/> 7 ALUMINUM
	<input type="checkbox"/> 9 BRONZE	<input type="checkbox"/> 10 GALVANIZED STEEL	<input type="checkbox"/> 95 UNKNOWN
C. INTERIOR LINING	<input type="checkbox"/> 1 RUBBER LINED	<input type="checkbox"/> 2 ALKYD LINING	<input type="checkbox"/> 3 EPOXY LINING
	<input type="checkbox"/> 5 GLASS LINING	<input checked="" type="checkbox"/> 6 UNLINED	<input type="checkbox"/> 4 PHENOLIC LINING
	IS LINING MATERIAL COMPATIBLE WITH 100% METHANOL? YES ___ NO ___		
D. CORROSION PROTECTION	<input type="checkbox"/> 1 POLYETHYLENE WRAP	<input type="checkbox"/> 2 COATING	<input type="checkbox"/> 3 VINYL WRAP
	<input type="checkbox"/> 5 CATHODIC PROTECTION	<input type="checkbox"/> 91 NONE	<input checked="" type="checkbox"/> 95 UNKNOWN
			<input type="checkbox"/> 4 FIBERGLASS REINFORCED PLASTIC
			<input type="checkbox"/> 99 OTHER
E. SPILL AND OVERFILL	SPILL CONTAINMENT INSTALLED (YEAR) _____		OVERFILL PREVENTION EQUIPMENT INSTALLED (YEAR) _____

**IV. PIPING INFORMATION** CIRCLE A IF ABOVE GROUND OR U IF UNDERGROUND, BOTH IF APPLICABLE

A. SYSTEM TYPE	A <input checked="" type="checkbox"/> 1 SUCTION	<input checked="" type="checkbox"/> 2 PRESSURE	A U <input type="checkbox"/> 3 GRAVITY	A U <input type="checkbox"/> 99 OTHER
B. CONSTRUCTION	<input checked="" type="checkbox"/> 1 SINGLE WALL	A U <input type="checkbox"/> 2 DOUBLE WALL	A U <input type="checkbox"/> 3 LINED TRENCH	A U <input type="checkbox"/> 95 UNKNOWN
C. MATERIAL AND CORROSION PROTECTION	<input checked="" type="checkbox"/> 1 BARE STEEL	A U <input type="checkbox"/> 2 STAINLESS STEEL	A U <input type="checkbox"/> 3 POLYVINYL CHLORIDE (PVC)	A U <input type="checkbox"/> 4 FIBERGLASS PIPE
	A U <input type="checkbox"/> 5 ALUMINUM	A U <input type="checkbox"/> 6 CONCRETE	A U <input type="checkbox"/> 7 STEEL W/ COATING	A U <input type="checkbox"/> 8 100% METHANOL COMPATIBLE W/FRP
	A U <input type="checkbox"/> 9 GALVANIZED STEEL	A U <input type="checkbox"/> 10 CATHODIC PROTECTION	A U <input type="checkbox"/> 95 UNKNOWN	A U <input type="checkbox"/> 99 OTHER
D. LEAK DETECTION	<input type="checkbox"/> 1 AUTOMATIC LINE LEAK DETECTOR	<input checked="" type="checkbox"/> 2 LINE TIGHTNESS TESTING	<input type="checkbox"/> 3 INTERSTITIAL MONITORING	<input type="checkbox"/> 99 OTHER

**V. TANK LEAK DETECTION**

<input type="checkbox"/> 1 VISUAL CHECK	<input type="checkbox"/> 2 INVENTORY RECONCILIATION	<input type="checkbox"/> 3 VADOZE MONITORING	<input type="checkbox"/> 4 AUTOMATIC TANK GAUGING	<input type="checkbox"/> 5 GROUND WATER MONITORING
<input checked="" type="checkbox"/> 6 TANK TESTING	<input type="checkbox"/> 7 INTERSTITIAL MONITORING	<input type="checkbox"/> 91 NONE	<input type="checkbox"/> 95 UNKNOWN	<input type="checkbox"/> 99 OTHER

**VI. TANK CLOSURE INFORMATION**

1. ESTIMATED DATE LAST USED (MO/DAY/YR) <b>8-1-94</b>	2. ESTIMATED QUANTITY OF SUBSTANCE REMAINING <b>0</b> GALLONS	3. WAS TANK FILLED WITH INERT MATERIAL? YES <input type="checkbox"/> NO <input checked="" type="checkbox"/>
--	--	---

THIS FORM HAS BEEN COMPLETED UNDER PENALTY OF PERJURY, AND TO THE BEST OF MY KNOWLEDGE, IS TRUE AND CORRECT

APPLICANT'S NAME (PRINTED & SIGNATURE) <i>Carl V. Wilson</i>	DATE <b>7-25-94</b>
---	------------------------

LOCAL AGENCY USE ONLY THE STATE I.D. NUMBER IS COMPOSED OF THE FOUR NUMBERS BELOW

STATE I.D.#	COUNTY #	JURISDICTION #	FACILITY #	TANK #
	<b>01</b>	<b>000</b>	<b>019666</b>	<b>000004</b>
PERMIT NUMBER	PERMIT APPROVED BY/DATE		PERMIT EXPIRATION DATE	

THIS FORM MUST BE ACCOMPANIED BY A PERMIT APPLICATION - FORM A, UNLESS A CURRENT FORM A HAS BEEN FILED.  
FILE THIS FORM WITH THE LOCAL AGENCY IMPLEMENTING THE UNDERGROUND STORAGE TANK REGULATIONS

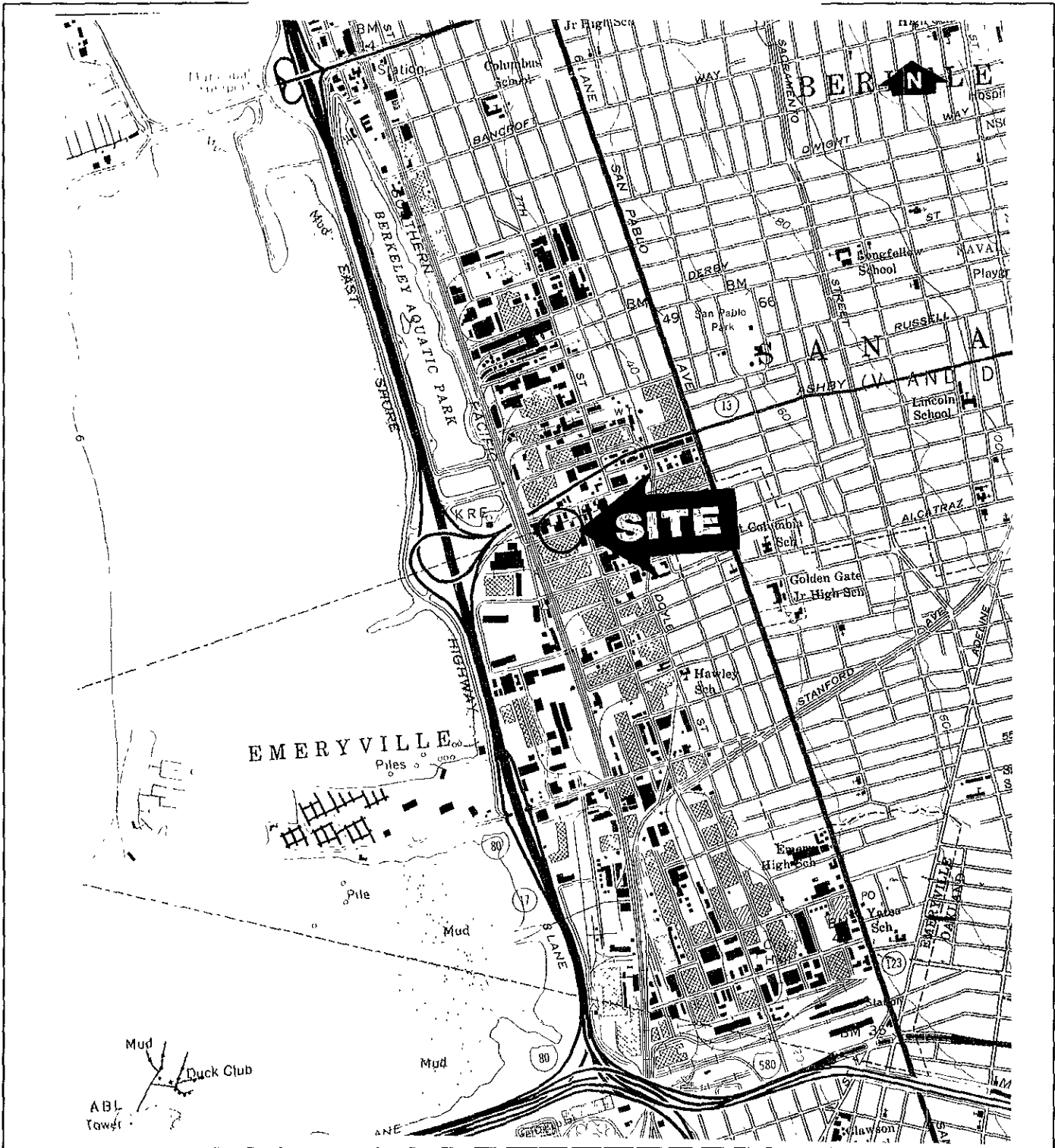

Reference

Emeryville, California  
 Oakland West Quadrangle  
 Photorevised 1959. Scale 1:24,000

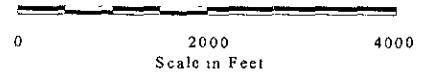

ENVIRONMENTAL STRATEGIES CORPORATION  
 226 Airport Parkway, Suite 630  
 San Jose, California 95110  
 408 453.6100

Figure 1  
 Site Location  
 Clearprint Paper Company  
 Emeryville, California



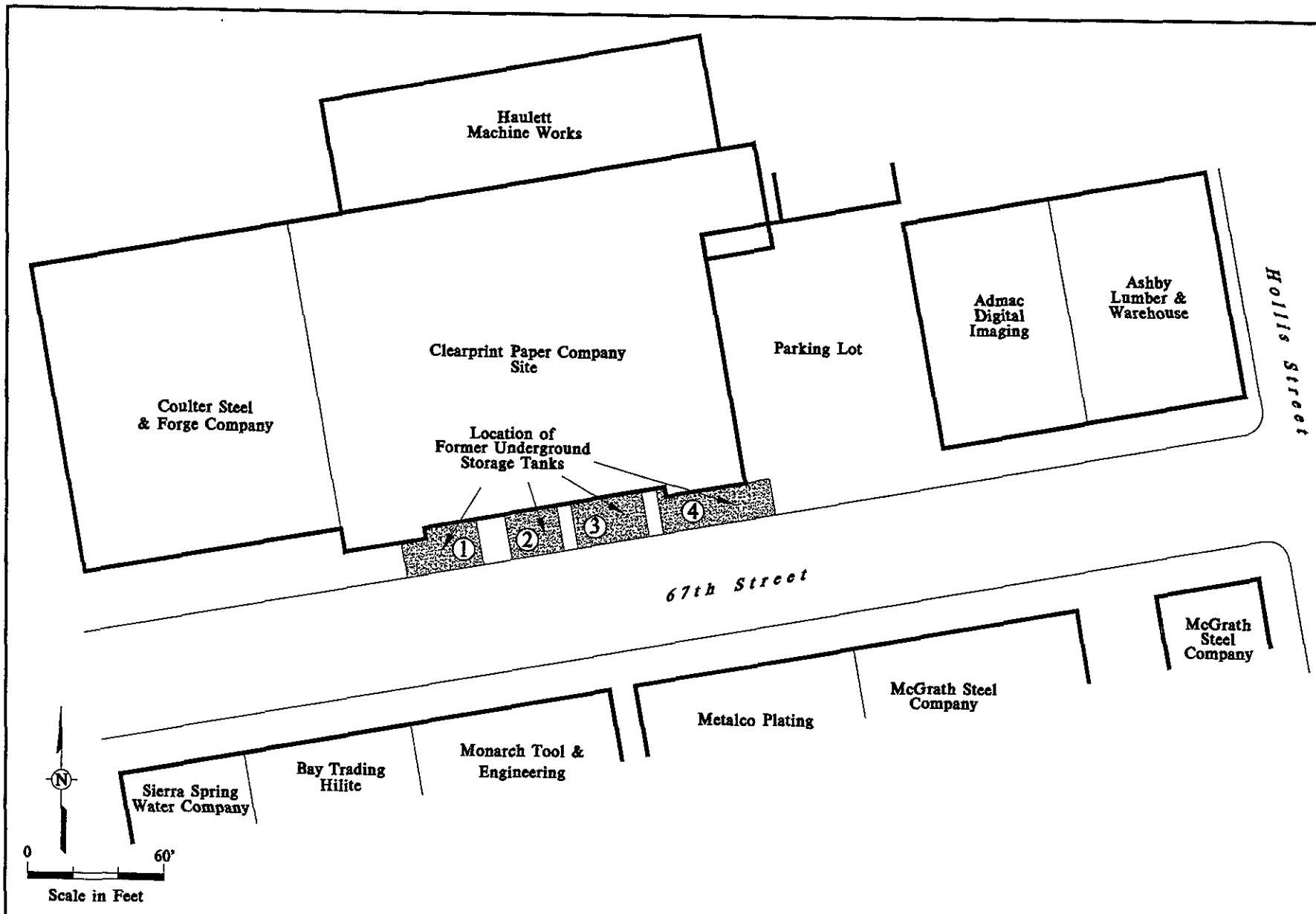

**ENVIRONMENTAL STRATEGIES CORPORATION**  
 226 Airport Parkway Suite 630  
 San Jose, California 95110  
 408-453-6100

Figure 2  
 Site Layout  
 Clearprint Paper Company  
 Emeryville, California

CLEAR009.DWG