

4th Quarter 1996 Monitoring Results
Chevron Station 9-4587
609 Oak Street, Oakland

Blaine Tech Services, Inc.

BLAINE
TECH SERVICES INC.

1680 ROGERS AVENUE
SAN JOSE, CALIFORNIA 95112
(408) 573-7771 FAX
(408) 573-0555 PHONE



January 21, 1997

Phil Briggs
Chevron U.S.A. Products Company
P.O. Box 6004
San Ramon, CA 94583-0904

4th Quarter 1996 Monitoring at 9-4587

Fourth Quarter 1996 Groundwater Monitoring at
Chevron Service Station Number 9-4587
609 Oak Street
Oakland, CA

Monitoring Performed on December 19, 1996

Groundwater Sampling Report 961219-S-2

This report covers the routine quarterly monitoring of groundwater wells at this Chevron facility. Blaine Tech Services, Inc.'s work at the site includes inspection, gauging, evacuation, purgewater containment, sample collection and sample handling in accordance with standard procedures that conform to Regional Water Quality Control Board requirements.

Routine field data collection includes depth to water, total well depth, thickness of any separate immiscible layer, water column volume, calculated volume of a three-case volume purge, elapsed evacuation time, total volume of water removed, and standard water parameter instrument readings. Sample material is collected, contained, stored, and transported to the laboratory in conformance with EPA standards. Purgewater is, likewise, collected and transported to McKittrick Waste Treatment Site for disposal.

Basic field information is presented alongside analytical values excerpted from the laboratory report in the cumulative table of **WELL DATA AND ANALYTICAL RESULTS**. The full analytical report for the most recent samples is located in the **Analytical Appendix**. The table also contains new groundwater elevation calculations taken from the computer plotted gradient map which is located in the **Professional Engineering Appendix**.

also contains new groundwater elevation calculations taken from the computer plotted gradient map which is located in the **Professional Engineering Appendix**.

At a minimum, Blaine Tech Services, Inc. field personnel are certified upon completion of a forty-hour Hazardous Materials and Emergency Response training course per 29 CFR 1910.120. Field personnel are also enrolled in annual eight hour refresher courses.

Blaine Tech Services, Inc. conducts sampling and documentation assignments of this type as an independent third party. In order to avoid compromising the objectivity necessary for the proper and disinterested performance of this work, Blaine Tech Services, Inc. concentrates on objective data collection and does not participate in the interpretation of analytical results, the definition of geological or hydrological conditions, the formulation of recommendations, or the marketing of remedial systems.

Please call if you have any questions.

Yours truly,

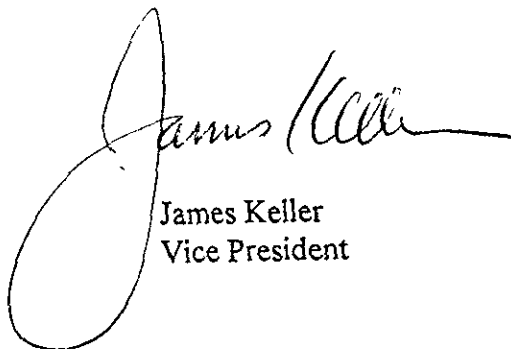
A handwritten signature in black ink that reads "James Keller". The signature is written in a cursive style with a large, looping initial "J".

James Keller
Vice President

JPK/cg

attachments: Professional Engineering Appendix
Cumulative Table of Well Data and Analytical Results
Analytical Appendix
Field Data Sheets

Professional Engineering Appendix



SCALE (ft)

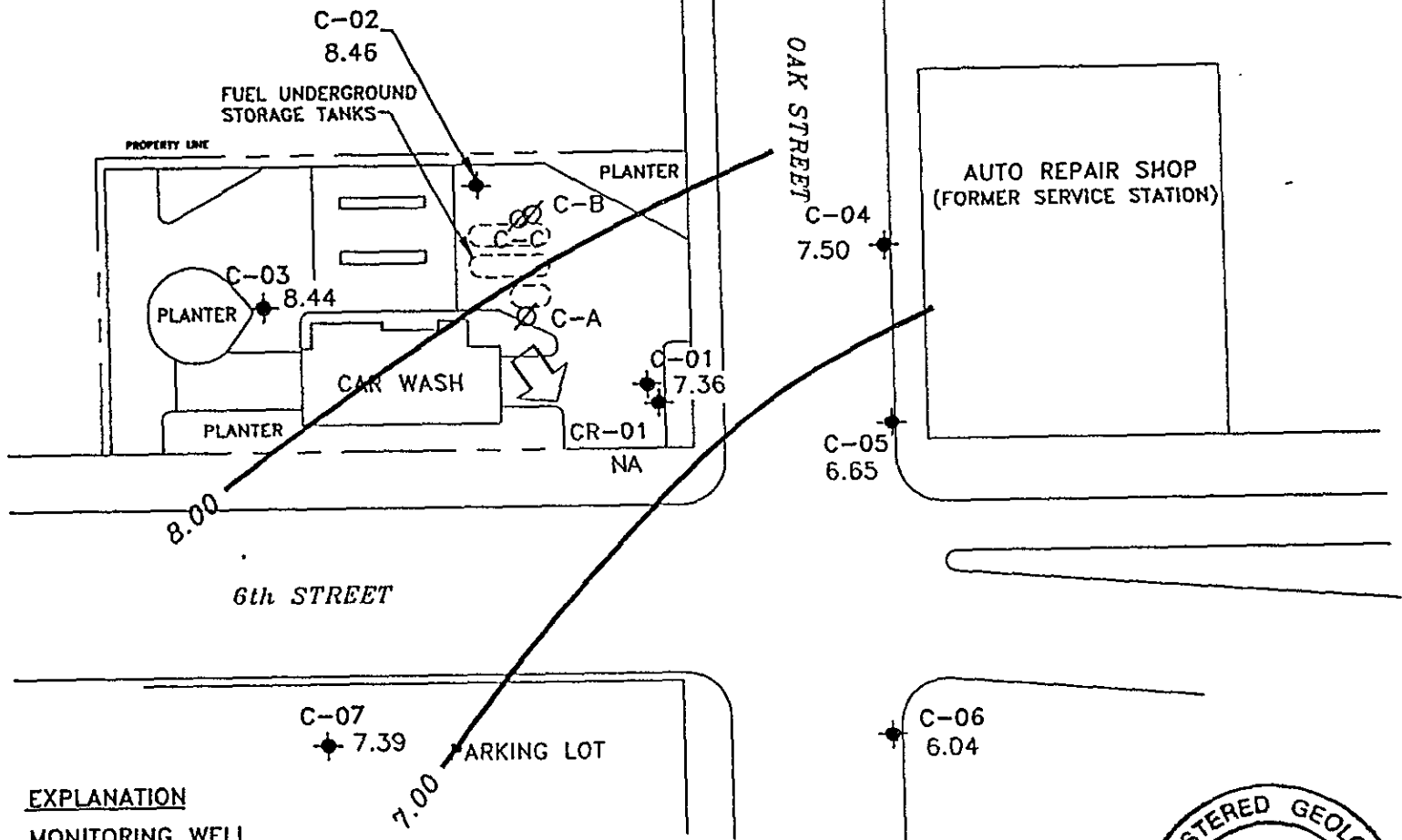

EXPLANATION



MONITORING WELL



DESTROYED WELL

6.04

GROUNDWATER ELEVATION (FT, MSL)

7.00

GROUNDWATER ELEVATION CONTOUR (FT, MSL)

NA

DATA NOT AVAILABLE



APPROXIMATE GROUNDWATER FLOW DIRECTION;
APPROXIMATE GRADIENT = 0.02

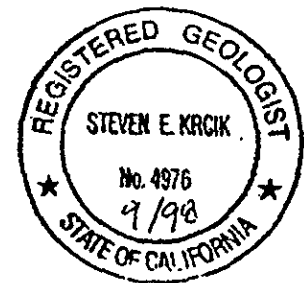

Base map from Cambria Environmental Technology, Inc.

PREPARED BY

RRM

Chevron Station 9-4587
609 Oak Street
Oakland, California

GROUNDWATER ELEVATION
CONTOUR MAP, DECEMBER 19, 1996

FIGURE:

1

PROJECT:

DAC04

Table of Well Data and Analytical Results

Cumulative Table of Well Data and Analytical Results

Vertical Measurements are in feet.			Volumetric Measurements are in gallons.				Analytical results are in parts per billion (ppb)						
DATE	Well Head Elev.	Ground Water Elev.	Depth To Water	SPH Thickness	SPH Removed	Total SPH Removed	Notes	TPH-Gasoline	Benzene	Toluene	Ethyl-Benzene	Xylene	MTBE
C-A													
12/06/89	--	--	--	--	--	--	--	44,000	20,000	66	1600	2220	--
10/30/90	--	--	11.20	--	--	--	Sheen	31,000	23,000	110	1100	160	--
10/30/90	--	--	11.20	--	--	--	Sheen	30,000	23,000	150	1000	180	--
01/14/91	--	--	11.25	--	--	--	--	12,000	30,000	540	1400	560	--
04/03/91	--	--	9.82	--	--	--	--	59,000	33,000	2400	2200	3100	--
07/17/91	--	--	10.93	--	--	--	--	52,000	38,000	380	1300	500	--
10/07/91	--	--	--	--	--	--	--	--	--	--	--	--	--
06/25/92	--	--	--	--	--	--	--	--	--	--	--	--	--
09/17/92	--	--	--	--	--	--	--	--	--	--	--	--	--
12/16/92	--	--	--	--	--	--	--	--	--	--	--	--	--
03/18/93	--	--	--	--	--	--	--	--	--	--	--	--	--
06/11/93	--	--	--	--	--	--	--	--	--	--	--	--	--
09/08/93	--	--	--	--	--	--	--	--	--	--	--	--	--
09/17/93	--	--	10.02	--	--	--	--	--	--	--	--	--	--
12/23/93	--	--	--	--	--	--	--	--	--	--	--	--	--
03/07/94	--	--	--	--	--	--	--	--	--	--	--	--	--
06/17/94	--	--	10.05	--	--	--	--	77,000	32,000	3600	3200	14,000	--
09/12/94	--	--	11.75	--	--	--	--	270	170	1.0	13	24	--
06/29/95	--	--	--	--	--	--	Destroyed	--	--	--	--	--	--

Cumulative Table of Well Data and Analytical Results

Vertical Measurements are in feet.			Volumetric Measurements are in gallons.				Analytical results are in parts per billion (ppb)						
DATE	Well Head Elev.	Ground Water Elev.	Depth To Water	SPH Thickness	SPH Removed	Total SPH Removed	Notes	TPH-Gasoline	Benzene	Toluene	Ethyl-Benzene	Xylene	MTBE
C-B													
12/06/89	--	--	--	0.01	--	--	--	--	--	--	--	--	--
10/30/90	--	--	11.19	0.01	--	--	--	--	--	--	--	--	--
01/14/91	--	--	11.40	0.01	--	--	--	--	--	--	--	--	--
04/03/91	--	--	9.55	1.00	--	--	--	--	--	--	--	--	--
04/04/91	--	--	10.54	1.06	--	--	--	--	--	--	--	--	--
07/17/91	--	--	10.84	0.03	--	--	--	--	--	--	--	--	--
10/07/91	--	--	11.10	0.04	--	--	--	--	--	--	--	--	--
02/04/92	--	--	10.78	0.01	--	--	--	--	--	--	--	--	--
03/06/92	--	--	--	--	--	--	--	--	--	--	--	--	--
04/01/92	--	--	10.33	1.02	--	--	--	--	--	--	--	--	--
06/25/92	--	--	11.20	0.68	--	--	--	--	--	--	--	--	--
09/17/92	--	--	11.07	0.13	--	--	--	--	--	--	--	--	--
12/16/92	--	--	10.41	0.38	--	--	--	--	--	--	--	--	--
03/18/93	--	--	9.19	0.05	--	--	--	--	--	--	--	--	--
06/11/93	--	--	9.54	0.70	--	--	--	--	--	--	--	--	--
09/08/93	--	--	--	--	--	--	--	--	--	--	--	--	--
09/17/93	--	--	9.85	0.52	--	--	--	--	--	--	--	--	--
12/23/93	--	--	9.37	0.20	--	--	--	--	--	--	--	--	--
03/07/94	--	--	9.24	0.85	--	--	--	--	--	--	--	--	--
06/17/94	--	--	9.38	0.02	--	--	--	--	--	--	--	--	--
09/12/94	--	--	11.13	0.49	--	--	--	--	--	--	--	--	--
06/29/95	--	--	--	--	--	--	Destroyed	--	--	--	--	--	--

Cumulative Table of Well Data and Analytical Results

Vertical Measurements are in feet.			Volumetric Measurements are in gallons.				Analytical results are in parts per billion (ppb)						
DATE	Well Head Elev.	Ground Water Elev.	Depth To Water	SPH Thickness	SPH Removed	Total SPH Removed	Notes	TPH-Gasoline	Benzene	Toluene	Ethyl-Benzene	Xylene	MTBE
C-C													
12/06/89	--	--	--	0.15	--	--	--	--	--	--	--	--	--
10/30/90	--	--	10.84	0.03	--	--	--	--	--	--	--	--	--
01/14/91	--	--	11.01	0.11	--	--	--	--	--	--	--	--	--
04/03/91	--	--	9.19	0.02	--	--	--	--	--	--	--	--	--
07/17/91	--	--	10.53	0.03	--	--	--	--	--	--	--	--	--
10/07/91	--	--	10.98	0.08	--	--	--	--	--	--	--	--	--
02/04/92	--	--	10.45	0.09	--	--	--	--	--	--	--	--	--
03/06/92	--	--	8.83	0.09	--	--	--	--	--	--	--	--	--
04/01/92	--	--	9.23	0.16	--	--	--	--	--	--	--	--	--
06/25/92	--	--	10.40	0.12	--	--	--	--	--	--	--	--	--
09/17/92	--	--	10.84	0.12	--	--	--	--	--	--	--	--	--
12/16/92	--	--	10.02	0.12	--	--	--	--	--	--	--	--	--
03/18/93	--	--	8.70	0.15	--	--	--	--	--	--	--	--	--
06/11/93	--	--	9.25	0.13	--	--	--	--	--	--	--	--	--
09/08/93	--	--	--	--	--	--	--	--	--	--	--	--	--
09/17/93	--	--	9.83	--	--	--	Sheen	--	--	--	--	--	--
12/23/93	--	--	9.66	0.07	--	--	--	--	--	--	--	--	--
03/07/94	--	--	8.93	0.28	--	--	--	--	--	--	--	--	--
06/17/94	--	--	10.13	0.03	--	--	--	--	--	--	--	--	--
09/12/94	--	--	11.20	0.13	--	--	--	--	--	--	--	--	--
06/29/95	--	--	--	--	--	--	Destroyed	--	--	--	--	--	--

Cumulative Table of Well Data and Analytical Results

Vertical Measurements are in feet.				Volumetric Measurements are in gallons.			Analytical results are in parts per billion (ppb)						
DATE	Well Head Elev.	Ground Water Elev.	Depth To Water	SPH Thickness	SPH Removed	Total SPH Removed	Notes	TPH-Gasoline	Benzene	Toluene	Ethyl-Benzene	Xylene	MTBE
C-1													
12/06/89	16.07	--	--	0.20	--	--	--	--	--	--	--	--	--
10/30/90	16.07	5.30	10.79	0.02	--	--	--	--	--	--	--	--	--
01/14/91	16.07	4.70	11.39	0.02	--	--	--	--	--	--	--	--	--
04/03/91	16.07	6.66	9.43	0.02	--	--	--	--	--	--	--	--	--
07/17/91	16.07	5.64	10.46	0.04	--	--	--	--	--	--	--	--	--
10/07/91	16.07	5.36	10.74	0.04	--	--	--	--	--	--	--	--	--
02/04/92	16.07	5.71	10.37	0.01	--	--	--	--	--	--	--	--	--
03/06/92	16.07	6.87	9.20	--	--	--	--	--	--	--	--	--	--
04/01/92	16.07	6.79	9.28	--	--	--	--	--	--	--	--	--	--
06/25/92	16.07	6.10	9.98	0.01	--	--	--	100,000	8800	7000	2800	19,000	--
09/17/92	16.07	5.56	10.51	--	--	--	Sheen	--	--	--	--	--	--
12/16/92	16.07	6.26	9.81	--	--	--	Sheen	--	--	--	--	--	--
03/18/93	16.07	7.19	8.88	--	--	--	Sheen	--	--	--	--	--	--
06/11/93	16.07	6.78	9.31	0.02	--	--	--	--	--	--	--	--	--
09/08/93	16.07	--	--	--	--	--	--	--	--	--	--	--	--
09/17/93	16.07	6.37	9.72	0.02	--	--	--	--	--	--	--	--	--
12/23/93	16.07	6.58	9.49	--	--	--	--	41,000	5400	590	710	5600	--
03/07/94	16.07	7.32	8.96	0.26	--	--	--	--	--	--	--	--	--
06/17/94	16.07	6.39	9.70	0.02	--	--	--	--	--	--	--	--	--
09/12/94	16.07	3.66	12.42	0.01	--	--	--	--	--	--	--	--	--
06/29/95	16.07	7.29	8.78	--	--	--	--	220,000	11,000	3600	3500	19,000	--
09/13/95	16.07	6.54	9.56	0.04	0.21	0.21	--	14,000	180	81	240	2200	440
12/19/95	16.07	6.76	9.31	--	--	0.21	--	790	22	5.3	21	96	<12
03/26/96	16.07	7.14	8.93	--	--	0.21	--	--	--	--	--	--	--
06/10/96	16.07	7.84	8.23	--	--	0.21	Insufficient water	--	--	--	--	--	--
09/13/96	16.07	6.55	9.52	--	--	0.21	--	110	0.85	<0.5	0.95	1.9	3.6
12/19/96	16.07	7.36	8.71	--	--	0.21	--	51	<0.5	<0.5	0.69	1.3	<2.5

Cumulative Table of Well Data and Analytical Results

Vertical Measurements are in feet.			Volumetric Measurements are in gallons.				Analytical results are in parts per billion (ppb)						
DATE	Well Head Elev.	Ground Water Elev.	Depth To Water	SPH Thickness	SPH Removed	Total SPH Removed	Notes	TPH-Gasoline	Benzene	Toluene	Ethyl-Benzene	Xylene	MTBE
C-2													
12/06/89	16.84	--	--	--	--	--	--	16,000	250	1200	550	1400	--
10/30/90	16.84	5.68	11.16	--	--	--	--	28,000	3700	1900	1200	4300	--
01/14/91	16.84	5.73	11.11	--	--	--	--	24,000	3300	1200	1100	4100	--
01/14/91	16.84	5.73	11.11	--	--	--	--	30,000	3900	1500	1500	5000	--
04/03/91	16.84	7.31	9.53	--	--	--	--	12,000	1100	840	650	1800	--
04/03/91	16.84	7.31	9.53	--	--	--	--	14,000	1100	990	680	1800	--
07/17/91	16.84	6.16	10.68	--	--	--	--	13,000	1700	560	650	1700	--
07/17/91	16.84	6.16	10.68	--	--	--	--	14,000	1700	640	720	1900	--
10/07/91	16.84	5.82	11.02	--	--	--	--	25,000	3700	1300	1400	3800	--
02/04/92	16.84	6.24	10.60	--	--	--	--	16,000	2600	300	880	1900	--
04/01/92	16.84	7.54	9.30	--	--	--	--	15,000	1900	300	700	1500	--
06/25/92	16.84	6.39	10.45	--	--	--	--	23,000	3400	740	1300	3400	--
09/17/92	16.84	6.06	10.78	--	--	--	--	18,000	3500	550	1400	3900	--
12/16/92	16.84	6.90	9.94	--	--	--	--	12,000	1200	120	460	1100	--
03/18/93	16.84	8.04	8.80	--	--	--	--	5200	990	130	290	430	--
06/11/93	16.84	7.41	9.43	--	--	--	--	34,000	8200	910	2400	6600	--
09/08/93	16.84	--	--	--	--	--	--	3400	690	26	190	330	--
09/17/93	16.84	6.93	9.91	--	--	--	--	--	--	--	--	--	--
12/23/93	16.84	7.15	9.69	--	--	--	--	2500	830	26	130	260	--
03/07/94	16.84	7.87	8.97	--	--	--	--	1100	420	6.5	110	69	--
06/17/94	16.84	6.98	9.86	--	--	--	--	1400	290	8.6	60	63	--
09/12/94	16.84	5.74	11.10	--	--	--	--	370	96	1.3	9.4	16	--
06/29/95	16.84	7.84	9.00	--	--	--	--	4100	400	96	250	500	--
09/13/95	16.84	7.10	9.74	--	--	--	--	3500	200	50	57	290	--
12/19/95	16.84	7.74	9.10	--	--	--	--	<50	<0.5	<0.5	<0.5	<0.5	<2.5
03/26/96	16.84	9.46	7.38	--	--	--	Insufficient water	--	--	--	--	--	--
06/10/96	16.84	9.00	7.84	--	--	--	Insufficient water	--	--	--	--	--	--
09/13/96	16.84	8.44	8.40	--	--	--	--	<50	<0.5	<0.5	<0.5	<0.5	<2.5
12/19/96	16.84	8.46	8.38	--	--	--	--	<50	<0.5	<0.5	<0.5	<0.5	<2.5

3500
3/4 200

20

Cumulative Table of Well Data and Analytical Results

Vertical Measurements are in feet.			Volumetric Measurements are in gallons.				Analytical results are in parts per billion (ppb)						
DATE	Well Head Elev.	Ground Water Elev.	Depth To Water	SPH Thickness	SPH Removed	Total SPH Removed	Notes	TPH-Gasoline	Benzene	Toluene	Ethyl-Benzene	Xylene	MTBE
C-3													
12/06/89	16.48	--	--	--	--	--	--	<500	<0.5	<0.5	<0.5	0.74	--
10/30/90	16.48	6.04	10.44	--	--	--	--	410	4.0	4.0	2.0	9.0	--
01/14/91	16.48	6.14	10.34	--	--	--	--	80	<0.5	<0.5	<0.5	1.0	--
04/03/91	16.48	7.47	9.01	--	--	--	--	53	<0.5	<0.5	<0.5	2.0	--
07/17/91	16.48	6.48	10.00	--	--	--	--	<50	5.9	<0.5	<0.5	<0.5	--
10/07/91	16.48	6.10	10.38	--	--	--	--	<50	<0.5	<0.5	<0.5	<0.5	--
02/04/92	16.48	6.48	10.00	--	--	--	--	<50	<0.5	<0.5	<0.5	<0.5	--
04/01/92	16.48	7.65	8.83	--	--	--	--	<50	<0.5	<0.5	<0.5	<0.5	--
06/25/92	16.48	6.63	9.85	--	--	--	--	<50	<0.5	<0.5	<0.5	<0.5	--
09/17/92	16.48	6.28	10.20	--	--	--	--	<50	<0.5	<0.5	<0.5	<0.5	--
12/16/92	16.48	7.08	9.40	--	--	--	--	<50	<0.5	<0.5	<0.5	<1.5	--
03/18/93	16.48	8.36	8.12	--	--	--	--	<50	<0.5	<0.5	<0.5	<0.5	--
06/11/93	16.48	7.89	8.59	--	--	--	--	<50	<0.5	<0.5	<0.5	<1.5	--
09/08/93	16.48	--	--	--	--	--	--	<50	<0.5	<0.5	<0.5	<1.5	--
09/17/93	16.48	7.48	9.00	--	--	--	--	--	--	--	--	--	--
12/23/93	16.48	7.65	8.83	--	--	--	--	<50	<0.5	0.8	<0.5	2.9	--
03/07/94	16.48	8.29	8.19	--	--	--	--	<50	<0.5	<0.5	<0.5	<0.5	--
06/17/94	16.48	7.43	9.05	--	--	--	--	<50	<0.5	<0.5	<0.5	<0.5	--
09/12/94	16.48	--	--	--	--	--	Inaccessible	--	--	--	--	--	--
06/29/95	16.48	8.18	8.30	--	--	--	--	<50	<0.5	<0.5	<0.5	<0.5	--
09/13/95	16.48	7.64	8.84	--	--	--	--	<50	<0.5	<0.5	<0.5	<0.5	--
12/19/95	16.48	8.02	8.46	--	--	--	--	<50	<0.5	<0.5	<0.5	<0.5	<2.5
03/26/96	16.48	9.01	7.47	--	--	--	--	<50	<0.5	<0.5	<0.5	<0.5	<2.5
06/10/96	16.48	8.23	8.25	--	--	--	--	<50	<0.5	<0.5	<0.5	<0.5	<2.5
09/13/96	16.48	7.46	9.02	--	--	--	Sampled annually	--	--	--	--	--	--
12/19/96	16.48	8.44	8.04	--	--	--	--	--	--	--	--	--	--

Cumulative Table of Well Data and Analytical Results

Vertical Measurements are in feet.				Volumetric Measurements are in gallons.			Analytical results are in parts per billion (ppb)						
DATE	Well Head Elev.	Ground Water Elev.	Depth To Water	SPH Thickness	SPH Removed	Total SPH Removed	Notes	TPH-Gasoline	Benzene	Toluene	Ethyl-Benzene	Xylene	MTBE
C-4													
12/06/89	16.53	--	--	--	--	--	--	--	--	--	--	--	--
10/30/90	16.53	4.97	11.56	--	--	--	--	<50	<0.5	<0.5	<0.5	<0.5	--
01/14/91	16.53	5.09	11.44	--	--	--	--	<50	<0.5	<0.5	<0.5	<0.5	--
04/03/91	16.53	6.53	10.00	--	--	--	--	150	3.0	<0.5	12	9.0	--
07/17/91	16.53	5.37	11.16	--	--	--	--	290	2.3	0.4	52	0.4	--
10/07/91	16.53	5.14	11.39	--	--	--	--	<50	<0.5	<0.5	4.6	<0.5	--
02/04/92	16.53	5.51	11.02	--	--	--	--	<50	<0.5	<0.5	2.8	<0.5	--
02/04/92	16.53	5.51	11.02	--	--	--	--	<50	<0.5	<0.5	2.5	0.5	--
04/01/92	16.53	6.70	9.83	--	--	--	--	480	4.9	<0.5	64	4.3	--
06/25/92	16.53	5.65	10.88	--	--	--	--	<50	<0.5	<0.5	<0.5	<0.5	--
09/17/92	16.53	5.29	11.24	--	--	--	--	<50	<0.5	<0.5	<0.5	<0.5	--
12/16/92	16.53	6.13	10.40	--	--	--	--	56	<0.5	<0.5	1.0	<0.5	--
03/18/93	16.53	7.05	9.48	--	--	--	--	<50	<0.5	<0.5	<0.5	<1.5	--
06/11/93	16.53	6.92	9.61	--	--	--	--	<50	<0.5	<0.5	<0.5	<1.5	--
09/08/93	16.53	--	--	--	--	--	--	<50	<0.5	<0.5	<0.5	<1.5	--
09/17/93	16.53	6.46	10.07	--	--	--	--	--	--	--	--	--	--
12/23/93	16.53	6.70	9.83	--	--	--	--	<50	1.2	1.5	<0.5	3.2	--
03/07/94	16.53	7.33	9.20	--	--	--	--	60	0.7	1.1	6.7	1.8	--
06/17/94	16.53	6.56	9.97	--	--	--	--	<50	<0.5	<0.5	<0.5	<0.5	--
09/12/94	16.53	5.32	11.21	--	--	--	--	<50	<0.5	<0.5	<0.5	<0.5	--
06/29/95	16.53	7.18	9.35	--	--	--	--	<50	<0.5	<0.5	1.4	<0.5	--
09/13/95	16.53	6.60	9.93	--	--	--	--	<50	<0.5	<0.5	<0.5	<0.5	--
12/19/95	16.53	6.98	9.55	--	--	--	--	<50	<0.5	<0.5	<0.5	<0.5	<2.5
03/26/96	16.53	7.99	8.54	--	--	--	--	<50	<0.5	<0.5	<0.5	<0.5	<2.5
06/10/96	16.53	7.23	9.30	--	--	--	--	<50	<0.5	<0.5	<0.5	<0.5	4.1
09/13/96	16.53	6.71	9.82	--	--	--	Sampled annually	--	--	--	--	--	--
12/19/96	16.53	7.50	9.03	--	--	--	--	--	--	--	--	--	--

Cumulative Table of Well Data and Analytical Results

Vertical Measurements are in feet.

Volumetric Measurements are in gallons.

Analytical results are in parts per billion (ppb)

DATE	Well Head Elev.	Ground Water Elev.	Depth To Water	SPH Thickness	SPH Removed	Total SPH Removed	Notes	TPH- Gasoline	Benzene	Toluene	Ethyl- Benzene	Xylene	MTBE
C-5													
12/06/89	14.70	4.73	9.97	--	--	--	--	--	--	--	--	--	--
10/30/90	14.70	--	--	--	--	--	--	<50	0.8	<0.5	<0.5	0.5	--
01/14/91	14.70	4.83	9.87	--	--	--	--	54	<0.5	<0.5	<0.5	<0.5	--
04/03/91	14.70	5.98	8.72	--	--	--	--	1800	330	200	52	170	--
07/17/91	14.70	5.07	9.63	--	--	--	--	170	120	5.3	12	20	--
10/07/91	14.70	4.87	9.83	--	--	--	--	<50	1.1	<0.5	<0.5	<0.5	--
02/04/92	14.70	5.17	9.53	--	--	--	--	91	16	<0.5	2.4	2.0	--
04/01/92	14.70	6.13	8.57	--	--	--	--	960	200	5.4	21	33	--
06/25/92	14.70	5.26	9.44	--	--	--	--	800	2.5	<0.5	1.3	7.3	--
09/17/92	14.70	4.98	9.72	--	--	--	--	<50	<0.5	<0.5	<0.5	<0.5	--
12/16/92	14.70	5.63	9.07	--	--	--	--	81	5.4	1.2	1.5	4.3	--
03/18/93	14.70	6.26	8.44	--	--	--	--	<50	<0.5	<0.5	<0.5	<1.5	--
06/11/93	14.70	6.17	8.53	--	--	--	--	<50	1.6	<0.5	<0.5	<1.5	--
09/08/93	14.70	--	--	--	--	--	--	<50	<0.5	<0.5	<0.5	<1.5	--
09/17/93	14.70	5.81	8.89	--	--	--	--	--	--	--	--	--	--
12/23/93	14.70	6.02	8.68	--	--	--	--	<50	5.5	1.3	0.7	4.0	--
03/07/94	14.70	6.52	8.18	--	--	--	--	460	180	21	27	70	--
06/17/94	14.70	5.89	8.81	--	--	--	--	<50	10	0.5	1.4	3.3	--
09/12/94	14.70	4.83	9.87	--	--	--	--	<50	6.4	<0.5	<0.5	<0.5	--
06/29/95	14.70	6.33	8.37	--	--	--	--	65	10	<0.5	2.3	9.1	--
09/13/95	14.70	5.90	8.80	--	--	--	--	370	41	0.76	17	50	--
12/19/95	14.70	6.22	8.48	--	--	--	--	<50	<0.5	<0.5	<0.5	<0.5	<2.5
03/26/96	14.70	6.97	7.73	--	--	--	--	<50	<0.5	<0.5	<0.5	<0.5	<2.5
06/10/96	14.70	6.40	8.30	--	--	--	--	<50	<0.5	<0.5	<0.5	<0.5	3.9
09/13/96	14.70	5.95	8.75	--	--	--	--	<50	<0.5	<0.5	<0.5	<0.5	<2.5
12/19/96	14.70	6.65	8.05	--	--	--	--	<50	4.2	<0.5	<0.5	<0.5	<2.5

Cumulative Table of Well Data and Analytical Results

Vertical Measurements are in feet.			Volumetric Measurements are in gallons.				Analytical results are in parts per billion (ppb)						
DATE	Well Head Elev.	Ground Water Elev.	Depth To Water	SPH Thickness	SPH Removed	Total SPH Removed	Notes	TPH-Gasoline	Benzene	Toluene	Ethyl-Benzene	Xylene	MTBE
C-6													
12/06/89	13.87	--	--	--	--	--	--	--	--	--	--	--	--
10/30/90	13.87	4.44	9.43	--	--	--	--	<50	<0.5	<0.5	<0.5	<0.5	--
01/14/91	13.87	4.46	9.41	--	--	--	--	<0.5	<0.5	<0.5	<0.5	<0.5	--
04/03/91	13.87	5.21	8.66	--	--	--	--	<0.5	<0.5	<0.5	<0.5	<0.5	--
07/17/91	13.87	4.62	9.25	--	--	--	--	<0.5	<0.5	<0.5	<0.5	<0.5	--
10/07/91	13.87	4.53	9.34	--	--	--	--	67	<0.5	0.6	<0.5	0.6	--
02/04/92	13.87	4.71	9.16	--	--	--	--	<50	<0.5	<0.5	<0.5	<0.5	--
04/01/92	13.87	5.28	8.59	--	--	--	--	<50	<0.5	<0.5	<0.5	<0.5	--
06/25/92	13.87	4.76	9.11	--	--	--	--	<50	<0.5	<0.5	<0.5	<0.5	--
09/17/92	13.87	4.59	9.28	--	--	--	--	<50	<0.5	<0.5	<0.5	<0.5	--
12/16/92	13.87	4.99	8.88	--	--	--	--	120	9.3	1.9	2.7	7.4	--
03/18/93	13.87	5.52	8.35	--	--	--	--	<50	<0.5	<0.5	<0.5	<1.5	--
06/11/93	13.87	5.66	8.21	--	--	--	--	<50	<0.5	0.7	<0.5	<1.5	--
09/08/93	13.87	--	--	--	--	--	--	<50	<0.5	<0.5	<0.5	<1.5	--
09/17/93	13.87	5.50	8.37	--	--	--	--	--	--	--	--	--	--
12/23/93	13.87	5.58	8.29	--	--	--	--	<50	1.4	1.0	<0.5	3.5	--
03/07/94	13.87	5.87	8.00	--	--	--	--	<50	0.8	<0.5	<0.5	<0.5	--
06/17/94	13.87	5.46	8.41	--	--	--	--	<50	<0.5	<0.5	<0.5	<0.5	--
09/12/94	13.87	4.99	8.88	--	--	--	--	<50	<0.5	<0.5	<0.5	<0.5	--
06/29/95	13.87	5.79	8.08	--	--	--	--	<50	<0.5	<0.5	<0.5	<0.5	--
09/13/95	13.87	5.56	8.31	--	--	--	--	<50	<0.5	<0.5	<0.5	<0.5	--
12/19/95	13.87	5.75	8.12	--	--	--	--	<50	<0.5	<0.5	<0.5	<0.5	<2.5
03/26/96	13.87	6.19	7.68	--	--	--	--	<50	<0.5	<0.5	<0.5	<0.5	<2.5
06/10/96	13.87	5.69	8.18	--	--	--	--	<50	<0.5	<0.5	<0.5	<0.5	<2.5
09/13/96	13.87	5.01	8.86	--	--	--	Sampled annually	--	--	--	--	--	--
12/19/96	13.87	6.04	7.83	--	--	--	--	--	--	--	--	--	--

Cumulative Table of Well Data and Analytical Results

Vertical Measurements are in feet.				Volumetric Measurements are in gallons.			Analytical results are in parts per billion (ppb)						
DATE	Well Head Elev.	Ground Water Elev.	Depth To Water	SPH Thickness	SPH Removed	Total SPH Removed	Notes	TPH-Gasoline	Benzene	Toluene	Ethyl-Benzene	Xylene	MTBE
C-7													
02/07/91	15.78	5.90	9.88	--	--	--	--	<50	<0.5	0.8	<0.5	<0.5	--
04/03/91	15.78	6.74	9.04	--	--	--	--	<50	<0.5	<0.5	<0.5	<0.5	--
07/17/91	15.78	5.92	9.86	--	--	--	--	<50	<0.5	<0.5	<0.5	<0.5	--
10/07/91	15.78	5.68	10.10	--	--	--	--	<50	<0.5	<0.5	<0.5	<0.5	--
02/04/92	15.78	6.04	9.74	--	--	--	--	<50	<0.5	<0.5	<0.5	<0.5	--
04/01/92	15.78	6.82	8.96	--	--	--	--	<50	<0.5	<0.5	<0.5	<0.5	--
06/25/92	15.78	6.16	9.62	--	--	--	--	<50	<0.5	<0.5	<0.5	<0.5	--
09/17/92	15.78	6.03	9.75	--	--	--	--	<50	<0.5	<0.5	<0.5	<0.5	--
12/16/92	15.78	6.37	9.41	--	--	--	--	--	--	--	--	--	--
03/18/93	15.78	7.33	8.45	--	--	--	--	<50	<0.5	<0.5	<0.5	<1.5	--
06/11/93	15.78	7.07	8.71	--	--	--	--	<50	<0.5	<0.5	<0.5	<1.5	--
09/08/93	15.78	--	--	--	--	--	--	<50	<0.5	<0.5	<0.5	<1.5	--
09/17/93	15.78	6.73	9.05	--	--	--	--	--	--	--	--	--	--
09/17/93	15.78	6.73	9.05	--	--	--	--	--	--	--	--	--	--
12/23/93	15.78	6.93	8.85	--	--	--	--	<50	1.9	1.4	<0.5	3.6	--
03/07/94	15.78	7.35	8.43	--	--	--	--	<50	2.4	1.3	<0.5	0.6	--
03/07/94	15.78	7.35	8.43	--	--	--	--	<50	<0.5	<0.5	<0.5	1.2	--
06/17/94	15.78	6.71	9.07	--	--	--	--	<50	<0.5	<0.5	<0.5	<0.5	--
09/12/94	15.78	5.98	9.80	--	--	--	--	<50	<0.5	<0.5	<0.5	<0.5	--
06/29/95	15.78	7.14	8.64	--	--	--	--	<50	<0.5	<0.5	<0.5	<0.5	--
09/13/95	15.78	6.86	8.92	--	--	--	--	<50	<0.5	<0.5	<0.5	<0.5	<2.5
12/19/95	15.78	7.06	8.72	--	--	--	--	<50	<0.5	<0.5	<0.5	<0.5	<2.5
03/26/96	15.78	7.86	7.92	--	--	--	--	<50	<0.5	<0.5	<0.5	<0.5	<2.5
06/10/96	15.78	7.26	8.52	--	--	--	--	<50	<0.5	<0.5	<0.5	<0.5	<2.5
09/13/96	15.78	6.66	9.12	--	--	--	Sampled annually	--	--	--	--	--	--
12/19/96	15.78	7.39	8.39	--	--	--	--	--	--	--	--	--	--

Cumulative Table of Well Data and Analytical Results

Vertical Measurements are in feet.

Volumetric Measurements are in gallons.

Analytical results are in parts per billion (ppb)

DATE	Well Head Elev.	Ground Water Elev.	Depth To Water	SPH Thickness	SPH Removed	Total SPH Removed	Notes	TPH-Gasoline	Benzene	Toluene	Ethyl-Benzene	Xylene	MTBE
CR-1													
10/30/90	--	--	10.51	--	--	--	--	9600	7100	65	610	190	--
01/14/91	--	--	10.29	--	--	--	--	1500	3200	52	190	77	--
07/17/91	--	--	10.19	--	--	--	--	15,000	9300	220	680	530	--
10/07/91	--	--	10.46	--	--	--	--	17,000	7600	50	440	68	--
10/07/91	--	--	10.46	--	--	--	--	14,000	9400	52	430	110	--
02/04/92	--	--	10.12	--	--	--	--	19,000	6100	32	350	100	--
04/01/92	--	--	9.24	--	--	--	--	29,000	5300	820	380	1200	--
06/25/92	--	--	10.03	--	--	--	--	12,000	3300	280	210	460	--
09/17/92	--	--	10.30	--	--	--	--	--	--	--	--	--	--
12/16/92	--	--	9.59	--	--	--	Sheen	--	--	--	--	--	--
03/18/93	--	--	8.82	0.05	--	--	--	--	--	--	--	--	--
06/11/93	--	--	9.58	0.87	--	--	--	--	--	--	--	--	--
09/08/93	--	--	--	--	--	--	--	--	--	--	--	--	--
09/17/93	--	--	--	--	--	--	--	--	--	--	--	--	--
12/23/93	--	--	9.02	0.02	--	--	--	--	--	--	--	--	--
03/07/94	--	--	8.41	0.04	--	--	--	--	--	--	--	--	--
06/17/94	--	--	--	--	--	--	--	--	--	--	--	--	--
09/12/94	--	--	15.32	0.02	--	--	--	--	--	--	--	--	--
06/29/95	--	--	8.67	--	--	--	--	49,000	9400	310	2400	7200	--
09/13/95	--	--	9.93	0.03	0.13	0.13	--	--	--	--	--	--	--
12/19/95	--	--	8.75	--	--	0.13	--	19,000	880	48	1600	3100	4000
03/26/96	--	--	7.50	--	--	0.13	--	60	2.6	<0.5	0.86	6.3	67
06/10/96	--	--	8.15	--	--	0.13	--	1100	38	30	9.7	190	54
09/13/96	--	--	9.27	--	--	0.13	--	77	1.1	<0.5	<0.5	<0.5	33
12/19/96	--	--	7.96	--	--	0.13	--	<50	0.86	<0.5	<0.5	0.62	<2.5

Cumulative Table of Well Data and Analytical Results

Vertical Measurements are in feet.				Volumetric Measurements are in gallons.			Analytical results are in parts per billion (ppb)						
DATE	Well Head Elev.	Ground Water Elev.	Depth To Water	SPH Thickness	SPH Removed	Total SPH Removed	Notes	TPH-Gasoline	Benzene	Toluene	Ethyl-Benzene	Xylene	MTBE
TRIP BLANK													
10/30/90	--	--	--	--	--	--	--	--	--	--	--	--	--
01/14/91	--	--	--	--	--	--	--	<50	<0.5	<0.5	<0.5	<0.5	<0.5
02/07/91	--	--	--	--	--	--	--	<50	<0.5	<0.5	<0.5	<0.5	<0.5
04/03/91	--	--	--	--	--	--	--	<50	<0.5	<0.5	<0.5	<0.5	<0.5
07/17/91	--	--	--	--	--	--	--	<50	<0.5	<0.5	<0.5	<0.5	<0.5
10/07/91	--	--	--	--	--	--	--	<50	<0.5	<0.5	<0.5	<0.5	<0.5
02/04/92	--	--	--	--	--	--	--	<50	<0.5	<0.5	<0.5	<0.5	<0.5
04/01/92	--	--	--	--	--	--	--	<50	<0.5	<0.5	<0.5	<0.5	<0.5
06/25/92	--	--	--	--	--	--	--	<50	<0.5	<0.5	<0.5	<0.5	<0.5
09/17/92	--	--	--	--	--	--	--	<50	<0.5	<0.5	<0.5	<0.5	<0.5
12/16/92	--	--	--	--	--	--	--	<50	<0.5	<0.5	<0.5	<0.5	<0.5
03/18/93	--	--	--	--	--	--	--	<50	<0.5	<0.5	<0.5	<1.5	<0.5
06/11/93	--	--	--	--	--	--	--	<50	<0.5	<0.5	<0.5	<1.5	<0.5
09/08/93	--	--	--	--	--	--	--	<50	<0.5	<0.5	<0.5	<1.5	<0.5
09/17/93	--	--	--	--	--	--	--	--	--	--	--	--	--
12/23/93	--	--	--	--	--	--	--	<50	<0.5	<0.5	<0.5	<0.5	<0.5
03/07/94	--	--	--	--	--	--	--	<50	<0.5	<0.5	<0.5	<0.5	<0.5
06/17/94	--	--	--	--	--	--	--	<50	<0.5	<0.5	<0.5	<0.5	<0.5
09/12/94	--	--	--	--	--	--	--	<50	<0.5	<0.5	<0.5	<0.5	<0.5
06/29/95	--	--	--	--	--	--	--	<50	<0.5	<0.5	<0.5	<0.5	<0.5
09/13/95	--	--	--	--	--	--	--	<50	<0.5	<0.5	<0.5	<0.5	<0.5
12/19/95	--	--	--	--	--	--	--	<50	<0.5	<0.5	<0.5	<0.5	<0.5
03/26/96	--	--	--	--	--	--	--	<50	<0.5	<0.5	<0.5	<0.5	<2.5
06/10/96	--	--	--	--	--	--	--	<50	<0.5	<0.5	<0.5	<0.5	<2.5
09/13/96	--	--	--	--	--	--	--	<50	<0.5	<0.5	<0.5	<0.5	<2.5
12/19/96	--	--	--	--	--	--	--	<50	<0.5	<0.5	<0.5	<0.5	<2.5

Note: Blaine Tech Services, Inc. began routine monitoring of the groundwater wells at this site on June 29, 1995.
 Earlier field data and analytical results are drawn from the October 14, 1994 Groundwater Technology, Inc. report.

ABBREVIATIONS:

TPH = Total Petroleum Hydrocarbons
 SPH = Separate Phase Hydrocarbons
 MTBE = Methyl t-Butyl Ether

Analytical Appendix



Blaine Technical Services 1680 Rogers Avenue San Jose, CA 95112	Client Proj. ID: Chevron 9-4587/961219-S2 Sample Descript: C-1 Matrix: LIQUID Analysis Method: 8015Mod/8020 Lab Number: 9612C48-01	Sampled: 12/19/96 Received: 12/20/96 Analyzed: 12/26/96 Reported: 01/03/97
---	--	---

QC Batch Number: GC122696BTEX02A
Instrument ID: GCHP2

Total Purgeable Petroleum Hydrocarbons (TPPH) with BTEX and MTBE

Analyte	Detection Limit ug/L	Sample Results ug/L
TPPH as Gas	50	51
Methyl t-Butyl Ether	2.5	N.D.
Benzene	0.50	N.D.
Toluene	0.50	N.D.
Ethyl Benzene	0.50	0.69
Xylenes (Total)	0.50	1.3
Chromatogram Pattern:		Gas

Surrogates	Control Limits %	% Recovery
Trifluorotoluene	70 130	94

Analytes reported as N.D. were not present above the stated limit of detection.

SEQUOIA ANALYTICAL - ELAP #1210

Peggy Penner
Project Manager





Blaine Technical Services 1680 Rogers Avenue San Jose, CA 95112	Client Proj. ID: Chevron 9-4587/961219-S2 Sample Descript: C-2 Matrix: LIQUID Analysis Method: 8015Mod/8020 Lab Number: 9612C48-02	Sampled: 12/19/96 Received: 12/20/96 Analyzed: 12/23/96 Reported: 01/03/97
Attention: Jim Keller		

QC Batch Number: GC122396BTEX03A
Instrument ID: GCHP3

Total Purgeable Petroleum Hydrocarbons (TPPH) with BTEX and MTBE

Analyte	Detection Limit ug/L	Sample Results ug/L
TPPH as Gas	50	N.D.
Methyl t-Butyl Ether	2.5	N.D.
Benzene	0.50	N.D.
Toluene	0.50	N.D.
Ethyl Benzene	0.50	N.D.
Xylenes (Total)	0.50	N.D.
Chromatogram Pattern:		
Surrogates	Control Limits %	% Recovery
Trifluorotoluene	70 130	102

Analytes reported as N.D. were not present above the stated limit of detection.

SEQUOIA ANALYTICAL - ELAP #1210

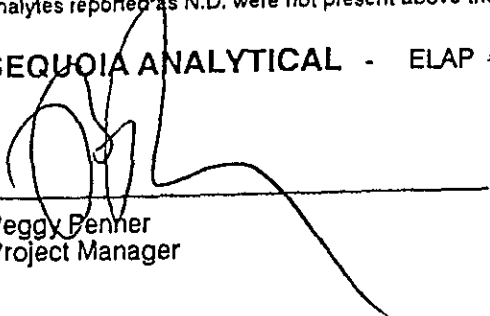
Peggy Penner
Project Manager





Blaine Technical Services 1680 Rogers Avenue San Jose, CA 95112	Client Proj. ID: Chevron 9-4587/961219-S2 Sample Descript: C-5 Matrix: LIQUID Analysis Method: 8015Mod/8020 Lab Number: 9612C48-03	Sampled: 12/19/96 Received: 12/20/96 Analyzed: 12/23/96 Reported: 01/03/97
Attention: Jim Keller		

QC Batch Number: GC122396BTEX03A
Instrument ID: GCHP3

Total Purgeable Petroleum Hydrocarbons (TPPH) with BTEX and MTBE

Analyte	Detection Limit ug/L	Sample Results ug/L
TPPH as Gas	50	N.D.
Methyl t-Butyl Ether	2.5	N.D.
Benzene	0.50	4.2
Toluene	0.50	N.D.
Ethyl Benzene	0.50	N.D.
Xylenes (Total)	0.50	N.D.
Chromatogram Pattern:		
	Control Limits %	% Recovery
Surrogates	70	130
Trifluorotoluene		105

Analytes reported as N.D. were not present above the stated limit of detection.

SEQUOIA ANALYTICAL - ELAP #1210

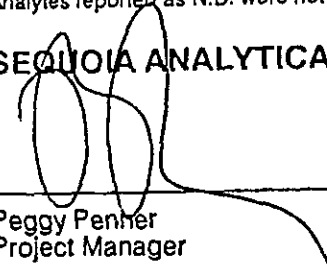
Peggy Penner
Project Manager





**Sequoia
Analytical**

680 Chesapeake Drive
404 N. Wiget Lane
819 Stnker Avenue, Suite 8

Redwood City, CA 94063
Walnut Creek, CA 94598
Sacramento, CA 95834

(415) 364-9600
(510) 988-9600
(916) 921-9600

FAX (415) 364-9233
FAX (510) 988-9673
FAX (916) 921-0100

Blaine Technical Services 1680 Rogers Avenue San Jose, CA 95112 Attention: Jim Keller	Client Proj. ID: Chevron 9-4587/961219-S2	Sampled: 12/19/96
	Sample Descript: CR-1	Received: 12/20/96
	Matrix: LIQUID	Analyzed: 12/23/96
	Analysis Method: 8015Mod/8020	Reported: 01/03/97
	Lab Number: 9612C48-04	

QC Batch Number: GC122396BTEX03A
Instrument ID: GCHP3

Total Purgeable Petroleum Hydrocarbons (TPPH) with BTEX and MTBE

Analyte	Detection Limit ug/L	Sample Results ug/L
TPPH as Gas	50	N.D.
Methyl t-Butyl Ether	2.5	N.D.
Benzene	0.50	0.86
Toluene	0.50	N.D.
Ethyl Benzene	0.50	N.D.
Xylenes (Total)	0.50	0.62
Chromatogram Pattern:		
Surrogates	Control Limits %	% Recovery
Trifluorotoluene	70 130	100

Analytes reported as N.D. were not present above the stated limit of detection.

SEQUOIA ANALYTICAL - ELAP #1210

Peggy Renner
Project Manager





Blaine Technical Services 1680 Rogers Avenue San Jose, CA 95112	Client Proj. ID: Chevron 9-4587/961219-S2 Sample Descript: TB Matrix: LIQUID Analysis Method: 8015Mod/8020 Lab Number: 9612C48-05	Sampled: 12/19/96 Received: 12/20/96 Analyzed: 12/23/96 Reported: 01/03/97
---	---	---

QC Batch Number: GC122396BTEX03A
Instrument ID: GCHP3

Total Purgeable Petroleum Hydrocarbons (TPPH) with BTEX and MTBE

Analyte	Detection Limit ug/L	Sample Results ug/L
TPPH as Gas	50	N.D.
Methyl t-Butyl Ether	2.5	N.D.
Benzene	0.50	N.D.
Toluene	0.50	N.D.
Ethyl Benzene	0.50	N.D.
Xylenes (Total)	0.50	N.D.
Chromatogram Pattern:		
Surrogates	Control Limits %	% Recovery
Trifluorotoluene	70 130	102

Analytes reported as N.D. were not present above the stated limit of detection.

SEQUOIA ANALYTICAL - ELAP #1210

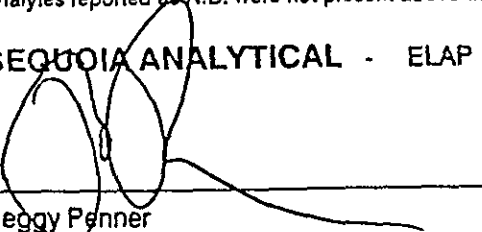
Peggy Penner
Project Manager





Blaine Technical Services
1680 Rogers Avenue
San Jose, CA 95112
Attention: Jim Keller

Client Proj. ID: Chevron 9-4587/961219-S2

Received: 12/20/96

Lab Proj. ID: 9612C48

Reported: 01/03/97

LABORATORY NARRATIVE

In order to properly interpret this report, it must be reproduced in its entirety. This report contains a total of 5 pages including the laboratory narrative, sample results, quality control, and related documents as required (cover page, COC, raw data, etc.).

SEQUOIA ANALYTICAL

Peggy Penner
Project Manager





Blaine Tech Services, Inc.
1680 Rogers Avenue
San Jose, CA 95112
Attention: Jim Keller

Client Project ID: Chevron 9-4587/961219-S2
Matrix: Liquid

Work Order #: 9612C48 -01

Reported: Jan 7, 1997

QUALITY CONTROL DATA REPORT

Analyte:	Benzene	Toluene	Ethyl Benzene	Xylenes
QC Batch#:	GC122696BTEX02A	GC122696BTEX02A	GC122696BTEX02A	GC122696BTEX02A
Analy. Method:	EPA 8020	EPA 8020	EPA 8020	EPA 8020
Prep. Method:	EPA 5030	EPA 5030	EPA 5030	EPA 5030

Analyst:	G. Fish	G. Fish	G. Fish	G. Fish
MS/MSD #:	961292705	961292705	961292705	961292705
Sample Conc.:	N.D.	N.D.	N.D.	N.D.
Prepared Date:	12/23/96	12/23/96	12/23/96	12/23/96
Analyzed Date:	12/23/96	12/23/96	12/23/96	12/23/96
Instrument I.D.#:	GCHP03	GCHP03	GCHP03	GCHP03
Conc. Spiked:	10 µg/L	10 µg/L	10 µg/L	30 µg/L

Result:	10	10	10	32
MS % Recovery:	100	100	100	107
Dup. Result:	10	10	11	32
MSD % Recov.:	100	100	110	107
RPD:	0.0	0.0	9.5	0.0
RPD Limit:	0-25	0-25	0-25	0-25

LCS #:	BLK122396	BLK122396	BLK122396	BLK122396
Prepared Date:	12/23/96	12/23/96	12/23/96	12/23/96
Analyzed Date:	12/23/96	12/23/96	12/23/96	12/23/96
Instrument I.D.#:	GCHP03	GCHP03	GCHP03	GCHP03
Conc. Spiked:	10 µg/L	10 µg/L	10 µg/L	30 µg/L
LCS Result:	10	10	11	32
LCS % Recov.:	100	100	110	107

MS/MSD	60-140	60-140	60-140	60-140
LCS	70-130	70-130	70-130	70-130
Control Limits				

SEQUOIA ANALYTICAL

Peggy Penner
Project Manager

Please Note:

The LCS is a control sample of known, interferent-free matrix that is analyzed using the same reagents, preparation, and analytical methods employed for the samples. The matrix spike is an aliquot of sample fortified with known quantities of specific compounds and subjected to the entire analytical procedure. If the recovery of analytes from the matrix spike does not fall within specified control limits due to matrix interference, the LCS recovery is to be used to validate the batch.

** MS = Matrix Spike, MSD = MS Duplicate, RPD = Relative % Difference

9612C48.BLA <1>





Sequoia Analytical

680 Chesapeake Drive
404 N. Wiget Lane
819 Striker Avenue, Suite 8

Redwood City, CA 94063
Walnut Creek, CA 94598
Sacramento, CA 95834

(415) 364-9600
(510) 988-9600
(916) 921-9600

FAX (415) 364-9233
FAX (510) 988-9673
FAX (916) 921-0100

Blaine Tech Services, Inc.
1680 Rogers Avenue
San Jose, CA 95112
Attention: Jim Keller

Client Project ID: Chevron 9-4587/961219-S2
Matrix: Liquid

Work Order #: 9612C48-02-05

Reported: Jan 7, 1997

QUALITY CONTROL DATA REPORT

Analyte:	Benzene	Toluene	Ethyl Benzene	Xylenes
QC Batch#:	GC122396BTEX03A	GC122396BTEX03A	GC122396BTEX03A	GC122396BTEX03A
Analy. Method:	EPA 8020	EPA 8020	EPA 8020	EPA 8020
Prep. Method:	EPA 5030	EPA 5030	EPA 5030	EPA 5030

Analyst:	G. Fish	G. Fish	G. Fish	G. Fish
MS/MSD #:	961268309	961268309	961268309	961268309
Sample Conc.:	N.D.	N.D.	N.D.	N.D.
Prepared Date:	12/23/	12/23/	12/23/	12/23/
Analyzed Date:	12/26/96	12/26/96	12/26/96	12/26/96
Instrument I.D.#:	GCHP02	GCHP02	GCHP02	GCHP02
Conc. Spiked:	10 µg/L	10 µg/L	10 µg/L	30 µg/L
Result:	8.6	8.7	8.9	29
MS % Recovery:	86	87	89	97
Dup. Result:	8.7	8.8	9.1	29
MSD % Recov.:	87	88	91	97
RPD:	1.2	1.1	2.2	0.0
RPD Limit:	0-25	0-25	0-25	0-25

LCS #:	BLK122696	BLK122696	BLK122696	BLK122696
Prepared Date:	12/26/96	12/26/96	12/26/96	12/26/96
Analyzed Date:	12/26/96	12/26/96	12/26/96	12/26/96
Instrument I.D.#:	GCHP02	GCHP02	GCHP02	GCHP02
Conc. Spiked:	10 µg/L	10 µg/L	10 µg/L	30 µg/L
LCS Result:	8.8	8.9	9.2	30
LCS % Recov.:	88	89	92	100

MS/MSD	60-140	60-140	60-140	60-140
LCS	70-130	70-130	70-130	70-130
Control Limits				

SEQUOIA ANALYTICAL

Peggy Penner
Project Manager

Please Note:

The LCS is a control sample of known, interferent-free matrix that is analyzed using the same reagents, preparation, and analytical methods employed for the samples. The matrix spike is an aliquot of sample fortified with known quantities of specific compounds and subjected to the entire analytical procedure. If the recovery of analytes from the matrix spike does not fall within specified control limits due to matrix interference, the LCS recovery is to be used to validate the batch.

** MS=Matrix Spike, MSD=MS Duplicate, RPD=Relative % Difference

9612C48.BLA <2>

Fax copy of Lab Report and COC to Chevron Contact: No

Chain-of-Custody-Record

Chevron U.S.A. Inc.
P.O. BOX 5004
San Ramon, CA 94583
FAX (415)842-9591

Chevron Facility Number 9-4587
Facility Address 609 Oak St., Oakland, CA
Consultant Project Number 961219-52
Consultant Name Blaine Tech Services, Inc.
Address 985 Timothy Dr., San Jose, CA 95133
Project Contact (Name) Jim Keller
(Phone) 408 995-5535 (Fax Number) 408 293-8773

Chevron Contact (Name) Phil Briggs
(Phone) (510) 842-9136
Laboratory Name SEQUOIA
Laboratory Release Number 2172490
Samples Collected by (Name) DOUG SANDERS
Collection Date 12-19-96
Signature D.S.

Sample Number	Lab Sample Number	Number of Containers	Matrix S = Soil W = Water A = Air C = Charcoal	Type G = Grab C = Composite D = Discrete	Time	Sample Preservation	Iced (Yes or No)	Analytes To Be Performed														
								BTX + TPH GAS (8029 + 8015)	TPH Diesel (8015)	Oil and Grease (8020)	Purgeable Halocarbons (8010)	Purgeable Aromatics (8020)	Purgeable Organics (8040)	Extractable Organics (8070)	Metals Cd, Cr, Pb, Zn, Ni (ICAP or AA)	MTBE						
C-1	1	3	W	D	12:30	HCl	Y	X														
C-2	2	3	W	D	12:10		Y	X														
C-5	3	3	W	D	11:55		Y	X														
CR-1	4	3	W	D	12:50		Y	X														
TB	5	2	W	D			Y	X														

DO NOT BILL
FOR TB-LB
9612C48
Remarks

Dec 21

11/19/96

Relinquished By (Signature)

Organization BTS

Date/Time 12/20/96

Received By (Signature)

Organization SSA

Date/Time 12/20/96

Turn Around Time (Circle Choice)

Relinquished By (Signature)

Organization SSA

Date/Time 12/30/96

Received By (Signature)

Organization

Date/Time

- 24 Hrs.
- 48 Hrs.
- 5 Days
- 10 Days
- As Contracted

Relinquished By (Signature)

Organization

Date/Time

Received For Laboratory By (Signature)

Date/Time 12/20/96

Date/Time 11:35

Field Data Sheets

587

Sampling Point:
or TOC

OC

✓

11

CHEVRON WELL MONITORING DATA SHEET

Project #: 961219-52	Station #: 9-4587
Sampler: DOUG	Date: 12-19-96
Well I.D.: C-2	Well Diameter: 2 (3) 4 6 8
Total Well Depth: 12.71	Depth to Water: 8.38
Depth to Free Product:	Thickness of Free Product (feet):
Referenced to: PVC Grade	D.O. Meter (if req'd): YSI HACH

Well Diameter	Multiplier	Well Diameter	Multiplier
2"	0.16	5"	1.02
3"	0.37	6"	1.47
4"	0.65	Other	radius ² * 0.163

Purge Method: Bailer Disposable Bailer Middleburg Electric Submersible Extraction Pump Other: _____

Sampling Method: Bailer Disposable Bailer Extraction Port Other: _____

<u>1.6</u>	x	<u>3</u>	=	<u>4.8</u>	Gals.
1 Case Volume (Gals.)		Specified Volumes		Calculated Volume	

Time	Temp (°F)	pH	Cond.	Gals. Removed	Observations
12:03	67.2	7.4	330	1.5	
12:05	67.0	7.5	300	3.0	
12:07	67.2	7.5	290	5.0	

Did well dewater? Yes No Gallons actually evacuated: 5.0

Sampling Time: 12:10 Sampling Date: 12-19-96

Sample I.D.: C-2 Laboratory: Sequoia GTEL N. Creek Assoc. Labs

Analyzed for: TPH-G BTEX MTBE TPH-D Other: _____

Duplicate I.D.: Analyzed for: TPH-G BTEX MTBE TPH-D Other: _____

D.O. (if req'd):	Pre-purge:	mg/L	Post-purge:	mg/L
O.R.P. (if req'd):	Pre-purge:	mV	Post-purge:	mV

CHEVRON WELL MONITORING DATA SHEET

Project #: 961219-SZ	Station #: 9-4587
Sampler: DOUG	Date: 12-19-96
Well I.D.: C-5	Well Diameter: (2) 3 4 6 8
Total Well Depth: 28.76	Depth to Water: 8.05
Depth to Free Product:	Thickness of Free Product (feet):
Referenced to: PVC Grade	D.O. Meter (if req'd): YSI HACH

Well Diameter	Multiplier	Well Diameter	Multiplier
2"	0.16	5"	1.02
3"	0.37	6"	1.47
4"	0.65	Other	radius ² * 0.163

Purge Method: Bailer Disposable Bailer Middleburg Electric Submersible Extraction Pump

Other: _____

Sampling Method: Bailer Disposable Bailer Extraction Port

Other: _____

<u>3.3</u>	x	<u>3</u>	=	<u>9.9</u>	Gals.
1 Case Volume (Gals.)		Specified Volumes		Calculated Volume	

Time	Temp (°F)	pH	Cond.	Gals. Removed	Observations
11:40	71.2	7.6	740	3.5	
11:45	70.4	7.6	720	7.0	
11:49	70.6	7.6	730	10.0	

Did well dewater? Yes No Gallons actually evacuated: 10.0

Sampling Time: 11:55 Sampling Date: 12-19-96

Sample I.D.: C-5 Laboratory: Sequoia GTEL N. Creek Assoc. Labs

Analyzed for: TPH-G BTEX MTBE TPH-D Other: _____

Duplicate I.D.: Analyzed for: TPH-G BTEX MTBE TPH-D Other: _____

D.O. (if req'd):	Pre-purge:	mg/L	Post-purge:	mg/L
O.R.P. (if req'd):	Pre-purge:	mV	Post-purge:	mV

CHEVRON WELL MONITORING DATA SHEET

Project #: 961219-52	Station #: 9-4587
Sampler: DOUG	Date: 12-19-96
Well I.D.: CR-01	Well Diameter: 2 3 4 6 8
Total Well Depth: 27.20	Depth to Water: 7.96
Depth to Free Product:	Thickness of Free Product (feet):
Referenced to: PVC Grade	D.O. Meter (if req'd): YSI HACH

Well Diameter	Multiplier	Well Diameter	Multiplier
2"	0.16	5"	1.02
3"	0.37	6"	1.47
4"	0.65	Other	radius ² * 0.163

Purge Method:	Sampling Method:
Bailer	Bailer
Disposable Bailer	Disposable Bailer
Middleburg	Extraction Port
Electric Submersible	Other: _____
Extraction Pump	
Other: _____	

<u>28.3</u>	x	<u>3</u>	=	<u>84.8</u>	Gals.
1 Case Volume (Gals.)		Specified Volumes		Calculated Volume	

Time	Temp (°F)	pH	Cond.	Gals. Removed	Observations
12:42	68.4	7.2	690	29	
12:45	68.8	7.3	680	58	
12:48	68.6	7.2	700	85	

Did well dewater? Yes No	Gallons actually evacuated: 85.0
Sampling Time: 12:50	Sampling Date: 12-19-96
Sample I.D.: CR-1	Laboratory: Sequoia GTEL N. Creek Assoc. Labs
Analyzed for: TPH-G BTEX MTBE TPH-D Other: _____	
Duplicate I.D.:	Analyzed for: TPH-G BTEX MTBE TPH-D Other:
D.O. (if req'd):	Pre-purge: _____ mg/L Post-purge: _____ mg/L
O.R.P. (if req'd):	Pre-purge: _____ mV Post-purge: _____ mV